

PROVINCE OF THE EASTERN CAPE  
IPHONDO LEMPUMA KOLONI  
PROVINSIE OOS-KAAP

**Provincial Gazette**  
**Igazethi Yephondo**  
**Provinsiale Koerant**

Vol. 15

BISHO/  
KING WILLIAM'S TOWN, 25 JULY 2008

**No. 1941**  
(Extraordinary)

---

---

**CONTENTS • INHOUD**

*No.*

*Page  
No.    Gazette  
         No.*

**PROVINCIAL NOTICE**

27	Nature Conservation Ordinance (19/1974): Alteration of boundaries of local nature reserve.....	3	1941
----	--	---	------

---

---

---

**PROVINCIAL NOTICE**

---

**PROVINCIAL NOTICE 27 OF 2008****PROVINCE OF THE EASTERN CAPE****DEPARTMENT OF ECONOMIC DEVELOPMENT AND ENVIRONMENTAL  
AFFAIRS****ALTERATION OF BOUNDARIES OF A LOCAL NATURE RESERVE IN  
TERMS OF SECTION 7 (7) OF THE NATURE CONSERVATION  
ORDINANCE, 1974 (ORDINANCE NO.19 OF 1974).**

I, **MBULELO SOGONI**, Member of the Executive Council responsible for Economic Development & Environmental Affairs in the Province of the Eastern Cape, acting in terms of section 7 (7) of the Nature Conservation Ordinance, 1974 (Ordinance No. 19 of 1974) hereby alter the boundary of the Nelson Mandela University Private Reserve by deproclaiming and removing the area highlighted and fully described in the Schedule hereto, from the area demarcated and proclaimed as the Nelson Mandela University Private Reserve.



---

**MBULELO SOGONI****MEC: DEPARTMENT OF ECONOMIC DEVELOPMENT &  
ENVIRONMENTAL AFFAIRS**

SIDES Metres		ANGLES OF DIRECTION	CO-ORDINATES Y System WG25 X		S.G. No.
		Constant		0,00	+3700000,00
AB	227,04	340 12 00	A	- 63 315,76	+ 64 310,31
BC	399,20	38 59 10	B	-63 392,66	+ 64 523,92
CD	391,01	52 26 40		-63 141,51	+ 64 834,21
DE	336,15	63 48 50		-62 831,53	+ 65 072,53
EF	167,19	181 05 20	E	-62 529, 88	+ 65 220,87
FG	187,72	84 11 00	F	-62 533,06	+65 053,71
GH	69,06	174 15 00	G	-62 346,31	+65 072, 74
HJ	420,99	90 00 20	H	-62 339,39	+65 004, 02
JK	34,70	99 44 10	J	-61 918,40	+65 003,99
KL	60,65	90 37 20	K	-61 884,20	+64 998,12
LM	100,46	24 41 50	L	-61 823,56	+64 997,46
MN	242,46	91 52 50	M	-61 781,58	+65 088,73
NP	270,58	154 22 40	N	-61 539,25	+65 080,77
PQ	77,36	181 01 50	P	-61 422,25	+64 836,80
QR	38,88	214 16 00	Q	-61 423, 64	+64 759,45
RS	84,60	272 37 20	R	-61 445,53	+64 727,32
ST	100,20	155 19 00	S	-61 530,04	+64 731,19
TU	135,14	179 48 00	T	-61 488,20	+64 640,14
UV	1019,73	270 01 10	U	-61 487,73	+64 505,00
VW	30,66	278 51 20	V	-62 507,46	+64 505,33
WX	18,35	291 21 00	W	-62 537 75	+64 510,05
XY	16,97	302 09 02	X	-62 554,84	+ 64 516,73
YZ	58,16	271 07 50	Y	- 62 569,21	+64 525,76
ZA1	102,13	179 12 50	Z	-62 627,36	+64 526,91
A1B1	6,53	257 52 50	A1	-62 625,96	+64 424,79
B1A	692,71	260 36 10	B1	-62 632,34	+64 423 42
	(461) Plamer New			-58 803,70	+ 64 601, 64
	(398) Snake			-58 740,11	+ 64 633, 96

Approved

Surveyor-General

Sheet 1 of 2 Sheets

The figure ABCDEFGHIJKLMNOPQRSTUVWXYZA1B1 represents 103,8081 hectares of land being

**AREA No. 1 TO BE DEPROCLAIMED OVER ERF 1612 SUMMERSTRAND**

Situated in the Nelson Mandela Metropolitan Municipality  
Administrative District of Port Elizabeth  
PROVINCE OF THE EASTERN CAPE

Surveyed in March 2006  
by me

R. J. Hemsley (PLS 0258)  
Professional Land Surveyor

This diagram is annexed to No.	The original diagram is	File No. 8/6166/49
Dated	No. 4857/73 annexed to	S. R. No.
i.f.o	Transfer/Grant	Comp. AO-2AB (3639)
Registrar of Deeds	No.	

S.G. No.

Approved

Surveyor-General

Sheet 2 of 2 Sheets

**Beacons**

A,B1-concrete block with centre peg.  
 R,S, T, U, V,W,X,Y,Z,A1 -12mm from peg at kerb.  
 All other beacons are 12mm iron peg.

**Servitude Note**

The line a b c represents the southern boundary of an existing servitude road vide Dgm. No.4861/1973

1. The line a b c represents the southern boundary of an existing servitude road vide Dgm. No. 4861/1973
2. The line d e represents the southern boundary of an existing servitude road vide Dgm. No. 4861/1973
3. The line x y represents the centre line of an existing sewer servitude 10,00m wide vide Dgm No. 4861/1973

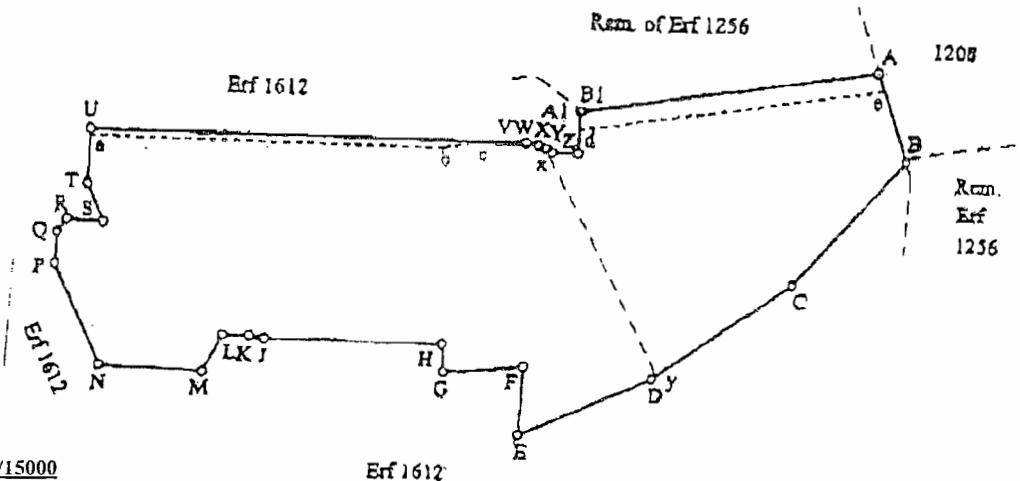

Scale 1/15000

The figure A B C D E F G H J K L M N P Q R S T U V W X Y Z A1 B1 represents 103,8081 hectares of land being

**AREA No. 1 TO BE DEPROCLAIMED OVER ERF 1612 SUMMERSTRAND**

Situated in the Nelson Mandela Metropolitan Municipality  
 Administrative District of Port Elizabeth  
 PROVINCE OF THE EASTERN CAPE

Surveyed in March 2006  
 by me

R. J. Hemssley (PLS 0258)  
 Professional Land Surveyor

SIDES Metres		ANGLES OF DIRECTION	CO-ORDINATES Y System WG25 X			S.G. No.
		Constant		0,00	+3700000,00	
AB	305,19	1 03 50	A	- 61 272,70	+ 64 913,32	Approved  Surveyor-General
BC	223,47	90 34 50	B	-61 267,02	+ 65 218,46	
CD	136,03	180 46 50	C	-61 043,57	+ 65 216,20	
DE	66,73	89 41 30	D	-61 045,42	+ 65 080,18	
EF	80,97	181 44 20	E	-60 978,69	+ 65 080,54	
FA	304,05	253 30 50	F	-60 981,15	+64 999,61	

(461) Plamer New  
(398) Snake

-58 803,70      + 64 601, 64  
- 58 740,11      + 64 633, 96

**Beacons**

All beacons are 12mm iron peg.

T N

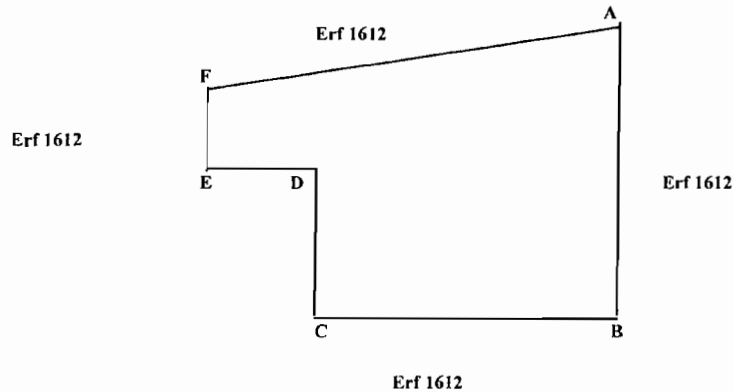

Scale 1/5000

The figure A B C D E F represents 6,6619 hectares of land being

**AREA No. 1 TO BE DEPROCLAIMED OVER ERF 1612 SUMMERSTRAND**

Situated in the Nelson Mandela Metropolitan Municipality  
Administrative District of Port Elizabeth  
PROVINCE OF THE EASTERN CAPE

Surveyed in March 2006  
by me

R. J. Hemsley (PLS 0258)  
Professional Land Surveyor

This diagram is annexed to No.	The original diagram is No. 4857/73 annexed to	File No. 8/6166/49
Dated i.f.o	Transfer/Grant No.	S. R. No.
Registrar of Deeds		Comp. AO-2AB (3639)

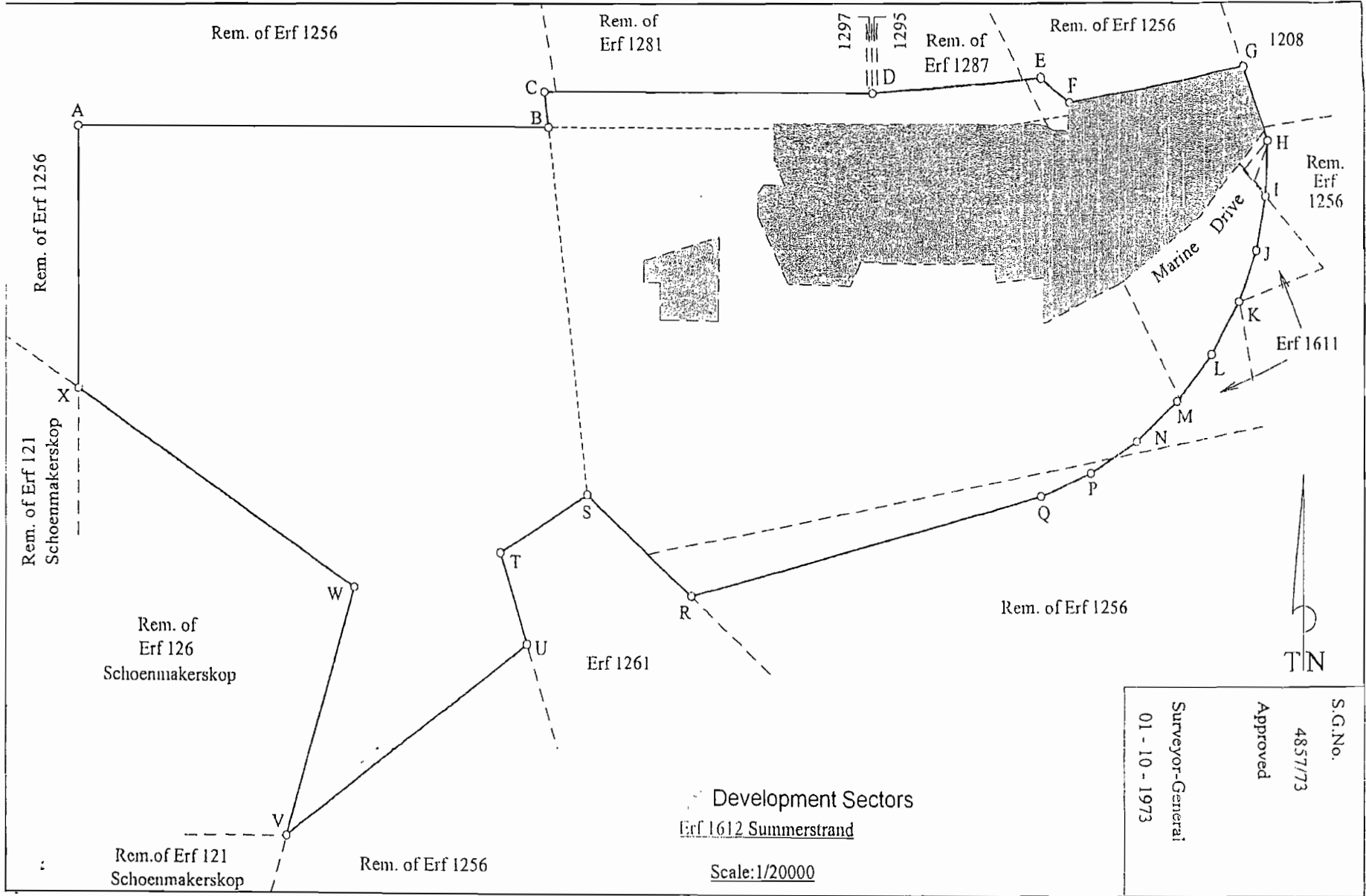

S.G.No.  
4837/73  
Approved  
Surveyor-General  
01 - 10 - 1973

Development Sectors  
Erf 1612 Summerstrand  
Scale: 1/20000