

PROVINCE OF THE EASTERN CAPE
IPHONDO LEMPUMA KOLONI
PROVINSIE OOS-KAAP

Provincial Gazette
Igazethi Yephondo
Provinsiale Koerant

Vol. 26

BISHO/KING WILLIAM'S TOWN
4 FEBRUARY 2019
4 FEBRUARIE 2019

No. 4178

CONTENTS

		<i>Gazette</i>	<i>Page</i>
		<i>No.</i>	<i>No.</i>
PROVINCIAL NOTICES • PROVINSIALE KENNISGEWINGS			
16	Spatial Planning and Land Use Management Act (16/2013): Erf 237, Amsterdamhoek	4178	11
17	Spatial Planning and Land Use Management Act (16/2013): Erf 89, Kabega, Port Elizabeth, Eastern Cape ...	4178	11
18	Mineral and Petroleum Resources Development Act (28/2002): Notice regarding consultation with interested and affected persons	4178	12
19	Spatial Planning and Land Use Management Act (16/2013): Erf 2158, Walmer, Port Elizabeth, Eastern Cape 4178	4178	17
20	Spatial Planning and Land Use Management Act (16/2013): Erf 708, Beacon Bay	4178	17
21	Spatial Planning and Land Use Management Act (16/2013): Erf 885, Summerstrand, Port Elizabeth, Eastern Cape	4178	17
LOCAL AUTHORITY NOTICES • PLAASLIKE OWERHEIDS KENNISGEWINGS			
20	Local Government: Municipal Property Rates Act (6/2004): Public notice calling for inspection of supplementary valuation roll and lodging of objections	4178	18
26	Spatial Planning and Land Use Management Act (16/2013): Erf 2306, Gonubie	4178	19
27	Spatial Planning and Land Use Management Act (16/2013): Erf 2518, Gonubie	4178	19
28	Land Use Regulations Act (15/1987): Rezoning of a Portion of Farm 1404, East London, Mdantsane NU 2 (Slovo Park)	4178	20
29	Land Use Regulations Act, 15 of 1987: Rezoning of a Portion of Farm 1404, East London, Mdantsane NU2 (Ekuphumleni)	4178	21

Closing times for **ORDINARY WEEKLY** 2019 EASTERN CAPE PROVINCIAL GAZETTE

The closing time is **15:00** sharp on the following days:

- **28 December 2018**, Friday for the issue of Monday **07 January 2019**
- **07 January**, Monday for the issue of Monday **14 January 2019**
- **14 January**, Monday for the issue of Monday **21 January 2019**
- **21 January**, Monday for the issue of Monday **28 January 2019**
- **28 January**, Monday for the issue of Monday **04 February 2019**
- **04 February**, Monday for the issue of Monday **11 February 2019**
- **11 February**, Monday for the issue of Monday **18 February 2019**
- **18 February**, Monday for the issue of Monday **25 February 2019**
- **25 February**, Monday for the issue of Monday **04 March 2019**
- **04 March**, Monday for the issue of Monday **11 March 2019**
- **11 March**, Monday for the issue of Monday **18 March 2019**
- **15 March**, Friday for the issue of Monday **25 March 2019**
- **25 March**, Monday for the issue of Monday **01 April 2019**
- **01 April**, Wednesday for the issue of Monday **08 April 2019**
- **08 April**, Monday for the issue of Monday **15 April 2019**
- **12 April**, Friday for the issue of Monday **22 April 2019**
- **18 April**, Thursday for the issue of Monday **29 April 2019**
- **26 April**, Friday for the issue of Monday **06 May 2019**
- **06 May**, Monday for the issue of Monday **13 May 2019**
- **13 May**, Monday for the issue of Monday **20 May 2019**
- **20 May**, Monday for the issue of Monday **27 May 2019**
- **27 May**, Monday for the issue of Monday **03 June 2019**
- **03 June**, Monday for the issue of Monday **10 June 2019**
- **10 June**, Monday for the issue of Monday **17 June 2019**
- **14 June**, Friday for the issue of Monday **24 June 2019**
- **24 June**, Monday for the issue of Monday **01 July 2019**
- **01 July**, Monday for the issue of Monday **08 July 2019**
- **08 July**, Monday for the issue of Monday **15 July 2019**
- **15 July**, Monday for the issue of Monday **22 July 2019**
- **22 July**, Monday for the issue of Monday **29 July 2019**
- **29 July**, Monday for the issue of Monday **05 August 2019**
- **02 August**, Friday for the issue of Monday **12 August 2019**
- **12 August**, Monday for the issue of Monday **19 August 2019**
- **19 August**, Monday for the issue of Monday **26 August 2019**
- **26 August**, Monday for the issue of Monday **02 September 2019**
- **02 September**, Monday for the issue of Monday **09 September 2019**
- **09 September**, Monday for the issue of Monday **16 September 2019**
- **16 September**, Monday for the issue of Monday **23 September 2019**
- **20 September**, Friday for the issue of Monday **30 September 2019**
- **30 September**, Monday for the issue of Monday **07 October 2019**
- **07 October**, Monday for the issue of Monday **14 October 2019**
- **14 October**, Monday for the issue of Monday **21 October 2019**
- **21 October**, Monday for the issue of Monday **28 October 2019**
- **28 October**, Monday for the issue of Monday **04 November 2019**
- **04 November**, Monday for the issue of Monday **11 November 2019**
- **11 November**, Monday for the issue of Monday **18 November 2019**
- **18 November**, Monday for the issue of Monday **25 November 2019**
- **25 November**, Monday for the issue of Monday **02 December 2019**
- **02 December**, Monday for the issue of Monday **09 December 2019**
- **09 December**, Monday for the issue of Monday **16 December 2019**
- **13 December**, Friday for the issue of Monday **23 December 2019**
- **19 December**, Thursday for the issue of Monday **30 December 2019**

PROVINCIAL NOTICES • PROVINSIALE KENNISGEWINGS

PROVINCIAL NOTICE 16 OF 2019

Nelson Mandela Bay Municipality (EASTERN CAPE)

Removal of Restrictions in terms of the Spatial Planning and Land Use Management Act, 2013 (Act 16 of 2013)

ERF 237 AMSTERDAMHOEK, PORT ELIZABETH, EASTERN CAPE

Under Section 47 of the Spatial Planning and Land Use Management Act, 2013 (Act 16 of 2013) and upon instructions by the Local Authority, notice is hereby given that conditions B.5. (b), (c), (d) in Deed of Transfer No.T40626/2010 applicable to Erf 237 Amsterdamhoek are hereby removed.

PROVINCIAL NOTICE 17 OF 2019

Nelson Mandela Bay Municipality (EASTERN CAPE)

Removal of Restrictions in terms of the Spatial Planning and Land Use Management Act, 2013 (Act 16 of 2013)

ERF 89 KABEGA, PORT ELIZABETH, EASTERN CAPE

Under Section 47 of the Spatial Planning and Land Use Management Act, 2013 (Act 16 of 2013) and upon instructions by the Local Authority, notice is hereby given that conditions B.18. (a), (b), (c), (d) and C.(b), (c), (d) in Deed of Transfer No.T40556/2007 applicable to Erf 89 Kabega are hereby removed.

PROVINCIAL NOTICE 18 OF 2019

Petroleum Agency SA

Tygerpoort Building · 7 Mispel Street · Bellville 7530 · P.O. Box 5111 Tygervalley 7536 · South Africa
 Tel: +27 21 938 3500 · Fax: +27 21 938 3520
 E-mail: plu@petroleumagencysa.com



NOTICE REGARDING CONSULTATION WITH INTERESTED AND AFFECTED PERSONS IN TERMS OF SECTION 10 READ WITH REGULATION 3 OF THE MINERAL AND PETROLEUM RESOURCES DEVELOPMENT ACT, 2002 (ACT NO. 28 OF 2002)

File Ref No: 12/3/351 ER

Notice is hereby given in terms of Section 10 (1) of the Mineral and Petroleum Resources Development Act, 2002 (Act No.28 of 2002) that I, Lindiwe Mekwe, Acting Chief Executive Officer of Petroleum Agency SA, have on the **21st of January 2019** accepted an application for an Exploration Right for **Petroleum** submitted by Gondwana Energy (Pty) Ltd.

APPLICATION DETAILS:	
Date of receipt of application:	04 January 2019
Sketch Plan and co-ordinates depicting the application area, and a list of farms are attached as:	Annexure A1, A2 and A3
Contact Details of the Applicant	Mr. Roy Manson Brebner Gondwana Energy (Pty) Ltd 17 Arthurs Court 222 High Level Road Sea Point Cape Town 8005 Tel: +2721 434 7136 E- Mail: oilrig@mweb.co.za
Contact Details of the Agency	Chief Executive Officer P.O Box 5111 Tygervalley 7536 Tel: 021 938 3500 Fax: 021 938 3520 Email: plu@petroleumagencysa.com

Any person wishing to submit comments on the above application should, in accordance with Section 10 (1) (b) of the above Act, do so in writing **within 30 days from date of publication**, for the attention of the **Chief Executive Officer** at the address indicated above.

Dated in Cape Town on the **21st of January 2019**

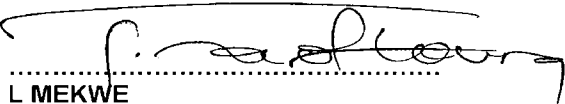

L MEKWE
ACTING CHIEF EXECUTIVE OFFICER

Directors: MP Fusi (Chairperson)

B Luthuli R Nkambule L Nengovhela L Mekwe (Acting Executive)

Company Secretary: E Hendricks

Subsidiary of CEF SOC Ltd.
 South African Agency for Promotion of Petroleum Exploration and Exploitation SOC Ltd. Registration No. 1999/015715/30



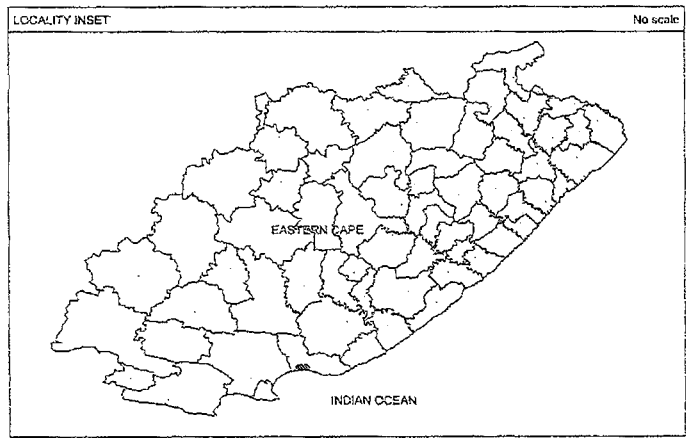

+ 37 22800 X
+ 35 000 Y

+ 37 22800 X
+ 35 000 Y

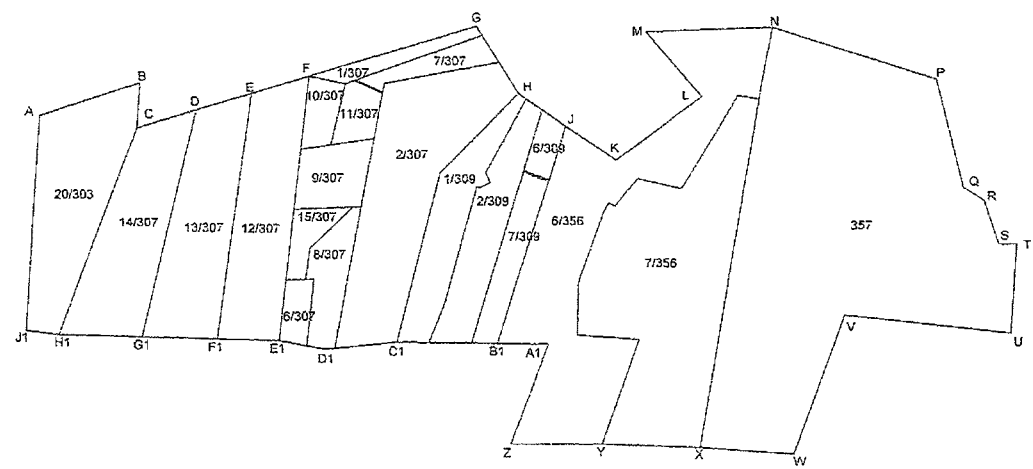

+ 37 33000 X
+ 35 000 Y

+ 37 33000 X
+ 35 000 Y

**GONDWANA ENERGY
(PTY) LIMITED**
**Coordinate Map Plan 006
(sheet 1 of 2 sheets)**

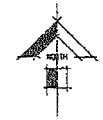

R. C. Abrahamse
R. C. Abrahamse (PLS 0032)
Professional Land Surveyor

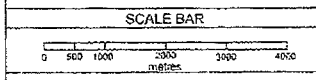

AREA DESCRIPTION

The figure A B C D E F G H I J K L M N P Q R S T U V W X Y High Water Mark of Indian Ocean X High Water Mark of Indian Ocean Y High Water Mark of Indian Ocean Z A1 B1 C1 D1 E1 F1 G1 H1 J1 represents 20 farms and farm portions as annotated and listed on sheet 2, together measuring 7635 hectares of land situated in the Administrative District of Alexandria in the Province of the Eastern Cape

All co-ordinates are in the Hartebeeshoek 94 datum.

dh-ta	david helleg - abrahamse professional land surveyors 2nd floor wale street chambers 38 wale street, cape town Tel: +27 021 426 2613 info@dhata.co.za www.dhata.co.za

date	5 May 2017
scale	1 / 75 000
ref no	L11791
drawing no.	GE MAP PLAN 006 (Sheet 1 of 2 Sheets)

Farm List no 1		Farm List no 2		Farm List no 3	
Original Farm Name:	Springmount	Original Farm Name:	Springmount	Original Farm Name:	Springmount
and Farm Number:	356/ 2	and Farm Number:	356/5	and Farm Number:	356/6
Subdivision name & no.	Sea View 357	Subdivision name & no.	Sea View 356	Subdivision name & no.	Springmount 356

Farm List no 4		Farm List no 5		Farm List no 6	
Original Farm Name:	Groenkop	Original Farm Name:	Groenkop	Original Farm Name:	Groenkop
and Farm Number:	309	and Farm Number:	309	and Farm Number:	309
Subdivision name & no.	Groenkop 3	Subdivision name & no.	Groenkop 2	Subdivision name & no.	Groenkop1

Farm List no 7		Farm List no 8		Farm List no 9	
Original Farm Name:	Congas Kraal	Original Farm Name:	Congas Kraal	Original Farm Name:	Congas Kraal
and Farm Number:	307	and Farm Number:	307	and Farm Number:	307
Subdivision name & no.	Lindney 2	Subdivision name & no.	Congas Kraal 12	Subdivision name & no.	Summer Pride 6

Farm List no 10		Farm List no 11		Farm List no 12	
Original Farm Name:	Congas Kraal	Original Farm Name:	Congas Kraal	Original Farm Name:	Congas Kraal
and Farm Number:	307	and Farm Number:	307	and Farm Number:	307
Subdivision name & no.	Koppie Strand 8	Subdivision name & no.	Koppie Strand 15	Subdivision name & no.	Bethal 9

Farm List no 13		Farm List no 14		Farm List no 15	
Original Farm Name:	Congas Kraal	Original Farm Name:	Congas Kraal	Original Farm Name:	Congas Kraal
and Farm Number:	307	and Farm Number:	307	and Farm Number:	307
Subdivision name & no.	Uitzicht 11	Subdivision name & no.	Ou Werf 10	Subdivision name & no.	Basryk 7

Farm List no 16		Farm List no 17		Farm List no 18	
Original Farm Name:	Congas Kraal	Original Farm Name:	Congas Kraal	Original Farm Name:	Platte Rug
and Farm Number:	307	and Farm Number:	307	and Farm Number:	303/20
Subdivision name & no.	Congas Kraal 13	Subdivision name & no.	Congas Kraal 14	Subdivision name & no.	Platte Rug 20

Farm List no 19		Farm List no 20		Farm List no 21	
Original Farm Name:	The Farm	Original Farm Name:	The Farm	Original Farm Name:	The Farm
and Farm Number:	296	and Farm Number:	296	and Farm Number:	296
Subdivision name & no.	Farm 296 /2	Subdivision name & no.	Farm REM296	Subdivision name & no.	Farm 296 /5

Farm List no 22		Farm List no 23		Farm List no 24	
Original Farm Name:	The Farm	Original Farm Name:	The Farm	Original Farm Name:	The Farm
and Farm Number:	296	and Farm Number:	296	and Farm Number:	296
Subdivision name & no.	Farm 296 /11	Subdivision name & no.	Farm 296 /10	Subdivision name & no.	Farm 296 /9

Farm List no 25		Farm List no 26		Farm List no 27	
Original Farm Name:	The Farm	Original Farm Name:	The Farm	Original Farm Name:	The Farm
and Farm Number:	296	and Farm Number:	296	and Farm Number:	296
Subdivision name & no.	Farm 296 /3	Subdivision name & no.	Farm 296 /6	Subdivision name & no.	Farm 296 /8

Farm List no 28		Farm List no 29		Farm List no 30	
Original Farm Name:	Nanaga Hoogte	Original Farm Name:	Nanaga Hoogte	Original Farm Name:	Nanaga Hoogte
and Farm Number:	299	and Farm Number:	299	and Farm Number:	299
Subdivision name & no.	1	Subdivision name & no.	22	Subdivision name & no.	35

Farm List no 31		Farm List no 32		Farm List no 33	
Original Farm Name:	Nanaga Hoogte	Original Farm Name:	Nanaga Hoogte	Original Farm Name:	Nanaga Hoogte
and Farm Number:	299	and Farm Number:	299	and Farm Number:	299
Subdivision name & no.	26	Subdivision name & no.	10	Subdivision name & no.	11

Farm List no 34		Farm List no 35		Farm List no 36	
Original Farm Name:	Nanaga Hoogte	Original Farm Name:	Nanaga Hoogte	Original Farm Name:	Nanaga Hoogte
and Farm Number:	299	and Farm Number:	299	and Farm Number:	299
Subdivision name & no.	29	Subdivision name & no.	2	Subdivision name & no.	12

Farm List no 37		Farm List no 38		Farm List no 39	
Original Farm Name:	Nanaga Hoogte	Original Farm Name:	Nanaga Hoogte	Original Farm Name:	Nanaga Hoogte
and Farm Number:	299	and Farm Number:	299	and Farm Number:	299
Subdivision name & no.	13	Subdivision name & no.	4	Subdivision name & no.	RE 299

Farm List no 40		Farm List no 41		Farm List no 42	
Original Farm Name:	Nanaga Hoogte	Original Farm Name:	Nanaga Hoogte	Original Farm Name:	Nanaga Hoogte
and Farm Number:	299	and Farm Number:	299	and Farm Number:	299
Subdivision name & no.	30	Subdivision name & no.	27	Subdivision name & no.	14

Farm List no 43		Farm List no 44		Farm List no 45	
Original Farm Name:	Nanaga Hoogte	Original Farm Name:	Nanaga Hoogte	Original Farm Name:	Kinkelbosch
and Farm Number:	299	and Farm Number:	299	and Farm Number:	Outspan 301
Subdivision name & no.	15	Subdivision name & no.	28	Subdivision name & no.	1

Farm List no 46		Farm List no 47		Farm List no 48	
Original Farm Name:	Kinkelbosch	Original Farm Name:	Kinkelbosch	Original Farm Name:	Kinkelbosch
and Farm Number:	Outspan 301	and Farm Number:	Outspan 301	and Farm Number:	Outspan 301
Subdivision name & no.	6	Subdivision name & no.	2	Subdivision name & no.	9

Farm List no 49		Farm List no 50		Farm List no 51	
Original Farm Name:	Kinkelbosch	Original Farm Name:	Kinkelbosch	Original Farm Name:	Kinkelbosch
and Farm Number:	Outspan 301	and Farm Number:	Outspan 301	and Farm Number:	Outspan 301
Subdivision name & no.	3	Subdivision name & no.	14	Subdivision name & no.	15

Farm List no 52		Farm List no 53		Farm List no 54	
Original Farm Name:	Kinkelbosch	Original Farm Name:	Olifants Plaats	Original Farm Name:	Olifants Plaats
and Farm Number:	Outspan 301	and Farm Number:	214	and Farm Number:	214
Subdivision name & no.	RE 301	Subdivision name & no.	1	Subdivision name & no.	REM 214

Farm List no 55		Farm List no 56		Farm List no 57	
Original Farm Name:	ingelside	Original Farm Name:	Ingelside	Original Farm Name:	Ingelside
and Farm Number:	215	and Farm Number:	216	and Farm Number:	215
Subdivision name & no.	8	Subdivision name & no.	6	Subdivision name & no.	10

Farm List no 58		Farm List no 59		Farm List no 60	
Original Farm Name:	ingelside	Original Farm Name:	ingelside	Original Farm Name:	Melville
and Farm Number:	215	and Farm Number:	215	and Farm Number:	308
Subdivision name & no.	9	Subdivision name & no.	4	Subdivision name & no.	3

Farm List no 61		Farm List no 62		Farm List no 63	
Original Farm Name:	Melville	Original Farm Name:	Tanka tara	Original Farm Name:	Tanka tara
and Farm Number:	308	and Farm Number:	643	and Farm Number:	643
Subdivision name & no.	4	Subdivision name & no.	1	Subdivision name & no.	643 REM

Farm List no 64		Farm List no 65		Farm List no 66	
Original Farm Name:		Original Farm Name:		Original Farm Name:	
and Farm Number:		and Farm Number:		and Farm Number:	
Subdivision name & no.		Subdivision name & no.		Subdivision name & no.	

PROVINCIAL NOTICE 19 OF 2019**Nelson Mandela Bay Municipality (EASTERN CAPE)****Removal of Restrictions in terms of the Spatial Planning and Land Use Management Act, 2013 (Act 16 of 2013)****ERF 2158 WALMER, PORT ELIZABETH, EASTERN CAPE**

Under Section 47 of the Spatial Planning and Land Use Management act, 2013 (Act 16 of 2013) and upon instructions by the Local Authority, a notice is hereby given that conditions B6(a), B6(b), B6(c) and B6(d) on page 3 of Deed of Transfer No. T1054/2017CTN applicable to Erf 2158 Walmer, In the Nelson Mandela Bay Metropolitan Municipality, Division of Port Elizabeth, are hereby removed.

4-11

PROVINCIAL NOTICE 20 OF 2019**REMOVAL OF RESTRICTIVE TITLE DEED CONDITIONS : BM HOFERT & DK HOFERT**

In terms of section 47(1) of the Spatial Planning and Land Use Management Act No 16 of 2013, read with section 59 of the Buffalo City Metropolitan Municipal Spatial Planning and Land Use Management Bylaw of 2016, approval is hereby granted for the removal of restrictive title conditions C.4 (a), (b), (c) & (d) found in Deed of Transfer No. T11607/1999, pertaining to Erf 708 Beacon Bay.

Drake Flemmer & Orsmond (EL) Inc
22 St James Road
Southernwood
East London
Tel: 043 722 4210
E-mail: shaun@drakefo.co.za

PROVINCIAL NOTICE 21 OF 2019**Nelson Mandela Bay Municipality (EASTERN CAPE)****Removal of Restrictions in terms of the Spatial Planning and Land Use Management Act, 2013 (Act 16 of 2013)****ERF 885 SUMMERSTRAND, PORT ELIZABETH, EASTERN CAPE**

Under Section 47 of the Spatial Planning and Land Use Management Act, 2013 (Act 16 of 2013) and upon instructions by the Local Authority, notice is hereby given that Conditions C(v)(b) and (d) in Deed of Transfer Number T 6798/2016 CTN applicable to Erf 68 Humewood are hereby removed.

Friedman Scheckter

LOCAL AUTHORITY NOTICES • PLAASLIKE OWERHEIDS KENNISGEWINGS

LOCAL AUTHORITY NOTICE 20 OF 2019



SENQU MUNICIPALITY

NOTICE 07 /2019

PUBLIC NOTICE CALLING FOR INSPECTION OF SUPPLEMENTARY VALUATION ROLL AND LODGING OF OBJECTION/S

Notice is hereby given in terms of Section 77 reads with Section 78 (6) of the Local Government: Municipal Property Rates Act, (Act No. 6 of 2004), hereinafter referred to as the "Act", that the supplementary valuation roll for the financial year 2019/2020 is open for public inspection at the Senqu Municipality Offices and public libraries at Lady Grey, Sterkspruit and Barkly East from 28th of January 2019 to 8th of March 2019.

In addition, the supplementary valuation roll is available at the following website: www.senqu.gov.za

An invitation is hereby made in terms of section 78(5)(b) of the Act that any owner of property should lodge a request with the municipal manager in respect of any matter reflected in the supplementary valuation roll within the above-mentioned period.

Attention is specifically drawn to the fact that in terms of section 50(2) of the Act an objection must be in relation to a specific individual property and not against the supplementary valuation roll as such.

The form for the lodging of an objection is obtainable at the following addresses:

Senqu Municipal Offices <i>(Lady Grey Offices)</i> 19 Murray Street Lady Grey 9755	Senqu Municipal Offices <i>(Sterkspruit Offices)</i> 79 Main Street Sterkspruit 9762	Senqu Municipal Offices <i>(Barkly East Offices)</i> Molteno Street Barkly East 9786
--	--	--

or on the website www.senqu.gov.za

(Please use: the following forms when lodging an objection)

Form a: residential (full title and sectional title used for residential purposes)

Form b: properties other than residential or agricultural (e.g. businesses, factories, schools)

Form c: agricultural holdings or farms) and

Form d: Appeal form

The completed forms must be returned to the following address:	Or Posted to the Following Address:
Senqu Municipal Office 19 Murray Street Lady Grey 9755	Senqu Municipality Private Bag X 03 Lady Grey 9755

Please Note that all forms must be clearly marked with the words: "**Supplementary Valuation Objection**"

Objections may also be faxed to [086 585 5302](tel:0865855302) but the onus is on the sender to ensure that the administration of Senqu Municipality receives such faxed objections.

For enquiries please telephone or email

Mr Andile Gushmani : Tel 051 603 1348 mailto: gushmania@senqu.gov.za

Ms Zifkile Luwaca : Tel 051 603 1363 mailto: luwacaz@senqu.gov.za

MR MM YAWA
Municipal Manager

10 January 2019

LOCAL AUTHORITY NOTICE 26 OF 2019

BUFFALO CITY METROPOLITAN MUNICIPALITY

**SPLUMA Act No. 16 of 2013: ERF 2306, GONUBIE:
REMOVAL OF RESTRICTIONS**

Under Section 47 (1) of the Spatial Planning and Land Use Management Act, No. 16 of 2013, read with Section 59 of the Buffalo City Metropolitan Municipal Spatial Planning and Land Use Management By-Law of 2016, and upon instruction from the abovementioned municipality, notice is hereby given that following application by the owner of Erf 2306, Gonubie, Conditions C (d), C (e) and C (f) found in Deed of Transfer No. 3895/2008 pertaining to Erf 2306, Gonubie, are hereby removed.

LOCAL AUTHORITY NOTICE 27 OF 2019

BUFFALO CITY METROPOLITAN MUNICIPALITY

**SPLUMA Act No. 16 of 2013: ERF 2518, GONUBIE:
REMOVAL OF RESTRICTIONS**

Under Section 47 (1) of the Spatial Planning and Land Use Management Act, No. 16 of 2013, read with Section 59 of the Buffalo City Metropolitan Municipal Spatial Planning and Land Use Management By-Law of 2016, and upon instruction from the abovementioned municipality, notice is hereby given that following application by the owner of Erf 2518, Gonubie, Conditions D (1) and D (2) found in Deed of Transfer No. T109/2010 pertaining to Erf 2518, Gonubie, are hereby removed.

LOCAL AUTHORITY NOTICE 28 OF 2019

- a)
- Buffalo City Metropolitan Municipality**

NOTICE: TOWNSHIP ESTABLISHMENT: (3824)
--

An application has been submitted for b) **SUBDIVISION & REZONING OF A PORTION OF FARM 1404, EAST LONDON, MDANTSANE NU 2, COMPRISING OF 127 ERVEN FOR RESIDENTIAL, TWO ERVEN FOR HIGH DENSITY RESIDENTIAL, ONE ERF FOR INSTITUTIONAL, ONE ERF FOR BUSINESS PURPOSES AND ROADWAY AREA (SLOVO PARK – MDANTSANE INFILL AREAS).**

- on c)
- A PORTION OF FARM 1404,**
- d)
- EAST LONDON, MDANTSANE NU2 (SLOVO PARK)**

in terms of section 13 of the Land Use Regulations Act, 15 of 1987.

Further details of the proposed application may be obtained from the municipal offices at e) **THE TOWN PLANNING ENQUIRY COUNTER, FIRST FLOOR, CITY ENGINEERING CENTRE, 26 OXFORD STREET, EAST LONDON.**

During normal office hours and any objections thereto must be lodged in writing with the undersigned by not later than 12h00 on the exactly 21 days after the date of the publication of this notice.

NAME OF MUNICIPALITY: **BUFFALO CITY METROPOLITAN MUNICIPALITY**

ADDRESS OF MUNICIPALITY: **P O BOX 81, EAST LONDON, 5200**

DATE: **04/02/2019**

- a) Name of Municipality
- b) Nature of application
- c) Property description
- d) Name of Township or area
- e) Address of Municipal offices where application can be viewed

A.SIHLAHLA
CITY MANAGER

.....
PROVINCIAL GAZETTE:

ONE INSERTION:

04 FEBRUARY 2019

LOCAL AUTHORITY NOTICE 29 OF 2019a) **Buffalo City Metropolitan Municipality**

NOTICE: TOWNSHIP ESTABLISHMENT: (3823)
--

An application has been submitted for b) **SUBDIVISION & REZONING OF A PORTION OF FARM 1404, EAST LONDON, MDANTSANE NU 2, COMPRISING OF 62 ERVEN FOR RESIDENTIAL PURPOSES AND ROADWAY AREA (EKUPHUMLENI – MDANTSANE INFILL AREAS).**

on c) **A PORTION OF FARM 1404,** d) **EAST LONDON, MDANTSANE NU2 (EKUPHUMLENI)**

in terms of section 13 of the Land Use Regulations Act, 15 of 1987.

Further details of the proposed application may be obtained from the municipal offices at e) **THE TOWN PLANNING ENQUIRY COUNTER, FIRST FLOOR, CITY ENGINEERING CENTRE, 26 OXFORD STREET, EAST LONDON.**

During normal office hours and any objections thereto must be lodged in writing with the undersigned by not later than 12h00 on the exactly 21 days after the date of the publication of this notice.

NAME OF MUNICIPALITY: **BUFFALO CITY METROPOLITAN MUNICIPALITY**

ADDRESS OF MUNICIPALITY: **P O BOX 81, EAST LONDON, 5200**

DATE: **04/02/2019**

- a) Name of Municipality
- b) Nature of application
- c) Property description
- d) Name of Township or area
- e) Address of Municipal offices where application can be viewed

A.SIHLAHLA
CITY MANAGER

.....
PROVINCIAL GAZETTE:

ONE INSERTION:

04 FEBRUARY 2019