CONTENTS- INHOUD

<i>No.</i>		<i>Page No.</i>	<i>Gazette No.</i>
GENERAL NOTICES			
3380	Gauteng Transport Infrastructure (8/2001): Proclamation of the increase in width of a portion of Provincial Road P122-1, District Pretoria	.	3 208
3381	do.: Proclamation of <i>the</i> increase in width of a portion of Provincial Road P157-1, District Pretoria	..	5 208

GENERAL NOTICES

NOTICE 3380 OF 2007

PROCLAMATION OF THE INCREASE IN WIDTH OF A PORTION OF PROVINCIAL ROAD P122-1 DISTRICT: PRETORIA

In terms of section 11 (2) of the Gauteng Transport Infrastructure Act, 2001 (Act No.8 of 2001) the MEC for Public Transport, Roads and Works hereby proclaims the increase in the width of a portion of provincial road P122-1 over the Remainers of Portions 5 and 131 of the farm Doornkloof 391-JR, District Pretoria, as indicated on the accompanying sketch plans.

In terms of section 23 (6) of the aforementioned act, it is hereby declared that boundary beacons demarcating the said increase in width of a portion of the above-mentioned provincial road, have been placed on the land and that plan GRP05/33/1 Exp indicating the land encroached upon, are available for inspection by any interested person in the Plan Room of the Department of Public Transport Roads and Works, Sage Life Building, 41 Simmonds Street, Johannesburg.

Reference: 2/1/1/213/1 - P122-1

MEC Resolution **018...** dated

17.01., 2007

KENNISGEWING 3380 VAN 2007**PROKLAMASIE VAN DIE VERBREDING VAN 'N GEDEELTE VAN PROVINSIALE PAD P122-1, DISTRIK PRETORIA**

Ingevolge artikel 11 (2) van die Gauteng Transport Infrastructure Act, 2001 (Act NO.8 of 2001) proklameer die LUR vir Openbare Vervoer, Paaie en Werke hiennee die verbreding van 'n gedeelte van provinsiale pad P122-1 oor die Restante van Gedeeltes 5 en 131 van die plaas Doornkloof 391-JR Distrik Pretoria sods op die bygaande sketsplan aangetoon.

Ingevolge artikeJ 23 (6) van voormelde Wet word hiermee verklaar dat grensbakens wat gemelde verbreding van 'n gedeelte van die bogemelde provinsiale pad aandui op die grond geplaas is en dat plan *GRP05/33/1* Exp wat die grond aantoon wat deur die proklamasie van die verbreding in beslag geneem is, in die Plankamer van die Departement van Openbare Vervoer, Paaie en Werke, Sage Life Gebou, Simmondstraat 41, Johannesburg deur enige belanghebbende persoon ter insae beskikbaar is.

Verwysing: 2/1/1/2/3/1-P122-1

LUR Besluit **018** gedateer

17.01., 2007

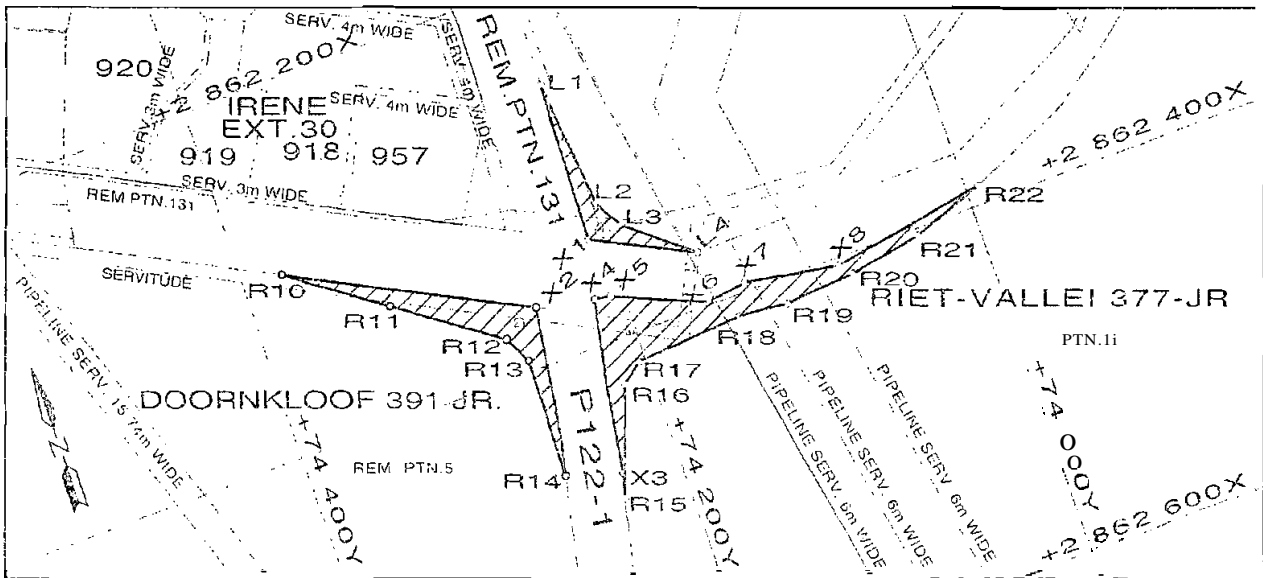

VERWYSING / REFERENCE

PAC VERBREEDING
ROAD WIDENING



BESTAANDE PAD
EXISTING ROAD

DIE FIGURE 1: L1-L4, X1, L1
2: R10, X2, R14-R10
3: X4-X8, R22-R15, X3, X4
VERTEENWOORDIG DIE PROKLAMASIE VAN VERMEERDERING VAN DIE BREDTE VAN PROVINSIALE PAD P122-1 OOR DIE RESTANTE VAN GEDEELTES 5 & 131 VAN DIE PLAAS DOORKLOOF 391-JR SOOS BEDOEL BY AFKONDIGING DAARVAN IN DIE PROVINSIALE KOERANT EN IN DETAIL GETOON OP PLAN GRP05/33/1 Exp

THE FIGURES 1: L1-L4, X1, L1
2: R10, X2, R14-R10
3: X4-X8, R22-R15, X3, X4
REPRESENT THE PROCLAMATION OF THE INCREASE OF WIDTH OF PROVINCIAL ROAD P122-1, OVER THE REMAINDERS OF PORTIONS 5 & 131 OF THE FARM DOORKLOOF 391-JR AS INTENDED BY PUBLICATION THEREOF IN THE PROVINCIAL GAZETTE AND SHOWN IN DETAIL ON PLAN GRP05/33/1 Exp

GUNDEL NR. / FILE NO. 2/1/1/2/3/-P122-1

KOÖRDINATE LYS / CO-ORDINATE LIST WG 29^{de} KONST. / CONST. Y = ± 0.000 X = +2 800 000.000

L1	+74 205 453	+62254.778	R15	+74 236.711	+62 482.806	X1	+74 208.439	+62 342.605
L2	+74 197853	+62325531	R16	+74215.579	+62 424.578	X2	+74 248.935	+62 367.840
L3	+74 188.386	+6234'1,392	R17	+74 203.765	+624'15.680	X3	+74 232.930	+62 469.380
L4	+74152.144	+62370.540	R18	+74 141.981	+62411.643	X4	+74 216.319	+62 374.985
R10	+74 377 090	+62302.079	R19	+74 114.171	+62414.348	X5	+74 207.120	+62 376.308
R11	+74 325.334	+62 339 157	R20	+74 074.727	+62 411.079	X6	+74 155.135	+62 398 488
R12	+74270.444	+62 378.480	R21	+74 033431	+62 403.883	X7	+74 133.173	+62 395.163
R13	+74262.574	+62 393 780	R22	+73992.933	+62 389.885	X8	+74 080.262	+62 404.214
R14	+74263.842	+62 459.903						

NOTICE 3381 OF 2007

PROCLAMATION OF THE INCREASE IN WIDTH OF A PORTION OF PROVINCIAL ROAD P157-1 DISTRICT: PRETORIA

In terms of section 11 (2) of the Gauteng Transport Infrastructure Act, 2001 (Act No.8 of 2001) the MEC for Public Transport, Roads and Works hereby proclaims the increase in the width of a portion of provincial road P157-1 over the Reminders of Portions 5 and 330 of the farm Doornkloof 391-JR, District Pretoria, as indicated on the accompanying sketch plans.

In terms of section 23 (6) of the aforementioned act, it is hereby declared that boundary beacons demarcating the said increase in width of a portion of the above-mentioned provincial road, have been placed on the land and that plan GRP05/33/1 Exp indicating the land encroached upon are available for inspection by any interested person in the Plan Room of the Department of Public Transport Roads and Works, Sage Life Building, 41 Simmonds Street, Johannesburg.

Reference: 2/1/1/2/3/1 - P157-1

MEC Resolution **Q18** dated **17-01-2007**

 KENNISGEWING 3381 VAN 2007

PROKLAMASIE VAN DIE VERBREDING VAN 'N GEDEELTE VAN PROVINSIALE PAD P157-1, DISTRIK PRETORIA

Ingevolge artikel 11 (2) van die Gauteng Transport Infrastructure Act, 2001 (Act No.8 of 2001) proklameer die LUR vir Openbare Vervoer, Paaie en Werke hiermee die verbreding van 'n gedeelte van provinsiale pad P157-1 oor die Restante van Gedeeltes 5 en 330 van die plaas Doornkloof 391-JR, Distrik Pretoria soos op die bygaande sketsplan aangetoon.

Ingevolge artikel 23 (6) van voormelde Wet word hiermee verklaar dat grensbakens wat die verbreding van 'n gedeelte van die bogenoemde provinsiale pad aandui op die grond geplaas is en dat plan GRP05/33/1 Exp wat die grond aantoon wat deur die proklamasie van die verbreding in beslag geneem is, in die Plankamer van die Departement van Openbare Vervoer, Paaie en Werke, Sage Life Gebou, Sirmondstraat 41, Johannesburg deur enige belanghebbende persoon ter insae beskikbaar is.

Verwysing: 2/1/1/2/3/1-P157-1

LUR Besluit **Q18** gedateer **17-01-2007**

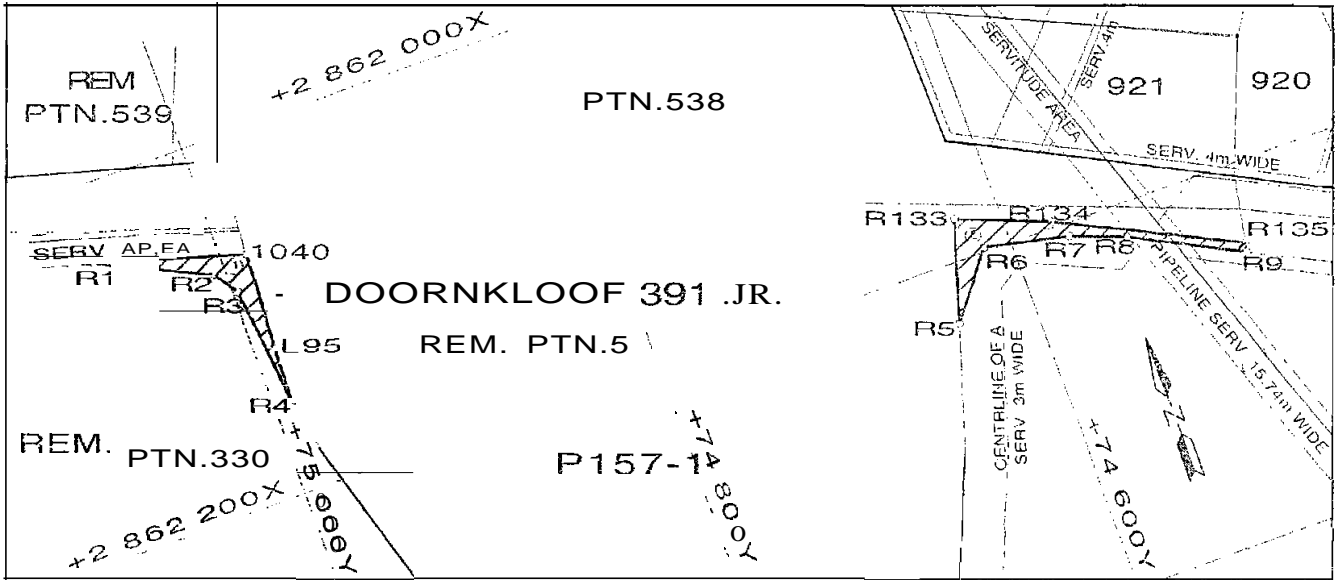

VERINSYING / REFERENCE

PAD VERBREEDING
ROAD WIDENING



BESTAANDE PAD
EXISTING ROAD

DIE FIGURE 1: R1, 1040, L95, R4-R1

2: R133-R135, R9-R5, R133

VERTEENWOORDIG DIE PROKLAMASIE VAN DIE VERMEERDERING VAN DIE BREEDTE VAN PROVINSIALE PAD P157-1 OOR DIE RESTANTE VAN GEDEELTES 5 & 330 VAN DIE PLAAS DOORNKLOOF 391-JR SOOS BEDOEL BY AFIKONDIGING DAARVAN IN DIE PROVINSIALE KOERANT EN IN DETAIL GETOON OP PLAN GRP05/33/1 Exp

THE FIGURES 1: R1, 1040.1_95, R4-R1

2: R133-R135, R9-R5, R133

REPRESENT THE PROCLAMATION OF THE INCREASE IN WIDTH OF PROVINCIAL ROAD P157-1 OVER THE REMAINDERS OF PORTIONS 5 & 330 OF THE FARM DOORNKLOOF 391-JR AS INTENDED BY PUBLICATION THEREOF IN THE PROVINCIAL GAZETTE AND SHOWN IN DETAIL ON PLAN GRP05/3311 Exp

BUNDEL NR. / FILE NO. 2/1/1/2/3/1-P157-1

KOÖRDINATE LYS / CO-ORDINATE LIST WG 29^o KONST. / CONST. Y = ± 0.000 X = +2 800 000,000

1040	+74 936 150	+62 066.270	R4	+74 939.621	+62 149.847	R9	+74 482.745	+62247.864
L95	+74 988,770	+62 11 9 393	R5	+74 640.625	+62 231 768	R133	+74 623.713	-;-62177,702
R1	+75 064.947	+62 043 360	R6	+74 614.224	+62 197.611	R134	+74 576 134	+62 196.600
R2	+75 006 440	+62 070.787	R7	+74569,914	+62 207 068	R135	+74 481.843	+62242,921
R3	+74 997.171	+62 083.895	R8	+74 540.457	+62218.250			