

*THE PROVINCE OF  
GAUTENG*

*DIE PROVINSIE  
GAUTENG*

**Provincial Gazette Extraordinary  
Buitengewone Provinsiale Koerant**

**Vol. 14**

**PRETORIA, 10 DECEMBER  
DESEMBER 2008**

**No. 334**

---

**CONTENTS • INHOUD**

<i>No.</i>		<i>Page No.</i>	<i>Gazette No.</i>
<b>GENERAL NOTICES</b>			
5339	Gauteng Transport Infrastructure Act (8/2001): Proclamation of portions of access roads and closure of portions of Provincial Road 49: District of Pretoria .....	3	334
5340	do.: Deviation of a portion and closure of portions of Provincial Road 49: District of Pretoria .....	5	334

---

---

## GENERAL NOTICES

---

### NOTICE 5339 OF 2008

#### PROCLAMATION OF PORTIONS OF ACCESS ROADS AND CLOSURE OF PORTIONS OF PROVINCIAL ROAD 49 : DISTRICT PRETORIA

In terms of sections 11(1)(d) and 13 of the Gauteng Transport Infrastructure Act, 2001 (Act No. 8 of 2001) the MEC hereby proclaims portions of access roads and the closure of portions of provincial road 49 over Portion 7 of the farm Zwartkop 356-JR, Portions 28 and 70 of the farm Mooiplaats 355-JR and Holdings 154 and 155 Raslouw Agricultural Holdings, District Pretoria as indicated on the accompanying sketch plan.

In terms of section 23(6) of the aforementioned Act it is hereby declared that boundary beacons demarcating the portions of the access roads, have been erected on the land and that plans GRP 04/16/8A EXP and 8B EXP which indicate the land encroached upon by the said portions of the access roads are available for inspection by any interested person at the office of the Department of Public Transport, Roads and Works (Gauteng), 41 Simmonds Street, Sage Life Building, Johannesburg.

MEC Resolution: 020

Reference: 2/1/7/49

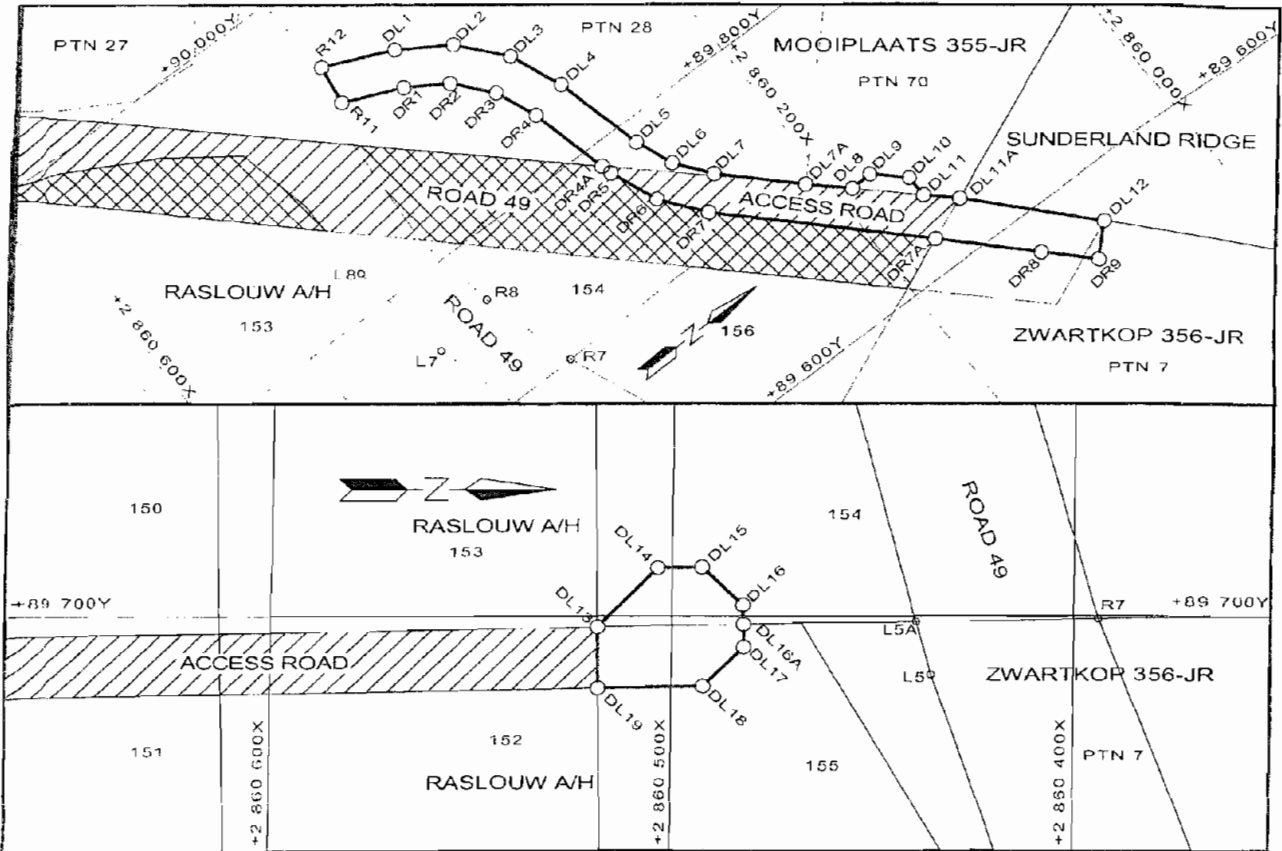

**VERWYSINGS / REFERENCE**

PAD GEPROKLAEMEER  
ROAD PROCLAIMED



BESTAANDE PAD  
EXISTING ROAD



PAD GESLUIT  
ROAD CLOSED



DIE FIGURE R12, DL1-DL12, DR9-DR1, R11, R12 & DL13-DL19, DL13 VERTEENWOORDIG DIE PROKLAMASIE VAN DIE BETROKKE GEDEELTES VAN TOEGANGSPAARIE OOR GEDEELTE 7 VAN DIE PLAAS ZWARTKOP 356-JR, GEDEELTES 28 & 70 VAN DIE PLAAS MOOIPLAATS 355-JR EN HOEWES 154 & 155 RASLOUW L/H EN DIE SLUITING VAN GEDEELTES VAN PROVINSIALE PAD 49 DISTRIK PRETORIA SOOS BEDOEL BY AFKONDIGING DAARVAN IN DIE PROVINSIALE KOERANT EN IN DETAIL GETOON OP PLAN GRP04/16/8A Exp & 8B Exp

THE FIGURES R12, DL1-DL12, DR9-DR1, R11, R12 & DL13-DL19, DL13 REPRESENT THE PROCLAMATION OF THE PORTIONS CONCERNED OF ACCESS ROADS OVER PORTION 7 OF THE FARM ZWARTKOP 356-JR, PORTIONS 28 & 70 OF THE FARM MOOIPLAATS 355-JR AND HOLDINGS 154 & 155 RASLOUW A/H AND THE CLOSING OF PORTIONS OF PROVINCIAL ROAD 49 DISTRICT PRETORIA AS INTENDED BY PUBLICATION THEREOF IN THE PROVINCIAL GAZETTE AND SHOWN IN DETAIL ON PLAN GRP04/16/8A Exp & 8B Exp

BUNDEL NR. / FILE NO. 2/1/1/2/3/1-K71

**KOÖRDINATE LYS / CO-ORDINATE LIST WG 29° KONST. / CONST. Y = ± 0.000 X = +2 800 000.000**

R11	+89 919.21	+60 408.09	DL10	+89 662.84	+60 157.27	DR1	+89 903.02	+60 371.65
R12	+89 944.99	+60 404.54	DL11	+89 648.44	+60 156.83	DR2	+89 887.15	+60 346.87
DL1	+89 925.87	+60 361.49	DL11A	+89 633.10	+60 140.41	DR3	+89 864.62	+60 327.96
DL2	+89 905.93	+60 330.37	DL12	+89 566.03	+60 077.92	DR4	+89 837.47	+60 316.62
DL3	+89 877.62	+60 306.60	DL13	+89 697.12	+60 518.38	DR4A	+89 785.83	+60 303.77
DL4	+89 843.51	+60 292.37	DL14	+89 712.38	+60 503.64	DR5	+89 779.25	+60 302.13
DL5	+89 785.29	+60 277.87	DL15	+89 712.57	+60 492.64	DR6	+89 748.29	+60 289.75
DL6	+89 760.65	+60 268.02	DL16	+89 702.74	+60 482.47	DR7	+89 721.81	+60 269.48
DL7	+89 739.57	+60 251.88	DL16A	+89 697.74	+60 482.38	DR7A	+89 621.27	+60 167.99
DL7A	+89 699.35	+60 211.28	DL17	+89 691.74	+60 482.28	DR8	+89 574.01	+60 120.30
DL8	+89 679.39	+60 189.94	DL18	+89 681.57	+60 492.11	DR9	+89 548.99	+60 096.21
DL9	+89 679.87	+60 175.57	DL19	+89 681.12	+60 518.10			

**NOTICE 5340 OF 2008****DEVIATION OF A PORTION AND CLOSURE OF PORTIONS OF  
PROVINCIAL ROAD 49 : DISTRICT PRETORIA**

In terms of section 11(1)(d) of the Gauteng Transport Infrastructure Act, 2001 (Act No. 8 of 2001) the MEC hereby proclaims the deviation of a portion of provincial road 49 and the resultant closure of portions thereof over Portion 7 of the farm Zwartkop 356-JR, Portions 27 and 28 of the farm Mooiplaats 355-JR and Holdings 154, 155 and 156 of Raslouw Agricultural Holdings, District Pretoria as indicated on the accompanying sketch plan.

In terms of section 23(6) of the aforementioned Act it is hereby declared that boundary beacons demarcating the deviation of the road, have been erected on the land and that plans GRP 04/16/8A EXP and 8B EXP which indicate the land encroached upon by the said road deviation are available for inspection by any interested person at the office of the Department of Public Transport, Roads and Works (Gauteng), 41 Simmonds Street, Sage Life Building, Johannesburg.

**MEC Resolution: 020**

**Reference: 2/1/7/49**

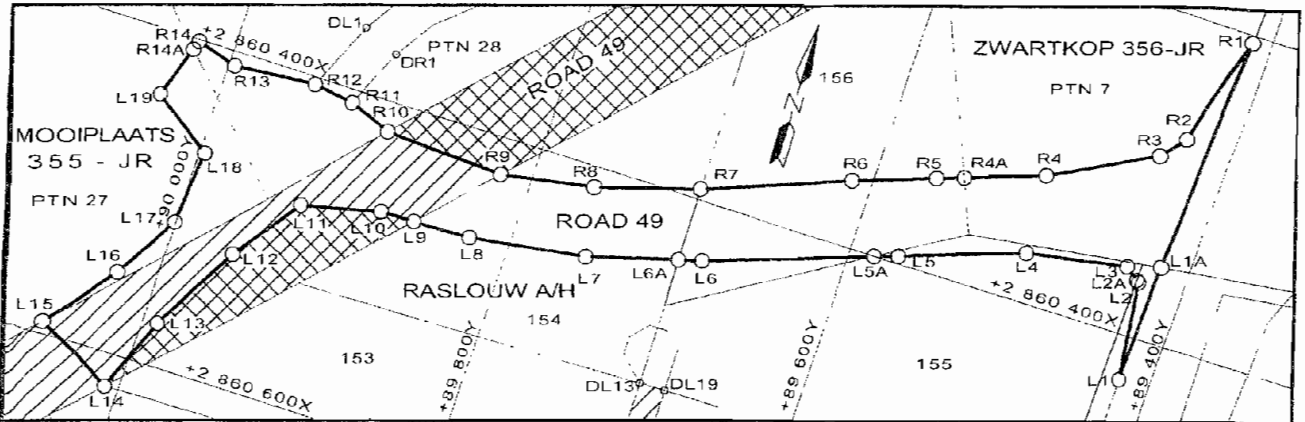

**VERWYSINGS / REFERENCE**

PADVERLEGGING GEPROKLAAMEER  
ROAD DEVIATION PROCLAIMED



BESTAANDE PAD  
EXISTING ROAD

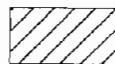

PAD GESLUIT  
ROAD CLOSED



DIE FIGUUR L1-L19, R14-R1, L1  
VERTEENWOORDIG DIE PROKLAMASIE VAN DIE VERLEGGING VAN DIE BETROKKE GEDEELTE VAN PROVINSIALE PAD 49 EN GEVOLGLIKE SLUITING VAN GEDEELTES DAARVAN OOR GEDEELTE 7 VAN DIE PLAAS ZWARTKOP 356-JR, GEDEELTES 27 & 28 VAN DIE PLAAS MOOIPLAATS 355-JR & HOEWES 154, 155 & 156 VAN RASLOUW L/H DISTRIK PRETORIA SOOS BEDOEL BY AFKONDIGING DAARVAN IN DIE PROVINSIALE KOERANT EN IN DETAIL GETOON OP PLANNE GRP04/16/8A Exp & 8B Exp

THE FIGURE L1-L19, R14-R1, L1  
REPRESENTS THE PROCLAMATION OF THE DEVIATION OF THE PORTION CONCERNED OF PROVINCIAL ROAD 49 AND RESULTANT CLOSURE OF PORTIONS THEREOF OVER PORTION 7 OF THE FARM ZWARTKOP 356-JR, PORTIONS 27 & 28 OF THE FARM MOOIPLAATS 355-JR & HOLDINGS 154, 155 & 156 OF RASLOUW A/H DISTRICT PRETORIA AS INTENDED BY PUBLICATION THEREOF IN THE PROVINCIAL GAZETTE AND SHOWN IN DETAIL ON PLANS GRP04/16/8A Exp & 8B Exp

BUNDEL NR. / FILE NO. 2/1/1/2/3/1-K71

**KOÖRDINATE LYS / CO-ORDINATE LIST WG 29° KONST. / CONST. Y = ± 0.000 X = +2 800 000.000**

L1	+89 418.18	+60 401.06	L8	+89 824.20	+60 464.54	R5	+89 555.59	+60 340.16
L1A	+89 416.66	+60 353.30	L9	+89 859.78	+60 466.05	R6	+89 612.20	+60 360.05
L2	+89 426.04	+60 366.19	L10	+89 881.03	+60 465.85	R7	+89 699.12	+60 393.76
L2A	+89 427.69	+60 364.96	L11	+89 929.90	+60 477.33	R8	+89 760.25	+60 411.99
L3	+89 435.67	+60 358.98	L19	+90 034.25	+60 439.19	R9	+89 818.57	+60 422.15
L4	+89 497.34	+60 369.86	R1	+89 412.60	+60 226.54	R10	+89 892.95	+60 418.31
L5	+89 558.88	+60 391.13	R2	+89 427.61	+60 274.00	R11	+89 919.21	+60 408.09
L5A	+89 586.17	+60 400.72	R3	+89 438.73	+60 288.51	R12	+89 956.39	+60 473.60
L6	+89 684.53	+60 435.27	R4	+89 501.08	+60 321.01	R13	+89 996.13	+60 408.80
L6A	+89 698.49	+60 439.20	R4A	+89 548.42	+60 337.64	R14	+90 021.84	+60 401.16
L7	+89 751.27	+60 454.04				R14A	+90 023.70	+60 406.86