

*THE PROVINCE OF
GAUTENG*

*DIE PROVINSIE
GAUTENG*

**Provincial Gazette Extraordinary
Buitengewone Provinsiale Koerant**

Vol. 15

PRETORIA, 2 SEPTEMBER 2009

No. 202

CONTENTS • INHOUD

<i>No.</i>		<i>Page No.</i>	<i>Gazette No.</i>
GENERAL NOTICES			
2854	Gauteng Transport Infrastructure Act (8/2001): Proposed closure of an access road in respect of Provincial Road P70-1 over Portion 1 and the Remainder of Holding 5, Magalies View Agricultural Holdings, Portion 191 and the Remaining Extent of Portion 112 of the farm Witkoppen 194 IQ.....	3	202
2855	do.: Proposed closure of an access road in respect of Provincial Road P1-2 (K101) over Erf 613, Hennospark Extension 42	5	202

GENERAL NOTICES

NOTICE 2854 OF 2009

PROPOSED CLOSURE OF AN ACCESS ROAD IN RESPECT OF PROVINCIAL ROAD P70-1 OVER PORTION 1 AND THE REMAINDER OF HOLDING 5 MAGALIES VIEW AGRICULTURAL HOLDINGS, THE REMAINDER OF MAGALIES VIEW AGRICULTURAL HOLDINGS, PORTION 191 AND THE REMAINING EXTENT OF PORTION 112 OF THE FARM WITKOPPEN 194 IQ

An application in terms of section 38 (1) of the Gauteng Transport Infrastructure Act, 2001 (Act No 8 of 2001) has been received from Brian Gray and Associates to close an access road in respect of Provincial Road P70-1 over Portion 1 and the Remainder of Holding 5 Magalies View Agricultural Holdings, the Remainder of Magalies View Agricultural Holdings, Portion 191 and the Remaining Extent of Portion 112 of the farm Witkoppen 194 IQ.

In terms of section 38 (2) of the aforementioned Act interested parties are hereby requested to submit comments or objections in writing to the: Department of Roads and Transport, Directorate Design: Attention Ms. A. N. Ndaba, Tel 011 355 7118, Private Bag X83, Marshalltown 2107, within 30 (thirty) days from publication of the notice

Reference: 2/1/1/2/3/1-P70-1

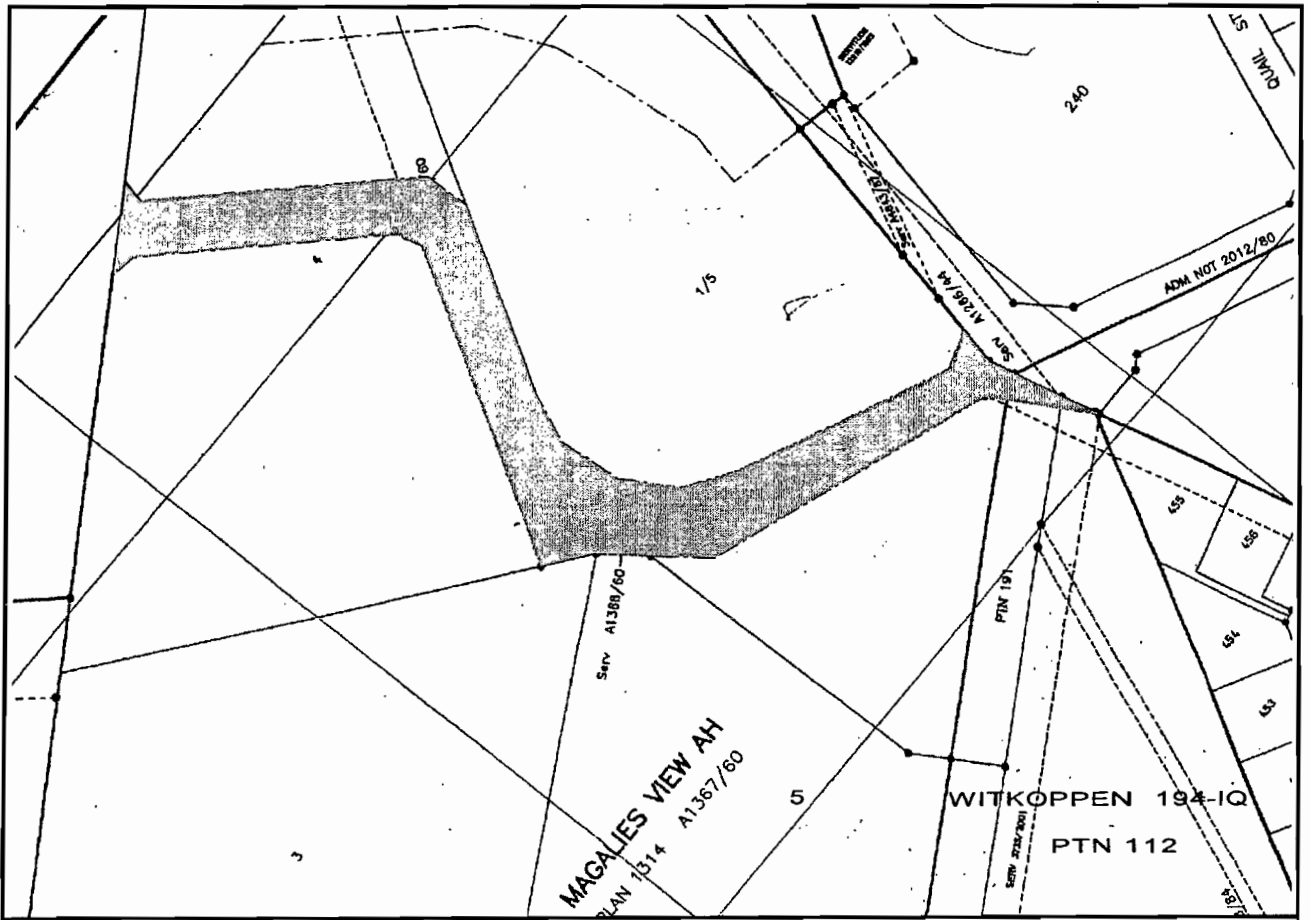

VERWYSINGS / REFERENCE

VOORGESTELDE SLUITING VAN TOEGANGSPAD
PROPOSED CLOSURE OF ACCESS ROAD



NOTICE 2855 OF 2009**PROPOSED CLOSURE OF AN ACCESS ROAD IN RESPECT OF PROVINCIAL ROAD P1-2 (K101) OVER ERF 613 HENNOPSPARK EXTENSION 42.**

An application in terms of section 38(1) of the Gauteng Transport Infrastructure Act, 2001, (Act No 8 of 2001) has been received from Citiplan Town & Regional Planners to close an access road in respect of Provincial Road P1-2 (K101) over a Portion of Erf 613 Hennospark Extension 42 as indicated on the accompanying sketch plan.

In terms of Section 38(1) of the aforementioned Act interested parties are hereby requested to submit comments or objections in writing, to the Head: Department of Roads and Transport, Directorate Design, Attention Mr. S J Matshelanokana, Tel No. (011) 355 7043, Private Bag X83, Marshalltown 2107, within 30(thirty) days from the date of this notice.

Reference: 1/1/3/1/3-10588

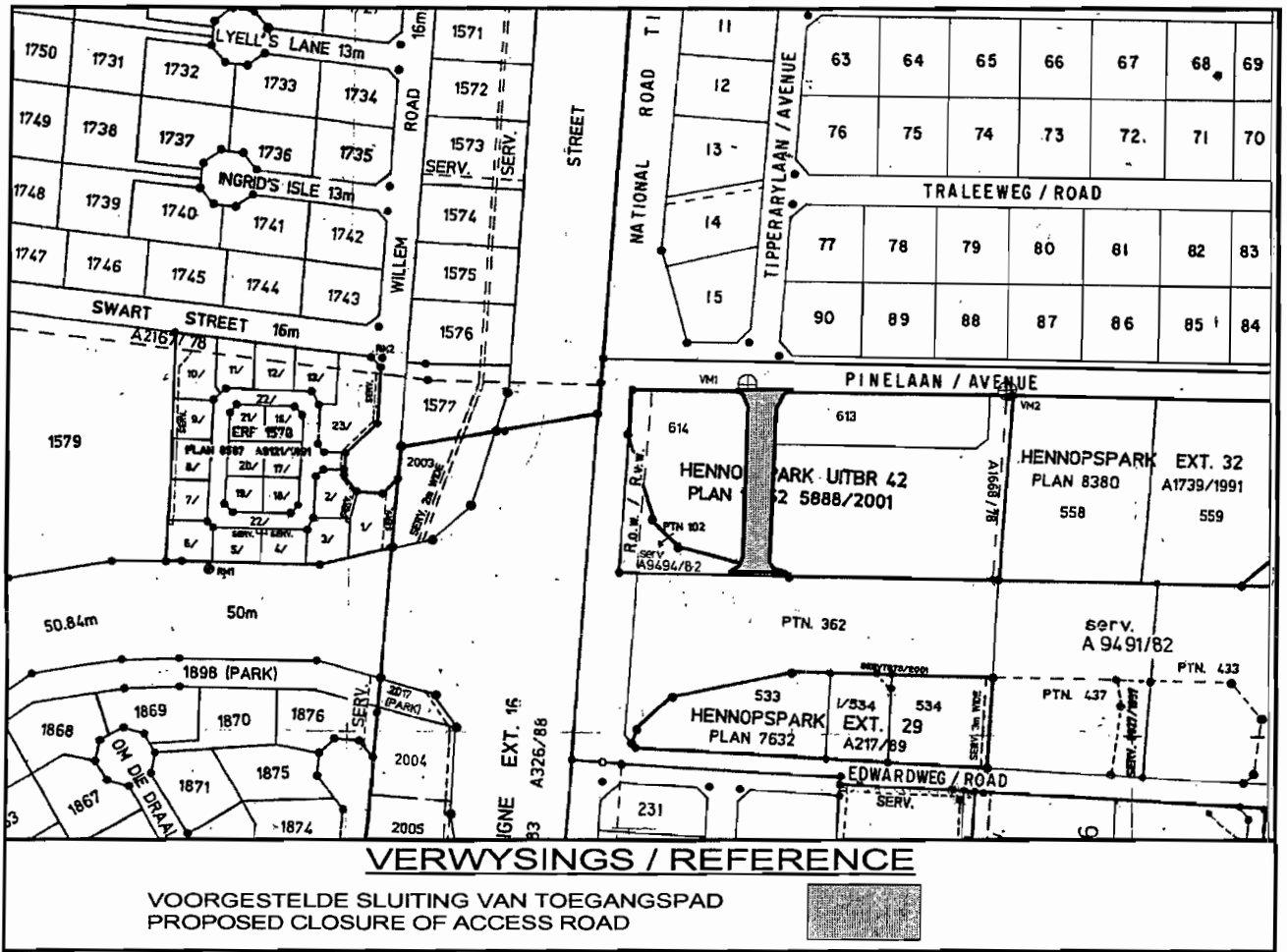

VERWYSINGS / REFERENCE

VOORGESTELDE SLUITING VAN TOEGANGSPAD
 PROPOSED CLOSURE OF ACCESS ROAD

