

*THE PROVINCE OF
GAUTENG*

*DIE PROVINSIE
GAUTENG*

**Provincial Gazette Extraordinary
Buitengewone Provinsiale Koerant**

Vol. 15

PRETORIA, 21 APRIL 2009

No. 91

CONTENTS · INHOUD

<i>No.</i>	<i>Page No.</i>	<i>Gazette No.</i>
GENERAL NOTICE		
1357 Gauteng Transport Infrastructure Act (8/2001): Increase in width of a portion of Provincial Road K26: District Krugersdorp	3	91

GENERAL NOTICE

NOTICE 1357 OF 2009

INCREASE IN WIDTH OF A PORTION OF PROVINCIAL ROAD K26: DISTRICT KRUGERSDORP

In terms of section 11(2) of the Gauteng Transport Infrastructure Act, 2001 (Act No. 8 of 2001) the MEC for Public Transport, Roads and Works hereby proclaims the increase of the width of provincial road K26 over the Remainder and Portion 3 of the farm Spring Farm 588JQ as indicated on the accompanying sketch plan.

In terms of section 23(6) of the aforementioned act, it is hereby declared that boundary beacons, demarcating the increase in the width of the portion of the road in question have been placed on the land and that plan GRP 02/47/7 Exp indicating the land encroached upon by the said road adjustment is available for inspection by any interested person in the Plan Room of the Department of Public Transport, Roads and Works, Sage Life Building, 41 Simmonds Street, Johannesburg.

Reference: 2/1/1/2/3/1-K26 (2)

MEC Resolution : 005 of 24 March 2003

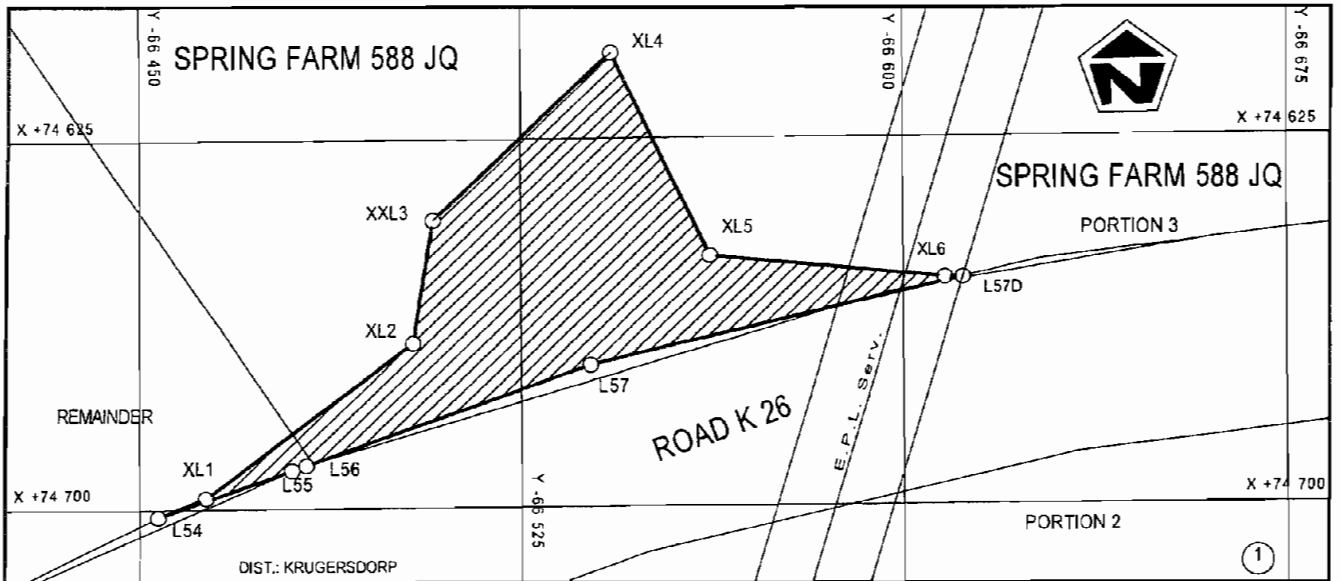

VERWYSINGS / REFERENCE

BESTAANDE PAD
EXISTING ROAD

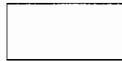

PAD VERBREDING
ROAD WIDENING



DIE FIGUUR : L54, XL1, XL2, XXL3, XL4-XL6, L57D, L57-L54.
 VERTEENWOORDIG DIE VERMEERDERING VAN DIE BREEKTE VAN DIE BETROKKE
 GEDEELTE VAN PROVINSIALE PAD K26 OOR DIE RESTANT EN GEDEELTE 3
 VAN DIE PLAAS SPRING FARM 588 JQ SOOS BEDOEL BY AFKONDIGING
 DAARVAN IN DIE PROVINSIALE KOERANT EN IN DETAIL GETOON OP PLAN
 GRP 02/47/7 Exp

THE FIGURE : L54, XL1, XL2, XXL3, XL4-XL6, L57D, L57-L54
 REPRESENTS THE INCREASE OF THE WIDTH OF THE PORTION CONCERNED
 OF PROVINCIAL ROAD K26 OVER THE REMAINDER AND PORTION 3 OF THE
 FARM SPRING FARM 588 JQ AS INTENDED BY PUBLICATION THEREOF IN THE
 PROVINCIAL GAZETTE AND SHOWN ON PLAN GRP 02/47/7 Exp

BUNDEL NR. / FILE NO. 2/1/1/2/3/1-K26(2)

KOÖRDINATE LYS / CO-ORDINATE LIST WG 27° KONST. / CONST. Y= +/-0.000 X= +2 800 000.000

L54	-66453.563	+74701.598	L57D	-66611.702	+74653.770	XL5	-66561.989	+74649.024
L55	-66480.037	+74692.094	XL1	-66462.978	+74697.685	XL6	-66608.157	+74653.752
L56	-66482.861	+74691.081	XL2	-66503.889	+74666.399	XXL3	-66507.832	+74641.466
L57	-66538.703	+74671.064	XL4	-66542.802	+74607.552			