

*THE PROVINCE OF
GAUTENG*

*DIE PROVINSIE
GAUTENG*

**Provincial Gazette Extraordinary
Buitengewone Provinsiale Koerant**

Vol. 17

**PRETORIA, 27 MAY
MEI 2011**

No. 103

IMPORTANT NOTICE

The Government Printing Works will not be held responsible for faxed documents not received due to errors on the fax machine or faxes received which are unclear or incomplete. Please be advised that an "OK" slip, received from a fax machine, will not be accepted as proof that documents were received by the GPW for printing. If documents are faxed to the GPW it will be the sender's responsibility to phone and confirm that the documents were received in good order.

Furthermore the Government Printing Works will also not be held responsible for cancellations and amendments which have not been done on original documents received from clients.

CONTENTS • INHOUD

<i>No.</i>		<i>Page No.</i>	<i>Gazette No.</i>
GENERAL NOTICES • ALGEMENE KENNISGEWINGS			
1491	Gauteng Transport Infrastructure Act (8/2001): Proclamation of an access road in connection with the Gautrain Rapid Rail link between Pretoria, Johannesburg and the OR Tambo International Airport: District Randburg.....	3	103
1492	do.: Proclamation of the increase in width of a portion of the provincial railway line in connection with the Gautrain Rapid Rail link between Pretoria, Johannesburg and the OR Tambo International Airport: District Randburg.....	5	103
1493	do.: Application by Centurus (Pty) Ltd (Developers) for the amendment of the preliminary design of a Portion of Provincial Road K54 between Roads K109 and K105 (km 18.200 – km 23.500): District Pretoria	7	103

GENERAL NOTICES

NOTICE 1491 OF 2011

PROCLAMATION OF AN ACCESS ROAD IN CONNECTION WITH THE GAUTRAIN RAPID RAIL LINK BETWEEN PRETORIA, JOHANNESBURG AND THE O R TAMBO INTERNATIONAL AIRPORT: DISTRICT RANDBURG

In terms of section 13(1) of the Gauteng Transport Infrastructure Act, 2001 (Act No. 8 of 2001), the MEC hereby proclaims that an access road with varying widths exists on the land as described and indicated on the accompanying sketch plan.

In terms of section 23 (6) of the aforementioned act it is hereby stated that plans GRP 09/05/02 Exp and GRP 03/38/21 Exp which indicate the land affected by the access road in detail, are available for inspection at the office of The Department of Roads and Transport, First Floor, South Tower, Sage Life Building, 41 Simmonds Street, Johannesburg, during office hours.

Reference: 2/1/7/8 - Gautrain

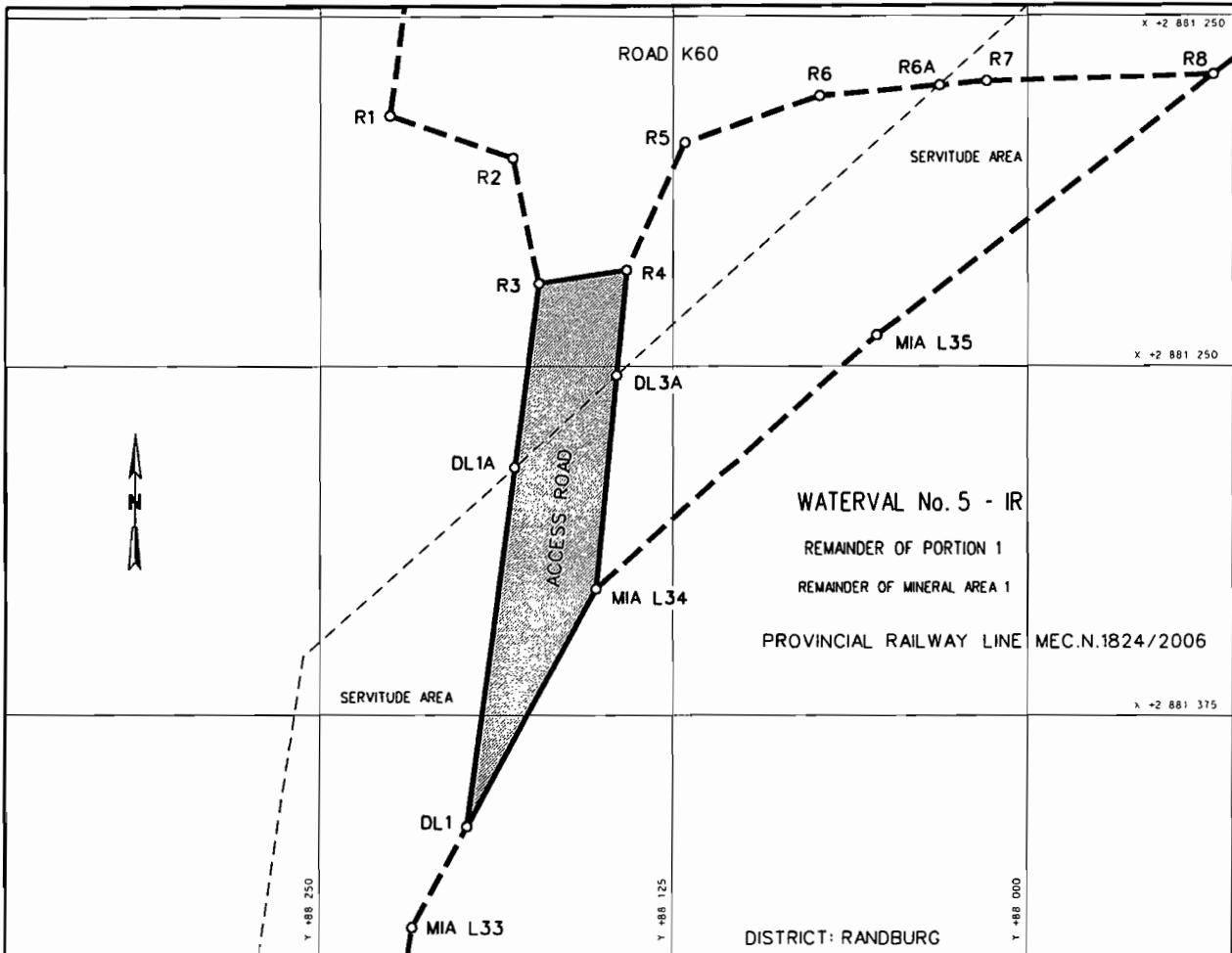

REFERENCE

PROCLAIMED ACCESS ROAD



THE FIGURE : DL1, R3, R4, MIA L34, DL1.

REPRESENTS THE PROCLAMATION OF THE ACCESS ROAD OVER THE REMAINDER OF PORTION 1 OF THE FARM WATERVAL No. 5-IR AS INTENDED BY THE PUBLICATION THEREOF IN THE PROVINCIAL GAZETTE AND SHOWN IN DETAIL ON PLANS GRP 09/05/02Exp AND GRP 03/38/21Exp.

BUNDEL NR. / FILE NO. 2/1/7/8-GAUTRAIN

CO-ORDINATE LIST WG 29° CONST. Y= +/- 0.00 X= +2 800 000.00

DL 1	+88198.028	+81414.439	DL3A	+88145.202	+81253.319	MIA L34	+88152.412	+81329.550
DL1A	+88181.430	+81286.181						

NOTICE 1492 OF 2011**PROCLAMATION OF THE INCREASE IN WIDTH OF A PORTION OF THE PROVINCIAL RAILWAY LINE IN CONNECTION WITH THE GAUTRAIN RAPID RAIL LINK BETWEEN PRETORIA, JOHANNESBURG AND THE O R TAMBO INTERNATIONAL AIRPORT : DISTRICT RANDBURG**

In terms of section 11(2) of the Gauteng Transport Infrastructure Act, 2001 (Act No. 8 of 2001) the MEC hereby proclaims the increase in width of a portion of the provincial railway line on the land as described and indicated on the accompanying sketch plan.

In terms of section 23(6) of the aforementioned act it is hereby stated that plans GRP 09/05/02 Exp & GRP 03/38/21 Exp which indicate the land affected by the increase in width of the railway line in detail, are available for inspection at the office of the Department of Roads and Transport, First Floor, South Tower, Sage Life Building, 41 Simmonds Street, Johannesburg.

Reference: 2/1/7/8 - Gautrain

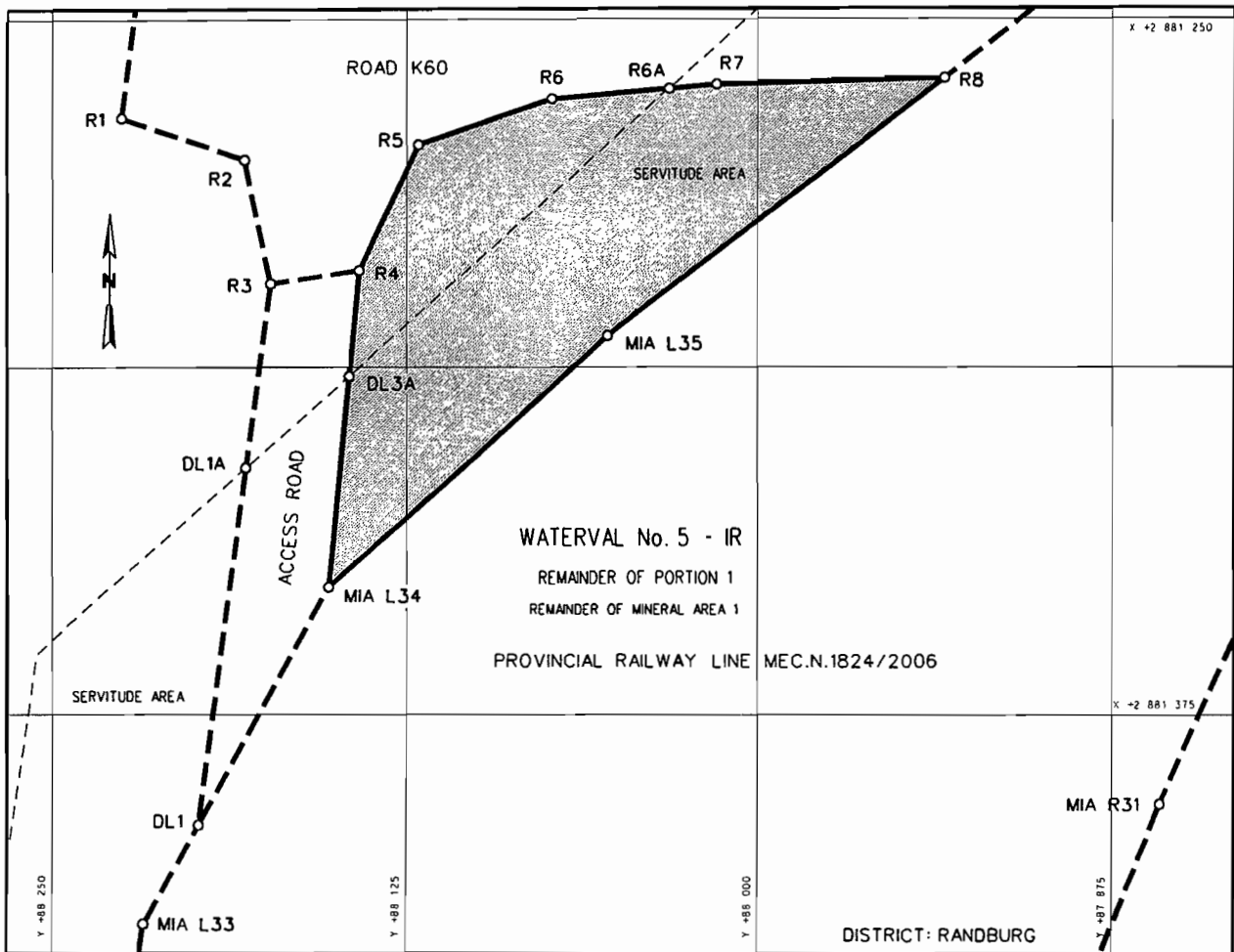

REFERENCE

PROCLAMATION OF THE INCREASE IN WIDTH OF RAILWAY LINE



THE FIGURE R4 - R8, MIA L35, MIA L34, R4.

REPRESENTS THE PROCLAMATION OF THE INCREASE IN WIDTH OF THE RAILWAY LINE OVER THE REMAINDER OF PORTION 1 OF THE FARM WATERVAL No. 5-IR AS INTENDED BY THE PUBLICATION THEREOF IN THE PROVINCIAL GAZETTE AND SHOWN IN DETAIL ON PLANS GRP 09/05/02Exp AND GRP 03/38/21 Exp.

BUNDEL NR. / FILE NO. 2/1/7/8-GAUTRAIN

CO-ORDINATE LIST WG 29° CONST. Y= +/- 0.00 X= +2 800 000.00

R3	+88172.767	+81220.298	R6	+88073.309	+81153.535	R8	+87934.056	+81146.100
R4	+88141.629	+81215.539	R6A	+88031.375	+81149.808	MIA L34	+88152.412	+81329.550
R5	+88120.822	+81169.949	R7	+88014.611	+81148.318	MIA L35	+88053.302	+81238.962

NOTICE 1493 OF 2011**APPLICATION BY CENTURUS (PTY) LTD (DEVELOPERS) FOR THE AMENDMENT OF THE PRELIMINARY DESIGN OF A PORTION OF PROVINCIAL ROAD K54 BETWEEN ROADS K109 AND K105 (KM 18.200 – KM 23.500): DISTRICT PRETORIA**

It is hereby notified for general information that Centurus (Pty) Ltd (Developers) has lodged a written application in terms of section 8(9) of the Gauteng Transport Infrastructure Act, 2001 (Act No. 8 of 2001) for the amendment of a portion of the preliminary design of provincial road K54 between roads K109 and K105 (km 18.200 – km 23.500).

The proposed amendment of the preliminary design in question is indicated on plans GRP00/19/7-10PLy which are available for inspection by any interested person at the Plan Room of the Department of Roads and Transport, First Floor, South Tower, Sage Life Building, 41 Simmonds Street, Johannesburg, for any written comments or objections to be submitted to the Head : Department of Roads and Transport, Private Bag X83, Marshalltown 2107 (Fax (011) 355 7235) within 30 (thirty) days after the date of this notice.

Reference: 2/1/1/2/3/1-K54 (5)

NOTICE 1493 OF 2011**AANSOEK DEUR CENTURUS (PTY) LTD (ONTWIKKELAARS) VIR DIE WYSIGING VAN DIE VOORLOPIGE ONTWERP VAN 'N GEDEELTE VAN PROVINSIALE PAD K 54 TUSSEN PROVINSIALE PAAIE K109 EN K105 (KM 18.200 – KM 23.500): DISTRIK PRETORIA**

Hiermee word vir algemene inligting bekend gemaak dat Centurus (Pty) Ltd (Ontwikkelaars) ingevolge artikel 8(9) van die Gauteng Transport Infrastructure Act, 2001 (Act No. 8 of 2001) 'n skriftelike aansoek ingedien het om 'n wysiging van 'n gedeelte van die voorlopige ontwerp van provinsiale pad K54 tussen provinsiale paaie K109 en K105 (km 18.200 – km 23.500).

Die voorgestelde wysiging van die betrokke voorlopige ontwerp is aangedui op planne GRP00/19/7-10PLy, wat ter insae vir enige belanghebbende persoon by die Plankamer van die Departement van Paaie en Vervoer, Eerste Vloer, Suidtoring, Sage Life Gebou, Simmondsstraat 41, Johannesburg beskikbaar is, vir enige skriftelike kommentaar of beswaar wat binne 30 (dertig) dae na die datum van hierdie kennisgewing by die Hoof : Departement van Paaie en Vervoer, Privaatsak X83, Marshalltown 2107 (faks (011) 355 7235) ingedien moet word.

Verwysing : 2/1/1/2/3/1-K54 (5)
