

*THE PROVINCE OF  
GAUTENG*

*DIE PROVINSIE  
GAUTENG*

**Provincial Gazette Extraordinary  
Buitengewone Provinsiale Koerant**

**Vol. 17**

**PRETORIA, 31 MAY  
MEI 2011**

**No. 108**

**IMPORTANT NOTICE**

The Government Printing Works will not be held responsible for faxed documents not received due to errors on the fax machine or faxes received which are unclear or incomplete. Please be advised that an "OK" slip, received from a fax machine, will not be accepted as proof that documents were received by the GPW for printing. If documents are faxed to the GPW it will be the sender's responsibility to phone and confirm that the documents were received in good order.

Furthermore the Government Printing Works will also not be held responsible for cancellations and amendments which have not been done on original documents received from clients.

**CONTENTS • INHOUD**

<i>No.</i>		<i>Page No.</i>	<i>Gazette No.</i>
<b>GENERAL NOTICES</b>			
1497	Gauteng Transport Infrastructure Act (8/2001): Closure of an access road in respect of Provincial Road P66-1: District Johannesburg .....	3	108
1498	do.: Closure of an access road in respect of Provincial Road P161-1 (PWV3) over portions of Portions 13 and 14 of the farm Olivedale 197-IQ: District Randburg.....	5	108
1499	do.: Proclamation of access roads in respect of Provincial Road K71: District Pretoria.....	7	108

---

## GENERAL NOTICES

---

### NOTICE 1497 OF 2011

#### **CLOSURE OF AN ACCESS ROAD IN RESPECT OF PROVINCIAL ROAD P66-1: DISTRICT JOHANNESBURG**

In terms of section 38 (5) of the Gauteng Transport Infrastructure Act, 2001 (Act No 8 of 2001) the MEC hereby proclaims the closure of an access road in respect of Provincial Road P66-1 on the land as described and indicated by the figure on the accompanying sketch plan.

Boundary beacons, demarcating the aforementioned closure of the road, have been placed on the land concerned and a plan indicating the closure of the road, in detail is available for inspection by any interested person during office hours at the office of the Department of Roads and Transport, Sage Life Building, 41 Simmonds Street, Johannesburg.

MEC Resolution: 006 dated 20 July 2010

Reference: 2/1/1/2/3/1-K73 (2)

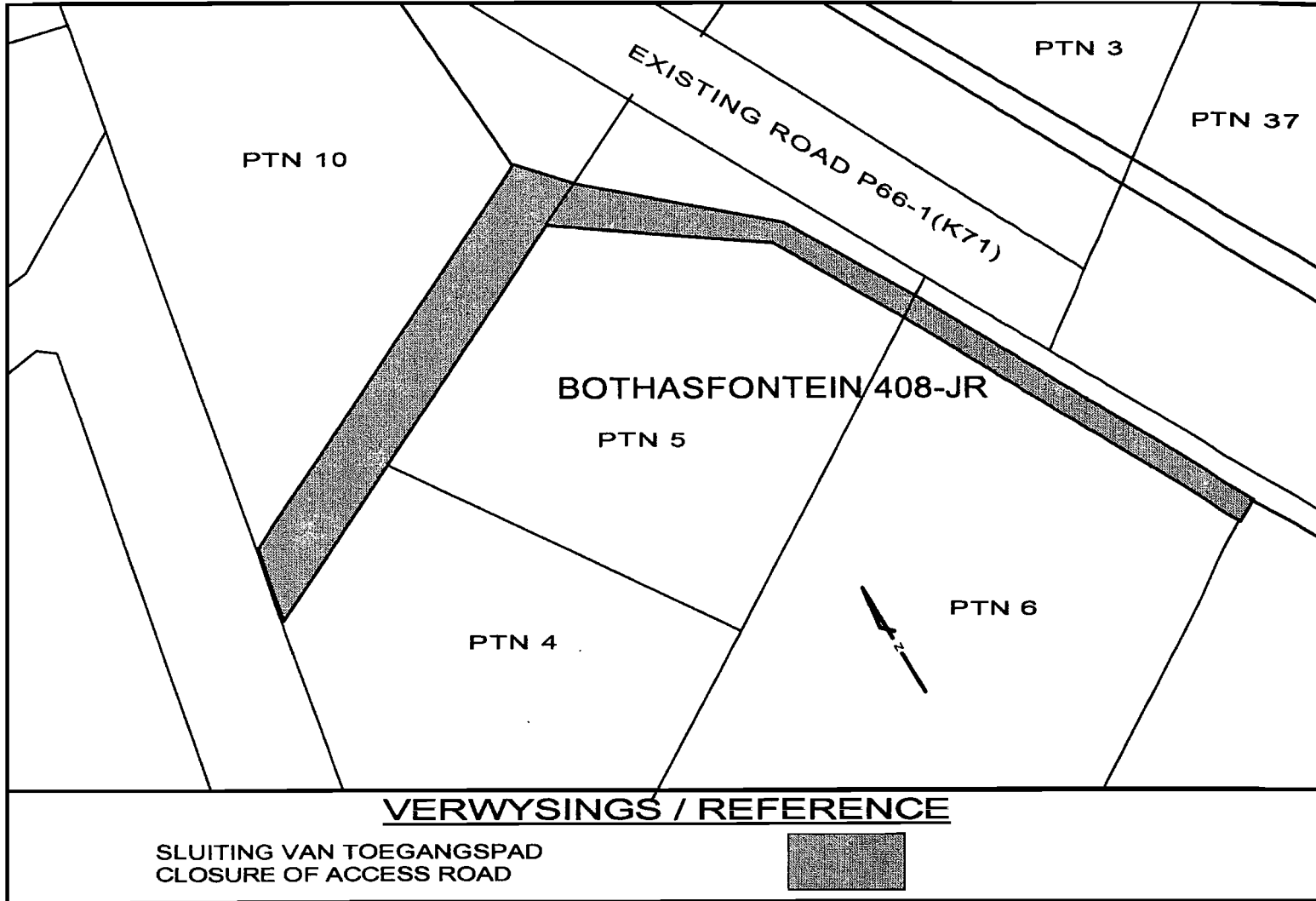

**NOTICE 1498 OF 2011****CLOSURE OF AN ACCESS ROAD IN RESPECT OF PROVINCIAL ROAD P161-1 (PWV3)  
OVER PORTIONS OF PORTIONS 13 AND 14 OF THE FARM OLIVEDALE 197-IQ:  
DISTRICT RANDBURG**

In terms of section 38 (5) of the Gauteng Transport Infrastructure Act, 2001 (Act No 8 of 2001) the MEC hereby proclaims the closure of an access road in respect of Provincial Road P161-1 on the land as described and indicated by the figure on the accompanying sketch plan.

Boundary beacons, demarcating the aforementioned closure of the road, have been placed on the land concerned and plan PRS 77/54/7V indicating the closure of the road, in detail are available for inspection by any interested person during office hours at the office of the Department of Roads and Transport, Sage Life Building, 41 Simmonds Street, Johannesburg.

MEC Resolution: 018 dated 20 July 2010

Reference: 2/1/1/2/3/1-P161-1(PWV3)

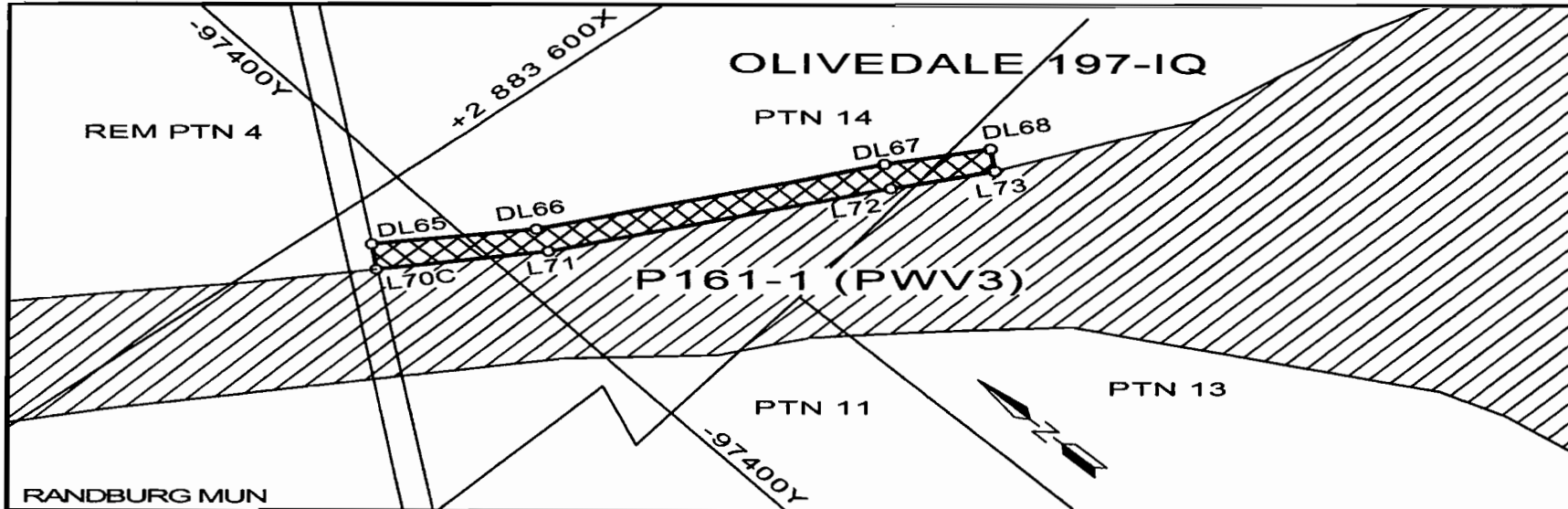

**VERWYSING / REFERENCE**

TOEGANGSPAD GESLUIT  
ACCESS ROAD CLOSED



BESTAANDE PAD  
EXISTING ROAD



DIE FIGUUR : DL65-DL68, L73-L71, L70C, DL65

VERTEENWOORDIG DIE SLUITING VAN 'N TOEGANGSPAD NA PROVINSIALE PAD P161-1 OOR GEDELTES 13 EN 14 VAN DIE PLAAS OLIVEDALE 197-IQ SOOS BEDOEL BY AFKONDIGING DAARVAN IN DIE PROVINSIALE KOERANT EN IN DETAIL GETOON OP PLAN PRS 77/54/7V

THE FIGURE : DL65-DL68, L73-L71, L70C, DL65

REPRESENTS THE CLOSURE OF AN ACCESS ROAD TO PROVINCIAL ROAD P161-1 OVER PORTIONS 13 AND 14 OF THE FARM OLIVEDALE 197-IQ AS INTENDED BY PUBLICATION THEREOF IN THE PROVINCIAL GAZETTE AND SHOWN IN DETAIL ON PLAN PRS 77/54/7V

BUNDEL NR. / FILE NO. 2/1/1/2/3/1-P161-1

**KOÖRDINATE LYS / CO-ORDINATE LIST LO 27° KONST. / CONST. Y = ± 0.000 X = +2 800 000.000**

L70C	-97 345.80	+88 364.66
L71	-97 425.30	+83 687.62
L72	-97 601.18	+83 782.55

L73	-97 650.84	+83 812.62
DL65	-97 354.34	+83 621.12
DL66	-97 433.56	+83 673.89

DL67	-97 609.13	+83 768.65
DL68	-97 659.13	+83 798.93

**NOTICE 1499 OF 2011****PROCLAMATION OF ACCESS ROADS IN RESPECT OF PROVINCIAL ROAD K71: DISTRICT PRETORIA**

In terms of section 13(1) of the Gauteng Transport Infrastructure Act, 2001 (Act No. 8 of 2001) ("the Act") the MEC proclaims access roads to road K71 as described and indicated by the figures on the accompanying sketch plan.

In terms of section 23(6) of the aforementioned act, it is hereby declared that boundary beacons demarcating the said access roads, have been placed and that plan GRP 08/25/2 Exp indicating the land encroached upon by virtue of the proclamation of the access roads, is available for inspection by any interested person in the Plan Room of the Department of Roads and Transport, Sage Life Building, 41 Simmonds Street, Johannesburg.

**Reference: 2/1/1/2/3/1-P66-1**

**MEC Resolution 017 Dated 06 May 2011**

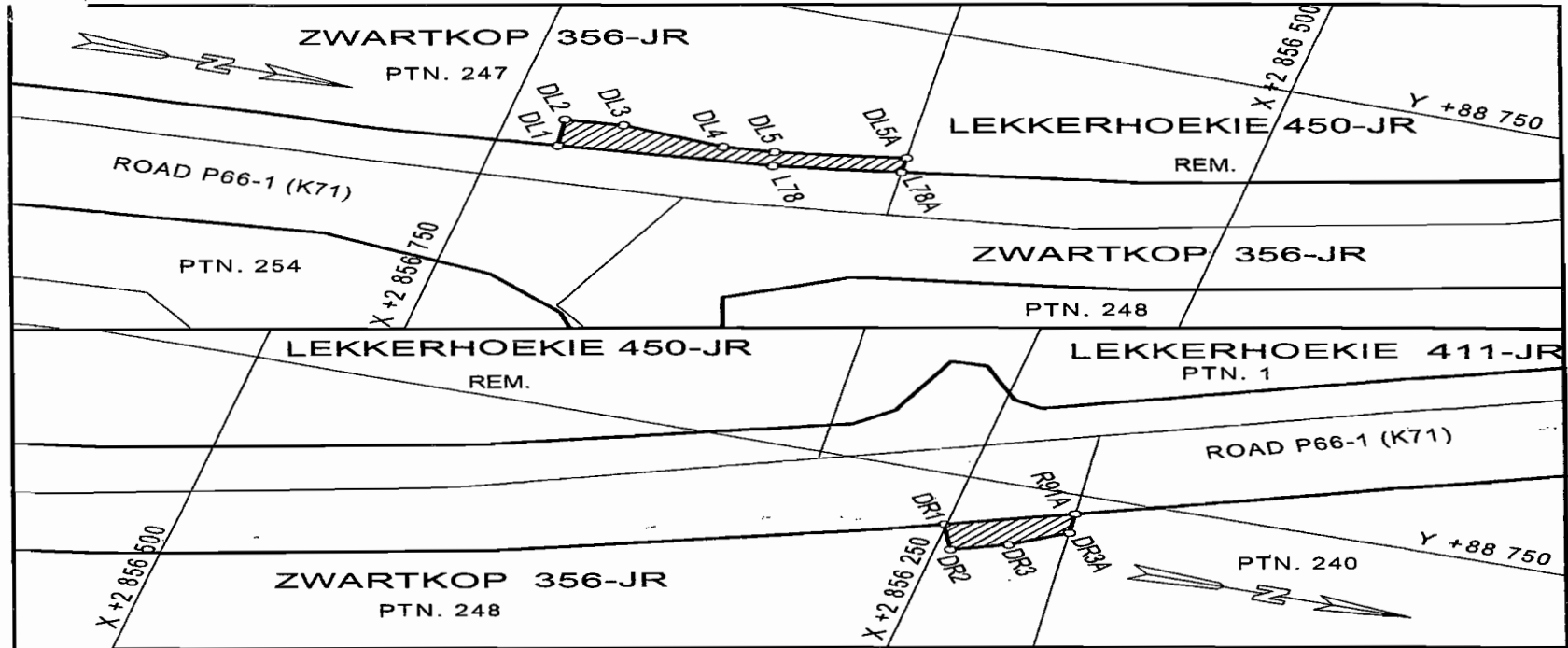

**REFERENCE / VERWYSINGS**

TOEGANGSPAD GEPROKLAEMEER  
ACCESS ROAD PROCLAIMED



BESTAANDE PAD  
EXISTING ROAD

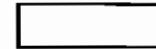

DIE FIGURE : DL1-DL5, DL5A, L78A, L78, DL1  
THE FIGURES : DR1, R91A, DR3A, DR3-DR1

VERTEENWOORDIG DIE PROKLAMASIE VAN DIE BETROKKE GEDEELTE VAN TOEGANGSPAIE NA PROVINSIALE PAD K71 OOR GEDEELTES 247 EN 248 VAN DIE PLAAS ZWARTKOP 356-JR SOOS BEDOEL BY DIE AFKONDIGING DAARVAN IN DIE PROVINSIALE KOERANT EN IN DETAIL GETOON OP PLAN GRP 08/25/2Exp.

REPRESENTS THE PROCLAMATION OF THE PORTION CONCERNED OF ACCESS ROADS TO PROVINCIAL ROAD K71 OVER PORTIONS 247 AND 248 OF THE FARM ZWARTKOP 356-JR AS INTENDED BY PUBLICATION THEREOF IN THE PROVINCIAL GAZETTE AND SHOWN IN DETAIL ON PLAN GRP 08/25/2Exp.

BUNDEL NR. / FILE NO. 2/1/1/2/3/1-P66-1

KOORDINATE LYS/CO-ORDINATE LIST WG 29° KONST./CONST. Y= +/- 0.00 X= +2 800 000.00

L78	+88 660.35	+56 656.63
L78A	+88 669.31	+56 613.67
DL1	+88 651.59	+56 729.00
DL2	+88 666.49	+56 730.75
DL3	+88 668.82	+56 710.88

DL4	+88 666.15	+56 675.30
DL5	+88 668.26	+56 657.80
DL5A	+88 677.38	+56 614.19
R91A	+88 739.06	+56 210.14

DR1	+88 720.84	+56 250.84
DR2	+88 707.14	+56 244.73
DR3	+88 715.56	+56 226.47
DR3A	+88 727.68	+56 209.01