

**THE PROVINCE OF  
GAUTENG**

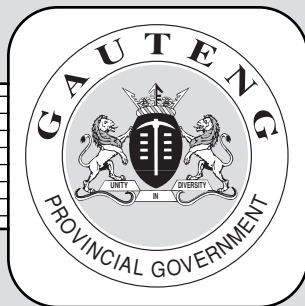

**DIE PROVINSIE  
GAUTENG**

# Provincial Gazette Extraordinary Buitengewone Provinsiale Koerant

Vol. 18

PRETORIA, 10 JULY 2012  
JULIE 2012

No. 202

**We all have the power to prevent AIDS**

AIDS  
affects  
us all

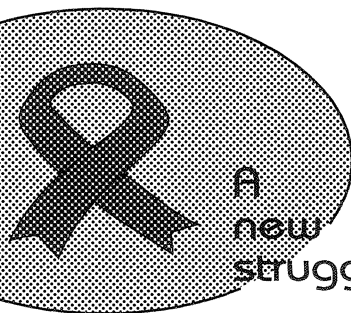

A  
new  
struggle

**AIDS  
HELPLINE**

**0800 012 322**

DEPARTMENT OF HEALTH

**Prevention is the cure**

*N.B. The Government Printing Works will not be held responsible for the quality of "Hard Copies" or "Electronic Files" submitted for publication purposes*



9771682452005

12202

**IMPORTANT NOTICE**

The Government Printing Works will not be held responsible for faxed documents not received due to errors on the fax machine or faxes received which are unclear or incomplete. Please be advised that an "OK" slip, received from a fax machine, will not be accepted as proof that documents were received by the GPW for printing. If documents are faxed to the GPW it will be the sender's responsibility to phone and confirm that the documents were received in good order.

Furthermore the Government Printing Works will also not be held responsible for cancellations and amendments which have not been done on original documents received from clients.

**CONTENTS • INHOUD**

<i>No.</i>		<i>Page No.</i>	<i>Gazette No.</i>
<b>GENERAL NOTICE</b>			
1738	Gauteng Transport Infrastructure Act (8/2001): Proclamation of the increase in width of a portion of the Provincial Railway Line in connection with the Gautrain Rapid Rail Link between Pretoria, Johannesburg and the OR Tambo International Airport: District Johannesburg.....	3	202

---

## GENERAL NOTICE

---

### NOTICE 1738 OF 2012

#### **PROCLAMATION OF THE INCREASE IN WIDTH OF A PORTION OF THE PROVINCIAL RAILWAY LINE IN CONNECTION WITH THE GAUTRAIN RAPID RAIL LINK BETWEEN PRETORIA, JOHANNESBURG AND THE O R TAMBO INTERNATIONAL AIRPORT : DISTRICT JOHANNESBURG**

In terms of section 11(2) of the Gauteng Transport Infrastructure Act, 2001 (Act No. 8 of 2001) the MEC hereby proclaims the increase in width of a portion of the provincial railway line on the land as described and indicated on the accompanying sketch plan.

In terms of section 23(6) of the aforementioned act it is hereby stated that plan GRP 03/38/04 Exp, which indicates the land affected by the increase in width of the railway line on the land in detail, is available for inspection at the office of the Department of Roads and Transport, First Floor, South Tower, Sage Life Building, 41 Simmonds Street, Johannesburg, during office hours.

Reference: 2/1/7/8 - Gautrain

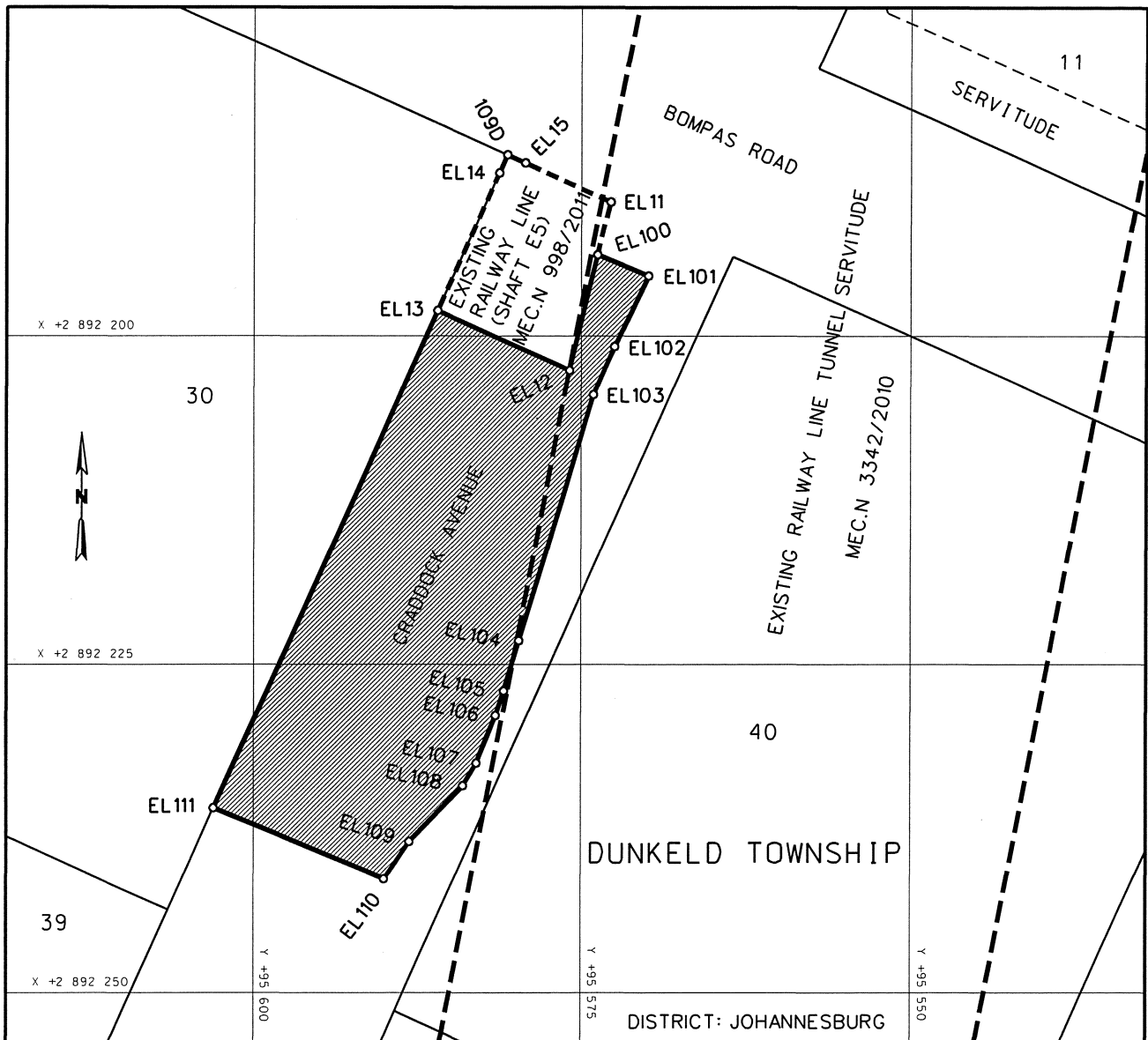

**REFERENCE**

PROCLAMATION OF THE INCREASE IN WIDTH OF RAILWAY LINE (SHAFT E5)

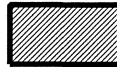

EXISTING RAILWAY LINE



EXISTING RAILWAY LINE TUNNEL SERVITUDE



THE FIGURE : EL13, EL12, EL100 - EL111, EL13.

REPRESENTS THE PROCLAMATION OF THE INCREASE IN WIDTH OF THE RAILWAY LINE (SHAFT E5) OVER A PORTION OF CRADDOCK AVENUE IN DUNKELD AS INTENDED BY THE PUBLICATION THEREOF IN THE PROVINCIAL GAZETTE AND SHOWN IN DETAIL ON PLAN GRP 03/38/04Exp.

FILE NO. 2/1/7/8-GAUTRAIN

**CO-ORDINATE LIST WG 29° CONST. Y= +/- 0.00 X= +2 800 000.00**

EL12	+95575.909	+92202.622	EL102	+95572.420	+92200.819	EL107	+95582.992	+92232.531
EL13	+95585.999	+92198.089	EL103	+95574.015	+92204.477	EL108	+95584.025	+92234.233
			EL104	+95579.761	+92223.182	EL109	+95588.133	+92238.500
EL100	+95573.722	+92193.822	EL105	+95580.896	+92227.030	EL110	+95590.094	+92241.328
EL101	+95569.836	+92195.435	EL106	+95581.510	+92228.902	EL111	+95603.000	+92235.931