

**THE PROVINCE OF
GAUTENG**



**DIE PROVINSIE
GAUTENG**

Provincial Gazette Extraordinary Buitengewone Provinsiale Koerant

Vol. 18

PRETORIA, 10 JULY 2012
JULIE 2012

No. 203

We all have the power to prevent AIDS

AIDS
affects
us all

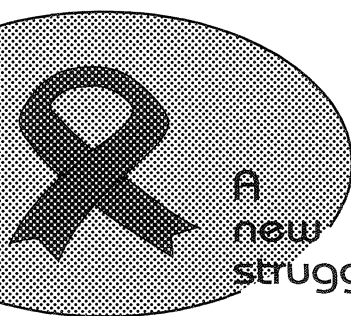

A
new
struggle

**AIDS
HELPLINE**

0800 012 322

DEPARTMENT OF HEALTH

Prevention is the cure

N.B. The Government Printing Works will not be held responsible for the quality of "Hard Copies" or "Electronic Files" submitted for publication purposes



9771682452005

12203

IMPORTANT NOTICE

The Government Printing Works will not be held responsible for faxed documents not received due to errors on the fax machine or faxes received which are unclear or incomplete. Please be advised that an "OK" slip, received from a fax machine, will not be accepted as proof that documents were received by the GPW for printing. If documents are faxed to the GPW it will be the sender's responsibility to phone and confirm that the documents were received in good order.

Furthermore the Government Printing Works will also not be held responsible for cancellations and amendments which have not been done on original documents received from clients.

CONTENTS • INHOUD*No.**Page
No. Gazette
 No.***GENERAL NOTICE**

1739	Gauteng Transport Infrastructure Act (8/2001): Reduction of the road reserve of Provincial Road K33 over a portion of the remainder of Portion 21 of the farm Bultfontein 533 JQ: District Krugersdorp.....	3	203
------	---	---	-----

GENERAL NOTICE

NOTICE 1739 OF 2012

REDUCTION OF THE ROAD RESERVE OF PROVINCIAL ROAD K33 OVER A PORTION OF THE REMAINDER OF PORTION 21 OF THE FARM BULTFONTEIN 533 JQ: DISTRICT KRUGERSDORP

In terms of section 11(2) of the Gauteng Transport Infrastructure Act, 2001 (Act No. 8 of 2001) the MEC for Roads and Transport, hereby proclaims the reduction in width of provincial road K33 over a portion of the Remainder of Portion 21 of the farm Bultfontein 533 JQ, District Krugersdorp, as indicated on the accompanying sketch plan.

In terms of section 23 (6) of the aforementioned act, it is hereby declared that boundary beacons demarcating the said reduction in width of a portion of the above-mentioned provincial road, have been placed on the land and that plan GRP 07/49/6Exp indicating the land encroached upon is available for inspection by any interested person in the Plan Room of the Department of Roads and Transport, Sage Life Building, 41 Simmonds Street, Johannesburg.

Reference: 2/1/1/2/3/1 – K33
MEC Resolution 003 dated 12 June 2012

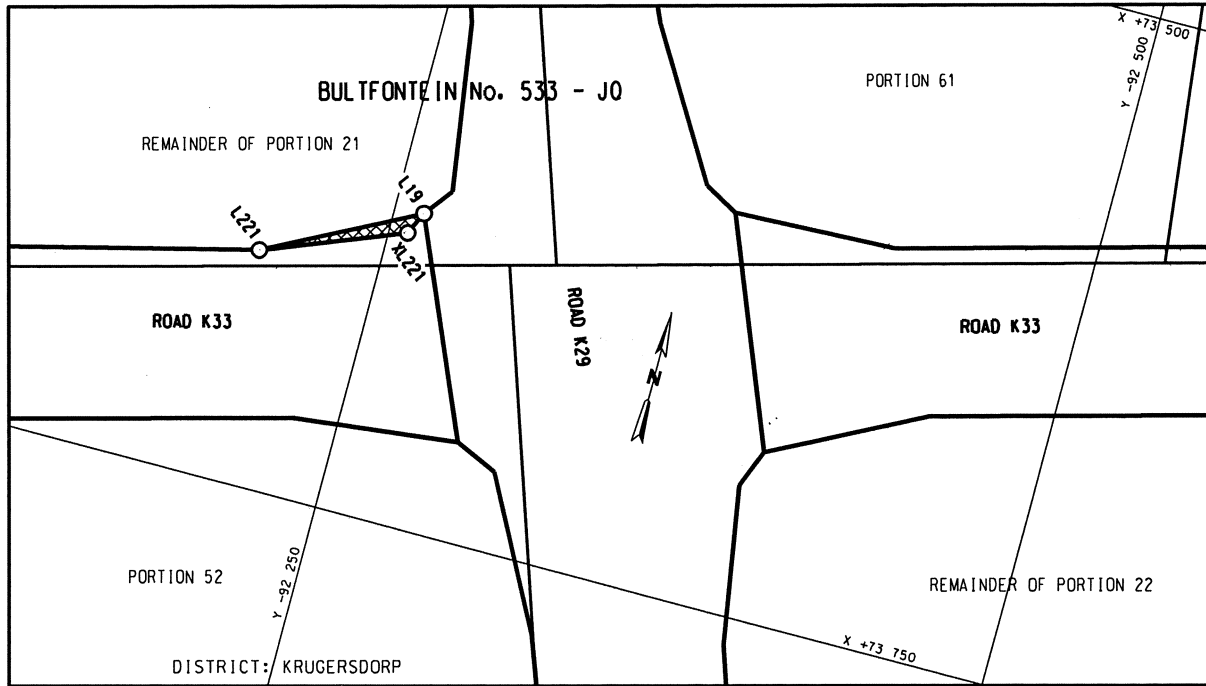

REFERENCE / VERWYSINGS

PAD VERMINDERING IN BREEDTE
ROAD REDUCTION IN WIDTH

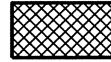

DIE FIGUUR : L221, L19, XL221, L221.
THE FIGURE :

VERTEENWOORDIG DIE VERMINDERING IN BREEDTE VAN PAD K33 OOR DIE RESTANT VAN GEDEELTE 21 VAN DIE PLAAS BULTFONTEIN 533-JO SOOS BEDOEL BY DIE AFKONDIGING DAARVAN IN DIE PROVINSIALE KOERANT EN IN DETAIL GETOON OP PLAN GRP 07/49/6E_{xp}.

REPRESENTS THE REDUCTION IN WIDTH OF ROAD K33 OVER THE REMAINDER OF PORTION 21 OF THE FARM BULTFONTEIN 533-JO AS INTENDED BY THE PUBLICATION THEREOF IN THE PROVINCIAL GAZETTE AND SHOWN IN DETAIL ON PLAN GRP 07/49/6E_{xp}.

BUNDEL NR. / FILE NO. 2/1/1/2/3/1-K33

KOORDINATE LYS/CO-ORDINATE LIST WG 29° KONST./CONST. Y= +/- 0.00 X= +2 800 000.00

L19	-92 260.949	+73 636.744	L221	-92 206.400	+73 664.912	XL221	-92 256.978	+73 645.064
-----	-------------	-------------	------	-------------	-------------	-------	-------------	-------------