

***THE PROVINCE OF
GAUTENG***

***DIE PROVINSIE
GAUTENG***

**Provincial Gazette Extraordinary
Buitengewone Provinsiale Koerant**

Vol. 18

**PRETORIA, 3 FEBRUARY
FEBRUARIE 2012**

No. 23

IMPORTANT NOTICE

The Government Printing Works will not be held responsible for faxed documents not received due to errors on the fax machine or faxes received which are unclear or incomplete. Please be advised that an "OK" slip, received from a fax machine, will not be accepted as proof that documents were received by the GPW for printing. If documents are faxed to the GPW it will be the sender's responsibility to phone and confirm that the documents were received in good order.

Furthermore the Government Printing Works will also not be held responsible for cancellations and amendments which have not been done on original documents received from clients.

CONTENTS • INHOUD*No.**Page
No. Gazette
No.***GENERAL NOTICE**

266	Gauteng Transport Infrastructure Act (8/2001): Proclamation of the increase in width of a portion of the provincial railway line in connection with the Gautrain Rapid Rail link between Pretoria, Johannesburg and the OR Tambo International Airport: District Kempton Park.....	3	23
-----	--	---	----

GENERAL NOTICE

NOTICE 266 OF 2012

PROCLAMATION OF THE INCREASE IN WIDTH OF A PORTION OF THE PROVINCIAL RAILWAY LINE IN CONNECTION WITH THE GAUTRAIN RAPID RAIL LINK BETWEEN PRETORIA, JOHANNESBURG AND THE O R TAMBO INTERNATIONAL AIRPORT : DISTRICT KEMPTON PARK

In terms of section 11(2) of the Gauteng Transport Infrastructure Act, 2001 (Act No. 8 of 2001) the MEC hereby proclaims the increase in width of a portion of the provincial railway line on the land as described and indicated on the accompanying sketch plan.

In terms of section 23(6) of the aforementioned act it is hereby stated that plan GRP 03/38/18 Exp, which indicates the land affected by the increase in width of the railway line on the land in detail, is available for inspection at the office of the Department of Roads and Transport, First Floor, South Tower, Sage Life Building, 41 Simmonds Street, Johannesburg, during office hours.

Reference: 2/17/8 - Gautrain

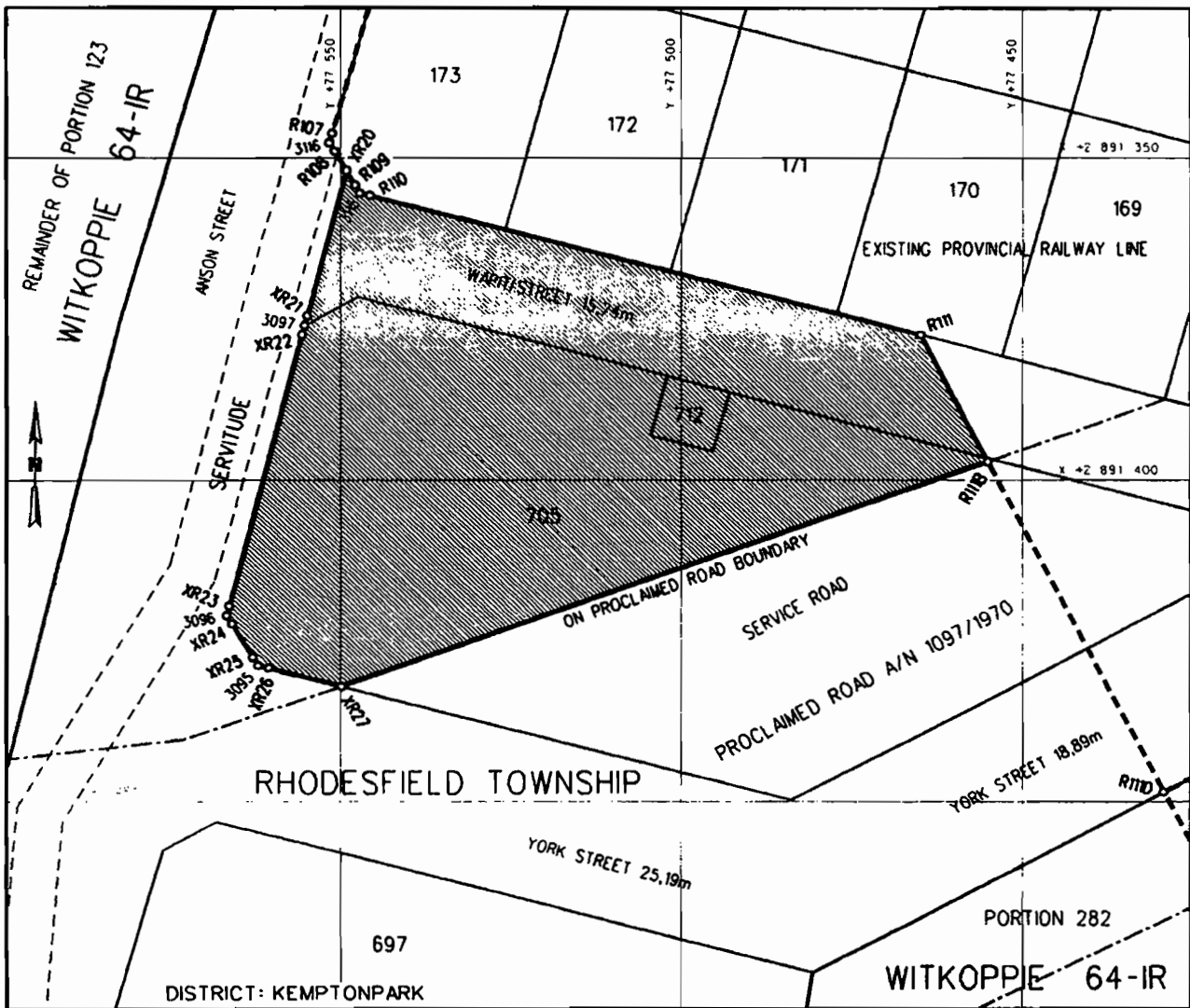

REFERENCE

PROCLAMATION OF THE INCREASE IN WIDTH OF RAILWAY LINE

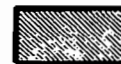

THE FIGURE : XR20, R109, 3115, R110, R111, R111B, XR27, XR26, 3095, XR25, XR24, 3096, XR23, XR22, 3097, XR21, XR20.

REPRESENTS THE PROCLAMATION OF THE INCREASE IN WIDTH OF THE RAILWAY LINE OVER ERVEN 705, 712 AND A PORTION OF WAPITI STREET IN RHODESFIELD AS INTENDED BY THE PUBLICATION THEREOF IN THE PROVINCIAL GAZETTE AND SHOWN IN DETAIL ON PLAN GRP 03/38/18Exp.

BUNDEL NR. / FILE 21/17/8-GAUTRAIN

CO-ORDINATE LIST WG 29° CONST. Y= +/- 0.00 X= +2 800 000.00

XR20	+77549.201	+91351.983	XR26	+77560.320	+91429.104	R111B	+77455.055	+91397.114
XR21	+77554.836	+91374.673	XR27	+77549.865	+91431.922	3095	+77561.769	+91428.714
XR22	+77555.559	+91377.585	R109	+77547.951	+91354.160	3096	+77566.331	+91420.964
XR23	+77565.970	+91419.508	R110	+77545.754	+91355.851	3097	+77555.197	+91376.129
XR24	+77565.570	+91422.257	R111	+77465.019	+91377.609	3115	+77547.200	+91355.460
XR25	+77562.530	+91427.421						