

**THE PROVINCE OF
GAUTENG**

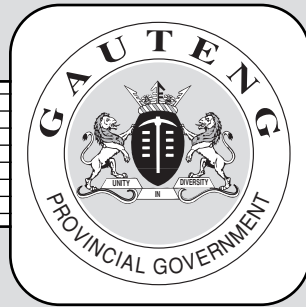

**DIE PROVINSIE
GAUTENG**

Provincial Gazette Extraordinary Buitengewone Provinsiale Koerant

Vol. 19

PRETORIA, 7 JUNE 2013
JUNIE 2013

No. 155

We all have the power to prevent AIDS

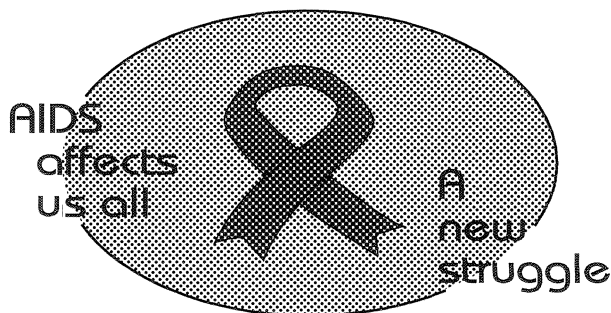

Prevention is the cure

**AIDS
HELPLINE**

0800 012 322

DEPARTMENT OF HEALTH

N.B. The Government Printing Works will not be held responsible for the quality of "Hard Copies" or "Electronic Files" submitted for publication purposes



IMPORTANT NOTICE

The Government Printing Works will not be held responsible for faxed documents not received due to errors on the fax machine or faxes received which are unclear or incomplete. Please be advised that an "OK" slip, received from a fax machine, will not be accepted as proof that documents were received by the GPW for printing. If documents are faxed to the GPW it will be the sender's responsibility to phone and confirm that the documents were received in good order.

Furthermore the Government Printing Works will also not be held responsible for cancellations and amendments which have not been done on original documents received from clients.

CONTENTS • INHOUD

<i>No.</i>		<i>Page No.</i>	<i>Gazette No.</i>
GENERAL NOTICE			
1461	Gauteng Transport Infrastructure Act (8/2001): Proclamation of the increase in width, deviation and Resultant closure of the Portion concerned of Provincial Road K14 (P2-5): District Pretoria	3	155

GENERAL NOTICE

NOTICE 1461 OF 2013

PROCLAMATION OF THE INCREASE IN WIDTH, DEVIATION AND RESULTANT CLOSURE OF THE PORTION CONCERNED OF PROVINCIAL ROAD K14 (P2-5): DISTRICT PRETORIA

In terms of sections 11(2) and 11(1)(d) of the Gauteng Transport Infrastructure Act, 2001 (Act No. 8 of 2001) the MEC for Roads and Transport proclaims the increase in width, deviation and resultant closure of the portion concerned of provincial road K14 (P2-5) as indicated on the accompanying sketch plan.

In terms of section 23 (6) of the aforementioned act, it is hereby declared that boundary beacons demarcating the said increase in width, deviation and resultant closure of the portion concerned of the above-mentioned provincial road, have been placed on the land and that plans GRP 01/05/1Exp-3Exp indicating the land encroached upon are available for inspection by any interested person in the Plan Room of the Department of Roads and Transport, Sage Life Building, 41 Simmonds Street, Johannesburg.

Reference: 2/1/1/2/3/1 – K14 (P2-5)
MEC Resolution 010 dated 20 December 2012

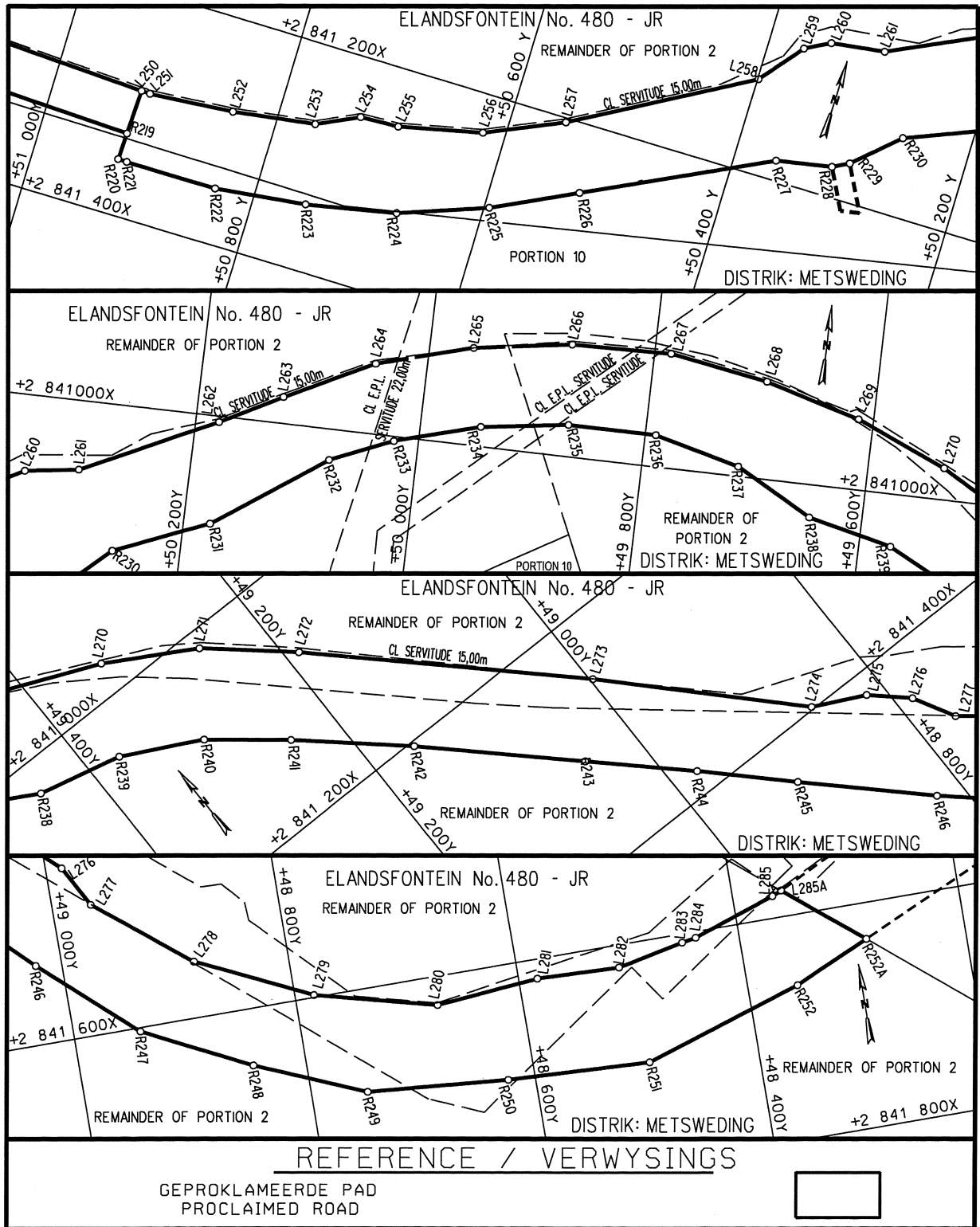

DIE FIGUUR :
THE FIGURE : L250-L285, L285A, R252A, R252-R219, L250.

VERTEENWOORDIG DIE PROKLAMASIE VAN DIE VERBREDING EN VERLEGGING VAN DIE BETROKKE GEDEELTE VAN PROVINSIALE PAD K14 OOR GEDEELTE 10 EN RESTANT VAN GEDEELTE 2 VAN DIE PLAAS ELANDSFONTEIN No. 480 - JR. SOOS BEDOEL BY DIE AFKONDIGING DAARVAN IN DIE PROVINSIALE KOERANT EN IN DETAIL GETOON OP PLANNE GRP 01/05/1EXP-3EXP.

REPRESENTS THE PROCLAMATION OF THE WIDENING AND DEVIATION OF THE PORTION CONCERNED OF PROVINCIAL ROAD K14 OVER PORTION 10 AND REMAINDER OF PORTION 2 OF THE FARM ELANDSFONTEIN No. 480 - JR. AS INTENDED BY THE PUBLICATION THEREOF IN THE PROVINCIAL GAZETTE AND SHOWN IN DETAIL ON PLANS GRP 01/05/1EXP-3EXP.

BUNDEL NR. / FILE NO. 2/1/1/2/3/1-K14(P2-5)

KOÖRDINATE LYS/CO-ORDINATE LIST Lo 29^o KONST./CONST. Y= +/- 0.00 X= +2 900 000.00

L250	+50 922.807	+41 286.646	L275	+49 016.200	+41 419.542	R230	+50 260.720	+41 130.443
L251	+50 914.773	+41 286.962	L276	+48 985.752	+41 447.539	R231	+50 176.905	+41 096.442
L252	+50 839.788	+41 280.963	L277	+48 965.633	+41 484.129	R232	+50 077.655	+41 027.502
L253	+50 765.849	+41 270.170	L278	+48 883.385	+41 550.086	R233	+50 022.011	+41 003.982
L254	+50 728.439	+41 252.427	L279	+48 783.022	+41 597.782	R234	+49 946.579	+40 982.504
L255	+50 693.925	+41 250.786	L280	+48 675.530	+41 625.526	R235	+49 868.905	+40 971.641
L256	+50 620.264	+41 234.150	L281	+48 583.397	+41 617.433	R236	+49 790.475	+40 971.600
L257	+50 551.974	+41 203.689	L282	+48 510.237	+41 620.021	R237	+49 714.639	+40 991.190
L258	+50 399.218	+41 117.528	L283	+48 450.859	+41 607.697	R238	+49 646.480	+41 029.185
L259	+50 368.267	+41 079.738	L284	+48 438.354	+41 605.414	R239	+49 571.603	+41 046.895
L260	+50 346.151	+41 068.082	L285	+48 362.096	+41 579.378	R240	+49 502.903	+41 082.286
L261	+50 298.648	+41 061.697	L285A	+48 356.611	+41 776.735	R241	+49 442.554	+41 130.968
L262	+50 179.752	+41 005.251				R242	+49 359.730	+41 204.303
L263	+50 124.998	+40 976.393	R219	+50 924.366	+41 326.615	R243	+49 248.767	+41 309.953
L264	+50 046.131	+40 937.205	R220	+50 925.301	+41 350.600	R244	+49 176.343	+41 378.909
L265	+49 961.253	+40 913.037	R221	+50 917.268	+41 350.913	R245	+49 112.541	+41 442.417
L266	+49 873.922	+40 899.816	R222	+50 835.183	+41 350.812	R246	+49 023.025	+41 529.719
L267	+49 785.395	+40 897.774	R223	+50 753.625	+41 341.125	R247	+48 941.048	+41 603.403
L268	+49 698.187	+40 912.900	R224	+50 672.984	+41 324.884	R248	+48 847.074	+41 650.509
L269	+49 613.284	+40 936.979	R225	+50 595.363	+41 296.351	R249	+48 749.839	+41 691.321
L270	+49 532.050	+40 971.659	R226	+50 522.134	+41 260.307	R250	+48 623.978	+41 702.119
L271	+49 455.096	+41 015.664	R227	+50 363.388	+41 182.293	R251	+48 497.165	+41 708.056
L272	+49 388.079	+41 073.753	R228	+50 313.931	+41 173.182	R252	+48 356.161	+41 662.728
L273	+49 197.739	+41 256.360	R229	+50 299.776	+41 165.722	R252A	+48 288.948	+41 632.416
L274	+49 060.944	+41 397.651						

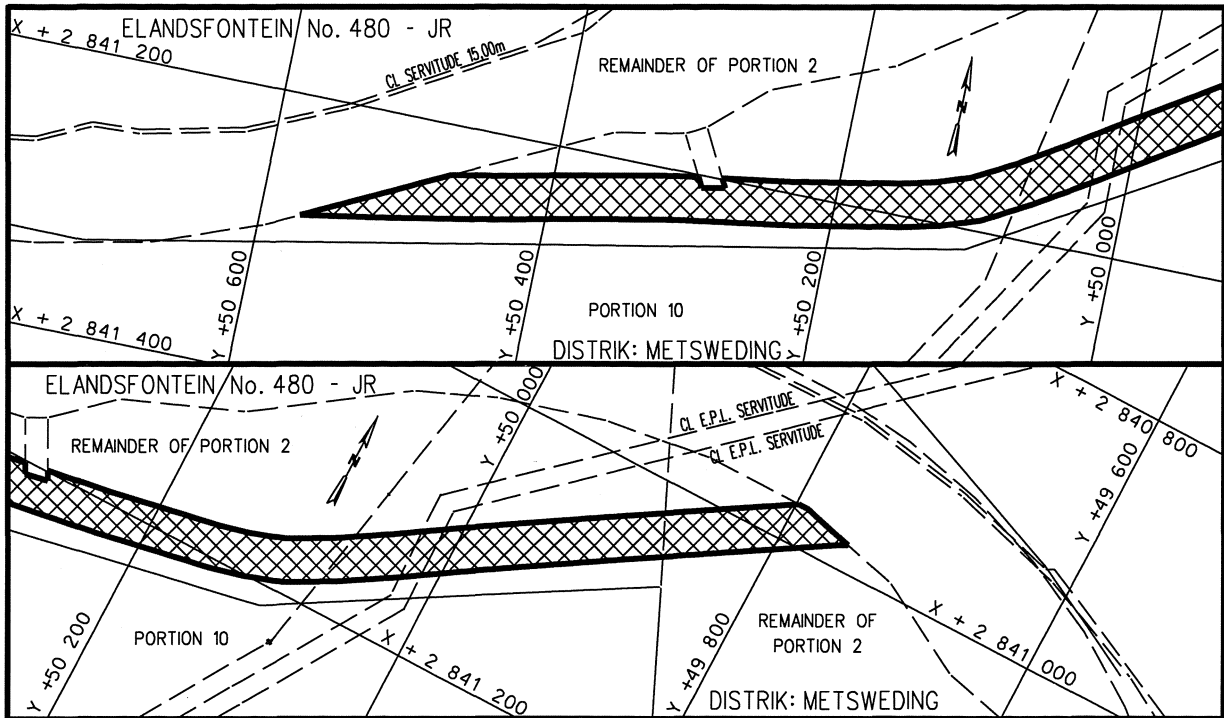

REFERENCE / VERWYSINGS

PAD GESLUIT
ROAD CLOSED



DIE FIGURE : 
THE FIGURES :

VERTEENWOORDIG DIE SLUITING VAN DIE BETROKKE GEDEELTE VAN PROVINSIALE PAD K14 OOR DIE RESTANT VAN GEDEELTE 2 VAN DIE PLAAS ELANDSFONTEIN No. 480 - JR. SOOS BEDOEL BY DIE AFKONDIGING DAARVAN IN DIE PROVINSIALE KOERANT EN IN DETAIL GETOON OP PLANNE GRP 01/05/1EXp-3EXP.

REPRESENTS THE CLOSURE OF THE PORTION CONCERNED OF PROVINCIAL ROAD K14 OVER THE REMAINDER OF PORTION 2 OF THE FARM ELANDSFONTEIN No. 480 - JR. AS INTENDED BY THE PUBLICATION THEREOF IN THE PROVINCIAL GAZETTE AND SHOWN IN DETAIL ON PLANS GRP 01/05/1EXp-3EXP.

BUNDEL NR. / FILE NO. 2/1/1/2/3/1-K14(P2-5)

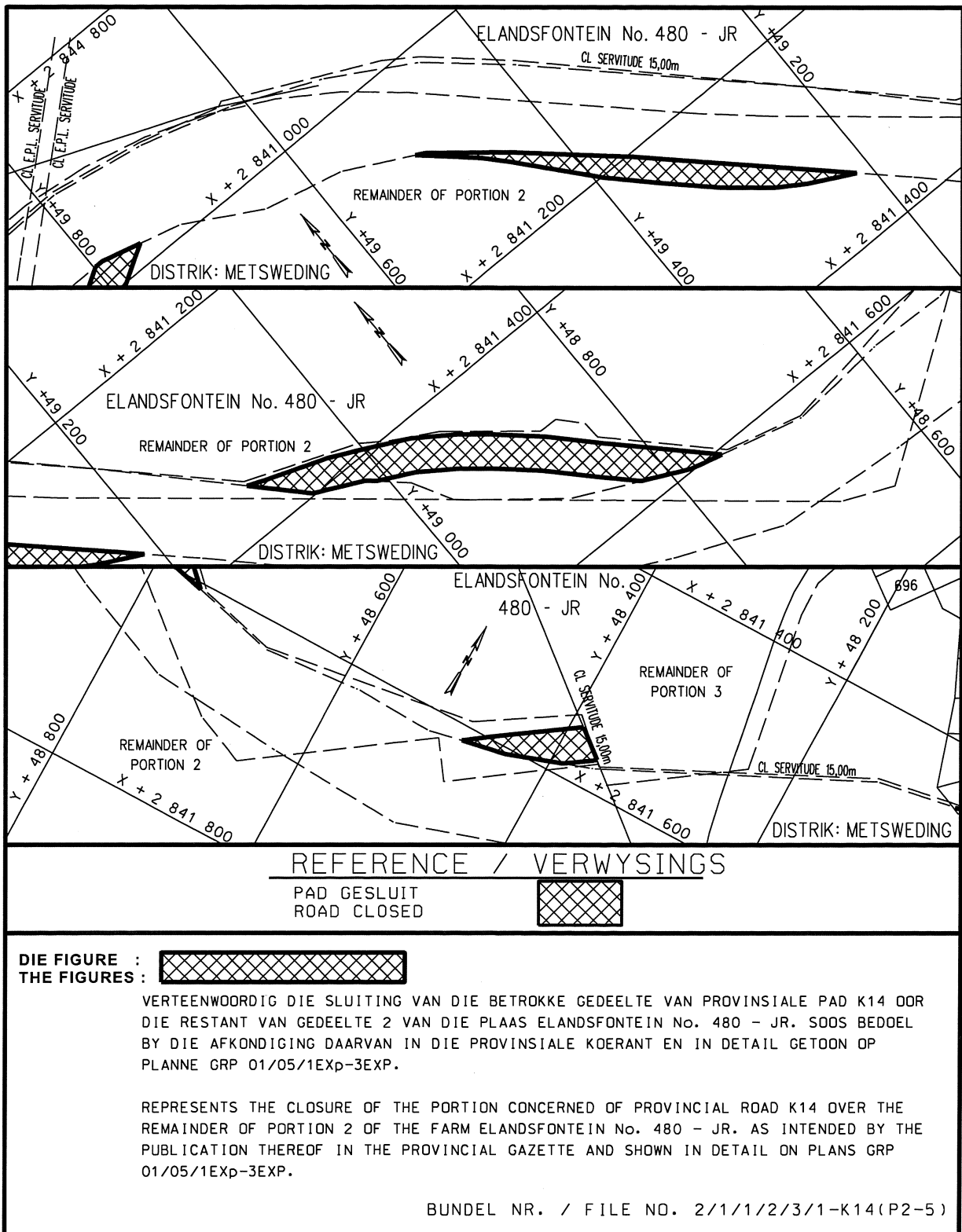

PROCLAMATION OF AN ACCESS ROAD IN CONNECTION WITH PROVINCIAL ROAD K14 (P2-5): DISTRICT PRETORIA

In terms of section 13(1) of the Gauteng Transport Infrastructure Act, 2001, (Act No. 8 of 2001) ("the Act") the MEC hereby proclaims that an access road exist on the land as indicated on the accompanying sketch plan.

In terms of section 23(6) of the aforementioned Act it is hereby declared that boundary beacons demarcating the land encroached upon by the proclamation of the access road, have been erected on the land and that plan GRP 01/05/1 EXP which indicate the said encroachment of the land, is available for inspection by any interested person at the office of the Department of Roads and Transport, 41 Simmonds Street, Sage Life Building, Johannesburg.

MEC Resolution: 010 Dated 20 December 2012

Reference: 2/1/1/2/3/1 – K14 (P2-5)

