

**THE PROVINCE OF
GAUTENG**



**DIE PROVINSIE
GAUTENG**

Provincial Gazette Extraordinary Buitengewone Provinsiale Koerant

Vol. 19

PRETORIA, 10 SEPTEMBER 2013

No. 265

We all have the power to prevent AIDS

AIDS
affects
us all



A
new
struggle

Prevention is the cure

**AIDS
HELPLINE**

0800 012 322

DEPARTMENT OF HEALTH

N.B. The Government Printing Works will not be held responsible for the quality of "Hard Copies" or "Electronic Files" submitted for publication purposes



IMPORTANT NOTICE

The Government Printing Works will not be held responsible for faxed documents not received due to errors on the fax machine or faxes received which are unclear or incomplete. Please be advised that an "OK" slip, received from a fax machine, will not be accepted as proof that documents were received by the GPW for printing. If documents are faxed to the GPW it will be the sender's responsibility to phone and confirm that the documents were received in good order.

Furthermore the Government Printing Works will also not be held responsible for cancellations and amendments which have not been done on original documents received from clients.

CONTENTS • INHOUD*No.**Page
No. Gazette
 No.***GENERAL NOTICE**

2440	Gauteng Transport Infrastructure Act (8/2001): Remainder of Portion 61, Portion 35 and Remainder of Portion 65 of the farm Boschfontein 386 IR	3	265
------	--	---	-----

GENERAL NOTICE

NOTICE 2440 OF 2013

PROCLAMATION OF REDUCTION IN WIDTH OF THE ROAD RESERVE OF PROVINCIAL ROAD P4-1 OVER THE REMAINDER OF PORTION 61, PORTION 35 AND REMAINDER OF PORTION 65 OF THE FARM BOSCHFONTEIN 386 IR: DISTRICT HEIDELBERG

In terms of section 38(5) of the Gauteng Transport Infrastructure Act, 2001 (Act No. 8 of 2001) the MEC for Roads and Transport, hereby proclaims the reduction in width of provincial road P4-1 over the Remainder of Portion 61, Portion 35 and Remainder of Portion 65 of the farm Boschfontein 386 IR, District Heidelberg, as indicated on the accompanying sketch plan.

Boundary beacons demarcating the reduction in width of the above-mentioned provincial road, have been placed on the land and plan PRS 75/42/26V indicating the land encroached upon is available for inspection by any interested person in the Plan Room of the Department of Roads and Transport, Sage Life Building, 41 Simmonds Street, Johannesburg.

MEC Resolution: 009 Dated 22 August 2013

Reference: 2/1/1/2/3/1 – P4-1

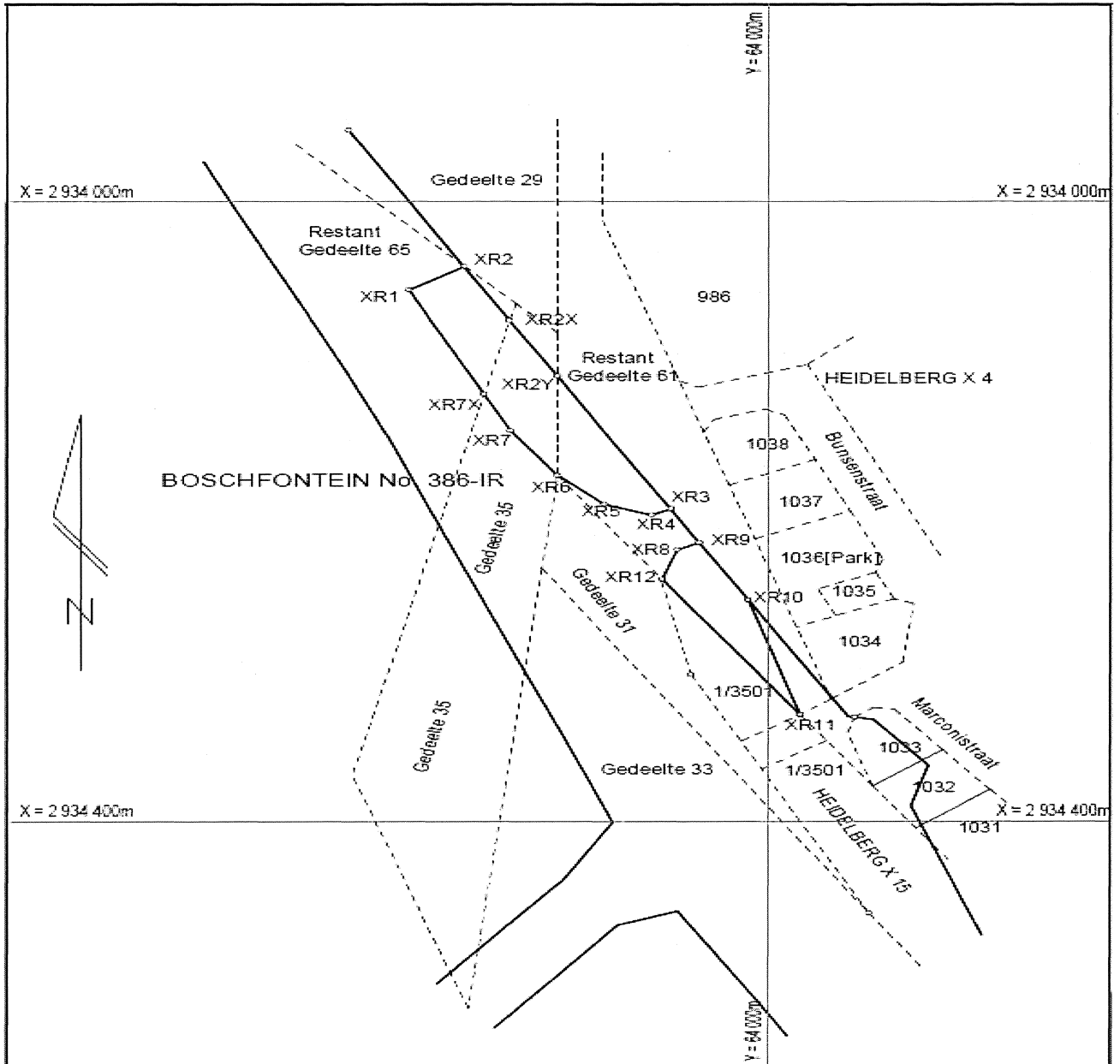

VERWYSING/REFERENCE

VERMINDERING IN BREEDTE
REDUCTION IN WIDTH



DIE FIGURE : XR1, XR2, XR3, XR4, XR5, XR6, XR7, XR1 EN XR8, XR9, XR10, XR11, XR12, XR8
VERTEENWOORDIG DIE VERMINDERING IN BREEDTE VAN DIE BETROKKE GEDEELTES VAN PROVINSIALE
PAD P4-1 OOR RESTANT VAN GEDEELTE 61, GEDEELTE 35 EN RESTANT VAN GEDEELTE 65
VAN DIE PLAAS BOSCHFONTEIN No. 386 - IR SOOS BEDOEL BY AFKONDIGING DAARVAN
IN DIE PROVINSIALE KOERANT EN IN DETAIL GETOON OP PLAN PRS 75/42/26V

THE FIGURES : XR1, XR2, XR3, XR4, XR5, XR6, XR7, XR1 AND XR8, XR9, XR10, XR11, XR12, XR8
REPRESENTS THE REDUCTION IN WIDTH OF THE PORTIONS CONCERNED OF PROVINSIAL
ROAD P4-1 OVER THE REMAINDER OF PORTION 61, PORTION 35 AND REMAINDER OF PORTION 65
OF THE FARM BOSCHFONTEIN No. 386 - IR AS INTENDED BY THE PUBLICATION THEREOF
IN THE PROVINCIAL GAZETTE AND SHOWN IN DETAIL ON PLAN PRS 75/42/26V

CO-ORDINATE LIST WG 29 CONST. Y= +/- 0.00 X= +/- 0.00

XR1	+ 64153.428	+ 2934056.936	XR7	+ 64109.261	+ 2934147.724
XR2	+ 64129.072	+ 2934041.532	XR7X	+ 64120.745	+ 2934124.120
XR2X	+ 64109.828	+ 2934076.444	XR8	+ 64038.538	+ 2934224.525
XR2Y	+ 64089.794	+ 2934112.100	XR9	+ 64029.447	+ 2934220.101
XR3	+ 64041.647	+ 2934198.234	XR10	+ 64008.694	+ 2934256.813
XR4	+ 64049.475	+ 2934202.043	XR11	+ 63986.296	+ 2934331.149
XR5	+ 64069.525	+ 2934195.117	XR12	+ 64045.001	+ 2934244.575
XR6	+ 64089.739	+ 2934171.008			