

**THE PROVINCE OF  
GAUTENG**



**DIE PROVINSIE  
GAUTENG**

# Provincial Gazette Extraordinary Buitengewone Provinsiale Koerant

**Vol. 19**

**PRETORIA, 16 SEPTEMBER 2013**

**No. 271**

**We all have the power to prevent AIDS**



**Prevention is the cure**

**AIDS  
HELPLINE**

**0800 012 322**

**DEPARTMENT OF HEALTH**

*N.B. The Government Printing Works will not be held responsible for the quality of "Hard Copies" or "Electronic Files" submitted for publication purposes*



**IMPORTANT NOTICE**

The Government Printing Works will not be held responsible for faxed documents not received due to errors on the fax machine or faxes received which are unclear or incomplete. Please be advised that an "OK" slip, received from a fax machine, will not be accepted as proof that documents were received by the GPW for printing. If documents are faxed to the GPW it will be the sender's responsibility to phone and confirm that the documents were received in good order.

Furthermore the Government Printing Works will also not be held responsible for cancellations and amendments which have not been done on original documents received from clients.

**CONTENTS • INHOUD**

<i>No.</i>		<i>Page No.</i>	<i>Gazette No.</i>
<b>GENERAL NOTICES</b>			
2513	Gauteng Transport Infrastructure Act (8/2001): Proclamation of the increase and reduction in width of portions of Provincial Road P1-1: District Vereeniging .....	3	271
2514	do.: Closure of access roads in connection with Provincial Road P1-1: District Vereeniging .....	7	271
2515	do.: Proclamation of access roads in connection with Provincial Road P1-1: District Vereeniging .....	10	271
2516	Notice of Proposed deproclamation of three Portions of Provincial Road 1455: District Johannesburg .....	12	271

---

## GENERAL NOTICES

---

### NOTICE 2513 OF 2013

#### **PROCLAMATION OF THE INCREASE AND REDUCTION IN WIDTH OF PORTIONS OF PROVINCIAL ROAD P1-1: DISTRICT VEREENIGING**

In terms of section 11(2) of the Gauteng Transport Infrastructure Act, 2001 (Act No. 8 of 2001) the MEC for Roads and Transport, proclaims the increase and reduction in width of portions of Provincial Road P1-1 as indicated on the accompanying sketch plans.

In terms of section 23(6) of the aforementioned act it is hereby declared that boundary beacons demarcating the said increase and reduction in width of portions of the above-mentioned provincial road, have been placed and that plan PRS78/202/19V (2) indicating the land encroached upon is available for inspection by any interested person in the Plan Room of the Department of Roads and Transport, Sage life Building, 41 Simmonds Street, Johannesburg.

**Reference: 2/1/1/2/3/1-P1-1**

**MEC: Resolution 010 Dated 01 August 2013**

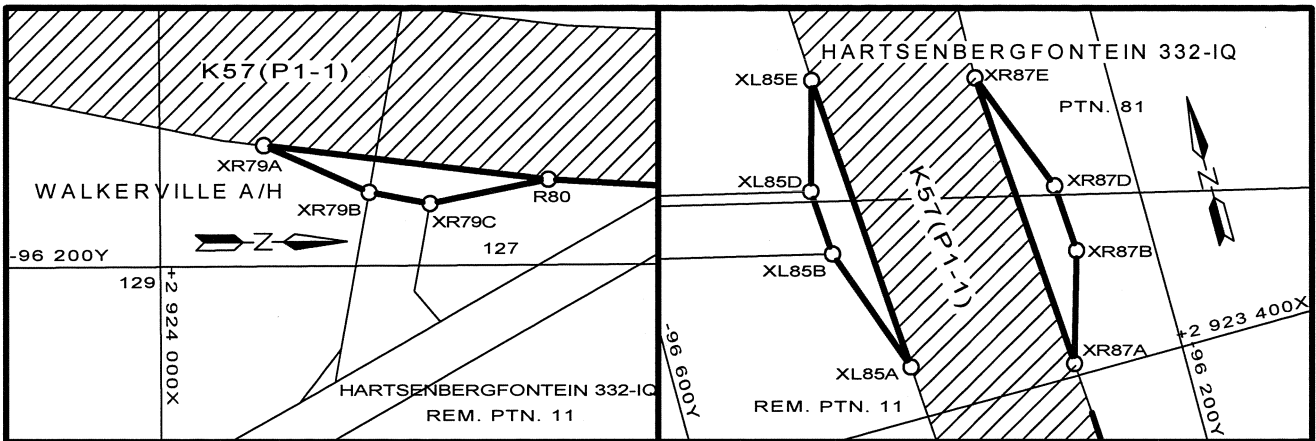

**VERWYSING / REFERENCE**

PAD VERBREED  
ROAD WIDENING



BESTAANDE PAD  
EXISTING ROAD



DIE FIGURE 1 : XR79A, R80, XR79C, XR79B, XR79A.  
 2 : XL85A, XL85B, XL85D, XL85E, XL85A.  
 3 : XR87A, XR87E, XR87D, XR87B, XR87A.  
 VERTEENWOORDIG DIE VERBREDING VAN DIE BETROKKE GEDEELTES VAN PROVINSIALE PAD K57(P1-1) OOR HOEWES 127 & 129 VAN WALKERVILLE L/H EN GEDEELTE 81 EN RESTANT VAN GEDEELTE 11 VAN DIE PLAAS HARTSENBERGFONTEIN 332-IQ SOOS BEDOEL BY AFKONDIGING DAARVAN IN DIE PROVINSIALE KOERANT EN IN DETAIL GETOON OP PLAN PRS 78/202/19V(2)

THE FIGURES 1 : XR79A, R80, XR79C, XR79B, XR79A.  
 2 : XL85A, XL85B, XL85D, XL85E, XL85A.  
 3 : XR87A, XR87E, XR87D, XR87B, XR87A.  
 REPRESENTS THE WIDENING OF THE PORTIONS CONCERNED OF PROVINCIAL ROAD K57(P1-1) OVER HOLDINGS 127 & 129 OF WALKERVILLE A/H AND PORTION 81 & REMAINDER OF PORTION 11 OF THE FARM HARTSENBERGFONTEIN 332-IQ AS INTENDED BY PUBLICATION THEREOF IN THE PROVINCIAL GAZETTE AND SHOWN IN DETAIL ON PLAN PRS 78/202/19V(2)

BUNDEL NR. / FILE NO. 2/1/1/2/3/1-P1-1

**KOÖRDINATE LYS / CO-ORDINATE LIST L<sub>0</sub> 27° KONST. / CONST. Y = ± 0.000 X = +2 900 000.000**

XL85A	-96 093.31	+23 379.13	R80	-96 166.19	+23 841.03	XR87A	-96 156.53	+23 394.99
XL85B	-96 074.86	+23 327.24	XR79A	-96 151.97	+23 958.25	XR87B	-96 169.27	+23 351.73
XL85D	-96 073.07	+23 301.01	XR79B	-96 170.74	+23 916.18	XR87D	-96 167.52	+23 324.74
XL85E	-96 085.11	+23 258.50	XR79C	-96 175.34	+23 891.60	XR87E	-96 148.35	+23 274.75

1/1 V1.2

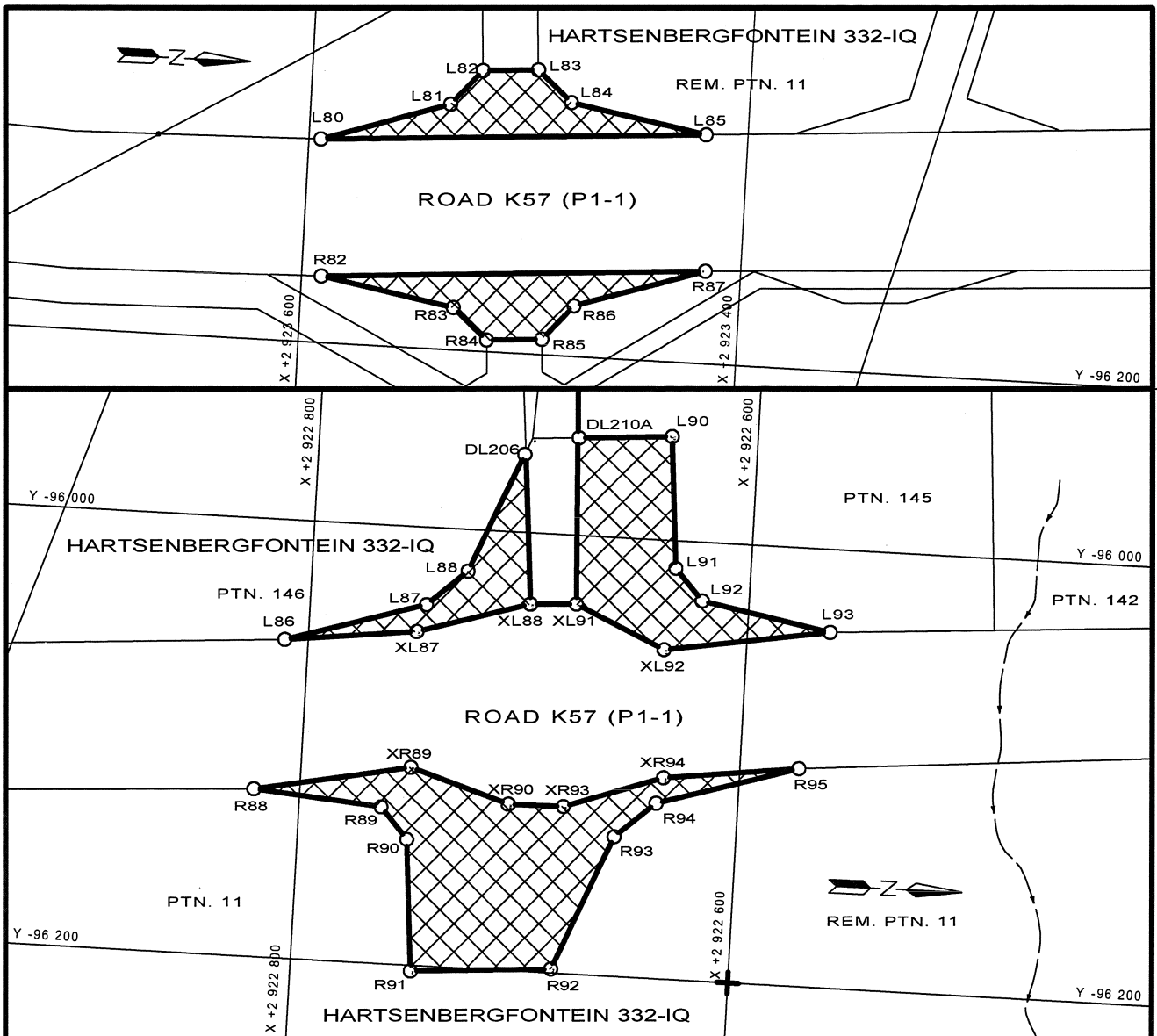

**VERWYSING / REFERENCE**

PAD GESLUIT  
ROAD CLOSED



BESTAANDE PAD  
EXISTING ROAD



- DIE FIGURE 1 : L80-L85, L80.  
2 : R82, R87-R82.  
3 : L86-L88, DL206, XL88, XL87, L86.  
4 : DL210A, L90-L93, XL92, XL91, DL210A.  
5 : R88, XR89, XR90, XR93, XR94, R95-R88.

VERTEENWOORDIG DIE VERMINDERING IN BREEDE VAN PROVINSIALE PAD K57(P1-1) OOR GEDEELTE 11 EN RESTANT GEDEELTE 11 VAN DIE PLAAS HARTSENBERGFONTEIN 332-IQ SOOS BEDOEL BY AFKONDIGING DAARVAN IN DIE PROVINSIALE KOERANT EN IN DETAIL GETOON OP PLAN PRS 78/202/19V(2)

- THE FIGURES 1 : L80-L85, L80.  
2 : R82, R87-R82.  
3 : L86-L88, DL206, XL88, XL87, L86.  
4 : DL210A, L90-L93, XL92, XL91, DL210A.  
5 : R88, XR89, XR90, XR93, XR94, R95-R88.

REPRESENTS THE REDUCTION IN WIDTH OF PROVINCIAL ROAD K57(P1-1) OVER PORTION 11 AND REMAINDER OF PORTION 11 OF THE FARM HARTSENBERGFONTEIN 332-IQ AS INTENDED BY PUBLICATION THEREOF IN THE PROVINCIAL GAZETTE AND SHOWN IN DETAIL ON PLAN PRS 78/202/19V(2)

BUNDEL NR. / FILE NO. 2/1/1/2/3/1-P1-1

KOÖRDINATE LYS / CO-ORDINATE LIST L <sub>o</sub> 27° KONST. / CONST. Y = ± 0.000 X = +2 900 000.000								
L80	-96 107.88	+23 594.57	XL87	-96 050.20	+22 745.22	R90	-96 142.71	+22 749.60
L81	-96 088.94	+23 536.02	XL88	-96 032.18	+22 701.34	R91	-96 202.51	+22 744.58
L82	-96 072.96	+23 522.08	XL91	-96 030.49	+22 676.40	R92	-96 198.18	+22 680.95
L83	-96 071.27	+23 497.13	XL92	-96 042.40	+22 630.49	R93	-96 136.29	+22 655.18
L84	-96 085.21	+23 481.15	R82	-96 169.77	+23 590.98	R94	-96 120.04	+22 637.19
L85	-96 096.11	+23 420.27	R83	-96 180.73	+23 529.78	R95	-96 100.64	+22 573.02
L86	-96 054.65	+22 810.67	R84	-96 194.68	+23 513.80	XR89	-96 112.06	+22 741.01
L87	-96 035.26	+22 746.50	R85	-96 192.98	+23 488.86	XR90	-96 123.97	+22 695.10
L88	-96 019.00	+22 728.51	R86	-96 177.00	+23 474.91	XR93	-96 122.28	+22 670.16
L90	-95 952.78	+22 639.11	R87	-96 157.97	+23 416.07	XR94	-96 104.26	+22 626.28
L91	-96 012.58	+22 634.09	R88	-96 123.51	+22 820.99	DL206	-95 964.57	+22 705.94
L92	-96 026.74	+22 621.28	R89	-96 128.55	+22 762.41	DL210A	-95 956.66	+22 681.42
L93	-96 037.77	+22 562.30						

2/2 V1.0

**NOTICE 2514 OF 2013****CLOSURE OF ACCESS ROADS IN CONNECTION WITH PROVINCIAL ROAD P1-1: DISTRICT VEREENIGING**

In terms of section 13(1) read with section 16(1) (c) of the Gauteng Transport Infrastructure Act, 2001 (Act No. 8 of 2001) the MEC for Roads and Transport, proclaims the closure of access roads in connection with Provincial Road P1-1 as indicated on the accompanying sketch plan.

In terms of section 23(6) of the aforementioned act it is hereby declared that boundary beacons demarcating the closure of the access roads have been placed and that plan PRS78/202/19V (2) indicating the land encroached upon is available for inspection by any interested person in the Plan Room of the Department of Roads and Transport, Sage life Building, 41 Simmonds Street, Johannesburg.

**Reference: 2/1/1/2/3/1-P1-1**

**MEC: Resolution 010 Dated 01 August 2013**

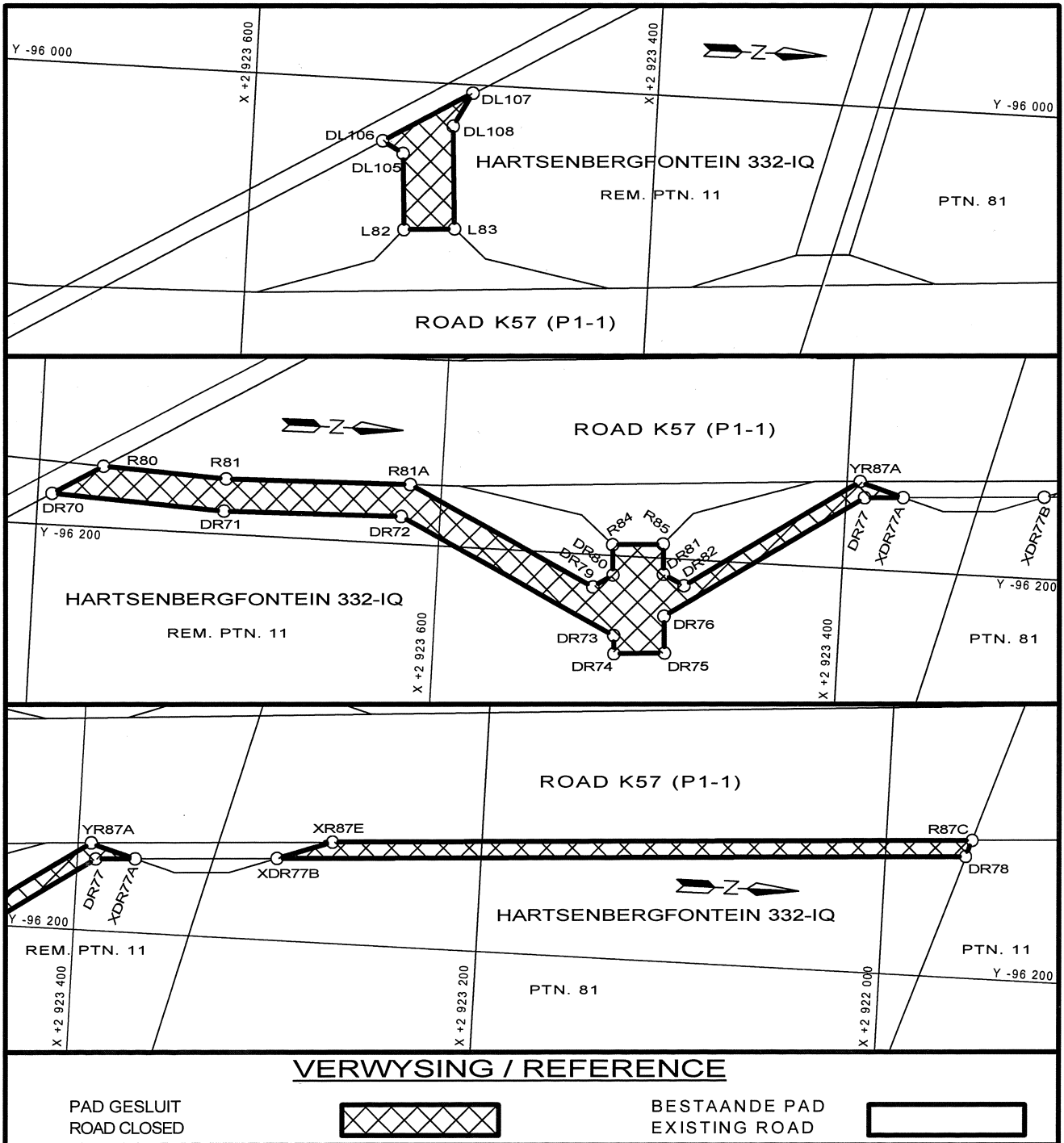

1/2 V1.0



**DIE FIGURE 1** : L82, DL105-DL108, L83, L82.  
**2** : R80,R81, R81A, DR79, DR80, R84, R85, DR81, DR82, YR87A, XDR77A, DR77-DR70, R80.  
**3** : XR87E, R87C, DR78, XDR77B, XR87E.  
 VERTEENWOORDIG DIE SLUITING VAN TOEGANGSPAARIE IN VERBAND MET PROVINSIALE PAD K57(P1-1) OOR GEDEELTE 81 & RESTANT GEDEELTE 11 VAN DIE PLAAS HARTSENBERGFONTEIN 332-IQ SOOS BEDOEL BY AFKONDIGING DAARVAN IN DIE PROVINSIALE KOERANT EN IN DETAIL GETOON OP PLAN PRS 78/202/19V(2)

**THE FIGURES 1** : L82, DL105-DL108, L83, L82.  
**2** : R80,R81, R81A, DR79, DR80, R84, R85, DR81, DR82, YR87A, XDR77A, DR77-DR70, R80.  
**3** : XR87E, R87C, DR78, XDR77B, XR87E.  
 REPRESENTS THE CLOSURE OF ACCESS ROADS IN CONNECTION WITH PROVINCIAL ROAD K57(P1-1) OVER PORTION 81 & REMAINDER OF PORTION 11 OF THE FARM HARTSENBERGFONTEIN 332-IQ AS INTENDED BY PUBLICATION THEREOF IN THE PROVINCIAL GAZETTE AND SHOWN IN DETAIL ON PLAN PRS 78/202/19V(2)

BUNDEL NR. / FILE NO. 2/1/1/2/3/1-P1-1

**KOÖRDINATE LYS / CO-ORDINATE LIST Lo 27° KONST. / CONST. Y = ± 0.000 X = +2 900 000.000**

L82	-96 072.96	+23 522.08	DL105	-96 035.56	+23 524.62	DR76	-96 228.69	+23 486.43
L83	-96 071.27	+23 497.13	DL106	-96 029.89	+23 535.03	DR77	-96 164.52	+23 390.90
R80	-96 166.19	+23 841.03	DL107	-96 003.91	+23 491.69	DR78	-96 139.59	+22 960.24
R81	-96 172.61	+23 707.47	DL108	-96 020.89	+23 500.56	DR79	-96 216.09	+23 522.37
R81A	-96 170.37	+23 615.64	DR70	-96 148.51	+23 792.96	DR80	-96 209.65	+23 512.78
R84	-96 194.68	+23 513.80	DR71	-96 188.60	+23 707.62	DR81	-96 207.95	+23 487.84
R85	-96 192.98	+23 488.86	DR72	-96 186.45	+23 619.18	DR82	-96 213.03	+23 477.47
R87C	-96 131.42	+22 957.53	DR73	-96 239.60	+23 510.75	XDR77A	-96 163.41	+23 371.64
XR87E	-96 148.35	+23 274.75	DR74	-96 248.56	+23 510.14	XDR77B	-96 159.48	+23 303.76
YR87A	-96 156.86	+23 393.85	DR75	-96 246.86	+23 485.19			

2/2 V1.0

**NOTICE 2515 OF 2013****PROCLAMATION OF ACCESS ROADS IN CONNECTION WITH PROVINCIAL ROAD P1-1  
DISTRICT VEREENIGING**

In terms of section 13(1) of the Gauteng Transport Infrastructure Act, 2001 (Act No. 8 of 2001) ("the Act") the MEC proclaims that access roads exist on the land as described and indicated by the figures on the accompanying sketch plan.

In terms of section 23(6) of the aforementioned act it is hereby stated that boundary beacons demarcating the said access roads, have been placed and that plan PRS78/202/19V(2) indicating the land encroached upon by virtue of the proclamation of the access roads, are available for inspection by any interested person in the Plan Room of the Department of Roads and Transport, Sage Life Building, 41 Simmonds Street, Johannesburg.

**Reference: 2/1/1/2/3/1-P1-1**

**MEC Resolution 010 Dated 01 August 2013**

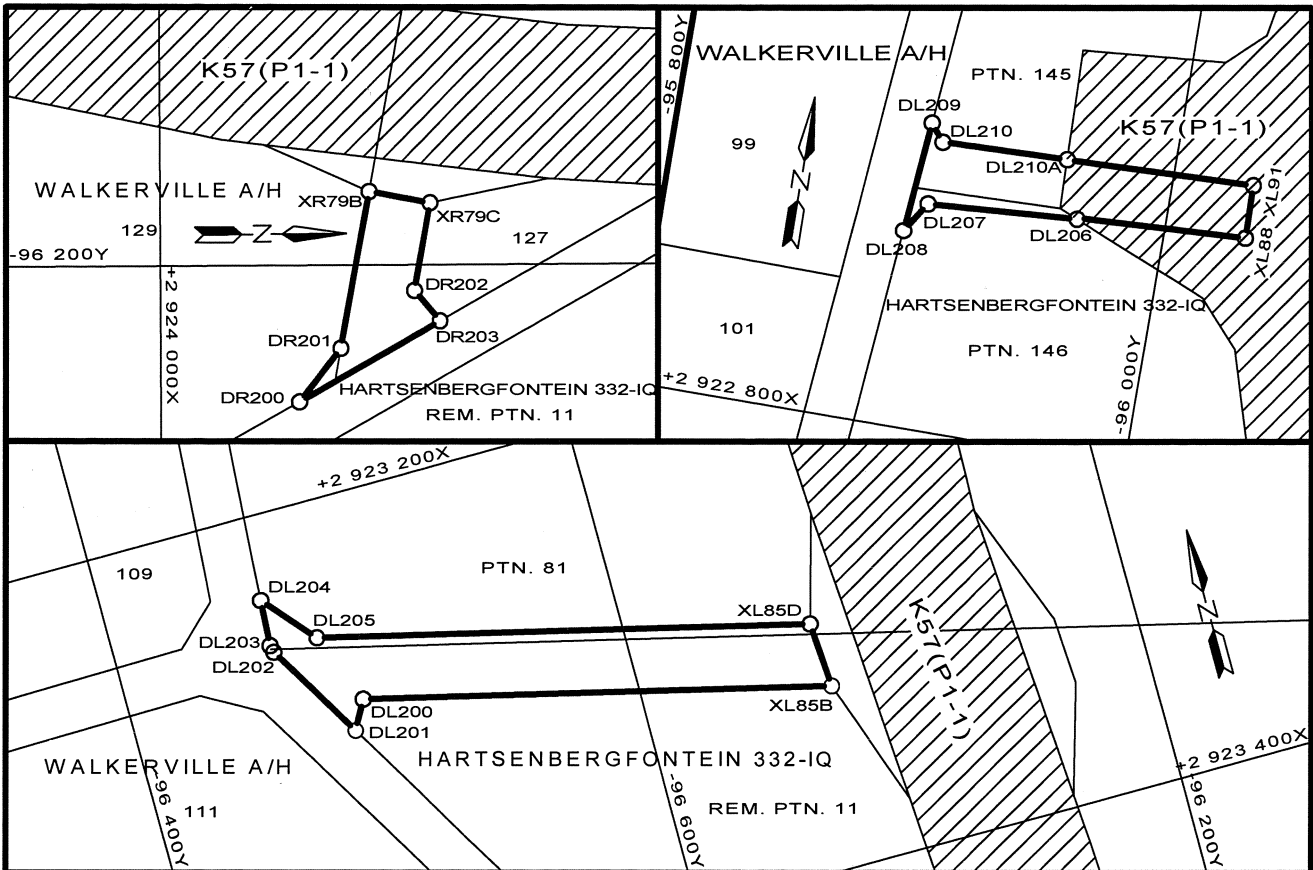

**VERWYSING / REFERENCE**

TOEGANGSPAARIE GEPROKLAEMEER  
ACCESS ROADS PROCLAIMED

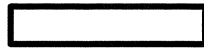

BESTAANDE PAD  
EXISTING ROAD



DIE FIGURE 1 : XR79B, XR79C, DR202, DR203, DR200, DR201, XR79B.  
 2 : XL85B, DL200-DL205, XL85D, XL85B.  
 3 : XL88, DL206-DL210, DL210A, XL91, XL88.  
 VERTEENWOORDIG DIE PROKLAMASIE VAN TOEGANGSPAARIE IN VERBAND MET PROVINSIALE PAD K57(P1-1) OOR HOEWES 127 & 129 VAN WALKERVILLE L/H EN GEDEELTES 81, 145 & 146 EN RESTANT GEDEELTE 11 VAN DIE PLAAS HARTSENBERGFONTEIN 332-IQ SOOS BEDOEL BY AFKONDIGING DAARVAN IN DIE PROVINSIALE KOERANT EN IN DETAIL GETOON OP PLAN PRS 78/202/19V(2)

THE FIGURES 1 : XR79B, XR79C, DR202, DR203, DR200, DR201, XR79B.  
 2 : XL85B, DL200-DL205, XL85D, XL85B.  
 3 : XL88, DL206-DL210, DL210A, XL91, XL88.  
 REPRESENTS THE PROCLAMATION OF ACCESS ROADS IN CONNECTION WITH PROVINCIAL ROAD K57(P1-1) OVER HOLDINGS 127 & 129 OF WALKERVILLE A/H AND PORTIONS 81, 145 & 146 AND REMAINDER OF PORTION 11 OF THE FARM HARTSENBERGFONTEIN 332-IQ AS INTENDED BY PUBLICATION THEREOF IN THE PROVINCIAL GAZETTE AND SHOWN IN DETAIL ON PLAN PRS 78/202/19V(2)

BUNDEL NR. / FILE NO. 2/1/1/2/3/1-P1-1

**KOÖRDINATE LYS / CO-ORDINATE LIST Lo 27° KONST. / CONST. Y = ± 0.000 X = +2 900 000.000**

XL85B -96 074.86 +23 327.24	DL202 -95 862.23 +23 254.89	DL209 -95 901.29 +22 677.96
XL85D -96 073.07 +23 301.01	DL203 -95 861.57 +23 252.10	DL210 -95 906.77 +22 684.81
XL88 -96 032.18 +22 701.34	DL204 -95 862.91 +23 232.33	DL210A -95 956.66 +22 681.42
XL91 -96 030.49 +22 676.40	DL205 -95 880.37 +23 252.60	DR200 -96 257.59 +23 945.13
XR79B -96 169.86 +23 915.52	DL206 -95 964.57 +22 705.94	DR201 -96 234.29 +23 927.54
XR79C -96 175.34 +23 891.60	DL207 -95 905.11 +22 709.98	DR202 -96 210.28 +23 898.13
DL200 -95 891.84 +23 281.25	DL208 -95 897.28 +22 722.14	DR203 -96 222.41 +23 887.68
DL201 -95 884.69 +23 292.35		

1/1 V1.1

**NOTICE 2516 OF 2013****NOTICE OF PROPOSED DEPROCLAMATION OF THREE PORTIONS OF PROVINCIAL ROAD 1455: DISTRICT JOHANNESBURG**

It is hereby notified for general information that an application was received to deproclaim three portions of provincial road 1455, proclaimed by administrator's notices 168, 169 and 170 of 22 February 1967, accompanying this notice.

Interested and affected parties are hereby notified of the opportunity to submit comments and objections with regard to the proposed deproclamation within 30 days of the date of publication of this notice to the following address: Head: Department of Public Transport, Roads and Works, Private Bag X83, Marshalltown, 2107; for attention Director Design.

**Reference: 2/1/1/2/3/1 –1455**

Administrateurskennisgewing No. 170.] [22 Februarie 1967.  
**OPENING.—OPENBARE PAD, DISTRIK  
 JOHANNESBURG.**

Dit word hiermee vir algemene inligting bekendgemaak dat die Administrateur, na ondersoek en verslag deur die Padraad van Johannesburg, ingevolge paragrawe (b) en (c) van subartikel (1) van artikel vyf en artikel drie van die Padordonnansie, 1957 (Ordonnansie No. 22 van 1957), goedgekeur het dat 'n openbare distrik pad, 80 Kaapse voet breed, oor die plaas Rietvallei No. 538—J.Q., distrik Johannesburg, sal bestaan soos op die bygaande sketsplan aangetoon. D.P. 021-025-23/22/1027 (e).

Administrator's Notice No. 170.] [22 February 1967.  
**OPENING.—PUBLIC ROAD, DISTRICT OF  
 JOHANNESBURG.**

It is hereby notified for general information that the Administrator has approved, after investigation and report by the Road Board of Johannesburg, in terms of paragraphs (b) and (c) of subsection (1) of section five and section three of the Roads Ordinance, 1957 (Ordinance No. 22 of 1957), that a public district road, 80 Cape feet wide, traversing the farm Rietvallei No. 538—J.Q., District of Johannesburg, shall exist as indicated on the subjoined sketch plan. D.P. 021-025-23/22/1027 (e).

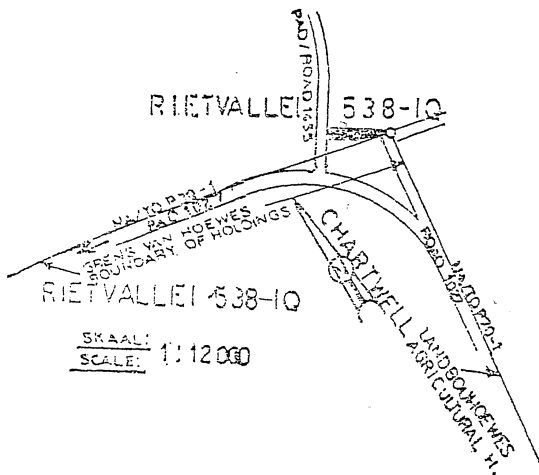

D.P. 021-025 - 23/22/1027 (e)

<u>VERWYSING</u>	<u>REFERENCE</u>
<u>PAD TOT 'N OPENBARE.</u>	<u>ROAD AS A PUBLIC ROAD</u>
<u>PAD VERKLAAR, 80 KVT. BREED</u>	<u>DECLARED, 80 CFT. WIDE</u>
<u>BESTAANDE PAALE</u>	<u>EXISTING ROADS</u>

Administrateurskennisgewing No. 169.] [22 Februarie 1967.  
 OPENING.—OPENBARE PAD, CHARTWELL  
 LANDBOUHOEWES, DISTRIK JOHANNES-  
 BURG.

Dit word hiermee vir algemene inligting bekendgemaak dat die Administrateur, ingevolge paragraaf (c) van subartikel (1) en paragraaf (b) van subartikel (2) van artikel vyf en artikel drie van die Padordonnansie, 1957 (Ordonnansie No. 22 van 1957), goedgekeur het dat Distrikspad No. 1455, 80 Kaapse voet breed, sal bestaan binne die Chartwell-landbouhoewes, distrik Johannesburg, soos aangetoon op bygaande sketplan.

D.P. 021-025-23-22/1027 (d).

Administrator's Notice No. 169.] [22 February 1967.  
 OPENING.—PUBLIC ROAD, CHARTWELL AGRI-  
 CULTURAL HOLDINGS, DISTRICT OF JOHAN-  
 NESBURG.

It is hereby notified for general information that the Administrator has approved, in terms of paragraph (c) of subsection (1) and paragraph (b) of subsection (2) of section five and section three of the Roads Ordinance, 1957 (Ordinance No. 22 of 1957), that District Road No. 1455, 80 Cape feet wide, shall exist within the Chartwell Agricultural Holdings, District of Johannesburg, as indicated on the sketch plan subjoined hereto.

D.P. 021-025-23/22/1027 (d).

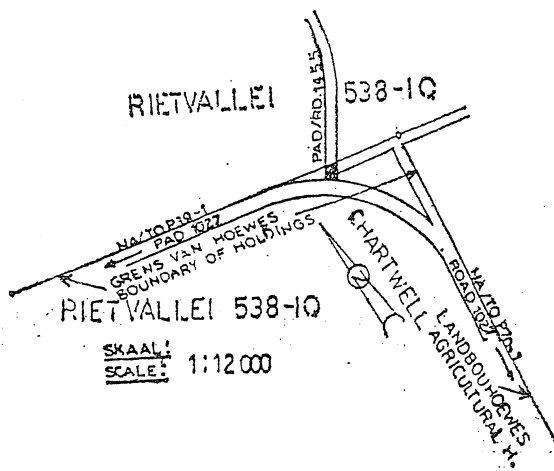

D.P. 021-025-23/22/1027 (d)

VERWYSING	REFERENCE
<u>PAD GEOPEN 80K.VT. BREED</u>	<u>ROAD OPENED 80C.FT. WIDE</u>
<u>BESTAANDE PAAIE</u>	<u>EXISTING ROAD</u>

Administrateurskennisgewing No. 168.] [22 Februarie 1967.  
 VERLEGGING.—OPENBARE PAD, DISTRIK  
 JOHANNESBURG.

Administrator's Notice No. 168.] [22 February 1967.  
 DEVIATION.—PUBLIC ROAD, DISTRICT OF  
 JOHANNESBURG.

Dit word hiermee vir algemene inligting bekendgemaak die Administrateur, na ondersoek en verslag deur die Padraad van Johannesburg, ingevolge paragraaf (d) van subartikel (1) van artikel vyf en artikel drie van die Padordonnansie, 1957 (Ordonnansie No. 22 van 1957), goedgekeur het dat Distrikspad No. 1455, oor die plaas Rietvallei No. 538—J.Q., distrik Johannesburg, verlê en na 80 Kaapse voet verbreed word soos aangetoon op bygaande sketsplan. D.P. 021-025-23/22/1027 (c).

It is hereby notified for general information that the Administrator has approved, after investigation and report by the Road Board of Johannesburg, in terms of paragraph (d) of subsection (1) of section five and section three of the Roads Ordinance, 1957 (Ordinance No. 22 of 1957), that District Road No. 1455, traversing the farm Rietvallei No. 538—J.Q., District of Johannesburg, shall be deviated and widened to 80 Cape feet as indicated on the sketch plan subjoined hereto. D.P. 021-025-23/22/1027 (c).

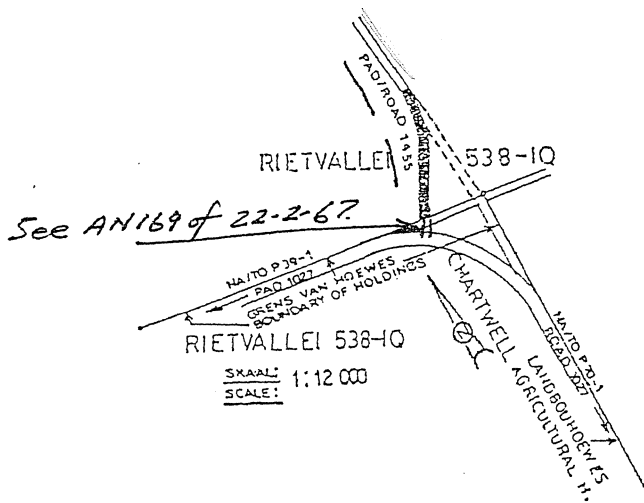

D.P. 021-025-23/22/1027 (c)

VERWYSING

REFERENCE

PAD VERLÊ 20 K.M.T. BREED	ROAD DEVIATED 80 C.F.T. WIDE
BESTAANDE PAAIE	EXISTING ROADS
PAD GESLUIT	ROAD CLOSED

