

***THE PROVINCE OF  
GAUTENG***

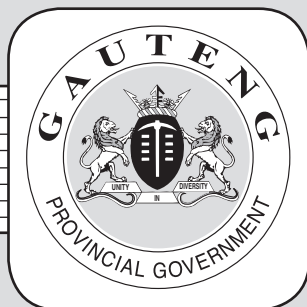

***DIE PROVINSIE VAN  
GAUTENG***

# **Provincial Gazette Provinsiale Koerant**

**EXTRAORDINARY • BUITENGEWOON**

Selling price • Verkoopprys: **R2.50**  
Other countries • Buitelands: **R3.25**

**Vol. 22**

**PRETORIA**  
30 MARCH 2016  
30 MAART 2016

**No. 107**

**We all have the power to prevent AIDS**



**Prevention is the cure**

**AIDS  
HELPLINE**

**0800 012 322**

DEPARTMENT OF HEALTH

**N.B. The Government Printing Works will  
not be held responsible for the quality of  
"Hard Copies" or "Electronic Files"  
submitted for publication purposes**

ISSN 1682-4525



9 771682 452005

00107



# Government Printing Works

## Notice submission deadlines

Government Printing Works has over the last few months implemented rules for completing and submitting the electronic Adobe Forms when you, the customer, submit your notice request.

In line with these business rules, GPW has revised the notice submission deadlines for all gazettes. Please refer to the GPW website [www.gpwonline.co.za](http://www.gpwonline.co.za) to familiarise yourself with the new deadlines.

### CANCELLATIONS

Don't forget!

Cancellation of notice submissions are accepted by GPW according to the deadlines stated in the table above.

Non-compliance to these deadlines will result in your request being failed. **Please pay special attention to the different deadlines for each gazette.**

**Please note that any notices cancelled after the cancellation deadline will be published and charged at full cost.**

Requests for cancellation must be sent by the original sender of the notice and must accompanied by the relevant notice reference number (N-) in the email body.

### AMENDMENTS TO NOTICES

take note!

With effect from 01 October, GPW will not longer accept amendments to notices. The cancellation process will need to be followed and a new notice submitted thereafter for the next available publication date.

### CUSTOMER INQUIRIES



Many of our customers request immediate feedback/confirmation of notice placement in the gazette from our Contact Centre once they have submitted their notice – While GPW deems it one of their highest priorities and responsibilities to provide customers with this requested feedback and the best service at all times, we are only able to do so once we have started processing your notice submission.

GPW has a **2-working day turnaround time for processing notices** received according to the business rules and deadline submissions.

Please keep this in mind when making inquiries about your notice submission at the Contact Centre.

### PROOF OF PAYMENTS



GPW reminds you that all notice submissions **MUST** be submitted with an accompanying proof of payment (PoP) or purchase order (PO). If any PoP's or PO's are received without a notice submission, it will be failed and your notice will not be processed.

When submitting your notice request to [submit.egazette@gpw.gov.za](mailto:submit.egazette@gpw.gov.za), please ensure that a purchase order (GPW Account customer) or proof of payment (non-GPW Account customer) is included with your notice submission. All documentation relating to the notice submission must be in a single email.

A reminder that documents must be attached separately in your email to GPW. (In other words, your email should have an Adobe Form plus proof of payment/purchase order – 2 separate attachments – where notice content is applicable, it should also be a 3rd separate attachment).

### REMINDER OF THE GPW BUSINESS RULES

- ☐ Single notice, single email – with proof of payment or purchase order.
- ☐ All documents must be attached separately in your email to GPW.
- ☐ 1 notice = 1 form, i.e. each notice must be on a separate form
- ☐ Please submit your notice **ONLY ONCE**.
- ☐ Requests for information, quotations and inquiries must be sent to the Contact Centre **ONLY**.
- ☐ The notice information that you send us on the form is what we publish. Please do not put any instructions in the email body.



eGazette



**CONTENTS***Gazette*    *Page*  
*No.*        *No.***PROVINCIAL NOTICES • PROVINSIALE KENNISGEWINGS**

250	Gauteng Transport Infrastructure Act (8/2001): Proclamation of the increase in width of Provincial Road D567: District Pretoria .....	107	4
-----	--	-----	---

---

**PROVINCIAL NOTICES • PROVINSIALE KENNISGEWINGS**

---

**PROVINCIAL NOTICE 250 OF 2016****PROCLAMATION OF THE INCREASE IN WIDTH OF PROVINCIAL ROAD D567:  
DISTRICT PRETORIA**

In terms of sections 11(2) of the Gauteng Transport Infrastructure Act, 2001 (Act No. 8 of 2001) the MEC for Roads and Transport proclaims the increase in width of provincial road D567 as indicated on the accompanying sketch plan.

In terms of section 23 (6) of the aforementioned act, it is hereby declared that boundary beacons demarcating the said increase in width of the above-mentioned provincial road, have been placed on the land and that plans PRS81/116/16V indicating the land encroached upon are available for inspection by any interested person in the Plan Room of the Department of Roads and Transport, Sage Life Building, 41 Simmonds Street, Johannesburg.

Reference: 2/1/1/2/3/1 – D567

MEC Resolution 008 dated 08 December 2015

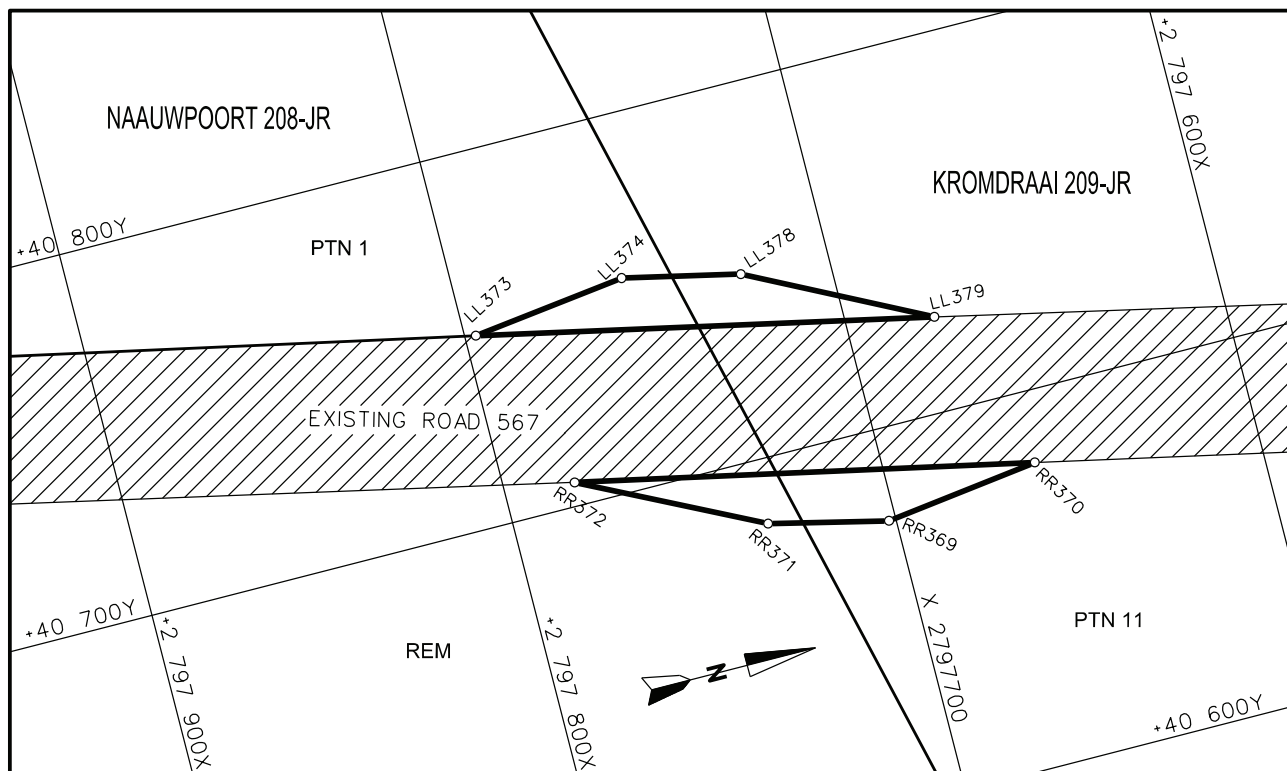

### REFERENCE / VERWYSINGS

PAD GEPROKLAAMEER  
ROAD PROCLAIMED



BESTAANDE PAD  
EXISTING ROAD



DIE FIGUUR : (1) LL373, LL374, LL378, LL379, LL373.  
THE FIGURE : (2) RR372, RR370, RR369, RR371, RR372

VERTEENWOORDIG DIE PROKLAMASIE VAN DIE VERMEERDERING IN BREEDTE VAN PROVINSIALE PAD 567 OOR GEDEELTES 1 EN DIE RESTANT VAN DIE PLAAS NAAUWPOORT 208-JR EN GEDEELTE 11 VAN DIE PLAAS KROMDRAAI 209-JR SOOS BEDOEL BY AFKONDIGING DAARVAN IN DIE PROVINSIALE KOERANT EN IN DETAIL GETOON OP PLAN PRS 81/116/16V.

REPRESENTS THE PROCLAMATION OF THE INCREASE OF WIDTH OF PROVINCIAL ROAD 567 OVER PORTIONS 1 AND THE REMAINDER OF THE FARM NAAUWPOORT 208-JR AND PORTION 11 OF THE FARM KROMDRAAI 209-JR AS INTENDED BY PUBLICATION THEREOF IN THE PROVINCIAL GAZETTE AND SHOWN IN DETAIL ON PLAN PRS 81/116/16V.

BUNDEL NR. / FILE NO. 2/1/1/2/3/1-567

KOÖRDINATE LYS/CO-ORDINATE LIST LO 29° KONST./CONST. Y= +/- 0.00 X= +2 800 000.00

LL373	+40 751.101	+97 797.031	LL379	+40 725.342	+97 676.466	RR370	+40 680.737	+97 660.058
LL374	+40 756.367	+97 755.269				RR371	+40 682.644	+97 733.526
LL378	+40 749.418	+97 723.986	RR369	+40 675.302	+97 701.899	RR372	+40 706.324	+97 781.129

KOÖRDINATE LYS/CO-ORDINATE LIST WG 29° KONST./CONST. Y= +/- 0.00 X= +2 800 000.00

LL373	+40 777.682	+98 093.107	LL379	+40 751.922	+97 972.543	RR370	+40 707.317	+97 956.136
LL374	+40 782.947	+98 051.346				RR371	+40 709.225	+98 029.603
LL378	+40 775.998	+98 020.063	RR369	+40 701.882	+97 997.977	RR372	+40 732.905	+98 077.206

1/1 v1





Printed by the Government Printer, Bosman Street, Private Bag X85, Pretoria, 0001,  
for the **Gauteng Provincial Administration**, Johannesburg.

Contact Centre Tel: 012-748 6200. eMail: [info.egazette@gpw.gov.za](mailto:info.egazette@gpw.gov.za)  
Publications: Tel: (012) 748 6053, 748 6061, 748 6065