



LIMPOPO PROVINCE  
 LIMPOPO PROVINSIE  
 XIFUNDZANKULU XA LIMPOPO  
 PROFENSE YA LIMPOPO  
 VUNDU LA LIMPOPO  
 IPHROVĪNSI YELIMPOPO

**Provincial Gazette • Provinsiale Koerant • Gazete ya Xifundzankulu  
 Kuranta ya Profense • Gazethe ya Vundu**

*(Registered as a newspaper) • (As 'n nuusblad geregistreer)  
 (Yi rhijistariwile tanihi Nyuziphepha)  
 (E ngwadisitšwe bjalo ka Kuranta)  
 (Yo redzhistariwa sa Nyusiphepha)*

**POLOKWANE,**

**Vol. 21**  
**Extraordinary**  
**Ku katsa na Tigazete to**  
**Hlawuleka hinkwato**

31 OCTOBER 2014  
 31 OKTOBER 2014  
 31 NHLANGULA 2014  
 31 OKTOBERE 2014  
 31 TSHIMEDZI 2014

**No. 2436**  
**Buitengewoon**  
**Hu tshi katelwa na**  
**Gazethe dza Nyingo**

**We all have the power to prevent AIDS**

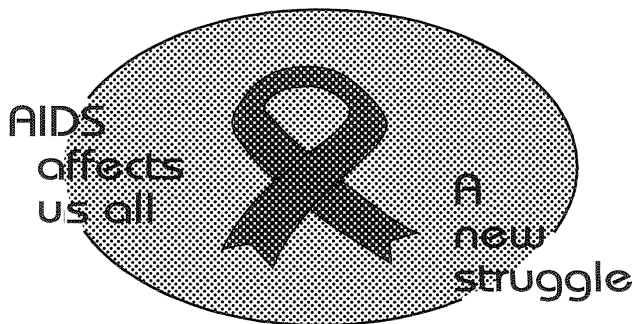

**Prevention is the cure**

**AIDS  
 HELPLINE**

**0800 012 322**

DEPARTMENT OF HEALTH

*N.B. The Government Printing Works will not be held responsible for the quality of "Hard Copies" or "Electronic Files" submitted for publication purposes*



**IMPORTANT NOTICE**

The Government Printing Works will not be held responsible for faxed documents not received due to errors on the fax machine or faxes received which are unclear or incomplete. Please be advised that an "OK" slip, received from a fax machine, will not be accepted as proof that documents were received by the GPW for printing. If documents are faxed to the GPW it will be the sender's responsibility to phone and confirm that the documents were received in good order.

Furthermore the Government Printing Works will also not be held responsible for cancellations and amendments which have not been done on original documents received from clients.

**CONTENTS • INHOUD**

<i>No.</i>	<i>Page No.</i>	<i>Gazette No.</i>
<b>PROVINCIAL NOTICE</b>		
10 National Environmental Management: Protected Areas Act (57/2003): Correction notice: Declaration of various land parcels as nature reserves .....	3	2436

---

**PROVINCIAL NOTICE**

---

No. 10

31 October 2014

**DEPARTMENT OF  
ECONOMIC DEVELOPMENT, ENVIRONMENT & TOURISM**

**CORRECTION OF GOVERNMENT NOTICE NO. 5 PUBLISHED IN THE PROVINCIAL GAZETTE EXTRAORDINARY NO. 2341, VOL. 21, OF 10 APRIL 2014.**

**AND CORRECTION OF GOVERNMENT NOTICE NO 1 PUBLISHED IN THE PROVINCIAL GAZETTE EXTRAORDINARY NO. 2319, VOL. 21, OF 25 FEBRUARY 2014.**

I, Seaparo Sekoati, Member of the Executive Council for Economic Development Environment and Tourism, hereby declare by virtue of the powers vested in me under Section 23(1) (a) (i) of the National Environmental Management: Protected Areas Act, 2003 (Act No. 57 of 2003) hereby wish to correct information in respect of Welgevonden Game Reserve, contained in Government Notice no. 1 published in the Provincial Gazette Extraordinary no. 2319, vol. 21, of 25 February 2014 and of Government Notice no. 5 published in the Provincial Gazette Extraordinary no. 2341, vol.21 of 10 April 2014 as follows:

**SEAPARO SEKOATI, MPL**

**MEC FOR ECONOMIC DEVELOPMENT, ENVIRONMENT AND TOURISM**

- A. THE DEPARTMENT WISHES TO CORRECT NOTICE NO 5 PUBLISHED IN THE PROVINCIAL GAZETTE EXTRAORDINARY NO 2341, VOL 21, OF 10 APRIL 2014 BY THE REPLACEMENT OF THE CONTENT THEREOF WITH THE FOLLOWING:**

**DECLARATION OF VARIOUS LAND PARCLES AS NATURE RESERVES**

I, Seaparo Sekoati, Member of the Executive Council for Economic Development Environment and Tourism, hereby declare by virtue of the powers vested in me under section 23 (1) (a) (i) of the National Environmental Management: Protected Areas Act, 2003 (Act No. 57 of 2003) the properties listed in Schedules 1 to 5 to be nature reserves, to be known as Welgevonden Game Reserve, Luvhondo Nature Reserve, Mokolo Nature Reserve Happy Rest Nature Reserve and Bothasvley Nature Reserve, respectively.

**B. THE DEPARTMENT WISHES TO CORRECT SCHEDULE 1 PUBLISHED IN NOTICE NO 1 OF THE PROVINCIAL GAZETTE NO 2319, VOL 21, OF 25 FEBRUARY 2014 BY THE INCLUSION THEREIN OF THE FOLLOWING PROPERTIES AS ITEMS NO 73 TO 80:**

- 73. The Remaining Extent of the farm WELGEVONDEN NO. 470  
Registration Division KQ, Limpopo Province
- 74. Portion 3 of the farm DUIKERHOEK NO. 225  
Registration Division KQ, Limpopo Province
- 75. Portion 2 of the farm KROMELLENBOOG NO. 203  
Registration Division KQ, Limpopo Province
- 76. Portion 3 of the farm KROMELLENBOOG NO. 203  
Registration Division KQ, Limpopo Province
- 77. Portion 7 of the farm ELANDSHOEK NO. 263  
Registration Division KQ, Limpopo Province
- 78. Portion 2 of the farm GROOTFONTEIN NO. 258  
Registration Division KQ, Limpopo Province
- 79. Portion 3 of the farm GROOTFONTEIN NO. 258  
Registration Division KQ, Limpopo Province
- 80. The farm KLIPPOORT NO. 710  
Registration Division KQ, Limpopo Province

**C. THE DEPARTMENT WISHES TO CORRECT SCHEDULE 1 PUBLISHED IN NOTICE NO 1 OF THE PROVINCIAL GAZETTE EXTRAORDINARY NO 2319, VOL 21, OF 25 FEBRUARY 2014 BY THE FOLLOWING:**

- a. Property No 16 to be deleted and replaced with the following:
  - 16. Portion 70 of the farm WELGEVONDEN NO. 470  
Registration Division KQ, Limpopo Province

- b. Property No 17 to be deleted and replaced with the following:
17. Portion 71 of the farm WELGEVONDEN NO. 470  
Registration Division KQ, Limpopo Province
- c. Property No 32 to be deleted and replaced with the following:
32. Portion 39 of the farm WELGEVONDEN NO. 470  
Registration Division KQ, Limpopo Province
- d. Property No 35 to be deleted and replaced with the following:
35. Portion 42 of the farm WELGEVONDEN NO. 470  
Registration Division KQ, Limpopo Province
- e. Property No 36 to be deleted and replaced with the following:
36. Portion 43 of the farm WELGEVONDEN NO. 470  
Registration Division KQ, Limpopo Province
- f. Property No 37 to be deleted and replaced with the following:
37. Portion 63 of the farm WELGEVONDEN NO. 470  
Registration Division KQ, Limpopo Province
- g. Property No 39 to be deleted and replaced with the following:
39. Portion 64 of the farm WELGEVONDEN NO. 470  
Registration Division KQ, Limpopo Province
- h. Property No 55 to be deleted and replaced with the following:
55. Portion 82 of the farm WELGEVONDEN NO. 470  
Registration Division KQ, Limpopo Province
- i. Property No 56 to be deleted and replaced with the following:
56. Portion 83 of the farm WELGEVONDEN NO. 470  
Registration Division KQ, Limpopo Province

- j. Property No 59 to be deleted and replaced with the following:
59. Portion 92 of the farm WELGEVONDEN NO. 470  
Registration Division KQ, Limpopo Province
- k. Property No 61 to be deleted and replaced with the following:
61. The Remaining Extent of Portion 3 of the farm KOEDOESPOORT NO. 238  
Registration Division KQ, Limpopo Province
- l. Property No 67 to be deleted and replaced with the following:
67. Portion 6 of the farm DUIKERHOEK NO. 225  
Registration Division KQ, Limpopo Province
- m. Property No 68 to be deleted and replaced with the following:
68. Portion 7 of the farm DUIKERHOEK NO. 225  
Registration Division KQ, Limpopo Province
- n. Property No 72 to be deleted and replaced with the following:
72. The Remaining Extent of Portion 5 of the farm ELANDSHOEK NO. 263  
Registration Division KQ, Limpopo Province
- o. The following on page 12 to be deleted:
- The TOTAL area is in extent of 34 830,5817 hectares
- And to be replaced with:
- The TOTAL area is in extent of 34 830,5814 hectares as reflected on Proclamation Diagram herewith.
- p. The diagram as published to be replaced with the following diagram:

PROCLAMATION DIAGRAM

The figure **A B C D E F G H J K L M N P O R S T U V W X Y Z A1 B1 C1 D1 E1 F1 G1 H1 J1 K1  
L1 M1 N1 P1 Q1 R1 S1 T1 U1 V1 W1 X1 Y1 Z1 A2 B2 A**

represents **34 830,5814 hectares** of land being  
a Proclamation area for

**WELGEVONDEN GAME RESERVE**

and comprises the properties as listed in the schedule

Province of Limpopo

Framed for the purposes of declaring a Nature Reserve  
in terms of Section 23(1) of the National Environmental  
Management Protected Areas Act, 57 of 2003  
in March 2013 by me

*A.C. Calogero*  
**A.C. CALOGERO (PLS 1039-D)**  
Professional Land Surveyor

Note:  
All dimensions are approximate pending final survey.

Servitude Notes:  
For Servitude details, see S.G. Diagrams as  
listed in the schedule

**SHEET 1 OF 2 SHEETS**

S.G. No.  
  
Approved  
  
for  
SURVEYOR-  
GENERAL

SIDES Metres	ANGLES OF DIRECTION	CO-ORDINATES Y System: WG 27° X			
		±	0,00	±	0,00
Constants:					
A5	3 157,14	306 03 38	A	-75 662,73	+2 672 741,73
BC	3 125,15	300 32 31	B	-78 214,95	+2 674 600,15
CD	1 430,86	60 26 41	C	-80 906,51	+2 676 188,25
DE	4 375,58	299 11 45	D	-79 661,83	+2 676 894,04
EF	4 867,83	299 15 09	E	-83 481,53	+2 679 028,43
FG	4 899,82	221 07 11	F	-87 728,88	+2 681 407,14
GH	2 471,48	292 47 58	G	-90 984,42	+2 677 575,51
HJ	397,73	8 08 40	H	-83 268,32	+2 678 637,55
JK	4 247,89	41 33 34	J	-93 211,97	+2 679 031,27
KL	1 154,55	286 15 36	K	-90 393,94	+2 682 209,83
LM	2 420,73	9 28 45	L	-91 499,44	+2 682 542,76
MN	2 158,88	4 22 41	M	-91 100,77	+2 684 930,44
NP	2 847,98	298 29 32	N	-90 935,97	+2 687 083,02
PO	5 350,19	343 52 42	P	-93 526,90	+2 688 489,32
OR	2 511,93	109 07 42	Q	-95 012,53	+2 693 629,11
RS	2 036,41	322 11 06	R	-92 639,29	+2 692 806,99
ST	2 999,91	64 58 52	S	-93 588,51	+2 694 907,11
TU	86,99	338 48 40	T	-91 888,82	+2 695 495,21
UV	2 037,70	64 50 23	U	-91 714,21	+2 695 589,52
VW	1 372,18	64 49 24	V	-89 869,84	+2 696 425,85
WX	299,97	90 34 50	W	-88 628,02	+2 697 009,59
XY	485,65	81 32 30	X	-88 328,06	+2 697 006,55
YZ	535,02	81 35 50	Y	-87 847,70	+2 697 077,98
ZA1	480,55	17 42 40	Z	-87 318,42	+2 697 156,16
A1B1	2 235,06	59 42 22	A1	-87 172,24	+2 697 613,94
B1C1	2 246,15	334 27 04	B1	-85 242,38	+2 698 741,38
C1D1	2 186,54	78 08 10	C1	-86 211,10	+2 700 767,90
D1E1	1 156,16	51 35 20	D1	-84 071,27	+2 701 217,42
E1F1	2 784,61	67 57 25	E1	-83 948,88	+2 701 314,41
F1G1	1 804,24	96 05 11	F1	-81 367,81	+2 702 359,48
G1H1	1 877,15	135 58 06	G1	-79 573,75	+2 702 188,18
H1J1	1 873,84	220 15 17	H1	-78 289,02	+2 700 818,59
J1K1	666,03	261 55 00	J1	-79 350,51	+2 699 541,31
K1L1	2 053,13	212 50 19	K1	-80 207,93	+2 699 419,55
L1M1	945,62	168 39 40	L1	-81 321,29	+2 697 694,50
M1N1	468,11	230 22 20	M1	-81 134,57	+2 696 763,42
N1P1	120,53	131 37 30	N1	-81 495,11	+2 696 464,86
P1Q1	180,14	109 12 30	P1	-81 405,01	+2 696 384,80
Q1R1	86,47	112 09 00	Q1	-81 231,90	+2 696 325,53
R1S1	117,61	119 44 40	R1	-81 154,81	+2 696 292,53
S1T1	69,20	127 27 00	S1	-81 052,69	+2 696 234,58
T1U1	1 031,60	46 11 05	T1	-80 997,75	+2 696 192,50
U1V1	3 454,11	135 03 59	U1	-80 293,97	+2 696 906,71
V1W1	6 422,78	175 28 09	V1	-77 813,78	+2 694 481,46
W1X1	4 776,39	142 25 51	W1	-77 306,11	+2 688 058,74
X1Y1	4 576,28	141 51 11	X1	-74 394,15	+2 684 272,89
Y1Z1	3 451,94	232 37 34	Y1	-71 567,48	+2 680 673,97
Z1A2	894,88	90 32 30	Z1	-74 310,70	+2 678 578,59
A2B2	4 835,37	203 00 43	A2	-73 315,87	+2 678 569,19
B2A	1 450,61	198 20 48	B2	-75 206,12	+2 674 116,60
HERANUSDOORNS ONVERDEE STERKSTROOM	54 96 67	Δ Δ Δ		-75 659,71 -87 743,52 -78 521,99	+2 672 742,98 +2 686 655,70 +2 692 298,48

SCHEDULE OF PROPERTIES AFFECTED

Description of Property	Area Hectares	Diagram
1 Welgevonden No. 470-KQ Portion 1	500,0021	A5268/1993
2 Welgevonden No. 470-KQ Portion 2	500,0035	A5269/1993
3 Welgevonden No. 470-KQ Portion 3	500,0000	A5270/1993
4 Welgevonden No. 470-KQ Portion 4	500,3693	A5271/1993
5 Welgevonden No. 470-KQ Portion 5	500,0000	A5272/1993
6 Welgevonden No. 470-KQ Portion 6	500,0003	A5273/1993
7 Welgevonden No. 470-KQ Portion 9	500,0017	A5278/1993
8 Welgevonden No. 470-KQ Portion 10	500,0004	A5277/1993
9 Welgevonden No. 470-KQ Portion 11	500,0001	A5278/1993
10 Welgevonden No. 470-KQ Portion 12	500,0002	A5279/1993
11 Welgevonden No. 470-KQ Portion 13	500,0001	A5280/1993
12 Welgevonden No. 470-KQ Portion 14	500,0003	A5281/1993
13 Welgevonden No. 470-KQ Portion 15	500,0013	A5282/1993
14 Welgevonden No. 470-KQ Portion 16	500,0000	A5283/1993
15 Welgevonden No. 470-KQ Portion 17	500,0008	A5284/1993
16 Welgevonden No. 470-KQ Portion 20	500,0002	A5287/1993
17 Welgevonden No. 470-KQ Portion 21	500,0002	A5288/1993
18 Welgevonden No. 470-KQ Portion 25	500,0002	A5292/1993
19 Welgevonden No. 470-KQ Portion 26	500,0778	A5293/1993
20 Welgevonden No. 470-KQ Portion 27	500,0003	A5294/1993
21 Welgevonden No. 470-KQ Portion 28	500,0002	A5295/1993
22 Welgevonden No. 470-KQ Portion 29	500,0001	A5296/1993
23 Welgevonden No. 470-KQ Portion 31	500,0069	A5298/1993
24 Welgevonden No. 470-KQ Portion 32	500,0005	A5299/1993
25 Welgevonden No. 470-KQ Portion 33	500,0004	A5300/1993
26 Welgevonden No. 470-KQ Portion 34	500,0002	A5301/1993
27 Welgevonden No. 470-KQ Portion 35	500,0000	A5302/1993
28 Welgevonden No. 470-KQ Portion 36	500,0138	A5303/1993
29 Welgevonden No. 470-KQ Portion 37	500,0007	A5304/1993
30 Welgevonden No. 470-KQ Portion 39	500,0000	A5306/1993
31 Welgevonden No. 470-KQ Portion 40	500,0002	A5307/1993
32 Welgevonden No. 470-KQ Portion 41	500,0013	A5308/1993
33 Welgevonden No. 470-KQ Portion 42	500,0003	A5309/1993
34 Welgevonden No. 470-KQ Portion 43	500,0020	A5310/1993
35 Welgevonden No. 470-KQ Portion 45	500,0000	A5312/1993
36 Welgevonden No. 470-KQ Portion 47	500,0010	A5314/1993
37 Welgevonden No. 470-KQ Portion 46	500,0001	A5315/1993
38 Welgevonden No. 470-KQ Portion 49	500,0004	A5316/1993
39 Welgevonden No. 470-KQ Portion 50	500,0001	A5317/1993
40 Welgevonden No. 470-KQ Portion 51	438,5703	A5318/1993
41 Welgevonden No. 470-KQ Portion 52	4,0000	A5319/1993
42 Welgevonden No. 470-KQ Portion 53	2,0000	A5320/1993
43 Welgevonden No. 470-KQ Portion 54	2,0000	A5321/1993
44 Welgevonden No. 470-KQ Portion 55	7,0001	A5322/1993
45 Welgevonden No. 470-KQ Portion 56	2,0000	A5323/1993
46 Welgevonden No. 470-KQ Portion 57	2,0001	A5324/1993
47 Welgevonden No. 470-KQ Portion 58	2,0000	A5325/1993
48 Welgevonden No. 470-KQ Portion 59	20,4469	A5326/1993

SCHEDULE OF PROPERTIES AFFECTED continued ...

Description of Property	Area Hectares	Diagram
49 Welgevonden No. 470-KQ Portion 63	499,9999	7638/1995
50 Welgevonden No. 470-KQ Portion 64	500,0002	7639/1995
51 Welgevonden No. 470-KQ Portion 70	499,9999	10625/1995
52 Welgevonden No. 470-KQ Portion 71	500,0001	10626/1995
53 Welgevonden No. 470-KQ Portion 79	500,0028	1274/1998
54 Welgevonden No. 470-KQ Portion 80	500,0001	1275/1998
55 Welgevonden No. 470-KQ Portion 82	500,0001	1277/1998
56 Welgevonden No. 470-KQ Portion 83	499,9999	1278/1998
57 Welgevonden No. 470-KQ Portion 87	500,0000	11391/1999
58 Welgevonden No. 470-KQ Portion 91	500,0010	8590/2001
59 Welgevonden No. 470-KQ Portion 92	500,0002	8591/2001
60 Welgevonden No. 470-KQ Remainder	14,5308	A5284/1993
61 Klippaaldrift No. 248-KQ Remainder of Portion 1	399,4821	A5025/1954
62 Koedoespoort No. 238-KQ Remainder of Portion 1	492,4771	A2859/1940
63 Koedoespoort No. 238-KQ Portion 3	499,9990	13001/1997
64 Koedoespoort No. 238-KQ Portion 4	499,9999	13002/1997
65 Koedoespoort No. 238-KQ Remainder of Portion 5	499,9995	1263/1998
66 Koedoespoort No. 238-KQ Portion 6	499,9998	1265/1998
67 Koedoespoort No. 238-KQ Portion 8	451,9219	6969/1999
68 Duikerhoek No. 225-KQ Remainder	500,6783	8/1897
69 Duikerhoek No. 225-KQ Portion 3	139,5474	4103/1998
70 Duikerhoek No. 225-KQ Portion 6	500,0010	7045/2000
71 Duikerhoek No. 225-KQ Portion 7	500,0006	7046/2000
72 Kromellenboog No. 203-KQ Remainder	471,0753	1889/1893
73 Kromellenboog No. 203-KQ Remainder of Portion 1	470,1888	A5896/1959
74 Kromellenboog No. 203-KQ Portion 2	489,3869	2889/2005
75 Kromellenboog No. 203-KQ Portion 3	470,2733	2890/2005
76 Elandsheek No. 263-KQ Remainder of Portion 5	540,0894	A4884/1994
77 Elandsheek No. 263-KQ Portion 7	500,6847	493/2009
78 Grootfontein No. 258-KQ Portion 2	478,4622	420/2010
79 Grootfontein No. 258-KQ Portion 3	474,8187	421/2010
80 Klippoort No. 710-KQ	478,4565	424/2010

This diagram is annexed to  
No. :  
S.G. :  
T.F.S. :  
Registered of Deeds: Pretoria

The original diagram is:  
S.G. No. :  
Transfer  
Grant:

File  
S.R. :  
Comp. :

PROCLAMATION DIAGRAM

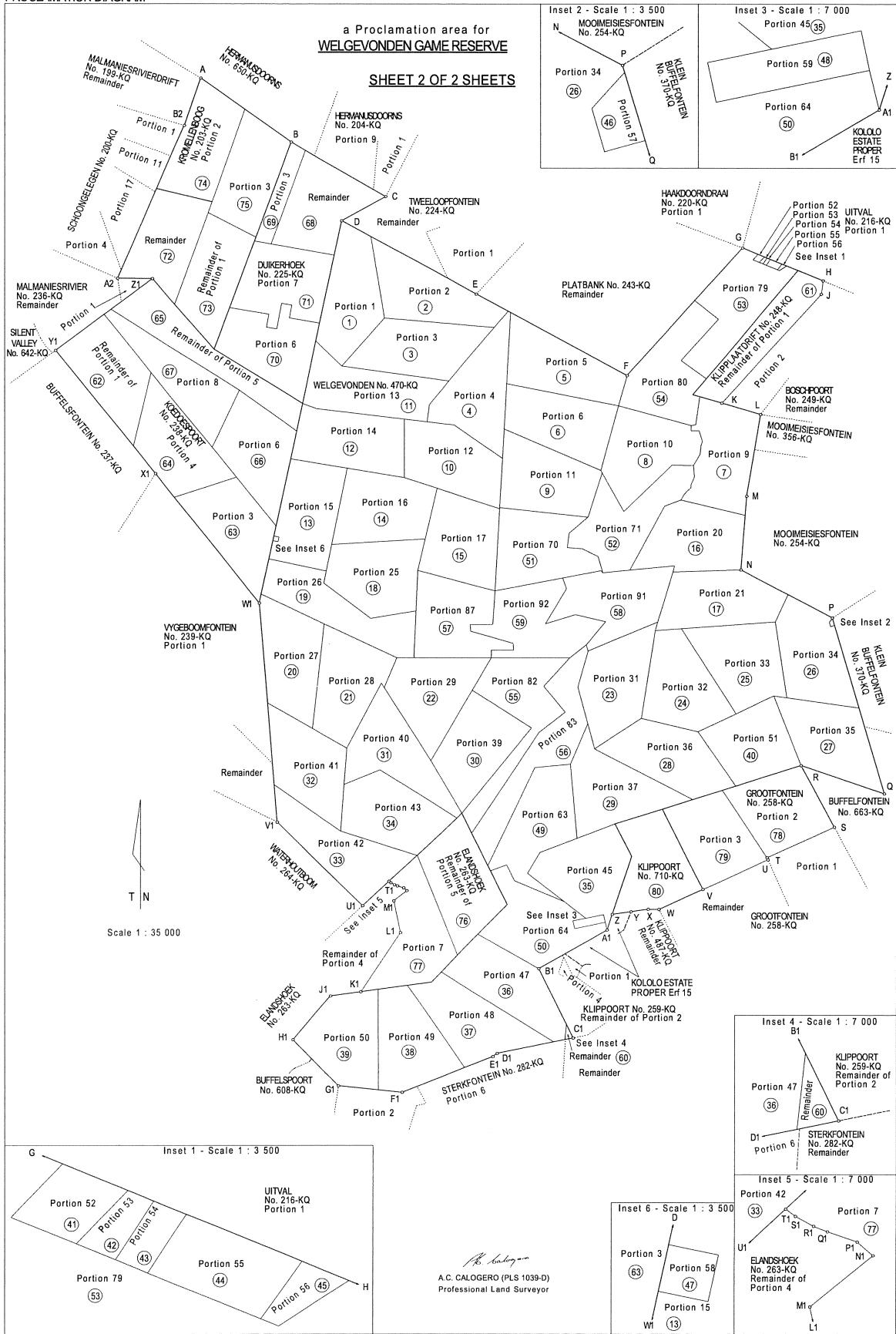

Printed by and obtainable from the Government Printer, Bosman Street, Private Bag X85, Pretoria, 0001. Tel: (012) 748 6052, 748 6053, 748 6058  
 Also available at **The Provincial Administration: Limpopo Province**, Private Bag X9483, Office of the Premier, 26 Bodenstein Street, Pietersburg, 0699. Tel. (015) 291-3910  
 Gedruk deur en verkrygbaar by die Staatsdrukker, Bosmanstraat, Privaat Sak X85, Pretoria, 0001. Tel: (012) 748 6052, 748 6053, 748 6058  
 Ook verkrygbaar by **Die Provinsiale Administrasie: Limpopo Provinsie**, Privaat Sak X9483, Kantoor van die Premier, Bodensteinstraat 26, Pietersburg, 0699. Tel. (015) 291-3910