



LIMPOPO PROVINCE  
 LIMPOPO PROVINSIE  
 XIFUNDZANKULU XA LIMPOPO  
 PROFENSE YA LIMPOPO  
 VUNDU LA LIMPOPO  
 IPHROVĪNSI YELIMPOPO

**Provincial Gazette • Provinsiale Koerant • Gazete ya Xifundzankulu  
 Kuranta ya Profense • Gazethe ya Vundu**

*(Registered as a newspaper) • (As 'n nuusblad geregistreer)*  
*(Yi rhijistariwile tanihi Nyuziphepha)*  
*(E ngwadisitšwe bjalo ka Kuranta)*  
*(Yo redzhistariwa sa Nyusiphepha)*

**Vol. 22**  
**Extraordinary**  
**Ku katsa na Tigazete to**  
**Hlawuleka hinkwato**

20 MARCH 2015  
 20 MAART 2015  
 20 NYENYANKULU 2015  
 20 MATŠHE 2015  
 20 THAFAMUHWÉ 2015

**No. 2488**  
**Buitengewoon**  
**Hu tshi katelwa na**  
**Gazethe dza Nyingo**

**We all have the power to prevent AIDS**

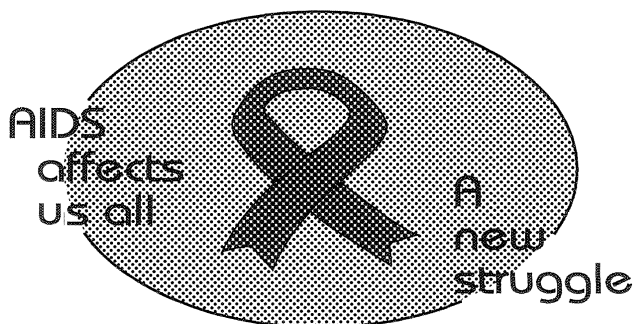

**AIDS  
 HELPLINE**

**0800 012 322**

DEPARTMENT OF HEALTH

**Prevention is the cure**

*N.B. The Government Printing Works will not be held responsible for the quality of "Hard Copies" or "Electronic Files" submitted for publication purposes*



**IMPORTANT NOTICE**

The Government Printing Works will not be held responsible for faxed documents not received due to errors on the fax machine or faxes received which are unclear or incomplete. Please be advised that an "OK" slip, received from a fax machine, will not be accepted as proof that documents were received by the GPW for printing. If documents are faxed to the GPW it will be the sender's responsibility to phone and confirm that the documents were received in good order.

Furthermore the Government Printing Works will also not be held responsible for cancellations and amendments which have not been done on original documents received from clients.

---

**CONTENTS • INHOUD***No.**Page  
No.      Gazette  
            No.***GENERAL NOTICE**

83	National Environmental Management: Protected Areas Act (57/2003): Declaration of attached respective land parcels as nature reserves in terms of the Act .....	3	2488
----	--	---	------

---

---

## GENERAL NOTICE

---

### GENERAL NOTICE 83 OF 2015

#### DEPARTMENT OF

#### ECONOMIC DEVELOPMENT, ENVIRONMENT & TOURISM

#### LIMPOPO PROVINCIAL GOVERNMENT

#### DEPARTMENT OF ECONOMIC DEVELOPMENT, ENVIRONMENT AND TOURISM

NO. 12/6/9

MARCH 2015

NATIONAL ENVIRONMENTAL MANAGEMENT: PROTECTED AREAS ACT, 2003

(ACT NO. 57 OF 2003)

**DECLARATION OF ATTACHED RESPECTIVE LAND PARCELS AS NATURE RESERVES IN TERMS OF THE NATIONAL ENVIRONMENTAL MANAGEMENT: PROTECTED AREAS ACT, 2003(ACT NO 57 OF 2003)**

I, Seaparo Sekoati, Member of the Executive Council for Economic Development Environment and Tourism, hereby declare by virtue of the power vested in me under section 23(1) of the National Environmental Management: Protected Areas Act, 2003(Act no 57 of 2003) respective land parcels, as listed in the attached schedules, as declared nature reserves.

**Hon. Seaparo Sekoati, MPL**

**MEC: Economic Development, Environment and Tourism**

#### **Schedule 1 Details of the area declared as a Leopard Cave Safaris Nature Reserve**

1. Portion 6 of the farm Buffelshoek No. 446 – KQ
2. Remainder of portion 9 of the farm Buffelshoek No. 446 – KQ
3. Portion 10 of the farm Buffelshoek No. 446 – KQ
4. Portion 11 of the farm Buffelshoek No. 446 – KQ
5. Portion 12 of the farm Buffelshoek No. 446 – KQ
6. Portion 13 of the farm Buffelshoek No. 446 – KQ
7. Portion 14 of the farm Buffelshoek No. 446 – KQ

---

Evruidiki Towers, 20 Hans van Rensburg Street, POLOKWANE, 0700, Private Bag X9484, POLOKWANE, 0700  
Tel: 015 293 8300, Fax: 086 597 6071, website: <http://www.Limpopo.gov.za>

8. Portion 15 of the farm Buffelshoek No. 446 – KQ
9. Portion 16 of the farm Buffelshoek No. 446 – KQ
10. Portion 17 of the farm Buffelshoek No. 446 – KQ
11. Portion 18 of the farm Buffelshoek No. 446 – KQ
12. Portion 19 of the farm Buffelshoek No. 446 – KQ
13. Portion 20 of the farm Buffelshoek No. 446 – KQ
14. Portion 21 of the farm Buffelshoek No. 446 – KQ
15. Portion 23 of the farm Buffelshoek No. 446 – KQ
16. The farm Dassiesrand No. 447 – KQ
17. Portin 6 of the farm Dankerpoort No. 448 – KQ
18. The farm Leopard Cave No. 715 – KQ

### **Schedule 3 Details of the area declared as Olifants River Nature Reserve**

1. Portion 2 of Lisbon 37 KU

PROCLAMATION DIAGRAM

REGISTRATION COPY

LEOPARD CAFE SAFARIS NATURE RESERVE

Sheet 3 of 3 Sheets

Scale 1:75000

S.G. No.

401/2014

Approved

for  
SURVEYOR-  
GENERAL

2014.05.29

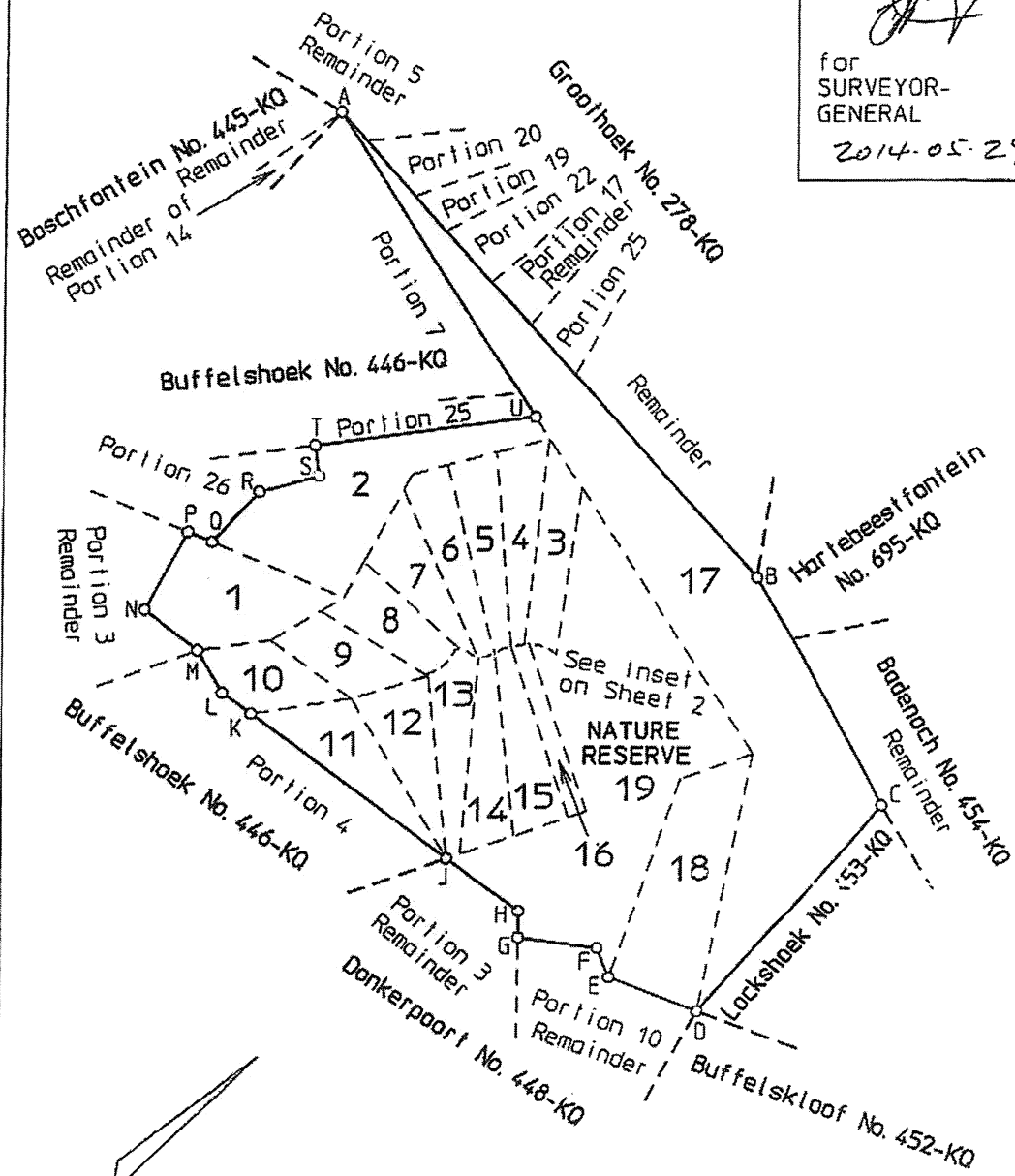

Framed in terms of Section 16 of the Land Survey Act, Act 8 of 1997 for Proclamation Purposes in terms of Section 23(1) of the National Environmental Management: Protected Areas Act, Act No. 57 of 2003, by me in March 2014.

J. J. SNYMAN (PLS 1043)  
Professional Land Surveyor

JJ Snyman Tel. 082 824 7311

Bemetrying van Bakens:

- A. Gemesselde bakens 3' hoog.
- B, C. Halwe ysterpaal onder klipstapel.
- X. 1/2 x 18 mm ysterpen in klipstapel op rotakoppie.
- D. Halwe ysterpaal in klipstapel teenaan voet van boom.

SYE Kaapse Voet	RIGTINGS- HOEKE	KO-ORDINATE	
		Stelsel L <sup>a</sup> 31.	Konstant X
		Y	X
		±	±
		0.0	860000.0
A-B	13747.6	292.19.32	A - 20497.2 + 79651.8
B-C	20977.1	51.38.42	B - 33214.3 + 84874.1
C-A	18617.3	191.32.59	C - 16764.4 + 97891.0
C-B	802.4	51.38.42	X - 16135.2 + 98388.9
D-B	1916.4	51.38.42	D - 247171 + 83684.9

L.G. No. A. 6011/55

Goedgekeur

*[Signature]*  
Landmeter-generaal

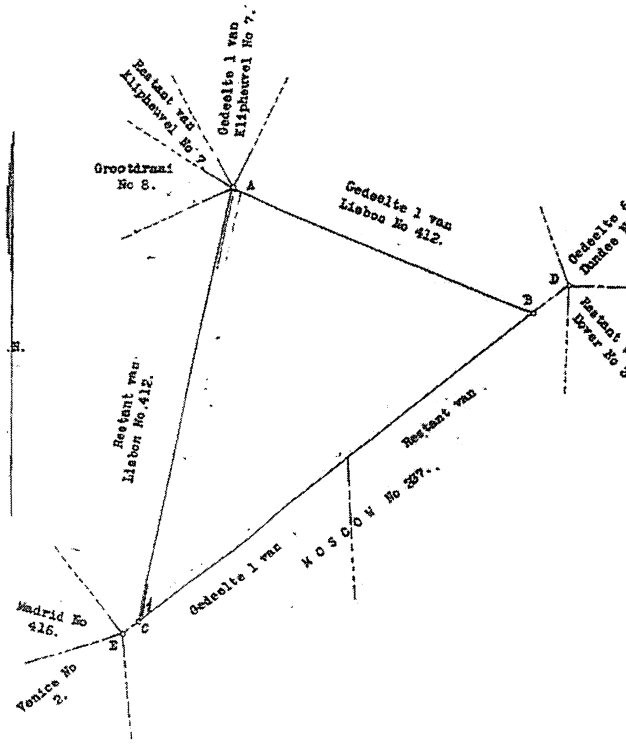

Van geregisreer of  
Nou geregisreer ons  
No. 31  
REGISTRAR-GENERAAL  
PROVINSIE OORANGE-VOORSTAD

Skaal 1:50000.

Morge grond synde

Die figuur A B C  
Stel voor 1455.1133

Gedeelte 2  
van die Plaas  
LISBON No 412.

geleë in Distrik PILGRIMSREEST

Transvaal.  
Provinsie Orange-Vorstad.

Gemeet in Julie 1955

deur my

*[Signature]*

Landmeter.

Hierdie kaart is geheg aan No. 753/97 ten punste van 18456/82 Registrateur van Aktes. 28. 239/18	Die oorspronklike kaart is No. 753/97 geheg aan Grondboek m. 5303 10/4/1870 Ooster Lande	L.G. Omslag No. 6499/1870 Meestukke No. 2058/55 Kommissie KU-1 Landkaart Sekste Suider Bruechte Ooster Lande Alho-5658
---	--	--



# IMPORTANT Reminder from Government Printing Works

Dear Valued Customers,

As part of our preparation for eGazette Go Live on 9 March 2015, we will be suspending the following existing email addresses and fax numbers from **Friday, 6 February**.

Discontinued Email addresses	Discontinued Fax numbers
<a href="mailto:GovGazette&amp;LiquorLicense@gpw.gov.za">GovGazette&amp;LiquorLicense@gpw.gov.za</a>	+27 12 334 5842
<a href="mailto:Estates@gpw.gov.za">Estates@gpw.gov.za</a>	+27 12 334 5840
<a href="mailto:LegalGazette@gpw.gov.za">LegalGazette@gpw.gov.za</a>	+27 12 334 5819
<a href="mailto:ProvincialGazetteGauteng@gpw.gov.za">ProvincialGazetteGauteng@gpw.gov.za</a>	+27 12 334 5841
<a href="mailto:ProvincialGazetteECLPMPNW@gpw.gov.za">ProvincialGazetteECLPMPNW@gpw.gov.za</a>	+27 12 334 5839
<a href="mailto:ProvincialGazetteNCKZN@gpw.gov.za">ProvincialGazetteNCKZN@gpw.gov.za</a>	+27 12 334 5837
<a href="mailto:TenderBulletin@gpw.gov.za">TenderBulletin@gpw.gov.za</a>	+27 12 334 5830

To submit your notice request, please send your email (with Adobe notice form and proof of payment to [submit.egazette@gpw.gov.za](mailto:submit.egazette@gpw.gov.za) or fax +27 12-748 6030.

Notice requests not received in this mailbox, will **NOT** be processed.

Please **DO NOT** submit notice requests directly to your contact person's private email address at GPW – Notice requests received in this manner will also **NOT** be processed.

GPW does not accept responsibility for notice requests submitted through the discontinued channels as well as for the quality and accuracy of information, or incorrectly captured information and will not amend information supplied.

Thank you!

For any queries, please contact the eGazette Contact Centre.



[info.egazette@gpw.gov.za](mailto:info.egazette@gpw.gov.za) (only for queries).

Notice requests received in this mailbox will **NOT** be processed.



012-748 6200



eGazette



Printed by and obtainable from the Government Printer, Bosman Street, Private Bag X85, Pretoria, 0001. Tel: (012) 748 6052, 748 6053, 748 6058  
 Also available at **The Provincial Administration: Limpopo Province**, Private Bag X9483, Office of the Premier, 26 Bodenstein Street, Pietersburg, 0699. Tel. (015) 291-3910  
 Gedruk deur en verkrygbaar by die Staatsdrukker, Bosmanstraat, Privaat Sak X85, Pretoria, 0001. Tel: (012) 748 6052, 748 6053, 748 6058  
 Ook verkrygbaar by **Die Provinsiale Administrasie: Limpopo Provinsie**, Privaat Sak X9483, Kantoor van die Premier, Bodensteinstraat 26, Pietersburg, 0699. Tel. (015) 291-3910