

THE PROVINCE OF MPUMALANGA
DIE PROVINSIE MPUMALANGA

**Provincial Gazette Extraordinary
Buitengewone Provinsiale Koerant**

(Registered as a newspaper) • (As 'n nuusblad geregistreer)

Vol. 16

NELSPRUIT, 28 JANUARY
JANUARIE 2009

No. 1611

CONTENTS • INHOUD

<i>No.</i>		<i>Page No.</i>	<i>Gazette No.</i>
GENERAL NOTICE			
20	Roads Ordinance (22/1957): Deviation of a portion of Provincial Road D1725 on the farm Vlaaklagte 21 IS, Emalahleni District.....	2	1611

GENERAL NOTICE**NOTICE 20 OF 2009****DEPARTMENT OF ROADS AND TRANSPORT
MPUMALANGA PROVINCE****DEVIATION OF A PORTION OF PROVINCIAL ROAD D 1725 ON THE FARM
VLAAKLAGTE 21 – IS: EMALAHLENI DISTRICT**

In terms of sections 3 and 5 of the Roads Ordinance, 1957 (Ordinance 22 of 1957), the Member of the Executive Council responsible for Roads and Transport: Mpumalanga, hereby deviate a portion of District Road D 1725 on the farm Vlaklaagte 21 – IS as indicated on the subjoined sketches which also indicates the general direction and situation of the said, deviation.

In terms of section 5A (3) of the said Ordinance, it is hereby declared that the land taken up by the said road is physically demarcated and the plans indicating the land taken up by the said road, are available for inspection by any interested person, at the office of the Senior Manager: Design & Material, Chief Directorate: Roads, Riverside Provincial Government Building in Nelspruit.

APPROVAL : 29 October 2008
REFERENCE : F09/11/2/2 – D 1725

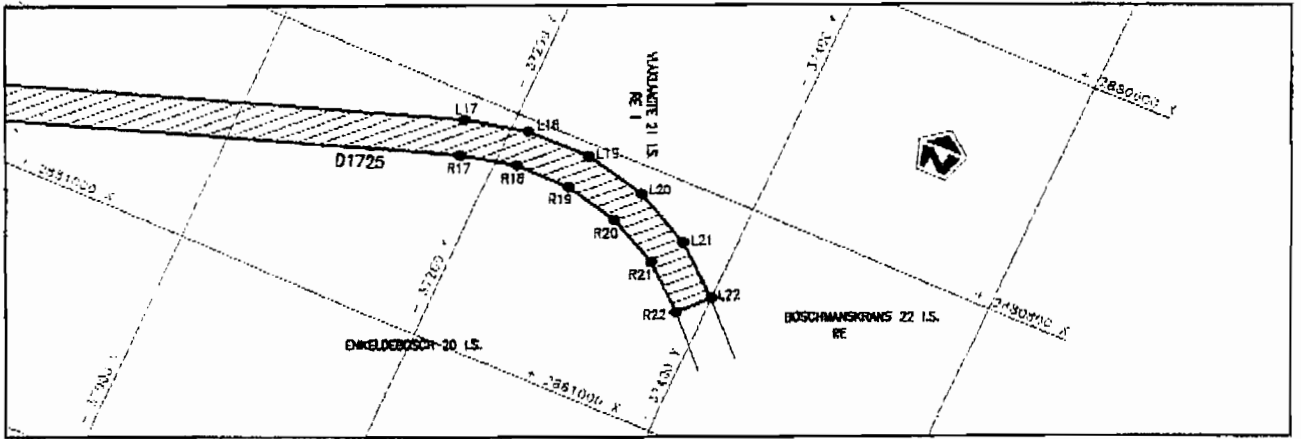

SHEET 4

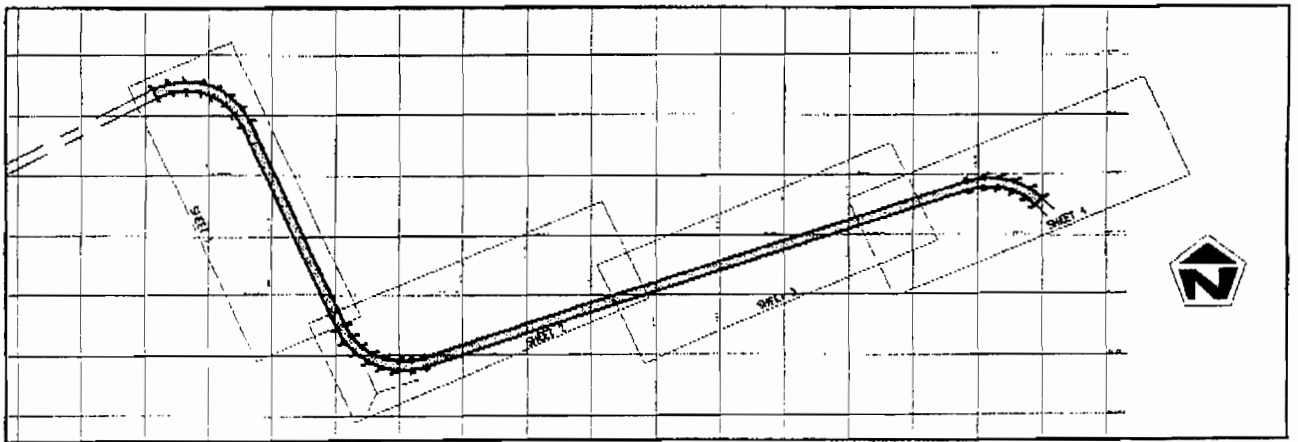

KEY PLAN

COORDINATE LIST: WGS 1984

POINT	Y	X	POINT	Y	X	POINT	Y	X
L1	-34622.12	2880513.655	L16	-35477.305	2881408.835	R9	-35206.782	2881316.273
L2	-34670.54	2880494.533	L17	-37163.941	2880821.43	R10	-35230.206	2881357.095
L3	-34722.97	2880487.126	L18	-37213.36	2880810.355	R11	-35262.272	2881392.638
L4	-34775.679	2880492.171	L19	-37264.87	2880810.812	R12	-35301.128	2881420.596
L5	-34825.752	2880509.39	L20	-37314.927	2880822.968	R13	-35345.019	2881439.705
L6	-34870.417	2880537.828	L21	-37360.91	2880846.185	R14	-35391.957	2881449.1
L7	-34907.204	2880575.914	L22	-37399.746	2880878.692	R15	-35439.821	2881448.357
L8	-34933.624	2880620.77	R1	-34634.788	2880540.908	R16	-35485.661	2881437.692
L9	-35233.596	2881302.729	R2	-34678.254	2880523.741	R17	-37172.181	2880850.327
L10	-35254.63	2881339.381	R3	-34723.648	2880517.328	R18	-37216.549	2880840.384
L11	-35282.397	2881370.16	R4	-34769.284	2880521.696	R19	-37261.148	2880840.78
L12	-35316.046	2881394.371	R5	-34812.637	2880536.604	R20	-37304.49	2880851.305
L13	-35354.053	2881410.918	R6	-34851.308	2880561.226	R21	-37344.304	2880871.408
L14	-35394.699	2881419.054	R7	-34883.158	2880594.2	R22	-37379.17	2880900.592
L15	-35436.148	2881418.411	R8	-34906.876	2880634.47			

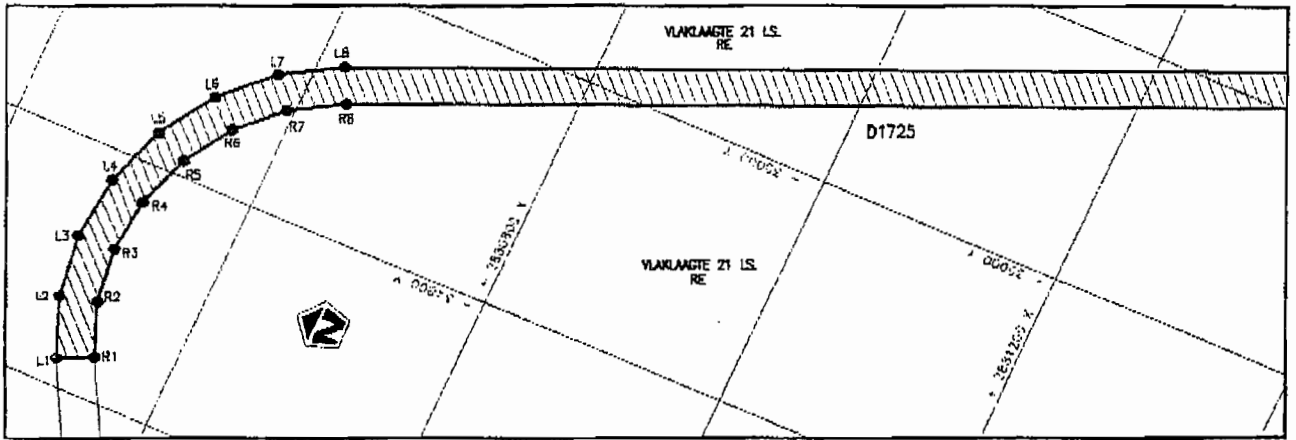

SHEET 1

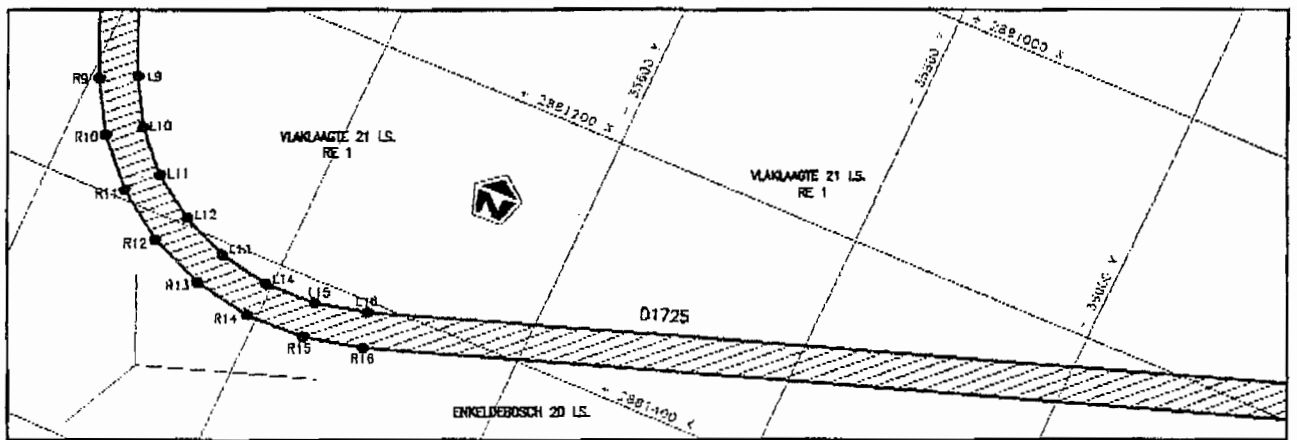

SHEET 2

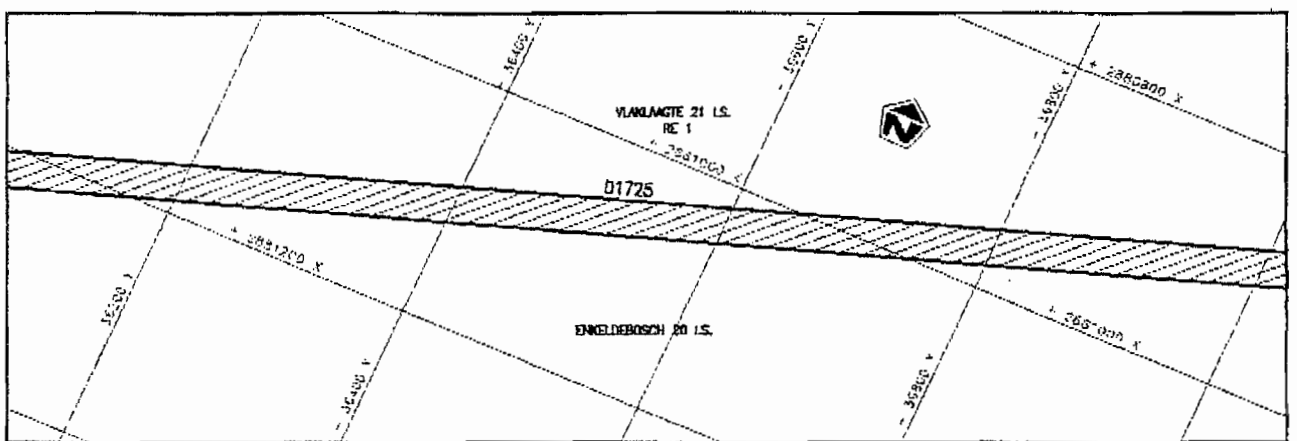

SHEET 3