

---

**CONTENTS • INHOUD**

No.

*Page* *Gazette*  
*No.* *No.*

**GENERAL NOTICE**

74	Mineral and Petroleum Resources Development Act (28/2002): Notice regarding consultation with interest and affected persons in terms of section 10 read with regulation 3	..	3	1129
----	---	----	---	------

---

## GENERAL NOTICE

### NOTICE 74 OF 2007



# Petroleum Agency SA

NOTICE REGARDING CONSULTATION WITH INTEREST AND AFFECTED PERSONS IN TERMS OF SECTION 10 READ WITH REGULATION 3 OF THE MINERAL AND PETROLEUM RESOURCES DEVELOPMENT ACT, 2002 (ACT 28 OF 2002)

File Ref No: 30/5/214/2103 PR

Notice is hereby given in terms of Section 10 (1) of the Mineral and Petroleum Resources Development Act, 2002 (Act 28 of 2002) that I, M Xiphu, CEO, for Petroleum Agency SA, has on 03 April 2007 accepted an application for an Production Right submitted by Forest Exploration International SA (Ply) Ltd.

APPLICATION DETAILS:	
Date of receipt of application:	23 March 2007
Property/properties that form (s) the subject of the relevant application:	Block 2 A as per attached Annexure
Contact Details of the Applicant	Nautica The Waterclub, Suite 1B, Beach Road, Granger Bay, Cape Town, 8005 Tel: 021 401 4140

Any person wishing to submit comments on the above application should in accordance with Section 10 (1) (b) of the above Act do so in writing on or before 03 May 2007 for the Chief Executive Officer's attention at the above given address

Dated in Cape Town on the 03 April 2007.

.....  
**M XIPHU**  
CHIEF EXECUTIVE OFFICER  
PETROLEUM AGENCY OF SA

Block 2A Relinquished  
May, 2005

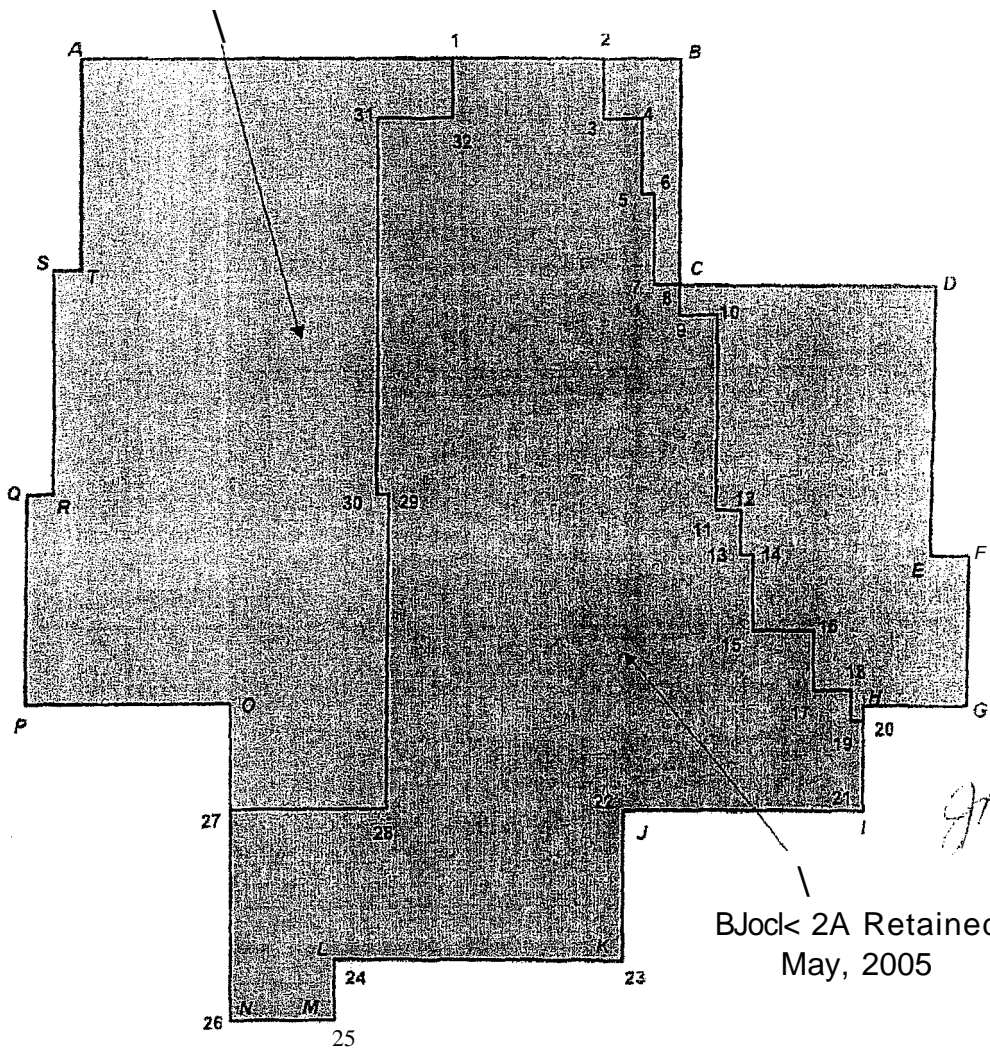

Block 2A Retained  
May, 2005

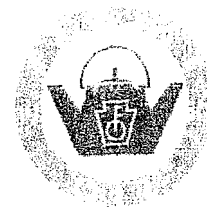

Point	Latitude	Longitude
1	-30:00:00 S	-16:32:00 E
2	-30:00:00 S	16:44:00 E
3	-30:04:00 S	16:44:00 E
4	-30:04:00 S	16:47:00 E
5	-30:09:00 S	16:47:00 E
6	-30:09:00 S	16:48:00 E
7	-30:15:00 S	16:48:00 E
8	-30:15:00 S	16:50:00 E
9	-30:17:00 S	16:50:00 E
10	-30:17:00 S	16:53:00 E
11	-30:30:00 S	16:53:00 E
12	-30:30:00 S	16:55:00 E
13	-30:33:00 S	16:55:00 E
14	-30:33:00 S	16:56:00 S
15	-30:38:00 S	16:56:00 E
16	-30:38:00 S	17:01:00 E
17	-30:42:00 S	17:01:00 E
18	-30:42:00 S	17:04:00 E
19	-30:44:00 S	17:04:00 E
20	-30:44:00 S	17:05:00 E
21	-30:50:00 S	17:05:00 E
22	-30:50:00 S	16:46:00 E
23	-31:00:00 S	16:46:00 E
24	-31:04:00 S	16:23:00 E
25	-31:04:00 S	16:23:00 E
26	-31:04:00 S	16:15:00 E
27	-30:50:00 S	16:15:00 E
28	-30:50:00 S	16:27:00 E
29	-30:29:00 S	16:27:00 E
30	-30:29:00 S	16:26:00 E
31	-30:04:00 S	16:26:00 E
32	-30:04:00 S	16:32:00 E

Point	Latitude	Longitude
A	-30:00:00 S	16:03:00 E
B	-30:00:00 S	16:50:00 E
C	-30:15:00 S	16:50:00 E
D	-30:15:00 S	17:10:00 E
E	-30:33:00 S	17:10:00 E
F	-30:33:00 S	17:13:00 E
G	-30:43:00 S	17:13:00 E
H	-30:43:00 S	17:05:00 E
I	-30:50:00 S	17:05:00 E
J	-30:50:00 S	16:46:00 E
K	-31:00:00 S	16:46:00 E
L	-31:00:00 S	16:23:00 E
M	-31:04:00 S	16:23:00 E
N	-31:04:00 S	16:15:00 E
O	-30:43:00 S	16:15:00 E
P	-30:43:00 S	15:59:00 E
Q	-30:29:00 S	15:59:00 E
R	-30:29:00 S	16:01:00 E
S	-30:14:00 S	16:01:00 E
T	-30:14:00 S	16:03:00 E