



KWAZULU-NATAL PROVINCE
KWAZULU-NATAL PROVINSIE
ISIFUNDAZWE SAKWAZULU-NATALI

Provincial Gazette • Provinsiale Koerant • Igazethi Yesifundazwe

GAZETTE EXTRAORDINARY—BUITENGEWONE KOERANT—IGAZETHI EYISIPESHELI

*(Registered at the post office as a newspaper) • (As 'n nuusblad by die poskantoor geregistreer)
(Irejistiwee njengephephandaba eposihhovisi)*

Vol. 8

PIETERMARITZBURG,

28 JANUARY 2014
28 JANUARIE 2014
28 kuMASINGANA 2014

No. 1088

We all have the power to prevent AIDS

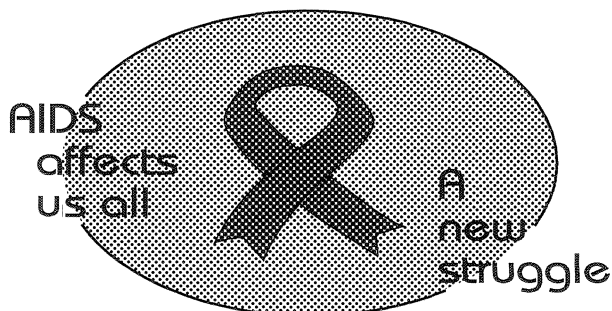

Prevention is the cure

**AIDS
HELPLINE**

0800 012 322

DEPARTMENT OF HEALTH

N.B. The Government Printing Works will not be held responsible for the quality of "Hard Copies" or "Electronic Files" submitted for publication purposes



01088

9771994455008

IMPORTANT NOTICE

The Government Printing Works will not be held responsible for faxed documents not received due to errors on the fax machine or faxes received which are unclear or incomplete. Please be advised that an "OK" slip, received from a fax machine, will not be accepted as proof that documents were received by the GPW for printing. If documents are faxed to the GPW it will be the sender's responsibility to phone and confirm that the documents were received in good order.

Furthermore the Government Printing Works will also not be held responsible for cancellations and amendments which have not been done on original documents received from clients.

CONTENTS

<i>No.</i>	<i>Page</i>
PROVINCIAL NOTICE	
19 Notice in terms of section 58(4) of the South African Schools Act, 1996 (Act No. 84 of 1996): Notice of expropriation.....	3

*No.***ISAZISO SESIFUNDAZWE**

19 Isaziso ngokwesigaba 58(4) soMthetho weZikole waseNingizimu Afrika, 1996 (uMthetho No. 84 ka 1996): Isaziso sokudliwa komhlaba	5
---	---

INHOUD

<i>No.</i>	<i>Bladsy</i>
PROVINSIALE KENNISGEWING	
19 Kennisgewing ingevolge artikel 58(4) van die Suid-Afrikaanse Skolewet, 1996 (Wet No. 84 van 1996): Kennisgewing van ont-eiening.....	4

Ikhasi

PROVINCIAL NOTICE—PROVINSIALE KENNISGEWING—ISAZISO SESIFUNDAZWE**No. 19****28 January 2014****KWAZULU-NATAL DEPARTMENT OF EDUCATION****NOTICE IN TERMS OF SECTION 58(4) OF THE SOUTH AFRICAN SCHOOLS ACT, 1996 (ACT NO. 84 OF 1996):
NOTICE OF EXPROPRIATION**

The Member of the Executive Council for Education of the Province of KwaZulu-Natal (hereinafter referred to as the "MEC") hereby gives notice in terms of section 58(4) of the South African Schools Act, 1996 (Act No. 84 of 1996), (hereinafter referred to as the "Act"), of the expropriation, in terms of section 58(1) of the Act, of the land on which the Oakford Primary School and the Sacred Heart Secondary School are situated.

AND FURTHER TAKE NOTE that the said property is described as –

A portion of the Remainder of Portion 1 of Erf 828 of Roodekrans No. 828, measuring approximately 5 ha and registered in the name of **Oakford Priory Investment Pty Ltd** by virtue of Deed of Transfer No. **T37795/2009** dated **20 October 2009**.

The date of expropriation shall be the date of publication of the notice, from which date of ownership of the said land, will pass to the Provincial Government of the Province of KwaZulu-Natal and/or the said rights will vest in the Provincial Government of the Province of KwaZulu-Natal.

In terms of section 58(5) of the Act, any expropriation contemplated in sub-section 58(4) takes effect immediately even though compensation payable in respect of such land or real rights in or over such land has not been finally determined or paid.

The registered owner of the property must, within thirty (30) days of the date of this notice, provide the following information, in writing, to the MEC for consideration –

- (a) details of any compensation claimed as a result of this expropriation;
- (b) if, prior to the date of this notice, the property was wholly or partly leased under an unregistered lease –
 - (i) the name and address of the lessee; and
 - (ii) a certified copy of the lease or, if not in writing, full details of the lease agreement must be provided; and
- (c) if, prior to the date of this notice, all or part of the expropriated property had been sold but not yet registered in the name of the buyer; the name and address of the buyer and full particulars of the agreement of sale must be provided;
- (d) if any building or improvement on the expropriated property is subject to a builder's lien, the name and address of the builder and particulars of such lien, including a certified copy of the building contract, must be provided; and
- (e) if the previous owner wishes correspondence to be sent to an address different from that shown in this notice, details of the new address must be provided.

Any person who holds a registered right over the property and who wishes to claim compensation arising from this expropriation must provide full details of such right, the compensation claimed and the basis on which such compensation is calculated.

Correspondence with, or notification to the MEC, in connection with this expropriation must be addressed to the Member of the Executive Council, c/o the Manager, Legal Services: Mr Mandla Gwala by –

- (a) post to: Private Bag X9137, Pietermaritzburg, 3200;
- (b) hand to the 1st Floor, Anton Lembede House, 247 Burger Street, Pietermaritzburg, 3200;
- (c) facsimile to: (033) 392 1228;
- (d) telephone number: (033) 392 1143; or
- (e) e-mail to: mandla.gwala@kzndoe.gov.za.

MRS NELISWA PEGGY NKONYENI, MPL

Member of the Executive Council of the Province of KwaZulu-Natal
responsible for Education

No. 19

28 Januarie 2014

KWAZULU-NATAL DEPARTEMENT VAN ONDERWYS

KENNISGEWING INGEVOLGE ARTIKEL 58(4) VAN DIE SUID-AFRIKAANSE SKOLEWET, 1996 (WET NO. 84 VAN 1996): KENNISGEWING VAN ONTEIENING

Die Lid van die Uitvoerende Raad vir Onderwys van die Provinsie van KwaZulu-Natal (hierna verwys na as die "LUR") gee hiermee kennis ingevolge artikel 58(4) van die Suid-Afrikaanse Skolewet, 1996 (Wet No. 84 van 1996), (hierna verwys na as die "Wet"), van die onteiening, ingevolge artikel 58(1) van die Wet, van die grond waarop die Oakford Primary School en die Sacred Heart Secondary School gelêe is.

EN NEEM VERDER KENNIS dat die vermelde eiendom beskryf word as –

'n **Gedeelte van die Restant van Gedeelte 1 van Erf 828 van Roodekrans No. 828**, wat ongeveer 5 ha meet en geregistreer is in die naam van **Oakford Priory Investment Eiendoms Beperk** uit hoofte van Transportakte No. **T37795/2009** gedateer **20 Oktober 2009**.

Die onteieningsdatum sal die datum van publikasie van die kennisgewing wees, vanaf welke datum die eienaarskap van die vermelde grond oorgaan na die Provinsiale Regering van die Provinsie van KwaZulu-Natal en/of die vermelde regte sal berus in die Provinsiale Regering van die Provinsie van KwaZulu-Natal.

Ingevolge artikel 58(5) van die Wet sal enige onteiening bedoel in subartikel 58(4) onmiddelik in werking tree, selfs indien vergoeding betaalbaar met betrekking tot sodanige grond of werklike regte in of oor sodanige grond nog nie finaal bepaal of betaal is nie.

Die geregistreerde eienaar van die eiendom moet, binne dertig (30) dae vanaf die datum van hierdie kennisgewing, die volgende inligting, skriftelik, aan die LUR verskaf vir oorweging –

- (a) besonderhede van enige vergoeding geëis as gevolg van hierdie onteiening;
- (b) indien, voor die datum van hierdie kennisgewing, die eiendom ten volle of gedeeltelik verhuur is as 'n ongeregistreerde verhuring –
 - (i) die naam en adres van die huurder; en
 - (ii) 'n gewaarmerkte afskrif van die huurooreenkoms of, indien nie op skrif nie, moet volledige besonderhede van die huurooreenkoms verskaf word; en
- (c) indien, voor die datum van hierdie kennisgewing, die geheel of 'n gedeelte van die eiendom wat onteien is, verkoop, maar nog nie geregistreer is in die naam van die koper nie, moet die naam en adres van die koper en volle besonderhede van die verkoopsooreenkoms verskaf word;
- (d) indien enige gebou of verbetering op die eiendom wat onteien is onderworpe is aan die retensiereg van 'n bouer moet die naam en adres van die bouer en besonderhede van sodanige retensiereg, ingesluit 'n gewaarmerkte afskrif van die boukontrak, verskaf word; en
- (e) indien die vorige eienaar verlang dat korrespondensie aan 'n adres anders as die aangedui in hierdie kennisgewing gestuur moet word, moet besonderhede van die nuwe adres verskaf word.

Enige persoon wat 'n geregistreerde reg op die eiendom hou en wat verlang om vergoeding, voortspruitend uit hierdie onteiening, te eis, moet volledige besonderhede van sodanige reg, die vergoeding geëis en die basis waarop sodanige vergoeding bereken is, verskaf.

Korrespondensie met, of kennisgewing aan die LUR, in verband met hierdie onteiening, moet gerig word aan die Lid van die Uitvoerende Raad, per adres die Bestuurder, Regsdienste: Mnr. Mandla Gwala per –

- (a) pos aan: Privaatsak X9137, Pietermaritzburg, 3200;
- (b) hand na die 1ste Vloer, Anton Lembedehuis, Burgerstraat 247, Pietermaritzburg, 3200;
- (c) faks na: (033) 392 1228;
- (d) telefoonnommer: (033) 392 1143; of
- (e) e-pos aan: mandla.gwala@kzndoe.gov.za.

MEV. NELISWA PEGGY NKONYENI, LPW

Lid van die Uitvoerende Raad van die Provinsie van KwaZulu-Natal
verantwoordelik vir Onderwys

No. 19

28 kuMasingana 2014

UMNYANGO WEZEMFUNDO WAKWAZULU-NATALI

ISAZISO NGOKWESIGABA 58(4) SOMTHETHO WEZIKOLE WASENINGIZIMU AFRIKA, 1996 (UMTHETHO NO. 84 KA 1996): ISAZISO SOKUDLIWA KOMHLABA

ILungu loMkhandlu oPhethe elibhekele ezeMfundo esiFundazweni saKwaZulu-Natali (ngemuva kwalokhu elizobizwa "ngeLungu loMkhandlu oPhethe"), ngalokhu likhipha isaziso ngokwesigaba 58(4) soMthetho weZikole waseNingizimu Afrika, 1996 (uMthetho No. 84 ka 1996), (ngemuva kwalokhu ozobizwa "ngoMthetho"), sokudliwa komhlaba, ngokwesigaba 58(1) soMthetho, kuwo okunezikole i-Oakford Primary School ne-Sacred Heart Secondary School.

FUTHI UYAZISWA ukuthi umhlaba okukhulunywa ngawo –

Ingxenye yeNsalela yeNgxenye 1 yeSiza 828 e-Roode Krans No. 828, esilinganiselwe kuma-5 ha nebhaliwe egameni le-Oakford Priory Investment Pty Ltd ngokwamandla eTayitela lokuDlulisela No. **T37795/2009** lamhla zingama-20 kuMfumfu 2009.

Usuku lokudliwa komhlaba kuzoba usuku okushicilelwe ngalo isaziso, okuwusuku lapho ubunikazi balo mhlaba, buzodluliselwa kuHulumeni wesiFundazwe saKwaZulu-Natali futhi/noma lawo malungelo ezodluliselwa kuHulumeni wesiFundazwe saKwaZulu-Natali.

Ngokwesigaba 58(5) soMthetho, noma ikuphi ukudliwa komhlaba okuhlongozwe esigatshaneni 58(4) kuqala ukusebenza ngaleso sikhathi yize noma ukukhokhwa kwesinxephezelo salowo mhlaba noma selungelo lobunikazi bomhlaba balowo mhlaba singakanqunywa noma singakakhokhwa.

Umnikazi womhlaba obhalisiwe kumele, zingakapheli izinsuku ezingamashumi amathathu (30) kushicilelwe lesi saziso, ahlinzekele iLungu loMkhandlu oPhethe ngolwazi olulandelayo olubhalwe phansi ukuze lenze isinqumo –

- (a) imininingwane yanoma yisiphi isinxephezelo esiceliwe ngenxa yokudliwa komhlaba;
- (b) uma, ngaphambi kosuku lokushicilelwa kwalesi saziso, bekuqashiswe ngomhlaba wonke noma ngengxenye yawo ngaphansi kwesivumelwano sokuqashisa esingabhalisiwe –
 - (i) igama nekheli lomuntu oqashile; futhi
 - (ii) kuhlinzekelwe nekhophi yesivumelwano sokuqashisa enesigxivizo esisemthethweni noma, uma kungabhalwanga phansi, kuhlinzekelwe ngemininingwane egcwele yesivumelwano sokuqashisa; futhi
- (c) uma, ngaphambi kosuku lokushicilelwa kwalesi saziso, wonke noma ingxenye yomhlaba odliwayo udayisiwe kodwa ungakabhaliswa ngegama lomthengi, kumele kuhlinzekwe ngegama nekheli eligcwele lomthengi kanye nemininingwane egcwele yesivumelwano sokudayiselana;
- (d) uma kunesakhiwo noma kwakhiwa emhlabeni odliwayo umakhi anelungelo kuwo, kumele kuhlinzekwe ngegama nekheli likamakhi kanye nemininingwane yalelo lungelo, okubandakanya namakhophi esivumelwano sokwakha anesigxivuzo esisemthethweni; futhi
- (e) uma obengumnikazi wendawo efisa ukuthola izincwadi azibhalelwe ekhelini elihlukile kuleli elihlongozwe kulesi saziso, kumele ahlinzeke ngemininingwane yekheli elisha.

Noma ubani onelungelo elibhalisiwe kulo mhlaba nofisa ukufaka isicelo sesinxephezelo esivele ngenxa yokudliwa komhlaba kumele ahlinzekele ngemininingwane egcwele yalelo lungelo, isinxephezelo asicelayo kanye nendlela abale ngayo lesi samba sesinxephezelo.

Izincwadi noma izaziso ezibhalelwe iLungu loMkhandlu oPhethe, ezimayelana nalo kudliwa komhlaba kumele zithunyelwe kwiLungu loMkhandlu oPhethe, zibhekiswe kuMphathi weMisebenzi yoMthetho, uMnu. Mandla Gwala –

- (a) ngeposi ku: Private Bag X9137, Pietermaritzburg, 3200;
- (b) ngesandla ku: 1st Floor, Anton Lembede House, 247 Burger Street, Pietermaritzburg, 3200;
- (c) ngefeksi ku: (033) 392 1228;
- (d) ngenombolo yocingo ku: (033) 392 1143; noma
- (e) ngombikombani ku: mandla.gwala@kzndoe.gov.za.

NKK. NELISWA PEGGY NKONYENI

iLungu loMkhandlu oPhethe esiFundazweni saKwaZulu-Natali
elibhekele ezeMfundo

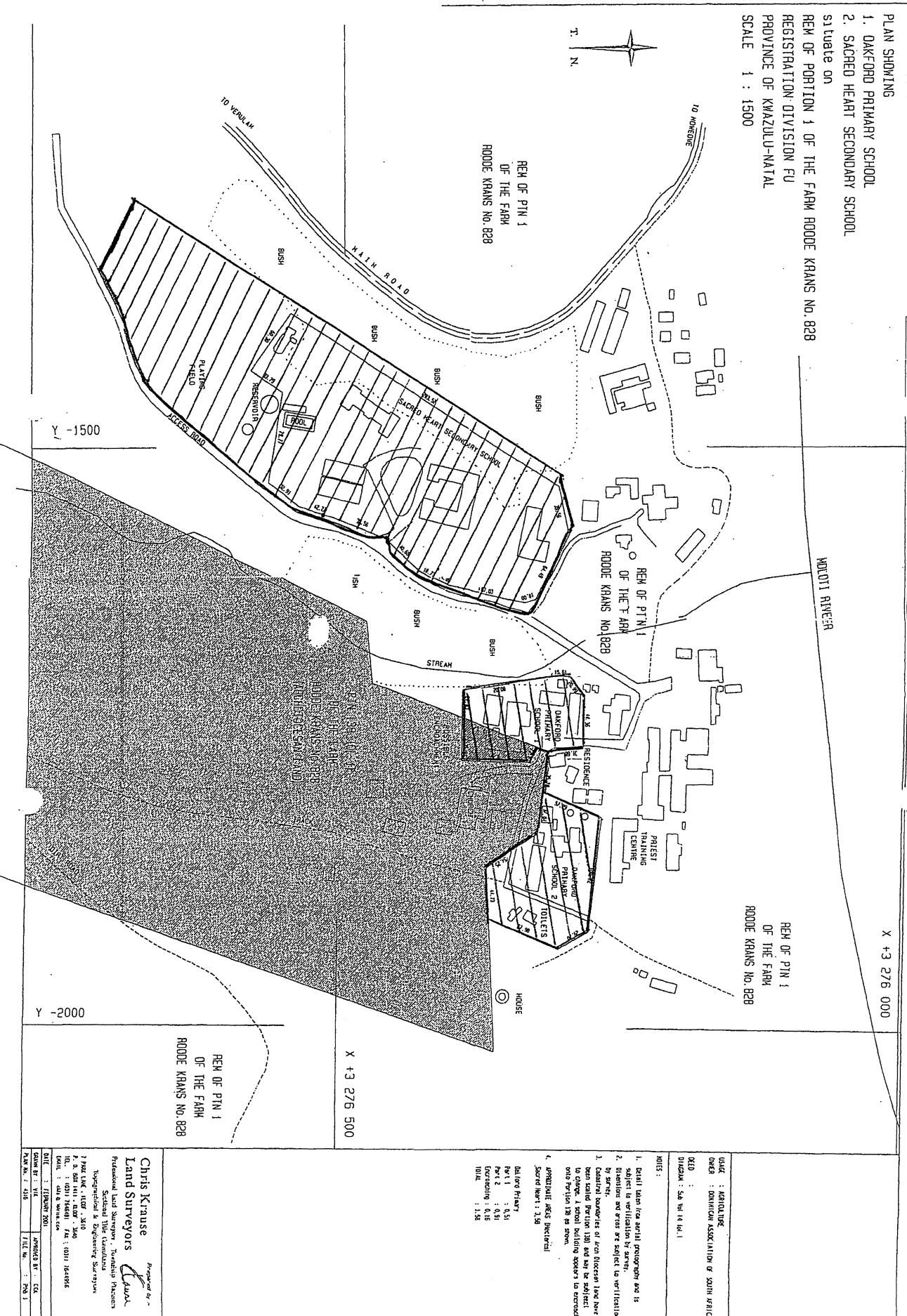

PLAN SHOWING
 1. OAKFORD PRIMARY SCHOOL
 2. SACRED HEART SECONDARY SCHOOL
 situated on
 REM OF PORTION 1 OF THE FARM ROODE KRANS NO. 828
 REGISTRATION DIVISION FU
 PROVINCE OF KWAZULU-NATAL
 SCALE 1 : 1500

REM OF PTN 1
 OF THE FARM
 ROODE KRANS NO. 828

REM OF PTN 1
 OF THE FARM
 ROODE KRANS NO. 828

SCALE : 1:1500
 DATE : 11/01/2011
 DRAWN BY : TJC
 CHECKED BY : TJC

1. Detail taken from aerial photograph and is shown as a dotted line.
2. Dimensions and areas are subject to verification by survey.
3. Certain boundaries of area shown have been scaled (Portion 128) and can be subject to change. A school building shown in sketch and Portion 128 are shown.
4. APPROXIMATE AREAS (hectares)
 BUSH: 1.38
 BALD PINE: 1.51
 PLOT 2: 0.81
 ENCLOSING: 0.18
 TOTAL: 1.55

Prepared by
Chris Krause
 Land Surveyors
 Professional Land Surveyors, Township Practitioners
 Incorporated & Registered Surveyors
 1 PEARL LANE, 4107, XH10
 T. & F. 031 3146111, 031 3146100
 TEL. : 031 3146111 FAX : 031 3146100
 EMAIL : chris@kwa.co.za

