

Government Gazette Staatskoerant

REPUBLIC OF SOUTH AFRICA
REPUBLIEK VAN SUID-AFRIKA

Vol. 501

Pretoria, 23 March
Maart 2007

No. 29722

CONTENTS**INHOUD**

<i>No.</i>	<i>Page No.</i>	<i>Gazette No.</i>	<i>No.</i>	<i>Bladsy No.</i>	<i>Koerant No.</i>
GOVERNMENT NOTICE			GOEWERMENSKENNISGEWING		
Transport, Department of			Vervoer, Departement van		
<i>Government Notice</i>			<i>Goewermentskennisgewing</i>		
252			252		
South African National Roads Agency Limited and the National Roads Act (7/1998): The South African National Roads Agency Limited: Declaration amendment of National Road N12 Section 16: Amendment of declaration No. 730 of 2005			Suid-Afrikaanse Nasionale Padagentskap Beperk en die Nasionale Paaie Wet (7/1998): Die Suid-Afrikaanse Nasionale Padagentskap Beperk: Verklaring wysiging van Nasionale Pad N12 Seksie 16: Wysiging van Verklaring No. 730 van 2005		
	3	29722		3	29722

**GOVERNMENT NOTICE
GOEWERMENTSKENNISGEWING**

**DEPARTMENT OF TRANSPORT
DEPARTEMENT VAN VERVOER**

No. 252

23 March 2007

**THE SOUTH AFRICAN NATIONAL ROADS
AGENCY LIMITED**

Registration No: 98/09584/06

DECLARATION AMENDMENT OF NATIONAL ROAD N12 SECTION 16

AMENDMENT OF DECLARATION No. 730 OF 2005

By virtue of section 40 (1)(b) of the South African National Roads Agency Limited and the National Roads Act, 1998 (Act No. 7 of 1998), I hereby amend Declaration No. 730 of 2005, by substituting paragraph (V) of the annexure thereto with the subjoined sheets 1 to 9 of Plan P601/06.

(National Road N12 Section 16: Klerksdorp - Potchefstroom)



MINISTER OF TRANSPORT

No. 252

23 Maart 2007

**DIE SUID-AFRIKAANSE NASIONALE
PADAGENTSKAP BEPERK**

Registrasie No: 98/09584/06

VERKLARING WYSIGING VAN NASIONALE PAD N12 SEKSIE 16.

WYSIGING VAN VERKLARING NO. 730 VAN 2005

Kragtens Artikel 40(1)(b) van die Suid Afrikaanse Nasionale Padagentskap Beperk en die Nasionale Paaie Wet, 1998 (Wet No.7 van 1998), wysig ek hiermee Verklaring No.730 van 2005, deur paragaaf (V) van die bylae daartoe te vervang met meegaande velle 1 tot 9 van Plan No. P601/06.

(Nasionale Pad N12 Seksie 16: Klersdorp - Potchefstroom)



MINISTER VAN VERVOER

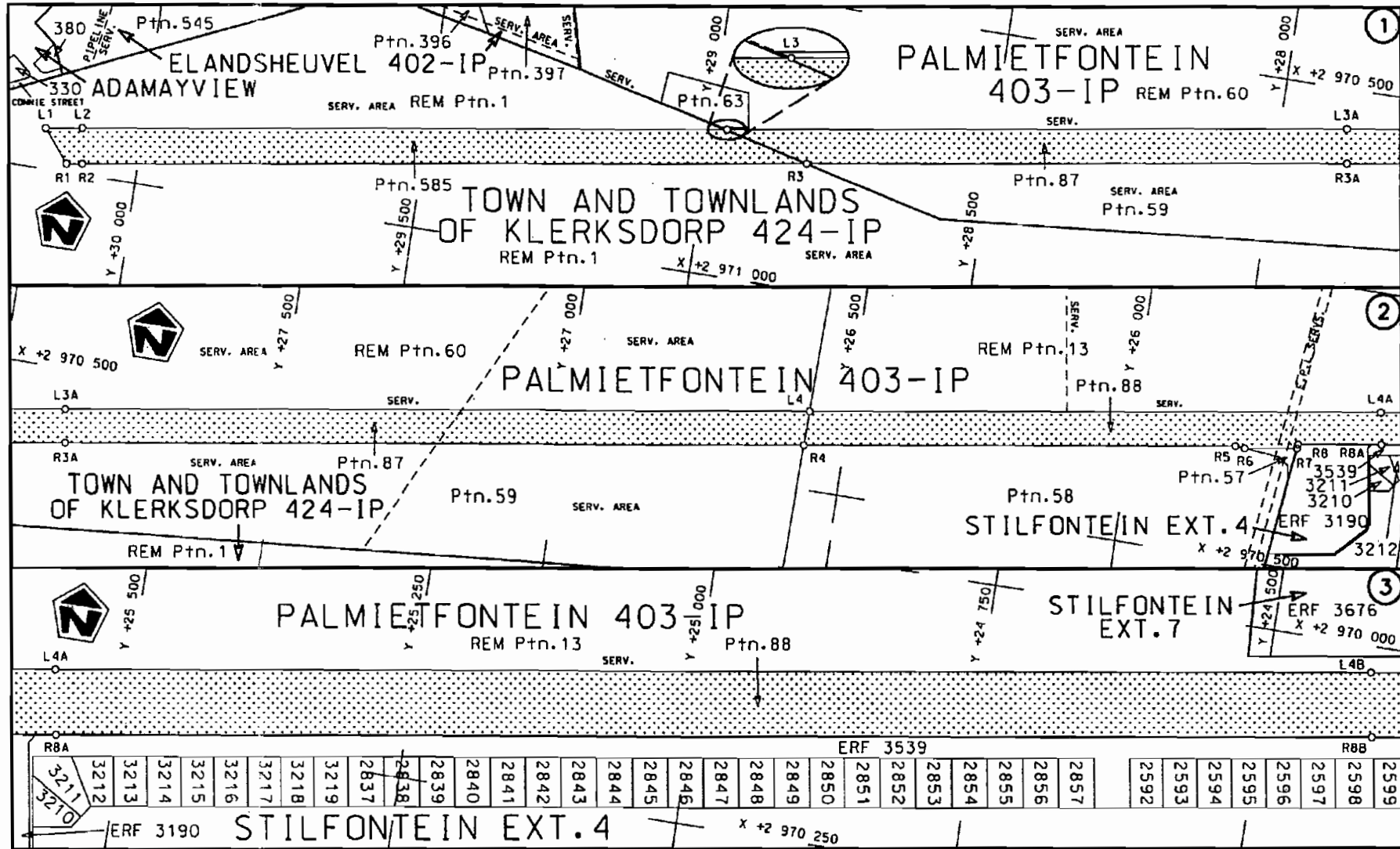

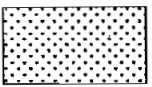

Die Suid Afrikaanse Nasionale Padagentskap Beperk The South African National Roads Agency Limited	Die figuur getoon The figure shown		steldie padreserwe voor van 'n gedeelte represents the road reserve of a portion von Nasionale Roete N12 Seksie of National Route Section	16	Vel Sheet 1 von 9 of	Plan P601/06
--	---------------------------------------	--	--	----	-------------------------	--------------

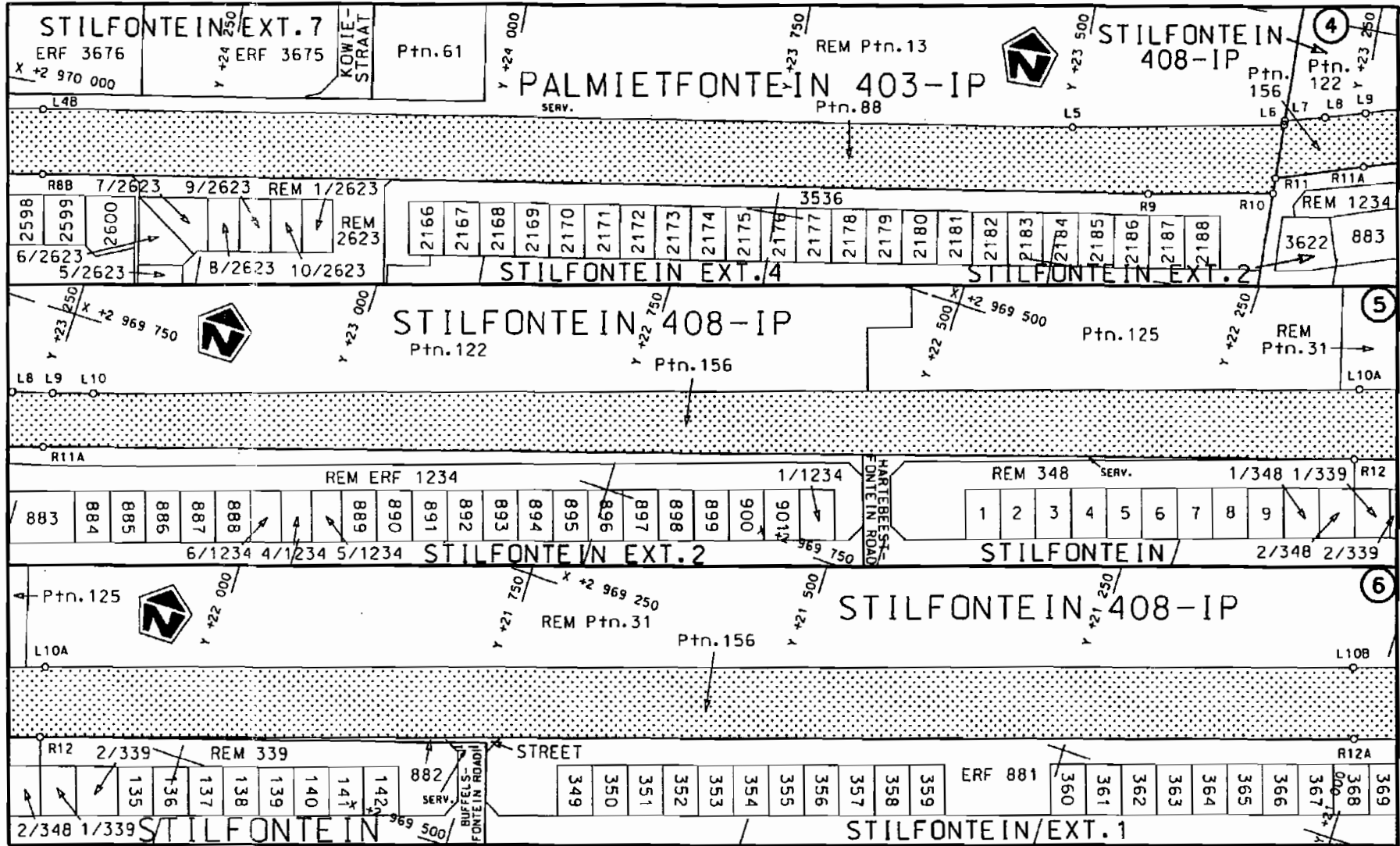
D.O.9.A

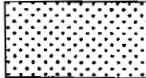

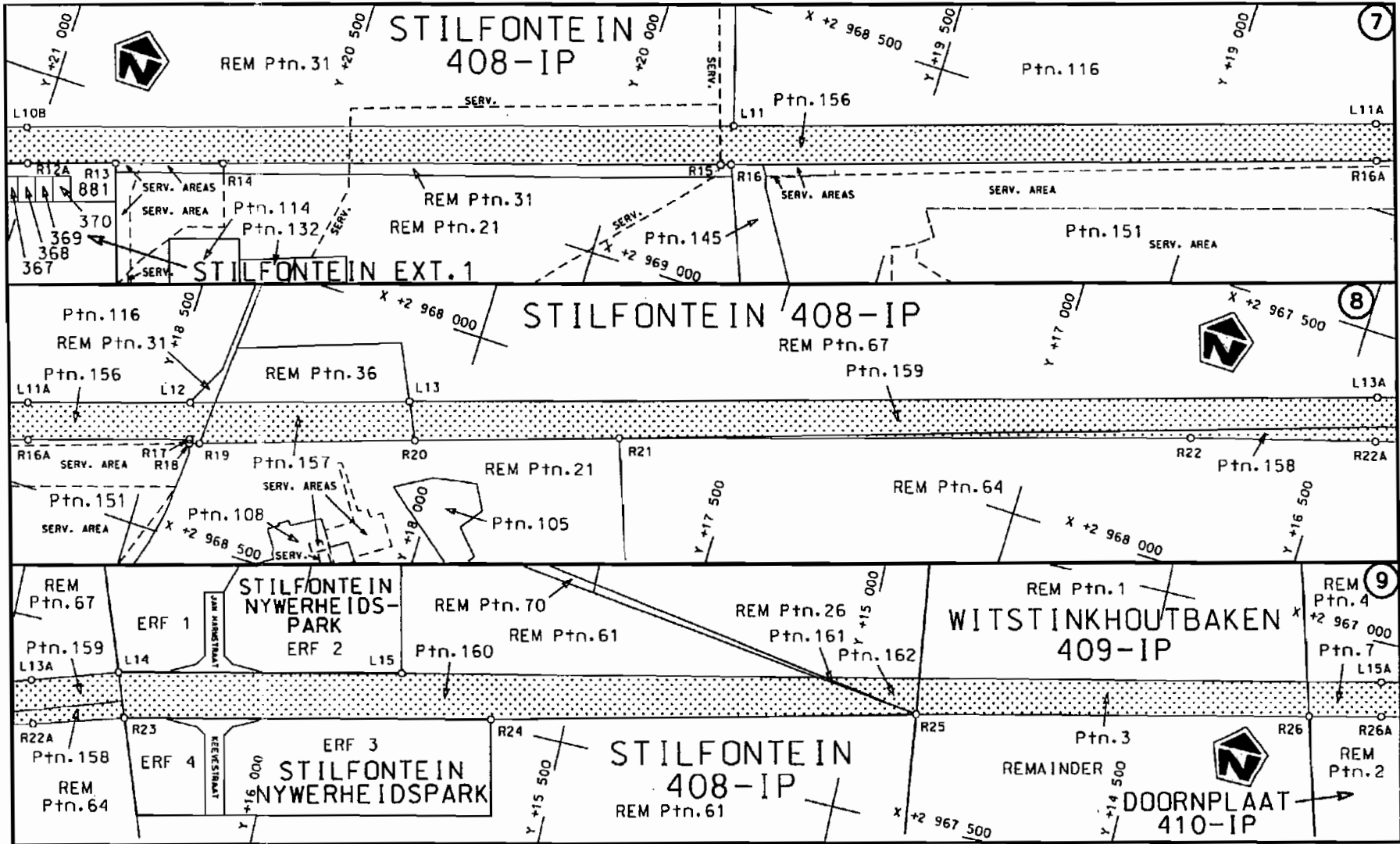
<p>Die Suid Afrikaanse Nasionale Padagentskap Beperk The South African National Roads Agency Limited</p>	<p>Die figuur getoon The figure shown</p> 	<p>stelt die padreserwe voor van 'n gedeelte represents the road reserve of a portion van Nasionale Roete N12 of National Route</p> <p>Seksie Section 16</p>	<p>Vel Sheet 2 van of 9 Plan P601/06</p>
--	--	--	--



<p>Die Suid Afrikaanse Nasionale Padagentskap Beperk The South African National Roads Agency Limited</p>	<p>Die figuur getoon The figure shown</p>	<p></p> <p>steldie podreserwe voor van 'n gedeelte represents the road reserve of a portion van Nasionale Roete N12 of National Route N12</p> <p>Seksie 16 Section 16</p>	<p>Vel 3 van 9 Sheet of</p> <p>Plan P601/06</p>
--	---	---	---

D.O.9.A

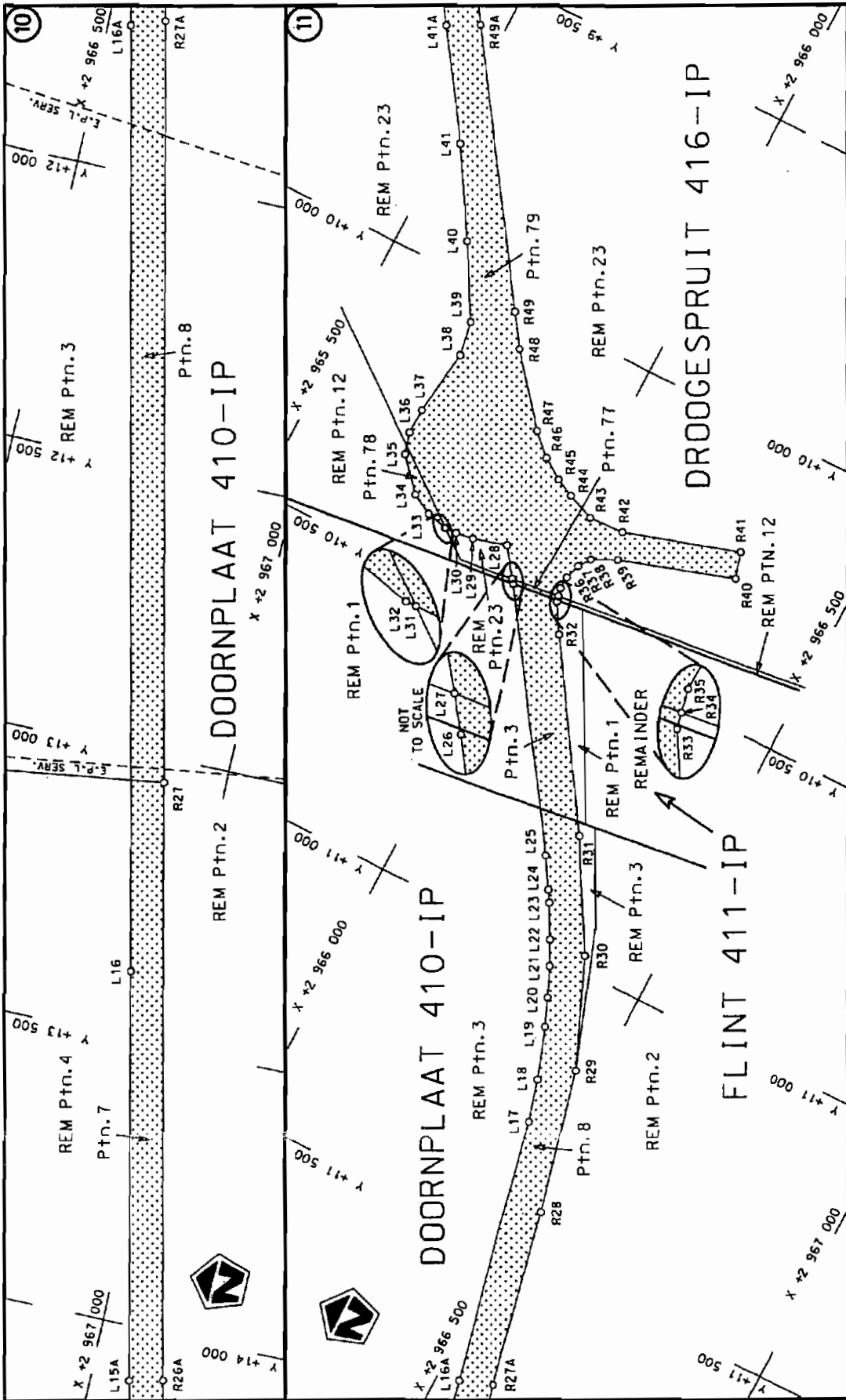

<p>Die Suid Afrikaanse Nasionale Padagentskap Beperk The South African National Roads Agency Limited</p>	<p>Die figuur getoon The figure shown</p> <p>stelt die padreserwe voor van 'n gedeelte represents the road reserve of a portion van Nasionale Roete N12 of National Route Section</p>	<p>Vel Sheet 4 of 9</p> <p>Plan P601/06</p>
<p>16</p>		

D.O.9.A

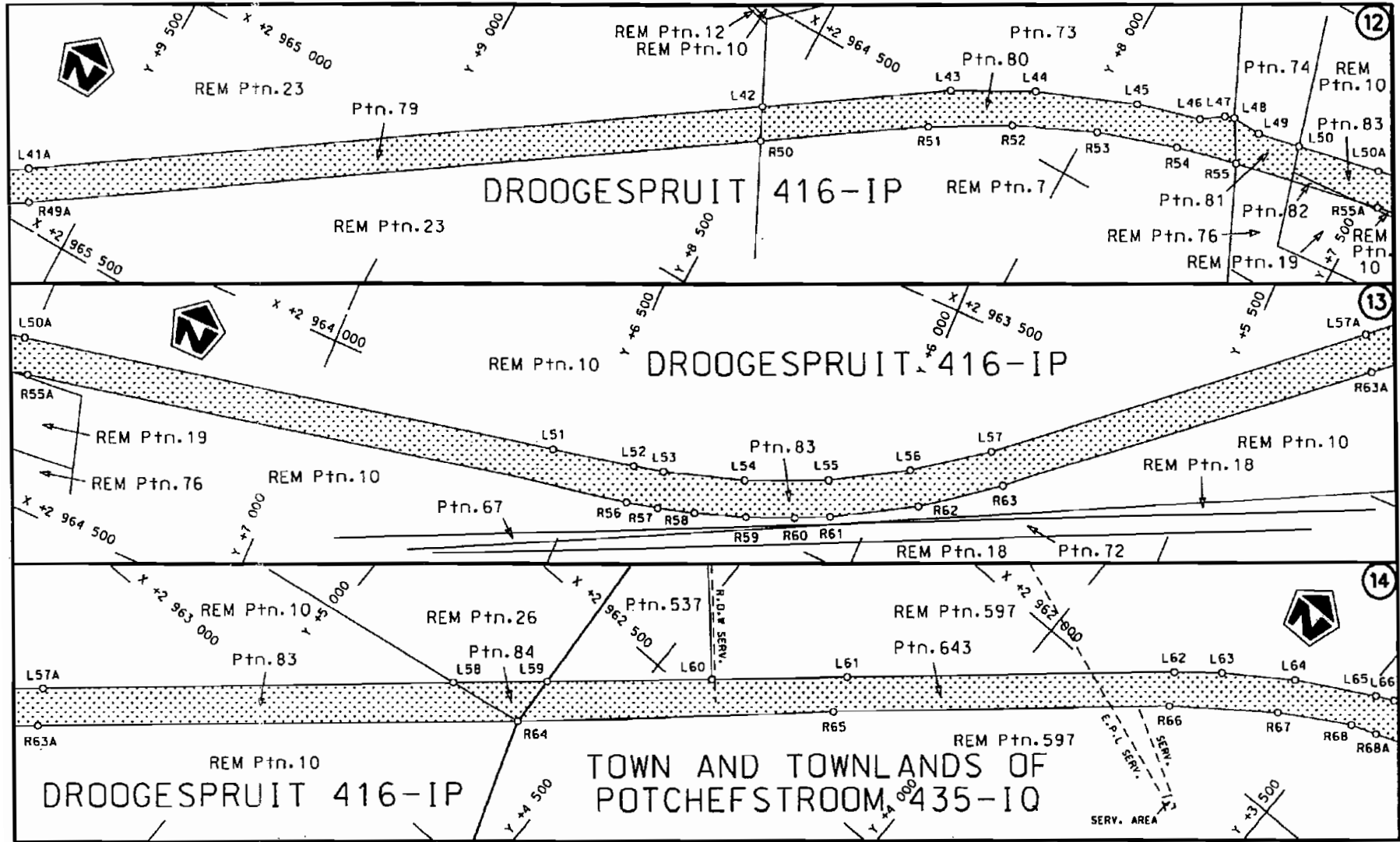

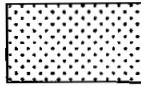
<p>Die Suid Afrikaanse Nasionale Padagentskap Beperk The South African National Roads Agency Limited</p>	<p>Die figuur getoon The figure shown</p> 	<p>steldie padreserwe voor van 'n gedeelte represents the road reserve of a portion van Nasionale Roete N12 of National Route</p> <p>Seksie Section 16</p>	<p>Vel Sheet 5 van 9 of of</p> <p>Plan P601/06</p>
--	--	--	--

D.O.9.A

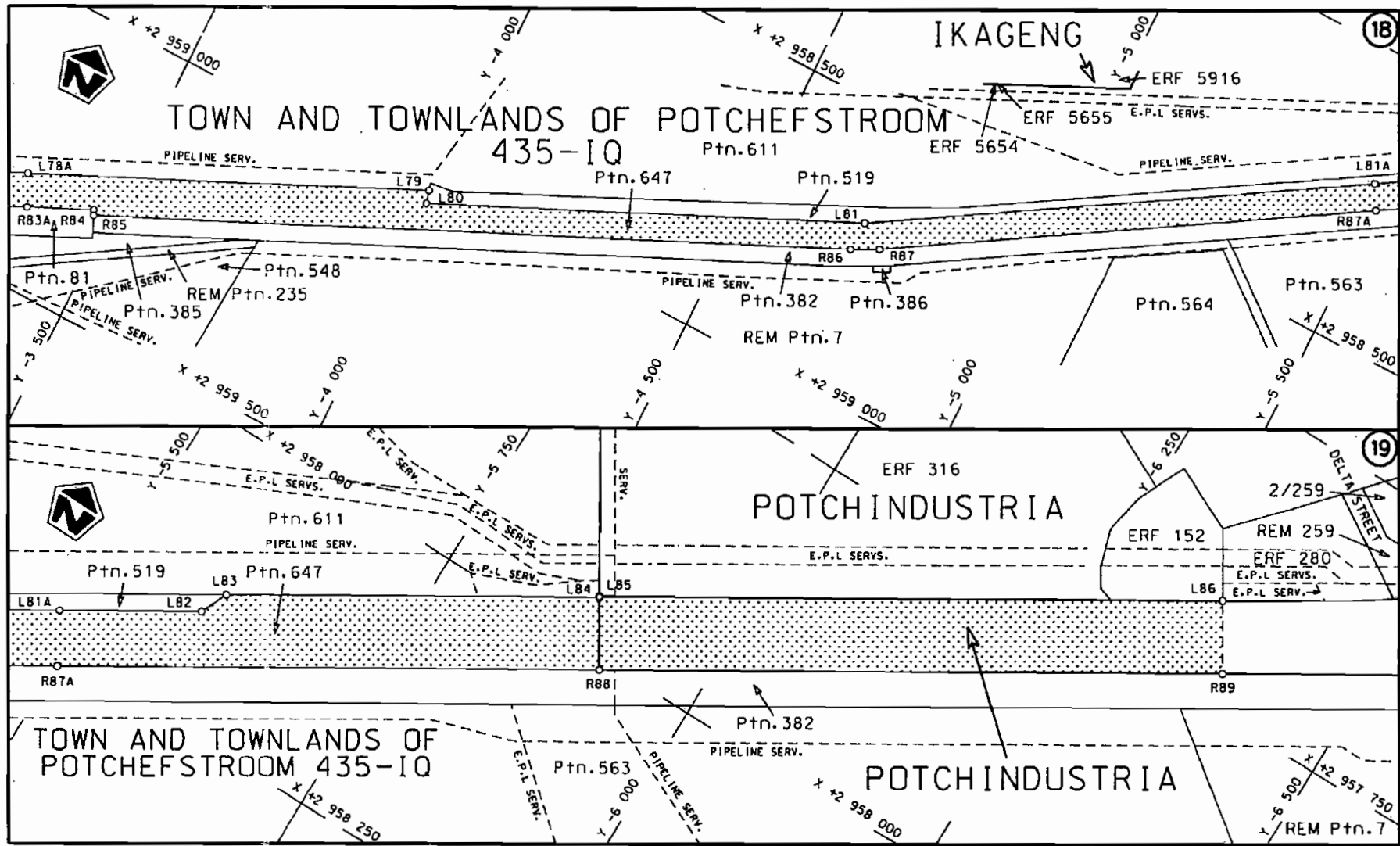

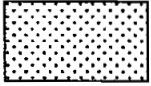
Die Suid Afrikaanse Nasionale Padagentskap Beperk The South African National Roads Agency Limited	Die figuur getoon The figure shown	 steldie padreserwe voor van 'n gedeelte represents the road reserve of a portion van Nasionale Roete of National Route N12 16	Vel Sheet 7 van of 9 Plan P601/06
--	---------------------------------------	--	--------------------------------------

D.O.9.A

PADRESERWE KOÖRDINATE				/	ROAD RESERVE CO-ORDINATES			
LINKERKANT/LEFT HAND SIDE					REGTERKANT/RIGHT HAND SIDE			
	Y	X	WG	27°	Y	X		
L1	+30 172,17	+2 970 929,18		R1	+30 126,46	+2 970 985,15		
L2	+30 107,20	+2 970 919,07		R2	+30 098,40	+2 970 980,72		
L3	+28 971,15	+2 970 742,24		R3	+28 821,77	+2 970 778,89		
L4	+26 570,04	+2 970 363,37		R4	+26 571,56	+2 970 424,01		
L5	+23 501,68	+2 969 879,18		R5	+25 812,15	+2 970 304,21		
L6	+23 317,08	+2 969 843,55		R6	+25 795,37	+2 970 305,75		
L7	+23 317,12	+2 969 840,23		R7	+25 704,52	+2 970 291,41		
L8	+23 282,41	+2 969 831,29		R8	+25 703,58	+2 970 283,97		
L9	+23 247,72	+2 969 821,56		R9	+23 425,22	+2 969 924,88		
L10	+23 213,29	+2 969 811,03		R10	+23 316,40	+2 969 905,01		
L11	+19 824,20	+2 968 711,21		R11	+23 316,57	+2 969 891,65		
L12	+18 459,43	+2 968 268,05		R12	+22 123,57	+2 969 521,44		
L13	+18 087,46	+2 968 146,06		R13	+20 857,94	+2 969 112,80		
L14	+16 297,07	+2 967 558,86		R14	+20 673,61	+2 969 053,29		
L15	+15 803,53	+2 967 446,97		R15	+19 826,56	+2 968 782,94		
L16	+13 384,33	+2 966 910,01		R16	+19 808,46	+2 968 776,84		
L17	+11 281,32	+2 966 433,30		R17	+18 441,44	+2 968 329,08		
L18	+11 207,80	+2 966 411,68		R18	+18 439,57	+2 968 336,47		
L19	+11 116,85	+2 966 379,39		R19	+18 422,64	+2 968 330,75		
L20	+11 069,26	+2 966 359,71		R20	+18 058,26	+2 968 207,64		
L21	+11 018,46	+2 966 336,60		R21	+17 711,69	+2 968 090,58		
L22	+10 976,05	+2 966 315,63		R22	+16 739,13	+2 967 776,55		
L23	+10 919,06	+2 966 284,68		R23	+16 269,18	+2 967 634,57		
L24	+10 899,14	+2 966 272,64		R24	+15 630,56	+2 967 489,79		
L25	+10 846,96	+2 966 240,02		R25	+14 890,34	+2 967 308,34		
L26	+10 443,61	+2 965 965,73		R26	+14 208,00	+2 967 154,29		
L27	+10 436,13	+2 965 960,19		R27	+13 044,51	+2 966 892,49		
L28	+10 386,74	+2 965 923,62		R28	+11 415,09	+2 966 525,97		
L29	+10 403,56	+2 965 865,73		R29	+11 162,76	+2 966 462,51		
L30	+10 408,86	+2 965 835,11		R30	+10 974,66	+2 966 382,06		
L31	+10 409,38	+2 965 814,62		R31	+10 790,04	+2 966 274,51		
L32	+10 409,40	+2 965 813,83		R32	+10 487,03	+2 966 077,44		
L33	+10 400,92	+2 965 776,85		R33	+10 436,77	+2 966 047,25		
L34	+10 381,30	+2 965 740,02		R34	+10 426,72	+2 966 044,99		
L35	+10 325,51	+2 965 691,38		R35	+10 412,53	+2 966 041,79		
L36	+10 287,89	+2 965 680,67		R36	+10 390,30	+2 966 042,59		
L37	+10 243,08	+2 965 680,78		R37	+10 363,31	+2 966 050,57		
L38	+10 124,97	+2 965 695,81		R38	+10 343,20	+2 966 063,90		
L39	+10 063,67	+2 965 685,03		R39	+10 322,14	+2 966 105,54		
L40	+9 941,07	+2 965 613,31		R40	+10 257,47	+2 966 306,05		
L41	+9 793,41	+2 965 523,43		R41	+10 211,00	+2 966 291,58		
L42	+8 527,16	+2 964 661,27		R42	+10 274,65	+2 966 089,94		
L43	+8 247,48	+2 964 469,93		R43	+10 277,93	+2 966 028,94		
L44	+8 114,19	+2 964 396,74		R44	+10 257,99	+2 965 981,49		
L45	+7 944,90	+2 964 328,26		R45	+10 242,23	+2 965 949,14		
L46	+7 834,59	+2 964 296,44		R46	+10 217,49	+2 965 913,44		
L47	+7 797,96	+2 964 270,12		R47	+10 182,61	+2 965 876,97		
L48	+7 782,01	+2 964 264,45		R48	+10 067,56	+2 965 782,70		
L49	+7 730,47	+2 964 268,30		R49	+10 012,61	+2 965 745,10		
L50	+7 657,10	+2 964 252,24		R50	+8 500,26	+2 964 716,30		
L51	+6 569,11	+2 964 017,08		R51	+8 250,85	+2 964 546,63		

Vel	8	Van	9	P601/06
Sheet		of		

PADRESERWE KOÖRDINATE				/	ROAD RESERVE CO-ORDINATES			
LINKERKANT/LEFT HAND SIDE					REGTERKANT/RIGHT HAND SIDE			
	Y	X	WG	27°	Y	X		
L52	+6 424,42	+2 963 985,82		R52	+8 121,04	+2 964 470,78		
L53	+6 371,32	+2 963 973,29		R53	+7 983,10	+2 964 407,78		
L54	+6 232,28	+2 963 928,90		R54	+7 845,28	+2 964 360,74		
L55	+6 094,13	+2 963 867,09		R55	+7 739,98	+2 964 333,59		
L56	+5 967,35	+2 963 792,70		R56	+6 412,24	+2 964 047,32		
L57	+5 847,58	+2 963 703,23		R57	+6 356,61	+2 964 034,10		
L58	+4 761,82	+2 962 761,12		R58	+6 292,74	+2 964 015,63		
L59	+4 634,11	+2 962 650,45		R59	+6 205,50	+2 963 985,44		
L60	+4 409,96	+2 962 456,34		R60	+6 124,62	+2 963 951,33		
L61	+4 226,67	+2 962 296,77		R61	+6 066,86	+2 963 923,52		
L62	+3 785,28	+2 961 913,91		R62	+5 929,86	+2 963 843,00		
L63	+3 719,34	+2 961 860,19		R63	+5 805,38	+2 963 749,54		
L64	+3 611,89	+2 961 786,31		R64	+4 629,02	+2 962 739,80		
L65	+3 483,16	+2 961 715,12		R65	+4 206,07	+2 962 360,30		
L66	+3 452,47	+2 961 700,73		R66	+3 753,33	+2 961 966,26		
L67	+3 341,49	+2 961 656,38		R67	+3 598,29	+2 961 851,15		
L68	+1 580,56	+2 961 042,77		R68	+3 482,77	+2 961 783,61		
L69	+1 438,08	+2 960 993,11		R69	+1 963,54	+2 961 245,14		
L70	+280,86	+2 960 583,03		R70	+1 822,66	+2 961 191,38		
L71	-25,58	+2 960 517,46		R71	+1 820,22	+2 961 195,99		
L72	-32,11	+2 960 500,50		R72	+1 774,06	+2 961 176,77		
L73	-1 428,03	+2 960 177,74		R73	+1 748,71	+2 961 167,67		
L74	-1 561,35	+2 960 140,41		R74	+1 469,04	+2 961 075,34		
L75	-1 791,26	+2 960 047,07		R75	+1 178,96	+2 960 976,83		
L76	-3 073,88	+2 959 411,83		R76	+1 174,34	+2 960 991,32		
L77	-3 077,99	+2 959 424,25		R77	+391,03	+2 960 686,73		
L78	-3 086,91	+2 959 419,84		R78	+263,69	+2 960 643,75		
L79	-3 985,24	+2 959 003,95		R79	-38,75	+2 960 579,04		
L80	-3 991,00	+2 959 026,19		R80	-1 443,62	+2 960 238,77		
L81	-4 703,06	+2 958 697,90		R81	-1 581,75	+2 960 200,09		
L82	-5 585,61	+2 958 155,67		R82	-1 817,11	+2 960 104,54		
L83	-5 597,01	+2 958 131,66		R83	-2 877,85	+2 959 580,40		
L84	-5 881,00	+2 957 956,96		R84	-3 468,14	+2 959 308,46		
L85	-5 880,51	+2 957 956,16		R85	-3 472,51	+2 959 317,33		
L86	-6 354,08	+2 957 665,24		R86	-4 701,49	+2 958 750,10		
				R87	-4 747,34	+2 958 726,46		
				R88	-5 913,44	+2 958 009,74		
				R89	-6 387,08	+2 957 718,93		