

CONTENTS**INHOUD**

No.	GOVERNMENT NOTICE	Page No.	Gazette No.	No.	GOEWERMENSKENNISGEWING	B/adsy No.	Koerant No.
	Transport, Department of				Vervoer, Departement van		
	<i>Government Notice</i>				<i>Goewermentskennisgewing</i>		
739	South African National Roads Agency Limited and the National Roads Act (7/1998): Declaration amendment of National Road R510 Section 1: Amendment of Declaration No. 1230 of 2004	3	30181	739	Suid-Afrikaanse Nasionale Padagentskap Beperk en die Nasionale Paaie Wet (7/1998): Verklaring wysiging van Nasionale Pad R510 Seksie 1; Wysiging van Verklaring No. 1230 van 2004	4	30181

**GOVERNMENT NOTICE
GOEWERMENTSKENNISGEWING**

**DEPARTMENT OF TRANSPORT
DEPARTEMENT VAN VERVOER**

No. 739

17 August 2007

**THE SOUTH AFRICAN NATIONAL ROADS
AGENCY LIMITED**

Registration No: 98/09584/06

DECLARATION AMENDMENT OF NATIONAL ROAD R510 SECTION 1

AMENDMENT OF DECLARATION No. 1230 OF 2004

By virtue of section 40 (1)(b) of the South African National Roads Agency Limited and the National Roads Act, 1998 (Act NO.7 of 1998), I hereby amend Declaration No. 1230 of 2004, by substituting the descriptive section from the North West/Limpopo Provincial Border up to Northam in paragraph (I) of the annexure with the subjoined sheets 1 to 4 of Plan P623/07.

(National Road R510 Section 1: North West/Limpopo Provincial Border - Northam)



MINISTER OF TRANSPORT

No. 739

17 Augustus 2007

DIE SUID-AFRIKAANSE NASIONALE PADAGENTSKAPBEPERK

Registrasie No: 98/09584/06

VERKLARING WYSIGING VAN NASIONALE PAD R510 SEKSIE 1.

WYSIGING VAN VERKLARING NO. 1230 VAN 2004

Kragtens Artikel40(1)(b) van die Suid Afrikaanse Nasionale Padagentskap Beperk en die Nasionale Paaie Wet, 1998 (Wet No.7 van 1998), wysig ek hiermee Verklaring No.1230 van 2004, deur die beskrywende gedeelte vanaf die Noord Wes/Limpopo Provinsiale Grens tot by Northam in paragaaf (l) van die bylae, te vervang met meegaande velie 1 tot 4 van Plan No. P623/07.

(Nasionale Pad R510 Seksie 1: Noord Wes/Limpopo Provinsiale Grens - Northam)



MINISTER VAN VERVOER

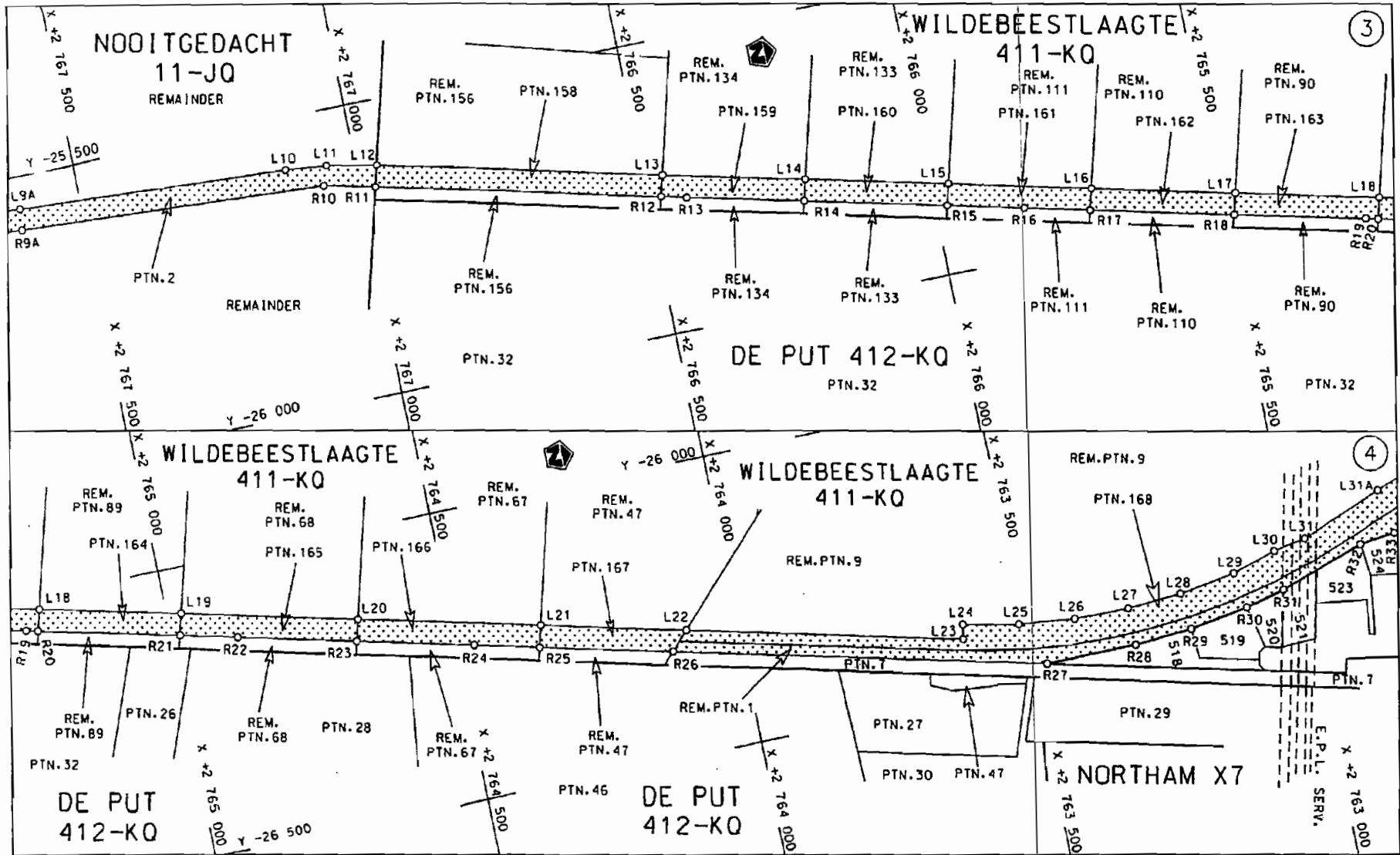

<p>Die Suid Afrikaanse Nasionale Padogenskap Beperk The South African National Roads Agency Limited</p>	<p>Die figuur getoon The figure shown</p>		<p>steldie padreserwe voor van 'n gedeelte represents the road reserve of a portion van Nasionale Roete R510 of National Route</p>	<p>Seksie 1 Section 1</p>	<p>Vel Sheet 2 van 4 Plan P623/07</p>
---	---	--	--	-------------------------------	---

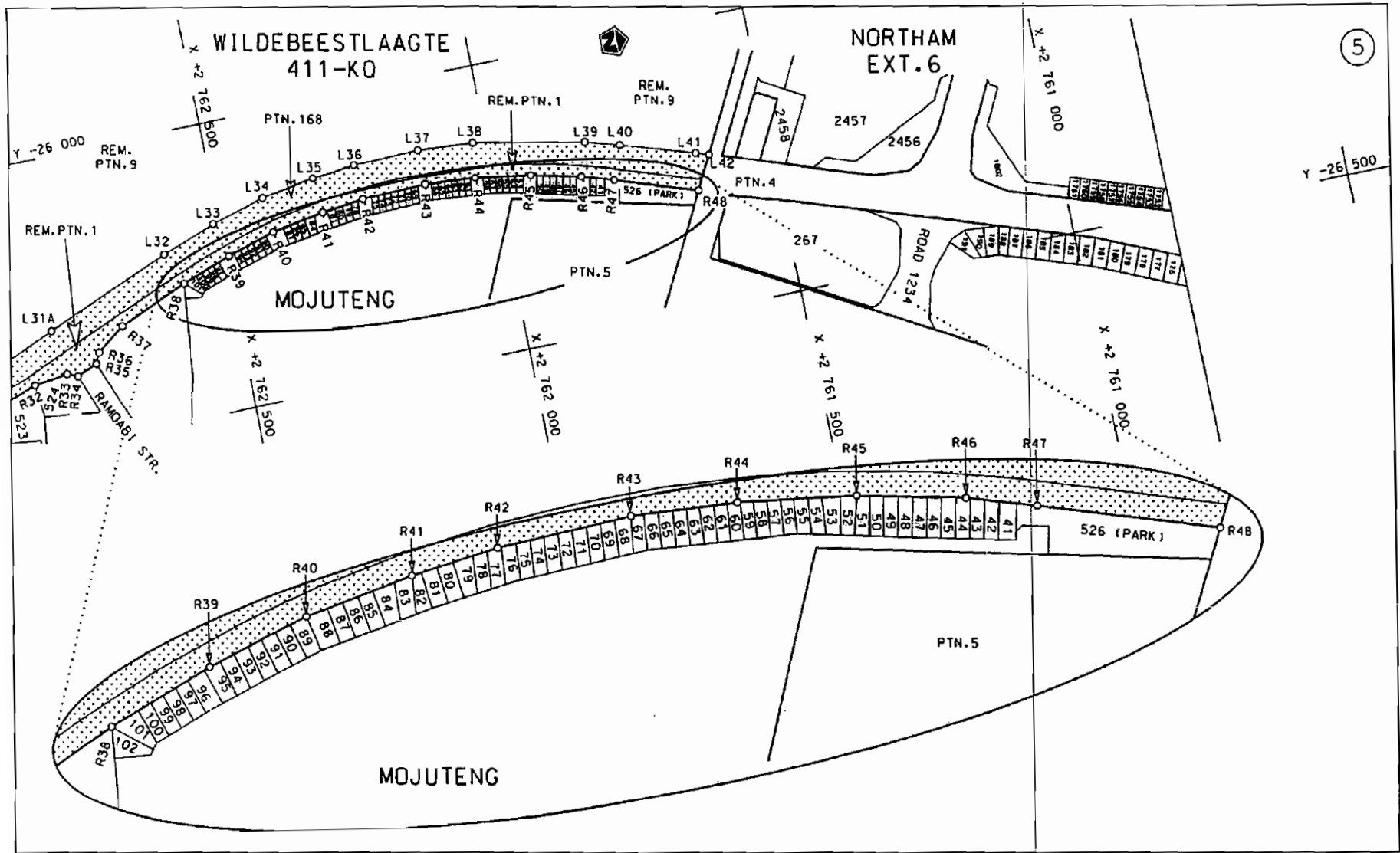

Die Suid Afrikaanse Nasionale Padagentskap Beperk
The South African National Roads Agency Limited

Die figuur getoon
The figure shown

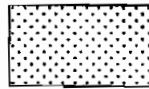

steldie padreserwe voor van 'n gedeelte
represents the road reserve of a portion
von Nasionale Roete
of National Route R510

Seksie
Section 1

Vel
Sheet 3 van 4
Plan P623/07

PADRESERWE KOORDINATE				/	ROAD RESERVE CO-ORDINATES			
LINKERKANT/LEFT HAND SIDE					REGTERKANT/RIGHT HAND SIDE			
	Y	X	WG	27 °	y	X		
L1	-25 304.77	2 771	631.98	R1	-25 341.04	2 771	606.83	
L2	-25 332.37	2 771	194.56	R2	-25 366.69	2 771	197.50	
L3	-25 367.68	2 770	633.64	R3	-25 402.10	2 770	635.14	
L4	-25 404.76	2 770	030.86	R4	-25 439.69	2 770	036.16	
L5	-25 436.97	2 769	501.74	R5	-25 472.98	2 769	505.11	
L6	-25 454.54	2 769	221.33	R6	-25 490.10	2 769	231.50	
L7	-25 467.37	2 769	016.44	R7	-25 503.02	2 769	024.80	
L8	-25 504.94	2 768	418.26	R8	-25 540.89	2 768	425.55	
L9	-25 542.54	2 767	819.87	R9	-25 578.77	2 767	820.53	
L10	-25 585.92	2 767	127.04	R10	-25 626.51	2 767	063.04	
L11	-25 593.32	2 767	051.15	R11	-25 647.85	2 766	972.47	
L12	-25 611.24	2 766	962.53	R12	-25 764.95	2 766	475.29	
L13	-25 728.43	2 766	465.37	R13	-25 775.31	2 766	431.29	
L14	-25 787.03	2 766	216.79	R14	-25 823.53	2 766	226.70	
L15	-25 845.63	2 765	968.20	R15	-25 882.12	2 765	978.12	
L16	-25 904.22	2 765	719.63	R16	-25 913.78	2 765	843.75	
L17	-25 962.82	2 765	471.04	R17	-25 940.68	2 765	729.53	
L18	-26 021.42	2 765	222.46	R18	-25 999.23	2 765	480.94	
L19	-26 080.01	2 764	973.89	R19	-26 052.81	2 765	253.39	
L20	-26 153.47	2 764	662.24	R20	-26 057.78	2 765	232.34	
L21	-26 228.08	2 764	345.73	R21	-26 116.36	2 764	983.76	
L22	-26 287.85	2 764	092.18	R22	-26 140.19	2 764	882.67	
L23	-26 401.10	2 763	610.75	R23	-26 189.76	2 764	672.10	
L24	-26 377.01	2 763	606.43	R24	-26 237.64	2 764	468.67	
L25	-26 395.99	2 763	507.78	R25	-26 264.14	2 764	355.52	
L26	-26 406.95	2 763	408.52	R26	-26 318.66	2 764	122.70	
L27	-26 408.54	2 763	311.46	R27	-26 471.15	2 763	472.21	
L28	-26 402.12	2 763	215.30	R28	-26 471.49	2 763	311.04	
L29	-26 386.72	2 763	115.45	R29	-26 464.49	2 763	209.04	
L30	-26 363.15	2 763	037.29	R30	-26 449.00	2 763	105.04	
L31	-26 352.86	2 762	980.00	R31	-26 432.00	2 763	035.04	
L32	-26 208.56	2 762	608.94	R32	-26 382.50	2 762	885.04	
L33	-26 175.22	2 762	512.03	R33	-26 374.50	2 762	823.04	
L34	-26 150.05	2 762	412.44	R34	-26 382.69	2 762	804.25	
L35	-26 134.28	2 762	318.29	R35	-26 368.00	2 762	767.04	
L36	-26 126.59	2 762	242.09	R36	-26 350.00	2 762	758.04	
L37	-26 123.97	2 762	123.69	R37	-26 314.50	2 762	708.04	
L38	-26 131.06	2 762	024.49	R38	-26 265.00	2 762	585.05	
L39	-26 169.22	2 761	826.18	R39	-26 234.50	2 762	495.05	
L40	-26 186.69	2 761	765.38	R40	-26 211.00	2 762	406.05	
L41	-26 227.64	2 761	634.70	R41	-26 196.00	2 762	313.05	
L42	-26 235.24	2 761	611.59	R42	-26 188.00	2 762	238.05	
				R43	-26 185.00	2 762	123.05	
				R44	-26 192.01	2 762	033.05	
				R45	-26 207.00	2 761	934.05	
				R46	-26 227.00	2 761	845.06	
				R47	-26 245.00	2 761	788.06	
				R48	-26 292.78	2 761	643.15	

Vel
Sheet4
Van
of

P623/07