

CONTENTS**INHOUD**

No.	Page No.	Gazette No.	No.	B/adsy No.	Koerant No.
GOVERNMENT NOTICE			GOEWERMENSKENNISGEWING		
Transport, Department of			Vervoer, Departement van		
<i>Government Notice</i>			<i>Goewermentskennisgewing</i>		
747	3	30196	747	4	30196
South African National Roads Agency Limited and the National Roads Act (7/199B): The South African National Roads Agency Limited: Declaration amendment of National Road N1 Section 23: Amendment of Declaration Nos. 21B of 19B2, 1B6 of 1973 and 2029 of 1990 .			Suid-Afrikaanse Nasionale Padagentskap Beperk en die Nasionale Paaie Wet (7/199B): Die Suid-Afrikaanse Nasionale Padagentskap Beperk: Verklaring wysiging van Nasionale Pad N1 Seksie 23: Wysiging van Verklaring Nos. 21 B van 1982, 1B6 van 1973, 2B3 en 2029 van 1990		

**GOVERNMENT NOTICE
GOEWERMENTSKENNISGEWING**

**DEPAR-rMENT OF TRANSPORT
DEPARTEMENT VAN VERVOER**

No. 747

24 August 2007

**THE SOUTH AFRICAN NATIONAL ROADS
AGENCY LIMITED**

Registration No: 98/09584/06

DECLARATION AMENDMENT OF NATIONAL ROAD N1 SECTION 23

AMENDMENT OF DECLARATION NO'S. 218 OF 1982, 186 OF 1973 AND 2029 OF 1990

By virtue of section 40 (1)(b) of the South African National Roads Agency Limited and the National Roads Act, 1998 (Act No.7 of 1998), I hereby amend the following declarations by substituting **(I)** Declaration No. 218 of 1982, sheets 1 to 4 of Plan No. P330/82, **(II)** Declaration No. 186 of 1973 sheets 1 to 3 of Plan No. P215/73 and **(III)** Declaration No. 2029 of 1990 the section from points L1 and R1 up to the common boundary between the farms Tweefontein 463 - KR and Cyferfontein 457 - KR on sheet 2 of Plan No. P261/90, with the subjoined sheets 1 to 13 of Plan NO.P586/06.

(National Road N1 Section 23: Pienaars River - Cyferfontein)

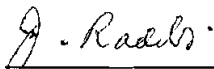
J. Radt

No. 747

24 Augustus 2007

DIE SUID-AFRIKAANSE NASIONALE PADAGENTSCHAPBEPERK

Registrasie No: 98109584/06

VERKLARING WYSIGING VAN NASIONALE PAD N1 SEKSIE 23.

WYSIGING VAN VERKLARING NO'S. 218 VAN 1982, 186 VAN 1973, 253 EN 2029 VAN 1990

Kragtens Artikel 40(1)(b) van die Suid Afrikaanse Nasionale Padagentskap Beperk en die Nasionale Paaie Wet, 1998 (Wet NO.7 van 1998), wysig ek hiermee die volgende verklarings deur (I) Verklaring No. 218 van 1982, velie 1 tot 4 van Plan no. P330/82, (II) Verklaring No. 186 van 1973 velie 1 tot 3 van Plan no. P215173 en (III) Verklaring No. 2029 van 1990, die gedeelte vanaf punte L1 en R1 tot die gemeenskaplike grens tussen plase Tweefontein 463 - KR en Cyferfontein 457 - KR op vel 2 van Plan no. P261/90 te vervang met meegaande velie 1 tot 13 van Plan no. P586/06.

(Nasionale Pad N1 Seksie 23: Pienaarsrivier - Cyferfontein)



MINISTER VAN VERVOER

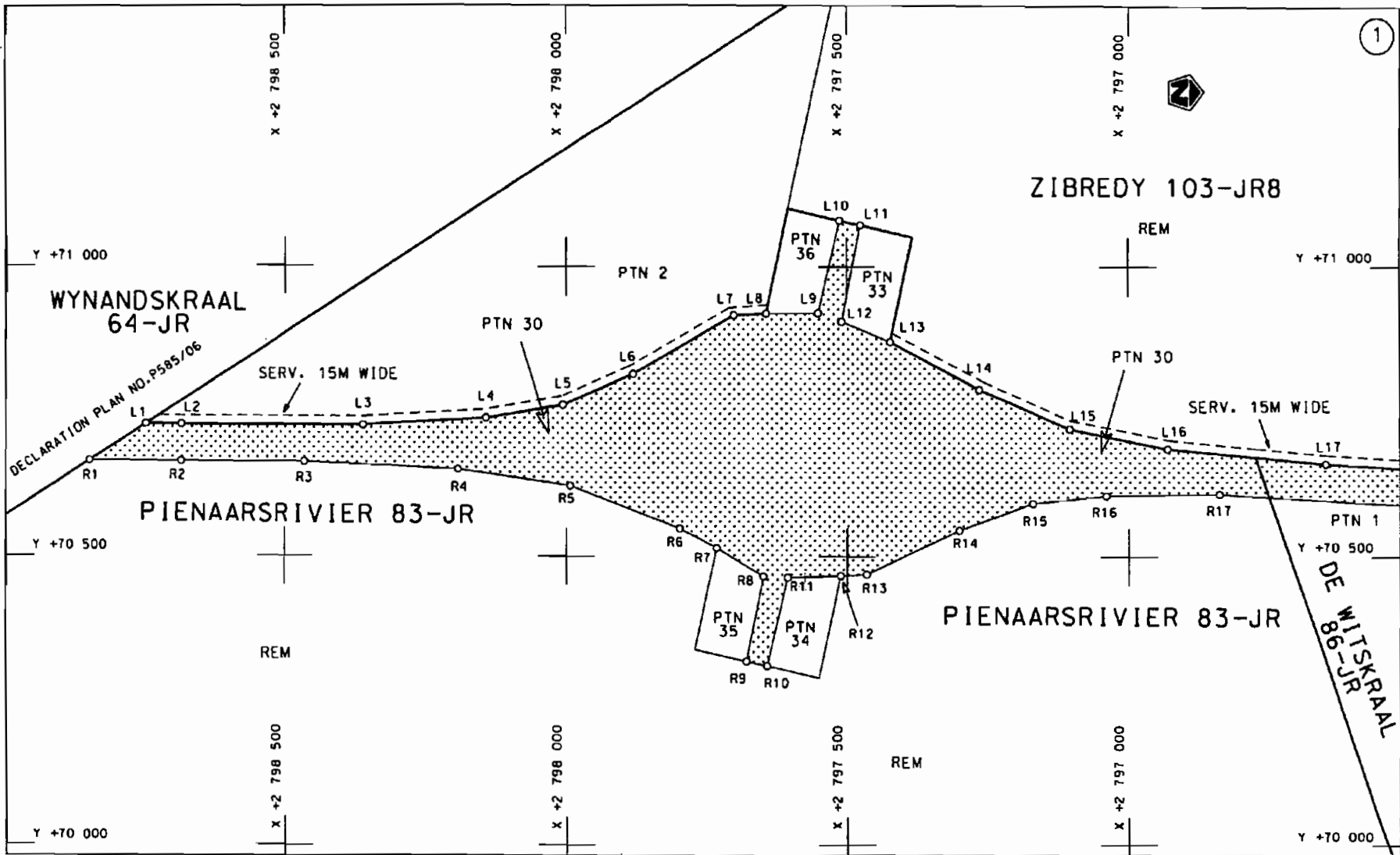

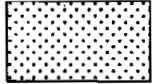
Die Suid Afrikaanse Nasionale Padagentskop Beperk The South African National Roads Agency Limited	Die figuur getoon The figure shown	 steldie padreserwe voor van 'n gedeelte represents the road reserve of a portion van Nasionale Roete of National Route	Vel Sheet 1 van of 13 Plan P586/06
--	---------------------------------------	---	---

N1 Seksie 23
 Section

D.O.9.A

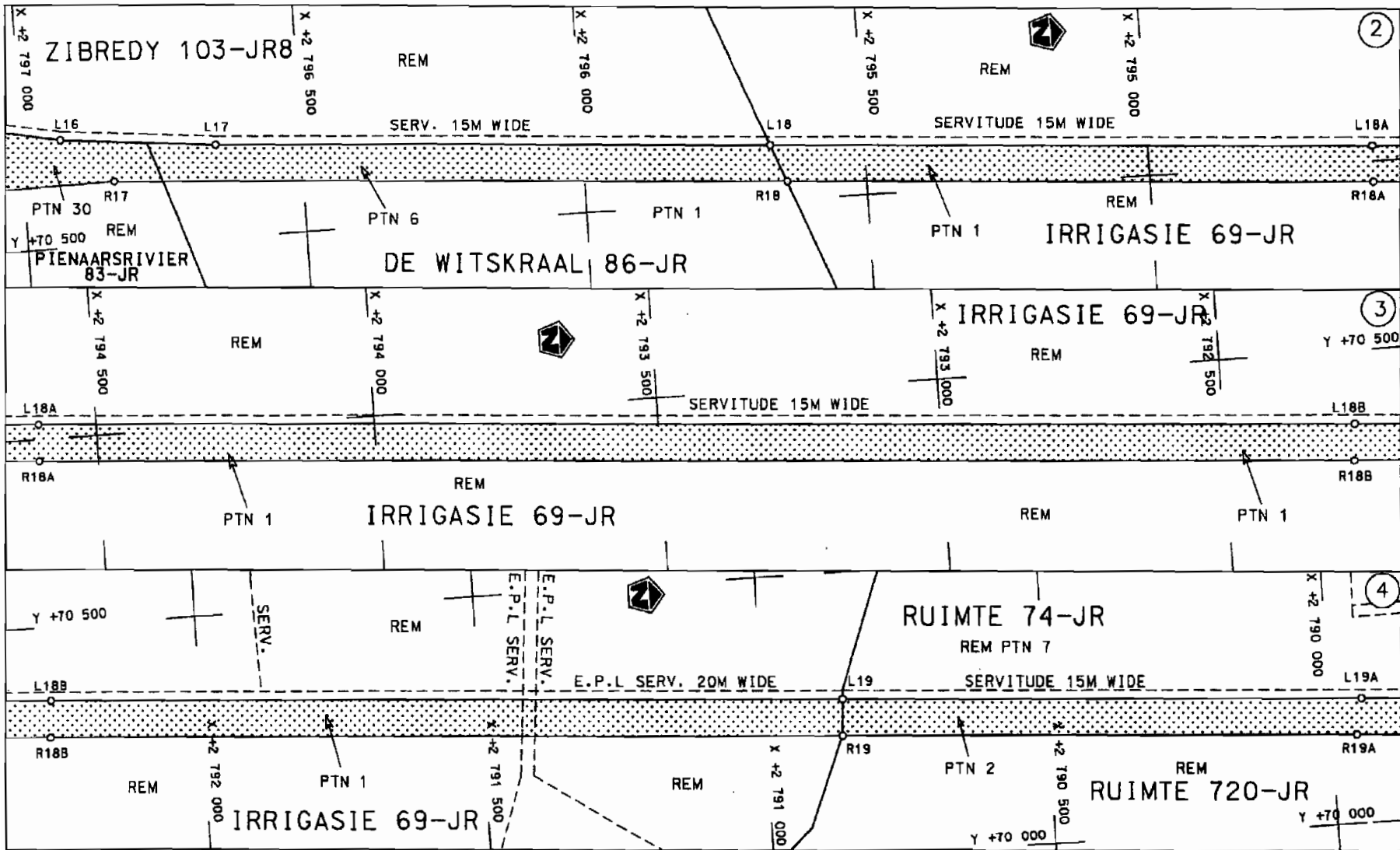

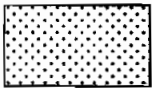
<p>Die Suid Afrikaanse Nasionale Padagentskap Beperk The South African National Roads Agency Limited</p>	<p>Die figuur getoon The figure shown</p>		<p>steldie padreserwe voor van 'n gedeelte represents the road reserve of a portion van Nasionale Roete of National Route</p>	<p>Vel Sheet 2 van of 13</p>
			<p>N1 Seksie Section 23</p>	<p>Plan P586/06</p>

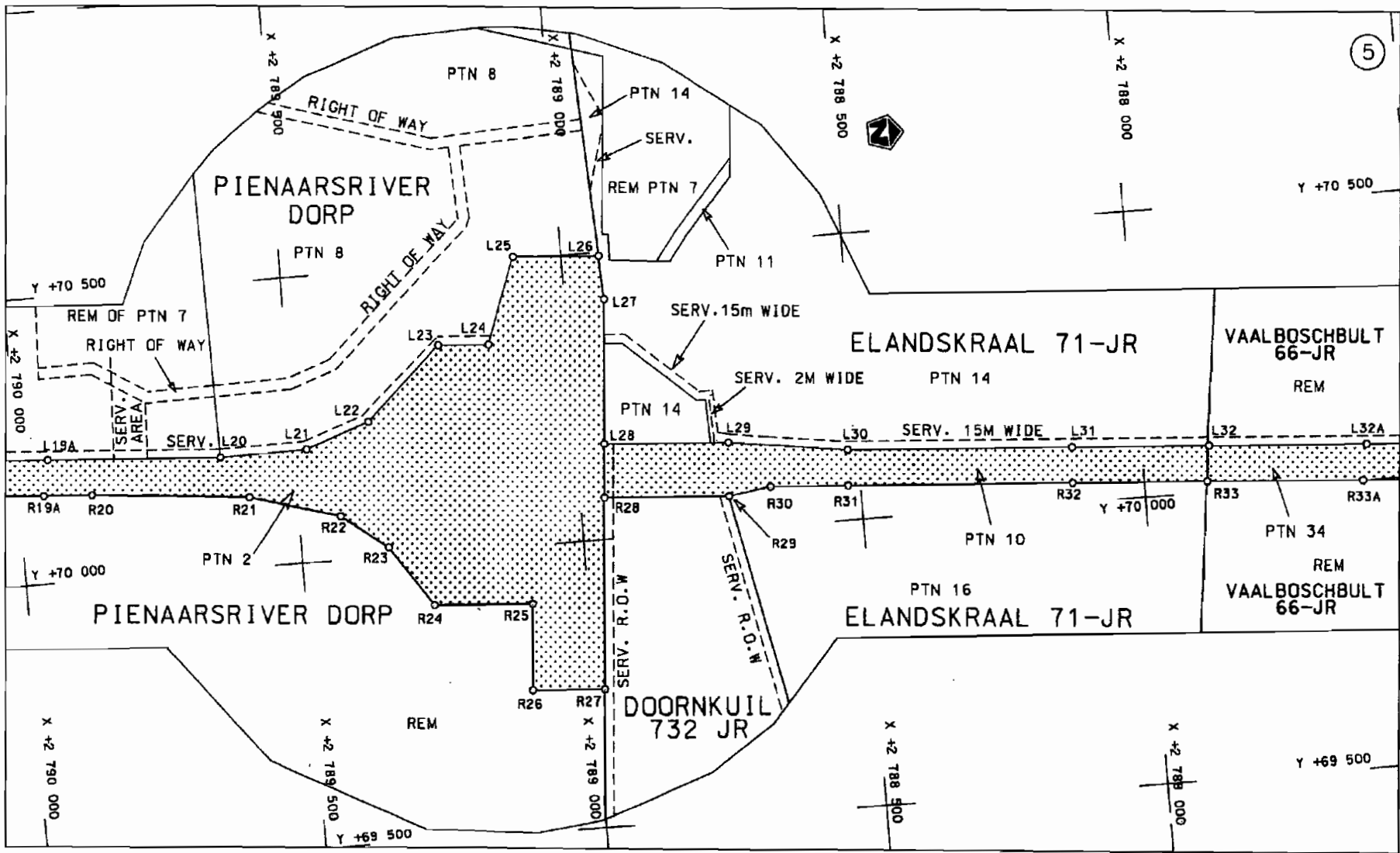

Die Suid Afrikaanse Nasionale Padagentskap Bepark
The South African National Roads Agency Limited

Die figuur getoon
The figure shown

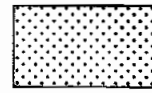

stel die padreserwe voor van 'n gedeelte
represents the road reserve of a portion
van Nasionale Roete N1 Seksie Section 23
of National Route

Vel Sheet 3 van of 13
Plan P586/06

D.O.9.A

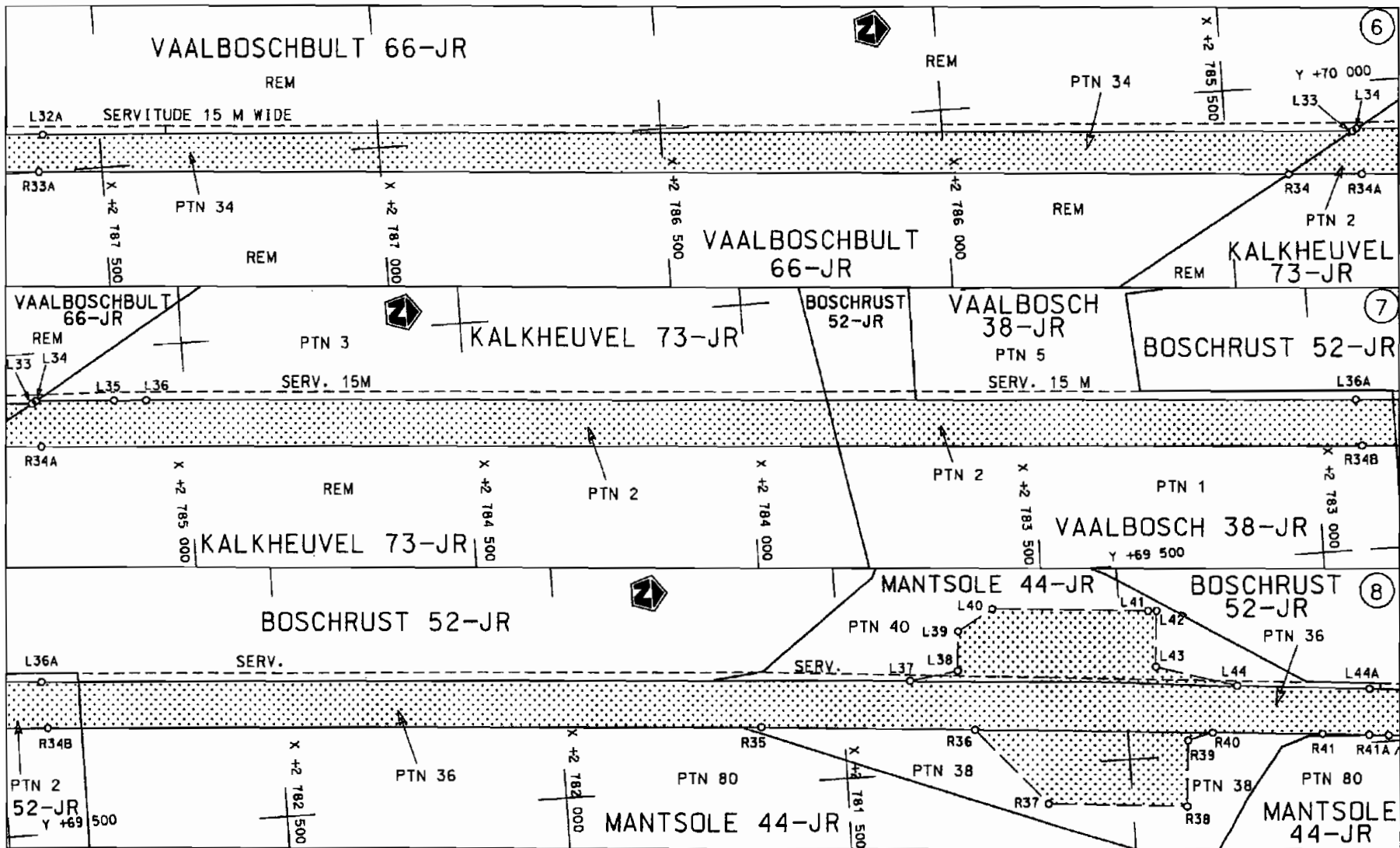

Die Suid Afrikaanse Nasionale Padagentskap Beperk	Die figuur getoon		steldie padreserwe voor van 'n gedeelte represents the road reserve of a portion van Nasionale Roete N1 Sektie 23 of National Route Section	Vel Sheet 4 van of 13
The South African National Roads Agency Limited	The figure shown			Plan P586/06

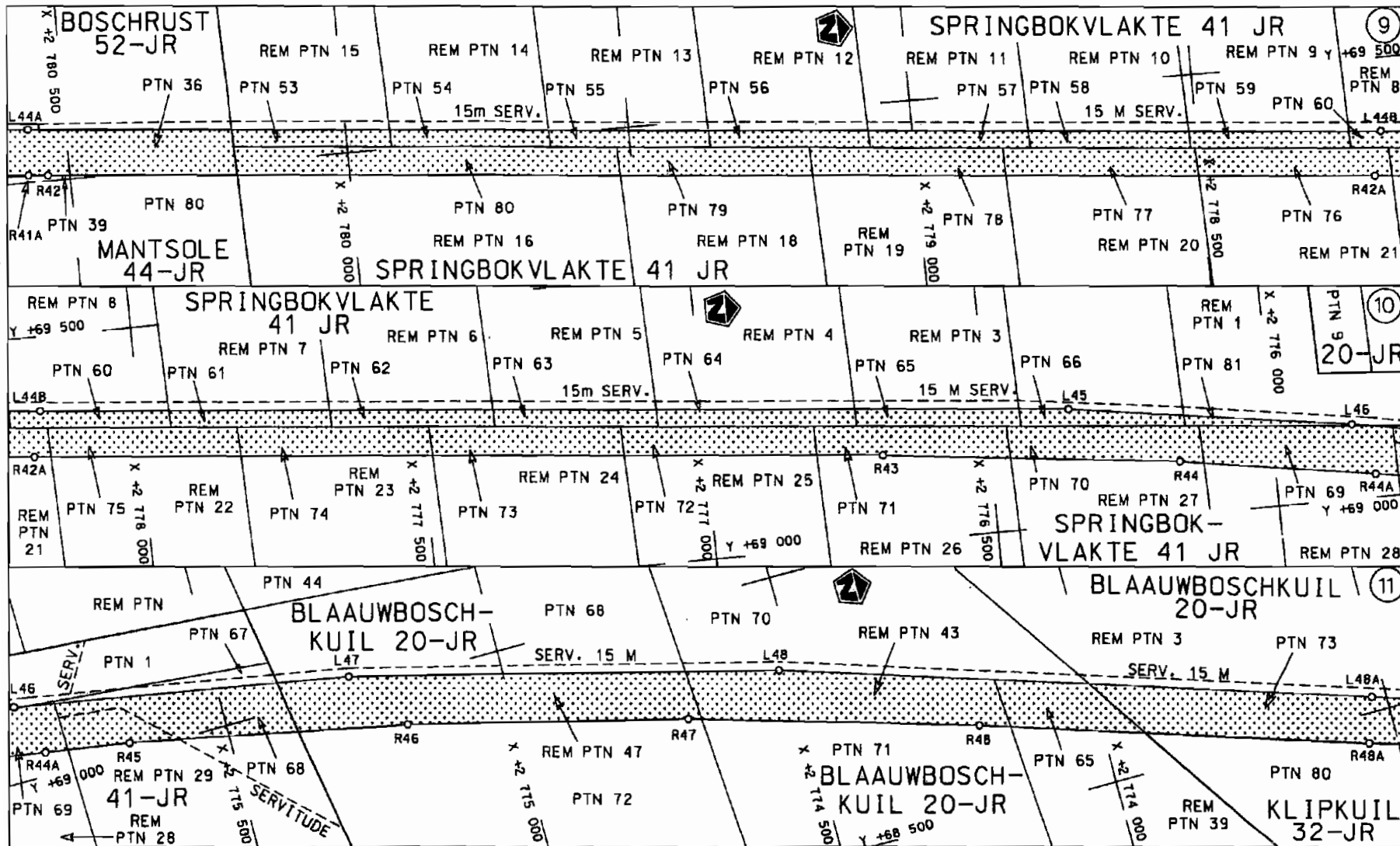

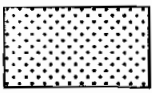
Die Suid Afrikaanse Nasionale Padagentskap Beperk The South African National Roads Agency Limited	Die figuur getoon The figure shown	 steldie padreserwe voor van 'n gedeelte represents the road reserve of a portion van Nasionale Roete of National Route	Vel Sheet 5 van of 13 Plan P586/06
			N1 23 Sektie Section

D.O.9.A

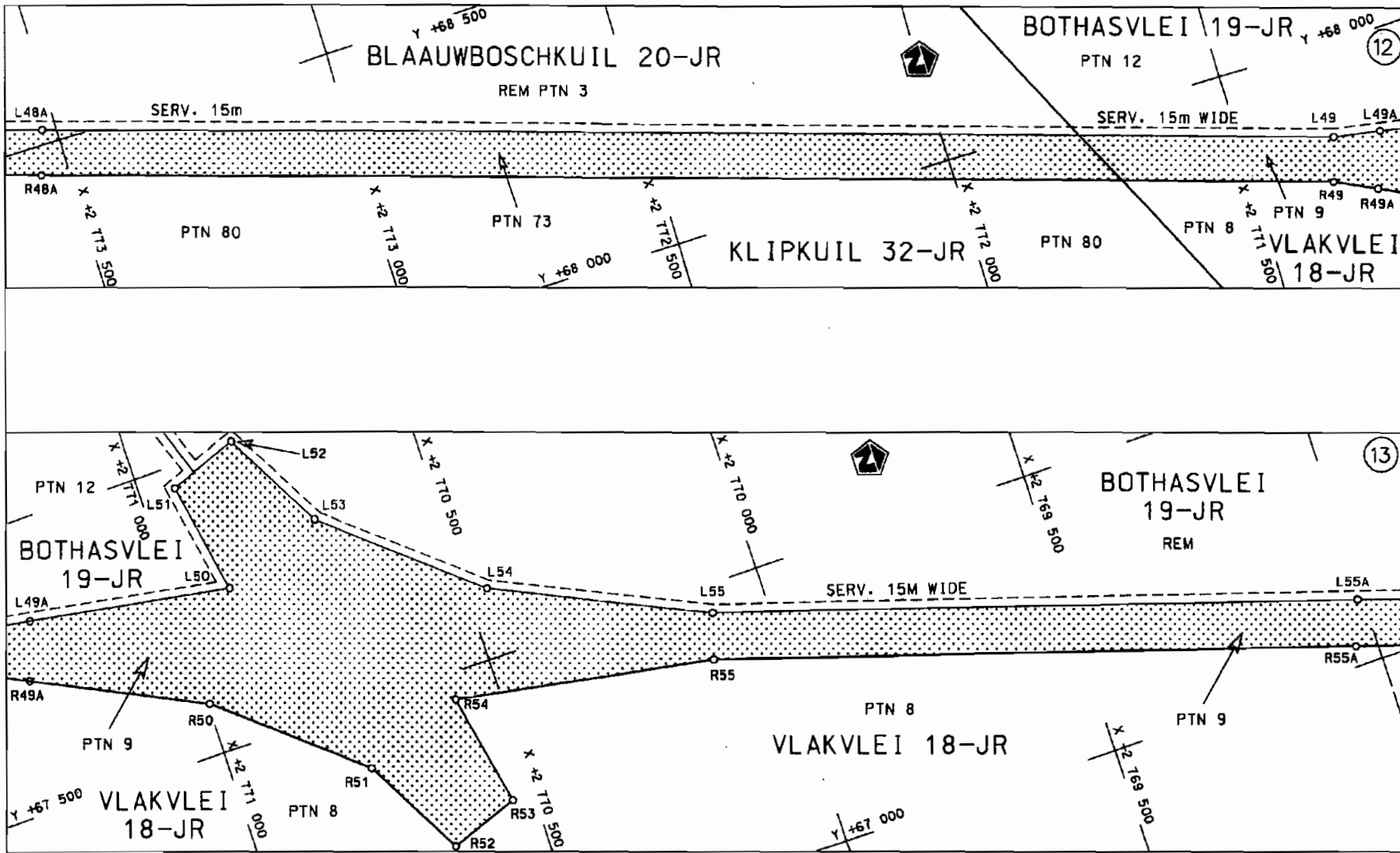

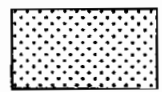
Die Suid Afrikaanse Nasionale Padagentskap Beperk The South African National Roads Agency Limited	Die figuur getoon The figure shown		staldie padreserwe voor van 'n gedeelte represents the road reserve of a portion van Nasionale Roete N1 Sektie of National Route Section	23	Vel Sheet 6 van of 13	Plan P586/06
--	---------------------------------------	--	---	----	-----------------------------	--------------

D.O.9.A

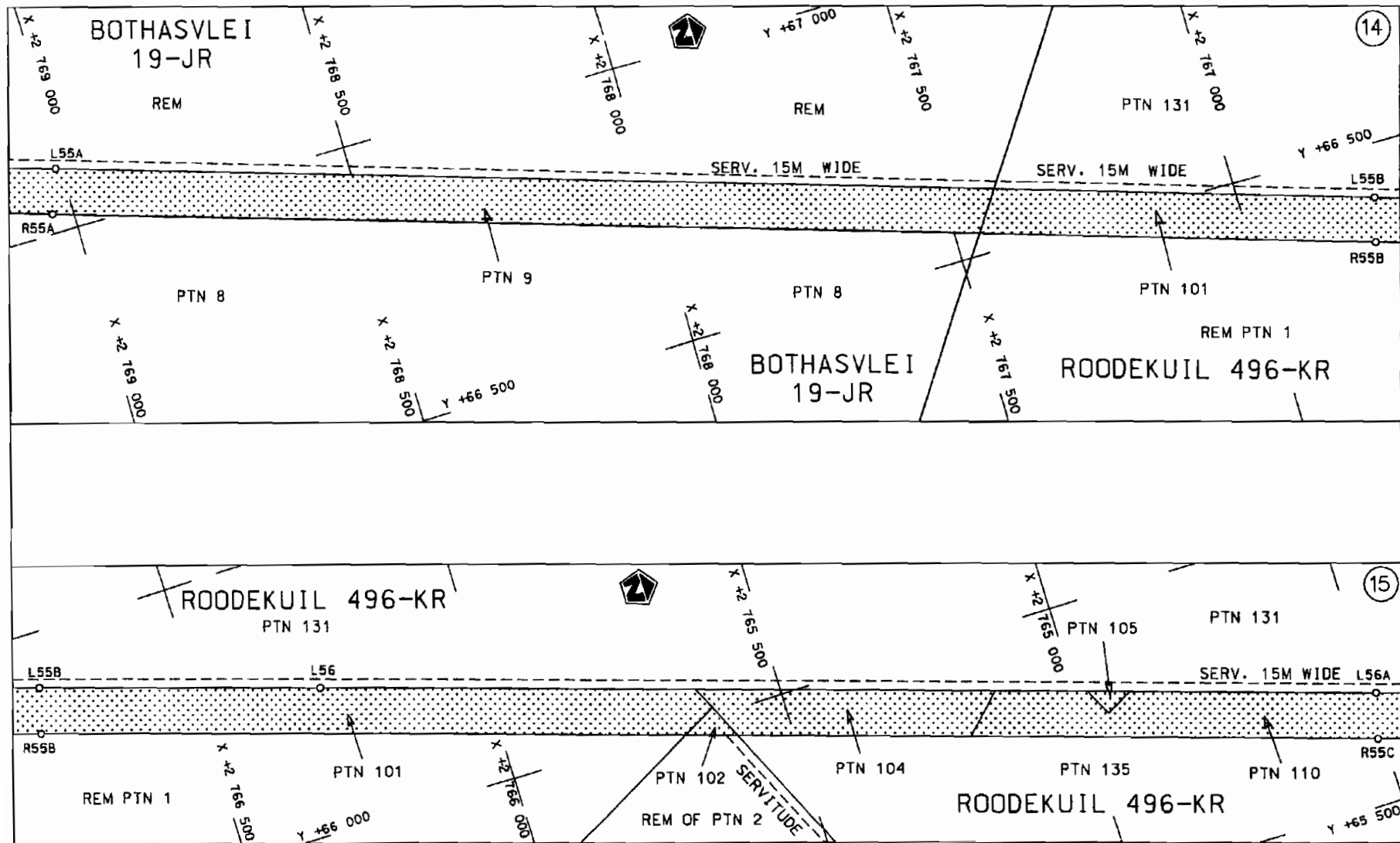

STAATSKOERANT, 24 AUGUSTUS 2007

No. 30196 11

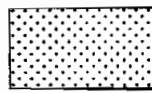
Die Suid Afrikaanse Nasionale Padagentskap Beperk The South African National Roads Agency Limited	Die figuur getoon The figure shown		steldie padreserwe voor van 'n gedeelte represents the road reserve of a portion van Nasionale Roete N1 Sektie of National Route Section 23	<table border="1"> <tr> <td>Vel Sheet</td> <td>7 van 13 of</td> </tr> <tr> <td>Plan</td> <td>P586/06</td> </tr> </table>	Vel Sheet	7 van 13 of	Plan	P586/06
Vel Sheet	7 van 13 of							
Plan	P586/06							

D.O.9.A

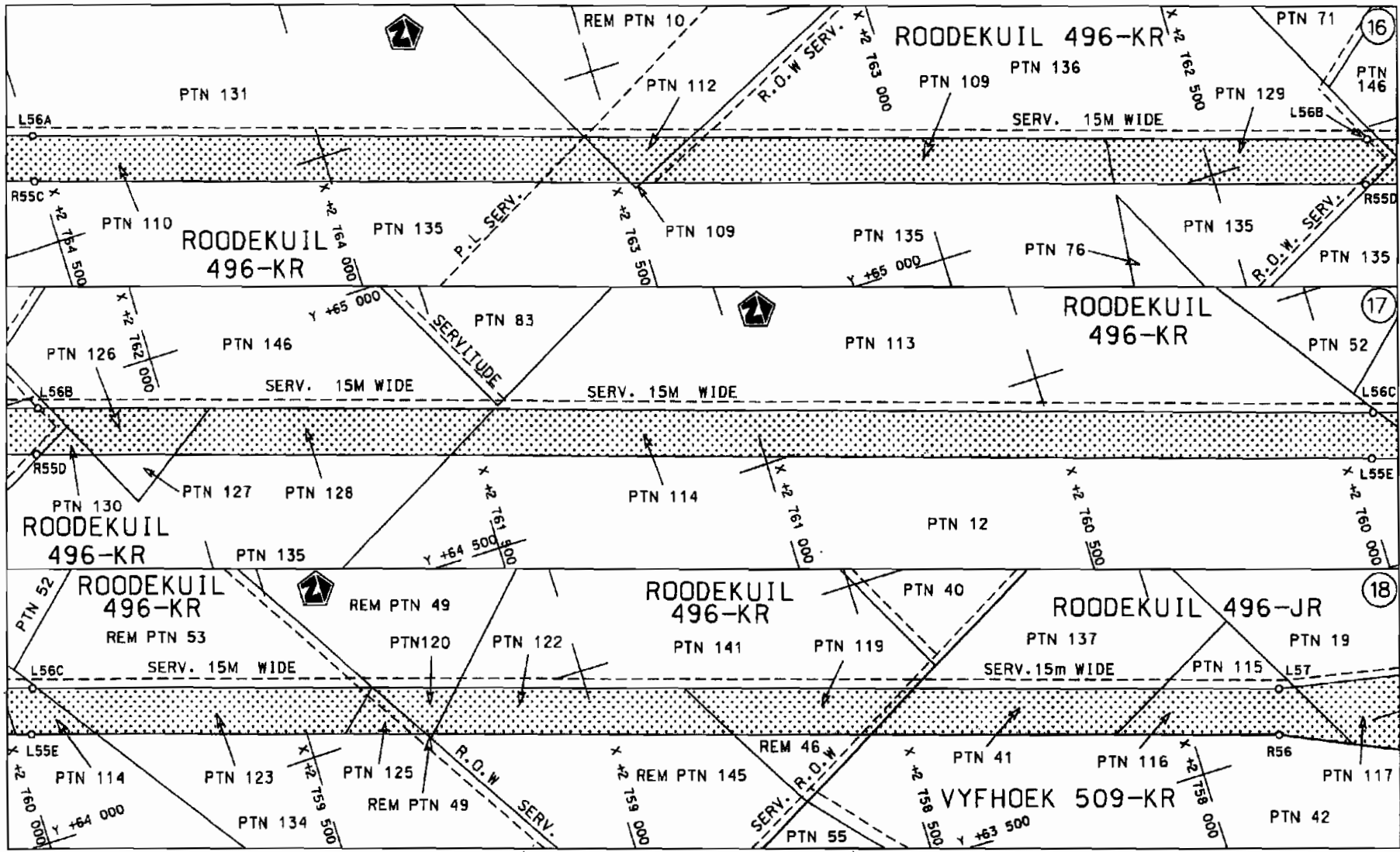

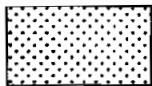
Die Suid Afrikaanse Nasionale Padagentenskap Beperk	Die figuur getoon		steldie padreserwe voor van 'n gedeelte represents the road reserve of a portion van Nasionale Roete N1 Sektie of National Route Section	Vel Sheet 8 van of 13
The South African National Roads Agency Limited	The figure shown		23	Plan P586/06

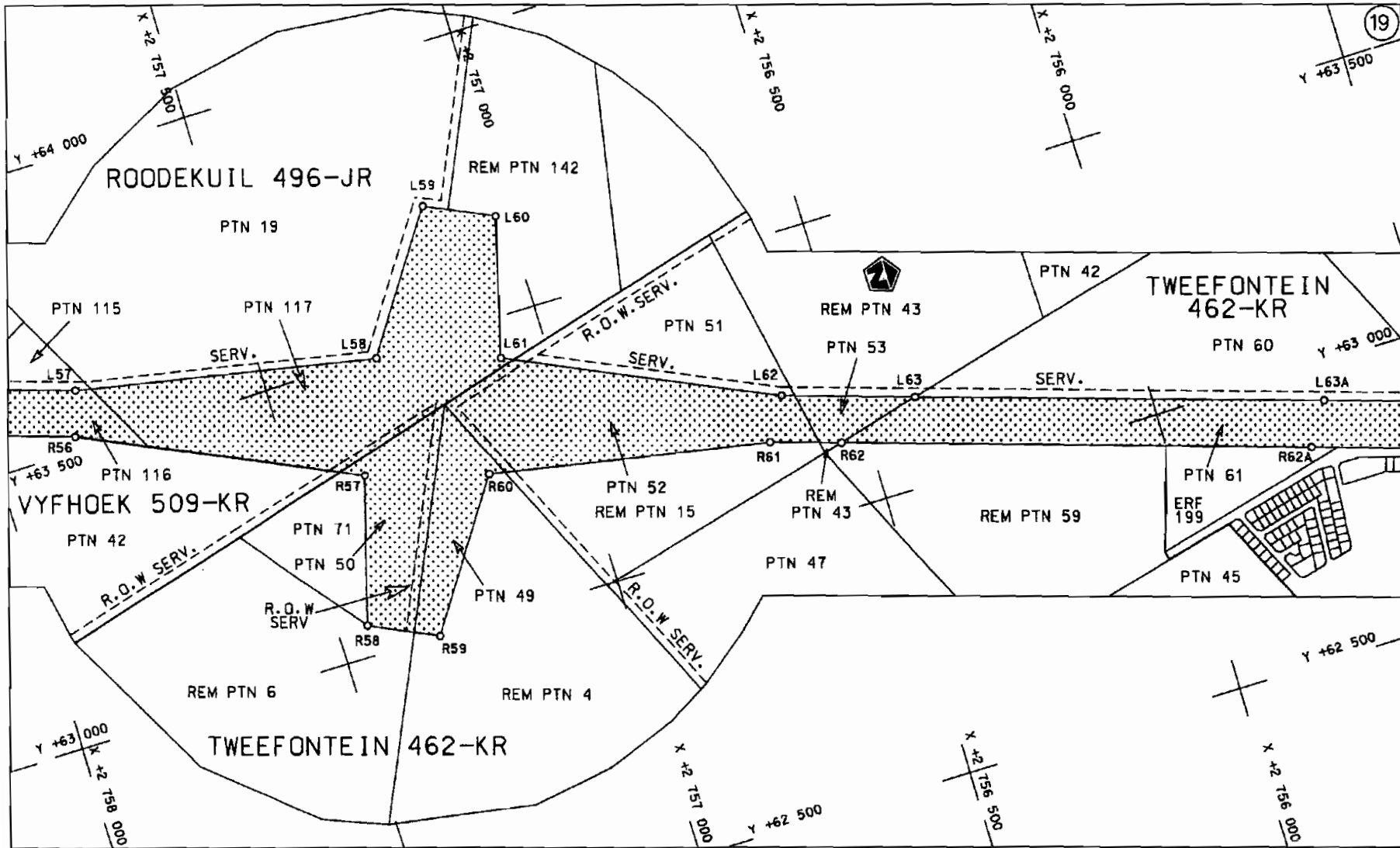

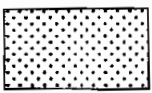
Die Suid Afrikaanse Nasionale Padagentskap Beperk The South African National Roads Agency Limited	Die figuur getoon The figure shown	 steldie padreserwe voor van 'n gedeelte represents the road reserve of a portion van Nasionale Roete N1 Seksie of National Route Section 23	Vel Sheet 9 van of 13 Plan P586/06
--	---------------------------------------	---	---

D.O.9.A

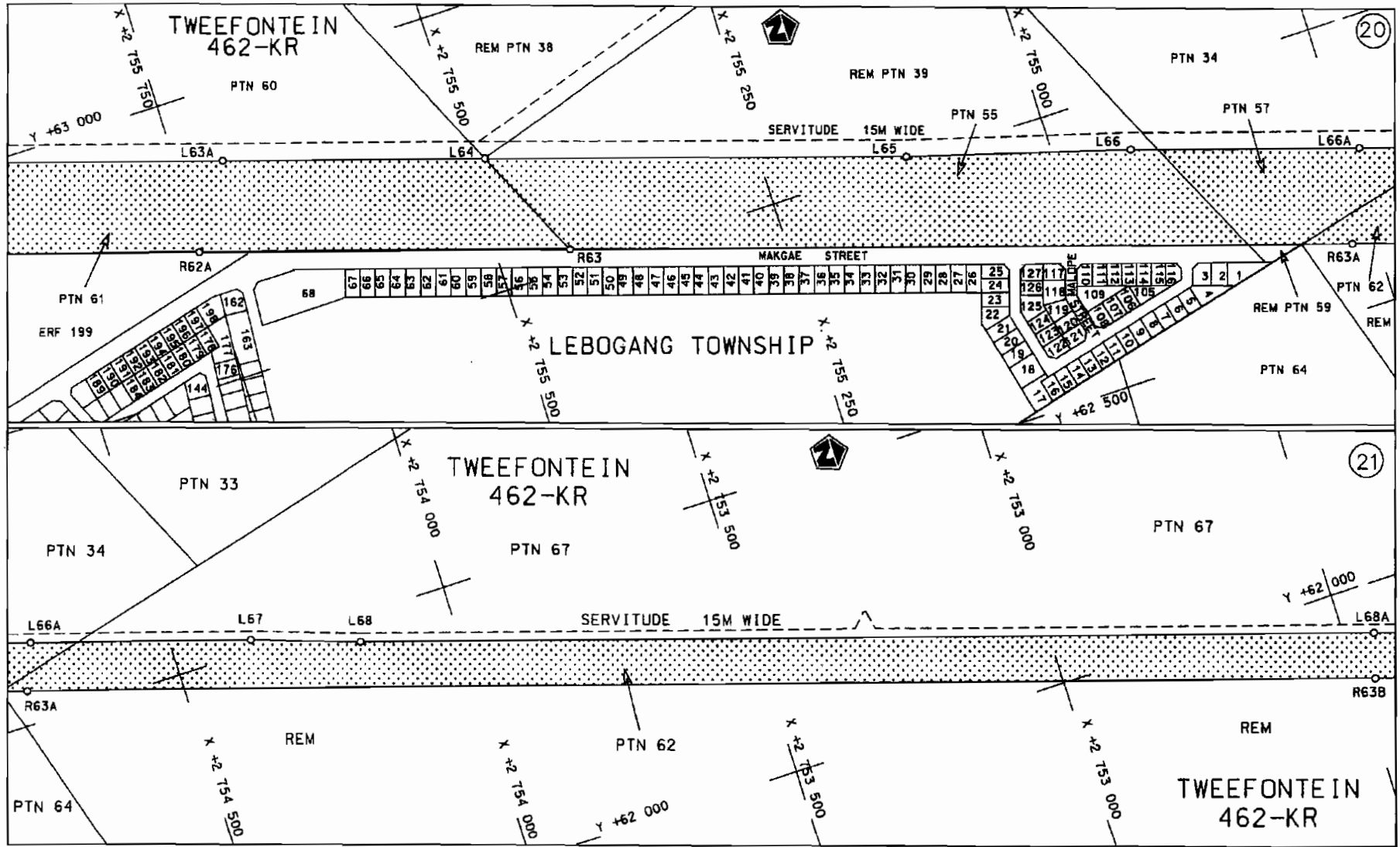

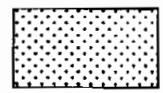
<p>Die Suid Afrikaanse Nasionale Padagentskap Beperk The South African National Roads Agency Limited</p>	<p>Die figuur getoon The figure shown</p> 	<p>steldie padreserwe voor van 'n gedeelte represents the road reserve of a portion van Nasionale Roete N1 Seksie Section of National Route 23</p>	<p>Vel Sheet 10 van of 13 Plan P586/06</p>
--	--	--	--

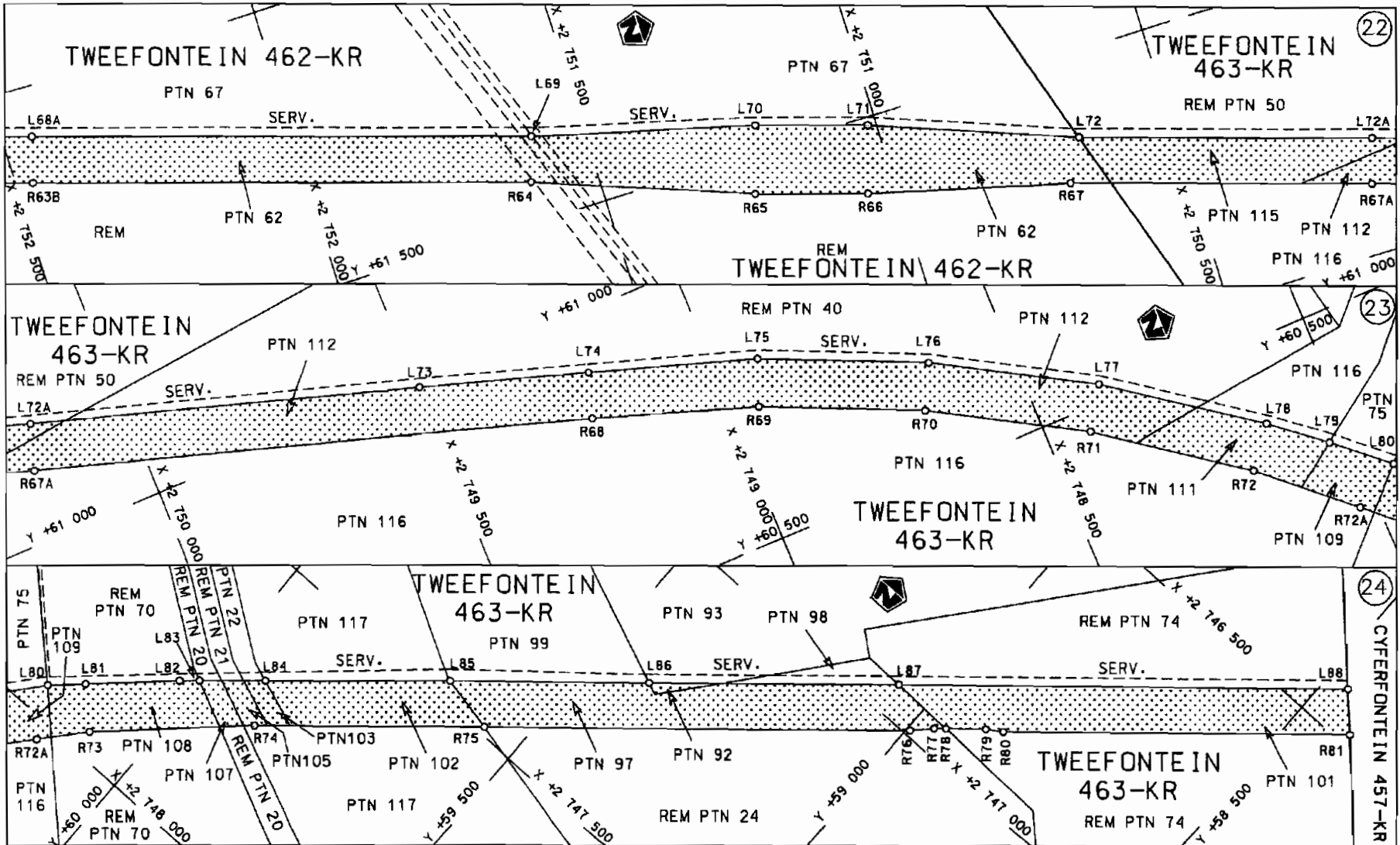

STAATSKOERANT, 24 AUGUSTUS 2007

No. 30196 15

Die Suid Afrikaanse Nasionale Padagentakap Beperk
The South African National Roads Agency Limited

Die figuur getoon
The figure shown

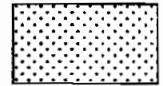

steldie padreserwe voor van 'n gedeelte
represents the road reserve of a portion
van Nasionale Roete N1 Seksie
of National Route Section

Vel Sheet 11 van 13
Plan P586/06

23

D.O.9.A

PADRESERWE KOORDINATE / ROAD RESERVE CO-ORDINATES						
LINKERKANT/LEFT HAND SIDE			REGTERKANT/RIGHT HAND SIDE			
	Y	X	WG29°	Y	X	
L1	70727.111	2 798 750.425		R1	70663.632	2798850.865
L2	70727.00	2 798 687.285		R2	70663.420	2798687.316
L3	70726.867	2 798 361.107		R3	70663.318	2 798 464.807
L4	70739.675	2798142.508		R4	70651.266	2 798 191.878
L5	70762.544	2798006.848		R5	70623.885	2 797 993.130
L6	70815.927	2 797 881.957		R6	70549.423	2 797 798.551
L7	70917.195	2797701.816		R7	70515.263	2797732.742
L8	70919.854	2797643.937		R8	70465.472	2 797 648.863
L9	70920.464	2797550.867		R9	70316.263	2797679.724
L10	71 078.393	2797512.476		R10	70308.163	2797642.814
L11	71 070.322	2797475.516		R11	70463.466	2 797 605.870
L12	70905.463	2 797 508.867		R12	70466.675	2 797 511.291
L13	70871.263	2 797 422.468		R13	70468.784	2 797 465.121
L14	70789.882	2 797265.559		R14	70546.293	2 797 301.371
L15	70721.601	2 797 103.270		R15	70593.522	2797 170.281
L16	70688.100	2796931.061		R16	70607.261	2 797 039.211
L17	70661.455	2 796 653.063		R17	70610.049	2796839.592
L18	70596.777	2 795 667.294		R18	70531.367	2795641.494
L19	70278.721	2790859.420		R19	70215.061	2 790 863.611
L20	70197.875	2789633.578		R20	70149.657	2 789 868.907
L21	70199.853	2789477.428		R21	70123.704	2789587.259
L22	70239.500	2 789 364.626		R22	70077.802	2789427.197
L23	70361.378	2789230.456		R23	70015.432	2 789 346.378
L24	70355.458	2789140.957		R24	69908.692	2 789 273.259
L25	70503.621	2 789 085.259		R25	69897.391	2789099.860
L26	70493.589	2 788 933.848		R26	69748.542	2789111.661
L27	70418.259	2788930.128		R27	69740.031	2 788 984.032
L28	70168.463	2788950.022		R28	70073.559	2788957.520
L29	70153.760	2788730.131		R29	70058.960	2 788736.431
L30	70124.159	2788518.232		R30	70069.772	2788660.586
L31	70098.157	2788123.034		R31	70060.659	2 788 522.432
L32	70082.356	2787881.136		R32	70034.557	2788127.235
L33	69 913.711	2 785 275.334		R33	70019.056	2 787 888.836
L34	69918.051	2 785 268.034		R34	69846.142	2785393.314
L35	69909.326	2785128.165		R35	69598.934	2781 647.294
L36	69905.518	2 785 070.586		R36	69568.973	2 781 268.933
L37	69661.207	2781 376.367		R37	69432.250	2 781 148.084
L38	69672.958	2781 291.758		R38	69411.164	2 780 903.933
L39	69741.187	2781 286.327		R39	69525.033	2780894.192
L40	69776.138	2781 223.542		R40	69535.765	2780 849.385
L41	69754.320	2780949.409		R41	69520.493	2 780 656.440
L42	69753.130	2 780 934.456		R42	69509.859	2780 539.760
L43	69656.594	2780942.124		R43	69154.074	2 776 688.687
L44	69614.180	2780800.950		R44	69094.413	2776167.628
L45	69203.633	2776355.297		R45	69016.621	2 775 675.449
L46	69130.411	2 775 858.908		R46	68918.389	2775186.930
L47	69025.009	2 775 266.019		R47	68799.897	2 774 702.921
L48	68839.846	2774526.031		R48	68656.406	2774 208.523
L49	67839.715	2771 337.943		R49	67763.386	2 771 361.883
L50	67765.264	2770900.153		R50	67588.314	2 770 997.584
L51	67962.254	2 770 936.803		R51	67389.254	2 770 756.485

Van 12
Sheet of

P586/06

PADRESERWE KOORDINATE / ROAD RESERVE CO-ORDINATES					
LINKERKANT/LEFT HAND SIDE			REGTERKANT/RIGHT HAND SIDE		
	Y	X	WG29	Y	X
L52	68007.213	2770814.833	R52	67211.634	2 770 660.096
L53	67830.283	2770716.563	R53	67256.593	2770538.126
L54	67618.032	2 770 464.244	R54	67454.703	2 770 578.355
L55	67450.601	2770097.545	R55	67374.271	2770121.495
L56	66253.260	2766280.926	R56	63524.781	2757851.286
L57	63601.110	2757827.335	R57	63308.065	2757 374.267
L58	63494.813	2757294.724	R58	63054.052	2757448.231
L59	63725.760	2757 137.681	R59	62999.490	2 757 330.232
L60	63671.208	2757019.683	R60	63245.998	2757163.179
L61	63430.847	2 757 084.237	R61	63153.582	2756668.150
L62	63223.932	2756625.119	R62	63115.701	2756 547.380
L63	63 152.859	2 756 398.580	R63	62767.280	2 755 436.037
L64	62866.719	2 755483.526	R64	61 569.828	2 751 618.393
L65	62753.858	2755124.869	R65	61430.984	2751 242.815
L66	62698.897	2 754 932.671	R66	61 371.042	2751 051.546
L67	62519.244	2754359.676	R67	61282.297	2750702.787
L68	62454.444	2754170.658	R68	60821.356	2749234.194
L69	61646.299	2 751 594.042	R69	60726.652	2748951.615
L70	61 545.584	2751 206.343	R70	60606.877	2748681.308
L71	61 485.551	2751 015.624	R71	60460.674	2748423.991
L72	61354.956	2 750 663.936	R72	60289.320	2 748 182.493
L73	60988.245	2749497.131	R73	60094.938	2747959.534
L74	60897.766	2749209.493	R74	59879.035	2747756.479
L75	60804.772	2748921.554	R75	59568.142	2747487.178
L76	60681.666	2748643.327	R76	58994.418	2746990.496
L77	60531343	2748378.960	R77	58964.688	2746959.425
L78	60355.220	2748130.663	R78	58948.608	2746 945.495
L79	60282.479	2748039.133	R79	58894.737	2746899.305
L80	60205.599	2747947.943	R80	58868.297	2746 882.555
L81	60 155.338	2747901.313	R81	58403.797	2746479.038
L82	60032.297	2747786.773			
L83	60005.217	2747762.773			
L84	59915.565	2 747684.528			
L85	59666.243	2747466.287			
L86	59398.698	2747234.654			
L87	59062.087	2 746 943.251			
L88	58459.134	2746421.264			

Vel	13	Van	13	P586/06
Sheet		of		