

**CONTENTS****INHOUD**

| <i>No.</i>   | <i>Page<br/>No.</i> | <i>Gazette<br/>No.</i> | <i>No.</i>  | <i>Bladsy<br/>No.</i> | <i>Koerant<br/>No.</i> |
|--|---------------------|------------------------|---|-----------------------|------------------------|
| <b>GOVERNMENT NOTICE</b>   |                     |                        | <b>GOEWERMENTSKENNISGEWING</b>  |                       |                        |
| Transport, <b>Department of</b>  |                     |                        | Vervoer, <b>Departement van</b>   |                       |                        |
| <i>Government Notice</i>   |                     |                        | <i>Goewermentskennisgewing</i>  |                       |                        |
| 750  |                     |                        | 750   |                       |                        |
| South African National Roads Agency Limited and the National Roads Act (7/1998): The South African National Roads Agency Limited: Declaration amendment of National Road N3 Section 11: Amendment of Declaration Nos. 2026 of 1990, 151 of 1983 and 22 of 1980 |                     |                        | Suid-Afrikaanse Nasionale Padagentskap Beperk en die Nasionale Paaie Wet (7/1998): Die Suid-Afrikaanse Nasionale Padagentskap Beperk: Verklaring wysiging van Nasionale Pad N3 Seksie 11: Wysiging van Verklaring Nos. 2026 van 1990, 151 van 1983 en 22 van 1980 |                       |                        |
|  | 3                   | 30199                  |   | 4                     | 30199                  |

---

**GOVERNMENT NOTICE  
GOEWERMENTSKENNISGEWING**

---

**DEPARTMENT OF TRANSPORT  
DEPARTEMENT VAN VERVOER**

No. 750

24 August 2007

**THE SOUTH AFRICAN NATIONAL ROADS  
AGENCY LIMITED**

**DECLARATION AMENDMENT OF NATIONAL ROAD N3 SECTION 11**

AMENDMENT OF DECLARATION NO'S. 2026 OF 1990, 151 OF 1983 AND 22 OF 1980

By virtue of Section 40(1)(b) of The South African National Roads Agency Limited and National Roads Act, 1998 (Act No 7 of 1998) I hereby amend declaration **No's** 2026 of 1990, 151 of 1983 and 22 of 1980 by substituting the following plan sheets and the applicable co-ordinates covered by this section of road from the common boundary between the farms Malanskraal 407 – IR and Modderfontein 410 -JR, where the N3 section 11 starts on sheet 6 of Plan P381/90, sheets 1 to 10 of Plan P334/82 over which section 11 traverses and sheets 1 to 3 of plan P303/79 up to the common boundary between the farms Tamboekiesfontein 173 – IR and Vlakplaats 138 – JR, where the N3 section 11 ends, for the subjoined sheets 1 to 14 respectively of Plan P566/06, which covers the entire N3 section 11.

**(National Road N3 Section 11: Malanskraal- Tamboekiesfontein)**

---

# DIE StUD AFRIKAANSE NASIONALE PADAGENTSKAP BEPERK

## VERKLARING WYSIGING VAN NASIONALE PAD N3 SEKSIE 11

### WYSIGING VAN VERKLARING NO'S 2026 VAN 1990, 151 VAN 1983 EN 22 VAN 1980

Kragtens artikel 40 (1)(b) van die Suid Afrikaanse Nasionale Padagentskap Beperk en Nasionale Paaie Wet (Wet No. 7 van 1998), wysig ek hiermee verklaring No's. 2026 van 1990, 151 van 1983 en 22 van 1980 deur daarin die volgende plan velie en die toepaslike koördinate wat deur hierdie gedeelte pad gedek word, vanaf die gemeenskaplike grens tussen die plase Malanskraal 407 - IR en Modderfontein 410 - JR, waar die N3 seksie 11 begin op vel 6 van Plan P381/90, velie 1 tot 10 van Plan P334/82 waar oor seksie 11 strek en velie 1 tot 3 van Plan P303/1979 tot by die gemeenskaplike grens tussen plase Tambaekiesfontein 173 - IR en Vlakplaats 138 - IR, waar die N3 seksie 11 eindig, te vervang deur bygaande velie 1 tot 14 van Plan P566/06, wat die N3 seksie 11 in sy geheel dek.

(Nasionale Pad N3 Seksie 11: Malanskraal- Tamboekiesfontein)



MINISTER OF TRANSPORT

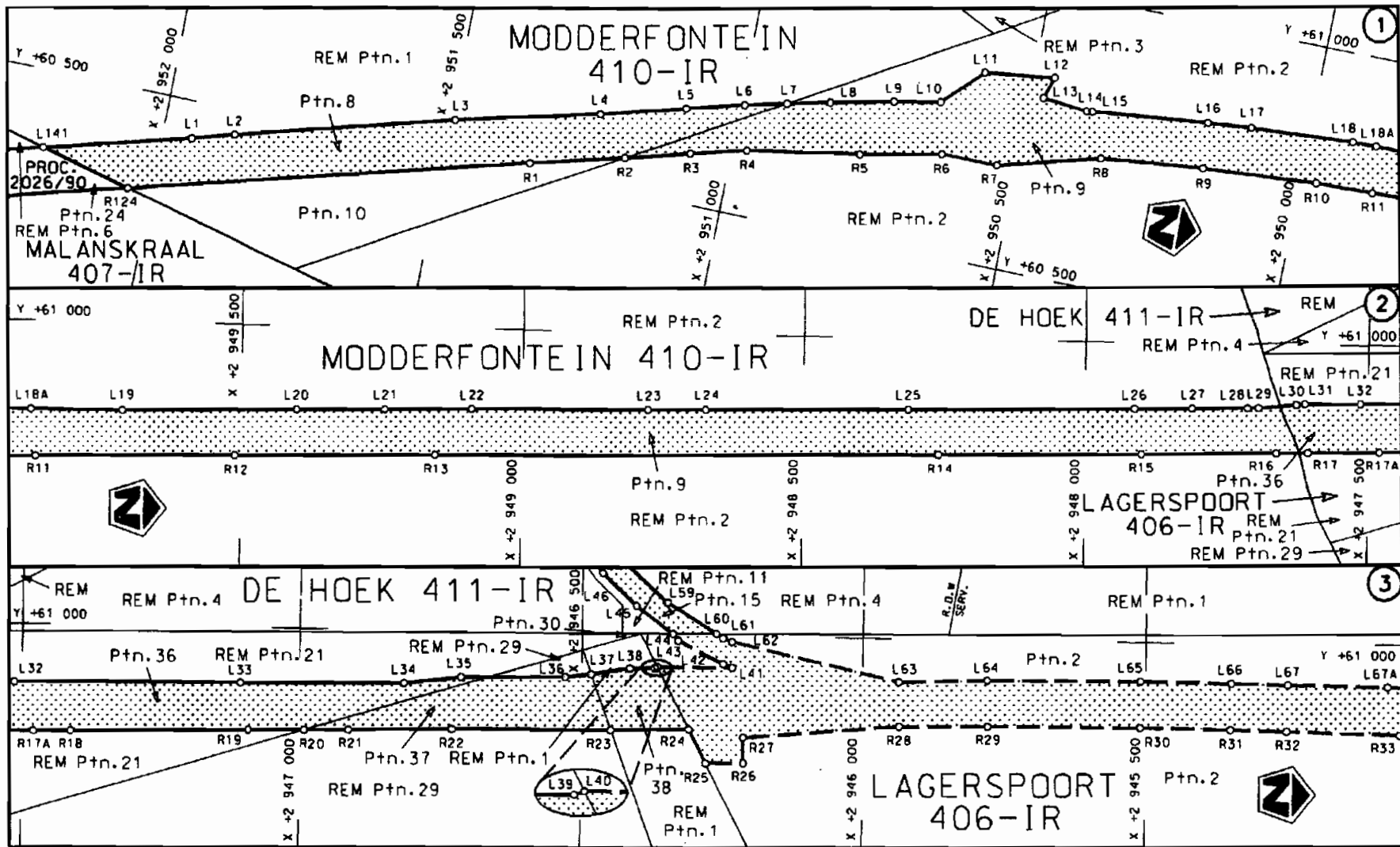

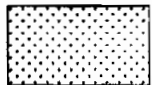
|  |                                       |  |  |                                    |
|--|---------------------------------------|--|--|------------------------------------|
| Die Suid Afrikaanse Nasionale Padagentskap Beperk<br>The South African National Roads Agency Limited | Die figuur getoon<br>The figure shown |  | steldie padreserwe voor van 'n gedeelte<br>represents the road reserve of a portion<br>von Nasionale Rôete N3 Seksie 11<br>of National Route Section | Vel Sheet 1 van 14<br>Plan P566/06 |
|--|---------------------------------------|--|--|------------------------------------|

D.O.9.A

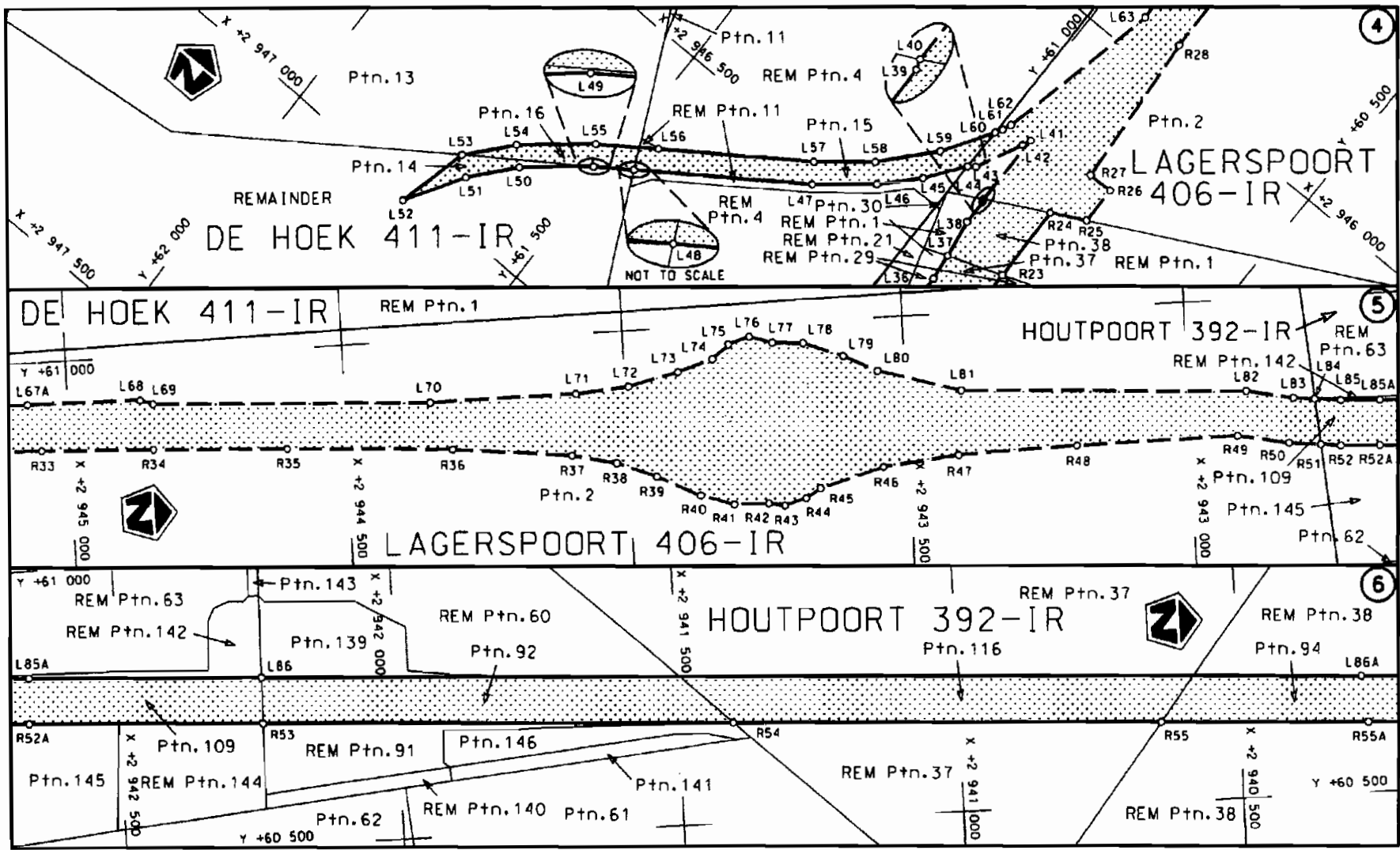

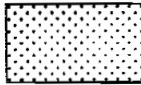
|  |  |   |  |
|--|--|---|--|
| <p>Die Suid Afrikaanse Nasionale Padagentskop Beperk<br/>The South African National Roads Agency Limited</p> | <p>Die figuur getoon<br/>The figure shown</p>  | <p>steldie padreserwe voor van 'n gedeelte<br/>represents the road reserve of a portion<br/>van Nasionale Roete<br/>of National Route</p> <p>N3</p> <p>Seksie<br/>Section</p> <p>11</p> | <p>Vel<br/>Sheet</p> <p>2<br/>of</p> <p>14</p> <p>Plan<br/>P566/06</p> |
|--|--|---|--|

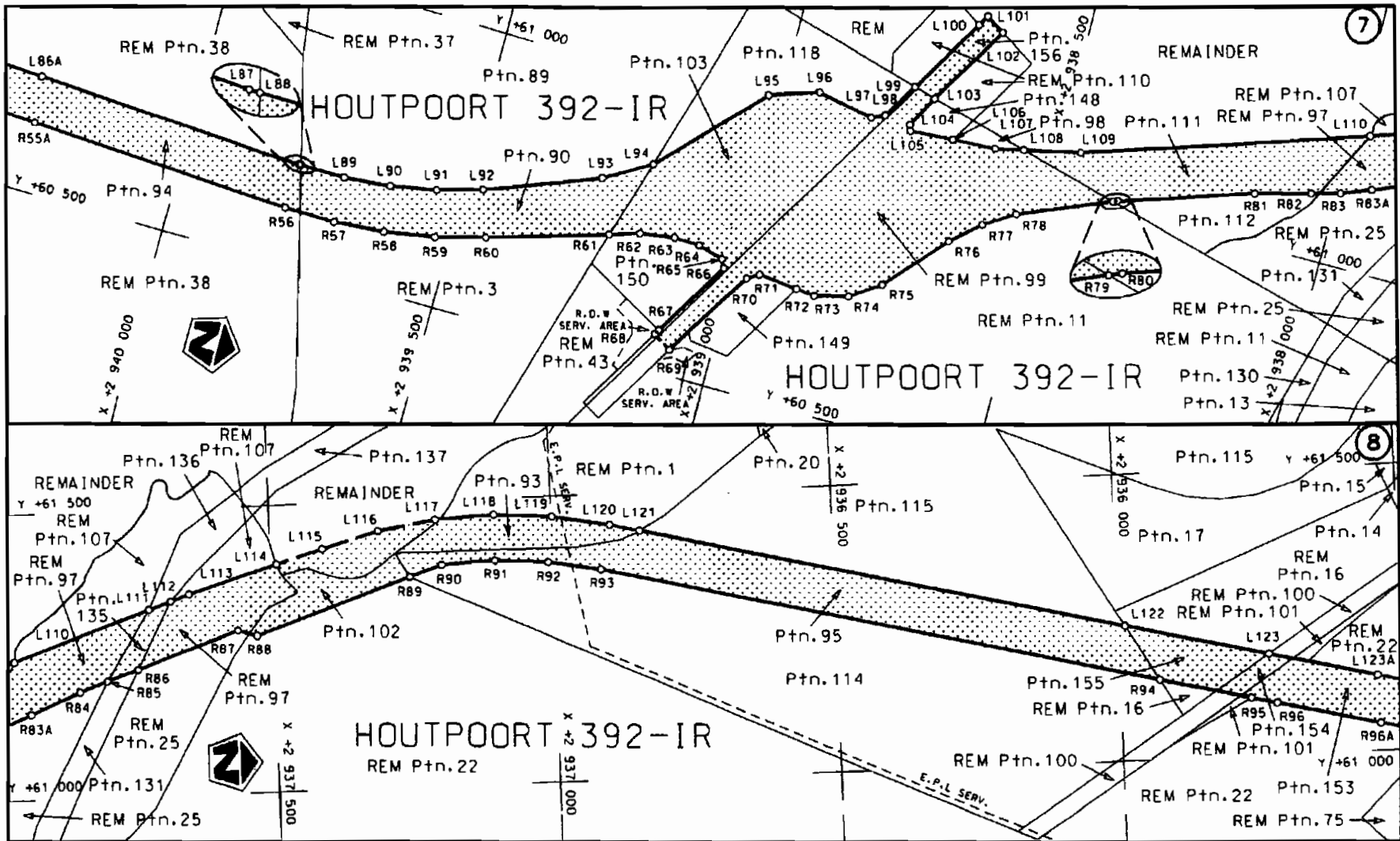

|  |   |  |  |           |                                      |                         |
|--|---|--|--|-----------|--------------------------------------|-------------------------|
| <p>Die Suid Afrikaanse Nasionale Padagentskap Beperk<br/>The South African National Roads Agency Limited</p> | <p>Die figuur getoon<br/>The figure shown</p> |  | <p>stel die padreserwe voor van 'n gedeelte<br/>represents the road reserve of a portion<br/>van Nasionale Roete<br/>of National Route</p> | <p>N3</p> | <p>Vel<br/>Sheet 3 van<br/>of 14</p> | <p>Plan<br/>P566/06</p> |
|--|---|--|--|-----------|--------------------------------------|-------------------------|

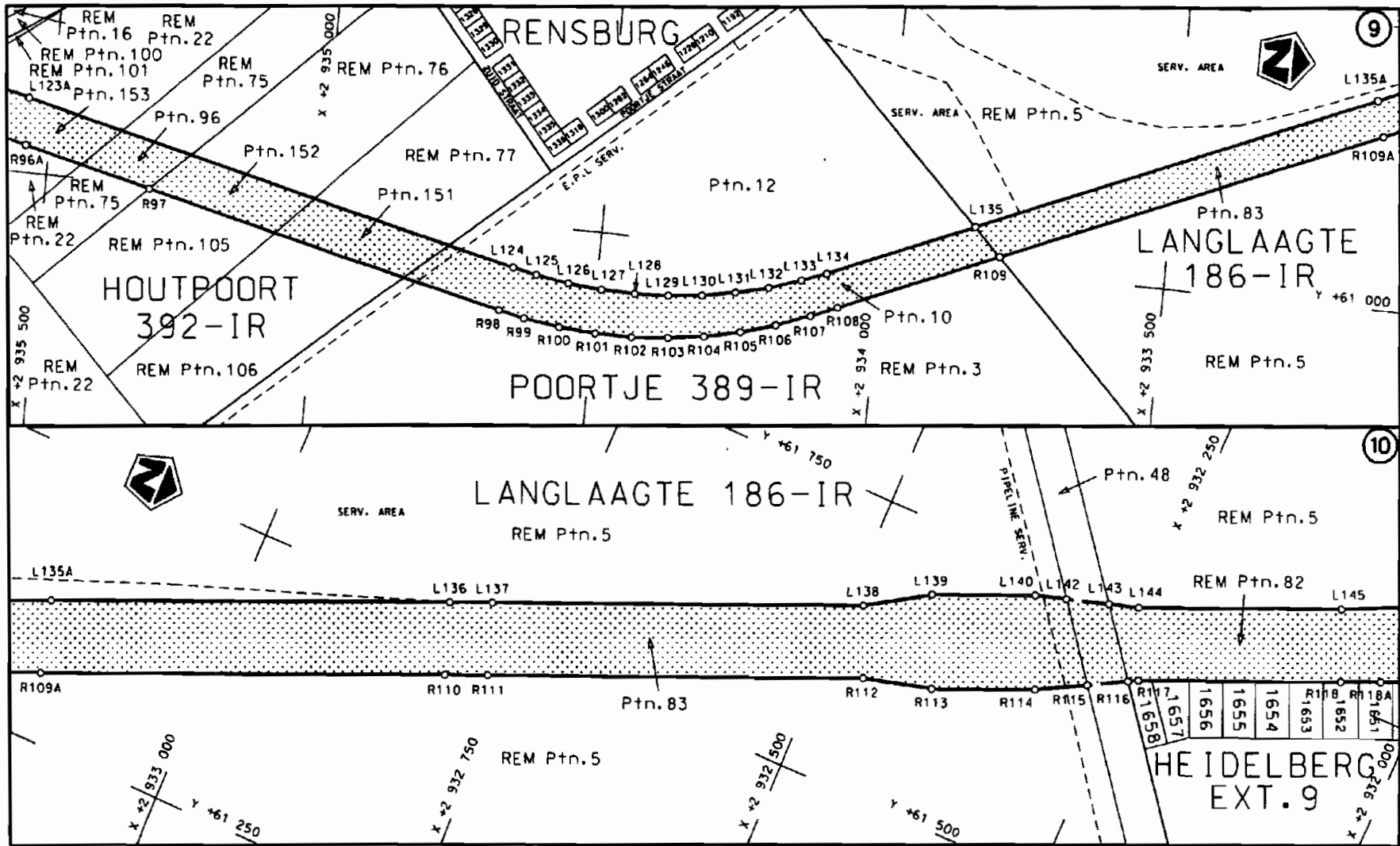

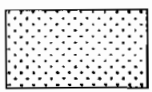
|  |  |  |  |
|--|--|--|--|
| <p>Die Suid Afrikaanse Nasionale Padagentskap Beperk<br/>The South African National Roads Agency Limited</p> | <p>Die figuur getoon<br/>The figure shown</p>  | <p>steldie padreserwe voor van 'n gedeelte<br/>represents the road reserve of a portion<br/>van Nasionale Roete N3<br/>of National Route N3</p> <p>Seksie 11<br/>Section</p> | <p>Vel 4 van 14<br/>Sheet of</p> <p>Plan P566/06</p> |
|--|--|--|--|

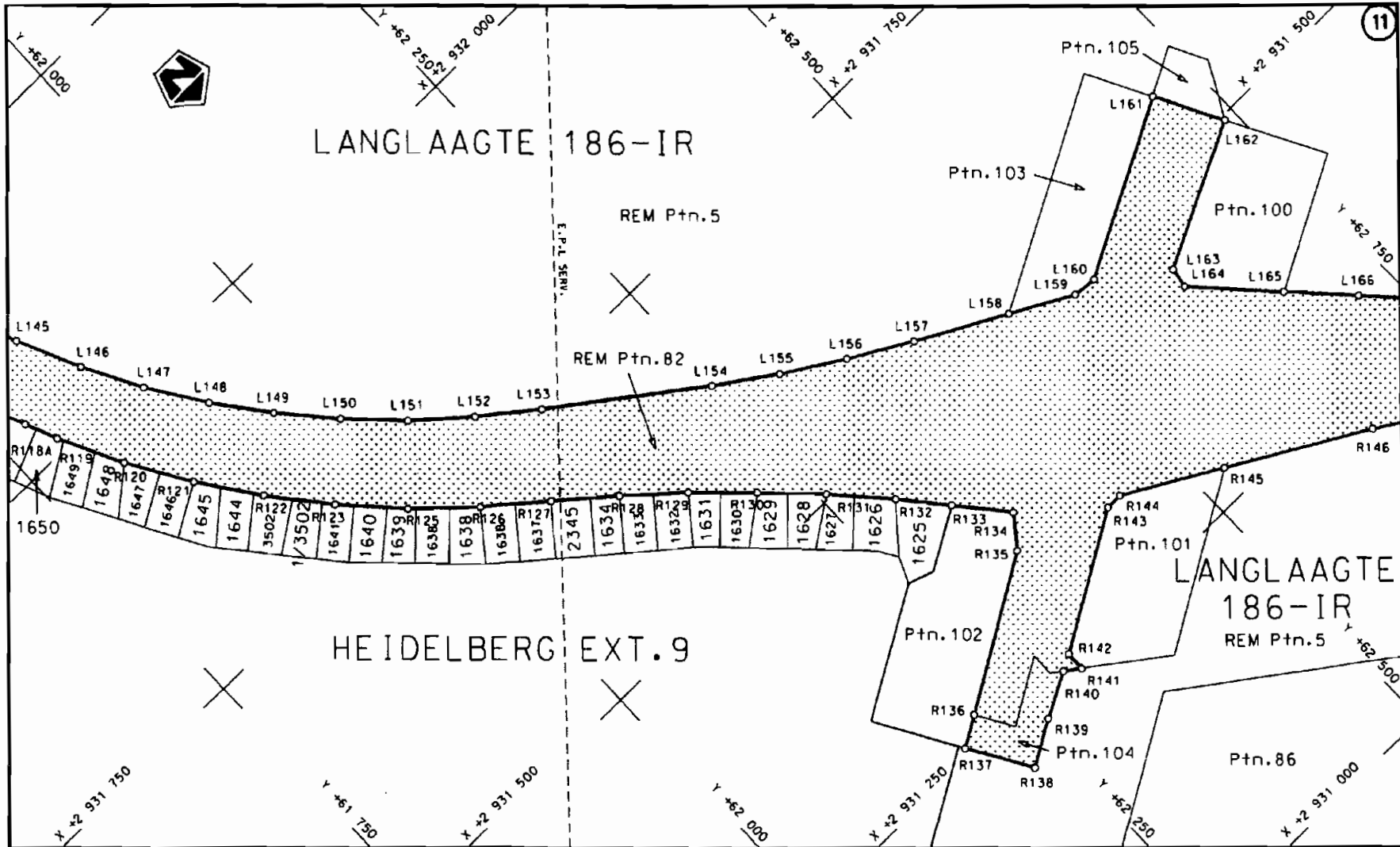

|  |                                       |  |                                       |
|--|---------------------------------------|--|---------------------------------------|
| Die Suid Afrikaanse Nasionale Padogentskap Beperk<br>The South African National Roads Agency Limited | Die figuur getoon<br>The figure shown | <br>steldie padreserwe voor van 'n gedeelte<br>represents the road reserve of a portion<br>van Nasionale Roete N3 Seksie<br>of National Route Section 11 | Vel Sheet 5 van of 14<br>Plan P566/06 |
|--|---------------------------------------|--|---------------------------------------|

D.O.9.A



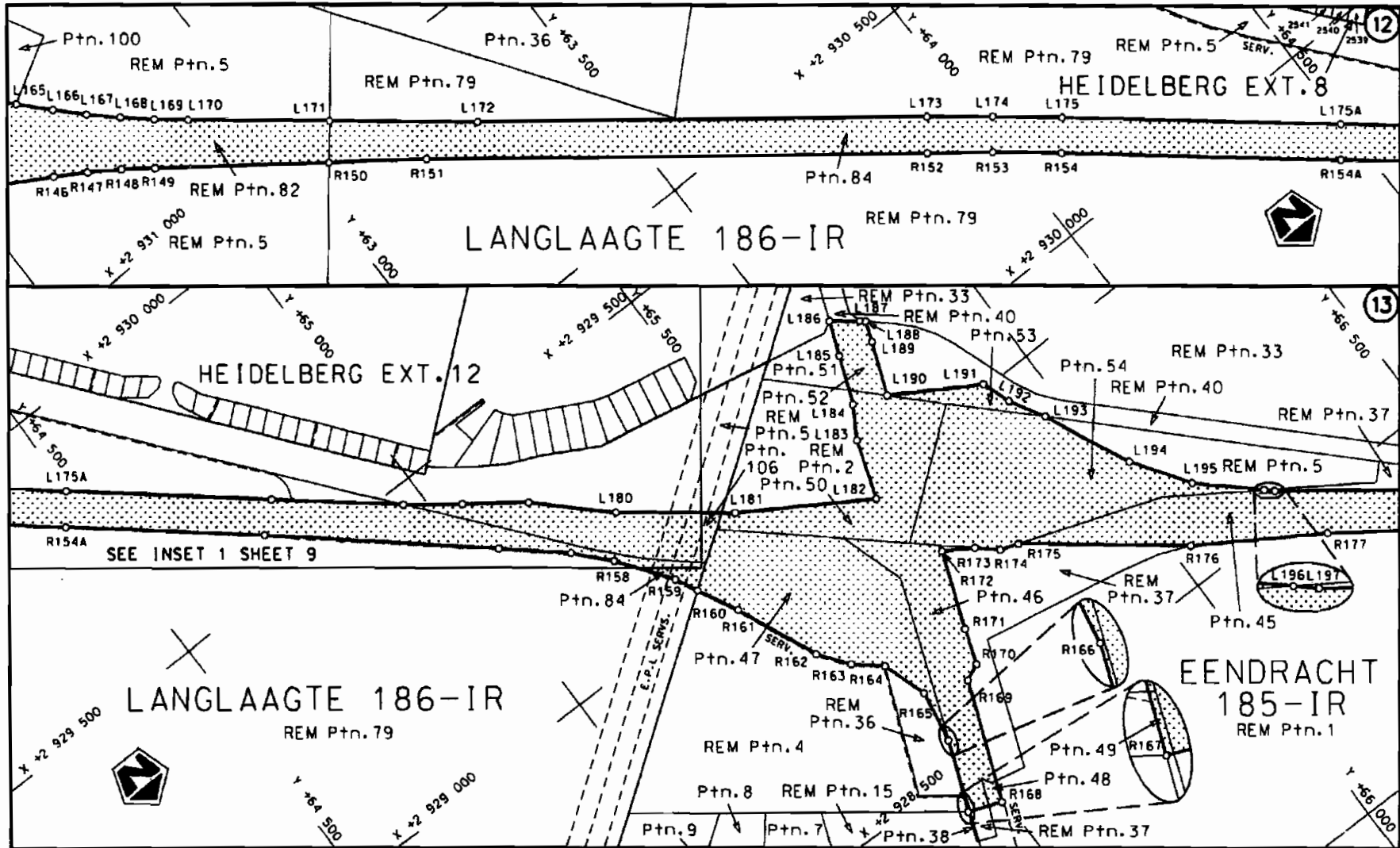

|  |   |  |                                     |
|--|---|--|-------------------------------------|
| <p>Die Suid Afrikaanse Nasionale Padagentskap Beperk<br/>The South African National Roads Agency Limited</p> | <p>Die figuur getoon<br/>The figure shown</p> | <p>steldie padreserwe voor van 'n gedeelte<br/>represents the road reserve of a portion<br/>van Nasionale Roete N3 Seksie 11<br/>of National Route N3 Section 11</p> | <p>Vel Sheet 6 van 14<br/>of of</p> |
| <p>Plan P566/06</p>  |   |  | <p>11</p>                           |

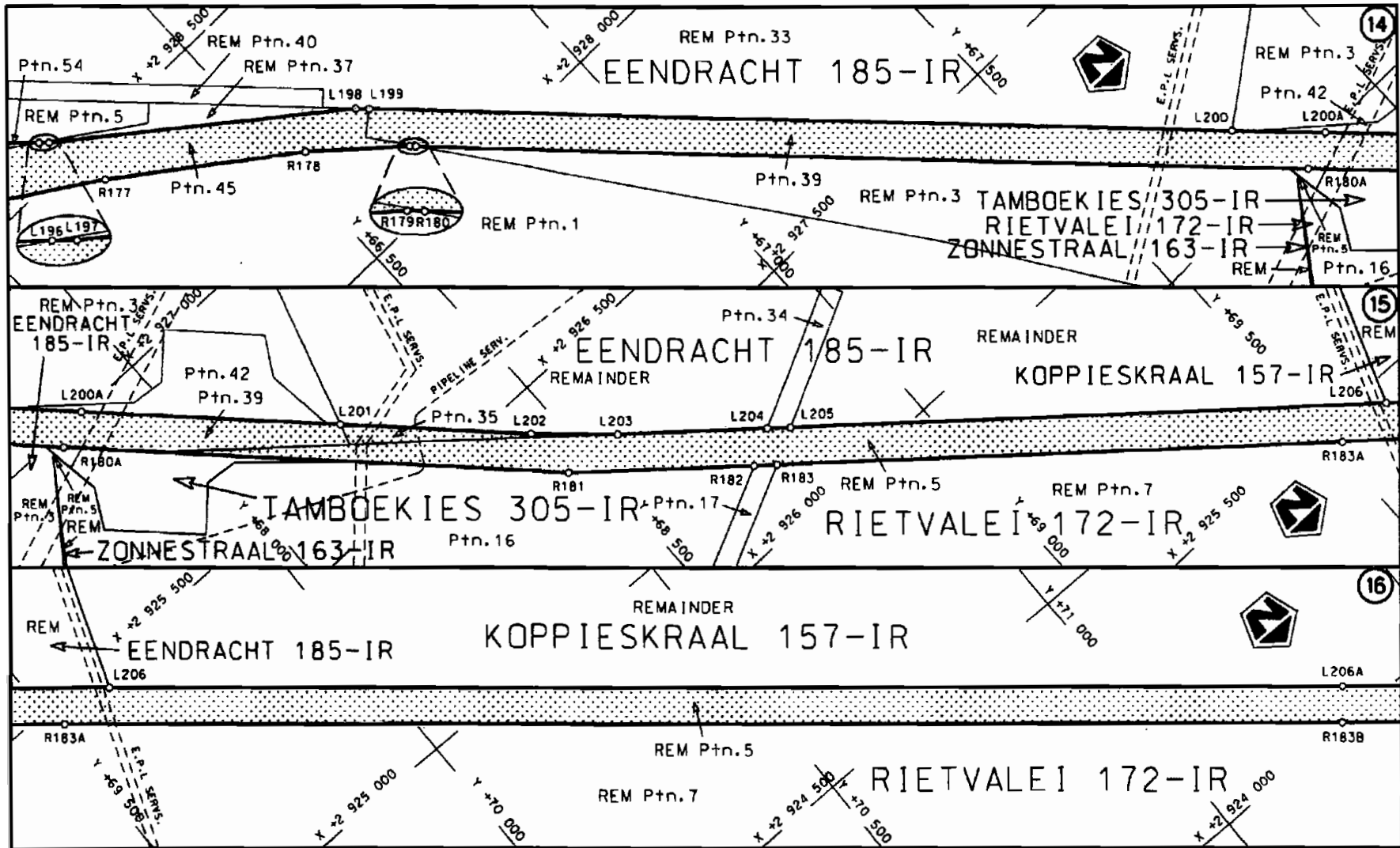

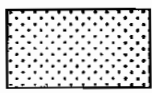
|  |                                       |  |                                    |
|--|---------------------------------------|--|------------------------------------|
| Die Suid Afrikaanse Nasionale Padagentskap Beperk<br>The South African National Roads Agency Limited | Die figuur getoon<br>The figure shown |  steld die padreserwe voor van 'n gedeelte<br>represents the road reserve of a portion<br>van Nasionale Roete N3<br>of National Route N3 | Vel Sheet 7 van 14<br>Plan P566/06 |
| 11   |                                       |  | 11                                 |

D.O.9.A

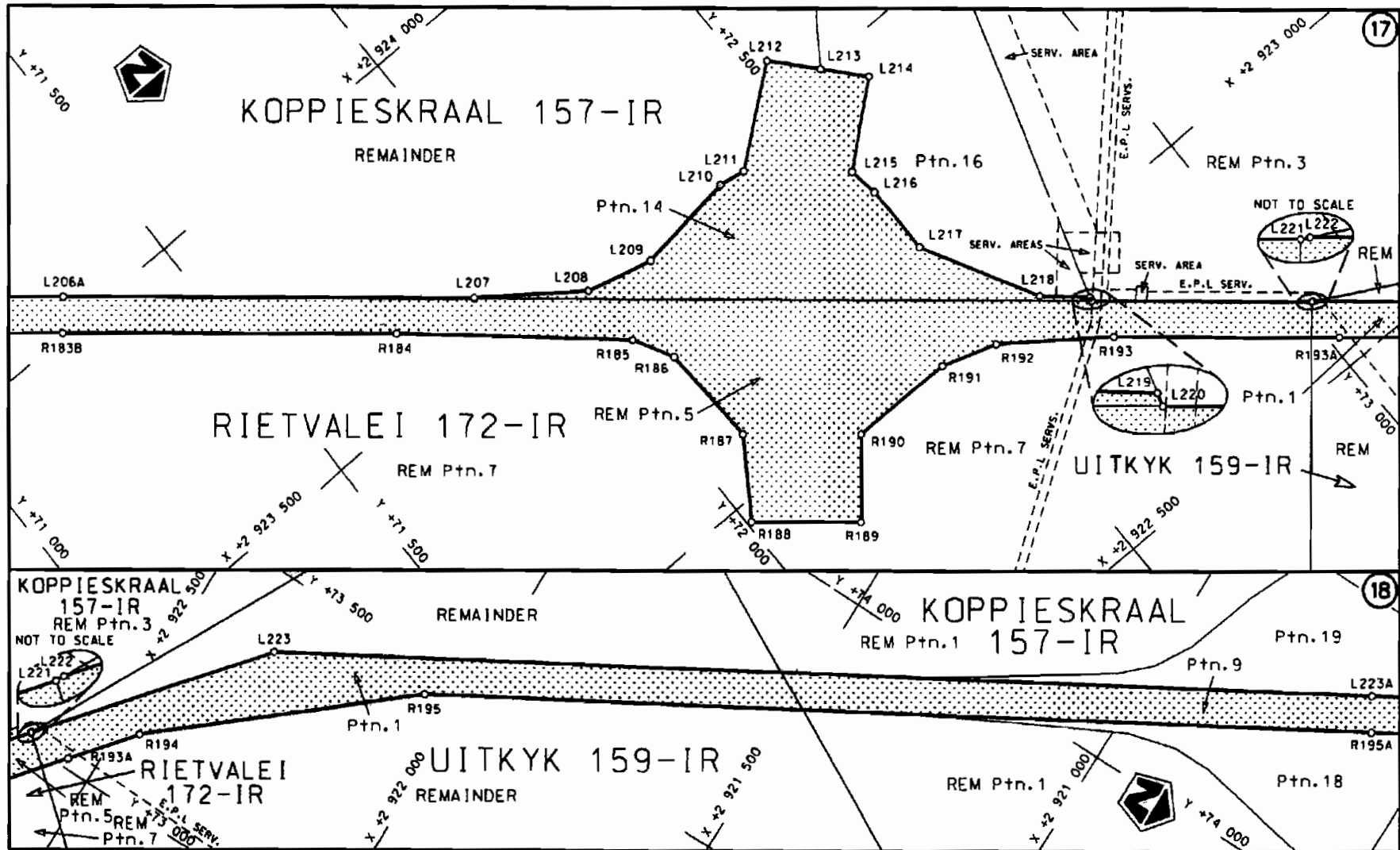

|  |                          |  |                              |
|--|--------------------------|--|------------------------------|
| <p>Die Suid Afrikaanse Nasionale Padagentskap Beperk</p> | <p>Die figuur getoon</p> | <p>steldie padreserwe voor van 'n gedeelte<br/>represents the road reserve of a portion<br/>van Nasionale Roete N3</p> | <p>Vel Sheet 8 van of 14</p> |
| <p>The South African National Roads Agency Limited</p>   | <p>The figure shown</p>  | <p>Seksie Section 11</p>   | <p>Plan P566/06</p>          |

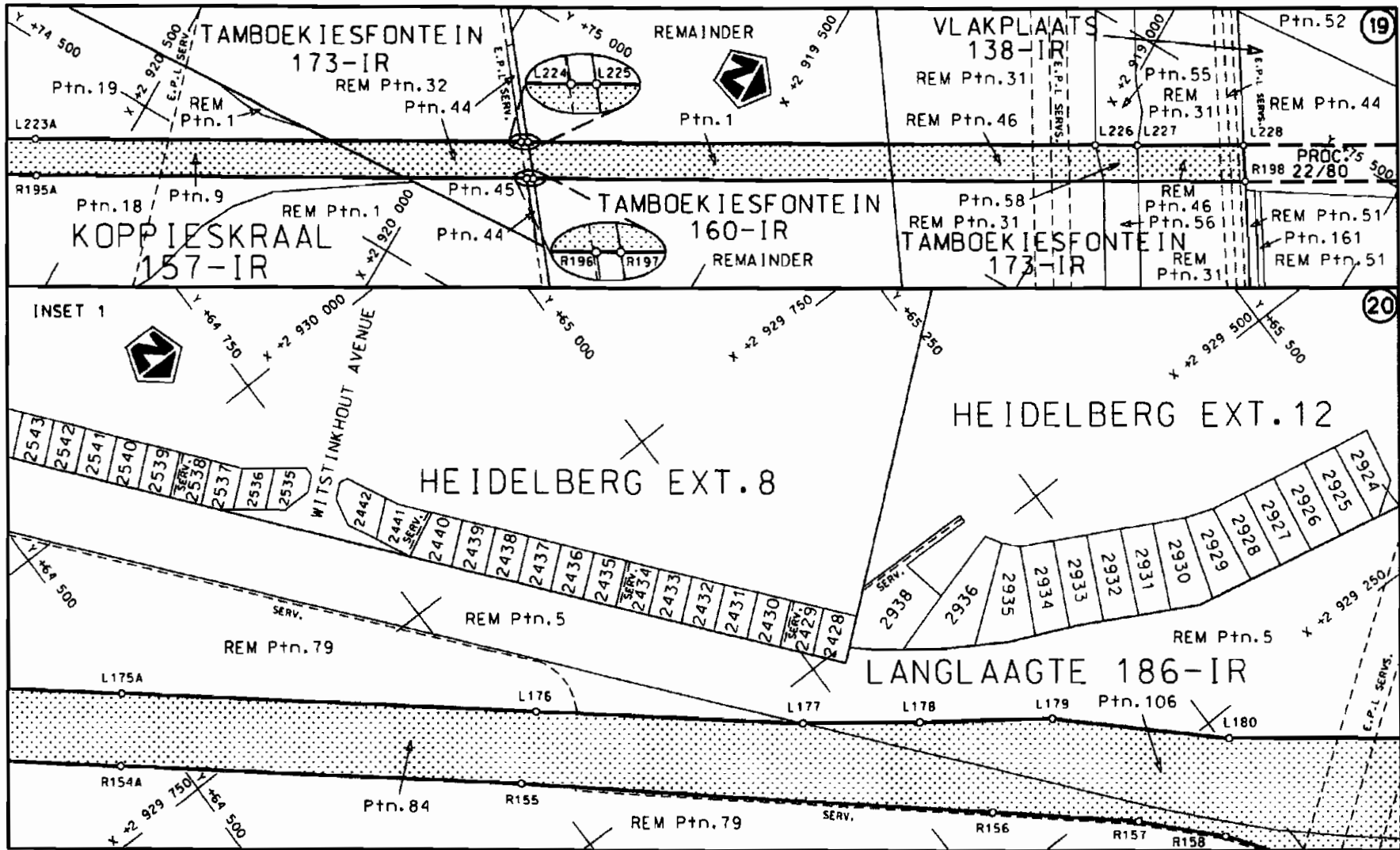

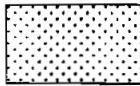
|  |                                       |  |                                    |
|--|---------------------------------------|--|------------------------------------|
| Die Suid Afrikaanse Nasionale Padogentskap Beperk<br>The South African National Roads Agency Limited | Die figuur getoon<br>The figure shown |  steldie padreserwe voor van 'n gedeelte<br>represents the road reserve of a portion<br>von Nasionale Roete N3<br>of National Route N3 | Vel Sheet 9 van 14<br>Plan P566/06 |
|--|---------------------------------------|--|------------------------------------|

D.O.9.A

| PADRESERWE KOORDINATE     |            |               |    | /     | ROAD RESERVE CO-ORDINATES  |               |    |         |
|---------------------------|------------|---------------|----|-------|----------------------------|---------------|----|---------|
| LINKERKANT/LEFT HAND SIDE |            |               |    | 1     | REGTERKANT/RIGHT HAND SIDE |               |    |         |
|                           | Y          | X             | WG | 29°   | y                          | X             |    |         |
| L141                      | +60 364,25 | +2 952 204,80 |    | R124  | +60 324,75                 | +2 952 041,33 |    |         |
| L1                        | +60 434,52 | +2 951 946,51 |    | R1    | +60 514,36                 | +2 951 347,49 |    |         |
| L2                        | +60 456,67 | +2 951 872,26 |    | R2    | +60 558,52                 | +2 951 183,85 |    |         |
| L3                        | +60 562,00 | +2 951 492,39 |    | R3    | +60 589,58                 | +2 951 071,41 |    |         |
| L4                        | +60 626,09 | +2 951 242,02 |    | R4    | +60 615,41                 | +2 950 972,54 |    |         |
| L5                        | +60 666,96 | +2 951 094,46 |    | R5    | +60 649,90                 | +2 950 775,10 |    |         |
| L6                        | +60 694,50 | +2 950 993,02 |    | R6    | +60 679,27                 | +2 950 632,65 |    |         |
| L7                        | +60 712,35 | +2 950 919,55 |    | R7    | +60 679,89                 | +2 950 533,87 |    |         |
| L8                        | +60 729,66 | +2 950 844,71 |    | R8    | +60 729,41                 | +2 950 354,11 |    |         |
| L9                        | +60 754,24 | +2 950 733,52 |    | R9    | +60 747,89                 | +2 950 173,36 |    |         |
| L10                       | +60 770,33 | +2 950 653,16 |    | R10   | +60 761,52                 | +2 949 971,05 |    |         |
| L11                       | +60 836,61 | +2 950 586,75 |    | R11   | +60 763,75                 | +2 949 870,39 |    |         |
| L12                       | +60 853,09 | +2 950 462,41 |    | R12   | +60 771,46                 | +2 949 511,20 |    |         |
| L13                       | +60 814,20 | +2 950 475,51 |    | R13   | +60 779,29                 | +2 949 153,88 |    |         |
| L14                       | +60 806,80 | +2 950 395,07 |    | R14   | +60 798,16                 | +2 948 260,21 |    |         |
| L15                       | +60 808,00 | +2 950 385,11 |    | R15   | +60 805,62                 | +2 947 900,11 |    |         |
| L16                       | +60 829,10 | +2 950 180,59 |    | R16   | +60 810,90                 | +2 947 661,54 |    |         |
| L17                       | +60 835,77 | +2 950 103,06 |    | R17   | +60 812,01                 | +2 947 605,53 |    |         |
| L18                       | +60 845,89 | +2 949 922,50 |    | R18   | +60 815,84                 | +2 947 411,55 |    |         |
| L19                       | +60 846,92 | +2 949 713,62 |    | R19   | +60 822,55                 | +2 947 091,51 |    |         |
| L20                       | +60 854,16 | +2 949 400,85 |    | R20   | +60 824,46                 | +2 946 991,47 |    |         |
| L21                       | +60 857,65 | +2 949 244,51 |    | R21   | +60 825,93                 | +2 946 912,47 |    |         |
| L22                       | +60 861,10 | +2 949 090,15 |    | R22   | +60 830,28                 | +2 946 728,80 |    |         |
| L23                       | +60 866,86 | +2 948 777,40 |    | R23   | +60 834,52                 | +2 946 447,58 |    |         |
| L24                       | +60 868,98 | +2 948 673,75 |    | R24   | +60 838,23                 | +2 946 309,04 |    |         |
| L25                       | +60 876,61 | +2 948 313,82 |    | R25   | +60 779,78                 | +2 946 278,43 |    |         |
| L26                       | +60 885,15 | +2 947 913,11 |    | R26   | +60 781,21                 | +2 946 211,01 |    |         |
| L27                       | +60 887,25 | +2 947 811,87 |    | R27   | +60 825,21                 | +2 946 211,94 |    |         |
| L28                       | +60 889,38 | +2 947 713,27 |    | R28   | +60 848,74                 | +2 945 934,98 |    |         |
| L29                       | +60 889,90 | +2 947 693,70 |    | R29   | +60 851,12                 | +2 945 780,06 |    |         |
| L30                       | +60 896,43 | +2 947 626,60 |    | R30   | +60 852,87                 | +2 945 509,32 |    |         |
| L31                       | +60 897,88 | +2 947 611,68 |    | R31   | +60 851,60                 | +2 945 349,91 |    |         |
| L32                       | +60 899,06 | +2 947 513,93 |    | R32   | +60 849,94                 | +2 945 250,35 |    |         |
| L33                       | +60 904,14 | +2 947 106,94 |    | R33   | +60 844,65                 | +2 945 051,18 |    |         |
| L34                       | +60 908,36 | +2 946 814,36 |    | R34   | +60 836,59                 | +2 944 849,36 |    |         |
| L35                       | +60 920,55 | +2 946 713,72 |    | R35   | +60 825,33                 | +2 944 608,79 |    |         |
| L36                       | +60 924,59 | +2 946 529,52 |    | R36   | +60 808,51                 | +2 944 312,03 |    |         |
| L37                       | +60 930,17 | +2 946 483,23 |    | R37   | +60 787,18                 | +2 944 099,62 |    |         |
| L38                       | +60 941,71 | +2 946 414,84 |    | R38   | +60 770,18                 | +2 944 020,90 |    |         |
| L39                       | +60 942,82 | +2 946 370,47 |    | R39   | +60 742,98                 | +2 943 951,64 |    |         |
| L40                       | +60 944,38 | +2 946 365,88 |    | R40   | +60 705,87                 | +2 943 875,18 |    |         |
| L41                       | +60 945,80 | +2 946 232,25 |    | R41   | +60 686,78                 | +2 943 815,19 |    |         |
| L42                       | +60 951,81 | +2 946 248,19 |    | R42   | +60 685,32                 | +2 943 753,31 |    |         |
| L43                       | +60 990,86 | +2 946 329,54 |    | R43   | +60 679,69                 | +2 943 724,72 |    |         |
| L44                       | +61 002,72 | +2 946 338,62 |    | R44   | +60 691,21                 | +2 943 686,41 |    |         |
| L45                       | +61 050,30 | +2 946 404,51 |    | R45   | +60 707,67                 | +2 943 659,63 |    |         |
| L46                       | +61 106,78 | +2 946 464,90 |    | R46   | +60 739,18                 | +2 943 546,52 |    |         |
| L47                       | +61 194,93 | +2 946 538,15 |    | R47   | +60 753,38                 | +2 943 412,11 |    |         |
| L48                       | +61 457,56 | +2 946 720,24 |    | R48   | +60 759,55                 | +2 943 201,66 |    |         |
| L49                       | +61 516,12 | +2 946 761,14 |    | R49   | +60 763,53                 | +2 942 915,17 |    |         |
| L50                       | +61 617,24 | +2 946 846,83 |    | R50   | +60 746,60                 | +2 942 824,79 |    |         |
|                           |            |               |    | Vel   | 10                         | Van           | 14 | P566/06 |
|                           |            |               |    | Sheet |                            | of            |    |         |

| PADRESERWE KOORDINATE     |            |        |        | /     | ROAD RESERVE CO-ORDINATES  |        |        |         |
|---------------------------|------------|--------|--------|-------|----------------------------|--------|--------|---------|
| LINKERKANT/LEFT HAND SIDE |            |        |        |       | REGTERKANT/RIGHT HAND SIDE |        |        |         |
|                           | y          | X      | WG     | 29°   | y                          | X      |        |         |
| L51                       | +61 679,48 | +2 946 | 921,32 | R51   | +60 741,01                 | +2 942 | 768,70 |         |
| L52                       | +61 741,03 | +2 947 | 024,04 | R52   | +60 737,47                 | +2 942 | 733,16 |         |
| L53                       | +61 709,73 | +2 946 | 895,16 | R53   | +60 714,56                 | +2 942 | 242,56 |         |
| L54                       | +61 646,06 | +2 946 | 819,18 | R54   | +60 675,32                 | +2 941 | 402,26 |         |
| L55                       | +61 538,53 | +2 946 | 727,68 | R55   | +60 639,68                 | +2 940 | 640,03 |         |
| L56                       | +61 446,86 | +2 946 | 664,23 | R56   | +60 600,32                 | +2 939 | 797,55 |         |
| L57                       | +61 218,13 | +2 946 | 505,55 | R57   | +60 599,08                 | +2 939 | 707,16 |         |
| L58                       | +61 133,63 | +2 946 | 436,14 | R58   | +60 606,34                 | +2 939 | 616,94 |         |
| L59                       | +61 057,05 | +2 946 | 348,55 | R59   | +60 621,95                 | +2 939 | 527,70 |         |
| L60                       | +61 003,78 | +2 946 | 260,95 | R60   | +60 645,81                 | +2 939 | 440,19 |         |
| L61                       | +60 996,53 | +2 946 | 248,97 | R61   | +60 710,84                 | +2 939 | 229,99 |         |
| L62                       | +60 990,32 | +2 946 | 233,19 | R62   | +60 727,50                 | +2 939 | 178,24 |         |
| L63                       | +60 925,73 | +2 945 | 936,17 | R63   | +60 737,09                 | +2 939 | 116,99 |         |
| L64                       | +60 931,11 | +2 945 | 781,30 | R64   | +60 735,85                 | +2 939 | 071,20 |         |
| L65                       | +60 932,87 | +2 945 | 509,12 | R65   | +60 723,38                 | +2 939 | 025,19 |         |
| L66                       | +60 931,59 | +2 945 | 348,84 | R66   | +60 708,43                 | +2 939 | 017,59 |         |
| L67                       | +60 929,93 | +2 945 | 248,74 | R67   | +60 571,69                 | +2 939 | 101,02 |         |
| L68                       | +60 924,62 | +2 944 | 868,53 | R68   | +60 563,11                 | +2 939 | 106,25 |         |
| L69                       | +60 916,50 | +2 944 | 845,62 | R69   | +60 543,51                 | +2 939 | 074,11 |         |
| L70                       | +60 893,21 | +2 944 | 347,95 | R70   | +60 702,02                 | +2 938 | 973,64 |         |
| L71                       | +60 895,43 | +2 944 | 086,93 | R71   | +60 714,85                 | +2 938 | 953,04 |         |
| L72                       | +60 903,73 | +2 943 | 993,64 | R72   | +60 707,84                 | +2 938 | 882,49 |         |
| L73                       | +60 924,11 | +2 943 | 904,56 | R73   | +60 704,57                 | +2 938 | 848,84 |         |
| L74                       | +60 943,08 | +2 943 | 841,49 | R74   | +60 719,73                 | +2 938 | 789,62 |         |
| L75                       | +60 966,98 | +2 943 | 811,12 | R75   | +60 755,97                 | +2 938 | 737,53 |         |
| L76                       | +60 978,50 | +2 943 | 772,82 | R76   | +60 861,71                 | +2 938 | 644,48 |         |
| L77                       | +60 965,73 | +2 943 | 732,11 | R77   | +60 906,03                 | +2 938 | 595,08 |         |
| L78                       | +60 962,11 | +2 943 | 677,37 | R78   | +60 939,99                 | +2 938 | 542,16 |         |
| L79                       | +60 936,24 | +2 943 | 607,02 | R79   | +61 008,15                 | +2 938 | 380,79 |         |
| L80                       | +60 907,59 | +2 943 | 548,00 | R80   | +61 011,34                 | +2 938 | 373,25 |         |
| L81                       | +60 866,57 | +2 943 | 401,61 | R81   | +61 089,32                 | +2 938 | 142,21 |         |
| L82                       | +60 841,31 | +2 942 | 896,44 | R82   | +61 115,53                 | +2 938 | 045,70 |         |
| L83                       | +60 825,50 | +2 942 | 813,57 | R83   | +61 129,35                 | +2 937 | 994,90 |         |
| L84                       | +60 821,89 | +2 942 | 775,91 | R84   | +61 185,34                 | +2 937 | 852,90 |         |
| L85                       | +60 817,44 | +2 942 | 729,47 | R85   | +61 202,10                 | +2 937 | 802,78 |         |
| L86                       | +60 794,63 | +2 942 | 241,23 | R86   | +61 220,69                 | +2 937 | 747,61 |         |
| L87                       | +60 680,25 | +2 939 | 793,84 | R87   | +61 282,66                 | +2 937 | 564,06 |         |
| L88                       | +60 680,25 | +2 939 | 790,50 | R88   | +61 272,26                 | +2 937 | 528,43 |         |
| L89                       | +60 680,18 | +2 939 | 710,88 | R89   | +61 365,72                 | +2 937 | 254,18 |         |
| L90                       | +60 687,88 | +2 939 | 628,40 | R90   | +61 385,37                 | +2 937 | 196,50 |         |
| L91                       | +60 703,21 | +2 939 | 546,90 | R91   | +61 389,98                 | +2 937 | 101,91 |         |
| L92                       | +60 726,04 | +2 939 | 467,24 | R92   | +61 383,95                 | +2 937 | 007,15 |         |
| L93                       | +60 804,21 | +2 939 | 268,50 | R93   | +61 367,72                 | +2 936 | 913,49 |         |
| L94                       | +60 851,85 | +2 939 | 188,02 | R94   | +61 137,98                 | +2 935 | 929,34 |         |
| L95                       | +61 024,90 | +2 939 | 021,40 | R95   | +61 100,55                 | +2 935 | 768,84 |         |
| L96                       | +61 054,19 | +2 938 | 934,69 | R96   | +61 089,98                 | +2 935 | 723,75 |         |
| L97                       | +61 036,53 | +2 938 | 834,62 | R97   | +60 994,18                 | +2 935 | 312,87 |         |
| L98                       | +61 046,86 | +2 938 | 811,57 | R98   | +60 844,03                 | +2 934 | 668,81 |         |
| L99                       | +61 109,15 | +2 938 | 773,66 | R99   | +60 834,25                 | +2 934 | 623,04 |         |
| LI00                      | +61 242,71 | +2 938 | 692,86 | R100  | +60 825,62                 | +2 934 | 558,96 |         |
| L101                      | +61 261,28 | +2 938 | 681,69 | RI01  | +60 821,29                 | +2 934 | 494,46 |         |
|                           |            |        |        | Vel   | 11                         | Van    | 14     | P566/06 |
|                           |            |        |        | Sheet |                            | of     |        |         |

| PADRESERWE KOORDINATE     |            |        |        | ROAD RESERVE CO-ORDINATES  |            |        |        |
|---------------------------|------------|--------|--------|----------------------------|------------|--------|--------|
| LINKERKANT/LEFT HAND SIDE |            |        |        | REGTERKANT/RIGHT HAND SIDE |            |        |        |
|                           | y          | X      | WG     | 29°                        | y          | X      |        |
| L102                      | +61 241,37 | +2 938 | 648,59 | R102                       | +60 820,95 | +2 934 | 429,76 |
| L103                      | +61 099,47 | +2 938 | 735,19 | R103                       | +60 826,09 | +2 934 | 365,47 |
| L104                      | +61 042,63 | +2 938 | 765,03 | R104                       | +60 834,97 | +2 934 | 301,53 |
| L105                      | +61 032,35 | +2 938 | 761,39 | R105                       | +60 849,22 | +2 934 | 238,91 |
| L106                      | +61 037,86 | +2 938 | 685,24 | R106                       | +60 867,37 | +2 934 | 177,21 |
| L107                      | +61 042,77 | +2 938 | 608,96 | R107                       | +60 888,85 | +2 934 | 117,00 |
| L108                      | +61 054,03 | +2 938 | 558,91 | R108                       | +60 908,73 | +2 934 | 070,19 |
| L109                      | +61 076,44 | +2 938 | 459,54 | R109                       | +61 027,48 | +2 933 | 793,13 |
| L110                      | +61 241,39 | +2 937 | 970,51 | R110                       | +61 451,32 | +2 932 | 804,21 |
| L111                      | +61 324,48 | +2 937 | 724,18 | R111                       | +61 466,29 | +2 932 | 769,31 |
| L112                      | +61 337,91 | +2 937 | 684,34 | R112                       | +61 598,15 | +2 932 | 462,03 |
| L113                      | +61 349,32 | +2 937 | 650,87 | R113                       | +61 614,03 | +2 932 | 402,53 |
| L114                      | +61 396,70 | +2 937 | 489,83 | R114                       | +61 650,05 | +2 932 | 318,51 |
| L115                      | +61 420,79 | +2 937 | 407,95 | R115                       | +61 672,47 | +2 932 | 277,55 |
| L116                      | +61 448,44 | +2 937 | 307,78 | R116                       | +61 689,79 | +2 932 | 245,93 |
| L117                      | +61 465,06 | +2 937 | 205,19 | R117                       | +61 694,24 | +2 932 | 237,80 |
| L118                      | +61 470,08 | +2 937 | 101,28 | R118                       | +61 765,32 | +2 932 | 072,01 |
| L119                      | +61 463,55 | +2 936 | 997,62 | R119                       | +61 792,07 | +2 932 | 010,88 |
| L120                      | +61 445,53 | +2 936 | 895,24 | R120                       | +61 821,58 | +2 931 | 954,05 |
| L121                      | +61 433,33 | +2 936 | 842,97 | R121                       | +61 855,26 | +2 931 | 899,35 |
| L122                      | +61 233,63 | +2 935 | 987,25 | R122                       | +61 892,95 | +2 931 | 847,31 |
| L123                      | +61 174,77 | +2 935 | 734,96 | R123                       | +61 933,86 | +2 931 | 797,58 |
| L124                      | +60 921,84 | +2 934 | 650,66 | R125                       | +61 977,84 | +2 931 | 750,43 |
| L125                      | +60 913,36 | +2 934 | 608,79 | R126                       | +62 025,68 | +2 931 | 707,38 |
| L126                      | +60 904,28 | +2 934 | 550,00 | R127                       | +62 075,01 | +2 931 | 668,15 |
| L127                      | +60 899,15 | +2 934 | 490,79 | R128                       | +62 122,43 | +2 931 | 629,77 |
| L128                      | +60 897,65 | +2 934 | 431,33 | R129                       | +62 168,77 | +2 931 | 589,94 |
| L129                      | +60 900,17 | +2 934 | 371,72 | R130                       | +62 213,19 | +2 931 | 547,76 |
| L130                      | +60 906,63 | +2 934 | 312,59 | R131                       | +62 256,68 | +2 931 | 504,44 |
| LUI                       | +60 917,59 | +2 934 | 254,22 | R132                       | +62 298,30 | +2 931 | 458,63 |
| L132                      | +60 931,99 | +2 934 | 196,18 | R133                       | +62 330,41 | +2 931 | 420,63 |
| L133                      | +60 950,40 | +2 934 | 139,47 | R134                       | +62 365,59 | +2 931 | 378,33 |
| L134                      | +60 967,01 | +2 934 | 095,17 | R135                       | +62 344,86 | +2 931 | 352,17 |
| L135                      | +61 075,82 | +2 933 | 841,50 | R136                       | +62 218,08 | +2 931 | 275,06 |
| L136                      | +61 511,35 | +2 932 | 825,29 | R137                       | +62 192,42 | +2 931 | 259,53 |
| L137                      | +61 526,26 | +2 932 | 790,45 | R138                       | +62 225,43 | +2 931 | 204,87 |
| L138                      | +61 656,37 | +2 932 | 486,87 | R139                       | +62 263,16 | +2 931 | 227,38 |
| L139                      | +61 689,65 | +2 932 | 434,81 | R140                       | +62 301,33 | +2 931 | 248,03 |
| L140                      | +61 725,75 | +2 932 | 350,83 | R141                       | +62 314,60 | +2 931 | 238,67 |
| L142                      | +61 733,81 | +2 932 | 324,27 | R142                       | +62 315,27 | +2 931 | 255,59 |
| L143                      | +61 744,76 | +2 932 | 288,27 | R143                       | +62 428,94 | +2 931 | 323,89 |
| L144                      | +61 752,49 | +2 932 | 262,82 | R144                       | +62 443,77 | +2 931 | 324,13 |
| L145                      | +61 823,62 | +2 932 | 097,01 | R145                       | +62 527,72 | +2 931 | 277,34 |
| L146                      | +61 850,12 | +2 932 | 040,72 | R146                       | +62 645,94 | +2 931 | 210,54 |
| L147                      | +61 879,05 | +2 931 | 988,57 | R147                       | +62 698,07 | +2 931 | 178,28 |
| L148                      | +61 912,34 | +2 931 | 939,09 | R148                       | +62 748,71 | +2 931 | 144,06 |
| L149                      | +61 949,35 | +2 931 | 892,45 | R149                       | +62 797,83 | +2 931 | 107,87 |
| L150                      | +61 988,80 | +2 931 | 847,83 | R150                       | +63 049,11 | +2 930 | 919,94 |
| L151                      | +62 030,71 | +2 931 | 805,75 | R151                       | +63 188,38 | +2 930 | 815,79 |
| L152                      | +62 076,20 | +2 931 | 767,56 | R152                       | +63 891,39 | +2 930 | 270,46 |
| L153                      | +62 124,02 | +2 931 | 731,23 | R153                       | +63 982,70 | +2 930 | 200,05 |

|       |    |     |    |         |
|-------|----|-----|----|---------|
| Vel   | 12 | Van | 14 | P566/06 |
| Sheet |    | of  |    |         |

| PADRESERWE KOORDINATE     |     |        |    | ROAD RESERVE CO-ORDINATES  |        |      |     |        |    |     |        |
|---------------------------|-----|--------|----|----------------------------|--------|------|-----|--------|----|-----|--------|
| LINKERKANT/LEFT HAND SIDE |     |        |    | REGTERKANT/RIGHT HAND SIDE |        |      |     |        |    |     |        |
|                           | Y   | X      | WG | 29 <sup>0</sup>            | y      | X    |     |        |    |     |        |
| L154                      | +62 | 247,61 | +2 | 931                        | 641,89 | R154 | +64 | 076,85 | +2 | 930 | 123,14 |
| L155                      | +62 | 298,38 | +2 | 931                        | 607,89 | R155 | +64 | 733,28 | +2 | 929 | 578,43 |
| L156                      | +62 | 350,84 | +2 | 931                        | 576,08 | R156 | +65 | 051,06 | +2 | 929 | 305,15 |
| L157                      | +62 | 404,62 | +2 | 931                        | 545,92 | R157 | +65 | 149,69 | +2 | 929 | 220,85 |
| L158                      | +62 | 481,94 | +2 | 931                        | 505,12 | R158 | +65 | 202,52 | +2 | 929 | 163,07 |
| L159                      | +62 | 535,81 | +2 | 931                        | 476,69 | R159 | +65 | 268,76 | +2 | 929 | 071,04 |
| L160                      | +62 | 557,46 | +2 | 931                        | 474,99 | R160 | +65 | 288,66 | +2 | 929 | 032,19 |
| L161                      | +62 | 707,00 | +2 | 931                        | 555,24 | R161 | +65 | 325,05 | +2 | 928 | 961,18 |
| L162                      | +62 | 739,12 | +2 | 931                        | 495,75 | R162 | +65 | 388,01 | +2 | 928 | 815,45 |
| L163                      | +62 | 614,24 | +2 | 931                        | 432,88 | R163 | +65 | 426,62 | +2 | 928 | 763,28 |
| L164                      | +62 | 611,01 | +2 | 931                        | 414,81 | R164 | +65 | 472,76 | +2 | 928 | 724,29 |
| L165                      | +62 | 671,51 | +2 | 931                        | 350,25 | R165 | +65 | 499,06 | +2 | 928 | 644,52 |
| L166                      | +62 | 716,84 | +2 | 931                        | 301,82 | R166 | +65 | 483,03 | +2 | 928 | 552,64 |
| L167                      | +62 | 759,33 | +2 | 931                        | 257,30 | R167 | +65 | 435,56 | +2 | 928 | 433,99 |
| L168                      | +62 | 803,83 | +2 | 931                        | 215,13 | R168 | +65 | 493,78 | +2 | 928 | 410,97 |
| L169                      | +62 | 849,53 | +2 | 931                        | 174,65 | R169 | +65 | 574,29 | +2 | 928 | 615,16 |
| L170                      | +62 | 896,53 | +2 | 931                        | 135,79 | R170 | +65 | 603,91 | +2 | 928 | 628,28 |
| L171                      | +63 | 095,09 | +2 | 930                        | 975,30 | R171 | +65 | 625,48 | +2 | 928 | 690,19 |
| L172                      | +63 | 299,56 | +2 | 930                        | 810,04 | R172 | +65 | 676,15 | +2 | 928 | 822,90 |
| L173                      | +63 | 930,46 | +2 | 930                        | 320,78 | R173 | +65 | 725,76 | +2 | 928 | 792,26 |
| L174                      | +64 | 021,69 | +2 | 930                        | 248,65 | R174 | +65 | 759,64 | +2 | 928 | 762,32 |
| L175                      | +64 | 116,72 | +2 | 930                        | 171,24 | R175 | +65 | 791,47 | +2 | 928 | 751,08 |
| L176                      | +64 | 781,59 | +2 | 929                        | 619,94 | R176 | +66 | 032,60 | +2 | 928 | 563,42 |
| L177                      | +64 | 964,43 | +2 | 929                        | 468,40 | R177 | +66 | 239,54 | +2 | 928 | 433,61 |
| L178                      | +65 | 047,86 | +2 | 929                        | 406,00 | R178 | +66 | 536,17 | +2 | 928 | 220,79 |
| L179                      | +65 | 142,97 | +2 | 929                        | 336,97 | R179 | +66 | 677,57 | +2 | 928 | 101,01 |
| L180                      | +65 | 256,81 | +2 | 929                        | 228,55 | R180 | +66 | 685,06 | +2 | 928 | 093,64 |
| L181                      | +65 | 424,29 | +2 | 929                        | 099,28 | R181 | +68 | 456,51 | +2 | 926 | 340,66 |
| L182                      | +65 | 639,10 | +2 | 928                        | 966,28 | R182 | +68 | 710,34 | +2 | 926 | 129,48 |
| L183                      | +65 | 673,38 | +2 | 929                        | 067,09 | R183 | +68 | 742,05 | +2 | 926 | 103,14 |
| L184                      | +65 | 705,09 | +2 | 929                        | 120,47 | R184 | +71 | 729,39 | +2 | 923 | 620,47 |
| L185                      | +65 | 736,94 | +2 | 929                        | 201,59 | R185 | +72 | 046,25 | +2 | 923 | 345,65 |
| L186                      | +65 | 759,76 | +2 | 929                        | 259,82 | R186 | +72 | 084,62 | +2 | 923 | 276,34 |
| L187                      | +65 | 802,86 | +2 | 929                        | 226,80 | R187 | +72 | 092,94 | +2 | 923 | 093,94 |
| L188                      | +65 | 810,40 | +2 | 929                        | 220,25 | R188 | +72 | 007,71 | +2 | 922 | 966,94 |
| L189                      | +65 | 798,00 | +2 | 929                        | 185,08 | R189 | +72 | 157,05 | +2 | 922 | 843,17 |
| L190                      | +65 | 762,74 | +2 | 929                        | 095,38 | R190 | +72 | 254,31 | +2 | 922 | 960,21 |
| LIn                       | +65 | 910,24 | +2 | 929                        | 007,20 | R191 | +72 | 441,99 | +2 | 922 | 960,51 |
| L192                      | +65 | 928,64 | +2 | 928                        | 957,32 | R192 | +72 | 539,52 | +2 | 922 | 929,11 |
| L193                      | +65 | 963,99 | +2 | 928                        | 896,25 | R193 | +72 | 709,46 | +2 | 922 | 805,94 |
| L194                      | +66 | 034,77 | +2 | 928                        | 745,66 | R194 | +73 | 121,30 | +2 | 922 | 463,64 |
| L195                      | +66 | 101,31 | +2 | 928                        | 649,05 | R195 | +73 | 455,04 | +2 | 922 | 067,86 |
| L196                      | +66 | 196,26 | +2 | 928                        | 561,47 | R196 | +74 | 735,63 | +2 | 919 | 849,80 |
| L197                      | +66 | 209,76 | +2 | 928                        | 549,13 | R197 | +74 | 741,52 | +2 | 919 | 839,66 |
| L198                      | +66 | 653,20 | +2 | 928                        | 214,33 | R198 | +75 | 375,18 | +2 | 918 | 742,17 |
| L199                      | +66 | 670,02 | +2 | 928                        | 197,69 |      |     |        |    |     |        |
| L200                      | +67 | 761,52 | +2 | 927                        | 117,91 |      |     |        |    |     |        |
| L201                      | +68 | 210,47 | +2 | 926                        | 673,51 |      |     |        |    |     |        |
| L202                      | +68 | 451,29 | +2 | 926                        | 435,27 |      |     |        |    |     |        |
| L203                      | +68 | 567,00 | +2 | 926                        | 331,48 |      |     |        |    |     |        |
| L204                      | +68 | 771,56 | +2 | 926                        | 161,47 |      |     |        |    |     |        |

|       |    |     |    |         |
|-------|----|-----|----|---------|
| Vel   | 13 | Van | 14 | P566/06 |
| Sheet |    | of  |    |         |



| PADRESERWE                |     | Kod    | RDINATE | /                          |        | ROAD RESERVE CO-ORDINATES |  |
|---------------------------|-----|--------|---------|----------------------------|--------|---------------------------|--|
| LINKERKANT/LEFT HAND SIDE |     |        |         | REGTERKANT/RIGHT HAND SIDE |        |                           |  |
|                           | y   | X      | WG      | 29°                        | y      | X                         |  |
| L205                      | +68 | 803,33 | +2      | 926                        | 135,07 |                           |  |
| L206                      | +69 | 618,29 | +2      | 925                        | 457,85 |                           |  |
| L207                      | +71 | 875,52 | +2      | 923                        | 581,45 |                           |  |
| L208                      | +72 | 040,21 | +2      | 923                        | 462,36 |                           |  |
| L209                      | +72 | 159,58 | +2      | 923                        | 432,44 |                           |  |
| L210                      | +72 | 339,41 | +2      | 923                        | 454,70 |                           |  |
| L211                      | +72 | 386,69 | +2      | 923                        | 446,49 |                           |  |
| L212                      | +72 | 540,61 | +2      | 923                        | 567,78 |                           |  |
| L213                      | +72 | 604,27 | +2      | 923                        | 496,32 |                           |  |
| L214                      | +72 | 662,38 | +2      | 923                        | 431,03 |                           |  |
| L215                      | +72 | 533,94 | +2      | 923                        | 323,07 |                           |  |
| L216                      | +72 | 542,72 | +2      | 923                        | 270,95 |                           |  |
| L217                      | +72 | 543,66 | +2      | 923                        | 146,53 |                           |  |
| L21B                      | +72 | 653,69 | +2      | 922                        | 946,01 |                           |  |
| L219                      | +72 | 721,23 | +2      | 922                        | 886,93 |                           |  |
| L220                      | +72 | 719,15 | +2      | 922                        | 880,16 |                           |  |
| L221                      | +73 | 019,37 | +2      | 922                        | 630,60 |                           |  |
| L222                      | +73 | 020,96 | +2      | 922                        | 629,75 |                           |  |
| L223                      | +73 | 373,03 | +2      | 922                        | 337,14 |                           |  |
| L224                      | +74 | 785,67 | +2      | 919                        | 890,27 |                           |  |
| L225                      | +74 | 791,74 | +2      | 919                        | 879,90 |                           |  |
| L226                      | +75 | 297,75 | +2      | 919                        | 003,75 |                           |  |
| L227                      | +75 | 334,79 | +2      | 918                        | 939,59 |                           |  |
| L228                      | +75 | 428,95 | +2      | 918                        | 776,26 |                           |  |

|       |    |     |    |         |
|-------|----|-----|----|---------|
| Vel   | 14 | Van | 14 | P566/06 |
| Sheet |    | of  |    |         |