

CONTENTS**INHOUD**

<i>No.</i>	<i>Page No.</i>	<i>Gazette No.</i>	<i>No.</i>	<i>Bladsy No.</i>	<i>Koerant No.</i>
GOVERNMENT NOTICE			GOEWERMENSKENNISGEWING		
Transport, Department of			Vervoer, Departement van		
<i>Government Notice</i>			<i>Goewennenskennisgewing</i>		
751			751		
South African National Roads Agency Limited and the National Roads Act (7/1998): The South African National Roads Agency Limited: Declaration amendment of National Road N4 Section 16: Amendment of Declaration No. 1010 of 1998	..	3	30200	..	4
					30200

GOVERNMENT NOTICE
GOEWERMENTSKENNISGEWING

DEPARTMENT OF TRANSPORT
DEPARTEMENT VAN VERVOER

No. 751

24 August 2007

THE SOUTH AFRICAN NATIONAL ROADS
AGENCY LIMITED

Registration No: **98/09584/06**

DECLARATION AMENDMENT OF NATIONAL ROAD N4 SECTION 16

AMENDMENT OF DECLARATION No. 1010 OF 1998

By virtue of section 40 (1**II**b) of the South African National Roads Agency Limited and the National Roads Act, 1998 (Act NO.7 of 1998), I hereby amend Declaration No. 1010 of 1998, by substituting the descriptive section from the farm Kameeldoom 271 • JP up to the entrance of the operational area of the Skilpads Gate Border Post with the subjoined sheets 1 to 12 of Plan P579/06.

(National Road N4 Section 16: Kameeldoorn 271 - JP to Skilpads Gate Border Post)



MINISTER OF TRANSPORT

No. 751

24 Augustus 2007

DIE SUID-AFRIKAANSE NASIONALE PADAGENTSKAPBEPERK

Registrasie No: 98/09584/06

VERKLARING WYSIGING VAN NASIONALE PAD N4 SEKSIE 16.

WYSIGING VAN VERKLARING NO. 1010 VAN 1998

Kragtens Artikel 40(1)(b) van die Suid Afrikaanse Nasionale Padagentskap Beperk en die Nasionale Paaie Wet, 1998 (Wet No.7 van 1998), wysig ek hiermee Verklaring No.1010 van 1998, deur die beskrywende gedeelte vanaf die plaas Kameeldoorn 271 - JP tot by die ingang van die operasionele area van die Skilpadshek Grenspos, te vervang met meegaande velie 1 tot 12 van Plan No. P579/06.

(Nasionale Pad N4 Seksie 16: Kameeldoorn 271 - JP tot Skilpadshek Grenspos)



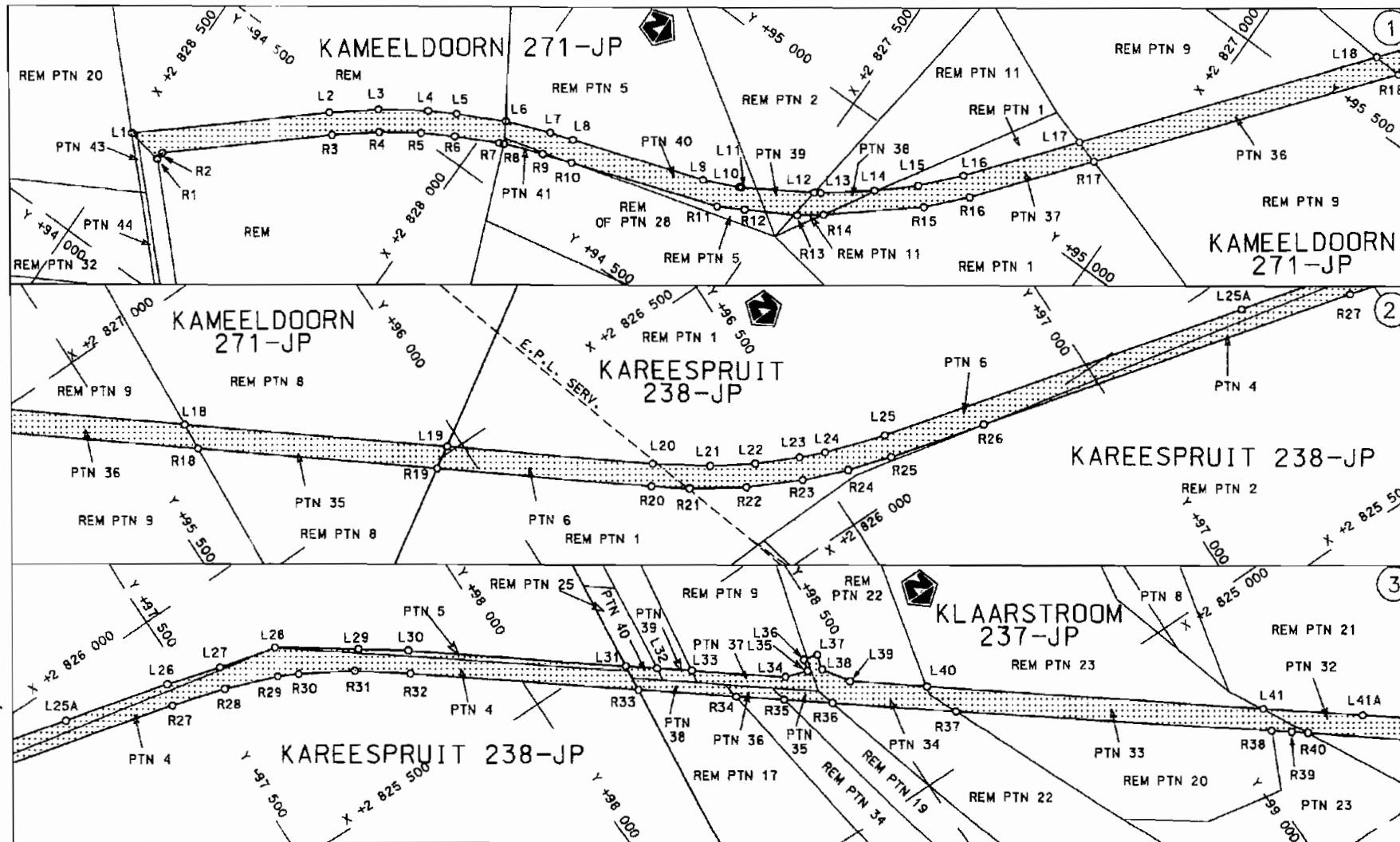

MINISTER VAN VERVOER

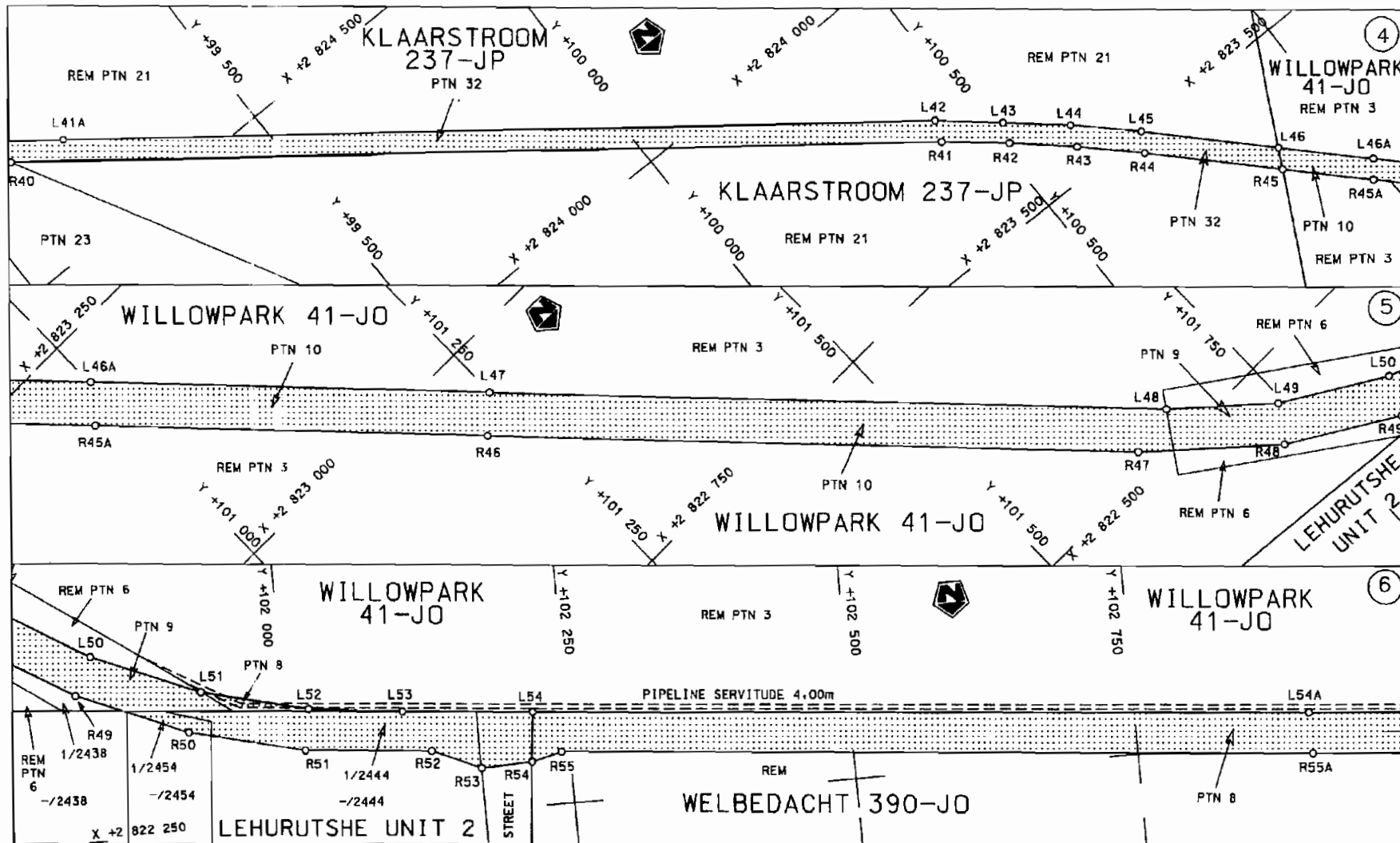

Die Suid Afrikaanse Nasionale Padagentskap Beperk	Die figuur getoon	steldie padreserwa voor van 'n gedeelte	Vel Sheet 1 van 12
The South African National Roads Agency Limited	The figure shown	represents the road reserve of a portion van Nasionale Raete N4 Seksie Section 16	Plan P579/06

D.O.9.A



<p>Die Suid Afrikaanse Nasionale Padagentskap Beperk The South African National Roads Agency Limited</p>	<p>Die figuur getoon The figure shown</p>		<p>steldie padreserwe voor van 'n gedeelte represents the road reserve of a portion van Nasionale Roete N4 Sektie of National Route Section</p>	<p>16</p>	<p>Vel Sheet 2 van 12 of</p>	<p>Plan P579/06</p>
--	---	--	---	-----------	----------------------------------	---------------------

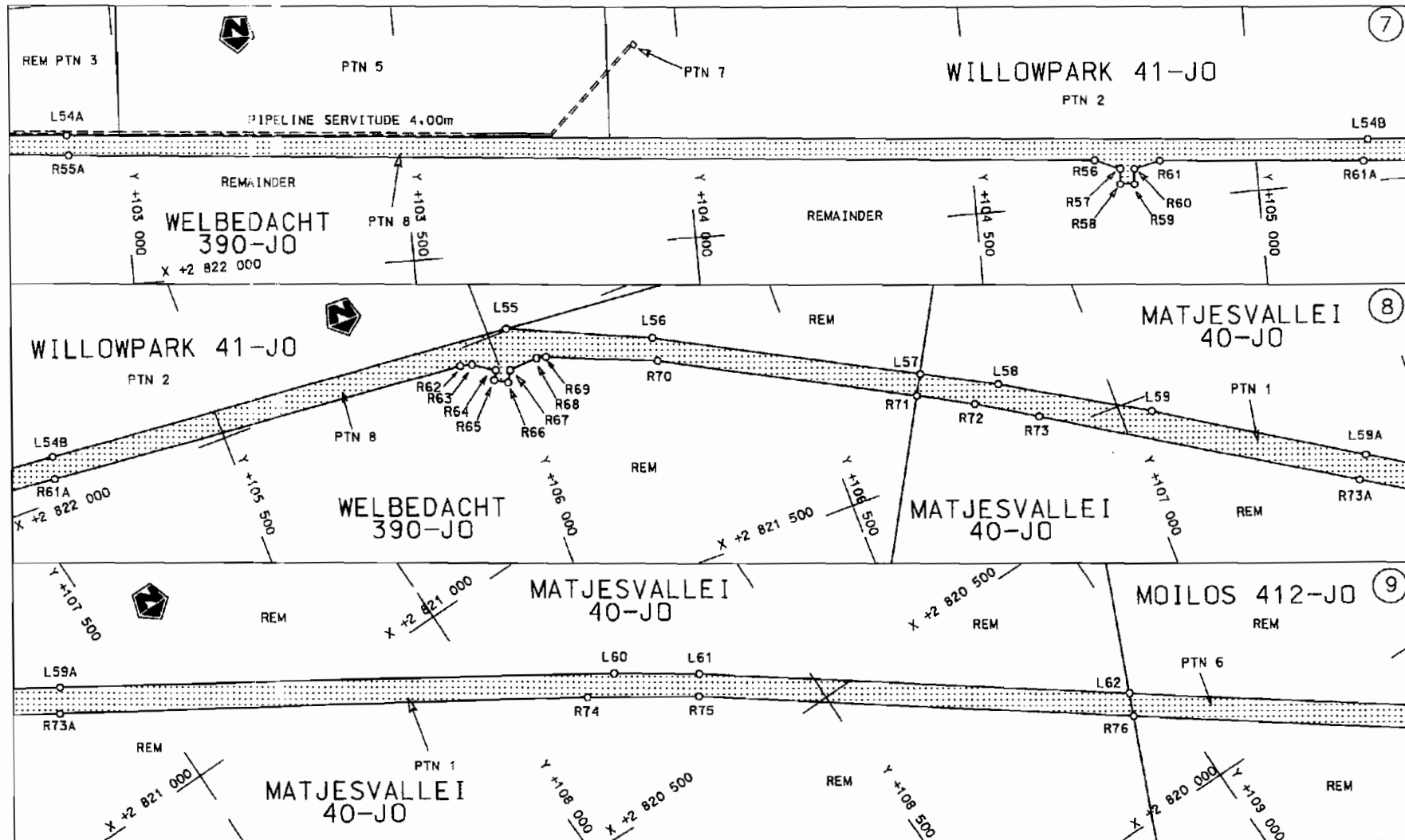

Die Suid Afrikaanse Nasionale Padagentskap Beperk
The South African National Roads Agency Limited

Die figuur getoon
The figure shown

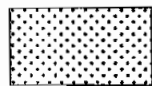

steldie padreserwe voor van 'n gedeelte
represents the road reserve of a portion
van Nasionale Roete N4 Seksie Section
of National Route 16

Vel Sheet 3 van of 12
Plan P579/06

D.O.9.A

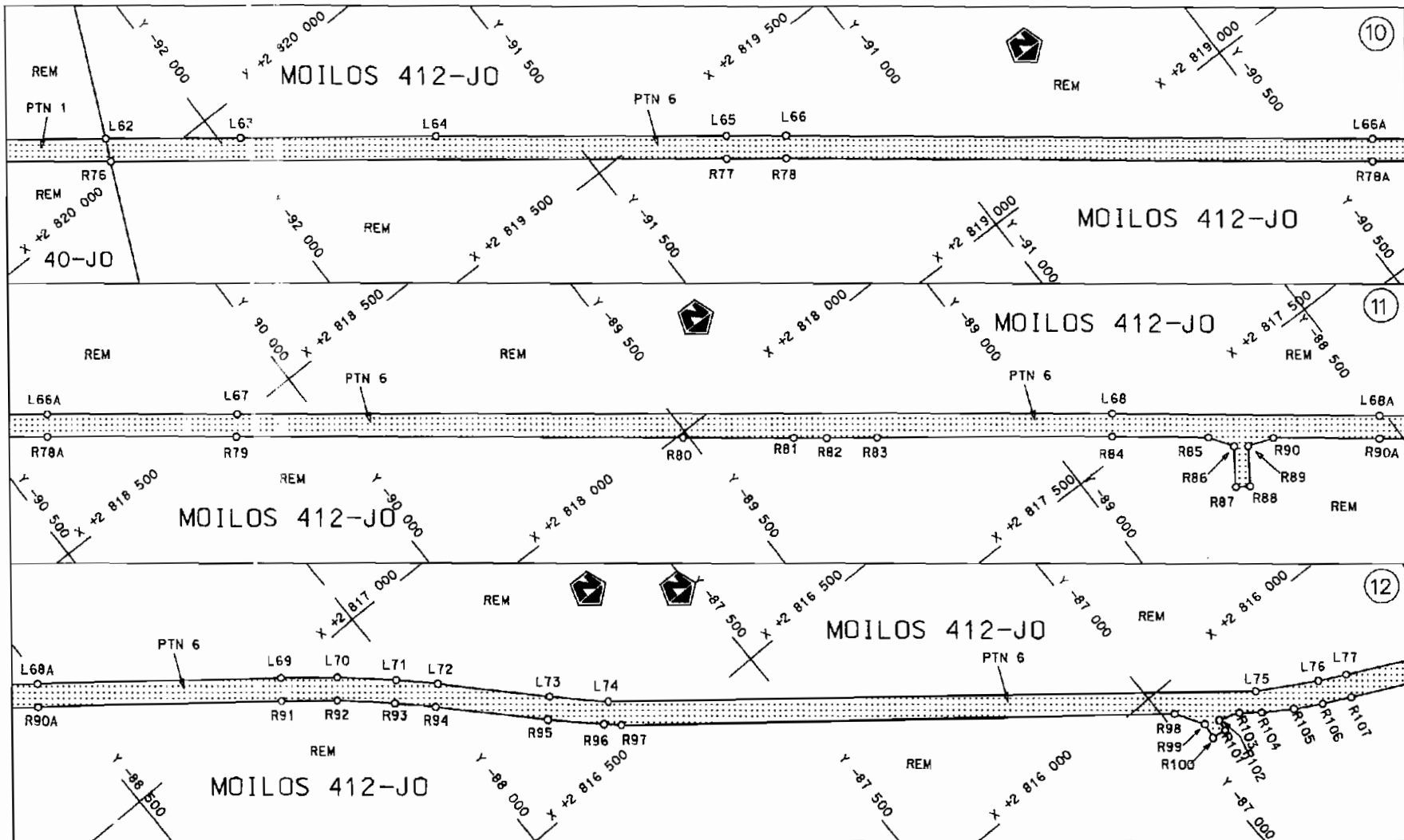

Die Suid Afrikaanse Nasionale Padagentskap Beperk The South African National Roads Agency Limited	Die figuur getoon The figure shown		steldie padreserwe voor van 'n gedeelte represents the road reserve of a portion van Nasionale Roete N4 Seksie of National Route N4 Section 16	Vel Sheet 4 van of 12 Plan P579/06
--	---------------------------------------	--	---	---------------------------------------

D.O.9.A

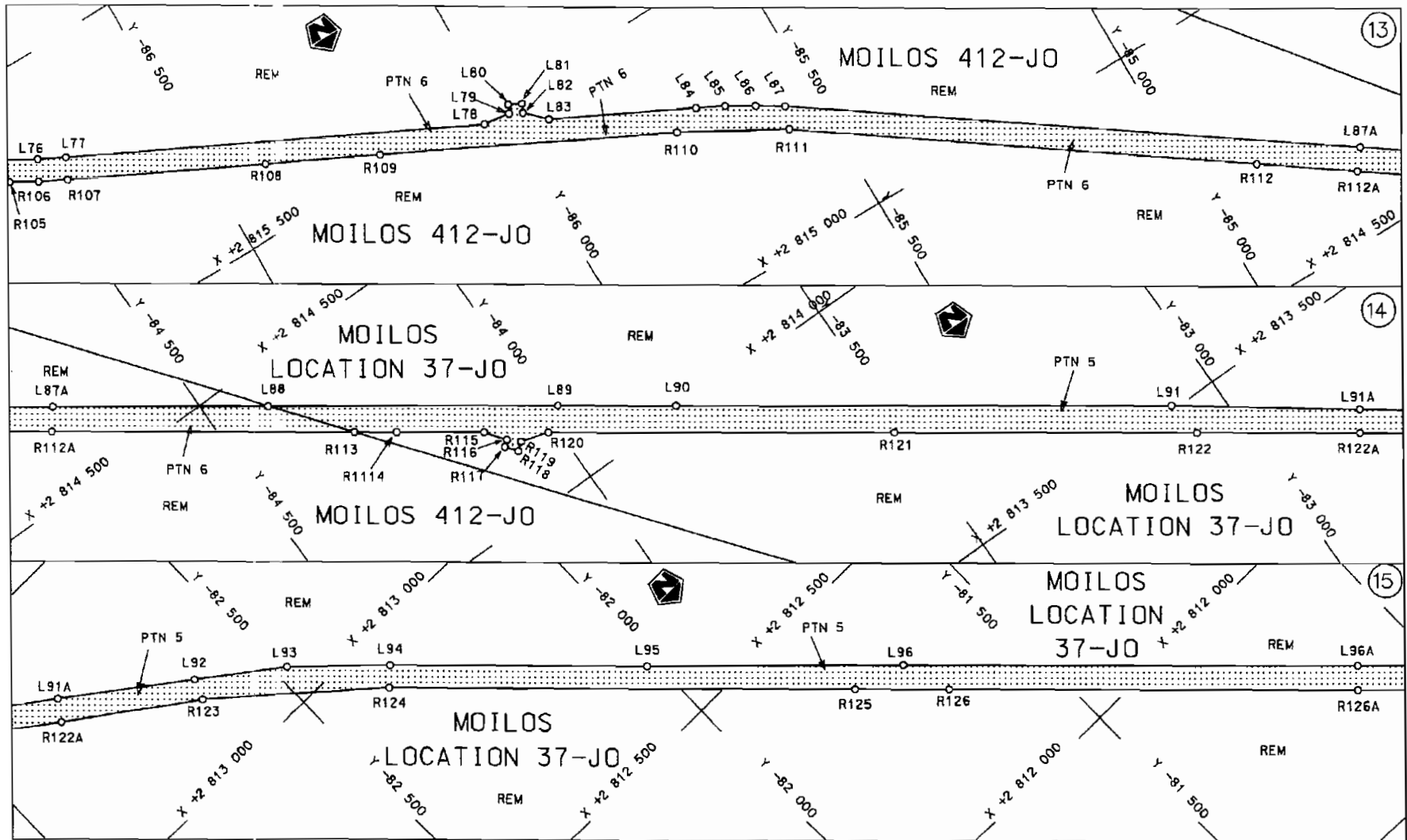

Die Suid Afrikaanse Nasionale Padagentskap Beperk
The South African National Roads Agency Limited

Die figuur getoon
The figure shown

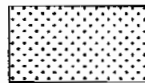

steldie padreserwe voor van 'n gedeelte
represents the road reserve of a portion
van Nasionale Roete N4 Sektie 16
of National Route N4 Section 16

Vel Sheet 5 van 12
Plan P579/06

D.O.9.A

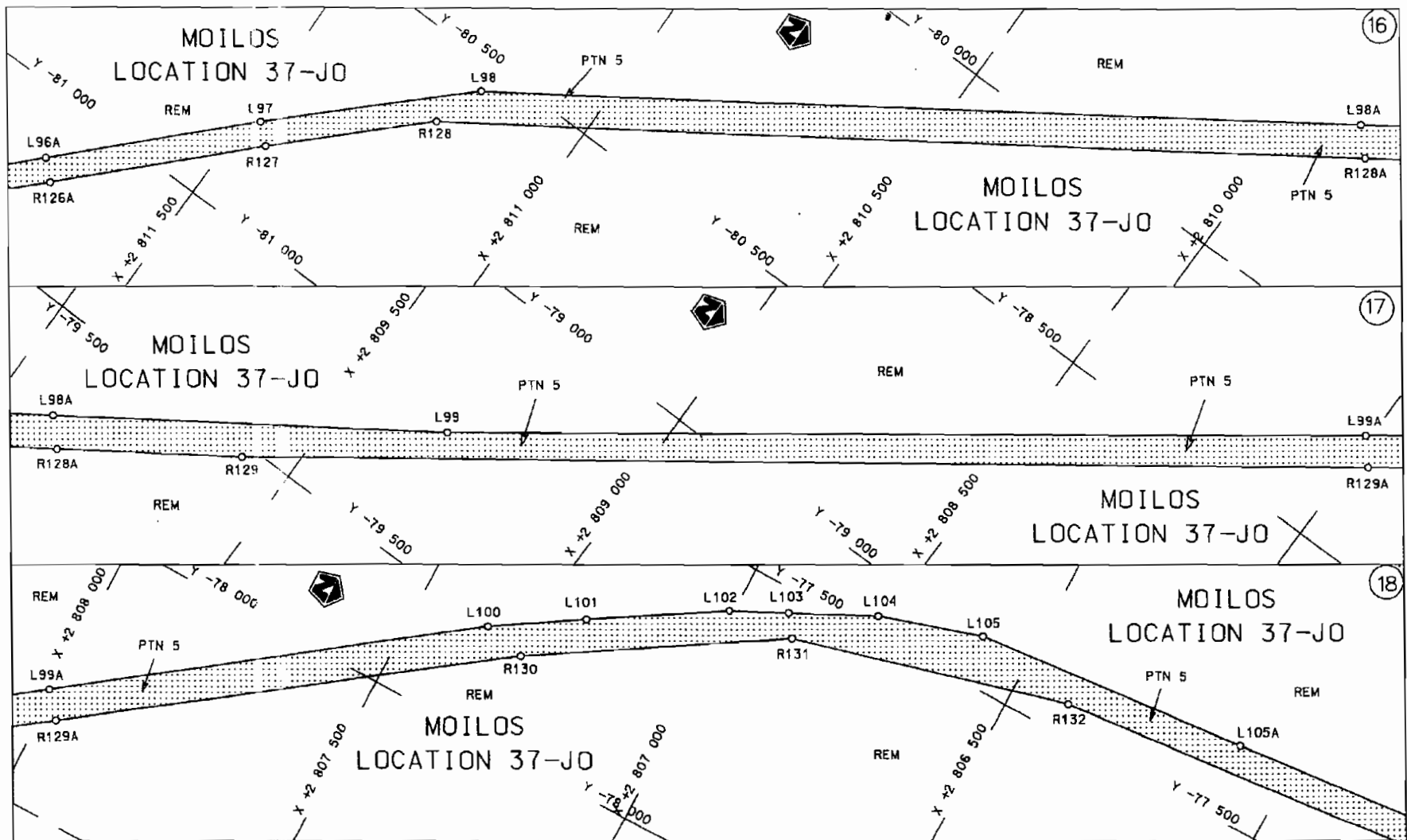

<p>Die Suid Afrikaanse Nasionale Padagentskap Beperk The South African National Roads Agency Limited</p>	<p>Die figuur getoon The figure shown</p>	<p>ste die podreserve voor van 'n gedeelte represents the road reserve of a portion van Nasionale Roete N4 of National Route N4</p>	<p>Vel Sheet 6 van 12 Plan P579/06</p>
--	---	---	--

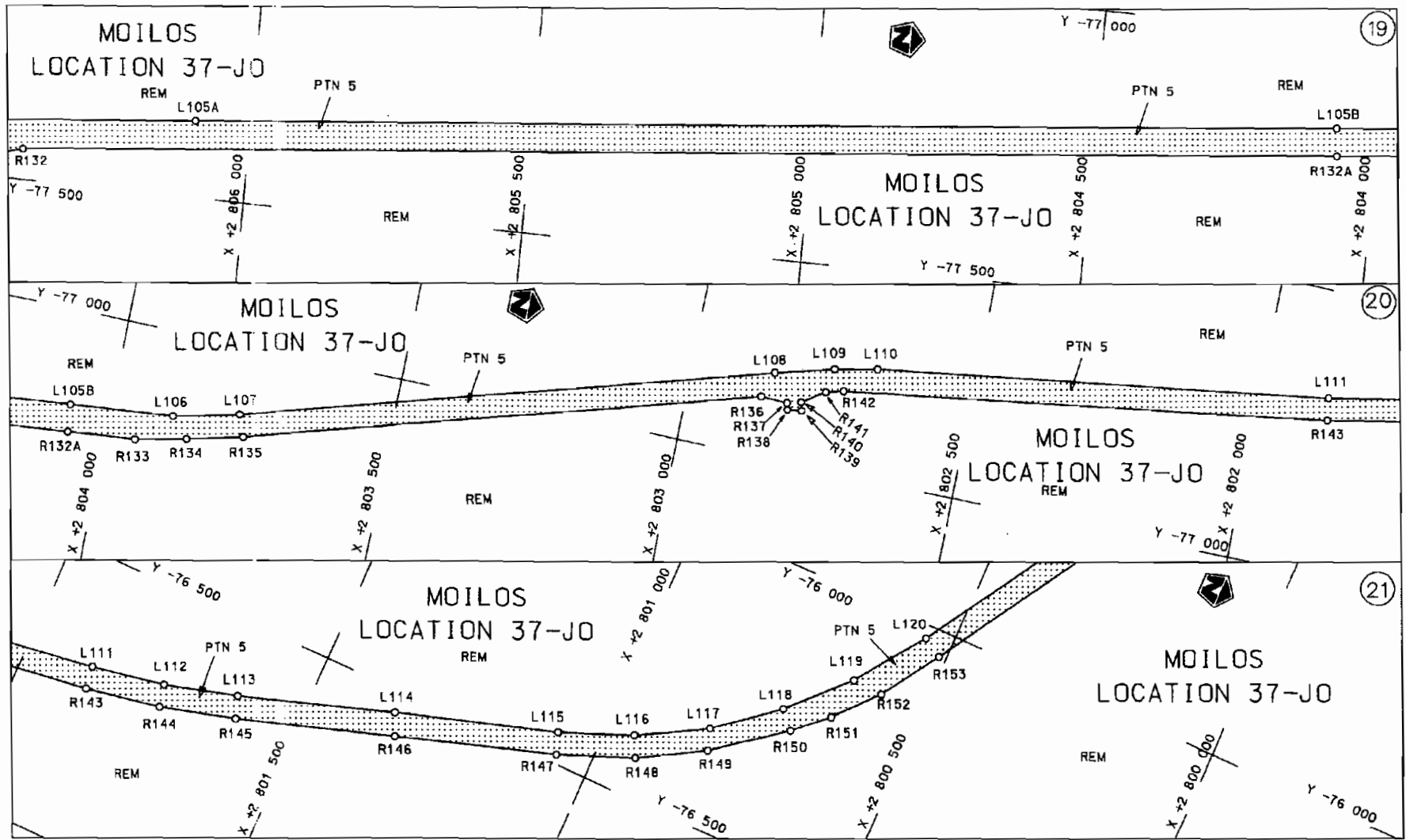

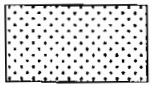
Die Suid Afrikaanse Nasionale Padogentskap Beperk The South African National Roads Agency Limited	Die figuur getoon The figure shown	 'steldie padreserwe voor van 'n gedeelte represents the road reserve of a portion van Nasionale Roete N4 of National Route N4 Seksie 16 Section 16	Vel 7 van 12 Sheet of Plan P579/06
--	---------------------------------------	--	--

D.O.9.A

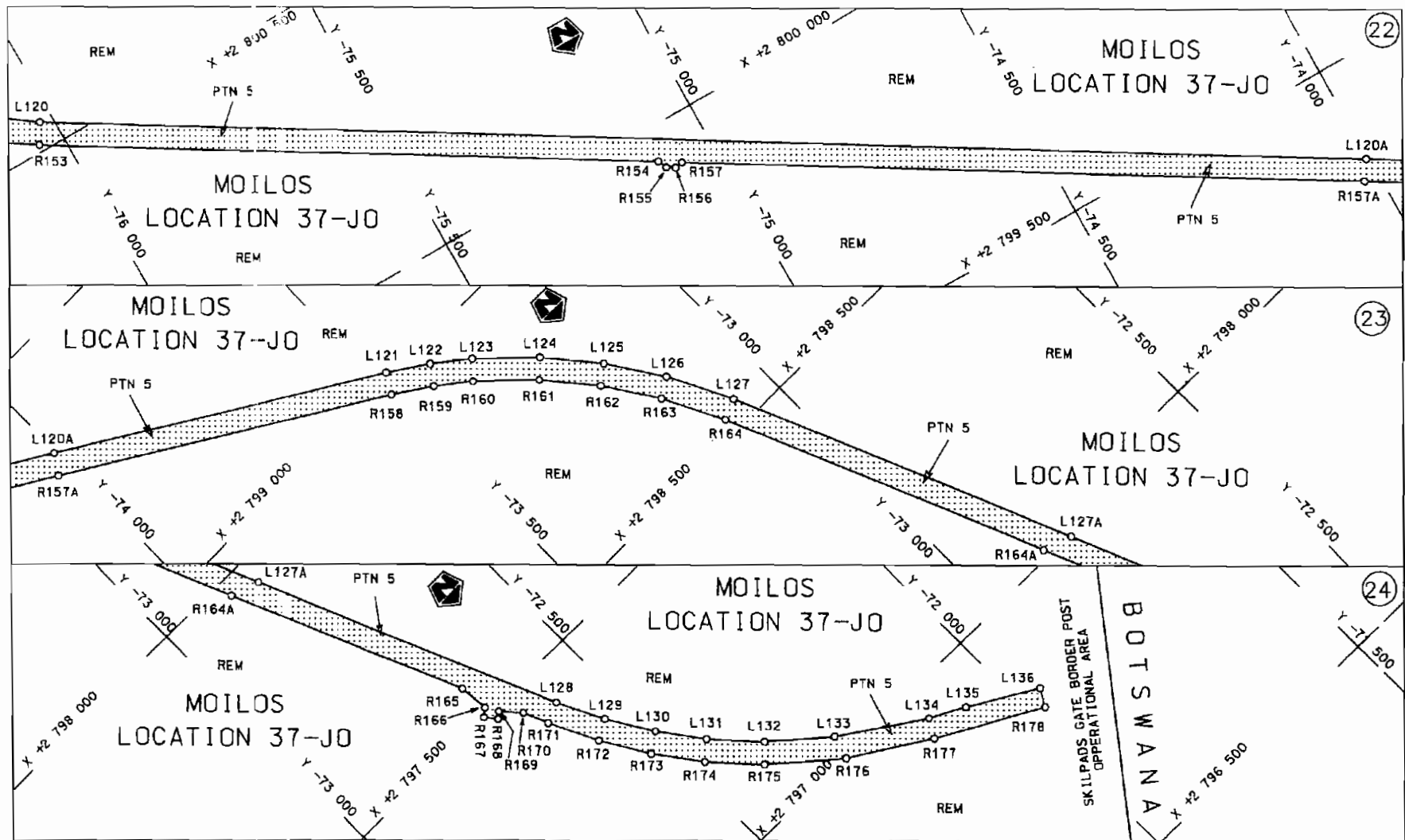

Die Suid Afrikaanse Nasionale Padagentskap Beperk	Die figuur getoon	steldie padreserwe voor van 'n gedeelte represents the raad reserve of a portion van Nasionale Roete N4 Seksie 16	Vel Sheet 8 van of 12
The South African National Roads Agency Limited	The figure shown	of National Route N4 Seksie Section 16	Plan P579/06

PADRESERWE KOORDINATE / ROAD RESERVE CO-ORDINATES					
L1NKERKANT/LEFT HAND SIDE			REGTERKANT/RIGHT HAND SIDE		
	Y	X	WG27°	Y	X
L1	94207.480	2828506.400	R1	94196.500	2828443.410
L2	94443.530	2 828 241.670	R2	94 210.210	2 828 442.900
L3	94498.221	2828174.830	R3	94413.710	2 828 215.000
L4	94547.400	2 828 102.260	R4	94466.180	2 828 150.790
L5	94572.790	2828 058.480	R5	94508.230	2828090.190
L6	94612.910	2 827 980.050	R6	94538.270	2 828 038.260
L7	94643.00	2 827 905.140	R7	94574.800	2 827 967.380
L8	94656.340	2 827 865.250	R8	94577.890	2827959.740
L9	94732.760	2827637.760	R9	94604.400	2 827 894.250
L10	94760.090	2827 578.300	R10	94621.420	2 827 843.770
L11	94761.720	2 827 575.660	R11	94709.260	2 827 590.820
L12	94829.560	2 827 465.460	R12	94733.290	2 827 548.460
L13	94835.690	2827455.500	R13	94779.610	2 827 466.860
L14	94895.380	2827379.890	R14	94807.530	2 827 429.400
L15	94947.470	2827322.790	R15	94922.550	2 827 292.670
L16	95008.980	2 827 268.640	R16	94983.490	2827237.740
L17	95177.190	2 827 136.870	R17	95164.130	2 827 096.230
L18	95607.400	2826799.840	R18	95604.290	2 826 751.430
L19	95975.810	2 826 511.230	R19	95939.930	2826488.510
L20	96262.860	2 826 286.360	R20	96238.420	2 826 254.690
L21	96345.850	2826226.850	R21	96292.970	2826214.080
L22	96414.490	2826186.690	R22	96378.320	2826160.590
L23	96486.230	2826 152.190	R23	96468.650	2826116.110
L24	96528.640	2826134.770	R24	96546.230	2 826 086.250
L25	96634.640	2 826 101.320	R25	96622.940	2826 063.130
L26	97470.450	2825890.720	R26	96790.440	2 826 021.260
L27	97565.160	2 825 863.390	R27	97457.160	2 825 854.580
L28	97666.970	2825837.660	R28	97551.560	2825827.700
L29	97789.450	2 825 753.970	R29	97643.560	2 825 792.970
L30	97860.940	2 825 703.320	R30	97678.190	2 825 775.550
L31	98167.760	2825470.180	R31	97763.500	2825 725.770
L32	98211.910	2 825 436.640	R32	97842.160	2825668.140
L33	98260.980	2825399.350	R33	98163.180	2 825 423.660
L34	98393.270	2 825298.840	R34	98301.190	2825318.550
L35	98431.860	2825285.700	R35	98369.080	2 825 266.840
L36	98437.190	2825305.810	R36	98437.430	2825214.790
L37	98461.350	2 825 299.400	R37	98611.350	2 825 082.320
L38	98454.520	2 825 273.640	R38	99058.100	2824746.140
L39	98484.830	2 825 229.260	R39	99086.570	2 824 724.950
L40	98593.410	2 825 146.770	R40	99108.850	2 824 708.000
L41	99067.530	2 824 786.520	R41	100424.440	2 823 706.900
L42	100439.310	2823743.650	R42	100516.410	2823 630.830
L43	100530.500	2823666.400	R43	100605.740	2 823 551.350
L44	100621.160	2 823 588.610	R44	100692.240	2823468.410
L45	100712.020	2823502.610	R45	100864.740	2 823 293.040
L46	100883.470	2823328.320	R46	101 222.246	2 822 929.699
L47	101 249.916	2 822 955.359	R47	101 626.026	2822519.209
L48	101 670.520	2 822 528.350	R48	101 724.000	2822433.770
L49	101 745.190	2822463.060	R49	101 815.530	2 822 379.670
L50	101 831.560	2822412.010	R50	101913.140	2822339.920
L51	101 927.130	2 822 373.600	R51	102015.150	2822 315.750

Vel	9	Van	12	P579/06
Sheet		of		

PADRESERWE KOORDINATE / ROAD RESERVE CO-ORDINATES					
L1NKERKANT/LEFT HAND SIDE			REGTERKANT/RIGHT HAND SIDE		
	Y	X	WG27	Y	X
L52	102021.316	2822351.169	R52	102127.620	2 822 305.550
L53	102105.036	2822341.834	R53	102169.760	2 822287.230
L54	102219.490	2822331.990	R54	102215.150	2 822 289.022
L55	106033.660	2822003.930	R55	102242.180	2 822 295.500
L56	106271.720	2 821 898.890	R56	104 716.270	2822 078.780
L57	106694.739	2821 674.368	R57	104 759.790	2 822 059.910
L58	106817.213	2 821 609.359	R58	104757.330	2822031.890
L59	107053.335	2821 471.757	R59	104782.240	2822029.710
L60	108211.521	2820742.610	R60	104784.690	2822057.730
L61	108335.780	2820658.714	R61	104830.830	2822068.750
L62	108947.893	2820208.740	R62	105935.280	2821 972.000
			R63	105955.280	2821 966.860
			R64	105991.380	2821 943.550
			R65	105982.620	2821 928.320
			R66	106004.300	2821 915.860
			R67	106 015.070	2 821 934.600
			R68	106066.660	2 821 938.220
			R69	106083.800	2 821 933.820
			R70	106266.210	2 821 859.020
			R71	106676.009	2821641.552
			R72	106765.650	2 821 592.472
			R73	106864.799	2821 532.263
			R74	108149.184	2820734.502
			R75	108313.787	2820626.799
			R76	108931.240	2820171.454
			Vel	10	Van
			Sheet		12
				of	P579/06

PADRESERWE KOORDINATE / ROAD RESERVE CO-ORDINATES						
L1NKERKANT/LEFT HAND SIDE				REGTERKANT/RIGHT HAND SIDE		
	Y	X	WG25		Y	X
L62	- 92159.360	2 820 082.650	R76		- 91 305.860	2819383.080
L63	- 91 967.550	2819937.154	R77		- 91 305.860	2819383.080
L64	- 91 689.460	2819726.210	R78		- 91 221.910	2819318.530
L65	- 91 281.550	2819414.850	R79		- 90 136.480	2818478.490
L66	- 91 197.480	2 819 350.200	R80		- 89 509.190	2817992.910
L67	- 90 110.780	2818508.920	R81		- 89 353.600	2817872.300
L68	- 88 881.120	2817562.890	R82		- 89 307.560	2817836580
L69	- 88166.670	2817003.760	R83		- 89 236.190	2817782.290
L70	- 88 087.970	2816940.200	R84		- 88 905.630	2817531.280
L71	- 88 009.620	2816869.630	R85		- 88 772.170	2817426.830
L72	- 87 957.230	2816818.300	R86		- 88 745.520	2817386.590
L73	- 87 818.920	2816676.670	R87		- 88 785.780	2817329.120
L74	- 87 743.480	2816604.040	R88		- 88 765.310	2817314.780
L75	- 86 845.400	2815889.970	R89		- 88 725.500	2817371.600
L76	- 86 749.060	2 815 833.800	R90		- 88681.610	2817355.960
L77	- 86 703.650	2815810.670	R91		- 88 191.480	2816972.380
L78	- 86 032.460	2815479.160	R92		- 88113.940	2816909.760
L79	- 85 985.470	2815472.680	R93		- 88 037.010	2816840.480
L80	- 85 978.180	2815487420	R94		- 87 985.540	2816790.040
L81	- 85 955.770	2815476.350	R95		- 87 847.010	2816648.190
L82	- 85 963.060	2815461.610	R96		- 87 774440	2816579.300
L83	- 85 928.360	2815428.240	R97		- 87751.330	2816558.460
L84	- 85 692.030	2815311.020	R98		- 86 981.720	2815951060
L85	- 85 645.540	2815287460	R99		- 86 950.950	2815903.990
L86	- 85598.830	2815260.180	R100		- 86 954.980	2 815 876.520
L87	- 85 554.740	2815232.780	R101		- 86 930.250	2815872.890
L88	- 84 397.660	2814427.840	R102		- 86 927.360	2815892.620
L89	- 83 976.020	2814134.520	R103		- 86 891.590	2815879.630
L90	- 83 803.180	2814013.080	R104		- 86 860.730	2815855.170
L91	- 83 083.670	2813508.240	R105		- 86 813.240	2815824.330
L92	- 82 614.250	2813165.130	R106		- 86 768.040	2815798.590
L93	- 82 477.090	2813064.850	R107		- 86 721.590	2815774.920
L94	- 82343.900	2812940.590	R108		- 86 401.830	2815617.310
L95	- 82 015.170	2812622.600	R109		- 86 218.300	2815527.670
L96	- 81 685.600	2812307.850	R110		- 85 743.720	2 815 291.940
L97	- 80 827.300	2811 475.450	R111		- 85 569.360	2 815 194.840
L98	- 80 548.880	2 811 190.020	R112		- 84 888.290	2 814 718.000
L99	- 79 266.420	2809317.350	R113		- 84 298.610	2 814 303470
L100	- 77 818.470	2 807 372.540	R114		- 84 237.430	2814260.470
L101	- 77 723.200	2 807 225.090	R115		- 84111.440	2814172.200
L102	- 77 586.970	2807007.840	R116		- 84 086.080	2814137.980
L103	- 77540.280	2806912.870	R117		- 84 096.330	2814129.880
L104	- 77 469.190	2 806 770.580	R118		- 84 080.830	2814110.260
L105	- 77 412.490	2806591.130	R119		- 84 067.150	2814121.070
L106	- 77148.760	2 803 889.550	R120		- 84 017.270	2814 106.220
L107	- 77120.900	2 803 772.760	R121		- 83 512.580	2 813 752.620
L108	- 76 849.160	2 802 852.460	R122		- 83 073.600	2 813 443.970
L109	- 76 820.860	2802749.660	R123		- 82 628.270	2 813 130.200
L110	- 76 805.390	2802674.790	R124		- 82 372.820	2 812 913.060
L111	- 76 689.860	2 801 878.840	R125		- 81 777.050	2812336.580
L112	- 76 665.320	2801 749.790	R126		- 81657.660	2812221.060

Vel	11	Van	12	P579/06
Sheet		of		

PADRESERWE KOORDINATE / ROAD RESERVE CO-ORDINATES							
L1NKERKANT/LEFT HAND SIDE			REGTERKANT/RIGHT HAND SIDE				
	Y	X	WG25		Y	X	
L113	- 76628.720	2 801 621.030		R127	- 80 856.600	2 811 443.270	
L114	- 76537,080	2 801 352,540		R128	- 80 639,120	2811 221,970	
L115	- 76 446,770	2 801 075,160		R129	- 79 522,150	2 809 586,360	
L116	- 76395.070	2 800 949.920		R130	-77 837,070	2 807 296.820	
L117	- 76 328,170	2800832,190		R131	-77 577.380	2 806 886.380	
L118	-76242.830	2800727,140		R132	- 77445.610	2 806 401.850	
L119	-76144.900	2800633,160		R133	- 77 203.210	2 803 947.360	
L120	-76023.930	2 800 546.750		R134	- 77 183.470	2 803 857,960	
L121	-73 480,440	2799009,830		R135	- 77 158.840	2 803758,790	
L122	- 73 413.710	2 798 965,880		R136	- 76 894,930	2802867,920	
L123	- 73 353,770	2798919,580		R137	- 76 896,820	2 802 820,840	
L124	- 73 266.210	2798837,300		R138	- 76 908,550	2802817,670	
L125	- 73193.240	2 798 750.480		R139	-76905,080	2802792,720	
L126	- 73130.060	2798655.730		R140	- 76 890,310	2802796,700	
L127	- 73 072.820	2 798 544.080		R141	- 76 864,120	2802757,160	
L128	- 72 586.860	2 797 428.440		R142	-76855,820	2 802 726.400	
L129	- 72 546.720	2797347.270		R143	- 76 729.410	2 801 873.220	
L130	- 72 498.490	2 797 268.850		R144	- 76 704.450	2801741.260	
L131	- 72 443.230	2797195.030		R145	- 76 666.660	2 801 608.350	
L132	-72 372.740	2797118.870		R146	- 76575.440	2 801 335.280	
L133	-72277.390	2797037.500		R147	-76484.400	2801 062.150	
L134	- 72 135.340	2 796 943.560		R148	-76430.860	2 800 932.390	
L135	- 72074.710	2796912.110		R149	-76365.120	2800819.890	
L136	- 71 955.860	2 796 842.850		R150	- 76 272.260	2 800 700.160	
				R151	-76221.160	2 800 644.180	
				R152	- 76147.590	2 800 578.910	
				R153	- 76 044.570	2 800 512.450	
				R154	-75099.140	2799941.770	
				R155	- 75 092.230	2799925.750	
				R156	- 75 077.980	2799916.970	
				R157	- 75 063.400	2799919.710	
				R158	- 73 500.920	2798975.610	
				R159	- 73 436.800	2798933.120	
				R160	-73381.180	2 798 890.290	
				R161	- 73295.350	2798809.860	
				R162	-73 224.990	2798726.160	
				R163	-73164,120	2 798 634.860	
				R164	- 73109.490	2798528.150	
				R165	-72 688.720	2 797 562.440	
				R166	-72 684.080	2797510.550	
				R167	- 72 697.740	2 797 499.660	
				R168	- 72 682.150	2797480.120	
				R169	- 72 671,550	2 797 488.570	
				R170	-72 642,440	2797456.210	
				R171	- 72 623.320	2797412.330	
				R172	- 72 581.570	2797327.790	
				R173	- 72 531.650	2 797246.430	
				R174	-72 473.390	2797 168.930	
				R175	- 72 400,910	2 797 090.600	
				R176	- 72 289.570	2796996.160	
R178	- 71 973.340	2796812.640		R177	- 72 153.840	2 796 911.540	
				Vel	12	Van 12	P579/06
				Sheet		of	