

**CONTENTS****INHOUD**

No,	<i>Page</i> No,	<i>Gazette</i> No,	No,	<i>Bladsy</i> No.	<i>Koerant</i> No,
GOVERNMENT NOTICE			GOEWERMENSKENNISGEWING		
Transport. Department of			Vervoer, Departement van		
<i>Government Notice</i>			<i>Goewermentskennisgewing</i>		
756 South African National Roads Agency Limited and the National Roads Act (7/1998): The South African National Roads Agency Limited: Declaration amendment of National Road N12 Section 17: Amendment of Declaration No. 730 of 2005 " , " ... , ..	3	30205	756 Suid-Afrikaanse Nasionale Padagentskap Beperk en die Nasionale Paaie Wet (7/1998): Die Suid-Afrikaanse Nasionale Padagentskap Beperk: Verklaring wysiging van Nasionale Pad N12 Seksie 17: Wysiging van Verklaring No. 730 van 2005 .. " .. " , .. " , .. " .. " , .. " , .. " .. "	4	30205

---

GOVERNMENT NOTICE  
GOEWERMENTSKENNISGEWING

---

DEPARTMENT OF TRANSPORT  
DEPARTEMENT VAN VERVOER

No. 756

24 August 2007

THE SOUTH AFRICAN NATIONAL ROADS  
AGENCY LIMITED

Registration No: 98/09584/06

DECLARATION AMENDMENT OF NATIONAL ROAD N12 SECTION 17

AMENDMENT OF DECLARATION No. 730 OF 2005

By virtue of section 40 (1)(b) of the South African National Roads Agency Limited and the National Roads Act, 1998 (Act No. 7 of 1998). I hereby amend Declaration No. 730 of 2005, by substituting paragraph (VI) of the annexure, with the subjoined sheets 1 to 17 of Plan P608/06.

(National Road N12 Section 17: Potchefstroom - North West|Gauteng Provincial Border)



MINISTER OF TRANSPORT

No. 756

24 Augustus 2007

**DIE SUID-AFRIKAANSE NASIONALE  
PADAGENTSKAPBEPERK**

Registrasie No: 98/09584/06

VERKLARING WYSIGING VAN NASIONALE PAD N12 SEKSIE 17.

WYSIGING VAN VERKLARING NO. 730 VAN 2005

Kragtens Artikel40(1)(b) van die Suid Afrikaanse Nasionale Padagentskap Beperk en die Nasionale Paaie Wet, 1998 (Wel NO.7 van 199B), wysig ek hiermee Verklaring NO.730 van 2005, deur paragaaf (VI) van die bylae, te vervang met meegaande velie 110117 van Plan No. P60B/OS.

(Nasionale Pad N12 Seksie 17: Potchefstroom - Noordwes/Gauteng Provinsiale Grens)

J. Raaij

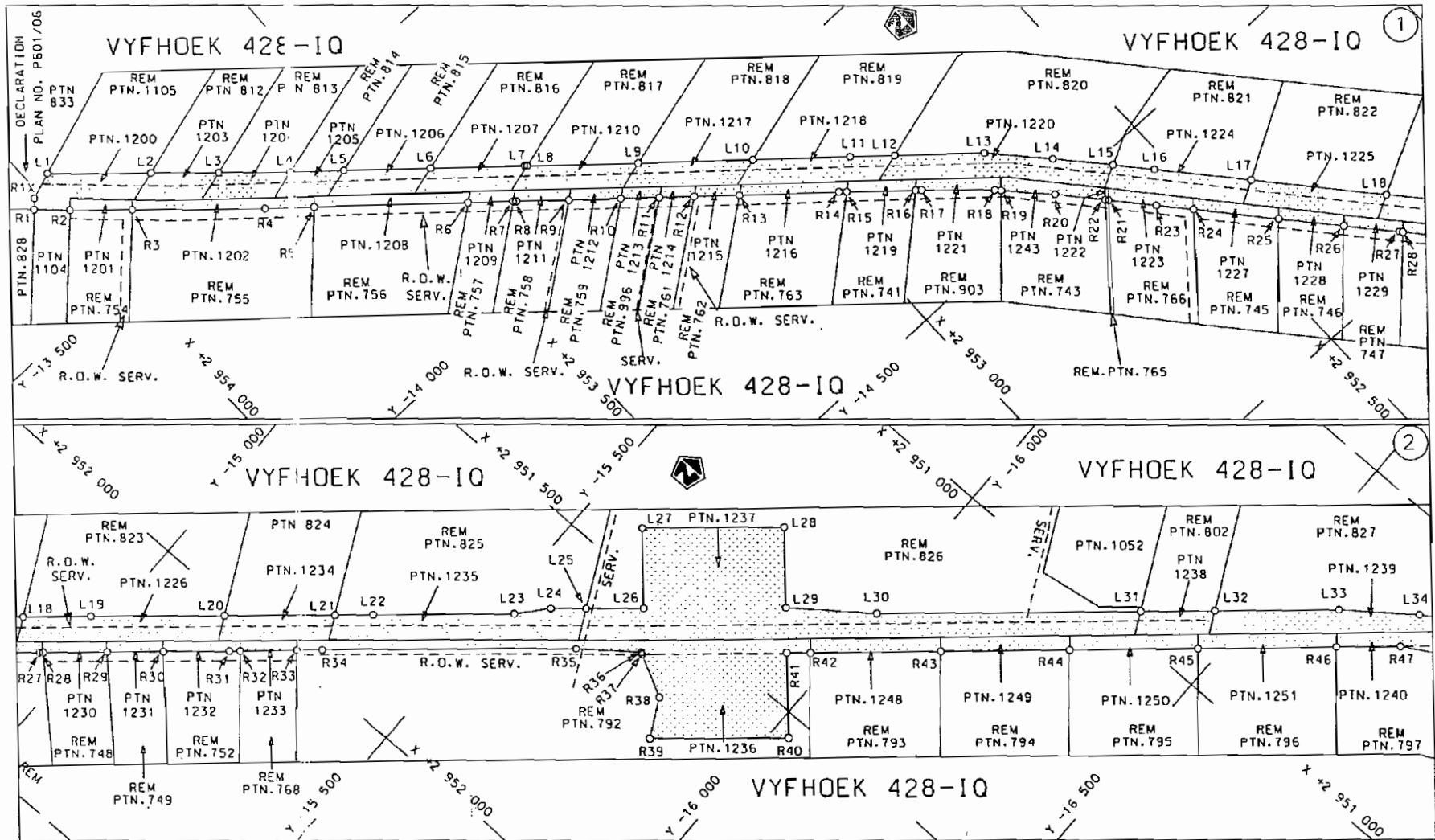

<p>Die Suid Afrikaanse Nasionale Padvoetskop Beperk The South African National Roads Agency Limited</p>	<p>Die figuur getoon The figure shown</p> 	<p>steldie padreserwe voor van 'n gedeelte represents the road reserve of a portion van Nasionale Roete N12 Seksie 17 of National Route N12 Section 17</p>	<p>Vel Sheet 1 van 17 Plan P608/06</p>
---	--	--	--

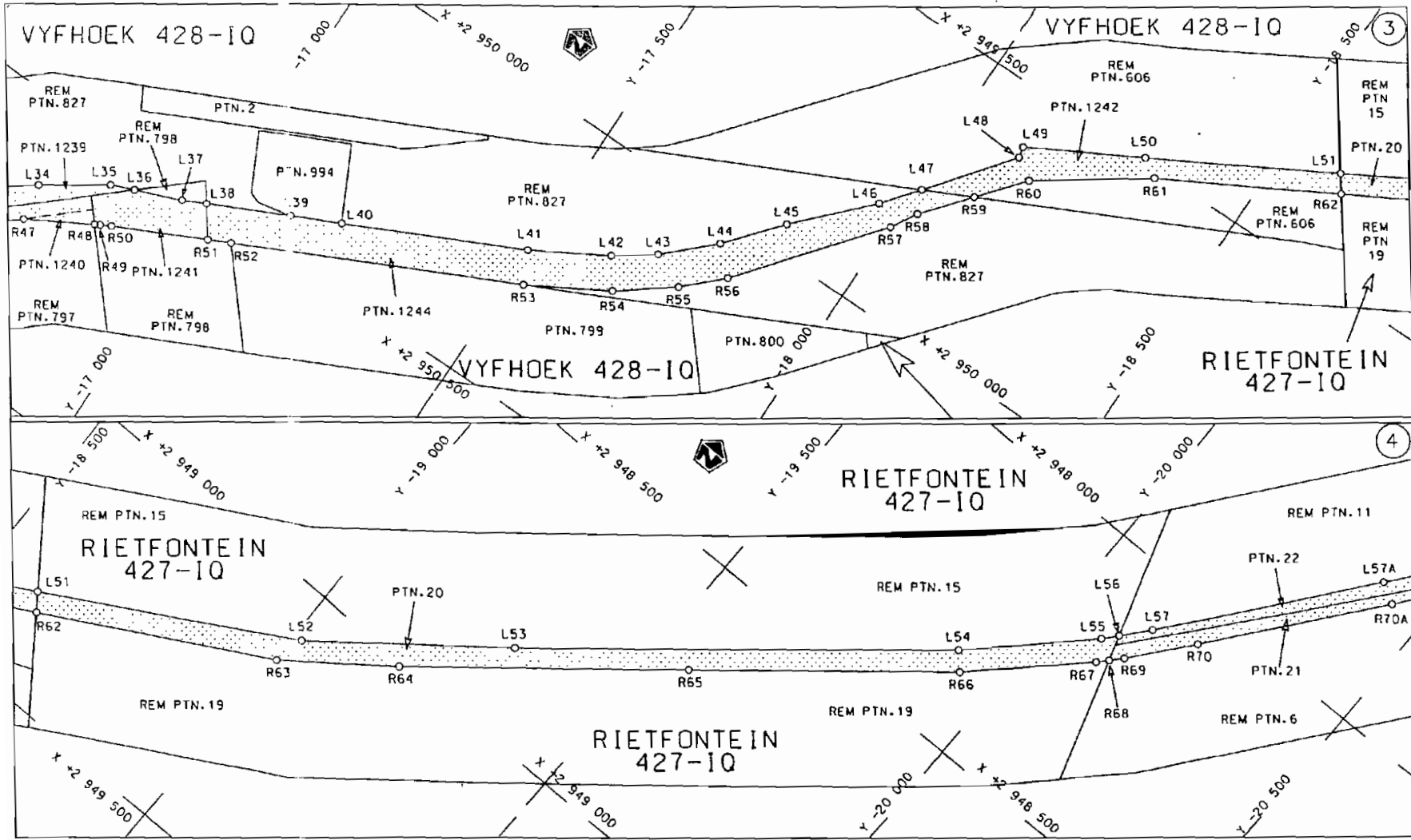

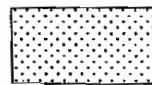
<p>Die Suid Afrikaanse Nasionale Padagentskap Beperk The South African National Roads Agency Limited</p>	<p>Die figuur getoon The figure shown</p>		<p>steldie padreserwe voor van 'n gedeelte represents the road reserve of a portion van Nasionale Roete N12 Sektie of National Route N12 Section</p>	<p>Vel Sheet 2 van 17 Plan P608/06</p>
--	---	--	--	--

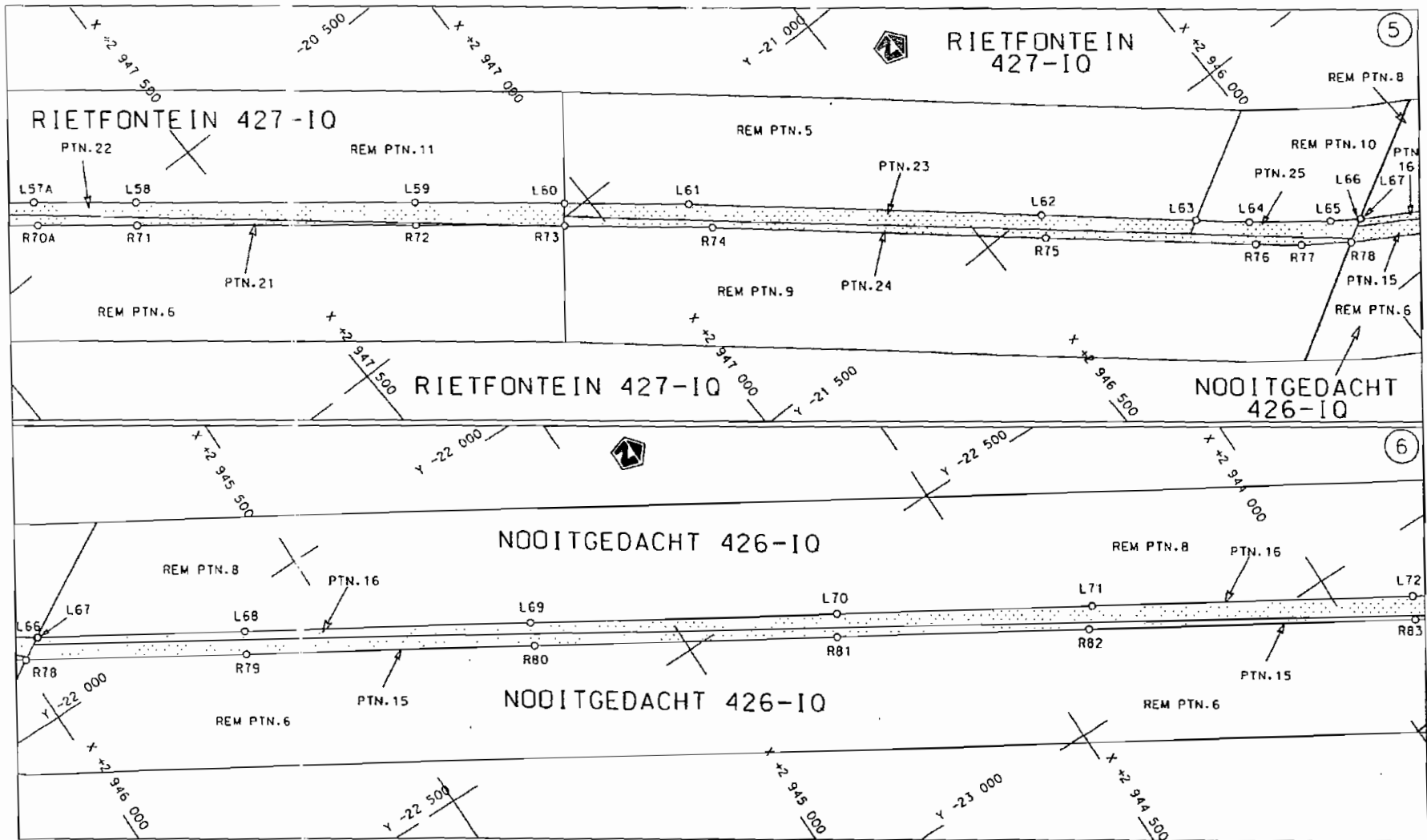

Die Suid Afrikaanse Nasionale Padoentskop Beperk  
The South African National Roads Agency Limited

Die figuur getoon  
The figure shown





steldie padreserwe voor van 'n gedeelte  
represents the road reserve of a portion  
van Nasionale Roete N12 Sektie  
of National Route Section

17

Vel  
Sheet 3 van 17  
of

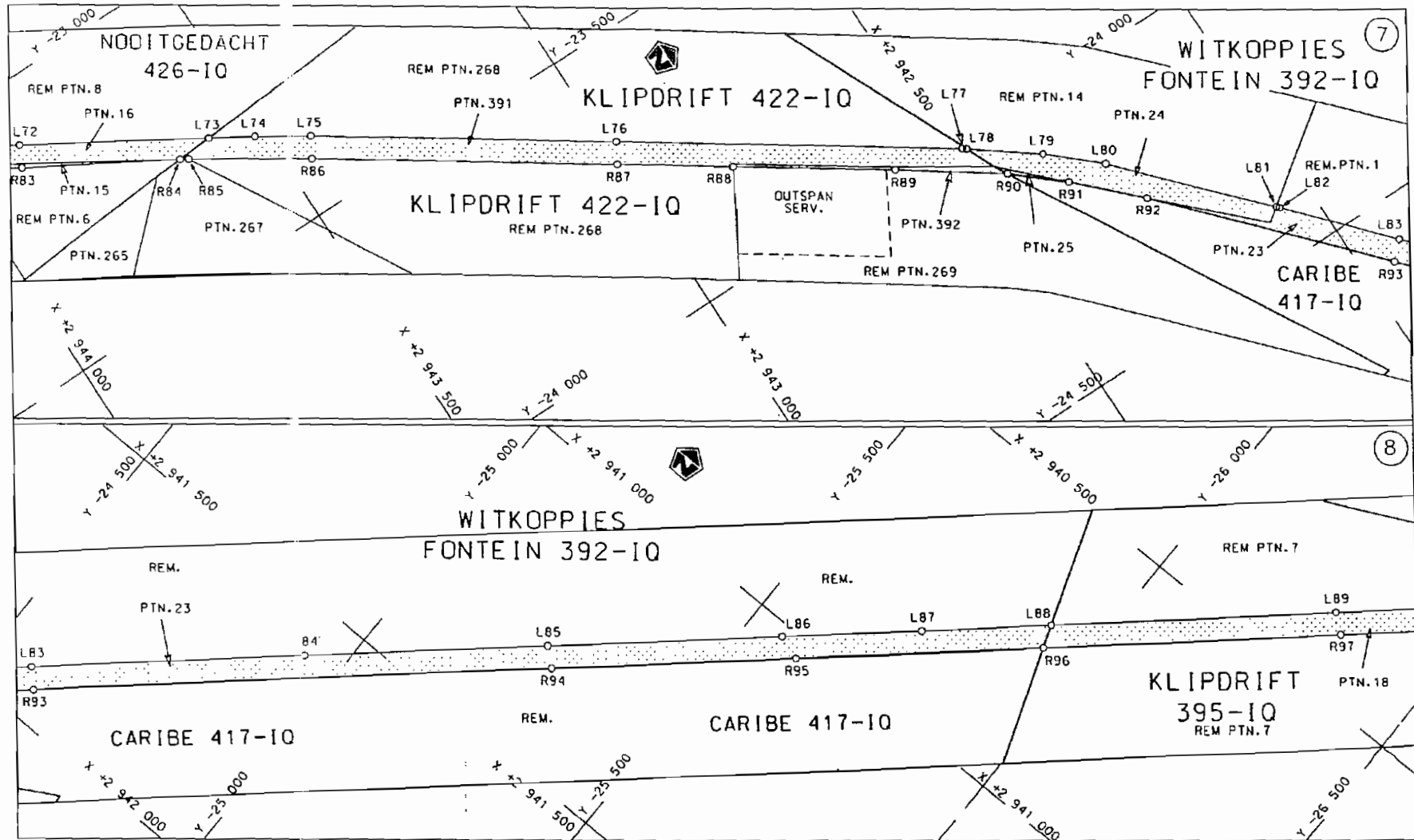
Plan P608/06



Die Suid Afrikaanse Nasionale Padoëntskep Beperk The South African National Roads Agency Limited	Die figuur getoon The figure shown		steldie padreserwe voor van 'n gedeelte represents the road reserve of a portion van Nasionale Roete N12 of National Route N12 Seksie 17 Section 17	Vel Sheet 4 van of 17 Plan P608/06
---	---------------------------------------	--	--	---------------------------------------

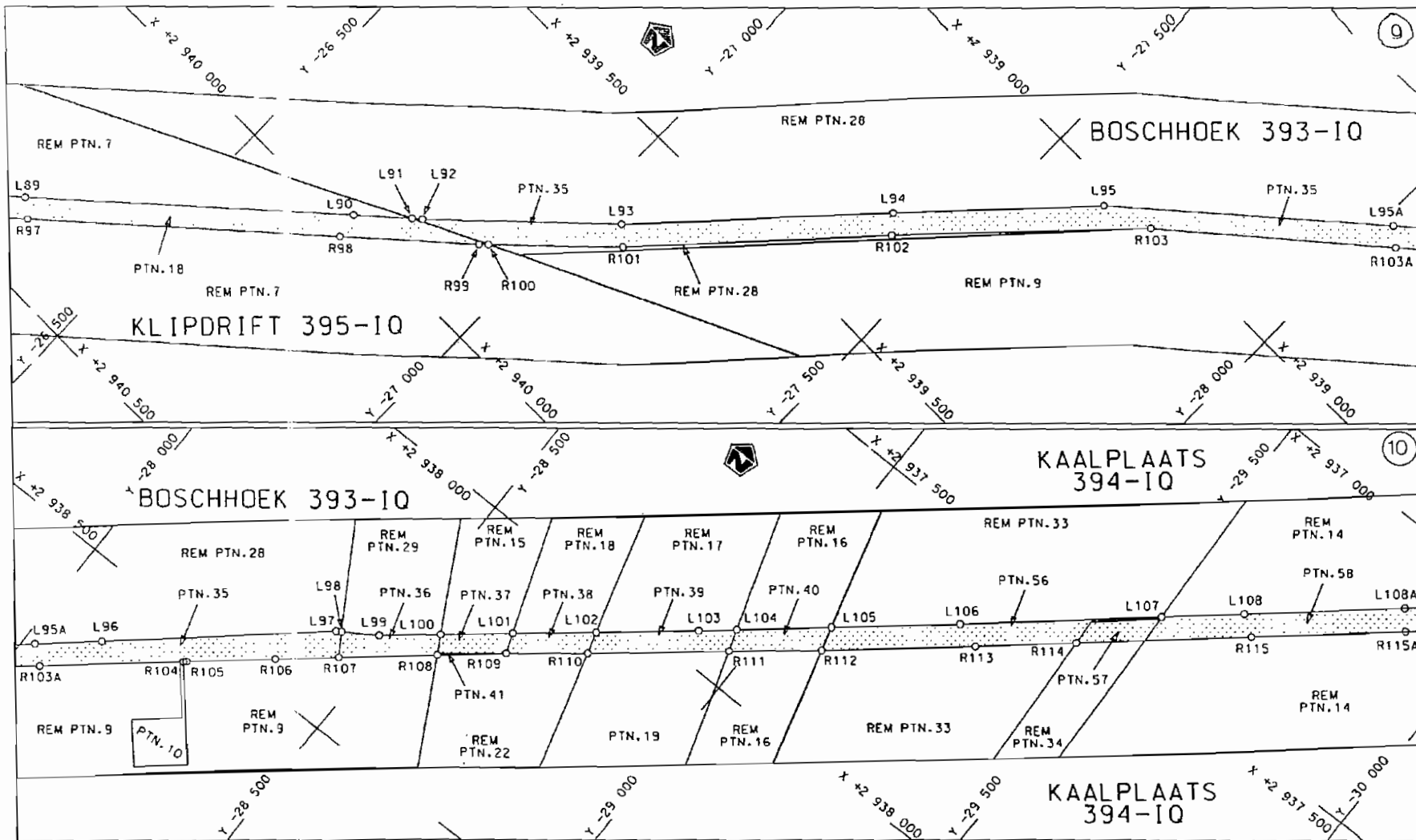

Die Suid Afrikaanse Nasionale Padreserwings Bepalings Owerheid  
The South African National Roads Agency Limited

Die figuur getoon  
The figure shown



steldie padreserwe voor van 'n gedeelte  
represents the road reserve of a portion  
von Nasionale Roete N12 Seksie  
of National Route Section

17

Vel  
Sheet 5 van  
of 17

Plan P608/06



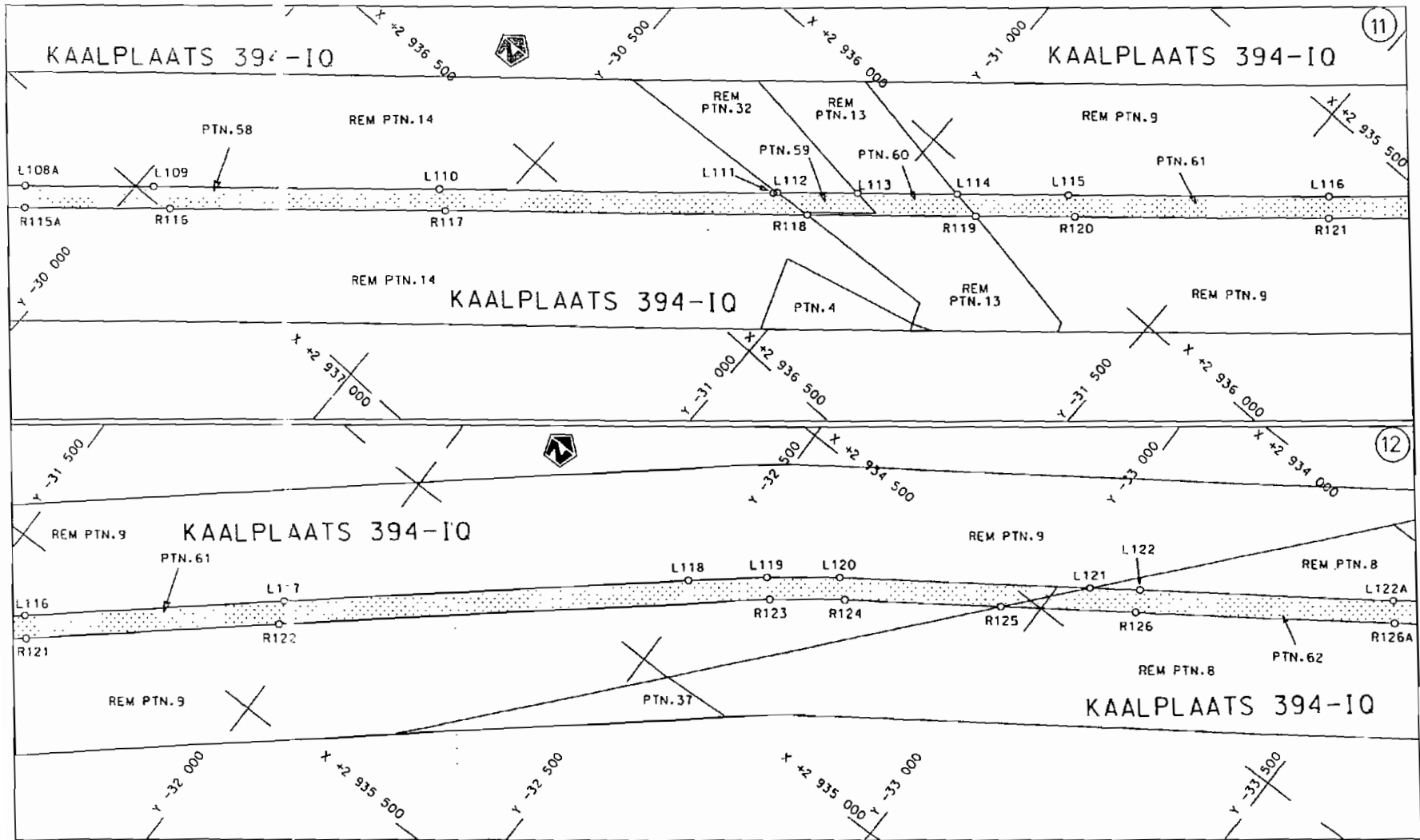

<p>Die Suid Afrikaanse Nasionale Padagentskap Beperk The South African National Roads Agency Limited</p>	<p>Die figuur getoon The figure shown</p>		<p>steldie padreserwe voor van 'n gedeelte represents the road reserve of a portion van Nasionale Roete N12 of National Route N12</p>	<p>Vel Sheet 6 van 17 Plan P608/06</p>
			<p>Seksie Section 17</p>	

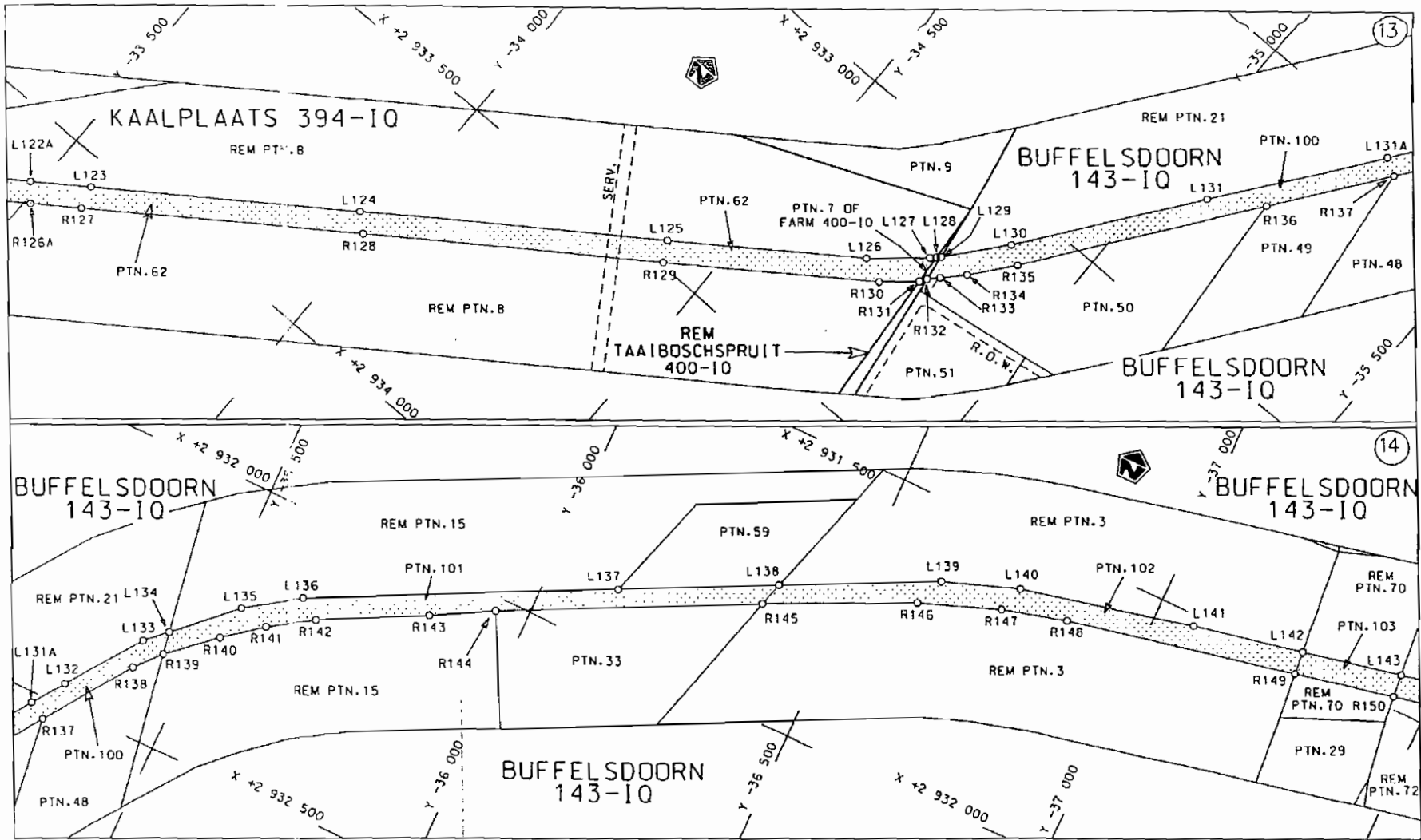

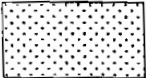
Die Suid Afrikaanse Nasionale Padrydenskap Beperk The South African National Roads Agency Limited	Die figuur getoon The figure shown	 steldie padreserwe voor van 'n gedeelte represents the road reserve of a portion van Nasionale Roete of National Route N12 Seksie Section 17	Vel Sheet 7 van of 17 Plan P608/06
--	---------------------------------------	--	---------------------------------------

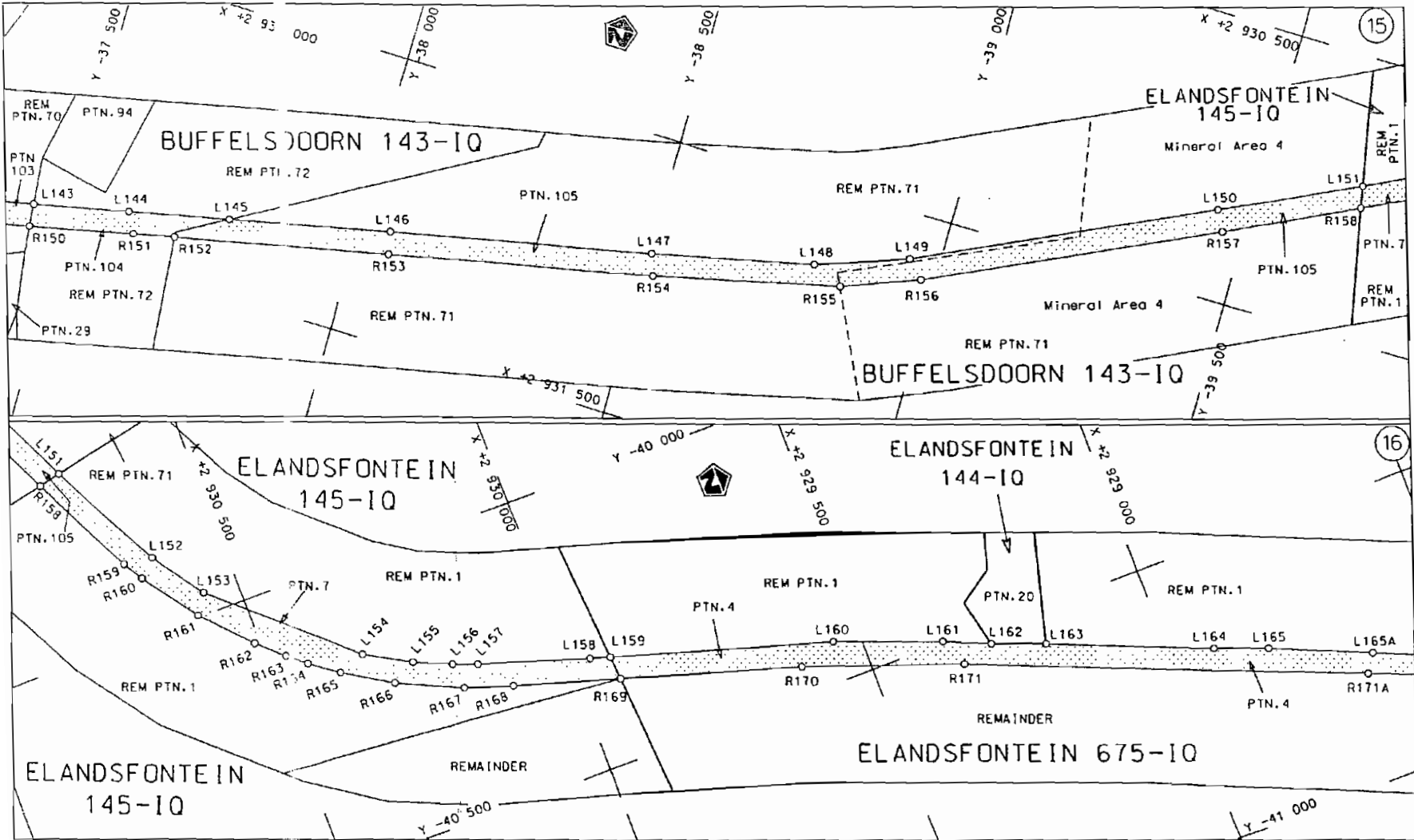

Die Suid Afrikaanse Nasionale Padagentskap Beperk  
The South African National Roads Agency Limited

Die figuur getoon  
The figure shown

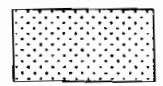

steldie podreserwe voor van 'n gedeelte  
represents the road reserve of a portion  
von Nasionale Roete N12 Seksie 17  
of National Route

Vel Sheet 8 van 17  
of  
Plan P608/06

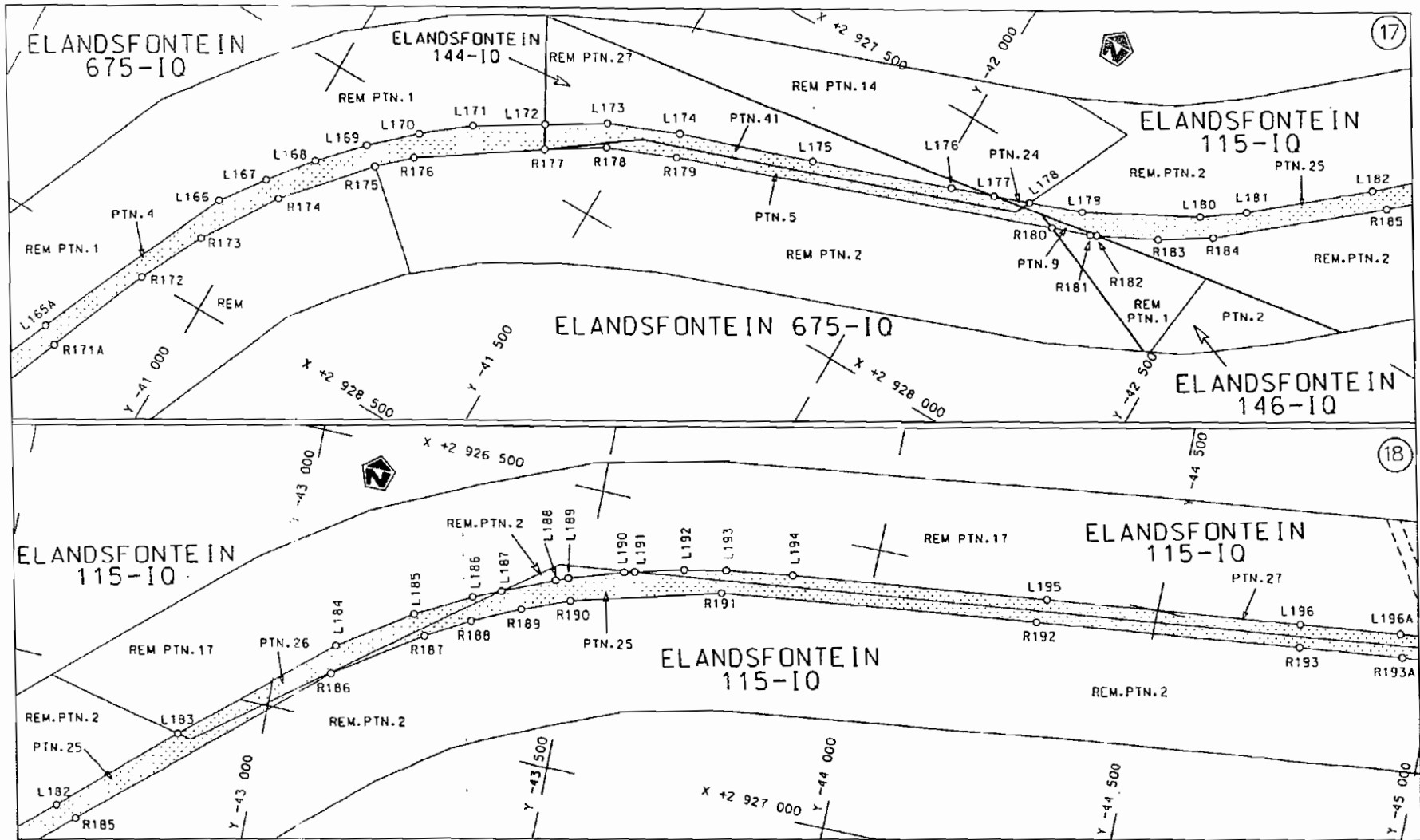

Die Suid Afrikaanse Nasionale Padagentskap Beperk  
 The South African National Roads Agency Limited

Die figuur getoon  
 The figure shown

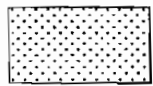

steldie padreserwe voor van 'n gedeelte  
 represents the road reserve of a portion  
 van Nasionale Roete N12 Sektie  
 of National Route 17

Vel  
 Sheet 9 van  
 of 17  
 Plan P608/06

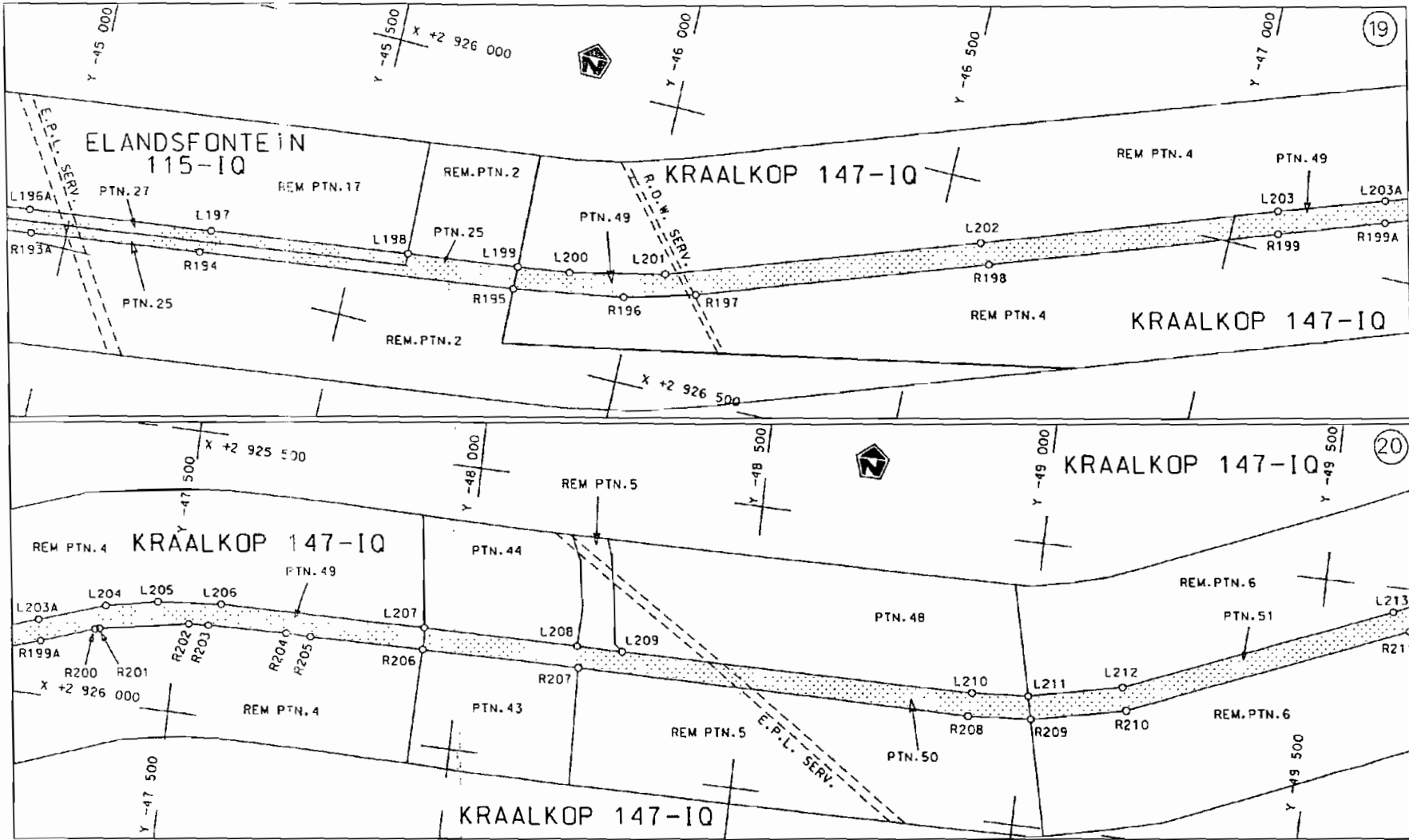

<p>Die Suid Afrikaanse Nasionale Padojentskap Beperk The South African National Roads Agency Limited</p>	<p>Die figuur getoon The figure shown</p>		<p>steldie padreserwe voor van 'n gedeelte represents the road reserve of a portion van Nasionale Roete N12 of National Route N12 Seksie 17 Section</p>	<p>Vel Sheet 10 van of 17</p>
				<p>Plan P608/06</p>

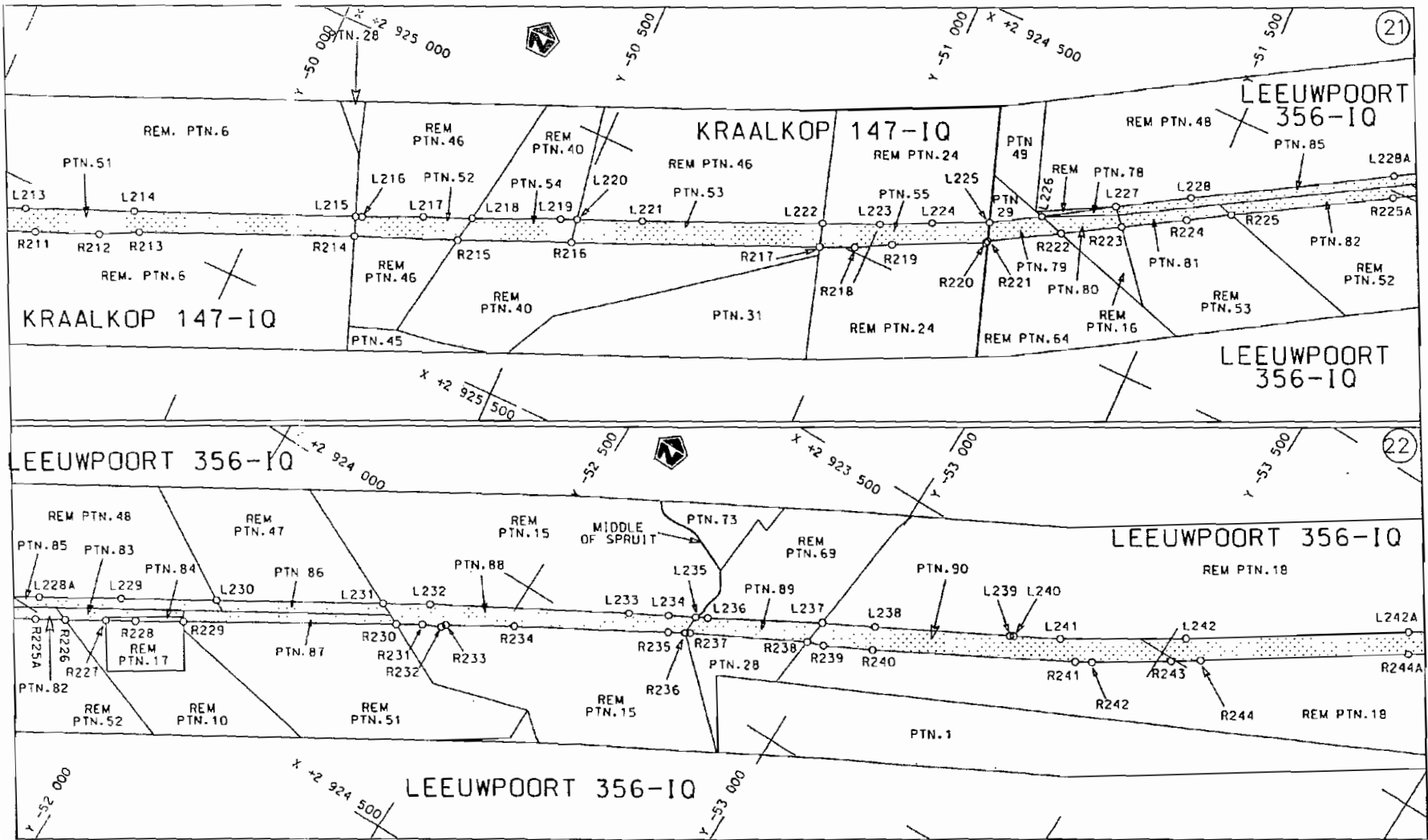

Die Suid Afrikaanse Nasionale Padroepstelsel Beperk  
The South African National Roads Agency Limited

Die figuur getoon  
The figure shown

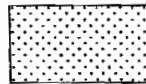

steldie padreserwe voor van 'n gedeelte  
represents the road reserve of a portion  
van Nasionale Roete N12 Seksie  
of National Route Section 17

Vel Sheet 11 van 17  
Plan P608/06

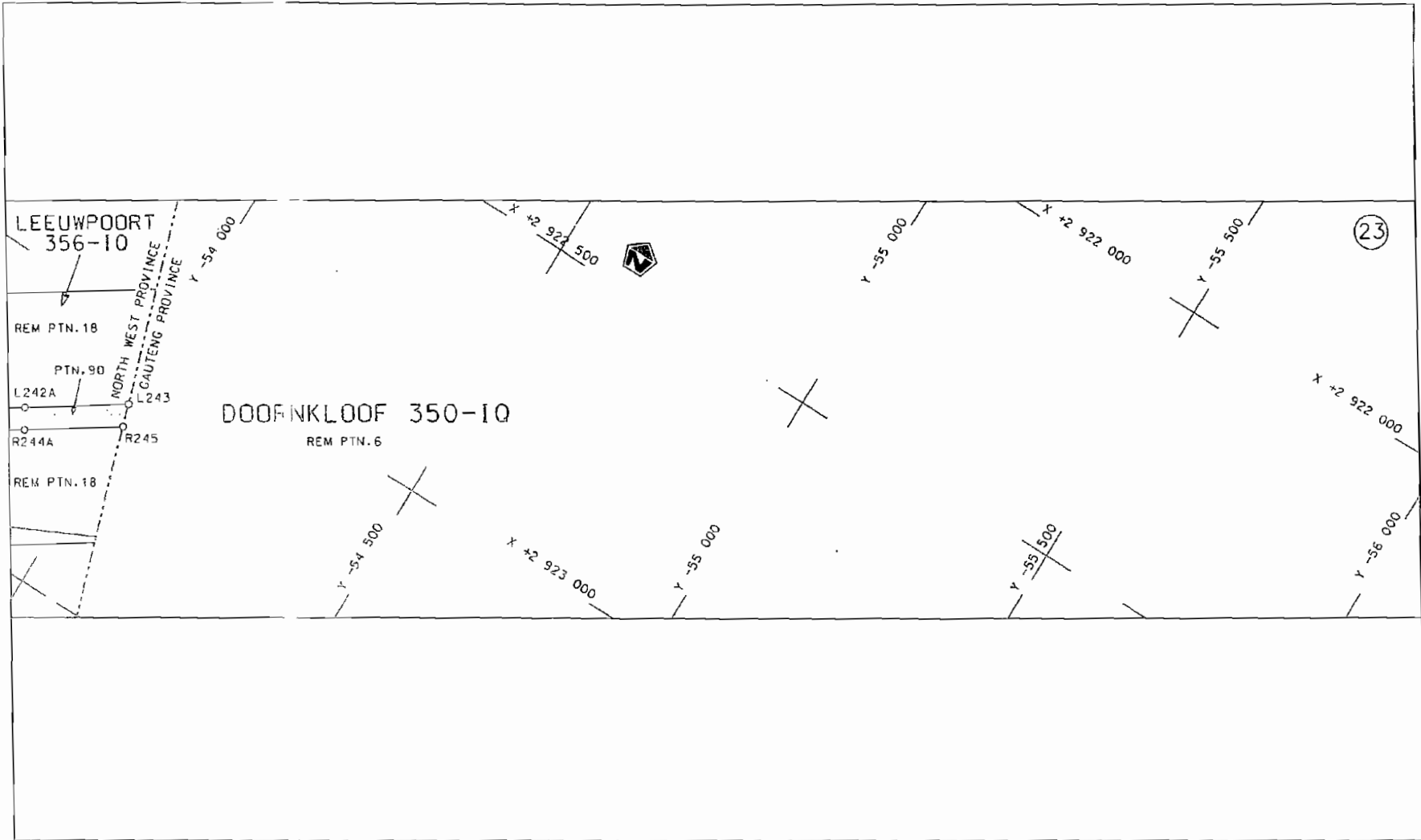

<p>Die Suid Afrikaanse Nasionale Padrentskop Beperk</p>	<p>Die figuur getoon</p>	<p>steldie padreserwe voor van 'n gedeelte represents the raad reserve of a portion</p>	<p>Vel Sheet 12 van of 17</p>
<p>The South African National Roads Agency Limited</p>	<p>The figure shown</p>	<p>van Nasionale Roete of National Route N12 Sektie Section 17</p>	<p>Plan P608/06</p>

PADRESERWE KOORDINATE / ROAD RESERVE CO-ORDINATES					
L1J1KERKANT/LEFT HAND SIDE			REGTERKANT/RIGHT HAND SIDE		
	Y	X	WG 27°	Y	X
L1	-13277.468	2 953964.989	R1	- 13 307.307	2 954 026.109
L2	- 13 399.656	2 953 829.379	R2	-13350.717	2 953 980.200
L3	- 13 479.308	2953740.978	R3	-13424.319	2 953 898.092
L4	- 13 564.789	2953646107	R4	- 13 580.912	2 953 723.402
L5	- 13 625193	2 953 576.103	R5	- 13 636.808	2 953658.465
L6	- 13 723.385	2 953 462.305	R6	-13811.545	2 953 455.461
L7	- 13 830.600	2953 338.050	R7	- 13 862.860	2 953 395.846
L8	- 13 833808	2953334319	R8	- 13 866.449	2953 391.675
L9	- 13 960635	2 953 186.809	R9	- 13 926.501	2953 321658
L10	-14091.936	2 953 034.096	RiO	- 13 985.932	2953252.365
L11	- 14 203.190	2 952 904.700	R11	-14029.515	2953201.549
L12	- '14 254.521	2 952 844.615	R12	- 14 068.937	2 953 155.585
L13	- 14 356.837	2 952 724.851	R13	- 14 121.323	2953094.507
L14	- 14 444.389	2 952 643.632	R14	- 14235.635	2952961225
L15	- 14 523.484	2 952 573.537	R15	- 14 244.292	2952951.247
L16	- 14 577.531	2 952 525.639	R16	- 14 323.853	2 952 859.552
L17	- 14 704.829	2952412.977	R17	- 14 330.678	2952851.686
L18	-14881.950	2952256.219	R18	-14416.567	2952 756.597
L19	- 14 971.890	2 952 176.621	R19	- 14 424.867	2952748.667
L20	- 15 148328	2 952 021 .138	R20	-14492737	2 952 683.830
L21	- 15 293.984	2 951 892.782	R21	- 14 558391	2 952 625.765
L22	- 15 343.524	2951 849125	R22	- 14 563.152	2 952 621.554
L23	-15526.532	2951686.410	R23	- 14 625.646	2952566285
L24	- 15 568.740	2951 636.812	R24	- 14 674.228	2 952 523.284
L25	- 15 615.246	2 951 595.658	R25	-14786.179	2952424.195
L26	- 15 690.662	2 951 528.922	R26	- 14 871.587	2 952 348.600
L27	- 15 597.703	2951 423.100	R27	- 14 944.346	2 952 284.199
L28	- 15 784.052	2951 257.778	R28	- 14 949.240	2952279.880
L29	- 15 877.368	2951 363.352	R29	- 15 033.626	2952205399
L30	-16004.396	2951 265.984	R30	- 15 107.708	2952 140.Q13
L31	- 16 349626	2 950 958.968	R31	-15194.589	2952063329
L32	- 16 446054	2950873.214	R32	-15209018	2 952 050.415
L33	- 16 607.987	2 950 729.208	R33	- 15284707	2951 982.677
L34	- 16 720233	2950643.758	R34	- 15 316.713	2951 954.033
L35	- 16 826.357	2950 570.976	R35	- 15647867	2951 661.535
L36	- 16 865.736	2950554615	R36	- 15 737.608	2951 591.039
L37	-16944.918	2 950 521.717	R37	- 15 740918	2951 592.801
L38	- 16 983820	2 950 502587	R38	- 15 812319	2 951 630.811
L39	-17119.545	2950435845	R39	- 15 846.780	2951 697.462
L40	- i 7 202.886	2 950 394.446	R40	- 16 029.478	2951 535.764
L41	- 17 495.615	2950248905	R41	- 15 930.149	2951 423.088
L42	- 17 622933	2950172546	R42	-15961968	2 951 395.606
L43	- 17 689 738	2 950 124.053	R43	- 16 132779	2951 243.029
L44	- 17 769.913	2 950 045.032	R44	- 16300.913	2951 092845
L45	- i 7 848.538	2 949 950.135	R45	- 16 467.538	2 950 944045
L46	- 17 964.124	2949826.208	R46	- 16 647.639	2 950 783.157
L47	-18012.595	2 949 763.131	R47	- 16 731.375	2950709114
L48	- 18 '123022	2949619425	R48	-16841.917	2 950 644.780
L49	-18119134	2 949 599.730	R49	- 16850400	2 950 639843
L50	- 18 306100	2949494.576	R50	- 16 867.818	2950630166
L51	- 18605.747	2 949 323.283	R51	- 17 020871	2950 554359

Vel 13 Van 17  
Sheet of

P608/06



PADRESERWE KOORDINATE			ROAD RESERVE CO-ORDINATES		
LINKERKANT/LEFT HAND SIDE			REGTERKANT/RIGHT HAND SIDE		
	y	X	WG 27°	y	X
L52	-19016.540	2 949 085.040	R52	- 17 058.275	2950535,716
L53	- 19 309310	2948851,00	R53	- 17 523.084	2950 304.167
L54	- 19908.210	2 948 343.630	R54	- 17 658,670	2 950 223.120
L55	- 20 086.470	2 948 165.960	R55	-1775'.335	2950 150.875
L56	- 20 106.579	2 948 141.936	R56	-17814.587	2950 088.171
L57	- 20144.570	2 948 096.505	R57	- 18 003.920	2949849.716
L58	- 20 514.469	2947627,302	R58	- 18 030.382	2949803.129
L59	-20817704	2 947 242.529	R59	- 18 096.429	2949721.369
L60	- 20 980.421	2947037.140	R60	-18160,051	2949642.612
L61	- 21 116.294	2 946 865.636	R61	- 18 338,825	2949 514.806
L62	- 21 514.605	2946389.993	R62	-18626.784	2949 352.686
L63	- 21 688.385	2946182.824	R63	- 19 004,557	2949 139.998
L64	- 21 748.533	2 946 111.119	R64	-19176.429	2949 007.415
L65	- 21 835.085	2945997,884	R65	- 19 566.307	2948679.902
L66	- 21 864.014	2 945 954.781	R66	- 19 934.092	2948372.015
L67	- 21 865.144	2 945 953.097	R67	- 20105,193	2948203.628
L68	- 22 052.84'	2 945 641.835	R68	- 20120.622	2948 186.542
L69	- 22 310.009	2945211.842	R69	- 20 138.640	2 948 166,590
L70	- 22587.808	2944747.226	R70	- 20 221.119	2948064.270
L71	- 22 818562	2944361,684	R71	- 20546.791	2947651,056
L72	- 23107.874	2 943877.428	R72	- 20 849,752	2947266,517
L73	- 23280,641	2943588,078	R73	- 21011.284	2947061,912
L74	- 23 322.567	2943 517,860	R74	- 21 173,854	2946 858,801
L75	- 23375.602	2 943 434,362	R75	-21550352	2945409,250
L76	- 23 676.288	2942984,126	R76	- 21 785797	2946 126,676
L77	- 24 019.007	2942474655	R77	- 21 835831	2946 064,728
L78	- 24 023.763	2942468258	R78	- 21 885982	2945992,998
L79	- 24105068	2 942 358.900	R79	- 22 087,321	2945661,874
L80	- 24 179.323	2 942 275.608	R80	- 22 347021	2945227,947
L81	- 24 406.388	2 942 065.395	R81	-22621152	2 944 769,559
L82	- 24 410.818	2 942 061.294	R82	- 22 848,885	2944388,250
La3	- 24 574,607	2 941 914,333	R83	- 23 143,607	2943895808
L84	- 24 934.405	2 941 589,329	R84	- 23 284,953	2943 650,730
L85	- 25254.201	2 941 300,617	R85	- 23 292,783	2943637,940
L86	- 25 563.035	2941 021,339	R86	- 23 410179	2 943 454,824
La7	-25747393	2940856534	R87	- 23 710440	2943 004,620
L88	- 25 917,254	2940702315	R88	- 23 825520	2942833310
L89	- 26 290.094	2940 366519	R89	- 23 986285	2942593993
L90	- 26 722.591	2 939 978.509	R90	- 24 099057	2942 431,557
L91	- 26 798.390	2939911120	R91	- 24 170,517	2942 347,957
L92	-26812054	2939 898,963	R92	- 24268,778	2942 248,007
L93	-27063.818	2 939 657,641	R93	- 24 601995	2 941 943,235
L94	- 27 286 708	2 939 303 054	R94	- 25 284 012	2 941 326,886
L95	- 27 636.917	2939031391	R95	- 25 605,594	"94',036,519
L96	- 28110,349	2 938 618,362	R96	- 25 931,296	2940742559
L97	-28419,900	2 938 345,356	R97	- 26321,062	2940391,873
L98	- 28 428303	2938339800	R98	- 26732378	2 940 023,176
L99	- 28482,731	2938303812	R99	- 26 912,034	2 939 861,584
L100	- 28564,577	2938234907	R100	- 26 924097	2939 849824
L101	- 28 660,795	2938 153904	R101	- 27 093451	2939 684,718
L102	- 28773,129	2938059332	R102	-27413,107	2939 333,460

Vel 14 Van 17  
Sheet of

P608/06

PADRESERWE KOORDINATE / ROAD RESERVE CO-ORDINATES					
LINKERKANT/LEFT HAND SIDE			REGTERKANT/RIGHT HAND SIDE		
	Y	X	WG 27°	Y	X
L103	- 28 910990	2937943.270	R103	- 27 723.089	2 939002.420
L104	- 28 961.837	2937899.867	R104	- 28242.736	2 93B 556.938
L105	- 29 089.309	2 937 791.058	R105	- 28 247.038	2 938 553.250
Li06	-29261.813	2937643.809	R106	- 28366584	2938450.776
L107	-29528.160	2937411.668	R107	- 28451630	2 938 377.847
L108	-29638446	2937315.545	R10B	- 28581.733	2938266322
L109	- 3D023991	2936979719	R109	- 28673072	2 938 188.395
L110	- 30 404.559	2936648.487	R110	- 28783.696	2938097.195
L111	- 30650 755	2936259.991	R111	- 28 973.909	2 937 937839
L112	- 30 854.527	2936254.618	R112	.29 100.726	2937833.771
L113	- 30 961.978	2936161.441	R113	- 29306097	2937657660
L114	- 31 094.657	2 936 046.388	R114	- 29 439852	2 937 541.282
L115	- 31 243.860	2935917.007	R115	- 29 672.309	2937339026
L116	- 31 590.889	2935614.648	R116	- 30 071.741	2 936 991008
L117	- 31 937.661	2935312.468	R117	- 30 438.185	2 936 671.579
L118	- 32 478273	2934841.217	R118	- 30 921.287	2936250.71B
L119	- 32 5B4.703	2934751.570	R119	- 31 145.591	2 936 055.313
L120	- 32 685.663	2 934 673.343	R120	- 31 278.440	2935 939.580
L121	- 33 046.411	2934418.163	R 21	- 31616.485	2 935 645.00B
L122	-33118561	2934367.126	R122	- 31954.616	2935350.337
L123	- 33 573151	2934046.479	R123	- 32 612.406	2934780.364
L124	- 33 961.792	2933 772.526	R124	- 32 717.029	2934700083
L125	- 34 404.585	2933459679	R125	- 32 941.791	2 934 541.083
L126	-34692.414	2 933 254.811	R126	.33136.298	2 934 403.486
L127	- 34 777.396	2933 180591	R127	- 33 584922	2934086966
L128	- 34 785744	2 933 1723C8	R128	- 33 991.219	2933800.085
L129	- 34 791.420	2 933 166.674	R129	- 34 424.167	2933494845
LBO	- 34 872.159	2933069214	R130	- 34 735.976	2933271512
L131	- 35 080029	2 932 782.222	R131	- 34 789.314	2933224.719
L132	- 35 313.205	2 932 462.652	R132	- 34 797.316	2933 212.466
L133	- 35 407266	2932335326	R133	- 34 813373	2933 195.661
L134	- 35442297	2 932 302.378	R134	- 34846.719	2933 160.734
L135	- 35 539.358	2932211.090	R135	- 34 903.584	2933089733
L136	- 35 631.872	2 932 147.367	R136	- 35 167.379	2932 723.457
L137	-36124.169	2 931 896.263	R137	- 35 302865	2932 535298
L138	- 36 377849	2931 766.824	R138	-35410518	2932 385396
L139	- 36 634625	2 931 638.007	R139	- 35 448.812	2 932 341.723
L140	- 36 766.460	2931 590.358	R140	- 35 526.224	2932 273191
L141	- 37 067.918	2931518.850	R141	-35592149	2932 221.438
L142	-37260723	2931477095	R142	- 35 667.652	2932 172.430
L143	- 37 434.662	2931 439.426	R143	- 35 842.842	2 932 081.089
L144	-37601384	2931 403.320	R144	- 35 944.340	2932 024048
L145	- 37 774129	2931 365554	R145	- 36 365.041	2931 809.399
L14b	- 38 053.092	2 931 205.541	k14b	- 36 612.107	2 931 690.536
L147	- 38 504907	2931 205.788	R147	- 36 751.475	2931 637332
L148	- 38787.854	2931 140997	R148	- 36 664.255	2931 605055
L149	- 38 946.967	2931061986	R149	- 37 264.278	2931517349
L150	- 39 444.095	2930 840011	R150	- 37438.206	2931 479.215
L151	- 39 677.971	2930 726.177	R151	- 37 619.479	2931439.470
L152	- 39 873.700	2930624.501	R152	- 37 690.695	2931 424.001
L153	- 39 962550	2930561.979	R153	- 38 062.723	2931343.192

Vel 15 Van 17 P60S/06  
Sheet of

PADRESERWE KOORDINATE / ROAD RESERVE CO-ORDINATES					
LINKERKANT/LEFT HAND SIDE			REGTERKANT/RIGHT HAND SIDE		
	Y	X	WG 27°	Y	X
L154	- 40 163.045	2 930 336080	R154	- 38518111	2 931 243.707
L155	- 40 206.514	2 930 257.681	R155	- 38 842.179	2931 165.481
L156	- 40 233.745	2930 194284	R156	- 38 976085	2931 112.501
L157	- 40 249.142	2 930 152804	R157	- 39 462.761	2 930 875.947
L158	- 40307.351	2 929 963.999	R158	- 39 685.605	2930 765.361
L159	-40317.623	2 929 929.308	R159	- 39 866.801	2 930 675.443
L160	- 40 430.500	2 929 548.087	Ri60	- 39 900895	2930654.631
L161	- 40 497.261	2 929 366.261	R161	- 39 996834	2 930 585.446
L162	- 40 530.990	2 929 287.600	R162	- 40 077.916	2930 509.694
L163	- 40564.590	2929196.700	R163	-40117.861	2930465668
L164	- 40 675.668	2 928 923.427	R164	-40143.513	2930434.351
L165	- 40709.008	2 928 833.938	R165	- 40 178.822	2930385.708
L166	- 40 932.683	2 928 312.893	R166	- 40 229.805	2 930 300.444
L167	- 40 986.639	2928236.762	R167	- 40279.657	2930189.810
L168	- 41 043.594	2928163135	R168	- 40306.063	2930 108.021
L169	-41107.114	2928093266	R169	- 40358940	2 929 926.200
L170	-41176.132	2928028.729	RHO	- 40 451.390	2 929 616.840
L171	- 41 249.539	2 927 967.496	R171	- 40547.650	2929 344.840
L172	- 41 356.630	2 927 900.268	R172	- 40 885670	2928 502.070
L173	- 41450.831	2927841.132	R173	- 40939.510	2 928 388.020
L174	-41569904	2 927 790.198	R174	- 41 022.830	2928255.210
L175	- 41 795.968	2 927 710696	R175	-41137.890	2928 118.280
L176	- 42 029.249	2 927 626.908	R176	-41188.780	2928 069.180
L177	- 42 101.439	2927 600.597	R177	- 41 377.580	2927938260
L178	- 42 161.484	2 927 578.713	R178	- 41 470.599	2927 878.357
L179	- 42 249.843	2 927 546.509	R179	-41585.361	2 927 829.267
L180	- 42 432.231	29274446925	R180	- 42 218.507	2927 598.670
L181	- 42 498.423	2927397.825	R181	- 42 283.153	2927575126
L182	- 42 669.401	2 927 249.878	R182	- 42 293.418	2927569.876
L183	- 42 854359	2 927 081.495	R183	-42389571	2927 520.697
L184	- 43 096.931	2 926 872.235	R184	- 42471.439	2927467.910
L185	- 43 219.830	2 926 790.433	R185	- 42708018	2927 265.653
L186	- 43 314.138	2 926 738.409	R186	- 43 098021	2926921.329
L187	- 43361.151	2 926 717.423	R187	- 43 245.228	2926822449
L188	- 43 450.058	2 926 677.735	R188	-43320.125	2926 779.955
L189	- 43 471226	2 926 668.759	R189	- 43 401.005	2926 741.258
L190	- 43 566030	2 926 636.870	R190	- 43 482.821	2926 707.500
L191	- 43 584088	2 926 632.117	R191	- 43 742.117	2926635676
L192	- 43 669.302	2 926 609.690	R192	- 44 295.852	2926 564.643
L193	- 43 742.529	2926 594.647	R193	- 44 756.595	2 926 508522
L194	- 43 859.388	2 926 577.600	R194	- 45236.221	2 926 449.405
L195	- 44 305.970	2 926 522902	R195	-45790.126	2926381.964
L196	- 44749730	2926469065	R196	- 45981.487	2926 349.554
L197	- 45 241.400	2 926 400.000	R197	- 46 100.410	2 926 314.000
L198	- 45 595652	2 926 365.401	R198	- 46 597.561	2 926 139552
L199	- 45 789 097	2 926 341.809	R199	- 47 081.542	2925966718
L200	- 45 879511	2 926 329.473	R200	- 47 355.354	2 925 870.637
L201	- 46 044073	2926291.695	R201	-47363.113	2925 868.666
L202	- 46574.983	2926105.612	R202	- 47 518.322	2925839.982
L203	- 47 072.174	2925927.143	R203	- 47552671	2 925 837.767
L204	- 47 369.720	2 925825.692	R204	- 47 689.984	2925834.520

Vel	16	Van	17	P60S/06
Sheet		of		

PADRESERWE KOORDINATE / ROAD RESERVE CO-ORDINATES						
LINKERKANT/LEFT HAND SIDE			REGTERKANT/RIGHT HAND SIDE			
	Y	X	WG 27°	y	X	
L205	-47459.883	2 925 807.241		R205	-47733.011	2 925 835.596
L206	- 47570.317	2 925 797.032		R206	-47933.696	2925832.901
L207	- 47931.790	2925793.061		R207	- 48 209.340	2925828.978
L208	- 48202.841	2 925 790.598		R208	- 48 901.981	2 925 823.758
L209	- 48 282.032	2925 790.099		R209	- 49 012.592	2 925 815.432
L210	-48904.334	2925783494		R210	- 49178.304	2925778951
L211	-49003.711	2925 776.376		R211	- 49 656.892	2925 575.880
L212	- 49 167.463	2925 739.655		R212	- 49762.324	2925531.444
L213	- 49624.210	2925544426		R213	- 49 824.939	2 925 498.392
L214	-49801.778	2925467.972		R214	- 50172460	2925345746
L215	- 50159.974	2925 312.258		R215	- 50 337.304	2925275878
L216	- 50 170.120	2 925 307.848		R216	- 50 519.014	2925 195029
L217	- 50 266.546	2925262.827		R217	- 50 919.590	2925017.161
L218	- 50 344.770	2925229.230		R218	- 50 976.357	2924991.441
L219	-50484.898	2925164.647		R219	- 51 034.024	2924959.082
L220	- 50 511.319	2925 153.006		R220	- 51 181.024	2924886.973
L221	-50616.165	2925 106.813		R221	- 51 182681	2 924 882.844
L222	- 50 907.377	2924 976.756		R222	- 51 294.074	2924815.983
L223	-51000026	2 924 935.378		R223	- 51 386.007	2 924 760.265
L224	- 51082.215	2924894.544		R224	- 51 483.922	2924700.922
L225	- 51172.122	2924851.391		R225	-51551.390	2 924 659.311
L226	-51251.011	2924802.377		R226	-51841.745	2924484.716
L227	- 51 361.809	2 924 730.056		R227	- 51904.140	2924447.016
L228	- 51474418	2924660.612		R228	- 51 948896	2924419973
L229	- 51 906.551	2 924 399.242		R229	- 52 020 190	2924375.996
L230	- 52 049464	2924312.561		R230	- 52 339.085	2 924 179.292
L231	- 52 300484	2924160.310		R231	- 52 377.856	2 924 155.377
L232	- 52 370.378	2924 117.917		R232	- 52 408.009	2 924 141.196
L233	- 52 670.977	2923944.279		R233	-52412810	2924 134.351
L234	- 52 732.217	2923910.372		R234	-52514419	2 924071.945
L235	-52774.198	2923887.127		R235	- 52 747125	2 923 935.022
L236	- 52 792.896	2923876775		R236	- 52 772.507	2 923 920.088
L237	- 52968430	2 923 774.955		R237	- 52 780.398	2 923 915.445
L238	- 53 050804	2923730 701		R238	- 52 963.538	2923817891
L239	- 53 258491	2923618506		R239	- 52 991.498	2 923808.322
L240	- 53 264.208	2923615335		R240	- 53 068.716	2 923 768.404
L241	- 53 335.821	2923575.374		R241	- 53 379.001	2923595.935
L242	- 53 522.007	2923456.918		R242	- 53 404.455	2 923 580.825
L243	- 53 998.822	2923 136.386		R243	- 53 520.836	2923505196
				R244	- 53 563.743	2923476389
				R245	- 54 011.249	2923 175.280

Vel	17	Van	17	P60S/06
Sheet		of		