

CONTENTS**INHOUD**

<i>No.</i>	<i>Page No.</i>	<i>Gazette No.</i>	<i>No.</i>	<i>8/edsy No.</i>	<i>Koeran! No.</i>
GOVERNMENT NOTICE			GOEWERMENSKENNISGEWING		
Transport, Department of			Vervoer, Departement van		
<i>Government Notice</i>			<i>Goewermentskennisgewing</i>		
776			776		
South African National Roads Agency Limited and the National Roads Act (7/1998): The South African National Roads Agency Limited: Declaration amendment of National Road R37 Section 1: Amendment of Declaration No. 619 of 2006	.	3 30216	Suid-Afrikaanse Nasionale Padagentskap Beperk en die Nasionale Paaie Wet (7/1998): Die Suid-Afrikaanse Nasionale padagentskap Beperk: Verklaring wysiging van Nasionale Pad R37 Seksie 1: Wysiging van Verklaring No. 619 van 2006	.	4 30216

GOVERNMENT NOTICE
GOEWERMENTSKENNISGEWING

DEPARTMENT OF TRANSPORT
DEPARTEMENT VAN VERVOER

No. 776

24 August 2007

THE SOUTH AFRICAN NATIONAL ROADS
AGENCY LIMITED

Registration No: 98/09584/06

DECLARATION AMENDMENT OF NATIONAL ROAD R37 SECTION 1

AMENDMENT OF DECLARATION No. 619 OF 2006

By *virtue* of section 40 (1)(b) of the South African National Roads Agency limited and the National Roads Act, 1998 (Act NO.7 of 1998), I hereby amend Declaration No.619 of 2006. by substituting sheets 1 to 34 with the subjoined sheets 1A to 34A of Plan *P547/2005*.

(National Road R37 Section 1: Polokwane - Limpopo/Mpumalanga Provincial Border)

J. Radtke

No. 776

24 Augustus 2007

**DIE SUID-AFRIKAANSE NASIONALE
PADAGENTSKAPBEPERK**

Registrasie No: 98/09584/06

VERKLARING WYSIGING VAN NASIONALE PAD R37 SEKSIE 1

WYSIGING VAN VERKLARING NO. 619 VAN 2006

Kragtens Artikel40(1)(b) van die Suid Afrikaanse Nasionale Padagentskap Beperk en die Nasionale Paaie Wet, 1998 (Wet No.7 van 1998), wysig ek hiermee Verklaring NO.619 van 2006, deur velie 1 tot 34, te vervang met meegaande velie 1A tot 34A van Plan *P547/2005*.

(Nasionale Pad R37 Seksie 1: Polokwane - Limpopo/Mpumalanga Provinsiale Grens)
J. Raath

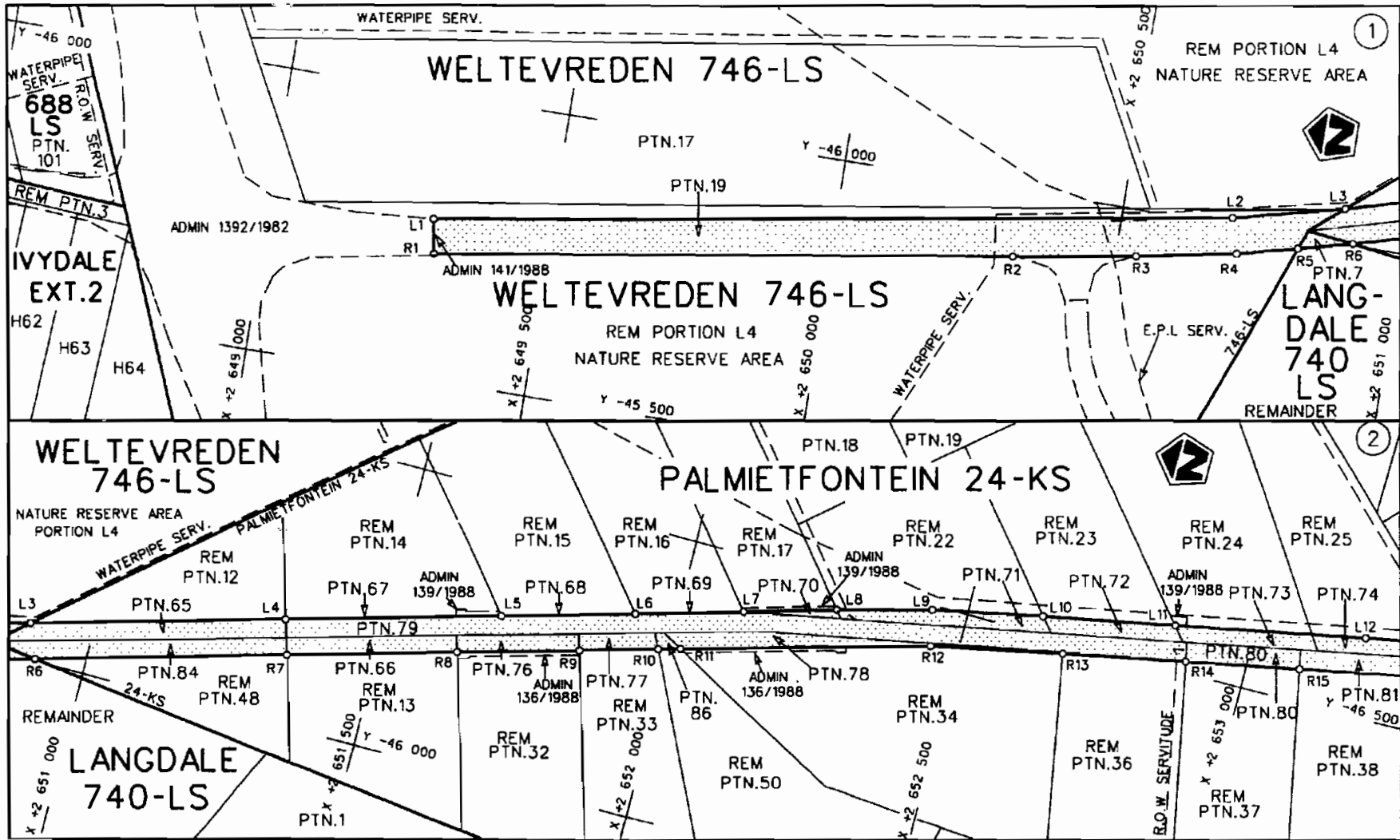

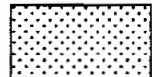
Suid-Afrikaanse Padagentskap Bpk. South African National Roads Agency Ltd.	Die figuur getoon The figure shown	 steldie padreserwe voor van 'n gedeelte represents the road reserve of a portion von Nasionale Roete of National Route	Vel Sheet 1A van 34 of P 547/2005
R37 1 1			P 547/2005

D.O.9.A

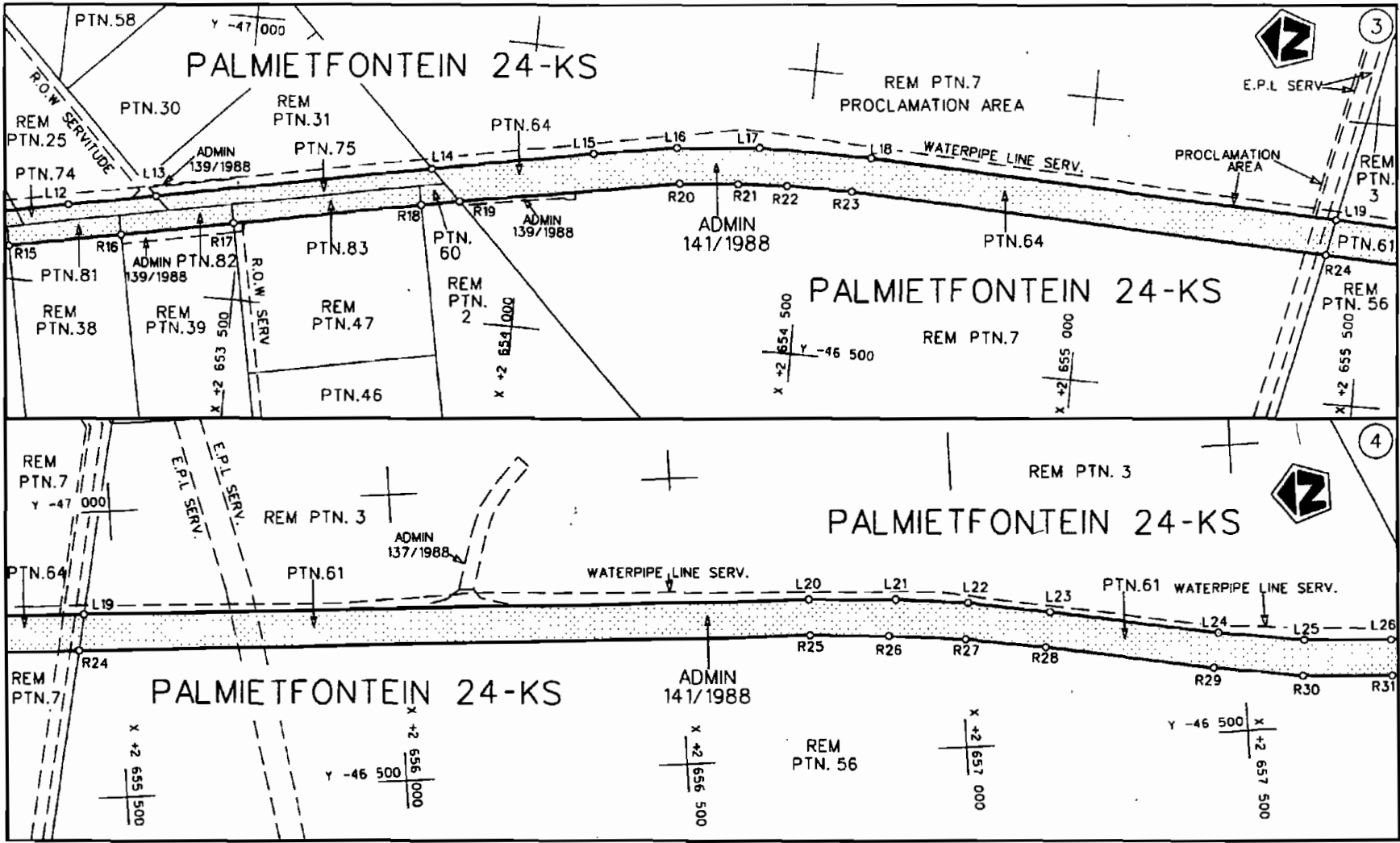

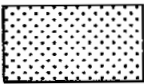
<p>Suid-Afrikaanse Padogentskap Bpk. South African National Roads Agency Ltd.</p>	<p>Die figuur getoon The figure shown</p>	 <p>steldie padreserwe voor van 'n gedeelte represents the road reserve of a portion van Nasionale Roete R37 Seksie of National Route R37 Section 1</p>	<p>Vel Sheet 2A of 34 P 547/2005</p>
---	---	---	--

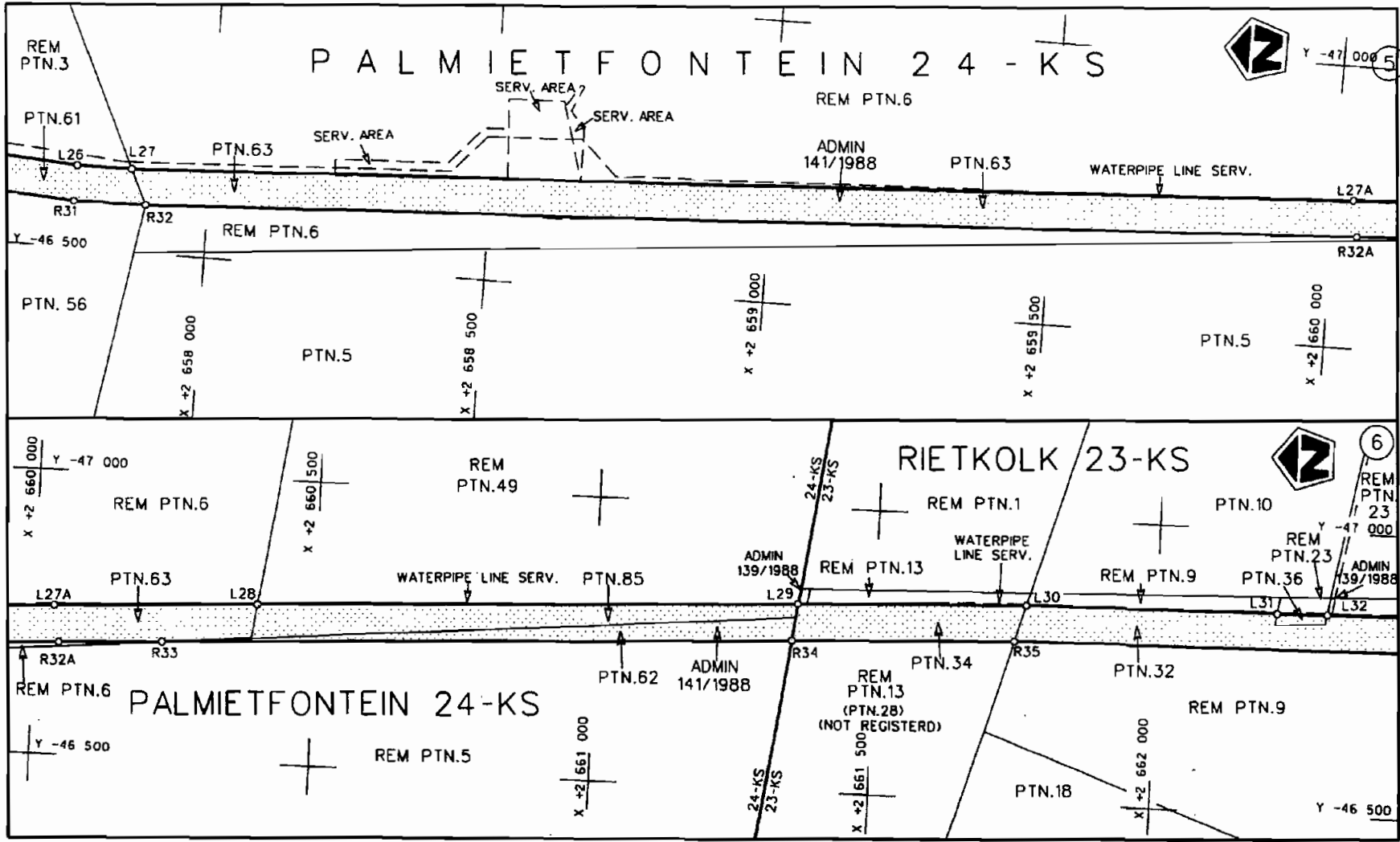

Suid-Afrikaanse Padogentskap Bpk.
South African National Roads Agency Ltd.

Die figuur getoon
The figure shown

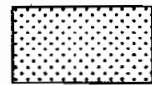

steldie padreserwe voor van 'n gedeelte
represents the road reserve of a portion
van Nasionale Roete
of National Route

R37
Seksie
Section

1

Vel Sheet 3A van of 34
P 547/2005

D.O.9.A

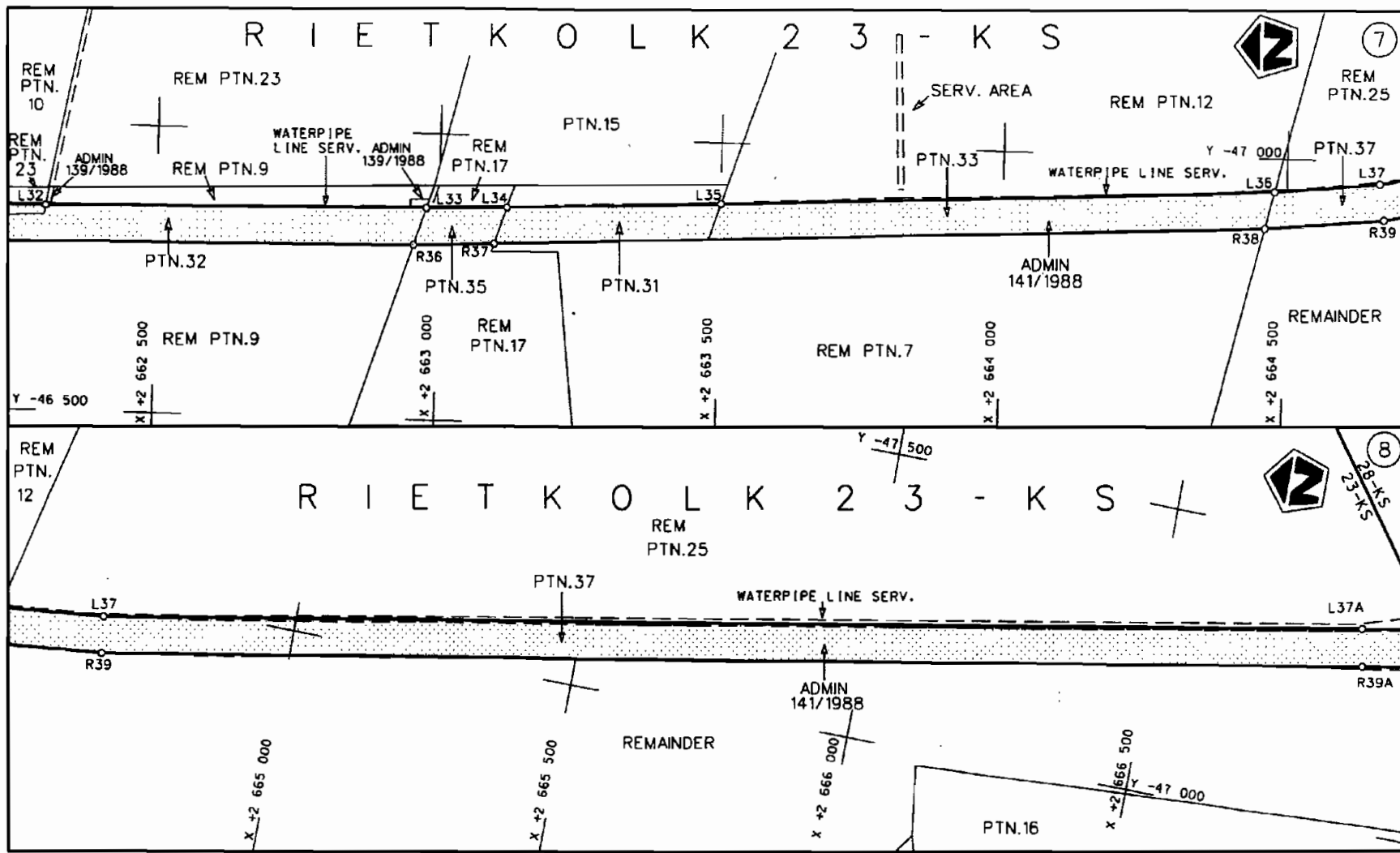

Suid-Afrikaanse Padagentskap Bpk. South African National Roads Agency Ltd.	Die figuur getoon The figure shown		staldie padreserwe voor van 'n gedeelte represents the road reserve of a portion van Nasionale Roete of National Route	Vel Sheet 4A of 34 P 547/2005
			R37 Seksie Section 1	

D.O.9.A

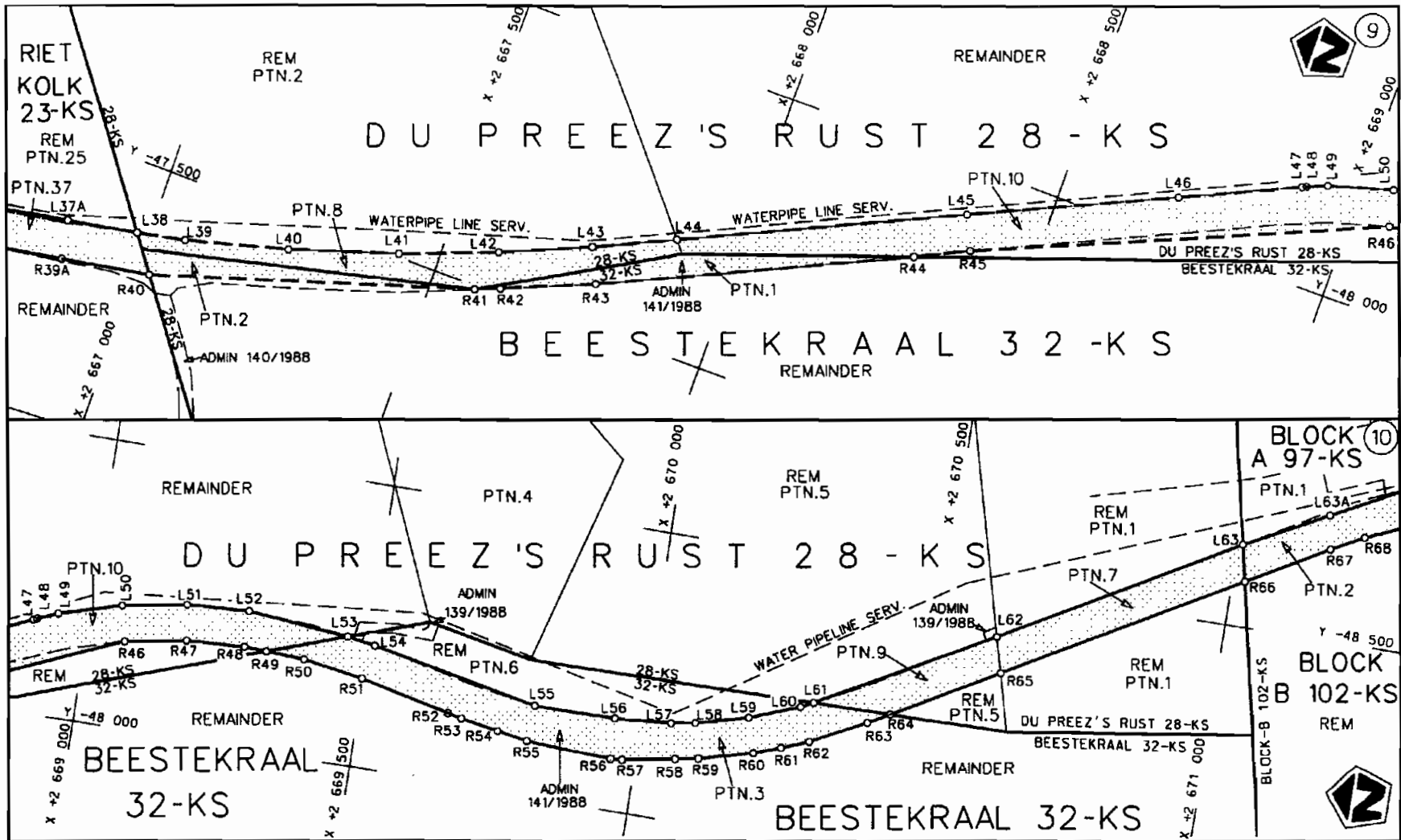

Suid-Afrikaanse Padogentskap Bpk.
South African National Roads Agency Ltd.

Die figuur getoon
The figure shown



steldie padreserve voor van 'n gedeelte
represents the road reserve of a portion
vbn Nasionale Roete R37 Seksie 1
of National Route

Vel Sheet 5A van of 34
P 547/2005

D.O.9.A

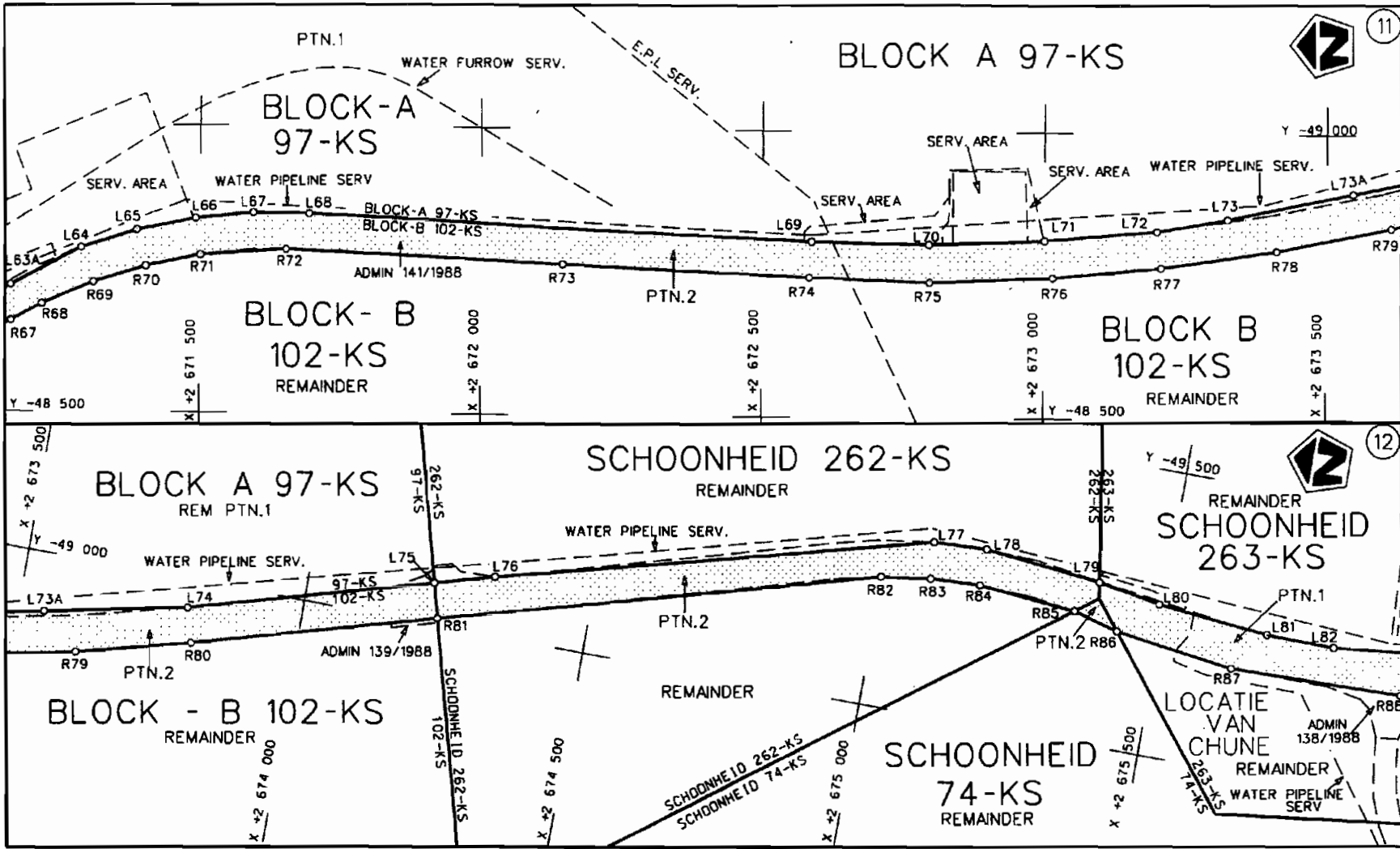

Suid-Afrikaanse Padogenskap Bpk.
South African National Roads Agency Ltd.

Die figuur getoon
The figure shown



steld die padreserwe voor van 'n gedeelte
represents the road reserve of a portion
von Nasionale Roete R37 Seksie 1
of National Route R37 Section 1

Vel Sheet 6A van 34
of of
P 547/2005

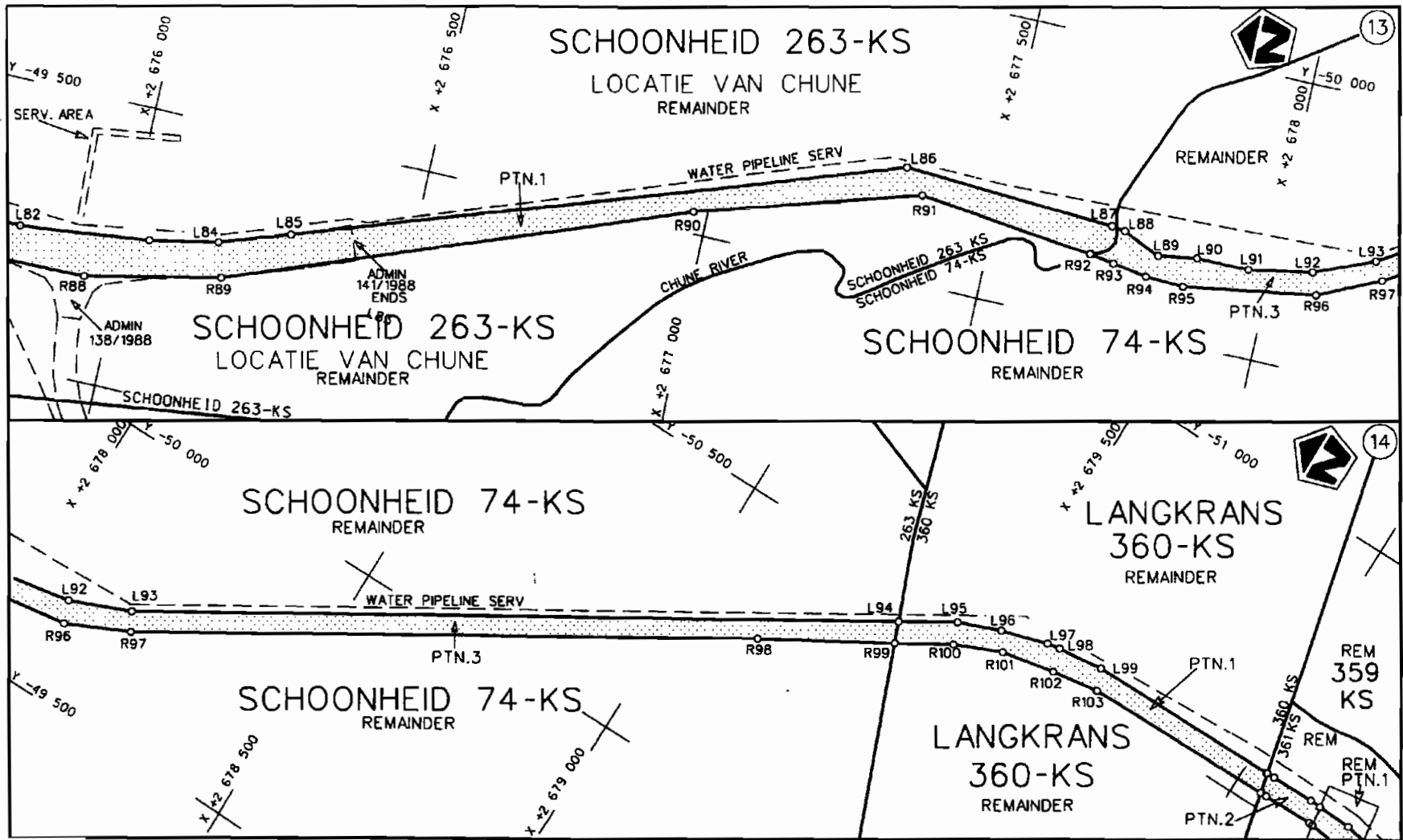

Suid-Afrikaanse Padogentskop Bpk. South African National Roads Agency Ltd.	Die figuur getoon The figure shown		steldie padreserwe voor van 'n gedeelte represents the road reserve of a portion van Nasionale Roete of National Route	Vel Sheet 7A van of 34 P 547/2005
			R37 Seksie 1	

D.O.9.A

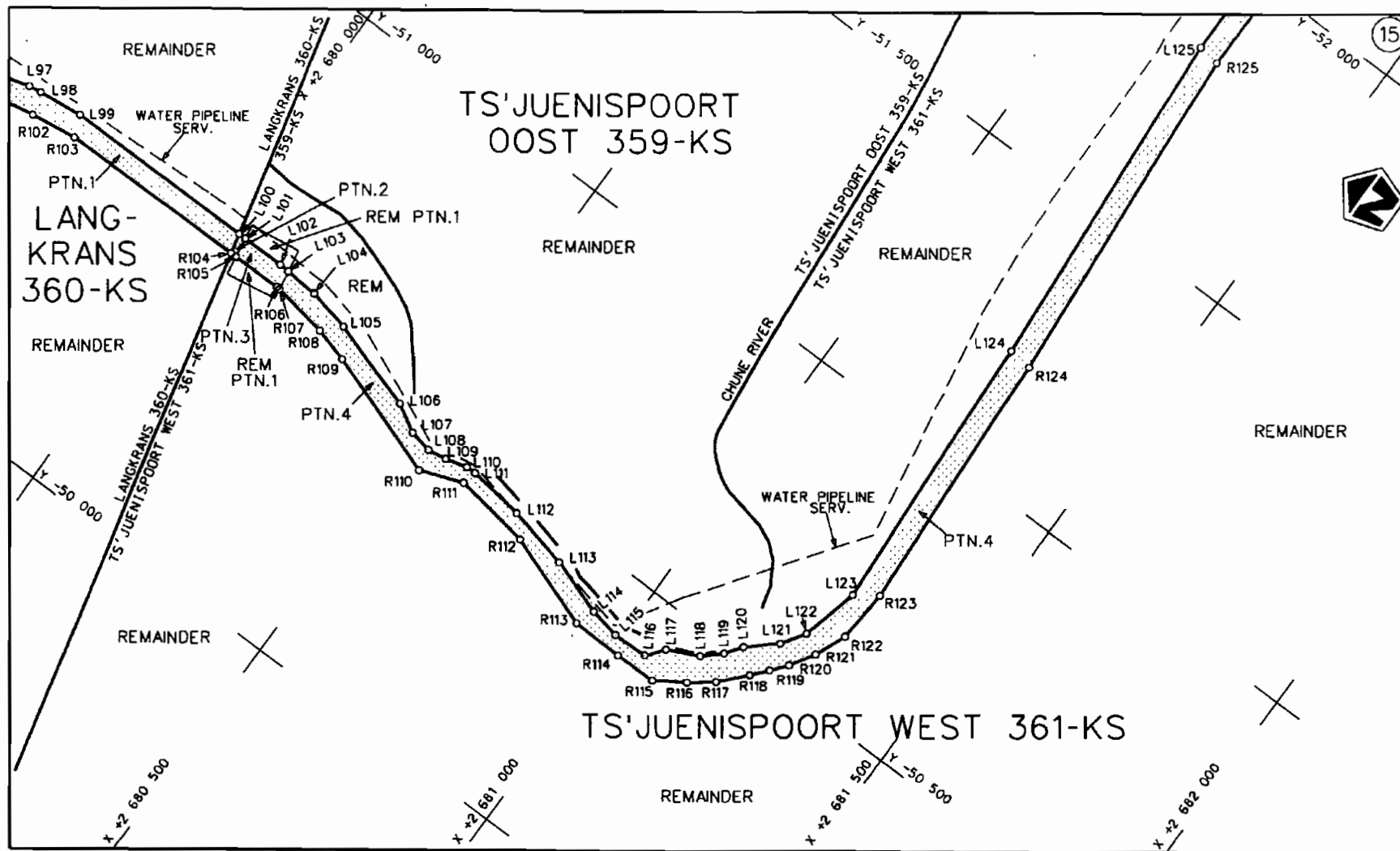

Suid-Afrikaanse Padagentskap Bpk.
South African National Roads Agency Ltd.

Die figuur getoon
The figure shown



steldie padreserwe voor van 'n gedeelte
represents the road reserve of a portion
van Nasionale Roete R37 Seksie
of National Route R37 Section 1

Vel
Sheet 8A van
of 34
P 547/2005

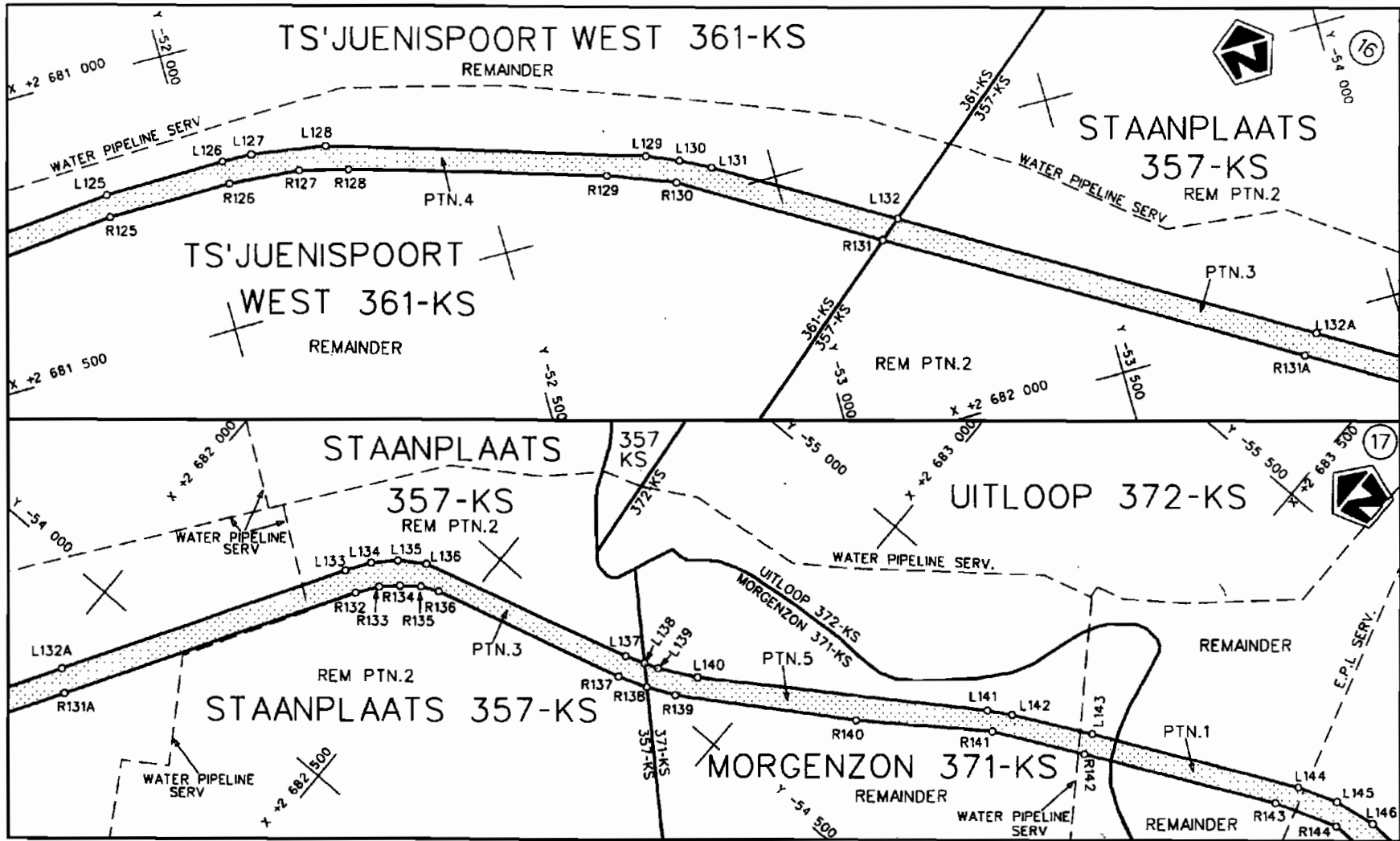

Suid-Afrikaanse Padagentskap Bpk.
South African National Roads Agency Ltd.

Die figuur getoon
The figure shown

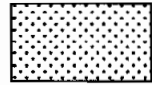

steldie podreserwe voor van 'n gedeelte
represents the road reserve of a portion
van Nasionale Roete R37 Sektie 1
of National Route R37 Section 1

Vel Sheet 9A van of 34
P 547/2005

D.O.9.A

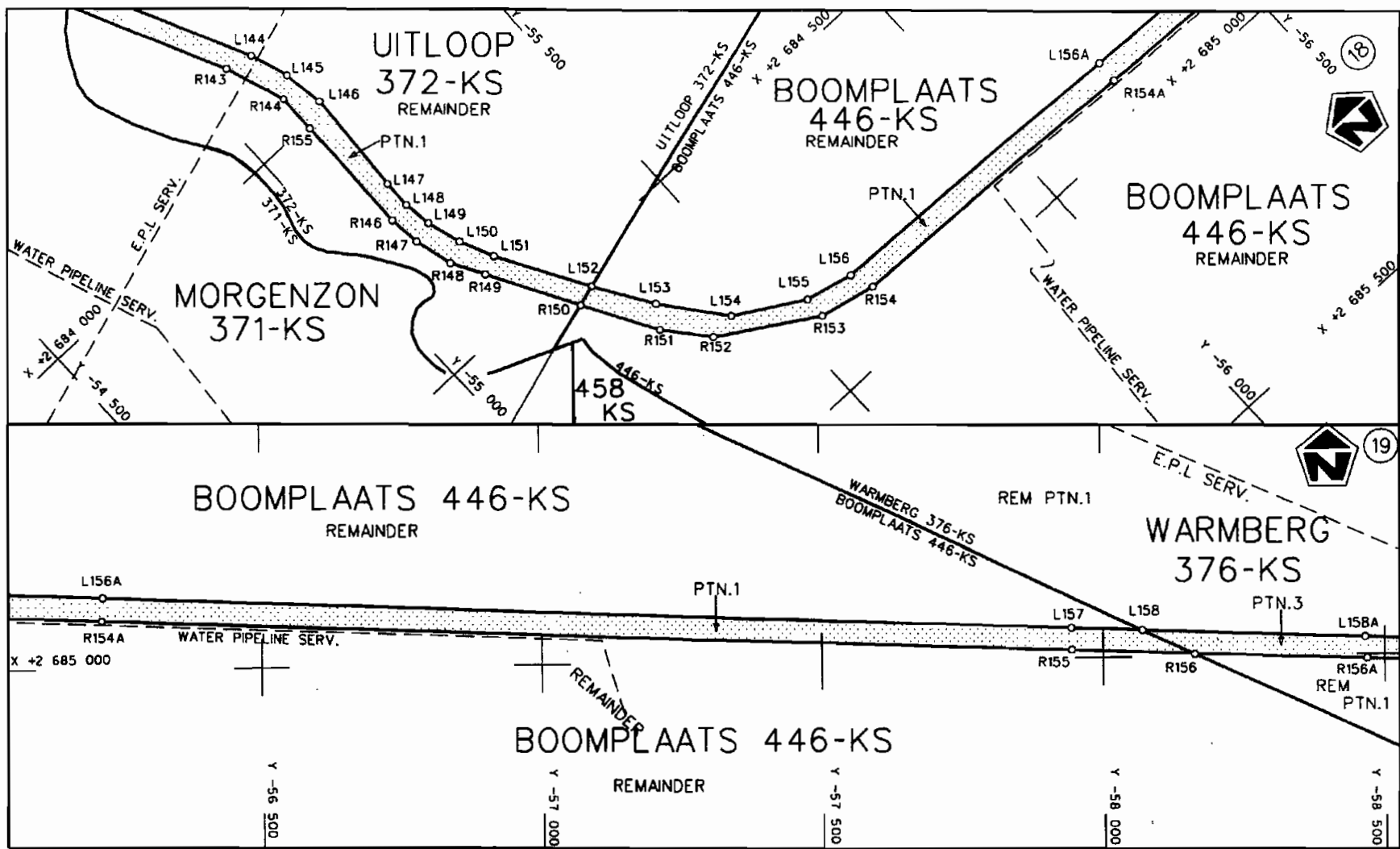

<p>Suid-Afrikaanse Padagentskop Bpk. South African National Roads Agency Ltd.</p>	<p>Die figuur getoon The figure shown</p> 	<p>stel die padreserwe voor van 'n gedeelte represents the road reserve of a portion van Nasionale Roete R37 of National Route R37</p> <p>Seksie 1 Section 1</p>	<p>Vel Sheet 10A van of 34 P 547/2005</p>
---	--	--	---

D.O.9.A

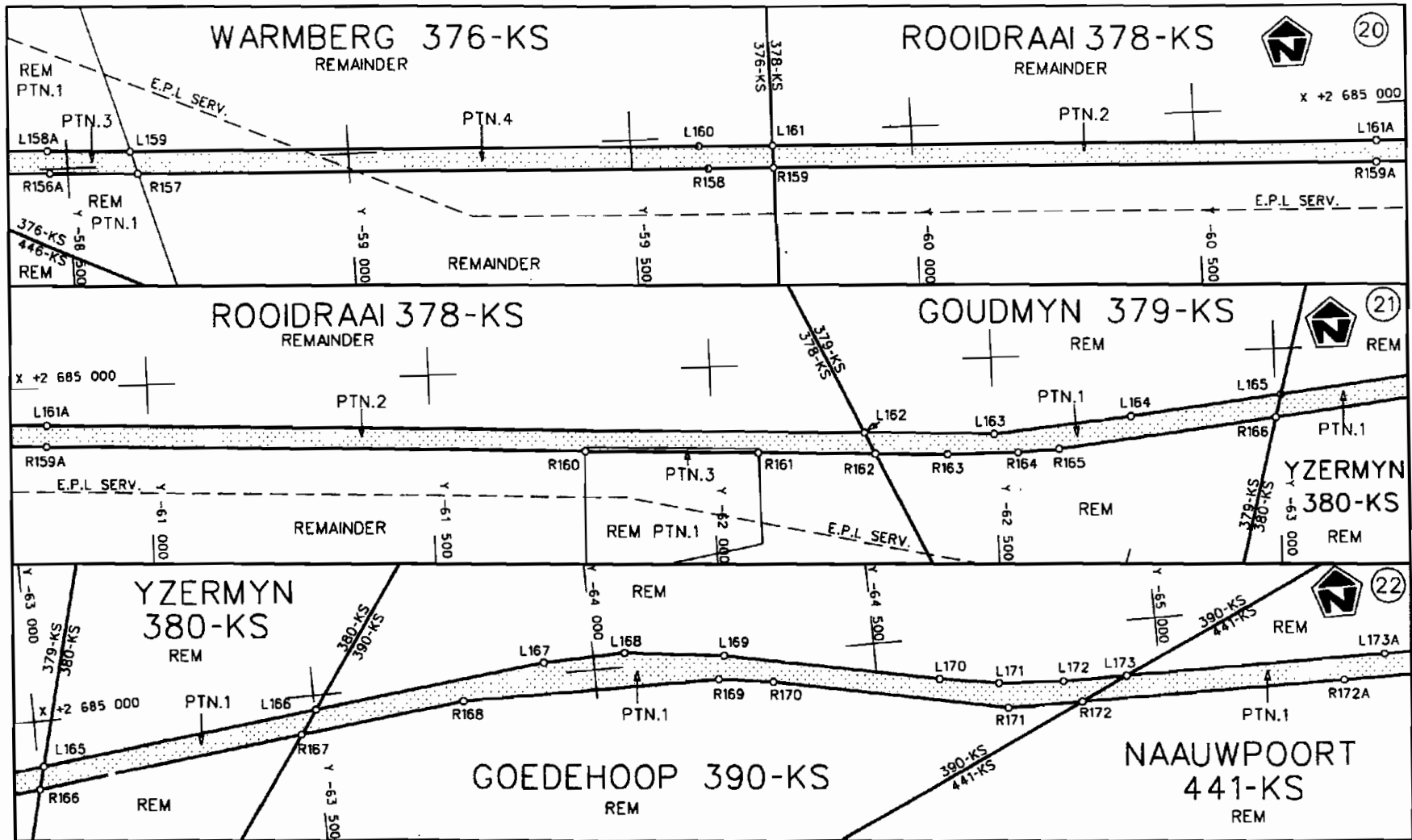

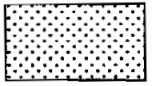
Suid-Afrikaanse Podagentskop Bpk. South African National Roads Agency Ltd.	Die figuur getoon The figure shown		steldie podreserwe voor van 'n gedeelte represents the road reserve of a portion van Nasionale Roete of National Route	Vel Sheet 11A van 34 of P 547/2005
---	---------------------------------------	--	---	---

R37 Seksie 1

D.O.9.A

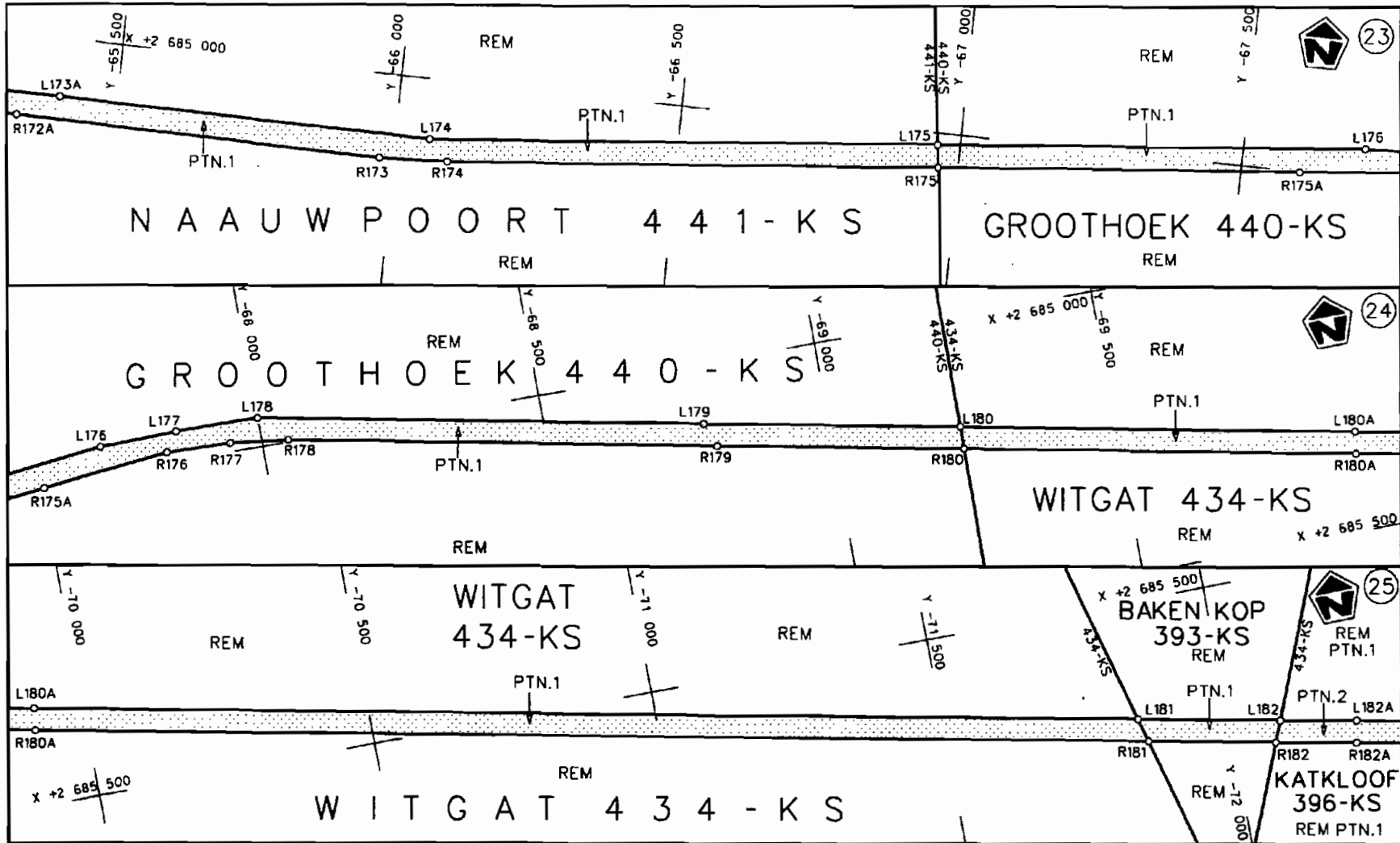

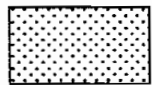

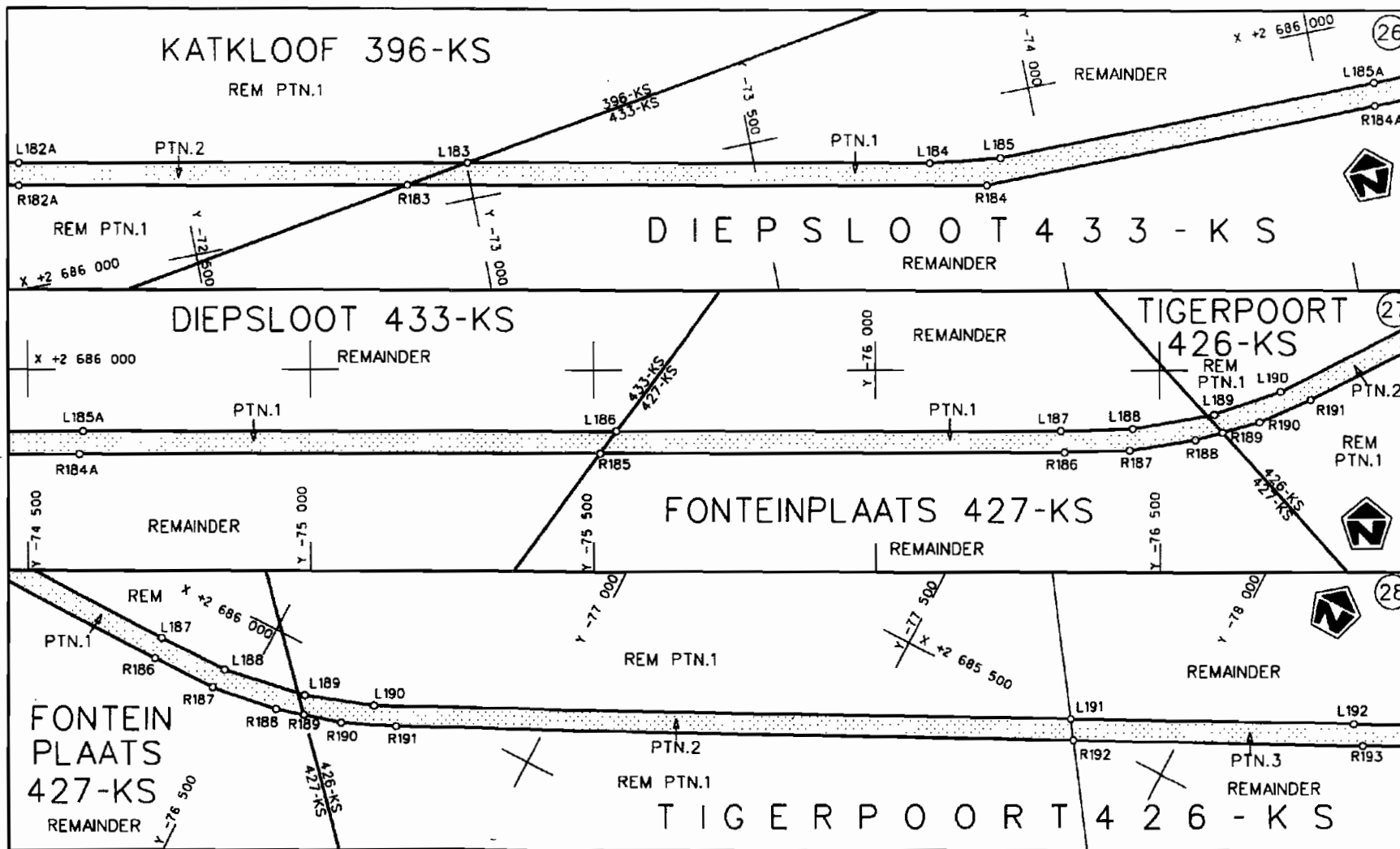
<p>Suid-Afrikaanse Padagentskap Bpk. South African National Roads Agency Ltd.</p>	<p>Die figuur getoon The figure shown</p>		<p>stel die padreserwe voor van 'n gedeelte represents the road reserve of a portion van Nasionale Roete R37 of National Route</p> <p>Sekasie 1 Section</p>	<p>Vel Sheet 12A van of 34 P 547/2005</p>
---	---	--	---	---



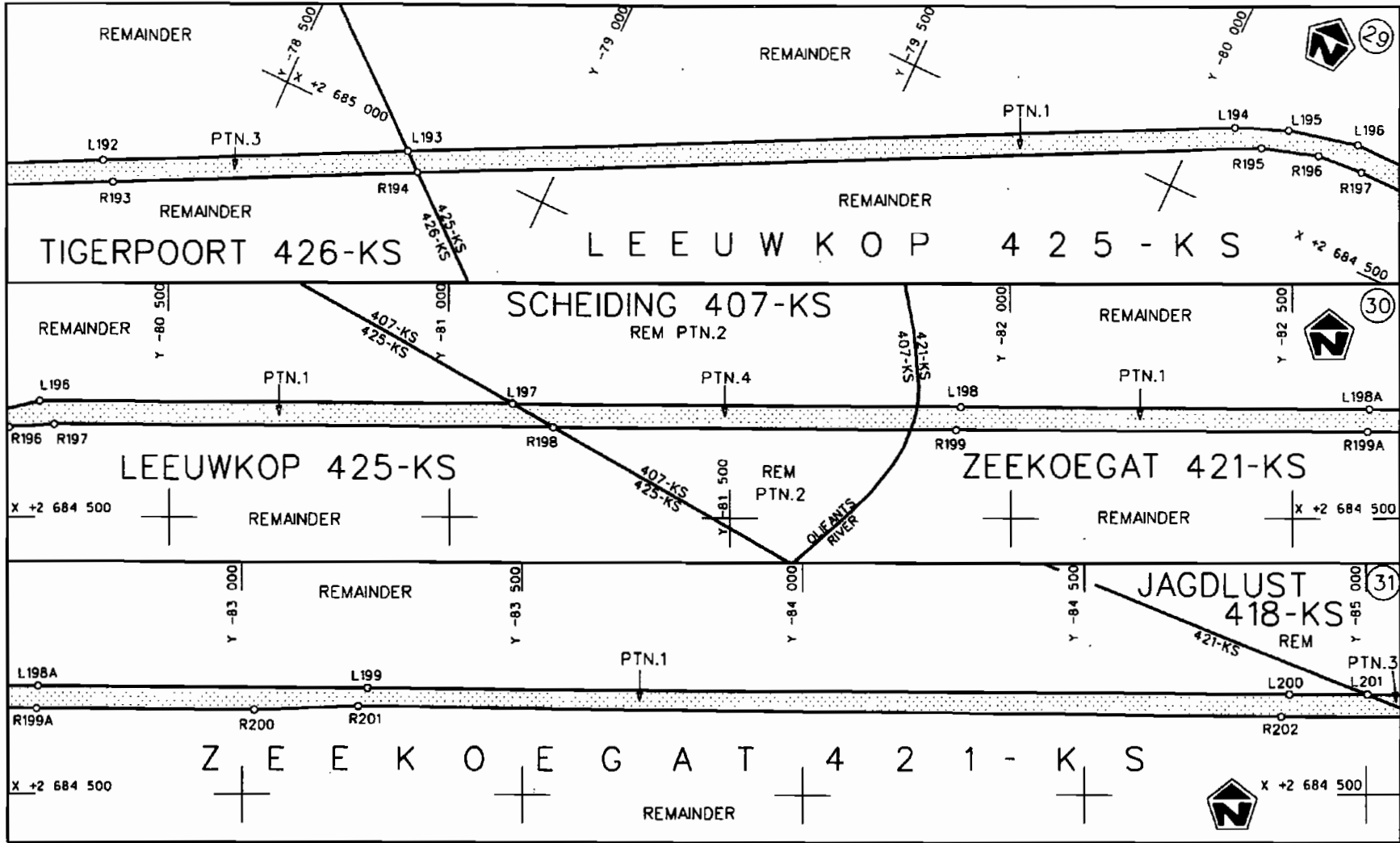

Suid-Afrikaanse Padagentskap Bpk. South African National Roads Agency Ltd.	Die figuur getoon The figure shown	 steldie padreserwe voor van 'n gedeelte represents the road reserve of a portion van Nasionale Roete R37 . Seksie 1 of National Route R37 . Section 1	Vel Sheet 13A van of 34 P 547/2005
---	---------------------------------------	---	---------------------------------------

D.O.9.A



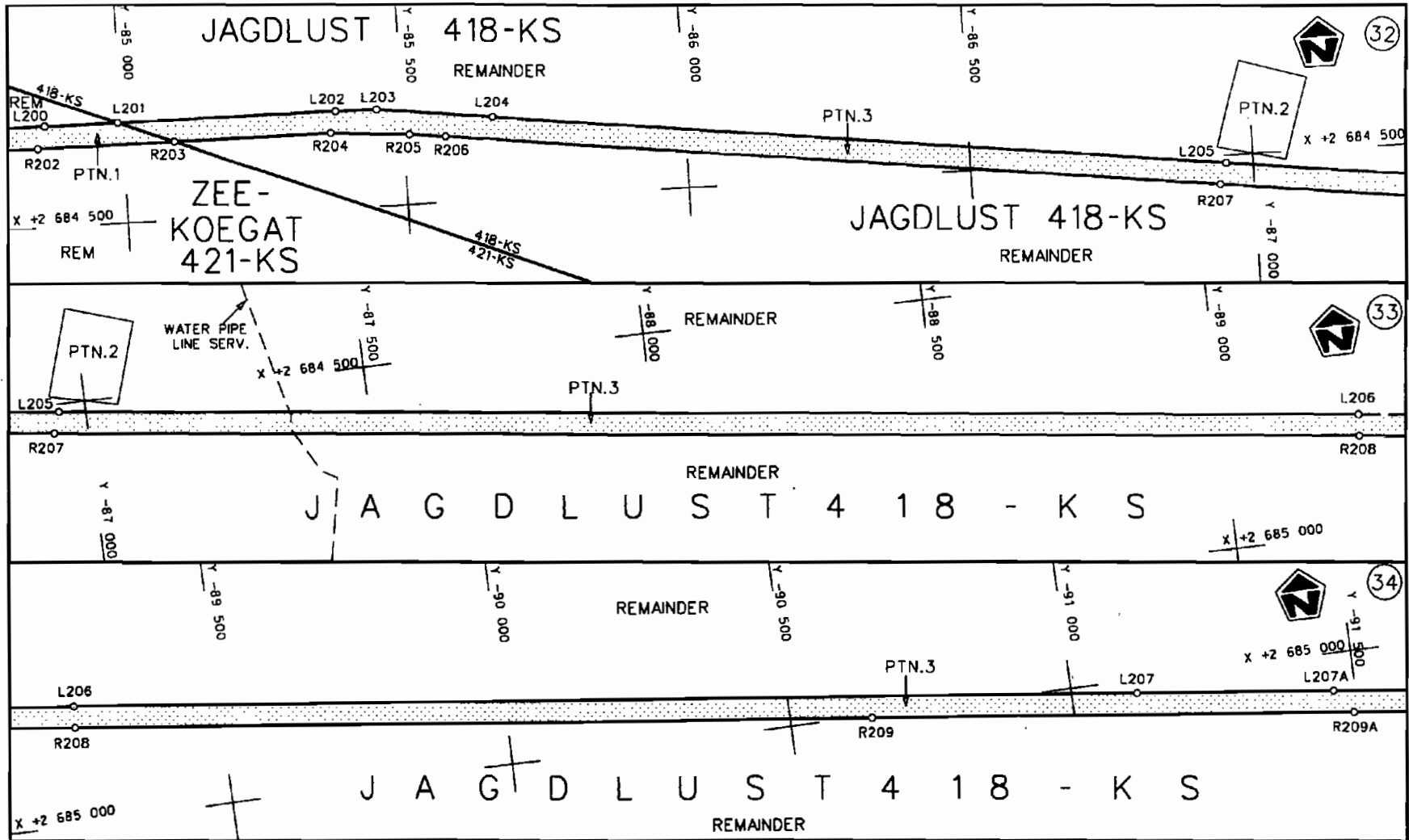

<p>Suid-Afrikaanse Padogenskop Bpk. South African National Roads Agency Ltd.</p>	<p>Die figuur getoon The figure shown</p> 	<p>steldie padreserwe voor van 'n gedeelte represents the road reserve of a portion van Nasionale Roete R37 of National Route R37</p> <p>Seksie 1 Section 1</p>	<p>Vel Sheet 14A van of 34 P 547/2005</p>
--	--	---	---

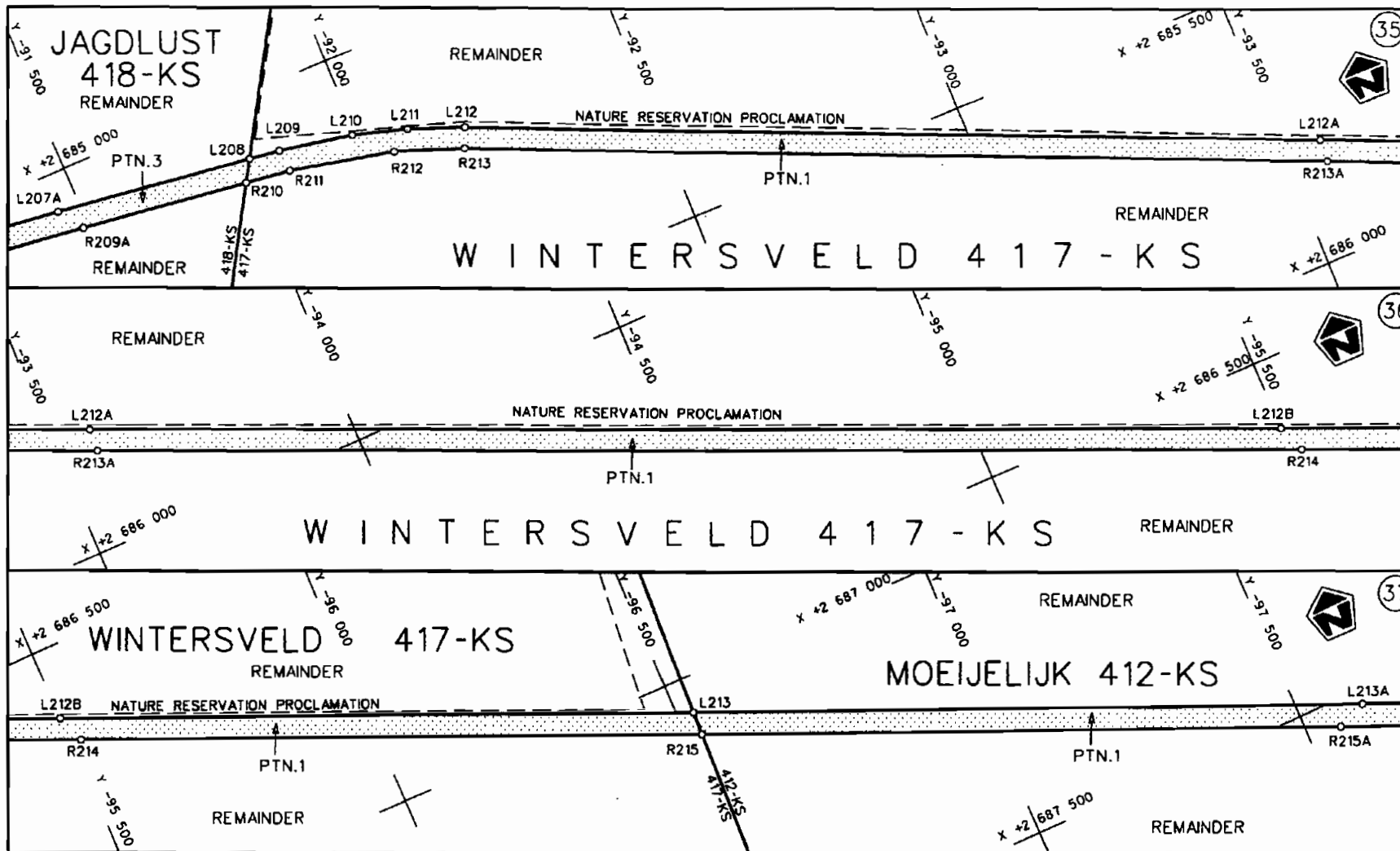

Suid-Afrikaanse Padogentskap Bpk. South African National Roads Agency Ltd.	Die figuur getoon The figure shown	 steldie padreserwe voor van 'n gedeelte represents the road reserve of a portion van Nasionale Roete of National Route R37	Vel Sheet 15A van of 34 P 547/2005
---	---------------------------------------	---	--

D.O.9.A



<p>Suid-Afrikaanse Padogentskap Bpk. South African National Roads Agency Ltd.</p>	<p>Die figuur getoon The figure shown</p> 	<p>stel die padreserwe voor van 'n gedeelte represents the road reserve of a portion van Nasionale Roete of National Route</p> <p>R37 Seksie Section</p> <p>1</p>	<p>Vel Sheet 16A of 34</p> <p>P 547/2005</p>
---	--	---	--

D.O.9.A

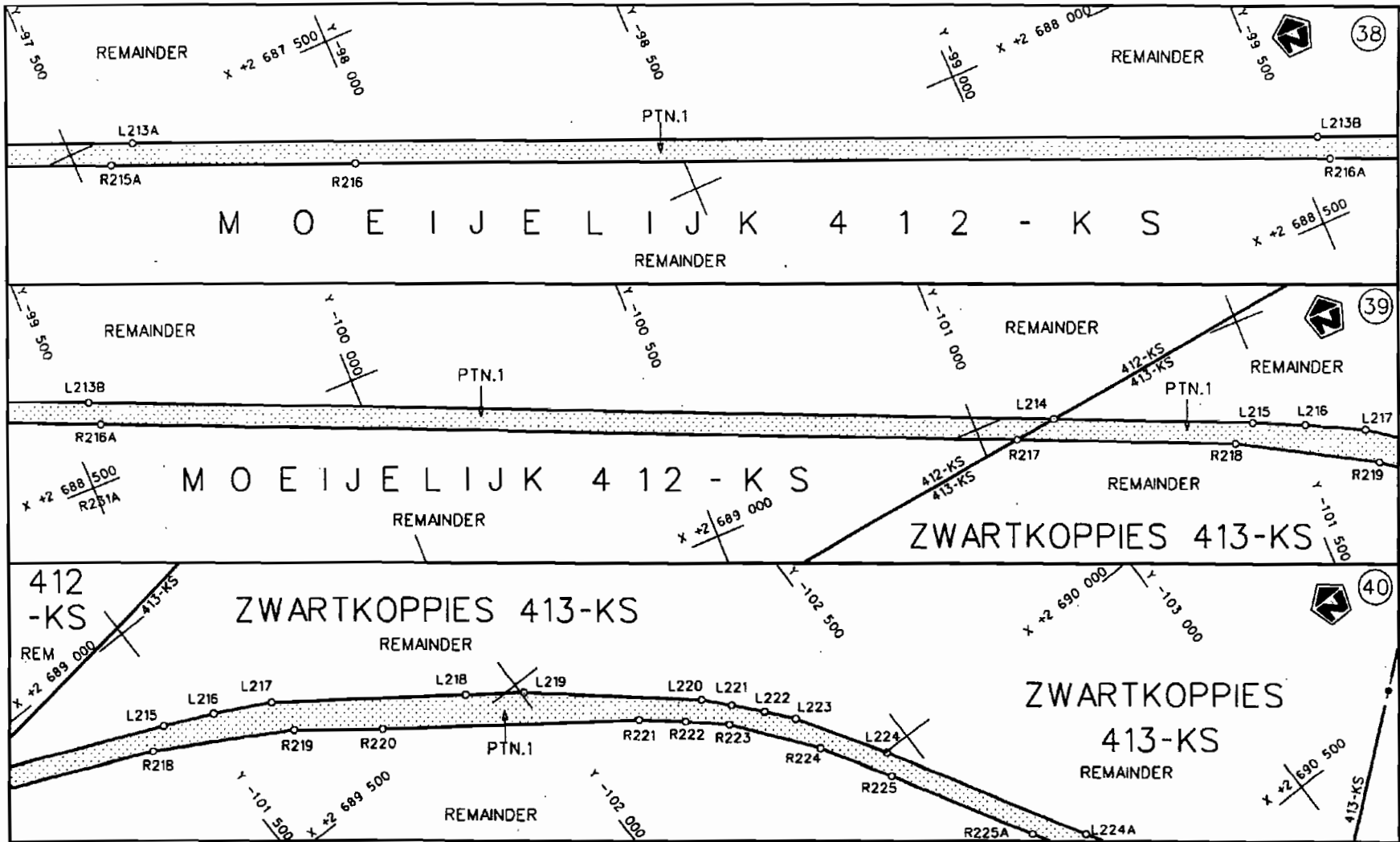

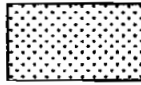
Suid-Afrikaanse Padagentskap Bpk. South African National Roads Agency Ltd.	Die figuur getoon The figure shown	 steldie padreserwe voor van 'n gedeelte represents the road reserve of a portion van Nasionale Roete of National Route	Vel 17A van 34 Sheet of P 547/2005
R37 1			1

D.O.9.A

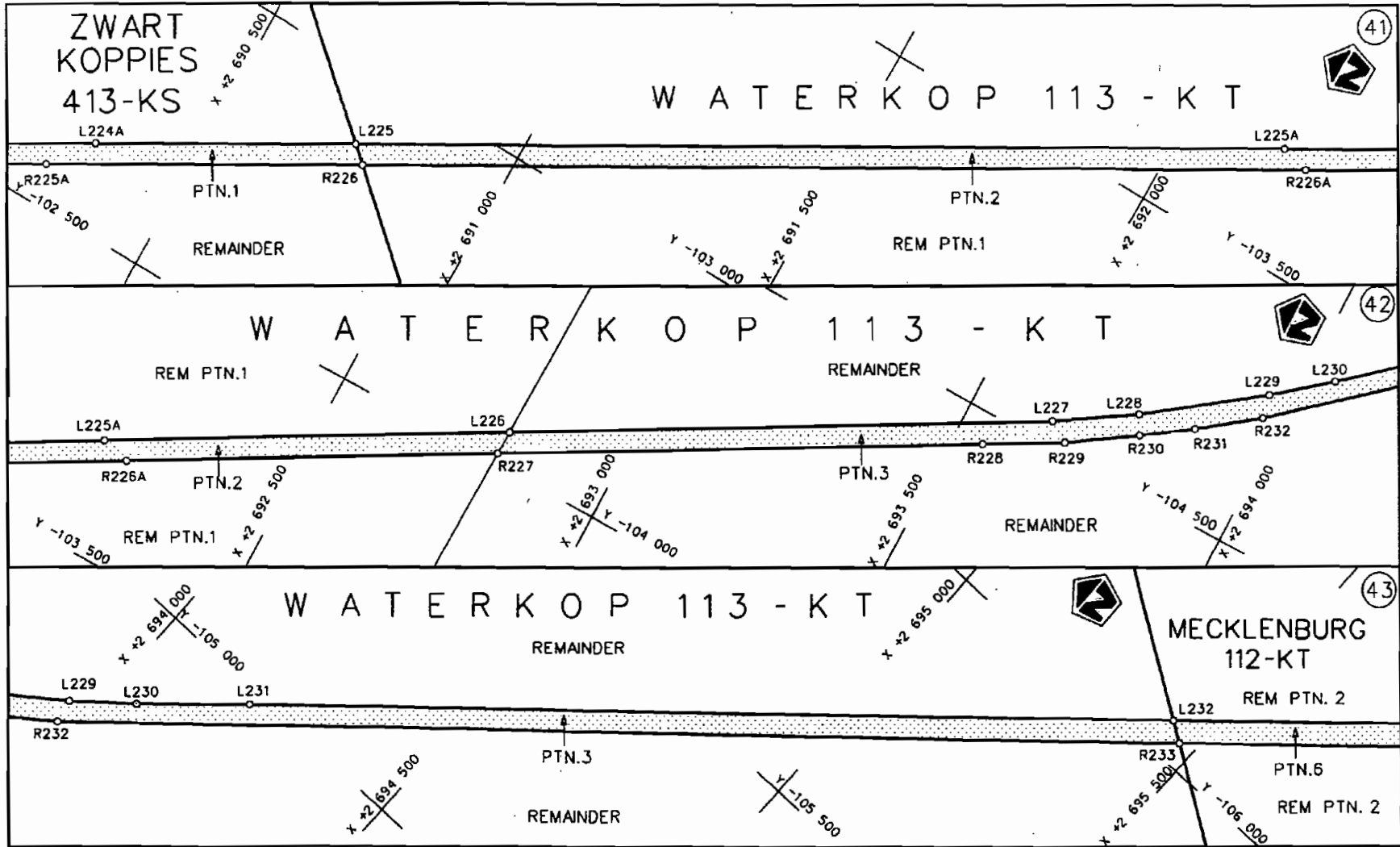

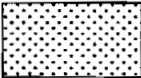
<p>Suid-Afrikaanse Padogenskap Bpk. South African National Roads Agency Ltd.</p>	<p>Die figuur getoon The figure shown</p> 	<p>steldie padreserwe voor van 'n gedeelte represents the road reserve of a portion van Nasionale Roete R37 Sektie 1 of National Route R37 Section 1</p>	<p>Vel Sheet 18A van of 34 P 547/2005</p>
--	--	--	---

D.O.9.A

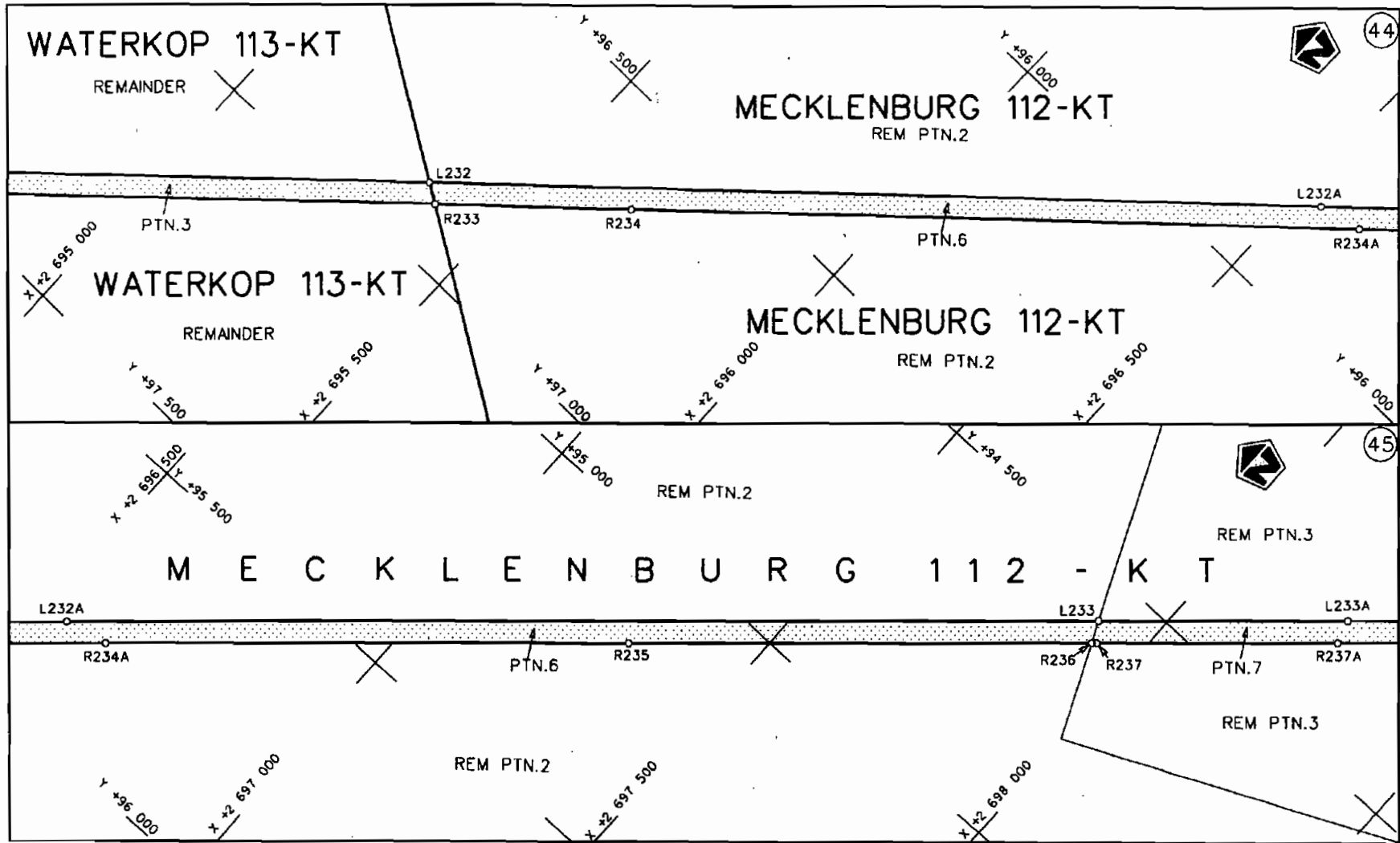

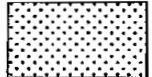
Suid-Afrikaanse Padagentskap Bpk. South African National Roads Agency Ltd.	Die figuur getoon The figure shown		steldie padreserwe voor van 'n gedeelte represents the road reserve of a portion van Nasionale Roete of National Route R37 Seksie Section 1	Vel Sheet 19A van of 34 P 547/2005
---	---------------------------------------	--	--	---------------------------------------

D.O.9.A

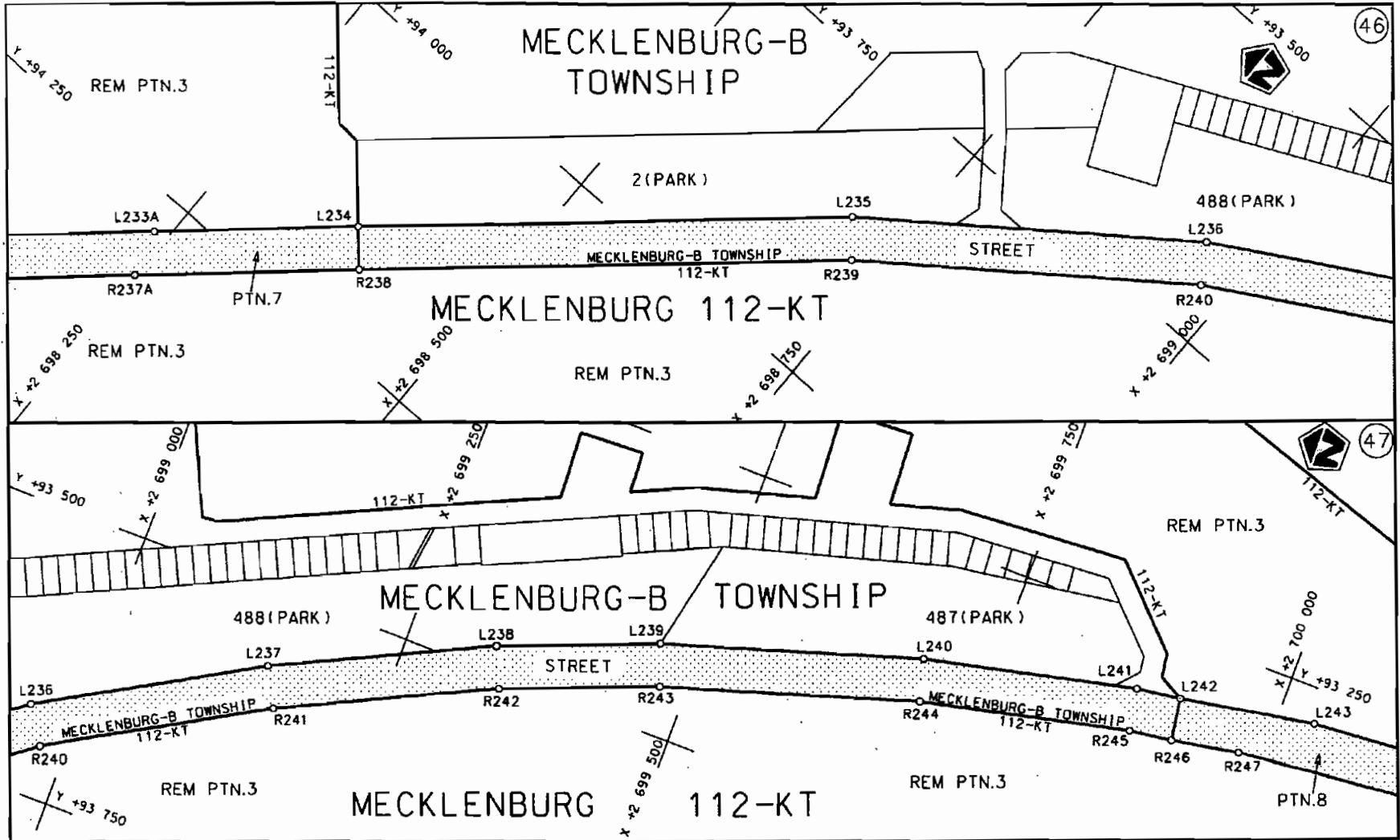

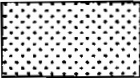
<p>Suid-Afrikaanse Padagentskap Bpk. South African National Roads Agency Ltd.</p>	<p>Die figuur getoon The figure shown</p> 	<p>steldie padreserwe voor van 'n gedeelte represents the road reserve of a portion van Nasionale Roete of National Route</p> <p>R37 Seksie 1 Section 1</p>	<p>Vel Sheet 20A van of 34</p> <p>P 547/2005</p>
---	--	---	--

D.O.9.A

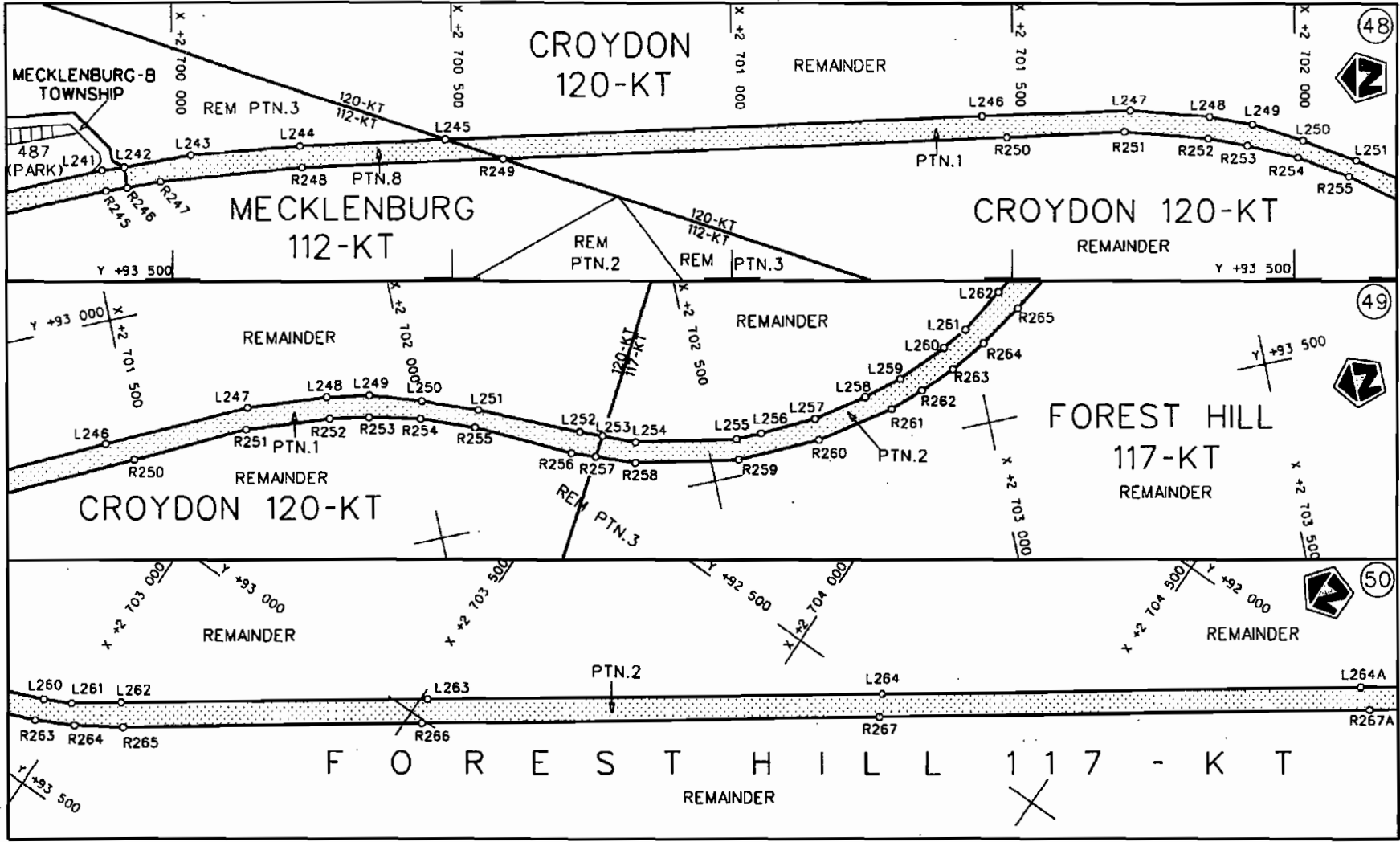

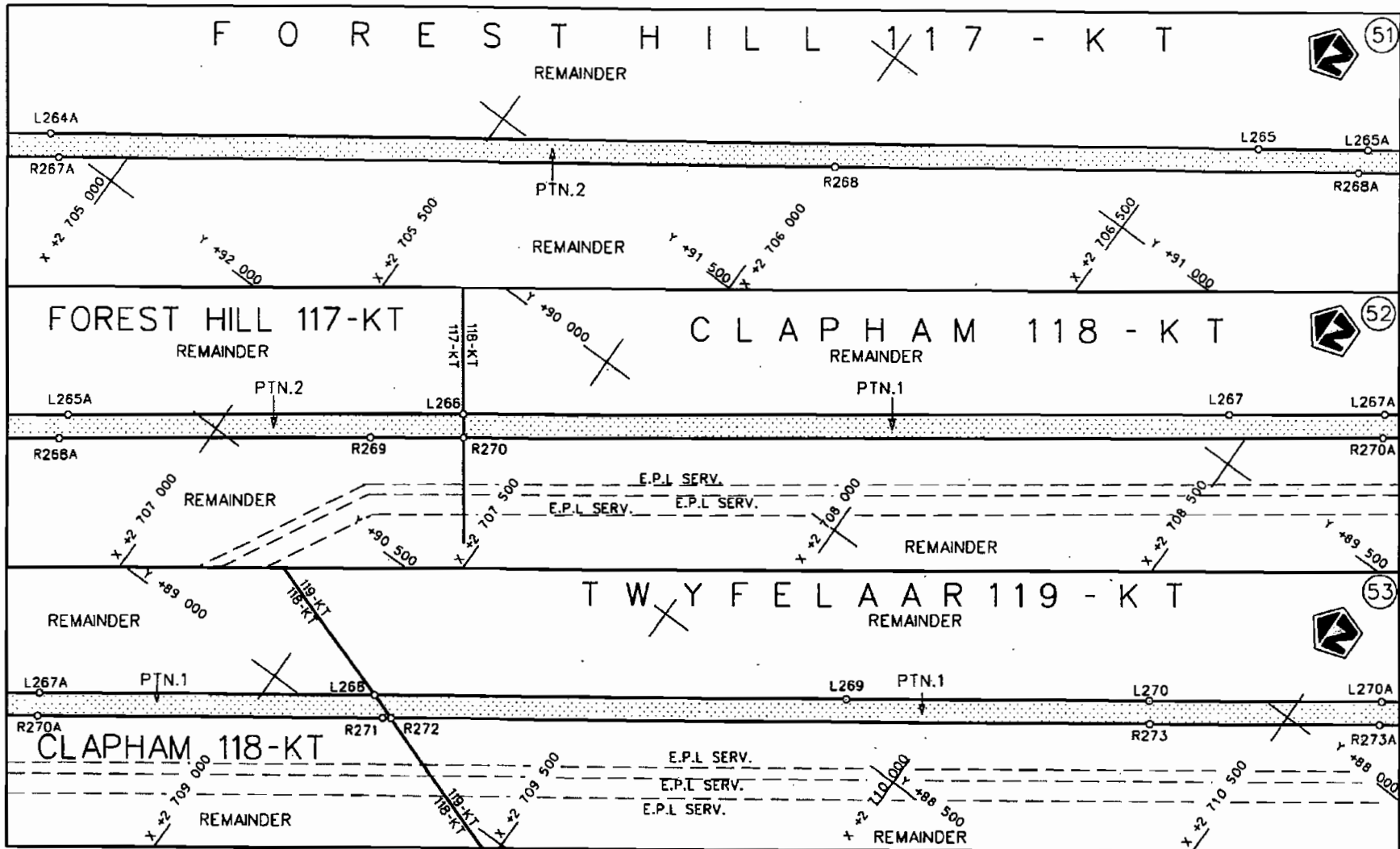

<p>Suid-Afrikaanse Padagentskop Bpk. South African National Roads Agency Ltd.</p>	<p>Die figuur getoon The figure shown</p> 	<p>steldie padreserwe voor van 'n gedeelte represents the road reserve of a portion van Nasionale Roete of National Route R37</p> <p>Seksie Section 1</p>	<p>Vel Sheet 21A of 34</p> <p>P 547/2005</p>
---	--	---	--

D.O.9.A

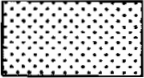

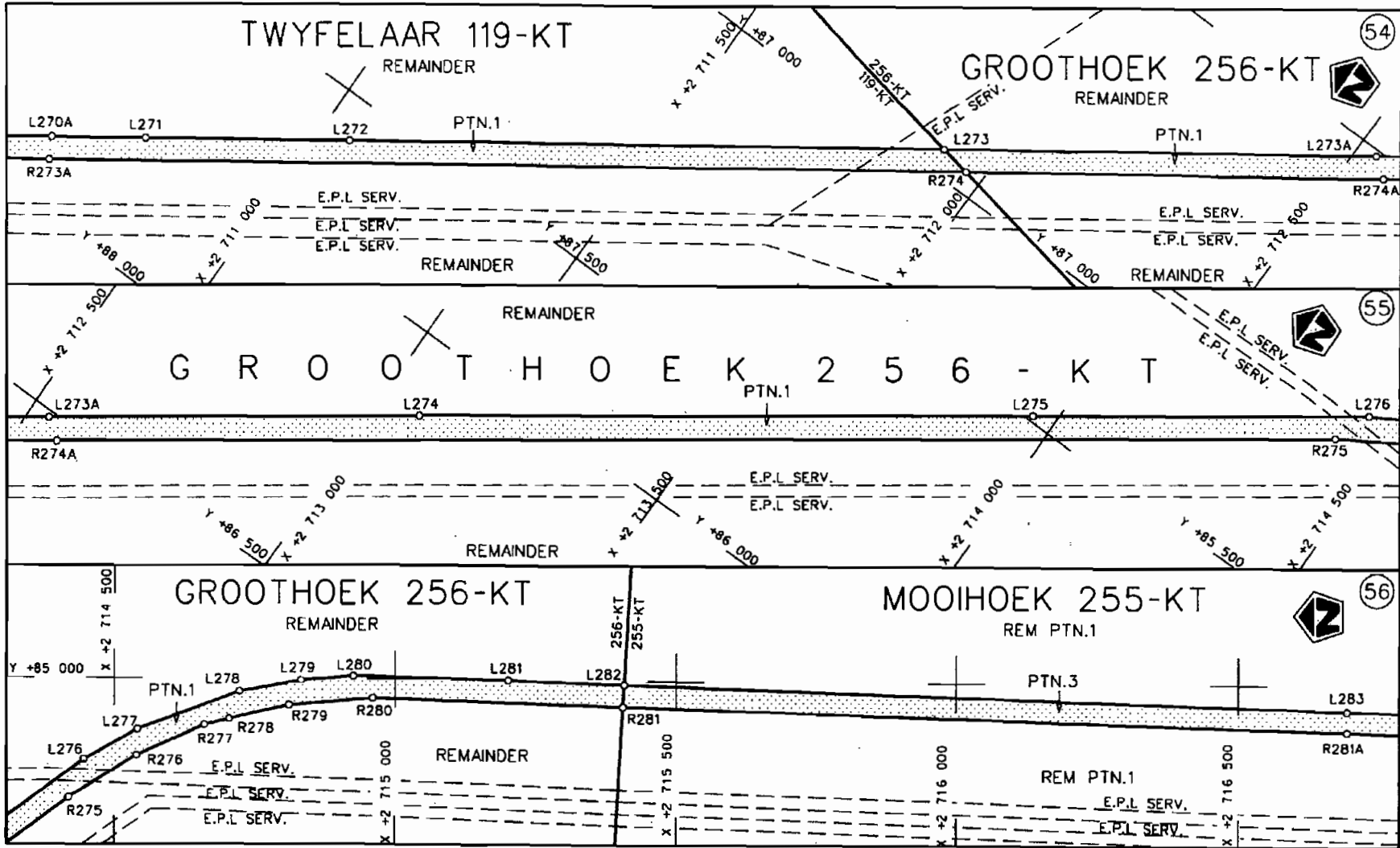
<p>Suid-Afrikaanse Padagentskap Bpk. South African National Roads Agency Ltd.</p>	<p>Die figuur getoon The figure shown</p> 	<p>stel die padreserwe voor van 'n gedeelte represents the road reserve of a portion van Nasionale Roete of National Route</p> <p>R37</p>	<p>Vel Sheet 22A of 34</p> <p>P 547/2005</p>
---	--	---	--



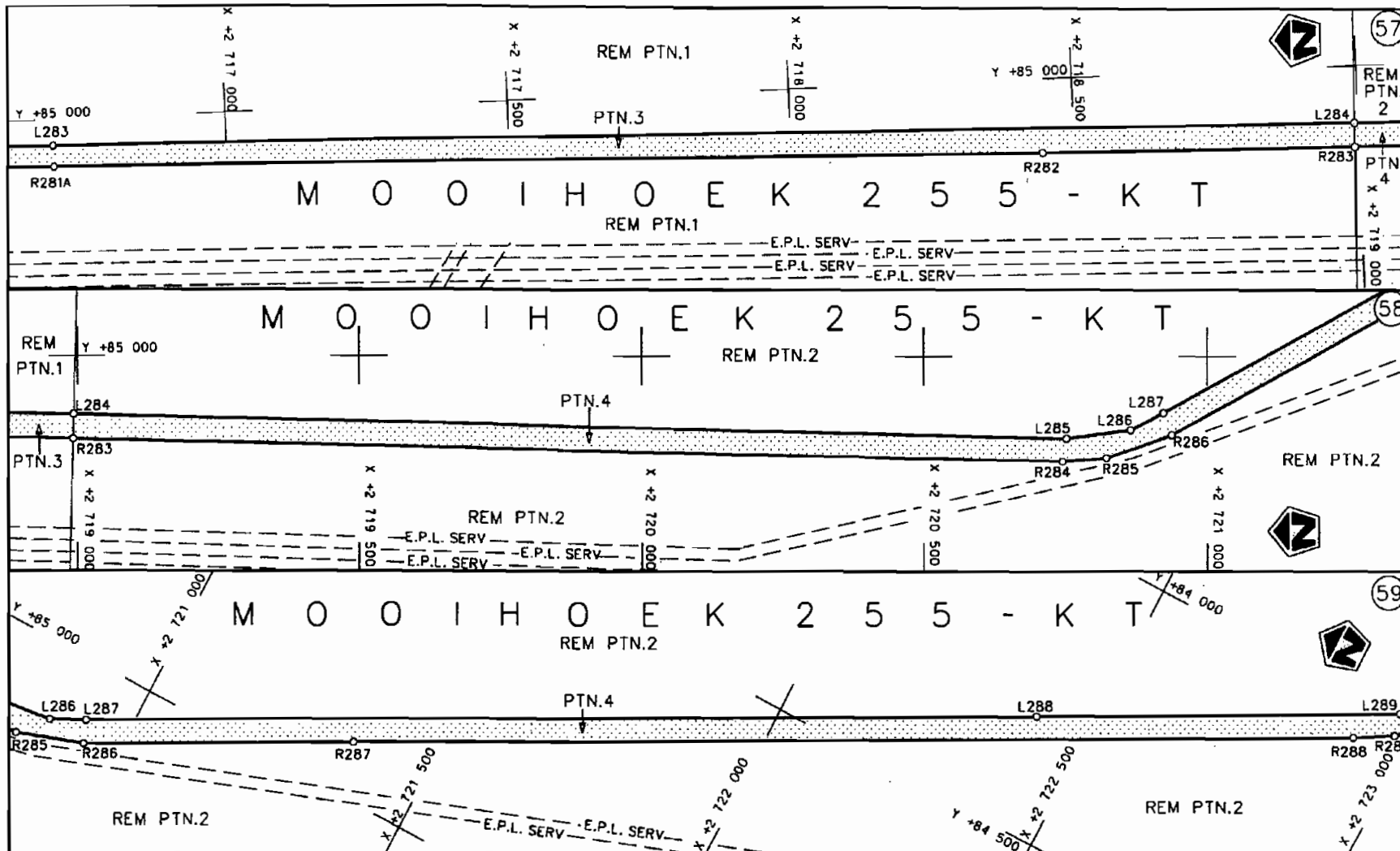

Suid-Afrikaanse Padogenskop Bpk. South African National Roads Agency Ltd.	Die figuur getoon The figure shown		stel die padreserwe voor van 'n gedeelte represents the road reserve of a portion van Nasionale Roete of National Route	Vel Sheet 23A of 34 P 547/2005
--	---------------------------------------	--	--	--------------------------------------

D.O.9.A

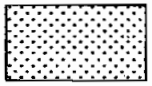

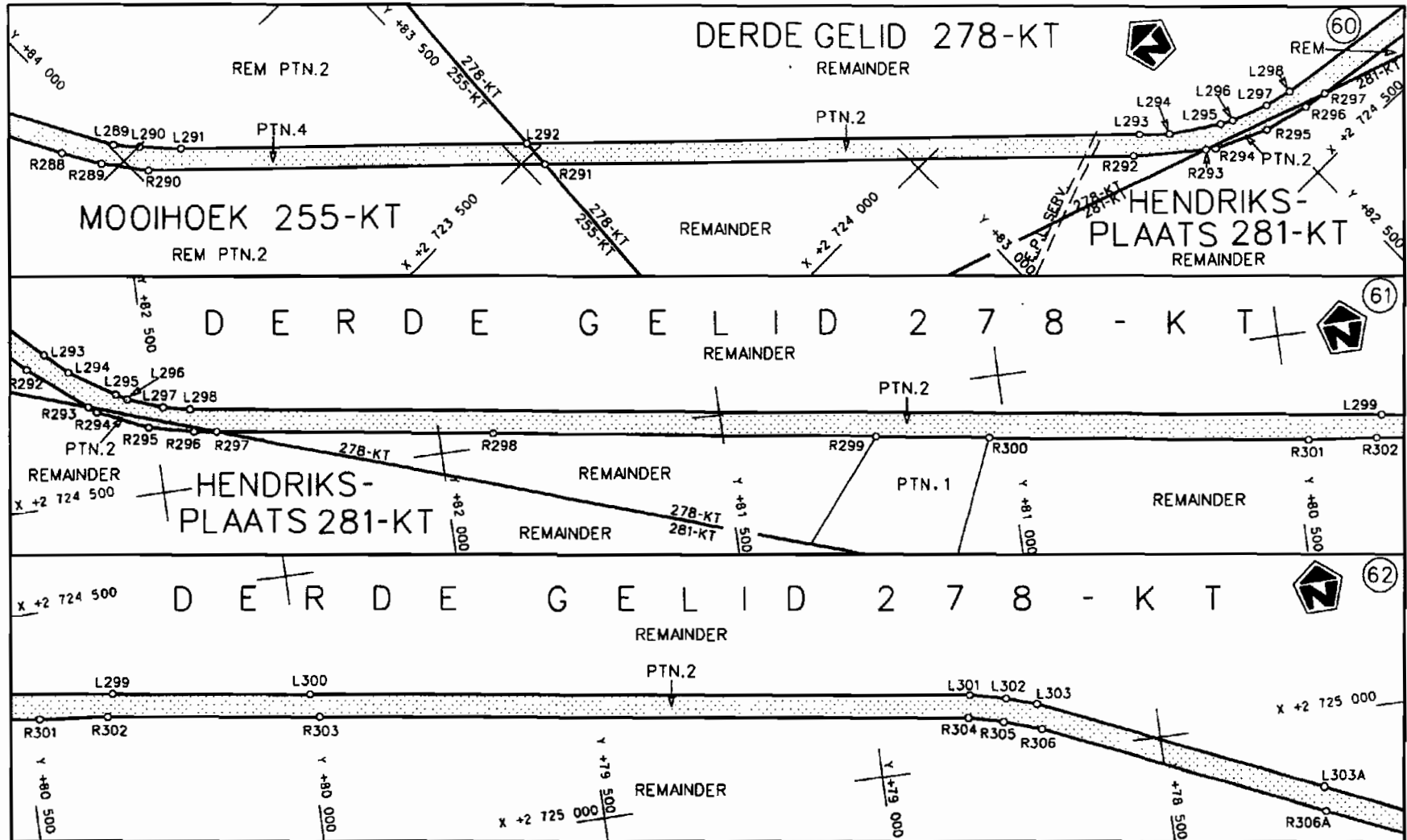

<p>Suid-Afrikaanse Padagentskop Bpk. South African National Roads Agency Ltd.</p>	<p>Die figuur getoon The figure shown</p> 	<p>steldie podreserwe voor van 'n gedeelte represents the road reserve of a portion van Nasionale Roete R37 of National Route R37</p> <p>Seksie 1 Section 1</p>	<p>Vel 24A van 34 Sheet 24A of 34</p> <p>P 547/2005</p>
---	--	---	---

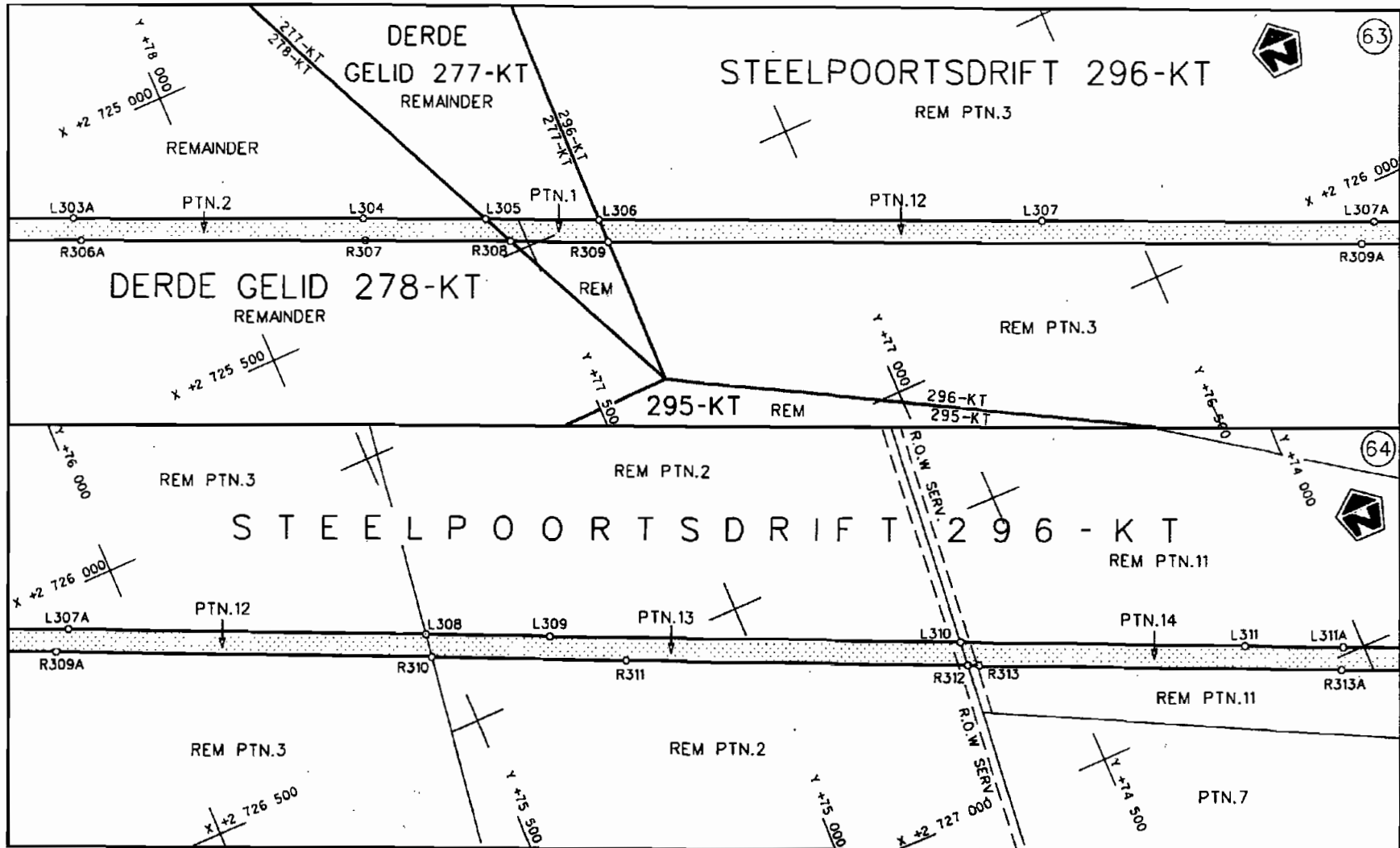

Suid-Afrikaanse Padogentskap Bpk. South African National Roads Agency Ltd.	Die figuur getoon The figure shown	 steldie padreserwe voor van 'n gedeelte represents the road reserve of a portion van Nasionale Roete R37 Seksie 1 of National Route R37 Section 1	Vel Sheet 25A van 34 of P 547/2005
---	---------------------------------------	---	--

D.O.9.A



<p>Suid-Afrikaanse Padagentskap Bpk. South African National Roads Agency Ltd.</p>	<p>Die figuur getoon The figure shown</p>		<p>steldie padreserwe voor van 'n gedeelte represents the road reserve of a portion van Nasionale Roete of National Route</p> <p>R37 Seksie 1</p> <p>Section</p>	<p>Vel Sheet 26A of 34</p> <p>P 547/2005</p>
---	---	--	--	--

D.O.9.A

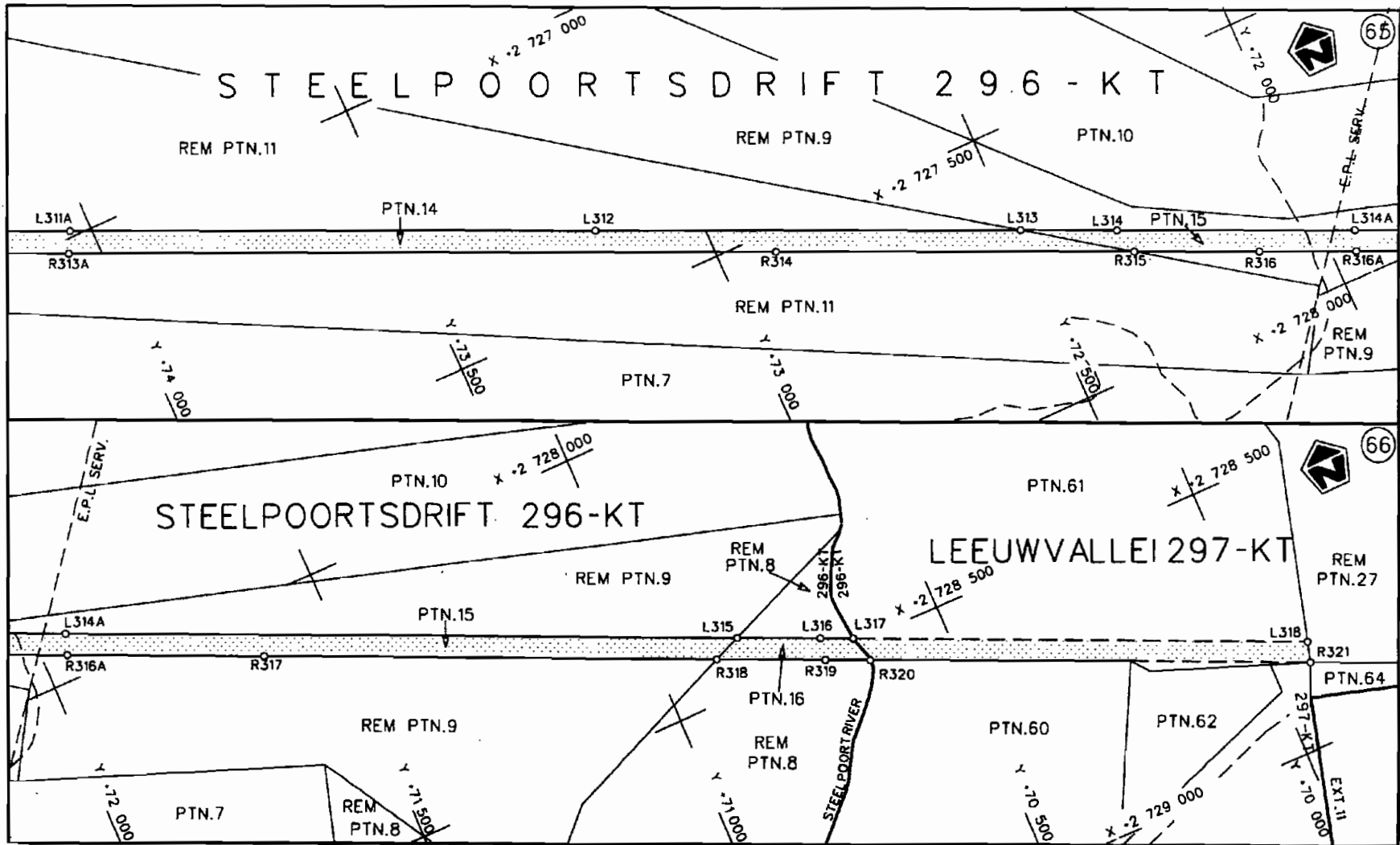

Suid-Afrikaanse Padagentskap Bpk. South African National Roads Agency Ltd.	Die figuur getoon The figure shown		steldie padreserwe voor van 'n gedeelte represents the road reserve of a portion van Nasionale Roete R37 Sektie 1 of National Route Section 1	Vel 27A van 34 Sheet of P 547/2005
---	---------------------------------------	--	--	--

D.O.9.A

PADRESERWE KOORDINATE f ROAD RESERVE CO-ORDINATES						
L1NKERKANT/LEFT HAND SIDE			REGTERKANTfRIGHT HAND SIDE			
	Y	X	WG 29°	Y	X	
L1	-45776.660	2649291.610		R1	-45716.590	2649301.560
L2	-46013.160	2 650 692.640		R2	-45882.380	2650319.460
L3	-46060.150	2 650 886.060		R3	-45919.460	2650535.410
L4	-46182.690	2651 327.290		R4	-45952.720	2 650 709.600
L5	-46286.670	2 651 696.230		R5	-45979.100	2650815.810
L6	-46350.890	2 651 925.800		R6	-46002.730	2 650 908.330
L7	-46403.890	2652112.910		R7	-46124.090	2 651 344.230
L8	-46448.800	2 652 273.560		R8	-46205.510	2651 635.020
L9	-46492.130	2652437.150		R9	-46264.240	2651 844.750
L10	-46531.460	2 652 630.830		R10	-46302.240	2651 980.410
L11	-46575.530	2 652 861.300		R11	-46313.230	2652019.810
L12	-46639.460	2 653 193.460		R12	-46430.400	2652450.130
L13	-46669.100	2 653 347.990		R13	-46477.260	2652680.610
L14	-46762.610	2 653 834.360		R14	-46519.360	2 652 894.670
L15	-46817.500	2654118.740		R15	-46557.500	2 653 093.330
L16	-46841.440	2 654 265.100		R16	-46595.600	2 653 292.000
L17	-46855.540	2 654 412.430		R17	-46633.770	2 653 490.660
L18	-46856.270	2654613.450		R18	-46697.040	2 653821.690
L19	-46824.990	2 655 443.100		R19	-46709.960	2 653 887.950
L20	-46776.270	2 656 736.570		R20	-46779.280	2 654 275.690
L21	-46767.830	2 656 891.310		R21	-46788.380	2 654 379.860
L22	-46 754.020	2657018.950		R22	-46793.130	2654467.750
L23	-46729.990	2 657 163.460		R23	-46794.220	2 654 584.630
L24	-46676.380	2 657459.550		R24	-46762.210	2655429.810
L25	-46 655.200	2 657 609.950		R25	-46714.360	2 656 734.360
L26	-46645.450	2657763.100		R26	-46705.730	2656874.780
L27	-46646.770	2 657 859.660		R27	-46691.090	2 657010.430
L28	-46780.870	2660419.320		R28	-46669.080	2 657 151.550
L29	-46829.070	2 661 361.270		R29	-46616.970	2657437.190
L30	-46847.350	2 661 766.870		R30	-46591.990	2657602.370
L31	-46854.560	2662212.380		R31	-46581.960	2657761.570
L32	-46855.990	2 662 301.550		R32	-46584.880	2 657888.450
L33	-46869.360	2 662 977.030		R33	-46706.400	2 660 229;090
L34	-46875.020	2663119.510		R34	-46764.860	2661 352.190
L35	-46892.870	2 663 498.540		R35	-46783.800	2661 748.020
L36	-46941.800	2 664 478.620		R36	-46804.980	2 662 955.690
L37	-46960.850	2 664 663.030		R37	-46812.020	2 663 098.290
L38	-47379.500	2666978.700		R38	-46877.720	2 664 463.000
L39	-47397.570	2 667 063.670		R39	-46897.860	2 664671.420
L40	-47445.670	2 667 243.420		R40	-47319.940	2 667 023.020
L41	-47506.090	2 667 430.180		R41	-47493.870	2667577.400
L42	-47569.300	2 667 596.500		R42	-47510.530	2 667 620.350
L43	-47636.150	2 667 750.380		R43	-47577.500	2 667 777.350
L44	-47699.270	2 667 887.360		R44	-47816.400	2 668 294.540
L45	-47916.480	2 668 358.840		R45	-47859.660	2668383.750
L46	-48074.530	2 668 702.680		R46	-48153.280	2 669 068.460
L47	-48165.200	2 668 901.450		R47	-48172.630	2669177.980
L48	-48167.970	2 668 907.950		R48	-48178.990	2 669 283.990
L49	-48 182.950	2 668 943.840		R49	-48 177.310	2 669 321.820
L50	-48215.060	2 669 054.200		R50	-48174.140	2 669 390.390
L51	-48235.250	2 669 168.720		R51	-48157.420	2669496.410

Vel	28A	Van	34	P547f2005
Sheet		of		

PADRESERWE KOORDINATE / ROAD RESERVE CO-ORDINATES							
L1NKERKANT/LEFT HAND SIDE			REGTERKANTIRIGHT HAND SIDE				
	Y	X	WG29	Y	X		
L52	-48242.450	2 669 281.880		R52	-48121.830 2669657.540		
L53	-48225.280	2669458.410		R53	-48117.300 2 669 682.720		
L54	-48218.040	2 669 510.530		R54	-48105.730 2669749.940		
L55	-48161.020	2669808.780		R55	-48097.070 2669804.590		
L56	-48162.600	2 669 952.520		R56	-48090.570 2 669 956.390		
L57	-48169.970	2 670 052.680		R57	-48092.010 2 669 976.380		
L58	-48171.580	2 670 095.250		R58	-48108.500 2670069.700		
L59	-48202.220	2670188.110		R59	-48115.880 2 670 110.290		
L60	-48235.340	2 670276.530		R60	-48141.380 2670206.210		
L61	-48246.280	2670298.770		R61	-48158.800 2 670 253.600		
L62	-48413.150	2 670 602.340		R62	-48177.090 2670302.040		
L63	-48643.310	2 671 008.680		R63	-48226.980 2670399.170		
L64	-48787.190	2 671 288.920		R64	-48248.110 2 670 436.350		
L65	-48818.370	2671 387.040		R65	-48351.340 2670618.860		
L66	-48839.310	2671 491.180		R66	-48580.060 2 671 022.060		
L67	-48849.750	2 671 594.690		R67	-48659.750 2 671 163.240		
L68	-48848.650	2671 695.210		R68	-48689.280 2671219.210		
L69	-48807.500	2 672 588.050		R69	-48728.050 2671 310.760		
L70	-48804.430	2672 795.620		R70	-48756.570 2 671 403.160		
L71	-48811.800	2 673 000.440		R71	-48776.510 2 671 500.470		
L72	-48829.700	2 673 198.950		R72	-48786.420 2 671 654.240		
L73	-48851.440	2 673 324.080		R73	-48765.740 2672145.670		
L74	-48949.560	2 673 793.890		R74	-48745.870 2 672 583.900		
L75	-49071.750	2674220.090		R75	-48738.620 2672 797.330		
L76	-49101.700	2674324.090		R76	-48747.520 2673 015.180		
L71	-49302.240	2 675080.540		R77	-48766.890 2673207.410		
L78	-49307.250	2675174.300		R78	-48 796.870 2 673411.470		
L79	-49285.920	2 675 380.320		R79	-48837.330 2673613.480		
L80	-49267.830	2675491.730		R80	-48 889.880 2673811.060		
L81	-49249.490	2 675688.600		R81	-49011.920 2674236.290		
L82	-49247.790	2 675 808.670		R82	-49226.430 2674998.810		
L83	-49273.840	2 676 038.960		R83	-49238.850 2 675 085.210		
L84	-49298.320	2676161.470		R84	-49243.500 2 675 172.980		
L85	-49339.600	2 676 284.620		R85	-49229.150 2 675 346.600		
L86	-49697.500	2 677 330.360		R86	-49207.720 2 675424.950		
L87	-49677.810	2677 707.130		R87	-49180.050 2 675636.970		
L88	-49674.330	2671731.140		R88	-49186.180 2 675 939.600		
L89	-49644.630	2 671 798.260		R89	-49237.500 2676180.070		
L90	-49656.290	2 677 867.230		R90	-49538.010 2676974.880		
L91	-49656.370	2 677 960.830		R91	-49655.940 2677 367.110		
L92	-49677.130	2 678 072.230		R92	-49621.250 2677680.150		
L93	-49720.520	2678177.300		R93	-49614.130 2 677 723.540		
L94	-50439.200	2 679 343.640		R94	-49604.080 2 677 784.820		
L95	-50493.200	2 679 431.440		R95	-49601.370 2677 853.700		
L96	-50522.780	2679505.540		R96	-49638.500 2 678087.180		
L97	-50547.420	2679587.110		R97	-49688.840 2678195.420		
L98	-50550.960	2 679 610.020		R98	-50277.810 2 679 145.420		
L99	-50560.360	2 679 690.450		R99	-50403.000 2 679 358.150		
L100	-50561.710	2 680 040.050		R100	-50455.990 2 679 446.250		
L101	-50561.760	2 680 053.170		R101	-50491.810 2679527.900		
L102	-50562.060	2680 129.920		R102	-50510.450 2 679 622.440		
			Vel	29A	Van	34	P547/2005
			Sheet		of		

PADRESERWE KOORDINATE / ROAD RESERVE CO-ORDINATES					
L1NKERKANT/LEFT HAND SIDE			REGTERKANT/RIGHT HAND SIDE		
	Y	X	WG29°	Y	X
L103	-50561.190	2680148.970		R103	-50523.090 2679705.570
L104	-50558.400	2680210.410		R104	-50526.200 2 680048.560
L105	-50542.250	2 680 286.410		R105	-50526.300 2 680 058.960
L106	-50492.800	2680446.730		R106	-50527.110 2 680 148.490
L107	-50465.000	2680495.110		R107	-50526.250 2 680 154.680
L108	-50457.270	2680534.410		R108	-50512.100 2680257.160
L109	-50463.190	2 680 568.290		R109	-50495.800 2680318.190
L110	-50473.750	2 680 606.830		R110	-50419.160 2680542.770
L111	-50473.900	2 680 624.480		R111	-50448.440 2 680 618.550
L112	-50462.790	2 680 724.290		R112	-50430.050 2 680755.640
L113	-50440.570	2 680 834.680		R113	-50374.290 2 680 922.160
L114	-50408.700	2 680 934.560		R114	-50372.060 2681014.120
L115	-50398.400	2 680 989.300		R115	-50371.980 2681 089.790
L116	-50400.340	2 681 052.250		R116	-50406.170 2681141.770
L117	-50431.290	2 681 076.460		R117	-50437.890 2681182.790
L118	-50458.200	2681 132.580		R118	-50483.730 2681 223.760
L119	-50487.950	2681 163.900		R119	-50511.130 2681 246.800
L120	-50517.550	2 681 184.860		R120	-50538.900 2 681 269.460
L121	-50561.160	2681 233.630		R121	-50582.310 2 681 295.350
L122	-50602.420	2 681 260.640		R122	-50638.980 2681 318.330
L123	-50705.810	2 681 286.090		R123	-50733.360 2 681 325.530
L124	-51215.160	2681 259.740		R124	-51 210.580 2 681 301.800
L125	-51 842.540	2 681 209.490		R125	-51 837.650 2 681 248.200
L126	-52059.030	2 681 208.490		R126	-52060.650 2681 249.820
L127	-52111.990	2681 210.720		R127	-52186.090 2 681 261.240
L128	-52242.940	2681 231.930		R128	-52271.080 2 681 282.940
L129	-52787.040	2681402.410		R129	-52710.830 2681417.130
L130	-52843.220	2 681 426.460		R130	-52827.180 2681462.640
L131	-52895.110	2 681 454.010		R131	-53156.460 2681 660.620
L132	-53191.320	2681 632.130		R132	-54 289.130 2682341.640
L133	-54307.170	2682303.130		R133	-54324.360 2 682 366.850
L134	-54346.860	2682329.160		R134	-54349.510 2 682 393.520
L135	-54380.510	2682362.910		R135	-54372.420 2682422.440
L136	-54408.900	2 682 404.920		R136	-54386.270 2682451.810
L137	-54516.850	2 682 778.930		R137	-54481.460 2 682 792.060
L138	-54 528.570	2 682 811.080		R138	-54499.120 2682841.760
L139	-54537.880	2 682 836.630		R139	-54522.500 2 682 890.490
L140	-54572.040	2682901.120		R140	-54696.740 2683165.380
L141	-54861.480	2 683332.770		R141	-54839.130 2 683 363.480
L142	-54883.820	2683371.100		R142	-54913.870 2683513.870
L143	-54950.040	2 683 501.490		R143	-55066.460 2 683 829.400
L144	-55114.580	2 683 842.430		R144	-55105.000 2 683 938.630
L145	-55139.020	2 683911.360		R145	-55104.430 2 684 009.970
L146	-55149.870	2 683 985.380		R146	-55102.070 2 684 227.530
L147	-55139.050	2684174.990		R147	-55109.320 2684283.760
L148	-55 138.780	2 684 225.050		R148	-55128.390 2 684 351.830
L149	-55146.210	2684274.630		R149	-55160.450 2684407.010
L150	-55165.180	2684 335.740		R150	-55249.600 2 684 561.450
L151	-55193.110	2 684 394.360		R151	-55323.600 2 684689.650
L152	-55286.730	2684551.130		R152	-55385.360 2 684 763.680
L153	-55349.440	2 684650.970		R153	-55553.960 2684869.280

Vel	30A	Van	34	P547/2005
Sheet		of		

PADRESERWE KOORDINATE / ROAD RESERVE CO-ORDINATES						
L1NKERKANT/LEFT HAND SIDE			REGTERKANT/RIGHT HAND SIDE			
	Y	X	WG 29°	Y	X	
L154	-55434.210	2 684 758.290		R154	-55654.070	2 684 891.890
L155	-55553.840	2684829.880		R155	-57944.690	2 684986.000
L156	-55639.490	2 684850.640		R156	-58164.520	2 684 996.620
L157	-57944.340	2684947.150		R157	-58623.620	2 685 014.920
L158	-58069.410	2 684952.330		R158	-59636.760	2 685 055.060
L159	-58612.520	2 684 976.840		R159	-59753.180	2685059.700
L160	-59622.020	2685 016.650		R160	-61772.410	2685140.110
L161	-59753.580	2 685 021.960		R161	-62081.080	2 685 152.400
L162	-62271.190	2 685 123.540		R162	-62288.890	2 685 160.680
L163	-62500.300	2 685 132.780		R163	-62415.790	2685165.730
L164	-62743.990	2685109.670		R164	-62541.600	2 685 166.420
L165	-63009.680	2 685080.030		R165	-62614.970	2 685 162.570
L166	-63502.230	2685025.100		R166	-62999.060	2 685 119.600
L167	-63912.010	2 684979.390		R167	-63472.600	2 685 066.630
L168	-64056.270	2 684 975.180		R168	-63763.580	2 685 034.080
L169	-64233.270	2 684 996.560		R169	-64219.500	2685036.740
L170	-64609.350	2 685 072.870		R170	-64316.030	2685050.740
L171	-64713.660	2 685 089.890		R171	-64 725.620	2 685 134.280
L172	-64828.170	2 685 097A70		R172	-64857.690	2685135.770
L173	-64940.260	2 685 098.280		R173	-65975.090	2685148.420
L174	-66060.400	2 685 106.410		R174	-66095.860	2685142.390
L175	-66960A00	2 685 020.410		R175	-66965.710	2 685 062.260
L176	-67714.590	2 684 948.340		R176	-67829.390	2684979.170
L177	-67852.000	2 684 945.270		R177	-67943.480	2 684 983.840
L178	-67999.570	2 684 948.420		R178	-68047.220	2 684996.410
L179	-68779.410	2685102.040		R179	-68795.760	2685144.950
L180	-69228.700	2 685 191.080		R180	-69228.230	2 685 231.770
L181	-71 845.550	2 685 709.680		R181	-71 856.500	2685 750.400
L182	-72 089.980	2685757.790		R182	-72 075.390	2 685 793.620
L183	-72 996.590	2685 936.250		R183	-72 885.690	2 685 953.630
L184	-73804.350	2 686 095.250		R184	-73895.100	2 686 152.960
L185	-73928.160	2686111.230		R185	-75513.020	2686147.530
L186	-75539.070	2 686 112.720		R186	-76331.940	2686 144.780
L187	-76325.850	2686107.730		R187	-76446.820	2686141.590
L188	-76452.370	2686 104.020		R188	-76563.500	2 686 123.360
L189	-76588.670	2 686 079.940		R189	-76615.110	2 686 109.040
L190	-76712.980	2686038.150		R190	-76676.090	2 686 092.120
L191	-77 813.340	2 685 486.630		R191	-76765.210	2 686 052.450
L192	-78259.410	2 685 263.050		R192	-77835.070	2685518.020
L193	-78744.830	2 685 019.580		R193	-78291.150	2685290.190
L194	-80060.670	2 684 359.600		R194	-78776.570	2685046.410
L195	-80148.450	2684324.320		R195	-80118.100	2684372.700
L196	-80270.510	2 684 296.230		R196	-80215.780	2684342.310
L197	-81122.000	2684301.060		R197	-80296.690	2 684337.330
L198	-81912.160	2 684305.890		R198	-81 194.520	2 684 341.850
L199	-83223.900	2 684 313.000		R199	-81 903.640	2 684 346.870
L200	-84863.070	2 684 323.130		R200	-83021.690	2 684351.040
L201	-84992.930	2 684 324.400		R201	-83207.190	2 684 345.000
L202	-85382.230	2 684 328.080		R202	-84848.500	2 684 362.210
L203	-85454.520	2 684 329.520		R203	-85091.890	2 684 363.840
L204	-85659.470	2 684354.570		R204	-85371.020	2 684365.640

Vel	31A	Van	34	P547/2005
Sheet		of		

PADRESERWE KOORDINATE / ROAD RESERVE CO-ORDINATES								
LINKERKANT/LEFT HAND SIDE			REGTERKANT/RIGHT HAND SIDE					
	Y	X	WG29°	Y	X			
L205	-86952.590	2684513.690		R205	-85509.880	2684376.760		
L206	-89241.300	2 684 794.470		R206	-85573.700	2684384.010		
L207	-91 115.970	2 685 023.840		R207	-86939.850	2 684 550.680		
L208	-91808.770	2685 109.040		R208	-89238.450	2684832.450		
L209	-91 863.220	2685115.740		R209	-90644.800	2685004.750		
L210	-91 993.660	2685139.590		R210	-91 787.330	2685145.510		
L211	-92087.910	2 685 166.850		R211	-91867.140	2 685 155.340		
L212	-92181.940	2685201.580		R212	-92051.130	2 685 194.470		
L213	-96528.830	2 687 062.440		R213	-92167.650	2 685235.670		
L214	-101 135.780	2 689 034.630		R214	-95518.440	2 686 670.680		
L215	-101 459.930	2 689 173.400		R215	-96527.220	2687102.880		
L216	-101 544.800	2 689 211.970		R216	-97961.290	2687 717.300		
L217	-101640.000	2689259.770		R217	-101061.500	2 689 044.190		
L218	-101920.130	2 689 459.370		R218	-101 417.590	2 689 196.600		
L219	-102 005.050	2 689 519.830		R219	-101 641.330	2689 323.050		
L220	-102249.060	2689 723.970		R220	-101 766.560	2689417.740		
L221	-102 285.890	2689764.730		R221	-102138.400	2689684.120		
L222	-102 324.980	2 689 809.820		R222	-102202.460	2689737.060		
L223	-102361.560	2 689 853.760		R223	-102261.69.0	2 689 789.270		
L224	-102454.520	2690001.640		R224	-102365.190	2 689 922.080		
L225	-102880.490	2690744.610		R225	-102435.120	2 690 040.080		
L226	-104059.770	2 692 801.490		R226	-102851.960	2690767.970		
L227	-104541.080	2 693642.900		R227	-104 015.970	2 692 800.550		
L228	-104625.540	2 693 772.020		R228	-104446.660	2693552.610		
L229	-104764.860	2 693 958.270		R229	-104518.740	2 693679.920		
L230	-104841.380	2 694 050.500		R230	-104593.370	2 693 790.500		
L231	-104 974.270	2694200.410		R231	-104650.720	2 693 870.770		
L232	-106059.270	2 695 434.360		R232	-104 724.050	2 693 967.030		
				R233	-106037.380	2695467.500		
				Vel	32A	Van	34	P547/2005
				Sheet		of		

PADRESERWE KOORDINATE / ROAD RESERVE CO-ORDINATES						
L1NKERKANT/LEFT HAND SIDE			REGTERKANT/RIGHT HAND SIDE			
	Y	X	WG 31°	Y	X	
L232	96882.890	2 695 368.290		R233	96904.300	2695401.740
L233	94582.940	2 697 911.050		R234	96669.730	2695662.100
L234	94163.540	2698374.730		R235'	95174.930	2697312.870
L235	93866.723	2698704.219		R236	94618.970	2697927.090
L236	93677.445	2698956.727		R237	94613.910	2 697 932.690
L237	93570.340	2 699 142.823		R238	94191.680	2698399.970
L238	93480.651	2699 327.811		R239	93896.102	2 698728.295
L239	93425.871	2 699 464.060		R240	93709.207	2 698 977.625
L240	93354.362	2699688.999		R241	93603.905	2699160.592
L241	93311.903	2 699 875.247		R242	93515.373	2 699 343.209
L242	93306.320	2699914.940		R243	93461.601	2 699476.944
L243	93285.380	2 700 033.670		R244	93390.990	2 699 699.042
L244	93269.470	2700229.750		R245	93349.220	2 699 882.269
L245	93257.600	2 700 498.500		R246	93343.720	2699920.350
L246	93215.710	2701 447.780		R247	93332.730	2 699 979.640
L247	93205.770	2701 710.850		R248	93307.350	2700233.610
L248	93216.840	2701 851.740		R249	93291.640	2 700 601.620
L249	93229.630	2701 927.340		R250	93253.630	2 701 491.980
L250	93259.040	2 702017.020		R251	93243.190	2 701 700.380
L251	93295.200	2702111.580		R252	93255.250	2 701 848.980
L252	93369.720	2 702 281.370		R253	93267.620	2701 918.660
L253	93384.650	2702317.810		R254	93289.380	2702008.080
L254	93408.050	2702374.930		R255	93324.190	2 702 099.290
L255	93440.070	2 702 553.440		R256	93403.220	2 702259.090
L256	93439.210	2 702 598.640		R257	93417.960	2 702298.550
L257	93434.170	2702698.010		R258	93443.510	2702366.980
L258	93415.120	2 702 793.480		R259	93476.290	2 702 549.820
L259	93396.290	2702861.060		R260	93472.270	2 702 696.880
L260	93360.250	2 702 948.570		R261	93445.600	2 702 834.630
L261	93337.640	2702993.120		R2.62	93424.420	2702894.780
L262	93286.440	2703064.770		R263	93399.590	2 702 956.620
L263	92969.160	2703511.470		R264	93367.180	2703019.780
L264	92497.760	2704172.600		R265	93320.990	2 703 092.540
L265	90751.180	2706614.650		R266	93010.590	2703527.180
L266	90227.140	2707347.100		R267	92534.290	2704191.160
L267	89434.960	2 708 454.390		R268	91 220.290	2706027.630
L268	88933.740	2 709 155.500		R269	90356.520	2 707 234.250
L269	88436.880	2 709 850.280		R270	90259.260	2 707 370.230
L270	88124.510	2710286.700		R271	88957.190	2 709 190.630
L271	87787.550	2 710 757.930		R272	88948.990	2709202.100
L272	87575.880	2 711 053.600		R273	88156.510	2710310.790
L273	86958.620	2711 916.310		R274	86968.360	2 711 971.250
L274	86130.860	2713073.190		R275	85215.950	2714420.270
L275	85494.760	2713962.730		R276	85141.780	2714541.010
L276	85149.700	2714447.230		R277	85087.640	2714661.540
L277	85095.650	2714542.740		R278	85076.490	2 714706.220
L278	85027.780	2714725.390		R279	85051.280	2714812.630
L279	85007.310	2714834.170		R280	85038.400	2714961.520
L280	84999.760	2714926.570		R281	85050.570	2715 405.900
L281	85005.340	2715201.850		R282	85133.740	2718443.930
L282	85011.410	2715408.160		R283	85146.060	2 718 993.290

Vel	33A	Van	34	P547/2005
Sheet		of		

PADRESERWE KOORDINATE / ROAD RESERVE CO-ORDINATES					
L1NKERKANT/LEFT HAND SIDE			REGTERKANT/RIGHT HAND SIDE		
	Y	X	WG 31°	Y	X
L283	85049.260	2716694.410	R284	85185.350	2 720 745.920
L284	85103.790	2 718 994.380	R285	85179.220	2 720 823.020
L285	85145.500	2 720 753.130	R286	85139.320	2 720938.900
L286	85130.910	2 720 866.000	R287	84911.330	2 721 360.310
L287	85101.470	2 720 924.170	R288	84073.050	2 722 913.790
L288	84302.030	2722405.790	R289	84036.450	2 722 976.470
L289	83998.300	2722967.610	R290	83984.960	2723043.210
L290	83967.080	2 723 002.400	R291	83473.730	2723530.780
L291	83916.770	2 723 056.380	R292	82716.790	2724252.700
L292	83470.740	2723 481.090	R293	82618.040	2 724331.890
L293	82682.280	2 724 231.860	R294	82602.510	2 724 344.350
L294	82642.610	2 724 268.440	R295	82515.220	2 724 383.550
L295	82565.320	2 724 318.910	R296	82436.480	2724401.750
L296	82546.080	2 724 329.260	R297	82390.780	2 724 408.370
L297	82484.590	2 724 351.820	R298	81909.870	2724478.120
L298	82437.870	2 724 361.680	R299	81233.870	2724577.190
L299	80340.420	2 724 663.490	R300	81 035.610	2724607.440
L300	79991.790	2724713.470	R301	80475.720	2724688.730
L301	78829.630	2724881.090	R302	80354.690	2 724 702.060
L302	78766.200	2 724 895.340	R303	79981.000	2 724 755.220
L303	78713.180	2724912.910	R304	78837.930	2 724 920.230
L304	77756.920	2725337.830	R305	78776.380	2724935.210
L305	77 558.860	2 725 425.680	R306	78710.980	2724957.530
L306	77 372.290	2 725 508.440	R307	77771.180	2 725 373.860
L307	76650.170	2 725 828.760	R308	77 533.920	2 725479.250
L308	75525.540	2726327.960	R309	77 372.990	2725550.730
L309	75327.600	2726415.820	R310	75531.200	2 726 368.820
L310	74658.440	2 726 713.030	R311	75218.940	2 726 507.530
L311	74196.900	2726918.030	R312	74662.350	2 726 754.950
L312	73180.530	2 727 369.960	R313	74644.270	2 726 762.990
L313	72487.120	2727678.810	R314	72900.730	2 727 536.240
L314	72330.610	2727748.520	R315	72 317.890	2727795.410
L315	70848.220	2 728 407.520	R316	72 115.020	2 727 885.630
L316	70711.510	2 728 468.300	R317	71633.340	2728099.760
L317	70672.560	2728485.617	R318	70896.480	2728427.490
L318	69925.952	2 728 817.256	R319	70718.810	2 728506.520
			R320	70653.608	2 728 535.523
			R321	69936.904	2 728 854.044

Vel 34A Van 34
Sheet of

P547/2005