

CONTENTS

No.		Page No.	Gazette No.
GOVERNMENT NOTICE			
Transport, Department of			
<i>Government Notice</i>			
779	South African National Roads Agency Limited and the National Roads Act (7/1998): The South African National Roads Agency Limited: Declaration amendment of National Road R526 Section 2: Amendment of Declaration No. 1229 of 2004	..	3 30219

INHOUD

No.		B/adsy No.	noeren: No.
GOEWERMENSKENNISGEWING			
Vervoer, Departement van			
<i>Goewermentskennisgewing</i>			
779	Suid-Afrikaanse Nasionale Padagentskap Beperk en die Nasionale Paaie Wet (7/1998): Die Suid-Afrikaanse Nasionale Padagentskap Beperk: Verklaring wysiging van Nasionale Pad R526 Seksie 2: Wysiging van Verklaring No. 1229 van 2004	.	4 30219

GOVERNMENT NOTICE
GOEWERMENTSKENNISGEWING

DEPARTMENT OF TRANSPORT
DEPARTEMENT VAN VERVOER

No. 779

24 August 2007

THE SOUTH AFRICAN NATIONAL ROADS
AGENCY LIMITED

Registration No: 98/09584/06

DECLARATION AMENDMENT OF NATIONAL ROAD R526 SECTION 2

AMENDMENT OF DECLARATION No. 1229 OF 2004

By virtue of section 40 (1)(b) of the South African National Roads Agency Limited and the National Roads Act, 1998 (Act No.7 of 1998), I hereby amend Declaration No. 1229 of 2004 by substituting the portion from Gravelotte up to the junction with the R40 on the farm Lekkergoed 158 -KT in paragraph (VII) of the Annexure, with the subjoined sheets 1 to 10 of Plan NO.P590106.

(National Road R526 Section 2: R40 • Gravelotte)



MINISTER OF TRANSPORT

No. 779

24 Augustus 2007

**DIE SUID-AFRIKAANSE NASIONALE
PADAGENTSKAPBEPERK**

Registrasie No: 98/09584/06

VERKLARING WYSIGING VAN NASIONALE PAD R526 SEKSIE 2.

WYSIGING VAN VERKLARING NO. 1229 VAN 2004.

Kragtens Artikel40(1)(b) van die Suid Afrikaanse Nasionale Padagentskap Beperk en die Nasionale Paaie Wet, 1998 (Wet NO.7 van 1998), wysig ek hiermee Verklarings No.1229 van 2004 deur die gedeelte vanaf Gravelotte tot by die aansluiting met die R40 op die plaas Lekkergoed 158 – KT in paragraaf (VII) van die bylae, te vervang met meegaande velie 1 tot 10 van Plan No. *P590f06*.

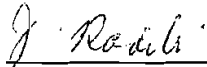
(Nasionale Pad R526 Seksie 2: R40 • Gravelotte)

J. Radeli

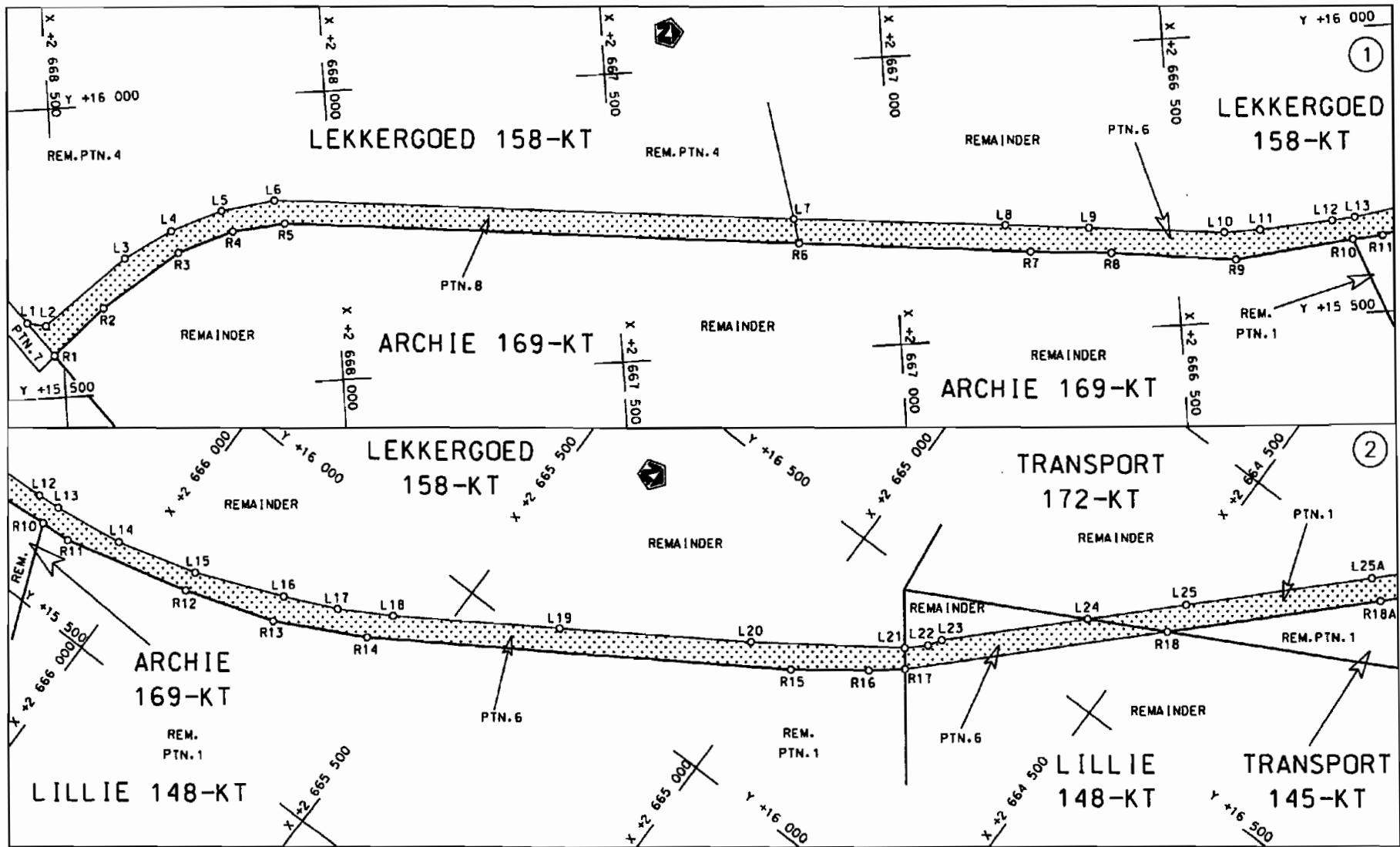

Die Suid Afrikaanse Nasionale Padagentskap Beperk
The South African National Roads Agency Limited

Die figuur getoon
The figure shown

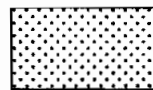

steldie padreserve voor van 'n gedeelte
represents the road reserve of a portion
von Nasionale Roete R526 Sektie
of National Route 2 Section

Vel
Sheet 1 von
of 10
Plan P 590/06

D.O.9.A

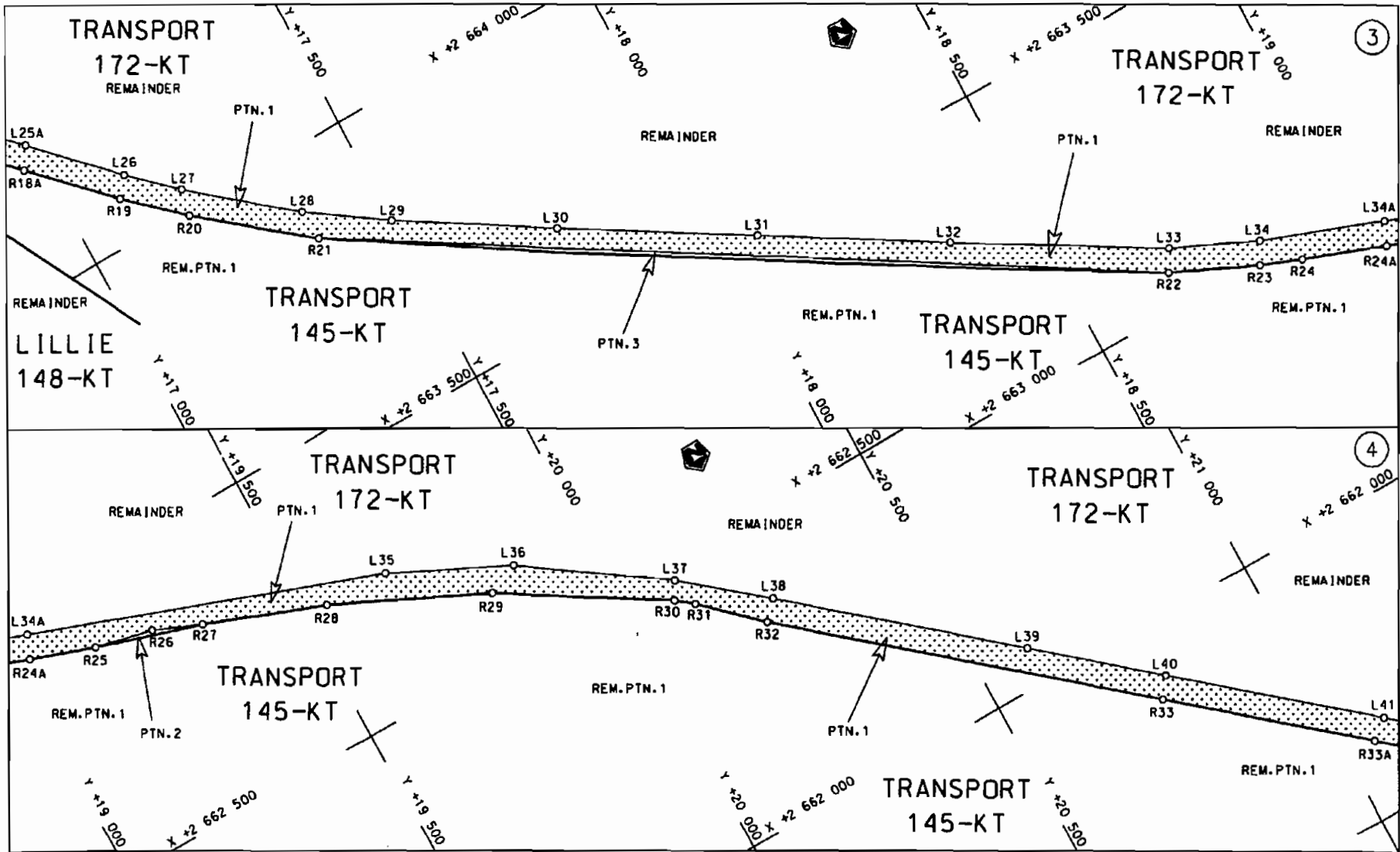

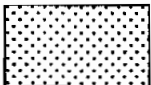
<p>Die Suid Afrikaanse Nasionale Padagentskap Beperk The South African National Roads Agency Limited</p>	<p>Die figuur getoon The figure shown</p>		<p>steldie padreserwe voor van 'n gedeelte represents the road reserve of a portion van Nasionale Roete R526 Sektie of National Route R526 Section 2</p>	<p>Vel Sheet 2 van of 10</p>
			<p>Plan P 590/06</p>	<p>P 590/06</p>

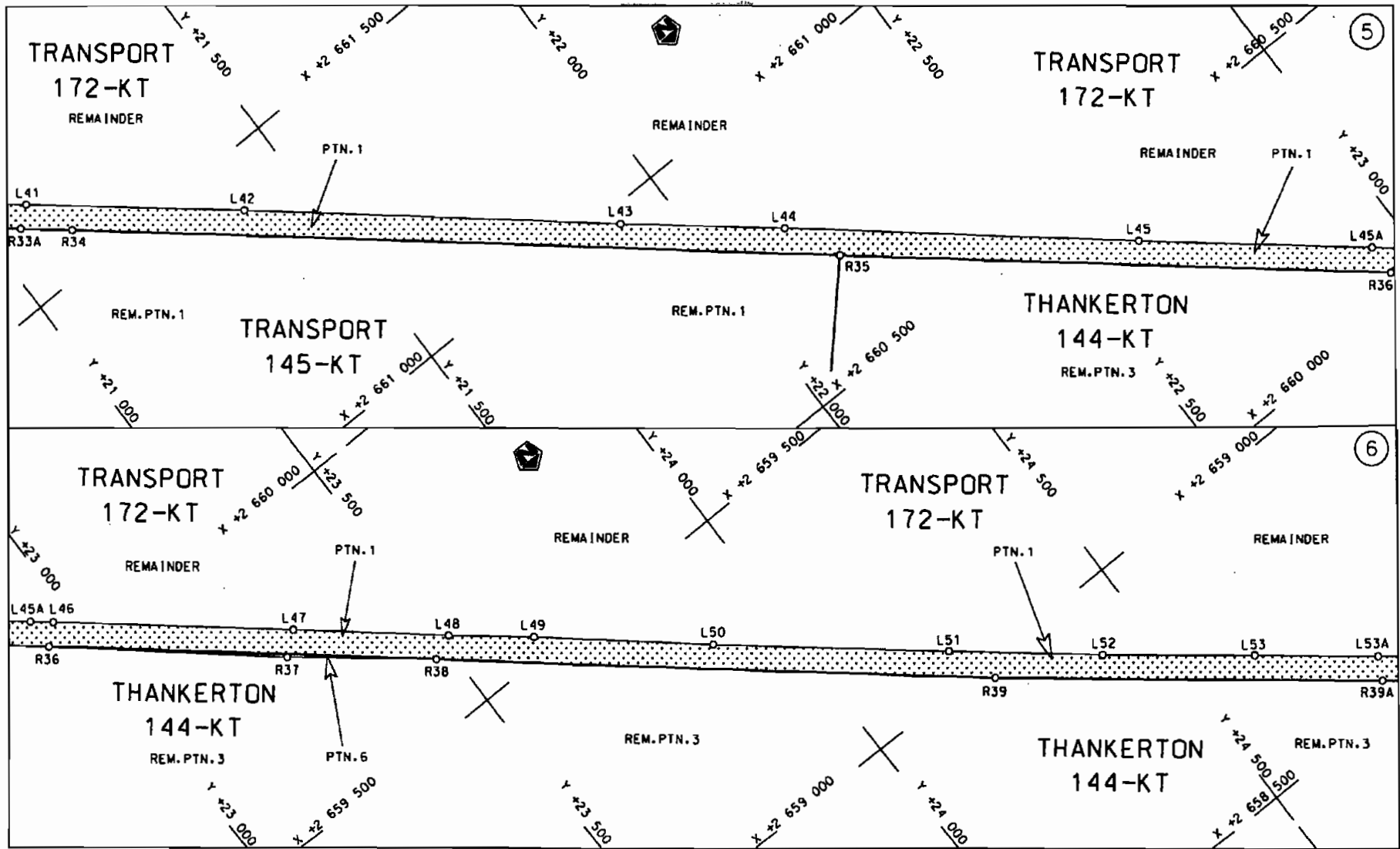

Die Suid Afrikaanse Nasionale Padagentskap Beperk
The South African National Roads Agency Limited

Die figuur getoon
The figure shown

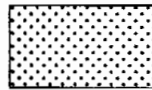

steldie padreserwe voor van 'n gedeelte
represents the road reserve of a portion
von Nasionale Roete R526 Seksie Section 2
of National Route

Vel Sheet 3 van of 10
Plan P 590/06

D.O.9.A

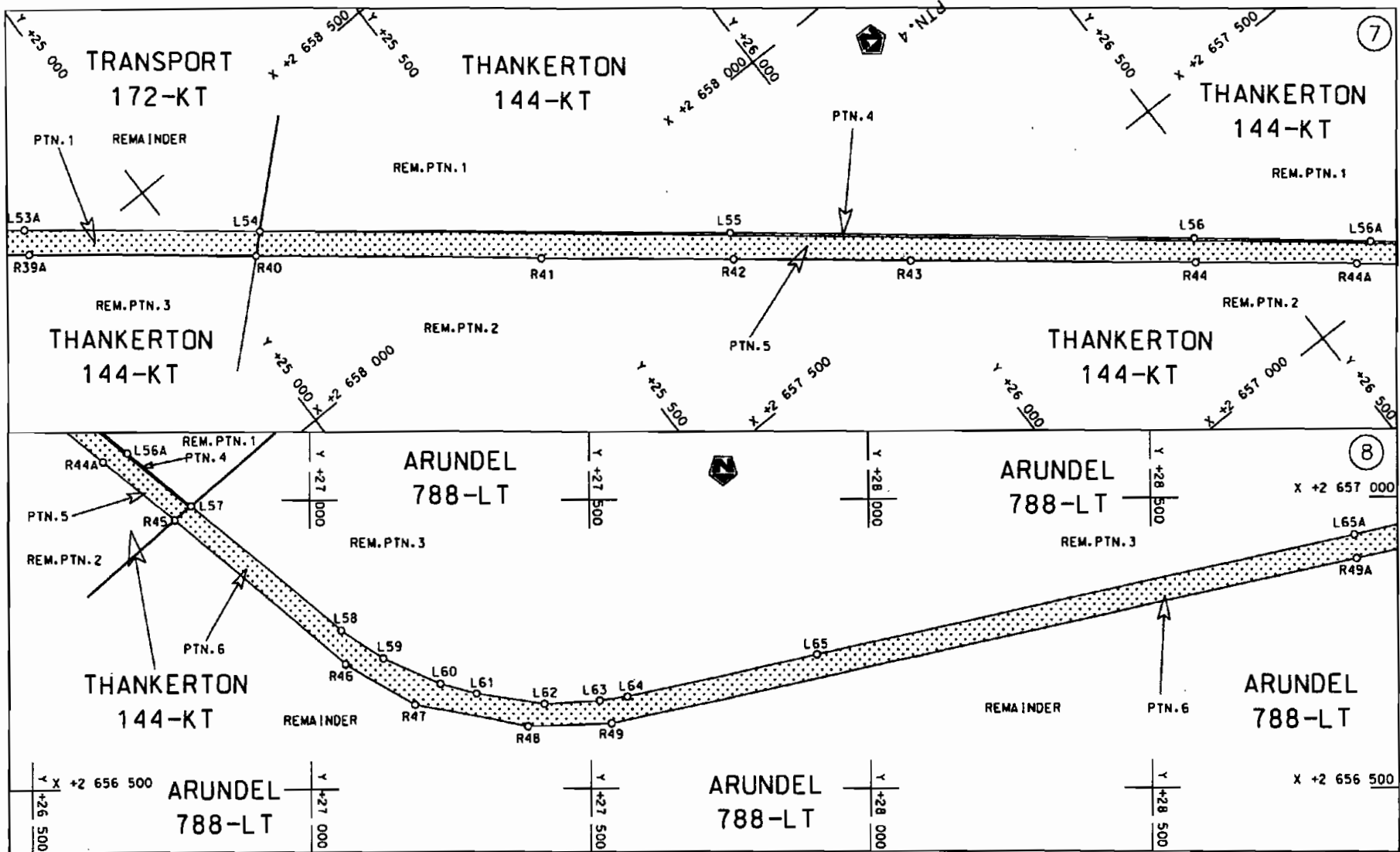

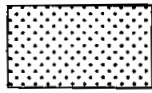
<p>Die Suid Afrikaanse Nasionale Podagentskap Beperk The South African National Roads Agency Limited</p>	<p>Die figuur getoon The figure shown</p> 	<p>steldie padreserwe voor van 'n gedeelte represents the road reserve of a portion van Nasionale Roete R526 Sektie of National Route R526 Section</p>	<p>Vel Sheet 4 van of 10 Plan P 590/06</p>
--------------------------------------------------------------------------------------------------------------	------------------------------------------------------------------------------------------------------------------------------------	--------------------------------------------------------------------------------------------------------------------------------------------------------------------	------------------------------------------------

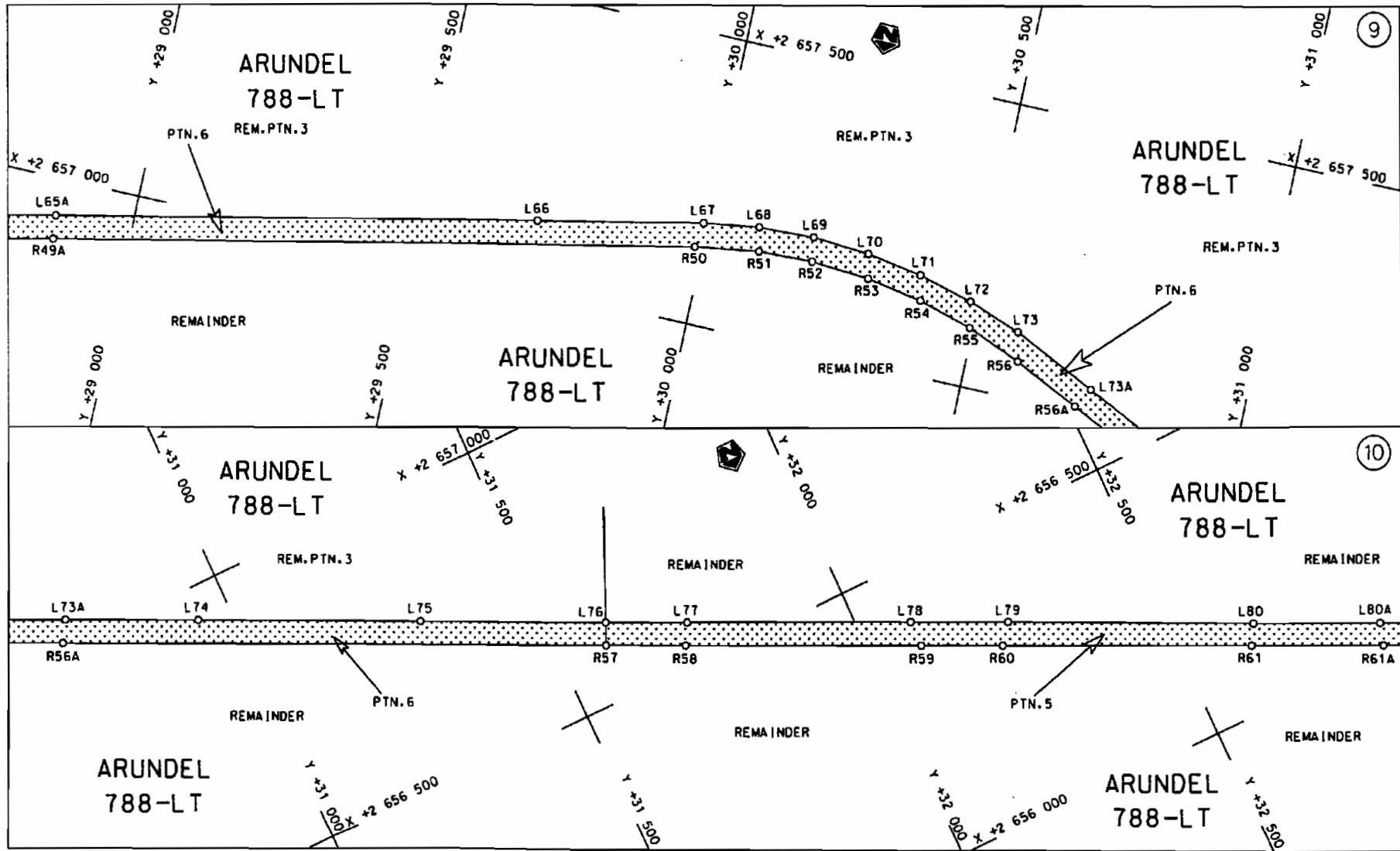

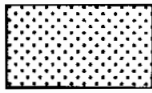
<p>Die Suid Afrikaanse Nasionale Padagentskop Beperk The South African National Roads Agency Limited</p>	<p>Die figuur getoon The figure shown</p>		<p>steldie padreserwe voor van 'n gedeelte represents the road reserve of a portion van Nasionale Roete R526 of National Route</p> <p>Seksie Section</p> <p>2</p>	<p>Vel Sheet 5 van of 10</p>
				<p>Plan P 590/06</p>

D.O.9.A

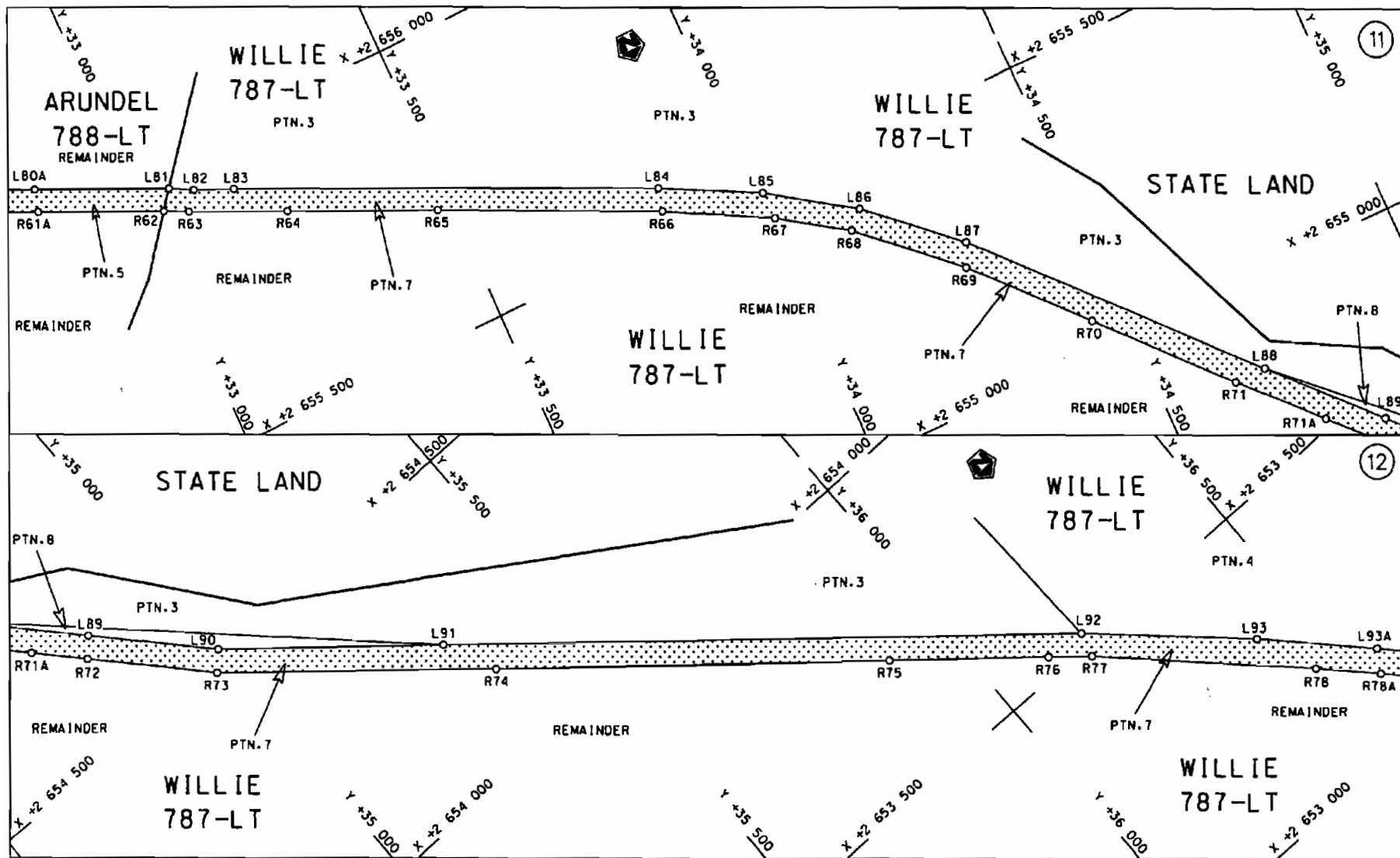

<p>Die Suid Afrikaanse Nasionale Padagentskap Beperk The South African National Roads Agency Limited</p>	<p>Die figuur getoon The figure shown</p>		<p>steldie padreserwe voor van 'n gedeelte represents the road reserve of a portion van Nasionale Roete R526 Seksie of National Route R526 Section 2</p>	<p>Vel Sheet 6 van of 10</p>
				<p>Plan P 590/06</p>

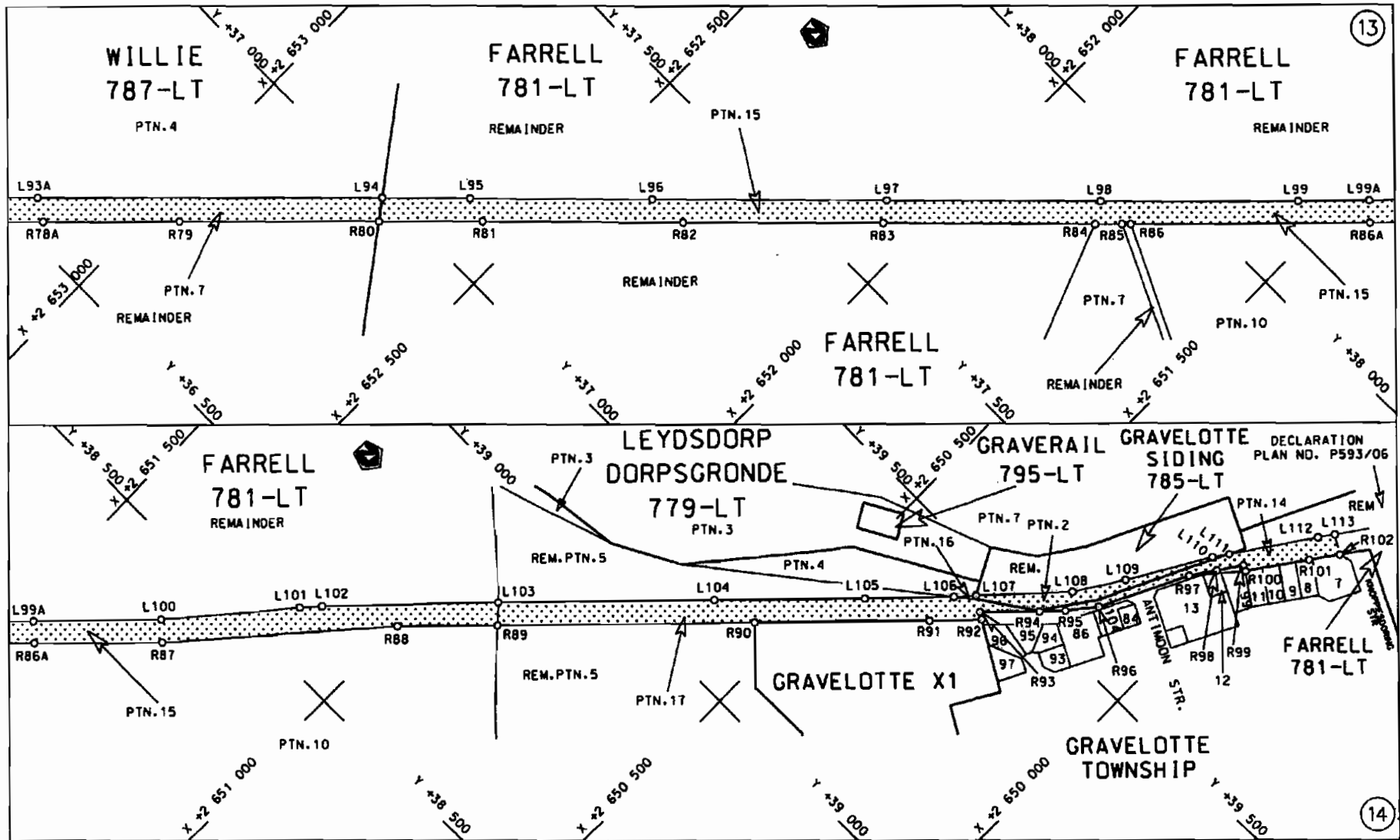

Die Suid Afrikaanse Nasionale Padagentskap Beperk
The South African National Roads Agency Limited

Die figuur getoon
The figure shown

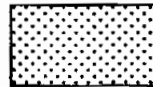

steldie padreserwe voor van 'n gedeelte
represents the road reserve of a portion
van Nasionale Raete R526 Seksie
of National Route Section 2

Vel Sheet 7 van of 10
Plan P 590/06

D.O.9.A

PADRESERWE KOORDINATE				/	ROAD RESERVE CO-ORDINATES			
LINKERKANT/LEFT HAND SIDE					REGTERKANT/RIGHT HAND SIDE			
	y	X	WG	31	Y	X		
L1	15 631.95	2 668	561.50	R1	15 573.03	2 668	515.72	
L2	15 624.78	2 668	528.39	R2	15 649.28	2 668	422.47	
L3	15 732.80	2 668	378.74	R3	15 736.78	2 668	282.59	
L4	15 774.85	2 668	293.20	R4	15 767.37	2 668	181.22	
L5	15 804.20	2 668	199.18	R5	15 774.86	2 668	085.86	
L6	15 816.09	2 668	102.13	R6	15 684.88	2 667	169.77	
L7	15 727.25	2 667	176.57	R7	15 644.43	2 666	757.96	
L8	15 692.82	2 666	800.00	R8	15 633.25	2 666	614.49	
L9	15 679.24	2 666	651.49	R9	15 608.32	2 666	394.74	
L10	15 656.71	2 666	412.45	R10	15 630.07	2 666	185.26	
L11	15 656.97	2 666	349.23	R11	15 633.35	2 666	131.79	
LI2	15 664.41	2 666	219.72	R12	15 691.86	2 665	910.93	
L13	15 667.81	2 666	179.58	R13	15 746.43	2 665	752.50	
L14	15 686.14	2 666	056.61	R14	15 825.20	2 665	602.16	
L15	15 727.17	2 665	915.91	R15	16 240.27	2 664	967.97	
LI6	15 791.94	2 665	762.65	R16	16 322.92	2 664	856.62	
LI7	15 832.27	2 665	673.70	R17	16 363.68	2 664	806.86	
LI8	15 883.06	2 665	587.83	R18	16 695.98	2 664	473.44	
LI9	16 046.75	2 665	339.29	R19	17 092.24	2 664	077.48	
L20	16 235.26	2 665	053.01	R20	17 186.64	2 663	990.69	
L21	16 392.48	2 664	828.90	R21	17 370.65	2 663	843.21	
L22	16 420.75	2 664	798.69	R22	18 667.04	2 663	059.92	
L23	16 442.86	2 664	784.68	R23	18 814.38	2 662	994.47	
L24	16 628.47	2 664	599.37	R24	18 884.51	2 662	967.01	
L25	16 753.43	2 664	474.61	R25	19 140.16	2 662	876.40	
L26	17 119.12	2 664	109.37	R26	19 244.10	2 662	852.68	
L27	17 196.78	2 664	036.84	R27	19 328.77	2 662	817.20	
L28	17 366.53	2 663	897.71	R28	19 540.32	2 662	737.40	
L29	17 500.48	2 663	806.15	R29	19 808.43	2 662	611.62	
L30	17 752.44	2 663	652.53	R30	20 086.40	2 662	444.28	
L31	18 057.60	2 663	468.83	R31	20 115.98	2 662	420.89	
L32	18 352.03	2 663	292.07	R32	20 213.16	2 662	330.90	
L33	18 688.02	2 663	096.89	R33	20 763.10	2 661	871.64	
L34	18 834.75	2 663	031.75	R34	21 127.94	2 661	568.01	
L35	19 658.63	2 662	733.87	R35	22 184.70	2 660	685.23	
L36	19 865.37	2 662	634.59	R36	22 938.10	2 660	056.87	
L37	20 103.42	2 662	473.92	R37	23 264.62	2 659	777.93	
L38	20 242.35	2 662	361.20	R38	23 471.95	2 659	611.62	
L39	20 595.56	2 662	066.41	R39	24 237.21	2 658	973.37	
L40	20 788.38	2 661	905.21	R40	25 092.51	2 658	288.36	
L41	21 090.26	2 661	653.98	R41	25 492.13	2 657	968.06	
L42	21 392.22	2 661	404.07	R42	25 761.46	2 657	754.52	
L43	21 908.15	2 660	970.03	R43	26 008.50	2 657	557.72	
L44	22 135.90	2 660	782.78	R44	26 405.12	2 657	243.69	
L45	22 619.37	2 660	376.56	R45	26 757.57	2 656	965.20	
L46	22 970.14	2 660	085.17	R46	27 064.10	2 656	717.92	
L47	23 302.23	2 659	808.38	R47	27 186.80	2 656	647.88	
L48	23 514.69	2 659	630.35	R48	27 388.54	2 656	609.75	
L49	23 634.36	2 659	534.33	R49	27 538.05	2 656	614.56	
L50	23 878.29	2 659	327.52	R50	29 986.67	2 657	132.28	
L51	24 201.12	2 659	059.83	R51	30 099.96	2 657	149.19	

Vel	8	Van	10	P590/06
Sheet		of		

PADRESERWE KOORDINATE				ROAD RESERVE CO-ORDINATES			
LINKERKANT/LEFT HAND SIDE				REGTERKANT/RIGHT HAND SIDE			
	Y	X	WG	31	Y	X	
L52	24	412.44	2	658	885.49	R52	30 196.82 2 657 152.85
L53	24	623.13	2	658	717.96	R53	30 300.25 2 657 146.06
L54	25	124.05	2	658	316.98	R54	30 398.50 2 657 129.23
L55	25	784.40	2	657	793.67	R55	30 494.34 2 657 102.52
L56	26	428.54	2	657	278.32	R56	30 589.87 2 657 064.82
L57	26	786.86	2	656	989.76	R57	31 582.45 2 656 597.86
L58	27	056.55	2	656	775.63	R58	31 710.09 2 656 537.94
L59	27	131.27	2	656	727.34	R59	32 089.09 2 656 360.31
L60	27	232.67	2	656	683.92	R60	32 219.76 2 656 298.65
L61	27	296.70	2	656	666.54	R61	32 618.60 2 656 110.66
L62	27	418.17	2	656	648.99	R62	33 031.66 2 655 916.69
L63	27	516.77	2	656	654.55	R63	33 072.07 2 655 896.78
L64	27	566.36	2	656	661.19	R64	33 231.19 2 655 821.76
L65	27	906.00	2	656	733.03	R65	33 474.92 2 655 708.53
L66	29	704.14	2	657	114.18	R66	33 836.65 2 655 537.61
L67	29	992.89	2	657	175.27	R67	34 011.86 2 655 442.12
L68	30	091.48	2	657	190.34	R68	34 126.18 2 655 364.29
L69	30	190.95	2	657	194.30	R69	34 283.46 2 655 222.74
L70	30	291.82	2	657	187.66	R70	34 445.58 2 655 046.36
L71	30	389.21	2	657	172.27	R71	34 631.73 2 654 844.62
L72	30	485.98	2	657	147.08	R72	34 816.06 2 654 647.79
L73	30	579.89	2	657	114.21	R73	34 975.43 2 654 478.31
L74	30	941.13	2	656	943.96	R74	35 355.51 2 654 156.67
L75	31	300.50	2	656	774.23	R75	35 892.18 2 653 710.31
L76	31	598.44	2	656	633.77	R76	36 108.58 2 653 529.87
L77	31	729.22	2	656	572.91	R77	36 167.46 2 653 480.83
L78	32	089.61	2	656	404.94	R78	36 453.65 2 653 204.86
L79	32	245.81	2	656	331.87	R79	36 706.69 2 652 951.01
L80	32	637.76	2	656	144.25	R80	36 958.63 2 652 696.93
L81	33	056.97	2	655	948.10	R81	37 089.15 2 652 565.30
L82	33	096.40	2	655	926.81	R82	37 342.04 2 652 310.32
L83	33	161.33	2	655	898.06	R83	37 594.87 2 652 055.04
L84	33	847.14	2	655	576.55	R84	37 859.05 2 651 786.24
L85	34	010.61	2	655	490.69	R85	37 892.88 2 651 752.03
L86	34	154.99	2	655	392.31	R86	37 903.73 2 651 741.09
L87	34	301.64	2	655	260.96	R87	38 367.29 2 651 278.11
L88	34	688.06	2	654	843.81	R88	38 685.24 2 651 000.32
L89	34	843.07	2	654	676.47	R89	38 813.13 2 650 874.35
L90	35	002.90	2	654	506.97	R90	39 141.55 2 650 552.88
L91	35	311.16	2	654	248.78	R91	39 364.26 2 650 334.37
L92	36	178.58	2	653	522.26	R92	39 431.06 2 650 269.24
L93	36	407.47	2	653	311.54	R93	39 437.94 2 650 280.77
L94	36	992.17	2	652	721.90	R94	39 513.52 2 650 206.66
L95	37	101.35	2	652	609.27	R95	39 546.79 2 650 175.19
L96	37	331.69	2	652	377.73	R96	39 593.79 2 650 138.09
L97	37	626.78	2	652	078.35	R97	39 745.09 2 650 061.79
L98	37	893.94	2	651	807.45	R98	39 786.09 2 650 033.49
L99	38	141.47	2	651	557.27	R99	39 825.79 2 650 006.29
L100	38	394.25	2	651	308.11	R100	39 821.29 2 649 996.19
L101	38	586.07	2	651	145.19	R101	39 914.29 2 649 929.69
L102	38	616.07	2	651	118.46	R102	39 959.37 2 649 897.39

Vel	9	Van	10	P590/06
Sheet		of		

PADRESERWE KOORDINATE				/	ROAD RESERVE CO-ORDINATES		
LINKERKANT/LEFT HAND SIDE					REGTERKANT/RIGHT HAND SIDE		
	y	X	WG	31	Y	X	
LI03	38 842.70	2 650	901.67				
L104	39 118.69	2 650	631.51				
L105	39 311.06	2 650	441.91				
L106	39 424.97	2 650	332.70				
L107	39 454.02	2 650	305.78				
LI08	39 579.68	2 650	189.30				
L109	39 660.28	2 650	136.73				
LI10	39 797.11	2 650	055.43				
LI11	39 822.00	2 650	038.07				
L112	39 953.70	2 649	946.25				
L113	39 977.88	2 649	928.97				

Vel	10	Van	10	P590/06
Sheet		of		