

CONTENTS**INHOUD**

<i>No.</i>	<i>Page No.</i>	<i>Gazette No.</i>	<i>No.</i>	<i>Bladsy No.</i>	<i>Koerant No.</i>
GOVERNMENT NOTICE			GOEWERMENTSKENNISGEWING		
Transport, Department of			Vervoer, Departement van		
<i>Government Notice</i>			<i>Goewermentskennisgewing</i>		
1085			1085		
South African National Roads Agency Limited and National Roads Act (7/1998): The South African National Roads Agency Limited: Declaration amendment of National Road N11 Section 6: Amendment of Declaration No. 1322 of 1989	3	30481	Suid-Afrikaanse Nasionale Padagentskap Beperk en Nasionale Paaie Wet (7/1998): Die Suid-Afrikaanse Nasionale Padagentskap Beperk: Verklaring wysiging van Nasionale Pad N11 Seksie 6: Wysiging van Verklaring No. 1322 van 1989	4	30481

GOVERNMENT NOTICE
GOEWERMENTSKENNISGEWING

DEPARTMENT OF TRANSPORT
DEPARTEMENT VAN VERVOER

No. 1085

16 November 2007

THE SOUTH AFRICAN NATIONAL ROADS
AGENCY LIMITED

Registration No: 98/09584/06

DECLARATION AMENDMENT OF NATIONAL ROAD N11 SECTION 6

AMENDMENT OF DECLARATION NO. 1322 OF 1989

By virtue of Section 40(1)(b) of The South African National Roads Agency Limited and National Roads Act, 1998 (Act No 7 of 1998) I hereby amend declaration No. 1322 of 1989 Schedule paragraph 14, by substituting the section of the descriptive declaration from Amersfoort to the Vaal river (between Amersfoort and Ermelo), with the subjoined sheets 1 to 7 of Plan No. P621/07.

(National Road N11 Section 6: Amersfoort – Vaal River)



MINISTER OF TRANSPORT

No. 1085

16 November 2007

DIE SUID-AFRIKAANSE NASIONALE PADAGENTSKAP BEPERK

Registrasie No: 98/09584/06

VERKLARING WYSIGING VAN NASIONALE PAD N11 SEKSIE 6

WYSIGING VAN VERKLARING NO. 1322 van 1989

Kragtens artikel 40 (1)(b) van die Suid Afrikaanse Nasionale Padagentskap Beperk en Nasionale Paaie Wet (Wet No. 7 van 1998), wysig ek hiermee verklaring no.1322 van 1989 Bylae paragraaf 14, deur die gedeelte van die beskrywende verklaring vanaf Amersfoort tot die Vaalrivier (tussen Amersfoort en Ermelo), te vervang deur meegaande velle 1 tot 7 van Plan No. P621/07.

(Nasionale Pad N11 Seksie 6: Amersfoort - Vaalrivier)



MINISTER VAN VERVOER

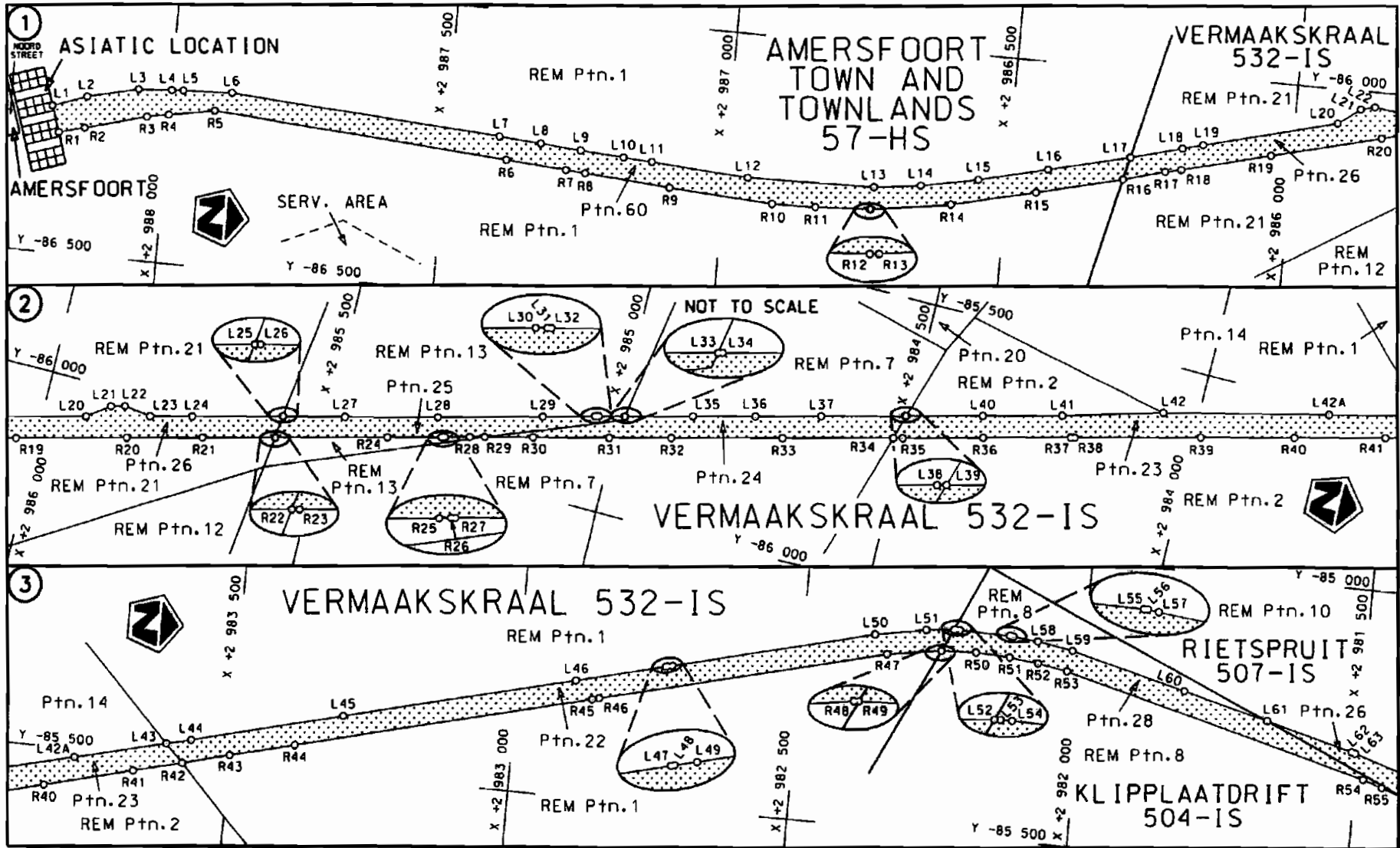

Die Suid Afrikaanse Nasionale Padagentskap Beperk The South African National Roads Agency Limited	Die figuur getoon The figure shown	 steldie padreserwe voor van 'n gedeelte represents the road reserve of a portion van Nasionale Roete of National Route	Vel Sheet 1 van of 7
N11 Seksie 6			Plan P621/07

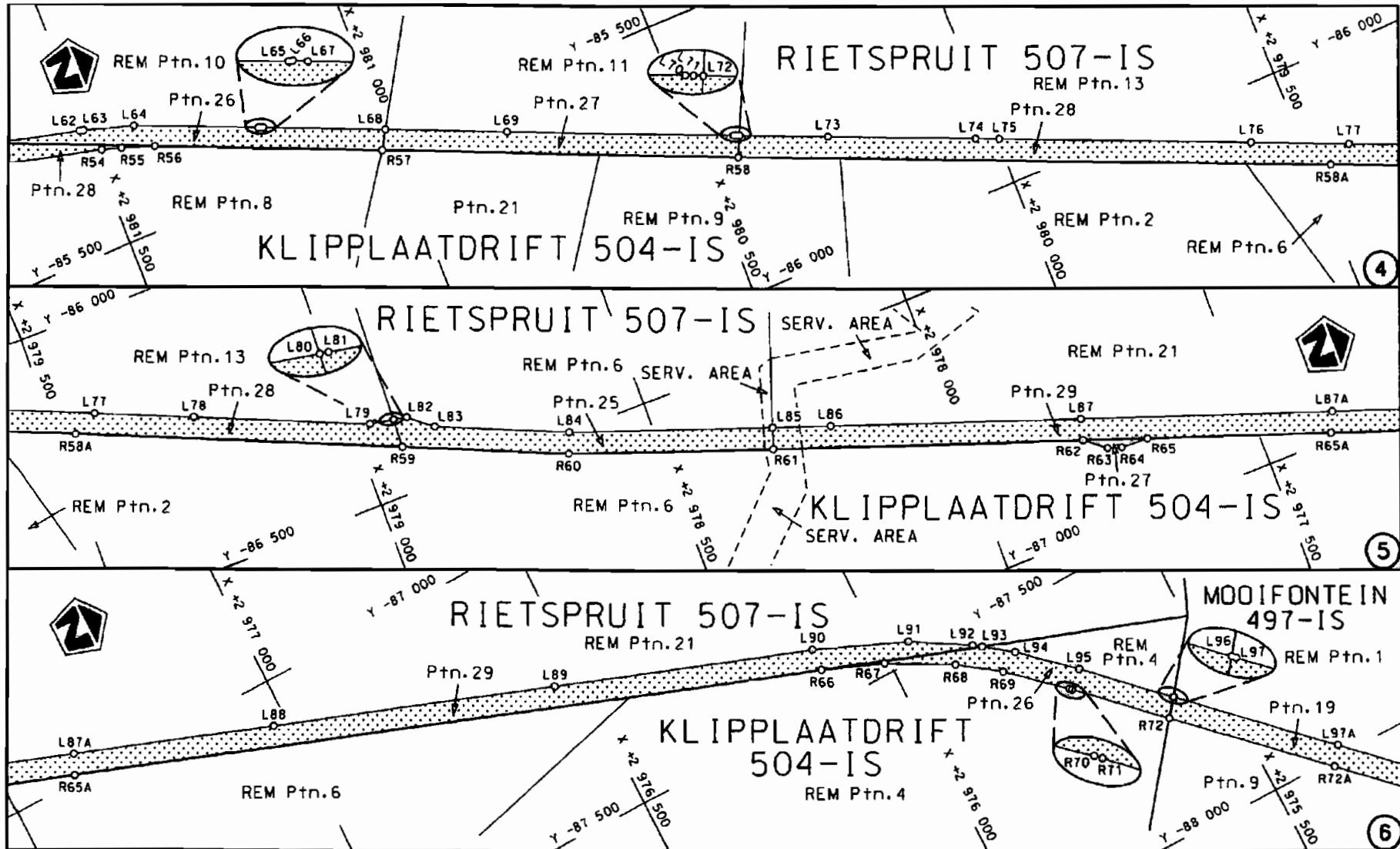

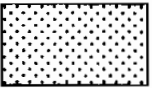
<p>Die Suid Afrikaanse Nasionale Padagentskap Beperk The South African National Roads Agency Limited</p>	<p>Die figuur getoon The figure shown</p> 	<p>steldie padreserwe voor van 'n gedeelte represents the road reserve of a portion van Nasionale Roete N11 Seksie of National Route Section 6</p>	<p>Vel Sheet 2 van 7 Plan P621/07</p>
--	--	--	---

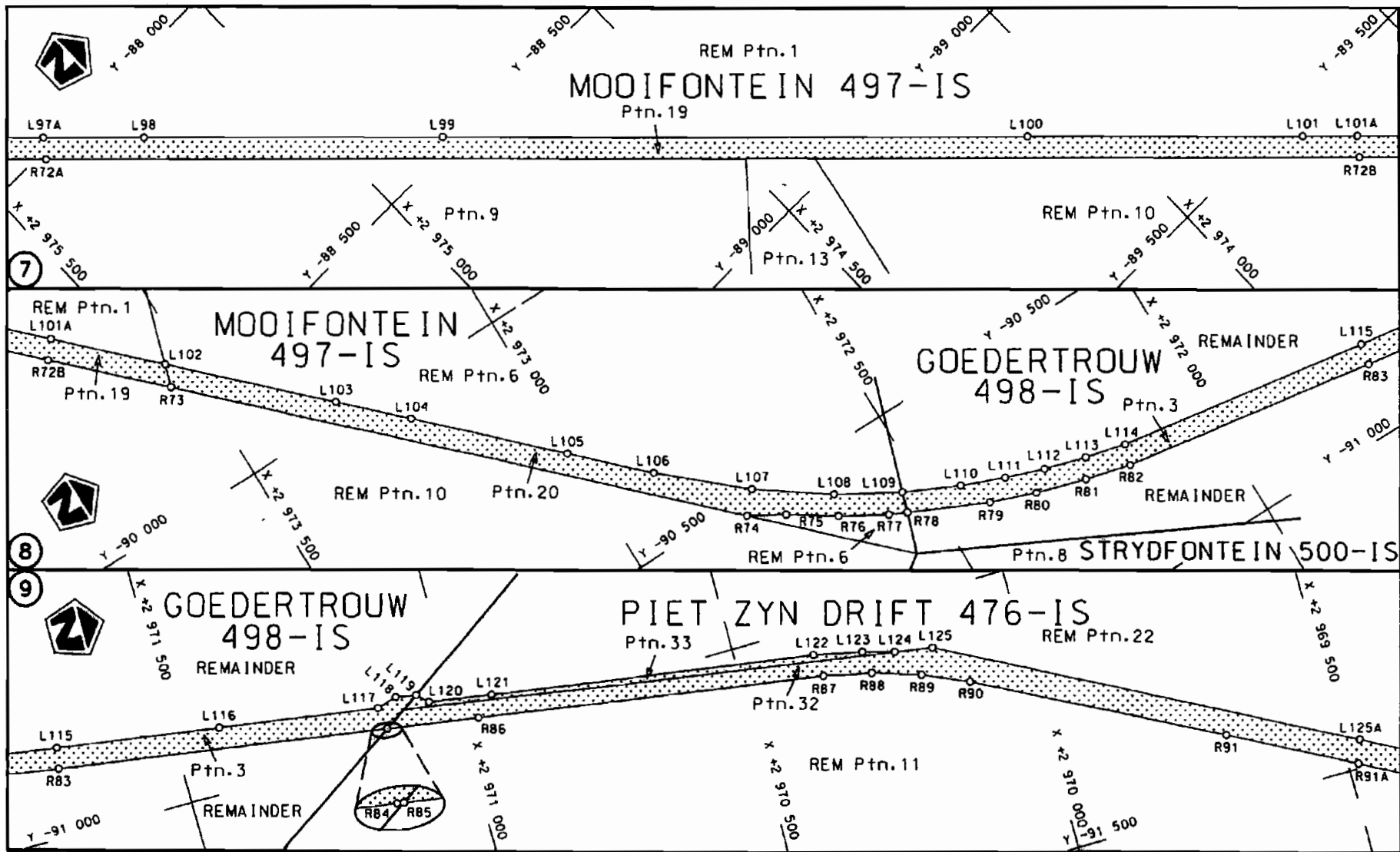

Die Suid Afrikaanse Nasionale Padagentskap Beperk	Die figuur getoon		steldie padreserwe voor van 'n gedeelte	Vel Sheet 3 van 7
The South African National Roads Agency Limited	The figure shown		represents the road reserve of a portion van Nasionale Roete N11	Seksie 6
				Plan P621/07

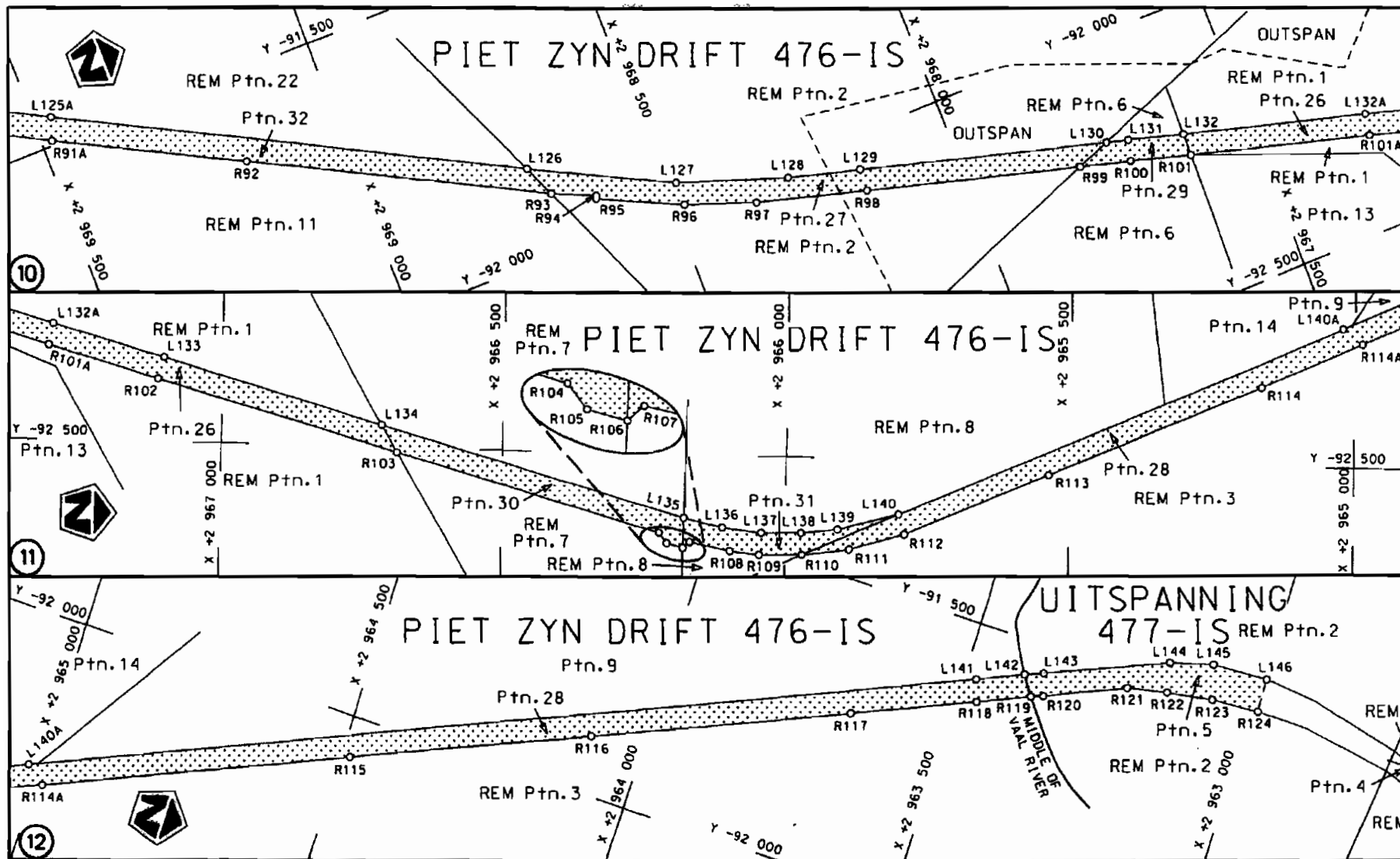

<p>Die Suid Afrikaanse Nasionale Padagentskap Beperk The South African National Roads Agency Limited</p>	<p>Die figuur getoon The figure shown</p>		<p>steldie padreserwe voor van 'n gedeelte represents the road reserve of a portion van Nasionale Roete N11 of National Route</p>	<p>Vel Sheet 4 van of 7</p>	<p>Plan P621/07</p>
			<p>Seksie Section 6</p>		

PADRESERWE KOÖRDINATE				/	ROAD RESERVE CO-ORDINATES			
LINKERKANT/LEFT HAND SIDE					REGTERKANT/RIGHT HAND SIDE			
	Y	X	WG	29°	Y	X		
L1	-86 244.340	2 988 209.140		R1	-86 290.500	2 988 193.650		
L2	-86 223.010	2 988 149.120		R2	-86 278.520	2 988 148.600		
L3	-86 201.850	2 988 057.980		R3	-86 249.050	2 988 039.000		
L4	-86 197.640	2 987 999.030		R4	-86 241.820	2 988 000.830		
L5	-86 196.320	2 987 978.290		R5	-86 226.880	2 987 918.380		
L6	-86 192.150	2 987 890.000		R6	-86 262.970	2 987 390.880		
L7	-86 223.800	2 987 406.680		R7	-86 270.360	2 987 284.010		
L8	-86 228.640	2 987 332.190		R8	-86 272.740	2 987 249.420		
L9	-86 233.380	2 987 260.810		R9	-86 283.890	2 987 096.280		
L10	-86 238.320	2 987 183.210		R10	-86 294.980	2 986 911.750		
L11	-86 241.300	2 987 131.770		R11	-86 293.680	2 986 834.770		
L12	-86 253.140	2 986 958.680		R12	-86 288.180	2 986 738.670		
L13	-86 249.560	2 986 734.710		R13	-86 288.020	2 986 736.850		
L14	-86 238.950	2 986 652.160		R14	-86 267.230	2 986 595.510		
L15	-86 219.430	2 986 551.140		R15	-86 232.150	2 986 446.720		
L16	-86 189.910	2 986 429.390		R16	-86 195.020	2 986 296.110		
L17	-86 155.360	2 986 286.460		R17	-86 174.700	2 986 221.940		
L18	-86 130.730	2 986 195.190		R18	-86 168.500	2 986 193.930		
L19	-86 120.850	2 986 159.170		R19	-86 128.260	2 986 036.770		
L20	-86 061.090	2 985 923.810		R20	-86 079.480	2 985 844.050		
L21	-86 032.960	2 985 885.300		R21	-86 046.170	2 985 712.440		
L22	-86 026.640	2 985 860.690		R22	-86 013.880	2 985 585.580		
L23	-86 032.990	2 985 812.440		R23	-86 013.570	2 985 584.320		
L24	-86 014.920	2 985 739.520		R24	-85 964.190	2 985 389.510		
L25	-85 974.340	2 985 580.040		R25	-85 940.570	2 985 297.430		
L26	-85 974.160	2 985 579.350		R26	-85 939.140	2 985 292.510		
L27	-85 948.190	2 985 471.900		R27	-85 938.700	2 985 290.550		
L28	-85 908.540	2 985 311.240		R28	-85 928.010	2 985 248.590		
L29	-85 861.290	2 985 131.070		R29	-85 921.520	2 985 223.190		
L30	-85 837.570	2 985 041.670		R30	-85 900.150	2 985 139.560		
L31	-85 836.350	2 985 036.700		R31	-85 867.710	2 985 008.120		
L32	-85 835.930	2 985 034.790		R32	-85 840.470	2 984 899.950		
L33	-85 824.850	2 984 989.880		R33	-85 792.090	2 984 707.810		
L34	-85 824.660	2 984 989.100		R34	-85 744.180	2 984 517.300		
L35	-85 794.620	2 984 871.190		R35	-85 740.130	2 984 501.230		
L36	-85 767.330	2 984 763.260		R36	-85 704.320	2 984 362.290		
L37	-85 738.910	2 984 650.370		R37	-85 666.200	2 984 211.500		
L38	-85 702.000	2 984 505.700		R38	-85 664.480	2 984 204.390		
L39	-85 701.540	2 984 503.870		R39	-85 609.380	2 983 987.770		
L40	-85 668.170	2 984 372.010		R40	-85 568.450	2 983 825.960		
L41	-85 633.250	2 984 235.060		R41	-85 528.780	2 983 669.440		
L42	-85 584.540	2 984 062.260		R42	-85 507.090	2 983 583.820		
L43	-85 475.580	2 983 614.630		R43	-85 485.650	2 983 499.180		
L44	-85 465.070	2 983 571.380		R44	-85 456.420	2 983 383.430		
L45	-85 397.010	2 983 302.490		R45	-85 324.590	2 982 864.980		
L46	-85 294.570	2 982 897.010		R46	-85 321.510	2 982 852.910		
L47	-85 254.410	2 982 738.670		R47	-85 194.590	2 982 349.270		
L48	-85 253.890	2 982 736.820		R48	-85 179.300	2 982 253.540		
L49	-85 251.570	2 982 727.050		R49	-85 179.290	2 982 253.330		
L50	-85 161.910	2 982 373.800		R50	-85 176.470	2 982 191.870		
L51	-85 145.130	2 982 283.660		R51	-85 178.840	2 982 131.040		

Vel 5 Van 7
Sheet of

P621/07

PADRESERWE KOÖRDINATE				/	ROAD RESERVE CO-ORDINATES			
LINKERKANT/LEFT HAND SIDE					REGTERKANT/RIGHT HAND SIDE			
	Y	X	WG	29°	Y	X		
L52	-85 140.610	2 982 234.680		R52	-85 184.520	2 982 080.060		
L53	-85 140.390	2 982 230.990		R53	-85 194.090	2 982 027.970		
L54	-85 140.250	2 982 224.110		R54	-85 331.630	2 981 486.220		
L55	-85 141.110	2 982 134.340		R55	-85 342.100	2 981 452.160		
L56	-85 141.070	2 982 132.560		R56	-85 361.710	2 981 396.210		
L57	-85 141.760	2 982 127.590		R57	-85 522.210	2 981 021.320		
L58	-85 146.170	2 982 083.720		R58	-85 772.070	2 980 437.690		
L59	-85 157.200	2 982 021.210		R59	-86 418.220	2 978 928.410		
L60	-85 208.130	2 981 817.410		R60	-86 534.610	2 978 656.540		
L61	-85 246.690	2 981 664.870		R61	-86 656.760	2 978 313.110		
L62	-85 285.680	2 981 510.640		R62	-86 841.240	2 977 794.400		
L63	-85 287.510	2 981 503.770		R63	-86 869.740	2 977 758.630		
L64	-85 314.460	2 981 417.200		R64	-86 878.120	2 977 734.850		
L65	-85 400.650	2 981 213.670		R65	-86 879.620	2 977 686.500		
L66	-85 401.100	2 981 211.630		R66	-87 439.560	2 976 112.110		
L67	-85 403.930	2 981 205.460		R67	-87 480.960	2 976 008.260		
L68	-85 490.680	2 981 002.110		R68	-87 541.280	2 975 898.330		
L69	-85 575.790	2 980 802.590		R69	-87 591.340	2 975 829.260		
L70	-85 733.480	2 980 431.360		R70	-87 672.530	2 975 738.890		
L71	-85 735.490	2 980 426.820		R71	-87 675.990	2 975 735.200		
L72	-85 737.780	2 980 421.500		R72	-87 801.440	2 975 606.490		
L73	-85 799.980	2 980 276.200		R73	-89 793.430	2 973 546.560		
L74	-85 903.610	2 980 034.770		R74	-90 523.600	2 972 791.490		
L75	-85 919.880	2 979 996.280		R75	-90 557.980	2 972 731.680		
L76	-86 096.710	2 979 583.530		R76	-90 609.810	2 972 653.000		
L77	-86 166.280	2 979 422.280		R77	-90 654.540	2 972 576.430		
L78	-86 235.740	2 979 259.360		R78	-90 668.610	2 972 546.380		
L79	-86 360.200	2 978 968.380		R79	-90 731.400	2 972 412.280		
L80	-86 368.190	2 978 926.590		R80	-90 760.930	2 972 332.680		
L81	-86 368.320	2 978 925.930		R81	-90 787.240	2 972 245.600		
L82	-86 372.930	2 978 902.570		R82	-90 806.730	2 972 165.790		
L83	-86 405.910	2 978 862.140		R83	-90 878.920	2 971 711.460		
L84	-86 499.940	2 978 642.290		R84	-90 969.020	2 971 128.800		
L85	-86 621.420	2 978 300.730		R85	-90 969.160	2 971 127.910		
L86	-86 656.250	2 978 202.810		R86	-90 993.810	2 970 967.540		
L87	-86 805.140	2 977 784.550		R87	-91 088.220	2 970 355.360		
L88	-87 075.080	2 977 025.200		R88	-91 106.460	2 970 271.770		
L89	-87 245.560	2 976 546.920		R89	-91 133.490	2 970 187.630		
L90	-87 400.770	2 976 110.410		R90	-91 168.150	2 970 108.310		
L91	-87 466.230	2 975 953.400		R91	-91 381.000	2 969 695.350		
L92	-87 525.510	2 975 855.250		R92	-91 650.950	2 969 174.120		
L93	-87 535.780	2 975 841.580		R93	-91 899.870	2 968 691.160		
L94	-87 571.080	2 975 794.520		R94	-91 931.850	2 968 618.850		
L95	-87 650.140	2 975 707.770		R95	-91 936.850	2 968 621.040		
L96	-87 771.210	2 975 582.840		R96	-92 002.910	2 968 479.670		
L97	-87 771.700	2 975 582.340		R97	-92 046.370	2 968 359.080		
L98	-88 106.950	2 975 236.460		R98	-92 099.320	2 968 169.750		
L99	-88 478.070	2 974 852.200		R99	-92 199.480	2 967 805.630		
L100	-89 201.950	2 974 104.290		R100	-92 223.540	2 967 718.160		
L101	-89 541.660	2 973 753.320		R101	-92 252.290	2 967 615.570		
L102	-89 753.290	2 973 534.360		R102	-92 391.020	2 967 113.930		

Vol 6 Van 7
Sheet of

P621/07

PADRESERWE KOÖRDINATE				ROAD RESERVE CO-ORDINATES			
LINKERKANT/LEFT HAND SIDE				REGTERKANT/RIGHT HAND SIDE			
	Y	X	WG	29°	Y	X	
L103	-89 971.220	2 973	308.880	R103	-92 508.990	2 966	686.460
L104	-90 065.600	2 973	210.760	R104	-92 637.460	2 966	222.640
L105	-90 263.750	2 973	005.650	R105	-92 655.230	2 966	208.370
L106	-90 372.890	2 972	892.880	R106	-92 662.190	2 966	179.940
L107	-90 488.780	2 972	759.390	R107	-92 651.850	2 966	168.000
L108	-90 573.460	2 972	639.710	R108	-92 665.930	2 966	096.810
L109	-90 633.930	2 972	535.030	R109	-92 670.810	2 966	044.500
L110	-90 678.600	2 972	441.210	R110	-92 669.800	2 965	969.680
L111	-90 709.160	2 972	365.940	R111	-92 658.780	2 965	885.720
L112	-90 732.950	2 972	298.040	R112	-92 630.680	2 965	789.100
L113	-90 754.050	2 972	225.570	R113	-92 522.430	2 965	536.820
L114	-90 771.260	2 972	154.790	R114	-92 362.510	2 965	165.410
L115	-90 842.530	2 971	704.790	R115	-92 069.220	2 964	484.920
L116	-90 886.510	2 971	417.550	R116	-91 900.290	2 964	092.160
L117	-90 929.850	2 971	134.370	R117	-91 718.400	2 963	669.930
L118	-90 920.030	2 971	098.970	R118	-91 630.070	2 963	465.500
L119	-90 926.420	2 971	063.340	R119	-91 592.128	2 963	377.687
L120	-90 943.840	2 971	044.360	R120	-91 584.130	2 963	357.420
L121	-90 961.240	2 970	933.860	R121	-91 524.960	2 963	221.910
L122	-91 048.600	2 970	363.080	R122	-91 510.460	2 963	152.310
L123	-91 066.890	2 970	277.780	R123	-91 498.270	2 963	073.410
L124	-91 082.640	2 970	222.710	R124	-91 492.320	2 962	991.880
L125	-91 093.160	2 970	156.550				
L126	-91 844.890	2 968	715.540				
L127	-91 962.230	2 968	479.180				
L128	-92 026.870	2 968	291.780				
L129	-92 060.920	2 968	167.880				
L130	-92 177.340	2 967	747.070				
L131	-92 187.860	2 967	709.040				
L132	-92 213.870	2 967	614.570				
L133	-92 354.310	2 967	104.420				
L134	-92 462.370	2 966	714.370				
L135	-92 610.390	2 966	179.160				
L136	-92 625.780	2 966	111.310				
L137	-92 633.240	2 966	041.630				
L138	-92 632.270	2 965	972.010				
L139	-92 624.540	2 965	906.760				
L140	-92 596.380	2 965	799.770				
L141	-91 593.300	2 963	478.570				
L142	-91 559.347	2 963	399.999				
L143	-91 546.810	2 963	369.220				
L144	-91 460.440	2 963	162.930				
L145	-91 440.280	2 963	089.660				
L146	-91 434.680	2 962	994.200				