

# Government Gazette Staatskoerant

REPUBLIC OF SOUTH AFRICA  
REPUBLIEK VAN SUID-AFRIKA

Vol. 512

Pretoria, 8 February 2008  
Februarie

No. 30744

**CONTENTS****INHOUD**

<i>No.</i>	<i>Page No.</i>	<i>Gazette No.</i>	<i>No.</i>	<i>Bladsy No.</i>	<i>Koerant No.</i>
<b>GOVERNMENT NOTICE</b>			<b>GOEWERMENSKENNISGEWING</b>		
<b>Transport, Department of</b>			<b>Vervoer, Departement van</b>		
<i>Government Notice</i>			<i>Goewermentskennisgewing</i>		
142			142		
South African National Roads Agency and National Roads Act (7/1998): The South African National Roads Agency Limited: Declaration amendment of National Road P720: Amendment of Declaration No. 1353 of 2003 .....			Suid-Afrikaanse Nasionale Padagentskap Beperk en Nasionale Paaie Wet (7/1998): Die Suid-Afrikaanse Nasionale Padagentskap Beperk: Verklaring wysiging van Nasionale Pad P720: Wysiging van Verklaring No. 1353 van 2003.....		
	3	30744		4	30744

---

GOVERNMENT NOTICE  
GOEWERMENTSKENNISGEWING

---

DEPARTMENT OF TRANSPORT  
DEPARTEMENT VAN VERVOER

No. 142

8 February 2008

THE SOUTH AFRICAN NATIONAL ROADS  
AGENCY LIMITED

Registration No: 98/09584/06

DECLARATION AMENDMENT OF NATIONAL ROAD P720

AMENDMENT OF DECLARATION NO. 1353 OF 2003

By virtue of Section 40(1)(b) of the South African National Roads Agency Limited and National Roads Act, 1998 (Act No. 7 of 1998), I hereby amend Declaration No. 1353 of 2003, by substituting it with the subjoined sheets 1 to 5 of Plan No. P632/07.

**[National Road P720: N2 – Golela {Swaziland Border} (10km)]**

  
\_\_\_\_\_  
MINISTER OF TRANSPORT

No. 145

8 Februarie 2008

**DIE SUID-AFRIKAANSE NASIONALE  
PADAGENTSKAP BEPERK**

Registrasie No: 98/09584/06

**VERKLARING WYSIGING VAN NASIONALE PAD P720**

WYSIGING VAN VERKLARING NO. 1353 VAN 2003.

Kragtens Artikel 40 (1)(b) van die Suid-Afrikaanse Nasionale Padagentskap Beperk en Nasionale Paaie Wet (Wet No. 7 van 1998), wysig ek hiermee Verklaring no. 1353 van 2003, deur dit te vervang met meegaande velle 1 tot 5 van Plan no.P632/07.

**[Nasionale Pad P720: N2 – Golela {Swaziland Grens} (10km)]**

---

MINISTER VAN VERVOER

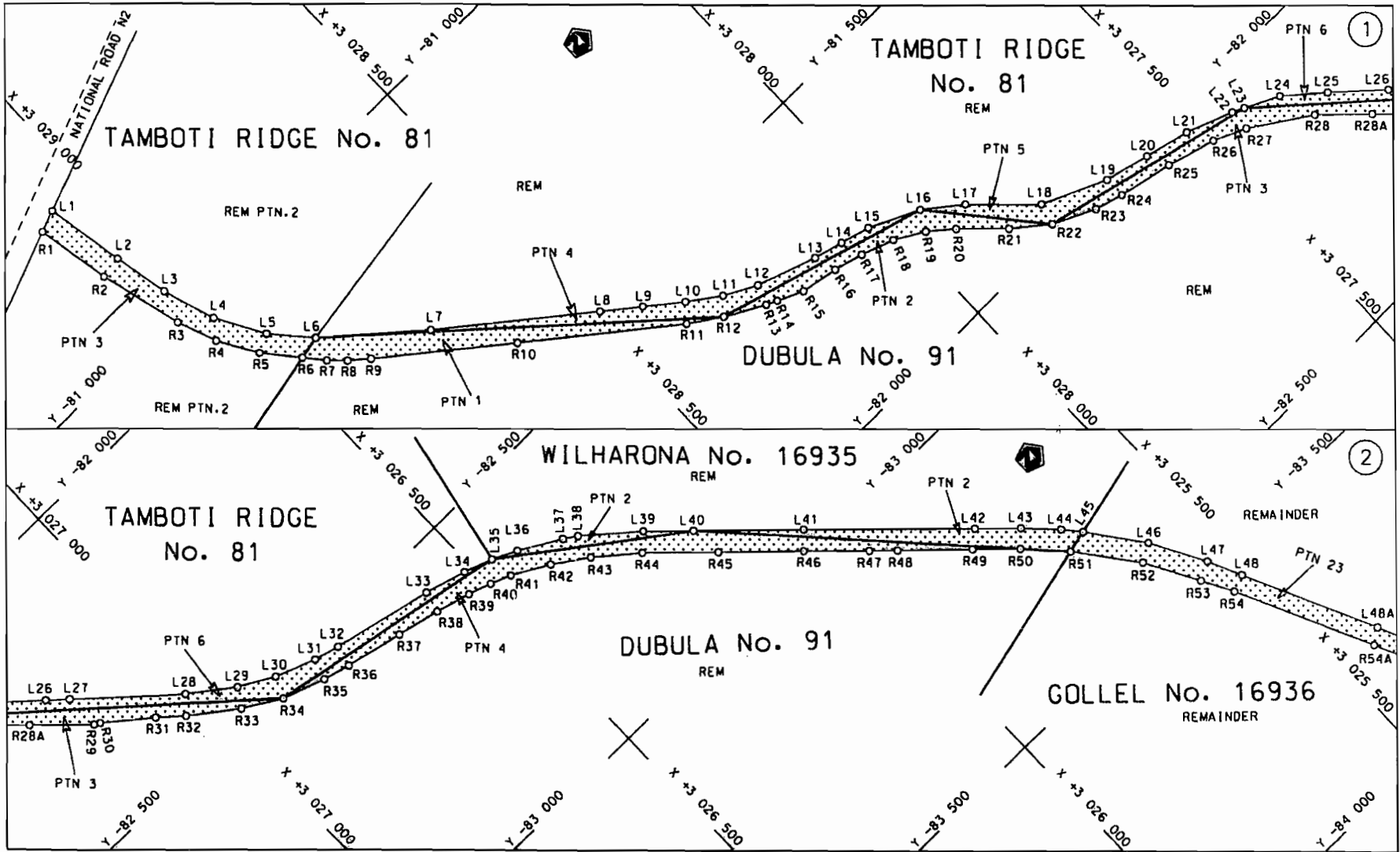

<p>Die Suid Afrikaanse Nasionale Padagentskap Beperk The South African National Roads Agency Limited</p>	<p>Die figuur getoon The figure shown</p>		<p>steldie padreserwe voor van 'n gedeelte represents the road reserve of a portion van Nasionale Roete P720 Seksie of National Route P720 Section</p>	<p>Vel Sheet 1 van of 5</p>
				<p>Plan P632/07</p>

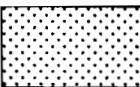
D.O.9.A

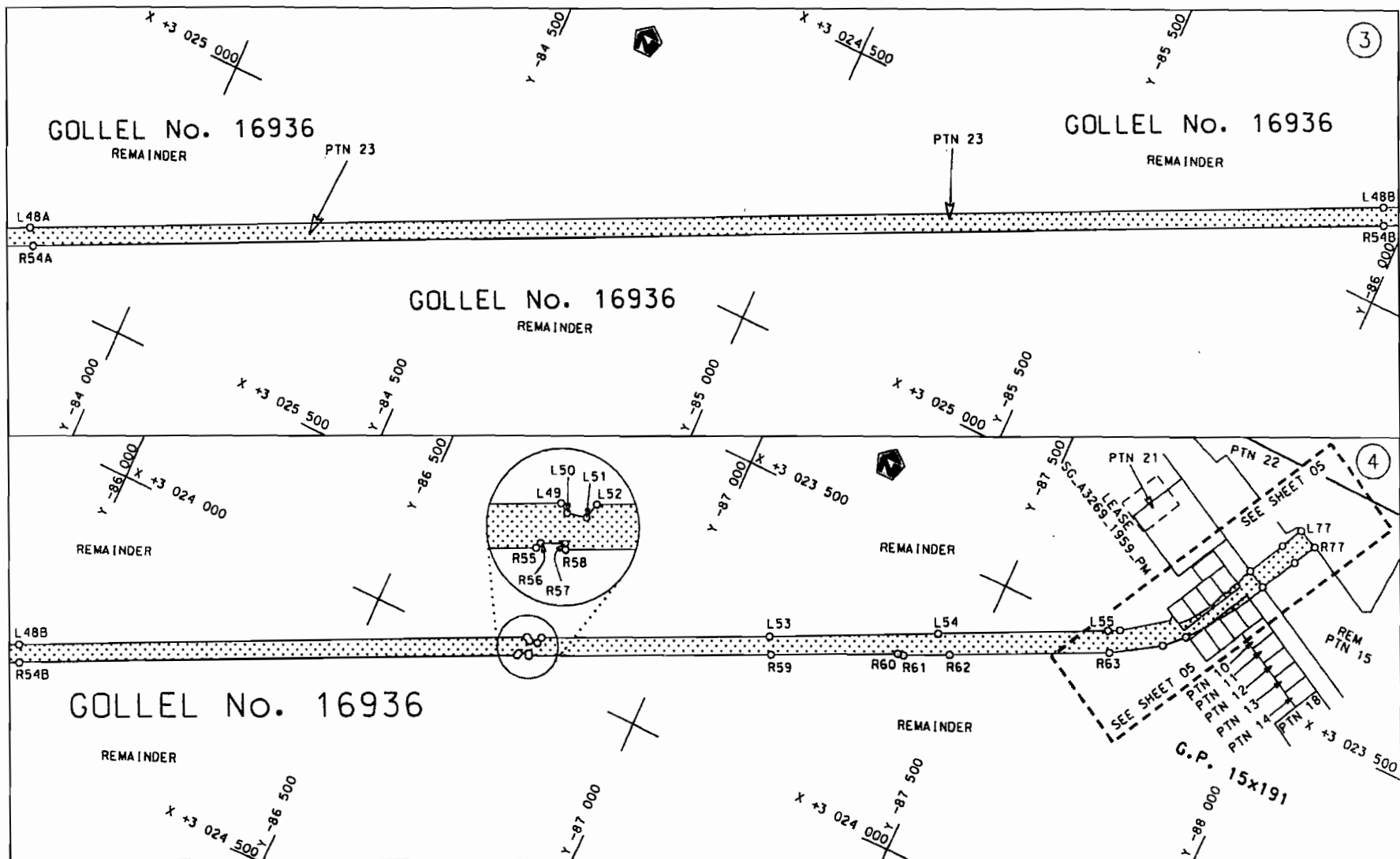

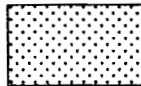
<p>Die Suid Afrikaanse Nasionale Padagentskop Beperk The South African National Roads Agency Limited</p>	<p>Die figuur getoon The figure shown</p> 	<p>steldie padreserwe voor van 'n gedeelte represents the road reserve of a portion van Nasionale Roete P720 Sektie of National Route P720 Section</p>	<p>Vel Sheet 2 van of 5 Plan P632/07</p>
--	--	--	--

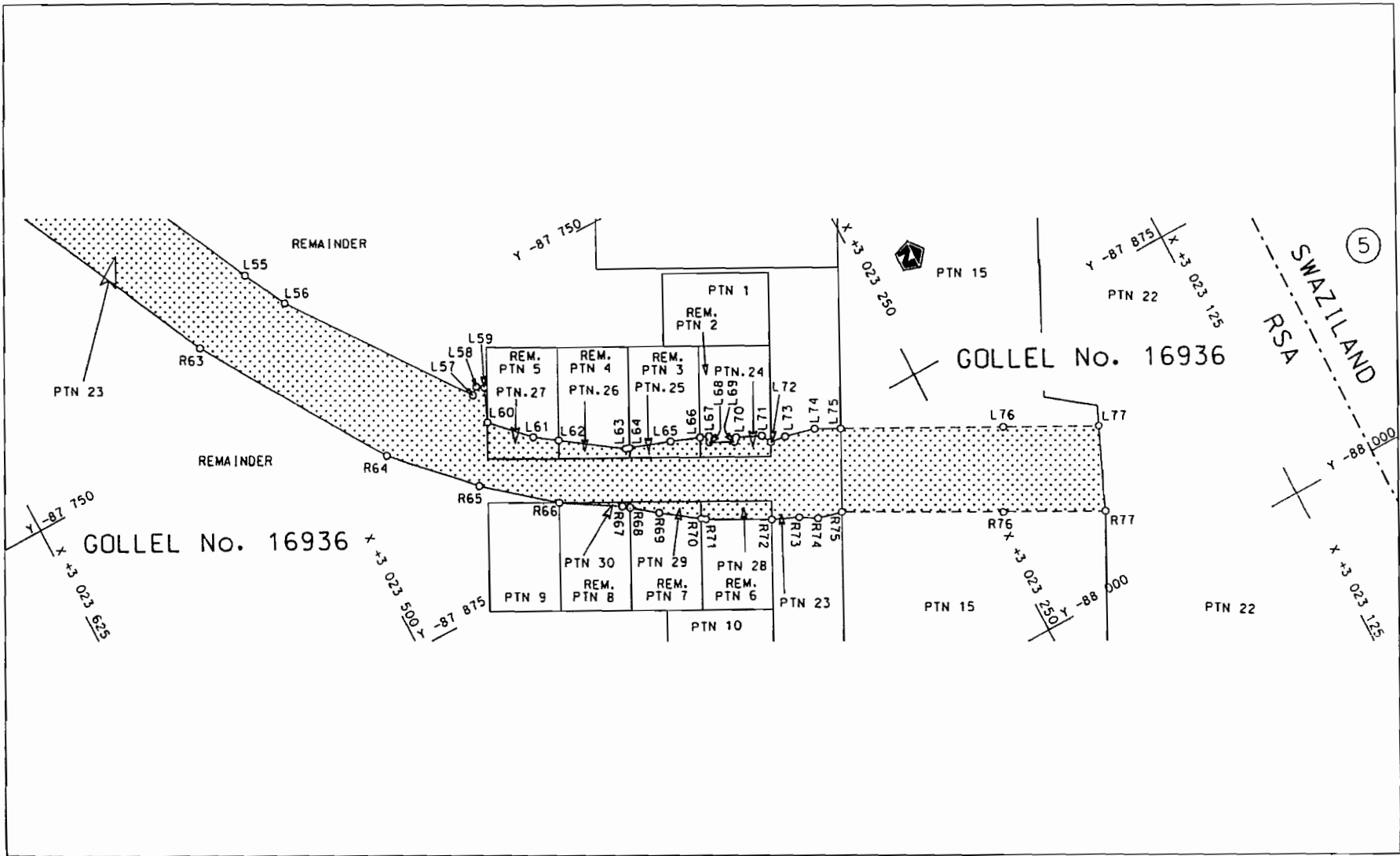

Die Suid Afrikaanse Nasionale Padagentskap Beperk  
 The South African National Roads Agency Limited

Die figuur getoon  
 The figure shown

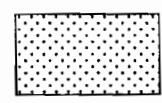

steldie padreserwe voor van 'n gedeelte  
 represents the road reserve of a portion  
 van Nasionale Roete P720 Sektie  
 of National Route P720 Section

Vel Sheet 3 van of 5  
 Plan P632/07

D.O.9.A

PADRESERWE KOÖRDINATE				/	ROAD RESERVE CO-ORDINATES			
LINKERKANT/LEFT HAND SIDE					REGTERKANT/RIGHT HAND SIDE			
	Y	X	WG	31°	Y	X		
L1	-80 727.454	3 029 070.398		R1	-80 741.238	3 029 107.917		
L2	-80 866.518	3 029 044.322		R2	-80 872.075	3 029 083.384		
L3	-80 964.552	3 029 023.406		R3	-81 019.183	3 029 042.753		
L4	-81 058.363	3 028 990.449		R4	-81 089.026	3 029 014.372		
L5	-81 144.462	3 028 940.330		R5	-81 159.375	3 028 971.733		
L6	-81 210.110	3 028 882.210		R6	-81 217.980	3 028 922.761		
L7	-81 342.752	3 028 725.305		R7	-81 251.477	3 028 894.770		
L8	-81 529.722	3 028 484.848		R8	-81 277.386	3 028 868.348		
L9	-81 576.966	3 028 423.881		R9	-81 304.152	3 028 835.920		
L10	-81 624.211	3 028 362.914		R10	-81 465.913	3 028 627.788		
L11	-81 663.490	3 028 307.033		R11	-81 652.615	3 028 387.430		
L12	-81 694.145	3 028 250.431		R12	-81 690.398	3 028 331.079		
L13	-81 731.533	3 028 144.236		R13	-81 727.998	3 028 263.125		
L14	-81 745.964	3 028 091.905		R14	-81 736.803	3 028 244.147		
L15	-81 760.396	3 028 039.573		R15	-81 757.840	3 028 198.654		
L16	-81 802.644	3 027 951.813		R16	-81 771.222	3 028 132.236		
L17	-81 851.533	3 027 887.609		R17	-81 785.367	3 028 080.207		
L18	-81 946.077	3 027 789.740		R18	-81 806.358	3 028 021.756		
L19	-81 996.221	3 027 676.662		R19	-81 835.932	3 027 970.256		
L20	-82 016.105	3 027 596.933		R20	-81 870.091	3 027 928.565		
L21	-82 035.989	3 027 517.203		R21	-81 935.475	3 027 860.211		
L22	-82 067.636	3 027 434.489		R22	-81 983.505	3 027 799.269		
L23	-82 077.524	3 027 414.139		R23	-82 018.950	3 027 725.758		
L24	-82 106.024	3 027 354.310		R24	-82 033.618	3 027 675.815		
L25	-82 161.150	3 027 288.074		R25	-82 054.480	3 027 579.592		
L26	-82 232.843	3 027 206.807		R26	-82 079.255	3 027 492.858		
L27	-82 260.996	3 027 175.017		R27	-82 105.311	3 027 436.127		
L28	-82 397.519	3 027 020.133		R28	-82 173.149	3 027 331.535		
L29	-82 454.776	3 026 944.061		R29	-82 322.079	3 027 173.651		
L30	-82 488.720	3 026 881.601		R30	-82 327.602	3 027 164.144		
L31	-82 516.593	3 026 810.639		R31	-82 389.180	3 027 086.169		
L32	-82 529.025	3 026 765.905		R32	-82 425.239	3 027 045.166		
L33	-82 571.365	3 026 588.325		R33	-82 485.997	3 026 964.208		
L34	-82 592.719	3 026 514.838		R34	-82 525.233	3 026 898.068		
L35	-82 610.772	3 026 463.550		R35	-82 552.110	3 026 822.331		
L36	-82 631.677	3 026 419.660		R36	-82 565.577	3 026 774.591		
L37	-82 672.986	3 026 346.407		R37	-82 589.696	3 026 672.519		
L38	-82 687.962	3 026 323.763		R38	-82 607.738	3 026 596.741		
L39	-82 762.658	3 026 233.915		R39	-82 625.566	3 026 535.392		
L40	-82 824.431	3 026 168.073		R40	-82 639.768	3 026 494.920		
L41	-82 958.732	3 026 024.994		R41	-82 654.987	3 026 458.359		
L42	-83 168.306	3 025 803.344		R42	-82 690.009	3 026 393.163		
L43	-83 224.570	3 025 743.231		R43	-82 730.259	3 026 332.972		
L44	-83 275.549	3 025 693.402		R44	-82 788.334	3 026 261.285		
L45	-83 305.403	3 025 667.973		R45	-82 881.833	3 026 161.687		
L46	-83 399.020	3 025 597.570		R46	-82 985.611	3 026 050.993		
L47	-83 494.810	3 025 543.940		R47	-83 066.159	3 025 965.798		
L48	-83 554.390	3 025 515.960		R48	-83 100.754	3 025 928.918		
L49	-86 766.280	3 023 946.040		R49	-83 190.712	3 025 831.257		
L50	-86 772.930	3 023 950.210		R50	-83 249.660	3 025 768.734		
L51	-86 787.040	3 023 947.120		R51	-83 314.489	3 025 707.851		

Vel	4	Van	5	P632/07
Sheet		of		



PADRESERWE KOÖRDINATE				/	ROAD RESERVE CO-ORDINATES			
LINKERKANT/LEFT HAND SIDE					REGTERKANT/RIGHT HAND SIDE			
	Y	X	WG 31°		Y	X		
L52	-86 789.950	3 023	935.760	R52	-83 417.080	3 025	628.580	
L53	-87 157.370	3 023	759.100	R53	-83 510.690	3 025	575.670	
L54	-87 426.018	3 023	626.194	R54	-83 564.680	3 025	545.140	
L55	-87 696.870	3 023	492.110	R55	-86 763.130	3 023	981.940	
L56	-87 715.970	3 023	482.110	R56	-86 764.600	3 023	977.390	
L57	-87 790.430	3 023	427.220	R57	-86 780.560	3 023	970.080	
L58	-87 787.880	3 023	424.110	R58	-86 782.810	3 023	974.070	
L59	-87 789.980	3 023	421.110	R59	-87 172.610	3 023	786.050	
L60	-87 803.630	3 023	427.010	R60	-87 375.470	3 023	688.100	
L61	-87 818.580	3 023	412.110	R61	-87 385.870	3 023	686.100	
L62	-87 825.160	3 023	402.750	R62	-87 459.340	3 023	650.080	
L63	-87 842.470	3 023	378.110	R63	-87 715.090	3 023	525.070	
L64	-87 843.010	3 023	376.570	R64	-87 795.200	3 023	473.110	
L65	-87 849.080	3 023	359.110	R65	-87 825.780	3 023	443.110	
L66	-87 853.750	3 023	346.670	R66	-87 848.840	3 023	415.150	
L67	-87 855.140	3 023	342.970	R67	-87 863.480	3 023	391.110	
L68	-87 857.580	3 023	344.110	R68	-87 865.590	3 023	388.390	
L69	-87 862.680	3 023	334.110	R69	-87 873.580	3 023	378.110	
L70	-87 861.280	3 023	332.510	R70	-87 884.630	3 023	362.830	
L71	-87 866.080	3 023	322.110	R71	-87 885.880	3 023	361.110	
L72	-87 870.410	3 023	319.860	R72	-87 899.910	3 023	335.310	
L73	-87 871.280	3 023	313.110	R73	-87 904.780	3 023	324.110	
L74	-87 874.480	3 023	300.110	R74	-87 909.080	3 023	317.110	
L75	-87 879.870	3 023	289.820	R75	-87 911.660	3 023	306.440	
L76	-87 913.360	3 023	225.980	R76	-87 945.330	3 023	243.370	
L77	-87 933.071	3 023	188.406	R77	-87 966.787	3 023	203.177	

Vel	5	Van	5	P632/07
Sheet		of		