

Government Gazette Staatskoerant

REPUBLIC OF SOUTH AFRICA
REPUBLIEK VAN SUID-AFRIKA

Vol. 512

Pretoria, 8 February 2008
Februarie

No. 30746

CONTENTS**INHOUD**

<i>No.</i>	<i>Page No.</i>	<i>Gazette No.</i>	<i>No.</i>	<i>Bladsy No.</i>	<i>Koerant No.</i>
GOVERNMENT NOTICE			GOEWERMENSKENNISGEWING		
Transport, Department of			Vervoer, Departement van		
<i>Government Notice</i>			<i>Goewermentskennisgewing</i>		
144			144		
South African National Roads Agency Limited and the National Roads Act (7/1998): The South African National Roads Agency Limited: Declaration Amendment of National Road N4 Section 5: Amendment of Declaration No. 186 of 1987	3	30746	Suid-Afrikaanse Nasionale Padagentskap Beperk en die Nasionale Paaie Wet (7/1998): Die Suid-Afrikaanse Nasionale Padagentskap Beperk: Verklaring Wysiging van Nasionale Pad N4 Seksie 5: Wysiging van Verklaring No. 186 van 1987	4	30746

**GOVERNMENT NOTICE
GOEWERMENTSKENNISGEWING**

**DEPARTMENT OF TRANSPORT
DEPARTEMENT VAN VERVOER**

No. 144

8 February 2008

**THE SOUTH AFRICAN NATIONAL ROADS
AGENCY LIMITED**

Registration No: 98/09584/06

DECLARATION AMENDMENT OF NATIONAL ROAD N4 SECTION 5

AMENDMENT OF DECLARATION NO. 186 OF 1987.

By virtue of section 40 (1)(b) of the South African National Roads Agency Limited and the National Roads Act, 1998 (Act No. 7 of 1998), I hereby amend Declaration No. 186 of 1987, the section from the common boundary between farms Kleinfontein 432 – JS and Leeuwfontein 431 – JS on sheet 2 up to points L110 and R110 on sheet 2 of Plan No. P358/86 and the applicable co-ordinates, with the subjoined sheets 1 to 5 of Plan No.P634/07.

(National Road N4 Section 5: Leeuwfontein – Wonderfontein)



MINISTER OF TRANSPORT

No. 144

8 Februarie 2008

**DIE SUID-AFRIKAANSE NASIONALE
PADAGENTSKAP BEPERK**

Registrasie No: 98/09584/06

VERKLARING WYSIGING VAN NASIONALE PAD N4 SEKSIE 5

WYSIGING VAN VERKLARING NO. 186 VAN 1987.

Kragtens Artikel 40(1)(b) van die Suid-Afrikaanse Nasionale Padagentskap Beperk en die Nasionale Paaie Wet, 1998 (Wet No.7 van 1998), wysig ek hiermee Verklaring no. 186 van 1987, deur die gedeelte vanaf die gemeenskaplike grens tussen plase Kleinfoein 432 – JS en Leeuwofontein 431 – JS op vel 2 tot by punte L110 en R110 op vel 2 van Plan no. P358/86 en die toepaslike koördinate, te vervang met meegaande velle 1 tot 5 van Plan no. P634/07.

(Nasionale Pad N4 Seksie 5: Leeuwofontein – Wonderfontein)**MINISTER VAN VERVOER**

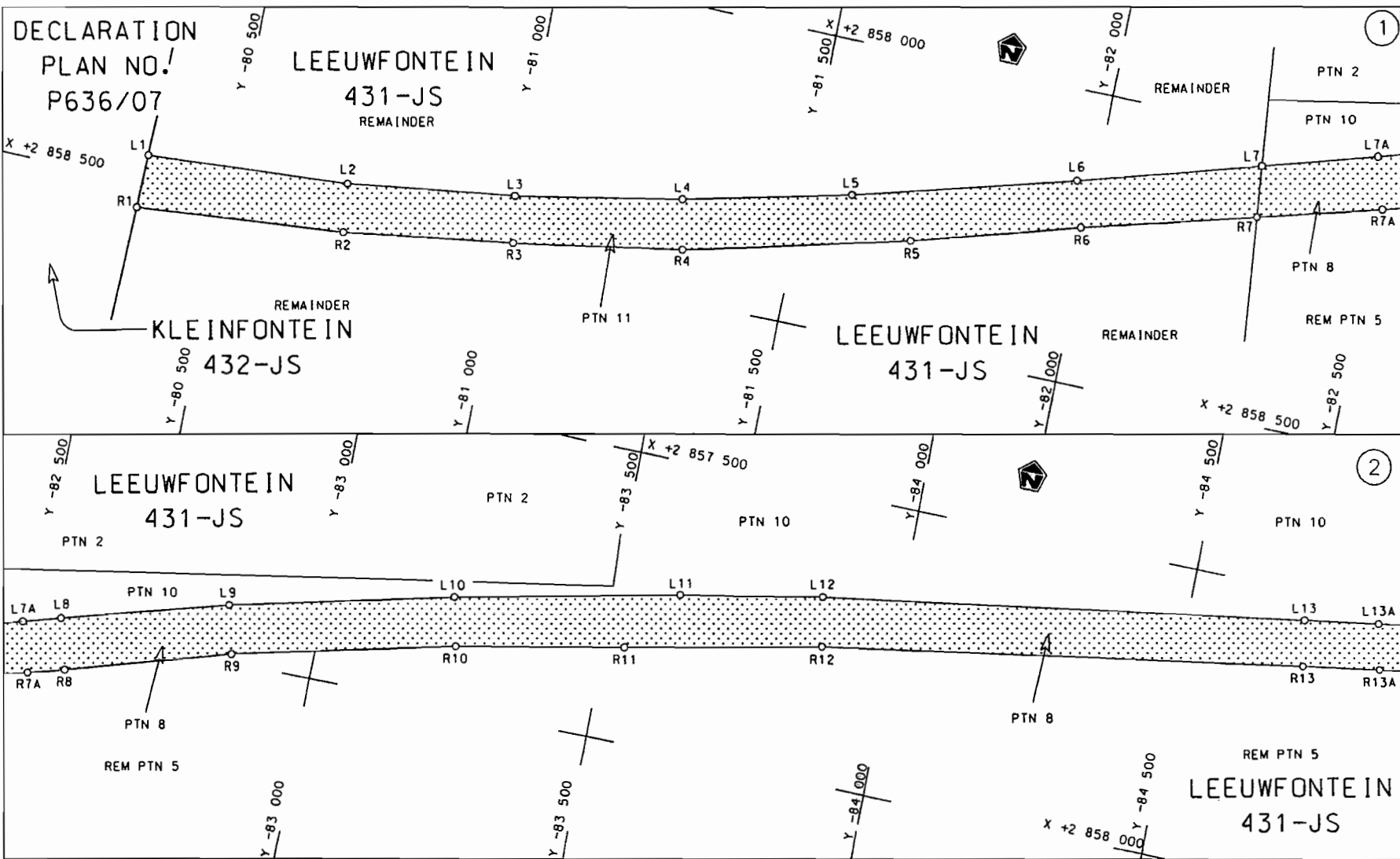

Die Suid Afrikaanse Nasionale Padagentskap Beperk
 The South African National Roads Agency Limited

Die figuur getoon
 The figure shown

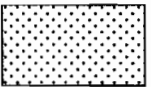

steldie padreserwe voor van 'n gedeelte
 represents the road reserve of a portion
 van Nasionale Roete N4 Seksie 5
 of National Route N4 Section 5

Vel 1 van 5
 Sheet 1 of 5
 Plan P634/07

D.O.9.A

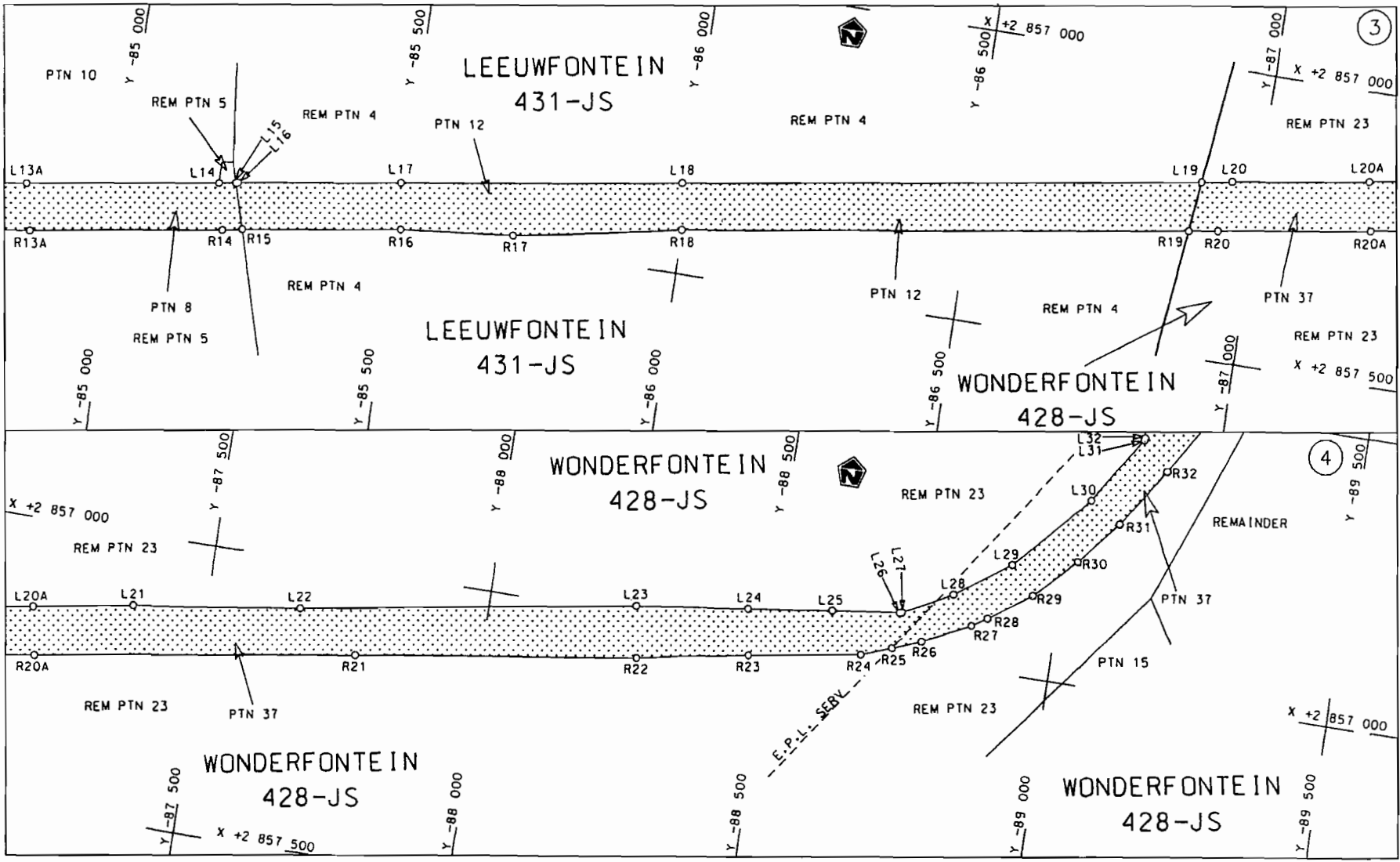

<p>Die Suid Afrikaanse Nasionale Padagentskap Beperk The South African National Roads Agency Limited</p>	<p>Die figuur getoon The figure shown</p> 	<p>steldie padreserwe voor van 'n gedeelte represents the road reserve of a portion van Nasionale Roete N4 of National Route N4</p> <p>Seksie 5 Section 5</p>	<p>Vel Sheet 2 van 5 of Plan P634/07</p>
--	--	---	--

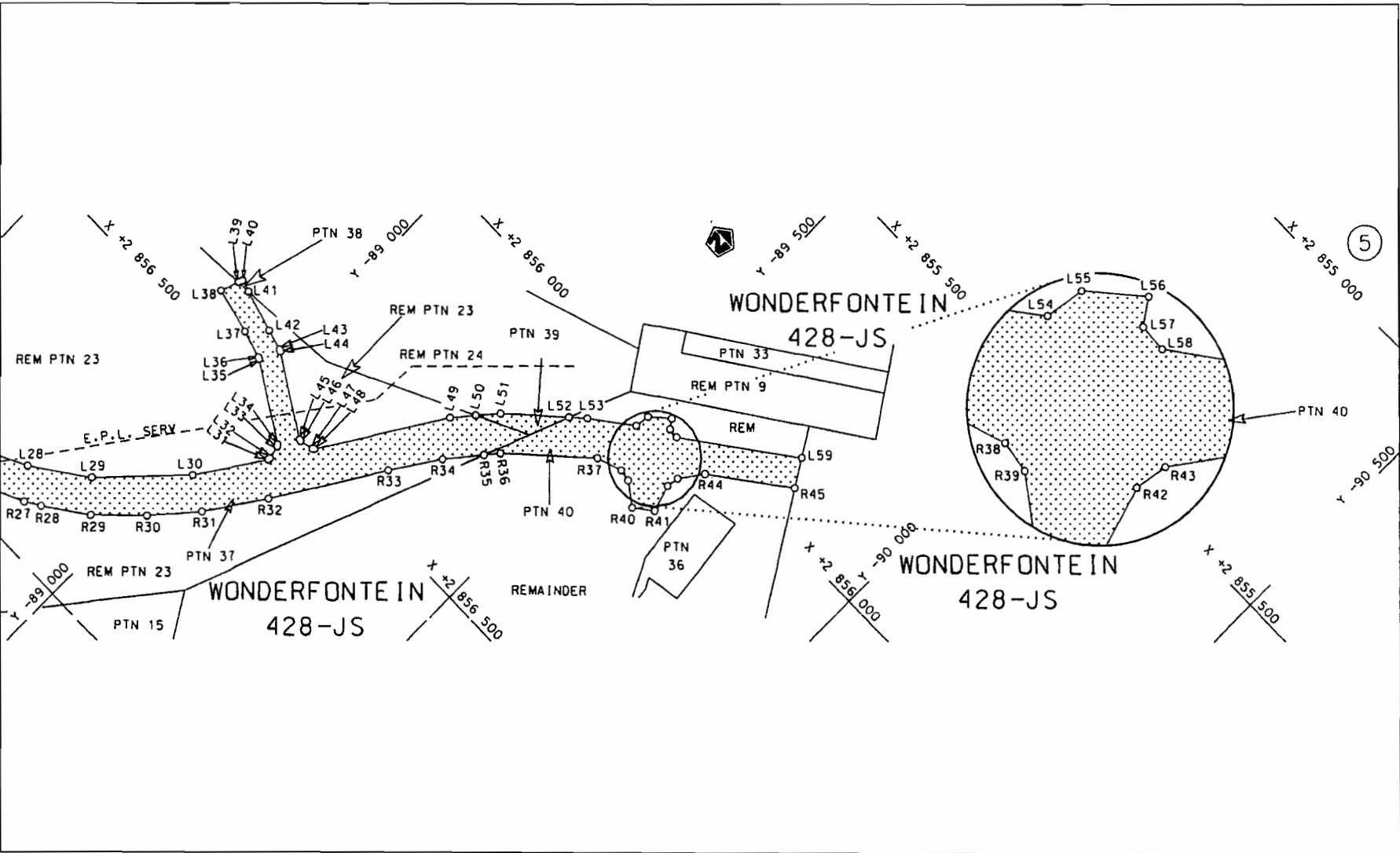

Die Suid Afrikaanse Nasionale Padagentskap Beperk
The South African National Roads Agency Limited

Die figuur getoon
The figure shown

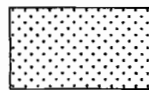

steldie padreserve voor van 'n gedeelte
represents the road reserve of a portion
van Nasionale Roete N4 Seksie 5
of National Route Section

Vel Sheet	3 of 5
Plan	P634/07

D.O.9.A

PADRESERWE KOÖRDINATE				/	ROAD RESERVE CO-ORDINATES			
LINKERKANT/LEFT HAND SIDE					REGTERKANT/RIGHT HAND SIDE			
	Y	X	WG	29°	Y	X		
L1	-80 347.73	2 858 453.13		R1	-80 345.43	2 858 543.78		
L2	-80 704.96	2 858 426.74		R2	-80 714.35	2 858 509.24		
L3	-80 999.96	2 858 385.89		R3	-81 013.03	2 858 464.78		
L4	-81 292.75	2 858 329.17		R4	-81 310.56	2 858 413.47		
L5	-81 582.39	2 858 260.37		R5	-81 700.78	2 858 314.74		
L6	-81 966.67	2 858 153.73		R6	-81 989.54	2 858 230.39		
L7	-82 282.27	2 858 061.19		R7	-82 291.04	2 858 148.30		
L8	-82 544.16	2 857 985.32		R8	-82 568.18	2 858 072.21		
L9	-82 833.73	2 857 903.83		R9	-82 854.70	2 857 986.05		
L10	-83 223.88	2 857 810.07		R10	-83 242.64	2 857 892.82		
L11	-83 616.19	2 857 725.80		R11	-83 536.00	2 857 834.55		
L12	-83 862.66	2 857 678.95		R12	-83 877.74	2 857 763.50		
L13	-84 703.40	2 857 548.79		R13	-84 715.76	2 857 627.54		
L14	-85 170.21	2 857 475.12		R14	-85 187.48	2 857 553.36		
L15	-85 199.97	2 857 470.59		R15	-85 222.24	2 857 547.29		
L16	-85 203.69	2 857 469.99		R16	-85 505.52	2 857 503.42		
L17	-85 494.09	2 857 424.94		R17	-85 704.62	2 857 482.00		
L18	-85 988.48	2 857 346.43		R18	-85 999.40	2 857 425.75		
L19	-86 897.46	2 857 200.02		R19	-86 887.40	2 857 285.94		
L20	-86 950.83	2 857 191.42		R20	-86 938.22	2 857 277.94		
L21	-87 369.17	2 857 124.08		R21	-87 777.48	2 857 145.84		
L22	-87 666.36	2 857 082.18		R22	-88 272.30	2 857 072.96		
L23	-88 258.24	2 856 984.13		R23	-88 469.08	2 857 037.06		
L24	-88 456.50	2 856 957.69		R24	-88 666.55	2 857 005.85		
L25	-88 605.30	2 856 938.34		R25	-88 718.62	2 856 985.71		
L26	-88 723.32	2 856 922.70		R26	-88 768.41	2 856 965.76		
L27	-88 727.06	2 856 921.37		R27	-88 852.68	2 856 925.76		
L28	-88 812.96	2 856 877.45		R28	-88 879.07	2 856 909.09		
L29	-88 907.93	2 856 811.06		R29	-88 952.15	2 856 857.60		
L30	-89 029.75	2 856 680.23		R30	-89 022.32	2 856 787.52		
L31	-89 107.16	2 856 564.17		R31	-89 085.74	2 856 712.48		
L32	-89 107.85	2 856 560.55		R32	-89 155.41	2 856 611.26		
L33	-89 102.32	2 856 536.99		R33	-89 270.33	2 856 425.26		
L34	-89 100.06	2 856 533.90		R34	-89 323.24	2 856 343.12		
L35	-88 971.92	2 856 454.19		R35	-89 369.73	2 856 285.05		
L36	-88 968.25	2 856 452.57		R36	-89 387.87	2 856 262.39		
L37	-88 919.44	2 856 438.62		R37	-89 514.08	2 856 145.04		
L38	-88 837.54	2 856 420.14		R38	-89 558.44	2 856 130.04		
L39	-88 850.43	2 856 387.73		R39	-89 579.10	2 856 133.27		
L40	-88 853.58	2 856 379.81		R40	-89 616.96	2 856 161.08		
L41	-88 875.16	2 856 385.77		R41	-89 648.87	2 856 136.73		
L42	-88 948.96	2 856 406.14		R42	-89 634.92	2 856 090.91		
L43	-88 985.22	2 856 416.03		R43	-89 638.25	2 856 069.56		
L44	-88 988.86	2 856 417.66		R44	-89 666.48	2 856 029.29		
L45	-89 121.40	2 856 499.92		R45	-89 794.97	2 855 931.85		
L46	-89 124.93	2 856 500.59						
L47	-89 148.76	2 856 494.95						
L48	-89 151.67	2 856 492.89						
L49	-89 281.94	2 856 283.45						
L50	-89 311.39	2 856 247.82						
L51	-89 339.36	2 856 213.97						

Vel 4
Sheet

Van 5
of

P634/07

PADRESERWE KOÖRDINATE				/		ROAD RESERVE CO-ORDINATES	
LINKERKANT/LEFT HAND SIDE				REGTERKANT/RIGHT HAND SIDE			
	Y	X	WG 29°	Y	X		
L52	-89 428.97	2 856	131.81				
L53	-89 453.04	2 856	109.75				
L54	-89 522.00	2 856	056.97				
L55	-89 525.96	2 856	031.25				
L56	-89 557.44	2 856	004.20				
L57	-89 568.21	2 856	019.51				
L58	-89 585.93	2 856	020.72				
L59	-89 766.94	2 855	887.02				

Vel	5	Van	5	P634/07
Sheet		of		