

# Government Gazette Staatskoerant

REPUBLIC OF SOUTH AFRICA  
REPUBLIEK VAN SUID-AFRIKA

Vol. 512

Pretoria, 8 February 2008  
Februarie

**No. 30747**

**CONTENTS****INHOUD**

<i>No.</i>	<i>Page No.</i>	<i>Gazette No.</i>	<i>No.</i>	<i>Bladsy No.</i>	<i>Koerant No.</i>
<b>GOVERNMENT NOTICE</b>			<b>GOEWERMENTSKENNISGEWING</b>		
<b>Transport, Department of</b>			<b>Vervoer, Departement van</b>		
<i>Government Notice</i>			<i>Goewermentskennisgewing</i>		
145			145		
South African National Roads Agency Limited and the National Roads Act (7/1998): The South African National Roads Agency Limited: Declaration Amendment of National Road N4 Section 4: Amendment of Declaration No.'s 190 of 1985, 296 of 1972, 358 of 1977, 160 of 1986 and 186 of 1987.....			Suid-Afrikaanse Nasionale Padagentskap Beperk en die Nasionale Paaie Wet (7/1998): Die Suid-Afrikaanse Nasionale Padagentskap Beperk: Verklaring Wysiging van Nasionale Pad N4 Seksie 4: Wysiging van Verklaring No.'s 190 van 1985, 296 van 1972, 358 van 1977, 160 van 1986 en 186 van 1987 .....		
	3	30747		4	30747

GOVERNMENT NOTICE  
GOEWERMENTSKENNISGEWING

DEPARTMENT OF TRANSPORT  
DEPARTEMENT VAN VERVOER

No. 145

8 February 2008

THE SOUTH AFRICAN NATIONAL ROADS  
AGENCY LIMITED

Registration No: 98/09584/06

## DECLARATION AMENDMENT OF NATIONAL ROAD N4 SECTION 4

AMENDMENT OF DECLARATION NO'S. 190 OF 1985, 296 OF 1972, 358 OF 1977, 160 OF 1986 AND  
186 OF 1987.

By virtue of section 40 (1)(b) of the South African National Roads Agency Limited and the National Roads Act, 1998 (Act No. 7 of 1998), I hereby amend the following declarations by substituting **(I)** Declaration No. 190 of 1985, the section from the common boundary between farms Rhenosterfontein 318 – JS and Rietfontein 314 – JS on sheet 7 up to sheet 8 of Plan No. P341/84 and the applicable co-ordinates, **(II)** Declaration No. 296 of 1972, **(III)** Declaration No. 358 of 1977, **(IV)** Declaration No. 160 of 1986 and **(V)** Declaration No. 186 of 1987, the section from sheet 1 up to the common boundary between farms Kleinfontein 432 – JS and Leeuwfontein 431 – JS on sheet 2 of Plan No. P358/86 and the applicable co-ordinates, with the subjoined sheets 1 to 15 of Plan no.P636/07.

**(National Road N4 Section 4: Rhenosterfontein – Leeuwfontein)**

  
\_\_\_\_\_  
MINISTER OF TRANSPORT

No. 145

8 Februarie 2008

**DIE SUID-AFRIKAANSE NASIONALE  
PADAGENTSKAP BEPERK**

Registrasie No: 98/09584/06

**VERKLARING WYSIGING VAN NASIONALE PAD N4 SEKSIE 4**

WYSIGING VAN VERKLARING NO'S. 190 VAN 1985, 296 VAN 1972, 358 VAN 1977, 160 VAN 1986  
EN 186 VAN 1987.

Kragtens Artikel 40(1)(b) van die Suid-Afrikaanse Nasionale Padagentskap Beperk en die Nasionale Paaie Wet, 1998 (Wet No.7 van 1998), wysig ek hiermee die volgende verklarings deur (I) Verklaring no. 190 van 1985, die gedeelte vanaf die gemeenskaplike grens tussen plase Rhenosterfontein 318 -JS en Rietfontein 314 – JS op vel 7 tot vel 8 van plan no. P341/84 en die toepaslike koördinate, (II) Verklaring no. 296 van 1972, (III) Verklaring no. 358 van 1977, (IV) Verklaring no. 160 van 1986 en (V) Verklaring no. 186 van 1987 die gedeelte vanaf vel 1 tot by die gemeenskaplike grens tussen plase Klefontein 432 – JS en Leeuwfontein 431 –JS op vel 2 van Plan no. P358/86 en die toepaslike koördinate, te vervang met meegaande velle 1 tot 15 van Plan no. P636/07.

**(Nasionale Pad N4 Seksie 4: Rhenosterfontein – Leeuwfontein)**

  
\_\_\_\_\_  
MINISTER VAN VERVOER

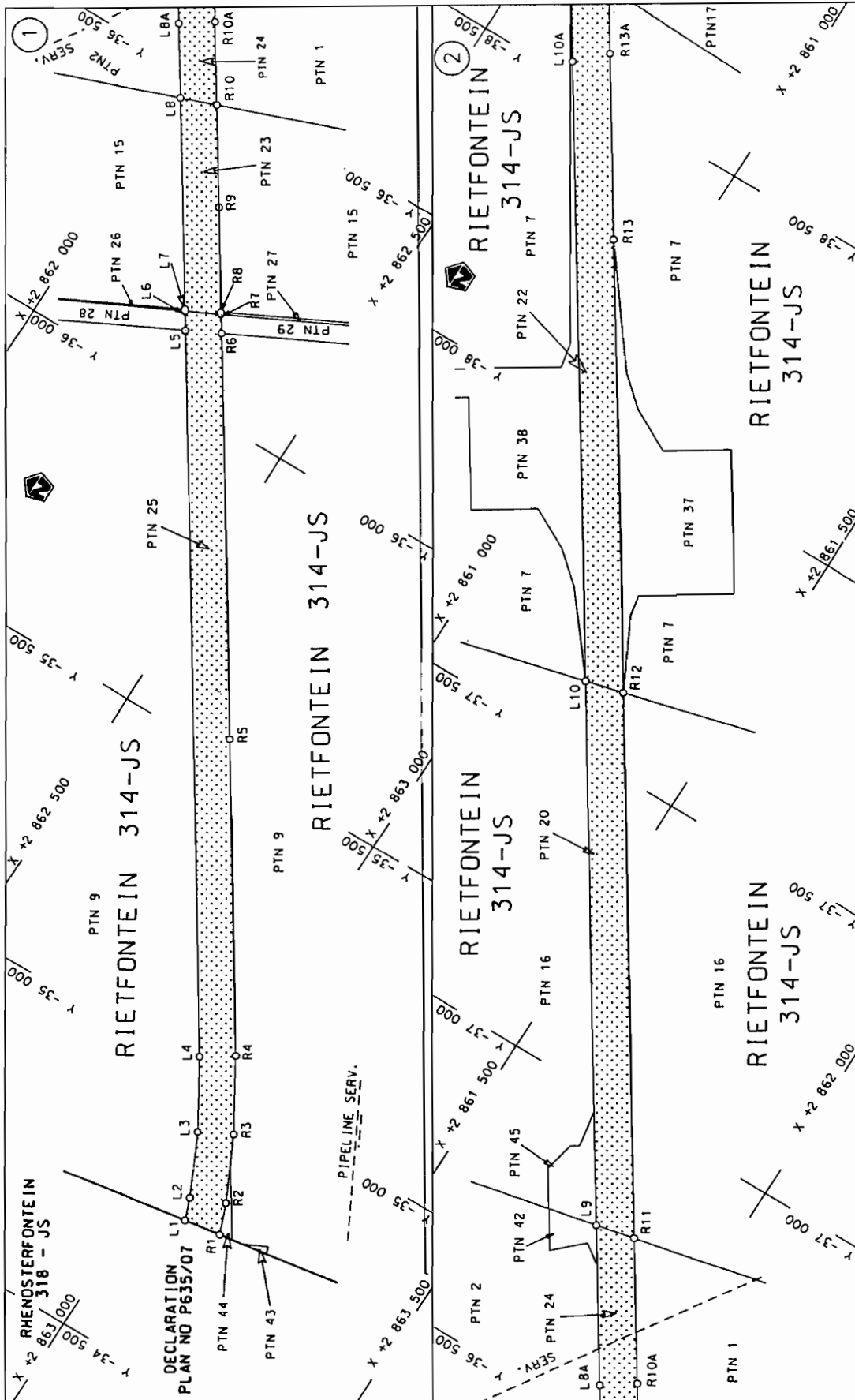

<p>Die Suid Afrikaanse Nasionale Padagentskap Beperk The South African National Roads Agency Limited</p>	<p>Die figuur getoon The figure shown</p>	<p>steldie podreserwe voor van 'n gedeelte represents the road reserve of a portion van Nasionale Roete N4 Sektie of National Route Section</p>
<p>Vel Sheet 1 of 15</p>	<p>Plan P636/07</p>	<p>4</p>

D.O.9.A

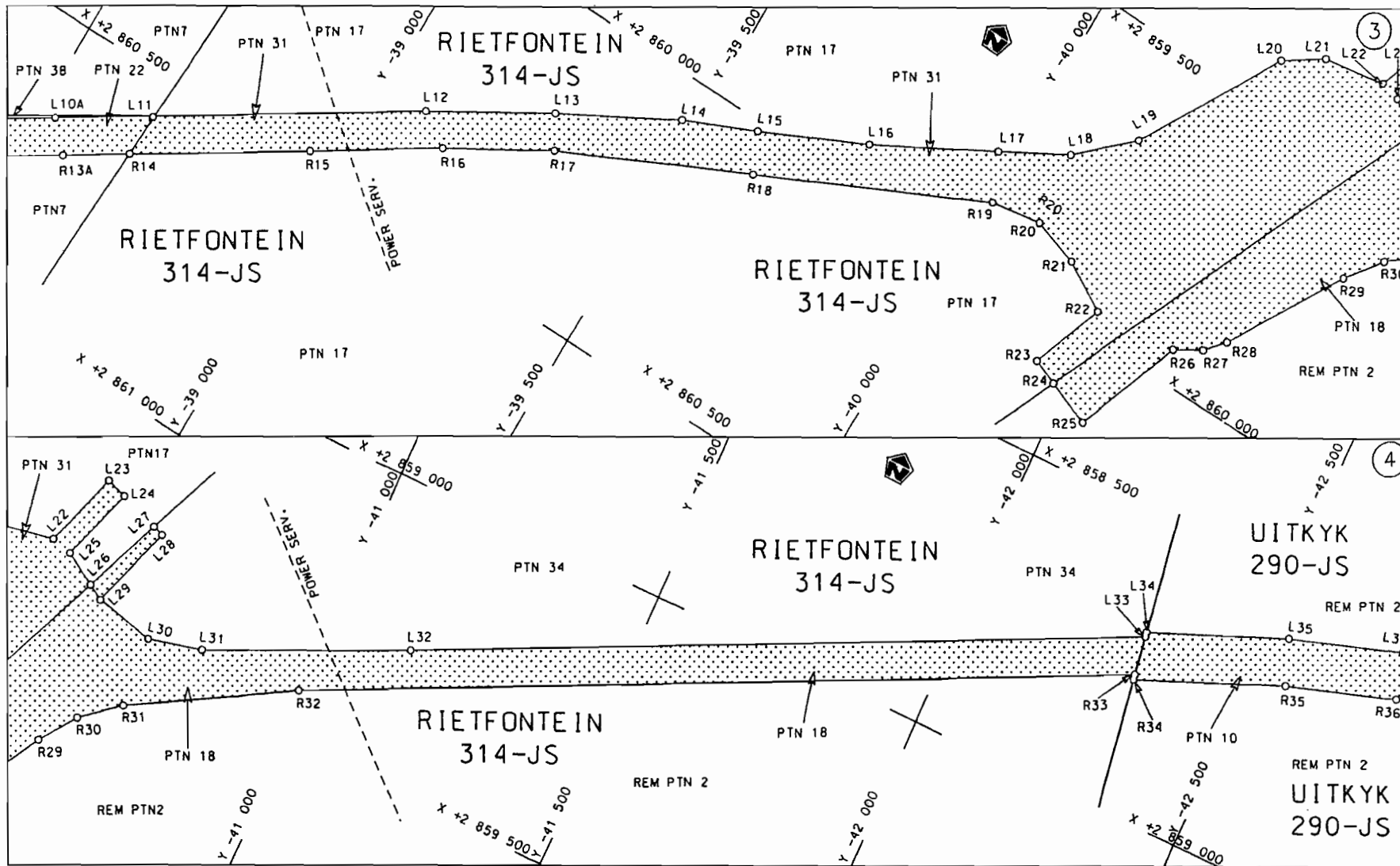

<p>Die Suid Afrikaanse Nasionale Padagentskap Beperk The South African National Roads Agency Limited</p>	<p>Die figuur getoon The figure shown</p> 	<p>steldie podreserwe voor van 'n gedeelte represents the road reserve of a portion van Nasionale Roete N4 Sektie of National Route N4 Section 4</p>	<p>Vel Sheet 2 van of 15 Plan P636/07</p>
--------------------------------------------------------------------------------------------------------------	------------------------------------------------------------------------------------------------------------------------------------	------------------------------------------------------------------------------------------------------------------------------------------------------------------	-----------------------------------------------

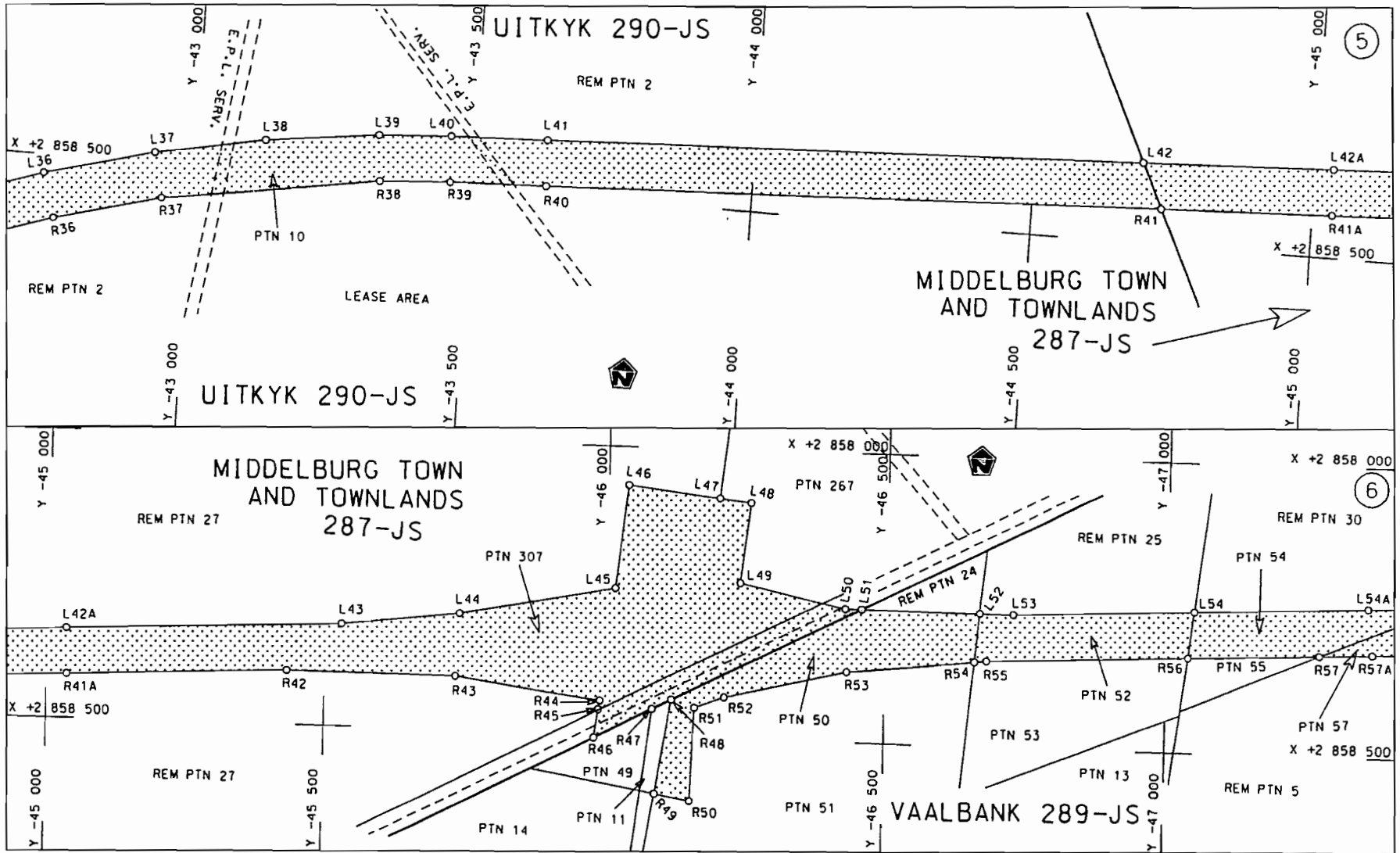

Die Suid Afrikaanse Nasionale Padogenskap Beperk The South African National Roads Agency Limited	Die figuur getoon The figure shown		steldie podreserwe voor van 'n gedeelte represents the raad reserve of a portion von Nasionale Roete N4 Seksie of National Route Section 4	Vel Sheet 3 van 15 Plan P636/07
-----------------------------------------------------------------------------------------------------	---------------------------------------	--	-----------------------------------------------------------------------------------------------------------------------------------------------------	------------------------------------

D.O.9.A

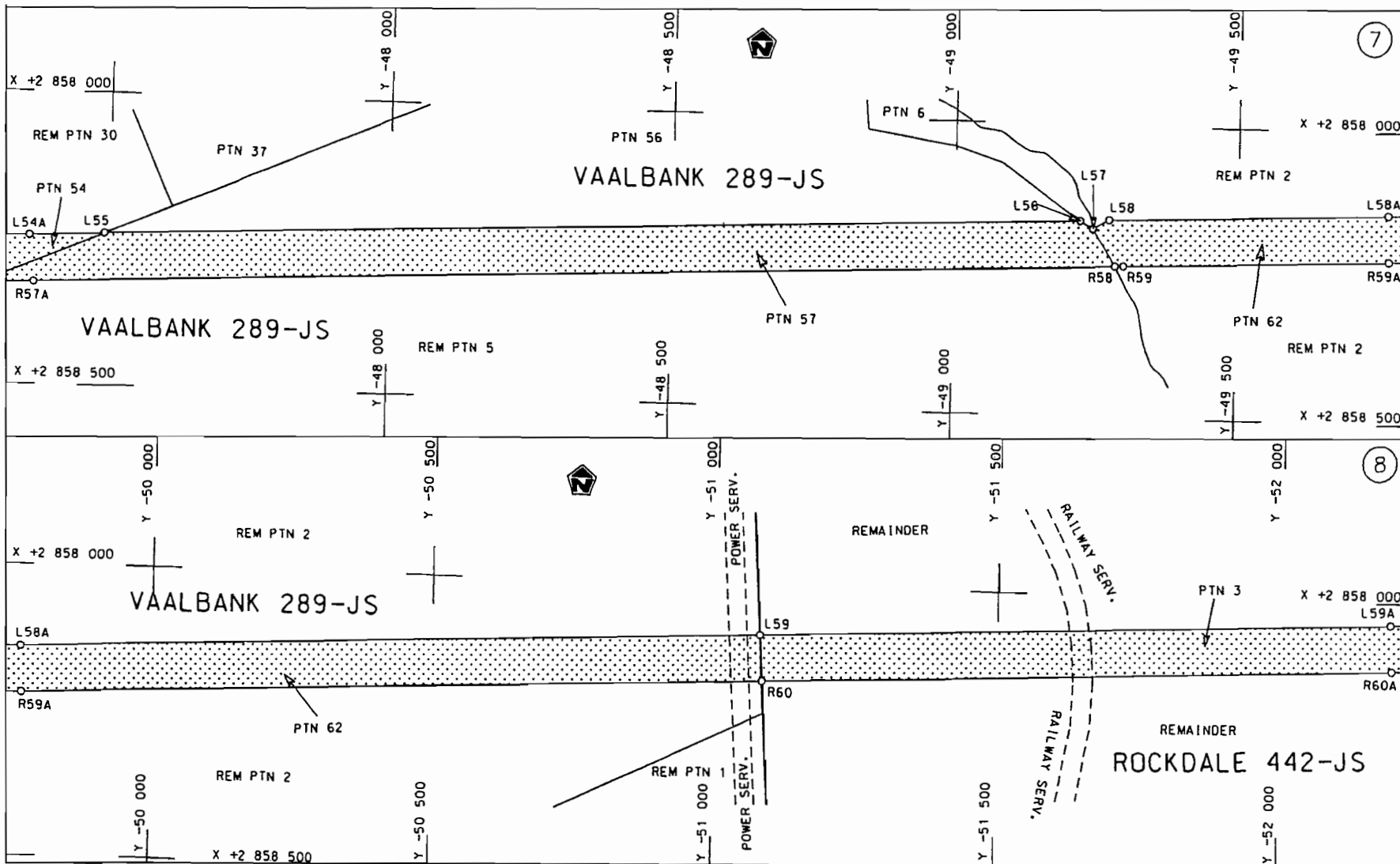

<p>Die Suid Afrikaanse Nasionale Padagentskap Beperk The South African National Roads Agency Limited</p>	<p>Die figuur getoon The figure shown</p>		<p>stel die podreserwe voor van 'n gedeelte represents the road reserve of a portion van Nasionale Roete N4 of National Route</p>	<p>Vel Sheet 4 van of 15 Plan P636/07</p>
--------------------------------------------------------------------------------------------------------------	-----------------------------------------------	--	-----------------------------------------------------------------------------------------------------------------------------------------------	-----------------------------------------------



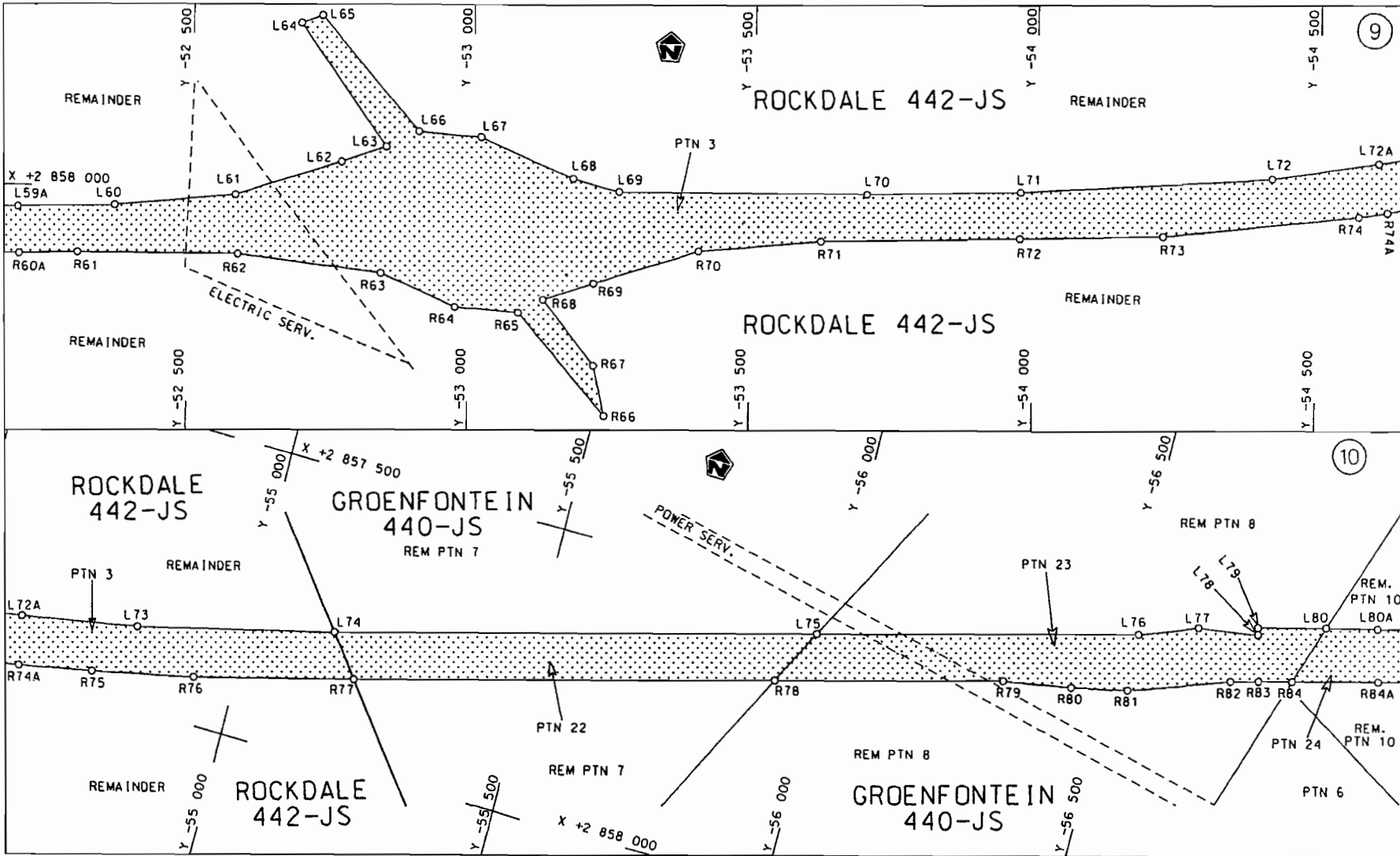

<p>Die Suid Afrikaanse Nasionale Padagentskap Beperk The South African National Roads Agency Limited</p>	<p>Die figuur getoon The figure shown</p>	<p>steldie padreserwe voor van 'n gedeelte represents the road reserve of a portion van Nasionale Roete N4 Seksie of National Route Section 4</p>	<p>Vel Sheet 5 van of 15 Plan P636/07</p>
--------------------------------------------------------------------------------------------------------------	-----------------------------------------------	---------------------------------------------------------------------------------------------------------------------------------------------------------------	-----------------------------------------------

D.O.9.A

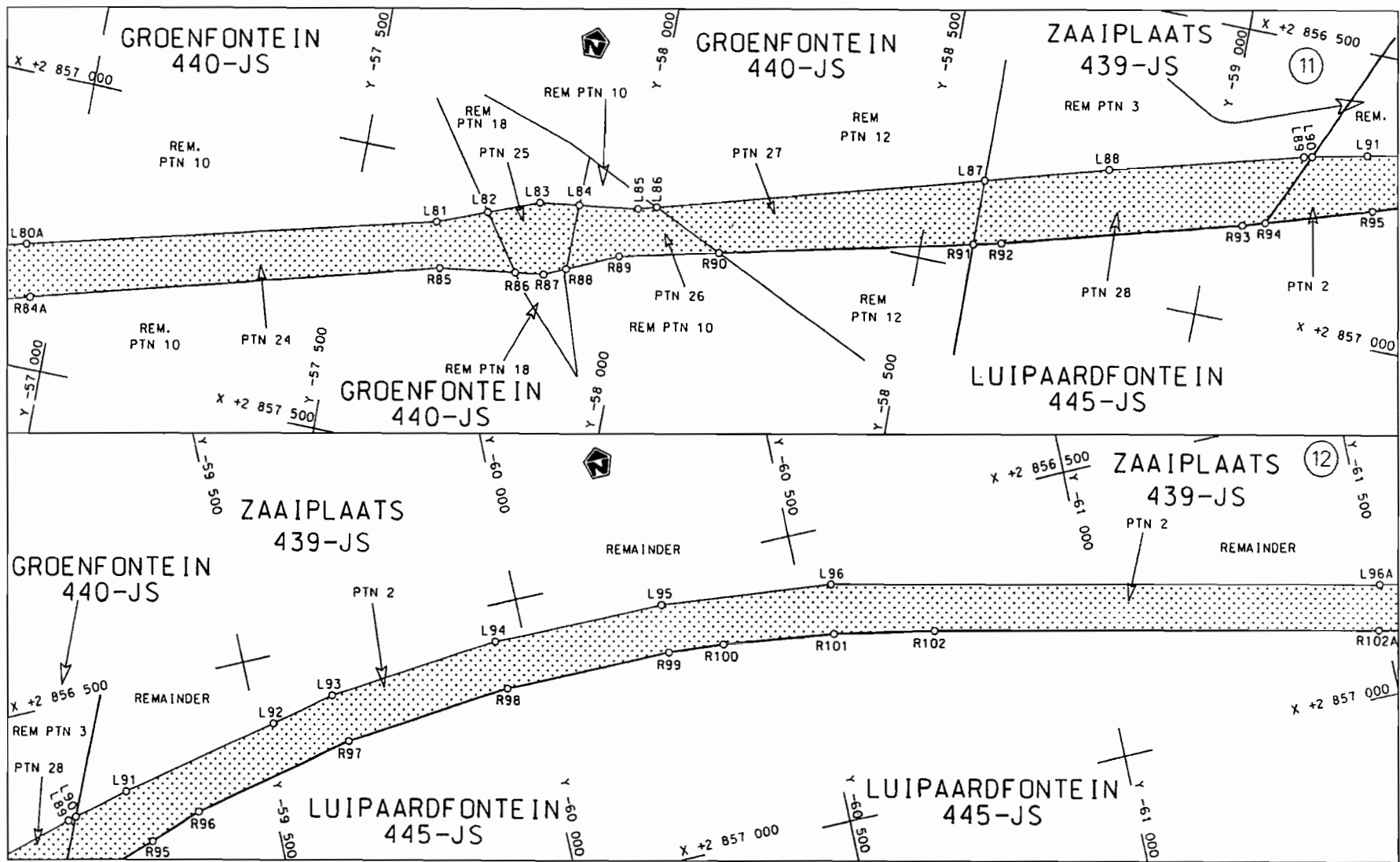

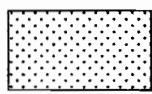
<p>Die Suid Afrikaanse Nasionale Padagentskap Beperk The South African National Roads Agency Limited</p>	<p>Die figuur getoon The figure shown</p> 	<p>steldie padreserwe voor van 'n gedeelte represents the road reserve of a portion van Nasionale Roete N4 Seksie of National Route Section 4</p>	<p>Vel van Sheet 6 of 15 Plan P636/07</p>
--------------------------------------------------------------------------------------------------------------	------------------------------------------------------------------------------------------------------------------------------------	---------------------------------------------------------------------------------------------------------------------------------------------------------------	---------------------------------------------------

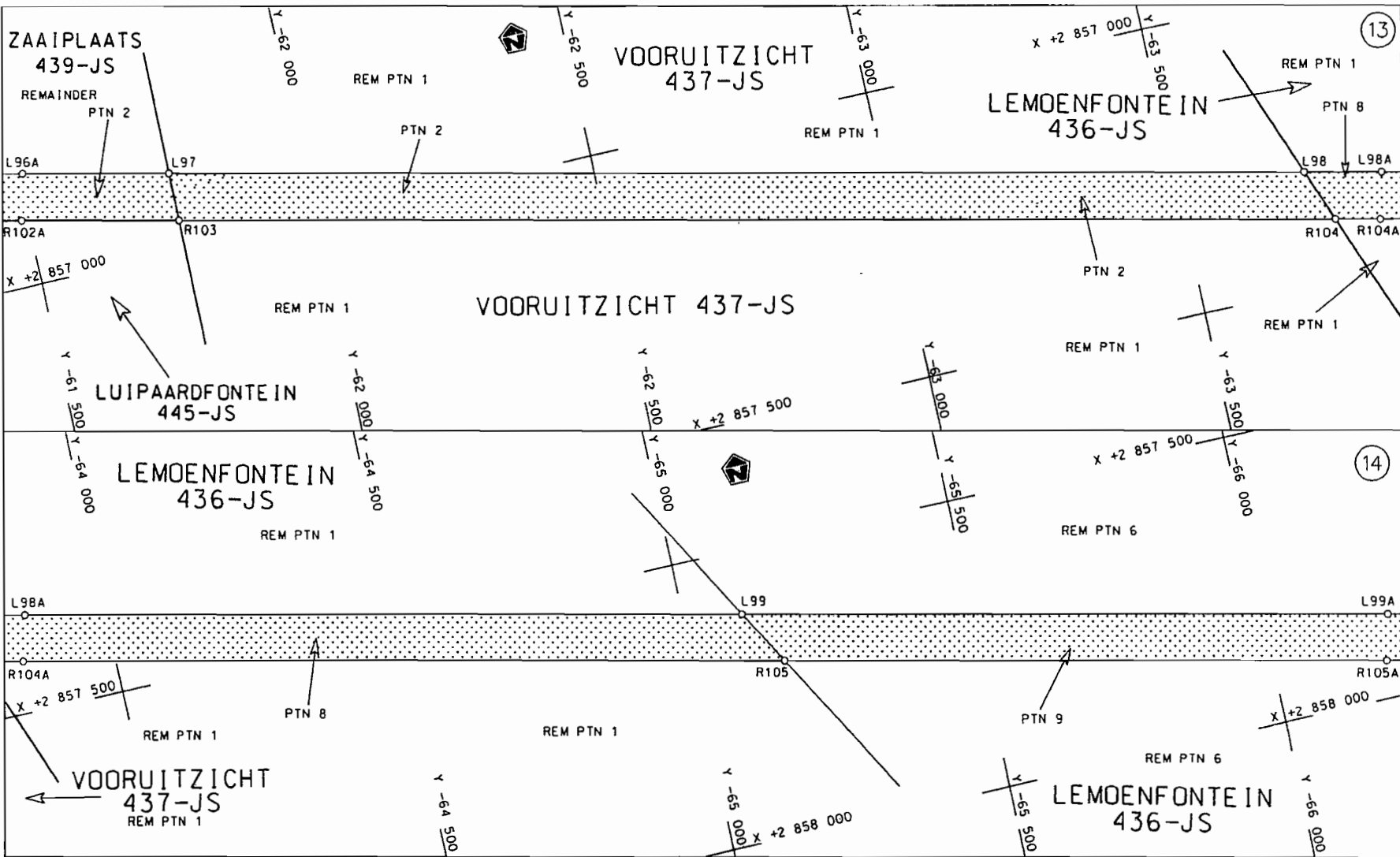

Die Suid Afrikaanse Nasionale Padagentskap Beperk  
 The South African National Roads Agency Limited

Die figuur getoon  
 The figure shown

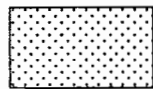

steldie padreserwe voor van 'n gedeelte  
 represents the road reserve of a portion  
 van Nasionale Roete N4 Sektie 4  
 of National Route of National Route

Vel Sheet 7 van 15  
 Plan P636/07

D.O.9.A

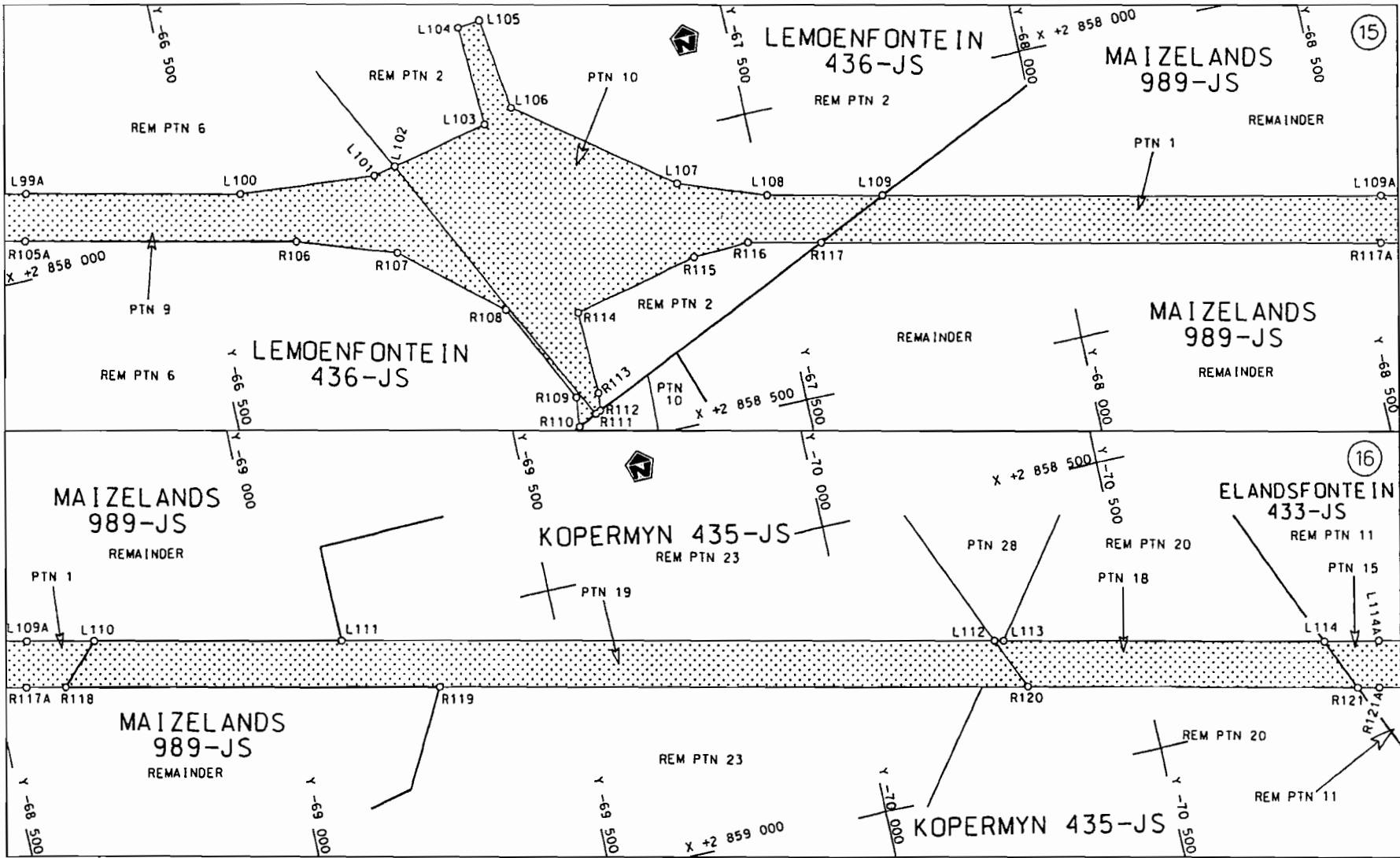

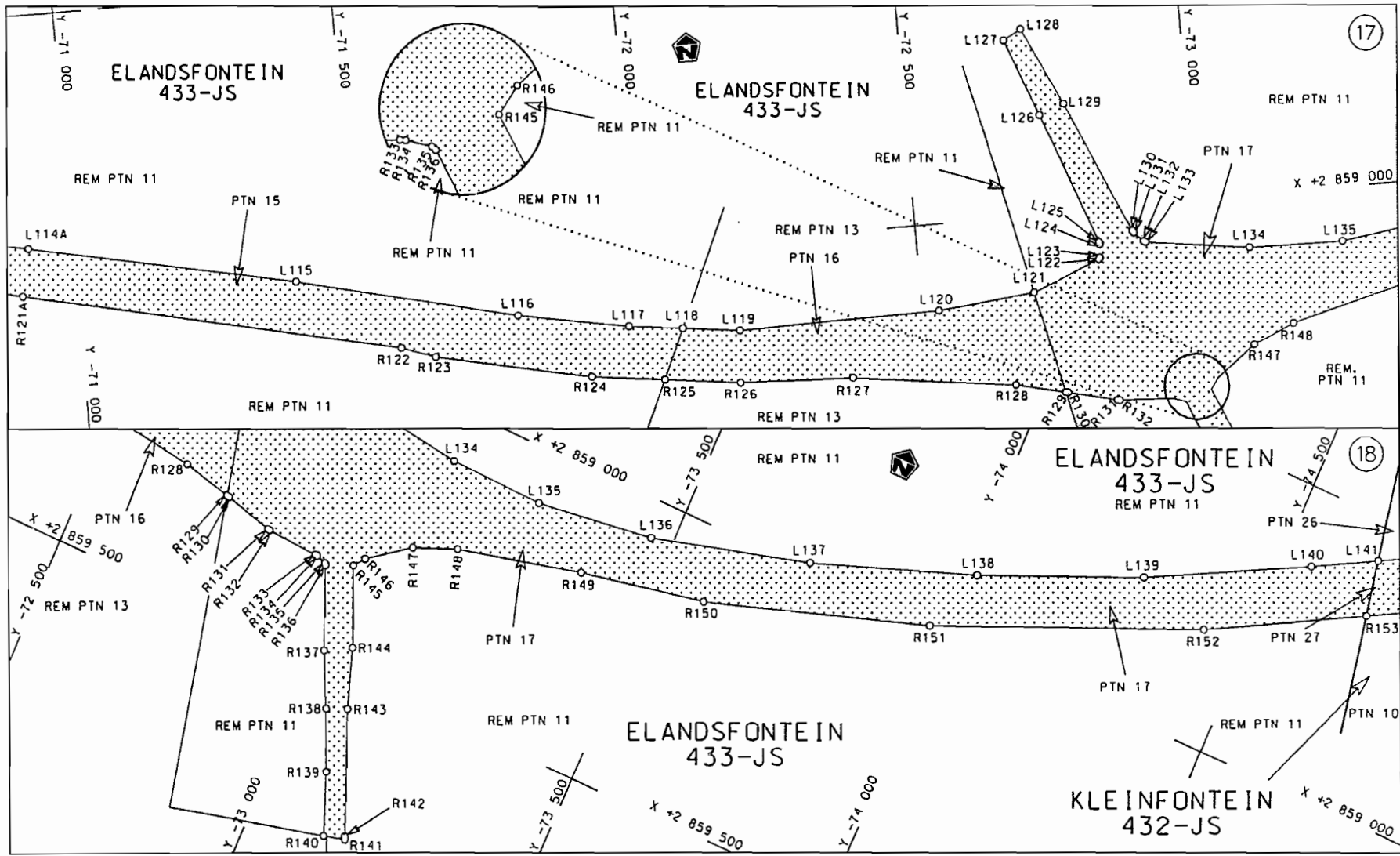

<p>Die Suid Afrikaanse Nasionale Padagentskap Beperk The South African National Roads Agency Limited</p>	<p>Die figuur getoon The figure shown</p>		<p>steldie padreserwe voor van 'n gedeelte represents the road reserve of a portion van Nasionale Roete N4 of National Route</p> <p>Seksie Section 4</p>	<p>Vel Sheet 8 van 15 of 15 Plan P636/07</p>
--------------------------------------------------------------------------------------------------------------	-----------------------------------------------	--------------------------------------------------------------------------------------	----------------------------------------------------------------------------------------------------------------------------------------------------------------------	--------------------------------------------------



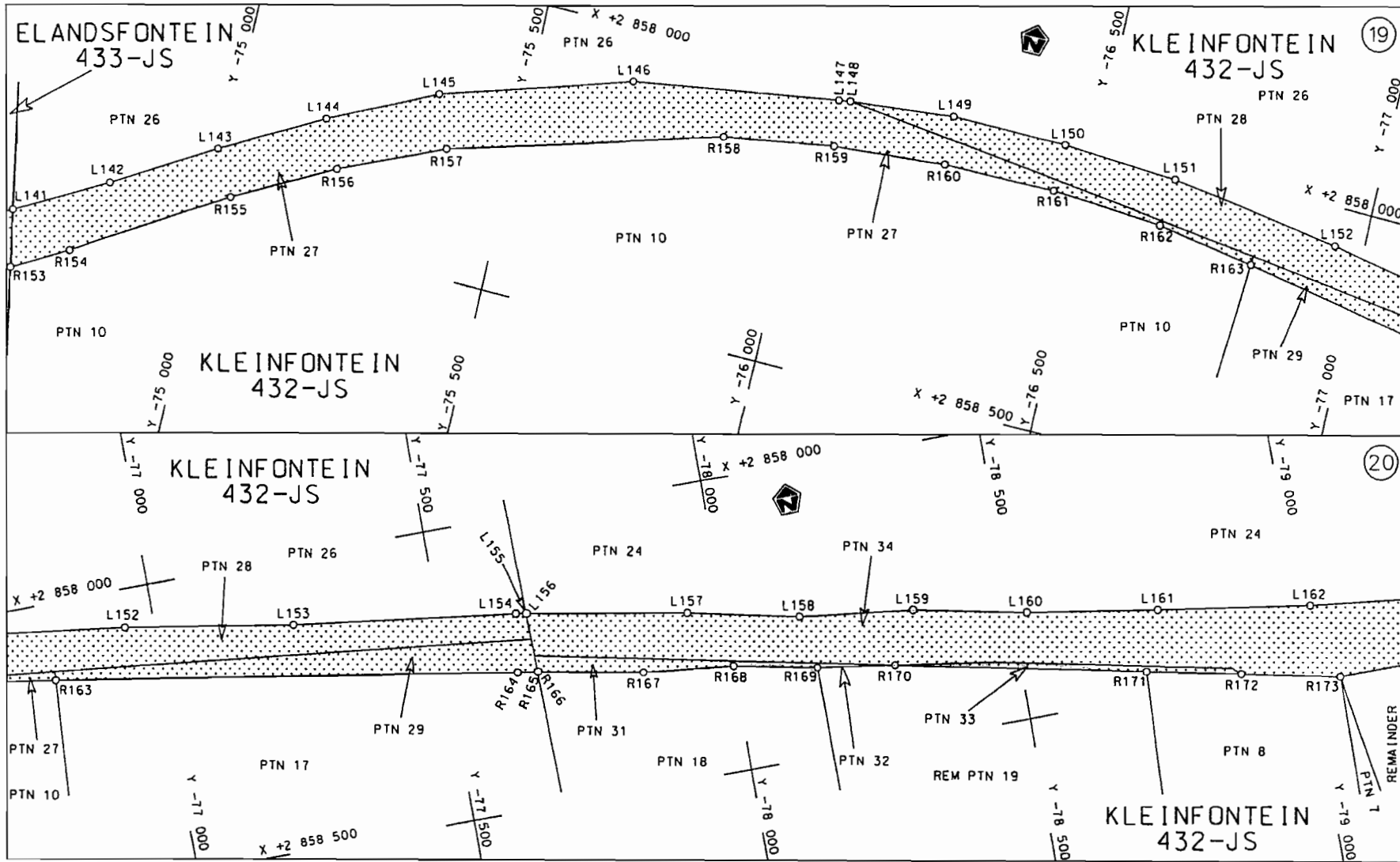

<p>Die Suid Afrikaanse Nasionale Padagentskap Beperk The South African National Roads Agency Limited</p>	<p>Die figuur getoon The figure shown</p>	<p>steldie padreserwe voor van 'n gedeelte represents the road reserve of a portion van Nasionale Roete N4 of National Route N4</p> <p>Seksie 4 Section 4</p>	<p>Vel 9 van 15 Sheet 9 of 15</p> <p>Plan P636/07</p>
--------------------------------------------------------------------------------------------------------------	-----------------------------------------------	-------------------------------------------------------------------------------------------------------------------------------------------------------------------------------	-----------------------------------------------------------

D.O.9.A

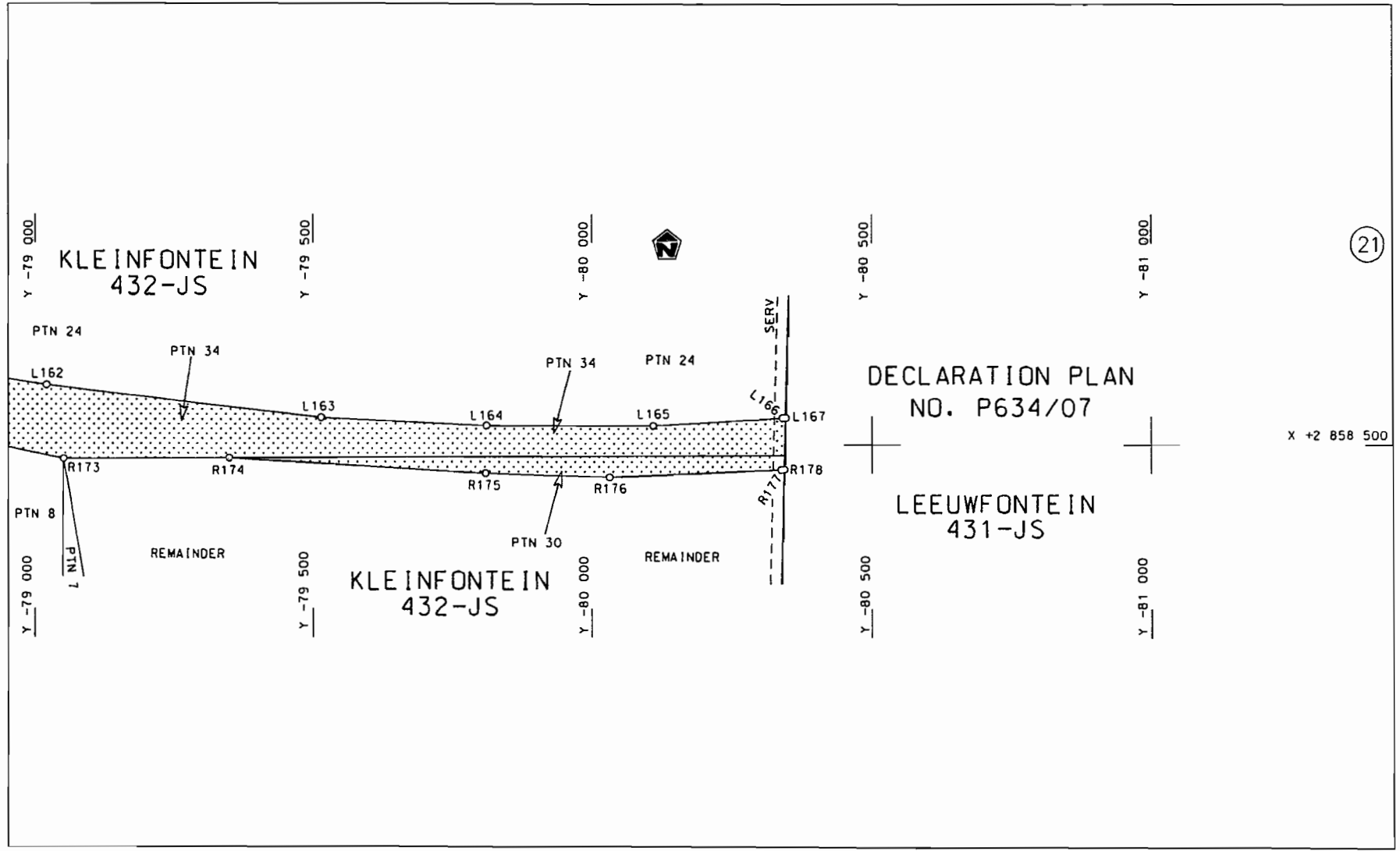

<p>Die Suid Afrikaanse Nasionale Padagentskap Beperk The South African National Roads Agency Limited</p>	<p>Die figuur getoon The figure shown</p>		<p>steldie padreserwe voor van 'n gedeelte represents the road reserve of a portion van Nasionale Roete N4 Seksie of National Route N4 Section 4</p>	<p>Vel Sheet 10 van of 15</p>
				<p>Plan P636/07</p>



<p>Die Suid Afrikaanse Nasionale Padagentskap Beperk The South African National Roads Agency Limited</p>	<p>Die figuur getoon The figure shown</p>		<p>st die padreserwe voor van 'n gedeelte represents the road reserve of a portion van Nasionale Roete N4 Seksie 4 of National Route N4 Section 4</p>	<table border="1"> <tr> <td>Vel Sheet</td> <td>11</td> <td>van of</td> <td>15</td> </tr> <tr> <td>Plan</td> <td colspan="3">P636/07</td> </tr> </table>	Vel Sheet	11	van of	15	Plan	P636/07		
Vel Sheet	11	van of	15									
Plan	P636/07											

D.O.9.A

PADRESERWE KOÖRDINATE				/	ROAD RESERVE CO-ORDINATES			
LINKERKANT/LEFT HAND SIDE					REGTERKANT/RIGHT HAND SIDE			
	Y	X	WG	29°	Y	X		
L1	-34 765.54	2 863 078.36		R1	-34 775.81	2 863 142.64		
L2	-34 803.61	2 863 063.88		R2	-34 829.01	2 863 122.22		
L3	-34 911.20	2 863 012.31		R3	-34 940.95	2 863 068.41		
L4	-35 026.97	2 862 943.97		R4	-35 061.65	2 862 997.31		
L5	-36 106.26	2 862 240.33		R5	-35 533.15	2 862 689.90		
L6	-36 135.12	2 862 221.53		R6	-36 135.00	2 862 297.60		
L7	-36 137.86	2 862 219.46		R7	-36 163.61	2 862 278.95		
L8	-36 451.32	2 862 015.21		R8	-36 166.75	2 862 276.63		
L9	-36 801.00	2 861 787.29		R9	-36 322.17	2 862 175.36		
L10	-37 611.47	2 861 258.51		R10	-36 473.90	2 862 076.48		
L11	-38 676.43	2 860 563.70		R11	-36 815.33	2 861 853.84		
L12	-39 080.34	2 860 300.45		R12	-37 627.95	2 861 323.65		
L13	-39 275.80	2 860 180.96		R13	-38 297.79	2 860 886.63		
L14	-39 472.53	2 860 071.44		R14	-38 672.83	2 860 641.95		
L15	-39 595.96	2 860 016.04		R15	-38 941.01	2 860 467.68		
L16	-39 773.97	2 859 930.85		R16	-39 139.05	2 860 338.02		
L17	-39 973.67	2 859 820.11		R17	-39 308.19	2 860 236.38		
L18	-40 085.09	2 859 756.06		R18	-39 628.64	2 860 082.88		
L19	-40 172.48	2 859 671.91		R19	-40 012.60	2 859 900.48		
L20	-40 313.21	2 859 423.04		R20	-40 101.18	2 859 886.47		
L21	-40 378.63	2 859 378.20		R21	-40 184.05	2 859 911.63		
L22	-40 485.95	2 859 359.39		R22	-40 267.91	2 859 959.33		
L23	-40 533.17	2 859 228.78		R23	-40 220.65	2 860 087.26		
L24	-40 569.22	2 859 241.05		R24	-40 265.49	2 860 103.54		
L25	-40 522.49	2 859 369.48		R25	-40 344.70	2 860 132.31		
L26	-40 577.90	2 859 403.52		R26	-40 413.19	2 859 944.31		
L27	-40 638.71	2 859 266.76		R27	-40 458.04	2 859 917.18		
L28	-40 657.79	2 859 273.70		R28	-40 487.02	2 859 883.46		
L29	-40 604.59	2 859 419.73		R29	-40 604.22	2 859 680.98		
L30	-40 709.52	2 859 445.49		R30	-40 650.88	2 859 618.61		
L31	-40 803.01	2 859 421.80		R31	-40 716.23	2 859 566.57		
L32	-41 140.17	2 859 267.05		R32	-40 987.31	2 859 412.02		
L33	-42 308.37	2 858 700.08		R33	-42 318.64	2 858 765.81		
L34	-42 307.14	2 858 692.16		R34	-42 319.98	2 858 774.44		
L35	-42 539.11	2 858 596.07		R35	-42 566.82	2 858 670.85		
L36	-42 731.43	2 858 532.32		R36	-42 754.19	2 858 609.05		
L37	-42 927.56	2 858 481.96		R37	-42 945.25	2 858 559.86		
L38	-43 126.91	2 858 444.64		R38	-43 335.09	2 858 500.15		
L39	-43 328.04	2 858 420.59		R39	-43 460.13	2 858 492.11		
L40	-43 456.58	2 858 412.26		R40	-43 632.97	2 858 484.68		
L41	-43 629.53	2 858 404.75		R41	-44 729.58	2 858 437.59		
L42	-44 692.40	2 858 359.11		R42	-45 431.92	2 858 407.32		
L43	-45 528.45	2 858 323.09		R43	-45 732.39	2 858 408.40		
L44	-45 737.65	2 858 298.57		R44	-45 992.30	2 858 442.31		
L45	-46 015.35	2 858 246.25		R45	-45 990.02	2 858 457.55		
L46	-46 035.44	2 858 067.36		R46	-45 982.87	2 858 505.34		
L47	-46 198.72	2 858 085.69		R47	-46 085.66	2 858 454.31		
L48	-46 254.09	2 858 091.93		R48	-46 119.83	2 858 437.35		
L49	-46 238.42	2 858 231.05		R49	-46 093.18	2 858 597.59		
L50	-46 426.63	2 858 270.41		R50	-46 156.05	2 858 608.10		
L51	-46 455.91	2 858 270.52		R51	-46 161.53	2 858 449.87		

Vel	12	Van	15	P636/07
Sheet		of		



PADRESERWE KOÖRDINATE				/	ROAD RESERVE CO-ORDINATES			
LINKERKANT/LEFT HAND SIDE					REGTERKANT/RIGHT HAND SIDE			
	Y	X	WG	29°	Y	X		
L52	-46 666.69	2 858	271.44	R52	-46 214.15	2 858	430.49	
L53	-46 727.11	2 858	271.71	R53	-46 431.46	2 858	380.40	
L54	-47 047.87	2 858	257.95	R54	-46 658.72	2 858	356.15	
L55	-47 491.04	2 858	238.94	R55	-46 680.43	2 858	353.83	
L56	-49 222.77	2 858	164.65	R56	-47 037.95	2 858	338.49	
L57	-49 245.57	2 858	177.84	R57	-47 273.48	2 858	328.38	
L58	-49 273.44	2 858	162.49	R58	-49 285.93	2 858	241.98	
L59	-51 080.55	2 858	085.29	R59	-49 301.02	2 858	241.36	
L60	-52 365.12	2 858	029.79	R60	-51 085.60	2 858	164.82	
L61	-52 580.60	2 858	005.77	R61	-52 301.27	2 858	112.69	
L62	-52 769.51	2 857	944.64	R62	-52 586.91	2 858	107.40	
L63	-52 847.69	2 857	916.40	R63	-52 843.29	2 858	133.98	
L64	-52 693.37	2 857	710.78	R64	-52 974.46	2 858	189.77	
L65	-52 730.42	2 857	696.70	R65	-53 088.20	2 858	196.55	
L66	-52 904.51	2 857	889.28	R66	-53 243.60	2 858	368.88	
L67	-53 014.89	2 857	895.56	R67	-53 223.11	2 858	283.57	
L68	-53 180.88	2 857	961.10	R68	-53 131.79	2 858	172.37	
L69	-53 262.09	2 857	981.26	R69	-53 220.02	2 858	141.08	
L70	-53 701.73	2 857	972.50	R70	-53 404.66	2 858	080.04	
L71	-53 972.66	2 857	960.84	R71	-53 622.50	2 858	055.90	
L72	-54 416.55	2 857	925.98	R72	-53 973.08	2 858	040.87	
L73	-54 807.69	2 857	860.91	R73	-54 226.08	2 858	029.88	
L74	-55 151.92	2 857	778.34	R74	-54 573.26	2 857	987.42	
L75	-55 978.14	2 857	556.82	R75	-54 750.31	2 857	955.07	
L76	-56 527.05	2 857	409.62	R76	-54 927.90	2 857	918.39	
L77	-56 625.06	2 857	371.33	R77	-55 205.62	2 857	847.55	
L78	-56 729.87	2 857	355.18	R78	-55 925.97	2 857	653.59	
L79	-56 726.76	2 857	343.50	R79	-56 315.60	2 857	549.44	
L80	-56 844.43	2 857	311.89	R80	-56 434.95	2 857	528.94	
L81	-57 647.55	2 857	108.93	R81	-56 532.59	2 857	507.46	
L82	-57 732.63	2 857	074.81	R82	-56 702.35	2 857	445.36	
L83	-57 820.21	2 857	039.70	R83	-56 750.63	2 857	432.43	
L84	-57 889.80	2 857	030.15	R84	-56 808.86	2 857	416.81	
L85	-57 995.14	2 857	015.70	R85	-57 668.27	2 857	186.25	
L86	-58 026.90	2 857	006.61	R86	-57 799.91	2 857	167.89	
L87	-58 589.51	2 856	845.60	R87	-57 849.95	2 857	160.92	
L88	-58 802.99	2 856	784.51	R88	-57 887.56	2 857	143.91	
L89	-59 136.99	2 856	695.45	R89	-57 977.30	2 857	103.33	
L90	-59 151.46	2 856	692.28	R90	-58 150.82	2 857	062.51	
L91	-59 248.70	2 856	670.98	R91	-58 591.41	2 856	958.86	
L92	-59 530.12	2 856	614.50	R92	-58 639.33	2 856	947.35	
L93	-59 645.97	2 856	591.45	R93	-59 052.99	2 856	833.15	
L94	-59 949.17	2 856	563.69	R94	-59 091.85	2 856	821.03	
L95	-60 253.44	2 856	566.21	R95	-59 276.35	2 856	763.51	
L96	-60 556.11	2 856	597.51	R96	-59 367.44	2 856	731.95	
L97	-61 761.58	2 856	865.69	R97	-59 657.60	2 856	674.57	
L98	-63 726.02	2 857	302.69	R98	-59 952.30	2 856	647.40	
L99	-65 103.15	2 857	609.05	R99	-60 248.20	2 856	649.84	
L100	-66 591.01	2 857	940.04	R100	-60 346.13	2 856	657.21	
L101	-66 832.56	2 857	961.35	R101	-60 542.36	2 856	682.12	
L102	-66 871.19	2 857	954.42	R102	-60 718.35	2 856	715.56	

Vel	13	Van	15	P636/07
Sheet		of		

PADRESERWE KOÖRDINATE				/	ROAD RESERVE CO-ORDINATES			
LINKERKANT/LEFT HAND SIDE					REGTERKANT/RIGHT HAND SIDE			
	Y	X	WG	29°	Y	X		
L103	-67 045.22	2 857	917.68	R103	-61 761.29	2 856	947.65	
L104	-67 034.94	2 857	744.63	R104	-63 761.74	2 857	392.63	
L105	-67 074.72	2 857	740.51	R105	-65 159.05	2 857	703.46	
L106	-67 097.52	2 857	898.97	R106	-66 671.48	2 858	039.88	
L107	-67 356.76	2 858	090.61	R107	-66 844.00	2 858	098.13	
L108	-67 508.90	2 858	144.22	R108	-67 012.77	2 858	233.71	
L109	-67 708.17	2 858	188.52	R109	-67 101.04	2 858	407.65	
L110	-68 689.07	2 858	406.62	R110	-67 095.49	2 858	457.95	
L111	-69 121.66	2 858	502.85	R111	-67 128.95	2 858	443.23	
L112	-70 254.43	2 858	754.82	R112	-67 138.04	2 858	439.25	
L113	-70 269.99	2 858	758.30	R113	-67 141.11	2 858	409.13	
L114	-70 825.31	2 858	883.51	R114	-67 136.16	2 858	265.58	
L115	-71 393.56	2 859	000.11	R115	-67 358.62	2 858	218.71	
L116	-71 781.98	2 859	091.62	R116	-67 457.26	2 858	214.68	
L117	-71 976.70	2 859	127.28	R117	-67 584.26	2 858	243.01	
L118	-72 071.75	2 859	138.89	R118	-68 623.12	2 858	473.90	
L119	-72 173.37	2 859	151.30	R119	-69 274.51	2 858	618.79	
L120	-72 529.15	2 859	147.68	R120	-70 295.20	2 858	845.84	
L121	-72 701.02	2 859	131.05	R121	-70 866.04	2 858	974.42	
L122	-72 821.64	2 859	085.08	R122	-71 569.68	2 859	129.55	
L123	-72 823.68	2 859	082.30	R123	-71 628.61	2 859	150.67	
L124	-72 825.27	2 859	059.67	R124	-71 903.59	2 859	208.11	
L125	-72 824.73	2 859	055.82	R125	-72 032.13	2 859	224.26	
L126	-72 738.28	2 858	829.96	R126	-72 166.76	2 859	241.17	
L127	-72 686.75	2 858	695.14	R127	-72 366.62	2 859	250.42	
L128	-72 718.59	2 858	677.62	R128	-72 654.56	2 859	287.24	
L129	-72 782.44	2 858	813.50	R129	-72 741.58	2 859	307.69	
L130	-72 884.80	2 859	041.60	R130	-72 745.89	2 859	308.70	
L131	-72 886.99	2 859	044.87	R131	-72 832.47	2 859	329.85	
L132	-72 902.79	2 859	060.89	R132	-72 836.49	2 859	330.41	
L133	-72 906.17	2 859	062.84	R133	-72 927.69	2 859	335.50	
L134	-73 087.64	2 859	087.58	R134	-72 931.69	2 859	336.19	
L135	-73 255.25	2 859	091.65	R135	-72 948.99	2 859	341.73	
L136	-73 461.35	2 859	064.19	R136	-72 951.65	2 859	344.33	
L137	-73 737.74	2 858	986.80	R137	-73 007.64	2 859	477.99	
L138	-74 016.31	2 858	884.61	R138	-73 051.65	2 859	568.00	
L139	-74 288.37	2 858	766.40	R139	-73 096.44	2 859	668.56	
L140	-74 551.77	2 858	627.85	R140	-73 137.13	2 859	771.63	
L141	-74 657.34	2 858	569.76	R141	-73 174.40	2 859	762.48	
L142	-74 814.64	2 858	484.07	R142	-73 174.15	2 859	761.90	
L143	-74 987.34	2 858	382.19	R143	-73 086.98	2 859	553.22	
L144	-75 164.84	2 858	285.48	R144	-73 052.31	2 859	453.37	
L145	-75 348.26	2 858	196.08	R145	-72 997.22	2 859	324.62	
L146	-75 677.75	2 858	090.77	R146	-73 011.48	2 859	305.84	
L147	-76 040.16	2 858	034.63	R147	-73 080.91	2 859	253.97	
L148	-76 060.02	2 858	031.60	R148	-73 154.42	2 859	223.79	
L149	-76 242.31	2 858	012.86	R149	-73 371.96	2 859	169.39	
L150	-76 445.37	2 858	013.70	R150	-73 589.97	2 859	125.04	
L151	-76 648.12	2 858	023.52	R151	-73 974.02	2 858	997.39	
L152	-76 947.98	2 858	064.35	R152	-74 419.60	2 858	804.40	
L153	-77 244.03	2 858	112.98	R153	-74 675.93	2 858	663.79	

Vel 14 Van 15  
Sheet of

P636/07

PADRESERWE KOÖRDINATE				/	ROAD RESERVE CO-ORDINATES			
LINKERKANT/LEFT HAND SIDE					REGTERKANT/RIGHT HAND SIDE			
	Y	X	WG	29°	Y	X		
L154	-77 636.90	2 858	163.83	R154	-74 771.35	2 858	611.17	
L155	-77 654.22	2 858	166.63	R155	-75 028.80	2 858	456.86	
L156	-77 656.14	2 858	166.94	R156	-75 203.63	2 858	364.65	
L157	-77 936.48	2 858	216.19	R157	-75 383.90	2 858	285.27	
L158	-78 132.05	2 858	257.68	R158	-75 855.84	2 858	145.65	
L159	-78 330.85	2 858	281.74	R159	-76 050.44	2 858	114.02	
L160	-78 527.16	2 858	321.28	R160	-76 246.53	2 858	096.85	
L161	-78 756.62	2 858	358.15	R161	-76 443.53	2 858	094.01	
L162	-79 020.70	2 858	398.13	R162	-76 640.38	2 858	105.16	
L163	-79 514.24	2 858	453.75	R163	-76 809.96	2 858	130.69	
L164	-79 812.02	2 858	467.61	R164	-77 621.76	2 858	262.96	
L165	-80 110.23	2 858	467.71	R165	-77 656.29	2 858	267.70	
L166	-80 341.63	2 858	453.58	R166	-77 658.17	2 858	267.96	
L167	-80 347.73	2 858	453.13	R167	-77 841.55	2 858	302.14	
				R168	-78 000.74	2 858	319.38	
				R169	-78 147.56	2 858	348.46	
				R170	-78 282.57	2 858	368.28	
				R171	-78 717.71	2 858	457.61	
				R172	-78 880.18	2 858	490.73	
				R173	-79 051.85	2 858	525.97	
				R174	-79 349.36	2 858	524.46	
				R175	-79 810.19	2 858	551.10	
				R176	-80 031.68	2 858	557.87	
				R177	-80 339.16	2 858	544.36	
				R178	-80 345.43	2 858	543.78	

Vel	15	Van	15	P636/07
Sheet		of		