

Government Gazette Staatskoerant

REPUBLIC OF SOUTH AFRICA
REPUBLIEK VAN SUID-AFRIKA

Vol. 517

Pretoria, 28 July
Julie 2008

No. 31274

CONTENTS**INHOUD**

<i>No.</i>	<i>Page No.</i>	<i>Gazette No.</i>	<i>No.</i>	<i>Bladsy No.</i>	<i>Koerant No.</i>
GOVERNMENT NOTICE			GOEWERMENSKENNISGEWING		
Transport, Department of			Vervoer, Departement van		
<i>Government Notice</i>			<i>Goewermentskennisgewing</i>		
800			800		
South African National Roads Agency Limited and the National Roads Act (7/1998); South African National Roads Agency Limited: Declaration of National Road R21: (Also known as the P157-1 and P157/2—Sections 1 and 2: From Hans Strydom Drive to Rietfontein Interchange (N12): Province of Gauteng, as a toll road and the establishment of electronic toll points	3	31273	Suid-Afrikaanse Nasionale Padagentskap Beperk en die Nasionale Paaie Wet (7/1998): Suid-Afrikaanse Nasionale Padagentskap Beperk: Verlaring van Nasionale Pad R21: (Ook bekend as die P157-1 en P157/2)—Seksie 1 en 2: Vanaf Hans Strydomweg tot Rietfontein Wisselaar (N12): Provinsie van Gauteng, as 'n aaneenlopende tolpad en die vestiging van elektroniese tolpunte.....	4	31273

GOVERNMENT NOTICE
GOEWERMENTSKENNISGEWING

DEPARTMENT OF TRANSPORT
DEPARTEMENT VAN VERVOER

No. 801

28 July 2008

THE SOUTH AFRICAN NATIONAL ROADS
AGENCY LIMITED

Registration No: 98/09584/06

DECLARATION AMENDMENT OF NATIONAL ROAD R36 SECTION 9

AMENDMENT OF DECLARATION No. 1229 OF 2004

By virtue of section 40 (1)(b) of the South African National Roads Agency Limited and the National Roads Act, 1998 (Act No. 7 of 1998), I hereby amend Declaration No. 1229 of 2004 by substituting the section of the descriptive declaration from Soekmekaar up to Bandelierskop in paragraphs (I) and (II) of the Annexure, with the subjoined sheets 1 to 7 of Plan No.P657/08.

(National Road R36 Section 9: Soekmekaar - Bandelierskop)



MINISTER OF TRANSPORT

No. 801

28 Julie 2008

DIE SUID-AFRIKAANSE NASIONALE PADAGENTSKAP BEPERK

Registrasie No: 98/09584/06

VERKLARING WYSIGING VAN NASIONALE PAD R36 SEKSIE 9.

WYSIGING VAN VERKLARING NO. 1229 VAN 2004.

Kragtens Artikel 40(1)(b) van die Suid-Afrikaanse Nasionale Padagentskap Beperk en die Nasionale Paaie Wet, 1998 (Wet No.7 van 1998), wysig ek hiermee Verklaring no.1229 van 2004 deur die gedeelte van die beskrywende verklaring vanaf Soekmekaar tot by Bandelierskop in paragrawe (I) en (II) van die bylae, te vervang met meegaande velle 1 tot 7 van Plan No. P657/08.

(Nasionale Pad R36 Seksie 9: Soekmekaar - Bandelierskop)

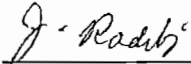

MINISTER VAN VERVOER

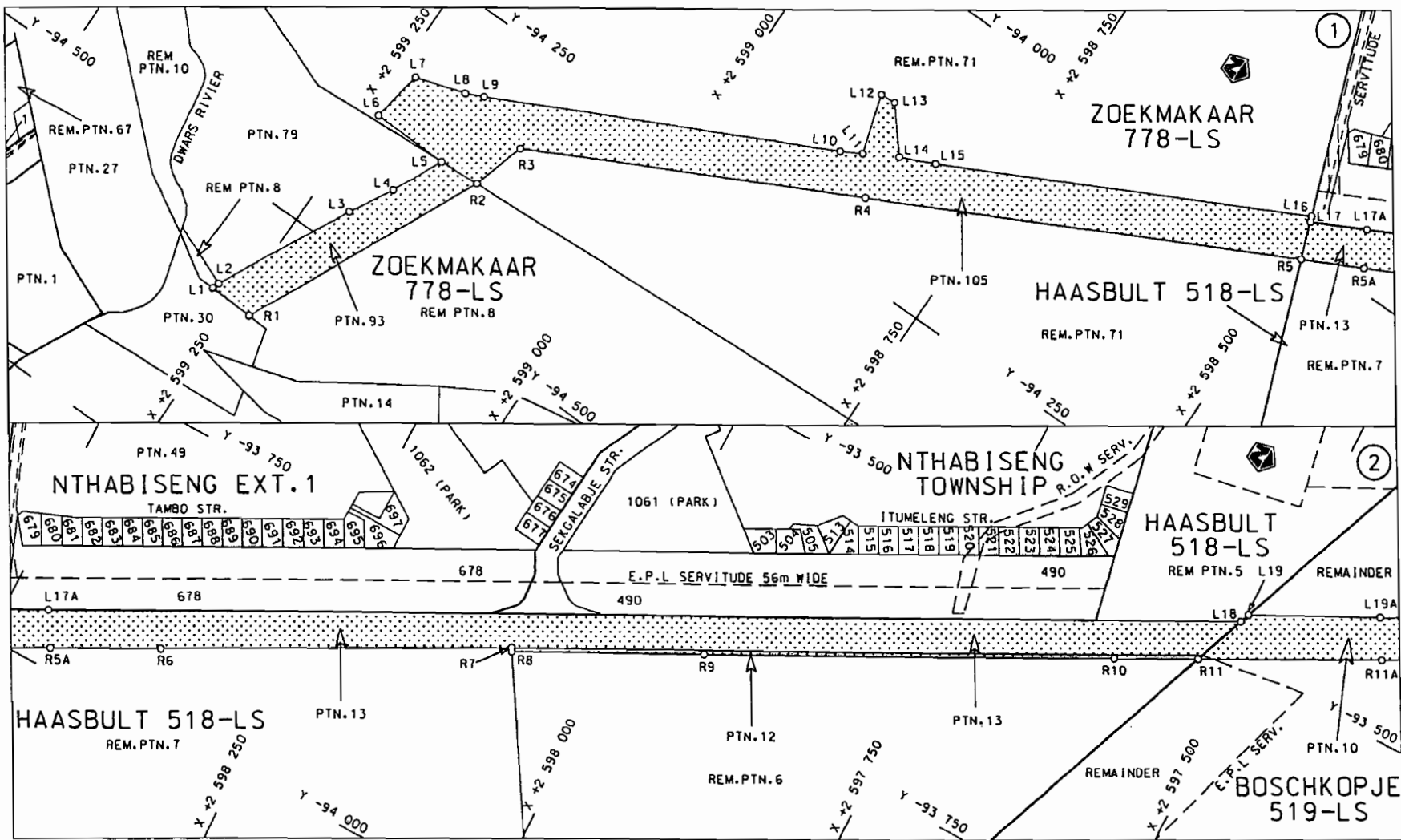

Suid-Afrikaanse Padagentskap Bpk. South African National Roads Agency Ltd.	Die figuur getoon The figure shown	 steidie padreserwe voor van 'n gedeelte represents the road reserve of a portion van Nasionale Roete R36 Seksie of National Route R36 Section 9	Vel 1 van 7 Sheet 1 of 7 P P657/08
---	---------------------------------------	---	--

D.O.9.A

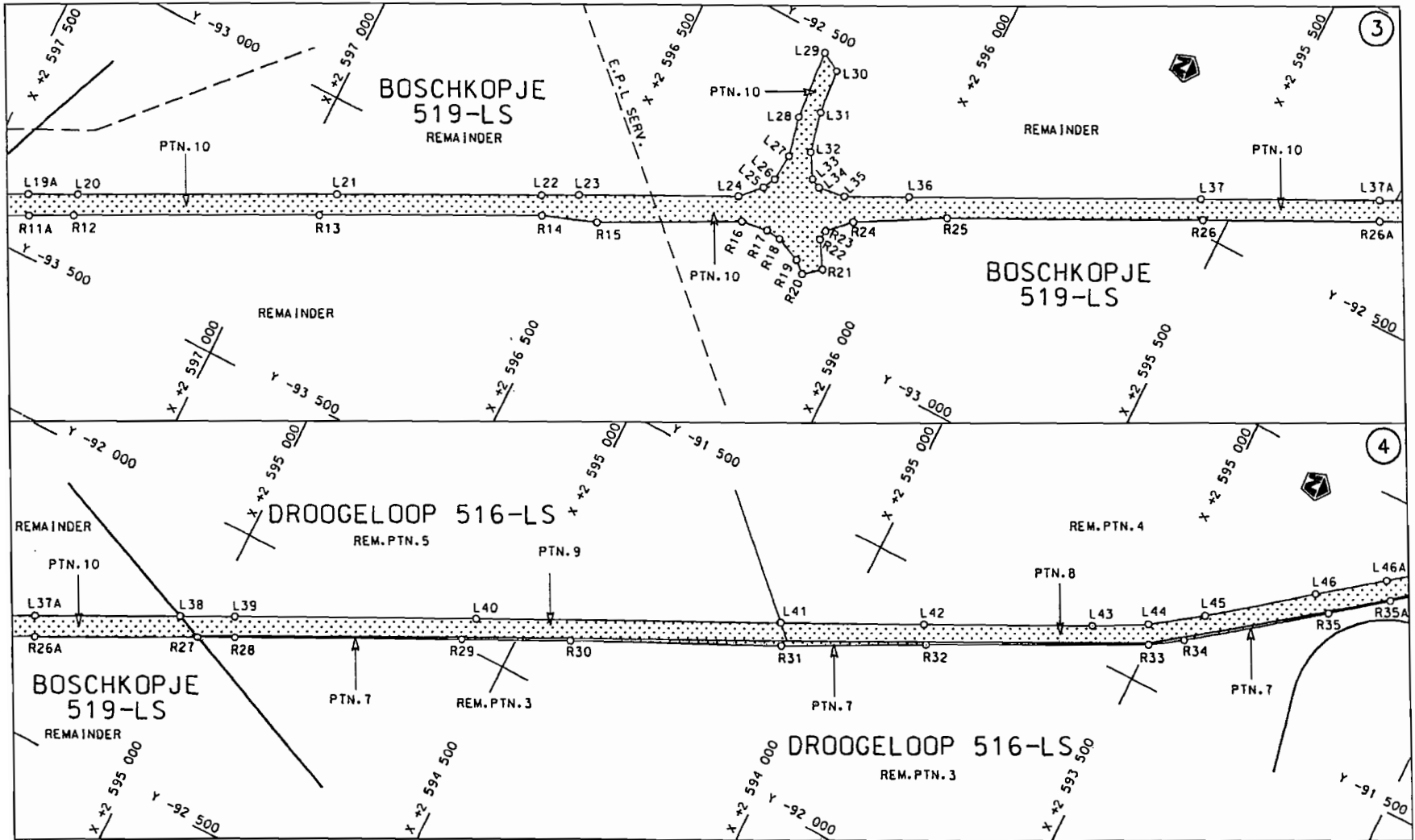

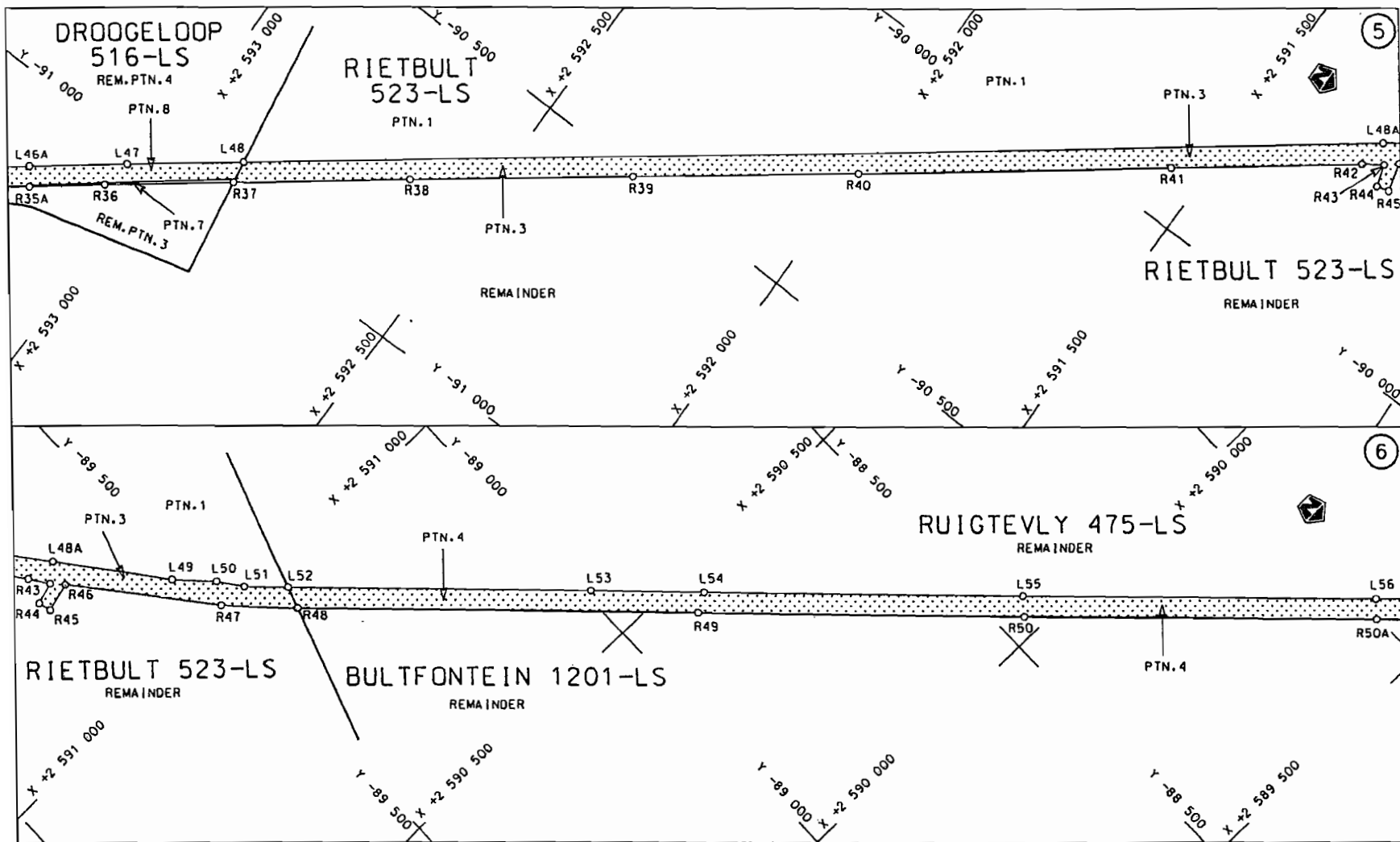

<p>Suid-Afrikaanse Padagentskap Bpk. South African National Roads Agency Ltd.</p>	<p>Die figuur getoon The figure shown</p>		<p>steldie padreserwe voor van 'n gedeelte represents the road reserve of a portion van Nasionale Roete Seksie of National Route R36 Section 9</p>	<p>Vel Sheet 2 van of 7 P P657/08</p>
---	---	--	--	---

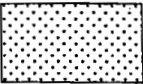

Suid-Afrikaanse Padagenskap Bpk. South African National Roads Agency Ltd.	Die figuur getoon The figure shown	 stel die padreserwe voor van 'n gedeelte represents the road reserve of a portion van Nasionale Roete R36 of National Route R36	Vel Sheet 3 van 7 of 9 P P657/08
--	---------------------------------------	---	-------------------------------------

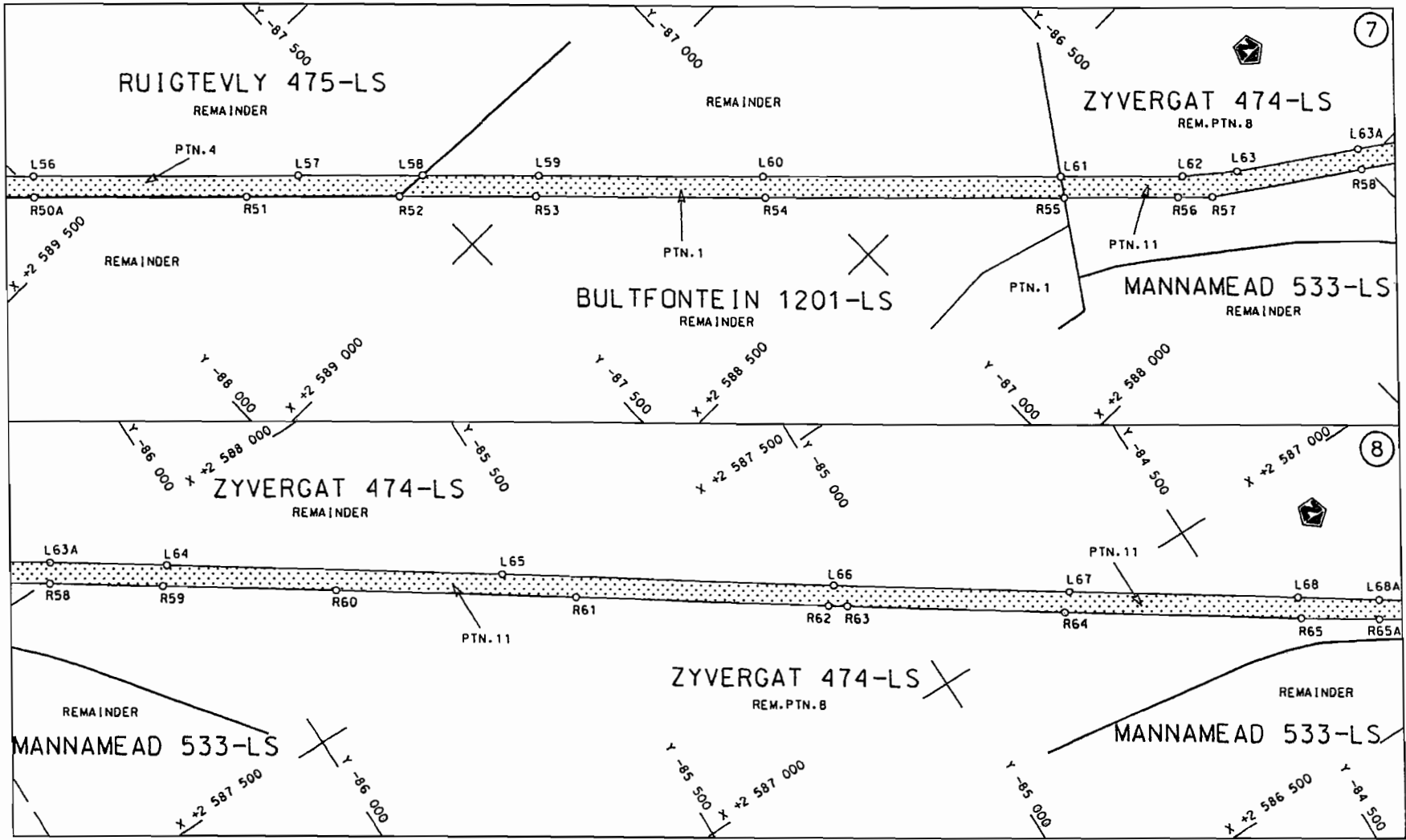
D.O.9.A



<p>Suid-Afrikaanse Padagentskop Bpk. South African National Roads Agency Ltd.</p>	<p>Die figuur getoon The figure shown</p>		<p>stel die padreserwe voor van 'n gedeelte represents the road reserve of a portion van Nasionale Roete of National Route</p> <p>R36</p> <p>Seksie Section</p> <p>9</p>	<p>Vel Sheet</p> <p>4 of 7</p> <p>P P657/08</p>
---	---	--	--	---

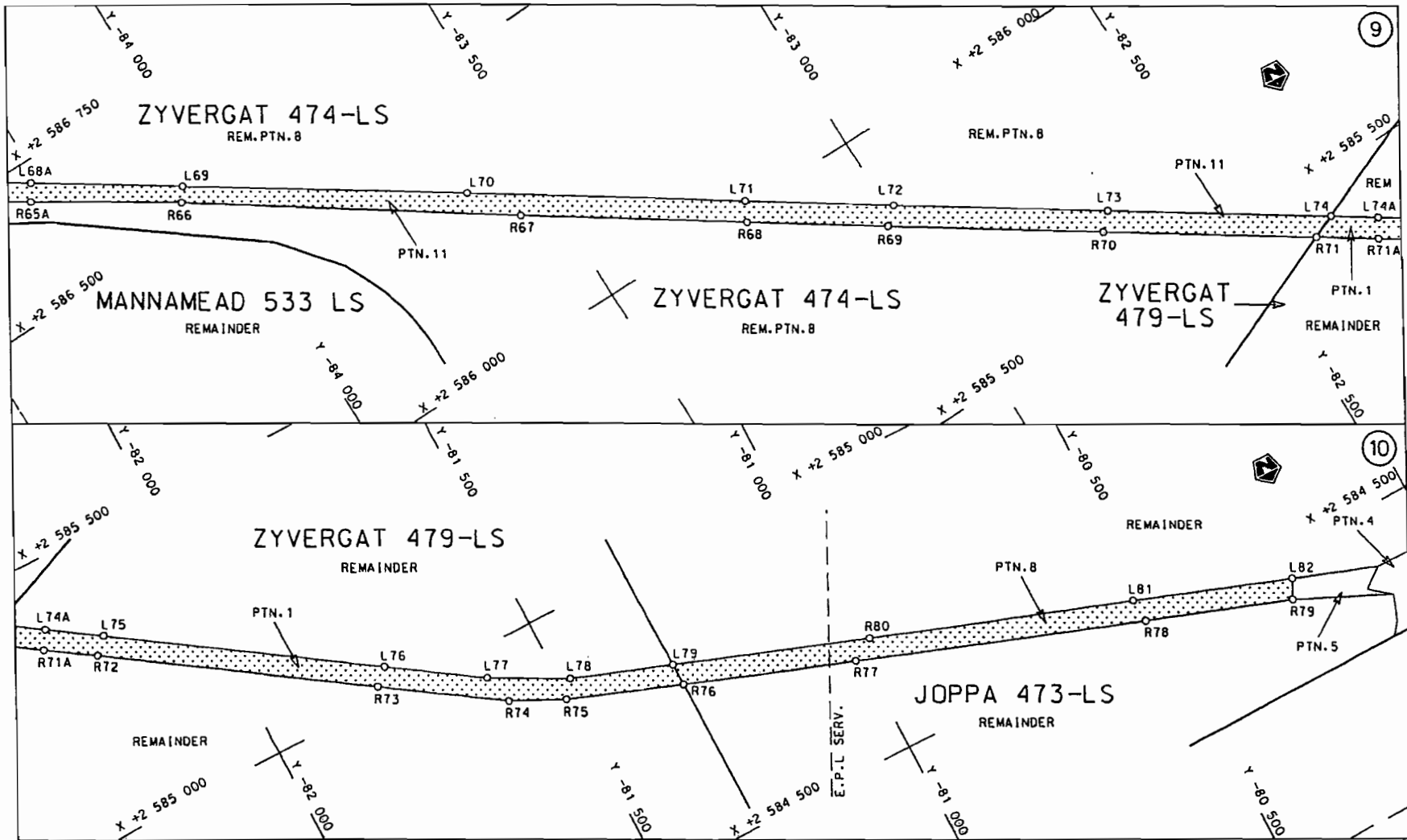

STAATSKOERANT, 28 JULIE 2008

No. 31274 9

Suid-Afrikaanse Padogentskap Bpk. South African National Roads Agency Ltd.	Die figuur getoon The figure shown		steldie padreserwe voor van 'n gedeelte represents the road reserve of a portion van Nasionale Roete of National Route	R36	Seksie Section	9	<table border="1"> <tr> <td>Vel</td> <td>5</td> <td>von</td> <td>7</td> </tr> <tr> <td>Sheet</td> <td></td> <td>of</td> <td></td> </tr> <tr> <td>P</td> <td colspan="3">P657/08</td> </tr> </table>	Vel	5	von	7	Sheet		of		P	P657/08		
Vel	5	von	7																
Sheet		of																	
P	P657/08																		

D.O.9.A

PADRESERWE KOÖRDINATE				ROAD RESERVE CO-ORDINATES			
LINKERKANT/LEFT HAND SIDE				REGTERKANT/RIGHT HAND SIDE			
	Y	X	WG 29°		Y	X	
L1	-94 592.14	2 599 276.83		R1	-94 593.51	2 599 235.88	
L2	-94 585.75	2 599 274.58		R2	-94 381.37	2 599 136.91	
L3	-94 467.18	2 599 215.42		R3	-94 333.18	2 599 123.25	
L4	-94 429.28	2 599 194.39		R4	-94 189.11	2 598 846.92	
L5	-94 383.64	2 599 173.65		R5	-94 008.02	2 598 497.42	
L6	-94 382.60	2 599 242.56		R6	-93 936.64	2 598 359.85	
L7	-94 335.38	2 599 235.19		R7	-93 789.58	2 598 084.22	
L8	-94 321.70	2 599 190.94		R8	-93 792.62	2 598 082.41	
L9	-94 314.55	2 599 175.52		R9	-93 713.96	2 597 930.89	
L10	-94 168.46	2 598 888.80		R10	-93 545.11	2 597 604.74	
L11	-94 158.47	2 598 870.98		R11	-93 510.19	2 597 537.79	
L12	-94 105.76	2 598 886.85		R12	-93 398.28	2 597 323.31	
L13	-94 104.61	2 598 873.19		R13	-93 196.97	2 596 935.11	
L14	-94 141.86	2 598 842.53		R14	-93 015.34	2 596 586.29	
L15	-94 128.18	2 598 812.56		R15	-92 981.34	2 596 495.48	
L16	-93 971.31	2 598 511.17		R16	-92 859.01	2 596 268.09	
L17	-93 976.12	2 598 509.36		R17	-92 851.54	2 596 221.27	
L18	-93 462.74	2 597 518.70		R18	-92 854.46	2 596 195.10	
L19	-93 454.62	2 597 515.43		R19	-92 873.52	2 596 151.37	
L20	-93 362.44	2 597 333.30		R20	-92 890.34	2 596 132.09	
L21	-93 150.18	2 596 923.93		R21	-92 865.97	2 596 103.11	
L22	-92 983.96	2 596 602.78		R22	-92 821.44	2 596 130.30	
L23	-92 953.54	2 596 544.93		R23	-92 803.26	2 596 128.14	
L24	-92 822.64	2 596 293.07		R24	-92 767.29	2 596 091.05	
L25	-92 788.39	2 596 260.09		R25	-92 683.83	2 595 946.19	
L26	-92 766.72	2 596 248.94		R26	-92 476.79	2 595 540.39	
L27	-92 718.88	2 596 244.57		R27	-92 202.76	2 595 003.16	
L28	-92 648.98	2 596 259.81		R28	-92 172.52	2 594 943.87	
L29	-92 525.96	2 596 268.76		R29	-91 990.68	2 594 585.93	
L30	-92 545.65	2 596 234.93		R30	-91 903.67	2 594 415.12	
L31	-92 622.98	2 596 228.81		R31	-91 737.81	2 594 079.45	
L32	-92 693.69	2 596 213.23		R32	-91 616.11	2 593 851.52	
L33	-92 734.46	2 596 188.86		R33	-91 433.69	2 593 499.39	
L34	-92 742.33	2 596 171.88		R34	-91 397.79	2 593 447.42	
L35	-92 734.84	2 596 125.06		R35	-91 236.70	2 593 241.47	
L36	-92 682.53	2 596 022.70		R36	-91 083.90	2 593 049.69	
L37	-92 445.85	2 595 559.62		R37	-90 942.04	2 592 869.03	
L38	-92 184.49	2 595 046.86		R38	-90 749.62	2 592 623.98	
L39	-92 140.31	2 594 960.17		R39	-90 505.91	2 592 313.10	
L40	-91 946.02	2 594 579.65		R40	-90 255.47	2 591 994.49	
L41	-91 700.97	2 594 098.96		R41	-89 911.26	2 591 556.33	
L42	-91 585.18	2 593 871.24		R42	-89 700.92	2 591 288.90	
L43	-91 449.24	2 593 604.09		R43	-89 677.80	2 591 256.01	
L44	-91 400.70	2 593 516.00		R44	-89 716.21	2 591 244.27	
L45	-91 341.52	2 593 434.11		R45	-89 710.05	2 591 222.14	
L46	-91 217.18	2 593 276.64		R46	-89 659.52	2 591 236.42	
L47	-91 030.85	2 593 039.44		R47	-89 483.66	2 591 020.22	
L48	-90 902.41	2 592 875.35		R48	-89 388.03	2 590 923.52	
L49	-89 516.44	2 591 113.65		R49	-88 877.51	2 590 435.25	
L50	-89 460.54	2 591 056.51		R50	-88 456.33	2 590 031.50	
L51	-89 431.00	2 591 015.70		R51	-87 729.40	2 589 336.58	

Vel 6
Sheet

Van 7
of

P657/08

PADRESERWE KOÖRDINATE				/	ROAD RESERVE CO-ORDINATES			
LINKERKANT/LEFT HAND SIDE					REGTERKANT/RIGHT HAND SIDE			
	Y	X	WG	29°		Y	X	
L52	-89 374.94	2 590 961.32			R52	-87 534.06	2 589 149.89	
L53	-88 988.96	2 590 591.90			R53	-87 358.95	2 588 982.44	
L54	-88 844.84	2 590 453.86			R54	-87 063.51	2 588 698.99	
L55	-88 432.51	2 590 059.69			R55	-86 676.14	2 588 328.42	
L56	-87 978.84	2 589 625.53			R56	-86 529.74	2 588 188.51	
L57	-87 637.72	2 589 299.07			R57	-86 485.36	2 588 146.65	
L58	-87 478.77	2 589 147.54			R58	-86 258.28	2 587 994.85	
L59	-87 330.32	2 589 004.92			R59	-86 091.54	2 587 884.22	
L60	-87 041.08	2 588 727.91			R60	-85 833.31	2 587 712.84	
L61	-86 654.98	2 588 359.09			R61	-85 480.15	2 587 477.35	
L62	-86 498.40	2 588 209.26			R62	-85 103.80	2 587 226.68	
L63	-86 422.44	2 588 147.79			R63	-85 075.93	2 587 208.48	
L64	-86 065.73	2 587 910.79			R64	-84 752.70	2 586 993.36	
L65	-85 568.89	2 587 580.11			R65	-84 402.68	2 586 760.52	
L66	-85 076.41	2 587 252.31			R66	-84 058.82	2 586 539.93	
L67	-84 725.99	2 587 019.15			R67	-83 561.72	2 586 200.11	
L68	-84 387.44	2 586 793.86			R68	-83 227.40	2 585 978.55	
L69	-84 040.99	2 586 563.20			R69	-83 015.65	2 585 837.73	
L70	-83 621.02	2 586 284.10			R70	-82 696.56	2 585 625.27	
L71	-83 210.30	2 586 010.85			R71	-82 380.61	2 585 414.86	
L72	-82 987.61	2 585 862.70			R72	-82 207.77	2 585 300.32	
L73	-82 670.04	2 585 651.24			R73	-81 791.74	2 585 023.30	
L74	-82 338.98	2 585 431.14			R74	-81 596.23	2 584 894.96	
L75	-82 181.90	2 585 326.63			R75	-81 504.72	2 584 851.43	
L76	-81 765.00	2 585 049.13			R76	-81 308.19	2 584 781.41	
L77	-81 611.73	2 584 949.35			R77	-81 013.04	2 584 676.78	
L78	-81 481.23	2 584 881.00			R78	-80 520.36	2 584 503.39	
L79	-81 308.62	2 584 820.51			R79	-80 271.16	2 584 416.34	
L80	-80 971.86	2 584 701.79						
L81	-80 523.70	2 584 544.12						
L82	-80 254.41	2 584 449.54						

Vel 7 Van 7
Sheet of

P657/08