

Government Gazette Staatskoerant

REPUBLIC OF SOUTH AFRICA
REPUBLIEK VAN SUID-AFRIKA

Vol. 517

Pretoria, 28 July
Julie 2008

No. 31275

CONTENTS**INHOUD**

<i>No.</i>	<i>Page No.</i>	<i>Gazette No.</i>	<i>No.</i>	<i>Bladsy No.</i>	<i>Koerant No.</i>
GOVERNMENT NOTICE			GOEWERMENSKENNISGEWING		
Transport, Department of			Vervoer, Departement van		
<i>Government Notice</i>			<i>Goewermentskennisgewing</i>		
802			802		
South African National Roads Agency Limited and the National Roads Act (7/1998): The South African National Roads Agency Limited: Declaration amendment of National Road R36 Section 8: Amendment of Declaration No. 1229 of 2004.....	3	31275	Suid-Afrikaanse Nasionale Padagentskap Beperk en die Nasionale Paaie Wet (7/1998): Die Suid-Afrikaanse Nasionale Padagentskap Beperk: Verklaring wysiging van Nasionale Pad R36 Seksie 8: Wysiging van Verklaring No. 1229 van 2004	4	31275

**GOVERNMENT NOTICE
GOEWERMENSKENNISGEWING**

**DEPARTMENT OF TRANSPORT
DEPARTEMENT VAN VERVOER**

No. 802

28 July 2008

**THE SOUTH AFRICAN NATIONAL ROADS
AGENCY LIMITED**

Registration No: 98/09584/06

DECLARATION AMENDMENT OF NATIONAL ROAD R36 SECTION 8

AMENDMENT OF DECLARATION No. 1229 OF 2004

By virtue of section 40 (1)(b) of the South African National Roads Agency Limited and the National Roads Act, 1998 (Act No. 7 of 1998), I hereby amend Declaration No. 1229 of 2004 by substituting the section of the descriptive declaration from Duiwelskloof up to Soekmekaar in paragraphs (II) and (III) of the Annexure, with the subjoined sheets 1 to 15 of Plan No.P658/08.

(National Road R36 Section 8: Duiwelskloof - Soekmekaar)



MINISTER OF TRANSPORT

No. 802

28 Julie 2008

**DIE SUID-AFRIKAANSE NASIONALE
PADAGENTSKAP BEPERK**

Registrasie No: 98/09584/06

VERKLARING WYSIGING VAN NASIONALE PAD R36 SEKSIE 8.

WYSIGING VAN VERKLARING NO. 1229 VAN 2004.

Kragtens Artikel 40(1)(b) van die Suid-Afrikaanse Nasionale Padagentskap Beperk en die Nasionale Paaie Wet, 1998 (Wet No.7 van 1998), wysig ek hiermee Verklaring no.1229 van 2004 deur die gedeelte van die beskrywende verklaring vanaf Duiwelskloof tot by Soekmekaar in paragrawe (II) en (III) van die bylae, te vervang met meegaande velle 1 tot 15 van Plan No. P658/08.

(Nasionale Pad R36 Seksie 8: Duiwelskloof - Soekmekaar)



MINISTER VAN VERVOER

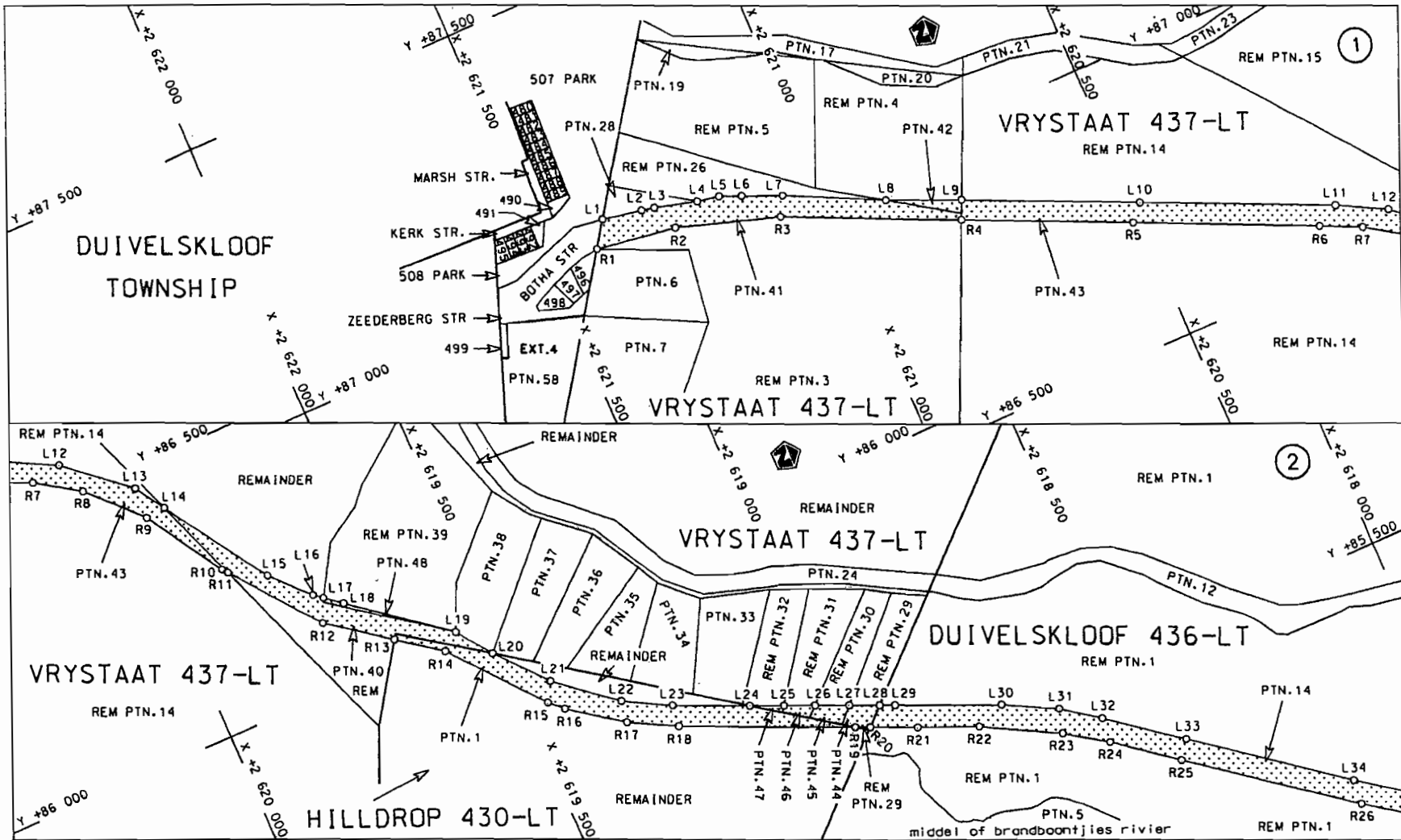

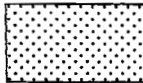
<p>Die Suid Afrikaanse Nasionale Padagentskap Beperk The South African National Roads Agency Limited</p>	<p>Die figuur getoon The figure shown</p> 	<p>steldie padreserwe voor van 'n gedeelte represents the road reserve of a portion van Nasionale Roete R36 Sektie 8 of National Route R36 Section 8</p>	<p>Vel Sheet 1 van 15 of 15 Plan P658/08</p>
--	--	--	--

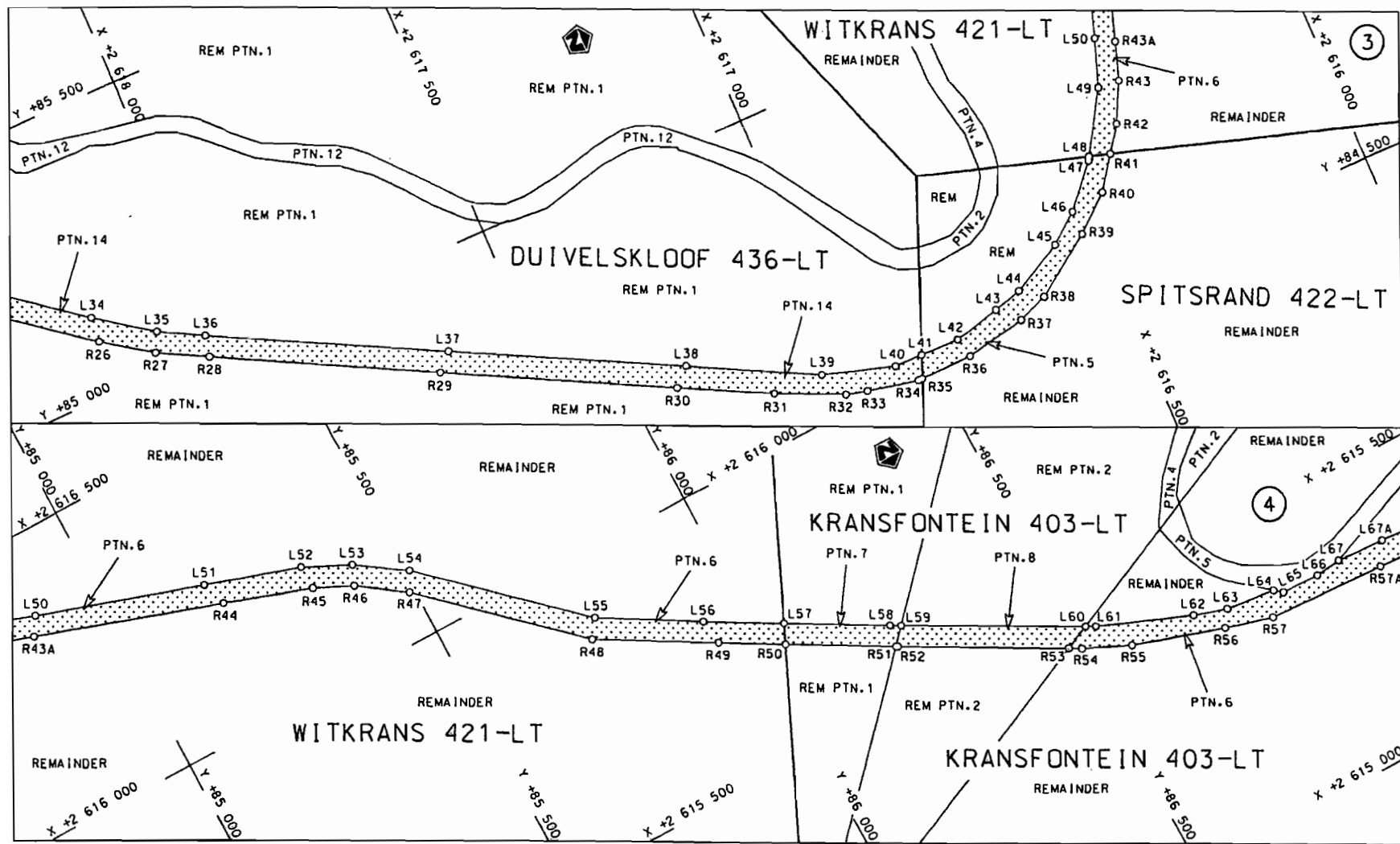

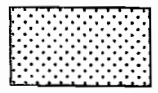
Die Suid Afrikaanse Nasionale Padagentskap Beperk The South African National Roads Agency Limited	Die figuur getoon The figure shown		steldie padreserwe voor van 'n gedeelte represents the road reserve of a portion van Nasionale Roete R36 of National Route	Vel Sheet 2 van of 15
			Seksie Section 8	Plan P658/08

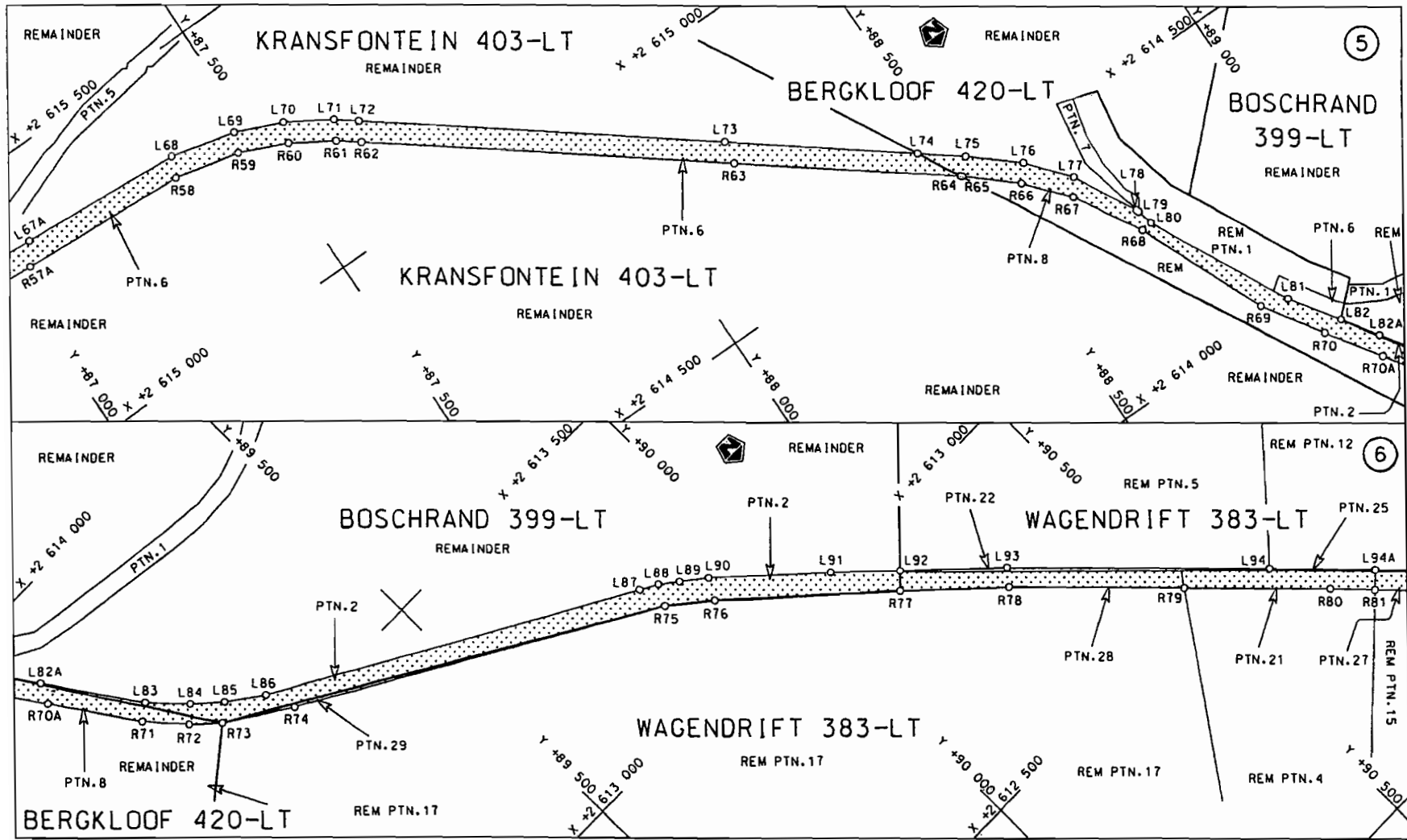

Die Suid Afrikaanse Nasionale Padagentskap Beperk
 The South African National Roads Agency Limited

Die figuur getoon
 The figure shown

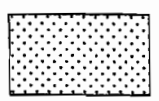

steldie podreserve voor van 'n gedeelte
 represents the road reserve of a portion
 van Nasionale Roete R36 Sektie 8
 of National Route R36 Section 8

Vel Sheet 3 van 15
 Plan P658/08

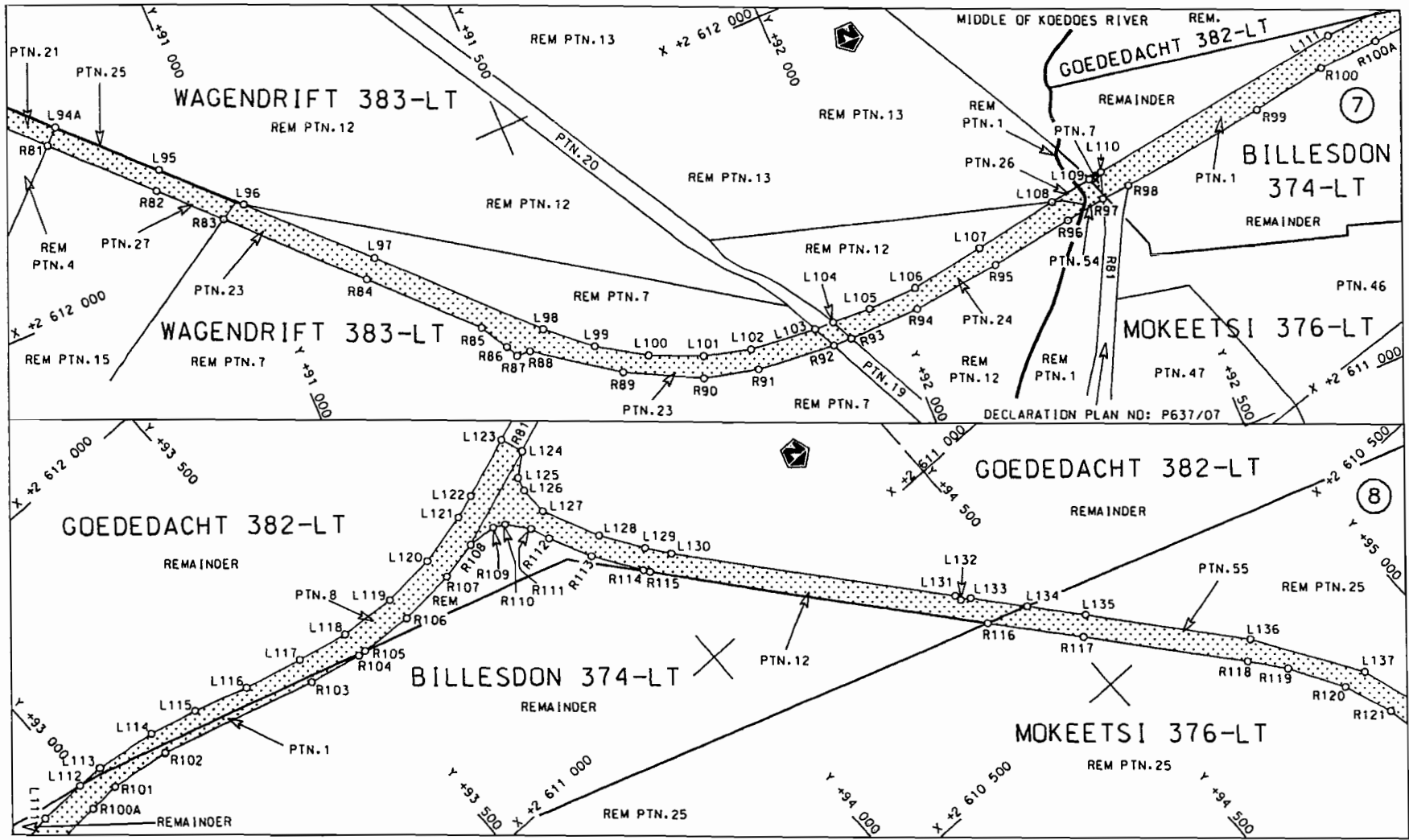

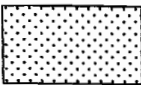
<p>Die Suid Afrikaanse Nasionale Padagentskap Beperk The South African National Roads Agency Limited</p>	<p>Die figuur getoon The figure shown</p>		<p>stel die padreserwe voor van 'n gedeelte represents the road reserve of a portion van Nasionale Roete R36 Sektie 8 of National Route</p>	<p>Vel Sheet 4 van 15 Plan P658/08</p>
--	---	--	---	--

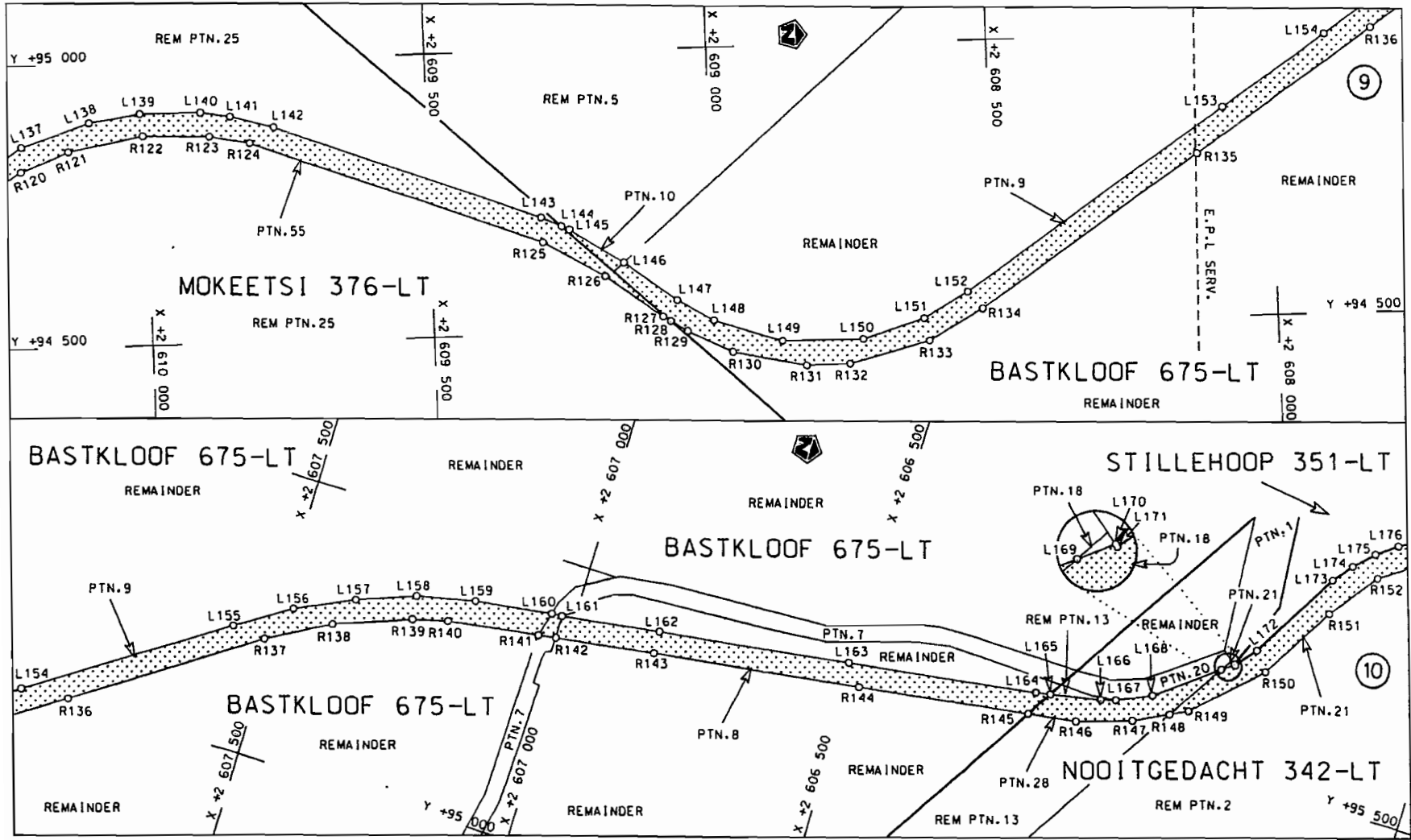

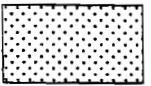
Die Suid Afrikaanse Nasionale Padogenskop Beperk The South African National Roads Agency Limited	Die figuur getoon The figure shown		steldie padreserwe voor van 'n gedeelte represents the road reserve of a portion van Nasionale Roete R36 of National Route R36 Seksie Section 8	Vel Sheet 5 van of 15 Plan P658/08
---	---------------------------------------	--	---	---------------------------------------

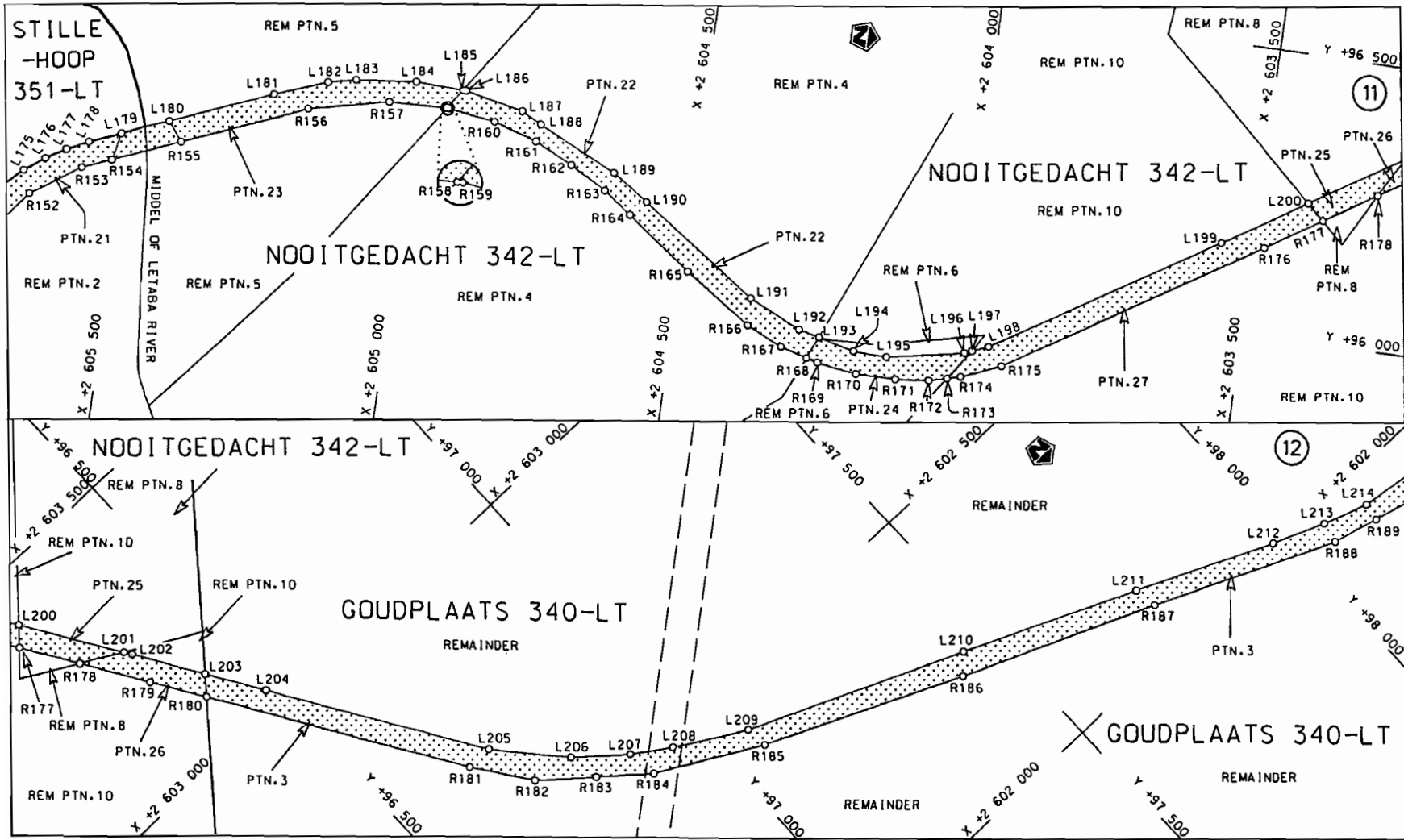

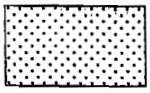
<p>Die Suid Afrikaanse Nasionale Padogentskop Beperk The South African National Roads Agency Limited</p>	<p>Die figuur getoon The figure shown</p> 	<p>steldie podreserwe voor van 'n gedeelte represents the road reserve of a portion von Nasionale Roete R36 of National Route</p> <p>Seksie 8</p>	<p>Vel Sheet 6 van 15 Plon P658/08</p>
--	--	---	--

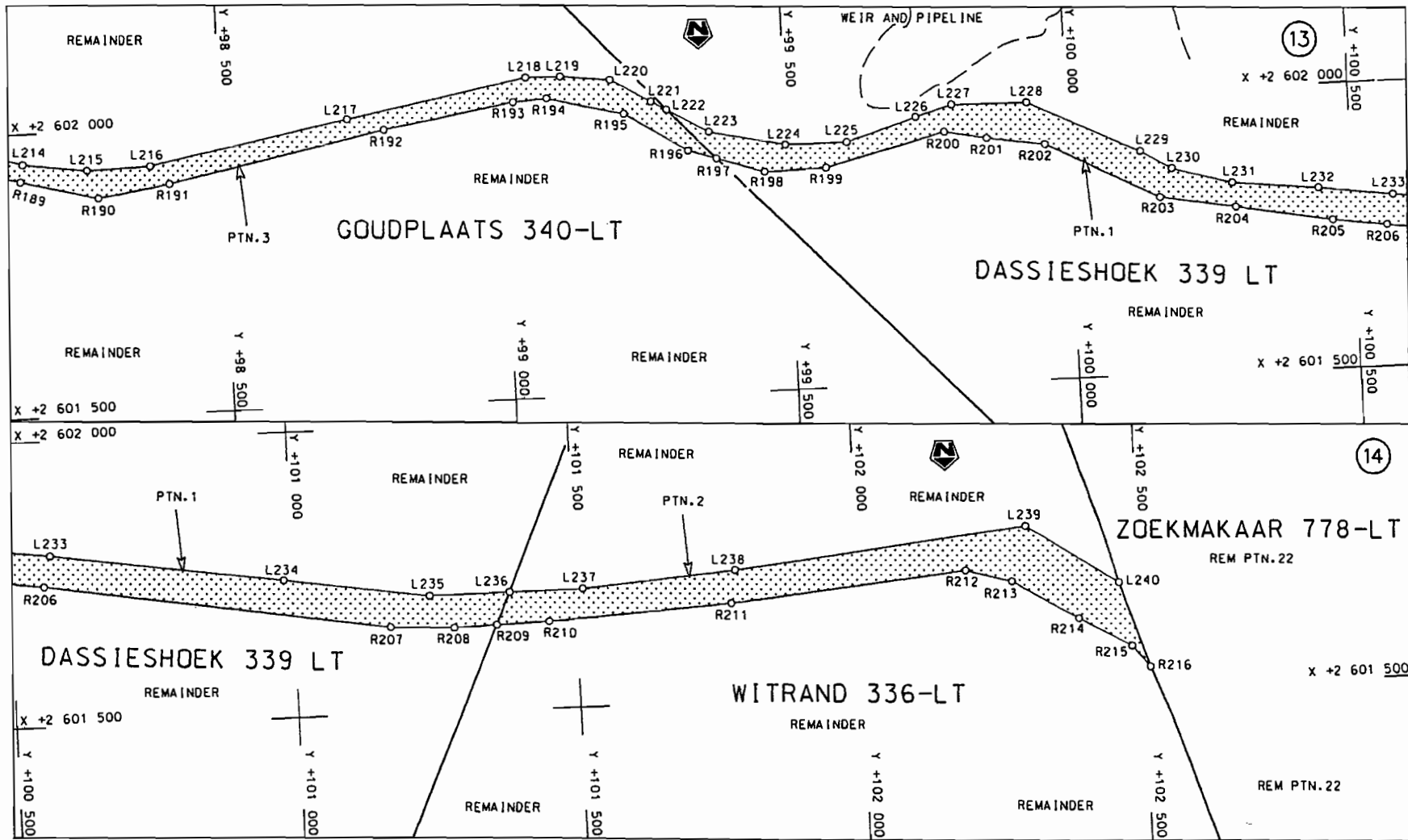

Die Suid Afrikaanse Nasionale Padagentskap Beperk
The South African National Roads Agency Limited

Die figuur getoon
The figure shown

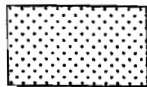

steldie padreserwe voor van 'n gedeelte
represents the road reserve of a portion
van Nasionale Roete
of National Route

R36

Seksie
Section

8

Vel
Sheet 7 van
of 15

Plan
P658/08

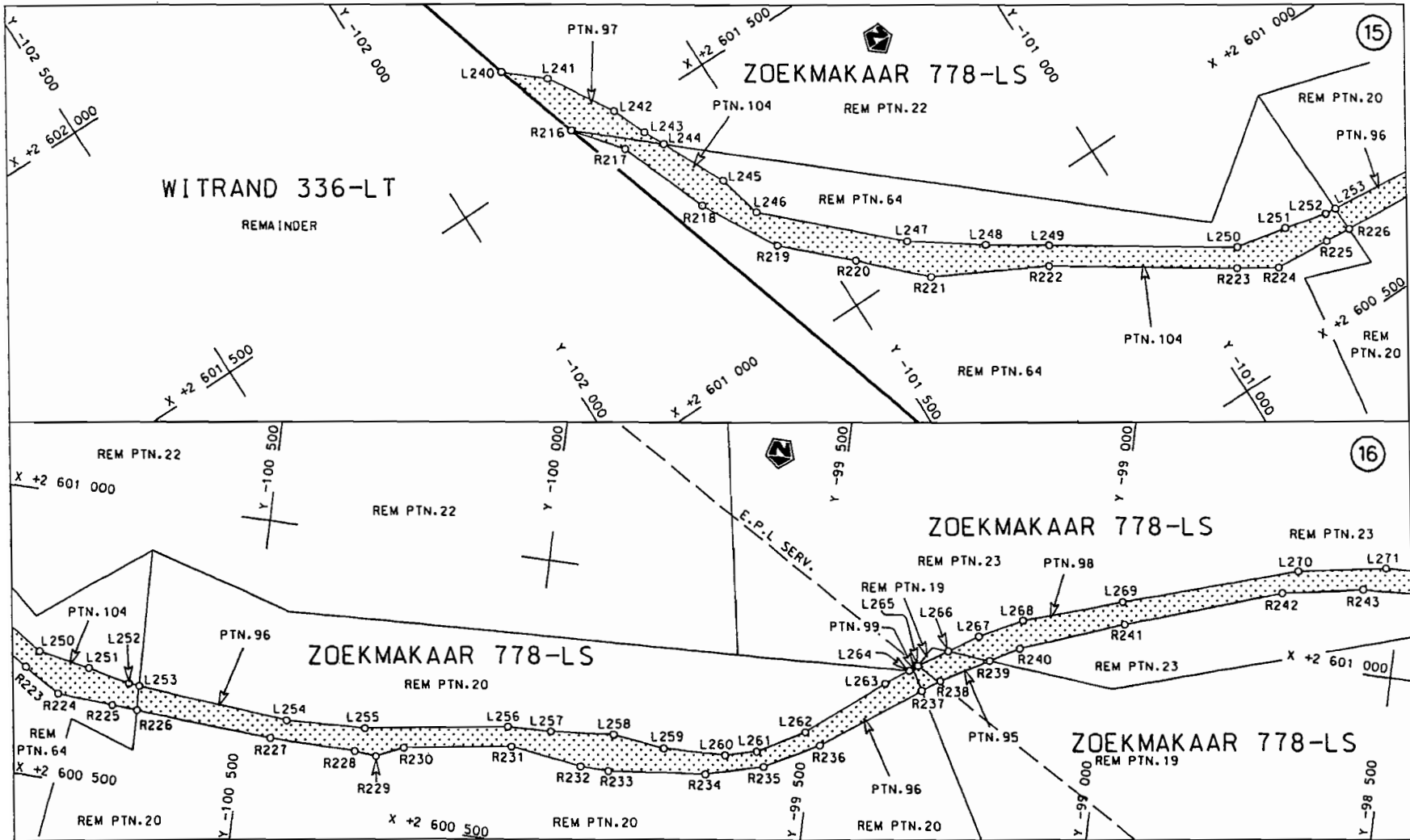

<p>Die Suid Afrikaanse Nasionale Padagentskap Beperk The South African National Roads Agency Limited</p>	<p>Die figuur getoon The figure shown</p>		<p>steldie padreserwe voor van 'n gedeelte represents the road reserve of a portion van Nasionale Roete R36 Sektie 8 of National Route Section 8</p>	<p>Vel Sheet 8 van 15 Plan P658/08</p>
--	---	--	--	--

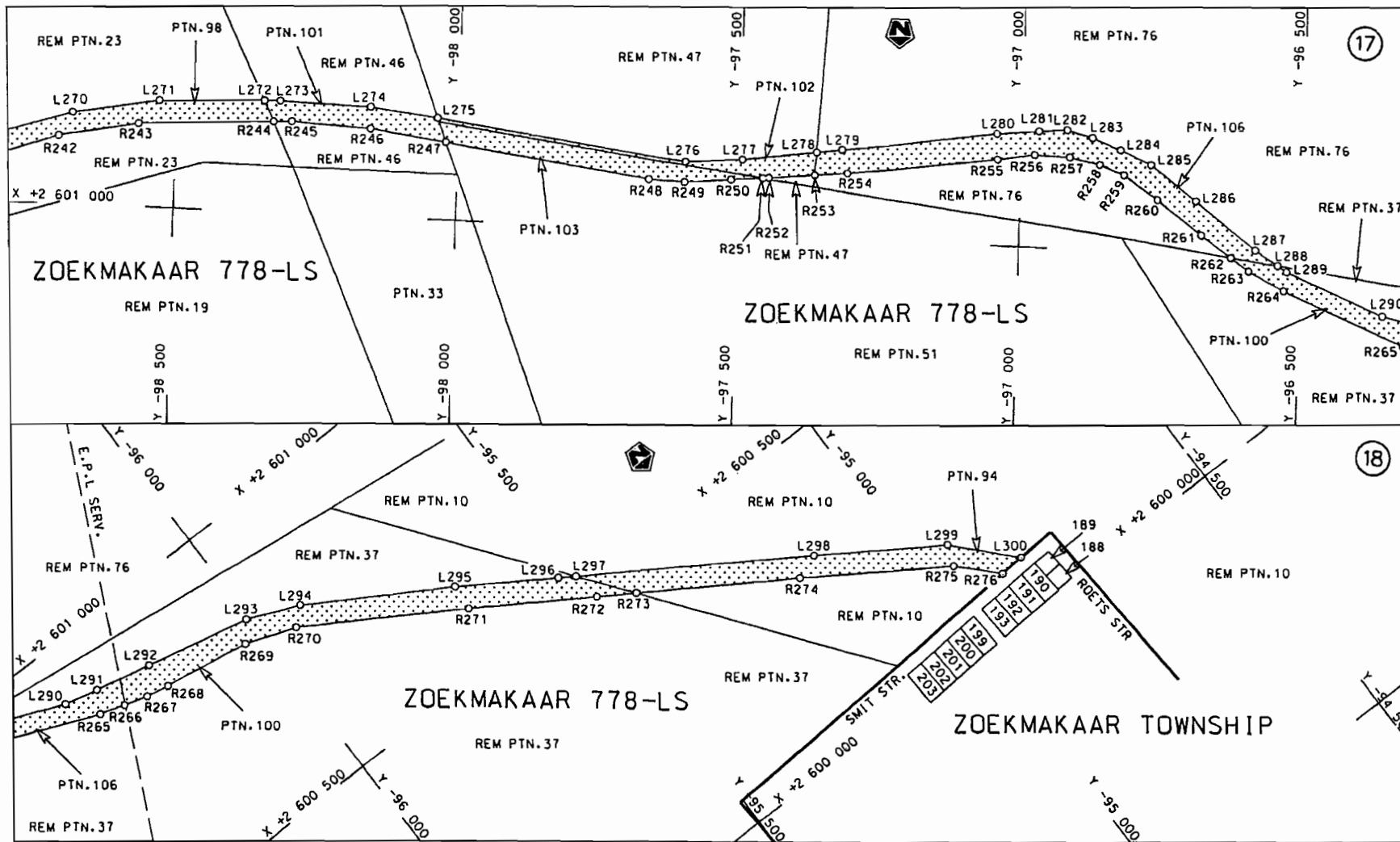

<p>Die Suid Afrikaanse Nasionale Padagentskap Beperk The South African National Roads Agency Limited</p>	<p>Die figuur getoon The figure shown</p>	 <p>steldie padreserve voor van 'n gedeelte represents the road reserve of a portion van Nasionale Roete R36 Seksie of National Route R36 Section</p>	<p>Vel Sheet 9 van of 15 Plan P658/08</p>
			<p>8</p>

PADRESERWE KOÖRDINATE / ROAD RESERVE CO-ORDINATES						
LINKERKANT/LEFT HAND SIDE				REGTERKANT/RIGHT HAND SIDE		
	Y	X	WG 31°	Y	X	
L1	87 098.71	2 621 377.64		R1	87 055.36	2 621 407.91
L2	87 085.92	2 621 307.85		R2	87 034.56	2 621 265.24
L3	87 081.06	2 621 285.30		R3	86 977.68	2 621 084.95
L4	87 061.11	2 621 211.18		R4	86 843.58	2 620 790.79
L5	87 053.72	2 621 171.52		R5	86 716.62	2 620 512.27
L6	87 038.16	2 621 134.00		R6	86 578.49	2 620 211.29
L7	87 009.80	2 621 066.52		R7	86 546.03	2 620 140.89
L8	86 928.43	2 620 899.79		R8	86 497.08	2 620 065.96
L9	86 875.19	2 620 776.22		R9	86 409.90	2 619 981.31
L10	86 743.51	2 620 486.94		R10	86 272.58	2 619 894.99
L11	86 600.00	2 620 170.18		R11	86 263.37	2 619 887.60
L12	86 555.87	2 620 086.07		R12	86 114.65	2 619 768.36
L13	86 464.56	2 619 979.50		R13	86 038.34	2 619 664.69
L14	86 413.15	2 619 945.52		R14	85 984.30	2 619 591.28
L15	86 230.18	2 619 824.60		R15	85 829.96	2 619 459.09
L16	86 166.89	2 619 763.81		R16	85 808.13	2 619 436.25
L17	86 154.94	2 619 748.84		R17	85 743.26	2 619 345.44
L18	86 132.19	2 619 720.34		R18	85 701.22	2 619 264.08
L19	86 007.26	2 619 560.75		R19	85 574.99	2 618 974.89
L20	85 947.38	2 619 514.85		R20	85 564.32	2 618 950.44
L21	85 862.16	2 619 439.73		R21	85 530.60	2 618 873.18
L22	85 780.79	2 619 338.92		R22	85 488.42	2 618 772.87
L23	85 738.31	2 619 259.38		R23	85 418.34	2 618 642.61
L24	85 684.29	2 619 133.37		R24	85 370.63	2 618 571.03
L25	85 660.26	2 619 077.32		R25	85 291.27	2 618 467.77
L26	85 638.13	2 619 025.70		R26	85 093.68	2 618 206.76
L27	85 613.76	2 618 968.85		R27	85 035.82	2 618 122.00
L28	85 592.53	2 618 919.32		R28	84 992.16	2 618 037.14
L29	85 581.79	2 618 894.28		R29	84 804.40	2 617 669.35
L30	85 507.24	2 618 720.75		R30	84 615.46	2 617 293.10
L31	85 460.14	2 618 630.74		R31	84 538.19	2 617 137.21
L32	85 414.37	2 618 566.74		R32	84 486.32	2 617 019.92
L33	85 321.92	2 618 445.22		R33	84 477.09	2 616 982.18
L34	85 137.41	2 618 202.03		R34	84 458.29	2 616 891.24
L35	85 069.18	2 618 105.21		R35	84 458.52	2 616 883.72
L36	85 015.60	2 618 028.78		R36	84 461.40	2 616 789.13
L37	84 832.65	2 617 641.19		R37	84 483.15	2 616 679.87
L38	84 644.44	2 617 262.81		R38	84 504.09	2 616 625.31
L39	84 535.00	2 617 045.45		R39	84 576.49	2 616 519.26
L40	84 497.79	2 616 918.33		R40	84 629.85	2 616 456.64
L41	84 497.27	2 616 868.02		R41	84 685.84	2 616 416.48
L42	84 496.53	2 616 797.84		R42	84 730.21	2 616 384.67
L43	84 516.97	2 616 714.54		R43	84 796.81	2 616 350.93
L44	84 531.11	2 616 663.48		R44	85 187.58	2 616 222.38
L45	84 578.25	2 616 571.11		R45	85 342.55	2 616 169.63
L46	84 619.22	2 616 519.26		R46	85 409.19	2 616 138.99
L47	84 690.87	2 616 456.58		R47	85 490.41	2 616 082.86
L48	84 696.88	2 616 452.88		R48	85 737.70	2 615 859.26
L49	84 799.87	2 616 389.47		R49	85 933.99	2 615 750.24
L50	84 882.39	2 616 360.01		R50	86 038.72	2 615 692.34
L51	85 172.26	2 616 266.44		R51	86 211.06	2 615 597.06

Vel	10	Van	15	P658/08
Sheet		of		

PADRESERWE KOÖRDINATE / ROAD RESERVE CO-ORDINATES						
LINKERKANT/LEFT HAND SIDE				REGTERKANT/RIGHT HAND SIDE		
	Y	X	WG 31°		Y	X
L52	85 341.43	2 616 211.53		R52	86 213.93	2 615 595.47
L53	85 424.08	2 616 172.71		R53	86 481.51	2 615 449.26
L54	85 508.36	2 616 116.54		R54	86 501.93	2 615 438.10
L55	85 760.23	2 615 890.67		R55	86 583.20	2 615 401.37
L56	85 927.60	2 615 795.60		R56	86 732.00	2 615 350.35
L57	86 053.90	2 615 725.65		R57	86 827.92	2 615 326.92
L58	86 219.23	2 615 634.09		R58	87 343.01	2 615 297.22
L59	86 236.74	2 615 624.66		R59	87 459.70	2 615 270.34
L60	86 526.01	2 615 468.93		R60	87 544.21	2 615 233.83
L61	86 542.37	2 615 460.12		R61	87 615.99	2 615 189.41
L62	86 704.74	2 615 396.51		R62	87 651.71	2 615 162.58
L63	86 762.76	2 615 378.29		R63	88 179.58	2 614 760.61
L64	86 851.52	2 615 367.91		R64	88 500.43	2 614 515.03
L65	86 865.48	2 615 356.38		R65	88 502.89	2 614 513.15
L66	86 932.88	2 615 354.50		R66	88 582.38	2 614 443.17
L67	86 979.31	2 615 358.95		R67	88 645.19	2 614 371.03
L68	87 357.72	2 615 332.65		R68	88 714.07	2 614 254.68
L69	87 473.93	2 615 303.51		R69	88 811.16	2 614 026.54
L70	87 557.46	2 615 268.63		R70	88 878.83	2 613 923.49
L71	87 634.41	2 615 221.76		R71	89 036.54	2 613 691.60
L72	87 669.29	2 615 194.97		R72	89 091.18	2 613 628.77
L73	88 186.79	2 614 800.96		R73	89 134.36	2 613 587.93
L74	88 459.10	2 614 590.92		R74	89 244.77	2 613 515.11
L75	88 527.30	2 614 538.31		R75	89 836.04	2 613 172.30
L76	88 606.13	2 614 471.42		R76	89 905.08	2 613 116.84
L77	88 665.78	2 614 400.15		R77	90 148.74	2 612 894.00
L78	88 724.69	2 614 289.52		R78	90 290.39	2 612 760.38
L79	88 726.90	2 614 284.58		R79	90 509.62	2 612 537.02
L80	88 733.63	2 614 256.43		R80	90 691.93	2 612 351.28
L81	88 858.91	2 614 009.34		R81	90 747.05	2 612 293.57
L82	88 916.12	2 613 926.38		R82	90 891.29	2 612 142.54
L83	89 063.17	2 613 710.86		R83	90 981.51	2 612 049.04
L84	89 117.85	2 613 652.08		R84	91 172.09	2 611 851.52
L85	89 163.06	2 613 610.86		R85	91 324.85	2 611 693.30
L86	89 223.68	2 613 566.66		R86	91 352.31	2 611 644.49
L87	89 824.75	2 613 223.07		R87	91 362.65	2 611 623.23
L88	89 854.65	2 613 206.32		R88	91 386.73	2 611 621.91
L89	89 884.55	2 613 183.61		R89	91 522.79	2 611 523.15
L90	89 925.91	2 613 152.14		R90	91 650.73	2 611 457.45
L91	90 086.26	2 613 004.21		R91	91 747.88	2 611 433.12
L92	90 175.08	2 612 919.16		R92	91 888.50	2 611 418.44
L93	90 312.84	2 612 787.27		R93	91 921.70	2 611 417.63
L94	90 640.94	2 612 452.95		R94	92 049.10	2 611 419.15
L95	90 910.19	2 612 175.64		R95	92 209.73	2 611 433.89
L96	91 025.13	2 612 058.70		R96	92 360.16	2 611 454.01
L97	91 200.23	2 611 880.57		R97	92 432.52	2 611 463.69
L98	91 424.07	2 611 648.14		R98	92 483.72	2 611 467.86
L99	91 495.35	2 611 584.90		R99	92 745.94	2 611 499.17
L100	91 576.01	2 611 533.15		R100	92 881.85	2 611 520.87
L101	91 666.20	2 611 493.80		R101	93 045.63	2 611 529.56
L102	91 749.40	2 611 470.84		R102	93 152.07	2 611 514.37

Vel	11	Van	15	P658/08
Sheet		of		

PADRESERWE KOÖRDINATE / ROAD RESERVE CO-ORDINATES					
LINKERKANT/LEFT HAND SIDE			REGTERKANT/RIGHT HAND SIDE		
	Y	X	WG 31°		X
L103	91 858.86	2 611 457.49		R103	93 433.16 2 611 433.21
L104	91 903.23	2 611 456.27		R104	93 525.96 2 611 413.65
L105	91 972.08	2 611 452.94		R105	93 539.62 2 611 412.81
L106	92 061.02	2 611 454.34		R106	93 632.83 2 611 407.06
L107	92 195.28	2 611 472.31		R107	93 735.98 2 611 415.18
L108	92 347.42	2 611 494.60		R108	93 805.82 2 611 429.72
L109	92 424.09	2 611 505.84		R109	93 856.16 2 611 425.64
L110	92 448.60	2 611 509.43		R110	93 875.85 2 611 416.01
L111	92 916.80	2 611 569.33		R111	93 905.09 2 611 380.15
L112	93 000.75	2 611 570.99		R112	93 918.06 2 611 346.90
L113	93 047.22	2 611 571.90		R113	93 954.04 2 611 288.69
L114	93 156.35	2 611 555.57		R114	94 006.34 2 611 196.24
L115	93 242.04	2 611 533.48		R115	94 012.80 2 611 186.53
L116	93 338.25	2 611 503.22		R116	94 407.33 2 610 723.71
L117	93 443.10	2 611 476.57		R117	94 519.31 2 610 593.43
L118	93 532.92	2 611 457.46		R118	94 708.71 2 610 370.81
L119	93 632.34	2 611 451.39		R119	94 755.30 2 610 313.69
L120	93 727.89	2 611 458.66		R120	94 811.66 2 610 221.50
L121	93 821.93	2 611 480.12		R121	94 844.35 2 610 136.44
L122	93 864.01	2 611 494.10		R122	94 868.79 2 610 004.41
L123	93 970.85	2 611 532.29		R123	94 864.63 2 609 886.42
L124	93 985.32	2 611 493.40		R124	94 851.25 2 609 814.79
L125	93 948.86	2 611 462.95		R125	94 662.77 2 609 300.32
L126	93 941.75	2 611 439.02		R126	94 600.81 2 609 193.03
L127	93 942.16	2 611 390.71		R127	94 526.55 2 609 092.69
L128	93 988.20	2 611 292.84		R128	94 518.05 2 609 079.26
L129	94 034.93	2 611 223.91		R129	94 499.70 2 609 050.25
L130	94 064.01	2 611 186.27		R130	94 461.36 2 608 972.31
L131	94 396.21	2 610 798.29		R131	94 433.98 2 608 840.65
L132	94 399.17	2 610 786.35		R132	94 434.92 2 608 762.80
L133	94 414.42	2 610 776.93		R133	94 472.02 2 608 619.55
L134	94 480.16	2 610 699.73		R134	94 525.66 2 608 523.17
L135	94 548.20	2 610 619.82		R135	94 787.58 2 608 133.27
L136	94 738.57	2 610 396.38		R136	95 001.79 2 607 815.07
L137	94 855.56	2 610 218.80		R137	95 206.28 2 607 513.59
L138	94 894.50	2 610 098.12		R138	95 268.21 2 607 403.81
L139	94 907.71	2 610 008.51		R139	95 318.76 2 607 273.67
L140	94 907.02	2 609 900.98		R140	95 334.86 2 607 213.38
L141	94 898.53	2 609 848.61		R141	95 360.66 2 607 052.26
L142	94 877.89	2 609 770.49		R142	95 365.52 2 607 021.91
L143	94 705.90	2 609 302.07		R143	95 393.30 2 606 848.38
L144	94 689.99	2 609 266.93		R144	95 449.36 2 606 483.70
L145	94 683.75	2 609 253.14		R145	95 495.85 2 606 183.59
L146	94 624.13	2 609 158.85		R146	95 509.00 2 606 098.70
L147	94 555.10	2 609 066.68		R147	95 540.41 2 606 003.51
L148	94 517.39	2 609 003.26		R148	95 570.32 2 605 945.14
L149	94 478.47	2 608 882.34		R149	95 585.80 2 605 914.94
L150	94 477.79	2 608 737.55		R150	95 692.41 2 605 805.55
L151	94 511.35	2 608 627.58		R151	95 824.15 2 605 725.76
L152	94 556.15	2 608 548.84		R152	95 910.15 2 605 660.56
L153	94 868.27	2 608 084.89		R153	95 969.23 2 605 575.74

Vel	12	Van	15	P658/08
Sheet		of		

PADRESERWE KOÖRDINATE / ROAD RESERVE CO-ORDINATES					
LINKERKANT/LEFT HAND SIDE			REGTERKANT/RIGHT HAND SIDE		
			WG 31°	X	
L154	94	993.40	2 607 899.04	R154	95 990.13 2 605 525.99
L155	95	211.54	2 607 573.68	R155	96 039.29 2 605 408.96
L156	95	272.41	2 607 478.40	R156	96 130.65 2 605 191.47
L157	95	321.52	2 607 377.26	R157	96 164.23 2 605 051.41
L158	95	360.16	2 607 278.41	R158	96 169.47 2 604 950.70
L159	95	383.43	2 607 176.29	R159	96 169.62 2 604 947.76
L160	95	403.65	2 607 040.78	R160	96 159.22 2 604 863.46
L161	95	405.45	2 607 022.84	R161	96 136.39 2 604 785.59
L162	95	432.13	2 606 849.87	R162	96 105.16 2 604 717.82
L163	95	484.35	2 606 513.09	R163	96 069.50 2 604 652.03
L164	95	535.40	2 606 181.36	R164	96 033.99 2 604 602.13
L165	95	540.47	2 606 155.82	R165	95 952.73 2 604 487.00
L166	95	558.00	2 606 067.43	R166	95 876.49 2 604 368.96
L167	95	565.76	2 606 041.73	R167	95 848.05 2 604 304.69
L168	95	592.60	2 605 982.88	R168	95 835.44 2 604 256.83
L169	95	673.20	2 605 881.18	R169	95 830.08 2 604 236.48
L170	95	688.54	2 605 861.78	R170	95 821.12 2 604 166.35
L171	95	687.33	2 605 860.33	R171	95 822.54 2 604 096.35
L172	95	723.93	2 605 831.14	R172	95 829.21 2 604 037.25
L173	95	882.31	2 605 736.59	R173	95 838.10 2 604 005.42
L174	95	916.68	2 605 709.37	R174	95 844.67 2 603 981.92
L175	95	949.81	2 605 676.38	R175	95 874.40 2 603 916.70
L176	95	975.91	2 605 641.63	R176	96 150.52 2 603 480.43
L177	95	996.76	2 605 607.17	R177	96 213.17 2 603 382.71
L178	96	015.13	2 605 569.61	R178	96 272.34 2 603 290.41
L179	96	038.31	2 605 515.45	R179	96 340.95 2 603 183.38
L180	96	071.94	2 605 434.78	R180	96 396.99 2 603 095.89
L181	96	146.36	2 605 256.28	R181	96 656.56 2 602 690.71
L182	96	182.23	2 605 162.73	R182	96 726.39 2 602 595.73
L183	96	193.45	2 605 114.41	R183	96 810.64 2 602 526.44
L184	96	206.54	2 605 010.12	R184	96 890.60 2 602 461.74
L185	96	204.66	2 604 926.98	R185	97 070.15 2 602 366.36
L186	96	204.52	2 604 920.89	R186	97 411.84 2 602 214.98
L187	96	184.68	2 604 817.16	R187	97 747.12 2 602 082.96
L188	96	167.16	2 604 781.21	R188	98 059.56 2 601 937.09
L189	96	103.47	2 604 640.60	R189	98 141.42 2 601 915.81
L190	96	060.95	2 604 575.78	R190	98 276.63 2 601 881.70
L191	95	924.06	2 604 370.14	R191	98 404.56 2 601 901.91
L192	95	883.55	2 604 277.14	R192	98 788.63 2 601 981.87
L193	95	875.31	2 604 239.88	R193	99 020.45 2 602 021.76
L194	95	859.88	2 604 176.00	R194	99 080.34 2 602 026.35
L195	95	858.94	2 604 116.98	R195	99 214.54 2 601 994.37
L196	95	887.29	2 603 981.17	R196	99 324.87 2 601 925.69
L197	95	892.87	2 603 968.03	R197	99 374.43 2 601 910.24
L198	95	904.81	2 603 939.87	R198	99 459.31 2 601 883.78
L199	96	147.25	2 603 557.35	R199	99 568.34 2 601 886.20
L200	96	239.74	2 603 412.69	R200	99 781.51 2 601 940.76
L201	96	342.16	2 603 252.52	R201	99 856.46 2 601 926.66
L202	96	350.38	2 603 239.66	R202	99 959.46 2 601 911.75
L203	96	422.47	2 603 126.90	R203	1 00 159.55 2 601 809.87
L204	96	482.81	2 603 032.52	R204	1 00 292.77 2 601 787.64

Vel	13	Van	15	P658/08
Sheet		of		

PADRESERWE KOÖRDINATE / ROAD RESERVE CO-ORDINATES							
LINKERKANT/LEFT HAND SIDE			REGTERKANT/RIGHT HAND SIDE				
			WG 31°		X		
L205	96 703.21	2 602 690.10	R205	100 463.05	2 601 759.26		
L206	96 801.27	2 602 581.29	R206	100 559.40	2 601 746.62		
L207	96 882.26	2 602 514.27	R207	101 169.41	2 601 652.29		
L208	96 946.54	2 602 472.41	R208	101 281.66	2 601 647.42		
L209	97 066.26	2 602 405.24	R209	101 358.36	2 601 649.83		
L210	97 441.34	2 602 245.67	R210	101 451.58	2 601 652.75		
L211	97 740.78	2 602 114.94	R211	101 774.04	2 601 673.51		
L212	97 975.70	2 602 010.95	R212	102 192.67	2 601 714.96		
L213	98 067.29	2 601 973.69	R213	102 273.57	2 601 692.47		
L214	98 146.53	2 601 946.41	R214	102 389.11	2 601 623.36		
L215	98 258.72	2 601 931.92	R215	102 481.52	2 601 571.28		
L216	98 371.37	2 601 935.09	R216	102 512.50	2 601 533.57		
L217	98 724.35	2 602 003.17					
L218	99 044.99	2 602 063.87					
L219	99 106.14	2 602 063.59					
L220	99 193.04	2 602 054.90					
L221	99 263.24	2 602 013.79					
L222	99 290.20	2 601 998.61					
L223	99 363.45	2 601 957.35					
L224	99 498.11	2 601 930.10					
L225	99 607.59	2 601 929.89					
L226	99 731.68	2 601 968.64					
L227	99 796.84	2 601 987.92					
L228	99 929.86	2 601 986.20					
L229	100 128.12	2 601 892.19					
L230	100 182.22	2 601 860.18					
L231	100 288.32	2 601 830.76					
L232	100 431.38	2 601 816.59					
L233	100 572.39	2 601 800.09					
L234	100 983.66	2 601 741.42					
L235	101 240.48	2 601 705.07					
L236	101 383.71	2 601 706.66					
L237	101 513.30	2 601 708.10					
L238	101 783.03	2 601 731.14					
L239	102 302.29	2 601 787.79					
L240	102 463.13	2 601 683.69					
			WG 29°		X		
Y	X		Y	X			
L240	-101 806.37	2 601 679.12	R216	-101 759.10	2 601 528.32		
L241	-101 743.93	2 601 625.42	R217	-101 695.95	2 601 450.11		
L242	-101 676.51	2 601 515.39	R218	-101 635.01	2 601 293.23		
L243	-101 650.77	2 601 455.83	R219	-101 561.28	2 601 162.22		
L244	-101 633.37	2 601 420.20	R220	-101 458.44	2 601 065.56		
L245	-101 579.74	2 601 310.41	R221	-101 361.56	2 600 969.27		
L246	-101 560.29	2 601 232.10	R222	-101 175.17	2 600 872.61		
L247	-101 362.95	2 601 044.74	R223	-100 896.54	2 600 688.94		
L248	-101 248.49	2 600 963.64	R224	-100 833.67	2 600 649.81		
L249	-101 155.04	2 600 902.61	R225	-100 737.04	2 600 642.70		
L250	-100 875.76	2 600 719.55	R226	-100 691.77	2 600 639.39		
			Vel	14	Van	15	P658/08
			Sheet		of		

PADRESERWE KOÖRDINATE / ROAD RESERVE CO-ORDINATES

LINKERKANT/LEFT HAND SIDE					REGTERKANT/RIGHT HAND SIDE						
					WG 29°	X					
L251	-100	785.51	2	600	701.53	R227	-100	451.87	2	600	621.80
L252	-100	712.08	2	600	684.20	R228	-100	300.67	2	600	619.98
L253	-100	692.77	2	600	682.34	R229	-100	262.34	2	600	615.97
L254	-100	427.41	2	600	656.81	R230	-100	215.33	2	600	637.84
L255	-100	287.96	2	600	662.38	R231	-100	025.81	2	600	666.69
L256	-100	036.48	2	600	700.41	R232	-99	901.93	2	600	649.70
L257	-99	960.61	2	600	702.69	R233	-99	851.91	2	600	648.06
L258	-99	850.77	2	600	712.69	R234	-99	680.87	2	600	667.13
L259	-99	759.75	2	600	701.15	R235	-99	580.49	2	600	694.90
L260	-99	650.45	2	600	704.98	R236	-99	485.85	2	600	745.15
L261	-99	595.82	2	600	719.45	R237	-99	318.69	2	600	864.94
L262	-99	514.63	2	600	764.76	R238	-99	288.49	2	600	886.58
L263	-99	385.23	2	600	868.97	R239	-99	205.48	2	600	934.03
L264	-99	345.58	2	600	897.49	R240	-99	155.89	2	600	962.37
L265	-99	331.16	2	600	907.86	R241	-98	977.46	2	601	029.21
L266	-99	280.71	2	600	940.75	R242	-98	707.18	2	601	120.80
L267	-99	229.71	2	600	973.68	R243	-98	566.59	2	601	145.97
L268	-99	156.05	2	601	011.65	R244	-98	328.46	2	601	159.47
L269	-98	985.90	2	601	067.85	R245	-98	295.57	2	601	161.33
L270	-98	683.97	2	601	162.27	R246	-98	155.62	2	601	154.32
L271	-98	530.99	2	601	188.00	R247	-98	021.72	2	601	136.67
L272	-98	345.92	2	601	195.69	R248	-97	660.40	2	601	089.03
L273	-98	317.48	2	601	196.87	R249	-97	595.99	2	601	086.35
L274	-98	156.28	2	601	192.67	R250	-97	513.83	2	601	094.33
L275	-98	037.35	2	601	177.85	R251	-97	457.72	2	601	099.43
L276	-97	595.57	2	601	122.82	R252	-97	446.93	2	601	100.41
L277	-97	494.71	2	601	131.33	R253	-97	366.22	2	601	109.00
L278	-97	364.03	2	601	150.01	R254	-97	308.42	2	601	115.16
L279	-97	318.79	2	601	156.48	R255	-97	042.12	2	601	150.90
L280	-97	044.44	2	601	195.74	R256	-96	976.45	2	601	161.89
L281	-96	969.71	2	601	203.50	R257	-96	914.44	2	601	160.07
L282	-96	919.90	2	601	207.40	R258	-96	860.91	2	601	149.15
L283	-96	875.04	2	601	195.50	R259	-96	817.07	2	601	132.32
L284	-96	824.40	2	601	176.72	R260	-96	756.99	2	601	091.99
L285	-96	769.96	2	601	152.63	R261	-96	677.64	2	601	033.63
L286	-96	689.15	2	601	092.90	R262	-96	624.18	2	600	996.44
L287	-96	580.86	2	601	011.37	R263	-96	592.08	2	600	974.11
L288	-96	540.04	2	600	986.04	R264	-96	528.11	2	600	942.56
L289	-96	523.43	2	600	975.74	R265	-96	313.74	2	600	855.14
L290	-96	351.87	2	600	906.28	R266	-96	269.99	2	600	842.06
L291	-96	292.29	2	600	892.52	R267	-96	228.50	2	600	828.99
L292	-96	192.77	2	600	870.05	R268	-96	187.77	2	600	821.51
L293	-96	007.15	2	600	828.05	R269	-96	034.30	2	600	795.59
L294	-95	915.40	2	600	790.31	R270	-95	945.36	2	600	763.44
L295	-95	677.15	2	600	650.41	R271	-95	681.06	2	600	605.49
L296	-95	521.68	2	600	552.17	R272	-95	487.86	2	600	485.32
L297	-95	495.43	2	600	535.74	R273	-95	428.35	2	600	448.33
L298	-95	135.63	2	600	310.47	R274	-95	180.08	2	600	294.01
L299	-94	935.52	2	600	181.55	R275	-94	949.91	2	600	145.22
L300	-94	845.48	2	600	084.50	R276	-94	889.24	2	600	081.96