

# Government Gazette Staatskoerant

REPUBLIC OF SOUTH AFRICA  
REPUBLIEK VAN SUID-AFRIKA

Vol. 521

Pretoria, 5 November 2008

**No. 31570**

**CONTENTS****INHOUD**

<i>No.</i>	<i>Page No.</i>	<i>Gazette No.</i>	<i>No.</i>	<i>Bladsy No.</i>	<i>Koerant No.</i>
<b>GOVERNMENT NOTICE</b>			<b>GOEWERMENTSKENNISGEWING</b>		
<b>Transport, Department of</b>			<b>Vervoer, Departement van</b>		
<i>Government Notice</i>			<i>Goewermentskennisgewing</i>		
1173			1173		
South African National Roads Agency Limited and the National Roads Act (7/1998): South African National Roads Agency Limited: Declaration amendment of National Road N6 Section 8 .....	3	31570	Suid-Afrikaanse Nasionale Padagentskap Beperk en die Nasionale Paaie Wet (7/1998): Suid-Afrikaanse Nasionale Padagentskap Beperk: Verklaring wysiging van Nasionale Pad N6 Seksie 8 .....	4	31570

---

**GOVERNMENT NOTICE  
GOEWERMENTSKENNISGEWING**

---

**DEPARTMENT OF TRANSPORT  
DEPARTEMENT VAN VERVOER**

**No. 1173**

**5 November 2008**

**THE SOUTH AFRICAN NATIONAL ROADS  
AGENCY LIMITED**

**Registration No: 98/09584/06**

---

**DECLARATION AMENDMENT OF NATIONAL ROAD N6 SECTION 8**

AMENDMENT OF DECLARATION NO. 930 OF 2006

By virtue of section 40 (1)(b) of the South African National Roads Agency Limited and the National Roads Act, 1998 (Act No. 7 of 1998), I hereby amend Declaration No. 930 of 2006 by substituting Annexure paragraph (II) and (III), with the subjoined sheets 1 to 13 of Plan No. P679/08.

**[National Road N6 Section 8: Reddersburg – N1(Bloemfontein)]**

  
\_\_\_\_\_  
**MINISTER OF TRANSPORT**

No. 1173

5 November 2008

**DIE SUID-AFRIKAANSE NASIONALE  
PADAGENTSKAP BEPERK**

Registrasie No: 98/09584/06

**VERKLARING WYSIGING VAN NASIONALE PAD N6 SEKSIE 8.**

WYSIGING VAN VERKLARING NO. 930 VAN 2006

Kragtens Artikel 40(1)(b) van die Suid-Afrikaanse Nasionale Padagentskap Beperk en die Nasionale Paaie Wet, 1998 (Wet No.7 van 1998), wysig ek hiermee Verklaring no. 930 van 2006 deur Bylae paragraaf (II) en (III), te vervang met meegaande velle 1 tot 13 van Plan No. P679/08.

**[Nasionale Pad N6 Seksie 8: Reddersburg – N1(Bloemfontein)]**

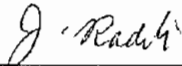

**MINISTER VAN VERVOER**

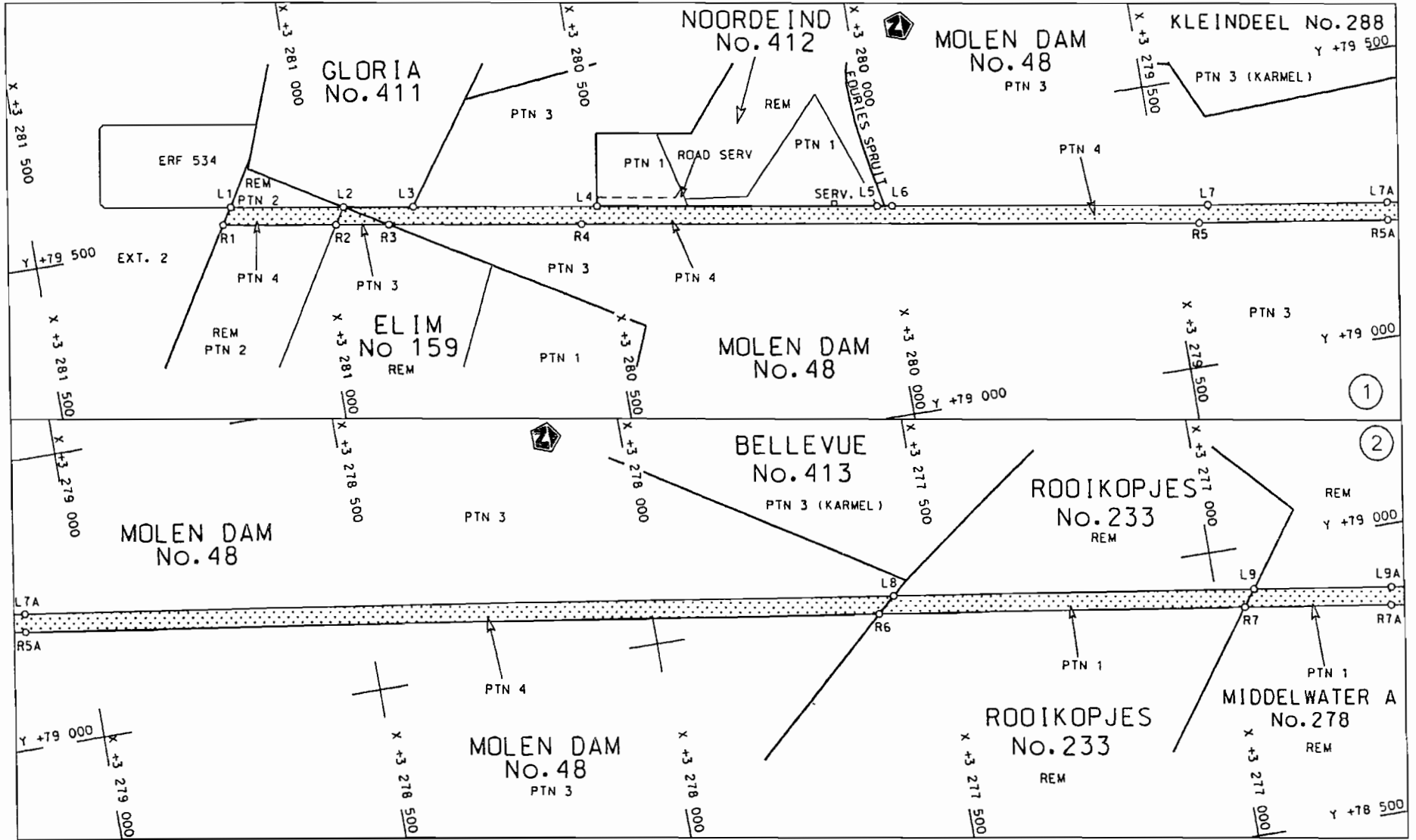

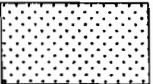
<p>Die Suid Afrikaanse Nasionale Padagentskop Beperk The South African National Roads Agency Limited</p>	<p>Die figuur getoon The figure shown</p>		<p>steldie podreserwe voor van 'n gedeelte represents the road reserve of a portion van Nasionale Roete N6 of National Route      N6      Seksie Section      8</p>	<p>Vel Sheet 1 of 13 Plon P679/08</p>
--	---	--	---	---

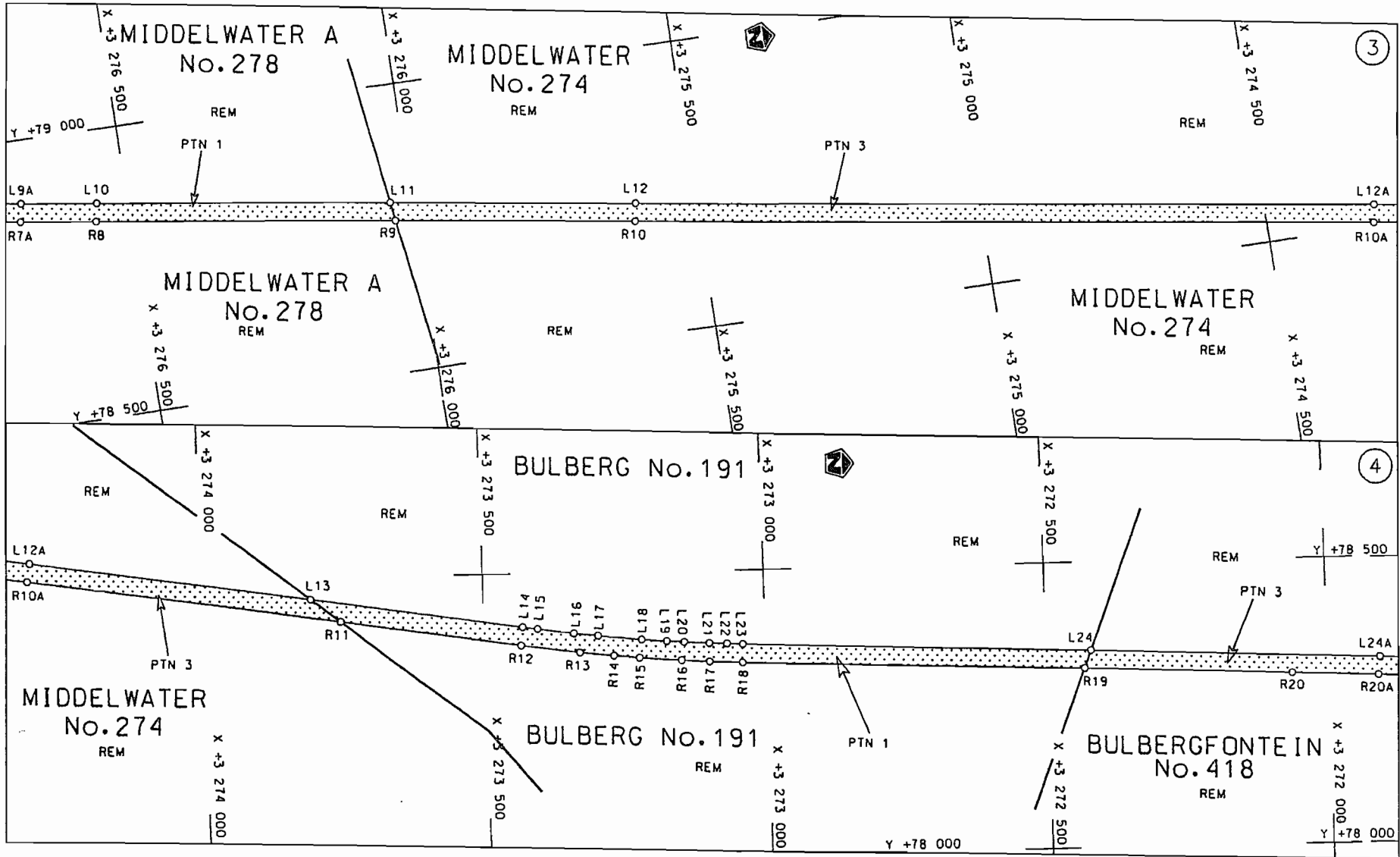

<p>Die Suid Afrikaanse Nasionale Padagentskap Beperk The South African National Roads Agency Limited</p>	<p>Die figuur getoon The figure shown</p>		<p>steldie padreserwe voor van 'n gedeelte represents the road reserve of a portion van Nasionale Roete N6 of National Route N6</p> <p>Seksie Section 8</p>	<p>Vel Sheet 2 van of 13 Plan P679/08</p>
--	---	--	---	---

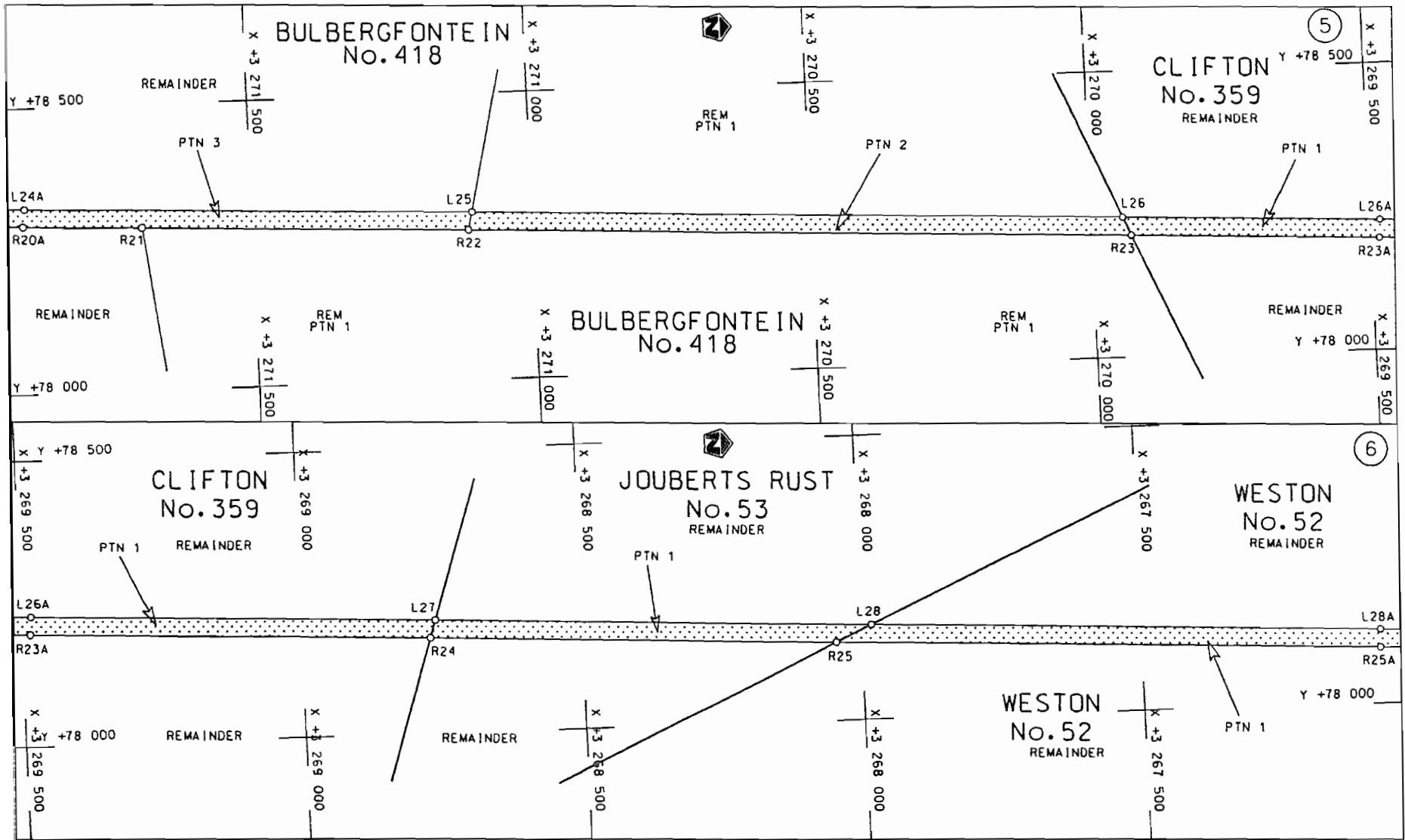

STAATSKOERANT, 5 NOVEMBER 2008

No. 31570 7

Die Suid Afrikaanse Nasionale Padagentskap Beperk The South African National Roads Agency Limited	Die figuur getoon The figure shown		stel die padreserwe voor van 'n gedeelte represents the road reserve of a portion van Nasionale Roete N6 of National Route      N6      Seksie Section      8	Vel Sheet 3 van of 13
				Plan P679/08

D.O.9.A

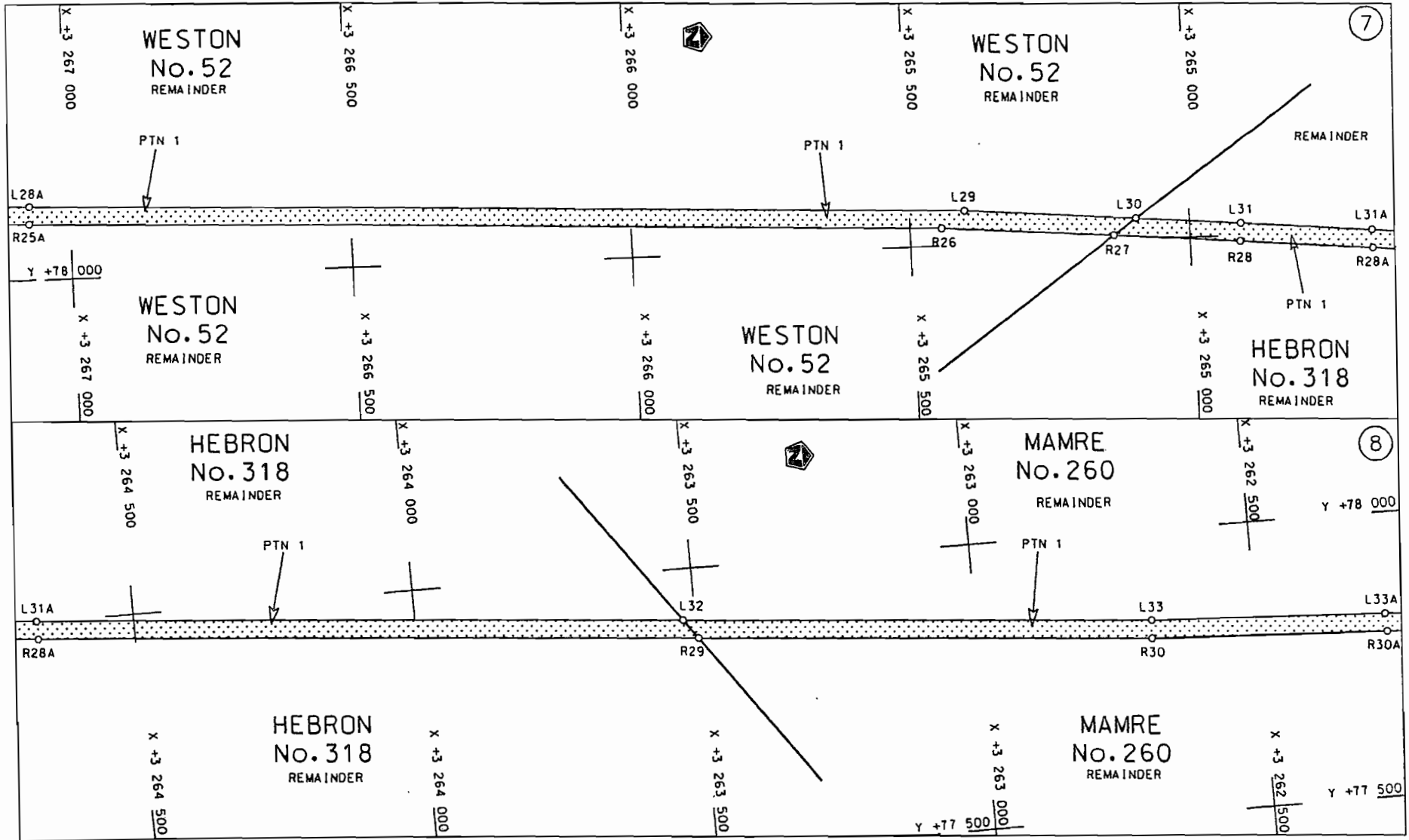

Die Suid Afrikaanse Nasionale Padagentskap Beperk  
The South African National Roads Agency Limited

Die figuur getoon  
The figure shown



steldie padreserwe voor van 'n gedeelte  
represents the road reserve of a portion  
van Nasionale Roete N6 Seksie  
of National Route 8 Section

Vel  
Sheet 4 van  
of 13

Plan P679/08



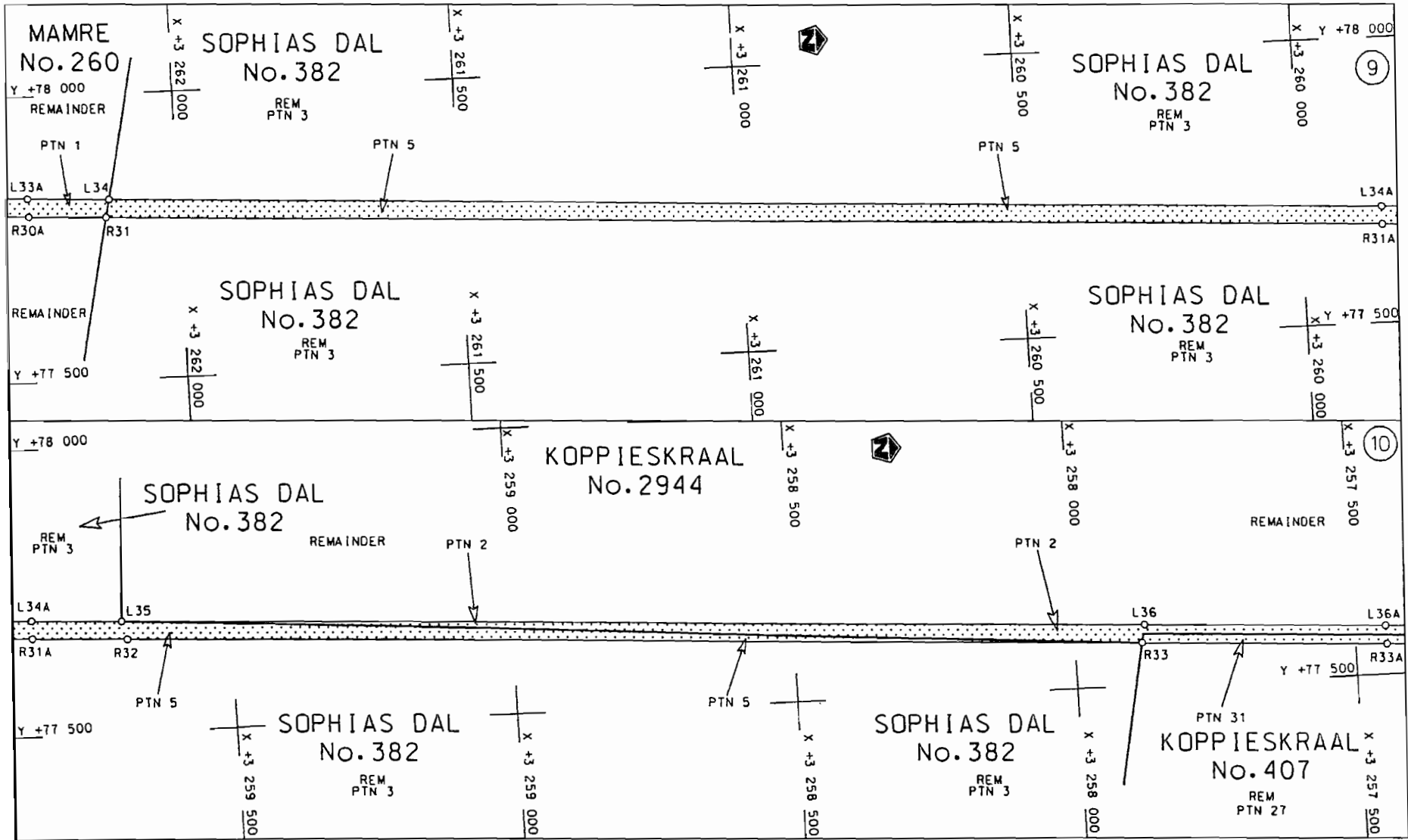

STAATSKOERANT, 5 NOVEMBER 2008

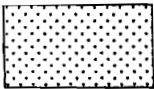
Die Suid Afrikaanse Nasionale Padagentskap Beperk The South African National Roads Agency Limited	Die figuur getoon		steldie padreserwe voor van 'n gedeelte	Vel	5	van	13
	The figure shown		represents the road reserve of a portion	of National Route	N6	Seksie	8

D.O.9.A

No. 31570 9

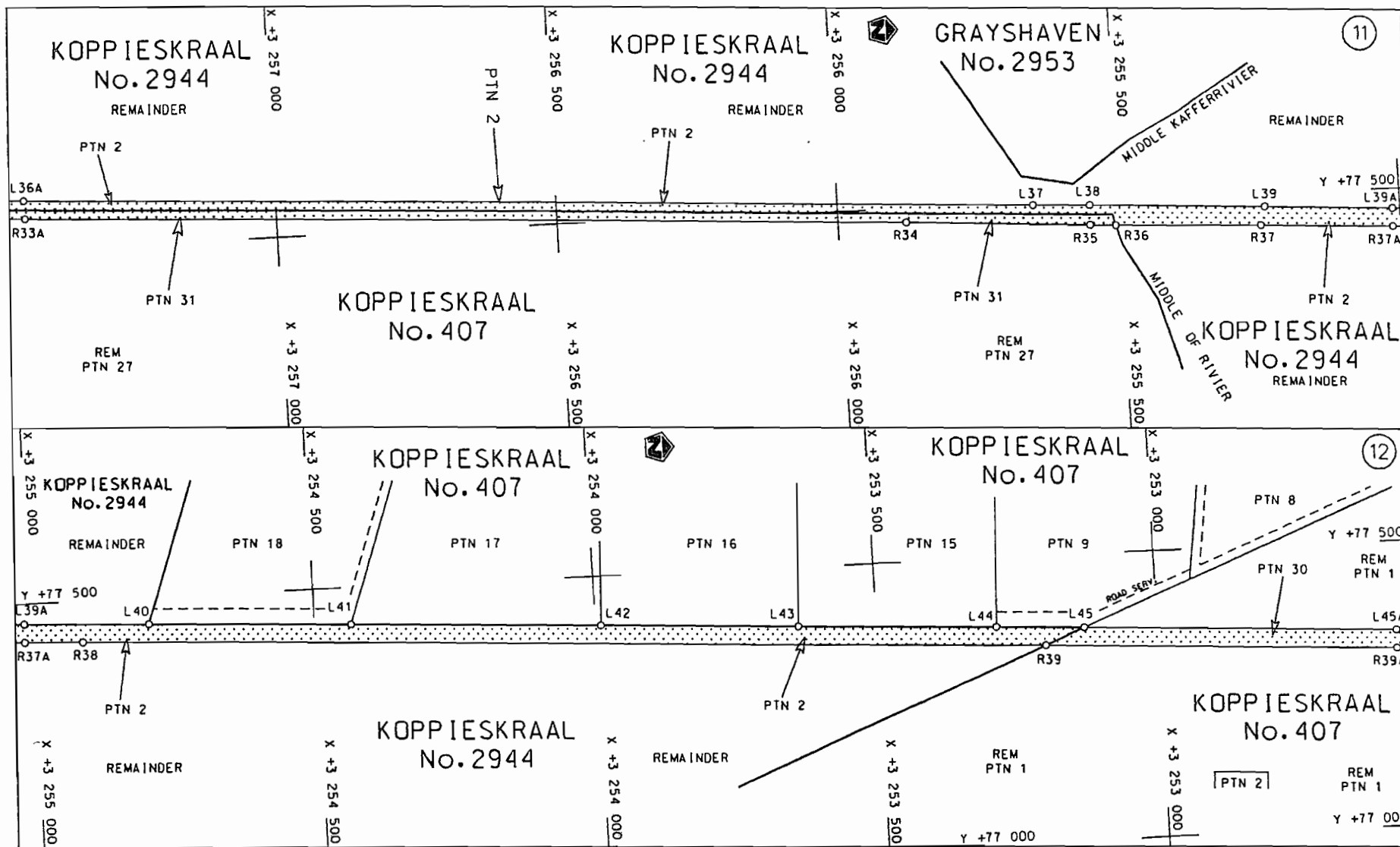

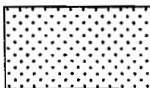
Die Suid Afrikaanse Nasionale Padagentskap Beperk The South African National Roads Agency Limited	Die figuur getoon The figure shown		steldie podreserve voor van 'n gedeelte represents the road reserve of a portion van Nasionale Roete N6      Seksie      8 of National Route      Section			Vel Sheet 6      von of 13
						Plan P679/08

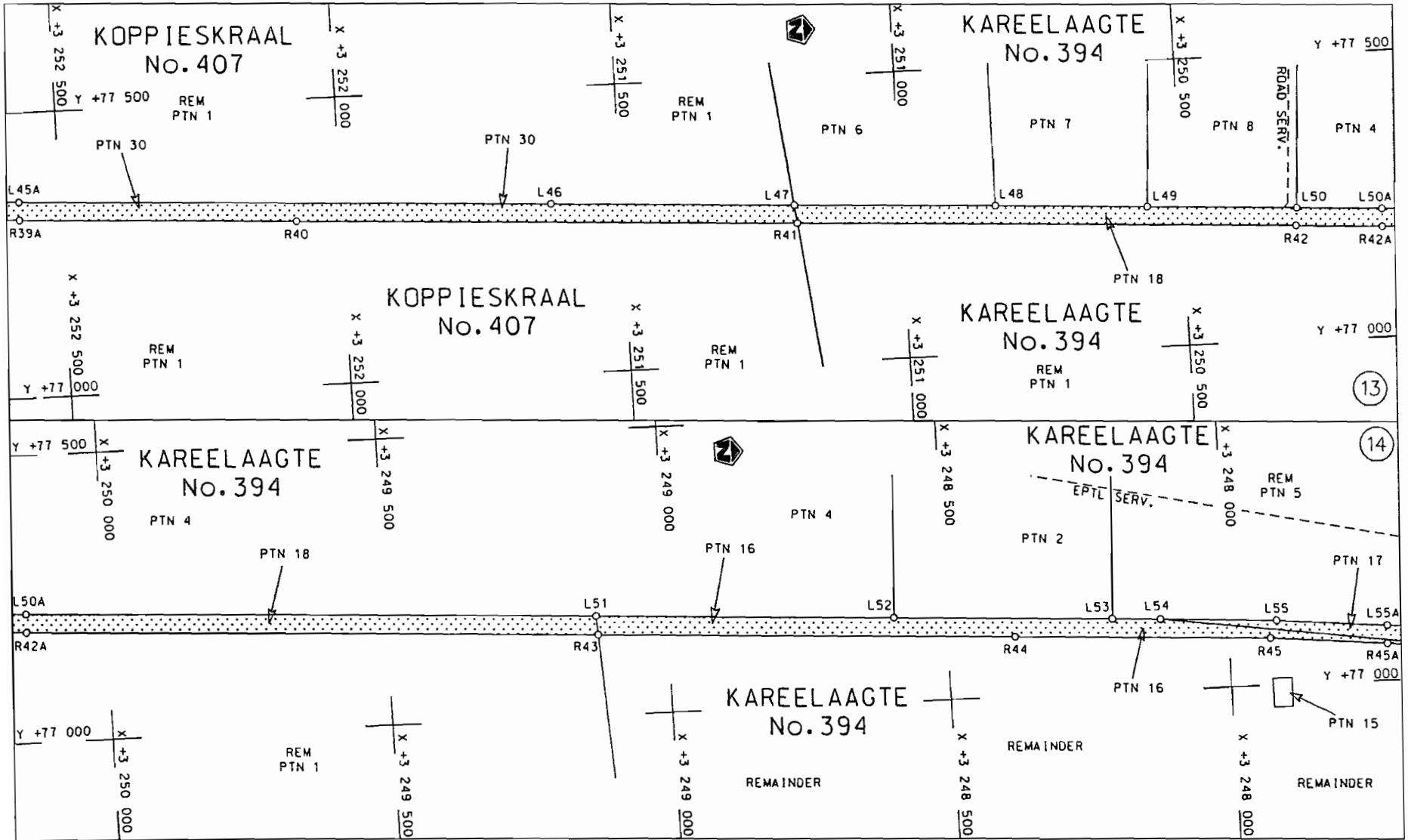

<p>Die Suid Afrikaanse Nasionale Padagentskap Beperk The South African National Roads Agency Limited</p>	<p>Die figuur getoon The figure shown</p>	<p>steldie padreserwe voor van 'n gedeelte represents the road reserve of a portion van Nasionale Roete N6 of National Route N6</p> <p>Seksie Section 8</p>	<p>Vel Sheet 7 van of 13 Plan P679/08</p>
--	---	---	---

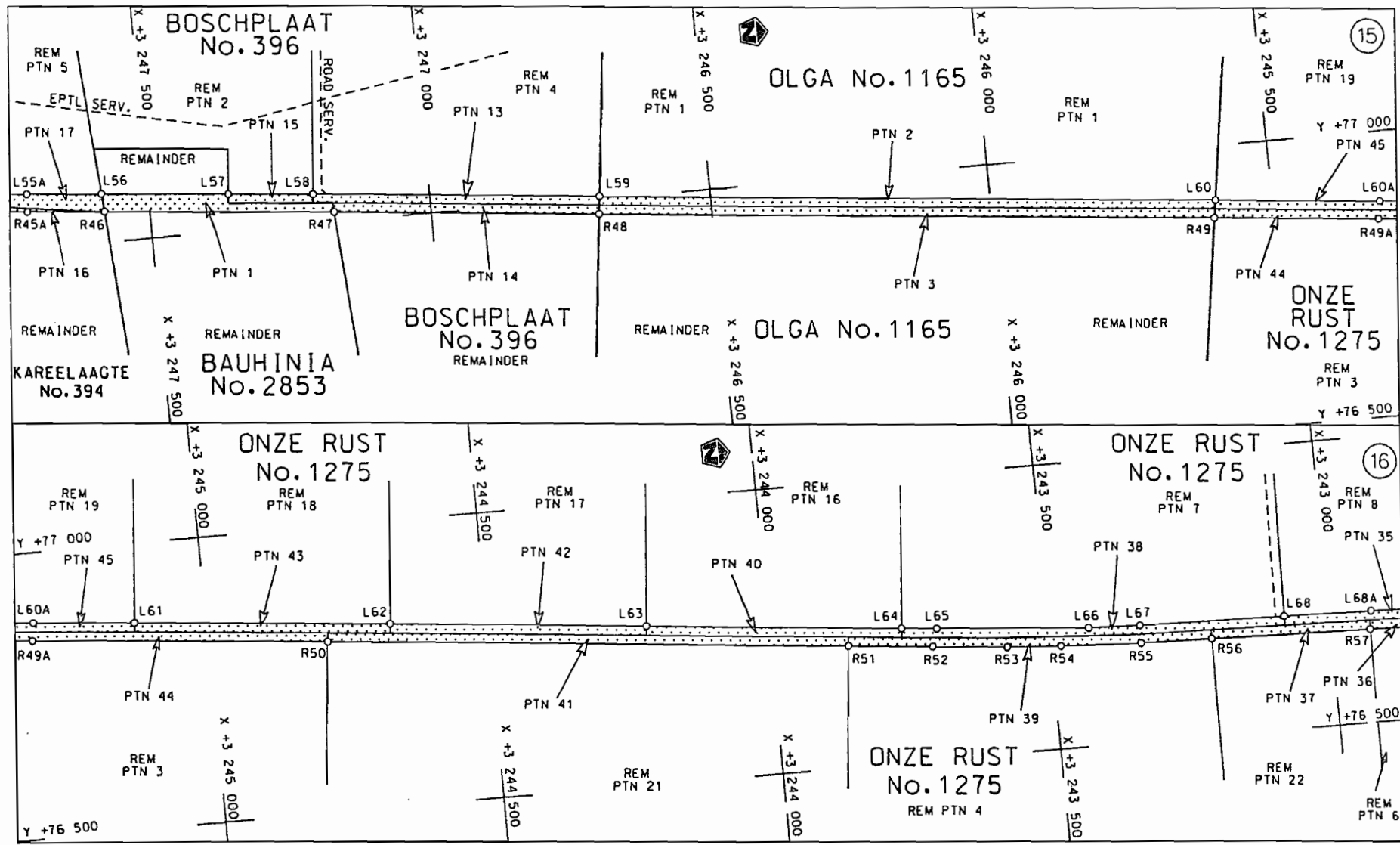

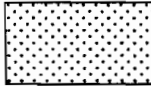
<p>Die Suid Afrikaanse Nasionale Padagentskap Beperk The South African National Roads Agency Limited</p>	<p>Die figuur getoon The figure shown</p>	 <p>steldie podreserve voor van 'n gedeelte represents the road reserve of a portion van Nasionale Roete N6 of National Route N6</p> <p>Seksie Section 8</p>	<p>Vel Sheet 8 van 13 Plan P679/08</p>
--	---	--	--

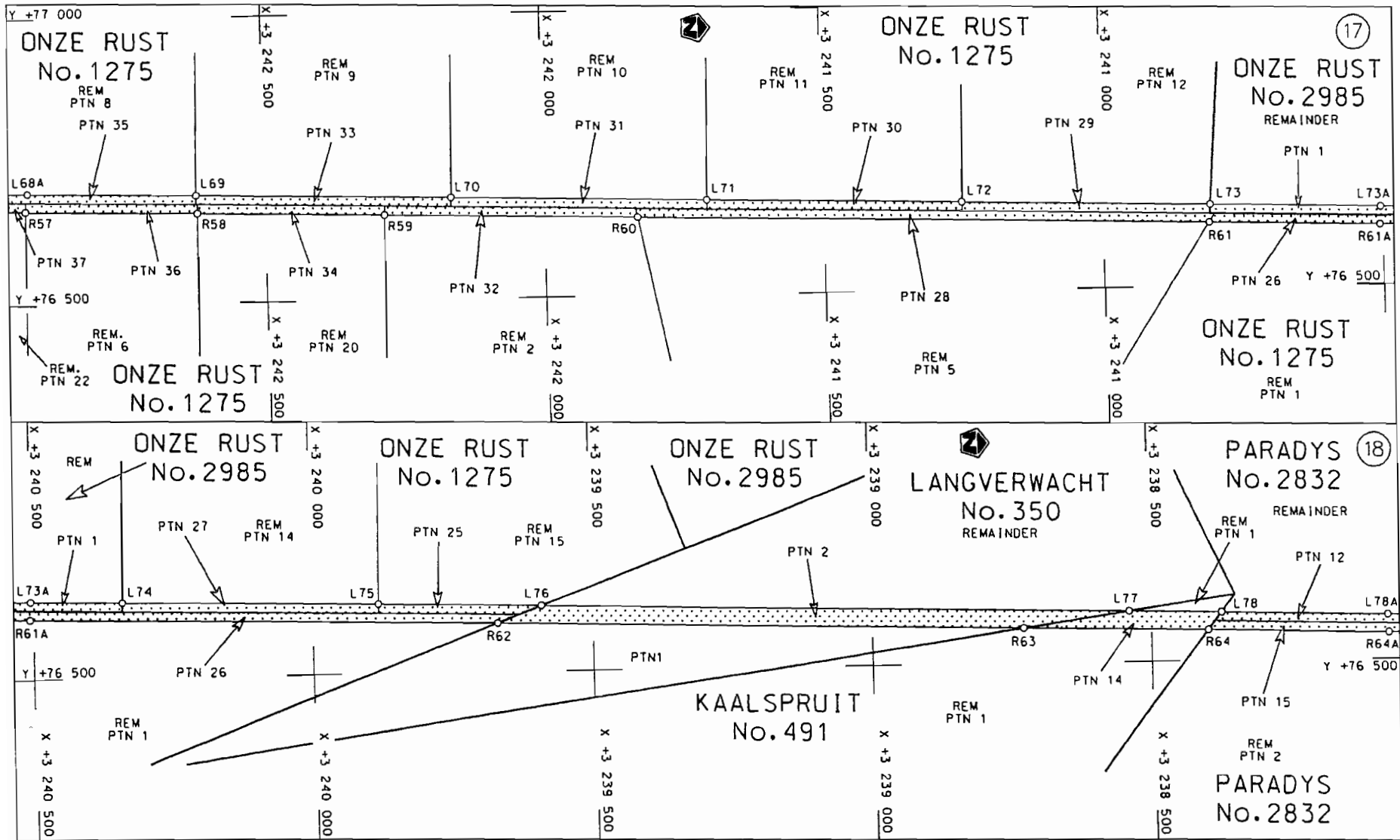

STAATSKOERANT, 5 NOVEMBER 2008

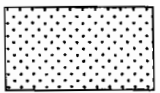
<p>Die Suid Afrikaanse Nasionale Padogenskop Beperk The South African National Roads Agency Limited</p>	<p>Die figuur getoon The figure shown</p>		<p>steldie podreserve voor van 'n gedeelte represents the road reserve of a portion van Nasionale Roete N6 of National Route</p> <p>Seksie 8</p>	<p>Vel 9 van 13 Sheet 9 of 13</p> <p>Plan P679/08</p>
---	---	--	--	---

No. 31570 13

D.O.9.A

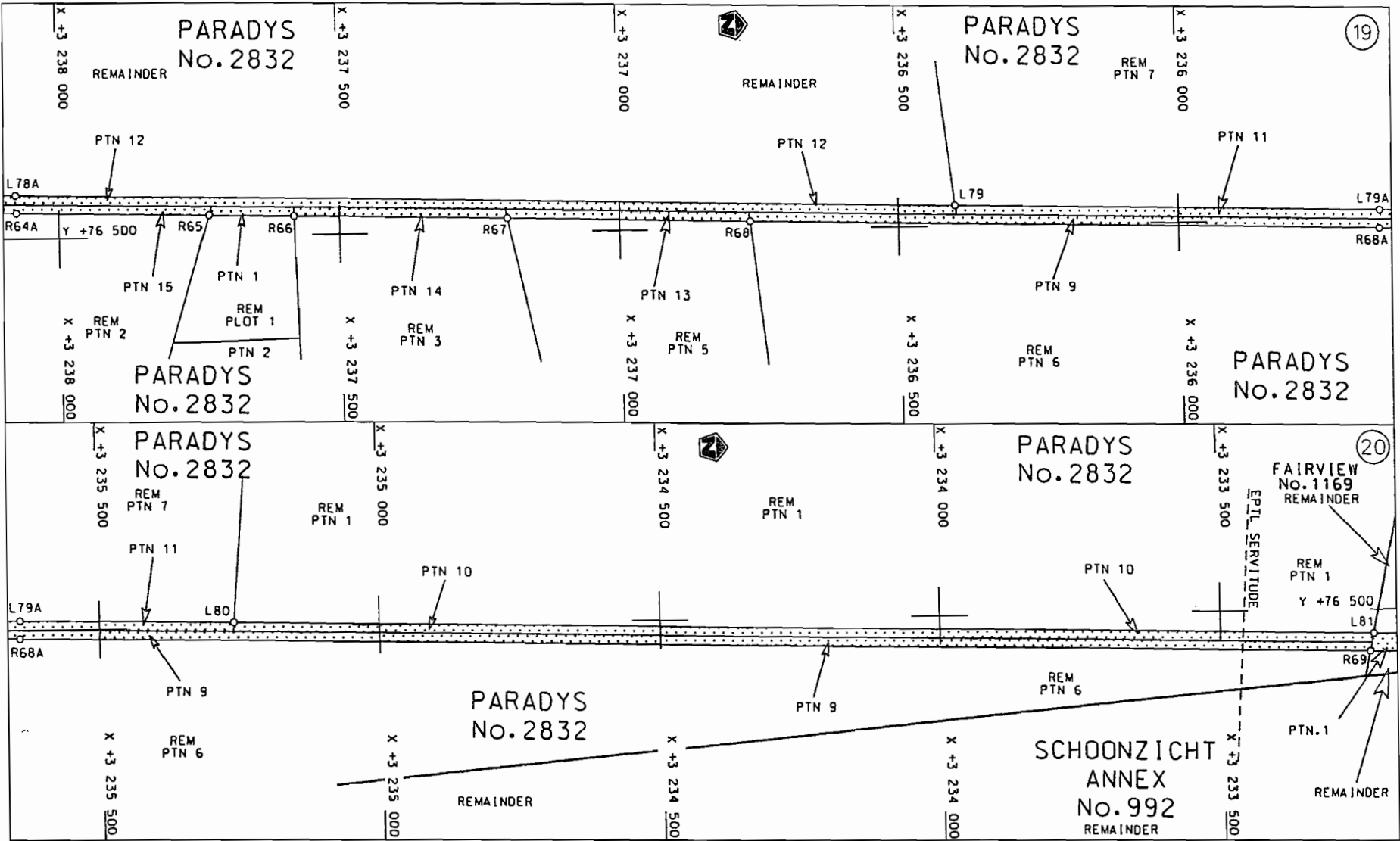

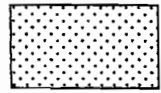
<p>Die Suid Afrikaanse Nasionale Padagentskap Beperk The South African National Roads Agency Limited</p>	<p>Die figuur getoon The figure shown</p> 	<p>steldie podreserve voor van 'n gedeelte represents the road reserve of a portion van Nasionale Roete N6 Seksie Section of National Route 8</p>	<p>Vel Sheet 10 van of 13 Plan P679/08</p>
--	--	---	--

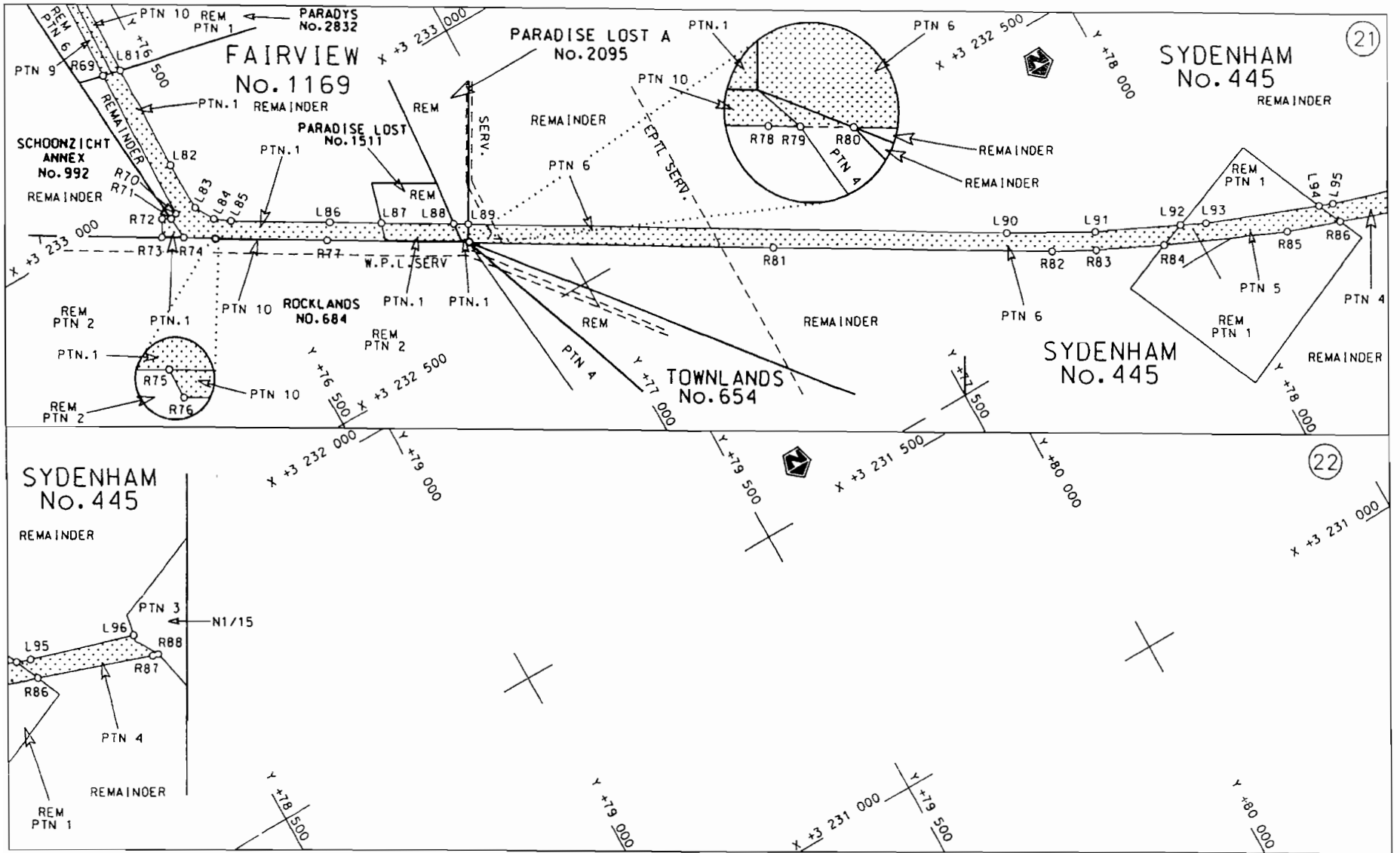

Die Suid Afrikaanse Nasionale Padagentskap Beperk  
The South African National Roads Agency Limited

Die figuur getoon  
The figure shown

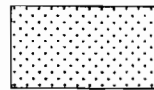

steldie padreserwe voor van 'n gedeelte  
represents the road reserve of a portion  
van Nasionale Roete of National Route N6

N6      Seksie      8

Vel Sheet 11 van 13

Plan P679/08

D.O.9.A

PADRESERWE KOÖRDINATE / ROAD RESERVE CO-ORDINATES							
LINKERKANT/LEFT HAND SIDE				REGTERKANT/RIGHT HAND SIDE			
	Y	X	WG 27°		Y	X	
L1	79 550.47	3 281	140.57	R1	79 521.19	3 281	159.02
L2	79 518.54	3 280	940.29	R2	79 489.62	3 280	958.51
L3	79 499.30	3 280	818.05	R3	79 474.83	3 280	865.82
L4	79 448.29	3 280	495.78	R4	79 421.26	3 280	528.59
L5	79 370.04	3 280	002.00	R5	79 249.63	3 279	440.21
L6	79 365.85	3 279	975.57	R6	78 988.18	3 277	598.73
L7	79 278.55	3 279	419.35	R7	78 896.58	3 276	953.34
L8	79 015.47	3 277	567.64	R8	78 840.65	3 276	560.71
L9	78 925.65	3 276	931.71	R9	78 763.35	3 276	033.59
L10	78 871.85	3 276	554.46	R10	78 700.44	3 275	612.29
L11	78 796.01	3 276	038.23	R11	78 423.11	3 273	754.79
L12	78 731.67	3 275	606.98	R12	78 375.24	3 273	434.48
L13	78 462.98	3 273	806.94	R13	78 361.23	3 273	330.65
L14	78 406.96	3 273	431.01	R14	78 354.71	3 273	269.82
L15	78 403.11	3 273	404.55	R15	78 350.45	3 273	224.23
L16	78 394.48	3 273	340.01	R16	78 344.64	3 273	149.18
L17	78 389.67	3 273	297.01	R17	78 341.56	3 273	100.06
L18	78 381.75	3 273	219.61	R18	78 339.11	3 273	041.85
L19	78 378.22	3 273	174.65	R19	78 314.60	3 272	432.60
L20	78 376.16	3 273	143.73	R20	78 299.84	3 272	063.90
L21	78 373.51	3 273	099.55	R21	78 284.93	3 271	696.16
L22	78 372.10	3 273	068.65	R22	78 261.20	3 271	114.95
L23	78 370.86	3 273	040.38	R23	78 213.11	3 269	928.27
L24	78 345.57	3 272	420.24	R24	78 166.04	3 268	771.78
L25	78 292.31	3 271	107.68	R25	78 136.40	3 268	045.31
L26	78 244.95	3 269	942.61	R26	78 030.66	3 265	443.83
L27	78 196.96	3 268	761.74	R27	78 007.55	3 265	134.90
L28	78 164.96	3 267	982.02	R28	77 989.83	3 264	911.55
L29	78 060.01	3 265	401.78	R29	77 876.09	3 263	497.30
L30	78 035.66	3 265	094.43	R30	77 810.52	3 262	687.52
L31	78 020.98	3 264	909.33	R31	77 783.27	3 262	128.88
L32	77 909.79	3 263	522.08	R32	77 663.55	3 259	685.66
L33	77 842.63	3 262	685.38	R33	77 574.35	3 257	879.84
L34	77 814.91	3 262	122.09	R34	77 475.64	3 255	879.50
L35	77 695.21	3 259	694.31	R35	77 456.80	3 255	551.48
L36	77 605.82	3 257	873.61	R36	77 454.19	3 255	506.01
L37	77 496.07	3 255	652.61	R37	77 443.85	3 255	249.64
L38	77 491.61	3 255	550.63	R38	77 427.78	3 254	911.95
L39	77 476.10	3 255	241.34	R39	77 342.89	3 253	201.30
L40	77 453.45	3 254	794.02	R40	77 287.49	3 252	081.64
L41	77 435.69	3 254	435.57	R41	77 243.42	3 251	187.77
L42	77 413.65	3 253	990.76	R42	77 199.68	3 250	297.90
L43	77 396.24	3 253	639.35	R43	77 141.18	3 249	126.08
L44	77 378.83	3 253	287.96	R44	77 104.79	3 248	379.19
L45	77 371.01	3 253	130.15	R45	77 082.18	3 247	925.83
L46	77 296.50	3 251	625.68	R46	77 053.43	3 247	580.58
L47	77 275.13	3 251	191.65	R47	77 016.27	3 247	173.42
L48	77 257.42	3 250	830.70	R48	76 973.29	3 246	701.97
L49	77 244.17	3 250	560.77	R49	76 873.07	3 245	604.08
L50	77 231.12	3 250	294.94	R50	76 798.44	3 244	788.26
L51	77 173.34	3 249	128.00	R51	76 713.72	3 243	860.05

Vel	12	Van	13	P679/08
Sheet		of		



## PADRESERWE KOÖRDINATE / ROAD RESERVE CO-ORDINATES

LINKERKANT/LEFT HAND SIDE				REGTERKANT/RIGHT HAND SIDE			
	Y	X	WG 27°		Y	X	
L52	77	146.94	3 248 594.86	R52	76	699.70	3 243 709.24
L53	77	127.62	3 248 204.65	R53	76	687.57	3 243 576.39
L54	77	123.38	3 248 119.10	R54	76	681.35	3 243 481.32
L55	77	112.35	3 247 912.70	R55	76	674.32	3 243 337.67
L56	77	085.35	3 247 583.01	R56	76	671.21	3 243 211.65
L57	77	065.09	3 247 358.56	R57	76	663.96	3 242 928.37
L58	77	051.12	3 247 208.64	R58	76	656.67	3 242 621.19
L59	77	004.66	3 246 698.30	R59	76	648.40	3 242 284.91
L60	76	904.23	3 245 599.35	R60	76	637.33	3 241 833.06
L61	76	861.04	3 245 127.46	R61	76	612.20	3 240 811.38
L62	76	819.61	3 244 672.18	R62	76	584.25	3 239 669.72
L63	76	778.16	3 244 216.85	R63	76	561.14	3 238 728.69
L64	76	736.26	3 243 761.59	R64	76	553.10	3 238 398.87
L65	76	730.63	3 243 698.66	R65	76	536.73	3 237 731.60
L66	76	708.89	3 243 428.44	R66	76	533.06	3 237 581.77
L67	76	705.55	3 243 336.47	R67	76	523.68	3 237 200.55
L68	76	699.45	3 243 080.08	R68	76	513.08	3 236 766.90
L69	76	688.20	3 242 623.03	R69	76	426.50	3 233 233.45
L70	76	677.12	3 242 166.04	R70	76	419.79	3 232 961.21
L71	76	665.73	3 241 709.01	R71	76	407.88	3 232 957.27
L72	76	654.48	3 241 251.96	R72	76	393.46	3 232 965.51
L73	76	643.62	3 240 809.01	R73	76	377.13	3 232 937.39
L74	76	632.06	3 240 338.64	R74	76	411.35	3 232 917.61
L75	76	620.82	3 239 881.59	R75	76	459.81	3 232 889.60
L76	76	613.71	3 239 591.08	R76	76	459.78	3 232 887.65
L77	76	588.03	3 238 539.08	R77	76	634.12	3 232 787.92
L78	76	583.79	3 238 374.78	R78	76	852.27	3 232 661.38
L79	76	535.45	3 236 399.48	R79	76	853.19	3 232 660.85
L80	76	507.69	3 235 259.73	R80	76	854.70	3 232 659.97
L81	76	457.90	3 233 226.40	R81	77	325.95	3 232 386.96
L82	76	453.45	3 233 039.03	R82	77	760.69	3 232 136.63
L83	76	455.52	3 232 953.80	R83	77	830.57	3 232 100.34
L84	76	475.04	3 232 919.72	R84	77	940.66	3 232 048.28
L85	76	500.37	3 232 902.00	R85	78	145.24	3 231 961.01
L86	76	653.94	3 232 813.46	R86	78	237.69	3 231 930.05
L87	76	733.29	3 232 767.65	R87	78	434.39	3 231 864.12
L88	76	845.45	3 232 702.86	R88	78	444.28	3 231 861.66
L89	76	868.24	3 232 689.66				
L90	77	705.76	3 232 203.79				
L91	77	845.01	3 232 128.79				
L92	77	983.32	3 232 064.70				
L93	78	025.00	3 232 045.39				
L94	78	218.20	3 231 973.34				
L95	78	242.15	3 231 964.40				
L96	78	422.98	3 231 910.22				