

Government Gazette Staatskoerant

REPUBLIC OF SOUTH AFRICA
REPUBLIEK VAN SUID-AFRIKA

Vol. 522

Pretoria, 17 December 2008
Desember

No. 31704

CONTENTS**INHOUD**

<i>No.</i>	<i>Page No.</i>	<i>Gazette No.</i>	<i>No.</i>	<i>Bladsy No.</i>	<i>Koerant No.</i>
GOVERNMENT NOTICE			GOEWERMENTSKENNISGEWING		
Transport, Department of			Vervoer, Departement van		
<i>Government Notice</i>			<i>Goewermentskennisgewing</i>		
1355			1355		
South African National Roads Agency Limited and the National Roads Act (7/1998): The South African National Roads Agency Limited: Declaration amendment of National Road N9 Section 7: Amendment of Declaration No. 2136 of 1992	3	31704	Suid-Afrikaanse Nasionale Padagentskap Beperk en die Nasionale Paaie Wet (7/1998): Die Suid-Afrikaanse Nasionale Padagentskap Beperk: Verklaring wysiging van Nasionale Pad N9 Seksie 7: Wysiging van Verklaring No. 2136 van 1992	4	31704

**GOVERNMENT NOTICE
GOEWERMENTSKENNISGEWING**

**DEPARTMENT OF TRANSPORT
DEPARTEMENT VAN VERVOER**

No. 1355

17 December 2008

**THE SOUTH AFRICAN NATIONAL ROADS
AGENCY LIMITED**

Registration No: 98/09584/06

DECLARATION AMENDMENT OF NATIONAL ROAD N9 SECTION 7

AMENDMENT OF DECLARATION No. 2136 OF 1992

By virtue of section 40 (1)(b) of the South African National Roads Agency Limited and the National Roads Act, 1998 (Act No. 7 of 1998), I hereby amend declaration No. 2136 of 1992, Schedule A paragraph (5), by substituting the descriptive wording from "at the Middelburg South Interchange" up to "near the town of Colesberg", with the subjoined sheets 1 to 29 of Plan No. P651/08.

(National Road N9 Section 7: Middelburg – Colesberg)



MINISTER OF TRANSPORT

No. 1355

17 Desember 2008

**DIE SUID-AFRIKAANSE NASIONALE
PADAGENTSKAP BEPERK**

Registrasie No: 98/09584/06

VERKLARING WYSIGING VAN NASIONALE PAD N9 SEKSIE 7.

WYSIGING VAN VERKLARING NO. 2136 VAN 1992

Kragtens Artikel 40(1)(b) van die Suid-Afrikaanse Nasionale Padagentskap Beperk en die Nasionale Paaie Wet, 1998 (Wet no. 7 van 1998), wysig ek hiermee verklaring no.2136 van 1992, Bylae A paragraaf (5) deur die beskrywende bewoording vanaf "by die Middelburg-Suidwisselaar" tot by "naby die dorp Colesberg", te vervang met meegaande velle 1 tot 29 van Plan no. P651/08.

(Nasionale Pad N9 Seksie 7: Middelburg – Colesberg)



MIÑISTER VAN VERVOER

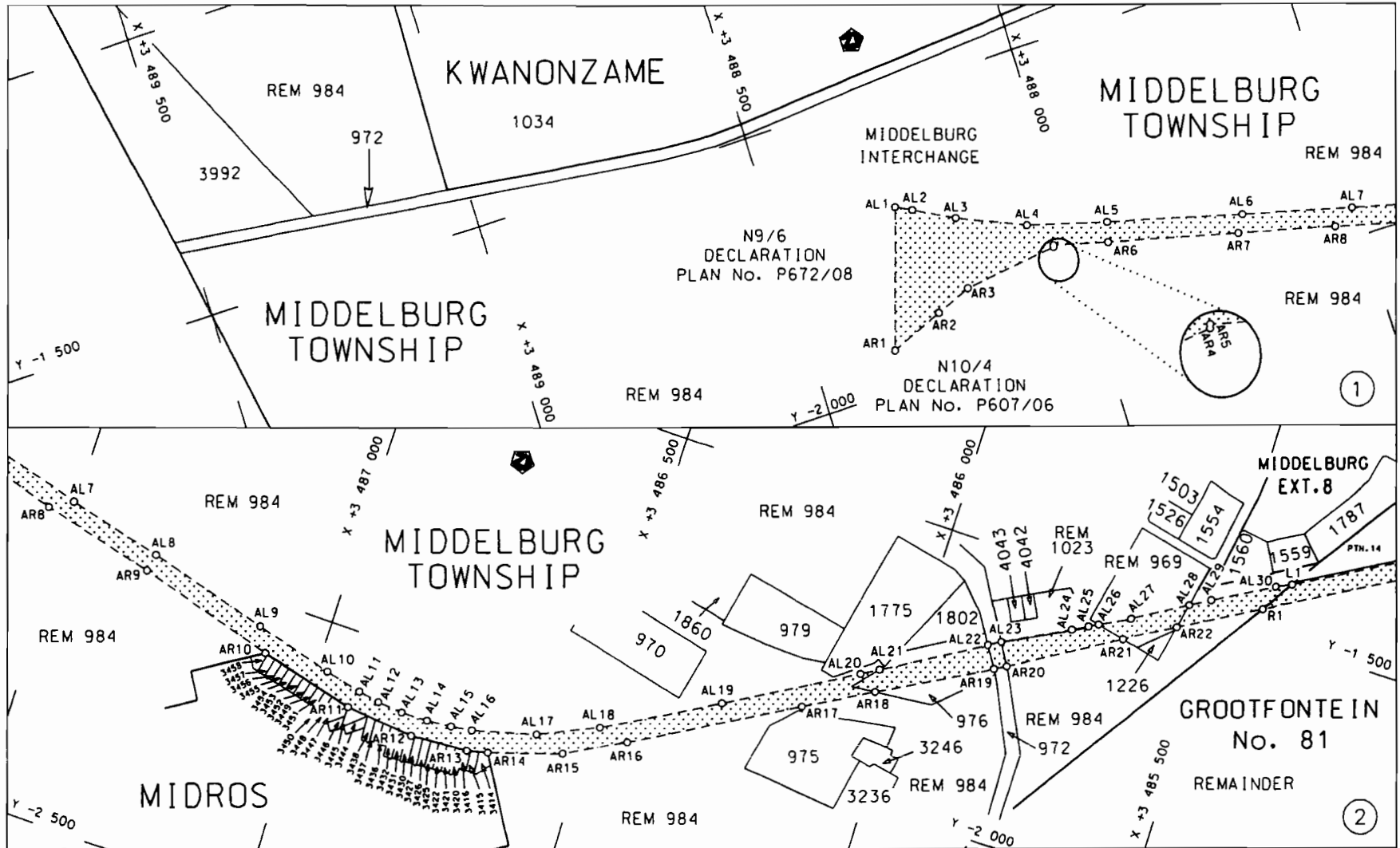

Suid-Afrikaanse Padagentskap Bpk. South African National Roads Agency Ltd.	Die figuur getoon The figure shown		stel die podreserwe voor van 'n gedeelte represents the road reserve of a portion van Nasionale Roete N9 Seksie 7 of National Route Section	Vel 1 van 29 Sheet 1 of 29 P P651/08
---	---------------------------------------	--	--	--

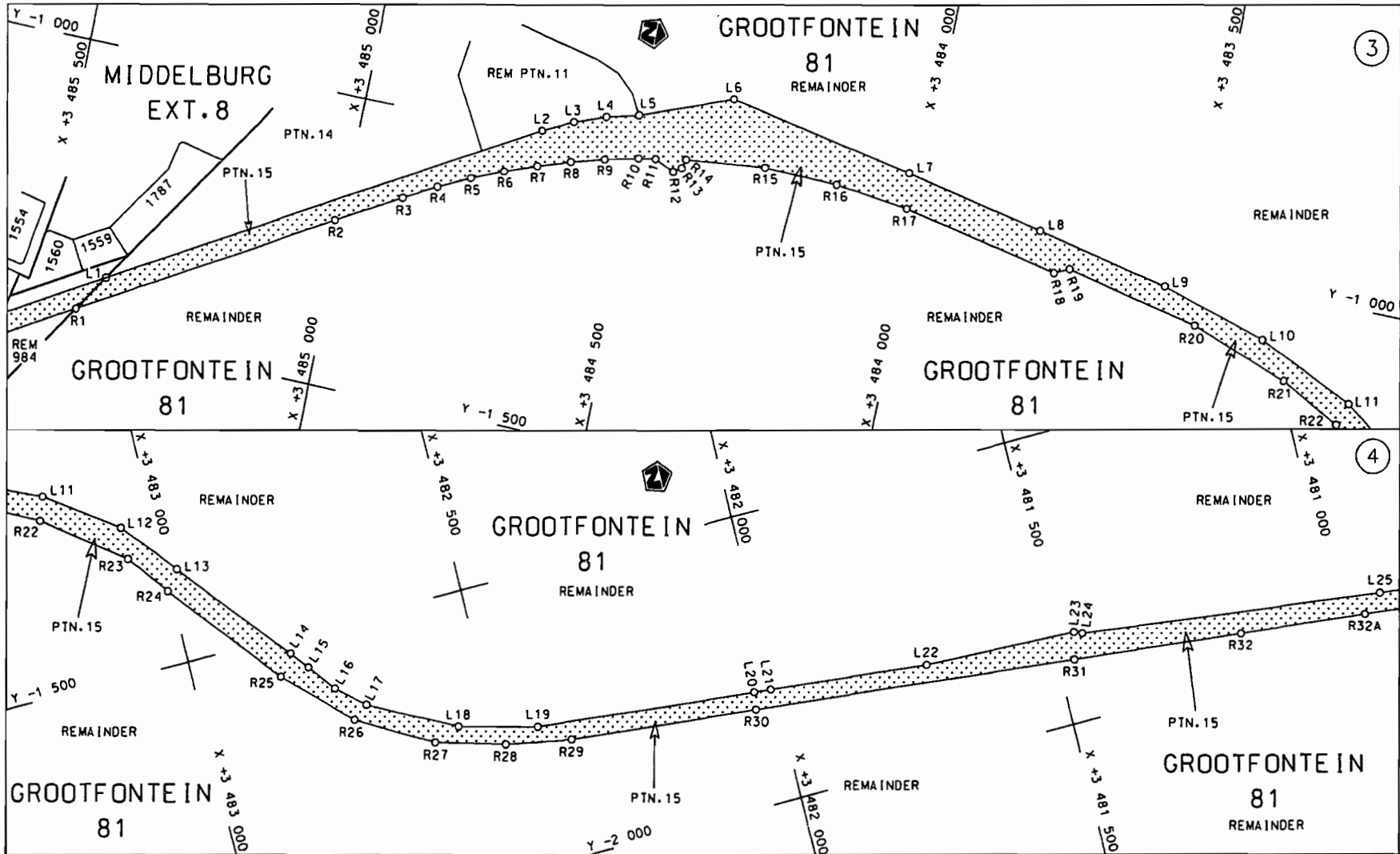

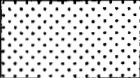
<p>Die Suid Afrikaanse Nasionale Padogenskap Beperk</p>	<p>Die figuur getoon</p>		<p>steldie padreserwe voor van 'n gedeelte represents the road reserve of a portion van Nasionale Roete N9 Seksie of National Route Section</p>	<p>Vel Sheet 2 von of 29</p>
<p>The South African National Roads Agency Limited</p>	<p>The figure shown</p>		<p>7</p>	<p>Plan P651/08</p>

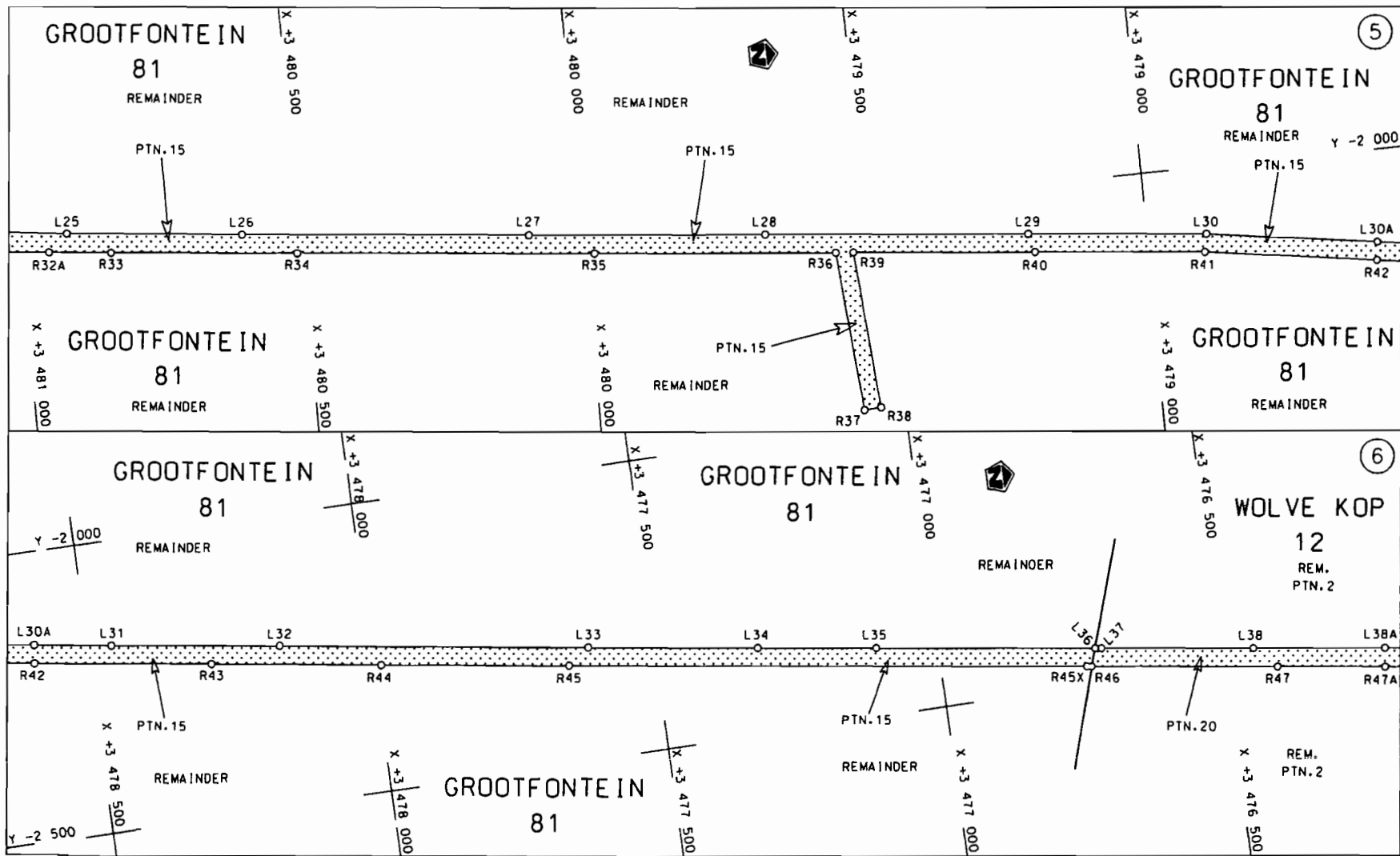

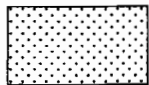
Die Suid Afrikaanse Nasionale Padagentskap Beperk The South African National Roads Agency Limited	Die figuur getoon The figure shown	 steldie padreserwe voor van 'n gedeelte represents the road reserve of a portion van Nasionale Roete N9 of National Route N9 Seksie 7 Section 7	Vel 3 van 29 Sheet 3 of 29 Plan P651/08
--	---------------------------------------	---	---

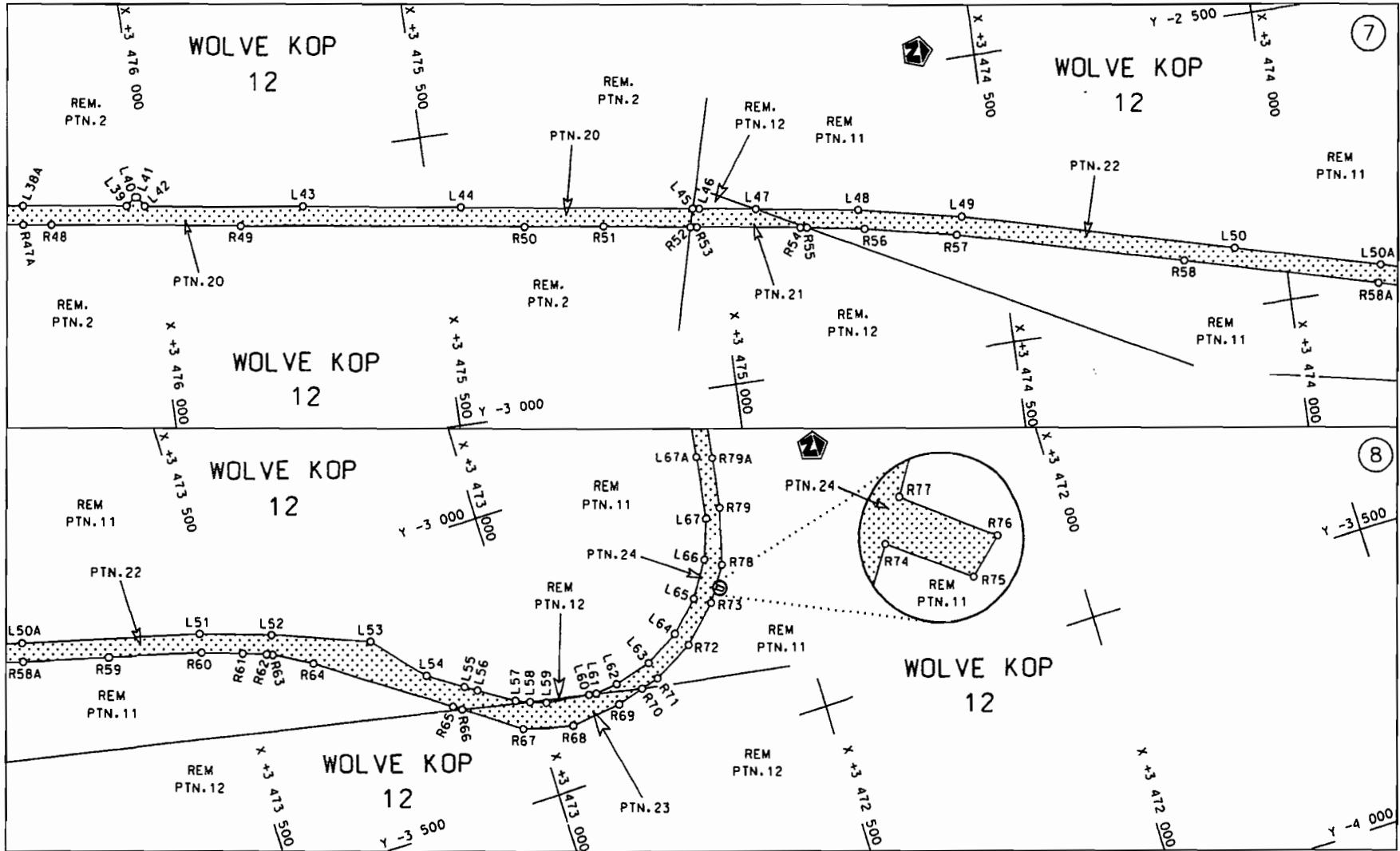

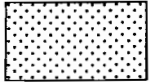
<p>Die Suid Afrikaanse Nasionale Padagentskap Beperk The South African National Roads Agency Limited</p>	<p>Die figuur getoon The figure shown</p>		<p>steldie padreserwe voor van 'n gedeelte represents the road reserve of a portion van Nasionale Roete N9 Seksie of National Route Section 7</p>	<p>Vel Sheet 4 van of 29 Plan P651/08</p>
--	---	--	---	---

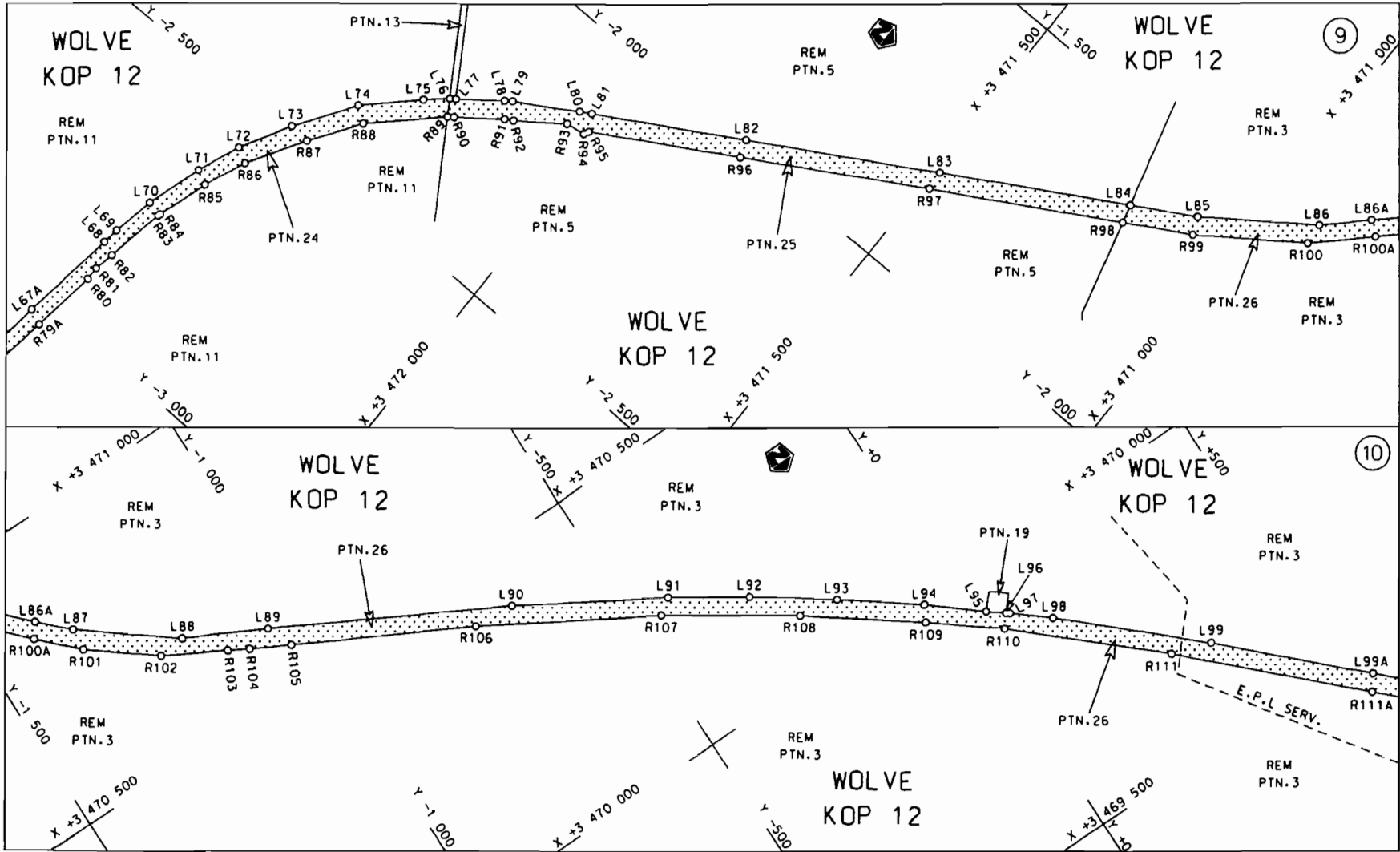

Die Suid Afrikaanse Nasionale Padagentskap Beperk
The South African National Roads Agency Limited

Die figuur getoon
The figure shown

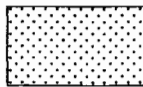

stel die padreserwe voor van 'n gedeelte
represents the road reserve of a portion
van Nasionale Roete N9
of National Route N9

Seksie 7

Vel 5 van 29
Sheet of

Plan P651/08

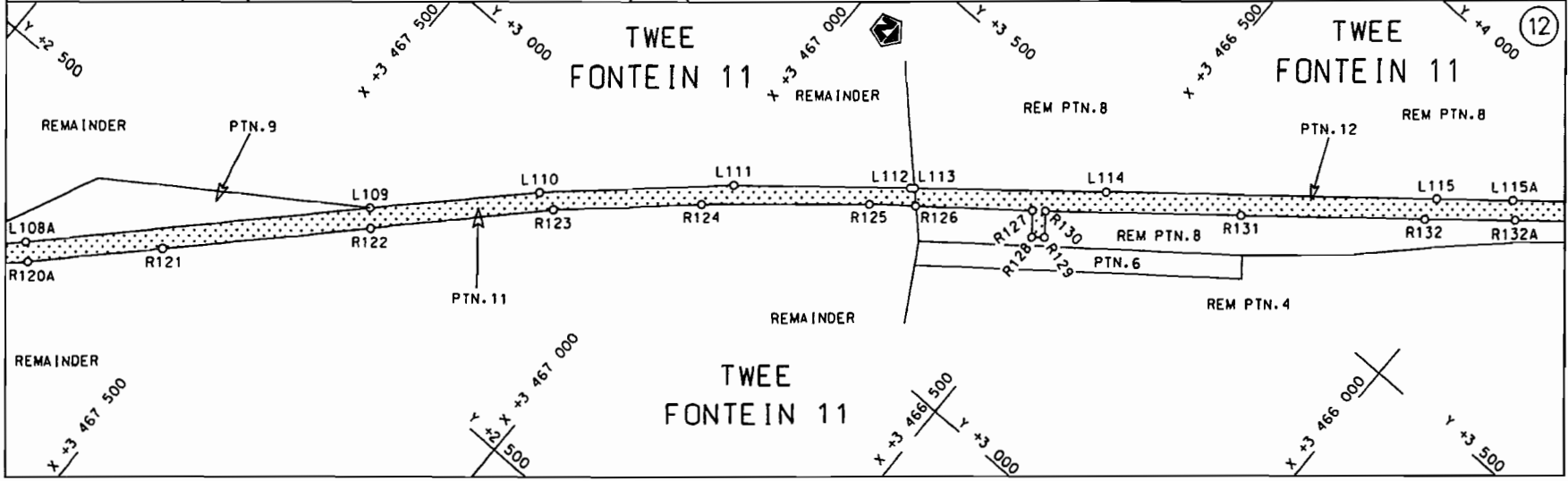
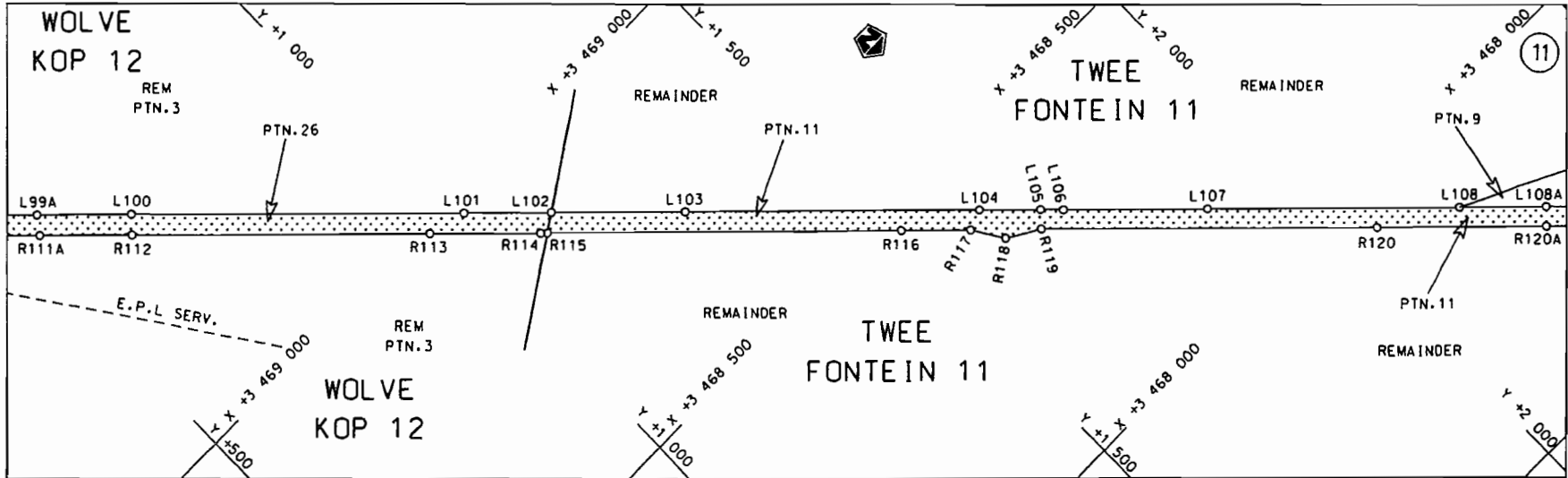

Die Suid Afrikaanse Nasionale Padagentskap Beperk
The South African National Roads Agency Limited

Die figuur getoon
The figure shown

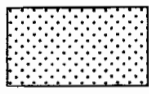

steldie padreserwe voor van 'n gedeelte
represents the road reserve of a portion
van Nasionale Roete N9
of National Route 7
Seksie
Section

Vel
Sheet 6 van
of 29
Plan P651/08

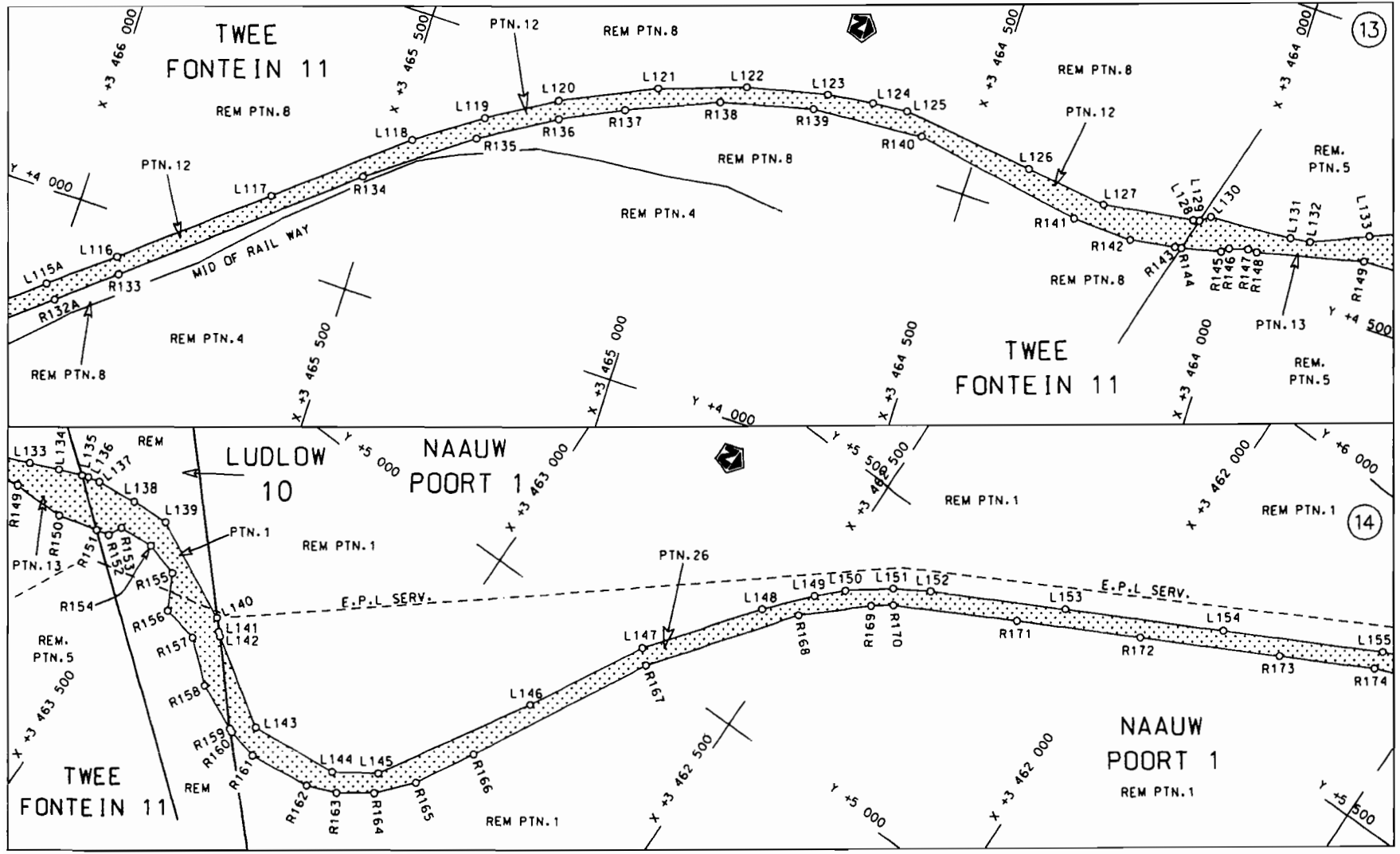

<p>Die Suid Afrikaanse Nasionale Podagentskop Beperk The South African National Roads Agency Limited</p>	<p>Die figuur getoon The figure shown</p>		<p>steldie padreserwe voor van 'n gedeelte represents the road reserve of a portion van Nasionale Roete N9 of National Route N9</p> <p>Seksie 7 Section 7</p>	<p>Vel Sheet 7 van of 29</p>
				<p>Plan P651/08</p>

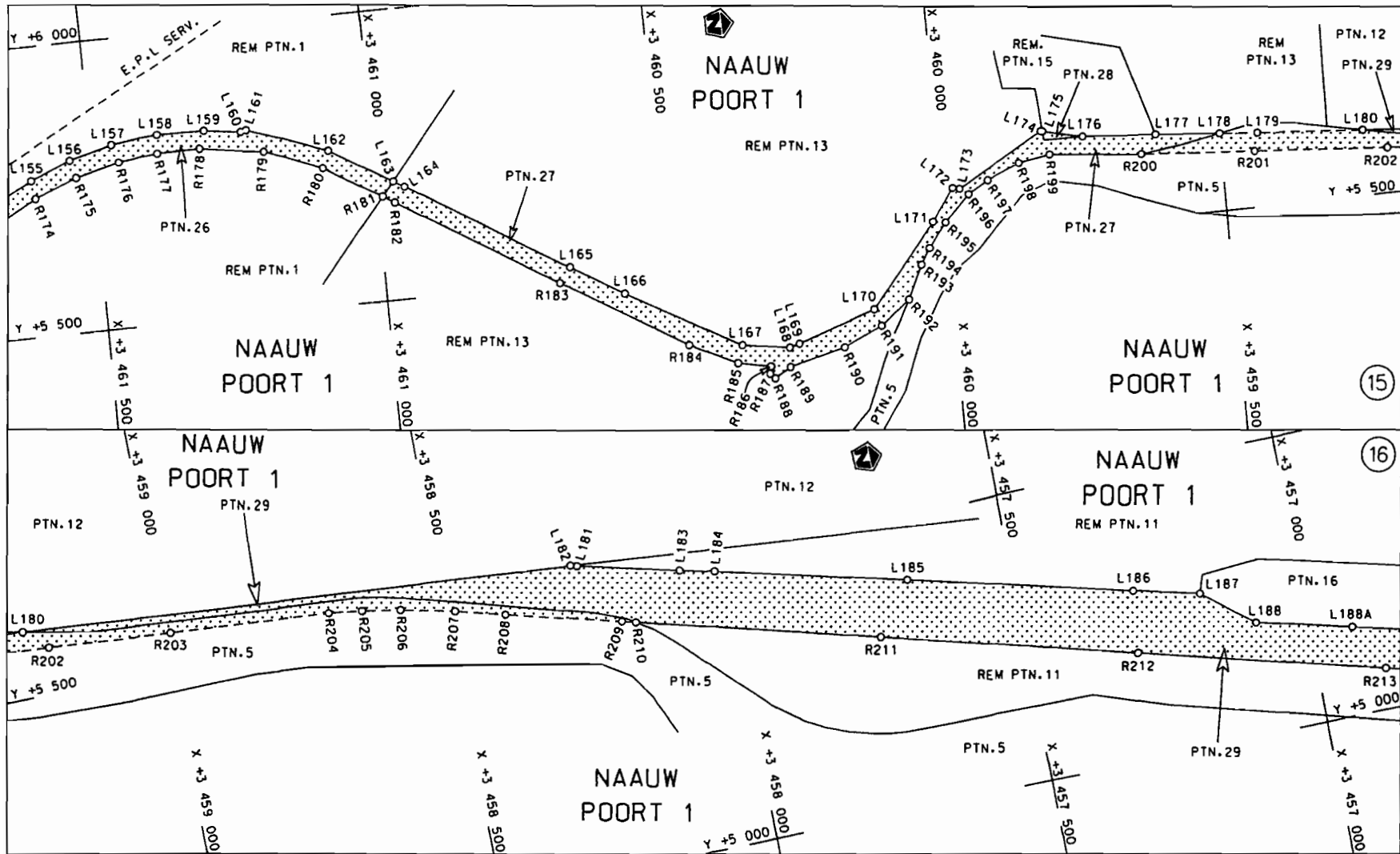

<p>Die Suid Afrikaanse Nasionale Padagentskop Beperk</p>	<p>Die figuur getoon</p>	<p>steldie padreserwe voor van 'n gedeelte represents the road reserve of a portion</p>	<p>Vel Sheet 8 van 29</p>
<p>The South African National Roads Agency Limited</p>	<p>The figure shown</p>	<p>van Nasionale Roete N9 Seksie Section 7</p>	<p>Plan P651/08</p>

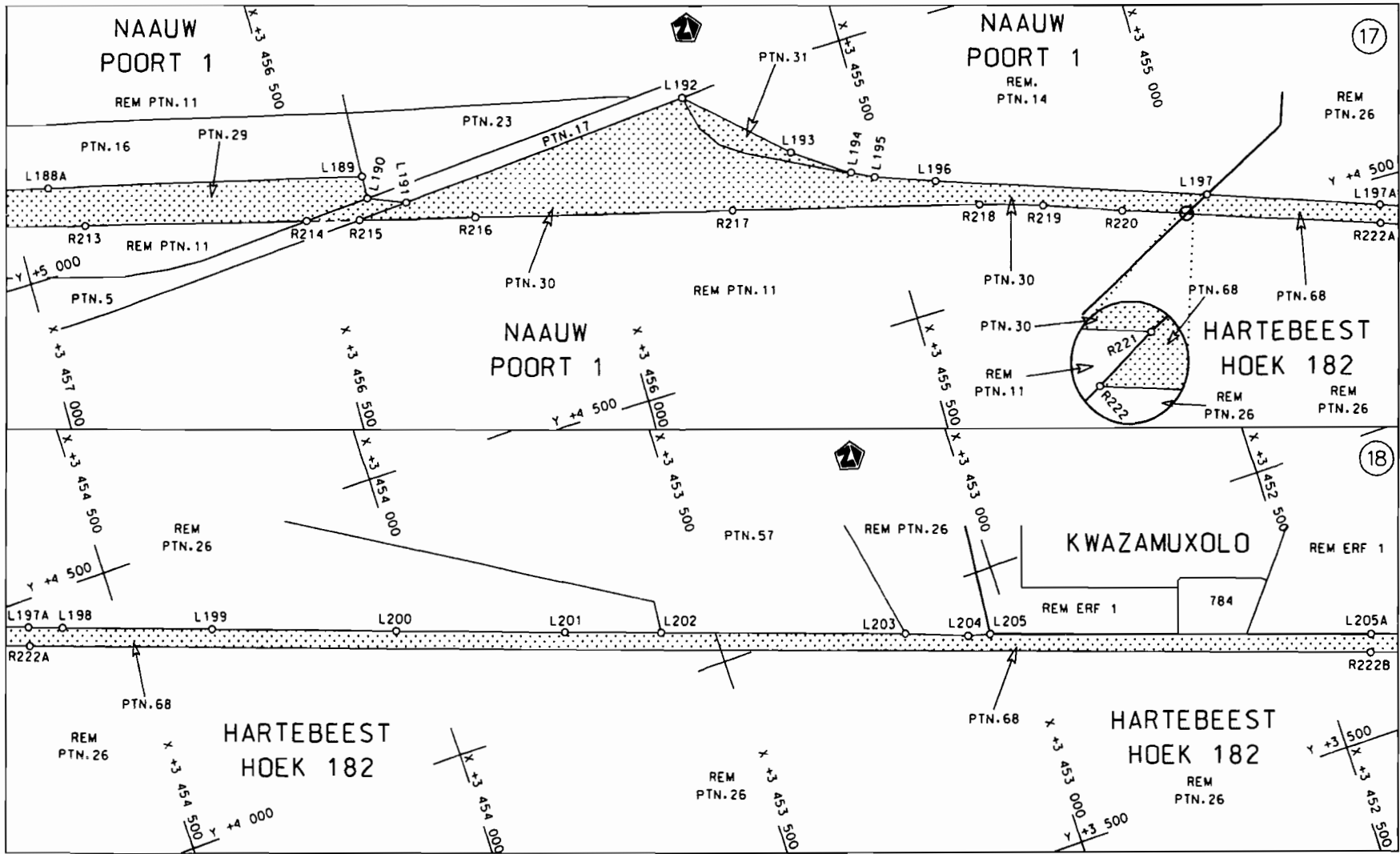

<p>Die Suid Afrikaanse Nasionale Padagentskap Beperk The South African National Roads Agency Limited</p>	<p>Die figuur getoon The figure shown</p> 	<p>steldie padreserwe voor van 'n gedeelte represents the road reserve of a portion van Nasionale Roete N9 of National Route N9</p> <p>Seksie Section</p> <p>7</p>	<p>Vel Sheet 9 van 29</p> <p>Plan P651/08</p>
--	--	--	---

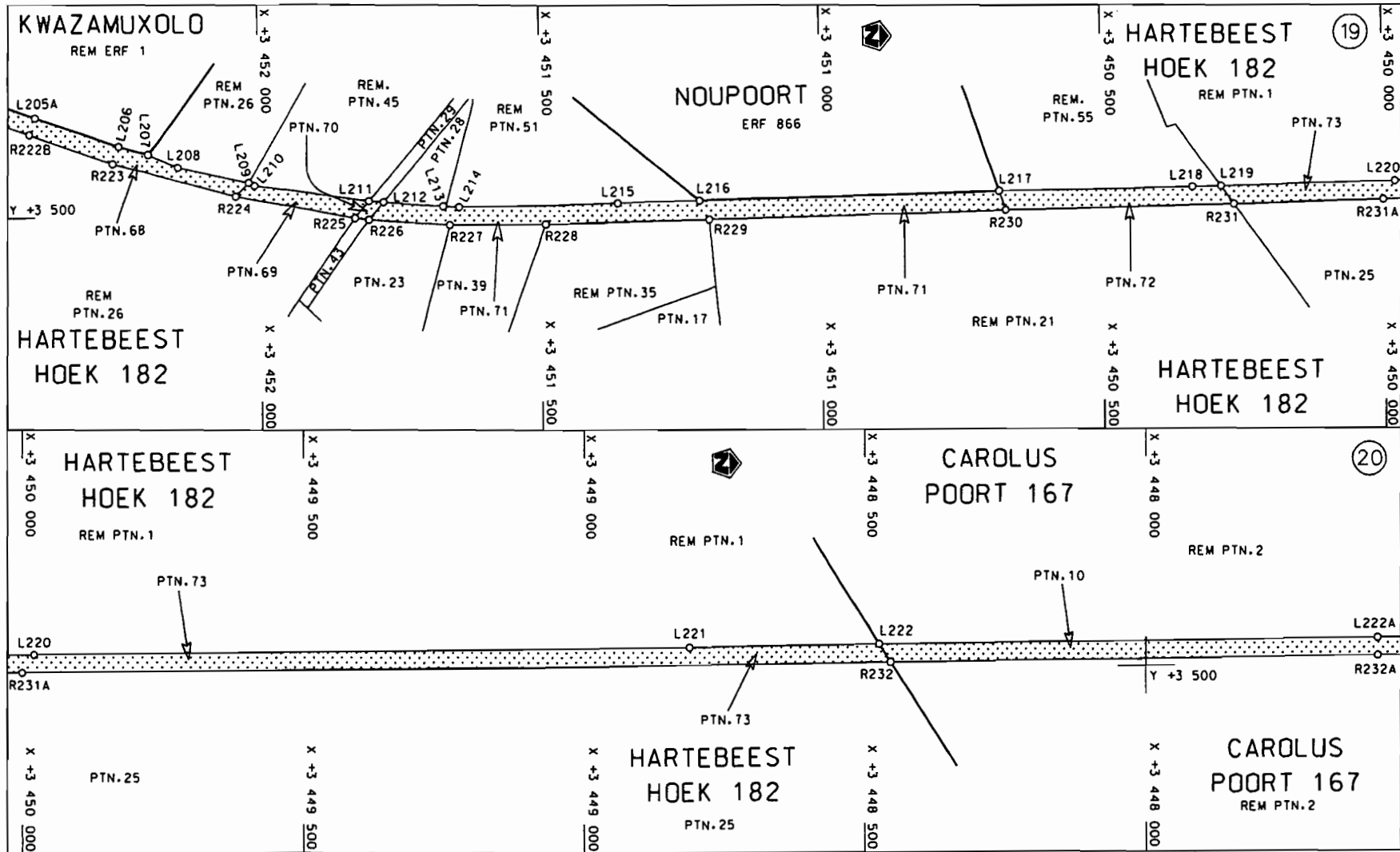

Die Suid Afrikaanse Nasionale Padagentskap Beperk The South African National Roads Agency Limited	Die figuur getoon The figure shown		steldie padreserwe voor van 'n gedeelte represents the road reserve of a portion van Nasionale Roete N9 Seksie of National Route 7	Vel Sheet 10 of 29
				Plan P651/08

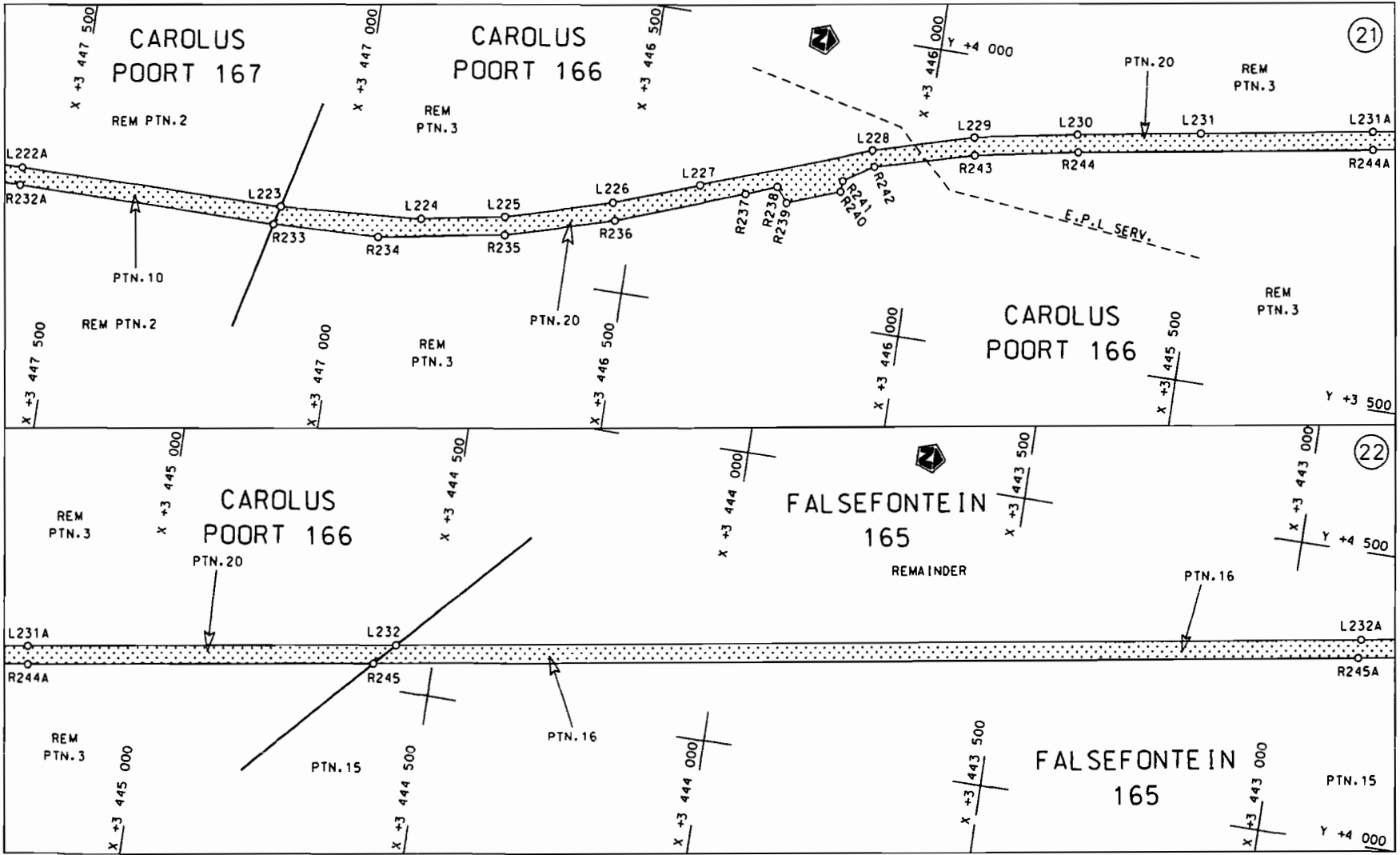

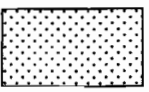
<p>Die Suid Afrikaanse Nasionale Padagentskap Beperk The South African National Roads Agency Limited</p>	<p>Die figuur getoon The figure shown</p>		<p>steldie padreserwe voor van 'n gedeelte represents the road reserve of a portion van Nasionale Roete N9 of National Route</p>	<p>Vel Sheet 11 van of 29 Plan P651/08</p>
			<p>Seksie Section 7</p>	

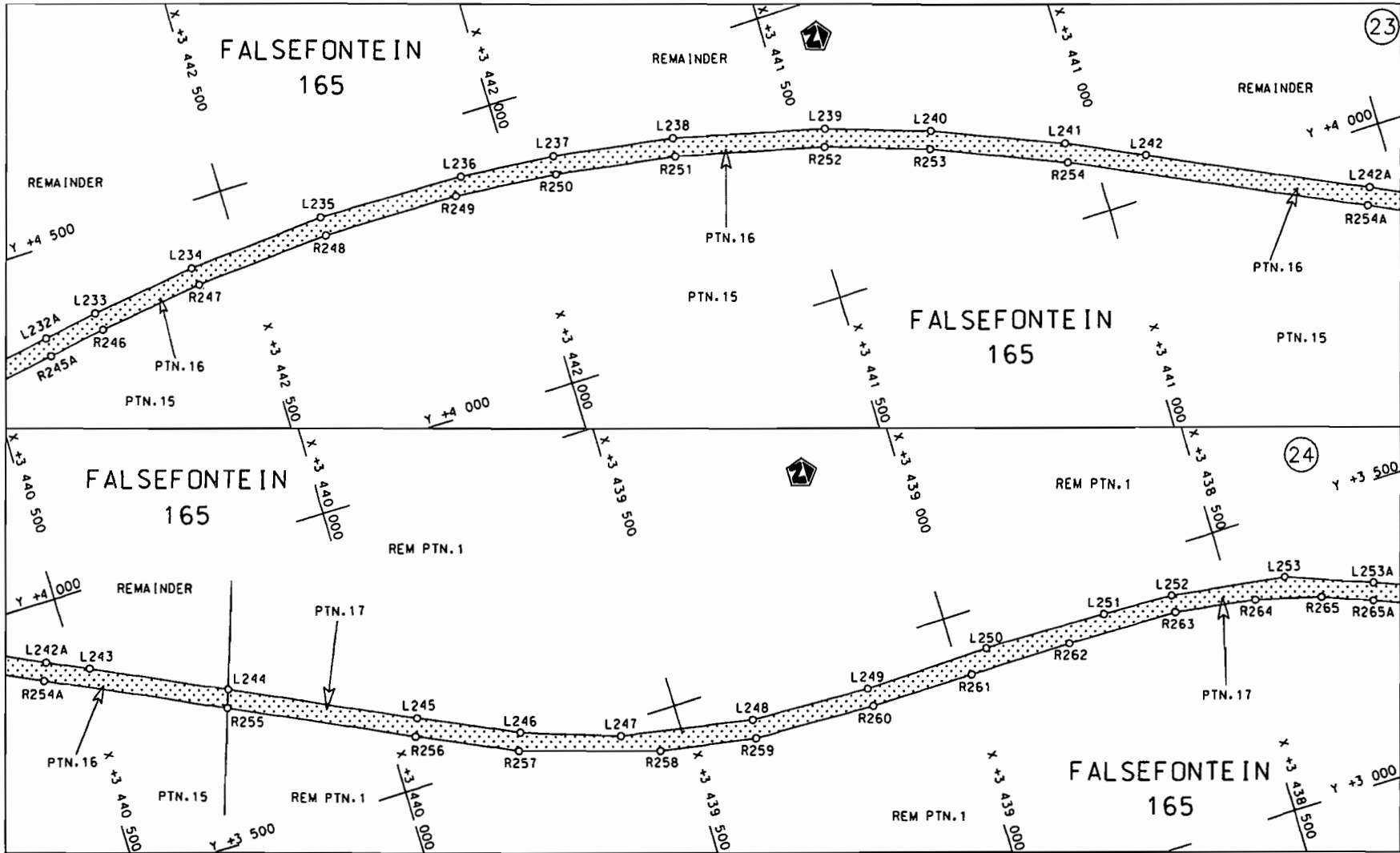

<p>Die Suid Afrikaanse Nasionale Padagentskap Beperk</p>	<p>Die figuur getoon</p>	<p>stel die padreserwe voor van 'n gedeelte</p>	<p>Vel Sheet 12 van 29</p>
<p>The South African National Roads Agency Limited</p>	<p>The figure shown</p>	<p>represents the road reserve of a portion van Nasionale Roete N9 Seksie 7 of National Route N9 Sektion 7</p>	<p>Plan P651/08</p>

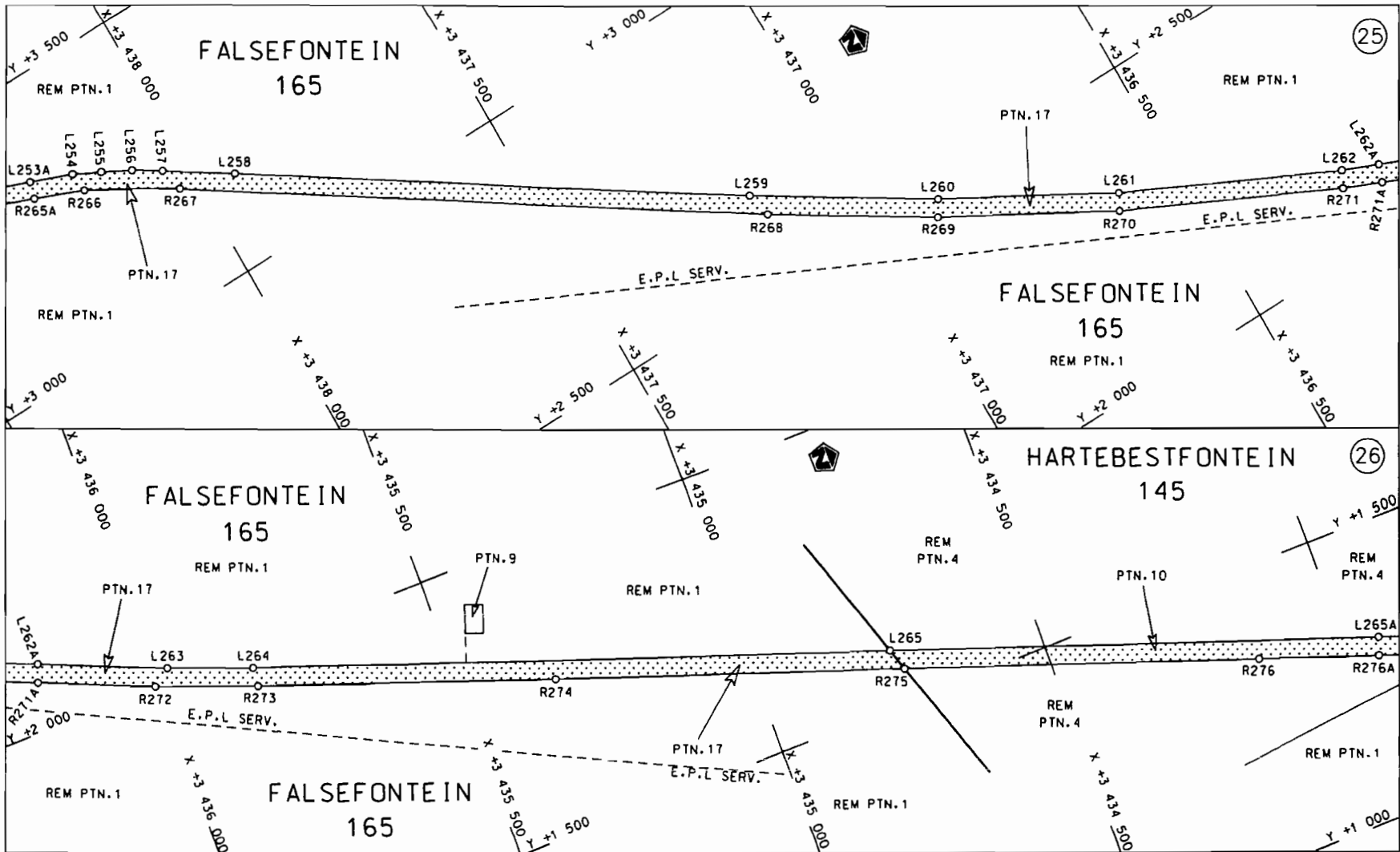

Die Suid Afrikaanse Nasionale Padagentskop Beperk The South African National Roads Agency Limited	Die figuur getoon The figure shown		steldie podreserwe voor van 'n gedeelte represents the road reserve of a portion van Nasionale Roete N9 Seksie of National Route Section 7	Vel Sheet 13 van 29 Plan P651/08
--	---------------------------------------	--	---	-------------------------------------

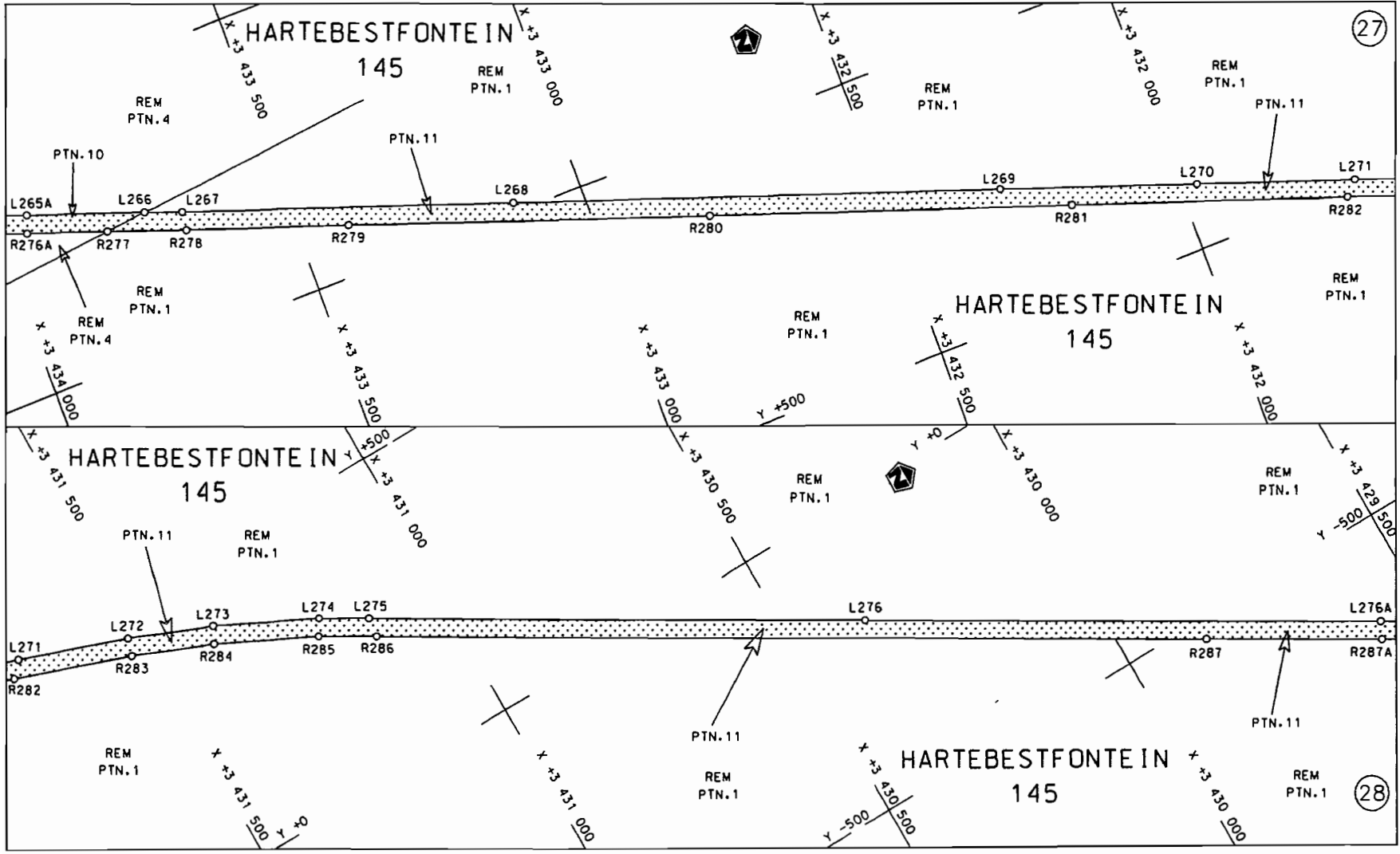

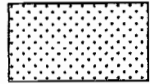
<p>Die Suid Afrikaanse Nasionale Padagentskop Beperk The South African National Roads Agency Limited</p>	<p>Die figuur getoon The figure shown</p> 	<p>steldie padreserwe voor van 'n gedeelte represents the road reserve of a portion van Nasionale Roete N9 of National Route N9</p> <p>Seksie Section 7</p>	<p>Vel Sheet 14 of 29 Plan P651/08</p>
--	--	---	--

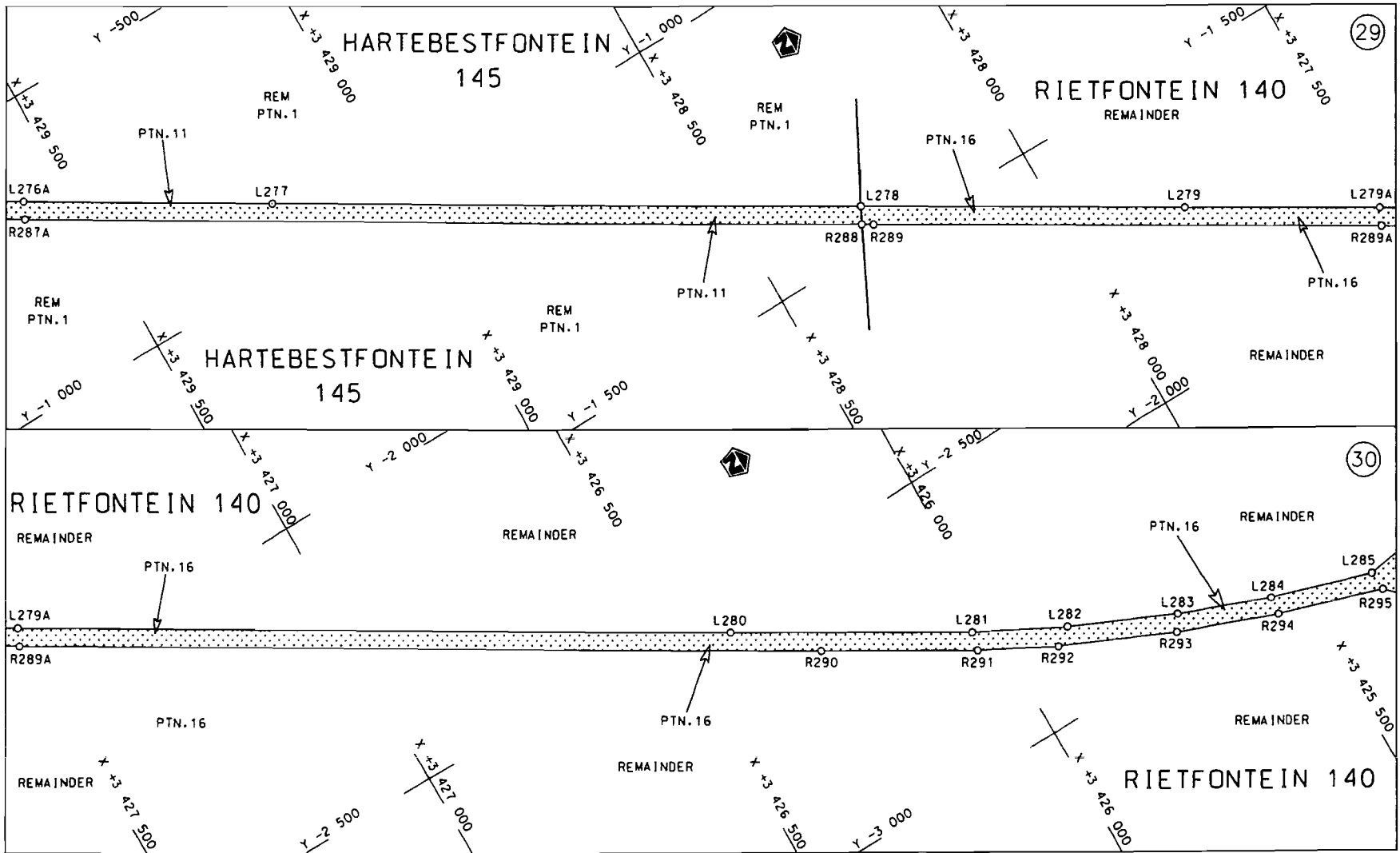

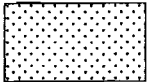
<p>Die Suid Afrikaanse Nasionale Padogentskap Beperk The South African National Roads Agency Limited</p>	<p>Die figuur getoon The figure shown</p>		<p>steldie padreserve voor van 'n gedeelte represents the road reserve of a partion van Nasionale Roete N9 Seksie of National Route N9 Section 7</p>	<p>Vel Sheet 15 van of 29 Plan P651/08</p>
--	---	--	--	--

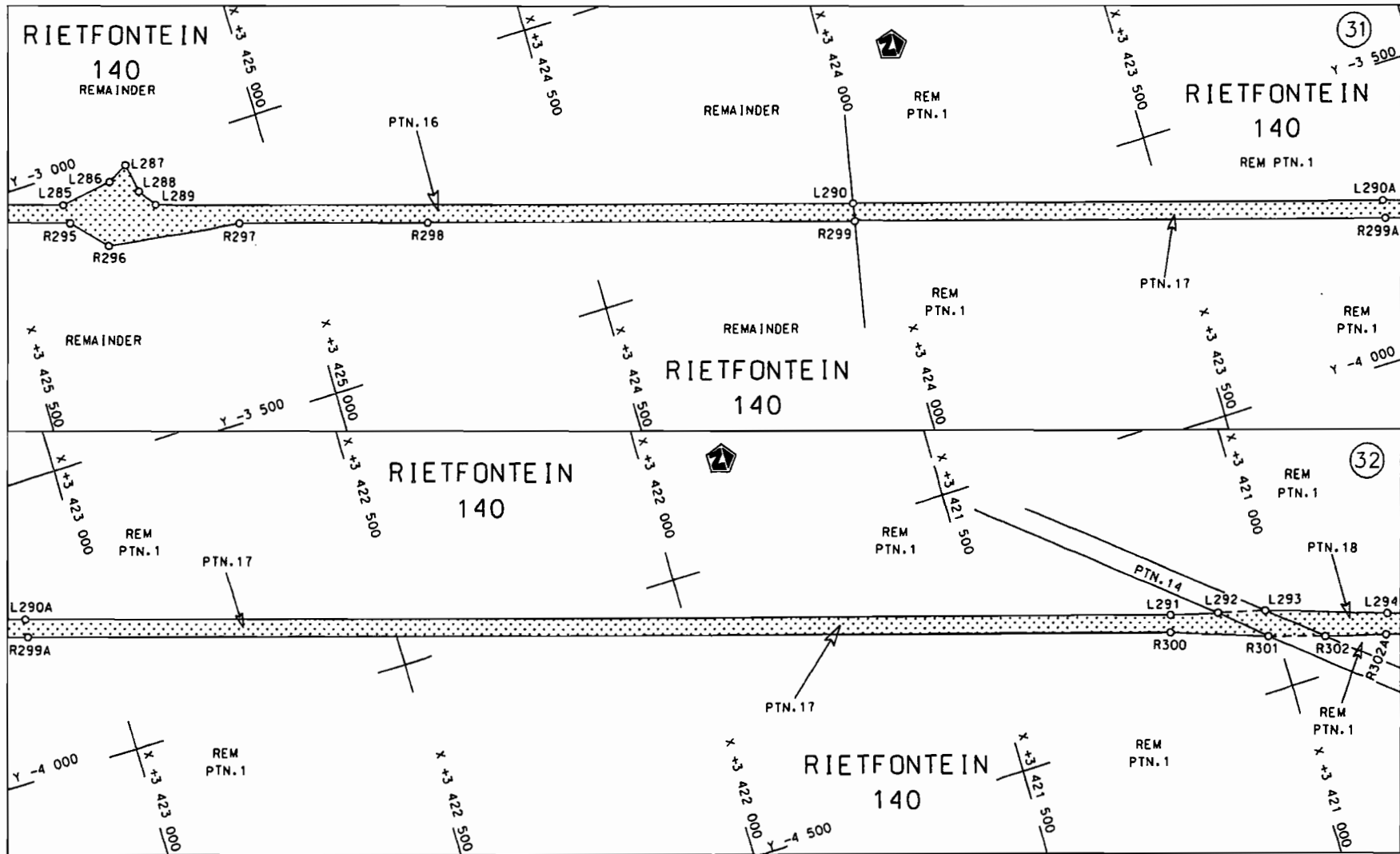

<p>Die Suid Afrikaanse Nasionale Padagentskap Beperk</p>	<p>Die figuur getoon</p>		<p>stel die padreserwe voor van 'n gedeelte represents the road reserve of a portion van Nasionale Roete N9 Seksie 7 of National Route</p>	<p>Vel. van Sheet 16 of 29</p>
<p>The South African National Roads Agency Limited</p>	<p>The figure shown</p>			<p>Plan P651/08</p>

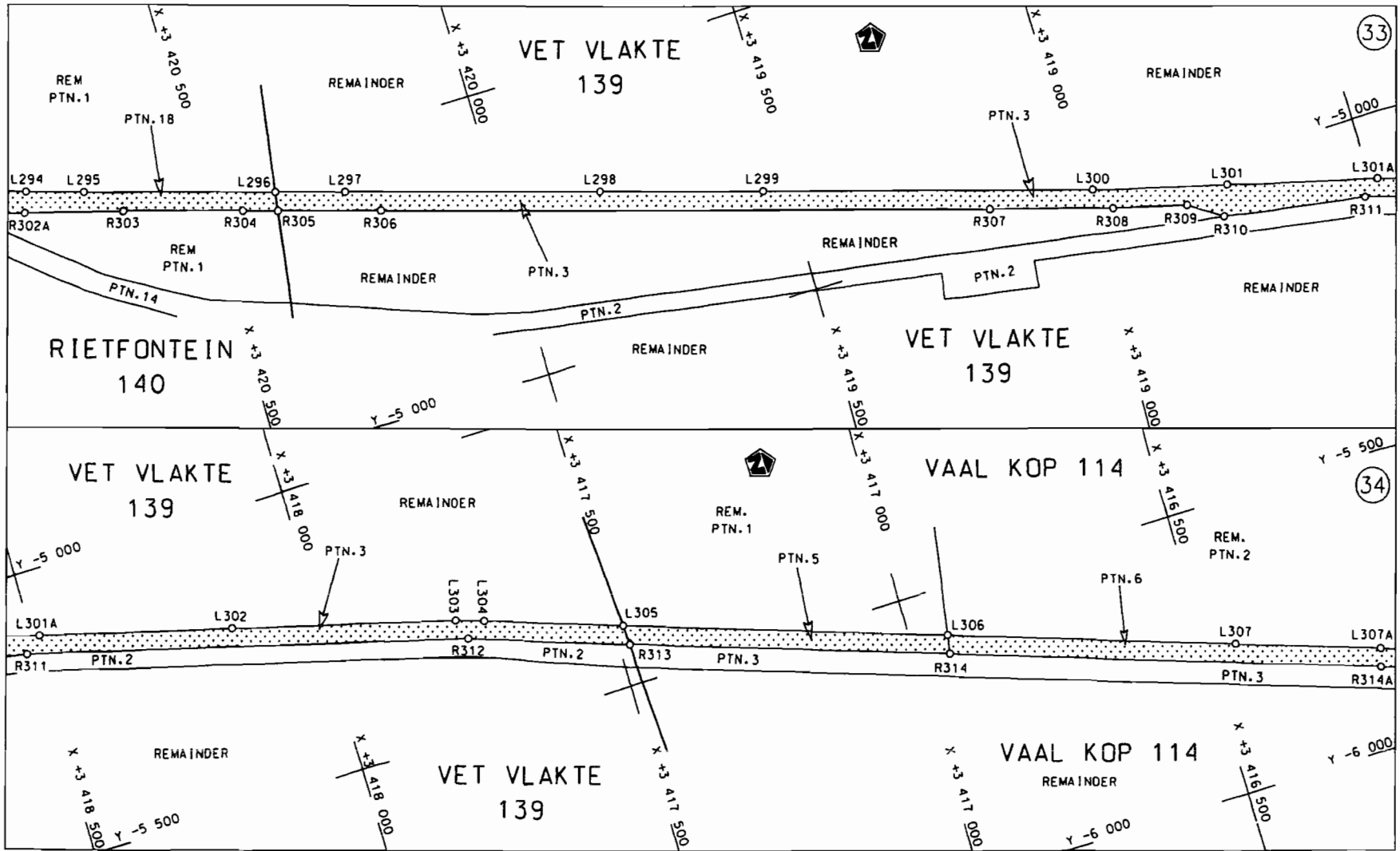

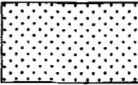
<p>Die Suid Afrikaanse Nasionale Padogentskap Beperk The South African National Roads Agency Limited</p>	<p>Die figuur getoon The figure shown</p>		<p>steldie padreserwe voor van 'n gedeelte represents the road reserve of a portion van Nasionale Roete N9 Seksie of National Route Section 7</p>	<p>Vel Sheet 17 van 29 Plan P651/08</p>
--	---	--	---	---

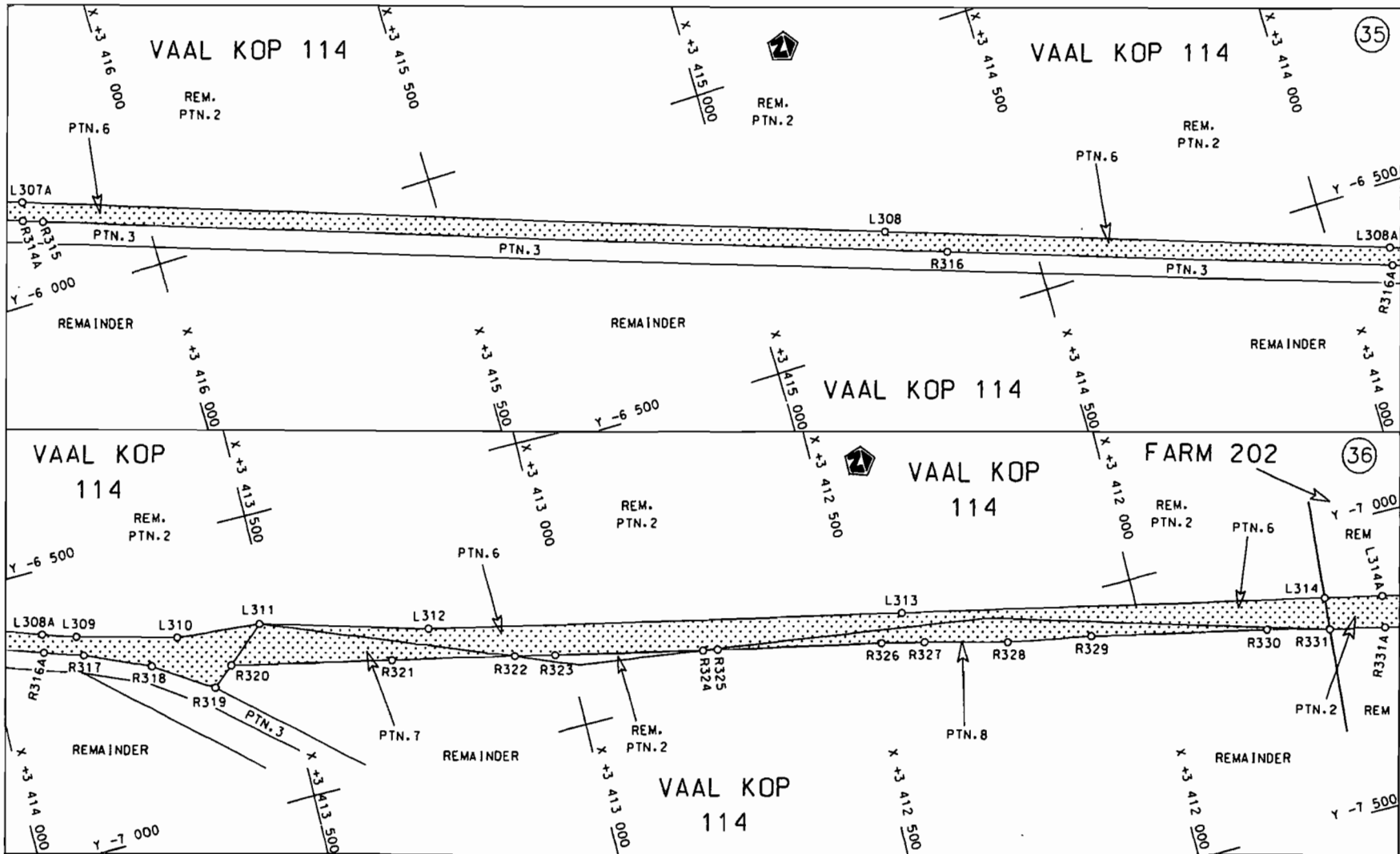

<p>Die Suid Afrikaanse Nasionale Padogentskap Beperk The South African National Roads Agency Limited</p>	<p>Die figuur getoon The figure shown</p> 	<p>steldie padreserwe voor van 'n gedeelte represents the rood reserve of a portion van Nasionale Roete N9 Sektie of National Route Section 7</p>	<p>Vel Sheet 18 van of 29 Plan P651/08</p>
--	--	---	--

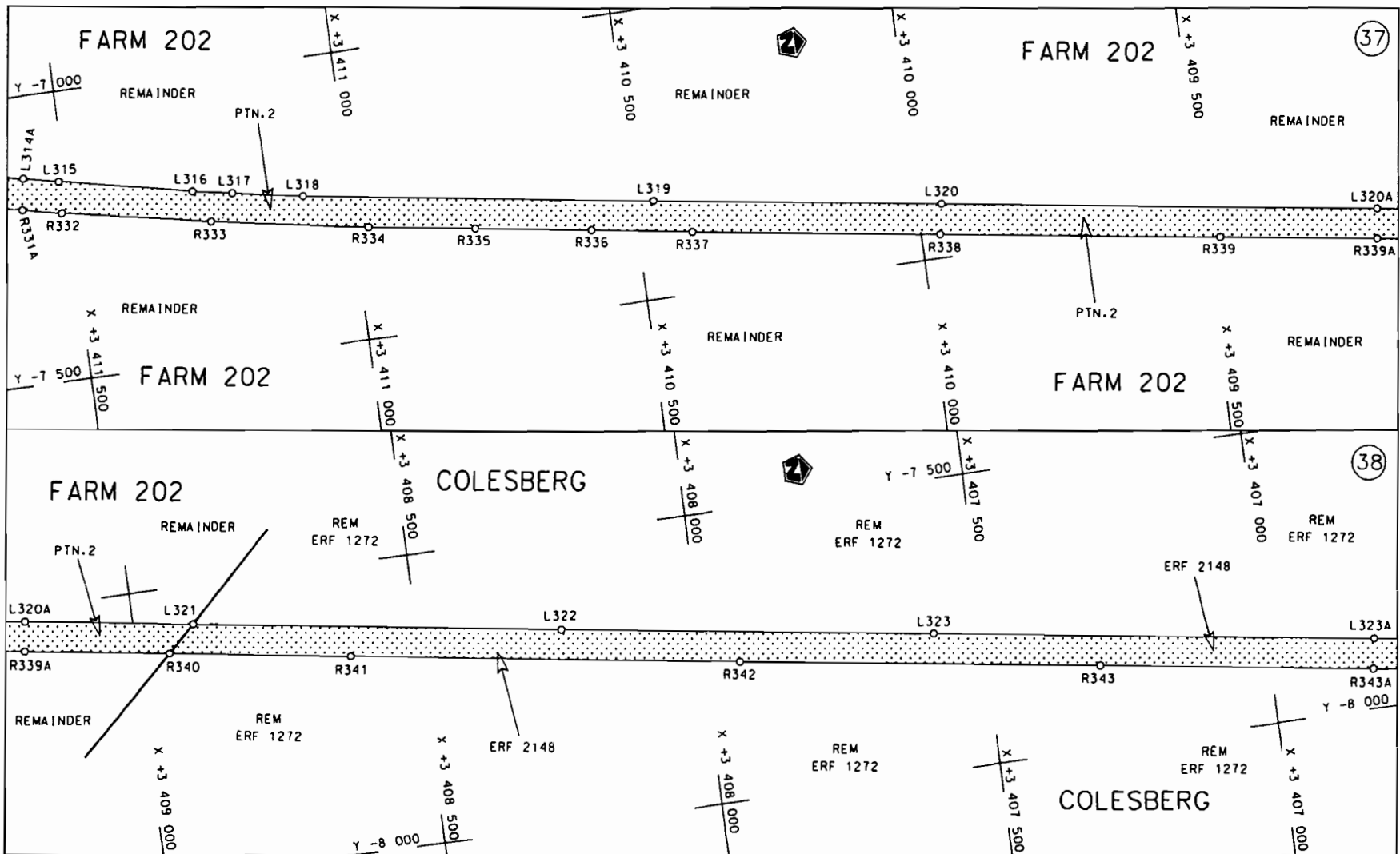

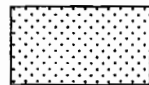
<p>Die Suid Afrikaanse Nasionale Padagentskap Beperk The South African National Roads Agency Limited</p>	<p>Die figuur getoon The figure shown</p>	<p>  steldie padreserwe voor van 'n gedeelte represents the road reserve of a portion van Nasionale Roete N9 Seksie 7 of National Route </p>	<p> Vel Sheet 19 van of 29 Plan P651/08 </p>
--	---	---	---

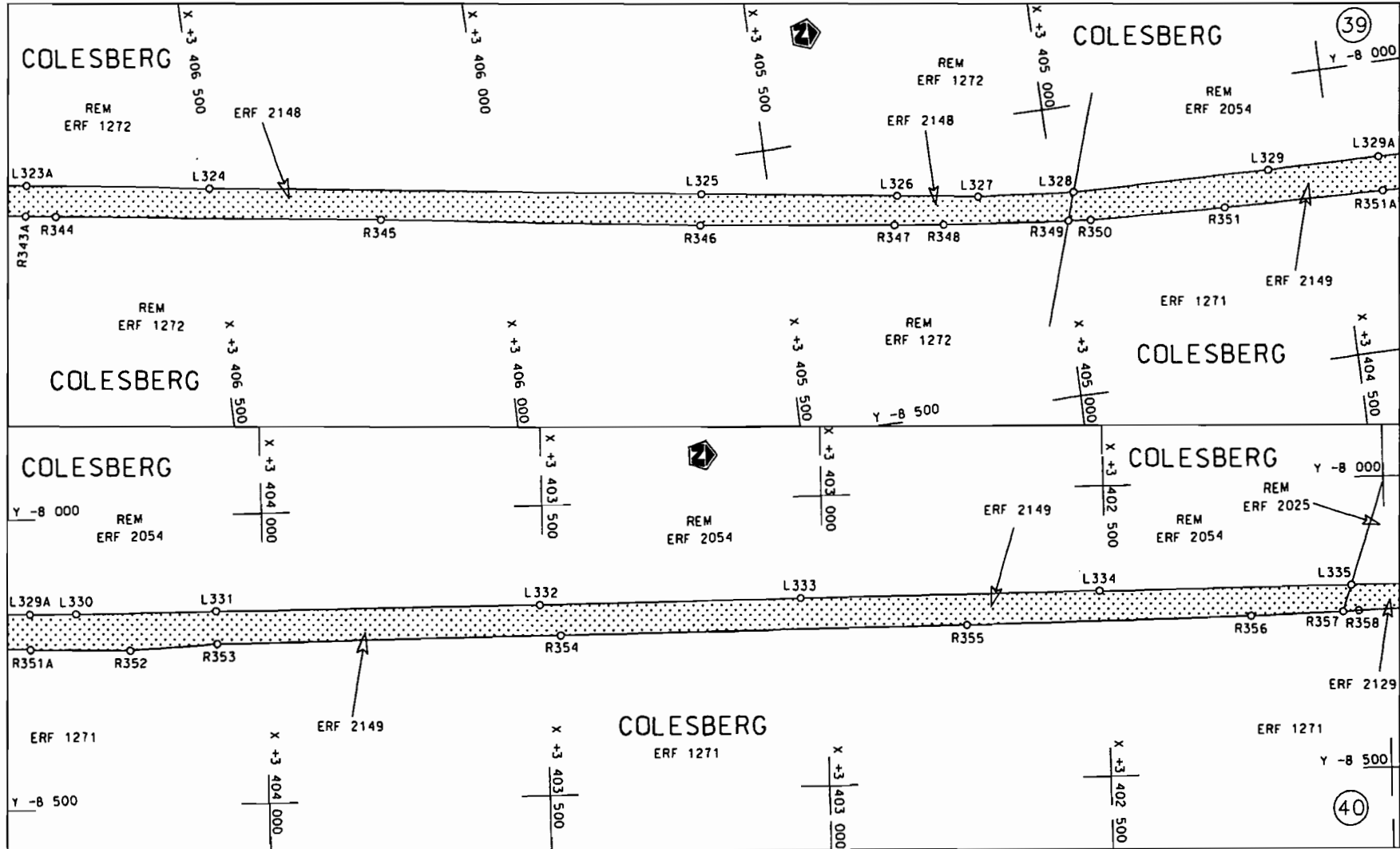

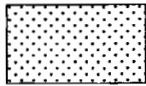
<p>Die Suid Afrikaanse Nasionale Padagentskap Beperk The South African National Roads Agency Limited</p>	<p>Die figuur getoon The figure shown</p>	 <p>steldie padreserwe voor van 'n gedeelte represents the road reserve of a portion van Nasionale Roete N9 Seksie 7 of National Route</p>	<p>Vel Sheet 20 of 29 Plan P651/08</p>
--	---	--	--

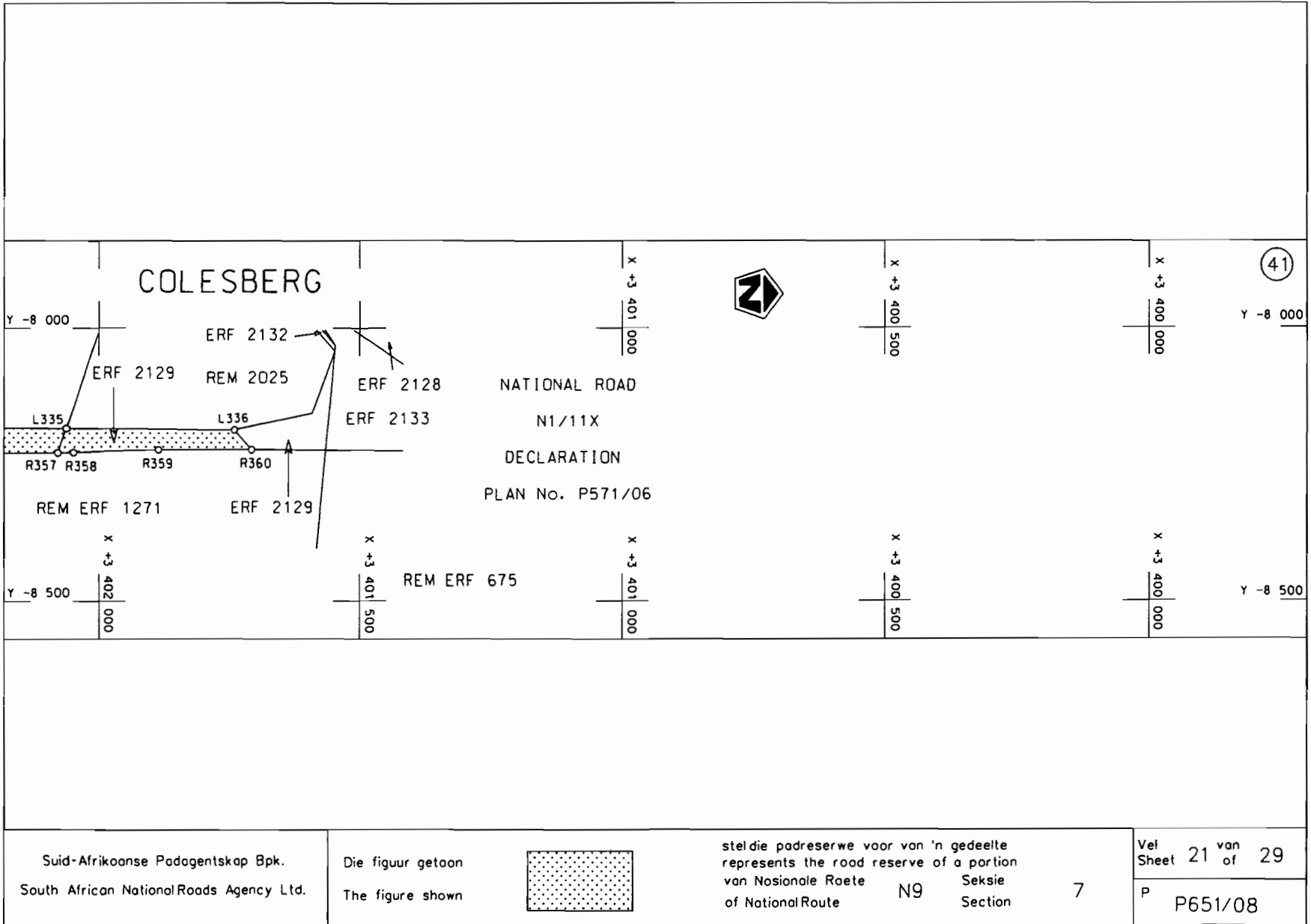

Suid-Afrikaanse Padagentskap Bpk.
South African National Roads Agency Ltd.

Die figuur getoon
The figure shown



steldie padreserwe voor van 'n gedeelte
represents the road reserve of a portion
van Nasionale Roete N9
of National Route

Seksie
Section 7

Vel
Sheet 21 van
of 29

P P651/08

PADRESERWE KOÖRDINATE / ROAD RESERVE CO-ORDINATES											
LINKERKANT/LEFT HAND SIDE					REGTERKANT/RIGHT HAND SIDE						
					WG 25°						
					X						
AL1	-1	696.121	3	488	281.096	AR1	-1	932.302	3	488	356.822
AL2	-1	710.366	3	488	253.582	AR2	-1	894.268	3	488	263.313
AL3	-1	747.516	3	488	184.672	AR3	-1	870.118	3	488	201.032
AL4	-1	798.998	3	488	066.713	AR4	-1	849.429	3	488	033.222
AL5	-1	836.838	3	487	929.401	AR5	-1	846.049	3	488	032.522
AL6	-1	898.818	3	487	695.697	AR6	-1	870.469	3	487	938.401
AL7	-1	948.527	3	487	504.935	AR7	-1	927.878	3	487	712.408
AL8	-1	990.737	3	487	337.302	AR8	-1	970.938	3	487	543.705
AL9	-2	046.196	3	487	118.859	AR9	-2	021.577	3	487	344.192
AL10	-2	083.276	3	486	980.817	AR10	-2	087.162	3	487	095.228
AL11	-2	098.445	3	486	916.776	AR11	-2	130.742	3	486	927.178
AL12	-2	105.145	3	486	879.525	AR12	-2	142.993	3	486	805.637
AL13	-2	109.425	3	486	834.515	AR13	-2	136.563	3	486	702.697
AL14	-2	109.105	3	486	786.874	AR14	-2	127.473	3	486	666.256
AL15	-2	105.484	3	486	743.223	AR15	-2	086.863	3	486	537.110
AL16	-2	099.894	3	486	705.613	AR16	-2	032.002	3	486	435.140
AL17	-2	069.263	3	486	592.422	AR17	-1	873.758	3	486	157.507
AL18	-2	023.192	3	486	489.090	AR18	-1	809.329	3	486	041.265
AL19	-1	913.869	3	486	296.378	AR19	-1	705.042	3	485	853.111
AL20	-1	787.586	3	486	075.616	AR20	-1	693.755	3	485	832.746
AL21	-1	769.912	3	486	045.889	AR21	-1	584.152	3	485	651.561
AL22	-1	669.184	3	485	876.474	AR22	-1	534.843	3	485	566.754
AL23	-1	657.069	3	485	855.218	R1	-1	457.460	3	485	431.500
AL24	-1	596.921	3	485	742.737	R2	-1	216.100	3	485	010.310
AL25	-1	582.262	3	485	716.228	R3	-1	153.910	3	484	902.170
AL26	-1	573.607	3	485	700.233	R4	-1	123.500	3	484	846.160
AL27	-1	546.121	3	485	648.956	R5	-1	096.950	3	484	791.250
AL28	-1	491.425	3	485	557.352	R6	-1	072.920	3	484	735.300
AL29	-1	471.011	3	485	523.164	R7	-1	051.350	3	484	678.260
AL30	-1	413.450	3	485	420.623	R8	-1	032.510	3	484	620.360
L1	-1	395.070	3	485	389.830	R9	-1	016.210	3	484	561.700
L2	-	989.360	3	484	682.310	R10	-1	002.660	3	484	502.380
L3	-	963.530	3	484	629.210	R11	-	997.280	3	484	472.470
L4	-	943.600	3	484	573.910	R12	-1	012.680	3	484	437.980
L5	-	929.280	3	484	517.120	R13	-1	003.100	3	484	424.220
L6	-	868.280	3	484	357.490	R14	-	987.230	3	484	419.570
L7	-	930.510	3	484	025.860	R15	-	973.110	3	484	279.380
L8	-	981.320	3	483	777.920	R16	-	975.790	3	484	148.350
L9	-1	029.290	3	483	540.220	R17	-	991.360	3	484	017.580
L10	-1	083.910	3	483	352.120	R18	-1	046.810	3	483	739.390
L11	-1	160.990	3	483	179.390	R19	-1	034.550	3	483	713.180
L12	-1	247.030	3	483	057.900	R20	-1	084.220	3	483	475.090
L13	-1	339.810	3	482	980.010	R21	-1	145.390	3	483	300.200
L14	-1	531.670	3	482	819.520	R22	-1	200.610	3	483	193.730
L15	-1	562.700	3	482	794.310	R23	-1	301.290	3	483	059.080
L16	-1	610.650	3	482	756.410	R24	-1	372.220	3	483	004.830
L17	-1	651.570	3	482	709.660	R25	-1	566.060	3	482	846.350
L18	-1	728.630	3	482	562.630	R26	-1	672.060	3	482	736.090
L19	-1	763.680	3	482	424.510	R27	-1	745.230	3	482	609.040
L20	-1	803.110	3	482	035.800	R28	-1	779.240	3	482	488.270
L21	-1	805.840	3	482	006.370	R29	-1	800.840	3	482	370.850

PADRESERWE KOÖRDINATE / ROAD RESERVE CO-ORDINATES											
LINKERKANT/LEFT HAND SIDE					REGTERKANT/RIGHT HAND SIDE						
					WG 25°						
					X						
L22	-1	834.030	3	481	726.690	R30	-1	832.710	3	482	040.300
L23	-1	844.660	3	481	459.580	R31	-1	891.130	3	481	470.190
L24	-1	850.490	3	481	445.550	R32	-1	921.600	3	481	172.450
L25	-1	915.120	3	480	915.120	R33	-1	955.570	3	480	840.050
L26	-1	946.260	3	480	602.630	R34	-1	988.570	3	480	508.390
L27	-1	996.830	3	480	094.240	R35	-2	040.440	3	479	982.770
L28	-2	038.350	3	479	675.890	R36	-2	082.610	3	479	553.640
L29	-2	084.640	3	479	208.540	R37	-2	357.920	3	479	529.350
L30	-2	116.010	3	478	892.880	R38	-2	356.280	3	479	499.130
L31	-2	180.800	3	478	458.080	R39	-2	085.790	3	479	522.880
L32	-2	225.420	3	478	158.870	R40	-2	117.260	3	479	200.120
L33	-2	306.200	3	477	617.410	R41	-2	147.060	3	478	899.170
L34	-2	351.090	3	477	317.860	R42	-2	192.070	3	478	597.420
L35	-2	382.100	3	477	109.240	R43	-2	238.610	3	478	284.710
L36	-2	439.400	3	476	723.350	R44	-2	283.090	3	477	987.280
L37	-2	439.450	3	476	723.050	R45	-2	332.520	3	477	654.980
L38	-2	480.480	3	476	444.500	R45X	-2	469.650	3	476	733.490
L39	-2	540.690	3	476	033.580	R46	-2	469.650	3	476	733.490
L40	-2	527.970	3	476	017.040	R47	-2	518.370	3	476	405.920
L41	-2	528.960	3	476	012.650	R48	-2	553.750	3	476	168.550
L42	-2	545.310	3	476	001.960	R49	-2	602.680	3	475	837.370
L43	-2	586.670	3	475	722.000	R50	-2	677.270	3	475	336.110
L44	-2	628.010	3	475	445.260	R51	-2	697.160	3	475	195.720
L45	-2	689.270	3	475	033.480	R52	-2	720.270	3	475	041.920
L46	-2	689.580	3	475	031.400	R53	-2	720.550	3	475	040.080
L47	-2	706.500	3	474	922.650	R54	-2	750.390	3	474	841.210
L48	-2	734.630	3	474	741.880	R55	-2	751.280	3	474	836.110
L49	-2	772.480	3	474	560.810	R56	-2	768.880	3	474	734.750
L50	-2	896.790	3	474	086.670	R57	-2	802.380	3	474	573.920
L51	-3	043.540	3	473	528.850	R58	-2	905.690	3	474	178.260
L52	-3	083.510	3	473	406.660	R59	-3	033.200	3	473	693.610
L53	-3	147.960	3	473	240.390	R60	-3	074.960	3	473	535.070
L54	-3	234.100	3	473	164.430	R61	-3	098.110	3	473	465.860
L55	-3	272.510	3	473	106.920	R62	-3	112.480	3	473	424.810
L56	-3	285.220	3	473	086.640	R63	-3	116.490	3	473	414.530
L57	-3	322.280	3	473	026.320	R64	-3	153.120	3	473	349.390
L58	-3	331.780	3	473	001.670	R65	-3	298.390	3	473	136.200
L59	-3	341.570	3	472	973.690	R66	-3	307.710	3	473	122.430
L60	-3	352.540	3	472	897.540	R67	-3	372.280	3	473	027.040
L61	-3	354.430	3	472	884.400	R68	-3	394.280	3	472	939.910
L62	-3	350.110	3	472	844.450	R69	-3	384.160	3	472	850.530
L63	-3	332.450	3	472	778.870	R70	-3	371.270	3	472	803.530
L64	-3	299.100	3	472	719.550	R71	-3	362.520	3	472	771.600
L65	-3	251.460	3	472	668.730	R72	-3	324.730	3	472	701.850
L66	-3	192.620	3	472	630.550	R73	-3	268.390	3	472	641.870
L67	-3	125.200	3	472	605.840	R74	-3	246.860	3	472	627.550
L68	-2	847.870	3	472	566.350	R75	-3	255.410	3	472	616.420
L69	-2	819.180	3	472	562.190	R76	-3	250.800	3	472	611.200
L70	-2	744.930	3	472	546.000	R77	-3	240.900	3	472	623.470
L71	-2	645.010	3	472	515.070	R78	-3	211.410	3	472	603.860
L72	-2	569.340	3	472	483.310	R79	-3	114.830	3	472	577.290

Vel	23	Van	29	P651/08
Sheet		of		

PADRESERWE KOÖRDINATE / ROAD RESERVE CO-ORDINATES							
LINKERKANT/LEFT HAND SIDE				REGTERKANT/RIGHT HAND SIDE			
				WG 25°	X		
L73	-2	480.780	3 472	434.160	R80	-2	917.140 3 472 547.880
L74	-2	378.790	3 472	366.720	R81	-2	893.380 3 472 548.260
L75	-2	297.570	3 472	284.220	R82	-2	857.320 3 472 541.700
L76	-2	266.520	3 472	248.850	R83	-2	752.660 3 472 520.460
L77	-2	259.850	3 472	240.160	R84	-2	748.190 3 472 519.280
L78	-2	206.740	3 472	170.920	R85	-2	657.630 3 472 489.360
L79	-2	197.820	3 472	159.060	R86	-2	582.670 3 472 457.560
L80	-2	136.240	3 472	056.080	R87	-2	483.400 3 472 398.060
L81	-2	125.690	3 472	036.950	R88	-2	397.370 3 472 339.600
L82	-1	985.720	3 471	793.130	R89	-2	293.220 3 472 232.060
L83	-1	811.800	3 471	490.680	R90	-2	293.150 3 472 231.960
L84	-1	641.090	3 471	193.630	R91	-2	231.410 3 472 150.460
L85	-1	580.000	3 471	087.330	R92	-2	222.880 3 472 136.790
L86	-1	453.490	3 470	909.080	R93	-2	166.340 3 472 059.780
L87	-1	341.190	3 470	794.930	R94	-2	162.090 3 472 026.110
L88	-1	186.520	3 470	675.390	R95	-2	153.030 3 472 021.460
L89	-1	048.620	3 470	603.440	R96	-2	015.030 3 471 782.250
L90	-	666.420	3 470	397.440	R97	-1	845.290 3 471 486.690
L91	-	426.960	3 470	254.810	R98	-1	672.880 3 471 185.190
L92	-	304.930	3 470	174.370	R99	-1	609.430 3 471 074.230
L93	-	177.860	3 470	083.960	R100	-1	490.990 3 470 905.510
L94	-	53.960	3 469	990.210	R101	-1	344.520 3 470 757.130
L95		30.840	3 469	919.890	R102	-1	234.310 3 470 671.660
L96		57.840	3 469	897.590	R103	-1	129.290 3 470 612.480
L97		64.220	3 469	893.280	R104	-1	094.730 3 470 593.010
L98		122.410	3 469	844.740	R105	-1	029.970 3 470 557.620
L99		333.000	3 469	652.150	R106	-	740.480 3 470 403.950
L100		650.970	3 469	344.080	R107	-	454.270 3 470 236.010
L101	1	029.070	3 468	976.770	R108	-	248.410 3 470 097.020
L102	1	128.260	3 468	880.480	R109	-	69.240 3 469 963.400
L103	1	282.900	3 468	730.350	R110		40.990 3 469 876.270
L104	1	618.570	3 468	403.460	R111		263.390 3 469 676.590
L105	1	687.630	3 468	335.780	R112		629.550 3 469 320.900
L106	1	713.080	3 468	310.370	R113		968.410 3 468 991.860
L107	1	876.810	3 468	150.690	R114	1	101.220 3 468 862.730
L108	2	164.650	3 467	870.490	R115	1	101.570 3 468 862.390
L109	2	658.410	3 467	390.980	R116	1	507.690 3 468 467.700
L110	2	849.010	3 467	203.180	R117	1	586.770 3 468 391.080
L111	3	058.980	3 466	972.590	R118	1	617.440 3 468 343.420
L112	3	237.320	3 466	754.520	R119	1	667.310 3 468 313.510
L113	3	241.640	3 466	749.210	R120	2	049.160 3 467 940.450
L114	3	433.210	3 466	513.680	R121	2	396.080 3 467 602.390
L115	3	764.750	3 466	105.180	R122	2	634.960 3 467 370.020
L116	3	926.240	3 465	906.670	R123	2	843.330 3 467 169.080
L117	4	113.190	3 465	676.460	R124	3	004.180 3 466 993.110
L118	4	283.630	3 465	467.290	R125	3	176.710 3 466 788.490
L119	4	360.570	3 465	356.280	R126	3	222.230 3 466 730.190
L120	4	430.530	3 465	239.310	R127	3	336.190 3 466 584.240
L121	4	506.110	3 465	076.240	R128	3	304.390 3 466 558.690
L122	4	556.870	3 464	927.010	R129	3	316.740 3 466 542.890
L123	4	589.470	3 464	784.520	R130	3	348.660 3 466 567.980

Vel	24	Van	29	P651/08
Sheet		of		

PADRESERWE KOÖRDINATE / ROAD RESERVE CO-ORDINATES								
LINKERKANT/LEFT HAND SIDE				REGTERKANT/RIGHT HAND SIDE				
				WG 25°	X			
L124	4	600.450	3 464	702.090	R131	3 544.190	3 466	326.890
L125	4	606.530	3 464	639.580	R132	3 728.710	3 466	099.860
L126	4	578.410	3 464	402.140	R133	3 897.260	3 465	894.330
L127	4	561.070	3 464	255.750	R134	4 195.460	3 465	530.600
L128	4	587.260	3 464	083.510	R135	4 321.930	3 465	359.660
L129	4	587.980	3 464	082.440	R136	4 400.480	3 465	229.090
L130	4	599.720	3 464	065.080	R137	4 452.450	3 465	121.080
L131	4	608.510	3 463	919.340	R138	4 517.360	3 464	963.380
L132	4	613.450	3 463	883.670	R139	4 557.600	3 464	801.260
L133	4	655.200	3 463	785.720	R140	4 572.550	3 464	601.400
L134	4	675.890	3 463	735.890	R141	4 521.270	3 464	298.230
L135	4	689.450	3 463	696.150	R142	4 517.850	3 464	190.290
L136	4	689.500	3 463	695.990	R143	4 532.850	3 464	099.530
L137	4	695.510	3 463	674.550	R144	4 533.090	3 464	098.460
L138	4	708.410	3 463	594.940	R145	4 548.470	3 464	029.430
L139	4	711.160	3 463	528.810	R146	4 557.860	3 464	017.580
L140	4	627.450	3 463	357.430	R147	4 567.270	3 463	985.280
L141	4	605.920	3 463	337.130	R148	4 567.190	3 463	969.070
L142	4	604.160	3 463	334.420	R149	4 610.550	3 463	781.070
L143	4	511.650	3 463	191.850	R150	4 612.890	3 463	691.020
L144	4	527.610	3 463	035.950	R151	4 629.510	3 463	622.090
L145	4	572.780	3 462	966.690	R152	4 634.980	3 463	599.400
L146	4	825.110	3 462	812.130	R153	4 658.440	3 463	587.970
L147	5	020.710	3 462	702.790	R154	4 662.470	3 463	527.310
L148	5	198.360	3 462	566.140	R155	4 645.910	3 463	468.030
L149	5	270.550	3 462	501.460	R156	4 587.630	3 463	437.630
L150	5	309.730	3 462	461.210	R157	4 574.720	3 463	374.330
L151	5	362.070	3 462	392.080	R158	4 519.040	3 463	309.080
L152	5	395.840	3 462	334.260	R159	4 482.850	3 463	228.430
L153	5	506.580	3 462	119.000	R160	4 480.250	3 463	222.620
L154	5	637.080	3 461	865.040	R161	4 469.310	3 463	169.120
L155	5	767.960	3 461	610.240	R162	4 481.860	3 463	060.400
L156	5	796.300	3 461	538.000	R163	4 502.980	3 463	008.850
L157	5	816.160	3 461	463.300	R164	4 540.850	3 462	952.990
L158	5	825.890	3 461	382.910	R165	4 598.570	3 462	902.620
L159	5	824.920	3 461	297.890	R166	4 696.850	3 462	846.410
L160	5	816.460	3 461	232.100	R167	4 999.720	3 462	680.190
L161	5	818.360	3 461	221.980	R168	5 225.710	3 462	506.020
L162	5	767.060	3 461	078.020	R169	5 314.820	3 462	407.500
L163	5	703.380	3 460	969.930	R170	5 338.670	3 462	375.320
L164	5	692.320	3 460	951.150	R171	5 440.830	3 462	178.170
L165	5	524.830	3 460	671.340	R172	5 543.320	3 461	979.690
L166	5	469.970	3 460	579.160	R173	5 657.180	3 461	757.720
L167	5	359.390	3 460	379.900	R174	5 736.100	3 461	605.400
L168	5	346.610	3 460	295.520	R175	5 765.680	3 461	530.110
L169	5	351.180	3 460	277.690	R176	5 785.030	3 461	453.150
L170	5	395.500	3 460	139.260	R177	5 793.960	3 461	385.350
L171	5	534.640	3 460	021.400	R178	5 795.040	3 461	308.400
L172	5	589.070	3 459	980.840	R179	5 777.940	3 461	194.280
L173	5	586.310	3 459	968.570	R180	5 737.860	3 461	090.940
L174	5	670.740	3 459	814.850	R181	5 678.760	3 460	991.040

PADRESERWE KOÖRDINATE / ROAD RESERVE CO-ORDINATES									
LINKERKANT/LEFT HAND SIDE				REGTERKANT/RIGHT HAND SIDE					
				WG 25°	X				
L175	5	669.990	3 459	811.610	R182	5	666.610	3 460	970.510
L176	5	653.790	3 459	741.600	R183	5	500.460	3 460	691.790
L177	5	643.760	3 459	612.970	R184	5	370.010	3 460	474.010
L178	5	634.540	3 459	499.530	R185	5	329.230	3 460	390.480
L179	5	628.848	3 459	432.491	R186	5	317.810	3 460	332.360
L180	5	613.760	3 459	244.540	R187	5	305.640	3 460	335.310
L181	5	534.360	3 458	266.430	R188	5	296.710	3 460	326.700
L182	5	533.830	3 458	265.380	R189	5	313.020	3 460	297.580
L183	5	487.600	3 458	078.200	R190	5	336.950	3 460	197.370
L184	5	473.120	3 458	017.320	R191	5	366.260	3 460	129.300
L185	5	389.480	3 457	683.820	R192	5	406.490	3 460	076.470
L186	5	291.290	3 457	294.720	R193	5	463.440	3 460	049.140
L187	5	262.380	3 457	179.430	R194	5	490.550	3 460	032.110
L188	5	193.040	3 457	091.660	R195	5	531.110	3 459	999.360
L189	5	014.450	3 456	381.870	R196	5	574.900	3 459	953.330
L190	4	975.110	3 456	383.540	R197	5	596.250	3 459	917.280
L191	4	949.010	3 456	318.770	R198	5	619.800	3 459	858.780
L192	4	984.210	3 455	796.530	R199	5	628.900	3 459	802.550
L193	4	838.060	3 455	636.730	R200	5	612.550	3 459	641.000
L194	4	774.390	3 455	543.530	R201	5	597.898	3 459	440.291
L195	4	754.520	3 455	505.300	R202	5	578.787	3 459	203.638
L196	4	717.270	3 455	402.860	R203	5	561.357	3 458	989.855
L197	4	558.370	3 454	946.220	R204	5	538.857	3 458	703.182
L198	4	433.630	3 454	598.760	R205	5	530.957	3 458	644.181
L199	4	346.240	3 454	346.720	R206	5	519.637	3 458	578.041
L200	4	238.550	3 454	037.800	R207	5	497.907	3 458	483.720
L201	4	140.170	3 453	754.580	R208	5	474.827	3 458	396.859
L202	4	083.890	3 453	591.270	R209	5	421.542	3 458	196.067
L203	3	940.300	3 453	178.880	R210	5	415.030	3 458	172.070
L204	3	901.180	3 453	074.750	R211	5	301.910	3 457	749.200
L205	3	891.030	3 453	036.850	R212	5	183.930	3 457	307.540
L206	3	620.970	3 452	248.080	R213	5	069.710	3 456	879.580
L207	3	606.130	3 452	196.580	R214	4	967.350	3 456	497.720
L208	3	583.990	3 452	144.990	R215	4	943.030	3 456	406.990
L209	3	555.860	3 452	018.940	R216	4	889.990	3 456	209.120
L210	3	550.400	3 452	008.650	R217	4	771.010	3 455	764.390
L211	3	520.130	3 451	804.990	R218	4	656.640	3 455	339.230
L212	3	517.930	3 451	779.300	R219	4	622.700	3 455	232.150
L213	3	508.890	3 451	674.050	R220	4	574.660	3 455	099.880
L214	3	507.210	3 451	646.030	R221	4	537.190	3 454	989.150
L215	3	509.200	3 451	361.680	R222	4	536.520	3 454	990.330
L216	3	511.550	3 451	215.230	R223	3	591.250	3 452	259.000
L217	3	517.590	3 450	682.840	R224	3	532.540	3 452	042.450
L218	3	519.090	3 450	339.070	R225	3	491.310	3 451	828.830
L219	3	519.570	3 450	288.330	R226	3	488.270	3 451	805.110
L220	3	522.510	3 449	978.930	R227	3	476.730	3 451	662.680
L221	3	534.780	3 448	811.710	R228	3	476.070	3 451	490.580
L222	3	538.880	3 448	474.380	R229	3	478.690	3 451	198.320
L223	3	552.520	3 447	123.520	R230	3	484.660	3 450	671.460
L224	3	570.810	3 446	872.810	R231	3	488.390	3 450	265.580
L225	3	597.580	3 446	725.700	R232	3	507.230	3 448	454.070

Vel	26	Van	29	P651/08
Sheet		of		

PADRESERWE KOÖRDINATE / ROAD RESERVE CO-ORDINATES							
LINKERKANT/LEFT HAND SIDE				REGTERKANT/RIGHT HAND SIDE			
				WG 25°		X	
L226	3	650.690	3 446 538.450	R233	3	521.470	3 447 131.440
L227	3	703.760	3 446 388.930	R234	3	528.860	3 446 943.810
L228	3	808.430	3 446 094.230	R235	3	566.790	3 446 721.340
L229	3	858.540	3 445 917.240	R236	3	621.210	3 446 530.130
L230	3	890.700	3 445 738.290	R237	3	700.310	3 446 307.250
L231	3	926.110	3 445 519.710	R238	3	720.780	3 446 253.680
L232	4	077.610	3 444 568.570	R239	3	696.190	3 446 233.460
L233	4	364.740	3 442 773.850	R240	3	730.080	3 446 140.590
L234	4	389.290	3 442 586.490	R241	3	748.430	3 446 139.420
L235	4	404.260	3 442 342.600	R242	3	781.200	3 446 086.880
L236	4	398.410	3 442 084.150	R243	3	827.920	3 445 911.800
L237	4	384.160	3 441 916.600	R244	3	860.530	3 445 732.050
L238	4	349.150	3 441 703.320	R245	4	040.390	3 444 603.700
L239	4	284.190	3 441 440.480	R246	4	333.770	3 442 768.950
L240	4	225.020	3 441 262.270	R247	4	358.260	3 442 582.080
L241	4	133.760	3 441 040.930	R248	4	372.810	3 442 341.970
L242	4	071.680	3 440 909.840	R249	4	368.660	3 442 102.120
L243	3	866.370	3 440 475.430	R250	4	353.070	3 441 921.180
L244	3	759.850	3 440 250.250	R251	4	318.030	3 441 708.120
L245	3	614.590	3 439 943.190	R252	4	254.490	3 441 450.020
L246	3	537.640	3 439 775.780	R253	4	195.330	3 441 272.580
L247	3	479.400	3 439 606.710	R254	4	101.060	3 441 045.760
L248	3	435.080	3 439 372.540	R255	3	729.910	3 440 260.560
L249	3	425.290	3 439 163.560	R256	3	585.800	3 439 955.070
L250	3	429.170	3 438 941.170	R257	3	508.500	3 439 787.540
L251	3	423.730	3 438 726.110	R258	3	433.620	3 439 545.490
L252	3	419.000	3 438 600.820	R259	3	403.760	3 439 376.370
L253	3	388.430	3 438 399.030	R260	3	394.200	3 439 162.370
L254	3	305.980	3 438 180.530	R261	3	393.510	3 438 978.790
L255	3	282.300	3 438 136.180	R262	3	392.620	3 438 798.600
L256	3	256.170	3 438 087.810	R263	3	389.220	3 438 603.060
L257	3	226.890	3 438 042.280	R264	3	367.100	3 438 460.130
L258	3	156.800	3 437 933.500	R265	3	336.570	3 438 345.260
L259	2	648.110	3 437 168.820	R266	3	271.410	3 438 177.440
L260	2	468.410	3 436 885.180	R267	3	184.680	3 438 031.230
L261	2	310.630	3 436 604.570	R268	2	603.710	3 437 158.310
L262	2	137.100	3 436 245.670	R269	2	441.460	3 436 901.790
L263	2	024.510	3 435 972.720	R270	2	283.020	3 436 619.800
L264	1	970.420	3 435 828.630	R271	2	109.150	3 436 259.830
L265	1	593.630	3 434 759.130	R272	2	002.620	3 436 003.570
L266	1	234.950	3 433 743.200	R273	1	938.230	3 435 831.340
L267	1	212.790	3 433 680.430	R274	1	762.360	3 435 332.360
L268	1	016.050	3 433 121.640	R275	1	555.520	3 434 745.690
L269		725.820	3 432 299.830	R276	1	345.980	3 434 151.360
L270		609.210	3 431 969.340	R277	1	227.500	3 433 816.080
L271		515.510	3 431 703.990	R278	1	180.950	3 433 684.320
L272		448.560	3 431 517.260	R279	1	084.920	3 433 410.840
L273		389.600	3 431 375.660	R280		869.320	3 432 801.150
L274		305.870	3 431 206.200	R281		654.100	3 432 190.510
L275		260.480	3 431 129.720	R282		490.840	3 431 727.000
L276	-	194.330	3 430 368.530	R283		418.700	3 431 527.050

Vel
Sheet

27

Van
of

29

P651/08

PADRESERWE KOÖRDINATE / ROAD RESERVE CO-ORDINATES							
LINKERKANT/LEFT HAND SIDE				REGTERKANT/RIGHT HAND SIDE			
				WG 25°	X		
L277	-	893.290	3 429 197.060	R284	361.720	3 431 389.950	
L278	-1	430.960	3 428 295.070	R285	279.340	3 431 222.640	
L279	-1	726.630	3 427 799.060	R286	226.610	3 431 133.560	
L280	-2	555.420	3 426 408.900	R287	-	534.060	3 429 859.960
L281	-2	775.240	3 426 036.780	R288	-1	458.790	3 428 309.360
L282	-2	853.710	3 425 886.650	R289	-1	469.570	3 428 291.280
L283	-2	934.280	3 425 705.850	R290	-2	666.040	3 426 284.730
L284	-2	994.470	3 425 549.250	R291	-2	807.180	3 426 044.210
L285	-3	050.320	3 425 372.320	R292	-2	874.600	3 425 916.950
L286	-3	036.420	3 425 282.380	R293	-2	961.080	3 425 723.120
L287	-3	015.940	3 425 246.760	R294	-3	026.020	3 425 552.500
L288	-3	066.360	3 425 237.500	R295	-3	083.980	3 425 369.490
L289	-3	097.350	3 425 216.400	R296	-3	140.620	3 425 315.000
L290	-3	457.160	3 424 025.520	R297	-3	171.090	3 425 081.360
L291	-4	318.390	3 421 172.650	R298	-3	267.560	3 424 760.230
L292	-4	340.000	3 421 090.210	R299	-3	487.720	3 424 031.660
L293	-4	360.680	3 421 008.130	R300	-4	347.900	3 421 181.720
L294	-4	429.150	3 420 801.840	R301	-4	405.440	3 421 015.780
L295	-4	459.990	3 420 703.480	R302	-4	435.490	3 420 918.480
L296	-4	559.310	3 420 374.330	R303	-4	511.210	3 420 645.350
L297	-4	595.100	3 420 255.740	R304	-4	573.320	3 420 440.450
L298	-4	726.070	3 419 820.730	R305	-4	591.830	3 420 379.320
L299	-4	810.800	3 419 541.390	R306	-4	644.780	3 420 204.460
L300	-4	980.720	3 418 978.580	R307	-4	958.930	3 419 163.180
L301	-5	043.520	3 418 745.250	R308	-5	021.120	3 418 952.730
L302	-5	199.900	3 418 153.600	R309	-5	055.480	3 418 823.840
L303	-5	301.040	3 417 768.810	R310	-5	094.290	3 418 765.940
L304	-5	316.160	3 417 720.960	R311	-5	135.990	3 418 516.990
L305	-5	396.100	3 417 483.560	R312	-5	337.160	3 417 756.490
L306	-5	581.560	3 416 934.410	R313	-5	430.630	3 417 481.180
L307	-5	745.990	3 416 447.080	R314	-5	613.070	3 416 939.810
L308	-6	320.210	3 414 747.780	R315	-5	870.780	3 416 176.390
L309	-6	628.020	3 413 838.820	R316	-6	385.960	3 414 651.150
L310	-6	672.810	3 413 666.920	R317	-6	662.100	3 413 833.930
L311	-6	686.650	3 413 520.680	R318	-6	709.460	3 413 723.510
L312	-6	770.460	3 413 229.100	R319	-6	774.910	3 413 623.340
L313	-6	954.290	3 412 406.570	R320	-6	743.360	3 413 586.650
L314	-7	117.930	3 411 672.070	R321	-6	806.250	3 413 305.870
L315	-7	154.050	3 411 511.650	R322	-6	853.480	3 413 092.720
L316	-7	202.570	3 411 279.120	R323	-6	869.040	3 413 022.500
L317	-7	215.190	3 411 208.430	R324	-6	927.370	3 412 764.520
L318	-7	237.790	3 411 082.840	R325	-6	933.110	3 412 739.160
L319	-7	330.860	3 410 466.050	R326	-6	995.650	3 412 454.730
L320	-7	407.110	3 409 957.240	R327	-7	013.480	3 412 379.770
L321	-7	566.860	3 408 894.540	R328	-7	051.020	3 412 235.820
L322	-7	664.170	3 408 244.100	R329	-7	077.950	3 412 089.720
L323	-7	762.810	3 407 586.600	R330	-7	144.990	3 411 785.370
L324	-7	928.090	3 406 487.900	R331	-7	173.100	3 411 676.460
L325	-8	059.020	3 405 619.570	R332	-7	209.130	3 411 513.680
L326	-8	110.790	3 405 275.240	R333	-7	259.100	3 411 253.030
L327	-8	132.560	3 405 132.050	R334	-7	307.290	3 410 974.440

Vel 28
Sheet ofVan 29
of

P651/08

PADRESERWE KOÖRDINATE / ROAD RESERVE CO-ORDINATES									
LINKERKANT/LEFT HAND SIDE				REGTERKANT/RIGHT HAND SIDE					
				WG 25°				X	
L328	-8	148.580	3 404	963.780	R335	-7	334.690	3 410	787.820
L329	-8	158.160	3 404	614.030	R336	-7	365.640	3 410	582.300
L330	-8	165.380	3 404	334.290	R337	-7	393.240	3 410	404.430
L331	-8	167.180	3 404	084.250	R338	-7	458.970	3 409	966.570
L332	-8	171.610	3 403	508.030	R339	-7	532.060	3 409	474.110
L333	-8	175.570	3 403	041.180	R340	-7	611.590	3 408	942.970
L334	-8	179.560	3 402	511.100	R341	-7	660.440	3 408	621.280
L335	-8	183.790	3 402	061.150	R342	-7	763.660	3 407	935.790
L336	-8	186.320	3 401	738.520	R343	-7	858.900	3 407	300.800
					R344	-7	939.830	3 406	765.720
					R345	-8	024.850	3 406	193.590
					R346	-8	112.620	3 405	629.110
					R347	-8	160.850	3 405	286.790
					R348	-8	172.660	3 405	200.360
					R349	-8	196.840	3 404	979.730
					R350	-8	201.010	3 404	940.820
					R351	-8	213.220	3 404	700.510
					R352	-8	229.620	3 404	239.780
					R353	-8	223.320	3 404	083.900
					R354	-8	224.930	3 403	473.250
					R355	-8	231.490	3 402	747.550
					R356	-8	231.840	3 402	241.450
					R357	-8	229.310	3 402	076.720
					R358	-8	228.880	3 402	048.720
					R359	-8	223.820	3 401	886.480
					R360	-8	223.720	3 401	705.370