

Government Gazette Staatskoerant

REPUBLIC OF SOUTH AFRICA
REPUBLIEK VAN SUID-AFRIKA

Vol. 522

Pretoria, 17 December 2008
Desember

No. 31706

CONTENTS**INHOUD**

<i>No.</i>	<i>Page No.</i>	<i>Gazette No.</i>	<i>No.</i>	<i>Bladsy No.</i>	<i>Koerant No.</i>
GOVERNMENT NOTICE			GOEWERMENSKENNISGEWING		
Transport, Department of			Vervoer, Departement van		
<i>Government Notice</i>			<i>Goewermentskennisgewing</i>		
1357		South African National Roads Agency Limited and the National Roads Act (7/1998): The South African National Roads Agency Limited: Declaration amendment of National Road N2 Section 5X: Amendment of Declaration No. 1322 of 1989	3	31706	
					1357 Suid-Afrikaanse Nasionale Padagentskap Beperk en die Nasionale Paaie Wet (7/1998): Die Suid-Afrikaanse Nasionale Padagentskap Beperk: Verklaring wysiging van Nasionale Pad N2 Seksie 5X: Wysiging van Verklaring No. 1322 van 1989
				4	31706

**GOVERNMENT NOTICE
GOEWERMENTSKENNISGEWING**

**DEPARTMENT OF TRANSPORT
DEPARTEMENT VAN VERVOER**

No. 1357

17 December 2008

**THE SOUTH AFRICAN NATIONAL ROADS
AGENCY LIMITED**

Registration No: 98/09584/06

DECLARATION AMENDMENT OF NATIONAL ROAD N2 SECTION 5X

AMENDMENT OF DECLARATION NO. 1322 of 1989.

By virtue of section 40 (1)(b) of the South African National Roads Agency Limited and the National Roads Act, 1998 (Act No. 7 of 1998), I hereby amend Declaration No. 1322 of 1989 as described in paragraph 2 of the Schedule by substituting the section of the descriptive declaration from Swellendam up to Riversdale, with the subjoined sheets 1 to 35 of plan P675/08 including only the roadway and shoulders (surfaced or gravel) but excluding kerbs, channels, sidewalks and parking areas through the township of Riversdale.

(National Road N2 Section 5X: Swellendam – Riversdale)



MINISTER OF TRANSPORT

No. 1357

17 Desember 2008

DIE SUID-AFRIKAANSE NASIONALE PADAGENTSKAP BEPERK

Registrasie No: 98/09584/06

VERKLARING WYSIGING VAN NASIONALE PAD N2 SEKSIE 5X.

WYSIGING VAN VERKLARING NO. 1322 VAN 1989.

Kragtens Artikel 40(1)(b) van die Suid-Afrikaanse Nasionale Padagentskap Beperk en die Nasionale Paaie Wet, 1998 (Wet No.7 van 1998), wysig ek hiermee Verklaring no. 1322 van 1989, deur Bylae paragraaf 2 die gedeelte van die beskrywende verklaring vanaf Swellendam tot by Riversdal, te vervang met meegaande velle 1 tot 35 van plan P675/08 insluitende slegs die padbaan en skouers (geplavlei of grond), maar uitsluitende randstene, kanale, sypaadjies en parkeer areas deur die dorpsgronde van Riversdal.

(Nasionale Pad N2 Seksie 5X: Swellendam – Riversdal)



MINISTER VAN VERVOER

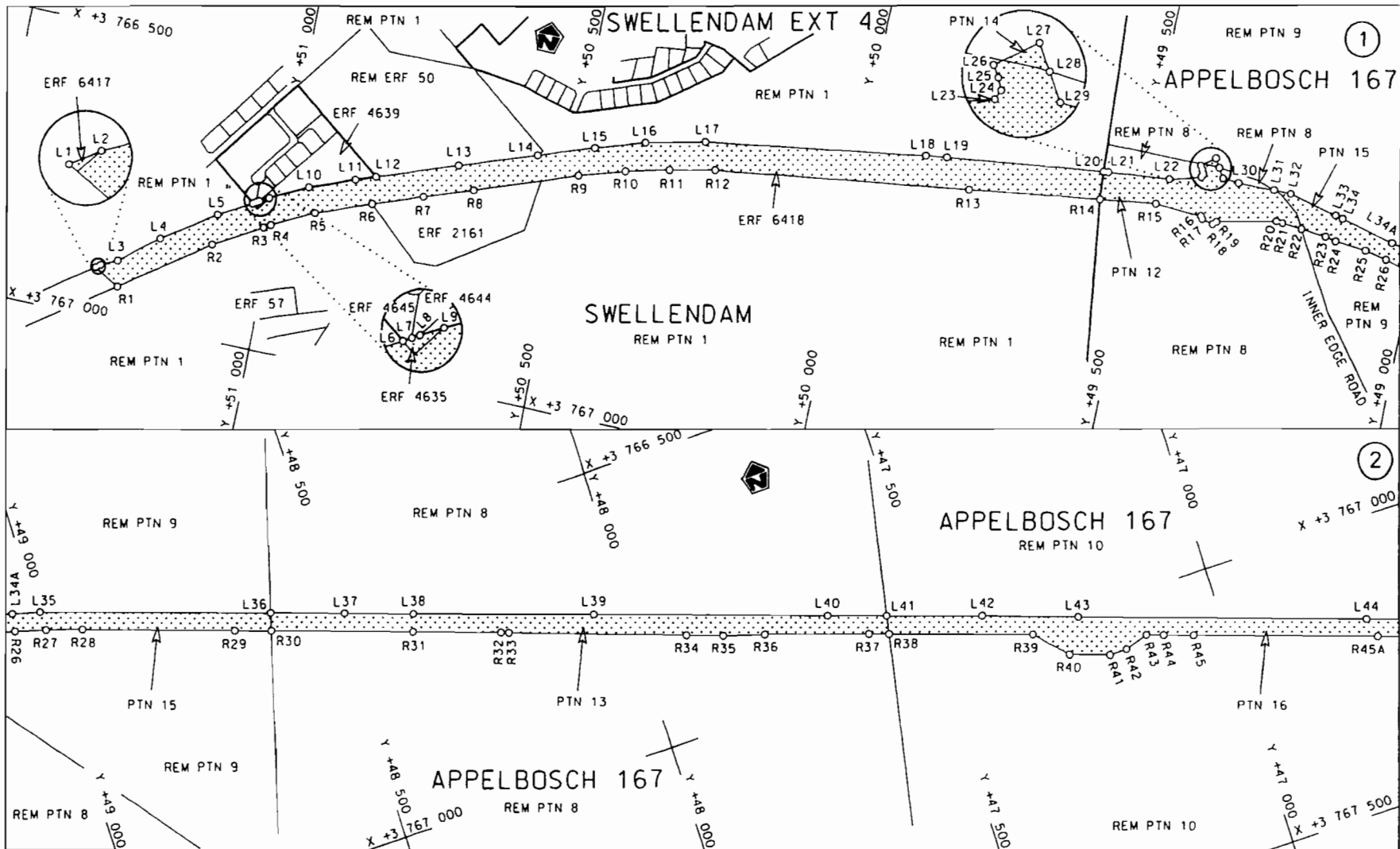

<p>Die Suid Afrikaanse Nasionale Padagentskap Beperk The South African National Roads Agency Limited</p>	<p>Die figuur getoon The figure shown</p> 	<p>steldie padreserwe voor van 'n gedeelte represents the road reserve of a portion van Nasionale Roete N2 Seksie of National Route Section 5X</p>	<p>Vel Sheet 1 van of 35 Plan P675/08</p>
--	--	--	---

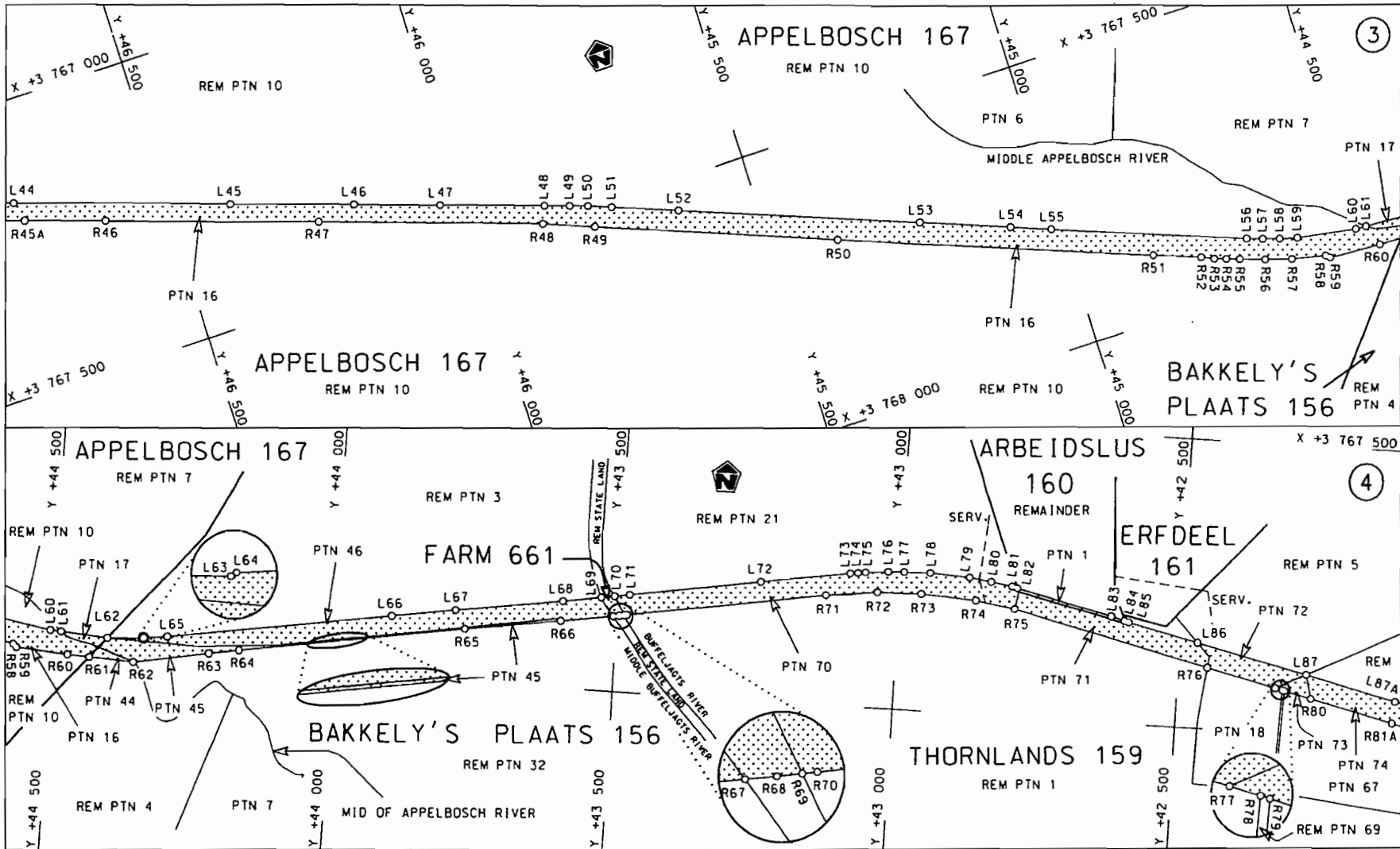

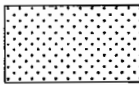
<p>Die Suid Afrikaanse Nasionale Padagentskap Beperk The South African National Roads Agency Limited</p>	<p>Die figuur getoon The figure shown</p> 	<p>steldie padreserwe voor van 'n gedeelte represents the road reserve of a portion van Nasionale Roete N2 of National Route N2</p> <p>Seksie 5X Section</p>	<p>Vel 2 van 35 Sheet of 35</p> <p>Plan P675/08</p>
--	--	--	---

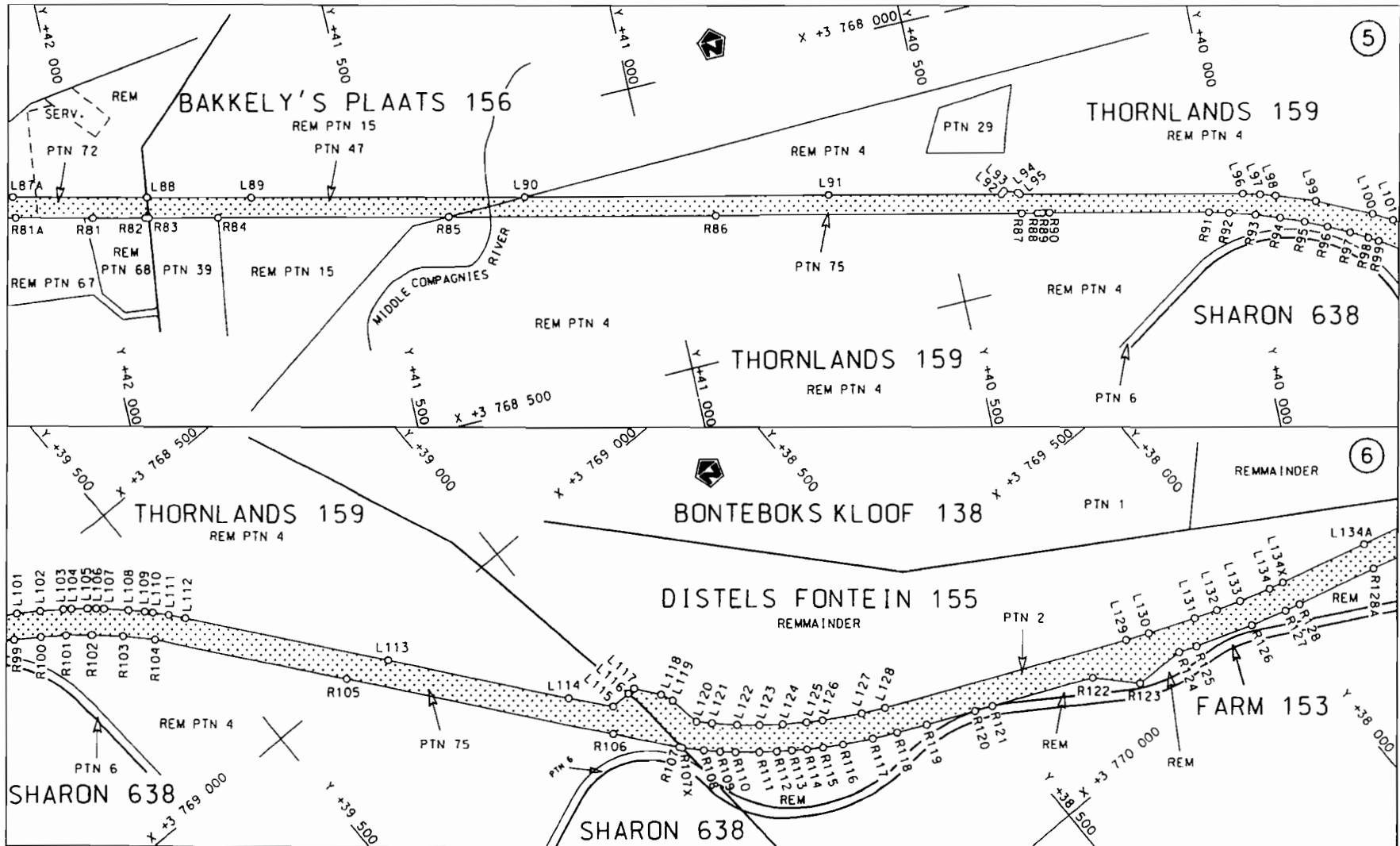

<p>Die Suid Afrikaanse Nasionale Padagentskap Beperk The South African National Roads Agency Limited</p>	<p>Die figuur getoon The figure shown</p> 	<p>steldie padreserwe voor van 'n gedeelte represents the road reserve of a portion van Nasionale Roete of National Route</p> <p>N2 Seksie Section 5X</p>	<p>Vel Sheet 3 van of 35 Plan P675/08</p>
--	--	---	---

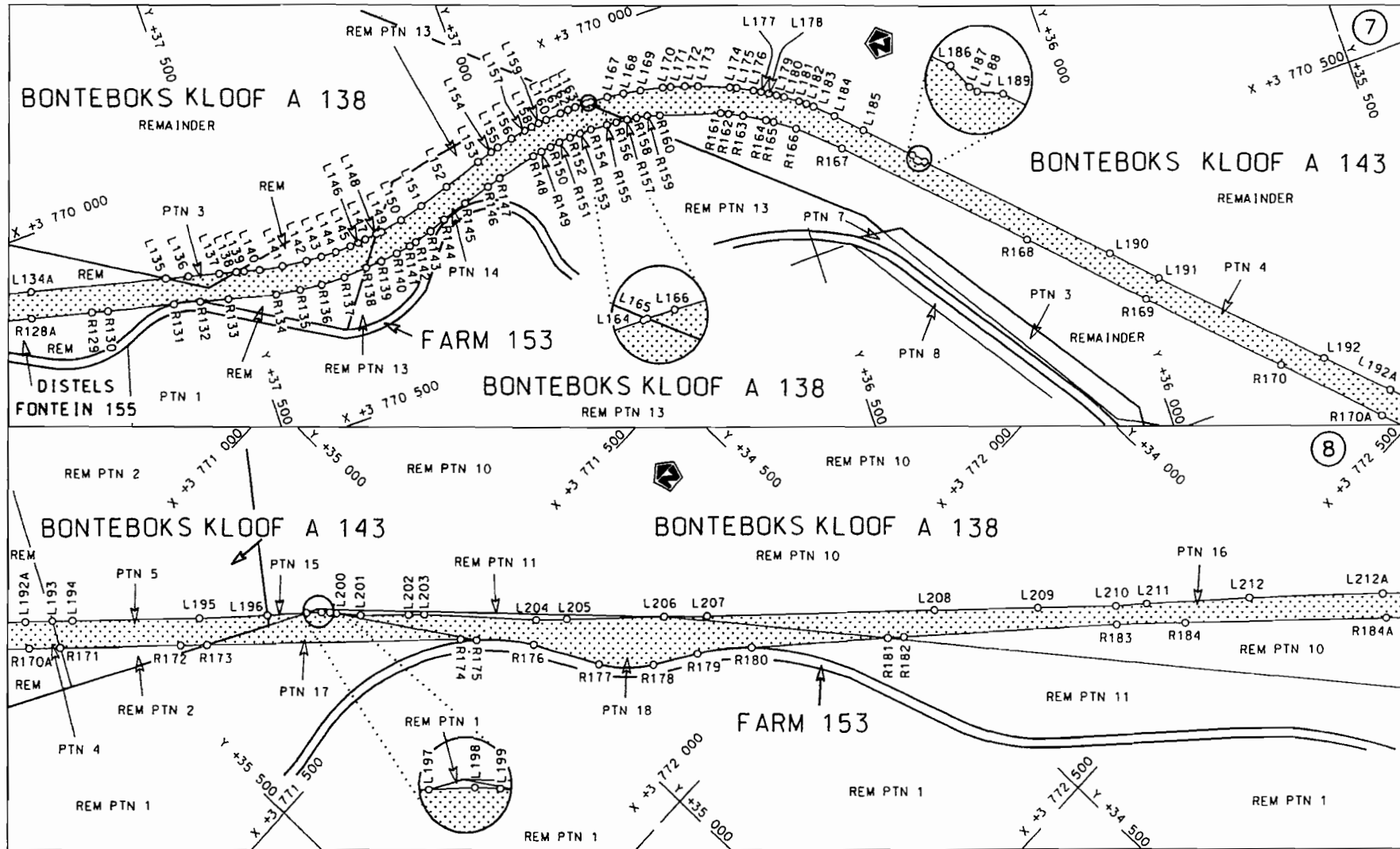

<p>Die Suid Afrikaanse Nasionale Padogentskap Beperk The South African National Roads Agency Limited</p>	<p>Die figuur getoon The figure shown</p>	 <p>steldie podreserve voor van 'n gedeelte represents the road reserve of a portion van Nasionale Roete of National Route</p>	<p>Vel Sheet 4 von of 35</p>
<p>N2 Seksie Section 5X</p>			<p>Plan P675/08</p>

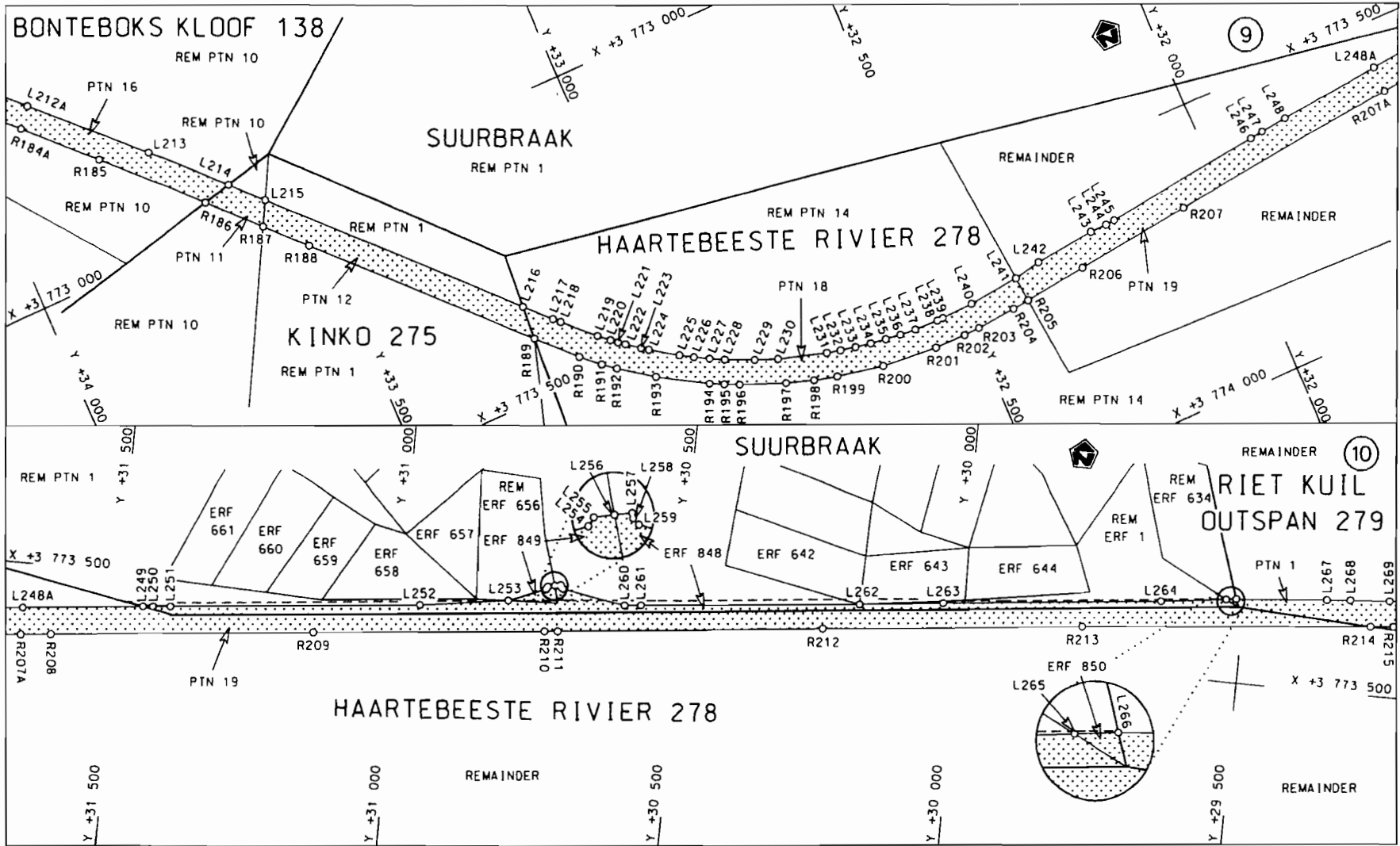

Die Suid Afrikaanse Nasionale Padogentskap Beperk
The South African National Roads Agency Limited

Die figuur getoon
The figure shown



steldie padreserwe voor van 'n gedeelte
represents the road reserve of a portion
van Nasionale Roete of National Route

N2 Seksie Section 5X

Vel Sheet 5 van of 35
Plan P675/08

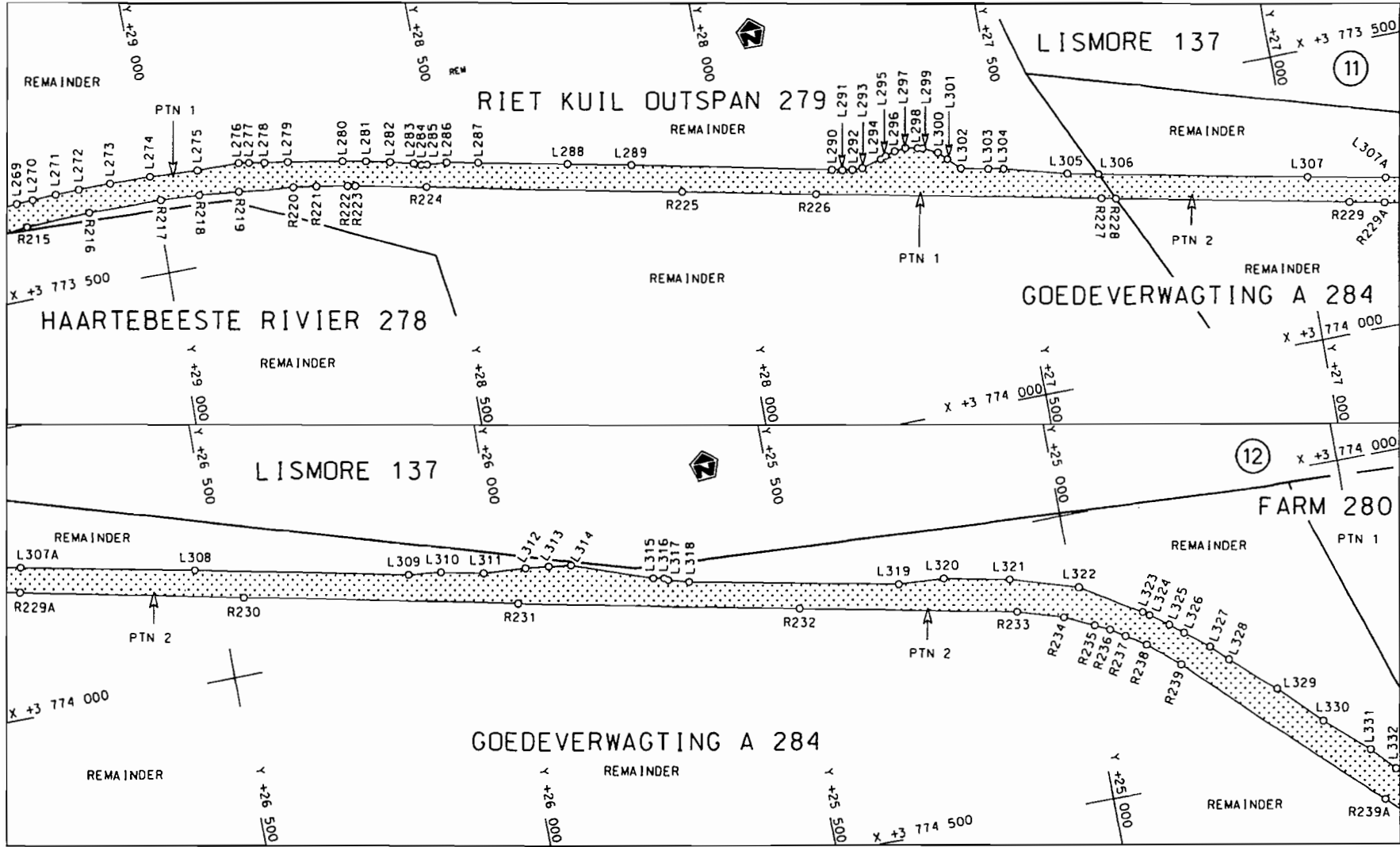

<p>Die Suid Afrikaanse Nasionale Padagentskap Beperk The South African National Roads Agency Limited</p>	<p>Die figuur getoon The figure shown</p>		<p>steldie podreserwe voor van 'n gedeelte represents the road reserve of a portion van Nasionale Roete N2 of National Route</p> <p>Seksie Section 5X</p>	<p>Vel Sheet 6 van of 35 Plan P675/08</p>
--	---	--	---	---

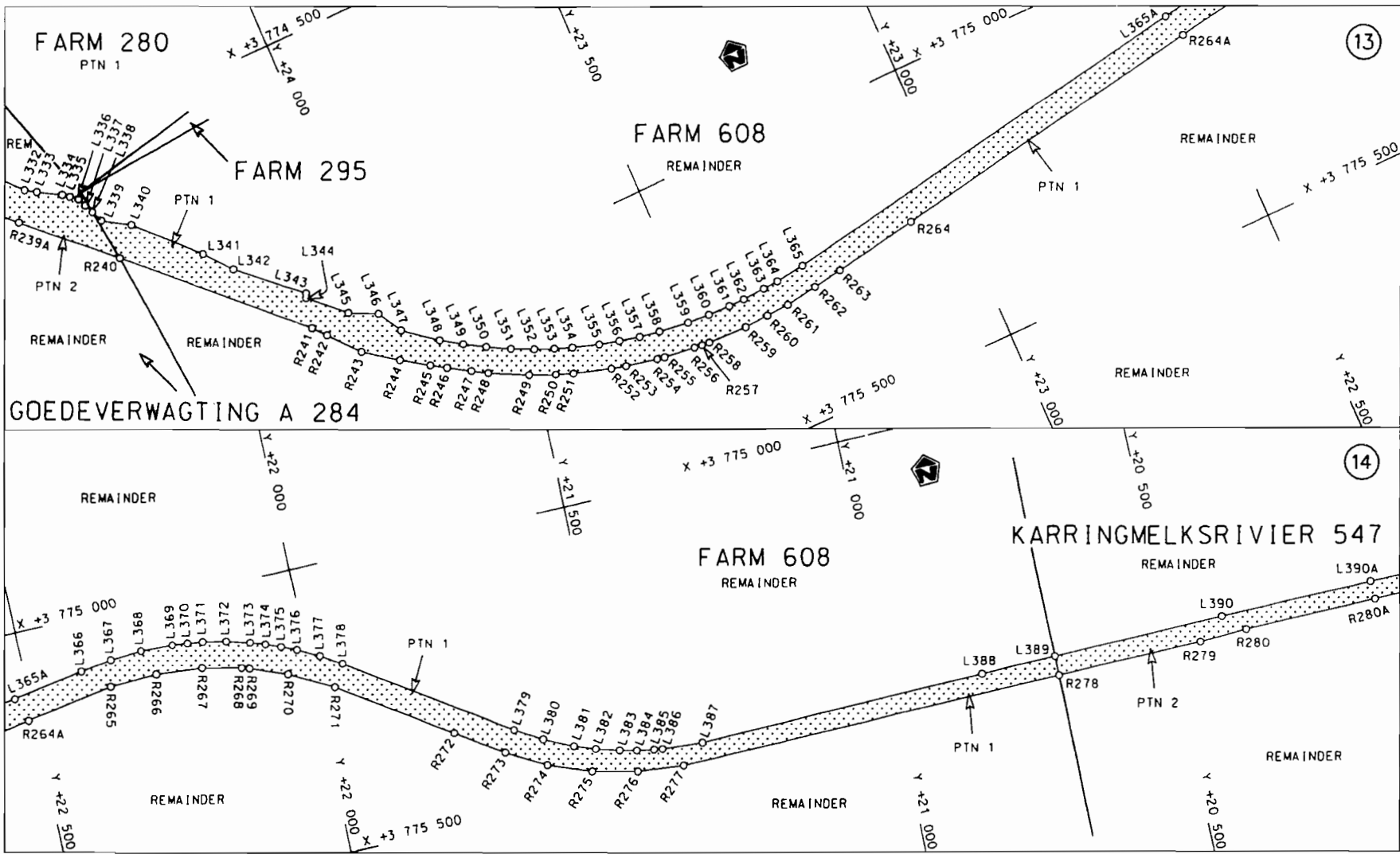

Die Suid Afrikaanse Nasionale Padagentskap Beperk The South African National Roads Agency Limited	Die figuur getoon The figure shown		steldie podreserwe voor van 'n gedeelte represents the road reserve of a portion van Nasionale Roete N2 of National Route N2 Seksie Section 5X	Vel Sheet 7 van 35 Plan P675/08
--	---------------------------------------	--	--	------------------------------------

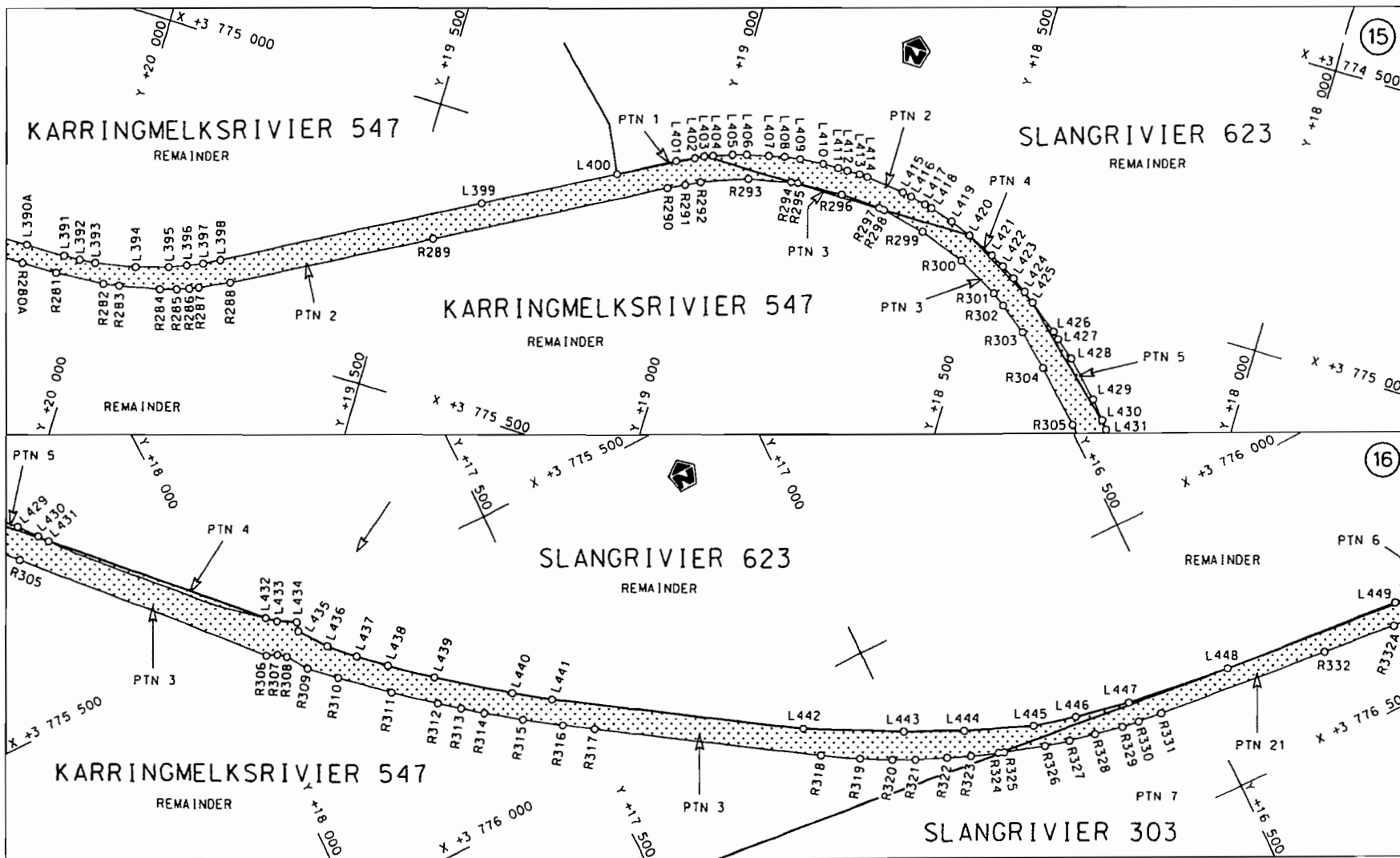

<p>Die Suid Afrikaanse Nasionale Padagentskap Beperk The South African National Roads Agency Limited</p>	<p>Die figuur getoon The figure shown</p>		<p>steldie padreserwe voor van 'n gedeelte represents the road reserve of a portion van Nasionale Roete N2 Seksie Section of National Route 5X</p>	<p>Vel Sheet 8 van 35 of of Plan P675/08</p>
--	---	--	--	--

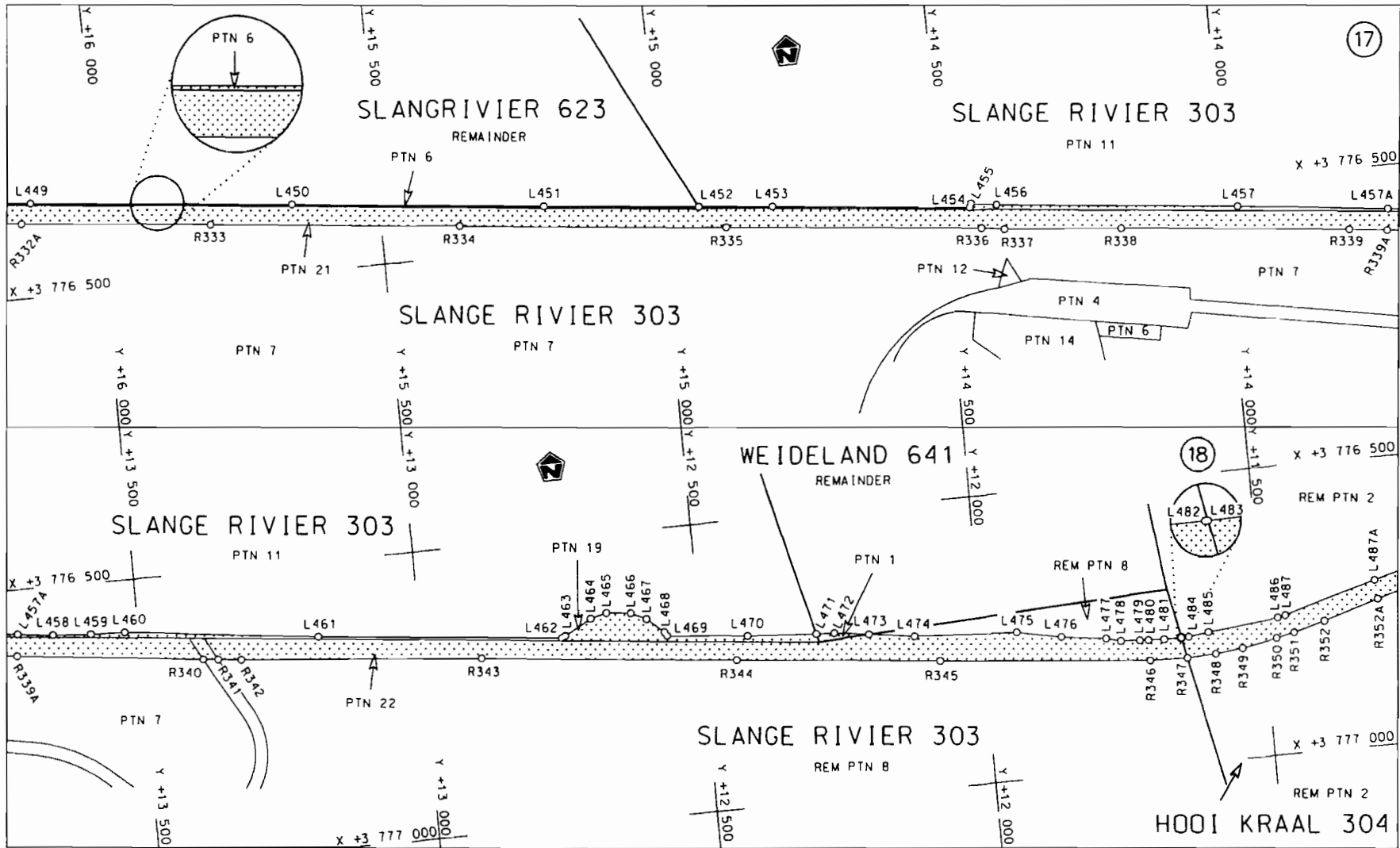

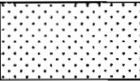
<p>Die Suid Afrikaanse Nasionale Padagentskap Beperk The South African National Roads Agency Limited</p>	<p>Die figuur getoon The figure shown</p> 	<p>steldie padreserwe voor van 'n gedeelte represents the road reserve of a portion van Nasionale Roete N2 of National Route N2</p> <p>Seksie Section 5X</p>	<p>Vel Sheet 9 van of 35 Plan P675/08</p>
--	--	--	---

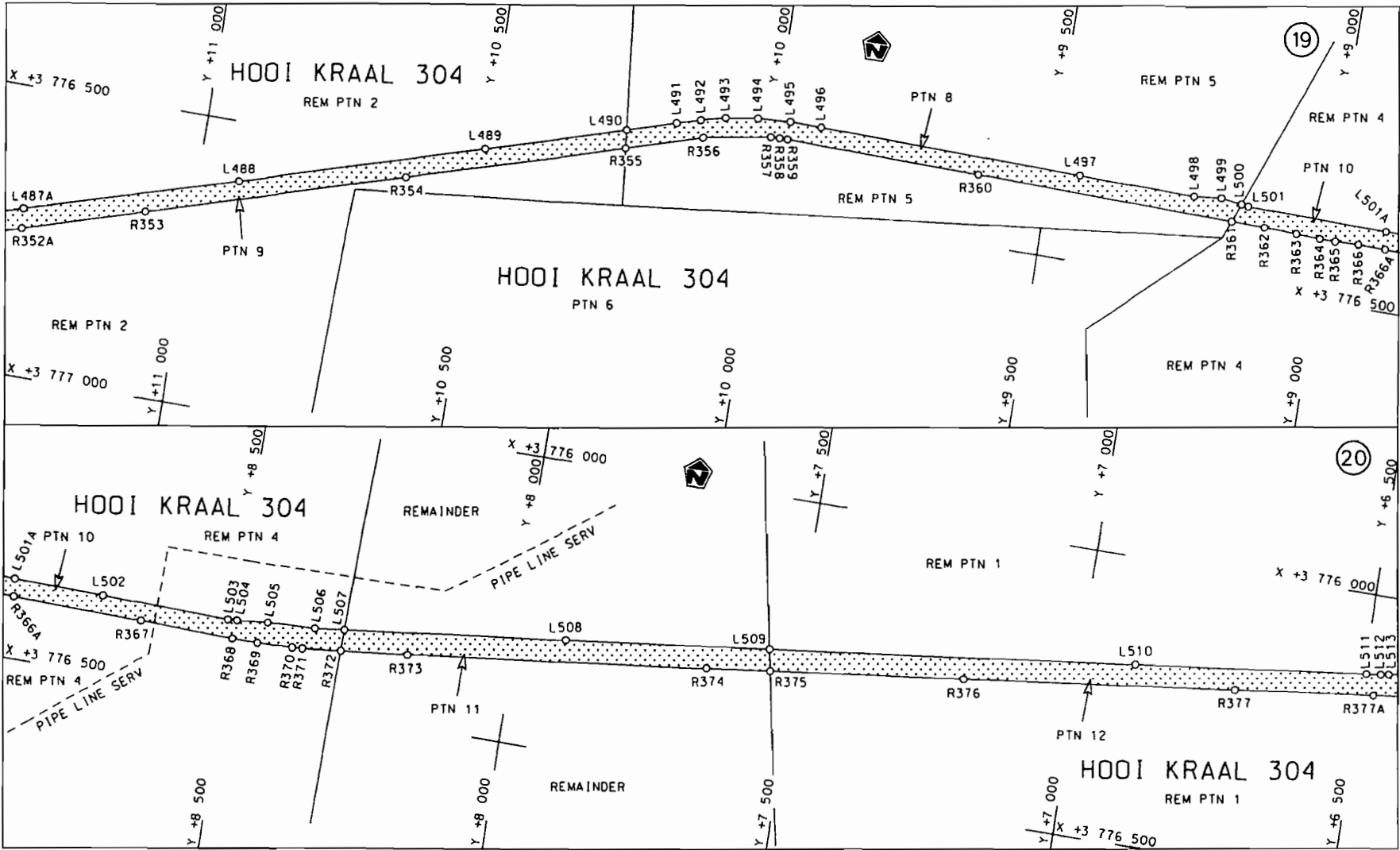

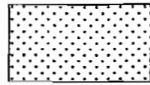
<p>Die Suid Afrikaanse Nasionale Padagentskap Beperk The South African National Roads Agency Limited</p>	<p>Die figuur getoon The figure shown</p> 	<p>steldie padreserve voor van 'n gedeelte represents the road reserve of a portion van Nasionale Roete N2 Seksie of National Route Section 5X</p>	<p>Vel Sheet 10 van 35 Plan P675/08</p>
--	--	--	---

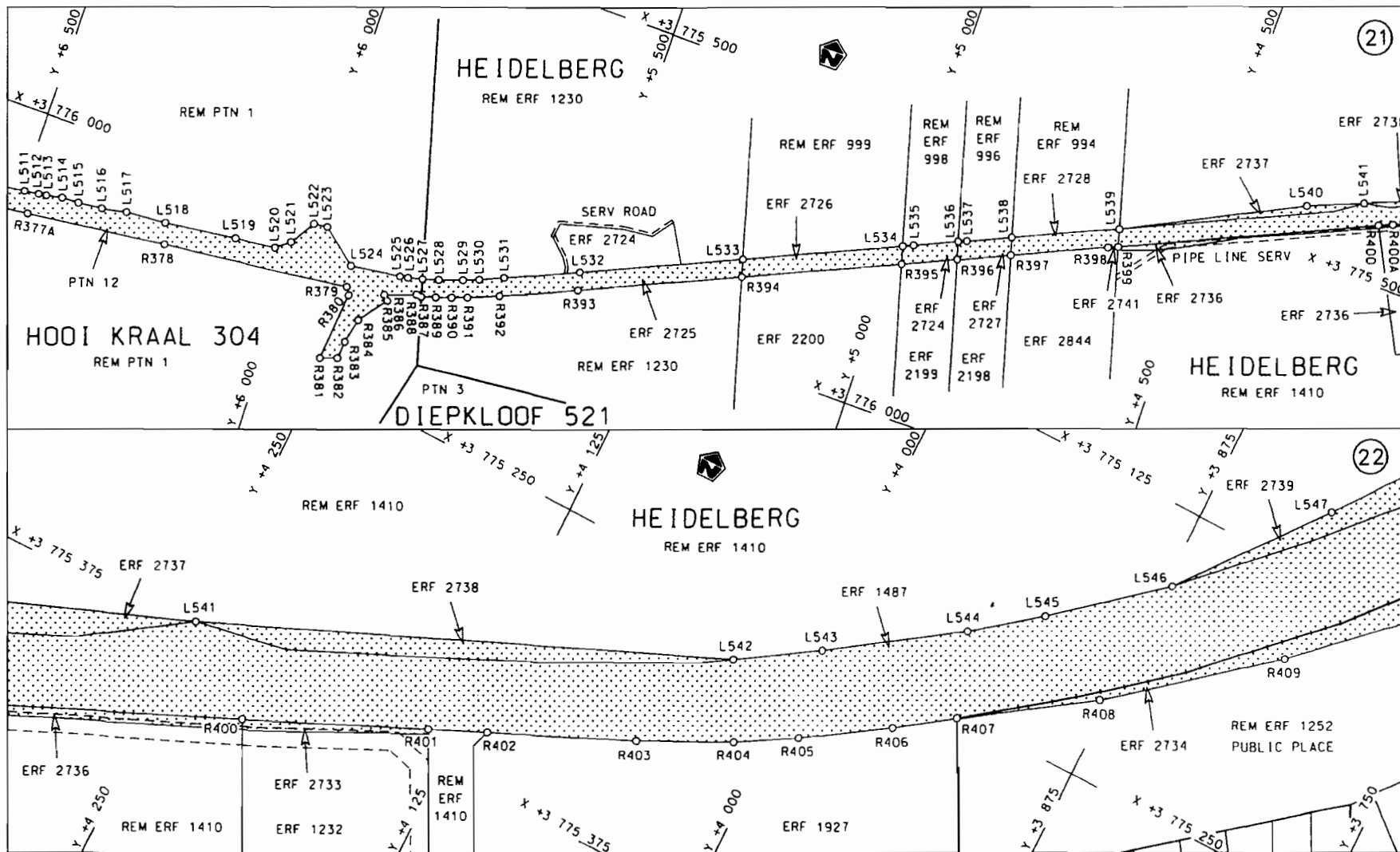

<p>Die Suid Afrikaanse Nasionale Padagentskap Beperk The South African National Roads Agency Limited</p>	<p>Die figuur getoon The figure shown</p> 	<p>steldie padreserwe voor van 'n gedeelte represents the road reserve of a portion van Nasionale Roete N2 Seksie 5X of National Route</p>	<p>Vel van Sheet 11 of 35 Plan P675/08</p>
--	--	--	--

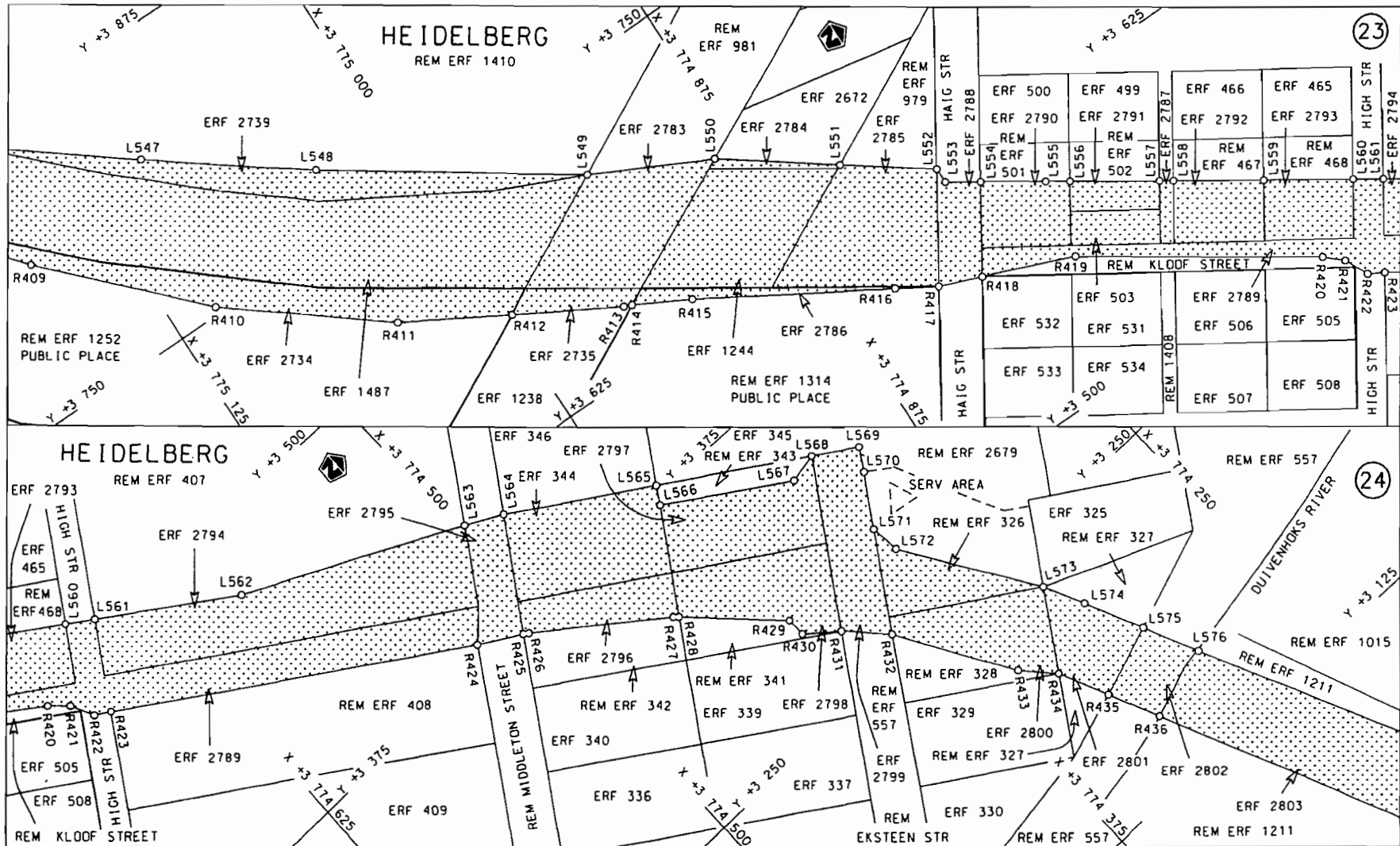

<p>Die Suid Afrikaanse Nasionale Podagentskap Beperk The South African National Roads Agency Limited</p>	<p>Die figuur getoon The figure shown</p>		<p>steldie padreserwe voor van 'n gedeelte represents the road reserve of a portion van Nasionale Roete N2 Seksie 5X of National Route Section</p>	<p>Vel Sheet 12 van 35 Plan P675/08</p>
--	---	--	--	---

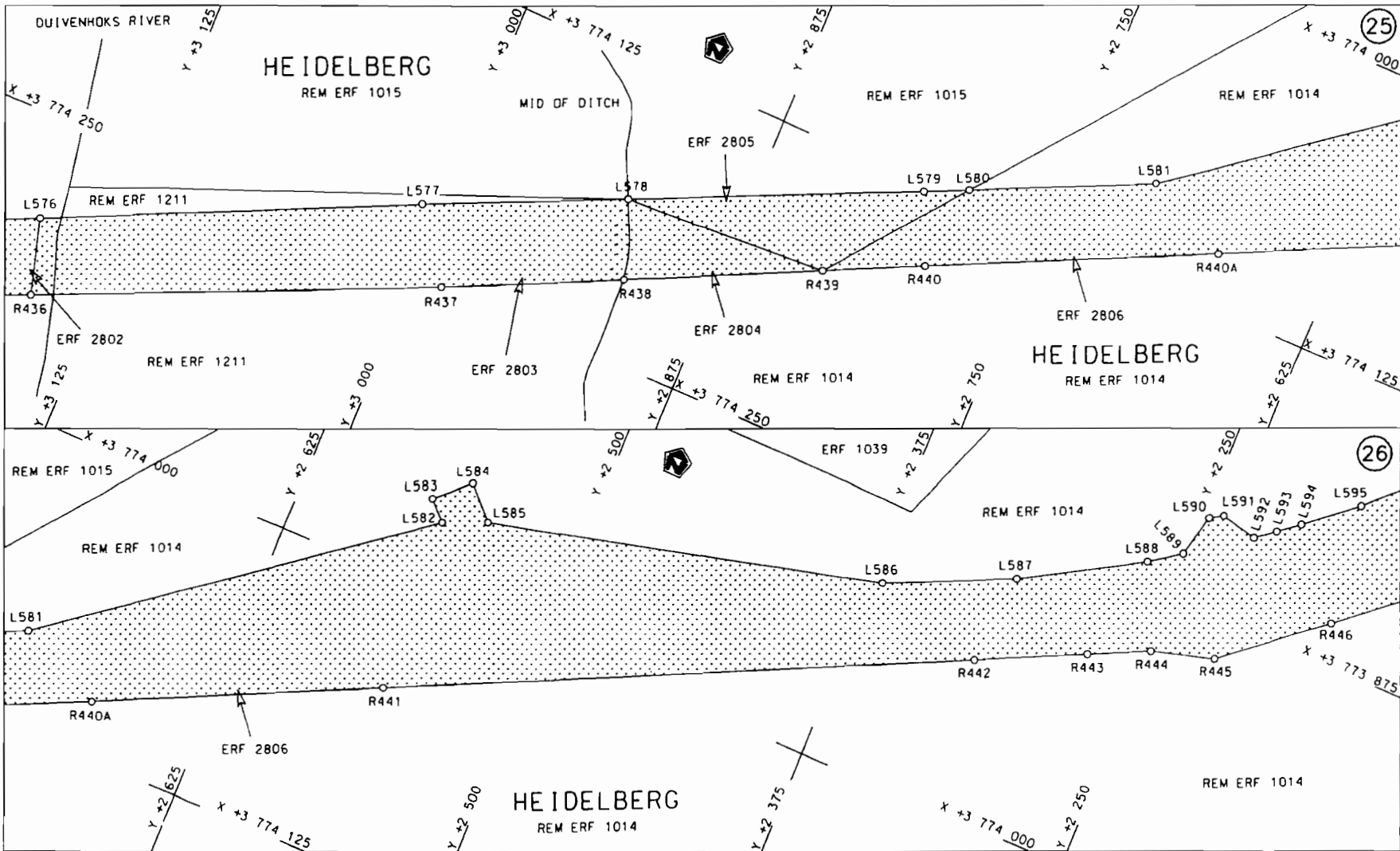

<p>Die Suid Afrikaanse Nasionale Padagentskop Beperk The South African National Roads Agency Limited</p>	<p>Die figuur getoon The figure shown</p>	<p>  steldie padreserwe voor van 'n gedeelte represents the road reserve of a portion van Nasionale Roete N2 Seksie 5X of National Route N2 Section 5X </p>	<p> Vel Sheet 13 van 35 Plan P675/08 </p>
--	---	--	--

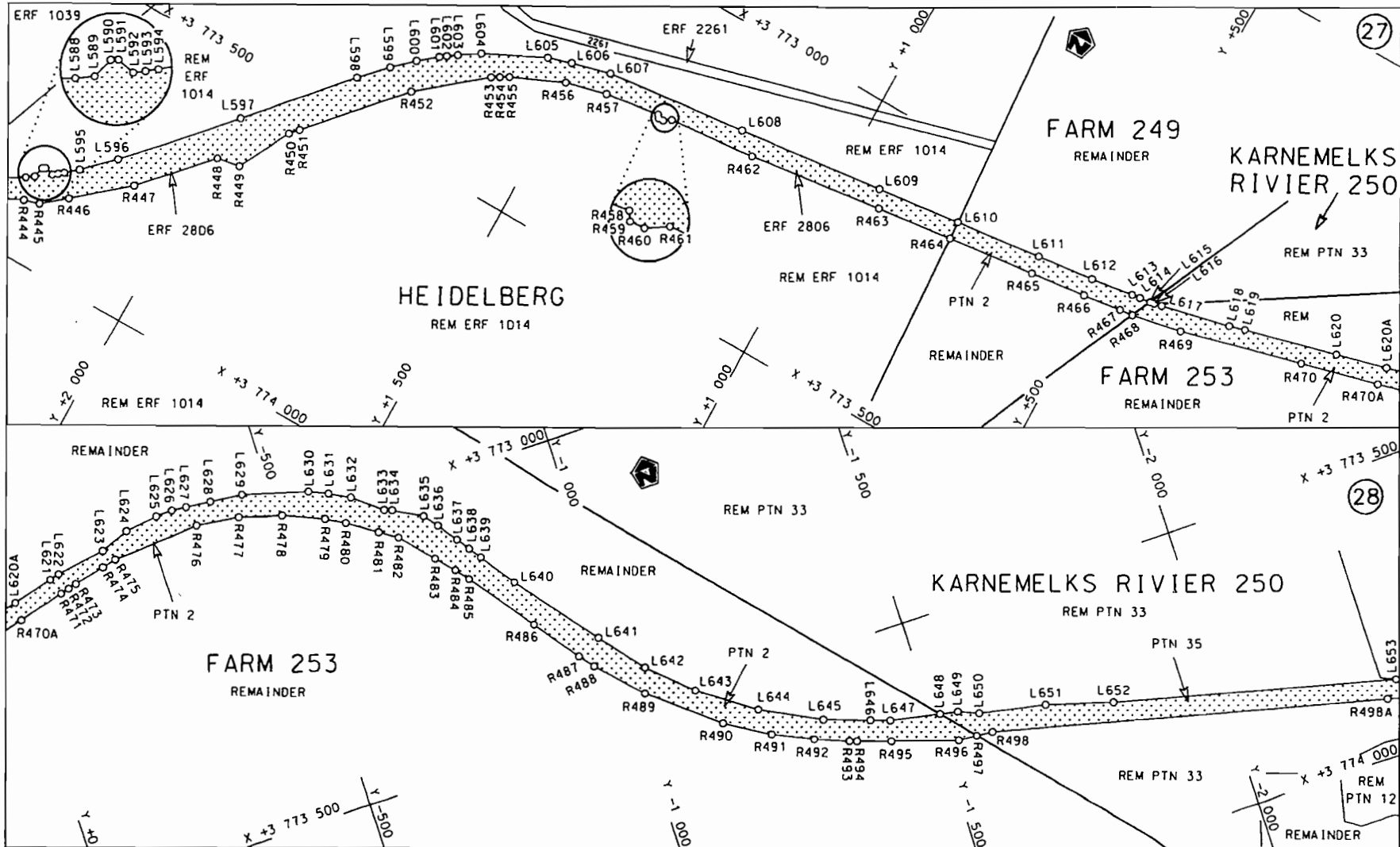

<p>Die Suid Afrikaanse Nasionale Padagentskap Beperk The South African National Roads Agency Limited</p>	<p>Die figuur getoon The figure shown</p>		<p>stel die padreserwe voor van 'n gedeelte represents the road reserve of a portion van Nasionale Roete N2 Seksie 5X of National Route Section</p>	<p>Vel Sheet 14 van of 35 Plan P675/08</p>
--	---	--	---	--

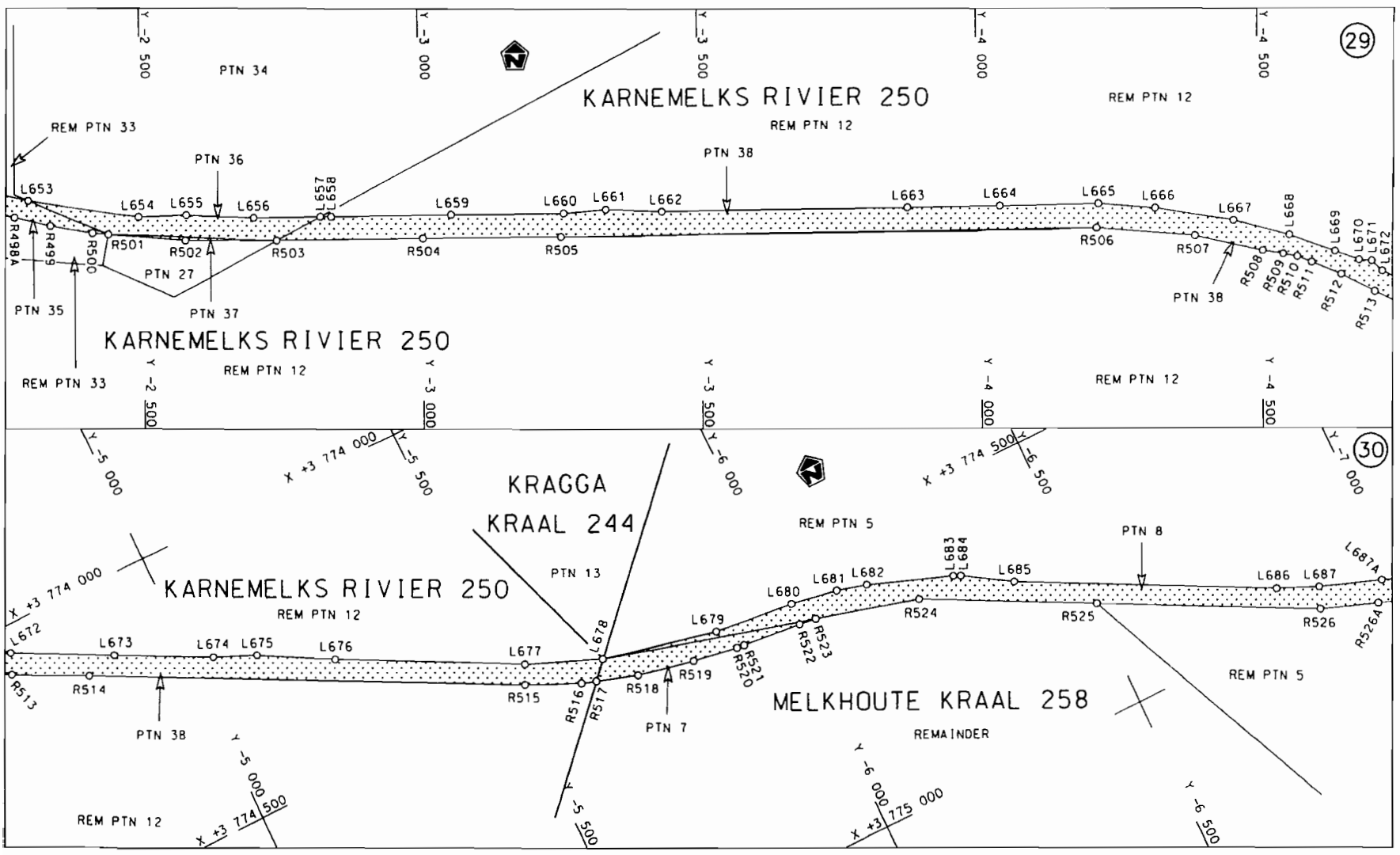

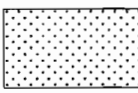
<p>Die Suid Afrikaanse Nasionale Padagentskap Beperk The South African National Roads Agency Limited</p>	<p>Die figuur getoon The figure shown</p> 	<p>steldie padreserwe voor van 'n gedeelte represents the road reserve of a portion van Nasionale Roete N2 Seksie of National Route N2 Section</p> <p>5X</p>	<p>Vel Sheet 15 van of 35 Plan P675/08</p>
--	--	--	--

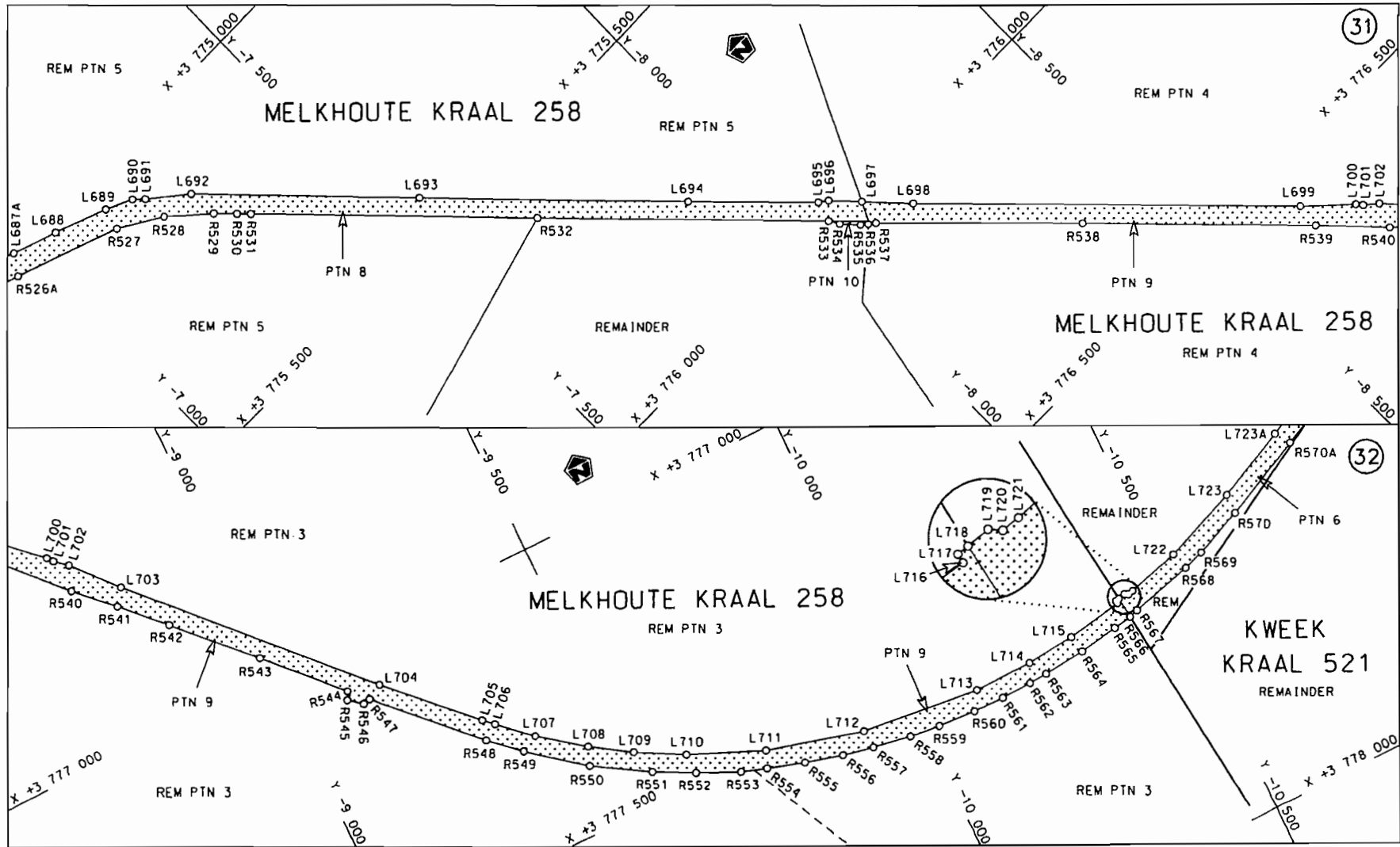

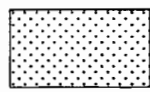
<p>Die Suid Afrikaanse Nasionale Padagentskap Beperk The South African National Roads Agency Limited</p>	<p>Die figuur getoon The figure shown</p> 	<p>steld die padreserwe voor van 'n gedeelte represents the road reserve of a portion van Nasionale Roete N2 Seksie 5X of National Route Section</p>	<p>Vel van Sheet 16 of 35 Plan P675/08</p>
--	--	--	--

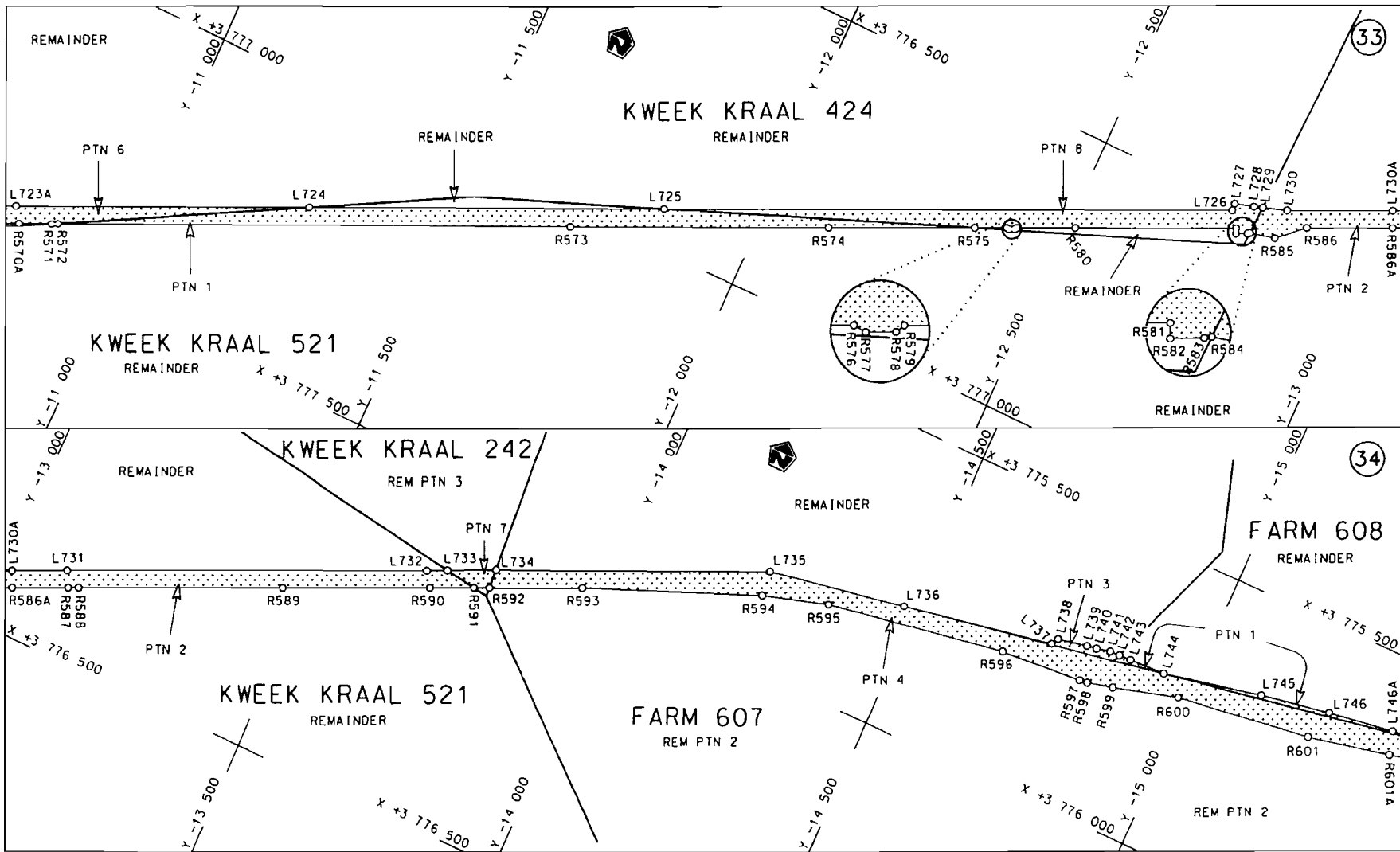

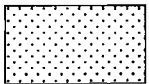
<p>Die Suid Afrikaanse Nasionale Padogenskap Beperk The South African National Roads Agency Limited</p>	<p>Die figuur getoon The figure shown</p>		<p>steldie padreserwe voor van 'n gedeelte represents the road reserve of a portion van Nasionale Roete N2 of National Route N2</p>	<p>Vel Sheet 17 van of 35 Plan P675/08</p>
			<p>Seksie Section 5X</p>	

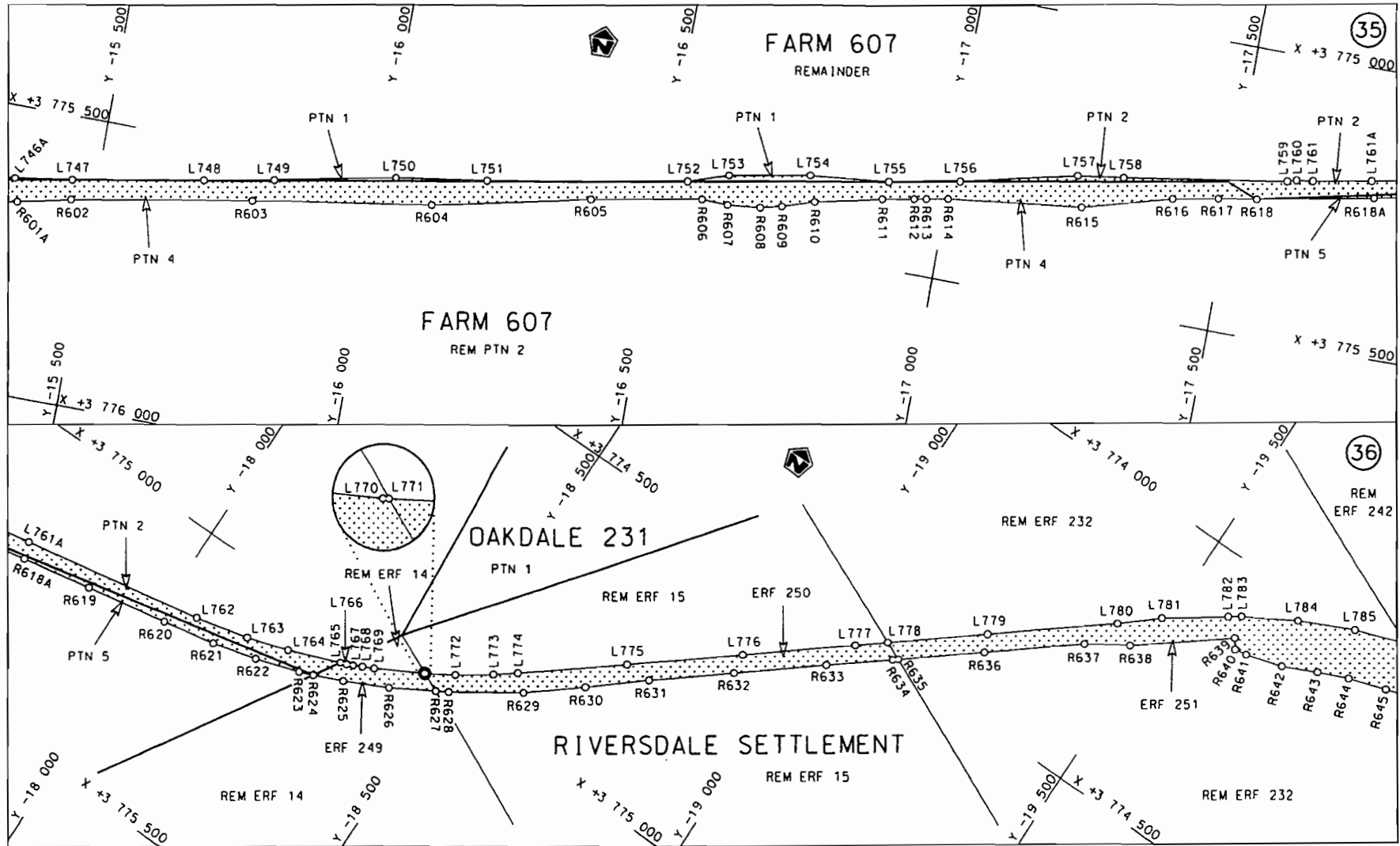

<p>Die Suid Afrikaanse Nasionale Padagentskap Beperk</p>	<p>Die figuur getoon</p>		<p>steldie padreserwe vir van 'n gedeelte represents the road reserve of a portion van Nasionale Roete N2</p>	<p>Vel Sheet 18 van 35</p>
<p>The South African National Roads Agency Limited</p>	<p>The figure shown</p>		<p>Seksie of National Route N2 Section 5X</p>	<p>Plon P675/08</p>

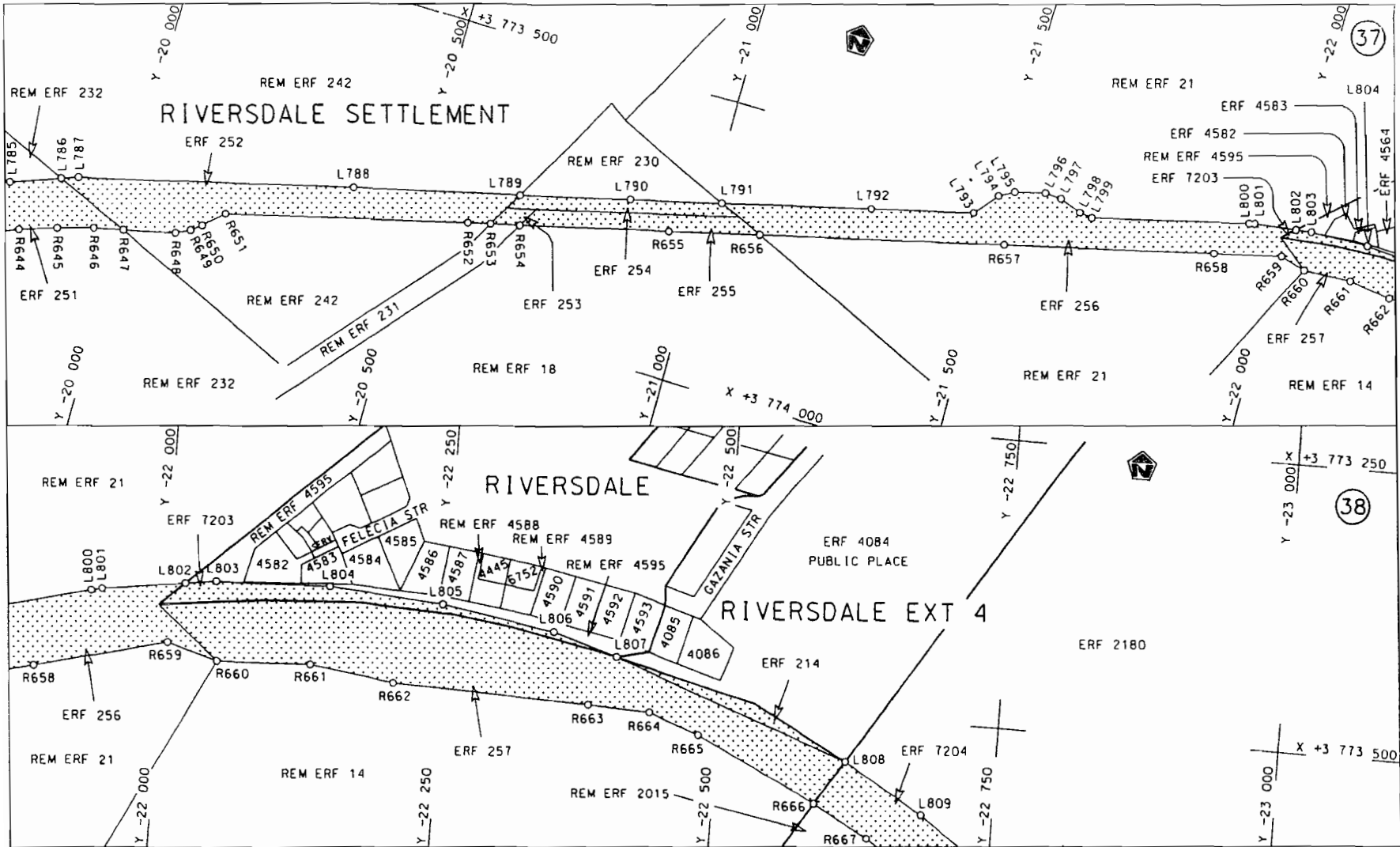

Die Suid Afrikaanse Nasionale Padogentskap Beperk
The South African National Roads Agency Limited

Die figuur getoon
The figure shown

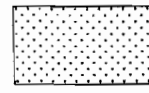

stel die padreserwe voor van 'n gedeelte
represents the road reserve of a portion
van Nasionale Roete N2
of National Route N2

Seksie 5X

Vel Sheet 19 van 35
Plan P675/08

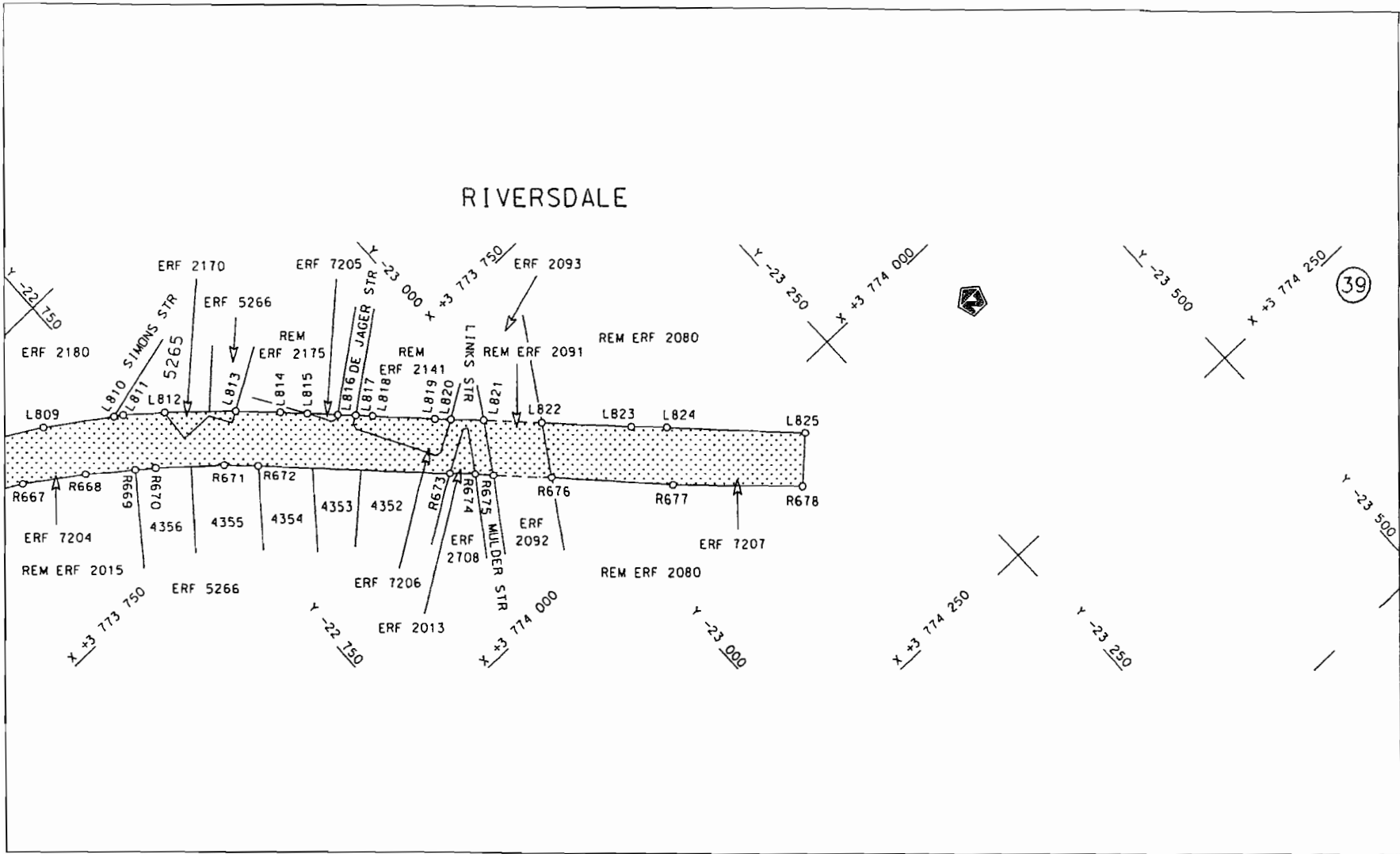

Die Suid Afrikaanse Nasionale Padagentskap Beperk The South African National Roads Agency Limited	Die figuur getoon The figure shown		steldie padreserve voor van 'n gedeelte represents the road reserve of a portion van Nasionale Roete N2 of National Route N2	Vel Sheet 20 van 35 of 35
Seksie 5X Section 5X				Plan P675/08

PADRESERWE KOÖRDINATE / ROAD RESERVE CO-ORDINATES					
LINKERKANT/LEFT HAND SIDE			REGTERKANT/RIGHT HAND SIDE		
	Y	X	WG 21°		X
L1	51 299.050	3 766 916.510		R1	51 254.190 3 766 941.290
L2	51 290.970	3 766 910.870		R2	51 101.350 3 766 836.240
L3	51 262.880	3 766 897.260		R3	51 017.150 3 766 788.010
L4	51 195.810	3 766 844.940		R4	51 005.320 3 766 781.590
L5	51 102.280	3 766 783.520		R5	50 933.680 3 766 745.470
L6	51 044.790	3 766 751.400		R6	50 837.340 3 766 709.930
L7	51 038.847	3 766 748.218		R7	50 749.850 3 766 679.610
L8	51 033.451	3 766 745.288		R8	50 664.990 3 766 650.040
L9	51 017.510	3 766 736.630		R9	50 485.980 3 766 587.630
L10	50 953.450	3 766 704.380		R10	50 406.070 3 766 564.130
L11	50 875.020	3 766 675.160		R11	50 329.490 3 766 546.460
L12	50 840.048	3 766 662.935		R12	50 248.860 3 766 530.780
L13	50 699.530	3 766 614.020		R13	49 799.600 3 766 473.540
L14	50 564.800	3 766 567.530		R14	49 568.560 3 766 443.930
L15	50 467.550	3 766 534.600		R15	49 469.450 3 766 431.230
L16	50 381.590	3 766 508.520		R16	49 387.170 3 766 436.380
L17	50 276.250	3 766 486.140		R17	49 383.650 3 766 441.520
L18	49 886.770	3 766 431.630		R18	49 363.820 3 766 446.440
L19	49 849.620	3 766 427.020		R19	49 357.700 3 766 440.780
L20	49 571.910	3 766 395.920		R20	49 253.690 3 766 419.190
L21	49 563.740	3 766 395.000		R21	49 242.210 3 766 419.920
L22	49 454.900	3 766 384.990		R22	49 206.301 3 766 422.872
L23	49 400.160	3 766 370.770		R23	49 161.340 3 766 426.570
L24	49 397.580	3 766 364.960		R24	49 142.270 3 766 431.240
L25	49 400.840	3 766 358.150		R25	49 087.410 3 766 437.060
L26	49 405.090	3 766 351.510		R26	49 049.540 3 766 444.770
L27	49 381.010	3 766 333.430		R27	48 996.320 3 766 459.400
L28	49 371.789	3 766 348.596		R28	48 935.200 3 766 479.390
L29	49 361.790	3 766 365.040		R29	48 676.490 3 766 565.550
L30	49 332.890	3 766 367.290		R30	48 614.110 3 766 586.280
L31	49 258.734	3 766 367.137		R31	48 376.150 3 766 665.330
L32	49 238.080	3 766 367.150		R32	48 227.460 3 766 715.110
L33	49 151.670	3 766 387.700		R33	48 214.060 3 766 719.830
L34	49 138.370	3 766 391.250		R34	47 914.040 3 766 822.190
L35	48 996.540	3 766 426.070		R35	47 851.480 3 766 844.050
L36	48 605.200	3 766 555.610		R36	47 779.740 3 766 864.980
L37	48 481.400	3 766 596.590		R37	47 603.170 3 766 922.040
L38	48 365.510	3 766 635.350		R38	47 569.290 3 766 933.290
L39	48 059.260	3 766 736.050		R39	47 326.190 3 767 013.980
L40	47 662.320	3 766 868.680		R40	47 275.900 3 767 068.050
L41	47 563.060	3 766 901.400		R41	47 208.510 3 767 090.320
L42	47 401.790	3 766 954.560		R42	47 177.520 3 767 090.180
L43	47 240.370	3 767 009.850		R43	47 135.720 3 767 077.290
L44	46 754.800	3 767 171.920		R44	47 106.460 3 767 087.100
L45	46 391.180	3 767 292.210		R45	47 055.910 3 767 103.940
L46	46 175.098	3 767 362.011		R46	46 611.420 3 767 251.930
L47	46 037.560	3 767 409.830		R47	46 250.750 3 767 371.550
L48	45 859.723	3 767 470.095		R48	45 872.174 3 767 498.020
L49	45 817.080	3 767 482.940		R49	45 785.900 3 767 531.670
L50	45 786.300	3 767 493.250		R50	45 380.690 3 767 690.100
L51	45 746.730	3 767 508.330		R51	44 858.120 3 767 891.080

Vel Sheet	21	Van of	35	P675/08
--------------	----	-----------	----	---------

PADRESERWE KOÖRDINATE / ROAD RESERVE CO-ORDINATES								
LINKERKANT/LEFT HAND SIDE					REGTERKANT/RIGHT HAND SIDE			
	Y	X	WG 21°		Y	X		
L52	45	635.530	3 767	551.910	R52	44	779.010	3 767 921.350
L53	45	233.770	3 767	706.450	R53	44	757.880	3 767 931.250
L54	45	082.960	3 767	765.330	R54	44	737.820	3 767 938.330
L55	45	015.160	3 767	791.560	R55	44	715.600	3 767 946.100
L56	44	692.760	3 767	916.290	R56	44	673.140	3 767 961.100
L57	44	665.940	3 767	925.700	R57	44	627.440	3 767 975.570
L58	44	633.174	3 767	934.950	R58	44	567.830	3 767 989.030
L59	44	606.580	3 767	943.670	R59	44	561.440	3 767 994.620
L60	44	503.320	3 767	961.620	R60	44	470.590	3 768 001.120
L61	44	484.483	3 767	962.901	R61	44	432.590	3 768 002.910
L62	44	403.290	3 767	968.420	R62	44	355.170	3 768 006.570
L63	44	340.140	3 767	964.630	R63	44	222.140	3 767 982.510
L64	44	339.070	3 767	963.790	R64	44	168.260	3 767 973.680
L65	44	298.580	3 767	959.150	R65	43	770.050	3 767 909.480
L66	43	900.160	3 767	896.130	R66	43	598.890	3 767 883.960
L67	43	788.410	3 767	878.270	R67	43	506.308	3 767 870.295
L68	43	596.950	3 767	849.430	R68	43	495.660	3 767 868.570
L69	43	529.453	3 767	838.578	R69	43	486.684	3 767 867.121
L70	43	505.934	3 767	834.796	R70	43	482.410	3 767 866.430
L71	43	479.340	3 767	830.520	R71	43	129.510	3 767 809.360
L72	43	248.290	3 767	793.370	R72	43	038.190	3 767 798.640
L73	43	088.520	3 767	768.070	R73	42	961.470	3 767 796.440
L74	43	074.700	3 767	766.070	R74	42	864.630	3 767 802.390
L75	43	061.480	3 767	764.450	R75	42	794.400	3 767 813.380
L76	43	021.600	3 767	760.760	R76	42	448.520	3 767 892.690
L77	42	993.560	3 767	759.430	R77	42	326.880	3 767 920.970
L78	42	948.200	3 767	758.420	R78	42	313.940	3 767 923.980
L79	42	878.640	3 767	762.570	R79	42	310.010	3 767 924.890
L80	42	839.080	3 767	768.120	R80	42	262.170	3 767 936.030
L81	42	801.380	3 767	773.810	R81	41	983.230	3 768 000.990
L82	42	791.420	3 767	776.290	R82	41	892.100	3 768 022.040
L83	42	623.160	3 767	815.240	R83	41	886.190	3 768 023.490
L84	42	599.600	3 767	821.400	R84	41	764.650	3 768 051.850
L85	42	591.600	3 767	823.490	R85	41	364.250	3 768 144.360
L86	42	468.250	3 767	850.810	R86	40	898.210	3 768 251.290
L87	42	272.650	3 767	894.110	R87	40	365.350	3 768 373.370
L88	41	881.560	3 767	987.250	R88	40	338.090	3 768 379.110
L89	41	698.670	3 768	030.800	R89	40	329.530	3 768 380.720
L90	41	222.780	3 768	141.610	R90	40	316.710	3 768 383.310
L91	40	693.220	3 768	262.830	R91	40	040.830	3 768 447.440
L92	40	393.620	3 768	331.980	R92	40	006.060	3 768 456.810
L93	40	387.720	3 768	327.550	R93	39	961.710	3 768 470.420
L94	40	364.320	3 768	335.530	R94	39	920.640	3 768 485.510
L95	40	360.960	3 768	339.480	R95	39	879.560	3 768 502.610
L96	39	975.470	3 768	428.940	R96	39	841.970	3 768 520.620
L97	39	946.120	3 768	437.000	R97	39	805.260	3 768 540.030
L98	39	920.160	3 768	445.430	R98	39	770.600	3 768 559.890
L99	39	852.190	3 768	471.010	R99	39	764.110	3 768 563.440
L100	39	759.320	3 768	516.530	R100	39	719.220	3 768 593.763
L101	39	726.590	3 768	535.230	R101	39	682.810	3 768 620.600
L102	39	691.850	3 768	558.450	R102	39	648.330	3 768 648.620

Vel	22	Van	35	P675/08
Sheet		of		

PADRESERWE KOÖRDINATE / ROAD RESERVE CO-ORDINATES							
LINKERKANT/LEFT HAND SIDE				REGTERKANT/RIGHT HAND SIDE			
	Y	X	WG 21°		Y	X	
L103	39 657.970	3 768 582.660		R103	39 607.260	3 768 685.420	
L104	39 646.390	3 768 591.430		R104	39 567.270	3 768 725.930	
L105	39 624.550	3 768 608.980		R105	39 344.180	3 768 995.500	
L106	39 613.670	3 768 618.090		R106	39 036.540	3 769 371.060	
L107	39 603.170	3 768 627.160		R107	38 958.790	3 769 466.590	
L108	39 571.320	3 768 656.560		R107X	38 957.710	3 769 467.890	
L109	39 550.670	3 768 677.160		R108	38 930.890	3 769 495.750	
L110	39 540.620	3 768 687.610		R109	38 910.030	3 769 516.130	
L111	39 521.400	3 768 708.600		R110	38 888.990	3 769 534.520	
L112	39 501.520	3 768 732.030		R111	38 856.100	3 769 562.190	
L113	39 267.660	3 769 017.610		R112	38 831.120	3 769 581.340	
L114	39 058.229	3 769 288.317		R113	38 809.070	3 769 597.470	
L115	39 006.730	3 769 334.810		R114	38 786.960	3 769 613.400	
L116	38 971.870	3 769 334.950		R115	38 763.000	3 769 629.190	
L117	38 958.680	3 769 334.860		R116	38 731.730	3 769 647.830	
L118	38 928.360	3 769 373.250		R117	38 684.680	3 769 673.670	
L119	38 918.890	3 769 393.890		R118	38 644.790	3 769 693.210	
L120	38 909.290	3 769 448.850		R119	38 595.910	3 769 715.610	
L121	38 889.520	3 769 468.580		R120	38 514.420	3 769 752.780	
L122	38 856.390	3 769 499.670		R121	38 484.970	3 769 766.150	
L123	38 825.640	3 769 525.890		R122	38 315.790	3 769 843.390	
L124	38 792.510	3 769 551.810		R123	38 256.590	3 769 905.100	
L125	38 757.500	3 769 576.610		R124	38 169.370	3 769 907.960	
L126	38 733.500	3 769 592.220		R125	38 139.900	3 769 919.850	
L127	38 672.130	3 769 627.610		R126	38 041.160	3 769 954.770	
L128	38 633.960	3 769 646.680		R127	37 979.070	3 769 973.650	
L129	38 228.940	3 769 832.290		R128	37 952.760	3 769 981.030	
L130	38 190.230	3 769 849.370		R129	37 706.910	3 770 042.400	
L131	38 111.580	3 769 880.840		R130	37 679.480	3 770 049.680	
L132	38 072.030	3 769 895.230		R131	37 567.215	3 770 077.175	
L133	38 030.310	3 769 909.410		R132	37 521.497	3 770 088.371	
L134	37 976.710	3 769 926.050		R133	37 472.220	3 770 100.440	
L134X	37 948.490	3 769 934.260		R134	37 389.100	3 770 120.740	
L135	37 565.350	3 770 030.460		R135	37 346.150	3 770 127.770	
L136	37 527.260	3 770 039.870		R136	37 306.090	3 770 132.350	
L137	37 473.450	3 770 053.380		R137	37 262.730	3 770 133.740	
L138	37 443.960	3 770 060.700		R138	37 220.690	3 770 131.080	
L139	37 430.810	3 770 064.000		R139	37 192.410	3 770 129.290	
L140	37 403.540	3 770 070.390		R140	37 162.520	3 770 125.440	
L141	37 362.910	3 770 078.760		R141	37 136.430	3 770 120.870	
L142	37 319.100	3 770 084.730		R142	37 123.650	3 770 117.890	
L143	37 291.260	3 770 086.750		R143	37 093.320	3 770 109.550	
L144	37 263.420	3 770 087.540		R144	37 064.230	3 770 098.350	
L145	37 234.900	3 770 086.950		R145	37 020.190	3 770 083.480	
L146	37 219.830	3 770 085.980		R146	36 972.310	3 770 069.810	
L147	37 205.610	3 770 084.430		R147	36 947.570	3 770 062.680	
L148	37 184.290	3 770 081.850		R148	36 861.160	3 770 043.790	
L149	37 178.170	3 770 081.280		R149	36 847.600	3 770 042.110	
L150	37 136.100	3 770 073.580		R150	36 833.630	3 770 040.690	
L151	37 094.390	3 770 062.490		R151	36 819.900	3 770 039.590	
L152	37 041.740	3 770 045.720		R152	36 803.410	3 770 038.770	

Vel	23	Van	35	P675/08
Sheet		of		

PADRESERWE KOÖRDINATE / ROAD RESERVE CO-ORDINATES					
LINKERKANT/LEFT HAND SIDE			REGTERKANT/RIGHT HAND SIDE		
	Y	X	WG 21°		X
L153	36 974.260	3 770	023.430	R153	36 789.670 3 770 038.390
L154	36 946.910	3 770	015.200	R154	36 761.660 3 770 038.570
L155	36 929.501	3 770	011.547	R155	36 732.190 3 770 040.330
L156	36 904.900	3 770	005.330	R156	36 717.000 3 770 041.760
L157	36 877.480	3 770	000.140	R157	36 698.040 3 770 044.150
L158	36 863.760	3 769	998.020	R158	36 686.390 3 770 045.620
L159	36 849.460	3 769	996.330	R159	36 672.610 3 770 047.850
L160	36 834.530	3 769	994.830	R160	36 659.170 3 770 050.350
L161	36 806.540	3 769	992.950	R161	36 537.550 3 770 089.050
L162	36 792.600	3 769	992.520	R162	36 524.830 3 770 094.760
L163	36 778.540	3 769	992.420	R163	36 501.630 3 770 106.520
L164	36 758.300	3 769	992.830	R164	36 465.510 3 770 127.340
L165	36 757.170	3 769	992.710	R165	36 453.610 3 770 134.790
L166	36 748.780	3 769	993.030	R166	36 419.400 3 770 159.040
L167	36 717.990	3 769	994.800	R167	36 352.780 3 770 218.720
L168	36 688.780	3 769	998.490	R168	36 095.600 3 770 478.530
L169	36 658.220	3 770	003.680	R169	35 929.600 3 770 646.980
L170	36 618.930	3 770	012.410	R170	35 743.950 3 770 835.980
L171	36 605.460	3 770	016.040	R171	35 565.460 3 771 016.980
L172	36 581.170	3 770	023.430	R172	35 417.280 3 771 167.430
L173	36 559.490	3 770	030.900	R173	35 383.840 3 771 201.290
L174	36 507.300	3 770	052.090	R174	35 067.050 3 771 523.500
L175	36 496.230	3 770	057.320	R175	35 048.480 3 771 545.160
L176	36 469.480	3 770	071.270	R176	34 982.958 3 771 624.762
L177	36 457.300	3 770	078.120	R177	34 927.180 3 771 733.280
L178	36 445.390	3 770	085.230	R178	34 860.810 3 771 804.710
L179	36 433.490	3 770	092.630	R179	34 793.230 3 771 848.010
L180	36 421.890	3 770	100.180	R180	34 720.420 3 771 910.540
L181	36 399.110	3 770	116.080	R181	34 542.400 3 772 077.440
L182	36 388.070	3 770	124.680	R182	34 521.450 3 772 096.960
L183	36 377.300	3 770	133.700	R183	34 247.350 3 772 356.800
L184	36 347.060	3 770	161.170	R184	34 161.470 3 772 444.490
L185	36 306.590	3 770	202.030	R185	33 808.660 3 772 803.330
L186	36 238.200	3 770	271.680	R186	33 665.220 3 772 949.560
L187	36 233.740	3 770	282.400	R187	33 586.800 3 773 029.380
L188	36 231.260	3 770	285.190	R188	33 524.820 3 773 092.280
L189	36 221.630	3 770	289.900	R189	33 220.810 3 773 400.710
L190	35 965.230	3 770	550.100	R190	33 160.630 3 773 461.400
L191	35 896.460	3 770	620.030	R191	33 129.600 3 773 489.790
L192	35 667.400	3 770	850.770	R192	33 107.850 3 773 507.320
L193	35 541.850	3 770	975.210	R193	33 050.560 3 773 549.000
L194	35 516.980	3 771	000.880	R194	32 967.170 3 773 599.150
L195	35 360.260	3 771	160.090	R195	32 943.580 3 773 611.050
L196	35 272.940	3 771	244.090	R196	32 918.500 3 773 622.990
L197	35 221.940	3 771	293.190	R197	32 841.340 3 773 654.570
L198	35 202.350	3 771	312.020	R198	32 793.090 3 773 670.470
L199	35 192.290	3 771	323.500	R199	32 752.610 3 773 681.230
L200	35 184.650	3 771	333.310	R200	32 670.200 3 773 697.600
L201	35 157.300	3 771	366.970	R201	32 572.000 3 773 706.970
L202	35 098.580	3 771	427.370	R202	32 516.970 3 773 707.650
L203	35 079.590	3 771	447.830	R203	32 488.540 3 773 706.530

Vel 24 Van 35
Sheet of

P675/08

PADRESERWE KOÖRDINATE / ROAD RESERVE CO-ORDINATES					
LINKERKANT/LEFT HAND SIDE			REGTERKANT/RIGHT HAND SIDE		
	Y	X	WG 21°		X
L204	34 948.930	3 771	598.420	R204	32 419.010 3 773 701.850
L205	34 910.470	3 771	637.890	R205	32 389.530 3 773 698.680
L206	34 787.480	3 771	761.250	R206	32 279.370 3 773 687.280
L207	34 735.210	3 771	816.170	R207	32 073.810 3 773 665.970
L208	34 450.590	3 772	104.810	R208	31 612.960 3 773 617.740
L209	34 322.560	3 772	235.570	R209	31 146.880 3 773 569.320
L210	34 224.710	3 772	334.350	R210	30 735.970 3 773 526.700
L211	34 184.080	3 772	372.550	R211	30 712.860 3 773 524.450
L212	34 052.110	3 772	497.530	R212	30 240.690 3 773 474.910
L213	33 723.370	3 772	827.990	R213	29 781.800 3 773 427.680
L214	33 615.030	3 772	938.340	R214	29 270.820 3 773 378.350
L215	33 565.020	3 772	989.170	R215	29 225.325 3 773 374.474
L216	33 217.650	3 773	342.150	R216	29 117.970 3 773 370.780
L217	33 177.100	3 773	383.110	R217	28 991.110 3 773 372.850
L218	33 166.550	3 773	392.950	R218	28 921.420 3 773 376.880
L219	33 116.640	3 773	441.560	R219	28 850.610 3 773 383.000
L220	33 098.420	3 773	458.190	R220	28 753.680 3 773 394.770
L221	33 087.790	3 773	466.840	R221	28 713.500 3 773 400.990
L222	33 077.300	3 773	475.220	R222	28 658.080 3 773 410.190
L223	33 054.660	3 773	492.570	R223	28 644.310 3 773 412.590
L224	33 043.340	3 773	500.770	R224	28 521.290 3 773 438.210
L225	32 996.620	3 773	531.830	R225	28 072.690 3 773 531.520
L226	32 974.290	3 773	545.240	R226	27 837.960 3 773 580.600
L227	32 949.650	3 773	559.100	R227	27 340.030 3 773 684.340
L228	32 925.290	3 773	571.840	R228	27 314.850 3 773 689.660
L229	32 876.220	3 773	594.370	R229	26 907.990 3 773 774.550
L230	32 837.440	3 773	610.030	R230	26 458.700 3 773 868.170
L231	32 753.030	3 773	636.300	R231	25 979.220 3 773 968.180
L232	32 729.050	3 773	642.330	R232	25 486.510 3 774 070.960
L233	32 702.410	3 773	647.950	R233	25 106.620 3 774 150.260
L234	32 674.820	3 773	653.140	R234	25 026.730 3 774 175.270
L235	32 647.480	3 773	657.400	R235	24 976.070 3 774 199.220
L236	32 621.090	3 773	660.520	R236	24 951.040 3 774 211.490
L237	32 592.690	3 773	662.920	R237	24 926.270 3 774 227.400
L238	32 551.210	3 773	664.950	R238	24 892.120 3 774 249.570
L239	32 540.580	3 773	665.020	R239	24 838.390 3 774 293.880
L240	32 484.060	3 773	663.620	R240	24 390.180 3 774 723.380
L241	32 394.260	3 773	655.810	R241	24 127.180 3 774 975.310
L242	32 346.570	3 773	647.170	R242	24 108.110 3 774 997.350
L243	32 241.170	3 773	636.760	R243	24 063.590 3 775 049.330
L244	32 211.530	3 773	636.520	R244	24 007.010 3 775 089.980
L245	32 195.860	3 773	635.360	R245	23 961.610 3 775 120.400
L246	31 917.450	3 773	604.600	R246	23 936.330 3 775 136.780
L247	31 894.280	3 773	601.270	R247	23 899.610 3 775 159.670
L248	31 847.160	3 773	596.200	R248	23 874.030 3 775 175.160
L249	31 455.480	3 773	555.450	R249	23 808.700 3 775 208.480
L250	31 437.490	3 773	553.650	R250	23 765.150 3 775 227.100
L251	31 406.830	3 773	550.510	R251	23 735.760 3 775 238.390
L252	30 963.030	3 773	504.400	R252	23 670.780 3 775 258.830
L253	30 806.210	3 773	480.900	R253	23 644.870 3 775 265.690
L254	30 740.300	3 773	455.110	R254	23 589.610 3 775 277.670

Vel	25	Van	35	P675/08
Sheet		of		

PADRESERWE KOÖRDINATE / ROAD RESERVE CO-ORDINATES						
LINKERKANT/LEFT HAND SIDE				REGTERKANT/RIGHT HAND SIDE		
	Y	X	WG 21°		Y	X
L255	30 737.600	3 773 449.700		R255	23 576.190	3 775 280.170
L256	30 725.490	3 773 447.120		R256	23 520.520	3 775 287.390
L257	30 715.280	3 773 445.040		R257	23 506.640	3 775 289.200
L258	30 714.370	3 773 448.190		R258	23 492.690	3 775 290.380
L259	30 710.510	3 773 451.350		R259	23 423.040	3 775 293.390
L260	30 598.790	3 773 469.580		R260	23 379.920	3 775 291.500
L261	30 570.030	3 773 466.770		R261	23 339.450	3 775 289.320
L262	30 178.920	3 773 427.480		R262	23 282.770	3 775 281.350
L263	30 031.270	3 773 410.900		R263	23 229.750	3 775 273.330
L264	29 646.260	3 773 370.830		R264	23 067.983	3 775 248.549
L265	29 531.510	3 773 356.570		R265	22 356.430	3 775 128.970
L266	29 513.500	3 773 354.330		R266	22 272.670	3 775 125.390
L267	29 352.270	3 773 340.320		R267	22 189.190	3 775 133.140
L268	29 310.590	3 773 336.650		R268	22 120.620	3 775 148.630
L269	29 241.410	3 773 331.680		R269	22 107.110	3 775 152.670
L270	29 212.300	3 773 330.260		R270	22 042.000	3 775 177.100
L271	29 170.460	3 773 328.740		R271	21 966.730	3 775 216.770
L272	29 128.880	3 773 327.950		R272	21 776.820	3 775 340.360
L273	29 073.120	3 773 327.930		R273	21 695.960	3 775 392.600
L274	29 002.240	3 773 329.700		R274	21 626.930	3 775 429.770
L275	28 916.850	3 773 333.930		R275	21 551.510	3 775 457.930
L276	28 841.430	3 773 334.360		R276	21 471.960	3 775 476.080
L277	28 823.530	3 773 337.010		R277	21 389.760	3 775 484.010
L278	28 796.150	3 773 341.920		R278	20 704.876	3 775 479.171
L279	28 755.210	3 773 349.800		R279	20 445.830	3 775 477.330
L280	28 658.660	3 773 366.380		R280	20 362.020	3 775 473.610
L281	28 617.410	3 773 374.200		R281	20 066.940	3 775 470.430
L282	28 576.360	3 773 383.180		R282	19 982.020	3 775 465.940
L283	28 535.750	3 773 393.350		R283	19 954.670	3 775 460.940
L284	28 523.120	3 773 398.490		R284	19 885.120	3 775 446.810
L285	28 517.500	3 773 399.880		R285	19 857.070	3 775 438.400
L286	28 478.060	3 773 402.960		R286	19 835.540	3 775 430.710
L287	28 422.650	3 773 413.810		R287	19 819.690	3 775 423.820
L288	28 264.790	3 773 445.500		R288	19 768.180	3 775 400.150
L289	28 152.850	3 773 468.700		R289	19 446.110	3 775 225.880
L290	27 786.540	3 773 546.960		R290	19 074.120	3 775 024.990
L291	27 773.790	3 773 549.890		R291	19 045.620	3 775 010.550
L292	27 761.120	3 773 551.730		R292	19 020.490	3 774 998.040
L293	27 748.360	3 773 551.960		R293	18 940.600	3 774 969.180
L294	27 713.620	3 773 542.790		R294	18 861.450	3 774 953.190
L295	27 703.890	3 773 538.990		R295	18 858.350	3 774 952.560
L296	27 686.550	3 773 533.980		R296	18 773.380	3 774 948.270
L297	27 667.180	3 773 531.580		R297	18 702.150	3 774 951.860
L298	27 645.820	3 773 535.980		R298	18 696.800	3 774 952.990
L299	27 636.800	3 773 538.070		R299	18 619.150	3 774 969.470
L300	27 611.730	3 773 550.380		R300	18 539.740	3 774 998.030
L301	27 597.220	3 773 564.900		R301	18 468.110	3 775 035.290
L302	27 577.090	3 773 585.130		R302	18 446.060	3 775 050.710
L303	27 528.680	3 773 595.350		R303	18 400.370	3 775 083.690
L304	27 501.350	3 773 601.130		R304	18 348.440	3 775 132.030
L305	27 391.460	3 773 630.410		R305	18 269.830	3 775 212.300

PADRESERWE KOÖRDINATE / ROAD RESERVE CO-ORDINATES						
LINKERKANT/LEFT HAND SIDE			REGTERKANT/RIGHT HAND SIDE			
	Y	X	WG 21°		Y	X
L306	27 337.940	3 773 641.570		R306	17 948.680	3 775 546.510
L307	26 973.080	3 773 717.210		R307	17 930.270	3 775 553.200
L308	26 536.060	3 773 805.610		R308	17 917.070	3 775 564.300
L309	26 162.870	3 773 883.080		R309	17 892.740	3 775 597.790
L310	26 105.500	3 773 890.120		R310	17 850.490	3 775 635.830
L311	26 030.670	3 773 905.720		R311	17 776.640	3 775 699.780
L312	25 954.630	3 773 910.250		R312	17 711.470	3 775 752.230
L313	25 913.020	3 773 914.660		R313	17 678.170	3 775 777.750
L314	25 873.450	3 773 920.670		R314	17 644.610	3 775 802.710
L315	25 733.390	3 773 970.360		R315	17 587.600	3 775 842.920
L316	25 714.570	3 773 973.670		R316	17 528.460	3 775 881.880
L317	25 710.570	3 773 977.240		R317	17 481.140	3 775 912.070
L318	25 671.770	3 773 988.400		R318	17 140.310	3 776 128.470
L319	25 305.260	3 774 063.660		R319	17 080.530	3 776 164.210
L320	25 225.030	3 774 068.520		R320	17 030.760	3 776 190.190
L321	25 108.770	3 774 093.220		R321	16 994.140	3 776 207.500
L322	24 990.360	3 774 129.230		R322	16 942.910	3 776 229.440
L323	24 888.560	3 774 192.780		R323	16 904.060	3 776 245.130
L324	24 877.480	3 774 200.200		R324	16 854.310	3 776 263.410
L325	24 846.140	3 774 223.320		R325	16 850.060	3 776 264.980
L326	24 823.320	3 774 241.730		R326	16 778.170	3 776 287.440
L327	24 782.550	3 774 273.730		R327	16 736.050	3 776 298.300
L328	24 753.650	3 774 301.560		R328	16 691.302	3 776 307.194
L329	24 679.080	3 774 367.580		R329	16 642.940	3 776 316.720
L330	24 607.981	3 774 436.769		R330	16 613.750	3 776 320.590
L331	24 535.300	3 774 501.500		R331	16 572.270	3 776 324.980
L332	24 494.850	3 774 545.830		R332	16 265.490	3 776 355.480
L333	24 476.200	3 774 557.790		R333	15 803.430	3 776 402.250
L334	24 437.850	3 774 580.430		R334	15 361.990	3 776 447.090
L335	24 426.850	3 774 589.230		R335	14 887.430	3 776 495.150
L336	24 415.340	3 774 600.250		R336	14 433.930	3 776 540.460
L337	24 409.100	3 774 614.430		R337	14 393.060	3 776 547.070
L338	24 402.280	3 774 630.720		R338	14 185.800	3 776 564.990
L339	24 393.860	3 774 650.720		R339	13 783.091	3 776 612.589
L340	24 347.810	3 774 679.890		R340	13 388.480	3 776 650.330
L341	24 250.643	3 774 784.952		R341	13 361.368	3 776 653.084
L342	24 211.950	3 774 824.950		R342	13 320.360	3 776 657.250
L343	24 111.980	3 774 916.430		R343	12 894.280	3 776 695.240
L344	24 115.450	3 774 923.900		R344	12 439.570	3 776 741.500
L345	24 057.400	3 774 978.260		R345	12 077.950	3 776 778.330
L346	24 009.170	3 775 001.710		R346	11 704.520	3 776 814.260
L347	23 984.100	3 775 044.460		R347	11 638.340	3 776 815.700
L348	23 928.530	3 775 088.060		R348	11 587.900	3 776 813.060
L349	23 893.660	3 775 111.360		R349	11 539.550	3 776 807.540
L350	23 858.460	3 775 132.520		R350	11 477.910	3 776 796.640
L351	23 819.910	3 775 153.320		R351	11 445.410	3 776 789.790
L352	23 781.870	3 775 171.410		R352	11 389.950	3 776 775.120
L353	23 749.070	3 775 185.140		R353	11 082.350	3 776 682.510
L354	23 718.910	3 775 196.680		R354	10 633.660	3 776 547.260
L355	23 673.400	3 775 211.670		R355	10 254.450	3 776 433.580
L356	23 637.840	3 775 221.330		R356	10 121.520	3 776 393.730

Vel	27	Van	35	P675/08
Sheet		of		

PADRESERWE KOÖRDINATE / ROAD RESERVE CO-ORDINATES											
LINKERKANT/LEFT HAND SIDE					REGTERKANT/RIGHT HAND SIDE						
	Y		X	WG 21°		Y		X			
L357	23	602.200	3	775	229.749	R357	10	003.030	3	776	374.020
L358	23	566.450	3	775	236.140	R358	9	987.130	3	776	373.290
L359	23	513.630	3	775	243.680	R359	9	972.380	3	776	372.930
L360	23	474.020	3	775	246.600	R360	9	626.520	3	776	378.680
L361	23	434.380	3	775	248.050	R361	9	168.950	3	776	387.590
L362	23	406.310	3	775	248.160	R362	9	109.500	3	776	388.750
L363	23	366.470	3	775	246.560	R363	9	051.120	3	776	391.650
L364	23	339.490	3	775	244.320	R364	9	009.000	3	776	393.530
L365	23	287.710	3	775	238.030	R365	8	981.340	3	776	393.610
L366	22	401.550	3	775	091.730	R366	8	939.630	3	776	392.350
L367	22	346.300	3	775	083.880	R367	8	663.430	3	776	397.870
L368	22	290.200	3	775	080.380	R368	8	498.460	3	776	401.560
L369	22	233.460	3	775	082.180	R369	8	452.780	3	776	401.430
L370	22	205.730	3	775	084.950	R370	8	389.260	3	776	398.950
L371	22	178.050	3	775	088.960	R371	8	370.830	3	776	397.640
L372	22	136.790	3	775	097.490	R372	8	301.320	3	776	389.930
L373	22	096.150	3	775	108.680	R373	8	184.780	3	776	377.000
L374	22	070.100	3	775	117.430	R374	7	654.620	3	776	313.770
L375	22	043.710	3	775	127.860	R375	7	542.470	3	776	300.400
L376	22	018.000	3	775	139.180	R376	7	199.560	3	776	259.530
L377	21	981.030	3	775	158.290	R377	6	722.430	3	776	202.310
L378	21	944.470	3	775	180.230	R378	6	230.310	3	776	143.480
L379	21	672.090	3	775	357.940	R379	5	900.150	3	776	105.020
L380	21	624.560	3	775	384.840	R380	5	891.700	3	776	117.680
L381	21	573.790	3	775	408.090	R381	5	904.150	3	776	236.940
L382	21	529.711	3	775	421.413	R382	5	874.650	3	776	226.880
L383	21	495.660	3	775	433.560	R383	5	871.460	3	776	196.260
L384	21	466.020	3	775	440.440	R384	5	861.280	3	776	152.880
L385	21	435.600	3	775	445.700	R385	5	823.860	3	776	103.910
L386	21	420.370	3	775	447.960	R386	5	832.350	3	776	096.140
L387	21	348.420	3	775	452.750	R387	5	777.620	3	776	075.430
L388	20	836.480	3	775	446.730	R388	5	771.070	3	776	077.480
L389	20	704.601	3	775	445.331	R389	5	745.590	3	776	069.670
L390	20	398.630	3	775	442.060	R390	5	718.850	3	776	060.860
L391	20	062.050	3	775	439.100	R391	5	692.480	3	776	051.410
L392	20	033.910	3	775	438.060	R392	5	640.400	3	776	030.200
L393	20	006.390	3	775	435.440	R393	5	512.260	3	775	973.770
L394	19	936.790	3	775	422.190	R394	5	244.750	3	775	854.950
L395	19	881.720	3	775	405.930	R395	4	984.250	3	775	739.250
L396	19	851.610	3	775	393.740	R396	4	894.750	3	775	699.480
L397	19	824.180	3	775	382.010	R397	4	807.780	3	775	660.870
L398	19	796.150	3	775	367.920	R398	4	651.190	3	775	591.320
L399	19	381.640	3	775	142.950	R399	4	634.280	3	775	584.410
L400	19	166.580	3	775	026.400	R400	4	212.830	3	775	397.311
L401	19	072.640	3	774	975.270	R401	4	137.611	3	775	363.368
L402	19	042.240	3	774	961.000	R402	4	113.862	3	775	352.697
L403	19	027.030	3	774	953.420	R403	4	053.022	3	775	325.366
L404	19	012.320	3	774	948.670	R404	4	014.272	3	775	305.905
L405	18	979.580	3	774	937.100	R405	3	989.752	3	775	291.515
L406	18	955.190	3	774	929.760	R406	3	954.212	3	775	268.475
L407	18	917.270	3	774	920.820	R407	3	930.882	3	775	251.834

Vel	28	Van	35	P675/08
Sheet		of		

PADRESERWE KOÖRDINATE / ROAD RESERVE CO-ORDINATES						
LINKERKANT/LEFT HAND SIDE				REGTERKANT/RIGHT HAND SIDE		
	Y	X	WG 21°		Y	X
L408	18 890.080	3 774 914.780		R408	3 878.380	3 775 216.270
L409	18 862.300	3 774 910.510		R409	3 813.510	3 775 163.070
L410	18 820.410	3 774 906.550		R410	3 752.900	3 775 105.100
L411	18 792.570	3 774 905.840		R411	3 702.130	3 775 041.210
L412	18 775.880	3 774 905.680		R412	3 676.610	3 774 997.300
L413	18 753.200	3 774 906.000		R413	3 651.240	3 774 953.630
L414	18 739.290	3 774 906.670		R414	3 649.660	3 774 950.250
L415	18 671.970	3 774 914.310		R415	3 636.700	3 774 926.590
L416	18 655.970	3 774 917.240		R416	3 589.690	3 774 849.380
L417	18 628.250	3 774 923.340		R417	3 579.630	3 774 832.870
L418	18 615.350	3 774 926.700		R418	3 572.180	3 774 814.590
L419	18 575.210	3 774 938.820		R419	3 556.130	3 774 775.270
L420	18 537.840	3 774 952.800		R420	3 494.130	3 774 684.560
L421	18 489.960	3 774 974.220		R421	3 487.210	3 774 677.120
L422	18 454.871	3 774 986.870		R422	3 476.910	3 774 672.180
L423	18 441.010	3 775 001.090		R423	3 473.170	3 774 665.630
L424	18 416.140	3 775 017.480		R424	3 384.080	3 774 526.340
L425	18 397.480	3 775 030.950		R425	3 373.460	3 774 507.930
L426	18 348.180	3 775 067.110		R426	3 372.470	3 774 506.210
L427	18 336.890	3 775 077.196		R427	3 332.330	3 774 452.950
L428	18 305.090	3 775 102.860		R428	3 331.250	3 774 451.870
L429	18 248.650	3 775 159.940		R429	3 296.540	3 774 417.140
L430	18 223.080	3 775 190.000		R430	3 288.420	3 774 416.820
L431	18 210.110	3 775 205.440		R431	3 277.440	3 774 403.290
L432	17 922.520	3 775 488.930		R432	3 260.980	3 774 387.800
L433	17 906.830	3 775 502.480		R433	3 211.350	3 774 357.590
L434	17 876.110	3 775 519.200		R434	3 197.920	3 774 345.180
L435	17 880.220	3 775 533.900		R435	3 176.260	3 774 335.440
L436	17 845.010	3 775 578.620		R436	3 153.610	3 774 325.260
L437	17 805.080	3 775 617.530		R437	2 987.190	3 774 250.460
L438	17 762.510	3 775 655.030		R438	2 913.540	3 774 215.470
L439	17 697.280	3 775 709.100		R439	2 833.580	3 774 177.480
L440	17 584.700	3 775 793.310		R440	2 792.290	3 774 157.720
L441	17 526.080	3 775 833.170		R441	2 557.520	3 774 046.180
L442	17 148.470	3 776 073.440		R442	2 319.820	3 773 932.910
L443	16 991.630	3 776 154.880		R443	2 274.980	3 773 911.520
L444	16 895.950	3 776 200.620		R444	2 249.230	3 773 899.340
L445	16 780.920	3 776 247.380		R445	2 221.870	3 773 891.300
L446	16 708.230	3 776 266.010		R446	2 180.200	3 773 857.490
L447	16 615.150	3 776 283.000		R447	2 092.520	3 773 783.230
L448	16 431.800	3 776 305.990		R448	1 986.490	3 773 667.960
L449	16 117.940	3 776 334.600		R449	1 945.620	3 773 660.760
L450	15 654.220	3 776 381.500		R450	1 896.230	3 773 568.790
L451	15 207.230	3 776 426.540		R451	1 882.790	3 773 553.980
L452	14 932.890	3 776 454.140		R452	1 741.700	3 773 399.010
L453	14 801.390	3 776 467.360		R453	1 630.030	3 773 307.900
L454	14 451.740	3 776 502.810		R454	1 616.810	3 773 299.960
L455	14 448.940	3 776 495.940		R455	1 601.750	3 773 291.130
L456	14 403.780	3 776 503.400		R456	1 508.720	3 773 249.310
L457	13 977.250	3 776 546.660		R457	1 435.610	3 773 230.440
L458	13 649.160	3 776 584.120		R458	1 337.980	3 773 216.350

Vel 29
Sheet of

Van 35

P675/08

PADRESERWE KOÖRDINATE / ROAD RESERVE CO-ORDINATES									
LINKERKANT/LEFT HAND SIDE					REGTERKANT/RIGHT HAND SIDE				
	Y	X	WG 21°		Y	X			
L459	13 583.580	3 776 588.890		R459	1 334.460	3 773 221.690			
L460	13 524.270	3 776 590.750		R460	1 325.080	3 773 221.000			
L461	13 179.580	3 776 631.290		R461	1 312.240	3 773 212.770			
L462	12 746.390	3 776 673.820		R462	1 154.950	3 773 197.050			
L463	12 743.970	3 776 673.430		R463	913.390	3 773 165.170			
L464	12 691.830	3 776 646.420		R464	777.920	3 773 149.240			
L465	12 663.090	3 776 639.230		R465	617.990	3 773 130.420			
L466	12 619.540	3 776 643.640		R466	518.610	3 773 118.320			
L467	12 592.460	3 776 656.300		R467	450.890	3 773 109.690			
L468	12 560.950	3 776 682.880		R468	427.100	3 773 106.780			
L469	12 558.790	3 776 687.850		R469	339.100	3 773 089.990			
L470	12 415.990	3 776 702.100		R470	123.880	3 773 034.720			
L471	12 292.365	3 776 710.520		R471	-94.900	3 772 978.900			
L472	12 259.980	3 776 712.200		R472	-110.330	3 772 974.980			
L473	12 199.410	3 776 720.940		R473	-125.080	3 772 971.090			
L474	12 118.980	3 776 731.870		R474	-179.440	3 772 957.630			
L475	11 936.700	3 776 742.580		R475	-203.230	3 772 951.480			
L476	11 858.320	3 776 758.210		R476	-358.040	3 772 940.590			
L477	11 779.260	3 776 768.420		R477	-434.940	3 772 950.960			
L478	11 753.610	3 776 774.940		R478	-509.380	3 772 972.050			
L479	11 719.800	3 776 777.840		R479	-580.410	3 773 002.120			
L480	11 704.410	3 776 778.850		R480	-614.250	3 773 020.780			
L481	11 676.480	3 776 780.060		R481	-664.200	3 773 053.750			
L482	11 646.320	3 776 779.980		R482	-694.290	3 773 073.490			
L483	11 645.720	3 776 779.970		R483	-744.350	3 773 128.530			
L484	11 632.360	3 776 779.710		R484	-772.650	3 773 158.950			
L485	11 596.890	3 776 774.610		R485	-790.540	3 773 182.010			
L486	11 472.390	3 776 761.930		R486	-876.650	3 773 294.260			
L487	11 458.400	3 776 759.220		R487	-935.630	3 773 371.970			
L488	10 927.394	3 776 608.845		R488	-955.660	3 773 397.160			
L489	10 502.920	3 776 475.580		R489	-1 026.570	3 773 470.950			
L490	10 257.880	3 776 401.810		R490	-1 142.930	3 773 563.600			
L491	10 172.440	3 776 376.100		R491	-1 218.910	3 773 609.630			
L492	10 130.550	3 776 364.170		R492	-1 288.610	3 773 642.420			
L493	10 087.700	3 776 354.100		R493	-1 346.570	3 773 665.280			
L494	10 031.020	3 776 345.890		R494	-1 359.250	3 773 669.820			
L495	9 972.510	3 776 342.090		R495	-1 417.110	3 773 689.390			
L496	9 915.510	3 776 342.160		R496	-1 538.107	3 773 725.631			
L497	9 447.300	3 776 351.460		R497	-1 564.180	3 773 728.620			
L498	9 241.890	3 776 355.280		R498	-1 593.110	3 773 731.180			
L499	9 193.710	3 776 350.470		R499	-2 339.320	3 773 916.360			
L500	9 156.760	3 776 355.560		R500	-2 413.190	3 773 930.190			
L501	9 144.450	3 776 357.260		R501	-2 441.100	3 773 933.080			
L502	8 735.130	3 776 365.230		R502	-2 577.870	3 773 947.060			
L503	8 511.590	3 776 370.400		R503	-2 743.740	3 773 950.050			
L504	8 495.390	3 776 369.060		R504	-3 004.190	3 773 951.550			
L505	8 439.930	3 776 363.460		R505	-3 252.590	3 773 953.640			
L506	8 354.460	3 776 359.760		R506	-4 210.170	3 773 959.220			
L507	8 300.440	3 776 353.310		R507	-4 385.530	3 773 976.450			
L508	7 909.810	3 776 306.660		R508	-4 505.000	3 774 005.710			
L509	7 549.570	3 776 263.710		R509	-4 541.660	3 774 012.360			

Vel	30	Van	35	P675/08
Sheet		of		

PADRESERWE KOÖRDINATE / ROAD RESERVE CO-ORDINATES

LINKERKANT/LEFT HAND SIDE				REGTERKANT/RIGHT HAND SIDE			
	Y	X	WG 21°		Y	X	
L510	6 902.130	3 776 186.320		R510	-4 567.030	3 774 017.380	
L511	6 495.520	3 776 137.960		R511	-4 592.970	3 774 027.760	
L512	6 470.390	3 776 134.760		R512	-4 645.330	3 774 049.840	
L513	6 456.360	3 776 132.540		R513	-4 704.350	3 774 080.990	
L514	6 428.310	3 776 126.960		R514	-4 827.050	3 774 142.540	
L515	6 398.640	3 776 125.700		R515	-5 523.150	3 774 494.500	
L516	6 356.040	3 776 121.050		R516	-5 615.760	3 774 536.070	
L517	6 312.980	3 776 112.050		R517	-5 641.190	3 774 544.700	
L518	6 241.570	3 776 107.490		R518	-5 712.800	3 774 567.960	
L519	6 114.240	3 776 091.570		R519	-5 812.730	3 774 589.050	
L520	6 042.800	3 776 082.630		R520	-5 892.400	3 774 601.820	
L521	6 019.010	3 776 063.800		R521	-5 905.810	3 774 603.190	
L522	5 991.450	3 776 020.690		R522	-6 011.580	3 774 614.770	
L523	5 967.440	3 776 017.880		R523	-6 041.890	3 774 618.710	
L524	5 905.500	3 776 067.480		R524	-6 222.910	3 774 668.700	
L525	5 817.790	3 776 055.750		R525	-6 504.970	3 774 813.920	
L526	5 803.600	3 776 053.360		R526	-6 860.520	3 774 996.480	
L527	5 778.620	3 776 047.240		R527	-7 140.020	3 775 098.470	
L528	5 751.070	3 776 039.020		R528	-7 213.670	3 775 142.460	
L529	5 710.540	3 776 025.340		R529	-7 281.080	3 775 201.450	
L530	5 684.140	3 776 015.170		R530	-7 309.970	3 775 231.200	
L531	5 643.670	3 775 997.450		R531	-7 327.200	3 775 249.120	
L532	5 519.530	3 775 942.430		R532	-7 689.000	3 775 615.854	
L533	5 253.390	3 775 824.710		R533	-8 047.288	3 775 990.518	
L534	4 992.730	3 775 709.410		R534	-8 057.370	3 776 008.280	
L535	4 974.980	3 775 701.560		R535	-8 084.300	3 776 038.490	
L536	4 903.320	3 775 669.710		R536	-8 093.160	3 776 044.840	
L537	4 889.440	3 775 663.540		R537	-8 103.170	3 776 052.020	
L538	4 816.320	3 775 631.240		R538	-8 361.910	3 776 315.030	
L539	4 642.780	3 775 554.570		R539	-8 651.880	3 776 613.930	
L540	4 343.230	3 775 406.250		R540	-8 740.860	3 776 709.730	
L541	4 250.180	3 775 369.440		R541	-8 802.600	3 776 769.790	
L542	4 030.570	3 775 274.680		R542	-8 870.670	3 776 838.430	
L543	3 997.402	3 775 253.335		R543	-8 991.190	3 776 961.310	
L544	3 943.743	3 775 216.334		R544	-9 107.050	3 777 082.300	
L545	3 916.223	3 775 194.974		R545	-9 099.910	3 777 096.020	
L546	3 872.100	3 775 157.670		R546	-9 123.500	3 777 114.930	
L547	3 824.300	3 775 097.000		R547	-9 136.210	3 777 112.170	
L548	3 777.110	3 775 034.990		R548	-9 289.820	3 777 267.960	
L549	3 707.720	3 774 935.660		R549	-9 341.970	3 777 314.740	
L550	3 681.650	3 774 884.510		R550	-9 435.870	3 777 389.690	
L551	3 648.250	3 774 839.720		R551	-9 532.900	3 777 449.360	
L552	3 622.590	3 774 805.310		R552	-9 602.950	3 777 486.140	
L553	3 615.660	3 774 805.340		R553	-9 675.720	3 777 520.290	
L554	3 606.880	3 774 792.240		R554	-9 719.580	3 777 535.510	
L555	3 590.760	3 774 768.210		R555	-9 784.340	3 777 556.570	
L556	3 584.700	3 774 759.150		R556	-9 850.240	3 777 575.030	
L557	3 562.570	3 774 726.040		R557	-9 904.910	3 777 586.840	
L558	3 559.070	3 774 720.800		R558	-9 972.550	3 777 598.850	
L559	3 536.930	3 774 687.690		R559	-10 026.730	3 777 605.330	
L560	3 514.790	3 774 654.570		R560	-10 094.140	3 777 610.550	

Vel
Sheet

31

Van

35

of

P675/08

PADRESERWE KOÖRDINATE / ROAD RESERVE CO-ORDINATES					
LINKERKANT/LEFT HAND SIDE			REGTERKANT/RIGHT HAND SIDE		
	Y	X	WG 21°		X
L561	3 507.460	3 774	643.610	R561	-10 149.780 3 777 611.720
L562	3 470.950	3 774	588.990	R562	-10 204.370 3 777 610.050
L563	3 424.920	3 774	496.080	R563	-10 237.160 3 777 608.550
L564	3 416.766	3 774	480.001	R564	-10 311.560 3 777 601.960
L565	3 378.986	3 774	421.429	R565	-10 381.410 3 777 590.910
L566	3 371.730	3 774	425.760	R566	-10 414.860 3 777 585.850
L567	3 338.640	3 774	375.280	R567	-10 430.890 3 777 581.620
L568	3 341.030	3 774	362.270	R568	-10 541.640 3 777 552.950
L569	3 329.540	3 774	344.200	R569	-10 578.360 3 777 540.740
L570	3 319.980	3 774	350.180	R570	-10 663.180 3 777 506.160
L571	3 299.110	3 774	363.450	R571	-10 861.890 3 777 414.740
L572	3 286.240	3 774	361.930	R572	-10 864.620 3 777 413.480
L573	3 229.800	3 774	324.910	R573	-11 696.190 3 777 031.670
L574	3 212.160	3 774	316.160	R574	-12 114.830 3 776 840.110
L575	3 186.860	3 774	304.270	R575	-12 351.280 3 776 731.020
L576	3 162.890	3 774	293.010	R576	-12 403.530 3 776 706.910
L577	3 009.060	3 774	220.730	R577	-12 408.180 3 776 707.300
L578	2 925.480	3 774	182.730	R578	-12 417.620 3 776 702.800
L579	2 805.420	3 774	128.300	R579	-12 419.330 3 776 699.680
L580	2 787.260	3 774	119.850	R580	-12 514.190 3 776 655.480
L581	2 712.400	3 774	085.000	R581	-12 772.670 3 776 536.540
L582	2 561.240	3 773	970.510	R582	-12 776.420 3 776 544.860
L583	2 569.280	3 773	962.720	R583	-12 794.700 3 776 536.010
L584	2 555.380	3 773	949.880	R584	-12 798.610 3 776 533.560
L585	2 542.730	3 773	962.490	R585	-12 841.940 3 776 523.320
L586	2 370.250	3 773	918.340	R586	-12 885.170 3 776 483.400
L587	2 316.100	3 773	893.560	R587	-13 111.980 3 776 379.010
L588	2 265.640	3 773	864.230	R588	-13 128.870 3 776 371.280
L589	2 252.200	3 773	854.860	R589	-13 459.410 3 776 219.640
L590	2 247.580	3 773	836.270	R590	-13 695.970 3 776 111.070
L591	2 241.980	3 773	832.850	R591	-13 767.150 3 776 078.240
L592	2 226.050	3 773	836.380	R592	-13 792.690 3 776 066.460
L593	2 217.650	3 773	830.190	R593	-13 942.400 3 775 997.420
L594	2 208.810	3 773	823.150	R594	-14 239.950 3 775 876.180
L595	2 187.810	3 773	805.570	R595	-14 354.210 3 775 841.580
L596	2 138.700	3 773	757.240	R596	-14 670.620 3 775 786.840
L597	1 984.360	3 773	587.550	R597	-14 815.630 3 775 775.450
L598	1 836.350	3 773	424.940	R598	-14 829.240 3 775 773.720
L599	1 794.700	3 773	380.860	R599	-14 873.220 3 775 762.530
L600	1 759.780	3 773	348.410	R600	-14 985.950 3 775 730.070
L601	1 727.890	3 773	322.540	R601	-15 224.210 3 775 696.060
L602	1 716.580	3 773	314.610	R602	-15 459.700 3 775 644.050
L603	1 700.680	3 773	303.600	R603	-15 776.780 3 775 586.760
L604	1 665.600	3 773	280.430	R604	-16 095.400 3 775 536.610
L605	1 557.800	3 773	227.280	R605	-16 373.860 3 775 474.410
L606	1 516.080	3 773	214.290	R606	-16 570.780 3 775 438.640
L607	1 446.820	3 773	196.460	R607	-16 617.480 3 775 440.380
L608	1 192.520	3 773	166.700	R608	-16 675.830 3 775 434.940
L609	928.950	3 773	135.670	R609	-16 713.620 3 775 425.900
L610	779.740	3 773	117.730	R610	-16 769.700 3 775 407.370
L611	621.940	3 773	098.910	R611	-16 887.070 3 775 380.710

Vel	32	Van	35	P675/08
Sheet		of		

PADRESERWE KOÖRDINATE / ROAD RESERVE CO-ORDINATES						
LINKERKANT/LEFT HAND SIDE				REGTERKANT/RIGHT HAND SIDE		
	Y	X	WG 21°		Y	X
L612	520.310	3 773	086.920	R612	-16 943.250	3 775 370.470
L613	445.000	3 773	076.020	R613	-16 964.880	3 775 366.620
L614	430.010	3 773	074.130	R614	-17 003.340	3 775 359.650
L615	410.620	3 773	071.490	R615	-17 242.080	3 775 331.610
L616	402.820	3 773	070.440	R616	-17 398.040	3 775 287.680
L617	389.470	3 773	067.300	R617	-17 478.610	3 775 272.950
L618	268.510	3 773	040.180	R618	-17 545.520	3 775 261.920
L619	240.765	3 773	032.800	R619	-17 873.380	3 775 201.140
L620	76.740	3 772	990.790	R620	-18 016.680	3 775 175.090
L621	-84.180	3 772	949.360	R621	-18 110.760	3 775 156.830
L622	- 101.330	3 772	944.560	R622	-18 188.460	3 775 137.040
L623	- 187.990	3 772	930.420	R623	-18 265.580	3 775 112.370
L624	- 237.100	3 772	910.910	R624	-18 290.340	3 775 102.290
L625	- 294.440	3 772	905.042	R625	-18 341.350	3 775 079.930
L626	- 323.320	3 772	905.043	R626	-18 415.290	3 775 043.740
L627	- 350.010	3 772	905.044	R627	-18 487.420	3 775 001.200
L628	- 394.770	3 772	909.470	R628	-18 507.480	3 774 989.370
L629	- 452.460	3 772	915.670	R629	-18 619.190	3 774 914.920
L630	- 566.870	3 772	947.980	R630	-18 704.940	3 774 844.500
L631	- 599.970	3 772	962.340	R631	-18 792.537	3 774 772.496
L632	- 636.840	3 772	981.860	R632	-18 911.840	3 774 674.750
L633	- 685.110	3 773	020.680	R633	-19 041.020	3 774 571.270
L634	- 698.370	3 773	025.660	R634	-19 133.280	3 774 497.840
L635	- 748.000	3 773	052.410	R635	-19 141.340	3 774 491.400
L636	- 767.140	3 773	075.980	R636	-19 263.150	3 774 393.950
L637	- 792.120	3 773	109.680	R637	-19 403.190	3 774 281.590
L638	- 807.740	3 773	131.100	R638	-19 471.390	3 774 238.040
L639	- 822.480	3 773	151.780	R639	-19 618.640	3 774 123.050
L640	- 866.140	3 773	212.540	R640	-19 630.650	3 774 139.830
L641	- 978.970	3 773	352.100	R641	-19 651.960	3 774 136.520
L642	-1 040.920	3 773	428.050	R642	-19 715.990	3 774 118.110
L643	-1 113.410	3 773	494.160	R643	-19 775.070	3 774 091.140
L644	-1 209.990	3 773	561.280	R644	-19 826.260	3 774 070.140
L645	-1 314.750	3 773	615.260	R645	-19 891.010	3 774 049.280
L646	-1 393.090	3 773	642.680	R646	-19 952.090	3 774 030.710
L647	-1 426.650	3 773	654.580	R647	-20 004.150	3 774 019.180
L648	-1 513.280	3 773	671.630	R648	-20 094.850	3 773 999.110
L649	-1 544.470	3 773	677.770	R649	-20 119.680	3 773 987.210
L650	-1 580.510	3 773	693.100	R650	-20 137.330	3 773 973.540
L651	-1 698.290	3 773	717.240	R651	-20 171.650	3 773 941.540
L652	-1 813.420	3 773	751.070	R652	-20 592.130	3 773 836.650
L653	-2 299.720	3 773	871.920	R653	-20 632.060	3 773 826.780
L654	-2 494.700	3 773	904.470	R654	-20 682.810	3 773 814.230
L655	-2 579.950	3 773	902.850	R655	-20 942.200	3 773 750.120
L656	-2 702.600	3 773	909.940	R656	-21 100.180	3 773 711.230
L657	-2 822.370	3 773	910.190	R657	-21 533.854	3 773 606.700
L658	-2 841.980	3 773	910.510	R658	-21 887.350	3 773 517.300
L659	-3 054.680	3 773	911.520	R659	-22 004.810	3 773 488.400
L660	-3 258.270	3 773	912.790	R660	-22 049.660	3 773 500.600
L661	-3 333.280	3 773	907.730	R661	-22 132.800	3 773 496.340
L662	-3 433.330	3 773	913.520	R662	-22 207.680	3 773 506.040

Vel 33
Sheet

Van 35
of

P675/08

PADRESERWE KOÖRDINATE / ROAD RESERVE CO-ORDINATES									
LINKERKANT/LEFT HAND SIDE				REGTERKANT/RIGHT HAND SIDE					
	Y	X	WG 21°		Y	X			
L663	-3	873.580	3 773	916.420	R663	-22	382.730	3 773	510.100
L664	-4	038.320	3 773	917.200	R664	-22	438.260	3 773	512.130
L665	-4	213.830	3 773	916.980	R665	-22	483.530	3 773	527.960
L666	-4	315.280	3 773	926.380	R666	-22	590.360	3 773	579.180
L667	-4	454.120	3 773	951.240	R667	-22	639.550	3 773	605.360
L668	-4	553.090	3 773	978.950	R668	-22	686.260	3 773	636.460
L669	-4	635.010	3 774	009.640	R669	-22	721.290	3 773	663.300
L670	-4	677.700	3 774	025.940	R670	-22	735.710	3 773	674.070
L671	-4	700.190	3 774	028.180	R671	-22	782.010	3 773	713.480
L672	-4	718.740	3 774	045.800	R672	-22	803.590	3 773	734.030
L673	-4	882.460	3 774	129.530	R673	-22	925.220	3 773	855.090
L674	-5	039.820	3 774	209.230	R674	-22	941.570	3 773	870.950
L675	-5	113.210	3 774	240.660	R675	-22	952.570	3 773	882.820
L676	-5	236.250	3 774	308.470	R676	-22	989.190	3 773	918.990
L677	-5	538.240	3 774	462.900	R677	-23	071.043	3 773	997.586
L678	-5	668.090	3 774	515.150	R678	-23	148.370	3 774	077.390
L679	-5	871.210	3 774	560.530					
L680	-6	013.390	3 774	576.740					
L681	-6	097.180	3 774	591.450					
L682	-6	151.858	3 774	605.741					
L683	-6	294.950	3 774	658.170					
L684	-6	307.560	3 774	663.890					
L685	-6	389.080	3 774	715.270					
L686	-6	804.650	3 774	929.880					
L687	-6	875.180	3 774	960.650					
L688	-7	058.470	3 775	025.990					
L689	-7	149.350	3 775	061.140					
L690	-7	195.230	3 775	082.420					
L691	-7	211.670	3 775	098.140					
L692	-7	276.710	3 775	148.950					
L693	-7	559.560	3 775	443.160					
L694	-7	894.320	3 775	788.870	L714	-10	219.100	3 777	578.170
L695	-8	057.000	3 775	954.980	L715	-10	305.630	3 777	571.150
L696	-8	072.280	3 775	965.760	L716	-10	404.870	3 777	555.070
L697	-8	112.300	3 776	009.080	L717	-10	404.350	3 777	550.100
L698	-8	174.500	3 776	076.390	L718	-10	410.760	3 777	548.670
L699	-8	655.870	3 776	570.650	L719	-10	423.260	3 777	545.870
L700	-8	727.190	3 776	638.560	L720	-10	429.680	3 777	549.620
L701	-8	735.320	3 776	648.730	L721	-10	439.250	3 777	547.520
L702	-8	757.070	3 776	667.210	L722	-10	532.640	3 777	521.780
L703	-8	822.980	3 776	742.600	L723	-10	663.640	3 777	471.870
L704	-9	163.180	3 777	096.990	L724	-11	261.580	3 777	197.140
L705	-9	299.030	3 777	233.240	L725	-11	835.160	3 776	933.120
L706	-9	316.490	3 777	249.550	L726	-12	753.030	3 776	511.040
L707	-9	372.420	3 777	299.430	L727	-12	751.810	3 776	498.520
L708	-9	448.310	3 777	357.910	L728	-12	785.230	3 776	488.890
L709	-9	517.620	3 777	403.310	L729	-12	799.940	3 776	484.010
L710	-9	601.320	3 777	449.540	L730	-12	841.120	3 776	470.360
L711	-9	731.790	3 777	506.430					
L712	-9	902.250	3 777	553.720					
L713	-10	114.790	3 777	579.000					
					LINKERKANT/LEFT HAND SIDE				
						Y		X	

Vel	34	Van	35	P675/08
Sheet		of		

PADRESERWE KOÖRDINATE / ROAD RESERVE CO-ORDINATES						
LINKERKANT/LEFT HAND SIDE				LINKERKANT/LEFT HAND SIDE		
	Y	X	WG 21°	Y	X	
L731	-13 097.750	3 776 352.250		L782	-19 588.420	3 774 098.860
L732	-13 678.480	3 776 085.680		L783	-19 607.670	3 774 085.430
L733	-13 711.510	3 776 070.030		L784	-19 695.920	3 774 035.170
L734	-13 790.340	3 776 032.700		L785	-19 787.950	3 773 992.470
L735	-14 235.020	3 775 832.420		L786	-19 873.790	3 773 961.800
L736	-14 477.898	3 775 788.432		L787	-19 902.210	3 773 951.650
L737	-14 744.450	3 775 738.360		L788	-20 378.950	3 773 833.440
L738	-14 751.430	3 775 726.110		L789	-20 669.060	3 773 762.330
L739	-14 802.570	3 775 715.940		L790	-20 860.220	3 773 715.480
L740	-14 819.560	3 775 713.380		L791	-21 020.320	3 773 676.080
L741	-14 843.260	3 775 707.880		L792	-21 278.780	3 773 612.480
L742	-14 861.130	3 775 707.000		L793	-21 456.850	3 773 568.320
L743	-14 881.970	3 775 705.980		L794	-21 491.890	3 773 526.900
L744	-14 945.770	3 775 703.440		L795	-21 518.080	3 773 512.260
L745	-15 118.950	3 775 665.200		L796	-21 571.300	3 773 499.130
L746	-15 240.040	3 775 642.810		L797	-21 600.190	3 773 501.020
L747	-15 455.900	3 775 610.520		L798	-21 638.070	3 773 515.280
L748	-15 685.900	3 775 568.250		L799	-21 660.730	3 773 518.210
L749	-15 809.130	3 775 545.180		L800	-21 933.290	3 773 449.520
L750	-16 023.820	3 775 501.760		L801	-21 942.910	3 773 447.030
L751	-16 185.100	3 775 477.010		L802	-22 016.850	3 773 436.660
L752	-16 539.840	3 775 413.350		L803	-22 044.260	3 773 432.820
L753	-16 611.200	3 775 389.140		L804	-22 145.580	3 773 428.540
L754	-16 753.890	3 775 363.490		L805	-22 247.120	3 773 435.120
L755	-16 893.120	3 775 349.230		L806	-22 347.810	3 773 449.940
L756	-17 019.810	3 775 326.170		L807	-22 405.190	3 773 466.570
L757	-17 225.160	3 775 278.310		L808	-22 615.730	3 773 540.380
L758	-17 306.140	3 775 267.330		L809	-22 686.690	3 773 581.400
L759	-17 594.320	3 775 221.510		L810	-22 738.970	3 773 616.920
L760	-17 610.390	3 775 217.190		L811	-22 745.790	3 773 621.570
L761	-17 639.160	3 775 213.480		L812	-22 774.200	3 773 644.340
L762	-18 061.260	3 775 136.750		L813	-22 821.240	3 773 686.040
L763	-18 154.990	3 775 114.560		L814	-22 849.530	3 773 713.680
L764	-18 227.890	3 775 091.760		L815	-22 866.590	3 773 730.630
L765	-18 319.110	3 775 056.290		L816	-22 886.330	3 773 750.240
L766	-18 325.490	3 775 053.740		L817	-22 897.830	3 773 761.660
L767	-18 336.620	3 775 048.970		L818	-22 903.410	3 773 767.210
L768	-18 350.210	3 775 042.230		L819	-22 952.500	3 773 816.340
L769	-18 369.970	3 775 032.930		L820	-22 957.890	3 773 821.450
L770	-18 454.870	3 774 987.082		L821	-22 979.240	3 773 841.700
L771	-18 454.880	3 774 986.410		L822	-23 015.670	3 773 878.000
L772	-18 500.680	3 774 958.260		L823	-23 072.050	3 773 934.600
L773	-18 556.660	3 774 918.920		L824	-23 095.210	3 773 956.820
L774	-18 591.410	3 774 892.180		L825	-23 182.410	3 774 044.450
L775	-18 744.296	3 774 772.400				
L776	-18 907.230	3 774 639.360				
L777	-19 063.850	3 774 513.650				
L778	-19 109.240	3 774 477.270				
L779	-19 250.180	3 774 364.280				
L780	-19 431.330	3 774 219.100				
L781	-19 491.230	3 774 167.000				

Vel	35	Van	35	P675/08
Sheet		of		