

Government Gazette Staatskoerant

REPUBLIC OF SOUTH AFRICA
REPUBLIEK VAN SUID-AFRIKA

Vol. 524

Pretoria, 26 February 2009
Februarie

No. 31919

CONTENTS**INHOUD**

<i>No.</i>	<i>Page No.</i>	<i>Gazette No.</i>	<i>No.</i>	<i>Bladsy No.</i>	<i>Koerant No.</i>
GOVERNMENT NOTICE			GOEWERMENTSKENNISGEWING		
Transport, Department of			Vervoer, Departement van		
<i>Government Notice</i>			<i>Goewermentskennisgewing</i>		
174			174		
South African National Roads Agency Limited and the National Roads Act (7/1998): The South African National Roads Agency Limited: Declaration amendment of National Road R22 Section 3: Amendment of Declaration No. 1350 of 2003	3	31919	Suid-Afrikaanse Nasionale Padagentskap Beperk en die Nasionale Paaie Wet (7/1998): Die Suid-Afrikaanse Nasionale Padagentskap Beperk: Verklaring wysiging van Nasionale Pad R22 Seksie 3: Wysiging van Verklaring No. 1350 van 2003	4	31919

GOVERNMENT NOTICE

DEPARTMENT OF TRANSPORT

No. 174

26 February 2009

THE SOUTH AFRICAN NATIONAL ROADS AGENCY LIMITED

Registration No: 98/09584/06

DECLARATION AMENDMENT OF NATIONAL ROAD R22 SECTION 3

AMENDMENT OF DECLARATION NO. 1350 OF 2003

By virtue of section 40(1)(b) of the South African National Roads Agency Limited and the National Roads Act, 1998 (Act No. 7 of 1998), I hereby amend Declaration No. 1350 of 2003 by substituting the section from the Mkuzi River up to the Mseleni River, with the subjoined sheets 1 to 10 of Plan No. P721/08.

(National Road R22 Section 3: Mkuzi River – Mseleni River)



MINISTER OF TRANSPORT

GOEWERMENTSKENNISGEWING

DEPARTEMENT VAN VERVOER

No. 174

26 Februarie 2009

DIE SUID-AFRIKAANSE NASIONALE PADAGENTSKAP BEPERK

Registrasie No: 98/09584/06

VERKLARING WYSIGING VAN NASIONALE PAD R22 SEKSIE 3.

WYSIGING VAN VERKLARING NO. 1350 VAN 2003

Kragtens Artikel 40(1)(b) van die Suid-Afrikaanse Nasionale Padagentskap Beperk en die Nasionale Paaie Wet, 1998 (Wet no.7 van 1998), wysig ek hiermee Verklaring no. 1350 van 2003, deur die gedeelte vanaf die Mkuzirivier tot by die Mselenirivier, te vervang met meegaande velle 1 tot 10 van Plan no. P721/08

(Nasionale Pad R22 Seksie 3: Mkuzirivier – Mselenirivier)



MINISTER VAN VERVOER

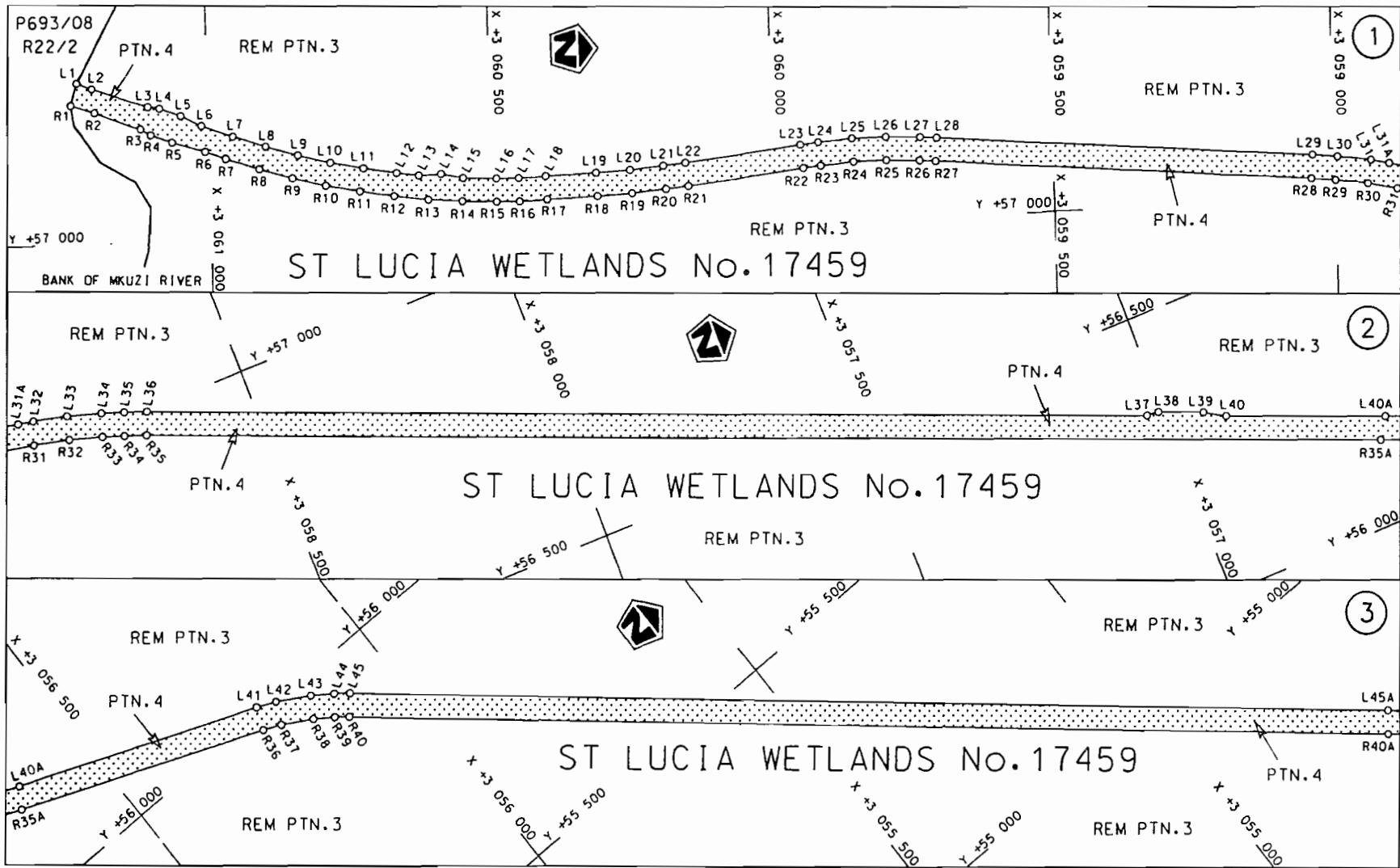

Die Suid Afrikaanse Nasionale Padagentskap Beperk The South African National Roads Agency Limited	Die figuur getoon The figure shown	 steldie podreserwe voor van 'n gedeelte represents the road reserve of a portion van Nasionale Roete R22 Seksie Section of National Route R22 Section 3	Vel Sheet 1 von of 10 Plon P721/08
--	---------------------------------------	---	---------------------------------------

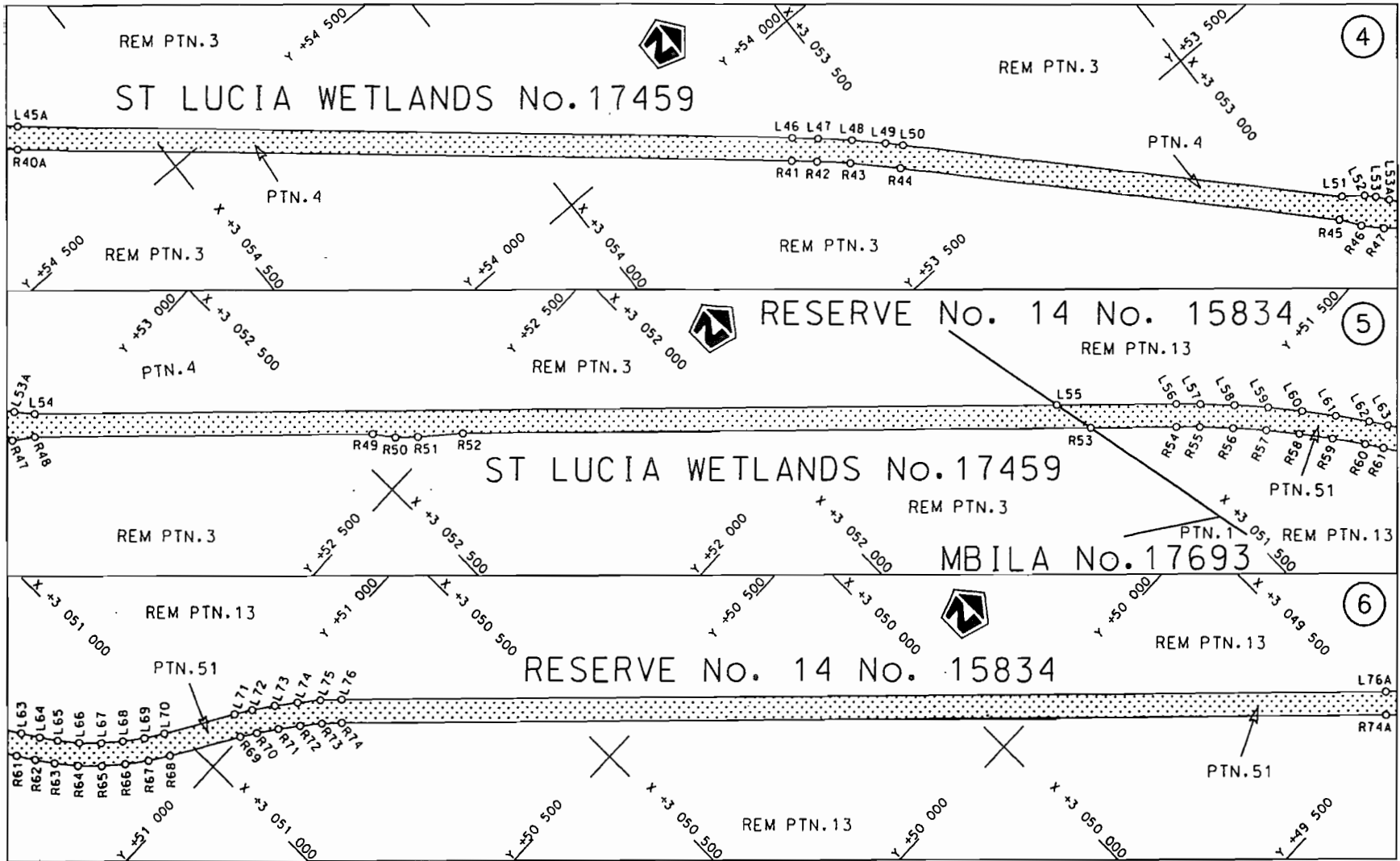

Die Suid Afrikaanse Nasionale Padagentskap Beperk
 The South African National Roads Agency Limited

Die figuur getoon
 The figure shown

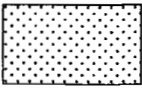

steldie padreserwe voor van 'n gedeelte
 represents the road reserve of a portion
 van Nasionale Roete R22 Seksie Section
 of National Route R22 Section 3

Vel Sheet 2 van of 10
 Plan P721/08

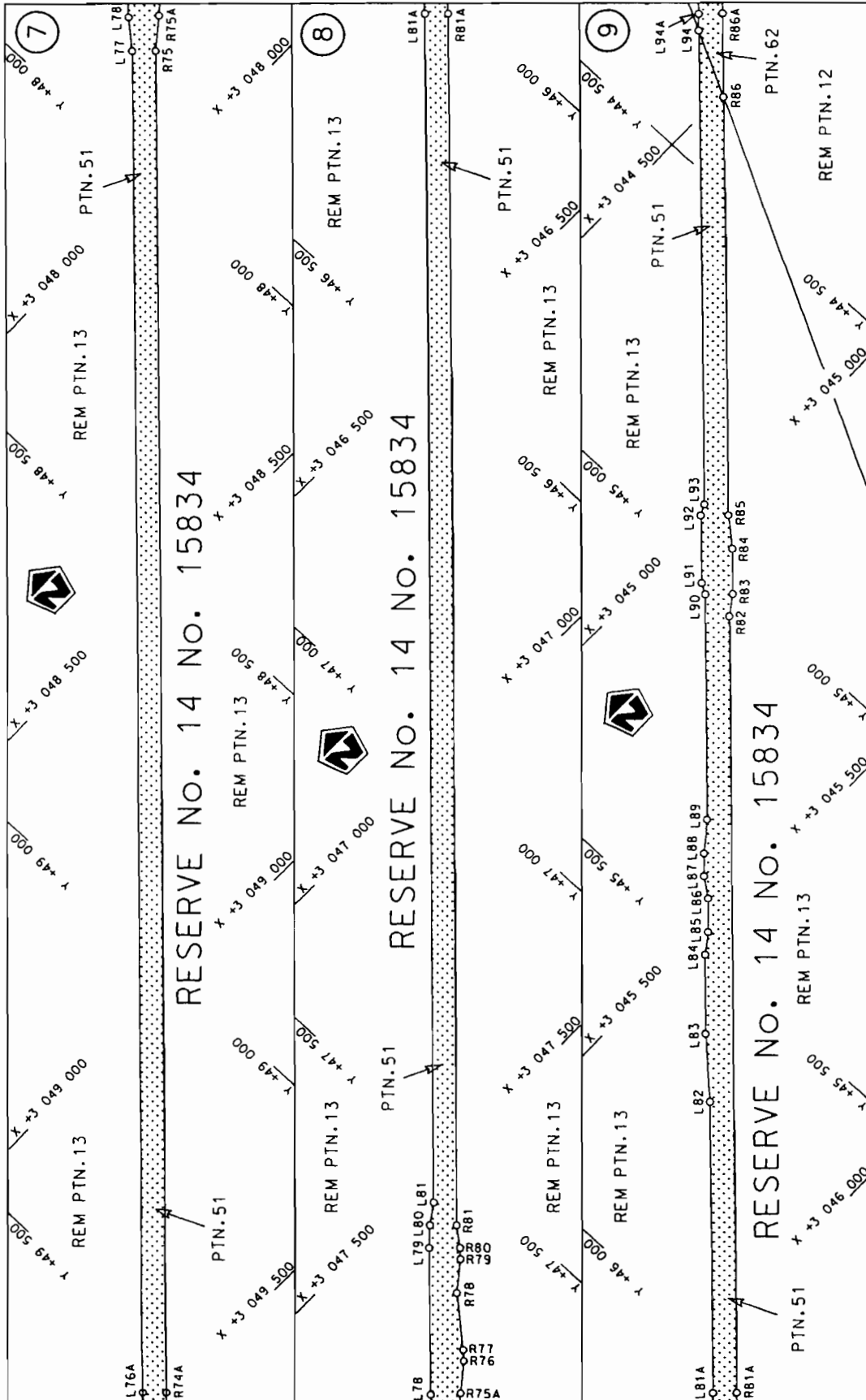

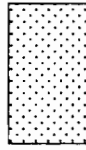
<p>Die Suid Afrikaanse Nasionale Padagentskap Beperk The South African National Roads Agency Limited</p>	<p>Die figuur getoon The figure shown</p> 	<p>steldie padreserwe voor van 'n gedeelte represents the road reserve of a portion van Nasionale Roete R22 of National Route</p> <p>R22 Seksie Section</p>
	<p>Vel Sheet</p> <p>3 of</p>	<p>10</p> <p>Plan P721/08</p>

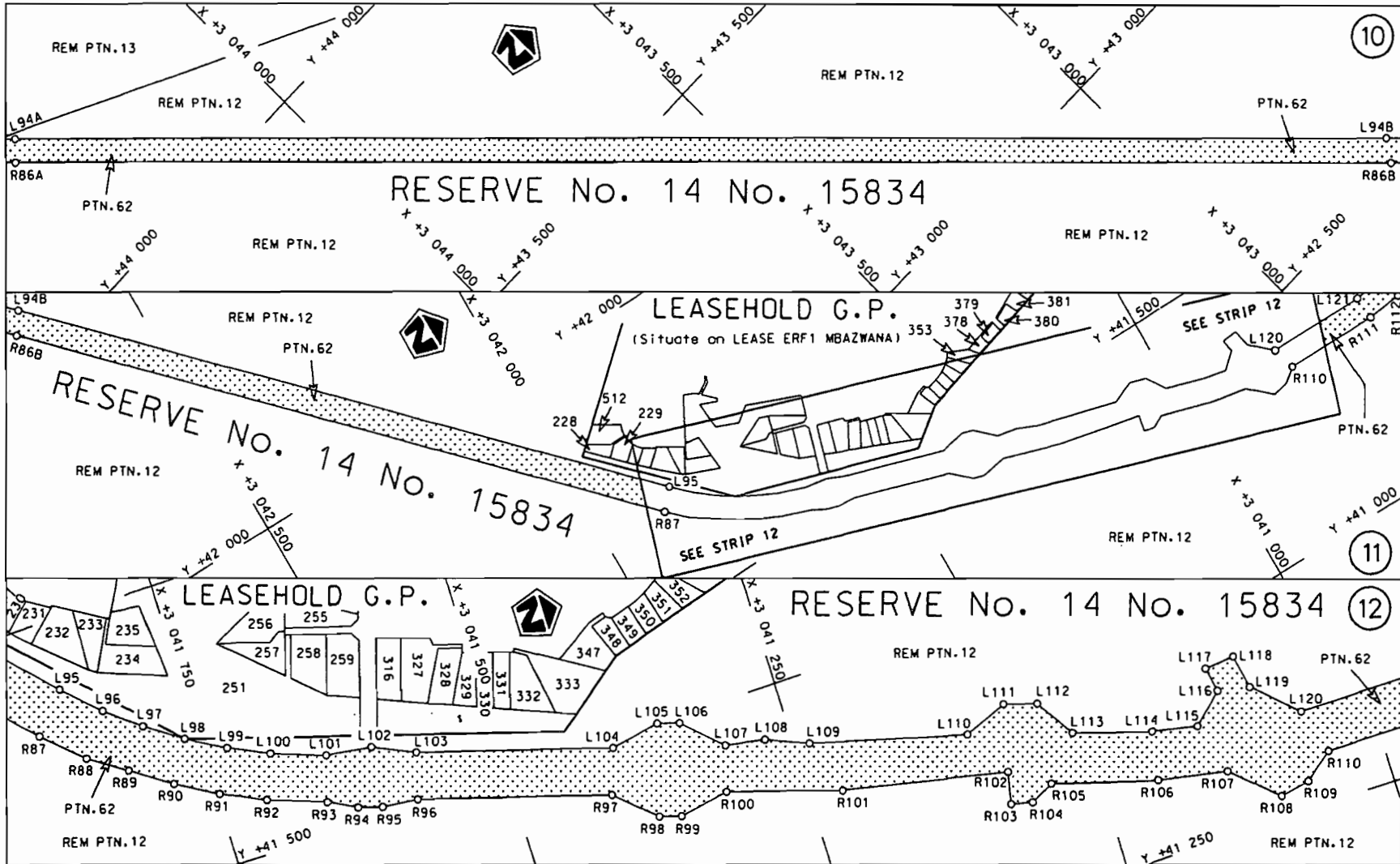

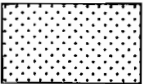
<p>Die Suid Afrikaanse Nasionale Padogentskap Beperk The South African National Roads Agency Limited</p>	<p>Die figuur getoon The figure shown</p> 	<p>steldie podreserwe voor van 'n gedeelte represents the road reserve of a portion van Nasionale Roete R22 Seksie Section 3 of National Route</p>	<p>Vel Sheet 4 of 10 Plan P721/08</p>
--	--	--	---

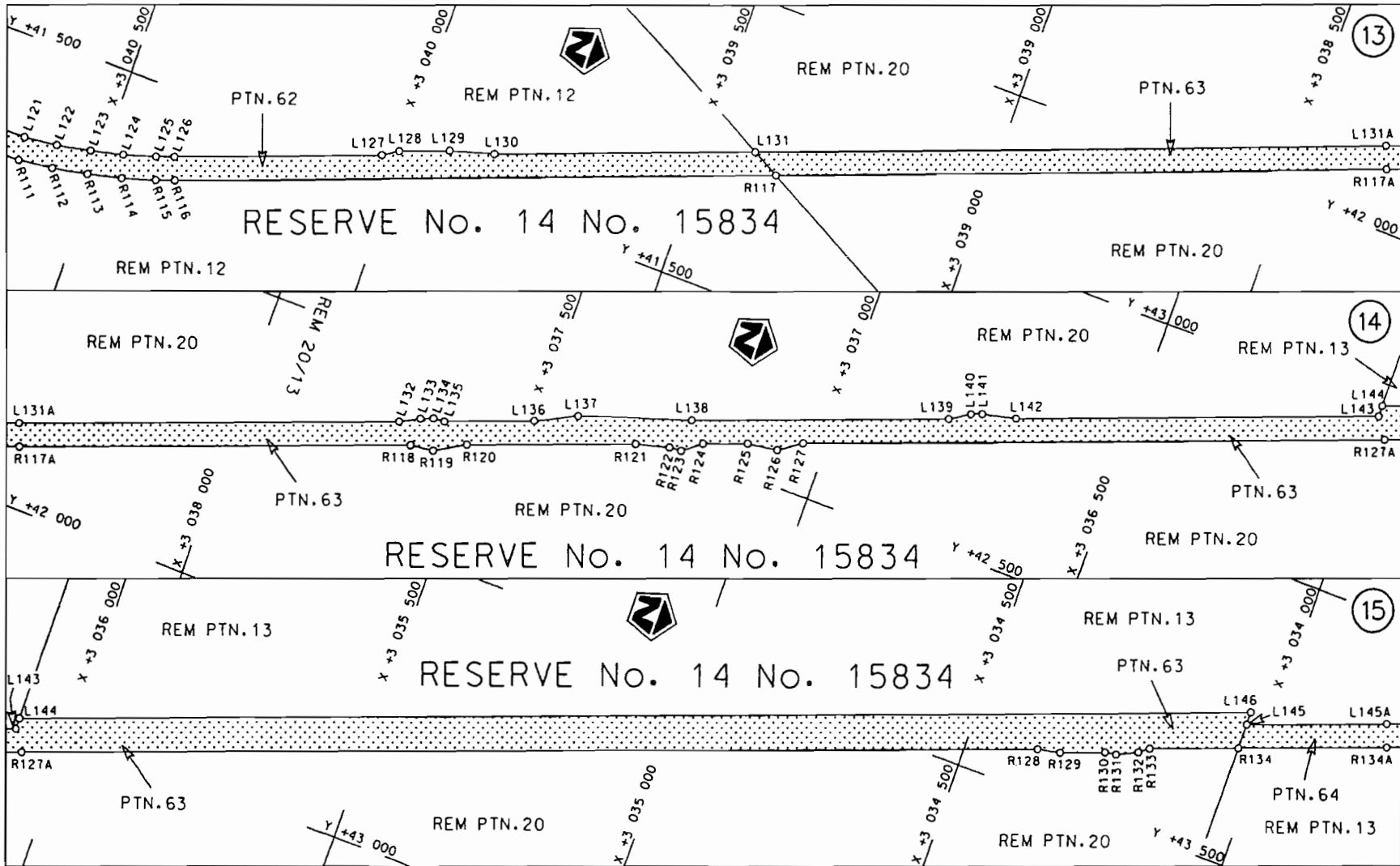

<p>Die Suid Afrikaanse Nasionale Padagentskap Beperk The South African National Roads Agency Limited</p>	<p>Die figuur getoon The figure shown</p> 	<p>steldie podreserve voor van 'n gedeelte represents the road reserve of a portion van Nasionale Roete R22 Seksie 3 of National Route R22 Section 3</p>	<p>Vel Sheet 5 van 10 of 10 Plan P721/08</p>
--	--	--	--

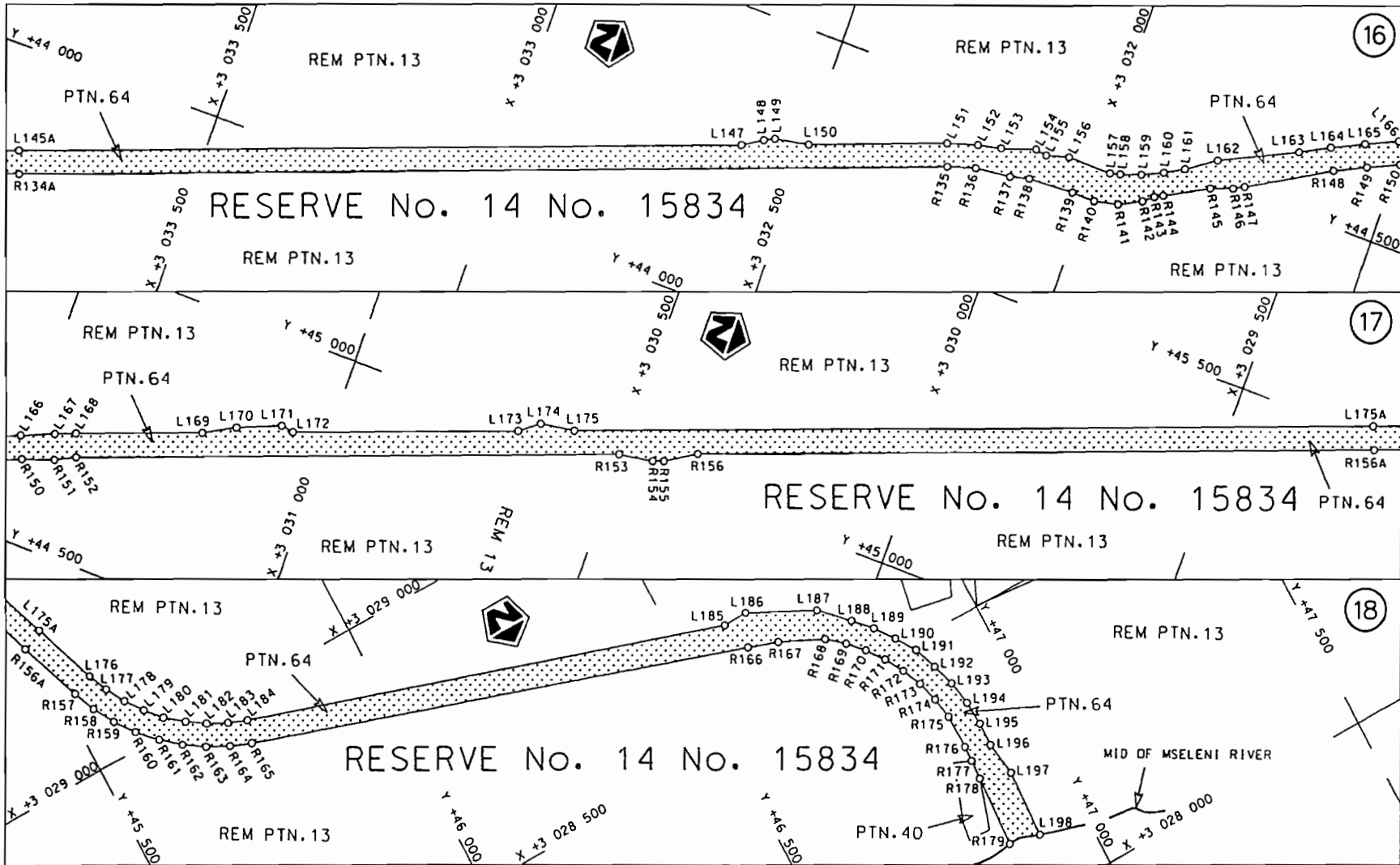

<p>Die Suid Afrikaanse Nasionale Podagentskop Beperk</p>	<p>Die figuur getoon</p>		<p>steldie podreserwe voor van 'n gedeelte represents the road reserve of a portion van Nasionale Roete R22 Seksie 3</p>	<p>Vel Sheet 6 van of 10</p>
<p>The South African National Roads Agency Limited</p>	<p>The figure shown</p>		<p>of National Route R22 Seksie 3</p>	<p>Plan P721/08</p>

PADRESERWE KOÖRDINATE / ROAD RESERVE CO-ORDINATES						
LINKERKANT/LEFT HAND SIDE			REGTERKANT/RIGHT HAND SIDE			
	Y	X	WG 33°		Y	X
L1	57 274.980	3 061 231.700		R1	57 236.690	3 061 243.520
L2	57 264.180	3 061 205.270		R2	57 222.920	3 061 201.720
L3	57 229.820	3 061 106.360		R3	57 192.180	3 061 119.920
L4	57 226.800	3 061 086.190		R4	57 181.640	3 061 102.460
L5	57 213.240	3 061 048.560		R5	57 168.090	3 061 064.820
L6	57 195.930	3 061 012.280		R6	57 151.510	3 061 007.020
L7	57 176.060	3 060 957.140		R7	57 138.430	3 060 970.700
L8	57 156.700	3 060 899.750		R8	57 118.550	3 060 911.750
L9	57 140.070	3 060 842.940		R9	57 101.470	3 060 853.410
L10	57 125.710	3 060 785.500		R10	57 086.730	3 060 794.420
L11	57 113.680	3 060 727.550		R11	57 074.360	3 060 734.900
L12	57 103.960	3 060 669.150		R12	57 064.380	3 060 674.930
L13	57 098.780	3 060 630.030		R13	57 056.810	3 060 614.600
L14	57 099.630	3 060 590.320		R14	57 051.660	3 060 554.030
L15	57 091.570	3 060 551.430		R15	57 048.930	3 060 493.290
L16	57 088.920	3 060 492.300		R16	57 048.460	3 060 452.750
L17	57 088.460	3 060 452.820		R17	57 049.350	3 060 403.600
L18	57 089.330	3 060 404.960		R18	57 052.410	3 060 314.080
L19	57 092.390	3 060 315.440		R19	57 055.510	3 060 251.630
L20	57 095.430	3 060 254.230		R20	57 060.360	3 060 191.220
L21	57 100.180	3 060 195.020		R21	57 064.570	3 060 151.370
L22	57 104.300	3 060 155.960		R22	57 088.380	3 059 945.030
L23	57 128.120	3 059 949.620		R23	57 091.650	3 059 913.110
L24	57 131.490	3 059 916.660		R24	57 095.480	3 059 854.200
L25	57 135.440	3 059 855.830		R25	57 096.470	3 059 795.170
L26	57 136.470	3 059 794.890		R26	57 094.640	3 059 736.170
L27	57 134.580	3 059 733.960		R27	57 092.740	3 059 707.750
L28	57 132.620	3 059 704.620		R28	57 040.510	3 059 042.020
L29	57 080.390	3 059 038.890		R29	57 036.420	3 058 999.660
L30	57 076.160	3 058 995.090		R30	57 028.230	3 058 941.240
L31	57 067.690	3 058 934.690		R31	57 017.120	3 058 883.300
L32	57 056.210	3 058 874.790		R32	57 003.140	3 058 825.980
L33	57 041.750	3 058 815.530		R33	56 986.310	3 058 769.440
L34	57 024.350	3 058 757.080		R34	56 973.510	3 058 732.250
L35	57 011.120	3 058 718.620		R35	56 959.510	3 058 695.490
L36	56 996.640	3 058 680.610		R36	55 975.750	3 056 239.860
L37	56 334.680	3 057 028.270		R37	55 962.320	3 056 209.430
L38	56 332.820	3 057 007.480		R38	55 934.200	3 056 159.200
L39	56 303.070	3 056 933.310		R39	55 912.200	3 056 127.740
L40	56 282.620	3 056 898.310		R40	55 896.260	3 056 107.910
L41	56 012.880	3 056 224.990		R41	53 808.370	3 053 645.890
L42	55 998.330	3 056 192.020		R42	53 778.910	3 053 611.940
L43	55 967.870	3 056 137.600		R43	53 738.810	3 053 568.120
L44	55 944.030	3 056 103.520		R44	53 675.480	3 053 503.950
L45	55 926.770	3 056 082.040		R45	53 108.670	3 052 955.210
L46	53 838.870	3 053 620.020		R46	53 075.760	3 052 931.700
L47	53 808.820	3 053 585.390		R47	53 047.020	3 052 903.870
L48	53 767.910	3 053 540.680		R48	53 022.460	3 052 871.740
L49	53 725.680	3 053 497.220		R49	52 591.370	3 052 454.410
L50	53 703.300	3 053 475.210		R50	52 558.460	3 052 430.900
L51	53 136.500	3 052 926.470		R51	52 529.720	3 052 403.070

Vel	7	Van	10	P721/08
Sheet		of		

PADRESERWE KOÖRDINATE / ROAD RESERVE CO-ORDINATES									
LINKERKANT/LEFT HAND SIDE					REGTERKANT/RIGHT HAND SIDE				
	Y	X	WG 33°		Y	X			
L52	53	111.930	3 052	894.340	R52	52	476.420	3 052	343.120
L53	53	097.560	3 052	880.430	R53	51	669.080	3 051	561.520
L54	53	050.280	3 052	843.000	R54	51	558.570	3 051	454.530
L55	51	739.870	3 051	574.370	R55	51	528.040	3 051	425.680
L56	51	586.390	3 051	425.790	R56	51	483.760	3 051	386.220
L57	51	555.160	3 051	396.270	R57	51	438.150	3 051	348.310
L58	51	509.850	3 051	355.910	R58	51	391.260	3 051	311.980
L59	51	463.190	3 051	317.120	R59	51	343.160	3 051	277.280
L60	51	415.220	3 051	279.950	R60	51	293.900	3 051	244.250
L61	51	366.000	3 051	244.450	R61	51	266.180	3 051	226.730
L62	51	315.600	3 051	210.650	R62	51	237.870	3 051	209.190
L63	51	287.240	3 051	192.710	R63	51	208.870	3 051	189.860
L64	51	258.930	3 051	175.180	R64	51	176.060	3 051	164.310
L65	51	232.160	3 051	157.340	R65	51	145.390	3 051	136.220
L66	51	201.870	3 051	133.750	R66	51	117.060	3 051	105.760
L67	51	173.560	3 051	107.820	R67	51	091.250	3 051	073.140
L68	51	147.410	3 051	079.710	R68	51	069.010	3 051	039.990
L69	51	123.590	3 051	049.600	R69	51	000.540	3 050	928.920
L70	51	103.060	3 051	019.000	R70	50	984.120	3 050	903.470
L71	51	034.590	3 050	907.930	R71	50	961.480	3 050	871.800
L72	51	017.270	3 050	881.080	R72	50	937.190	3 050	841.380
L73	50	993.390	3 050	847.680	R73	50	911.310	3 050	812.300
L74	50	967.770	3 050	815.590	R74	50	886.150	3 050	786.790
L75	50	940.470	3 050	784.920	R75	47	833.380	3 047	839.710
L76	50	913.930	3 050	758.010	R76	47	739.400	3 047	764.280
L77	47	861.160	3 047	810.930	R77	47	725.430	3 047	749.950
L78	47	822.160	3 047	764.940	R78	47	660.710	3 047	673.020
L79	47	636.290	3 047	583.130	R79	47	613.380	3 047	635.660
L80	47	606.330	3 047	556.580	R80	47	598.990	3 047	621.770
L81	47	573.380	3 047	533.110	R81	47	574.380	3 047	589.670
L82	45	688.410	3 045	713.420	R82	45	041.910	3 045	144.880
L83	45	606.250	3 045	625.750	R83	45	008.960	3 045	121.410
L84	45	505.520	3 045	528.520	R84	44	951.410	3 045	065.850
L85	45	472.580	3 045	505.050	R85	44	912.410	3 045	019.860
L86	45	429.410	3 045	463.380	R86	44	379.340	3 044	505.250
L87	45	404.800	3 045	431.280	R87	41	658.230	3 041	883.640
L88	45	376.020	3 045	403.500	R88	41	627.460	3 041	850.180
L89	45	328.690	3 045	366.140	R89	41	605.860	3 041	817.690
L90	45	040.910	3 045	088.320	R90	41	582.530	3 041	783.260
L91	45	030.690	3 045	070.110	R91	41	562.030	3 041	747.080
L92	44	944.360	3 044	986.770	R92	41	544.480	3 041	709.370
L93	44	925.800	3 044	977.190	R93	41	526.340	3 041	658.690
L94	44	322.400	3 044	394.690	R94	41	513.280	3 041	634.240
L95	41	690.940	3 041	854.330	R95	41	507.100	3 041	613.650
L96	41	662.060	3 041	823.900	R96	41	503.700	3 041	581.960
L97	41	638.050	3 041	793.940	R97	41	453.670	3 041	416.970
L98	41	616.520	3 041	762.160	R98	41	422.890	3 041	382.630
L99	41	597.590	3 041	728.760	R99	41	417.140	3 041	363.480
L100	41	581.390	3 041	693.960	R100	41	424.780	3 041	319.200
L101	41	564.640	3 041	647.180	R101	41	393.890	3 041	220.220
L102	41	558.910	3 041	607.130	R102	41	363.120	3 041	074.820

Vel	8	Van	10	P721/08
Sheet		of		

PADRESERWE KOÖRDINATE / ROAD RESERVE CO-ORDINATES							
LINKERKANT/LEFT HAND SIDE				REGTERKANT/RIGHT HAND SIDE			
	Y	X	WG 33°		Y	X	
L103	41 542.420	3 041 570.610		R103	41 336.040	3 041 080.970	
L104	41 491.870	3 041 403.670		R104	41 331.810	3 041 062.220	
L105	41 499.510	3 041 359.610		R105	41 341.680	3 041 041.530	
L106	41 493.750	3 041 340.450		R106	41 315.210	3 040 950.240	
L107	41 463.080	3 041 307.900		R107	41 303.630	3 040 888.650	
L108	41 456.790	3 041 273.020		R108	41 268.300	3 040 849.490	
L109	41 441.480	3 041 236.040		R109	41 273.130	3 040 822.800	
L110	41 404.770	3 041 099.250		R110	41 292.500	3 040 797.820	
L111	41 420.120	3 041 060.770		R111	41 292.420	3 040 635.860	
L112	41 411.480	3 041 032.040		R112	41 299.250	3 040 575.050	
L113	41 377.560	3 041 010.500		R113	41 309.710	3 040 514.760	
L114	41 356.930	3 040 942.320		R114	41 323.770	3 040 455.200	
L115	41 348.810	3 040 902.320		R115	41 341.370	3 040 396.600	
L116	41 372.340	3 040 875.840		R116	41 352.720	3 040 364.360	
L117	41 393.550	3 040 880.390		R117	41 723.940	3 039 363.930	
L118	41 395.900	3 040 853.600		R118	42 342.970	3 037 695.680	
L119	41 366.570	3 040 847.480		R119	42 347.790	3 037 654.800	
L120	41 332.460	3 040 810.430		R120	42 377.760	3 037 601.920	
L121	41 332.290	3 040 639.130		R121	42 482.120	3 037 320.660	
L122	41 338.850	3 040 580.700		R122	42 497.370	3 037 262.320	
L123	41 348.900	3 040 522.780		R123	42 499.410	3 037 240.800	
L124	41 362.410	3 040 465.560		R124	42 523.870	3 037 208.160	
L125	41 379.320	3 040 409.250		R125	42 551.700	3 037 133.150	
L126	41 390.230	3 040 378.270		R126	42 559.770	3 037 079.090	
L127	41 517.720	3 040 034.680		R127	42 586.490	3 037 039.400	
L128	41 534.390	3 040 007.970		R128	43 574.470	3 034 376.800	
L129	41 565.090	3 039 924.260		R129	43 582.760	3 034 337.210	
L130	41 587.300	3 039 847.170		R130	43 610.590	3 034 262.210	
L131	41 748.760	3 039 412.030		R131	43 613.800	3 034 242.060	
L132	42 373.510	3 037 728.340		R132	43 631.470	3 034 205.950	
L133	42 391.360	3 037 694.750		R133	43 644.050	3 034 189.290	
L134	42 399.490	3 037 673.140		R134	43 698.560	3 034 042.380	
L135	42 401.340	3 037 653.340		R135	44 363.250	3 032 251.080	
L136	42 457.000	3 037 503.330		R136	44 378.300	3 032 202.860	
L137	42 491.790	3 037 433.370		R137	44 385.380	3 032 140.420	
L138	42 554.410	3 037 240.820		R138	44 393.880	3 032 106.850	
L139	42 714.440	3 036 809.560		R139	44 397.320	3 032 026.700	
L140	42 735.670	3 036 774.770		R140	44 396.640	3 031 984.860	
L141	42 742.810	3 036 756.090		R141	44 406.220	3 031 942.290	
L142	42 756.180	3 036 697.050		R142	44 426.130	3 031 903.380	
L143	42 980.240	3 036 093.220		R143	44 440.320	3 031 886.390	
L144	42 998.570	3 036 093.290		R144	44 447.630	3 031 872.050	
L145	43 762.950	3 034 042.320		R145	44 487.770	3 031 797.380	
L146	43 741.240	3 034 042.340		R146	44 501.430	3 031 759.310	
L147	44 272.950	3 032 609.400		R147	44 510.900	3 031 741.700	
L148	44 294.370	3 032 574.680		R148	44 591.000	3 031 603.750	
L149	44 303.200	3 032 556.630		R149	44 616.840	3 031 550.270	
L150	44 314.700	3 032 496.900		R150	44 641.070	3 031 496.040	
L151	44 400.750	3 032 265.000		R151	44 659.600	3 031 441.280	
L152	44 417.060	3 032 212.750		R152	44 676.800	3 031 406.800	
L153	44 425.730	3 032 172.080		R153	45 012.950	3 030 504.490	

PADRESERWE KOÖRDINATE / ROAD RESERVE CO-ORDINATES					
LINKERKANT/LEFT HAND SIDE			REGTERKANT/RIGHT HAND SIDE		
	Y	X	WG 33°	Y	X
L154	44 445.520	3 032	112.960	R154	45 022.650 3 030 444.070
L155	44 441.910	3 032	092.400	R155	45 029.630 3 030 425.330
L156	44 452.570	3 032	053.380	R156	45 061.830 3 030 373.300
L157	44 451.560	3 031	974.850	R157	45 522.700 3 029 136.160
L158	44 456.220	3 031	956.580	R158	45 539.600 3 029 097.650
L159	44 468.630	3 031	920.990	R159	45 560.870 3 029 061.130
L160	44 485.520	3 031	884.940	R160	45 586.170 3 029 027.280
L161	44 504.060	3 031	851.560	R161	45 615.180 3 028 996.530
L162	44 537.760	3 031	801.550	R162	45 647.470 3 028 969.290
L163	44 600.510	3 031	672.170	R163	45 682.680 3 028 945.910
L164	44 626.750	3 031	621.690	R164	45 720.320 3 028 926.700
L165	44 653.110	3 031	567.130	R165	45 756.160 3 028 913.090
L166	44 677.830	3 031	511.800	R166	46 608.510 3 028 634.000
L167	44 700.880	3 031	455.760	R167	46 660.430 3 028 615.840
L168	44 714.290	3 031	420.770	R168	46 736.460 3 028 579.850
L169	44 792.100	3 031	211.890	R169	46 765.440 3 028 555.540
L170	44 820.920	3 031	158.600	R170	46 791.480 3 028 528.280
L171	44 851.190	3 031	084.510	R171	46 814.240 3 028 498.230
L172	44 847.960	3 031	061.960	R172	46 833.420 3 028 465.790
L173	44 987.600	3 030	687.130	R173	46 848.780 3 028 431.370
L174	45 012.810	3 030	653.830	R174	46 860.110 3 028 395.420
L175	45 022.510	3 030	593.420	R175	46 867.270 3 028 358.410
L176	45 560.170	3 029	150.120	R176	46 867.900 3 028 299.110
L177	45 575.250	3 029	115.780	R177	46 866.480 3 028 272.160
L178	45 594.230	3 029	083.210	R178	46 864.700 3 028 238.180
L179	45 616.790	3 029	053.010	R179	46 858.150 3 028 113.370
L180	45 639.690	3 029	025.860		
L181	45 671.470	3 029	001.290		
L182	45 702.870	3 028	980.440		
L183	45 736.390	3 028	963.290		
L184	45 768.400	3 028	951.170		
L185	46 590.660	3 028	686.770		
L186	46 633.080	3 028	688.020		
L187	46 747.220	3 028	630.490		
L188	46 792.740	3 028	584.780		
L189	46 821.930	3 028	554.220		
L190	46 847.450	3 028	520.530		
L191	46 870.460	3 028	486.290		
L192	46 886.180	3 028	445.550		
L193	46 898.890	3 028	405.240		
L194	46 906.910	3 028	363.750		
L195	46 910.150	3 028	321.610		
L196	46 909.160	3 028	280.430		
L197	46 918.080	3 028	220.030		
L198	46 912.720	3 028	101.830		