

# Government Gazette

REPUBLIC OF SOUTH AFRICA  
REPUBLIEK VAN SUID-AFRIKA

Vol. 524

Pretoria, 26 February 2009  
Februarie

No. 31922

**CONTENTS****INHOUD**

<i>No.</i>	<i>Page No.</i>	<i>Gazette No.</i>	<i>No.</i>	<i>Bladsy No.</i>	<i>Koerant No.</i>
<b>GOVERNMENT NOTICE</b>			<b>GOEWERMENSKENNISGEWING</b>		
<b>Transport, Department of</b>			<b>Vervoer, Departement van</b>		
<i>Government Notice</i>			<i>Goewermenskennisgewing</i>		
177			177		
South African National Roads Agency Limited and the National Roads Act (7/1998): The South African National Roads Agency Limited: Declaration amendment of National Road N1 Section 16X: Amendment of Declaration No. 3 of 1984 .....	3	31922	Suid-Afrikaanse Nasionale Padagentskap Beperk en die Nasionale Paaie Wet (7/1998): Die Suid-Afrikaanse Nasionale Padagentskap Beperk: Verklaring wysiging van Nasionale Pad N1 Seksie 16X: Wysiging van Verklaring No. 3 van 1984 .....	4	31922

---

**GOVERNMENT NOTICE**

---

**DEPARTMENT OF TRANSPORT**

No. 177

26 February 2009

**THE SOUTH AFRICAN NATIONAL ROADS  
AGENCY LIMITED**Registration No: 98/09584/06

---

**DECLARATION AMENDMENT OF NATIONAL ROAD N1 SECTION 16X****AMENDMENT OF DECLARATION NO. 3 OF 1984**

By virtue of section 40(1)(b) of the South African National Roads Agency Limited and the National Roads Act, 1998 (Act No. 7 of 1998), I hereby amend Declaration No. 3 of 1984 by substituting the descriptive wording from the words "A route as surveyed and depicted" up to and including the words "Keerom 2297; Stille Woning 1462", with the subjoined sheets 1 to 8 of Plan No.P732/08.

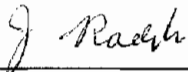
**(National Road N1 Section 16X: Winburg – Waterval)**

---

**MINISTER OF TRANSPORT**

## GOEWERMENSKENNISGEWING

---

### DEPARTEMENT VAN VERVOER

No. 177

26 Februarie 2009

## DIE SUID-AFRIKAANSE NASIONALE PADAGENTSKAP BEPERK

Registrasie No: 98/09584/06

---

### VERKLARING WYSIGING VAN NASIONALE PAD N1 SEKSIE 16X.

#### WYSIGING VAN VERKLARING NO. 3 VAN 1984

Kragtens Artikel 40(1)(b) van die Suid Afrikaanse Nasionale Padagentskap Beperk en die Nasionale Paaie Wet, 1998 (Wet No.7 van 1998), wysig ek hiermee Verklarings no. 3 van 1984 deur die beskrywende bewoording vanaf die woorde " 'n Roete, soos opgemeet en getoon op" tot by en insluitende die woorde "Keerom 2297; Stille Woning 1462", te vervang met meegaande velle 1 tot 8 van Plan no. P732/08.

(Nasionale Pad N1 Seksie 16X: Winburg – Waterval)



MINISTER VAN VERVOER

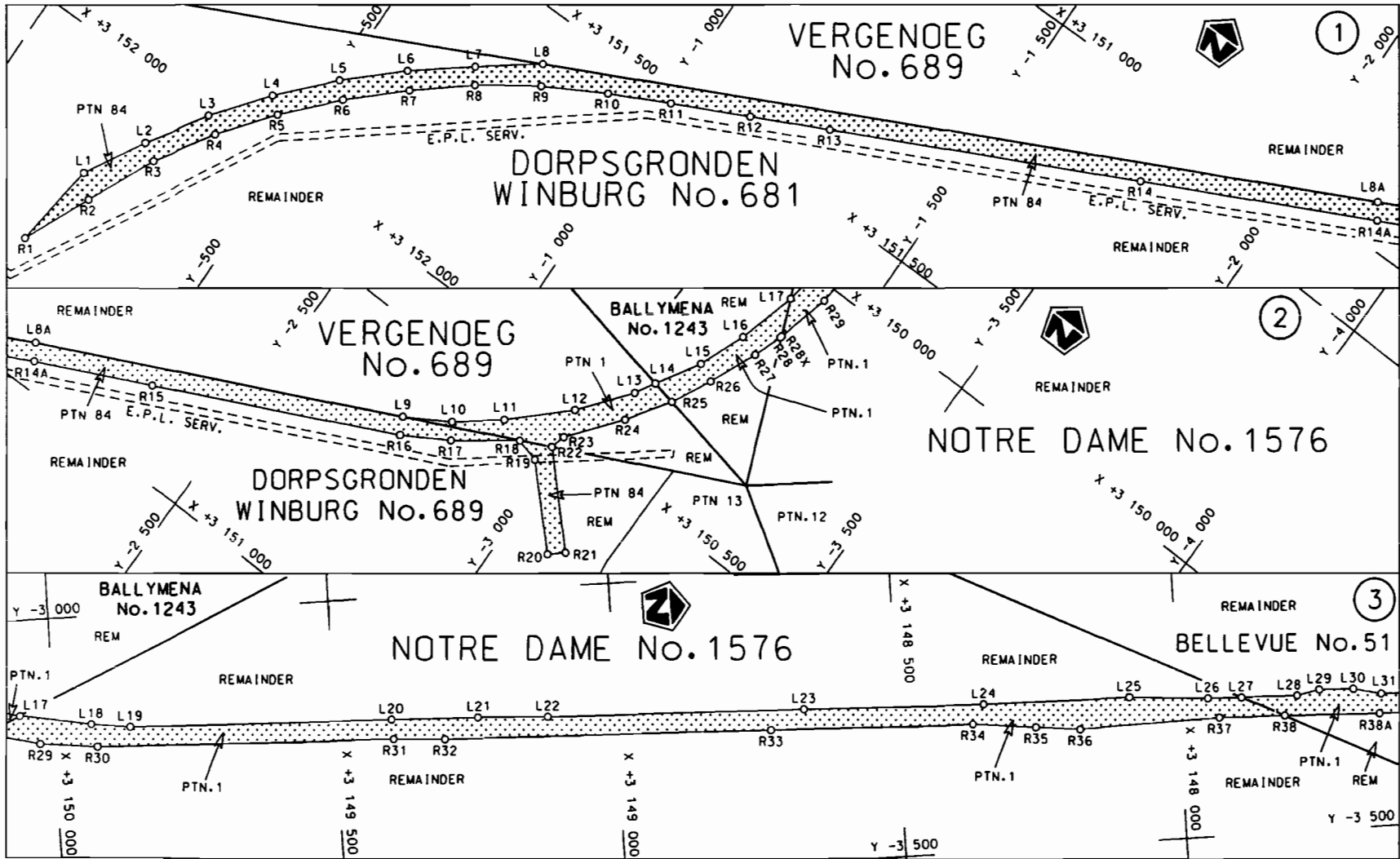

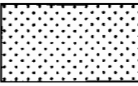
Suid-Afrikaanse Padogentskap Bpk. South African National Roads Agency Ltd.	Die figuur getoon The figure shown	 steldie padreserwe voor van 'n gedeelte represents the road reserve of a portion van Nasionale Roete of National Route	N1 Seksie Section 16X	Vel Sheet 1 van 8 of Plan P732/08
---	---------------------------------------	---	--------------------------------	--

D.O.9.A

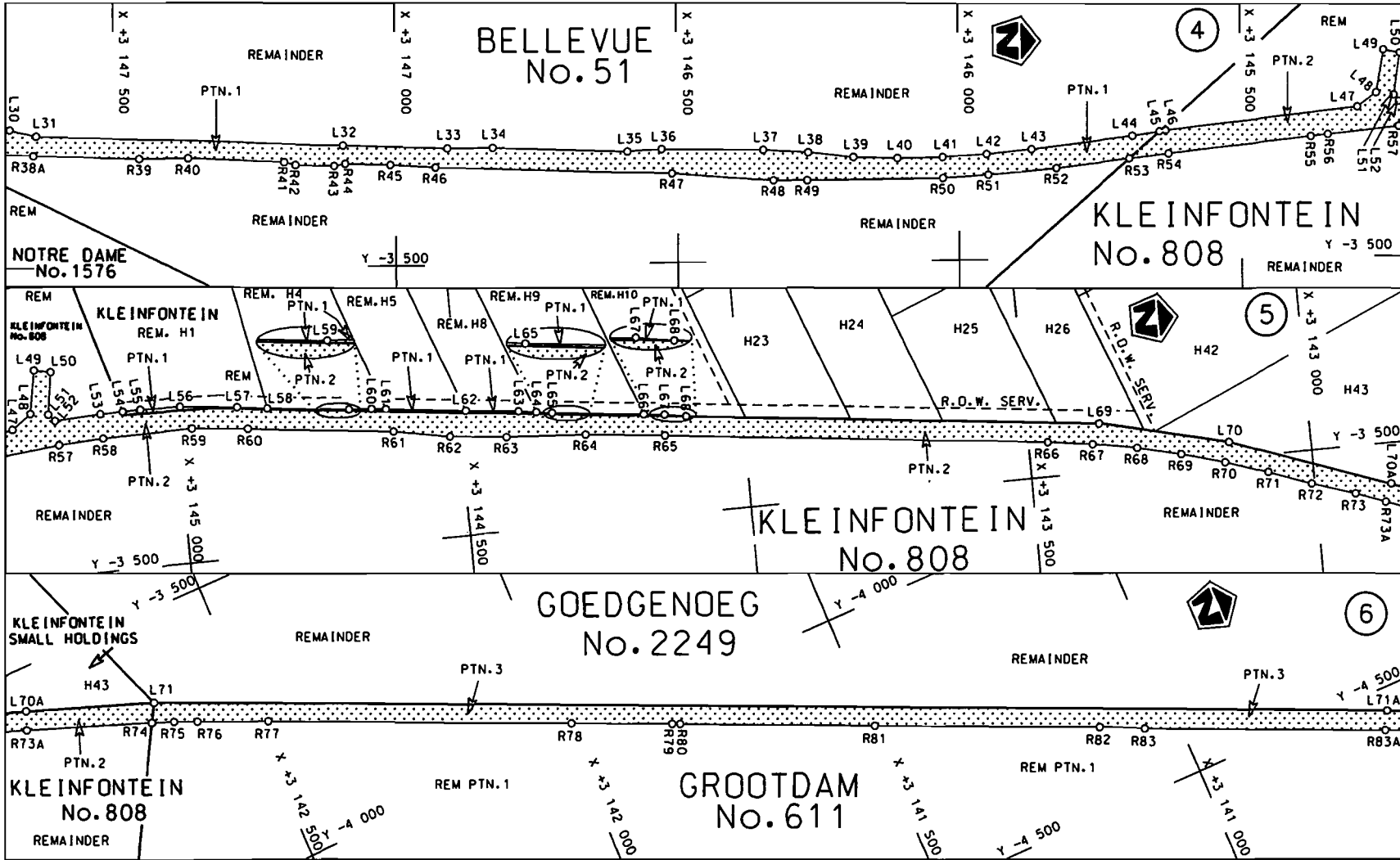

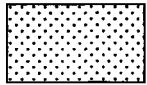
<p>Suid-Afrikaanse Podagentskap Bpk. South African National Roads Agency Ltd.</p>	<p>Die figuur getoon The figure shown</p>		<p>steldie padreserwe voor van 'n gedeelte represents the road reserve of a portion van Nasionale Roete of National Route</p> <p>N1      Seksie      16X                  Section</p>	<p>Vel Sheet 2 van 8 of of 8 Plan P732/08</p>
---	---	--	---	---

D.O.9.A

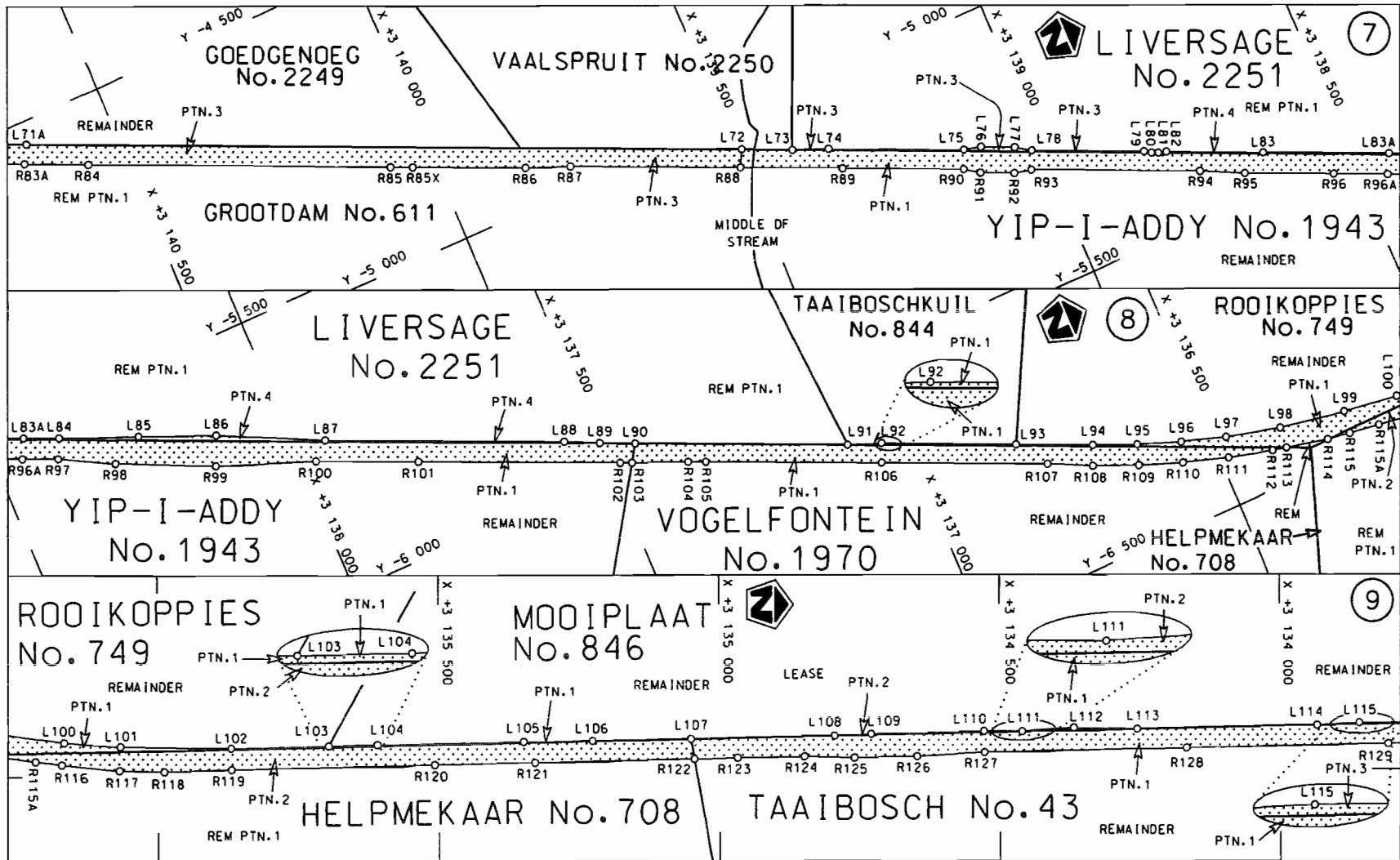

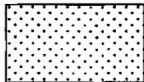
Suid-Afrikaanse Padogentskop Bpk. South African National Roads Agency Ltd.	Die figuur getoon The figure shown		steld die padreserwe voor van 'n gedeelte represents the road reserve of a portion van Nasionale Roete of National Route	N1 Seksie Section	16X	Vel Sheet 3 van 8 of of Plan P732/08
---	---------------------------------------	--	---	-------------------------	-----	--

D.O.9.A

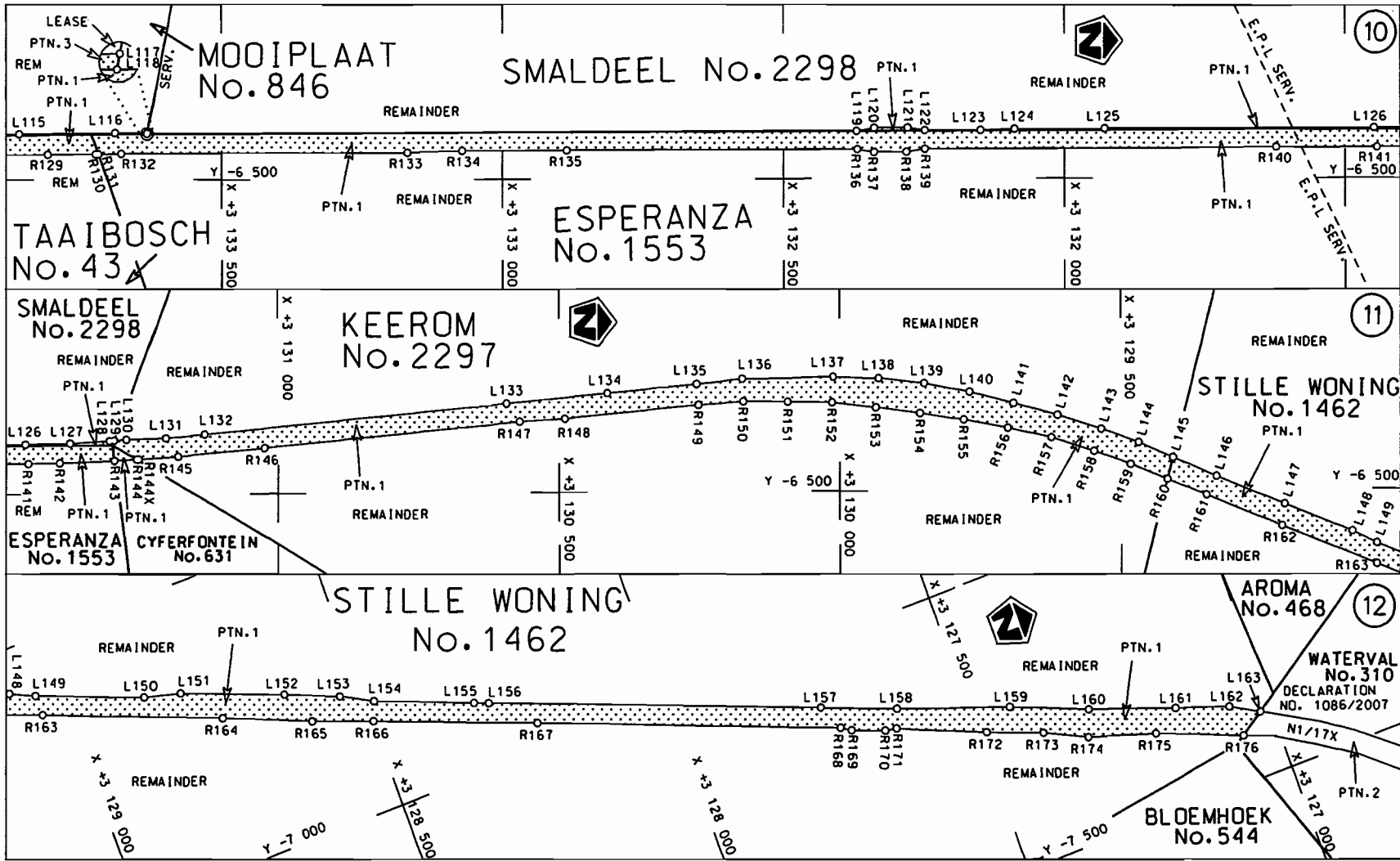

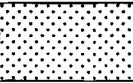
<p>Suid-Afrikaanse Padagentskop Bpk. South African National Roads Agency Ltd.</p>	<p>Die figuur getoon The figure shown</p>		<p>stel die padreserwe voor van 'n gedeelte represents the road reserve of a portion van Nasionale Roete of National Route</p> <p>N1      Seksie      16X          Section</p>	<p>Vel Sheet 4 van of 8 Plan P732/08</p>
---	---	--	--	--

D.O.9.A



PADRESERWE KOÖRDINATE				/	ROAD RESERVE CO-ORDINATES			
LINKERKANT/LEFT HAND SIDE					REGTERKANT/RIGHT HAND SIDE			
	Y	X	WG	27°	Y	X		
L1	-220.120	3 152	211.850	R1	-200.320	3 152	364.140	
L2	-279.260	3 152	106.240	R2	-253.800	3 152	244.840	
L3	-345.570	3 152	004.510	R3	-309.190	3 152	123.480	
L4	-419.660	3 151	909.060	R4	-373.860	3 152	024.440	
L5	-501.510	3 151	819.110	R5	-446.130	3 151	931.140	
L6	-589.910	3 151	736.330	R6	-526.070	3 151	843.580	
L7	-685.140	3 151	660.750	R7	-612.480	3 151	762.600	
L8	-782.420	3 151	587.450	R8	-703.370	3 151	687.070	
L9	-2 734.022	3 150	636.525	R9	-802.320	3 151	620.650	
L10	-2 809.570	3 150	590.230	R10	-905.980	3 151	562.710	
L11	-2 882.680	3 150	531.480	R11	-1 007.620	3 151	512.870	
L12	-2 973.340	3 150	442.000	R12	-1 135.580	3 151	450.570	
L13	-3 040.290	3 150	354.920	R13	-1 265.250	3 151	387.730	
L14	-3 060.440	3 150	320.190	R14	-1 768.970	3 151	142.290	
L15	-3 104.050	3 150	245.040	R15	-2 344.120	3 150	862.300	
L16	-3 135.980	3 150	162.930	R16	-2 749.110	3 150	664.420	
L17	-3 163.820	3 150	059.500	R17	-2 827.350	3 150	616.850	
L18	-3 185.610	3 149	934.730	R18	-2 926.740	3 150	543.320	
L19	-3 194.220	3 149	866.200	R19	-2 967.670	3 150	553.410	
L20	-3 209.420	3 149	401.090	R20	-3 083.750	3 150	669.590	
L21	-3 214.970	3 149	246.420	R21	-3 107.500	3 150	648.380	
L22	-3 222.040	3 149	121.120	R22	-2 979.120	3 150	517.100	
L23	-3 237.760	3 148	667.070	R23	-2 985.590	3 150	491.020	
L24	-3 248.900	3 148	347.040	R24	-3 054.210	3 150	401.670	
L25	-3 252.660	3 148	087.040	R25	-3 102.560	3 150	328.060	
L26	-3 263.050	3 147	947.390	R26	-3 136.040	3 150	258.600	
L27	-3 265.040	3 147	887.220	R27	-3 171.600	3 150	174.250	
L28	-3 268.350	3 147	787.440	R28	-3 189.130	3 150	123.870	
L28X	-3 189.960	3 150	120.690	R29	-3 214.720	3 150	026.260	
L29	-3 260.450	3 147	747.020	R30	-3 225.000	3 149	925.810	
L30	-3 262.740	3 147	687.210	R31	-3 243.070	3 149	399.000	
L31	-3 273.690	3 147	637.550	R32	-3 248.830	3 149	307.730	
L32	-3 292.970	3 147	093.270	R33	-3 269.160	3 148	728.030	
L33	-3 299.470	3 146	907.920	R34	-3 281.820	3 148	368.160	
L34	-3 299.740	3 146	827.870	R35	-3 293.660	3 148	255.780	
L35	-3 308.030	3 146	588.040	R36	-3 301.760	3 148	177.630	
L36	-3 305.090	3 146	527.840	R37	-3 297.290	3 147	928.350	
L37	-3 307.470	3 146	348.020	R38	-3 301.330	3 147	811.900	
L38	-3 313.240	3 146	267.870	R39	-3 313.690	3 147	455.810	
L39	-3 322.030	3 146	188.350	R40	-3 314.010	3 147	368.920	
L40	-3 324.170	3 146	109.020	R41	-3 320.340	3 147	199.050	
L41	-3 322.890	3 146	029.040	R42	-3 325.290	3 147	179.060	
L42	-3 318.350	3 145	950.790	R43	-3 327.720	3 147	109.130	
L43	-3 310.230	3 145	871.530	R44	-3 324.450	3 147	089.130	
L44	-3 289.600	3 145	692.870	R45	-3 326.970	3 147	009.090	
L45	-3 282.360	3 145	644.840	R46	-3 332.050	3 146	929.190	
L46	-3 280.680	3 145	633.700	R47	-3 346.830	3 146	509.520	
L47	-3 242.490	3 145	291.060	R48	-3 360.030	3 146	329.640	
L48	-3 218.280	3 145	257.360	R49	-3 361.060	3 146	269.710	
L49	-3 144.560	3 145	244.240	R50	-3 359.010	3 146	028.390	
L50	-3 150.080	3 145	215.430	R51	-3 354.100	3 145	947.810	
				Vel	5	Van	8	P732/08
				Sheet		of		

PADRESERWE KOÖRDINATE				/	ROAD RESERVE CO-ORDINATES						
LINKERKANT/LEFT HAND SIDE					REGTERKANT/RIGHT HAND SIDE						
	Y	X	WG	27°		Y	X				
L51	-3	222.370	3	145	226.310	R52	-3	343.250	3	145	827.610
L52	-3	233.950	3	145	215.190	R53	-3	328.470	3	145	698.700
L53	-3	230.080	3	145	134.480	R54	-3	320.460	3	145	628.900
L54	-3	229.590	3	145	094.630	R55	-3	292.920	3	145	374.620
L55	-3	229.220	3	145	063.710	R56	-3	289.590	3	145	344.450
L56	-3	231.570	3	144	992.900	R57	-3	275.980	3	145	212.190
L57	-3	241.680	3	144	892.250	R58	-3	271.950	3	145	133.400
L58	-3	247.700	3	144	839.250	R59	-3	270.660	3	144	975.200
L59	-3	264.230	3	144	693.610	R60	-3	279.740	3	144	876.550
L60	-3	266.900	3	144	653.510	R61	-3	309.260	3	144	618.280
L61	-3	269.780	3	144	628.320	R62	-3	327.470	3	144	519.540
L62	-3	285.850	3	144	487.600	R63	-3	338.730	3	144	420.240
L63	-3	296.410	3	144	395.180	R64	-3	347.760	3	144	280.330
L64	-3	301.030	3	144	363.640	R65	-3	363.490	3	144	139.830
L65	-3	305.100	3	144	335.860	R66	-3	440.540	3	143	465.600
L66	-3	323.620	3	144	173.630	R67	-3	451.460	3	143	387.170
L67	-3	327.770	3	144	137.250	R68	-3	465.890	3	143	309.460
L68	-3	334.160	3	144	099.300	R69	-3	484.060	3	143	232.400
L69	-3	417.110	3	143	372.520	R70	-3	505.640	3	143	156.220
L70	-3	471.480	3	143	146.170	R71	-3	530.540	3	143	081.000
L71	-3	646.890	3	142	652.450	R72	-3	557.510	3	143	005.490
L72	-5	057.192	3	139	490.225	R73	-3	581.740	3	142	929.440
L73	-5	094.380	3	139	406.870	R74	-3	677.120	3	142	669.380
L74	-5	118.860	3	139	347.070	R75	-3	691.990	3	142	632.440
L75	-5	216.320	3	139	127.840	R76	-3	708.030	3	142	594.190
L76	-5	223.730	3	139	097.920	R77	-3	758.390	3	142	479.540
L77	-5	248.310	3	139	043.310	R78	-3	978.050	3	141	987.800
L78	-5	265.770	3	139	017.970	R79	-4	051.000	3	141	823.960
L79	-5	347.240	3	138	835.400	R80	-4	056.960	3	141	810.830
L80	-5	354.570	3	138	823.730	R81	-4	197.790	3	141	496.160
L81	-5	359.544	3	138	812.582	R82	-4	359.420	3	141	132.410
L82	-5	363.330	3	138	798.790	R83	-4	394.260	3	141	060.300
L83	-5	434.060	3	138	641.670	R84	-4	614.340	3	140	566.980
L84	-5	550.890	3	138	377.920	R85	-4	834.350	3	140	074.140
L85	-5	604.700	3	138	248.350	R85X	-4	849.910	3	140	038.480
L86	-5	658.420	3	138	120.080	R86	-4	931.830	3	139	854.660
L87	-5	744.340	3	137	943.970	R87	-4	962.000	3	139	780.520
L88	-5	917.190	3	137	556.790	R88	-5	085.010	3	139	504.660
L89	-5	945.030	3	137	500.360	R89	-5	159.500	3	139	337.550
L90	-5	970.900	3	137	442.380	R90	-5	247.040	3	139	141.470
L91	-6	125.260	3	137	096.430	R91	-5	264.360	3	139	116.160
L92	-6	147.280	3	137	039.960	R92	-5	288.840	3	139	061.240
L93	-6	244.700	3	136	822.470	R93	-5	295.960	3	139	031.640
L94	-6	300.040	3	136	698.210	R94	-5	418.130	3	138	757.840
L95	-6	331.230	3	136	625.280	R95	-5	453.100	3	138	685.700
L96	-6	358.440	3	136	551.220	R96	-5	518.310	3	138	539.610
L97	-6	382.710	3	136	475.870	R97	-5	583.340	3	138	393.500
L98	-6	407.870	3	136	379.840	R98	-5	630.600	3	138	304.760
L99	-6	428.560	3	136	263.180	R99	-5	706.690	3	138	141.810
L100	-6	441.680	3	136	165.230	R100	-5	770.920	3	137	973.400
L101	-6	448.990	3	136	066.510	R101	-5	844.080	3	137	809.010

Vel	6	Van	8	P732/08
Sheet		of		

PADRESERWE KOÖRDINATE				/	ROAD RESERVE CO-ORDINATES			
LINKERKANT/LEFT HAND SIDE					REGTERKANT/RIGHT HAND SIDE			
	Y	X	WG	27°		Y	X	
L102	-6 452.140	3 135	867.970		R102	-5 990.710	3 137	480.350
L103	-6 449.390	3 135	693.610		R103	-5 998.930	3 137	460.860
L104	-6 448.030	3 135	608.030		R104	-6 037.500	3 137	369.470
L105	-6 444.710	3 135	348.030		R105	-6 049.930	3 137	340.810
L106	-6 444.380	3 135	225.850		R106	-6 177.920	3 137	053.560
L107	-6 441.710	3 135	050.870		R107	-6 297.980	3 136	784.750
L108	-6 437.770	3 134	793.320		R108	-6 332.880	3 136	712.830
L109	-6 434.770	3 134	728.230		R109	-6 365.210	3 136	636.960
L110	-6 431.700	3 134	528.130		R110	-6 392.570	3 136	562.720
L111	-6 432.190	3 134	460.250		R111	-6 417.110	3 136	485.880
L112	-6 426.760	3 134	368.520		R112	-6 438.250	3 136	407.900
L113	-6 429.540	3 134	255.600		R113	-6 443.710	3 136	382.720
L114	-6 424.620	3 133	933.960		R114	-6 459.610	3 136	309.300
L115	-6 421.270	3 133	858.170		R115	-6 466.560	3 136	269.250
L116	-6 419.400	3 133	688.580		R116	-6 479.770	3 136	169.200
L117	-6 420.070	3 133	631.720		R117	-6 489.840	3 136	068.120
L118	-6 421.240	3 133	631.950		R118	-6 491.850	3 135	988.040
L119	-6 417.960	3 132	369.250		R119	-6 488.820	3 135	867.100
L120	-6 412.740	3 132	337.810		R120	-6 483.130	3 135	507.310
L121	-6 412.610	3 132	278.070		R121	-6 480.390	3 135	327.480
L122	-6 417.030	3 132	247.860		R122	-6 475.900	3 135	044.670
L123	-6 416.900	3 132	148.020		R123	-6 474.670	3 134	967.500
L124	-6 414.750	3 132	088.420		R124	-6 473.050	3 134	847.350
L125	-6 414.450	3 131	928.030		R125	-6 475.450	3 134	758.580
L126	-6 413.160	3 131	448.070		R126	-6 473.800	3 134	647.420
L127	-6 411.990	3 131	368.450		R127	-6 467.990	3 134	527.400
L128	-6 407.430	3 131	299.000		R128	-6 462.400	3 134	167.610
L129	-6 407.020	3 131	290.680		R129	-6 456.920	3 133	807.560
L130	-6 405.930	3 131	269.150		R130	-6 455.590	3 133	723.010
L131	-6 403.360	3 131	199.710		R131	-6 455.570	3 133	717.890
L132	-6 397.360	3 131	130.170		R132	-6 455.450	3 133	677.850
L133	-6 346.600	3 130	592.660		R133	-6 453.510	3 133	167.780
L134	-6 329.500	3 130	413.390		R134	-6 450.950	3 133	071.250
L135	-6 314.470	3 130	254.010		R135	-6 450.420	3 132	886.200
L136	-6 306.320	3 130	173.580		R136	-6 449.460	3 132	368.030
L137	-6 303.300	3 130	011.480		R137	-6 454.320	3 132	338.040
L138	-6 306.200	3 129	930.270		R138	-6 454.230	3 132	280.300
L139	-6 314.680	3 129	849.540		R139	-6 449.000	3 132	247.910
L140	-6 330.260	3 129	768.040		R140	-6 447.200	3 131	622.620
L141	-6 349.600	3 129	690.850		R141	-6 446.560	3 131	443.080
L142	-6 370.780	3 129	612.620		R142	-6 445.910	3 131	387.020
L143	-6 394.710	3 129	535.280		R143	-6 441.910	3 131	290.420
L144	-6 418.590	3 129	468.620		R144	-6 440.270	3 131	250.810
L145	-6 444.470	3 129	408.010		R144X	-6 440.140	3 131	247.590
L146	-6 477.670	3 129	330.240		R145	-6 435.100	3 131	177.690
L147	-6 525.890	3 129	208.970		R146	-6 420.920	3 131	024.040
L148	-6 573.320	3 129	088.550		R147	-6 377.860	3 130	569.640
L149	-6 593.470	3 129	045.360		R148	-6 372.970	3 130	489.760
L150	-6 664.330	3 128	866.080		R149	-6 350.430	3 130	250.670
L151	-6 680.350	3 128	803.180		R150	-6 345.190	3 130	171.760
L152	-6 748.060	3 128	631.650		R151	-6 345.590	3 130	092.660

PADRESERWE KOÖRDINATE				/	ROAD RESERVE CO-ORDINATES			
LINKERKANT/LEFT HAND SIDE					REGTERKANT/RIGHT HAND SIDE			
	Y	X	WG 27°		Y	X		
L153	-6 786.150	3 128	538.390	R152	-6 347.440	3 130	013.510	
L154	-6 815.450	3 128	485.060	R153	-6 356.060	3 129	935.050	
L155	-6 880.750	3 128	320.640	R154	-6 366.290	3 129	856.570	
L156	-6 890.160	3 128	296.540	R155	-6 377.970	3 129	778.470	
L157	-7 107.780	3 127	747.250	R156	-6 392.340	3 129	700.890	
L158	-7 157.970	3 127	620.600	R157	-6 409.440	3 129	623.550	
L159	-7 225.900	3 127	432.480	R158	-6 432.800	3 129	547.910	
L160	-7 279.600	3 127	303.210	R159	-6 456.020	3 129	482.910	
L161	-7 332.150	3 127	158.420	R160	-6 482.000	3 129	417.750	
L162	-7 364.350	3 127	067.660	R161	-6 509.750	3 129	348.140	
L163	-7 392.100	3 127	018.860	R162	-6 563.510	3 129	213.690	
				R163	-6 629.220	3 129	045.260	
				R164	-6 746.860	3 128	748.600	
				R165	-6 808.650	3 128	600.550	
				R166	-6 847.260	3 128	497.710	
				R167	-6 953.280	3 128	227.780	
				R168	-7 152.640	3 127	726.340	
				R169	-7 163.660	3 127	708.980	
				R170	-7 185.860	3 127	653.280	
				R171	-7 189.450	3 127	633.100	
				R172	-7 252.490	3 127	485.530	
				R173	-7 289.160	3 127	392.680	
				R174	-7 324.080	3 127	320.810	
				R175	-7 360.970	3 127	206.270	
				R176	-7 419.550	3 127	061.690	

Vel	8	Van	8	P732/08
Sheet		of		