

# Government Gazette Republiek van Suid-Afrika

REPUBLIC OF SOUTH AFRICA  
REPUBLIEK VAN SUID-AFRIKA

Vol. 527

Pretoria, 15 May  
Mei 2009

No. 32177

**CONTENTS****INHOUD**

<i>No.</i>	<i>Page No.</i>	<i>Gazette No.</i>	<i>No.</i>	<i>Bladsy No.</i>	<i>Koerant No.</i>
<b>GOVERNMENT NOTICE</b>			<b>GOEWERMENTSKENNISGEWING</b>		
<b>Transport, Department of</b>			<b>Vervoer, Departement van</b>		
<i>Government Notice</i>			<i>Goewermentskennisgewing</i>		
460			460		
South African National Roads Agency Limited and the National Roads Act (7/1998): The South African National Roads Agency Limited: Declaration amendment of National Road N12 Section 7: Amendment of Declaration No. 631 of 2005 .....	3	32177	Suid-Afrikaanse Nasionale Padagentskap Beperk en die Nasionale Paaie Wet (7/1998): Die Suid-Afrikaanse Nasionale Padagentskap Beperk: Verklaring wysiging van Nasionale Pad N12 Seksie 7: Wysiging van Verklaring No. 631 van 2005 .....	4	32177

---

## GOVERNMENT NOTICE

---

### DEPARTMENT OF TRANSPORT

No. 460

15 May 2009

## THE SOUTH AFRICAN NATIONAL ROADS AGENCY LIMITED

Registration No: 98/09584/06

---

### DECLARATION AMENDMENT OF NATIONAL ROAD N12 SECTION 7

#### AMENDMENT OF DECLARATION No. 631 OF 2005

By virtue of section 40(1)(b) of the South African National Roads Agency Limited and the National Roads Act, 1998 (Act No. 7 of 1998), I hereby amend Declaration No. 631 of 2005, by substituting the descriptive section of the route from Britstown up to Strydenburg, with the subjoined sheets 1 to 23 of Plan No. P703/08.

**(National Road N12 Section 7: Britstown – Strydenburg)**

  
\_\_\_\_\_  
MINISTER OF TRANSPORT

---

## GOEWERMENSKENNISGEWING

---

### DEPARTEMENT VAN VERVOER

No. 460

15 Mei 2009

## DIE SUID-AFRIKAANSE NASIONALE PADAGENTSKAP BEPERK

Registrasie No: 98/09584/06

---

### VERKLARING WYSIGING VAN NASIONALE PAD N12 SEKSIE 7.

#### WYSIGING VAN VERKLARING NO. 631 VAN 2005

Kragtens Artikel 40(1)(b) van die Suid-Afrikaanse Nasionale Padagentskap Beperk en die Nasionale Paaie Wet, 1998 (Wet no.7 van 1998), wysig ek hiermee Verklaring no. 631 van 2005, deur die beskrywende gedeelte van die roete vanaf Britstown tot by Strydenburg, te vervang met meegaande velle 1 tot 23 van Plan no. P703/08.

**(Nasionale Pad N12 Seksie 7: Britstown – Strydenburg)**



**MINISTER VAN VERVOER**

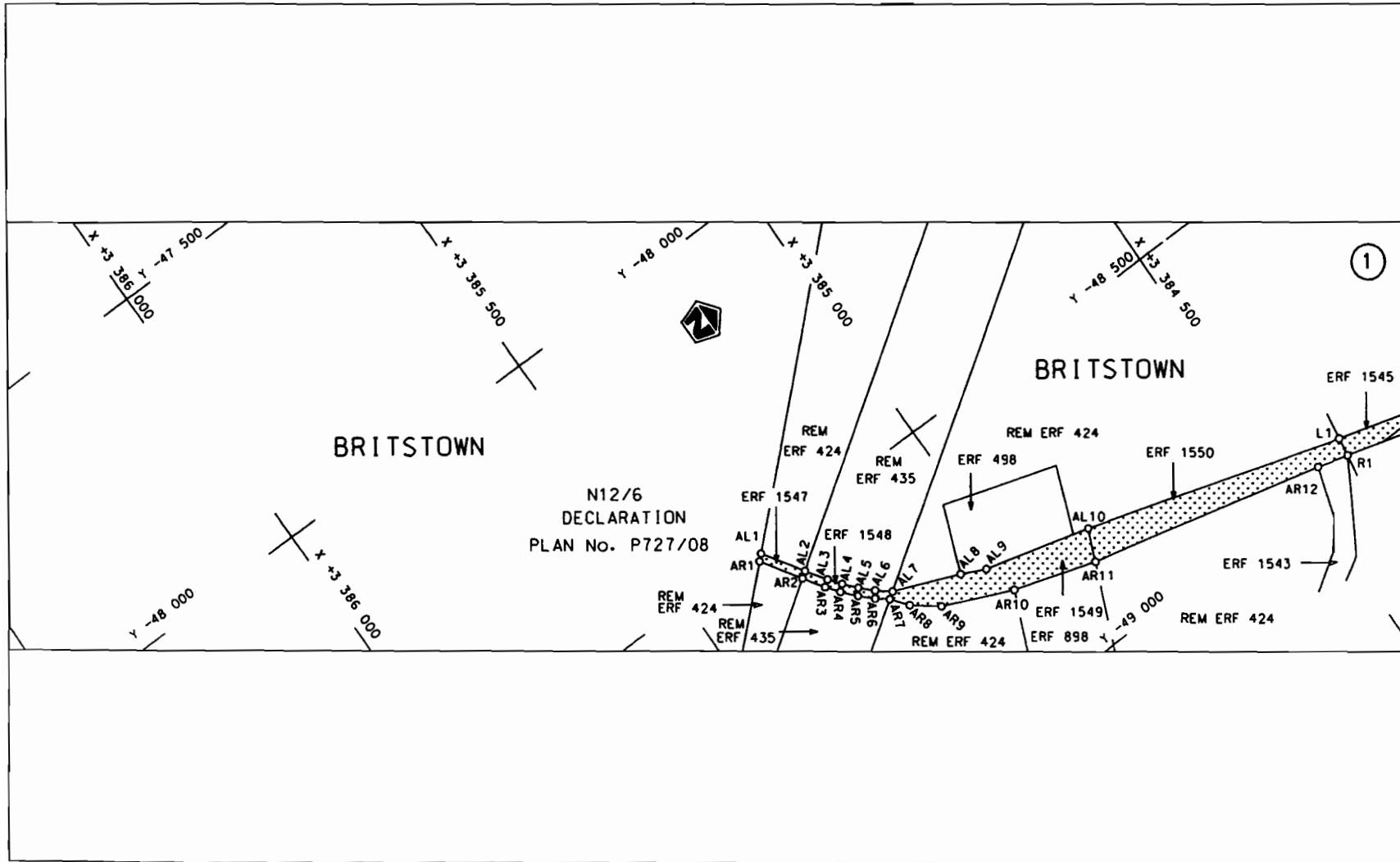

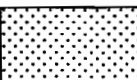

STAATSKOERANT, 15 MEI 2009

<p>Suid-Afrikaanse Padraad South African Roads Board</p>	<p>Die figuur getoon The figure shown</p> 	<p>st die padreserwe voor van 'n gedeelte represents the road reserve of a portion van Nasionale Roete of National Route N12 Seksie Section 7</p>	<p>Vel Sheet 1 van of 23 P P703/08</p>
--	--	---	--

D.O.9.A

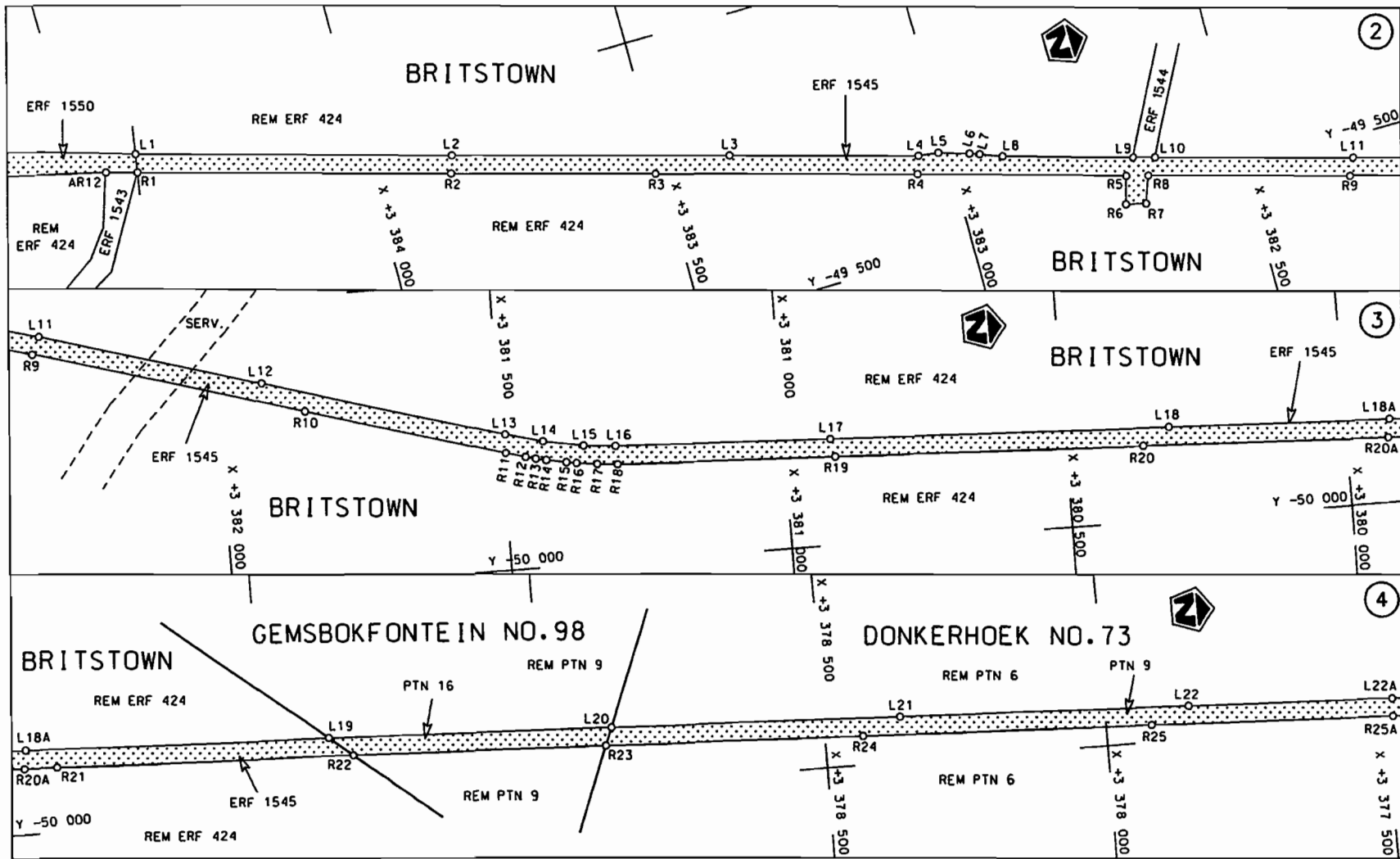
No. 32177 5



<p>Die Suid Afrikaanse Nasionale Padagentskap Beperk The South African National Roads Agency Limited</p>	<p>Die figuur getoon The figure shown</p> 	<p>steldie padreserwe voor van 'n gedeelte represents the road reserve of a portion van Nasionale Roete N12 of National Route N12</p> <p>Seksie 7 Section 7</p>	<p>Vel Sheet 2 van of 23 Plan P703/08</p>
--	--	---	---



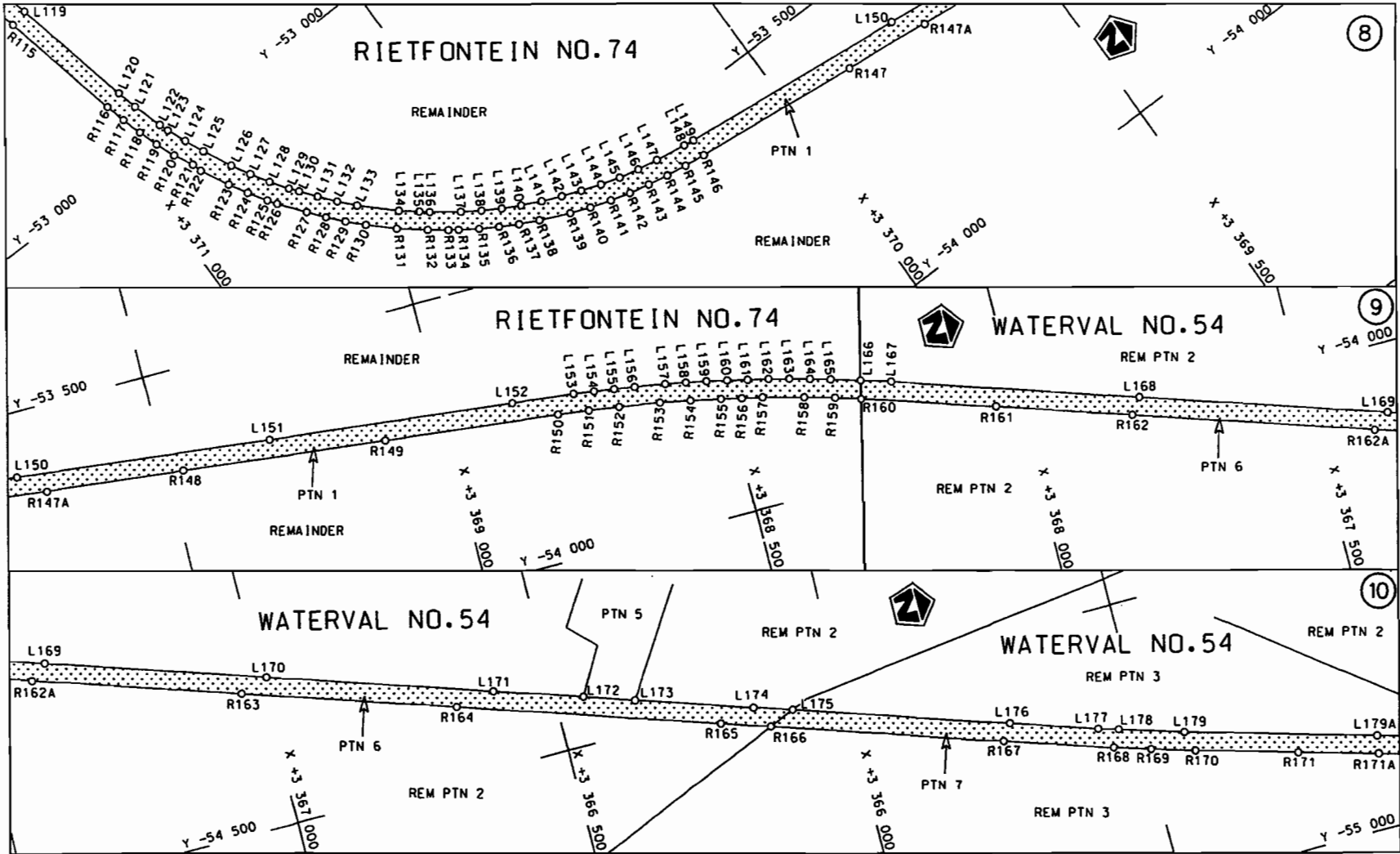

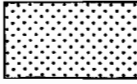
<p>Die Suid Afrikaanse Nasionale Padagentskap Beperk The South African National Roads Agency Limited</p>	<p>Die figuur getoon The figure shown</p> 	<p>steldie padreserwe voor van 'n gedeelte represents the road reserve of a portion of Nasionale Roete N12 of National Route N12</p> <p>Seksie 7 Section 7</p>	<p>Vel Sheet 4 van of 23 Plan P703/08</p>
--	--	--	---



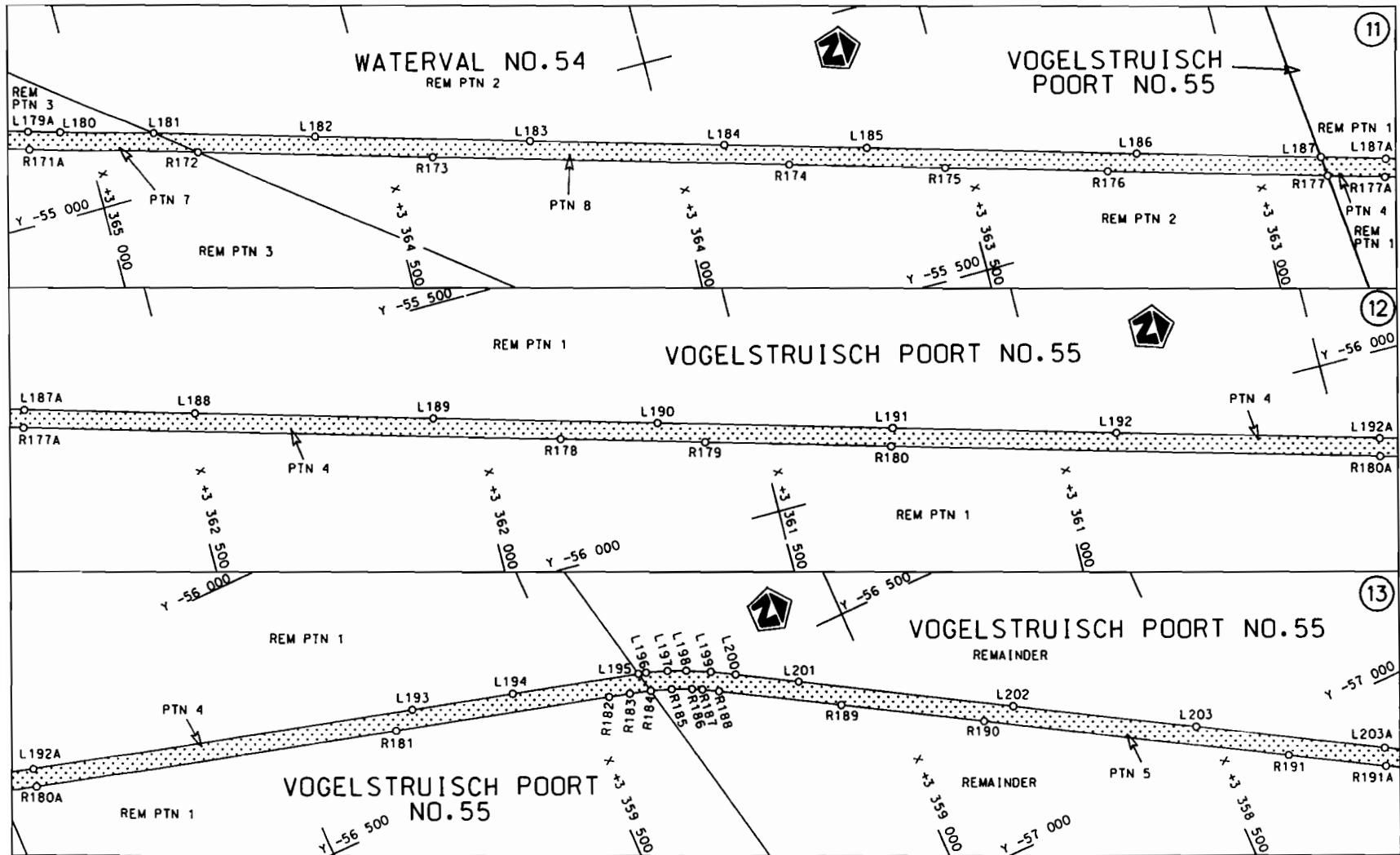

Die Suid Afrikaanse Nasionale Padagentskap Beperk The South African National Roads Agency Limited	Die figuur getoon The figure shown		steldie podreserve voor van 'n gedeelte represents the road reserve of a portion van Nasionale Roete N12 Seksie 7 of National Route N12 Section 7	Vel Sheet 5 van 23 Plan P703/08
--	---------------------------------------	--	--	------------------------------------

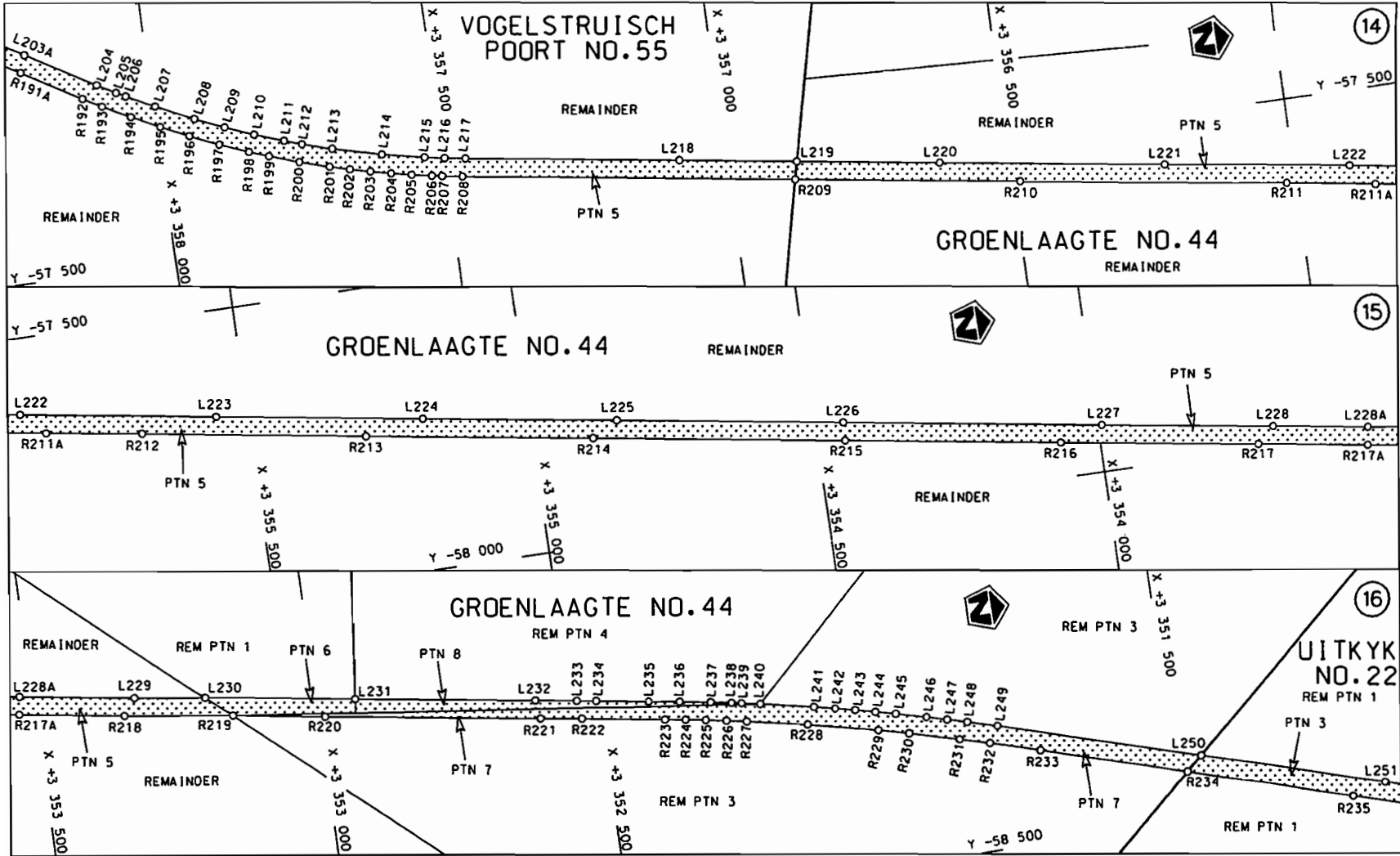

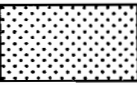
<p>Die Suid Afrikaanse Nasionale Padagentskop Beperk The South African National Roads Agency Limited</p>	<p>Die figuur getoon The figure shown</p>		<p>steldie padreserwe voor van 'n gedeelte represents the road reserve of a portion van Nasionale Roete N12 Seksie of National Route Section 7</p>	<p>Vel Sheet 6 van 23 Plan P703/08</p>
--	---	--	--	--

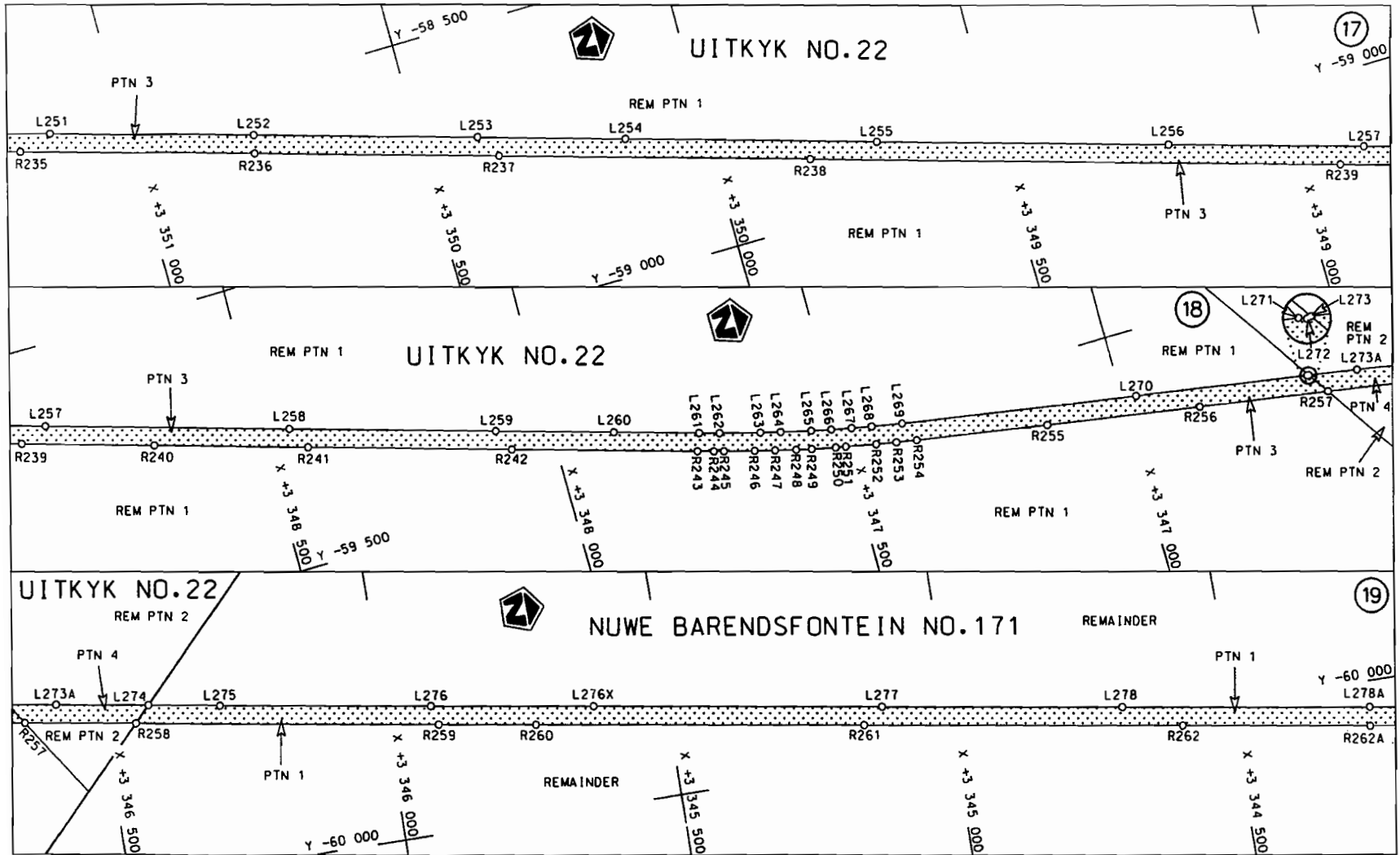

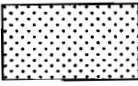
<p>Die Suid Afrikaanse Nasionale Padagentskap Beperk The South African National Roads Agency Limited</p>	<p>Die figuur getoon The figure shown</p> 	<p>stel die padreserwe voor van 'n gedeelte represents the road reserve of a portion van Nasionale Roete N12 of National Route</p> <p>Seksie 7</p>	<p>Vel Sheet 7 van 23 Plan P703/08</p>
--	--	--	--

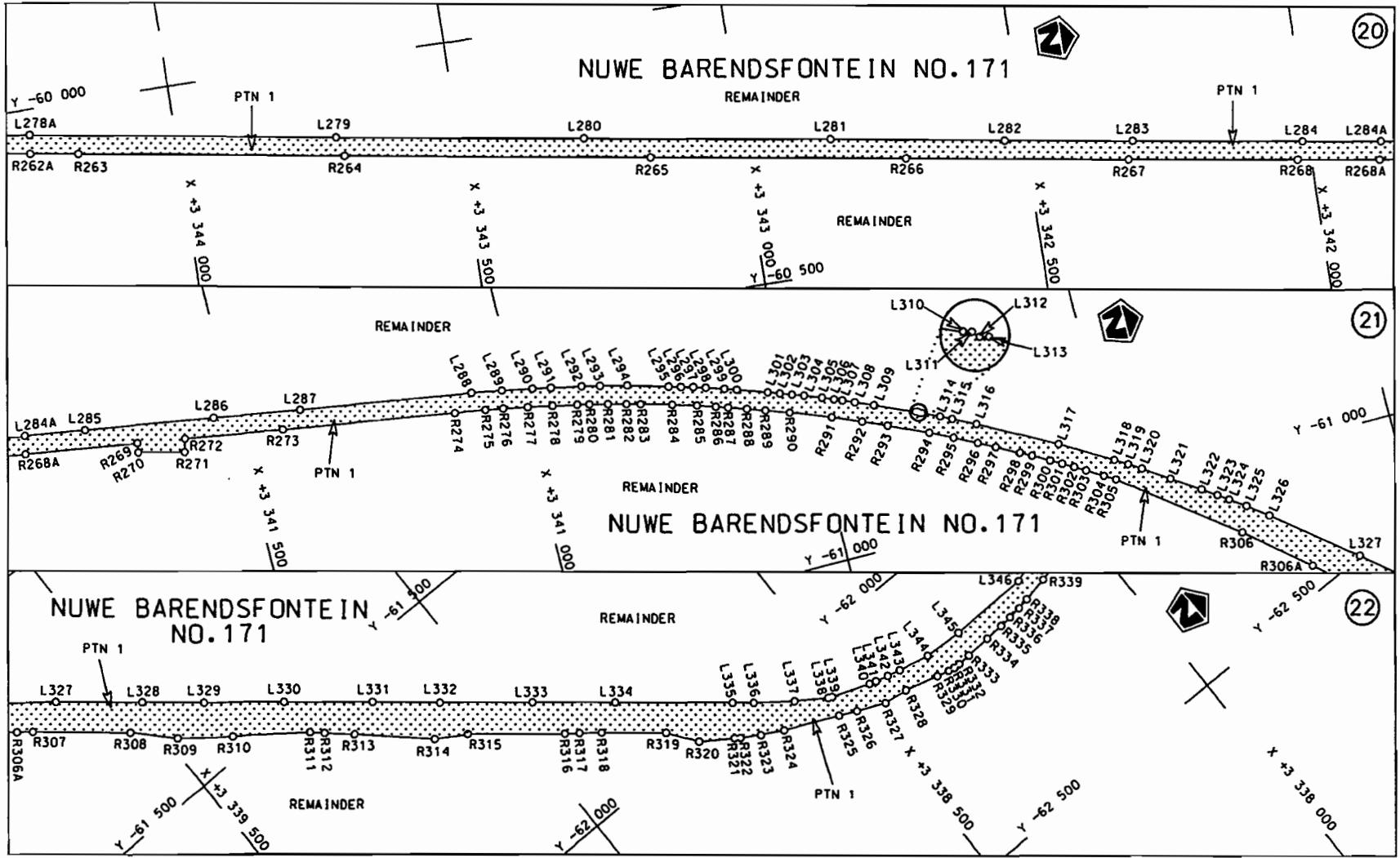

<p>Die Suid Afrikaanse Nasionale Padagentskap Beperk The South African National Roads Agency Limited</p>	<p>Die figuur getoon The figure shown</p>	 <p>steldie padreserwe voor van 'n gedeelte represents the road reserve of a portion van Nasionale Roete N12 of National Route N12</p>	<p>Vel Sheet 8 of 23</p>
<p>Seksie Section 7</p>			<p>Plan P703/08</p>

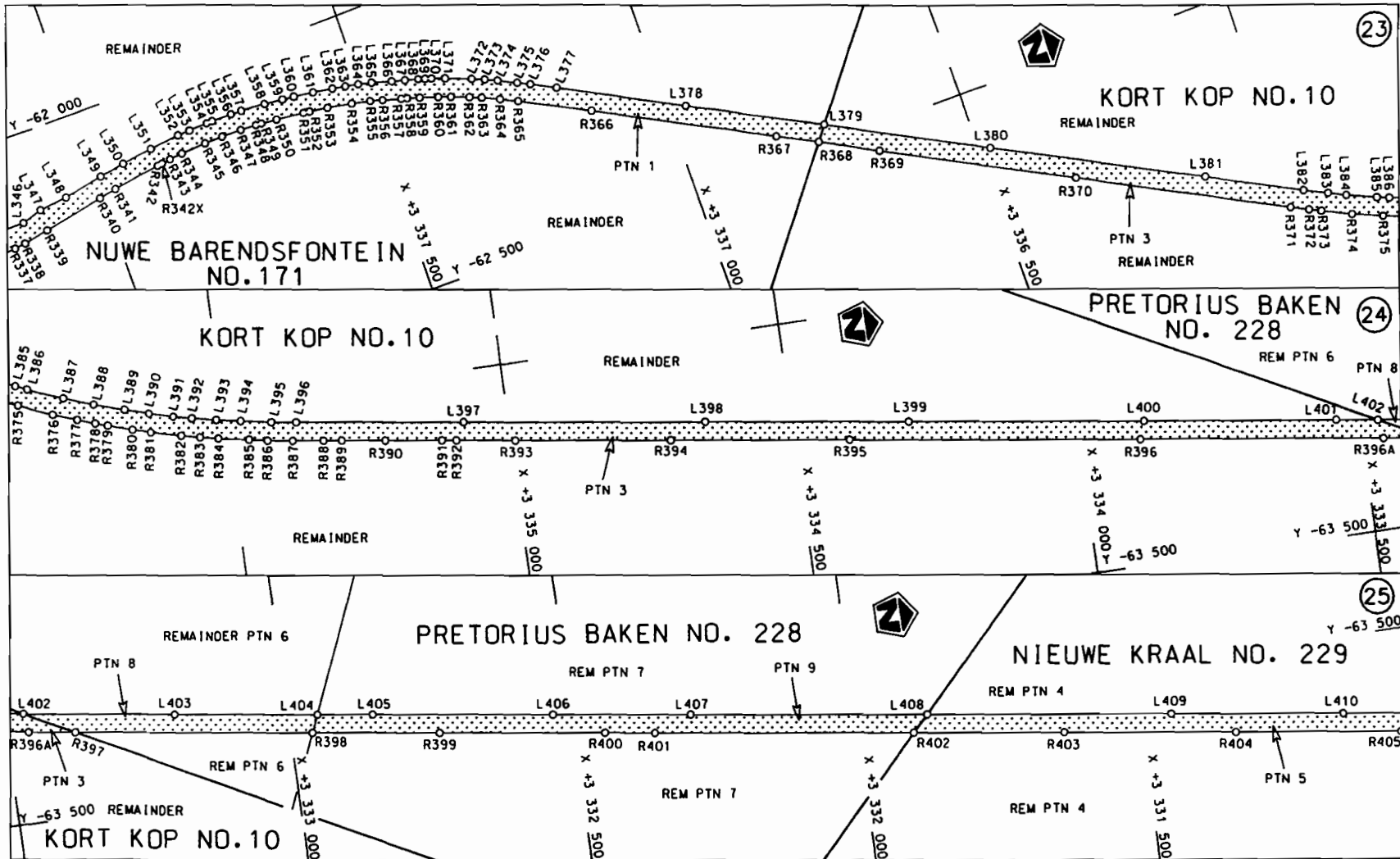

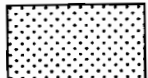
<p>Die Suid Afrikaanse Nasionale Padagentskap Beperk The South African National Roads Agency Limited</p>	<p>Die figuur getoon The figure shown</p>		<p>steldie padreserwe voor van 'n gedeelte represents the road reserve of a portion van Nasionale Roete N12 of National Route</p> <p>Seksie Section 7</p>	<p>Vel Sheet 9 van of 23 Plan P703/08</p>
--	---	--	---	---

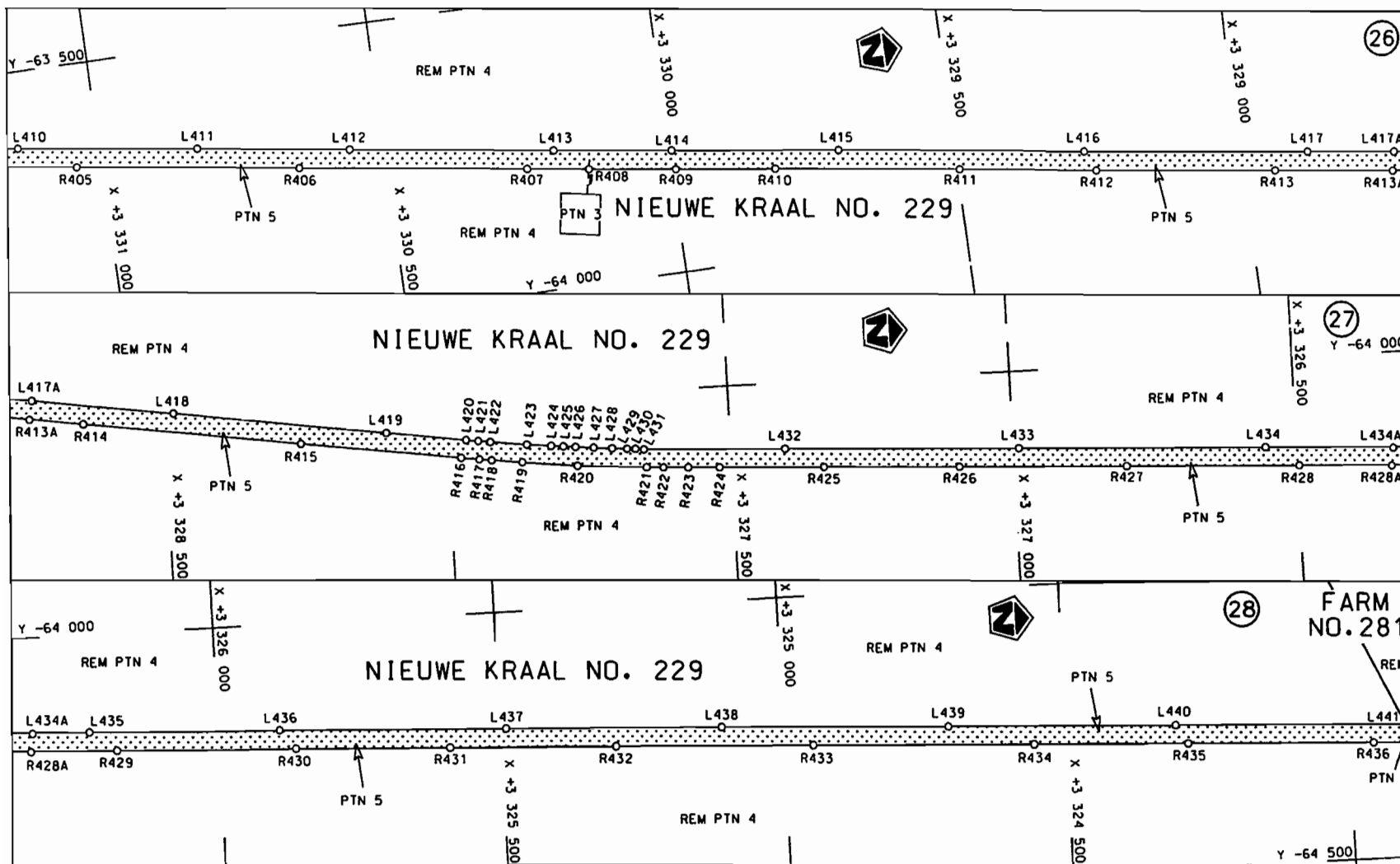

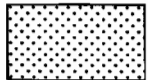
<p>Die Suid Afrikaanse Nasionale Padogentskap Beperk The South African National Roads Agency Limited</p>	<p>Die figuur getoon The figure shown</p>		<p>stel die padreserwe voor van 'n gedeelte represents the road reserve of a portion van Nasionale Roete N12 of National Route N12</p> <p>Seksie 7 Section 7</p>	<p>Vel Sheet 10 van 23 Plan P703/08</p>
--	---	--	--	---

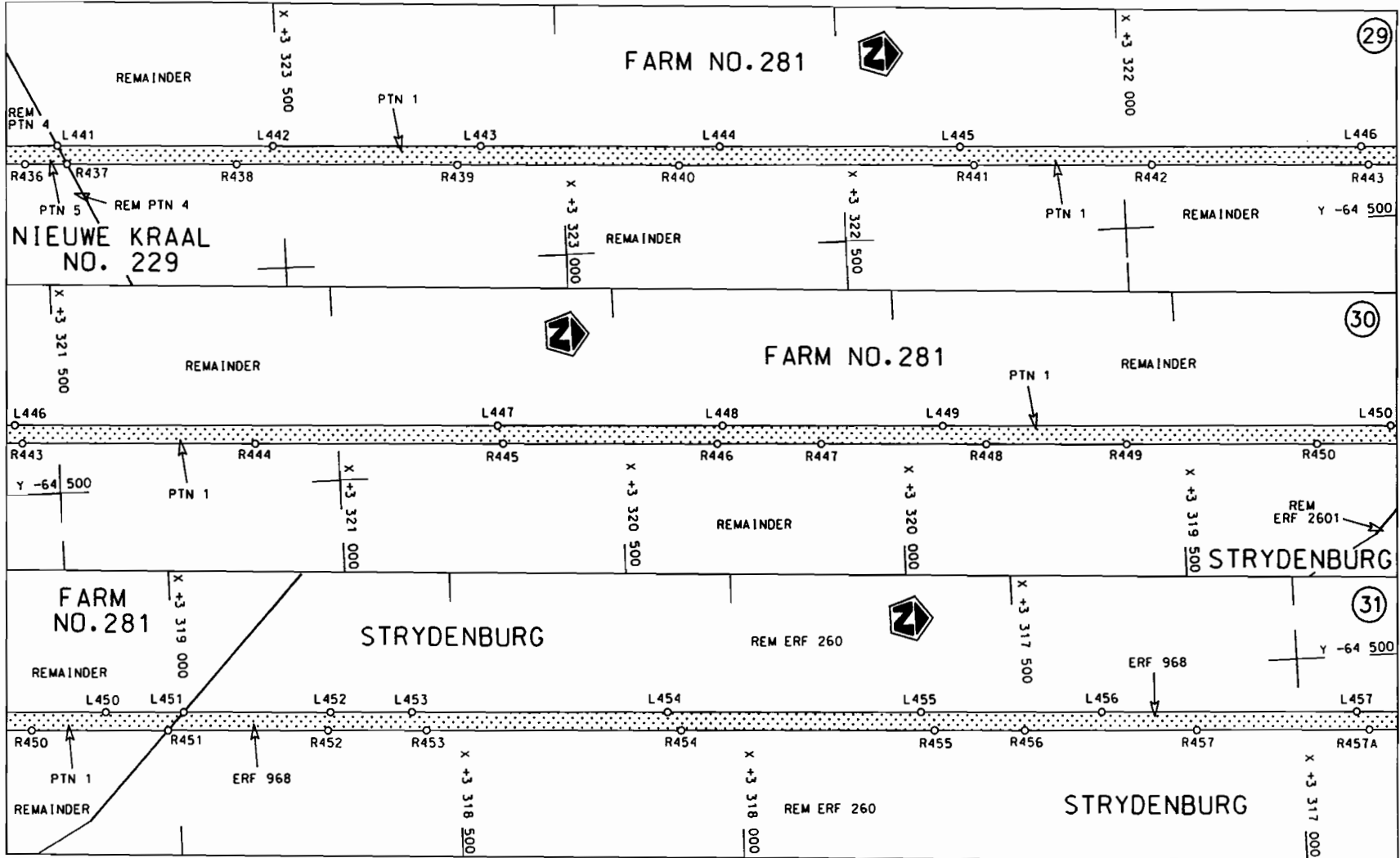

<p>Die Suid Afrikaanse Nasionale Podagentskap Beperk The South African National Roads Agency Limited</p>	<p>Die figuur getoon The figure shown</p>		<p>steldie padreserwe voor van 'n gedeelte represents the road reserve of a portion van Nasionale Roete N12 of National Route N12</p> <p>Seksie 7 Section</p>	<p>Vel Sheet 11 van of 23</p>
				<p>Plan P703/08</p>

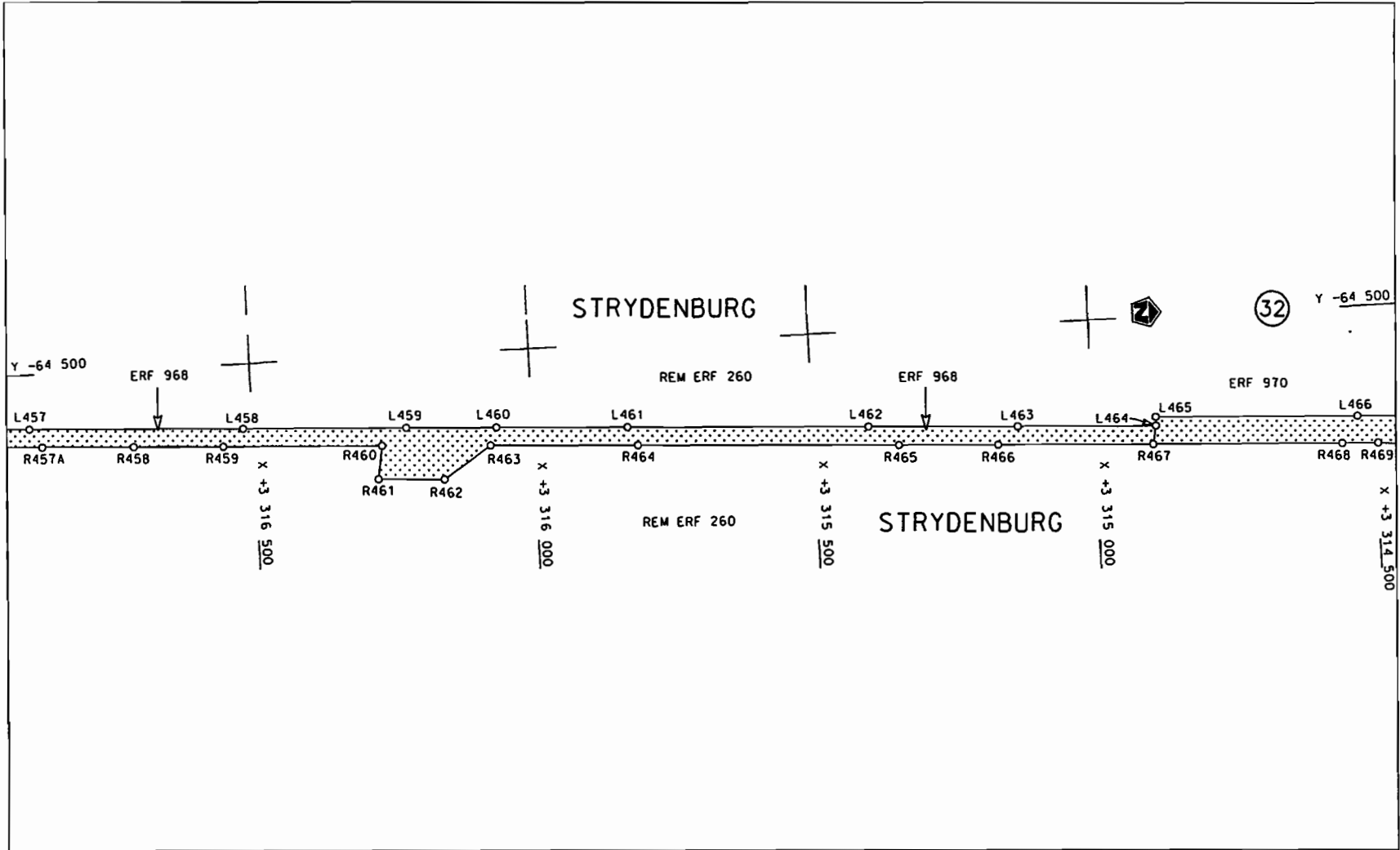

<p>Die Suid Afrikaanse Nasionale Padagentskap Beperk The South African National Roads Agency Limited</p>	<p>Die figuur getoon The figure shown</p>	<p></p> <p>steldie padreserwe voor van 'n gedeelte represents the road reserve of a portion van Nasionale Roete N12 of National Route</p> <p>Seksie 7 Section</p>	<p>Vel Sheet 12 van of 23 Plan P703/08</p>
--	---	---	--



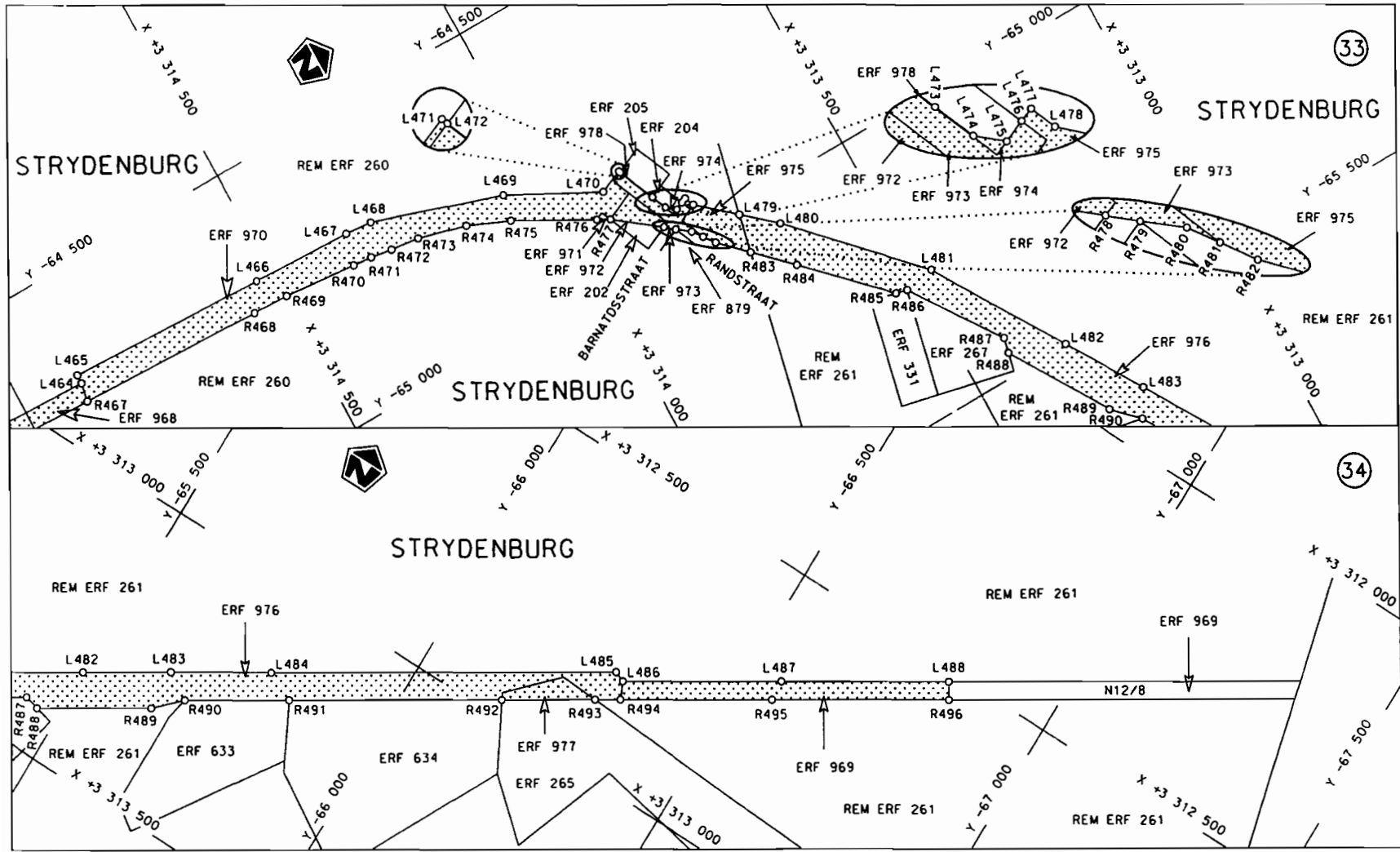

Suid-Afrikaanse Padrood  
South African Roads Board

Die figuur getoon  
The figure shown

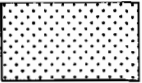

steldie padreserwe voor van 'n gedeelte  
represents the road reserve of a portion  
van Nasionale Roete N12 Seksie 7  
of National Route Section 7

Vel 13 von 23  
Sheet of  
P P703/08

D.O.9.A

STATSKOERANT, 15 MEI 2009

NO. 321 / 17

PADRESERWE KOÖRDINATE / ROAD RESERVE CO-ORDINATES											
LINKERKANT/LEFT HAND SIDE					REGTERKANT/RIGHT HAND SIDE						
					WG 23°	Y	Y				
AL1	-48	509.590	3	385	341.950	AR1	-48	518.950	3	385	352.070
AL2	-48	579.450	3	385	295.490	AR2	-48	587.000	3	385	306.810
AL3	-48	614.720	3	385	271.300	AR3	-48	622.580	3	385	282.340
AL4	-48	635.740	3	385	254.680	AR4	-48	644.730	3	385	265.060
AL5	-48	657.840	3	385	235.000	AR5	-48	668.500	3	385	243.440
AL6	-48	678.650	3	385	213.610	AR6	-48	689.650	3	385	221.520
AL7	-48	698.620	3	385	190.200	AR7	-48	706.370	3	385	201.850
AL8	-48	744.410	3	385	075.390	AR8	-48	734.940	3	385	179.170
AL9	-48	763.860	3	385	033.840	AR9	-48	769.060	3	385	134.870
AL10	-48	813.800	3	384	845.510	AR10	-48	821.240	3	385	014.230
L1	-48	949.760	3	384	394.880	AR11	-48	867.250	3	384	868.560
L2	-49	102.750	3	383	851.540	AR12	-48	966.470	3	384	453.810
L3	-49	236.550	3	383	375.920	R1	-48	981.420	3	384	400.320
L4	-49	327.820	3	383	051.320	R2	-49	132.600	3	383	861.350
L5	-49	331.840	3	383	015.630	R3	-49	231.450	3	383	510.360
L6	-49	347.740	3	382	962.570	R4	-49	357.940	3	383	061.380
L7	-49	353.790	3	382	945.500	R5	-49	458.420	3	382	705.000
L8	-49	368.480	3	382	907.550	R6	-49	505.560	3	382	718.600
L9	-49	431.230	3	382	684.430	R7	-49	514.690	3	382	683.630
L10	-49	441.700	3	382	646.970	R8	-49	469.070	3	382	666.830
L11	-49	537.130	3	382	307.960	R9	-49	569.235	3	382	321.815
L12	-49	645.960	3	381	919.900	R10	-49	699.350	3	381	846.130
L13	-49	765.750	3	381	492.820	R11	-49	797.920	3	381	494.440
L14	-49	782.480	3	381	426.310	R12	-49	807.350	3	381	459.210
L15	-49	795.190	3	381	354.730	R13	-49	811.740	3	381	441.340
L16	-49	800.160	3	381	298.230	R14	-49	815.250	3	381	423.130
L17	-49	816.690	3	380	916.360	R15	-49	821.550	3	381	387.390
L18	-49	840.820	3	380	313.540	R16	-49	824.470	3	381	369.410
L19	-49	879.170	3	379	380.600	R17	-49	828.790	3	381	333.040
L20	-49	899.880	3	378	876.860	R18	-49	832.150	3	381	296.840
L21	-49	921.260	3	378	362.270	R19	-49	847.880	3	380	909.670
L22	-49	942.380	3	377	849.880	R20	-49	870.100	3	380	361.490
L23	-49	959.670	3	377	429.920	R21	-49	890.480	3	379	867.690
L24	-49	978.690	3	376	974.430	R22	-49	912.495	3	379	352.199
L25	-49	978.290	3	376	970.010	R23	-49	930.860	3	378	889.440
L26	-49	980.190	3	376	965.370	R24	-49	949.610	3	378	431.200
L27	-49	979.260	3	376	962.290	R25	-49	970.900	3	377	918.080
L28	-49	994.210	3	376	597.680	R26	-49	995.850	3	377	315.170
L29	-50	012.120	3	376	158.540	R27	-50	012.010	3	376	928.990
L30	-50	028.450	3	375	760.410	R28	-50	028.710	3	376	525.740
L31	-50	062.500	3	374	935.440	R29	-50	049.010	3	376	024.780
L32	-50	074.620	3	374	643.960	R30	-50	078.340	3	375	311.850
L33	-50	078.920	3	374	551.040	R31	-50	095.800	3	374	889.030
L34	-50	082.320	3	374	514.360	R32	-50	109.500	3	374	559.330
L35	-50	084.320	3	374	496.220	R33	-50	111.130	3	374	541.070
L36	-50	087.130	3	374	477.710	R34	-50	115.230	3	374	504.870
L37	-50	093.690	3	374	440.560	R35	-50	120.410	3	374	468.830
L38	-50	101.420	3	374	404.570	R36	-50	127.580	3	374	433.190
L39	-50	106.210	3	374	386.140	R37	-50	135.820	3	374	397.330
L40	-50	111.140	3	374	368.410	R38	-50	145.580	3	374	362.270
L41	-50	116.260	3	374	350.640	R39	-50	150.990	3	374	344.790

Vel  
Sheet

14

Van  
of

23

P703/08

PADRESERWE KOÖRDINATE / ROAD RESERVE CO-ORDINATES											
LINKERKANT/LEFT HAND SIDE					REGTERKANT/RIGHT HAND SIDE						
					WG 23°	X					
L42	-50	121.780	3	374	330.070	R40	-50	156.850	3	374	327.360
L43	-50	134.090	3	374	298.050	R41	-50	174.540	3	374	280.850
L44	-50	146.600	3	374	265.430	R42	-50	187.040	3	374	249.800
L45	-50	154.370	3	374	247.420	R43	-50	202.750	3	374	218.090
L46	-50	169.620	3	374	215.020	R44	-50	219.840	3	374	185.760
L47	-50	185.910	3	374	182.470	R45	-50	238.210	3	374	153.700
L48	-50	203.620	3	374	150.350	R46	-50	247.790	3	374	138.240
L49	-50	223.020	3	374	118.890	R47	-50	267.690	3	374	108.440
L50	-50	243.660	3	374	088.840	R48	-50	300.580	3	374	063.990
L51	-50	265.240	3	374	059.180	R49	-50	335.860	3	374	022.610
L52	-50	287.980	3	374	029.890	R50	-50	360.550	3	373	995.640
L53	-50	311.130	3	374	002.380	R51	-50	386.540	3	373	969.980
L54	-50	336.670	3	373	975.310	R52	-50	413.790	3	373	945.050
L55	-50	362.400	3	373	949.800	R53	-50	483.660	3	373	885.220
L56	-50	389.640	3	373	924.620	R54	-50	734.870	3	373	670.260
L57	-50	627.560	3	373	720.630	R55	-50	942.330	3	373	493.000
L58	-50	877.070	3	373	507.180	R56	-50	995.260	3	373	447.460
L59	-50	884.440	3	373	502.330	R57	-51	023.140	3	373	422.840
L60	-50	883.240	3	373	498.620	R58	-51	048.740	3	373	397.100
L61	-50	891.250	3	373	494.810	R59	-51	080.630	3	373	363.450
L62	-50	988.360	3	373	411.880	R60	-51	091.680	3	373	349.110
L63	-51	026.700	3	373	377.320	R61	-51	112.550	3	373	319.040
L64	-51	051.390	3	373	347.560	R62	-51	122.520	3	373	303.870
L65	-51	082.490	3	373	308.940	R63	-51	141.810	3	373	273.350
L66	-51	106.610	3	373	269.680	R64	-51	158.200	3	373	240.940
L67	-51	130.460	3	373	225.630	R65	-51	173.130	3	373	207.580
L68	-51	145.510	3	373	192.170	R66	-51	186.370	3	373	172.970
L69	-51	158.890	3	373	156.300	R67	-51	192.330	3	373	155.440
L70	-51	169.630	3	373	122.360	R68	-51	211.796	3	373	120.322
L71	-51	174.450	3	373	102.480	R69	-51	211.882	3	373	102.164
L72	-51	182.860	3	373	057.410	R70	-51	213.920	3	373	065.710
L73	-51	187.800	3	373	025.360	R71	-51	218.960	3	373	029.190
L74	-51	194.930	3	372	962.010	R72	-51	242.130	3	372	825.680
L75	-51	213.298	3	372	802.202	R73	-51	263.330	3	372	643.500
L76	-51	225.840	3	372	686.950	R74	-51	272.050	3	372	591.240
L77	-51	232.650	3	372	634.720	R75	-51	291.890	3	372	500.520
L78	-51	241.420	3	372	580.470	R76	-51	302.250	3	372	501.900
L79	-51	248.610	3	372	546.720	R77	-51	317.070	3	372	461.250
L80	-51	257.550	3	372	508.720	R78	-51	322.760	3	372	444.700
L81	-51	270.290	3	372	363.090	R79	-51	321.540	3	372	408.340
L82	-51	270.120	3	372	359.900	R80	-51	333.880	3	372	375.740
L83	-51	274.730	3	372	351.630	R81	-51	347.580	3	372	341.650
L84	-51	277.660	3	372	348.190	R82	-51	362.790	3	372	307.820
L85	-51	308.770	3	372	353.520	R83	-51	378.300	3	372	275.280
L86	-51	323.240	3	372	319.710	R84	-51	395.490	3	372	242.030
L87	-51	338.220	3	372	286.410	R85	-51	403.930	3	372	226.900
L88	-51	362.560	3	372	237.460	R86	-51	422.010	3	372	195.710
L89	-51	380.150	3	372	205.690	R87	-51	441.000	3	372	164.790
L90	-51	398.530	3	372	174.000	R88	-51	471.880	3	372	119.540
L91	-51	438.120	3	372	113.120	R89	-51	482.770	3	372	104.330
L92	-51	461.310	3	372	080.580	R90	-51	504.440	3	372	075.410

## PADRESERWE KOÖRDINATE / ROAD RESERVE CO-ORDINATES

LINKERKANT/LEFT HAND SIDE				REGTERKANT/RIGHT HAND SIDE			
				WG 23°	X		
L93	-51	482.460	3 372 052.450	R91	-51	523.340	3 372 052.150
L94	-51	503.320	3 372 026.510	R92	-51	543.620	3 372 027.880
L95	-51	526.910	3 371 998.970	R93	-51	580.380	3 371 987.630
L96	-51	564.030	3 371 958.680	R94	-51	656.660	3 371 906.700
L97	-51	626.380	3 371 893.040	R95	-51	809.450	3 371 745.460
L98	-51	904.320	3 371 599.510	R96	-51	940.460	3 371 607.260
L99	-51	908.880	3 371 597.510	R97	-52	073.250	3 371 466.750
L100	-51	907.390	3 371 593.500	R98	-52	235.900	3 371 294.710
L101	-51	912.000	3 371 591.220	R99	-52	269.250	3 371 259.460
L102	-52	125.800	3 371 365.320	R100	-52	292.120	3 371 238.080
L103	-52	238.150	3 371 247.080	R101	-52	305.890	3 371 225.770
L104	-52	264.270	3 371 221.590	R102	-52	319.420	3 371 214.160
L105	-52	277.640	3 371 209.170	R103	-52	347.630	3 371 191.450
L106	-52	305.100	3 371 185.170	R104	-52	377.980	3 371 168.720
L107	-52	346.180	3 371 153.210	R105	-52	424.140	3 371 137.810
L108	-52	363.990	3 371 140.180	R106	-52	439.880	3 371 128.350
L109	-52	379.410	3 371 129.520	R107	-52	472.440	3 371 109.660
L110	-52	395.740	3 371 118.720	R108	-52	488.090	3 371 101.340
L111	-52	427.430	3 371 099.250	R109	-52	506.920	3 371 092.090
L112	-52	459.640	3 371 080.550	R110	-52	529.990	3 371 081.130
L113	-52	471.900	3 371 073.940	R111	-52	560.830	3 371 067.850
L114	-52	505.060	3 371 058.100	R112	-52	594.810	3 371 054.770
L115	-52	538.310	3 371 043.290	R113	-52	629.830	3 371 042.970
L116	-52	572.030	3 371 029.670	R114	-52	664.570	3 371 032.630
L117	-52	606.420	3 371 017.460	R115	-52	682.680	3 371 028.030
L118	-52	641.300	3 371 006.600	R116	-52	895.290	3 370 976.640
L119	-52	676.370	3 370 997.170	R117	-52	930.490	3 370 967.090
L120	-52	888.340	3 370 945.940	R118	-52	965.100	3 370 956.300
L121	-52	923.820	3 370 936.460	R119	-52	999.360	3 370 944.080
L122	-52	975.610	3 370 919.280	R120	-53	033.670	3 370 930.390
L123	-52	992.030	3 370 913.230	R121	-53	066.490	3 370 912.980
L124	-53	025.710	3 370 899.350	R122	-53	083.270	3 370 908.020
L125	-53	058.970	3 370 884.380	R123	-53	131.100	3 370 882.340
L126	-53	107.530	3 370 859.380	R124	-53	162.480	3 370 863.890
L127	-53	139.100	3 370 841.010	R125	-53	193.310	3 370 843.810
L128	-53	169.820	3 370 821.520	R126	-53	208.380	3 370 833.410
L129	-53	199.700	3 370 800.700	R127	-53	251.700	3 370 799.900
L130	-53	214.760	3 370 789.210	R128	-53	279.980	3 370 776.640
L131	-53	242.150	3 370 767.190	R129	-53	306.820	3 370 752.330
L132	-53	270.170	3 370 743.440	R130	-53	332.980	3 370 726.810
L133	-53	297.060	3 370 718.950	R131	-53	370.580	3 370 686.940
L134	-53	347.500	3 370 665.210	R132	-53	405.370	3 370 644.230
L135	-53	371.080	3 370 637.100	R133	-53	427.270	3 370 614.780
L136	-53	382.320	3 370 622.860	R134	-53	437.780	3 370 599.980
L137	-53	414.480	3 370 578.040	R135	-53	457.860	3 370 569.310
L138	-53	434.640	3 370 547.040	R136	-53	476.530	3 370 538.230
L139	-53	453.620	3 370 515.070	R137	-53	494.170	3 370 506.350
L140	-53	470.220	3 370 484.020	R138	-53	510.680	3 370 473.520
L141	-53	486.660	3 370 450.520	R139	-53	533.280	3 370 422.550
L142	-53	501.230	3 370 416.900	R140	-53	546.870	3 370 387.670
L143	-53	514.380	3 370 383.160	R141	-53	559.040	3 370 350.240

Vel	16	Van	23	P703/08
Sheet		of		

PADRESERWE KOÖRDINATE / ROAD RESERVE CO-ORDINATES											
LINKERKANT/LEFT HAND SIDE					REGTERKANT/RIGHT HAND SIDE						
					WG 23°						
					X						
L144	-53	526.680	3	370	348.310	R142	-53	569.400	3	370	314.790
L145	-53	537.020	3	370	313.900	R143	-53	578.310	3	370	279.380
L146	-53	546.020	3	370	278.860	R144	-53	585.680	3	370	243.150
L147	-53	553.610	3	370	242.760	R145	-53	591.800	3	370	207.060
L148	-53	562.540	3	370	188.120	R146	-53	596.570	3	370	170.310
L149	-53	565.140	3	370	169.610	R147	-53	629.780	3	369	871.390
L150	-53	610.350	3	369	762.560	R148	-53	674.380	3	369	471.080
L151	-53	660.710	3	369	308.970	R149	-53	714.680	3	369	108.250
L152	-53	709.200	3	368	872.510	R150	-53	749.050	3	368	799.360
L153	-53	721.680	3	368	763.460	R151	-53	755.990	3	368	744.250
L154	-53	726.540	3	368	726.810	R152	-53	763.780	3	368	689.770
L155	-53	731.680	3	368	690.780	R153	-53	775.580	3	368	616.830
L156	-53	737.470	3	368	653.970	R154	-53	785.700	3	368	562.870
L157	-53	746.810	3	368	599.280	R155	-53	796.500	3	368	509.490
L158	-53	753.470	3	368	562.840	R156	-53	804.320	3	368	473.730
L159	-53	760.560	3	368	526.650	R157	-53	812.850	3	368	438.140
L160	-53	768.300	3	368	490.580	R158	-53	830.950	3	368	366.270
L161	-53	776.280	3	368	455.180	R159	-53	845.560	3	368	313.040
L162	-53	784.770	3	368	419.310	R160	-53	858.700	3	368	268.270
L163	-53	793.850	3	368	383.350	R161	-53	932.660	3	368	038.540
L164	-53	803.120	3	368	348.040	R162	-54	007.970	3	367	807.330
L165	-53	813.060	3	368	312.070	R163	-54	258.140	3	367	038.860
L166	-53	827.830	3	368	260.790	R164	-54	376.990	3	366	673.620
L167	-53	844.210	3	368	208.190	R165	-54	523.730	3	366	222.820
L168	-53	981.400	3	367	787.210	R166	-54	551.140	3	366	138.670
L169	-54	118.610	3	367	365.910	R167	-54	679.960	3	365	743.040
L170	-54	241.310	3	366	988.940	R168	-54	739.760	3	365	557.110
L171	-54	367.020	3	366	602.850	R169	-54	759.350	3	365	492.310
L172	-54	416.940	3	366	449.980	R170	-54	781.160	3	365	416.690
L173	-54	446.537	3	366	361.314	R171	-54	830.920	3	365	239.630
L174	-54	511.130	3	366	159.990	R172	-54	950.550	3	364	812.640
L175	-54	532.690	3	366	093.760	R173	-55	063.750	3	364	408.810
L176	-54	652.950	3	365	724.440	R174	-55	235.840	3	363	794.560
L177	-54	701.060	3	365	575.520	R175	-55	310.570	3	363	527.520
L178	-54	712.020	3	365	540.240	R176	-55	389.350	3	363	246.680
L179	-54	745.570	3	365	427.220	R177	-55	495.510	3	362	868.400
L180	-54	853.750	3	365	042.020	R178	-55	782.760	3	361	844.700
L181	-54	898.570	3	364	882.000	R179	-55	852.200	3	361	597.260
L182	-54	976.740	3	364	602.900	R180	-55	942.200	3	361	277.000
L183	-55	080.790	3	364	231.800	R181	-56	353.410	3	359	810.260
L184	-55	174.140	3	363	898.620	R182	-56	457.600	3	359	438.260
L185	-55	242.970	3	363	652.830	R183	-56	467.740	3	359	402.540
L186	-55	373.150	3	363	188.600	R184	-56	478.670	3	359	366.560
L187	-55	462.000	3	362	871.900	R185	-56	491.580	3	359	331.800
L188	-55	575.520	3	362	467.320	R186	-56	506.190	3	359	298.650
L189	-55	690.620	3	362	057.430	R187	-56	514.390	3	359	282.340
L190	-55	799.080	3	361	670.940	R188	-56	529.330	3	359	256.350
L191	-55	912.510	3	361	266.550	R189	-56	641.120	3	359	066.100
L192	-56	020.700	3	360	881.120	R190	-56	770.730	3	358	846.280
L193	-56	332.390	3	359	769.160	R191	-57	048.960	3	358	374.800
L194	-56	381.790	3	359	592.780	R192	-57	197.650	3	358	122.580

PADRESERWE KOÖRDINATE / ROAD RESERVE CO-ORDINATES						
LINKERKANT/LEFT HAND SIDE				REGTERKANT/RIGHT HAND SIDE		
				WG 23°	X	
L195	-56 443.180	3 359	374.260	R193	-57 215.860	3 358 090.740
L196	-56 446.870	3 359	360.890	R194	-57 241.330	3 358 042.650
L197	-56 460.050	3 359	325.390	R195	-57 265.750	3 357 993.420
L198	-56 473.360	3 359	294.830	R196	-57 288.870	3 357 943.550
L199	-56 493.040	3 359	255.780	R197	-57 310.190	3 357 893.430
L200	-56 515.500	3 359	217.250	R198	-57 330.140	3 357 842.360
L201	-56 573.510	3 359	119.220	R199	-57 342.400	3 357 807.860
L202	-56 769.050	3 358	787.810	R200	-57 359.960	3 357 755.770
L203	-56 935.840	3 358	504.970	R201	-57 375.740	3 357 703.130
L204	-57 177.790	3 358	094.340	R202	-57 385.520	3 357 668.030
L205	-57 195.600	3 358	062.390	R203	-57 394.640	3 357 632.610
L206	-57 204.220	3 358	046.380	R204	-57 402.950	3 357 597.070
L207	-57 229.120	3 357	997.420	R205	-57 410.550	3 357 561.400
L208	-57 260.270	3 357	930.320	R206	-57 417.400	3 357 525.320
L209	-57 281.740	3 357	879.660	R207	-57 420.600	3 357 507.350
L210	-57 301.550	3 357	828.750	R208	-57 426.380	3 357 471.340
L211	-57 319.860	3 357	777.180	R209	-57 514.830	3 356 884.020
L212	-57 329.990	3 357	746.540	R210	-57 574.650	3 356 486.970
L213	-57 345.830	3 357	693.900	R211	-57 645.580	3 356 016.480
L214	-57 368.290	3 357	608.270	R212	-57 694.340	3 355 692.500
L215	-57 384.030	3 357	533.770	R213	-57 754.150	3 355 296.250
L216	-57 390.390	3 357	498.390	R214	-57 814.710	3 354 893.930
L217	-57 396.090	3 357	461.660	R215	-57 881.580	3 354 450.490
L218	-57 453.180	3 357	083.330	R216	-57 938.990	3 354 070.200
L219	-57 484.310	3 356	876.480	R217	-57 991.430	3 353 721.520
L220	-57 522.150	3 356	625.050	R218	-58 048.340	3 353 344.470
L221	-57 582.080	3 356	227.390	R219	-58 076.840	3 353 152.700
L222	-57 631.260	3 355	901.190	R220	-58 101.890	3 352 989.160
L223	-57 683.090	3 355	556.940	R221	-58 159.580	3 352 607.150
L224	-57 738.150	3 355	191.910	R222	-58 170.440	3 352 534.450
L225	-57 789.980	3 354	847.740	R223	-58 192.230	3 352 389.380
L226	-57 849.980	3 354	449.430	R224	-58 198.030	3 352 353.210
L227	-57 918.800	3 353	993.280	R225	-58 203.820	3 352 317.710
L228	-57 964.370	3 353	691.020	R226	-58 209.980	3 352 281.630
L229	-58 020.020	3 353	322.510	R227	-58 216.330	3 352 246.020
L230	-58 038.940	3 353	196.970	R228	-58 237.120	3 352 138.790
L231	-58 078.950	3 352	931.440	R229	-58 264.550	3 352 015.270
L232	-58 127.100	3 352	611.830	R230	-58 277.510	3 351 962.300
L233	-58 138.360	3 352	538.860	R231	-58 300.170	3 351 874.800
L234	-58 143.120	3 352	504.860	R232	-58 314.650	3 351 822.060
L235	-58 156.980	3 352	413.340	R233	-58 339.840	3 351 734.690
L236	-58 165.360	3 352	358.920	R234	-58 413.550	3 351 480.460
L237	-58 174.230	3 352	304.470	R235	-58 496.790	3 351 193.290
L238	-58 180.470	3 352	268.090	R236	-58 613.940	3 350 789.010
L239	-58 183.580	3 352	250.510	R237	-58 735.510	3 350 369.350
L240	-58 189.590	3 352	217.620	R238	-58 890.929	3 349 833.177
L241	-58 208.300	3 352	123.280	R239	-59 154.840	3 348 921.950
L242	-58 216.240	3 352	086.190	R240	-59 221.180	3 348 692.980
L243	-58 224.070	3 352	050.970	R241	-59 297.890	3 348 428.550
L244	-58 232.150	3 352	016.000	R242	-59 399.640	3 348 077.440
L245	-58 240.550	3 351	980.810	R243	-59 491.960	3 347 758.290

Vel	18	Van	23	P703/08
Sheet		of		

PADRESERWE KOÖRDINATE / ROAD RESERVE CO-ORDINATES											
LINKERKANT/LEFT HAND SIDE					REGTERKANT/RIGHT HAND SIDE						
					WG 23°	X					
L246	-58	253.620	3	351	927.800	R244	-59	499.920	3	347	730.010
L247	-58	263.000	3	351	891.920	R245	-59	504.680	3	347	712.520
L248	-58	272.380	3	351	856.970	R246	-59	518.900	3	347	659.280
L249	-58	287.090	3	351	804.200	R247	-59	528.090	3	347	623.570
L250	-58	389.120	3	351	452.210	R248	-59	537.220	3	347	586.780
L251	-58	481.490	3	351	133.380	R249	-59	543.590	3	347	559.360
L252	-58	583.290	3	350	782.090	R250	-59	552.360	3	347	516.520
L253	-58	694.410	3	350	398.270	R251	-59	555.910	3	347	498.720
L254	-58	768.310	3	350	143.420	R252	-59	566.430	3	347	444.780
L255	-58	894.360	3	349	709.030	R253	-59	573.040	3	347	409.070
L256	-59	039.230	3	349	208.400	R254	-59	579.220	3	347	372.780
L257	-59	136.590	3	348	872.200	R255	-59	616.220	3	347	141.300
L258	-59	258.500	3	348	451.730	R256	-59	659.620	3	346	869.300
L259	-59	361.260	3	348	097.060	R257	-59	695.930	3	346	641.540
L260	-59	420.120	3	347	893.690	R258	-59	727.280	3	346	444.860
L261	-59	462.580	3	347	746.600	R259	-59	813.000	3	345	909.310
L262	-59	472.460	3	347	711.280	R260	-59	840.540	3	345	737.120
L263	-59	491.370	3	347	640.570	R261	-59	933.350	3	345	155.340
L264	-59	500.290	3	347	605.150	R262	-60	023.210	3	344	592.530
L265	-59	512.870	3	347	551.630	R263	-60	089.690	3	344	175.770
L266	-59	520.510	3	347	515.870	R264	-60	164.800	3	343	705.210
L267	-59	527.780	3	347	479.800	R265	-60	251.170	3	343	166.130
L268	-59	534.620	3	347	444.050	R266	-60	323.470	3	342	713.990
L269	-59	544.460	3	347	390.060	R267	-60	385.990	3	342	322.190
L270	-59	611.130	3	346	974.090	R268	-60	433.490	3	342	024.750
L271	-59	659.610	3	346	670.100	R269	-60	488.380	3	341	680.790
L272	-59	660.410	3	346	668.000	R270	-60	504.220	3	341	683.150
L273	-59	660.100	3	346	666.740	R271	-60	523.990	3	341	602.060
L274	-59	699.940	3	346	417.800	R272	-60	501.960	3	341	595.910
L275	-59	720.110	3	346	291.580	R273	-60	529.770	3	341	422.460
L276	-59	779.760	3	345	917.830	R274	-60	578.420	3	341	116.810
L276X	-59	833.900	3	345	579.430	R275	-60	587.190	3	341	063.110
L277	-59	907.380	3	345	118.490	R276	-60	592.850	3	341	030.760
L278	-59	975.180	3	344	694.400	R277	-60	601.090	3	340	987.590
L279	-60	131.530	3	343	714.600	R278	-60	609.920	3	340	944.240
L280	-60	201.350	3	343	278.340	R279	-60	619.500	3	340	901.170
L281	-60	271.040	3	342	842.540	R280	-60	624.580	3	340	879.800
L282	-60	320.030	3	342	535.330	R281	-60	632.250	3	340	847.670
L283	-60	355.970	3	342	310.270	R282	-60	640.360	3	340	815.600
L284	-60	403.780	3	342	011.550	R283	-60	646.760	3	340	791.040
L285	-60	443.210	3	341	764.970	R284	-60	661.340	3	340	736.810
L286	-60	479.610	3	341	537.100	R285	-60	674.330	3	340	694.440
L287	-60	504.220	3	341	383.350	R286	-60	684.260	3	340	662.500
L288	-60	552.410	3	341	079.980	R287	-60	691.040	3	340	641.440
L289	-60	562.110	3	341	025.670	R288	-60	701.390	3	340	610.040
L290	-60	572.410	3	340	971.750	R289	-60	712.160	3	340	578.750
L291	-60	579.040	3	340	939.290	R290	-60	726.860	3	340	537.210
L292	-60	590.890	3	340	885.530	R291	-60	754.250	3	340	465.150
L293	-60	598.300	3	340	853.620	R292	-60	774.720	3	340	413.990
L294	-60	609.520	3	340	806.390	R293	-60	792.490	3	340	371.980
L295	-60	629.620	3	340	735.310	R294	-60	823.250	3	340	303.200

Vel	19	Van	23	P703/08
Sheet		of		

PADRESERWE KOÖRDINATE / ROAD RESERVE CO-ORDINATES							
LINKERKANT/LEFT HAND SIDE				REGTERKANT/RIGHT HAND SIDE			
				WG 23°	X		
L296	-60	635.680	3 340	714.110	R295	-60	841.990 3 340 263.470
L297	-60	641.940	3 340	692.990	R296	-60	861.320 3 340 223.970
L298	-60	648.400	3 340	671.800	R297	-60	876.250 3 340 194.520
L299	-60	658.350	3 340	640.100	R298	-60	896.590 3 340 155.460
L300	-60	665.210	3 340	619.120	R299	-60	907.000 3 340 136.080
L301	-60	683.000	3 340	567.060	R300	-60	922.980 3 340 107.080
L302	-60	690.300	3 340	546.240	R301	-60	933.550 3 340 087.690
L303	-60	697.800	3 340	525.430	R302	-60	944.370 3 340 068.480
L304	-60	705.470	3 340	504.690	R303	-60	955.470 3 340 049.320
L305	-60	717.110	3 340	473.750	R304	-60	972.230 3 340 020.940
L306	-60	725.050	3 340	453.250	R305	-60	983.670 3 340 001.500
L307	-60	730.450	3 340	439.410	R306	-61	129.450 3 339 806.890
L308	-60	739.040	3 340	418.210	R307	-61	235.070 3 339 678.350
L309	-60	752.210	3 340	386.530	R308	-61	345.360 3 339 543.540
L310	-60	782.110	3 340	317.280	R309	-61	407.230 3 339 483.730
L311	-60	783.230	3 340	313.650	R310	-61	467.240 3 339 406.720
L312	-60	786.020	3 340	310.900	R311	-61	549.620 3 339 294.330
L313	-60	786.960	3 340	307.000	R312	-61	567.180 3 339 274.680
L314	-60	800.870	3 340	277.110	R313	-61	602.950 3 339 234.940
L315	-60	810.300	3 340	257.210	R314	-61	699.210 3 339 129.050
L316	-60	829.350	3 340	217.740	R315	-61	730.050 3 339 078.870
L317	-60	898.950	3 340	085.270	R316	-61	839.170 3 338 943.080
L318	-60	949.930	3 339	995.900	R317	-61	855.470 3 338 922.420
L319	-60	963.510	3 339	973.540	R318	-61	879.620 3 338 890.960
L320	-60	977.750	3 339	951.710	R319	-61	952.310 3 338 801.810
L321	-61	007.720	3 339	905.680	R320	-62	001.510 3 338 766.280
L322	-61	038.970	3 339	857.800	R321	-62	036.620 3 338 713.400
L323	-61	055.380	3 339	833.410	R322	-62	042.970 3 338 704.910
L324	-61	067.890	3 339	815.290	R323	-62	060.860 3 338 673.210
L325	-61	087.200	3 339	788.470	R324	-62	081.660 3 338 635.970
L326	-61	113.310	3 339	752.840	R325	-62	125.420 3 338 542.790
L327	-61	221.630	3 339	613.600	R326	-62	139.640 3 338 512.490
L328	-61	319.420	3 339	494.080	R327	-62	160.780 3 338 463.600
L329	-61	389.250	3 339	408.830	R328	-62	167.020 3 338 421.620
L330	-61	479.990	3 339	297.970	R329	-62	183.840 3 338 363.190
L331	-61	580.800	3 339	174.760	R330	-62	189.320 3 338 341.980
L332	-61	657.090	3 339	082.070	R331	-62	191.890 3 338 330.470
L333	-61	761.350	3 338	953.570	R332	-62	192.250 3 338 319.470
L334	-61	854.810	3 338	839.310	R333	-62	191.730 3 338 297.340
L335	-61	987.440	3 338	677.310	R334	-62	190.250 3 338 253.130
L336	-62	011.000	3 338	648.520	R335	-62	188.890 3 338 220.050
L337	-62	055.150	3 338	589.490	R336	-62	187.360 3 338 198.120
L338	-62	089.730	3 338	538.860	R337	-62	185.250 3 338 176.080
L339	-62	092.910	3 338	531.780	R338	-62	182.320 3 338 155.580
L340	-62	117.660	3 338	465.420	R339	-62	173.780 3 338 110.900
L341	-62	121.280	3 338	453.720	R340	-62	152.820 3 338 003.950
L342	-62	127.370	3 338	431.410	R341	-62	147.330 3 337 973.010
L343	-62	133.190	3 338	408.460	R342	-62	135.020 3 337 888.730
L344	-62	146.160	3 338	354.350	R342X	-62	134.180 3 337 880.010
L345	-62	150.220	3 338	286.460	R343	-62	132.410 3 337 864.360
L346	-62	147.840	3 338	146.430	R344	-62	130.530 3 337 841.030

Vel	20	Van	23	P703/08
Sheet		of		



PADRESERWE KOÖRDINATE / ROAD RESERVE CO-ORDINATES							
LINKERKANT/LEFT HAND SIDE				REGTERKANT/RIGHT HAND SIDE			
				WG 23°	X		
L347	-62	136.180	3 338	109.750	R345	-62	128.540 3 337 796.350
L348	-62	131.160	3 338	060.480	R346	-62	128.130 3 337 763.350
L349	-62	118.490	3 337	989.830	R347	-62	128.590 3 337 727.610
L350	-62	111.160	3 337	945.660	R348	-62	129.690 3 337 699.040
L351	-62	103.600	3 337	890.370	R349	-62	130.210 3 337 688.140
L352	-62	098.960	3 337	836.960	R350	-62	132.300 3 337 660.730
L353	-62	097.860	3 337	814.900	R351	-62	137.600 3 337 612.010
L354	-62	096.860	3 337	781.880	R352	-62	139.160 3 337 600.710
L355	-62	096.810	3 337	771.100	R353	-62	143.820 3 337 568.370
L356	-62	096.980	3 337	734.740	R354	-62	151.990 3 337 524.960
L357	-62	097.610	3 337	715.590	R355	-62	158.900 3 337 492.760
L358	-62	099.930	3 337	671.870	R356	-62	164.230 3 337 471.540
L359	-62	102.990	3 337	639.360	R357	-62	172.740 3 337 439.780
L360	-62	105.250	3 337	618.820	R358	-62	175.740 3 337 429.370
L361	-62	109.810	3 337	583.620	R359	-62	182.220 3 337 408.290
L362	-62	115.600	3 337	548.820	R360	-62	192.630 3 337 377.060
L363	-62	119.950	3 337	525.630	R361	-62	199.970 3 337 356.250
L364	-62	124.530	3 337	502.580	R362	-62	211.580 3 337 325.310
L365	-62	130.040	3 337	479.490	R363	-62	219.790 3 337 304.980
L366	-62	138.930	3 337	445.100	R364	-62	233.010 3 337 274.560
L367	-62	145.180	3 337	422.470	R365	-62	246.930 3 337 244.680
L368	-62	151.680	3 337	399.860	R366	-62	307.090 3 337 127.130
L369	-62	155.030	3 337	388.420	R367	-62	459.210 3 336 832.530
L370	-62	158.700	3 337	377.320	R368	-62	494.290 3 336 764.570
L371	-62	166.800	3 337	354.970	R369	-62	544.350 3 336 667.600
L372	-62	183.470	3 337	310.890	R370	-62	705.850 3 336 355.560
L373	-62	192.360	3 337	289.170	R371	-62	882.400 3 336 013.780
L374	-62	201.750	3 337	267.620	R372	-62	897.360 3 335 983.890
L375	-62	216.700	3 337	235.510	R373	-62	907.000 3 335 963.960
L376	-62	227.010	3 337	214.150	R374	-62	930.350 3 335 913.680
L377	-62	248.600	3 337	172.120	R375	-62	952.220 3 335 862.400
L378	-62	354.550	3 336	966.960	R376	-62	975.810 3 335 802.980
L379	-62	469.390	3 336	744.600	R377	-62	990.400 3 335 761.300
L380	-62	605.480	3 336	480.950	R378	-63	000.890 3 335 730.030
L381	-62	782.210	3 336	138.240	R379	-63	007.610 3 335 708.750
L382	-62	863.000	3 335	982.010	R380	-63	020.700 3 335 666.460
L383	-62	882.370	3 335	942.540	R381	-63	029.340 3 335 634.630
L384	-62	896.460	3 335	912.690	R382	-63	042.470 3 335 581.150
L385	-62	918.700	3 335	862.100	R383	-63	049.830 3 335 548.700
L386	-62	926.960	3 335	841.670	R384	-63	056.440 3 335 516.300
L387	-62	950.340	3 335	780.690	R385	-63	066.170 3 335 461.890
L388	-62	968.300	3 335	728.640	R386	-63	071.670 3 335 429.040
L389	-62	984.800	3 335	676.170	R387	-63	078.170 3 335 385.050
L390	-62	996.940	3 335	634.020	R388	-63	085.650 3 335 330.360
L391	-63	008.010	3 335	591.120	R389	-63	090.000 3 335 297.730
L392	-63	015.510	3 335	558.880	R390	-63	100.460 3 335 221.180
L393	-63	024.460	3 335	515.670	R391	-63	114.060 3 335 122.190
L394	-63	032.550	3 335	472.180	R392	-63	117.570 3 335 096.770
L395	-63	041.480	3 335	417.930	R393	-63	132.040 3 334 991.970
L396	-63	047.870	3 335	374.370	R394	-63	169.780 3 334 719.180
L397	-63	088.470	3 335	079.600	R395	-63	213.400 3 334 402.290

Vel	21	Van	23	P703/08
Sheet		of		

PADRESERWE KOÖRDINATE / ROAD RESERVE CO-ORDINATES											
LINKERKANT/LEFT HAND SIDE					REGTERKANT/RIGHT HAND SIDE						
					WG 23°						
					X						
L398	-63	147.140	3	334	653.720	R396	-63	283.990	3	333	890.470
L399	-63	196.790	3	334	293.860	R397	-63	354.560	3	333	379.680
L400	-63	253.940	3	333	879.210	R398	-63	412.190	3	332	961.200
L401	-63	300.640	3	333	541.190	R399	-63	443.080	3	332	736.920
L402	-63	310.870	3	333	466.970	R400	-63	483.400	3	332	445.380
L403	-63	347.600	3	333	200.470	R401	-63	495.390	3	332	358.590
L404	-63	382.400	3	332	948.090	R402	-63	558.620	3	331	902.000
L405	-63	395.960	3	332	849.710	R403	-63	595.150	3	331	638.170
L406	-63	439.620	3	332	532.840	R404	-63	636.930	3	331	335.790
L407	-63	473.030	3	332	291.740	R405	-63	677.230	3	331	043.620
L408	-63	530.710	3	331	874.600	R406	-63	731.060	3	330	653.630
L409	-63	590.140	3	331	444.570	R407	-63	786.480	3	330	253.540
L410	-63	631.910	3	331	142.160	R408	-63	801.640	3	330	145.010
L411	-63	675.150	3	330	829.410	R409	-63	822.620	3	329	993.170
L412	-63	712.390	3	330	560.150	R410	-63	846.500	3	329	820.010
L413	-63	761.940	3	330	202.740	R411	-63	890.990	3	329	495.920
L414	-63	790.330	3	329	996.260	R412	-63	923.810	3	329	257.710
L415	-63	830.630	3	329	702.810	R413	-63	966.940	3	328	944.490
L416	-63	889.350	3	329	274.780	R414	-64	008.250	3	328	642.120
L417	-63	943.170	3	328	883.060	R415	-64	060.500	3	328	259.320
L418	-63	998.010	3	328	482.820	R416	-64	098.890	3	327	977.720
L419	-64	049.740	3	328	106.440	R417	-64	103.300	3	327	945.370
L420	-64	068.880	3	327	967.060	R418	-64	105.860	3	327	923.620
L421	-64	071.710	3	327	945.540	R419	-64	112.190	3	327	869.440
L422	-64	074.450	3	327	924.010	R420	-64	123.540	3	327	771.880
L423	-64	082.040	3	327	859.570	R421	-64	131.990	3	327	649.580
L424	-64	086.640	3	327	816.610	R422	-64	133.670	3	327	619.800
L425	-64	088.730	3	327	795.000	R423	-64	135.840	3	327	576.460
L426	-64	090.730	3	327	773.620	R424	-64	138.450	3	327	521.560
L427	-64	093.530	3	327	741.180	R425	-64	147.020	3	327	335.920
L428	-64	096.130	3	327	708.650	R426	-64	158.150	3	327	096.370
L429	-64	098.297	3	327	689.900	R427	-64	171.370	3	326	801.740
L430	-64	099.420	3	327	667.550	R428	-64	185.320	3	326	496.640
L431	-64	101.080	3	327	652.600	R429	-64	199.700	3	326	180.370
L432	-64	112.390	3	327	404.210	R430	-64	214.180	3	325	863.900
L433	-64	131.280	3	326	990.130	R431	-64	226.800	3	325	590.960
L434	-64	151.180	3	326	554.570	R432	-64	240.160	3	325	296.390
L435	-64	166.200	3	326	227.040	R433	-64	256.080	3	324	947.570
L436	-64	181.400	3	325	891.410	R434	-64	273.890	3	324	556.920
L437	-64	199.770	3	325	489.930	R435	-64	286.220	3	324	284.310
L438	-64	217.300	3	325	108.540	R436	-64	303.635	3	323	956.784
L439	-64	235.730	3	324	706.590	R437	-64	304.760	3	323	881.880
L440	-64	254.090	3	324	305.000	R438	-64	318.730	3	323	578.990
L441	-64	272.760	3	323	897.640	R439	-64	337.150	3	323	185.980
L442	-64	290.320	3	323	512.720	R440	-64	355.600	3	322	791.460
L443	-64	308.375	3	323	142.877	R441	-64	378.770	3	322	265.150
L444	-64	326.770	3	322	717.500	R442	-64	393.110	3	321	948.100
L445	-64	346.390	3	322	288.490	R443	-64	410.630	3	321	563.620
L446	-64	378.670	3	321	575.310	R444	-64	429.620	3	321	147.880
L447	-64	417.680	3	320	714.570	R445	-64	449.390	3	320	706.400
L448	-64	435.990	3	320	314.290	R446	-64	467.150	3	320	325.270

Vel	22	Van	23	P703/08
Sheet		of		

PADRESERWE KOÖRDINATE / ROAD RESERVE CO-ORDINATES											
LINKERKANT/LEFT HAND SIDE					REGTERKANT/RIGHT HAND SIDE						
					WG 23°		X				
L449	-64	454.110	3	319	921.480	R447	-64	475.740	3	320	139.560
L450	-64	490.750	3	319	123.950	R448	-64	489.320	3	319	845.120
L451	-64	497.170	3	318	984.860	R449	-64	500.830	3	319	595.130
L452	-64	509.580	3	318	723.220	R450	-64	516.280	3	319	257.780
L453	-64	516.460	3	318	577.560	R451	-64	527.330	3	319	014.320
L454	-64	538.000	3	318	123.700	R452	-64	540.780	3	318	729.180
L455	-64	559.340	3	317	671.500	R453	-64	549.100	3	318	553.290
L456	-64	574.390	3	317	350.330	R454	-64	570.620	3	318	101.080
L457	-64	595.950	3	316	897.320	R455	-64	592.050	3	317	649.240
L458	-64	613.890	3	316	517.320	R456	-64	599.650	3	317	488.600
L459	-64	627.660	3	316	224.880	R457	-64	614.060	3	317	182.140
L460	-64	635.280	3	316	064.230	R458	-64	635.860	3	316	715.010
L461	-64	646.450	3	315	831.000	R459	-64	643.450	3	316	554.460
L462	-64	666.860	3	315	399.700	R460	-64	656.810	3	316	269.770
L463	-64	679.190	3	315	135.510	R461	-64	714.220	3	316	278.850
L464	-64	690.950	3	314	888.470	R462	-64	720.080	3	316	161.890
L465	-64	675.330	3	314	887.920	R463	-64	666.060	3	316	076.670
L466	-64	692.380	3	314	528.750	R464	-64	678.600	3	315	814.530
L467	-64	701.160	3	314	348.540	R465	-64	701.170	3	315	347.590
L468	-64	705.480	3	314	300.760	R466	-64	709.690	3	315	172.040
L469	-64	780.470	3	314	071.490	R467	-64	722.810	3	314	895.040
L470	-64	863.340	3	313	913.970	R468	-64	738.050	3	314	558.800
L471	-64	846.050	3	313	872.250	R469	-64	740.860	3	314	494.520
L472	-64	848.860	3	313	871.010	R470	-64	754.670	3	314	363.840
L473	-64	915.130	3	313	841.830	R471	-64	758.090	3	314	330.110
L474	-64	941.650	3	313	830.160	R472	-64	764.670	3	314	291.650
L475	-64	954.540	3	313	814.100	R473	-64	771.410	3	314	240.710
L476	-64	948.470	3	313	800.260	R474	-64	793.950	3	314	155.430
L477	-64	944.900	3	313	791.540	R475	-64	825.390	3	314	081.950
L478	-64	961.480	3	313	784.460	R476	-64	899.500	3	313	948.190
L479	-65	017.080	3	313	721.720	R477	-64	911.090	3	313	926.650
L480	-65	066.230	3	313	666.210	R478	-64	970.240	3	313	849.880
L481	-65	268.060	3	313	470.920	R479	-64	983.520	3	313	833.010
L482	-65	497.350	3	313	326.610	R480	-65	000.860	3	313	810.110
L483	-65	629.670	3	313	243.030	R481	-65	018.540	3	313	797.030
L484	-65	782.230	3	313	147.590	R482	-65	038.470	3	313	782.290
L485	-66	302.260	3	312	820.540	R483	-65	083.260	3	313	736.830
L486	-66	321.060	3	312	827.430	R484	-65	143.060	3	313	676.130
L487	-66	560.250	3	312	677.200	R485	-65	272.320	3	313	545.680
L488	-66	813.730	3	312	517.940	R486	-65	276.920	3	313	525.620
						R487	-65	434.340	3	313	416.330
						R488	-65	460.680	3	313	422.360
						R489	-65	632.840	3	313	314.580
						R490	-65	675.890	3	313	270.990
						R491	-65	834.370	3	313	170.990
						R492	-66	154.940	3	312	968.900
						R493	-66	295.430	3	312	880.710
						R494	-66	333.960	3	312	856.600
						R495	-66	562.580	3	312	712.890
						R496	-66	830.430	3	312	544.500

Vel	23	Van	23	P703/08
Sheet		of		