

# Government Gazette Staatskoerant

REPUBLIC OF SOUTH AFRICA  
REPUBLIEK VAN SUID-AFRIKA

Vol. 544

Pretoria, 13 October  
Oktober 2010

No. 33625

**IMPORTANT NOTICE**

The Government Printing Works will not be held responsible for faxed documents not received due to errors on the fax machine or faxes received which are unclear or incomplete. Please be advised that an "OK" slip, received from a fax machine, will not be accepted as proof that documents were received by the GPW for printing. If documents are faxed to the GPW it will be the sender's responsibility to phone and confirm that the documents were received in good order.

Furthermore the Government Printing Works will also not be held responsible for cancellations and amendments which have not been done on original documents received from clients.

**CONTENTS****INHOUD**

<i>No.</i>	<i>Page No.</i>	<i>Gazette No.</i>	<i>No.</i>	<i>Bladsy No.</i>	<i>Koerant No.</i>
<b>GOVERNMENT NOTICE</b>			<b>GOEWERMENSKENNISGEWING</b>		
<b>Transport, Department of</b>			<b>Vervoer, Departement van</b>		
<i>Government Notice</i>			<i>Goewermenskennisgewing</i>		
899			899		
South African National Roads Agency Limited and the National Roads Act (7/1998): The South African National Roads Agency Limited: Declaration amendment of National Road D1120 Section 1: Amendment of Declaration No. 784 of 2000 .....	3	33625	Suid-Afrikaanse Nasionale Padagentskap Beperk en die Nasionale Paaie Wet (7/1998): Die Suid-Afrikaanse Nasionale Padagentskap Beperk: Verklaring wysiging van Nasionale Pad D1120 Seksie 1: Wysiging van Verklaring No. 784 van 2000.....	4	33625

---

## GOVERNMENT NOTICE

---

### DEPARTMENT OF TRANSPORT

No. 899

13 October 2010

## THE SOUTH AFRICAN NATIONAL ROADS AGENCY LIMITED

Registration No: 98/09584/06

---

### DECLARATION AMENDMENT OF NATIONAL ROAD D1120 SECTION 1

AMENDMENT OF DECLARATION No. 784 OF 2000

By virtue of section 40(1)(b) of the South African National Roads Agency Limited and the National Roads Act, 1998 (Act No. 7 of 1998), I hereby amend Declaration No. 784 of 2000 by substituting paragraph D of the schedule thereof, with the subjoined sheets 1 to 3 of Plan No. P743/09.

(National Road D1120 Section 1: Komatipoort – Crocodile River)



MINISTER OF TRANSPORT

---

## GOEWERMENSKENNISGEWING

---

### DEPARTEMENT VAN VERVOER

No. 899

13 Oktober 2010

## DIE SUID-AFRIKAANSE NASIONALE PADAGENTSKAP BEPERK

Registrasie No: 98/09584/06

---

### VERKLARING WYSIGING VAN NASIONALE PAD D1120 SEKSIE 1.

WYSIGING VAN VERKLARING NO. 784 VAN 2000.

Kragtens Artikel 40(1)(b) van die Suid-Afrikaanse Nasionale Padagentskap Beperk en die Nasionale Paaie Wet, 1998 (Wet no.7 van 1998), wysig ek hiermee Verklaring no. 784 van 2000 deur paragraaf D van die skedule daarvan, te vervang met meegaande velle 1 tot 3 van Plan no. P743/09.

(Nasionale Pad D1120 Seksie 1: Komatipoort - Krokodilrivier)

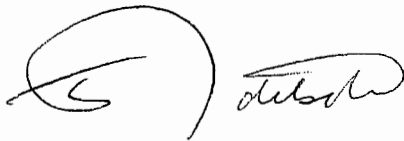

MINISTER VAN VERVOER

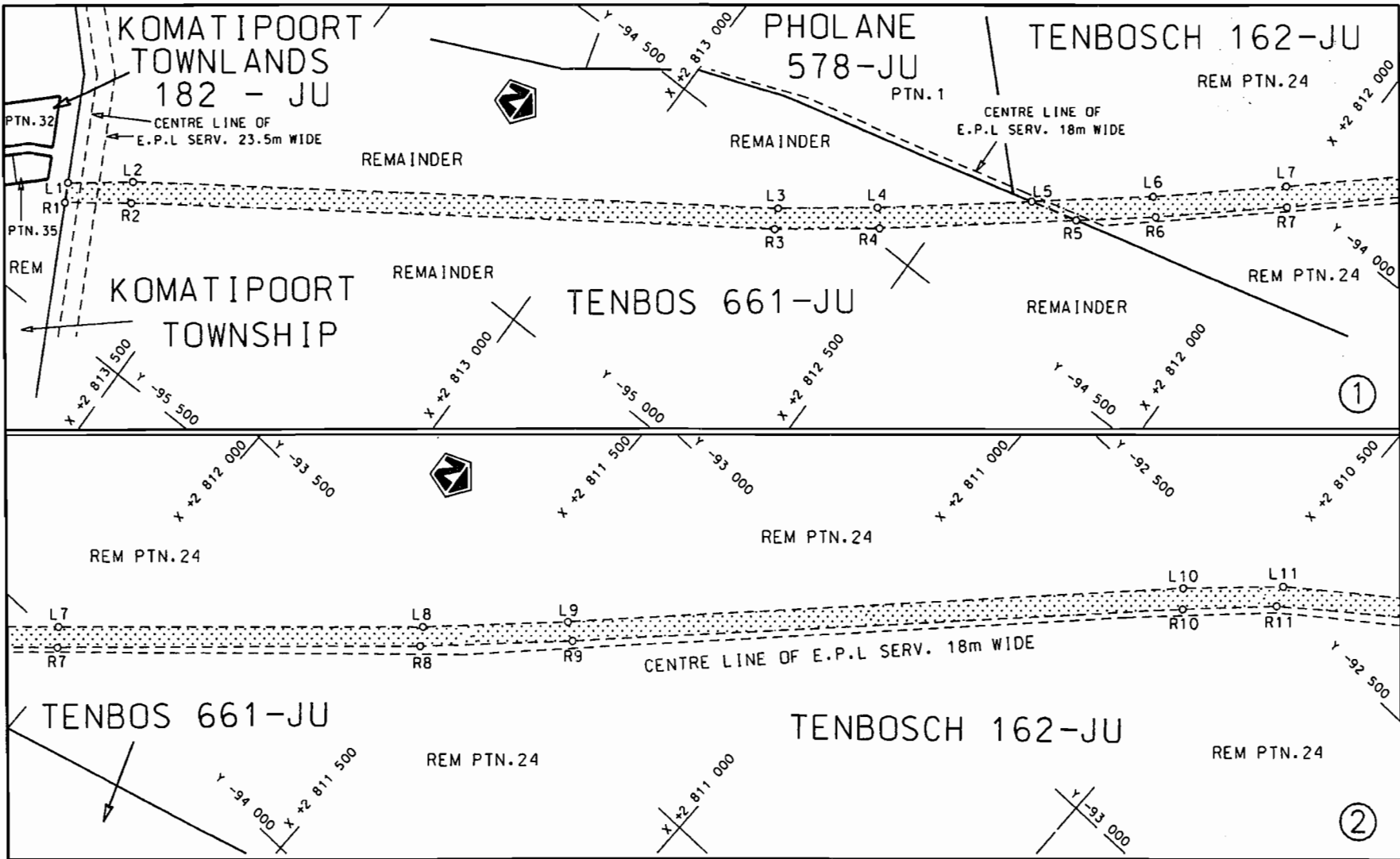

Die Suid Afrikaanse Nasionale Podagentskap Beperk  
 The South African National Roads Agency Limited

Die figuur getoon  
 The figure shown



stel die padreserwe voor van 'n gedeelte  
 represents the road reserve of a portion  
 van Nasionale Roete D1120 Seksie 1  
 of National Route of National Route Section 1

Vel Sheet 1 van of 3  
 Plan P743/09

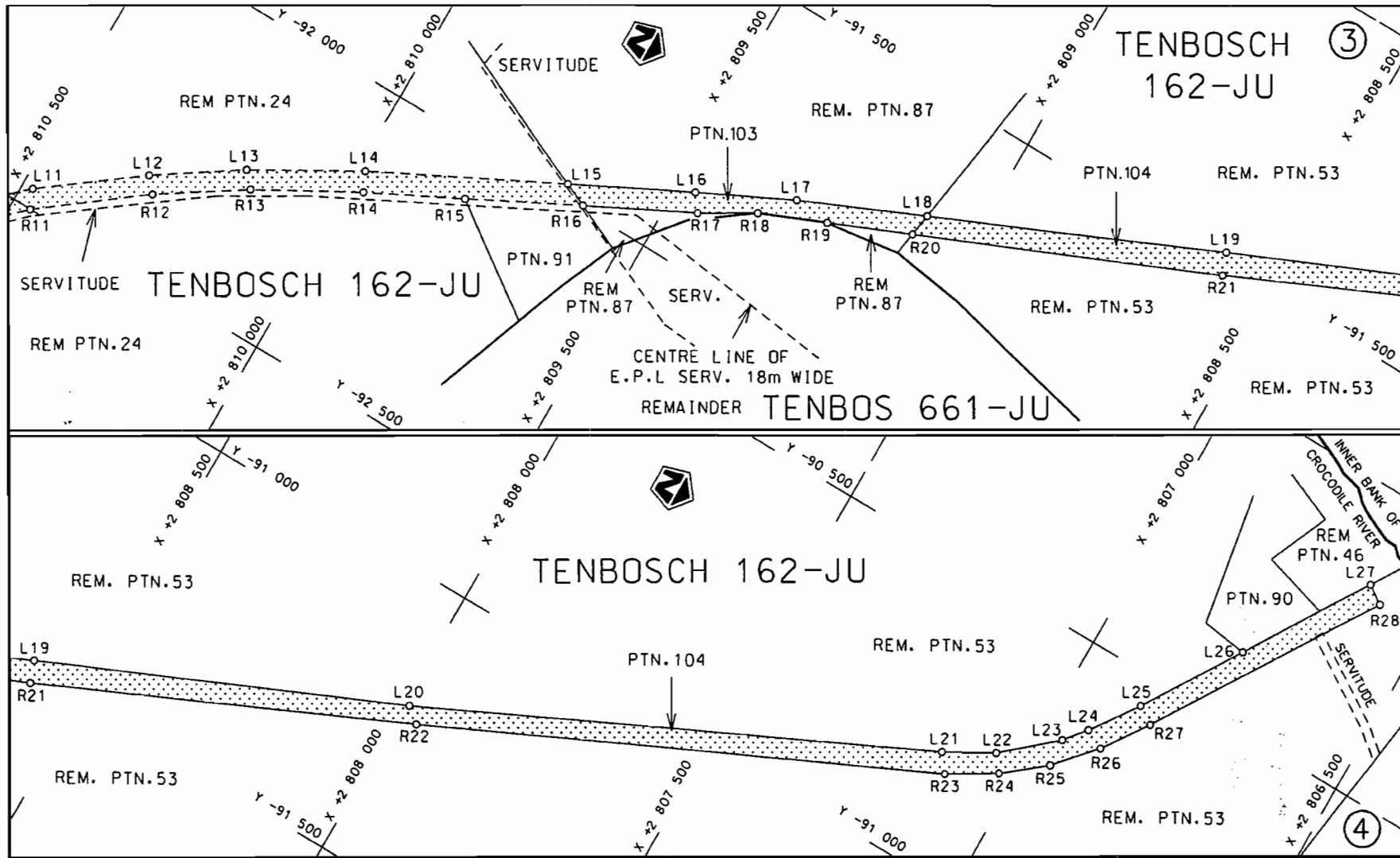

<p>Die Suid Afrikaanse Nasionale Padagentskap Beperk The South African National Roads Agency Limited</p>	<p>Die figuur getoon The figure shown</p>		<p>steldie padreserwe voor van 'n gedeelte represents the road reserve of a portion van Nasionale Roete D1120 Sektie of National Route Section 1</p>	<p>Vel Sheet 2 van 3 of at of 3 Plan P743/09</p>
--	---	--	--	--

PADRESERWE KOÖRDINATE / ROAD RESERVE CO-ORDINATES									
LINKERKANT/LEFT HAND SIDE					REGTERKANT/RIGHT HAND SIDE				
	Y	X	WG 31°		Y	X			
L1	-95 291.160	2 813	770.250	R1	-95 321.350	2 813	753.990		
L2	-95 219.570	2 813	678.840	R2	-95 250.330	2 813	659.210		
L3	-94 562.320	2 812	743.920	R3	-94 594.520	2 812	726.950		
L4	-94 453.690	2 812	603.640	R4	-94 480.070	2 812	579.210		
L5	-94 278.150	2 812	392.510	R5	-94 255.890	2 812	309.560		
L6	-94 139.700	2 812	225.990	R6	-94 165.300	2 812	200.590		
L7	-93 981.150	2 812	048.170	R7	-94 009.330	2 812	025.330		
L8	-93 547.240	2 811	567.330	R8	-93 575.440	2 811	548.440		
L9	-93 368.970	2 811	383.320	R9	-93 388.190	2 811	355.090		
L10	-92 589.300	2 810	610.590	R10	-92 617.020	2 810	587.110		
L11	-92 467.510	2 810	480.640	R11	-92 500.610	2 810	466.740		
L12	-92 342.790	2 810	314.460	R12	-92 367.960	2 810	292.650		
L13	-92 245.240	2 810	170.300	R13	-92 271.150	2 810	146.920		
L14	-92 140.190	2 809	987.950	R14	-92 173.460	2 809	972.270		
L15	-91 976.880	2 809	668.460	R15	-92 091.460	2 809	812.070		
L16	-91 874.090	2 809	467.380	R16	-91 995.280	2 809	626.710		
L17	-91 793.460	2 809	305.920	R17	-91 902.790	2 809	445.990		
L18	-91 698.420	2 809	092.760	R18	-91 847.630	2 809	354.030		
L19	-91 480.300	2 808	603.560	R19	-91 798.960	2 809	239.080		
L20	-91 211.060	2 807	990.420	R20	-91 738.520	2 809	099.420		
L21	-90 800.440	2 807	137.150	R21	-91 517.840	2 808	589.470		
L22	-90 752.250	2 807	051.880	R22	-91 232.790	2 807	963.540		
L23	-90 673.170	2 806	961.660	R23	-90 830.310	2 807	113.790		
L24	-90 635.430	2 806	930.900	R24	-90 779.800	2 807	030.130		
L25	-90 552.550	2 806	872.540	R25	-90 721.590	2 806	958.490		
L26	-90 379.800	2 806	763.030	R26	-90 651.770	2 806	896.650		
L27	-90 162.820	2 806	626.310	R27	-90 571.930	2 806	841.450		
				R28	-90 184.800	2 806	594.500		

Vel 3	Van 3	P743/09
Sheet	of	