

# Government Gazette Staatskoerant

REPUBLIC OF SOUTH AFRICA  
REPUBLIEK VAN SUID-AFRIKA

Vol. 544

Pretoria, 15 October  
Oktober 2010

**No. 33634**

**IMPORTANT NOTICE**

The Government Printing Works will not be held responsible for faxed documents not received due to errors on the fax machine or faxes received which are unclear or incomplete. Please be advised that an "OK" slip, received from a fax machine, will not be accepted as proof that documents were received by the GPW for printing. If documents are faxed to the GPW it will be the sender's responsibility to phone and confirm that the documents were received in good order.

Furthermore the Government Printing Works will also not be held responsible for cancellations and amendments which have not been done on original documents received from clients.

**CONTENTS****INHOUD**

<i>No.</i>	<i>Page No.</i>	<i>Gazette No.</i>	<i>No.</i>	<i>Bladsy No.</i>	<i>Koerant No.</i>
<b>GOVERNMENT NOTICE</b>			<b>GOEWERMENSKENNISGEWING</b>		
<b>Transport, Department of</b>			<b>Vervoer, Departement van</b>		
<i>Government Notice</i>			<i>Goewermenskennisgewing</i>		
908			908		
South African National Roads Agency Limited and the National Roads Act (7/1998): The South African National Roads Agency Limited: Declaration amendment of National Road N18 Section 6: Amendment of Declaration No. 731 of 2005 .....			Suid-Afrikaanse Nasionale Padagentskap Beperk en die Nasionale Paaie Wet (7/1998): Die Suid-Afrikaanse Nasionale Padagentskap Beperk: Verklaring wysiging van Nasionale Pad N18 Seksie 6: Wysiging van Verklaring No. 731 van 2005 .....		
	3	33634		4	33634

---

## GOVERNMENT NOTICE

---

### DEPARTMENT OF TRANSPORT

No. 908

15 October 2010

## THE SOUTH AFRICAN NATIONAL ROADS AGENCY LIMITED

Registration No: 98/09584/06

---

### DECLARATION AMENDMENT OF NATIONAL ROAD N18 SECTION 6

#### AMENDMENT OF DECLARATION NO. 731 OF 2005

By virtue of section 40(1)(b) of the South African National Roads Agency Limited and the National Roads Act, 1998 (Act No. 7 of 1998), I hereby amend Declaration No. 731 of 2005 by substituting the Annexure paragraph (III), the descriptive section from Neverset up to Mafikeng, with the subjoined sheets 1 to 8 of Plan No. P729/08.

**(National Road N18 Section 6: Neverset - Mafikeng)**



---

MINISTER OF TRANSPORT

---

## GOEWERMENTSKENNISGEWING

---

### DEPARTEMENT VAN VERVOER

No. 908

15 Oktober 2010

## DIE SUID-AFRIKAANSE NASIONALE PADAGENTSKAP BEPERK

Registrasie No: 98/09584/06

---

### VERKLARING WYSIGING VAN NASIONALE PAD N18 SEKSIE 6

WYSIGING VAN VERKLARING NO. 731 VAN 2005

Kragtens Artikel 40(1)(b) van die Suid-Afrikaanse Nasionale Padagentskap Beperk en die Nasionale Paaie Wet, 1998 (Wet no.7 van 1998), wysig ek hiermee Verklaring no. 731 van 2005 deur die Bylae paragraaf (III), die beskrywende gedeelte vanaf Neverset tot by Mafikeng, te vervang met meegaande velle 1 tot 8 van Plan no. P729/08.

(Nasionale Pad N18 Seksie 6 Neverset - Mafikeng)



MINISTER VAN VERVOER

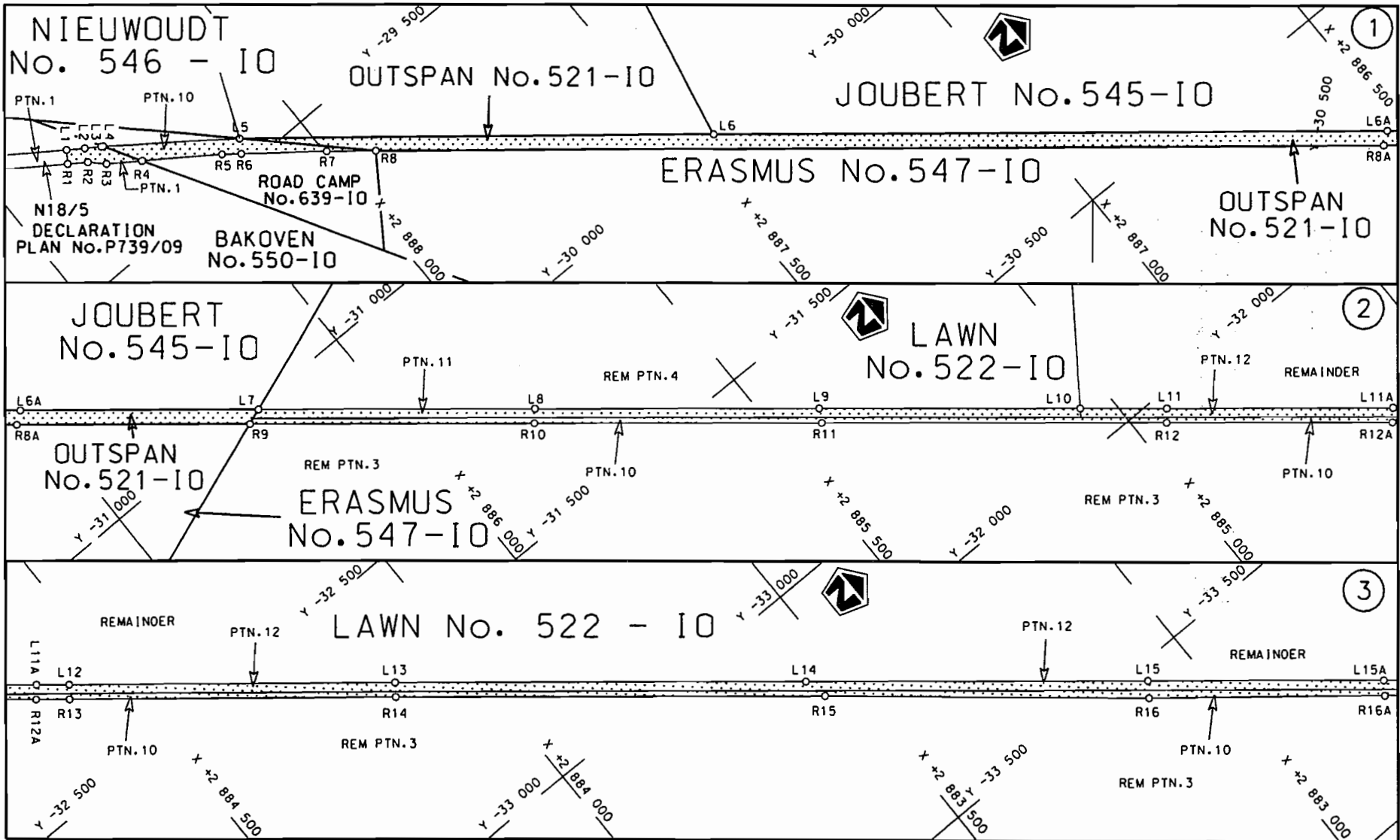

Suid-Afrikaanse Padagentskap Bpk.  
South African National Roads Agency Ltd.

Die figuur getoon  
The figure shown

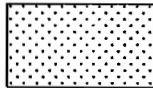

steldie padreserwe voor van 'n gedeelte  
represents the road reserve of a portion  
von Nasionale Raete N18 Seksie  
of National Route N18 Section 6

Vel Sheet 1 van of 8

Plan P729/08

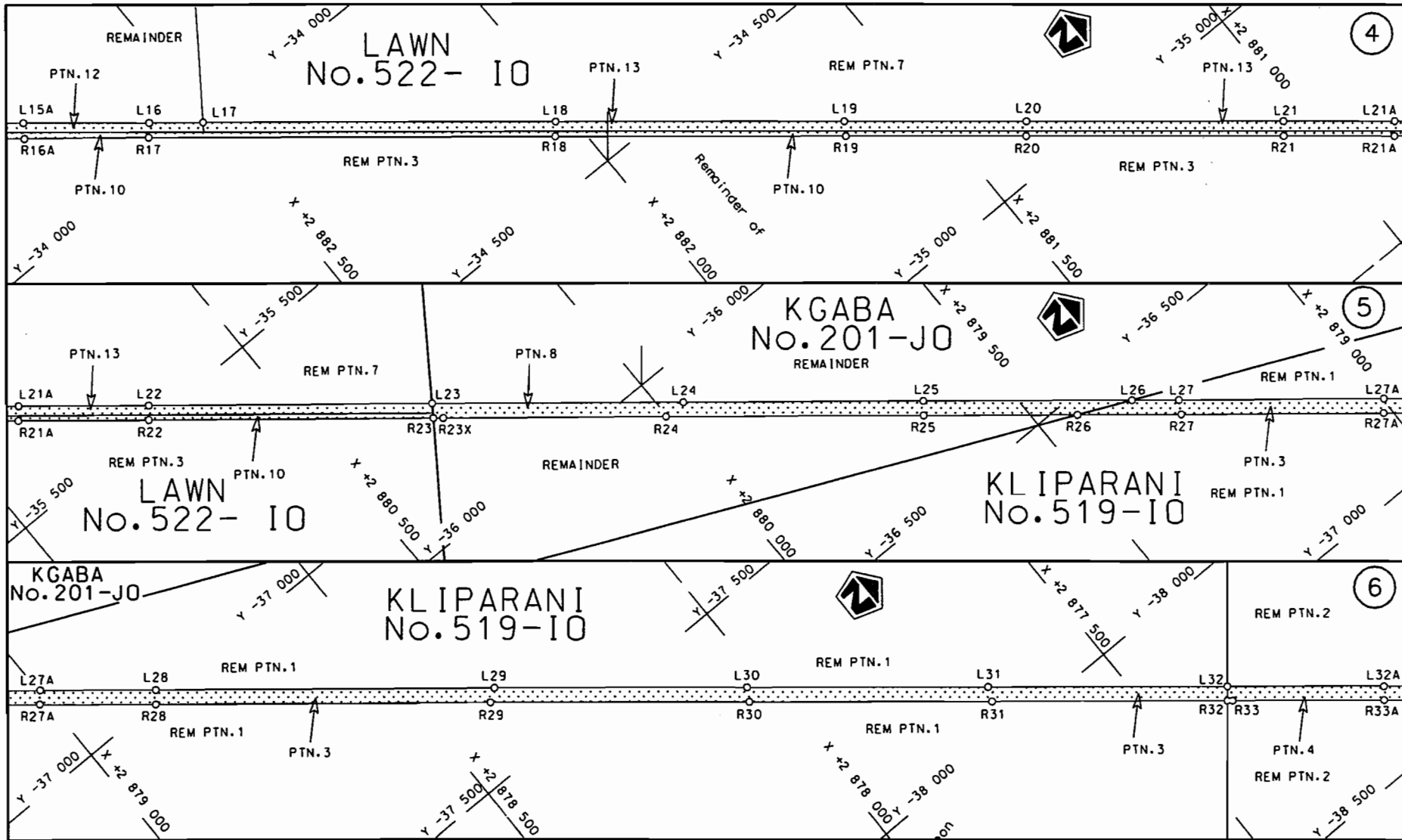

<p>Suid-Afrikaanse Podogentskap Bpk. South African National Roads Agency Ltd.</p>	<p>Die figuur getoon The figure shown</p> 	<p>steldie podogentse voor van 'n gedeelte represents the road reserve of a portion van Nasionale Roete N18 of National Route N18</p> <p>Seksie Section 6</p>	<p>Vel Sheet 2 van of 8 Plan P728/08</p>
---	--	---	--

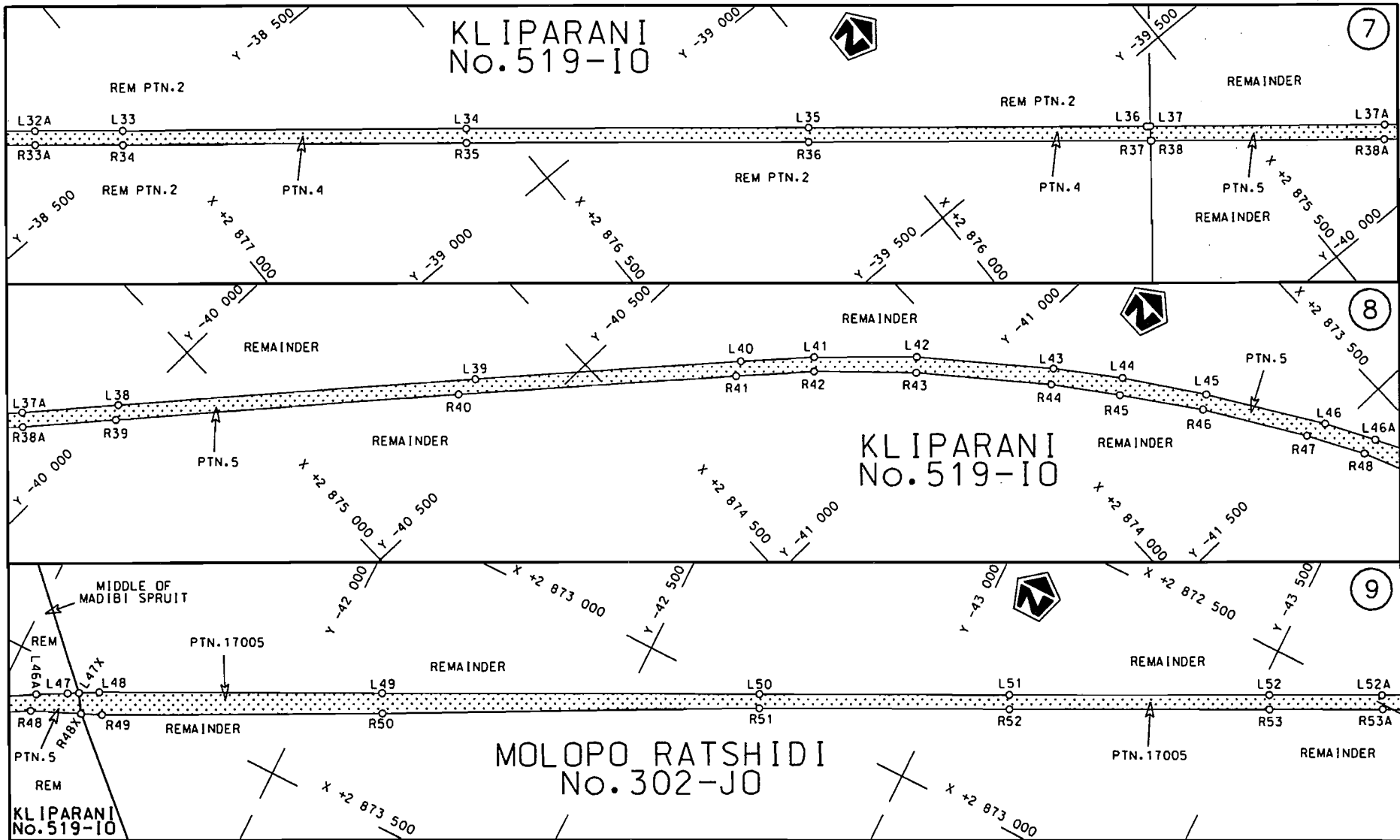

Suid-Afrikaanse Padagentskap Bpk.  
South African National Roads Agency Ltd.

Die figuur getoon  
The figure shown

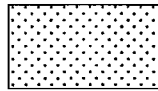

stel die padreserwe voor van 'n gedeelte  
represents the road reserve of a portion  
van Nasionale Roete N18  
of National Route N18

Seksie 6  
Section 6

Vel 3 van 8  
Sheet 3 of 8  
Plan P729/08

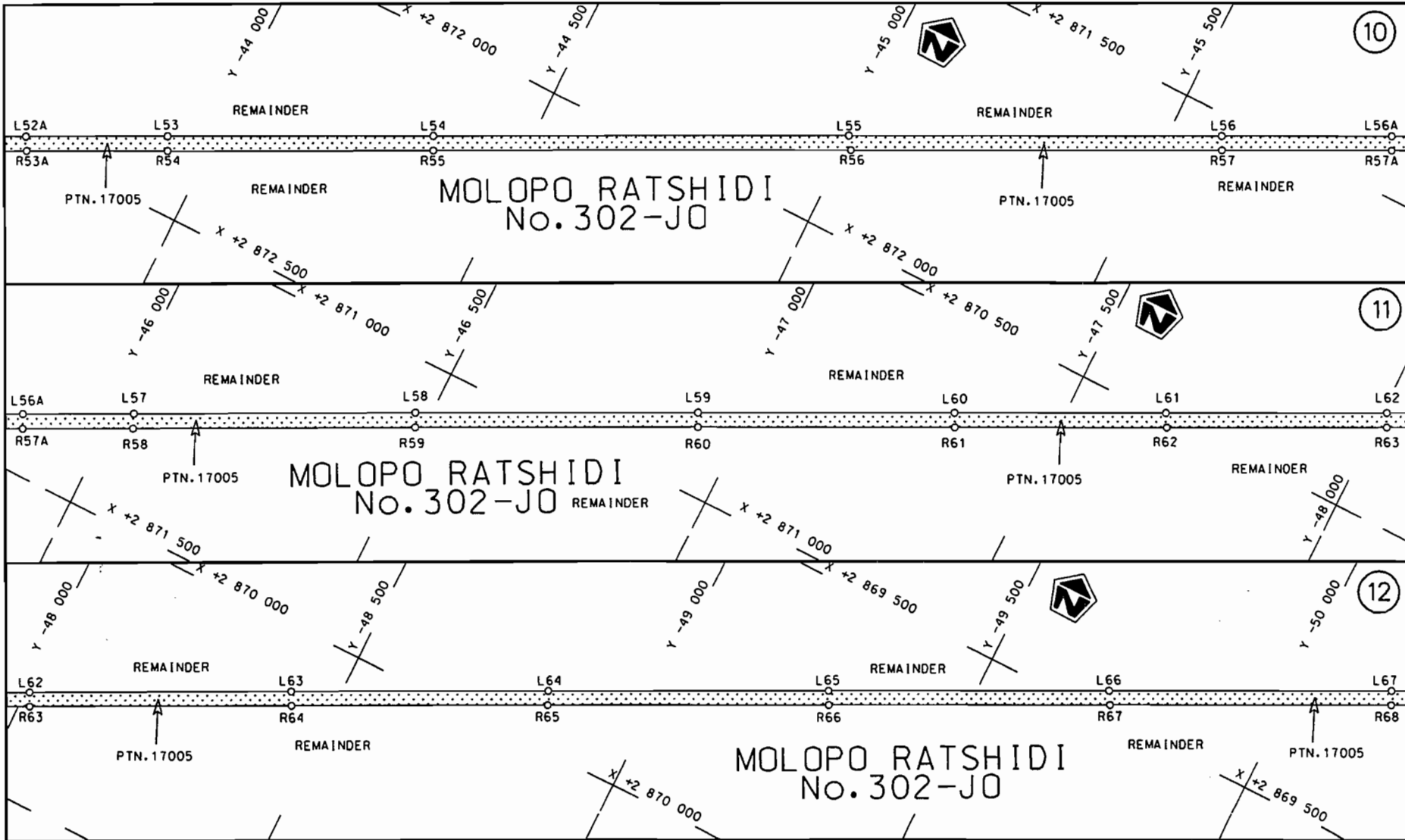

Suid-Afrikaanse Padagentskap Bpk.  
South African National Roads Agency Ltd.

Die figuur getoon  
The figure shown



st die padreserwe voor van 'n gedeelte  
represents the road reserve of a portion  
van Nasionale Roete N18 Sektie  
of National Route N18 Section

6

Vel  
Sheet 4 van 8

Plan P729/08



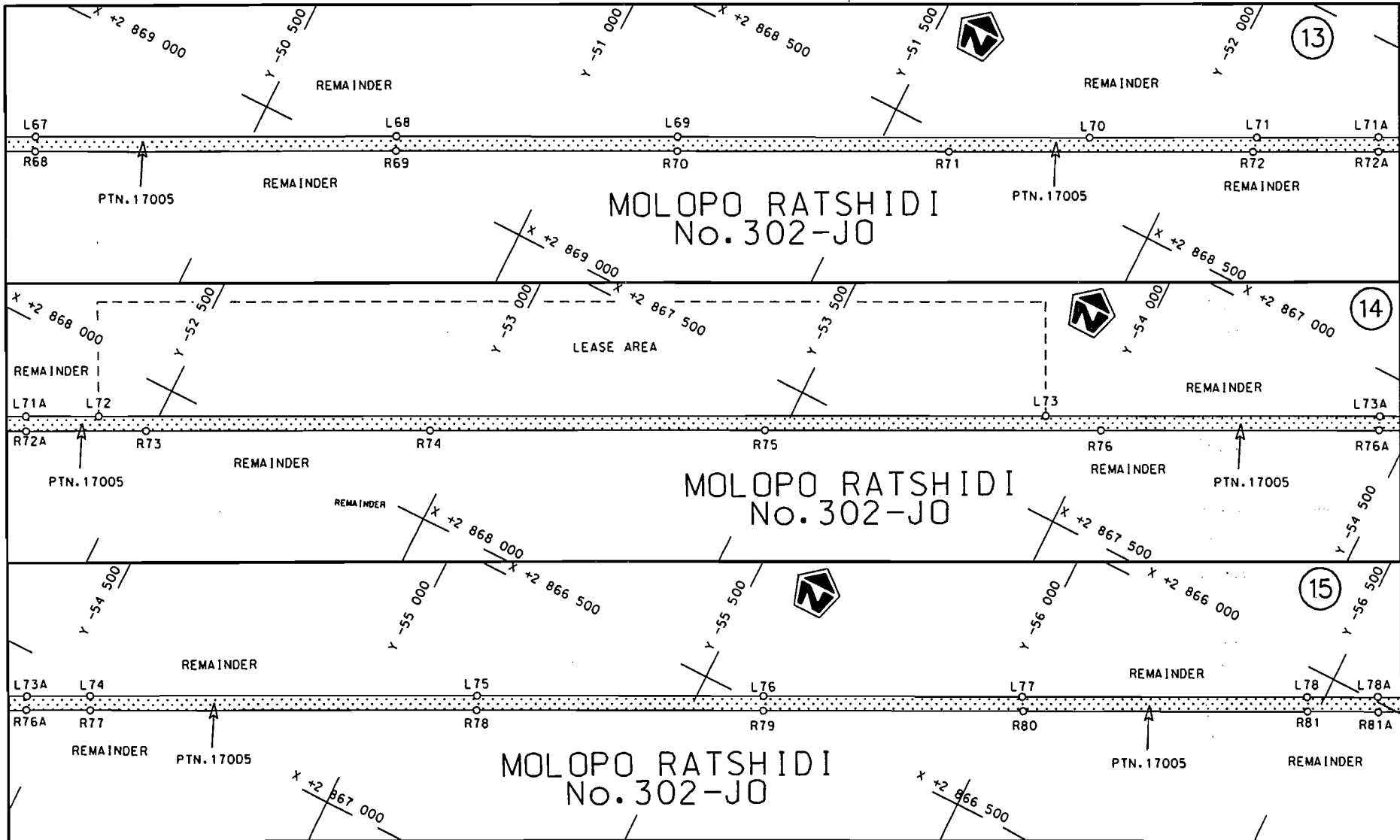

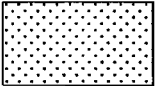
Suid-Afrikaanse Padagentskap Bpk. South African National Roads Agency Ltd.	Die figuur getoon The figure shown	 steldie podreserwe voor van 'n gedeelte represents the road reserve of a portion van Nasionale Raete of National Route	Vel Sheet 5 van 8 Plan P729/08
N18      Seksie      6			

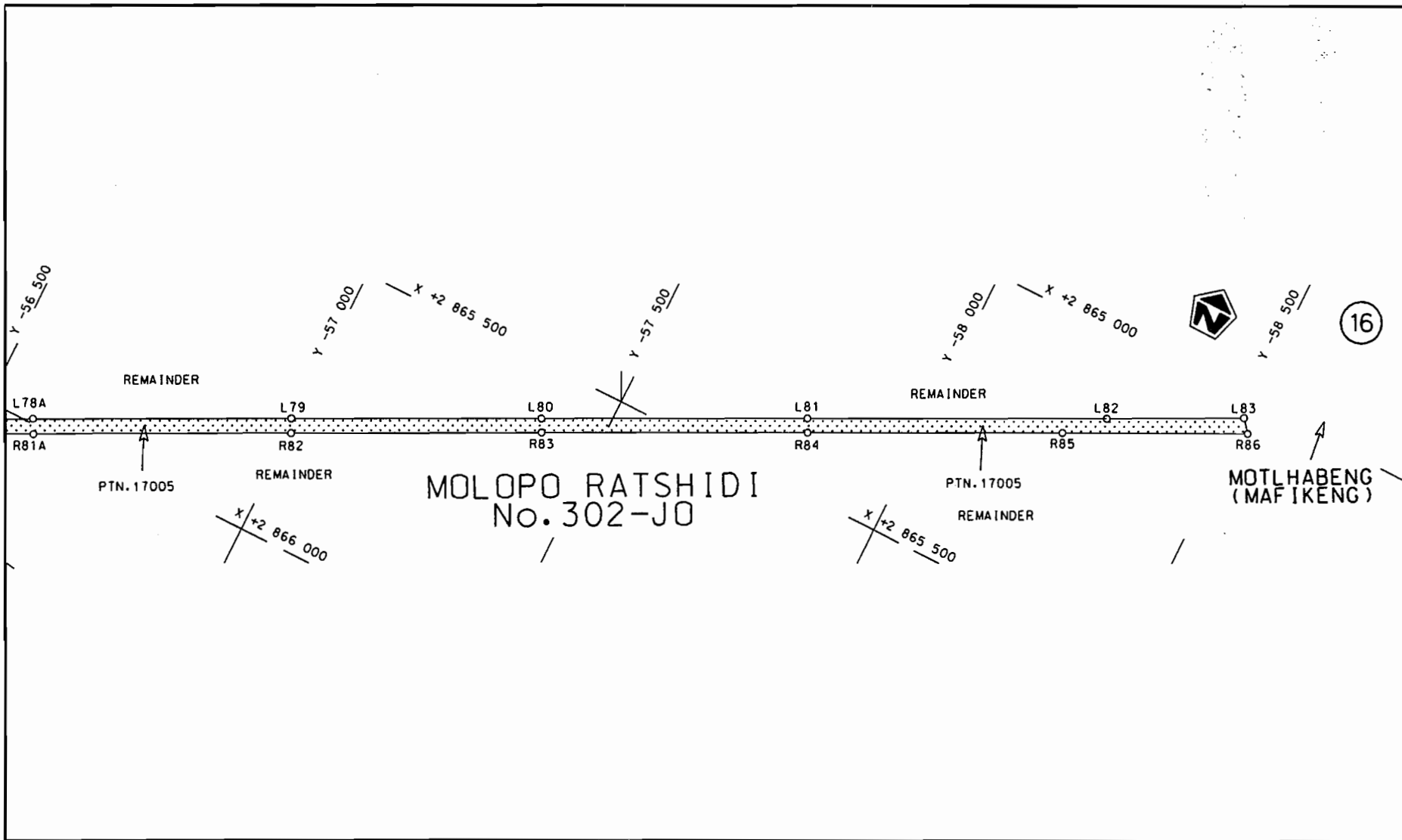

<p>Suid-Afrikaanse Padagentskap Bpk. South African National Roads Agency Ltd.</p>	<p>Die figuur getoon The figure shown</p> 	<p>steldie padreserwe voor van 'n gedeelte represents the road reserve of a portion van Nasionale Roete N18 of National Route N18</p> <p>Seksie Section 6</p>	<p>Vel Sheet 6 van of 8 Plan P729/08</p>
---	--	---	--

PADRESERWE KOÖRDINATE				/	ROAD RESERVE CO-ORDINATES			
LINKERKANT/LEFT HAND SIDE					REGTERKANT/RIGHT HAND SIDE			
	Y	X	WG	25°	Y	X		
L1	-29 271.160	2 888 352.360		R1	-29 291.730	2 888 366.530		
L2	-29 289.980	2 888 325.410		R2	-29 312.450	2 888 336.820		
L3	-29 306.550	2 888 300.660		R3	-29 336.070	2 888 313.000		
L4	-29 308.590	2 888 297.890		R4	-29 372.940	2 888 260.320		
L5	-29 452.920	2 888 101.790		R5	-29 454.750	2 888 143.440		
L6	-29 981.070	2 887 448.140		R6	-29 475.630	2 888 116.470		
L7	-31 007.100	2 886 185.960		R7	-29 569.180	2 887 995.960		
L8	-31 316.500	2 885 805.520		R8	-29 623.710	2 887 928.450		
L9	-31 634.590	2 885 414.320		R9	-31 017.180	2 886 213.740		
L10	-31 928.620	2 885 053.060		R10	-31 335.650	2 885 822.470		
L11	-32 026.850	2 884 932.570		R11	-31 657.000	2 885 427.080		
L12	-32 317.460	2 884 574.800		R12	-32 046.210	2 884 948.780		
L13	-32 684.420	2 884 123.580		R13	-32 337.620	2 884 590.410		
L14	-33 143.590	2 883 559.150		R14	-32 704.600	2 884 138.960		
L15	-33 529.380	2 883 084.880		R15	-33 185.070	2 883 548.420		
L16	-33 934.810	2 882 586.160		R16	-33 553.730	2 883 102.490		
L17	-33 995.320	2 882 510.540		R17	-33 953.700	2 882 602.830		
L18	-34 389.430	2 882 027.340		R18	-34 408.420	2 882 043.770		
L19	-34 711.510	2 881 631.480		R19	-34 732.470	2 881 645.490		
L20	-34 915.470	2 881 380.660		R20	-34 934.860	2 881 396.700		
L21	-35 203.630	2 881 026.370		R21	-35 223.350	2 881 042.170		
L22	-35 472.960	2 880 695.220		R22	-35 492.580	2 880 711.380		
L23	-35 789.790	2 880 305.070		R23	-35 811.040	2 880 319.960		
L24	-36 069.950	2 879 962.140		R23X	-35 822.170	2 880 306.280		
L25	-36 338.470	2 879 631.470		R24	-36 069.830	2 880 001.850		
L26	-36 571.940	2 879 344.630		R25	-36 358.330	2 879 647.080		
L27	-36 624.870	2 879 279.620		R26	-36 530.750	2 879 435.210		
L28	-36 983.620	2 878 838.240		R27	-36 646.920	2 879 292.470		
L29	-37 362.050	2 878 372.980		R28	-37 003.540	2 878 854.430		
L30	-37 644.190	2 878 026.500		R29	-37 377.640	2 878 394.690		
L31	-37 914.600	2 877 694.660		R30	-37 666.780	2 878 039.660		
L32	-38 183.220	2 877 364.770		R31	-37 938.910	2 877 705.580		
L33	-38 456.200	2 877 029.470		R32	-38 202.830	2 877 380.990		
L34	-38 840.830	2 876 556.570		R33	-38 208.890	2 877 373.540		
L35	-39 225.860	2 876 083.660		R34	-38 475.770	2 877 045.080		
L36	-39 606.430	2 875 616.010		R35	-38 860.700	2 876 572.050		
L37	-39 610.920	2 875 610.490		R36	-39 245.370	2 876 099.480		
L38	-39 982.830	2 875 152.950		R37	-39 630.590	2 875 626.270		
L39	-40 384.460	2 874 659.760		R38	-39 631.990	2 875 624.560		
L40	-40 684.660	2 874 294.290		R39	-39 998.610	2 875 173.980		
L41	-40 769.230	2 874 193.430		R40	-40 383.680	2 874 700.170		
L42	-40 894.290	2 874 060.120		R41	-40 697.570	2 874 318.560		
L43	-41 076.410	2 873 895.720		R42	-40 787.400	2 874 211.040		
L44	-41 172.010	2 873 817.870		R43	-40 913.800	2 874 079.630		
L45	-41 296.320	2 873 729.580		R44	-41 094.240	2 873 917.740		
L46	-41 479.610	2 873 610.140		R45	-41 191.230	2 873 842.520		
L47	-41 609.710	2 873 537.780		R46	-41 311.330	2 873 751.940		
L47X	-41 627.370	2 873 528.120		R47	-41 472.590	2 873 648.340		
L48	-41 659.070	2 873 510.790		R48	-41 565.040	2 873 595.410		
L49	-42 110.310	2 873 286.390		R48X	-41 647.020	2 873 559.520		
L50	-42 708.490	2 872 985.100		R49	-41 681.140	2 873 544.580		
					Vel 7	Van 8	P729/08	
					Sheet	of		

PADRESERWE KOÖRDINATE				/	ROAD RESERVE CO-ORDINATES			
LINKERKANT/LEFT HAND SIDE					REGTERKANT/RIGHT HAND SIDE			
	Y	X	WG	25°		X		
L51	-43	107.050	2 872	784.340	R50	-42	126.970	2 873 318.400
L52	-43	520.520	2 872	576.050	R51	-42	719.460	2 873 007.820
L53	-43	923.200	2 872	373.030	R52	-43	118.400	2 872 807.200
L54	-44	343.090	2 872	161.740	R53	-43	532.050	2 872 598.840
L55	-44	997.310	2 871	831.700	R54	-43	934.530	2 872 395.860
L56	-45	585.430	2 871	535.340	R55	-44	354.150	2 872 184.450
L57	-46	029.920	2 871	311.460	R56	-45	011.900	2 871 853.040
L58	-46	474.060	2 871	087.350	R57	-45	596.980	2 871 558.110
L59	-46	917.720	2 870	864.030	R58	-46	040.070	2 871 335.010
L60	-47	323.860	2 870	659.330	R59	-46	485.340	2 871 110.310
L61	-47	657.910	2 870	490.770	R60	-46	928.960	2 870 886.730
L62	-48	006.970	2 870	314.890	R61	-47	335.620	2 870 681.710
L63	-48	419.840	2 870	106.790	R62	-47	670.820	2 870 513.020
L64	-48	824.230	2 869	902.900	R63	-48	018.260	2 870 337.490
L65	-49	266.230	2 869	680.150	R64	-48	431.550	2 870 129.360
L66	-49	710.370	2 869	456.020	R65	-48	834.440	2 869 926.050
L67	-50	156.910	2 869	231.010	R66	-49	278.010	2 869 702.700
L68	-50	729.080	2 868	942.350	R67	-49	723.160	2 869 478.150
L69	-51	173.830	2 868	718.150	R68	-50	167.840	2 869 254.110
L70	-51	828.610	2 868	387.850	R69	-50	739.930	2 868 965.200
L71	-52	094.520	2 868	253.720	R70	-51	185.080	2 868 741.010
L72	-52	404.970	2 868	097.050	R71	-51	615.880	2 868 523.480
L73	-53	905.790	2 867	340.450	R72	-52	100.200	2 868 279.570
L74	-54	539.730	2 867	021.570	R73	-52	490.810	2 868 082.560
L75	-55	151.720	2 866	713.020	R74	-52	940.720	2 867 855.790
L76	-55	605.530	2 866	484.650	R75	-53	470.070	2 867 588.360
L77	-56	017.550	2 866	277.450	R76	-54	005.500	2 867 318.860
L78	-56	471.530	2 866	049.240	R77	-54	550.820	2 867 044.140
L79	-56	991.670	2 865	787.350	R78	-55	162.170	2 866 736.280
L80	-57	387.120	2 865	589.180	R79	-55	616.630	2 866 508.100
L81	-57	806.920	2 865	378.030	R80	-56	030.220	2 866 299.520
L82	-58	281.710	2 865	139.260	R81	-56	483.630	2 866 071.690
L83	-58	499.900	2 865	028.680	R82	-57	002.770	2 865 810.450
					R83	-57	398.650	2 865 611.200
					R84	-57	818.540	2 865 400.210
					R85	-58	222.780	2 865 196.940
					R86	-58	518.220	2 865 050.680

Vel 8  
Sheet

Van 8  
of

P729/08