

Government Gazette Staatskoerant

REPUBLIC OF SOUTH AFRICA
REPUBLIEK VAN SUID-AFRIKA

Vol. 544

Pretoria, 19 October
Oktober 2010

No. 33635

IMPORTANT NOTICE

The Government Printing Works will not be held responsible for faxed documents not received due to errors on the fax machine or faxes received which are unclear or incomplete. Please be advised that an "OK" slip, received from a fax machine, will not be accepted as proof that documents were received by the GPW for printing. If documents are faxed to the GPW it will be the sender's responsibility to phone and confirm that the documents were received in good order.

Furthermore the Government Printing Works will also not be held responsible for cancellations and amendments which have not been done on original documents received from clients.

CONTENTS**INHOUD**

<i>No.</i>	<i>Page No.</i>	<i>Gazette No.</i>	<i>No.</i>	<i>Bladsy No.</i>	<i>Koerant No.</i>
GOVERNMENT NOTICE			GOEWERMENTSKENNISGEWING		
Transport, Department of			Vervoer, Departement van		
<i>Government Notice</i>			<i>Goewermentskennisgewing</i>		
909			909		
South African National Roads Agency Limited and the National Roads Act (7/1998): The South African National Roads Agency Limited: Declaration amendment of National Road N18 Section 7: Amendment of Declaration No. 731 of 2005	3	33635	Suid-Afrikaanse Nasionale Padagentskap Beperk en die Nasionale Paaie Wet (7/1998): Die Suid-Afrikaanse Nasionale Padagentskap Beperk: Verklaring wysiging van Nasionale Pad N18 Seksie 7: Wysiging van Verklaring No. 731 van 2005	4	33635

GOVERNMENT NOTICE

DEPARTMENT OF TRANSPORT

No. 909

19 October 2010

THE SOUTH AFRICAN NATIONAL ROADS AGENCY LIMITED

Registration No: 98/09584/06

DECLARATION AMENDMENT OF NATIONAL ROAD N18 SECTION 7

AMENDMENT OF DECLARATION NO. 731 OF 2005

By virtue of section 40(1)(b) of the South African National Roads Agency Limited and the National Roads Act, 1998 (Act No. 7 of 1998), I hereby amend Declaration No. 731 of 2005 by substituting the Annexure paragraph (IV), the descriptive section from Motlhabeng (Mafikeng) up to the Ramatlabama border post, with the subjoined sheets 1 to 5 of Plan No. P740/09.

[National Road N18 Section 7: Motlhabeng (Mafikeng) – Ramatlabama Border Post]



MINISTER OF TRANSPORT

GOEWERMENTSKENNISGEWING

DEPARTEMENT VAN VERVOER

No. 909

19 Oktober 2010

DIE SUID-AFRIKAANSE NASIONALE PADAGENTSKAP BEPERK

Registrasie No: 98/09584/06

VERKLARING WYSIGING VAN NASIONALE PAD N18 SEKSIE 7

WYSIGING VAN VERKLARING NO. 731 VAN 2005

Kragtens Artikel 40(1)(b) van die Suid-Afrikaanse Nasionale Padagentskap Beperk en die Nasionale Paaie Wet, 1998 (Wet no.7 van 1998), wysig ek hiermee Verklaring no. 731 van 2005 deur die Bylae paragraaf (IV), die beskrywende gedeelte vanaf Motlhabeng (Mafikeng) tot by die Ramatlabama grenspos, te vervang met meegaande velle 1 tot 5 van Plan no. P740/09.

[Nasionale Pad N18 Seksie 7 Motlhabeng (Mafikeng) – Ramatlabama Grenspos]



MINISTER VAN VERVOER

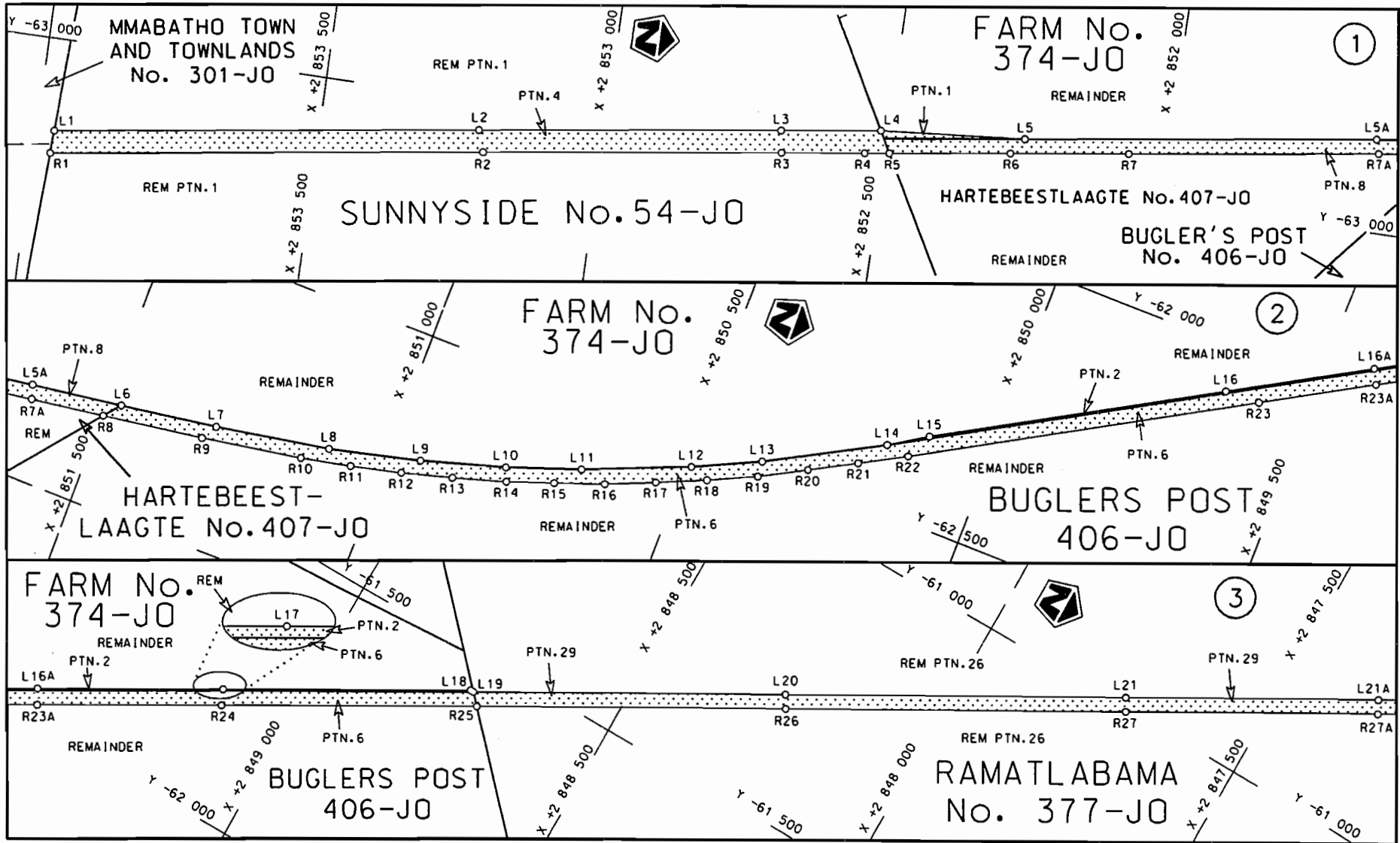

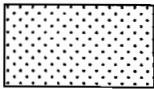
<p>Die Suid Afrikaanse Nasionale Padogentskap Beperk The South African National Roads Agency Limited</p>	<p>Die figuur getoon The figure shown</p> 	<p>steldie padreserwe voor van 'n gedeelte represents the road reserve of a portion van Nasionale Raete N18 Seksie Section 7 of National Route</p>	<p>Vel Sheet 1 van 5 of 8 Plan P740/09</p>
--	--	--	--

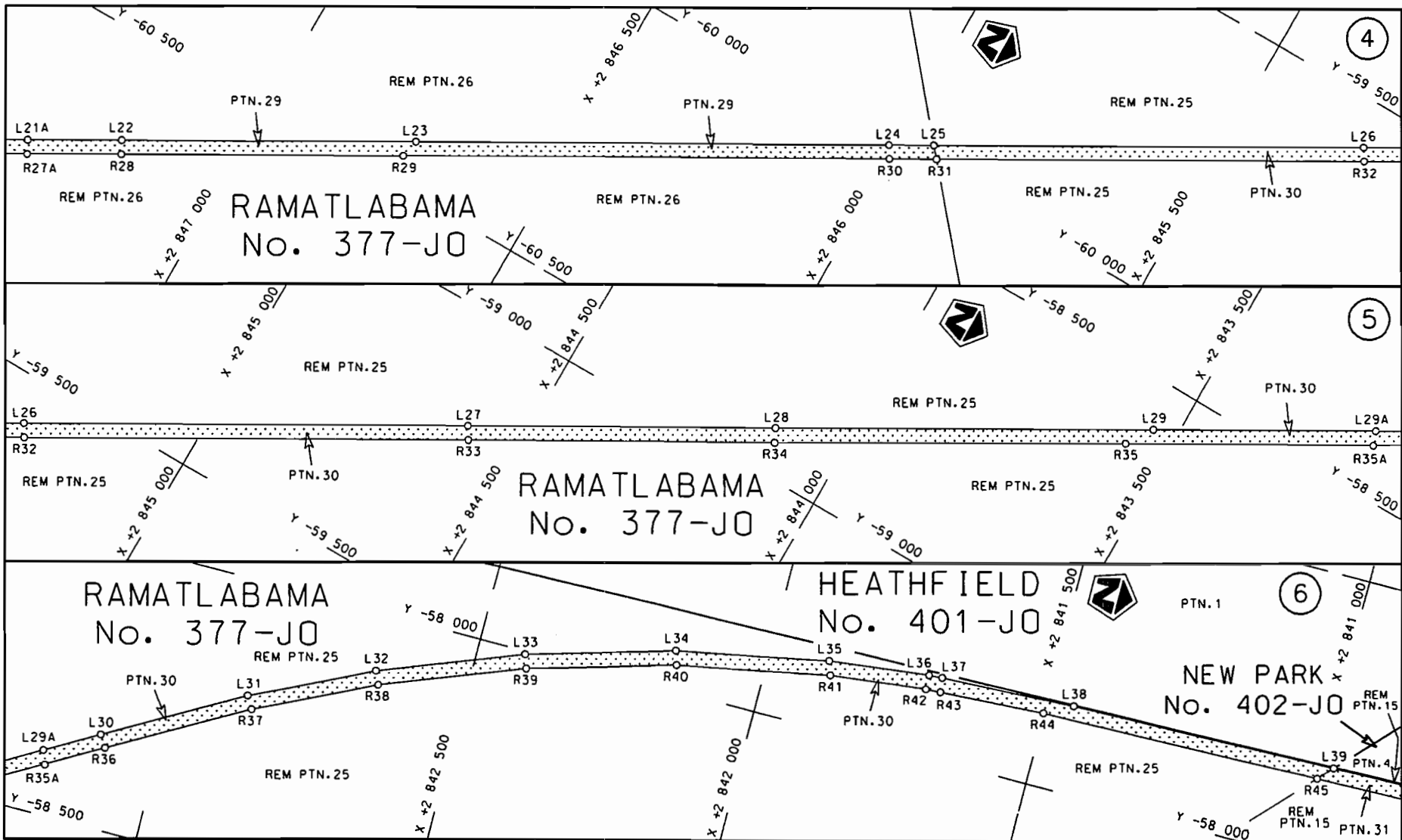

<p>Die Suid Afrikaanse Nasionale Padagentskap Beperk The South African National Roads Agency Limited</p>	<p>Die figuur getoon The figure shown</p>		<p>steldie padreserwe voor van 'n gedeelte represents the road reserve of a portion van Nasionale Roete N18 Seksie of National Route Section 7</p>	<p>Vel Sheet 2 van 5 Plan P740/09</p>
--	---	--	--	---

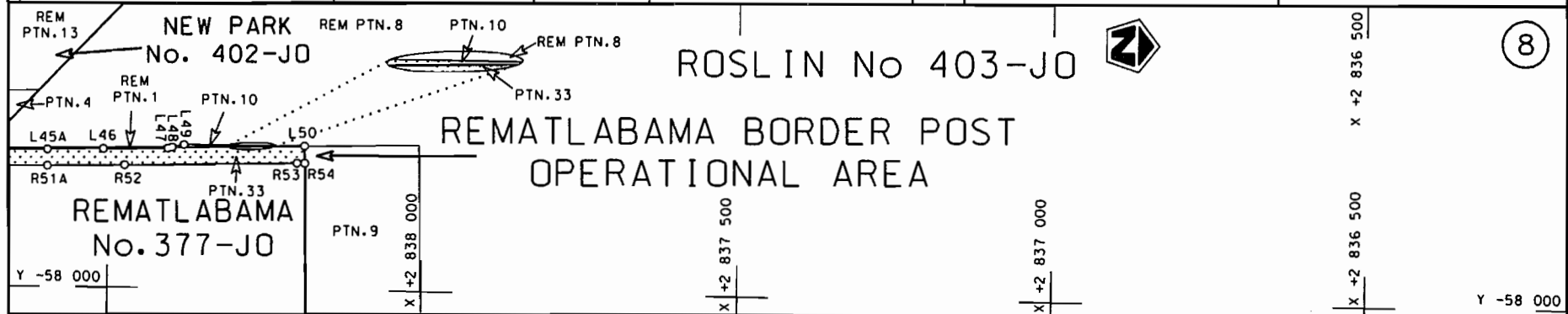
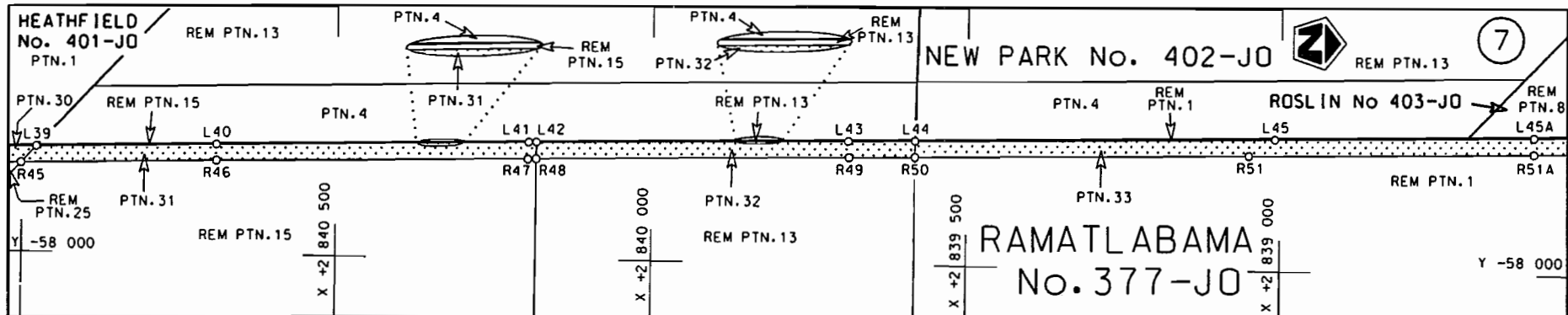

Die Suid Afrikaanse Nasionale Padagentskop Beperk
The South African National Roads Agency Limited

Die figuur getoon
The figure shown

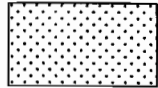

stel die padreserwe voor van 'n gedeelte
represents the road reserve of a portion
van Nasionale Roete
of National Route

N18 Seksie
 Section

7

Vel
Sheet 3 van 5
Plan P740/09

PADRESERWE KOÖRDINATE / ROAD RESERVE CO-ORDINATES									
LINKERKANT/LEFT HAND SIDE					REGTERKANT/RIGHT HAND SIDE				
	Y	X	WG 25°		Y	X			
L1	-63	160.930	2 853	968.240	R1	-63	200.400	2 853	970.030
L2	-63	052.100	2 853	220.890	R2	-63	089.160	2 853	208.300
L3	-62	974.530	2 852	690.240	R3	-63	012.730	2 852	683.830
L4	-62	948.370	2 852	513.160	R4	-62	991.460	2 852	536.200
L5	-62	925.350	2 852	257.360	R5	-62	985.090	2 852	492.670
L6	-62	811.180	2 851	474.130	R6	-62	953.890	2 852	279.540
L7	-62	786.320	2 851	303.600	R7	-62	923.370	2 852	069.820
L8	-62	749.810	2 851	101.230	R8	-62	839.610	2 851	497.820
L9	-62	711.080	2 850	942.510	R9	-62	813.470	2 851	320.020
L10	-62	667.950	2 850	798.260	R10	-62	782.910	2 851	143.140
L11	-62	623.110	2 850	671.210	R11	-62	764.160	2 851	054.630
L12	-62	548.360	2 850	490.650	R12	-62	743.040	2 850	966.830
L13	-62	493.990	2 850	376.780	R13	-62	718.840	2 850	879.770
L14	-62	385.600	2 850	178.150	R14	-62	691.210	2 850	788.560
L15	-62	344.300	2 850	113.090	R15	-62	662.810	2 850	708.190
L16	-62	078.370	2 849	648.720	R16	-62	632.170	2 850	623.280
L17	-61	780.380	2 849	128.430	R17	-62	596.610	2 850	539.730
L18	-61	561.740	2 848	746.830	R18	-62	560.130	2 850	456.860
L19	-61	561.860	2 848	741.410	R19	-62	521.150	2 850	374.870
L20	-61	286.280	2 848	260.020	R20	-62	478.290	2 850	295.540
L21	-60	983.300	2 847	731.020	R21	-62	434.350	2 850	215.320
L22	-60	675.640	2 847	194.710	R22	-62	390.350	2 850	136.010
L23	-60	415.630	2 846	741.220	R23	-62	075.690	2 849	586.740
L24	-59	999.110	2 846	014.280	R24	-61	806.570	2 849	117.180
L25	-59	959.010	2 845	944.230	R25	-61	581.040	2 848	723.600
L26	-59	579.670	2 845	281.620	R26	-61	307.960	2 848	247.100
L27	-59	188.050	2 844	597.560	R27	-61	005.230	2 847	718.630
L28	-58	917.950	2 844	125.580	R28	-60	697.900	2 847	182.730
L29	-58	583.040	2 843	542.460	R29	-60	448.790	2 846	748.030
L30	-58	334.650	2 843	107.770	R30	-60	020.510	2 846	001.030
L31	-58	201.320	2 842	872.760	R31	-59	978.540	2 845	927.620
L32	-58	100.780	2 842	664.210	R32	-59	601.010	2 845	268.660
L33	-58	005.540	2 842	417.140	R33	-59	209.080	2 844	584.670
L34	-57	931.400	2 842	160.820	R34	-58	940.750	2 844	114.120
L35	-57	879.430	2 841	893.790	R35	-58	628.770	2 843	573.580
L36	-57	858.070	2 841	714.810	R36	-58	355.720	2 843	094.830
L37	-57	856.550	2 841	691.120	R37	-58	223.010	2 842	860.010
L38	-57	845.640	2 841	452.600	R38	-58	123.700	2 842	654.190
L39	-57	835.160	2 840	978.130	R39	-58	029.240	2 842	408.750
L40	-57	828.800	2 840	690.260	R40	-57	955.520	2 842	153.120
L41	-57	817.310	2 840	190.170	R41	-57	903.410	2 841	885.450
L42	-57	817.180	2 840	183.410	R42	-57	883.330	2 841	714.340
L43	-57	807.240	2 839	688.780	R43	-57	881.780	2 841	687.820
L44	-57	804.980	2 839	583.140	R44	-57	871.400	2 841	501.470
L45	-57	792.730	2 839	009.780	R45	-57	860.310	2 841	002.010
L46	-57	782.240	2 838	508.330	R46	-57	853.380	2 840	689.870
L47	-57	780.040	2 838	405.440	R47	-57	843.010	2 840	188.700
L48	-57	778.360	2 838	398.380	R48	-57	842.900	2 840	183.360
L49	-57	773.890	2 838	379.660	R49	-57	832.330	2 839	687.300
L50	-57	773.930	2 838	187.560	R50	-57	830.130	2 839	583.090
					R51	-57	818.900	2 839	051.120

Vel	4	Van	5	P740/09
Sheet		of		

PADRESERWE KOÖRDINATE / ROAD RESERVE CO-ORDINATES

LINKERKANT/LEFT HAND SIDE

REGTERKANT/RIGHT HAND SIDE

Y

X

WG 25°

Y

X

R52	-57 807.240	2 838	474.220
R53	-57 800.830	2 838	190.330
R54	-57 800.820	2 838	186.990

Vel 5
Sheet

Van 5
of

P740/09