

# Government Gazette Staatskoerant

REPUBLIC OF SOUTH AFRICA  
REPUBLIEK VAN SUID-AFRIKA

Vol. 544

Pretoria, 19 October 2010  
Oktober

**No. 33637**

**IMPORTANT NOTICE**

The Government Printing Works will not be held responsible for faxed documents not received due to errors on the fax machine or faxes received which are unclear or incomplete. Please be advised that an "OK" slip, received from a fax machine, will not be accepted as proof that documents were received by the GPW for printing. If documents are faxed to the GPW it will be the sender's responsibility to phone and confirm that the documents were received in good order.

Furthermore the Government Printing Works will also not be held responsible for cancellations and amendments which have not been done on original documents received from clients.

**CONTENTS****INHOUD**

<i>No.</i>	<i>Page No.</i>	<i>Gazette No.</i>	<i>No.</i>	<i>Bladsy No.</i>	<i>Koerant No.</i>
<b>GOVERNMENT NOTICE</b>			<b>GOEWERMENSKENNISGEWING</b>		
<b>Transport, Department of</b>			<b>Vervoer, Departement van</b>		
<i>Government Notice</i>			<i>Goewermentskennisgewing</i>		
911			911		
South African National Roads Agency Limited and the National Roads Act (7/1998): The South African National Roads Agency Limited: Declaration amendment of National Road N7 Section 1: Amendment of Declaration No. 218 of 2006 .....	3	33637	Suid-Afrikaanse Nasionale Padagentskap Beperk en die Nasionale Paaie Wet (7/1998): Die Suid-Afrikaanse Nasionale Padagentskap Beperk: Verklaring wysiging van Nasionale Pad N7 Seksie 1: Wysiging van Verklaring No. 218 van 2006 .....	4	33637

---

## GOVERNMENT NOTICE

---

### DEPARTMENT OF TRANSPORT

No. 911

19 October 2010

## THE SOUTH AFRICAN NATIONAL ROADS AGENCY LIMITED

Registration No: 98/09584/06

---

### DECLARATION AMENDMENT OF NATIONAL ROAD N7 SECTION 1

AMENDMENT OF DECLARATION NO. 218 OF 2006.

By virtue of section 40 (1)(b) of the South African National Roads Agency Limited and the National Roads Act, 1998 (Act No. 7 of 1998), I hereby amend Declaration No. 218 of 2006, by substituting the section of the descriptive declaration from the Melkbos junction up to Malmesbury, with the subjoined sheets 1 to 11 of Plan No. P760/09.

[National Road N7 Section 1: MR199 (Melkbostrand) – Malmesbury]

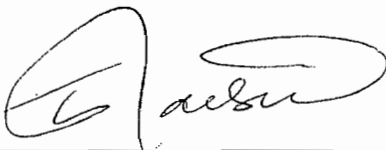

---

MINISTER OF TRANSPORT

---

## GOEWERMENTSKENNISGEWING

---

### DEPARTEMENT VAN VERVOER

No. 911

19 Oktober 2010

## DIE SUID-AFRIKAANSE NASIONALE PADAGENTSKAP BEPERK

Registrasie No: 98/09584/06

---

### VERKLARING WYSIGING VAN NASIONALE PAD N7 SEKSIE 1.

WYSIGING VAN VERKLARING NO. 218 VAN 2006

Kragtens Artikel 40(1)(b) van die Suid-Afrikaanse Nasionale Padagentskap Beperk en die Nasionale Paaie Wet, 1998 (Wet No.7 van 1998), wysig ek hiermee Verklaring no. 218 van 2006, deur die gedeelte van die beskrywende verklaring vanaf die Melkbos aansluiting tot by Malmesbury, te vervang met meegaande velle 1 tot 11 van Plan no. P760/09.

[Nasionale Pad N7 Seksie 1: MR199 (Melkbostrand) – Malmesbury]



MINISTER VAN VERVOER

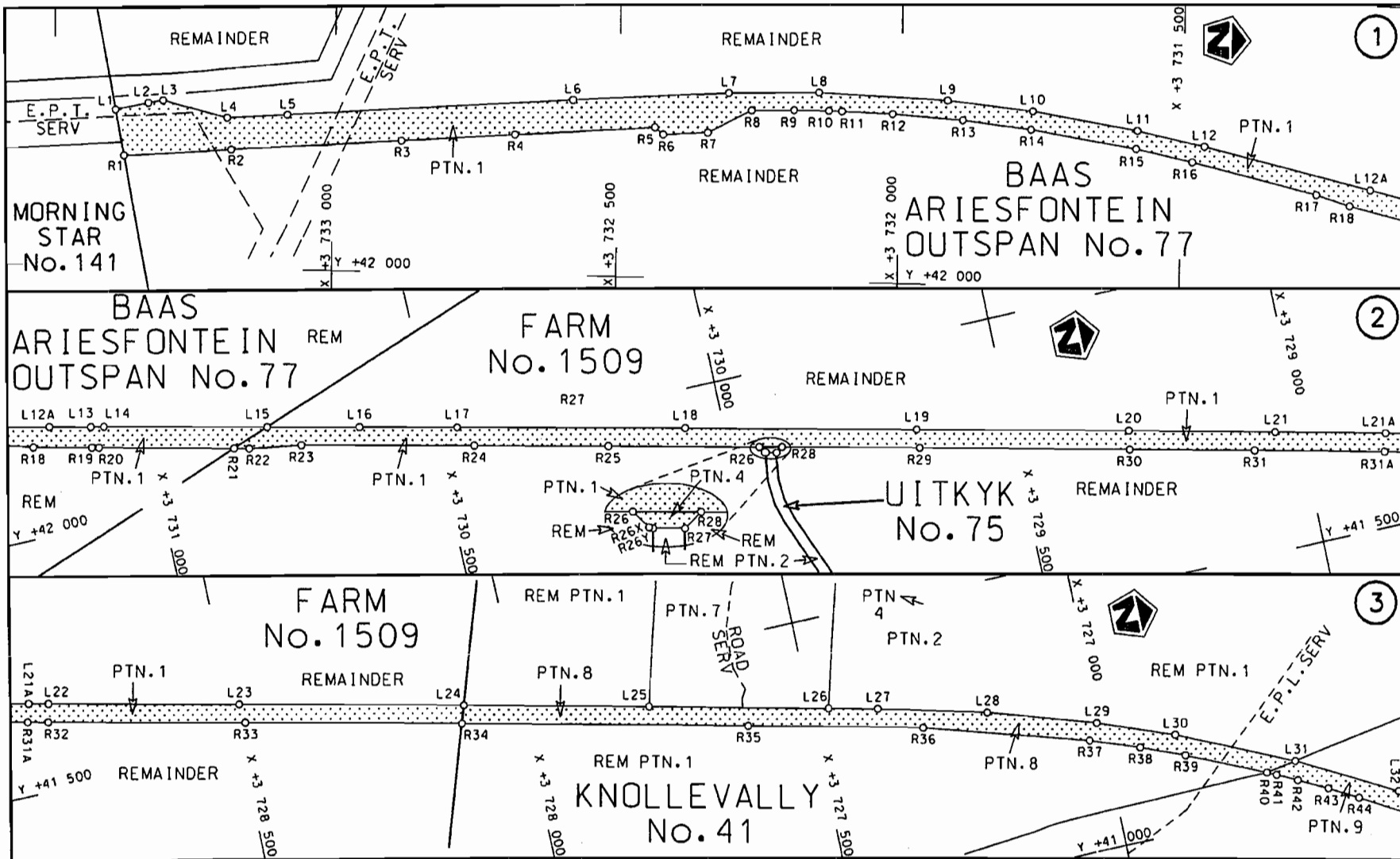

Die Suid Afrikaanse Nasionale Padagentskap Beperk The South African National Roads Agency Limited	Die figuur getoon The figure shown		stel die podreserwe voor van 'n gedeelte represents the road reserve of a portion van Nasionale Roete N7 Seksie Section of National Route 1	Vel Sheet 1 van of 11 Plan P760/09
--	---------------------------------------	--	--	---------------------------------------

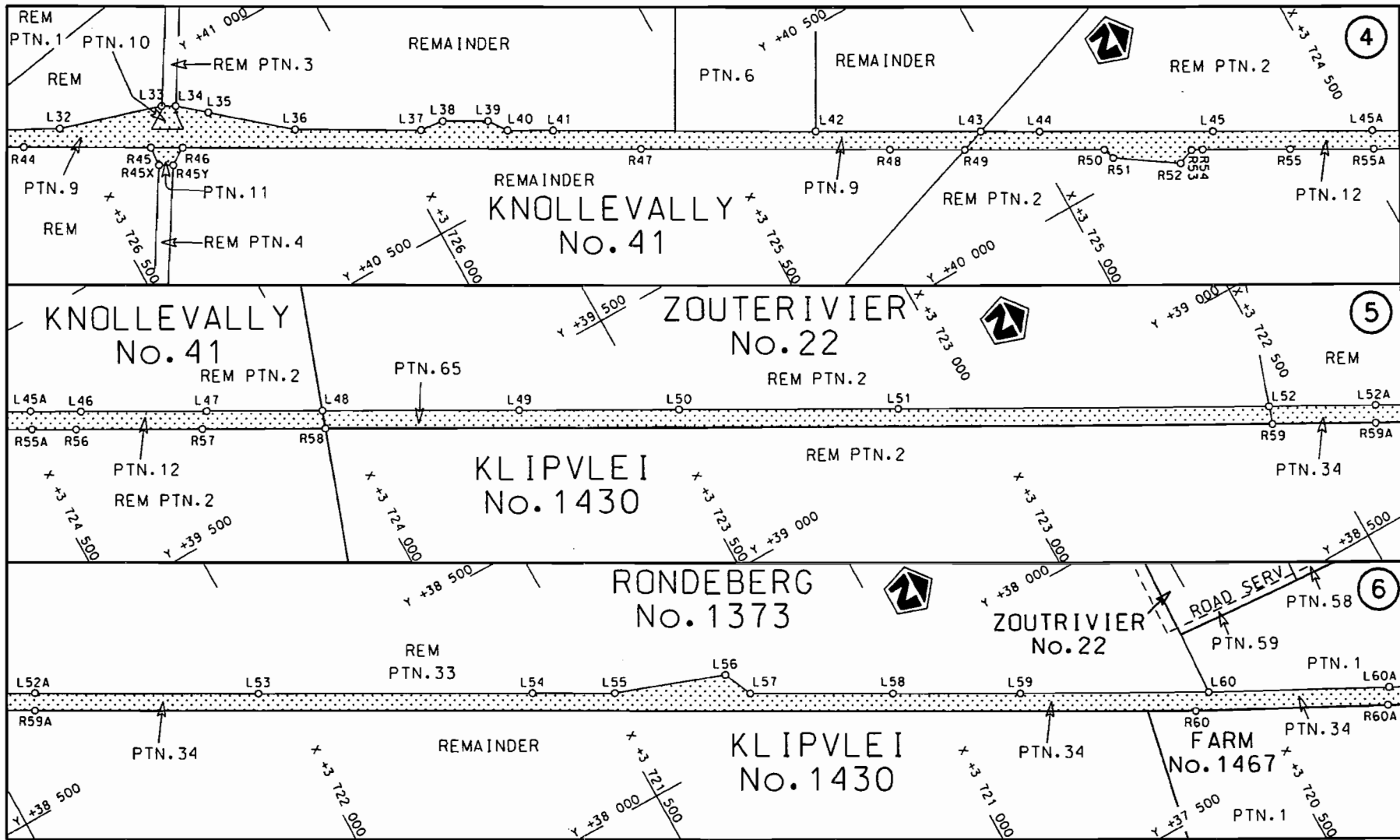

<p>Die Suid Afrikaanse Nasionale Padagentskap Beperk The South African National Roads Agency Limited</p>	<p>Die figuur getoon The figure shown</p>		<p>stel die padreserwe voor van 'n gedeelte represents the road reserve of a portion van Nasionale Roete N7 of National Route N7</p> <p>Seksie 1 Section</p>	<p>Vel 2 van 11 Sheet of</p> <p>Plon P760/09</p>
--	---	--	--	--

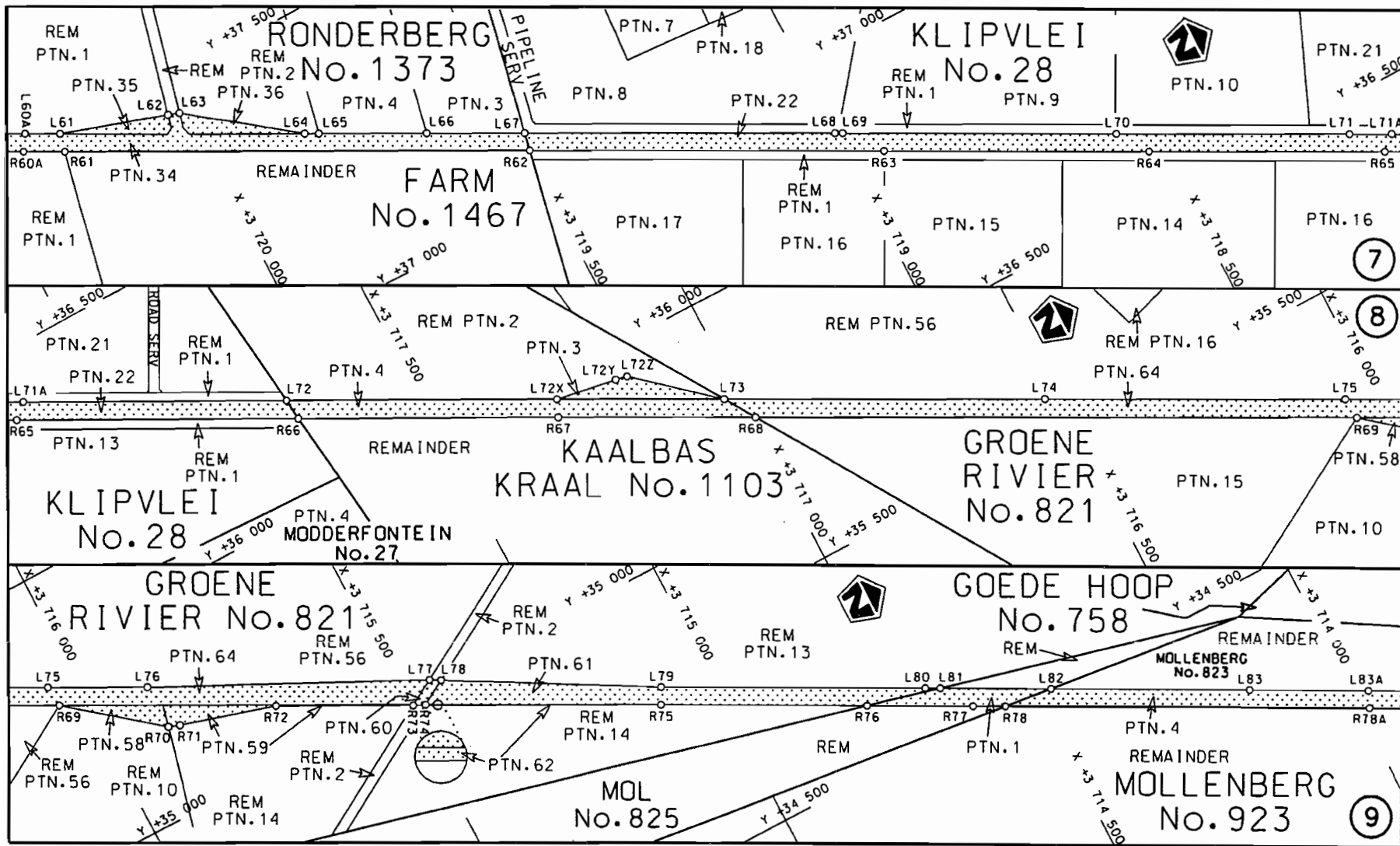

Die Suid Afrikaanse Nasionale Padagentskap Beperk	Die figuur getoon		Vel Sheet 3 van 11
The South African National Roads Agency Limited	The figure shown		stel die padreserwe voor van 'n gedeelte represents the road reserve of a portion van Nasionale Roete N7 Seksie Section of National Route 1

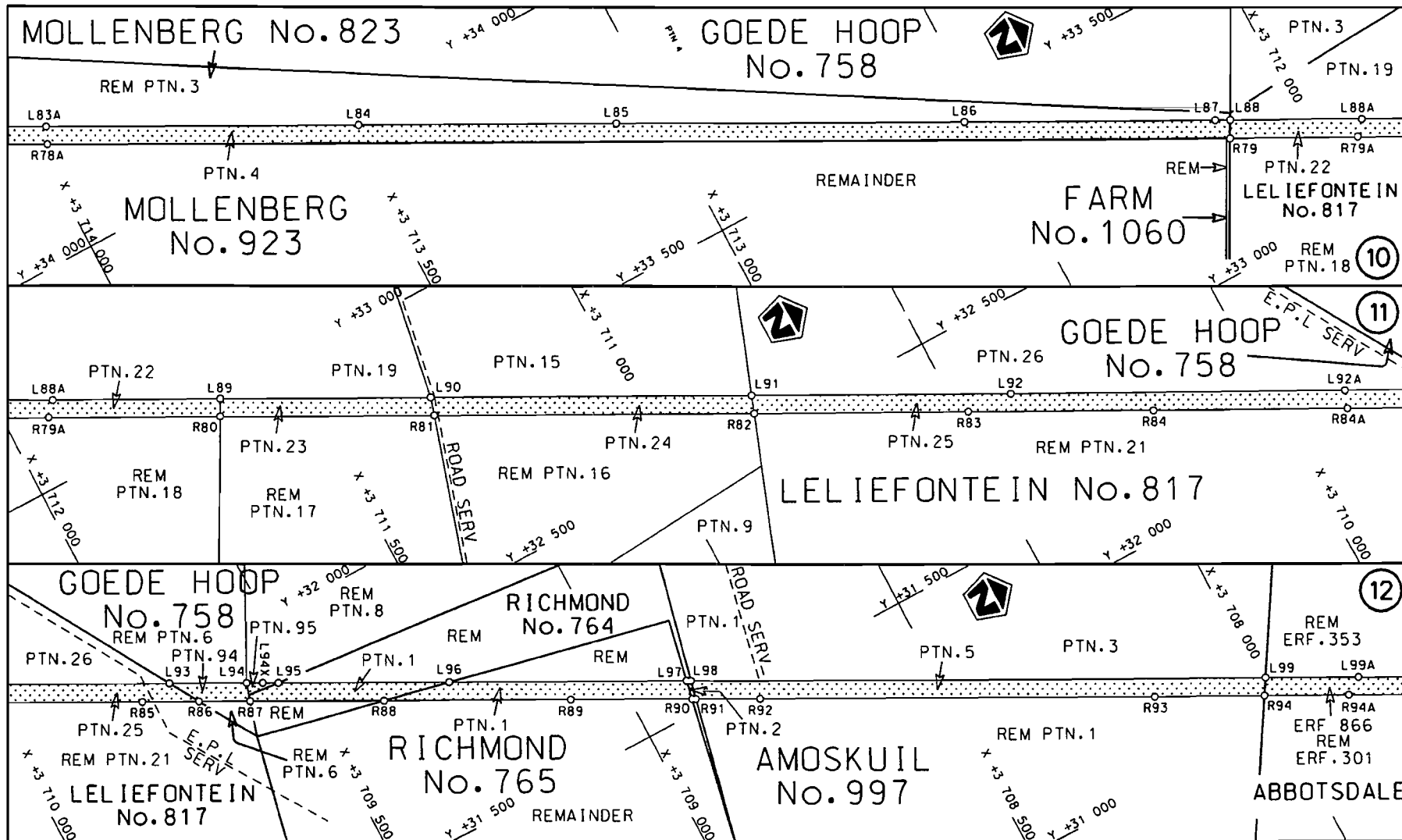

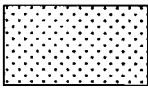
<p>Die Suid Afrikaanse Nasionale Padagentskap Beperk The South African National Roads Agency Limited</p>	<p>Die figuur getoon The figure shown</p>		<p>stel die padreserwe voor van 'n gedeelte represents the road reserve of a portion van Nasionale Roete of National Route N7</p> <p>Seksie Section 1</p>	<p>Vel Sheet 4 van of 11 Plan P760/09</p>
--	---	--	---	---



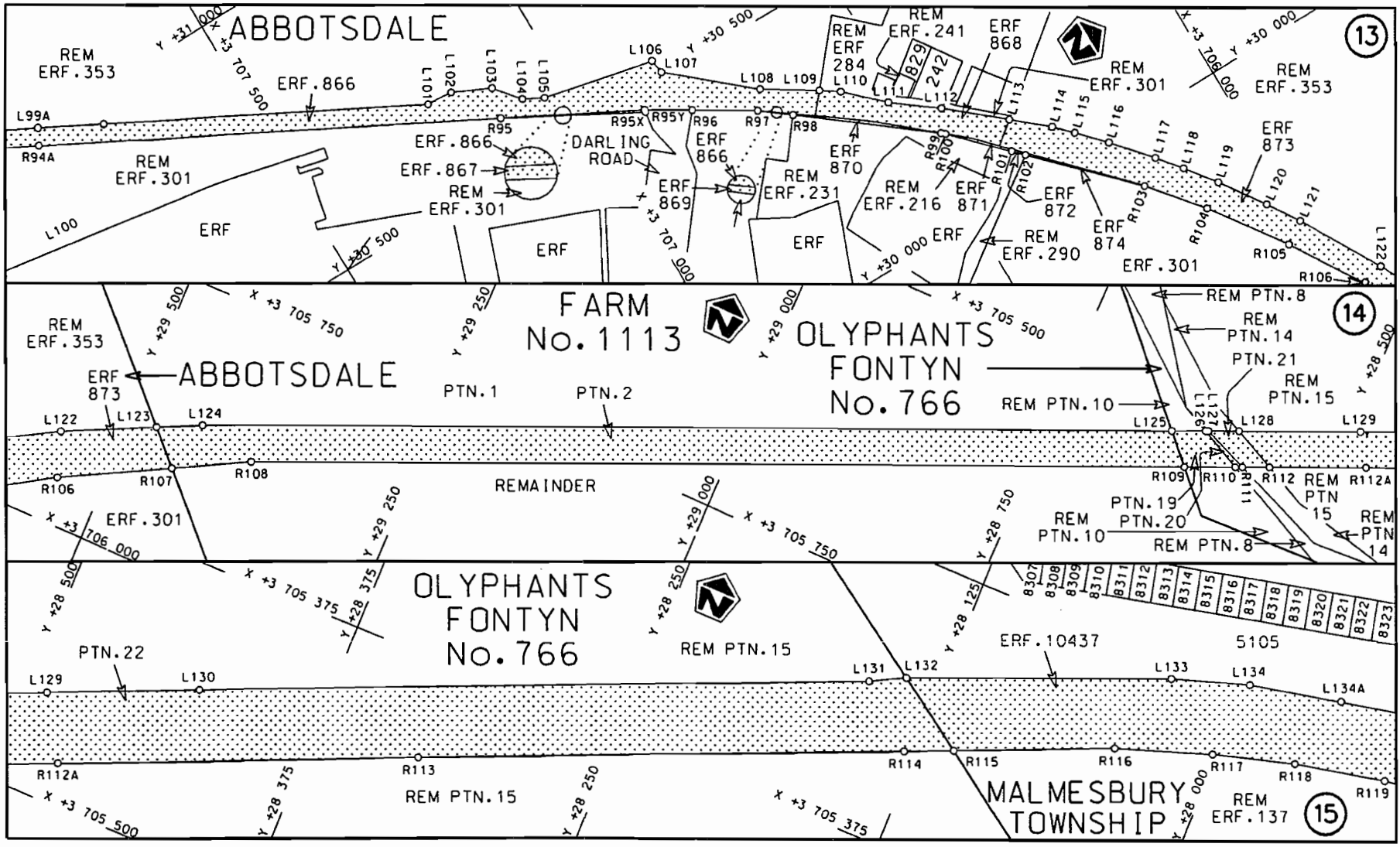

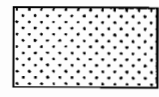
Die Suid Afrikaanse Nasionale Padagentskap Beperk The South African National Roads Agency Limited	Die figuur getoon The figure shown		stel die padreserwe voor van 'n gedeelte represents the road reserve of a portion van Nasionale Roete N7 Seksie 1 of National Route N7 Section 1	Vel Sheet 5 van 11 Plan P760/09
--	---------------------------------------	--	---	------------------------------------



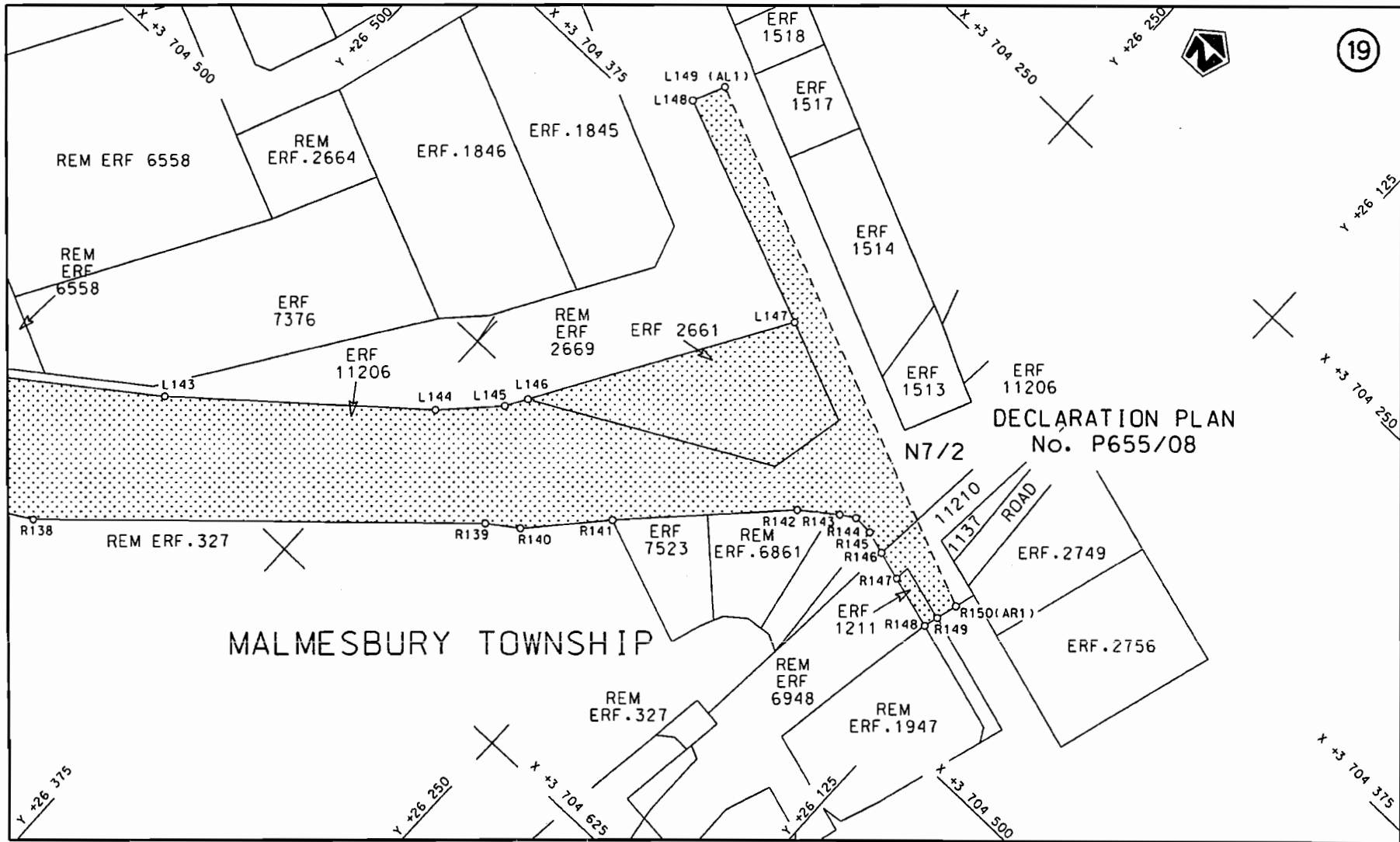

DECLARATION PLAN  
No. P655/08

MALMESBURY TOWNSHIP

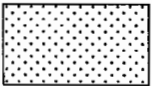
Die Suid Afrikaanse Nasionale Padagentskap Beperk The South African National Roads Agency Limited	Die figuur getoon The figure shown	 steldie podreserwe voor van 'n gedeelte represents the road reserve of a portion van Nasionale Roete N7 of National Route N7 Seksie Section 1	Vel Sheet 7 van of 11 Plan P760/09
--	---------------------------------------	--	---------------------------------------

PADRESERWE KOÖRDINATE / ROAD RESERVE CO-ORDINATES						
LINKERKANT/LEFT HAND SIDE				REGTERKANT/RIGHT HAND SIDE		
	Y	X	WG 19°		Y	X
L1	42 269.470	3 733	389.870	R1	42 190.880	3 733 373.580
L2	42 282.470	3 733	331.880	R2	42 204.880	3 733 182.000
L3	42 287.360	3 733	306.180	R3	42 226.670	3 732 881.250
L4	42 259.020	3 733	190.310	R4	42 241.310	3 732 681.020
L5	42 266.720	3 733	082.290	R5	42 259.130	3 732 435.610
L6	42 302.740	3 732	580.180	R6	42 247.130	3 732 420.750
L7	42 321.840	3 732	306.400	R7	42 252.650	3 732 342.320
L8	42 326.230	3 732	145.680	R8	42 292.470	3 732 264.810
L9	42 318.360	3 731	917.790	R9	42 294.660	3 732 189.360
L10	42 303.380	3 731	764.720	R10	42 295.190	3 732 127.430
L11	42 274.840	3 731	579.610	R11	42 294.920	3 732 104.030
L12	42 250.350	3 731	460.860	R12	42 292.230	3 732 013.950
L13	42 166.610	3 731	092.890	R13	42 284.880	3 731 890.010
L14	42 161.510	3 731	070.180	R14	42 271.920	3 731 767.130
L15	42 096.850	3 730	785.750	R15	42 243.080	3 731 581.450
L16	42 060.950	3 730	626.700	R16	42 223.060	3 731 481.800
L17	42 022.970	3 730	459.370	R17	42 172.390	3 731 260.230
L18	41 933.630	3 730	067.400	R18	42 154.470	3 731 200.800
L19	41 842.140	3 729	665.710	R19	42 131.130	3 731 099.020
L20	41 759.080	3 729	297.620	R20	42 128.290	3 731 087.140
L21	41 701.270	3 729	044.690	R21	42 073.710	3 730 851.740
L22	41 649.570	3 728	817.920	R22	42 067.640	3 730 825.540
L23	41 574.340	3 728	485.780	R23	42 052.570	3 730 732.700
L24	41 486.270	3 728	098.840	R24	41 985.140	3 730 436.690
L25	41 413.620	3 727	780.010	R25	41 932.480	3 730 206.800
L26	41 342.920	3 727	467.990	R26	41 873.320	3 729 945.670
L27	41 323.590	3 727	382.240	R26X	41 862.480	3 729 938.170
L28	41 276.870	3 727	193.160	R26Y	41 861.460	3 729 935.980
L29	41 217.550	3 727	005.020	R27	41 872.900	3 729 943.120
L30	41 168.140	3 726	873.510	R28	41 864.480	3 729 906.360
L31	41 079.070	3 726	674.010	R29	41 810.210	3 729 667.220
L32	40 989.480	3 726	503.840	R30	41 727.470	3 729 303.020
L33	40 936.940	3 726	326.510	R31	41 678.410	3 729 086.930
L34	40 924.810	3 726	304.400	R32	41 618.970	3 728 825.460
L35	40 886.830	3 726	258.730	R33	41 541.000	3 728 482.340
L36	40 786.290	3 726	137.820	R34	41 456.000	3 728 109.190
L37	40 677.460	3 725	942.150	R35	41 343.970	3 727 615.000
L38	40 672.630	3 725	901.220	R36	41 274.750	3 727 310.470
L39	40 634.310	3 725	831.410	R37	41 190.390	3 727 023.800
L40	40 603.500	3 725	809.040	R38	41 159.830	3 726 939.420
L41	40 563.670	3 725	737.620	R39	41 129.590	3 726 863.170
L42	40 337.720	3 725	331.220	R40	41 069.990	3 726 727.730
L43	40 195.020	3 725	073.450	R41	41 062.570	3 726 712.080
L44	40 143.700	3 724	981.550	R42	41 045.460	3 726 676.700
L45	39 993.440	3 724	710.780	R43	41 019.780	3 726 625.820
L46	39 811.620	3 724	383.710	R44	40 993.080	3 726 575.850
L47	39 703.200	3 724	188.370	R45	40 883.080	3 726 377.750
L48	39 603.130	3 724	008.470	R45X	40 848.510	3 726 380.350
L49	39 433.940	3 723	704.310	R45Y	40 836.310	3 726 358.140
L50	39 296.530	3 723	457.510	R46	40 855.560	3 726 328.110
L51	39 106.590	3 723	116.310	R47	40 460.850	3 725 617.260

Vel	8	Van	11	P760/09
Sheet		of		

PADRESERWE KOÖRDINATE / ROAD RESERVE CO-ORDINATES									
LINKERKANT/LEFT HAND SIDE					REGTERKANT/RIGHT HAND SIDE				
	Y		X	WG 19°		Y		X	
L52	38 785.890	3	722	540.650	R48	40 245.570	3	725	229.960
L53	38 500.750	3	722	027.460	R49	40 181.030	3	725	113.800
L54	38 264.820	3	721	602.690	R50	40 059.680	3	724	895.310
L55	38 194.390	3	721	475.530	R51	40 039.170	3	724	888.720
L56	38 128.730	3	721	289.600	R52	39 971.600	3	724	788.050
L57	38 078.460	3	721	266.820	R53	39 983.670	3	724	759.590
L58	37 954.690	3	721	044.700	R54	39 974.690	3	724	742.180
L59	37 845.090	3	720	847.380	R55	39 899.210	3	724	606.640
L60	37 683.470	3	720	554.350	R56	39 788.040	3	724	406.690
L61	37 504.510	3	720	215.840	R57	39 679.050	3	724	210.550
L62	37 443.500	3	720	031.080	R58	39 572.990	3	724	019.110
L63	37 437.190	3	720	011.960	R59	38 755.940	3	722	550.910
L64	37 301.110	3	719	830.450	R60	37 665.130	3	720	590.770
L65	37 289.510	3	719	808.320	R61	37 472.360	3	720	223.230
L66	37 201.610	3	719	640.560	R62	37 089.840	3	719	494.310
L67	37 121.500	3	719	487.840	R63	36 797.280	3	718	938.140
L68	36 866.220	3	719	001.190	R64	36 579.150	3	718	522.100
L69	36 859.820	3	718	989.040	R65	36 385.410	3	718	152.080
L70	36 633.920	3	718	559.090	R66	36 150.980	3	717	707.140
L71	36 442.010	3	718	193.030	R67	35 937.640	3	717	301.860
L72	36 188.970	3	717	711.590	R68	35 774.520	3	716	992.460
L72X	35 966.451	3	717	289.138	R69	35 276.970	3	716	046.080
L72Y	35 947.620	3	717	180.820	R70	35 153.230	3	715	891.940
L72Z	35 943.510	3	717	160.290	R71	35 146.610	3	715	872.980
L73	35 828.270	3	717	026.800	R72	35 096.210	3	715	706.250
L74	35 563.190	3	716	522.160	R73	34 983.780	3	715	490.390
L75	35 314.690	3	716	049.490	R74	34 974.850	3	715	470.400
L76	35 231.870	3	715	891.760	R75	34 781.180	3	715	101.390
L77	35 010.470	3	715	444.000	R76	34 610.650	3	714	776.470
L78	35 000.350	3	715	426.070	R77	34 523.190	3	714	610.230
L79	34 808.700	3	715	086.430	R78	34 496.450	3	714	558.700
L80	34 590.200	3	714	669.770	R79	33 217.770	3	712	127.110
L81	34 577.990	3	714	646.550	R80	32 970.800	3	711	655.540
L82	34 486.350	3	714	472.270	R81	32 794.330	3	711	320.900
L83	34 321.360	3	714	158.470	R82	32 531.640	3	710	820.800
L84	33 965.470	3	713	480.810	R83	32 355.620	3	710	484.370
L85	33 753.920	3	713	078.460	R84	32 202.520	3	710	194.080
L86	33 465.680	3	712	530.560	R85	31 974.850	3	709	761.590
L87	33 258.150	3	712	135.440	R86	31 928.190	3	709	672.330
L88	33 245.820	3	712	111.810	R87	31 886.740	3	709	593.030
L89	32 998.260	3	711	640.550	R88	31 775.870	3	709	382.310
L90	32 825.320	3	711	311.330	R89	31 623.160	3	709	091.680
L91	32 561.880	3	710	809.690	R90	31 523.470	3	708	902.150
L92	32 347.680	3	710	402.480	R91	31 520.210	3	708	895.940
L93	31 981.070	3	709	703.820	R92	31 467.260	3	708	795.270
L94	31 917.560	3	709	583.550	R93	31 141.870	3	708	177.660
L94X	31 905.870	3	709	561.580	R94	31 051.090	3	708	005.260
L95	31 891.740	3	709	534.010	R95	30 587.490	3	707	129.670
L96	31 750.250	3	709	265.750	R95X	30 464.490	3	706	905.360
L97	31 555.850	3	708	895.580	R95Y	30 468.450	3	706	904.840
L98	31 552.240	3	708	888.700	R96	30 424.340	3	706	832.220

Vel	9	Van	11	P760/09
Sheet		of		

PADRESERWE KOÖRDINATE / ROAD RESERVE CO-ORDINATES						
LINKERKANT/LEFT HAND SIDE				REGTERKANT/RIGHT HAND SIDE		
	Y	X	WG 19°		Y	X
L99	31 077.850	3 707	988.640	R97	30 363.010	3 706 731.310
L100	30 945.610	3 707	739.510	R98	30 324.300	3 706 681.530
L101	30 675.200	3 707	227.950	R99	30 161.270	3 706 471.930
L102	30 672.430	3 707	181.110	R100	30 155.510	3 706 465.180
L103	30 641.440	3 707	115.070	R101	30 067.800	3 706 379.730
L104	30 596.630	3 707	079.120	R102	30 049.650	3 706 362.060
L105	30 578.260	3 707	044.550	R103	29 892.590	3 706 209.060
L106	30 535.780	3 706	848.080	R104	29 801.020	3 706 133.500
L107	30 510.210	3 706	844.250	R105	29 670.880	3 706 040.750
L108	30 393.940	3 706	707.570	R106	29 540.400	3 705 959.500
L109	30 337.220	3 706	618.280	R107	29 449.510	3 705 911.010
L110	30 315.800	3 706	586.980	R108	29 386.580	3 705 877.350
L111	30 255.170	3 706	524.520	R109	28 624.070	3 705 546.420
L112	30 197.670	3 706	449.100	R110	28 582.070	3 705 528.190
L113	30 117.700	3 706	354.670	R111	28 576.130	3 705 525.610
L114	30 067.600	3 706	295.530	R112	28 553.910	3 705 515.970
L115	30 037.900	3 706	266.380	R113	28 328.320	3 705 418.050
L116	29 991.780	3 706	223.240	R114	28 129.690	3 705 331.970
L117	29 925.320	3 706	166.180	R115	28 109.430	3 705 323.160
L118	29 883.520	3 706	132.840	R116	28 043.350	3 705 294.430
L119	29 830.100	3 706	092.380	R117	28 001.880	3 705 279.910
L120	29 751.720	3 706	038.360	R118	27 966.210	3 705 269.540
L121	29 695.520	3 706	002.080	R119	27 926.500	3 705 260.850
L122	29 553.690	3 705	921.120	R120	27 888.250	3 705 255.570
L123	29 476.630	3 705	883.440	R121	27 810.300	3 705 251.300
L124	29 439.090	3 705	865.210	R122	27 606.750	3 705 266.710
L125	28 646.950	3 705	521.930	R123	27 543.240	3 705 270.870
L126	28 619.130	3 705	509.820	R124	27 507.340	3 705 270.100
L127	28 616.780	3 705	508.800	R125	27 485.400	3 705 268.510
L128	28 591.530	3 705	497.880	R126	27 452.800	3 705 264.930
L129	28 492.230	3 705	454.930	R127	27 387.980	3 705 252.880
L130	28 429.410	3 705	427.660	R128	27 351.600	3 705 243.280
L131	28 155.900	3 705	309.450	R129	27 315.970	3 705 230.510
L132	28 141.160	3 705	301.600	R130	27 267.970	3 705 209.310
L133	28 031.740	3 705	256.240	R131	27 247.000	3 705 200.050
L134	27 998.170	3 705	245.170	R132	27 208.100	3 705 177.710
L135	27 909.230	3 705	226.080	R133	27 186.220	3 705 163.330
L136	27 816.470	3 705	218.950	R134	26 956.820	3 705 007.620
L137	27 551.870	3 705	238.190	R135	26 766.100	3 704 878.480
L138	27 442.820	3 705	231.000	R136	26 747.740	3 704 866.090
L139	27 343.960	3 705	200.690	R137	26 627.450	3 704 784.920
L140	27 167.401	3 705	112.639	R138	26 465.780	3 704 692.000
L141	26 801.934	3 704	864.370	R139	26 318.100	3 704 556.210
L142	26 767.390	3 704	838.920	R140	26 305.210	3 704 546.990
L143	26 459.860	3 704	612.460	R141	26 277.760	3 704 516.400
L144	26 368.070	3 704	534.670	R142	26 221.280	3 704 456.940
L145	26 346.830	3 704	512.470	R143	26 205.890	3 704 445.270
L146	26 341.280	3 704	503.160	R144	26 199.560	3 704 441.340
L147	26 278.350	3 704	397.540	R145	26 190.890	3 704 441.730
L148	26 377.820	3 704	357.310	R146	26 180.830	3 704 444.790
L149	26 371.660	3 704	343.240	R147	26 168.170	3 704 448.400

Vel	10	Van	11	P760/09
Sheet		of		

