

Government Gazette Staatskoerant

REPUBLIC OF SOUTH AFRICA
REPUBLIEK VAN SUID-AFRIKA

Vol. 545

Pretoria, 12 November 2010

No. 33705

IMPORTANT NOTICE

The Government Printing Works will not be held responsible for faxed documents not received due to errors on the fax machine or faxes received which are unclear or incomplete. Please be advised that an "OK" slip, received from a fax machine, will not be accepted as proof that documents were received by the GPW for printing. If documents are faxed to the GPW it will be the sender's responsibility to phone and confirm that the documents were received in good order.

Furthermore the Government Printing Works will also not be held responsible for cancellations and amendments which have not been done on original documents received from clients.

CONTENTS**INHOUD**

<i>No.</i>	<i>Page No.</i>	<i>Gazette No.</i>	<i>No.</i>	<i>Bladsy No.</i>	<i>Koerant No.</i>
GOVERNMENT NOTICE			GOEWERMENTSKENNISGEWING		
Transport, Department of			Vervoer, Departement van		
<i>Government Notice</i>			<i>Goewermentskennisgewing</i>		
993			993		
South African National Roads Agency Limited and the National Roads Act (7/1998): The South African National Roads Agency Limited: Declaration Amendment of National Road R37 Section 4: Amendment of Declaration No. 727 of 2005	3	33705	Suid-Afrikaanse Nasionale Padagentskap Beperk en die Nasionale Paaie Wet (7/1998): Die Suid-Afrikaanse Nasionale Padagentskap Beperk: Verklaring Wysiging van Nasionale Pad R37 Seksie 4: Wysiging van Verklaring No. 727 van 2005	4	33705

GOVERNMENT NOTICE

DEPARTMENT OF TRANSPORT

No. 993

12 November 2010

**THE SOUTH AFRICAN NATIONAL ROADS
AGENCY LIMITED**Registration No: 98/09584/06

DECLARATION AMENDMENT OF NATIONAL ROAD R37 SECTION 4

AMENDMENT OF DECLARATION NO. 727 OF 2005.

By virtue of section 40(1)(b) of the South African National Roads Agency Limited and the National Roads Act, 1998 (Act No. 7 of 1998), I hereby amend Declaration No. 727 of 2005 Annexure paragraph (iii), by substituting it, with the subjoined sheets 1 to 14 of Plan No. P762/09.

(National Road R37 Section 4: Sabie Turn Off – Nelspruit)

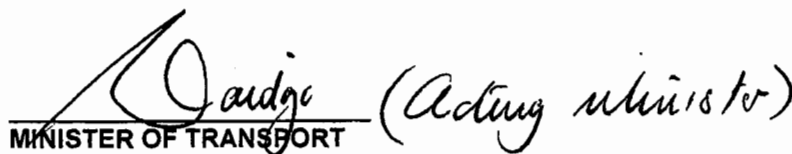
MINISTER OF TRANSPORT (Acting Minister)

GOEWERMENSKENNISGEWING

DEPARTEMENT VAN VERVOER

No. 993

12 November 2010

DIE SUID-AFRIKAANSE NASIONALE PADAGENTSKAP BEPERK

Registrasie No: 98/09584/06

VERKLARING WYSIGING VAN NASIONALE PAD R37 SEKSIE 4.

WYSIGING VAN VERKLARING NO. 727 VAN 2005

Kragtens Artikel 40(1)(b) van die Suid-Afrikaanse Nasionale Padagentskap Beperk en die Nasionale Paaie Wet, 1998 (Wet no. 7 van 1998), wysig ek hiermee Verklaring no. 727 van 2005 Bylae paragraaf (iii) deur dit te vervang met meegaande velle 1 tot 14 van Plan no. P762/09.

(Nasionale Pad R37 Seksie 4: Sabie Afdraai – Nelspruit)

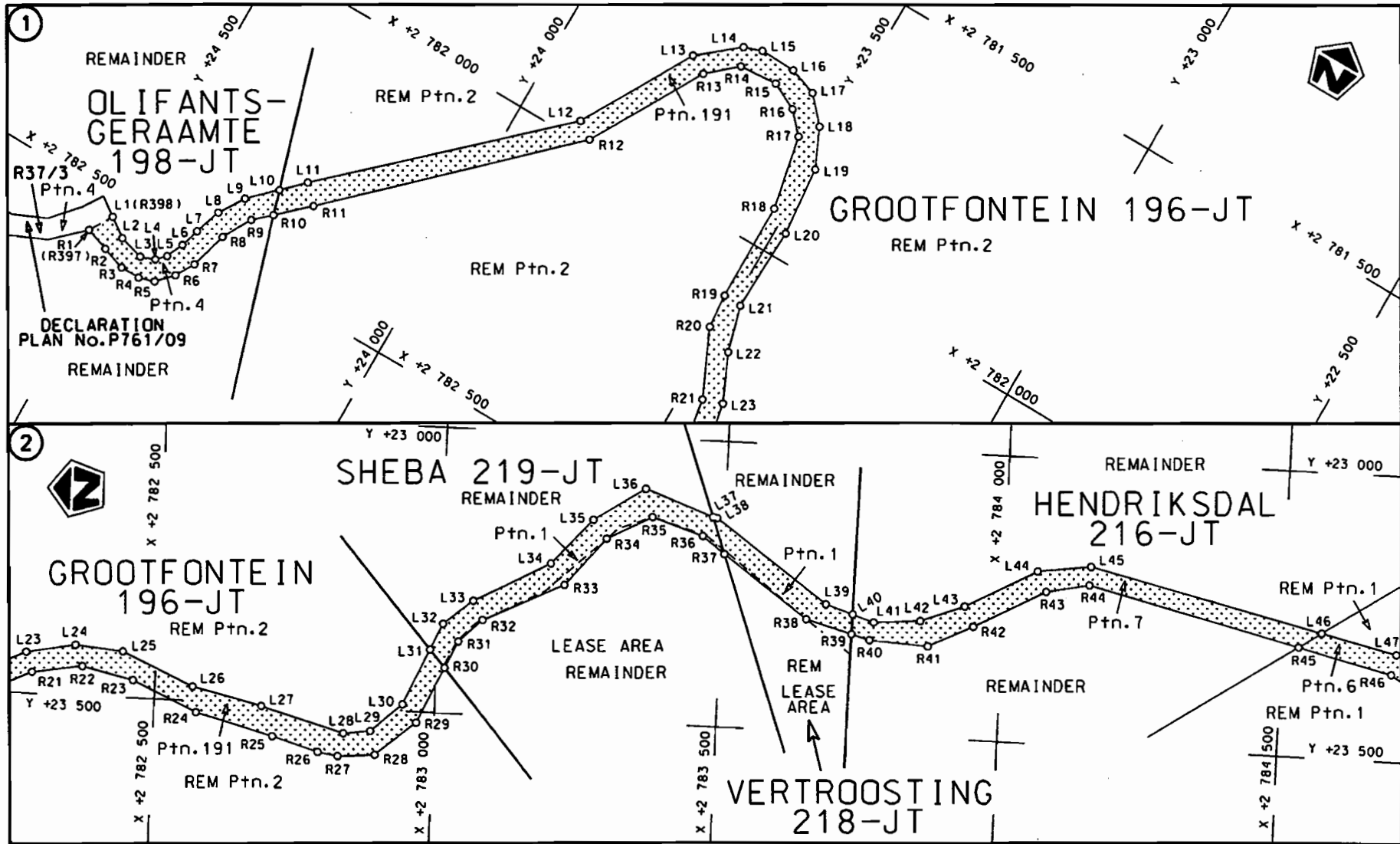

Daudje
Daudje
MINISTER VAN VERVOER

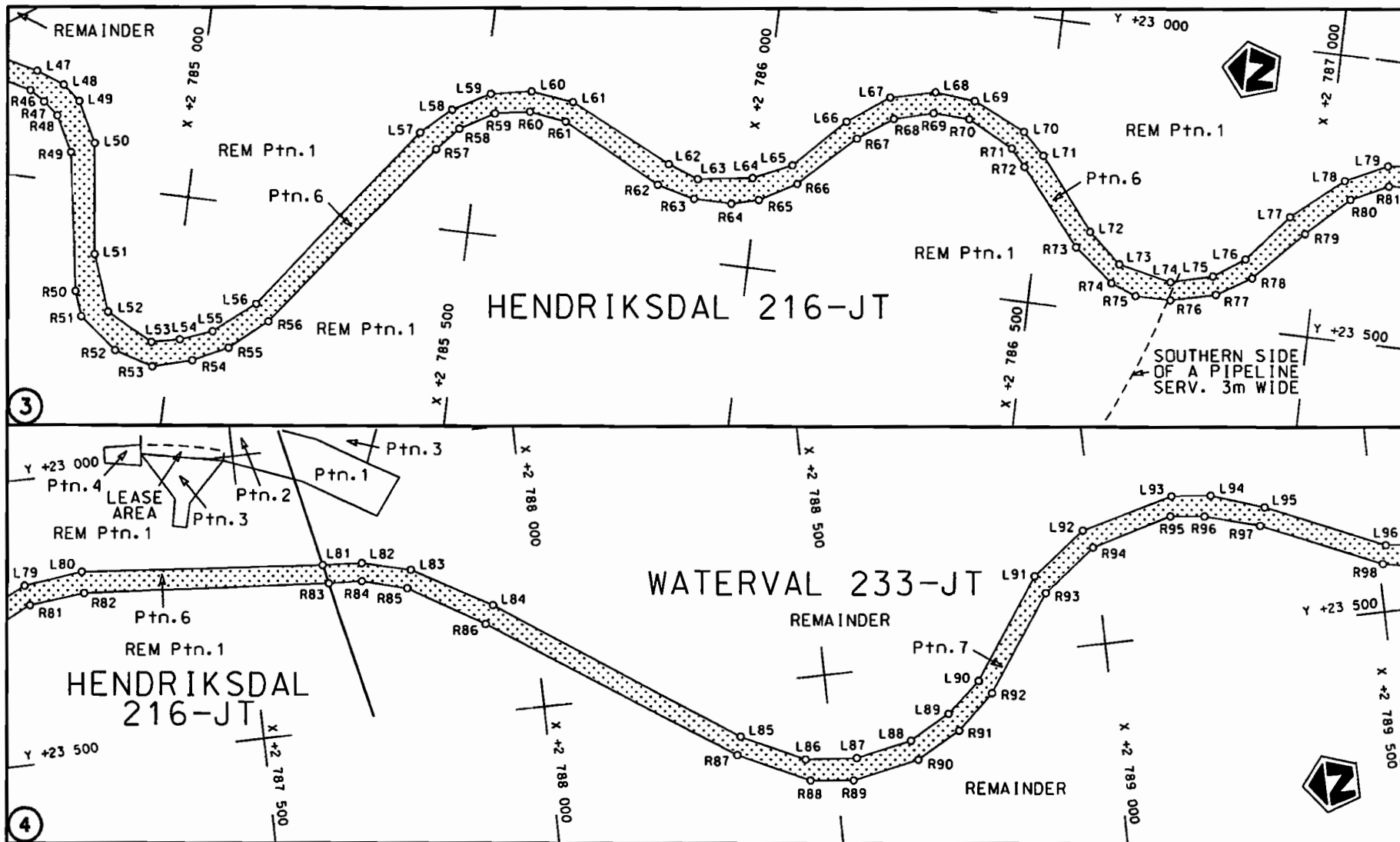

<p>Die Suid Afrikaanse Nasionale Padogenskap Beperk The South African National Roads Agency Limited</p>	<p>Die figuur getoon The figure shown</p>		<p>steldie podreserwe voor van 'n gedeelte represents the road reserve of a portion van Nasionale Roete R37 Seksie 4 of National Route</p>	<p>Vel Sheet 1 van of 14 Plan P762/09</p>
---	---	--	--	---

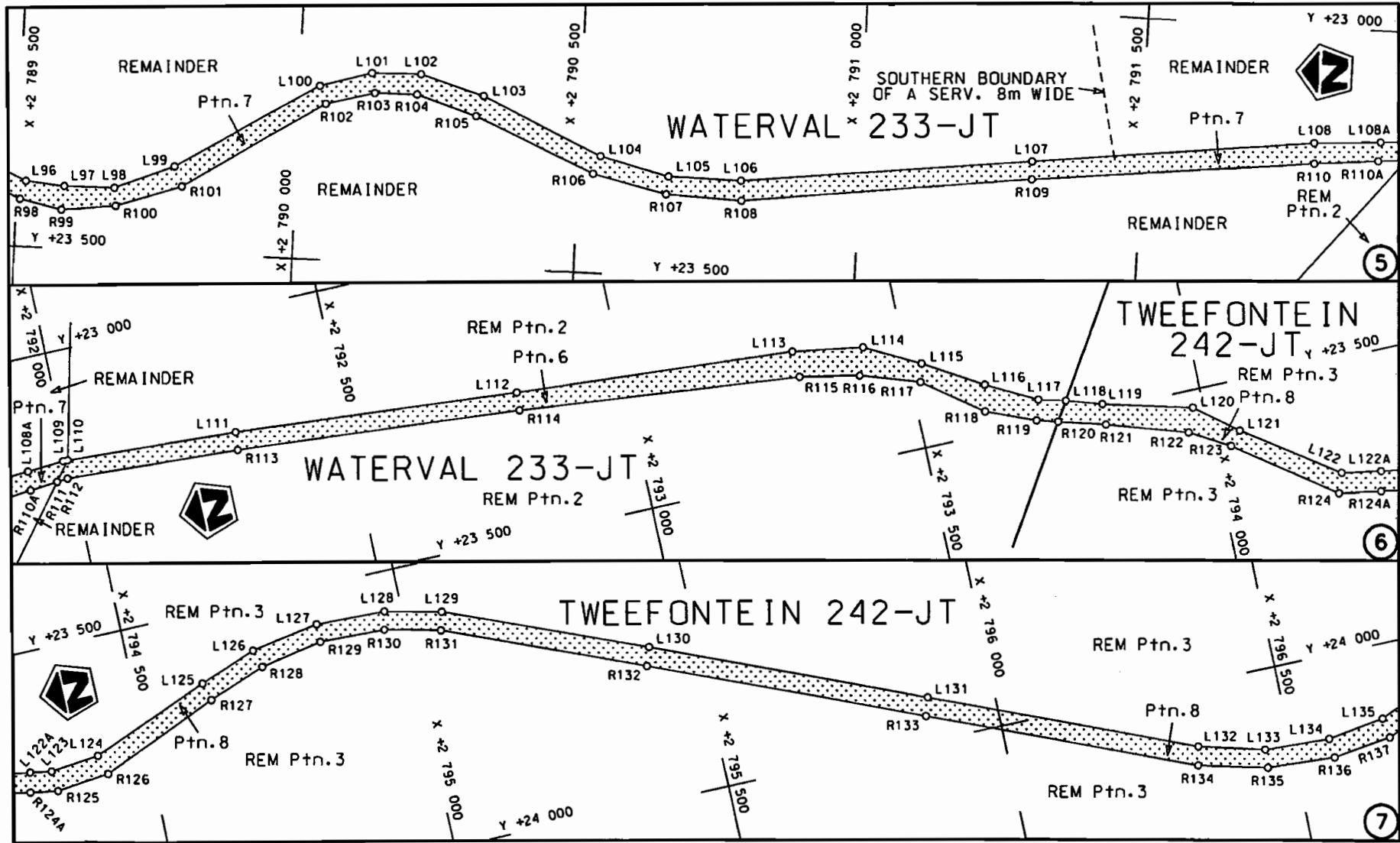

<p>Die Suid Afrikaanse Nasionale Padagentskop Beperk The South African National Roads Agency Limited</p>	<p>Die figuur getoon The figure shown</p>		<p>steldie padreserwe voor van 'n gedeelte represents the road reserve of a portion van Nasionale Roete of National Route</p>	<p>R37</p>	<p>Seksie Section</p>	<p>4</p>	<p>Vel Sheet</p>	<p>2 van of 14</p>	<p>Plan P762/09</p>
--	---	--	---	------------	---------------------------	----------	----------------------	------------------------	-------------------------

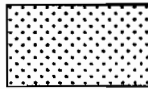

Die Suid Afrikaanse Nasionale Padagentskap Beperk	Die figuur getoon		steldie padreserwe voor van 'n gedeelte	Vel Sheet 3 van 14
The South African National Roads Agency Limited	The figure shown		represents the road reserve of a portion van Nasionale Roete R37 Sektie Section 4	Plan P762/09

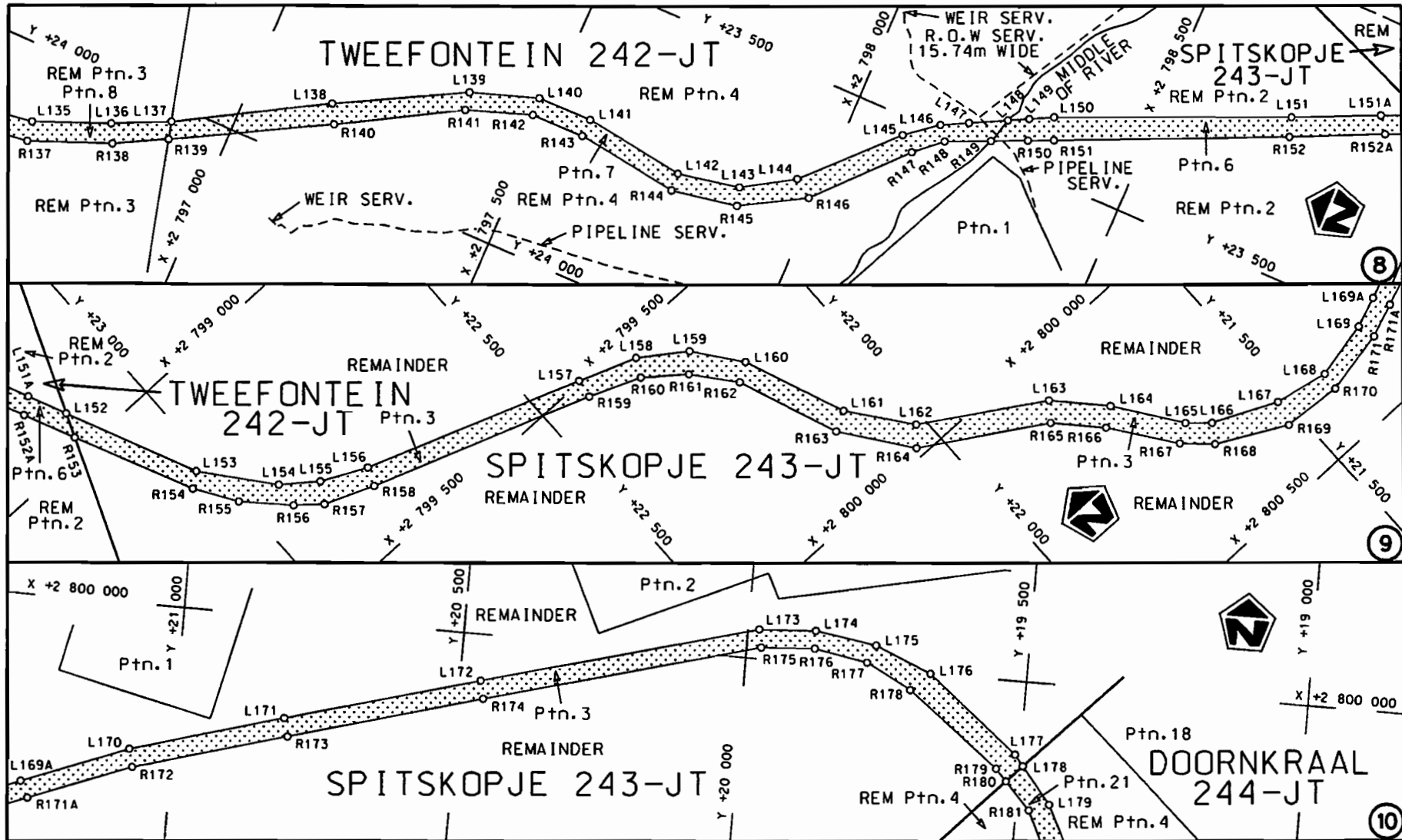

<p>Die Suid Afrikaanse Nasionale Padagentskap Beperk The South African National Roads Agency Limited</p>	<p>Die figuur getoon The figure shown</p>		<p>stel die padreserwe voor van 'n gedeelte represents the road reserve of a portion van Nasionale Roete R37 of National Route R37</p> <p>Seksie 4 Section 4</p>	<p>Vel Sheet 4 van 14 of 14</p> <p>Plan P762/09</p>
--	---	---	--	---

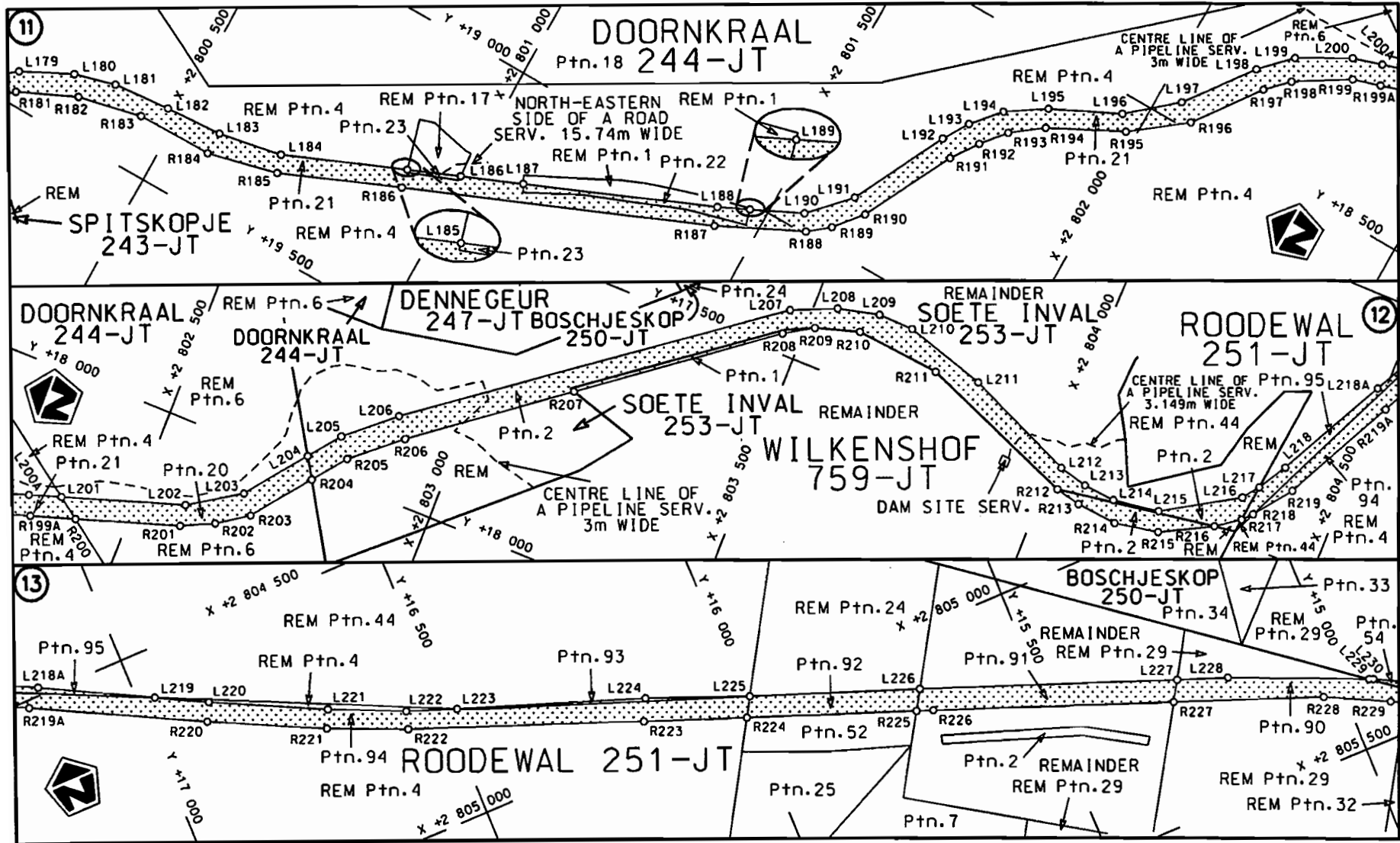

Die Suid Afrikaanse Nasionale Padagentskap Beperk	Die figuur getoon	steldie padreserwe voor van 'n gedeelte	Vel Sheet 5 van 14
The South African National Roads Agency Limited	The figure shown	represents the road reserve of a portion van Nasionale Roete R37 Seksie Section 4	Plan P762/09

STAATSKOERANT, 12 NOVEMBER 2010

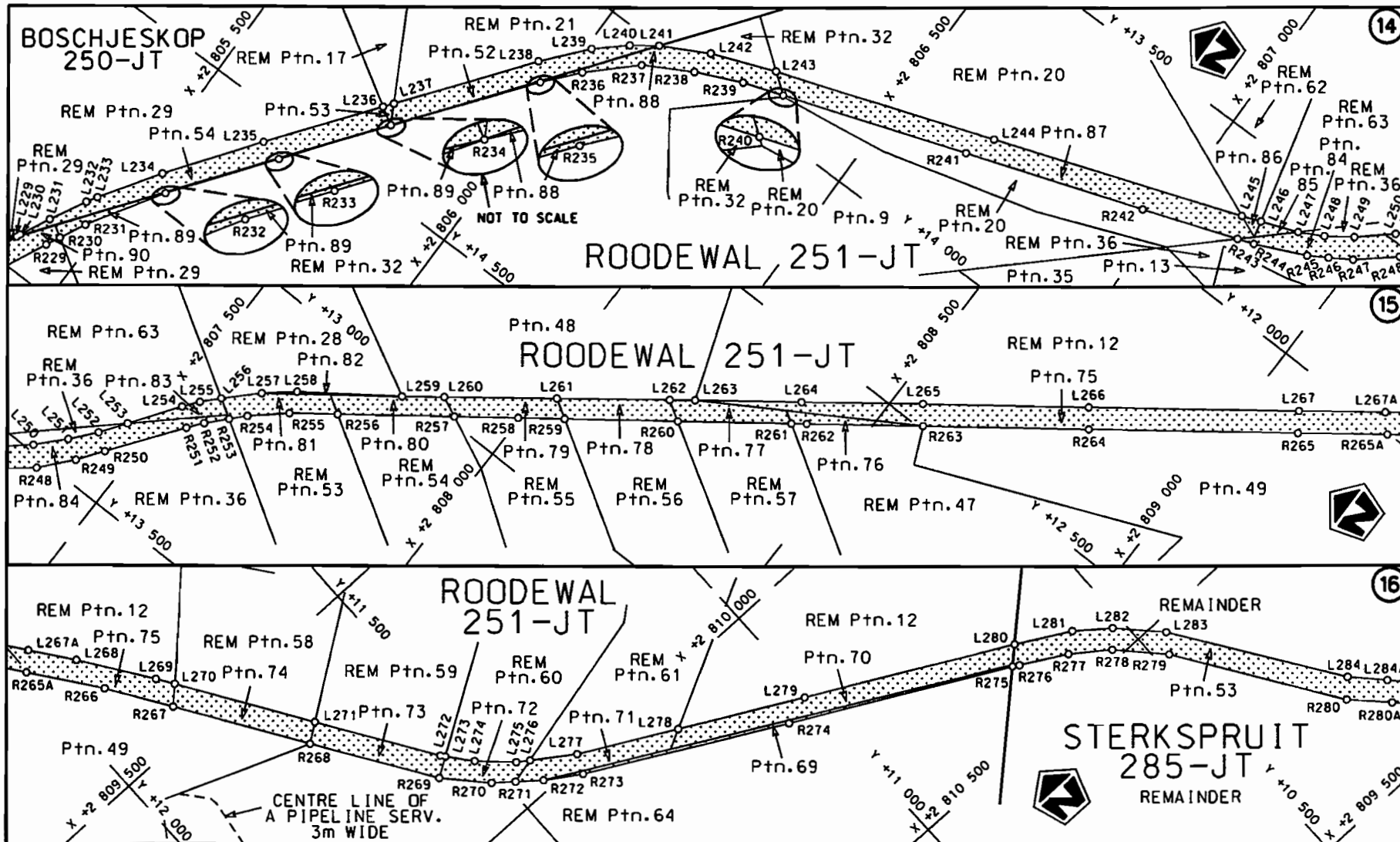

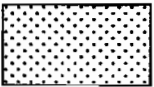
<p>Die Suid Afrikaanse Nasionale Padagentskap Beperk The South African National Roads Agency Limited</p>	<p>Die figuur getoon The figure shown</p>		<p>steldie padreserwe voor van 'n gedeelte represents the road reserve of a portion van Nasionale Roete R37 Sektie of National Route Section 4</p>	<p>Vel Sheet 6 van of 14</p>
				<p>Plan P762/09</p>

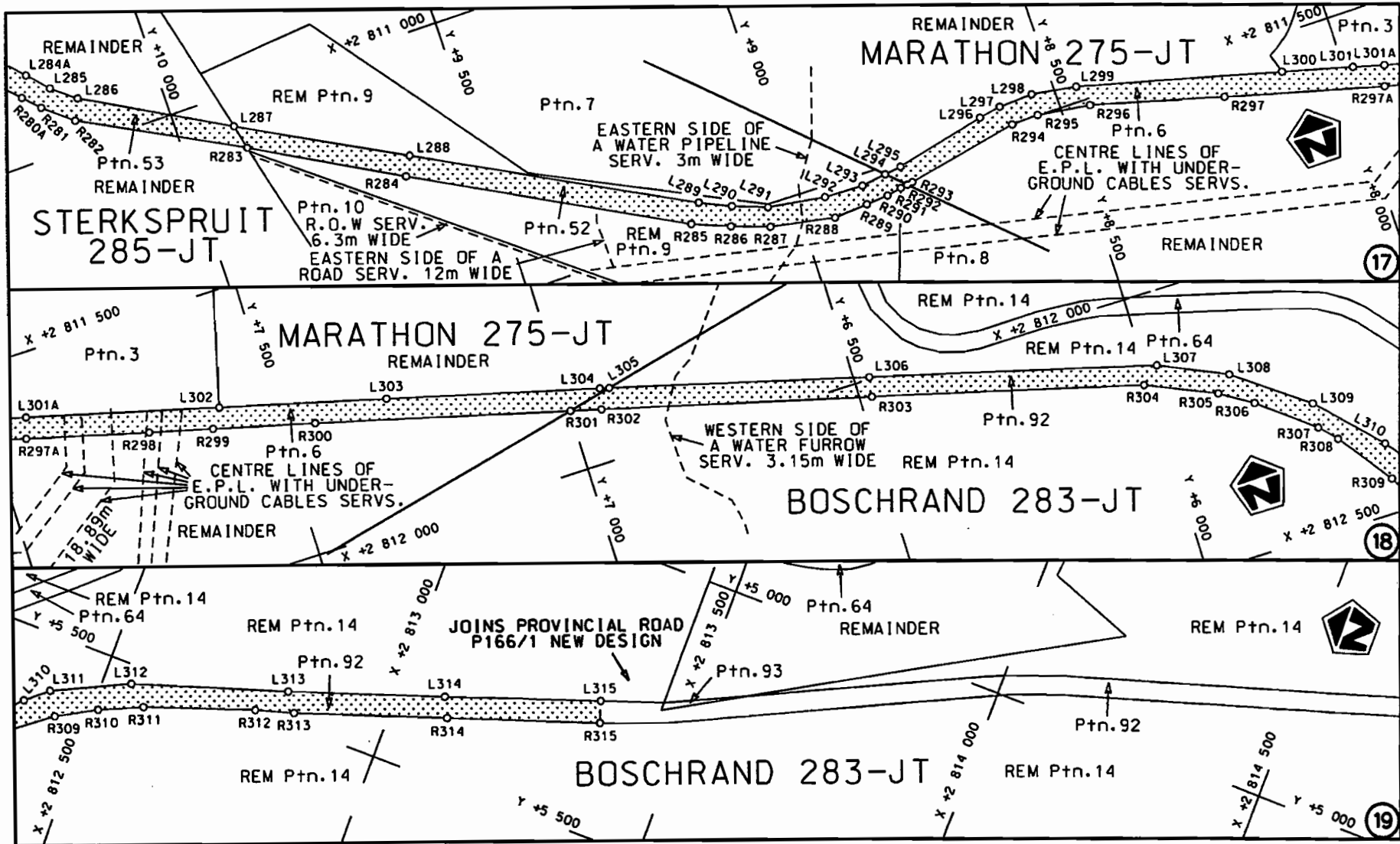

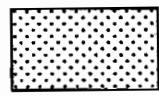
<p>Die Suid Afrikaanse Nasionale Padagentskap Beperk The South African National Roads Agency Limited</p>	<p>Die figuur getoon The figure shown</p> 	<p>steldie padreserwe voor van 'n gedeelte represents the road reserve of a portion van Nasionale Roete R37 of National Route R37</p> <p>Seksie 4 Section 4</p>	<p>Vel Sheet 7 van 14 of 14</p> <p>Plan P762/09</p>
--	---	---	---

PADRESERWE KOÖRDINATE				/	ROAD RESERVE CO-ORDINATES			
LINKERKANT/LEFT HAND SIDE					REGTERKANT/RIGHT HAND SIDE			
	Y	X	WG 31°		Y	X		
L1	24 530.000	2 782 532.070		R1	24 554.880	2 782 573.060		
L2	24 496.140	2 782 555.870		R2	24 513.170	2 782 587.380		
L3	24 452.260	2 782 568.060		R3	24 471.270	2 782 601.550		
L4	24 426.750	2 782 559.050		R4	24 436.280	2 782 601.710		
L5	24 411.340	2 782 543.420		R5	24 408.380	2 782 593.390		
L6	24 397.490	2 782 513.080		R6	24 381.480	2 782 565.500		
L7	24 386.800	2 782 478.880		R7	24 361.620	2 782 531.560		
L8	24 370.090	2 782 431.150		R8	24 342.100	2 782 464.440		
L9	24 340.650	2 782 385.690		R9	24 311.740	2 782 412.300		
L10	24 293.960	2 782 341.530		R10	24 280.770	2 782 384.790		
L11	24 257.090	2 782 304.800		R11	24 227.940	2 782 335.320		
L12	23 894.870	2 781 966.810		R12	23 864.400	2 781 987.330		
L13	23 781.060	2 781 767.110		R13	23 749.590	2 781 785.660		
L14	23 711.280	2 781 709.040		R14	23 698.410	2 781 740.560		
L15	23 678.820	2 781 697.600		R15	23 629.690	2 781 735.000		
L16	23 614.470	2 781 699.460		R16	23 581.090	2 781 758.770		
L17	23 564.810	2 781 716.400		R17	23 547.530	2 781 795.060		
L18	23 524.050	2 781 761.270		R18	23 521.230	2 781 926.670		
L19	23 492.690	2 781 830.000		R19	23 520.470	2 782 103.900		
L20	23 481.550	2 781 954.190		R20	23 515.660	2 782 164.240		
L21	23 487.290	2 782 105.080		R21	23 462.530	2 782 280.790		
L22	23 465.120	2 782 186.310		R22	23 448.210	2 782 369.730		
L23	23 428.020	2 782 268.910		R23	23 468.720	2 782 461.260		
L24	23 411.770	2 782 356.280		R24	23 520.070	2 782 575.870		
L25	23 419.130	2 782 440.900		R25	23 554.900	2 782 716.580		
L26	23 475.160	2 782 567.770		R26	23 578.480	2 782 797.940		
L27	23 503.200	2 782 694.030		R27	23 583.940	2 782 833.150		
L28	23 543.490	2 782 841.370		R28	23 578.390	2 782 898.450		
L29	23 537.360	2 782 888.760		R29	23 518.870	2 782 968.560		
L30	23 487.870	2 782 943.250		R30	23 420.620	2 783 014.430		
L31	23 389.750	2 782 987.470		R31	23 373.230	2 783 036.650		
L32	23 343.690	2 783 008.330		R32	23 333.680	2 783 077.820		
L33	23 301.030	2 783 060.020		R33	23 264.920	2 783 222.130		
L34	23 228.830	2 783 195.950		R34	23 180.460	2 783 292.510		
L35	23 148.620	2 783 267.790		R35	23 138.760	2 783 372.170		
L36	23 089.730	2 783 357.710		R36	23 167.140	2 783 462.230		
L37	23 133.100	2 783 478.710		R37	23 196.820	2 783 501.720		
L38	23 134.770	2 783 486.700		R38	23 303.200	2 783 653.060		
L39	23 275.410	2 783 686.910		R39	23 325.350	2 783 735.160		
L40	23 290.630	2 783 735.480		R40	23 334.180	2 783 767.300		
L41	23 302.700	2 783 773.290		R41	23 339.440	2 783 871.070		
L42	23 295.990	2 783 855.720		R42	23 301.070	2 783 949.080		
L43	23 266.490	2 783 932.410		R43	23 233.810	2 784 076.640		
L44	23 198.700	2 784 059.840		R44	23 218.410	2 784 153.720		
L45	23 185.870	2 784 155.180		R45	23 307.560	2 784 530.650		
L46	23 281.060	2 784 571.200		R46	23 347.150	2 784 698.440		
L47	23 311.800	2 784 706.030		R47	23 363.990	2 784 725.140		
L48	23 330.420	2 784 756.460		R48	23 385.640	2 784 751.590		
L49	23 355.300	2 784 788.190		R49	23 447.030	2 784 784.160		
L50	23 425.410	2 784 824.520		R50	23 687.600	2 784 822.170		
L51	23 619.190	2 784 848.170		R51	23 730.220	2 784 838.100		

Vel	8	Van	14	P762/09
Sheet		of		

PADRESERWE KOÖRDINATE				/	ROAD RESERVE CO-ORDINATES			
LINKERKANT/LEFT HAND SIDE					REGTERKANT/RIGHT HAND SIDE			
	Y	X	WG	31°	Y	X		
L52	23 716.240	2 784 884.480		R52	23 781.820	2 784 905.340		
L53	23 759.830	2 784 965.980		R53	23 802.130	2 784 972.640		
L54	23 749.180	2 785 015.730		R54	23 783.040	2 785 042.050		
L55	23 728.280	2 785 071.630		R55	23 753.250	2 785 103.540		
L56	23 670.840	2 785 142.840		R56	23 698.540	2 785 168.240		
L57	23 335.660	2 785 396.230		R57	23 361.150	2 785 427.680		
L58	23 288.720	2 785 447.030		R58	23 320.260	2 785 463.600		
L59	23 252.840	2 785 510.830		R59	23 286.150	2 785 522.100		
L60	23 239.600	2 785 582.210		R60	23 275.510	2 785 583.660		
L61	23 249.080	2 785 657.580		R61	23 285.170	2 785 649.040		
L62	23 336.860	2 785 840.330		R62	23 375.240	2 785 825.610		
L63	23 356.620	2 785 893.770		R63	23 391.950	2 785 891.650		
L64	23 342.740	2 785 990.200		R64	23 392.220	2 785 957.980		
L65	23 311.970	2 786 056.890		R65	23 379.860	2 786 005.720		
L66	23 223.770	2 786 143.770		R66	23 343.460	2 786 069.430		
L67	23 171.770	2 786 216.010		R67	23 251.240	2 786 165.500		
L68	23 152.970	2 786 294.410		R68	23 208.480	2 786 226.840		
L69	23 159.870	2 786 364.780		R69	23 190.130	2 786 295.560		
L70	23 203.340	2 786 457.190		R70	23 192.830	2 786 358.800		
L71	23 240.940	2 786 496.320		R71	23 234.880	2 786 439.450		
L72	23 363.340	2 786 594.710		R72	23 264.440	2 786 465.370		
L73	23 413.470	2 786 653.150		R73	23 393.160	2 786 572.940		
L74	23 433.400	2 786 748.230		R74	23 447.930	2 786 643.270		
L75	23 414.420	2 786 821.640		R75	23 465.240	2 786 688.910		
L76	23 377.820	2 786 875.440		R76	23 465.000	2 786 752.000		
L77	23 294.600	2 786 944.460		R77	23 445.950	2 786 830.800		
L78	23 219.890	2 787 033.820		R78	23 409.330	2 786 890.980		
L79	23 184.730	2 787 107.400		R79	23 320.790	2 786 974.540		
L80	23 172.150	2 787 212.180		R80	23 251.370	2 787 047.890		
L81	23 208.270	2 787 639.430		R81	23 219.630	2 787 113.220		
L82	23 212.970	2 787 709.150		R82	23 209.530	2 787 212.180		
L83	23 234.160	2 787 793.610		R83	23 241.380	2 787 646.710		
L84	23 311.820	2 787 929.730		R84	23 244.470	2 787 705.700		
L85	23 591.420	2 788 339.950		R85	23 265.630	2 787 783.850		
L86	23 643.930	2 788 450.040		R86	23 343.270	2 787 913.340		
L87	23 651.510	2 788 540.830		R87	23 622.910	2 788 330.510		
L88	23 632.140	2 788 640.070		R88	23 681.560	2 788 454.470		
L89	23 592.760	2 788 711.210		R89	23 689.810	2 788 530.850		
L90	23 540.650	2 788 770.230		R90	23 666.910	2 788 649.510		
L91	23 368.360	2 788 888.920		R91	23 624.340	2 788 726.530		
L92	23 297.840	2 788 982.880		R92	23 564.720	2 788 791.390		
L93	23 255.530	2 789 147.590		R93	23 399.900	2 788 905.200		
L94	23 262.180	2 789 216.400		R94	23 329.360	2 788 997.430		
L95	23 293.120	2 789 308.950		R95	23 290.420	2 789 141.760		
L96	23 383.820	2 789 515.850		R96	23 297.300	2 789 201.530		
L97	23 389.570	2 789 585.720		R97	23 324.630	2 789 297.480		
L98	23 389.610	2 789 675.770		R98	23 415.830	2 789 506.770		
L99	23 347.360	2 789 781.800		R99	23 431.220	2 789 582.240		
L100	23 193.090	2 790 036.070		R100	23 421.330	2 789 679.530		
L101	23 166.010	2 790 127.860		R101	23 381.970	2 789 796.370		
L102	23 164.090	2 790 215.080		R102	23 224.600	2 790 047.920		

Vel	9	Van	14	P762/09
Sheet		of		

PADRESERWE KOÖRDINATE				/ ROAD RESERVE CO-ORDINATES			
LINKERKANT/LEFT HAND SIDE				REGTERKANT/RIGHT HAND SIDE			
	Y	X	WG 31°		Y	X	
L103	23 197.180	2 790	326.920	R103	23 201.130	2 790	134.540
L104	23 292.820	2 790	538.620	R104	23 200.370	2 790	209.920
L105	23 322.520	2 790	661.510	R105	23 233.150	2 790	315.160
L106	23 323.380	2 790	790.150	R106	23 324.190	2 790	526.750
L107	23 263.170	2 791	306.150	R107	23 354.010	2 790	658.910
L108	23 203.940	2 791	805.970	R108	23 358.620	2 790	792.470
L109	23 192.660	2 791	990.400	R109	23 294.670	2 791	307.050
L110	23 193.150	2 791	999.030	R110	23 240.250	2 791	807.930
L111	23 209.980	2 792	304.340	R111	23 225.750	2 791	972.050
L112	23 249.860	2 792	808.310	R112	23 224.140	2 791	991.520
L113	23 284.050	2 793	302.260	R113	23 241.480	2 792	301.490
L114	23 303.600	2 793	427.710	R114	23 281.370	2 792	806.260
L115	23 353.700	2 793	525.150	R115	23 330.290	2 793	305.510
L116	23 413.820	2 793	626.440	R116	23 351.030	2 793	411.180
L117	23 459.360	2 793	713.320	R117	23 385.230	2 793	516.510
L118	23 471.350	2 793	760.560	R118	23 460.040	2 793	617.190
L119	23 490.700	2 793	823.330	R119	23 494.290	2 793	702.790
L120	23 530.870	2 793	980.960	R120	23 504.630	2 793	739.470
L121	23 587.450	2 794	054.410	R121	23 527.350	2 793	822.040
L122	23 697.740	2 794	215.630	R122	23 571.830	2 793	964.750
L123	23 715.900	2 794	323.620	R123	23 610.960	2 794	033.550
L124	23 706.300	2 794	411.260	R124	23 731.730	2 794	203.560
L125	23 622.840	2 794	622.830	R125	23 752.060	2 794	327.480
L126	23 586.320	2 794	724.650	R126	23 740.960	2 794	422.410
L127	23 565.680	2 794	845.690	R127	23 654.340	2 794	632.080
L128	23 569.800	2 794	968.790	R128	23 617.830	2 794	734.770
L129	23 592.270	2 795	068.350	R129	23 597.190	2 794	845.420
L130	23 731.520	2 795	414.870	R130	23 601.010	2 794	961.750
L131	23 923.370	2 795	882.930	R131	23 623.740	2 795	060.100
L132	24 108.750	2 796	337.650	R132	23 763.030	2 795	403.940
L133	24 138.840	2 796	452.940	R133	23 954.860	2 795	872.870
L134	24 143.990	2 796	568.510	R134	24 141.200	2 796	330.020
L135	24 129.170	2 796	669.110	R135	24 170.800	2 796	450.990
L136	24 076.030	2 796	799.480	R136	24 177.570	2 796	570.950
L137	24 030.130	2 796	896.400	R137	24 163.990	2 796	675.110
L138	23 885.340	2 797	147.250	R138	24 107.560	2 796	815.400
L139	23 769.250	2 797	362.790	R139	24 060.810	2 796	904.270
L140	23 729.170	2 797	480.570	R140	23 917.490	2 797	165.030
L141	23 728.490	2 797	577.260	R141	23 800.730	2 797	368.240
L142	23 753.180	2 797	757.990	R142	23 760.670	2 797	482.070
L143	23 731.510	2 797	867.760	R143	23 759.990	2 797	576.060
L144	23 676.900	2 797	956.260	R144	23 784.740	2 797	759.400
L145	23 531.130	2 798	097.210	R145	23 762.940	2 797	876.660
L146	23 487.830	2 798	151.860	R146	23 699.370	2 797	988.000
L147	23 464.190	2 798	197.590	R147	23 552.350	2 798	124.230
L148	23 432.074	2 798	260.014	R148	23 511.550	2 798	170.370
L149	23 414.820	2 798	293.550	R149	23 477.582	2 798	246.577
L150	23 394.650	2 798	332.730	R150	23 450.850	2 798	306.550
L151	23 227.010	2 798	721.000	R151	23 432.120	2 798	348.550
L152	23 130.950	2 798	932.840	R152	23 260.240	2 798	731.210
L153	23 025.110	2 799	162.820	R153	23 147.590	2 798	974.280

Vel	10	Van	14	P762/09
Sheet		of		

PADRESERWE KOÖRDINATE				/	ROAD RESERVE CO-ORDINATES			
LINKERKANT/LEFT HAND SIDE					REGTERKANT/RIGHT HAND SIDE			
	Y	X	WG	31°	Y	X		
L154	22 931.050	2 799 278.390		R154	23 050.080	2 799 181.620		
L155	22 871.620	2 799 323.740		R155	23 004.140	2 799 253.060		
L156	22 792.240	2 799 361.600		R156	22 935.920	2 799 322.930		
L157	22 411.150	2 799 496.710		R157	22 892.610	2 799 358.770		
L158	22 309.580	2 799 533.340		R158	22 805.580	2 799 393.110		
L159	22 230.680	2 799 587.670		R159	22 416.490	2 799 528.850		
L160	22 169.130	2 799 668.070		R160	22 326.240	2 799 564.840		
L161	22 097.010	2 799 847.810		R161	22 258.580	2 799 617.080		
L162	22 016.790	2 799 951.930		R162	22 200.620	2 799 687.910		
L163	21 812.290	2 800 078.190		R163	22 130.800	2 799 866.240		
L164	21 738.080	2 800 158.020		R164	22 043.950	2 799 983.420		
L165	21 658.700	2 800 269.210		R165	21 836.400	2 800 109.690		
L166	21 623.430	2 800 300.720		R166	21 769.580	2 800 181.170		
L167	21 511.400	2 800 352.120		R167	21 690.150	2 800 289.480		
L168	21 416.790	2 800 371.590		R168	21 644.530	2 800 332.200		
L169	21 316.220	2 800 349.880		R169	21 524.290	2 800 395.240		
L170	21 076.150	2 800 256.170		R170	21 420.200	2 800 403.220		
L171	20 805.810	2 800 178.690		R171	21 307.880	2 800 380.630		
L172	20 463.110	2 800 081.730		R172	21 068.260	2 800 287.660		
L173	19 980.310	2 799 948.370		R173	20 797.160	2 800 210.600		
L174	19 880.690	2 799 942.110		R174	20 456.290	2 800 113.220		
L175	19 772.170	2 799 958.850		R175	19 974.310	2 799 979.850		
L176	19 671.610	2 800 000.260		R176	19 879.980	2 799 973.600		
L177	19 509.040	2 800 129.150		R177	19 785.410	2 799 990.360		
L178	19 493.590	2 800 148.390		R178	19 704.830	2 800 031.700		
L179	19 442.360	2 800 212.210		R179	19 540.560	2 800 156.690		
L180	19 397.420	2 800 301.200		R180	19 521.230	2 800 177.370		
L181	19 377.510	2 800 374.510		R181	19 476.700	2 800 224.960		
L182	19 368.050	2 800 476.820		R182	19 428.910	2 800 327.300		
L183	19 360.460	2 800 580.280		R183	19 403.600	2 800 441.540		
L184	19 338.070	2 800 695.930		R184	19 401.530	2 800 578.650		
L185	19 251.400	2 800 903.630		R185	19 369.590	2 800 706.100		
L186	19 214.190	2 800 991.800		R186	19 283.580	2 800 910.400		
L187	19 170.470	2 801 096.210		R187	19 067.550	2 801 427.610		
L188	19 036.050	2 801 416.010		R188	18 995.080	2 801 574.510		
L189	19 010.560	2 801 468.950		R189	18 965.320	2 801 611.030		
L190	18 968.390	2 801 556.490		R190	18 916.680	2 801 651.270		
L191	18 899.360	2 801 620.370		R191	18 754.530	2 801 733.500		
L192	18 731.300	2 801 705.120		R192	18 706.680	2 801 766.080		
L193	18 685.510	2 801 732.870		R193	18 663.730	2 801 801.740		
L194	18 635.630	2 801 775.830		R194	18 622.800	2 801 855.070		
L195	18 590.930	2 801 842.510		R195	18 557.740	2 801 981.530		
L196	18 533.630	2 801 960.360		R196	18 486.260	2 802 073.360		
L197	18 463.030	2 802 041.800		R197	18 371.400	2 802 157.010		
L198	18 346.490	2 802 128.100		R198	18 334.300	2 802 193.580		
L199	18 294.750	2 802 178.030		R199	18 276.310	2 802 285.800		
L200	18 243.720	2 802 267.070		R200	18 235.900	2 802 411.310		
L201	18 209.120	2 802 374.010		R201	18 178.400	2 802 589.950		
L202	18 140.680	2 802 585.500		R202	18 150.750	2 802 648.200		
L203	18 082.350	2 802 677.920		R203	18 113.830	2 802 703.580		
L204	17 978.890	2 802 759.680		R204	18 014.850	2 802 781.560		

Vel	11	Van	14	P762/09
Sheet		of		

PADRESERWE KOÖRDINATE				/ ROAD RESERVE CO-ORDINATES			
LINKERKANT/LEFT HAND SIDE				REGTERKANT/RIGHT HAND SIDE			
	Y	X	WG 31°		Y	X	
L205	17 925.140	2 802	802.150	R205	17 958.070	2 802	826.270
L206	17 854.080	2 802	884.230	R206	17 887.380	2 802	908.860
L207	17 421.770	2 803	463.630	R207	17 698.210	2 803	159.030
L208	17 387.660	2 803	540.970	R208	17 465.130	2 803	466.400
L209	17 370.040	2 803	614.220	R209	17 434.610	2 803	515.880
L210	17 371.580	2 803	678.040	R210	17 410.990	2 803	593.120
L211	17 414.570	2 803	821.900	R211	17 425.580	2 803	744.810
L212	17 497.710	2 804	015.710	R212	17 535.180	2 804	023.050
L213	17 510.290	2 804	066.360	R213	17 545.240	2 804	067.870
L214	17 515.510	2 804	122.390	R214	17 552.310	2 804	139.600
L215	17 503.200	2 804	204.640	R215	17 537.520	2 804	217.540
L216	17 424.630	2 804	334.000	R216	17 490.450	2 804	306.710
L217	17 396.410	2 804	355.670	R217	17 460.940	2 804	347.500
L218	17 346.560	2 804	386.020	R218	17 444.520	2 804	363.090
L219	16 969.540	2 804	583.900	R219	17 379.740	2 804	412.910
L220	16 882.730	2 804	629.480	R220	16 898.750	2 804	659.910
L221	16 690.220	2 804	724.130	R221	16 704.950	2 804	754.610
L222	16 563.440	2 804	780.970	R222	16 572.450	2 804	811.190
L223	16 478.210	2 804	812.300	R223	16 178.410	2 804	961.320
L224	16 159.960	2 804	924.610	R224	16 005.380	2 805	026.130
L225	15 985.740	2 804	993.560	R225	15 720.110	2 805	131.620
L226	15 699.570	2 805	098.230	R226	15 692.000	2 805	141.990
L227	15 267.240	2 805	258.630	R227	15 287.870	2 805	292.180
L228	15 181.910	2 805	289.230	R228	15 035.280	2 805	386.090
L229	14 948.480	2 805	387.540	R229	14 927.700	2 805	438.330
L230	14 941.570	2 805	390.340	R230	14 903.260	2 805	450.630
L231	14 888.310	2 805	417.000	R231	14 858.000	2 805	473.480
L232	14 824.730	2 805	450.950	R232	14 729.510	2 805	554.350
L233	14 807.170	2 805	461.840	R233	14 560.940	2 805	680.820
L234	14 705.240	2 805	529.510	R234	14 394.310	2 805	804.660
L235	14 553.440	2 805	640.610	R235	14 176.290	2 805	970.990
L236	14 376.180	2 805	774.360	R236	14 118.080	2 806	020.560
L237	14 360.780	2 805	785.870	R237	14 044.670	2 806	097.480
L238	14 148.630	2 805	946.720	R238	13 998.800	2 806	179.340
L239	14 075.020	2 806	008.760	R239	13 962.540	2 806	259.340
L240	14 029.450	2 806	059.730	R240	13 938.140	2 806	329.520
L241	13 998.740	2 806	102.290	R241	13 826.550	2 806	650.870
L242	13 955.770	2 806	182.900	R242	13 719.290	2 806	962.130
L243	13 911.940	2 806	294.690	R243	13 661.650	2 807	127.760
L244	13 777.630	2 806	676.710	R244	13 651.820	2 807	155.940
L245	13 624.620	2 807	110.340	R245	13 612.330	2 807	244.140
L246	13 612.510	2 807	142.680	R246	13 592.470	2 807	277.250
L247	13 588.520	2 807	206.740	R247	13 569.560	2 807	314.910
L248	13 566.240	2 807	249.120	R248	13 516.390	2 807	378.190
L249	13 536.220	2 807	293.230	R249	13 462.550	2 807	424.830
L250	13 488.350	2 807	348.950	R250	13 418.780	2 807	456.150
L251	13 442.200	2 807	391.710	R251	13 298.230	2 807	544.400
L252	13 399.850	2 807	427.040	R252	13 272.400	2 807	564.200
L253	13 356.040	2 807	457.820	R253	13 239.450	2 807	594.650
L254	13 273.810	2 807	515.630	R254	13 215.330	2 807	616.950
L255	13 247.830	2 807	535.640	R255	13 164.840	2 807	673.760

Vel	12	Van	14	P762/09
Sheet		of		

PADRESERWE KOÖRDINATE				/	ROAD RESERVE CO-ORDINATES			
LINKERKANT/LEFT HAND SIDE					REGTERKANT/RIGHT HAND SIDE			
	Y	X	WG	31°	Y	X		
L256	13 219.620	2 807 561.640		R256	13 112.700	2 807 743.280		
L257	13 168.090	2 807 613.020		R257	12 990.000	2 807 906.870		
L258	13 126.890	2 807 661.480		R258	12 922.320	2 807 997.070		
L259	13 019.140	2 807 812.890		R259	12 872.920	2 808 063.150		
L260	12 974.090	2 807 872.090		R260	12 753.160	2 808 223.340		
L261	12 853.270	2 808 030.540		R261	12 633.400	2 808 383.520		
L262	12 732.490	2 808 189.010		R262	12 616.930	2 808 405.530		
L263	12 705.460	2 808 224.480		R263	12 493.550	2 808 570.580		
L264	12 592.670	2 808 374.960		R264	12 318.140	2 808 806.030		
L265	12 463.110	2 808 546.570		R265	12 097.440	2 809 102.280		
L266	12 287.850	2 808 782.380		R266	11 917.380	2 809 343.970		
L267	12 065.650	2 809 079.970		R267	11 848.670	2 809 448.440		
L268	11 921.280	2 809 273.330		R268	11 709.530	2 809 660.170		
L269	11 838.920	2 809 391.550		R269	11 580.450	2 809 856.550		
L270	11 819.780	2 809 420.430		R270	11 517.550	2 809 924.340		
L271	11 677.700	2 809 637.890		R271	11 484.270	2 809 951.130		
L272	11 553.070	2 809 828.300		R272	11 445.360	2 809 982.570		
L273	11 547.130	2 809 835.610		R273	11 386.190	2 810 020.540		
L274	11 514.370	2 809 875.930		R274	11 057.230	2 810 196.370		
L275	11 460.770	2 809 926.390		R275	10 697.040	2 810 386.790		
L276	11 440.140	2 809 940.450		R276	10 686.790	2 810 393.210		
L277	11 370.660	2 809 987.840		R277	10 609.000	2 810 436.740		
L278	11 208.800	2 810 073.770		R278	10 546.520	2 810 483.310		
L279	11 006.460	2 810 181.250		R279	10 477.020	2 810 556.770		
L280	10 668.330	2 810 360.420		R280	10 298.640	2 810 826.230		
L281	10 576.940	2 810 411.370		R281	10 214.960	2 810 912.170		
L282	10 520.550	2 810 455.410		R282	10 164.050	2 810 954.040		
L283	10 454.830	2 810 524.200		R283	9 888.340	2 811 100.270		
L284	10 270.640	2 810 797.450		R284	9 637.660	2 811 240.000		
L285	10 188.770	2 810 884.810		R285	9 185.980	2 811 483.690		
L286	10 147.390	2 810 918.220		R286	9 120.840	2 811 510.320		
L287	9 899.110	2 811 056.280		R287	9 055.010	2 811 533.790		
L288	9 619.640	2 811 207.360		R288	8 940.230	2 811 555.660		
L289	9 161.180	2 811 452.200		R289	8 878.670	2 811 551.560		
L290	9 107.620	2 811 477.080		R290	8 838.960	2 811 548.950		
L291	9 047.810	2 811 499.790		R291	8 812.090	2 811 543.870		
L292	8 945.750	2 811 515.470		R292	8 799.540	2 811 542.190		
L293	8 875.330	2 811 517.830		R293	8 789.270	2 811 540.480		
L294	8 830.840	2 811 512.050		R294	8 590.070	2 811 500.550		
L295	8 800.680	2 811 508.150		R295	8 542.220	2 811 499.170		
L296	8 640.380	2 811 470.890		R296	8 448.520	2 811 511.650		
L297	8 601.230	2 811 463.980		R297	8 217.170	2 811 573.870		
L298	8 540.540	2 811 461.150		R298	7 725.950	2 811 703.070		
L299	8 461.180	2 811 473.140		R299	7 615.660	2 811 731.400		
L300	8 106.570	2 811 564.080		R300	7 437.110	2 811 777.710		
L301	7 984.370	2 811 596.220		R301	6 998.700	2 811 893.200		
L302	7 593.450	2 811 699.040		R302	6 944.750	2 811 907.410		
L303	7 302.930	2 811 774.830		R303	6 478.050	2 812 030.510		
L304	6 936.530	2 811 871.220		R304	6 009.770	2 812 153.920		
L305	6 920.290	2 811 875.540		R305	5 887.930	2 812 206.380		
L306	6 472.160	2 811 996.360		R306	5 831.230	2 812 241.330		

Vel	13	Van	14	P762/09
Sheet		of		

PADRESERWE KOÖRDINATE				/	ROAD RESERVE CO-ORDINATES			
LINKERKANT/LEFT HAND SIDE					REGTERKANT/RIGHT HAND SIDE			
	Y	X	WG	31°	Y	X		
L307	5 977.520	2 812	127.350	R307	5 735.400	2 812	315.800	
L308	5 859.290	2 812	180.200	R308	5 707.360	2 812	345.000	
L309	5 732.460	2 812	272.430	R309	5 635.410	2 812	440.110	
L310	5 628.910	2 812	377.750	R310	5 596.780	2 812	509.910	
L311	5 596.510	2 812	416.630	R311	5 563.620	2 812	584.060	
L312	5 532.900	2 812	550.010	R312	5 498.080	2 812	773.570	
L313	5 446.520	2 812	818.300	R313	5 478.180	2 812	841.100	
L314	5 356.730	2 813	081.240	R314	5 390.250	2 813	097.950	
L315	5 265.310	2 813	342.630	R315	5 301.990	2 813	355.120	

Vel	14	Van	14	P762/09
Sheet		of		