

Government Gazette Staatskoerant

REPUBLIC OF SOUTH AFRICA
REPUBLIEK VAN SUID-AFRIKA

Vol. 545

Pretoria, 12 November 2010

No. 33707

IMPORTANT NOTICE

The Government Printing Works will not be held responsible for faxed documents not received due to errors on the fax machine or faxes received which are unclear or incomplete. Please be advised that an "OK" slip, received from a fax machine, will not be accepted as proof that documents were received by the GPW for printing. If documents are faxed to the GPW it will be the sender's responsibility to phone and confirm that the documents were received in good order.

Furthermore the Government Printing Works will also not be held responsible for cancellations and amendments which have not been done on original documents received from clients.

CONTENTS**INHOUD**

<i>No.</i>	<i>Page No.</i>	<i>Gazette No.</i>	<i>No.</i>	<i>Bladsy No.</i>	<i>Koerant No.</i>
GOVERNMENT NOTICE			GOEWERMENTSKENNISGEWING		
Transport, Department of			Vervoer, Departement van		
<i>Government Notice</i>			<i>Goewermentskennisgewing</i>		
995			995		
South African National Roads Agency Limited and the National Roads Act (7/1998): The South African National Roads Agency Limited: Declaration amendment of National Road N12 Section 5: Amendment of Declaration No. 631 of 2005	3	33707	Suid-Afrikaanse Nasionale Padagentskap Beperk en die Nasionale Paaie Wet (7/1998): Die Suid-Afrikaanse Nasionale Padagentskap Beperk: Verklaring wysiging van Nasionale Pad N12 Seksie 5: Wysiging van Verklaring No. 631 van 2005	4	33707

GOVERNMENT NOTICE

DEPARTMENT OF TRANSPORT

No. 995

12 November 2010

THE SOUTH AFRICAN NATIONAL ROADS AGENCY LIMITED

Registration No: 98/09584/06

DECLARATION AMENDMENT OF NATIONAL ROAD N12 SECTION 5

AMENDMENT OF DECLARATION No. 631 OF 2005

By virtue of section 40(1)(b) of the South African National Roads Agency Limited and the National Roads Act, 1998 (Act No. 7 of 1998), I hereby amend Declaration No. 631 of 2005, by substituting the section of the descriptive declaration of the route from Three Sisters up to Victoria West, with the subjoined sheets 1 to 17 of Plan No. P745/09.

(National Road N12 Section 5: Three Sisters – Victoria West)

MINISTER OF TRANSPORT (Acting Minister)

GOEWERMENTSKENNISGEWING

DEPARTEMENT VAN VERVOER

No. 995

12 November 2010

DIE SUID-AFRIKAANSE NASIONALE PADAGENTSKAP BEPERK

Registrasie No: 98/09584/06

VERKLARING WYSIGING VAN NASIONALE PAD N12 SEKSIE 5.

WYSIGING VAN VERKLARING NO. 631 VAN 2005

Kragtens Artikel 40(1)(b) van die Suid-Afrikaanse Nasionale Padagentskap Beperk en die Nasionale Paaie Wet, 1998 (Wet no.7 van 1998), wysig ek hiermee Verklaring no. 631 van 2005, deur die gedeelte van die beskrywende verklaring van die roete vanaf Drie Susters tot by Victoria Wes, te vervang met meegaande velle 1 tot 17 van Plan no. P745/09.

(Nasionale Pad N12 Seksie 5: Drie Susters – Victoria Wes)

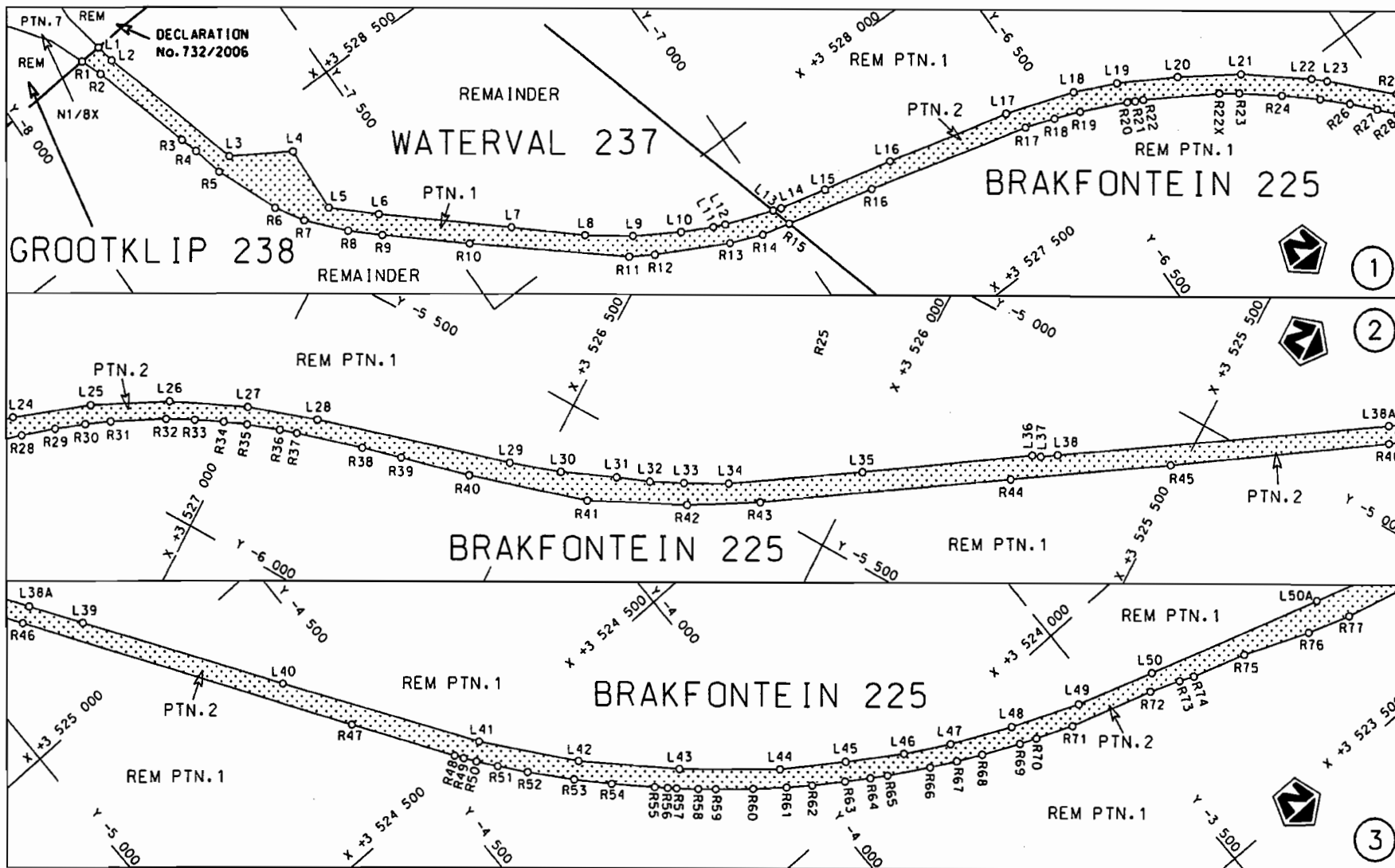

MINISTER VAN VERVOER *(Acting Minister)*

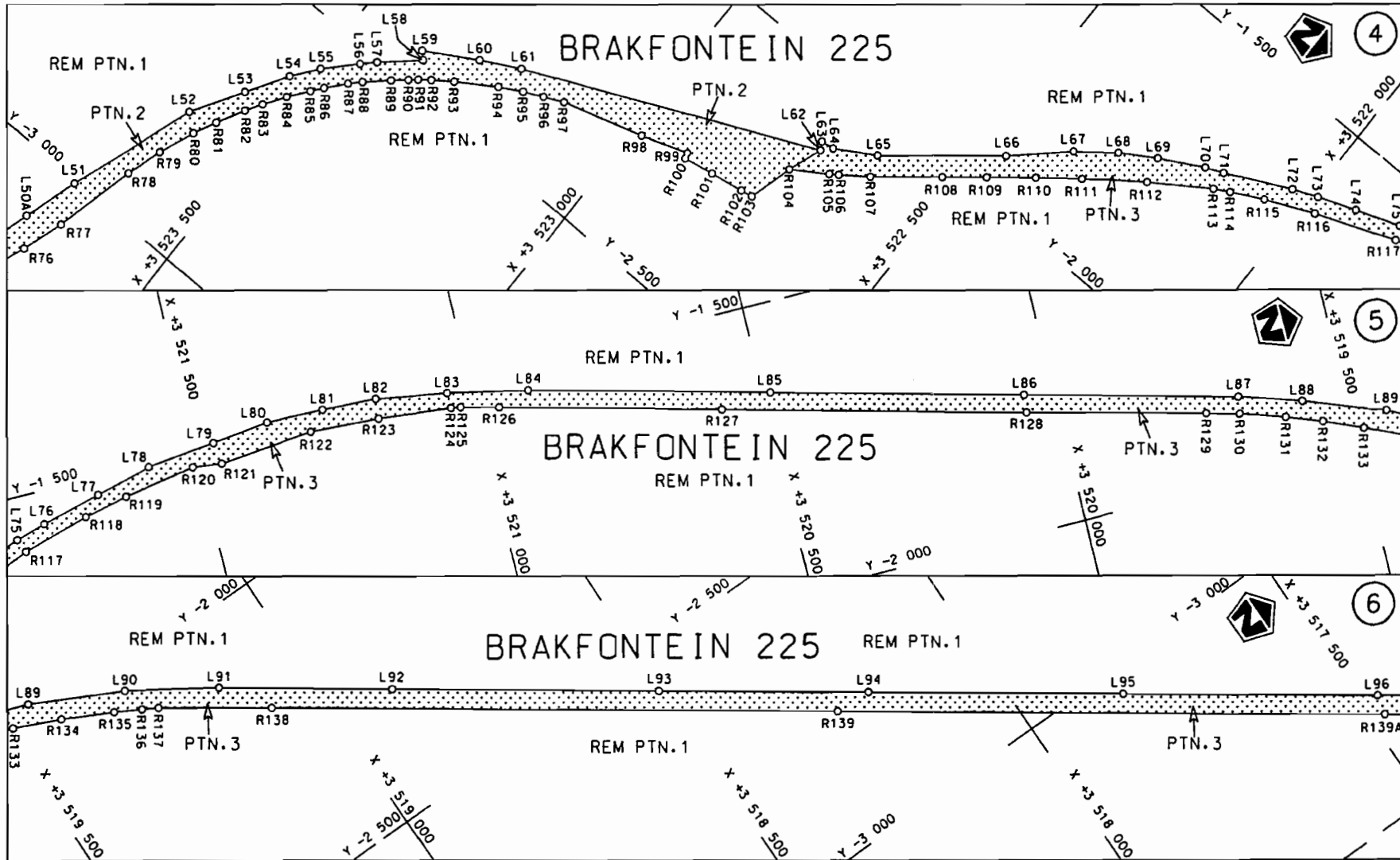

<p>Die Suid Afrikaanse Nasionale Padagentskap Beperk The South African National Roads Agency Limited</p>	<p>Die figuur getoon The figure shown</p>		<p>steldie padreserwe voor van 'n gedeelte represents the road reserve of a portion van Nasionale Roete N12 Seksie of National Route 5 Section</p>	<p>Vel Sheet 1 van of 17</p>
				<p>Plan P745/09</p>

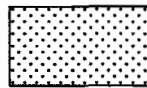

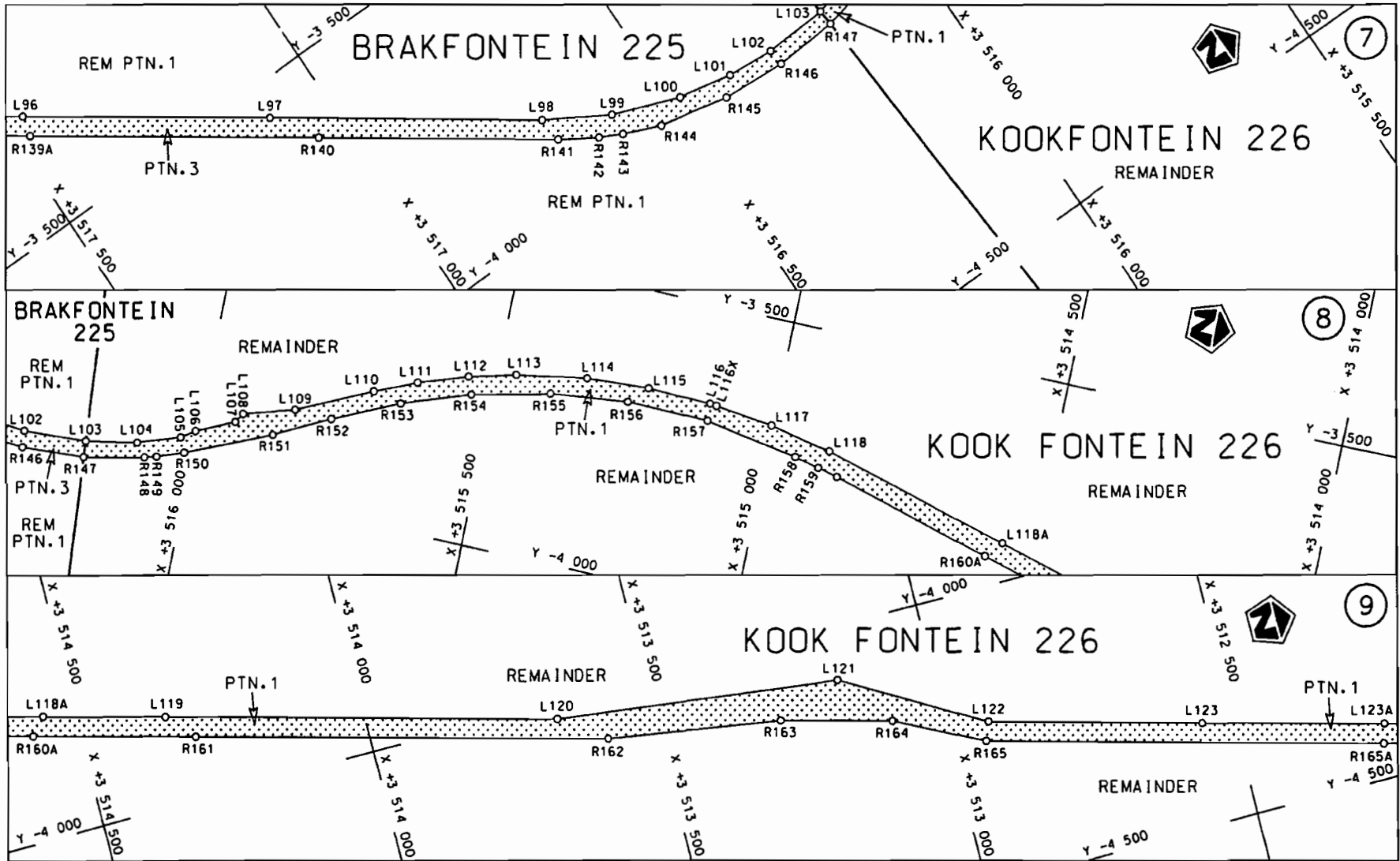
<p>Die Suid Afrikaanse Nasionale Padagentskap Beperk The South African National Roads Agency Limited</p>	<p>Die figuur getoon The figure shown</p> 	<p>steldie padreserwe voor van 'n gedeelte represents the road reserve of a portion van Nasionale Roete N12 Seksie Section of National Route 5</p>	<p>Vel Sheet 2 van 17 of of Plan P745/09</p>
--	--	--	--



Die Suid Afrikaanse Nasionale Padagentskap Beperk
The South African National Roads Agency Limited

Die figuur getoon
The figure shown

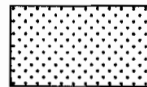

steldie padreserwe voor van 'n gedeelte
represents the road reserve of a portion
von Nasionale Roete N12 Sektie 5
of National Route Section

Vel
Sheet 3 van 17

Plan P745/09

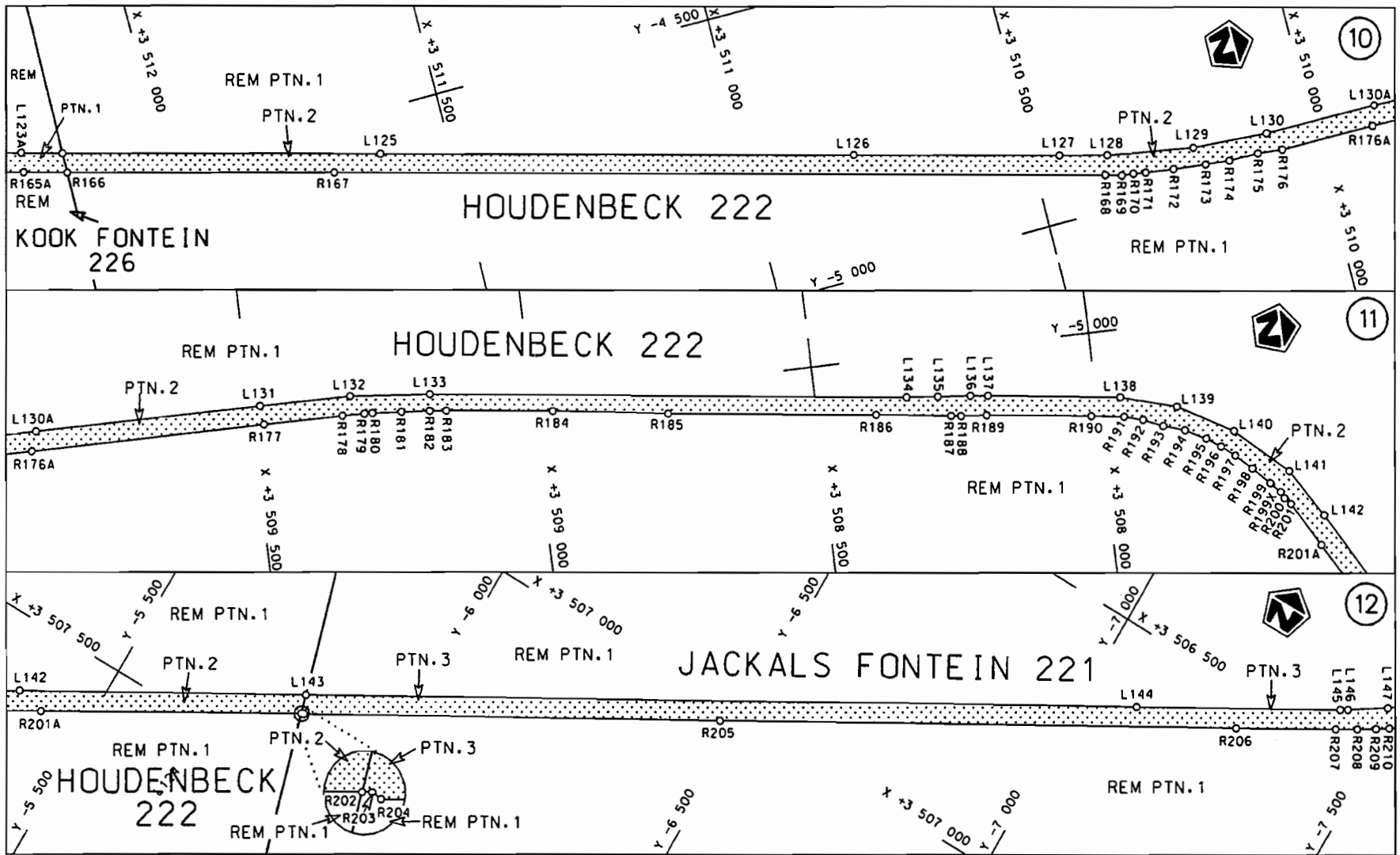

<p>Die Suid Afrikaanse Nasionale Padagentskap Beperk The South African National Roads Agency Limited</p>	<p>Die figuur getoon The figure shown</p>		<p>stel die padreserwe voor van 'n gedeelte represents the road reserve of a portion van Nasionale Roete N12 of National Route N12</p> <p>Seksie 5</p>	<p>Vel 4 van 17 Sheet of</p> <p>Plan P745/09</p>
--	---	--	--	--

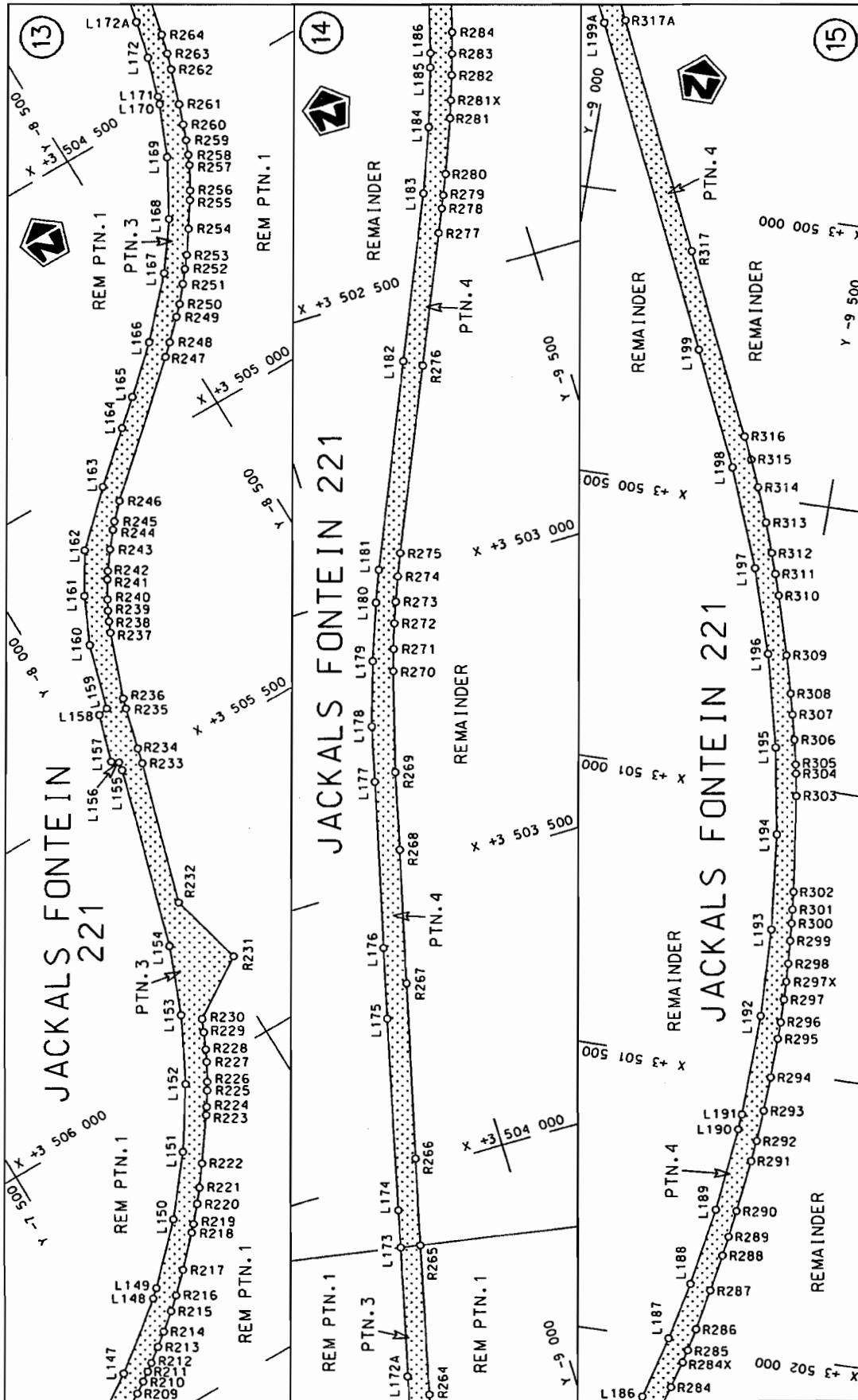

Die Suid Afrikaanse Nasionale Padogenskap Beperk The South African National Roads Agency Limited	Die figuur getoon The figure shown	steldie padreserwe voor van 'n gedeelte represents the road reserve of a portion van Nasionale Roete N12 Saksie of National Route Section	Vel Sheet 5 van 17
			Plan P745/09

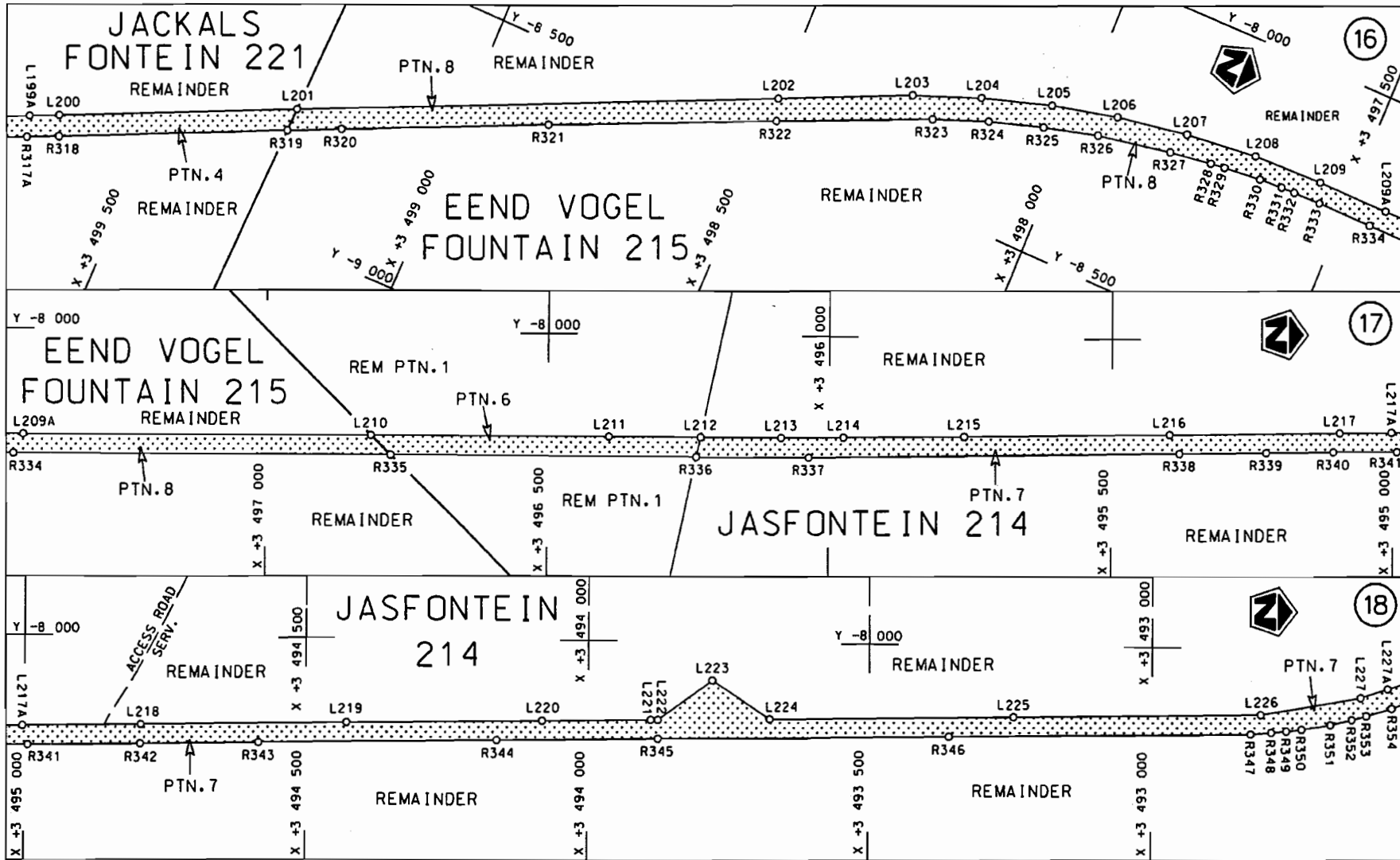

<p>Die Suid Afrikaanse Nasionale Padagentskap Beperk The South African National Roads Agency Limited</p>	<p>Die figuur getoon The figure shown</p> 	<p>steldie padreserwe voor van 'n gedeelte represents the road reserve of a portion van Nasionale Roete N12 of National Route Section 5</p>	<p>Vel Sheet 6 van 17 Plan P745/09</p>
--	--	---	--

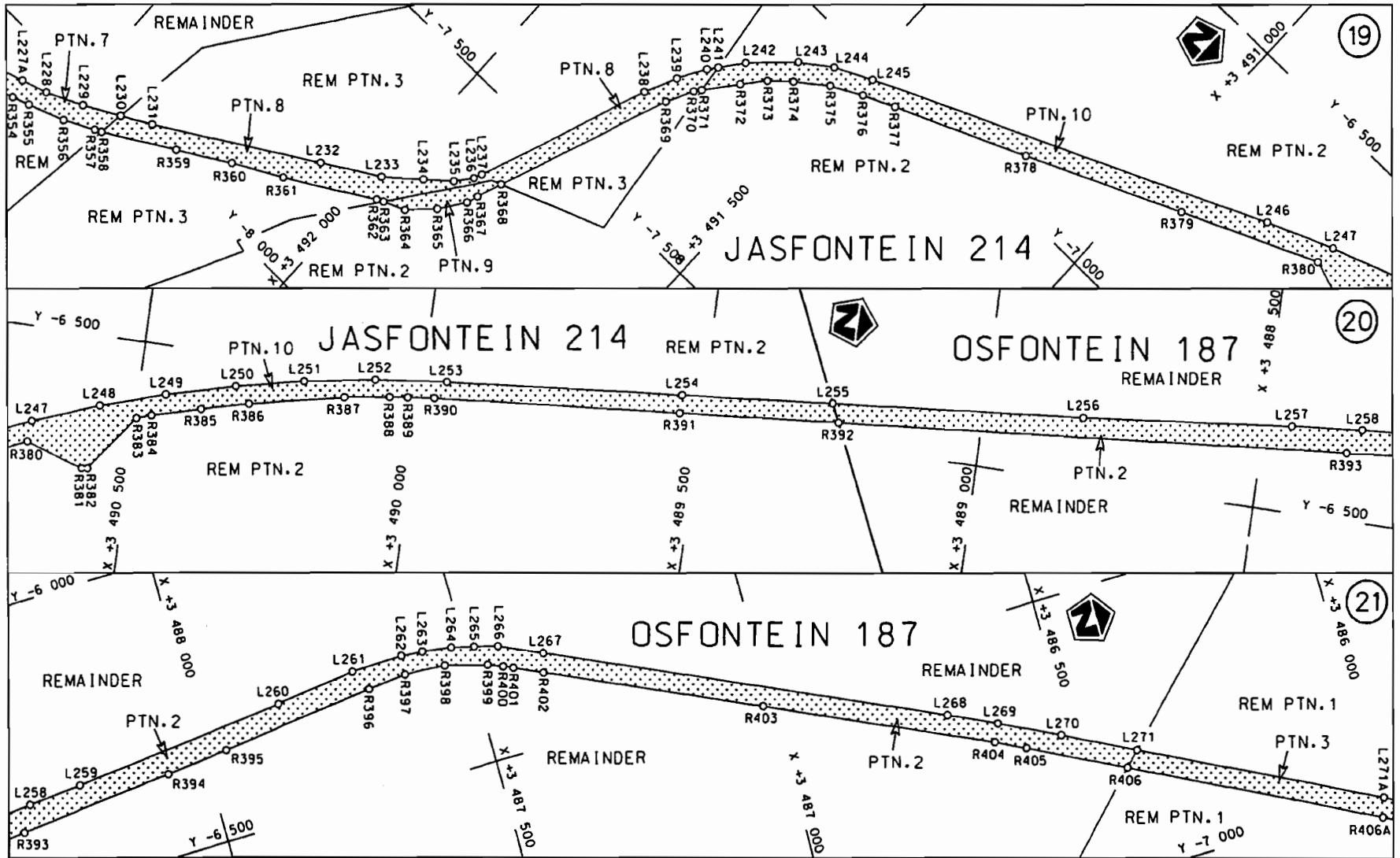

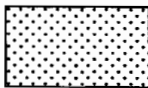
Die Suid Afrikaanse Nasionale Padagentskap Beperk The South African National Roads Agency Limited	Die figuur getoon The figure shown		Vel Sheet 7 van 17 Plan P745/09
steldie padreserwe voor van 'n gedeelte represents the road reserve of a portion von Nasionale Roete N12 Seksie of National Route Section 5			5

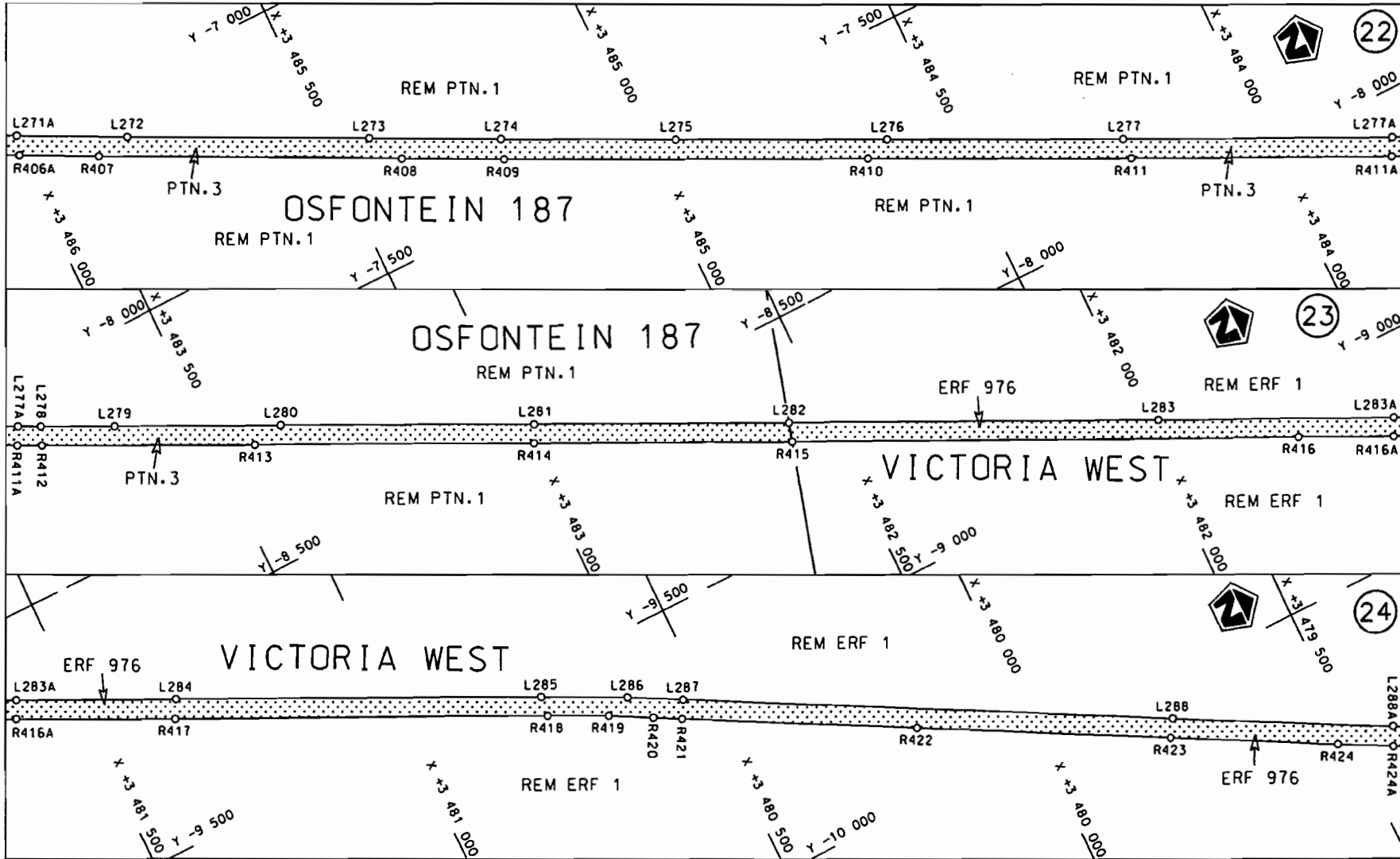

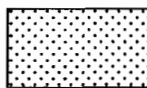
<p>Die Suid Afrikaanse Nasionale Padagentskap Beperk The South African National Roads Agency Limited</p>	<p>Die figuur getoon The figure shown</p> 	<p>steldie padreserwe voor van 'n gedeelte represents the road reserve of a portion van Nasionale Roete N12 Sektie of National Route 5</p>	<p>Vel Sheet 8 van of 17 Plan P745/09</p>
--	--	---	---

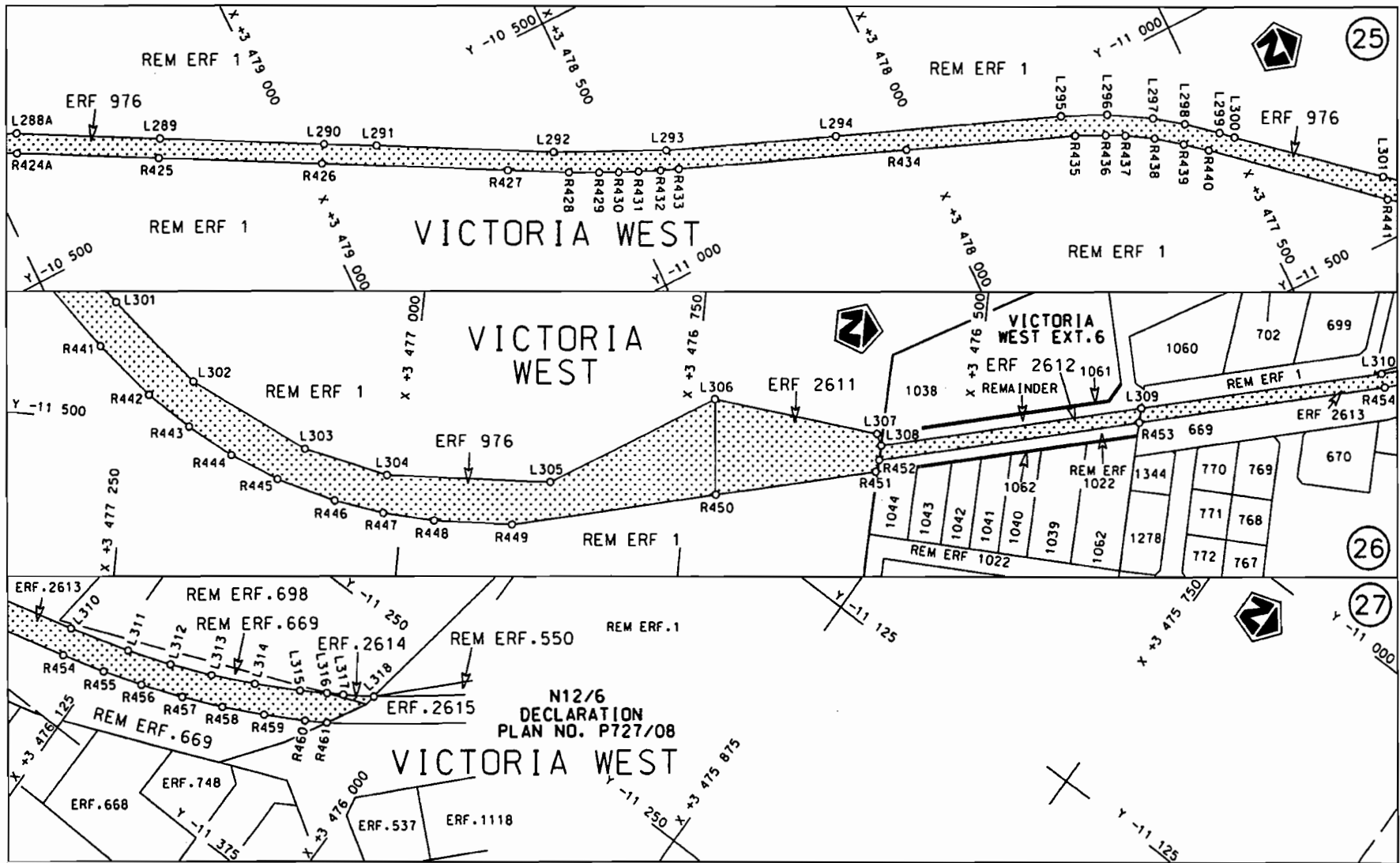

Die Suid Afrikaanse Nasionale Padagentskap Beperk
The South African National Roads Agency Limited

Die figuur getoon
The figure shown

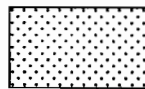

steldie padreserwe voor van 'n gedeelte
represents the road reserve of a portion
van Nasionale Roete N12 Seksie 5
of National Route Section

Vel Sheet 9 van of 17

Plan P745/09

PADRESERWE KOÖRDINATE / ROAD RESERVE CO-ORDINATES						
LINKERKANT/LEFT HAND SIDE				REGTERKANT/RIGHT HAND SIDE		
	Y	X	WG 23°		Y	X
L1	-7 803.040	3 528	771.940	R1	-7 840.900	3 528 769.540
L2	-7 797.330	3 528	740.760	R2	-7 826.770	3 528 733.280
L3	-7 723.030	3 528	486.250	R3	-7 775.530	3 528 558.730
L4	-7 625.680	3 528	425.780	R4	-7 766.100	3 528 528.520
L5	-7 632.110	3 528	310.800	R5	-7 753.730	3 528 475.240
L6	-7 568.250	3 528	250.970	R6	-7 708.750	3 528 366.060
L7	-7 391.880	3 528	096.140	R7	-7 679.300	3 528 318.150
L8	-7 294.380	3 528	008.960	R8	-7 627.950	3 528 258.730
L9	-7 226.800	3 527	958.620	R9	-7 584.360	3 528 218.140
L10	-7 153.760	3 527	914.500	R10	-7 468.920	3 528 117.070
L11	-7 102.850	3 527	888.820	R11	-7 253.190	3 527 933.370
L12	-7 083.090	3 527	880.200	R12	-7 213.970	3 527 909.530
L13	-6 999.730	3 527	849.790	R13	-7 094.780	3 527 848.740
L14	-6 985.980	3 527	844.780	R14	-7 039.090	3 527 826.900
L15	-6 903.370	3 527	824.360	R15	-6 989.610	3 527 814.660
L16	-6 780.770	3 527	796.190	R16	-6 835.210	3 527 776.500
L17	-6 567.030	3 527	741.670	R17	-6 552.680	3 527 702.890
L18	-6 447.710	3 527	701.260	R18	-6 501.850	3 527 684.840
L19	-6 376.720	3 527	669.200	R19	-6 457.940	3 527 667.560
L20	-6 283.270	3 527	615.120	R20	-6 380.840	3 527 632.480
L21	-6 189.950	3 527	553.700	R21	-6 368.860	3 527 625.770
L22	-6 093.470	3 527	473.680	R22	-6 355.630	3 527 619.710
L23	-6 072.700	3 527	454.410	R22X	-6 239.650	3 527 549.920
L24	-5 985.180	3 527	364.470	R23	-6 211.240	3 527 529.400
L25	-5 901.620	3 527	252.540	R24	-6 152.420	3 527 481.750
L26	-5 830.330	3 527	132.590	R25	-6 100.900	3 527 436.660
L27	-5 772.900	3 527	004.220	R26	-6 062.330	3 527 398.950
L28	-5 733.910	3 526	884.690	R27	-6 028.240	3 527 363.020
L29	-5 639.220	3 526	553.600	R28	-6 004.680	3 527 336.160
L30	-5 609.550	3 526	466.470	R29	-5 966.930	3 527 289.070
L31	-5 571.440	3 526	375.870	R30	-5 935.200	3 527 245.650
L32	-5 549.960	3 526	320.700	R31	-5 909.930	3 527 208.300
L33	-5 523.620	3 526	266.650	R32	-5 860.070	3 527 123.970
L34	-5 486.770	3 526	197.190	R33	-5 837.290	3 527 077.930
L35	-5 356.920	3 525	995.760	R34	-5 815.760	3 527 030.470
L36	-5 189.520	3 525	744.040	R35	-5 799.960	3 526 991.360
L37	-5 184.110	3 525	729.750	R36	-5 780.230	3 526 935.290
L38	-5 167.550	3 525	704.460	R37	-5 770.800	3 526 905.490
L39	-4 790.420	3 525	127.390	R38	-5 739.460	3 526 793.790
L40	-4 586.980	3 524	816.560	R39	-5 722.310	3 526 726.170
L41	-4 391.010	3 524	519.060	R40	-5 692.140	3 526 607.390
L42	-4 278.080	3 524	379.180	R41	-5 630.410	3 526 402.960
L43	-4 151.480	3 524	253.630	R42	-5 553.630	3 526 244.440
L44	-4 015.940	3 524	138.100	R43	-5 488.010	3 526 132.890
L45	-3 917.970	3 524	071.230	R44	-5 243.560	3 525 759.190
L46	-3 830.090	3 524	014.740	R45	-5 087.270	3 525 520.340
L47	-3 756.460	3 523	974.410	R46	-4 874.720	3 525 196.210
L48	-3 655.030	3 523	926.690	R47	-4 541.410	3 524 685.070
L49	-3 538.260	3 523	878.710	R48	-4 439.510	3 524 528.370
L50	-3 404.580	3 523	836.290	R49	-4 430.220	3 524 514.760
L51	-3 003.900	3 523	709.770	R50	-4 416.760	3 524 496.210

Vel	10	Van	17	P745/09
Sheet		of		

PADRESERWE KOÖRDINATE / ROAD RESERVE CO-ORDINATES						
LINKERKANT/LEFT HAND SIDE				REGTERKANT/RIGHT HAND SIDE		
	Y	X	WG 23°		Y	X
L52	-2 779.970	3 523 628.390		R51	-4 393.220	3 524 465.370
L53	-2 691.040	3 523 574.640		R52	-4 358.760	3 524 422.800
L54	-2 620.320	3 523 530.010		R53	-4 304.370	3 524 360.250
L55	-2 575.360	3 523 495.080		R54	-4 259.150	3 524 311.720
L56	-2 523.090	3 523 445.670		R55	-4 204.790	3 524 258.150
L57	-2 501.450	3 523 423.940		R56	-4 188.250	3 524 242.100
L58	-2 448.290	3 523 363.740		R57	-4 176.950	3 524 231.540
L59	-2 436.700	3 523 374.830		R58	-4 148.800	3 524 206.260
L60	-2 384.710	3 523 287.160		R59	-4 125.500	3 524 186.150
L61	-2 349.030	3 523 221.420		R60	-4 074.280	3 524 143.770
L62	-2 120.560	3 522 723.240		R61	-4 027.080	3 524 106.760
L63	-2 107.220	3 522 730.830		R62	-3 989.960	3 524 079.750
L64	-2 104.510	3 522 707.300		R63	-3 940.550	3 524 046.470
L65	-2 063.270	3 522 638.220		R64	-3 902.600	3 524 021.710
L66	-1 919.190	3 522 461.360		R65	-3 876.540	3 524 005.570
L67	-1 837.550	3 522 374.810		R66	-3 809.910	3 523 967.450
L68	-1 789.250	3 522 311.290		R67	-3 767.350	3 523 944.990
L69	-1 751.700	3 522 250.880		R68	-3 725.710	3 523 924.380
L70	-1 710.430	3 522 175.170		R69	-3 662.510	3 523 895.130
L71	-1 696.650	3 522 143.820		R70	-3 634.090	3 523 883.100
L72	-1 642.620	3 522 031.760		R71	-3 571.160	3 523 857.700
L73	-1 624.650	3 521 988.740		R72	-3 427.160	3 523 813.450
L74	-1 599.590	3 521 923.020		R73	-3 375.910	3 523 794.040
L75	-1 572.230	3 521 846.180		R74	-3 351.420	3 523 783.960
L76	-1 557.160	3 521 792.990		R75	-3 259.740	3 523 754.720
L77	-1 531.460	3 521 687.400		R76	-3 148.050	3 523 709.080
L78	-1 508.100	3 521 588.010		R77	-3 074.420	3 523 683.880
L79	-1 496.200	3 521 466.730		R78	-2 929.410	3 523 646.980
L80	-1 485.120	3 521 366.300		R79	-2 866.580	3 523 626.040
L81	-1 488.230	3 521 265.080		R80	-2 803.460	3 523 600.100
L82	-1 493.190	3 521 167.250		R81	-2 763.870	3 523 580.160
L83	-1 514.180	3 521 043.990		R82	-2 716.020	3 523 553.940
L84	-1 543.630	3 520 904.070		R83	-2 687.520	3 523 536.570
L85	-1 651.730	3 520 488.080		R84	-2 650.940	3 523 511.610
L86	-1 765.540	3 520 052.170		R85	-2 616.190	3 523 485.220
L87	-1 862.000	3 519 683.990		R86	-2 596.320	3 523 469.610
L88	-1 896.480	3 519 577.420		R87	-2 563.200	3 523 441.440
L89	-1 948.380	3 519 437.900		R88	-2 544.020	3 523 422.680
L90	-2 027.870	3 519 282.640		R89	-2 509.510	3 523 385.370
L91	-2 119.330	3 519 142.290		R90	-2 489.380	3 523 362.510
L92	-2 297.350	3 518 890.120		R91	-2 478.660	3 523 349.380
L93	-2 569.090	3 518 504.660		R92	-2 464.990	3 523 331.450
L94	-2 783.120	3 518 201.010		R93	-2 441.360	3 523 298.850
L95	-3 043.000	3 517 832.540		R94	-2 398.560	3 523 232.930
L96	-3 302.200	3 517 464.830		R95	-2 377.080	3 523 194.370
L97	-3 557.600	3 517 102.300		R96	-2 361.010	3 523 161.240
L98	-3 836.000	3 516 707.340		R97	-2 346.150	3 523 126.790
L99	-3 900.440	3 516 599.450		R98	-2 302.070	3 522 983.550
L100	-3 944.760	3 516 481.800		R99	-2 273.120	3 522 901.740
L101	-3 964.490	3 516 387.500		R100	-2 283.220	3 522 898.850
L102	-3 972.150	3 516 304.390		R101	-2 273.140	3 522 844.620

Vel	11	Van	17	P745/09
Sheet		of		

PADRESERWE KOÖRDINATE / ROAD RESERVE CO-ORDINATES						
LINKERKANT/LEFT HAND SIDE				REGTERKANT/RIGHT HAND SIDE		
	Y	X	WG 23°		Y	X
L103	-3 966.080	3 516	192.740	R102	-2 263.150	3 522 786.420
L104	-3 948.990	3 516	101.830	R103	-2 259.250	3 522 765.900
L105	-3 924.190	3 516	027.080	R104	-2 181.020	3 522 744.650
L106	-3 907.900	3 516	003.620	R105	-2 142.700	3 522 684.470
L107	-3 877.740	3 515	937.370	R106	-2 133.180	3 522 670.250
L108	-3 861.520	3 515	926.500	R107	-2 099.840	3 522 624.290
L109	-3 835.380	3 515	836.000	R108	-2 018.410	3 522 525.120
L110	-3 774.400	3 515	706.580	R109	-1 969.590	3 522 463.970
L111	-3 743.490	3 515	634.240	R110	-1 914.940	3 522 397.020
L112	-3 713.840	3 515	547.990	R111	-1 864.880	3 522 333.240
L113	-3 692.540	3 515	466.240	R112	-1 795.840	3 522 239.120
L114	-3 672.080	3 515	341.830	R113	-1 729.510	3 522 140.190
L115	-3 665.200	3 515	229.890	R114	-1 715.030	3 522 113.850
L116	-3 667.700	3 515	116.620	R115	-1 687.660	3 522 058.770
L116X	-3 668.110	3 515	112.040	R116	-1 650.190	3 521 975.120
L117	-3 680.530	3 515	002.400	R117	-1 595.510	3 521 836.120
L118	-3 703.220	3 514	892.370	R118	-1 563.150	3 521 717.770
L119	-3 848.850	3 514	345.030	R119	-1 546.660	3 521 639.880
L120	-4 028.250	3 513	670.340	R120	-1 527.740	3 521 511.820
L121	-4 089.660	3 513	168.670	R121	-1 533.830	3 521 460.770
L122	-4 226.320	3 512	925.460	R122	-1 519.830	3 521 294.620
L123	-4 324.800	3 512	556.040	R123	-1 527.080	3 521 170.880
L124	-4 427.130	3 512	171.520	R124	-1 540.350	3 521 043.850
L125	-4 573.170	3 511	622.000	R125	-1 543.360	3 521 026.990
L126	-4 789.830	3 510	807.360	R126	-1 559.630	3 520 960.520
L127	-4 884.460	3 510	451.020	R127	-1 659.820	3 520 577.590
L128	-4 905.390	3 510	368.720	R128	-1 795.650	3 520 055.670
L129	-4 931.980	3 510	216.240	R129	-1 875.020	3 519 746.530
L130	-4 942.290	3 510	082.650	R130	-1 890.700	3 519 689.160
L131	-4 949.660	3 509	482.810	R131	-1 916.070	3 519 612.120
L132	-4 952.300	3 509	320.710	R132	-1 939.150	3 519 550.140
L133	-4 964.080	3 509	179.000	R133	-1 967.220	3 519 483.430
L134	-5 072.330	3 508	334.640	R134	-2 003.510	3 519 404.070
L135	-5 078.000	3 508	280.800	R135	-2 047.070	3 519 319.570
L136	-5 083.200	3 508	222.320	R136	-2 071.620	3 519 275.800
L137	-5 087.060	3 508	191.010	R137	-2 087.010	3 519 250.410
L138	-5 117.580	3 507	957.370	R138	-2 200.830	3 519 085.650
L139	-5 145.970	3 507	858.050	R139	-2 778.670	3 518 265.190
L140	-5 200.240	3 507	761.150	R140	-3 635.440	3 517 050.160
L141	-5 280.880	3 507	671.920	R141	-3 879.420	3 516 703.260
L142	-5 364.560	3 507	619.530	R142	-3 918.300	3 516 640.950
L143	-5 807.800	3 507	364.560	R143	-3 938.270	3 516 602.070
L144	-7 091.540	3 506	622.960	R144	-3 965.480	3 516 537.260
L145	-7 406.770	3 506	440.800	R145	-3 992.280	3 516 414.060
L146	-7 418.690	3 506	433.560	R146	-4 000.630	3 516 301.750
L147	-7 478.110	3 506	394.620	R147	-3 994.280	3 516 190.530
L148	-7 590.020	3 506	306.330	R148	-3 972.100	3 516 083.490
L149	-7 604.340	3 506	293.520	R149	-3 966.260	3 516 062.710
L150	-7 692.880	3 506	203.550	R150	-3 949.200	3 516 015.420
L151	-7 768.350	3 506	109.400	R151	-3 884.910	3 515 866.830
L152	-7 834.100	3 506	008.940	R152	-3 836.980	3 515 770.610

Vel	12	Van	17	P745/09
Sheet		of		

PADRESERWE KOÖRDINATE / ROAD RESERVE CO-ORDINATES								
LINKERKANT/LEFT HAND SIDE				REGTERKANT/RIGHT HAND SIDE				
	Y	X	WG 23°		Y	X		
L153	-7	890.030	3 505	901.370	R153	-3	784.820 3 515	655.820
L154	-7	935.840	3 505	786.190	R154	-3	743.240 3 515	536.690
L155	-8	026.670	3 505	473.960	R155	-3	711.730 3 515	400.150
L156	-8	028.080	3 505	462.900	R156	-3	696.250 3 515	261.210
L157	-8	017.390	3 505	454.940	R157	-3	697.090 3 515	115.380
L158	-8	042.130	3 505	373.410	R158	-3	724.900 3 514	949.530
L159	-8	058.920	3 505	370.130	R159	-3	735.120 3 514	905.670
L160	-8	091.580	3 505	257.630	R160	-3	744.110 3 514	869.720
L161	-8	128.610	3 505	178.390	R161	-3	895.750 3 514	300.720
L162	-8	170.910	3 505	108.950	R162	-4	083.830 3 513	590.580
L163	-8	255.390	3 505	028.230	R163	-4	130.850 3 513	284.150
L164	-8	337.130	3 504	954.910	R164	-4	182.150 3 513	091.270
L165	-8	380.300	3 504	915.990	R165	-4	257.560 3 512	937.590
L166	-8	454.620	3 504	847.630	R166	-4	462.290 3 512	171.820
L167	-8	539.190	3 504	756.200	R167	-4	583.980 3 511	711.030
L168	-8	595.860	3 504	677.760	R168	-4	938.020 3 510	380.910
L169	-8	649.960	3 504	581.370	R169	-4	944.330 3 510	353.090
L170	-8	687.870	3 504	490.870	R170	-4	948.440 3 510	331.960
L171	-8	689.440	3 504	486.520	R171	-4	952.170 3 510	310.220
L172	-8	712.220	3 504	412.280	R172	-4	959.480 3 510	260.220
L173	-8	781.630	3 504	125.410	R173	-4	966.270 3 510	202.520
L174	-8	797.300	3 504	060.130	R174	-4	970.690 3 510	159.250
L175	-8	875.470	3 503	730.350	R175	-4	974.250 3 510	106.520
L176	-8	904.650	3 503	608.390	R176	-4	976.130 3 510	063.060
L177	-8	973.670	3 503	323.030	R177	-4	982.560 3 509	479.680
L178	-8	996.280	3 503	227.190	R178	-4	984.540 3 509	338.710
L179	-9	030.570	3 503	115.810	R179	-4	985.800 3 509	298.960
L180	-9	065.500	3 503	017.940	R180	-4	986.490 3 509	284.560
L181	-9	086.700	3 502	963.640	R181	-4	990.420 3 509	233.520
L182	-9	231.960	3 502	619.010	R182	-4	995.020 3 509	182.890
L183	-9	348.230	3 502	342.860	R183	-4	998.100 3 509	153.580
L184	-9	390.180	3 502	232.140	R184	-5	021.070 3 508	966.260
L185	-9	422.900	3 502	131.090	R185	-5	049.940 3 508	743.120
L186	-9	430.220	3 502	106.690	R186	-5	096.210 3 508	394.960
L187	-9	459.170	3 501	997.210	R187	-5	113.950 3 508	261.120
L188	-9	481.680	3 501	895.580	R188	-5	116.350 3 508	243.380
L189	-9	504.490	3 501	758.370	R189	-5	120.490 3 508	197.310
L190	-9	520.370	3 501	610.960	R190	-5	144.260 3 508	011.960
L191	-9	522.210	3 501	583.760	R191	-5	152.000 3 507	954.590
L192	-9	527.190	3 501	408.780	R192	-5	161.370 3 507	921.160
L193	-9	521.140	3 501	255.160	R193	-5	174.230 3 507	884.520
L194	-9	503.750	3 501	087.700	R194	-5	188.400 3 507	848.560
L195	-9	477.550	3 500	935.880	R195	-5	207.420 3 507	812.530
L196	-9	438.250	3 500	773.100	R196	-5	224.120 3 507	787.600
L197	-9	392.310	3 500	626.480	R197	-5	242.440 3 507	764.190
L198	-9	325.770	3 500	455.410	R198	-5	268.350 3 507	736.360
L199	-9	235.490	3 500	257.030	R199	-5	297.350 3 507	707.940
L200	-8	961.630	3 499	659.930	R199X	-5	314.770 3 507	691.410
L201	-8	785.470	3 499	275.030	R200	-5	324.500 3 507	684.080
L202	-8	430.670	3 498	499.570	R201	-5	337.950 3 507	675.910
L203	-8	331.450	3 498	281.750	R202	-5	817.260 3 507	396.770

Vel	13	Van	17	P745/09
Sheet		of		

PADRESERWE KOÖRDINATE / ROAD RESERVE CO-ORDINATES											
LINKERKANT/LEFT HAND SIDE					REGTERKANT/RIGHT HAND SIDE						
	Y		X	WG 23°				X			
L204	-8	287.780	3	498	168.950	R203	-5	820.360	3	507	394.960
L205	-8	250.010	3	498	048.080	R204	-5	821.830	3	507	395.160
L206	-8	221.830	3	497	932.540	R205	-6	463.940	3	507	024.760
L207	-8	200.190	3	497	808.870	R206	-7	263.990	3	506	562.970
L208	-8	186.780	3	497	684.240	R207	-7	417.220	3	506	474.140
L209	-8	182.480	3	497	559.160	R208	-7	450.330	3	506	454.400
L210	-8	178.770	3	496	812.880	R209	-7	478.640	3	506	436.880
L211	-8	176.690	3	496	392.540	R210	-7	498.510	3	506	423.720
L212	-8	175.990	3	496	231.490	R211	-7	514.440	3	506	412.830
L213	-8	175.370	3	496	087.330	R212	-7	528.110	3	506	402.810
L214	-8	174.020	3	495	974.490	R213	-7	552.770	3	506	384.160
L215	-8	170.560	3	495	763.140	R214	-7	575.280	3	506	366.000
L216	-8	163.550	3	495	398.230	R215	-7	604.690	3	506	341.400
L217	-8	157.980	3	495	095.800	R216	-7	626.580	3	506	321.890
L218	-8	152.200	3	494	794.690	R217	-7	660.190	3	506	289.280
L219	-8	145.270	3	494	427.050	R218	-7	707.150	3	506	240.060
L220	-8	138.890	3	494	080.900	R219	-7	717.810	3	506	228.350
L221	-8	135.020	3	493	883.820	R220	-7	741.770	3	506	200.690
L222	-8	135.040	3	493	877.390	R221	-7	759.930	3	506	178.080
L223	-8	065.450	3	493	781.650	R222	-7	785.770	3	506	143.490
L224	-8	131.200	3	493	678.670	R223	-7	836.440	3	506	073.090
L225	-8	123.050	3	493	246.640	R224	-7	844.670	3	506	061.200
L226	-8	114.640	3	492	809.210	R225	-7	860.290	3	506	037.000
L227	-8	084.120	3	492	629.410	R226	-7	867.900	3	506	024.400
L228	-8	053.840	3	492	535.990	R227	-7	885.070	3	505	993.920
L229	-8	024.900	3	492	472.200	R228	-7	894.920	3	505	974.480
L230	-7	991.770	3	492	411.470	R229	-7	907.880	3	505	946.680
L231	-7	963.690	3	492	359.990	R230	-7	917.400	3	505	925.310
L232	-7	801.930	3	492	094.400	R231	-8	020.570	3	505	858.040
L233	-7	746.030	3	492	000.150	R232	-7	988.850	3	505	728.010
L234	-7	698.500	3	491	943.530	R233	-8	061.240	3	505	484.670
L235	-7	663.300	3	491	902.790	R234	-8	067.700	3	505	457.850
L236	-7	634.740	3	491	880.580	R235	-8	086.860	3	505	384.960
L237	-7	625.170	3	491	875.700	R236	-8	092.180	3	505	368.970
L238	-7	316.400	3	491	760.380	R237	-8	133.570	3	505	257.190
L239	-7	259.440	3	491	735.650	R238	-8	141.540	3	505	238.870
L240	-7	211.490	3	491	707.970	R239	-8	149.810	3	505	221.700
L241	-7	195.320	3	491	695.910	R240	-8	159.300	3	505	203.920
L242	-7	155.800	3	491	666.410	R241	-8	177.500	3	505	173.150
L243	-7	089.520	3	491	598.010	R242	-8	182.150	3	505	166.210
L244	-7	051.040	3	491	543.800	R243	-8	209.070	3	505	129.910
L245	-7	018.590	3	491	479.470	R244	-8	230.730	3	505	102.720
L246	-6	711.820	3	490	799.210	R245	-8	240.830	3	505	091.200
L247	-6	663.470	3	490	683.130	R246	-8	267.150	3	505	064.190
L248	-6	620.360	3	490	564.930	R247	-8	465.750	3	504	884.390
L249	-6	585.150	3	490	451.400	R248	-8	485.170	3	504	865.960
L250	-6	553.240	3	490	329.860	R249	-8	517.670	3	504	833.530
L251	-6	526.990	3	490	206.610	R250	-8	534.030	3	504	816.410
L252	-6	506.730	3	490	082.550	R251	-8	556.930	3	504	789.200
L253	-6	492.250	3	489	957.320	R252	-8	573.740	3	504	768.120
L254	-6	454.460	3	489	537.730	R253	-8	589.260	3	504	748.040

Vel	14	Van	17	P745/09
Sheet		of		

PADRESERWE KOÖRDINATE / ROAD RESERVE CO-ORDINATES								
LINKERKANT/LEFT HAND SIDE				REGTERKANT/RIGHT HAND SIDE				
	Y	X	WG 23°			X		
L255	-6	430.140	3 489	267.150	R254	-8	615.600 3 504	709.650
L256	-6	390.120	3 488	820.030	R255	-8	643.810 3 504	667.020
L257	-6	351.960	3 488	450.450	R256	-8	652.800 3 504	652.510
L258	-6	340.650	3 488	323.500	R257	-8	675.130 3 504	612.960
L259	-6	334.290	3 488	226.840	R258	-8	682.940 3 504	596.360
L260	-6	298.310	3 487	845.410	R259	-8	693.010 3 504	572.060
L261	-6	284.330	3 487	701.910	R260	-8	703.140 3 504	545.720
L262	-6	278.050	3 487	611.140	R261	-8	715.540 3 504	511.080
L263	-6	281.760	3 487	573.760	R262	-8	735.940 3 504	450.830
L264	-6	288.730	3 487	522.870	R263	-8	744.580 3 504	423.570
L265	-6	298.460	3 487	483.080	R264	-8	753.440 3 504	389.880
L266	-6	310.100	3 487	441.650	R265	-8	814.610 3 504	130.960
L267	-6	343.250	3 487	366.340	R266	-8	851.250 3 503	980.260
L268	-6	644.820	3 486	700.990	R267	-8	924.420 3 503	679.750
L269	-6	683.710	3 486	618.570	R268	-8	980.390 3 503	449.560
L270	-6	734.710	3 486	514.350	R269	-9	012.060 3 503	316.600
L271	-6	797.110	3 486	389.020	R270	-9	059.290 3 503	142.760
L272	-7	084.040	3 485	813.760	R271	-9	070.950 3 503	105.380
L273	-7	276.060	3 485	427.690	R272	-9	085.220 3 503	062.040
L274	-7	379.520	3 485	218.930	R273	-9	098.360 3 503	026.000
L275	-7	516.050	3 484	942.490	R274	-9	114.710 3 502	983.870
L276	-7	682.380	3 484	604.550	R275	-9	130.450 3 502	945.350
L277	-7	867.140	3 484	227.300	R276	-9	261.290 3 502	635.900
L278	-8	094.050	3 483	761.130	R277	-9	353.360 3 502	418.110
L279	-8	150.910	3 483	643.460	R278	-9	370.840 3 502	378.090
L280	-8	279.610	3 483	377.330	R279	-9	380.060 3 502	355.890
L281	-8	474.430	3 482	973.310	R280	-9	394.610 3 502	320.680
L282	-8	670.510	3 482	565.460	R281	-9	429.920 3 502	227.390
L283	-8	954.720	3 481	973.900	R281X	-9	440.400 3 502	197.440
L284	-9	258.850	3 481	341.020	R282	-9	454.470 3 502	154.670
L285	-9	538.520	3 480	758.960	R283	-9	465.600 3 502	118.720
L286	-9	607.050	3 480	622.030	R284	-9	476.490 3 502	082.290
L287	-9	653.760	3 480	535.110	R284X	-9	489.380 3 502	035.780
L288	-10	066.550	3 479	767.910	R285	-9	494.930 3 502	013.300
L289	-10	374.680	3 479	195.380	R286	-9	503.770 3 501	973.940
L290	-10	512.640	3 478	938.550	R287	-9	517.500 3 501	902.010
L291	-10	556.160	3 478	855.850	R288	-9	528.360 3 501	837.600
L292	-10	705.050	3 478	579.480	R289	-9	533.640 3 501	802.910
L293	-10	792.040	3 478	396.010	R290	-9	540.020 3 501	755.310
L294	-10	903.140	3 478	114.940	R291	-9	550.700 3 501	663.720
L295	-11	050.220	3 477	740.200	R292	-9	554.440 3 501	626.800
L296	-11	084.390	3 477	665.200	R293	-9	558.050 3 501	571.810
L297	-11	126.440	3 477	593.520	R294	-9	560.960 3 501	512.400
L298	-11	160.650	3 477	545.850	R295	-9	562.360 3 501	443.880
L299	-11	201.550	3 477	496.770	R296	-9	562.640 3 501	414.420
L300	-11	220.260	3 477	476.490	R297	-9	562.210 3 501	374.290
L301	-11	396.670	3 477	272.130	R297X	-9	561.130 3 501	342.000
L302	-11	456.980	3 477	196.240	R298	-9	559.410 3 501	309.960
L303	-11	503.840	3 477	091.510	R299	-9	556.590 3 501	269.580
L304	-11	518.750	3 477	016.610	R300	-9	553.990 3 501	238.910
L305	-11	509.180	3 476	872.210	R301	-9	551.730 3 501	214.520

Vel	15	Van	17	P745/09
Sheet		of		

PADRESERWE KOÖRDINATE / ROAD RESERVE CO-ORDINATES						
LINKERKANT/LEFT HAND SIDE				REGTERKANT/RIGHT HAND SIDE		
	Y	X	WG 23°		X	
L306	-11	422.260	3 476	732.490	R302	-9 548.470 3 501 183.310
L307	-11	436.320	3 476	586.350	R303	-9 527.110 3 501 015.680
L308	-11	446.050	3 476	581.510	R304	-9 520.260 3 500 976.050
L309	-11	389.370	3 476	354.440	R305	-9 517.210 3 500 960.340
L310	-11	337.030	3 476	145.260	R306	-9 507.950 3 500 917.260
L311	-11	329.300	3 476	118.740	R307	-9 497.390 3 500 873.790
L312	-11	322.820	3 476	099.920	R308	-9 488.090 3 500 837.380
L313	-11	315.720	3 476	082.400	R309	-9 470.170 3 500 770.470
L314	-11	307.440	3 476	064.790	R310	-9 440.200 3 500 667.920
L315	-11	297.670	3 476	046.840	R311	-9 428.520 3 500 631.070
L316	-11	291.430	3 476	036.660	R312	-9 416.600 3 500 594.970
L317	-11	287.660	3 476	030.490	R313	-9 398.180 3 500 543.250
L318	-11	280.130	3 476	019.080	R314	-9 374.540 3 500 483.370
					R315	-9 355.120 3 500 437.000
					R316	-9 337.420 3 500 397.980
					R317	-9 195.370 3 500 086.290
					R318	-8 994.640 3 499 646.350
					R319	-8 825.260 3 499 276.760
					R320	-8 785.010 3 499 188.950
					R321	-8 632.500 3 498 855.270
					R322	-8 467.340 3 498 487.390
					R323	-8 355.250 3 498 233.330
					R324	-8 319.810 3 498 141.210
					R325	-8 290.260 3 498 047.400
					R326	-8 263.910 3 497 952.880
					R327	-8 239.250 3 497 824.170
					R328	-8 229.250 3 497 751.310
					R329	-8 226.190 3 497 726.500
					R330	-8 220.450 3 497 661.240
					R331	-8 218.010 3 497 620.140
					R332	-8 217.130 3 497 595.580
					R333	-8 216.080 3 497 546.460
					R334	-8 215.320 3 497 448.280
					R335	-8 212.390 3 496 777.940
					R336	-8 210.020 3 496 238.790
					R337	-8 209.140 3 496 036.760
					R338	-8 195.950 3 495 380.650
					R339	-8 193.120 3 495 228.460
					R340	-8 190.900 3 495 107.280
					R341	-8 189.410 3 494 993.750
					R342	-8 185.670 3 494 795.520
					R343	-8 181.520 3 494 584.070
					R344	-8 173.160 3 494 161.760
					R345	-8 167.340 3 493 877.330
					R346	-8 157.740 3 493 360.600
					R347	-8 148.210 3 492 826.690
					R348	-8 145.190 3 492 789.970
					R349	-8 142.490 3 492 762.920
					R350	-8 139.190 3 492 735.450
					R351	-8 131.130 3 492 683.580
					R352	-8 121.980 3 492 644.960
REGTERKANT/RIGHT HAND SIDE						
	Y	X				
R 354	-8	101.980	3 492	574.190		
R 355	-8	091.140	3 492	544.340		
R 356	-8	066.730	3 492	480.570		
R 357	-8	035.740	3 492	418.660		
R 358	-8	034.950	3 492	417.300		
R 359	-7	966.060	3 492	299.530		
R 360	-7	914.080	3 492	211.080		
R 361	-7	867.530	3 492	125.690		
R 362	-7	778.580	3 491	976.140		
R 363	-7	774.750	3 491	967.950		
R 364	-7	758.920	3 491	931.100		
R 365	-7	718.600	3 491	890.920		
R 366	-7	673.860	3 491	860.580		
R 367	-7	653.150	3 491	853.610		
R 368	-7	608.830	3 491	836.970		
R 369	-7	302.520	3 491	721.950		
R 370	-7	255.290	3 491	698.370		
R 371	-7	243.800	3 491	689.650		
R 372	-7	188.920	3 491	647.950		
R 373	-7	151.540	3 491	616.410		
R 374	-7	119.900	3 491	581.350		
R 375	-7	078.800	3 491	527.140		
R 376	-7	050.150	3 491	473.280		
R 377	-7	025.960	3 491	418.240		
R 378	-6	925.360	3 491	194.200		
R 379	-6	802.990	3 490	921.180		
R 380	-6	699.770	3 490	686.160		
R 381	-6	732.940	3 490	578.380		
R 382	-6	732.300	3 490	574.000		
R 383	-6	632.360	3 490	497.970		
R 384	-6	624.220	3 490	471.700		
R 385	-6	600.520	3 490	385.860		

PADRESERWE KOÖRDINATE / ROAD RESERVE CO-ORDINATES											
REGTERKANT/RIGHT HAND SIDE					REGTERKANT/RIGHT HAND SIDE						
	Y		X	WG 23°				X			
R 386	-6	579.790	3	490	301.620	R353	-8	114.940	3	492	618.750
R 387	-6	544.300	3	490	132.150	R437	-11	130.430	3	477	651.150
R 388	-6	532.650	3	490	053.340	R438	-11	158.340	3	477	606.030
R 389	-6	528.400	3	490	021.960	R439	-11	190.590	3	477	562.880
R 390	-6	523.190	3	489	975.270	R440	-11	219.650	3	477	527.170
R 391	-6	485.550	3	489	537.470	R441	-11	435.310	3	477	282.380
R 392	-6	461.180	3	489	252.610	R442	-11	472.460	3	477	234.150
R 393	-6	383.770	3	488	346.220	R443	-11	495.850	3	477	196.060
R 394	-6	359.630	3	488	070.490	R444	-11	516.220	3	477	156.160
R 395	-6	348.710	3	487	959.330	R445	-11	532.690	3	477	113.210
R 396	-6	318.380	3	487	681.690	R446	-11	545.560	3	477	060.820
R 397	-6	311.080	3	487	614.090	R447	-11	551.410	3	477	016.470
R 398	-6	315.370	3	487	542.400	R448	-11	553.080	3	476	971.140
R 399	-6	335.720	3	487	468.320	R449	-11	549.130	3	476	901.880
R 400	-6	345.960	3	487	442.370	R450	-11	504.120	3	476	723.160
R 401	-6	353.160	3	487	425.330	R451	-11	469.230	3	476	584.010
R 402	-6	375.820	3	487	375.450	R452	-11	458.890	3	476	581.920
R 403	-6	539.260	3	487	015.520	R453	-11	401.750	3	476	354.840
R 404	-6	713.130	3	486	632.690	R454	-11	348.480	3	476	141.350
R 405	-6	739.160	3	486	580.870	R455	-11	343.180	3	476	122.380
R 406	-6	821.810	3	486	414.180	R456	-11	337.600	3	476	105.080
R 407	-7	091.510	3	485	873.570	R457	-11	331.060	3	476	087.410
R 408	-7	332.460	3	485	391.190	R458	-11	323.940	3	476	070.530
R 409	-7	413.320	3	485	229.040	R459	-11	315.570	3	476	053.700
R 410	-7	697.050	3	484	649.510	R460	-11	306.650	3	476	037.410
R 411	-7	903.270	3	484	228.430	R461	-11	301.610	3	476	029.220
R 412	-8	124.620	3	483	773.630						
R 413	-8	289.820	3	483	432.730						
R 414	-8	503.990	3	482	987.880						
R 415	-8	702.640	3	482	574.630						
R 416	-9	094.820	3	481	761.980						
R 417	-9	288.850	3	481	357.200						
R 418	-9	572.840	3	480	763.390						
R 419	-9	620.930	3	480	666.270						
R 420	-9	658.440	3	480	596.260						
R 421	-9	682.860	3	480	551.230						
R 422	-9	880.980	3	480	182.660						
R 423	-10	094.790	3	479	785.500						
R 424	-10	236.080	3	479	523.760						
R 425	-10	403.900	3	479	212.280						
R 426	-10	541.310	3	478	956.980						
R 427	-10	697.950	3	478	665.670						
R 428	-10	748.950	3	478	570.660						
R 429	-10	773.120	3	478	521.950						
R 430	-10	788.410	3	478	489.930						
R 431	-10	803.310	3	478	457.210						
R 432	-10	818.880	3	478	420.930						
R 433	-10	831.080	3	478	389.990						
R 434	-10	979.810	3	478	012.270						
R 435	-11	090.650	3	477	732.260						
R 436	-11	114.240	3	477	682.850						

Vel Sheet	17	Van of	17	P745/09
-----------	----	--------	----	---------