



Government Gazette Staatskoerant

REPUBLIC OF SOUTH AFRICA
REPUBLIEK VAN SUID-AFRIKA

Vol. 570

Pretoria, 11 December 2012
Desember

No. 35971

N.B. The Government Printing Works will not be held responsible for the quality of "Hard Copies" or "Electronic Files" submitted for publication purposes



AIDS HELPLINE: 0800-0123-22 Prevention is the cure

IMPORTANT NOTICE

The Government Printing Works will not be held responsible for faxed documents not received due to errors on the fax machine or faxes received which are unclear or incomplete. Please be advised that an "OK" slip, received from a fax machine, will not be accepted as proof that documents were received by the GPW for printing. If documents are faxed to the GPW it will be the sender's responsibility to phone and confirm that the documents were received in good order.

Furthermore the Government Printing Works will also not be held responsible for cancellations and amendments which have not been done on original documents received from clients.

CONTENTS**INHOUD**

<i>No.</i>	<i>Page No.</i>	<i>Gazette No.</i>	<i>No.</i>	<i>Bladsy No.</i>	<i>Koerant No.</i>
GOVERNMENT NOTICE			GOEWERMENSKENNISGEWING		
Transport, Department of			Vervoer, Departement van		
<i>Government Notice</i>			<i>Goewermentskennisgewing</i>		
1041		South African National Roads Agency Limited and the National Roads Act (7/1998): Declaration amendment of National Road N11 Section 10.....	3	35971	
			1041		Suid-Afrikaanse Nasionale Padagentskap Beperk en die Nasionale Paaie Wet (7/1998): Verklaring wysiging van Nasionale Pad N11 Seksie 10
			4	35971	

GOVERNMENT NOTICE

DEPARTMENT OF TRANSPORT

No. 1041

11 December 2012

THE SOUTH AFRICAN NATIONAL ROADS AGENCY LIMITED

Registration No: 98/09584/06

DECLARATION AMENDMENT OF NATIONAL ROAD N11 SECTION 10

AMENDMENT OF DECLARATION NO. 1137 OF 2005.

By virtue of section 40(1)(b) of the South African National Roads Agency Limited and the National Roads Act, 1998 (Act No. 7 of 1998), I hereby amend Declaration No. 1137 of 2005 Annexure paragraph 3 by substituting it, with the subjoined sheets 1 to 20 of Plan No. P712/08.

(National Road N11 Section 10: Middelburg - Groblersdal)



MINISTER OF TRANSPORT

GOEWERMENTSKENNISGEWING

DEPARTEMENT VAN VERVOER

No. 1041

11 Desember 2012

DIE SUID-AFRIKAANSE NASIONALE PADAGENTSKAP BEPERK

Registrasie No: 98/09584/06

VERKLARING WYSIGING VAN NASIONALE PAD N11 SEKSIE 10.

WYSIGING VAN VERKLARING NO. 1137 VAN 2005.

Kragtens Artikel 40(1)(b) van die Suid-Afrikaanse Nasionale Padagentskap Beperk en die Nasionale Paaie Wet, 1998 (Wet no.7 van 1998), wysig ek hiermee Verklaring no. 1137 van 2005 Bylae paragraaf 3 deur dit, te vervang met meegaande velle 1 tot 20 van Plan no. P712/08.

(Nasionale Pad N11 Seksie 10 Middelburg – Groblersdal)



MINISTER VAN VERVOER

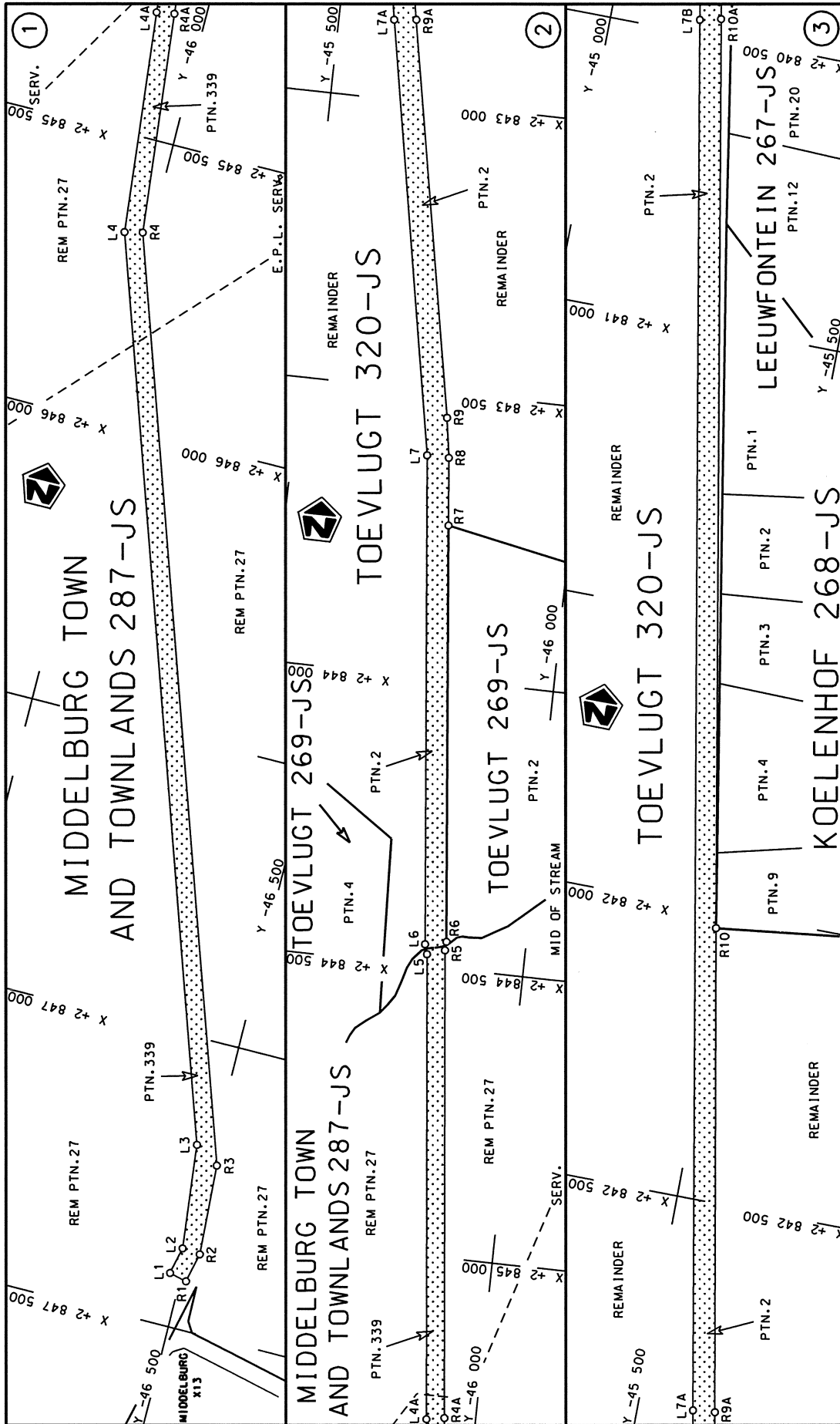

<p>Die Suid Afrikaanse Nasionale Padagentskap Beperk The South African National Roads Agency Limited</p>	<p>Die figuur getoon The figure shown</p>	<p>steldie padreserwe voor van 'n gedeelte represents the road reserve of a portion van Nasionale Roete N11 of National Route</p>
<p>Vel Sheet</p>	<p>10</p>	<p>10</p>
<p>van of</p>	<p>10</p>	<p>10</p>
<p>20</p>	<p>10</p>	<p>10</p>
<p>Plan</p>	<p>P712/08</p>	<p>Section</p>

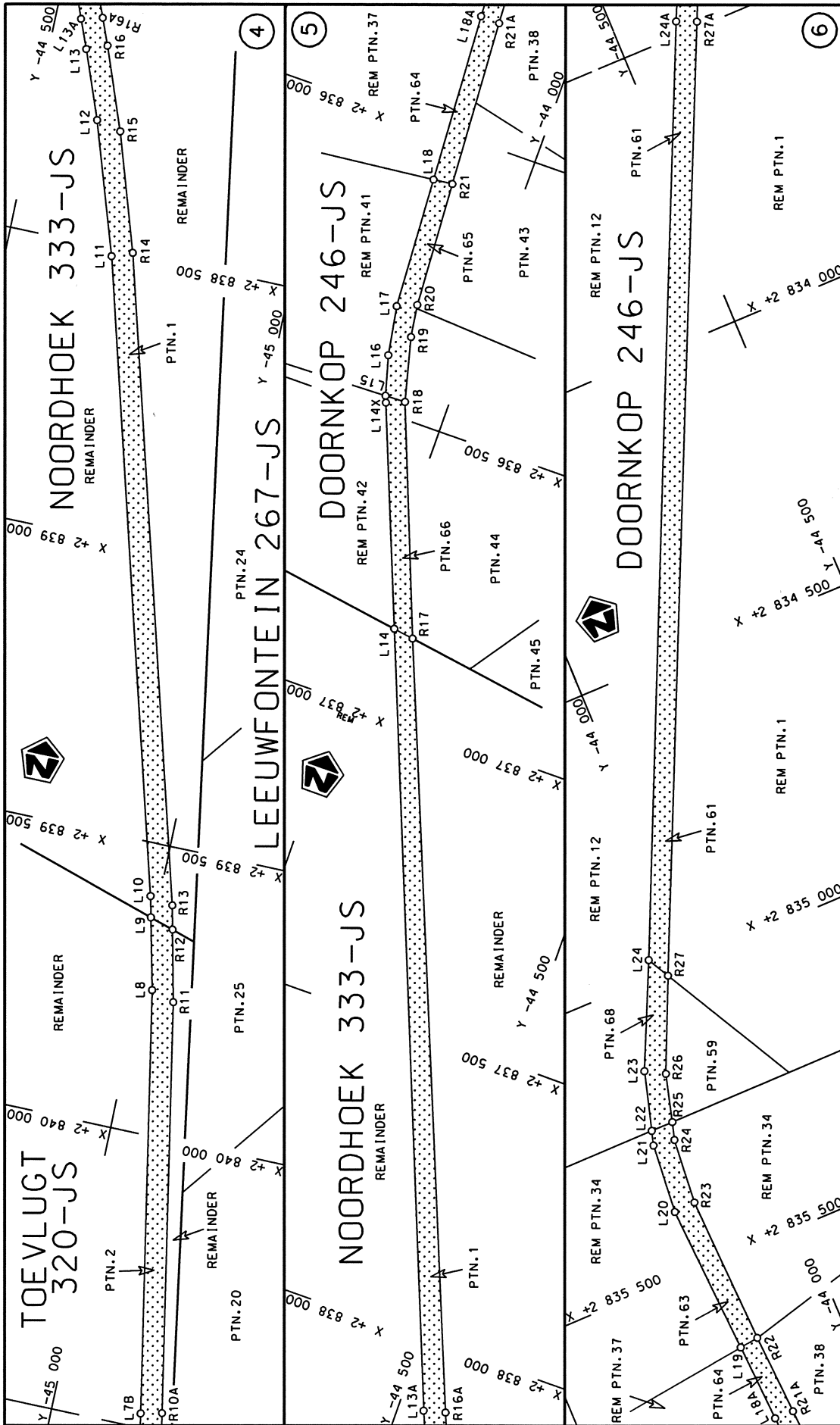

<p>Die Suid Afrikaanse Nasionale Padagentskap Beperk The South African National Roads Agency Limited</p>	<p>Die figuur getoon The figure shown</p>	<p>stetdie padreserwe voor van 'n gedeelte represents the road reserve of a portion van Nasionale Roete N11 of National Route</p>	<p>Vel Sheet 2 of 20</p>
<p>10 Seksie Section</p>		<p>Plan P712/08</p>	

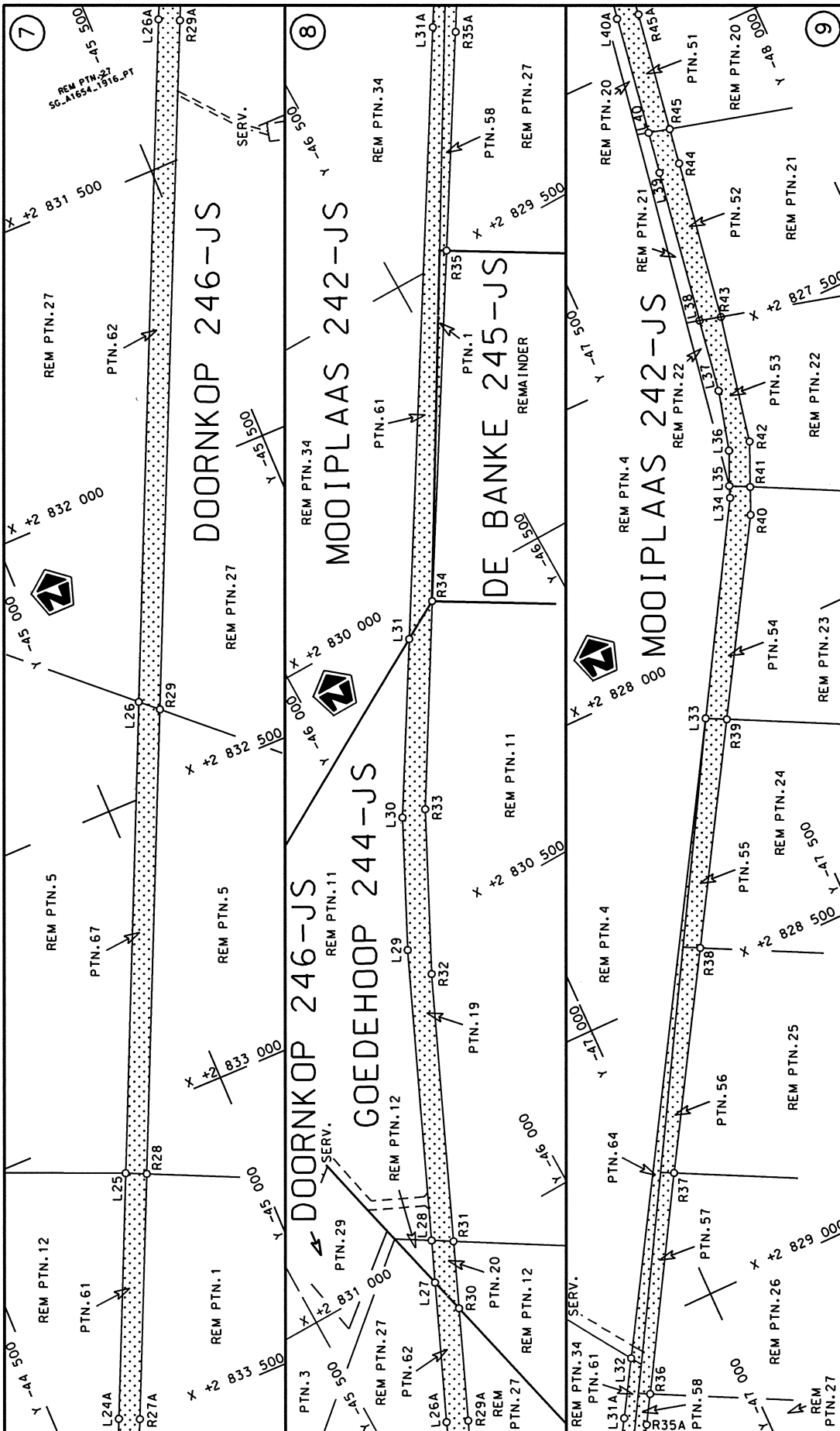

<p>Die Suid Afrikaanse Nasionale Padagentskap Beperk The South African National Roads Agency Limited</p>	<p>Die figuur getoon The figure shown</p>	<p>steeldie padreserwe voor van 'n gedeelte represents the road reserve of a portion van Nasionale Roete N11 Seksie of National Route N11 Section</p>	<p>Vel Sheet 3 of 20</p>
<p>Plan P712/08</p>		<p>10</p>	

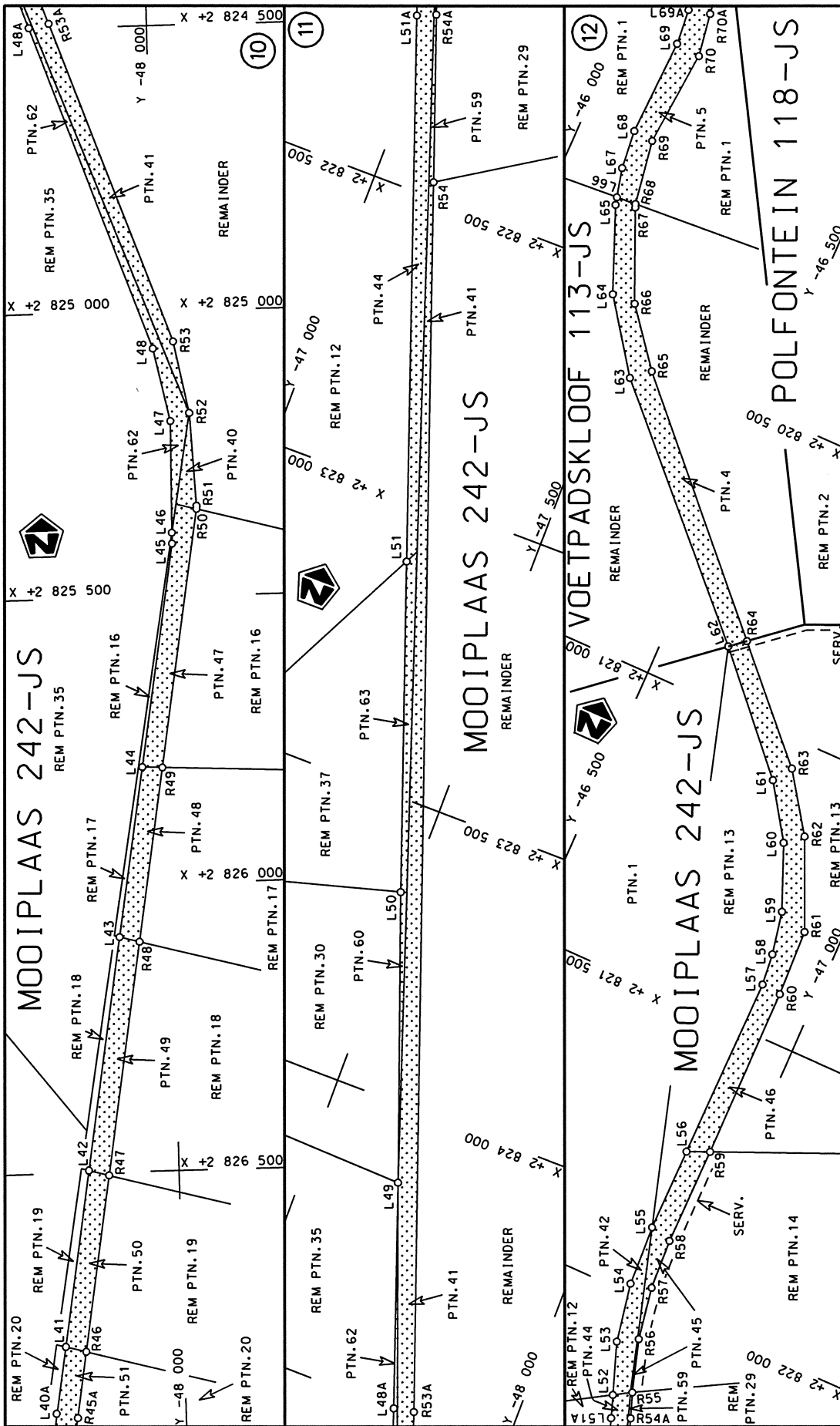

<p>Die Suid Afrikaanse Nasionale Padagentskap Beperk The South African National Roads Agency Limited</p>	<p>Die figuur getoon The figure shown</p>	<p>steldie podreserwe voor van 'n gedeelte represents the road reserve of a portion van Nasionale Roete N11 of National Route</p>
<p>Vel Sheet 4 of 20</p>	<p>Plan P712/08</p>	<p>10 Seksie Section</p>

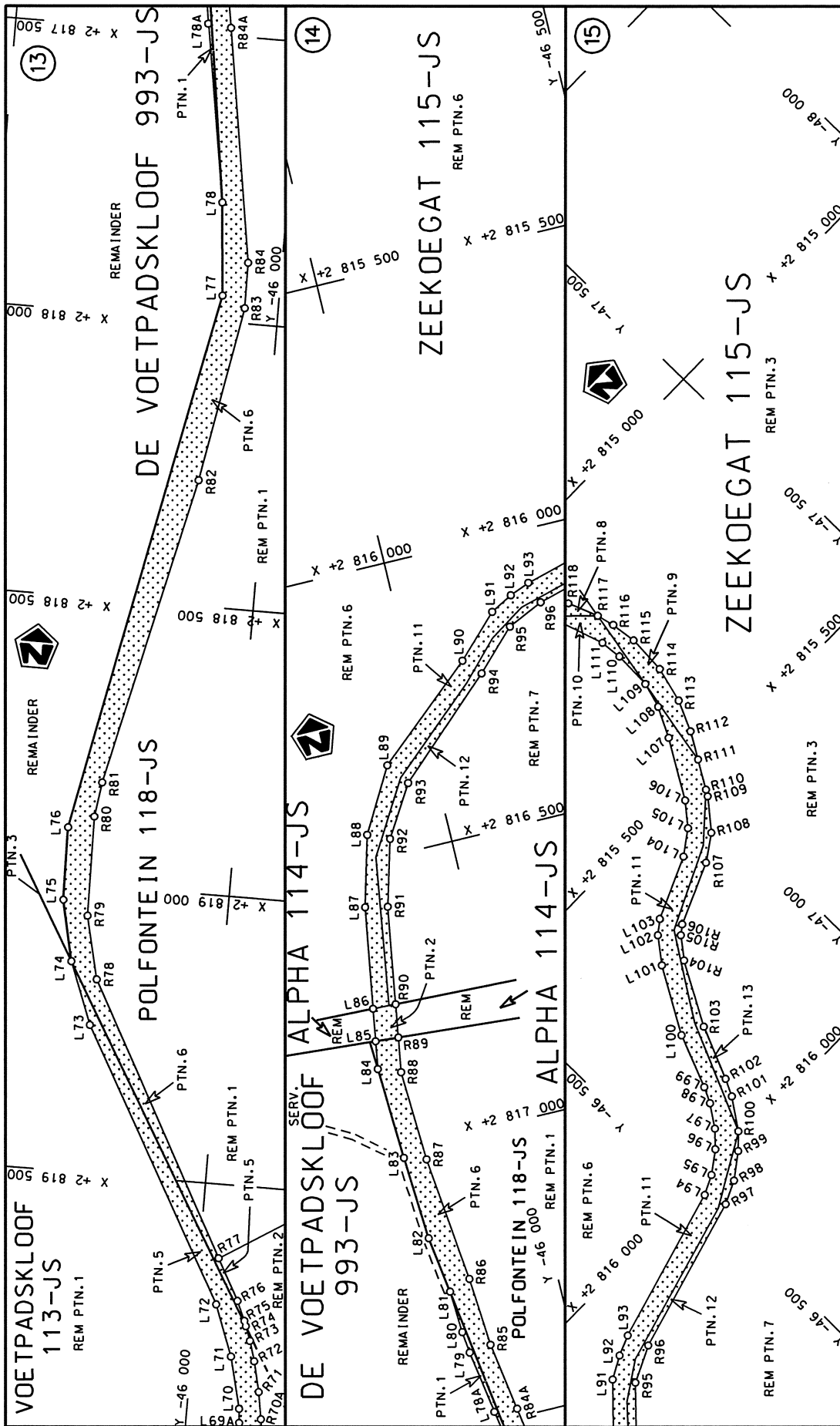

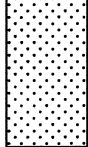
<p>Die Suid Afrikaanse Nasionale Padagentskap Beperk The South African National Roads Agency Limited</p>	<p>Die figuur getoon The figure shown</p> 	<p>stel die padreserwe voor van 'n gedeelte represents the road reserve of a portion van Nasionale Roete N11 of National Route</p> <p>Seksie Section</p> <p>10</p>	<p>Vel Sheet</p> <p>5 van 20</p>
		<p>Plan</p> <p>P712/08</p>	

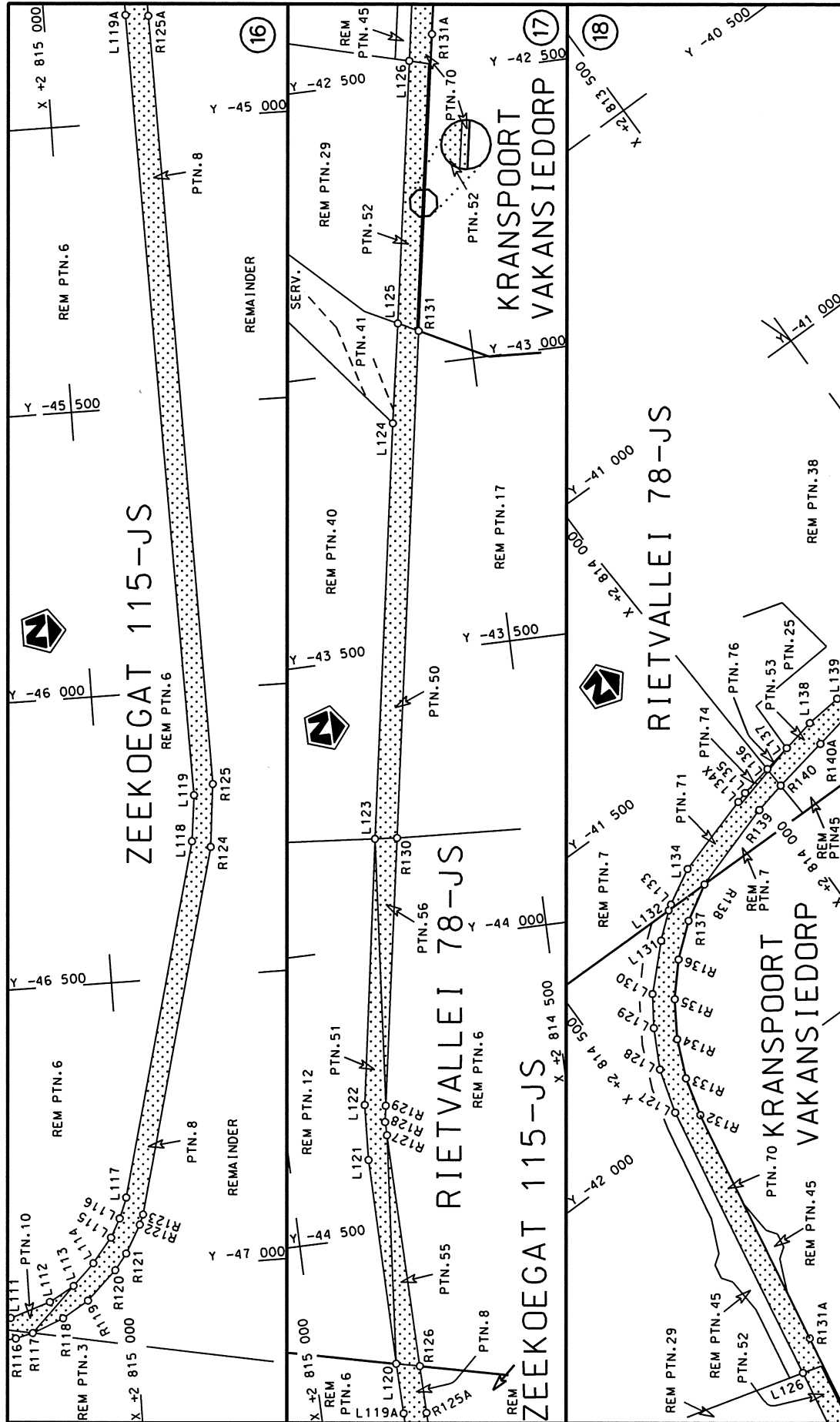

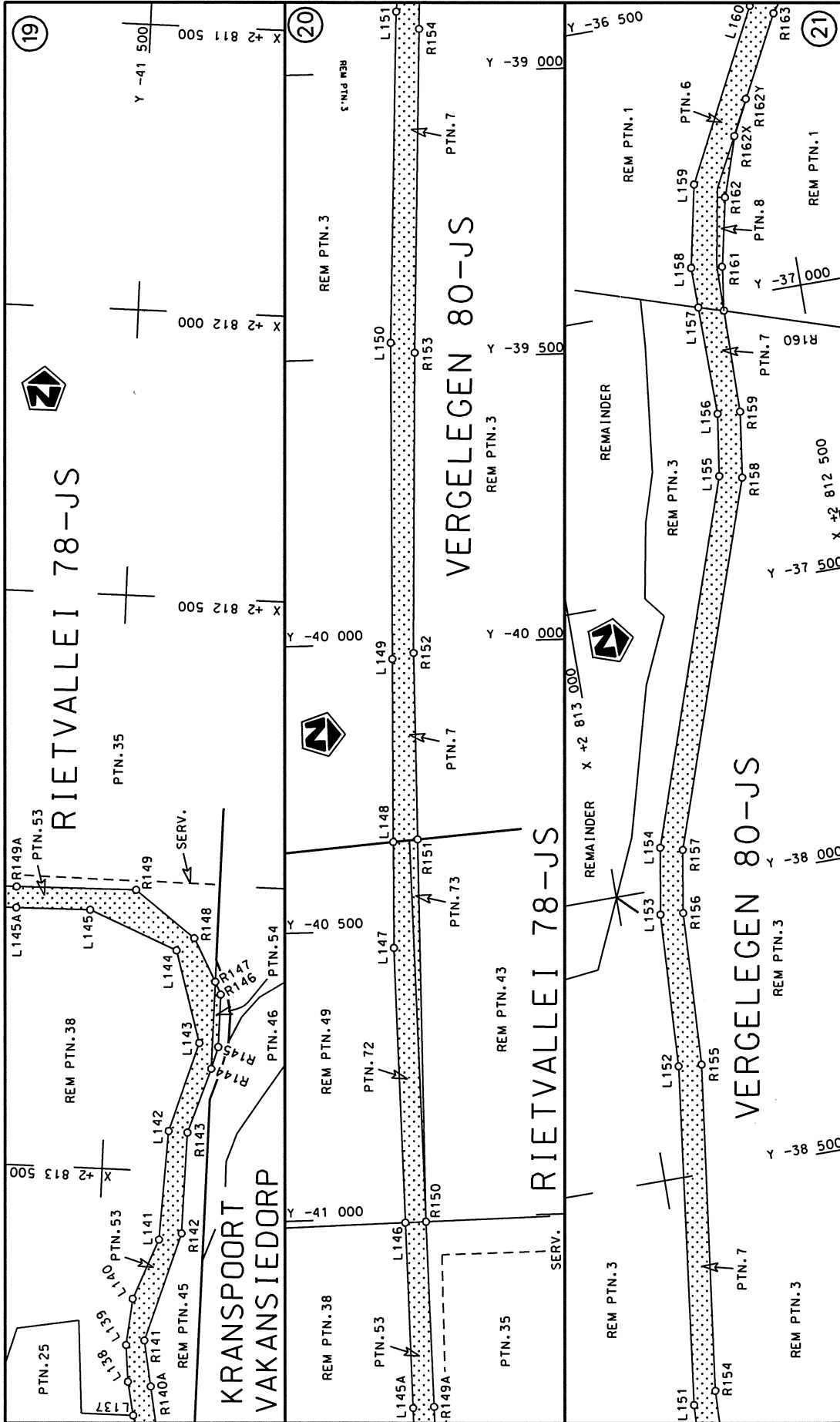

<p>Die Suid Afrikaanse Nasionale Padagentskap Beperk The South African National Roads Agency Limited</p>	<p>Die figuur getoon The figure shown</p>	<p>steldie padreserwe voor van 'n gedeelte represents the road reserve of a portion van Nasionale Roete N11 of National Route</p>	<p>Vel Sheet 7 van 20 of Plan P712/08</p>
--	---	---	---

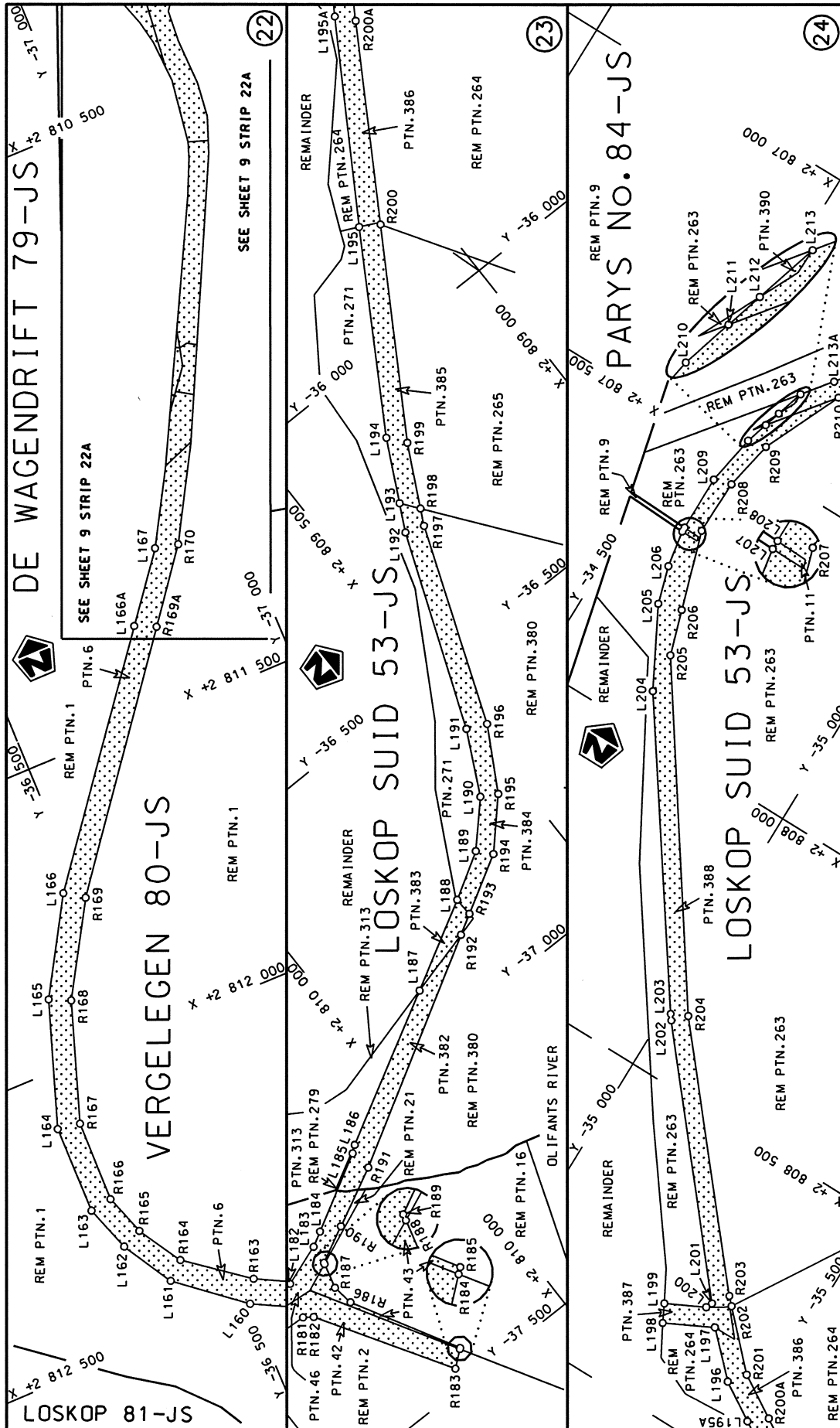

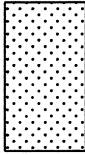
<p>Die Suid Afrikaanse Nasionale Padagentskap Beperk The South African National Roads Agency Limited</p>	<p>Die figuur getoon The figure shown</p> 	<p>steldie padreserwe voor van 'n gedeelte represents the road reserve of a portion van Nasionale Roete N11 Seksie of National Route N11 Section</p> <p>Vel Sheet 8 of 20 Plan P712/08</p>
--	---	--

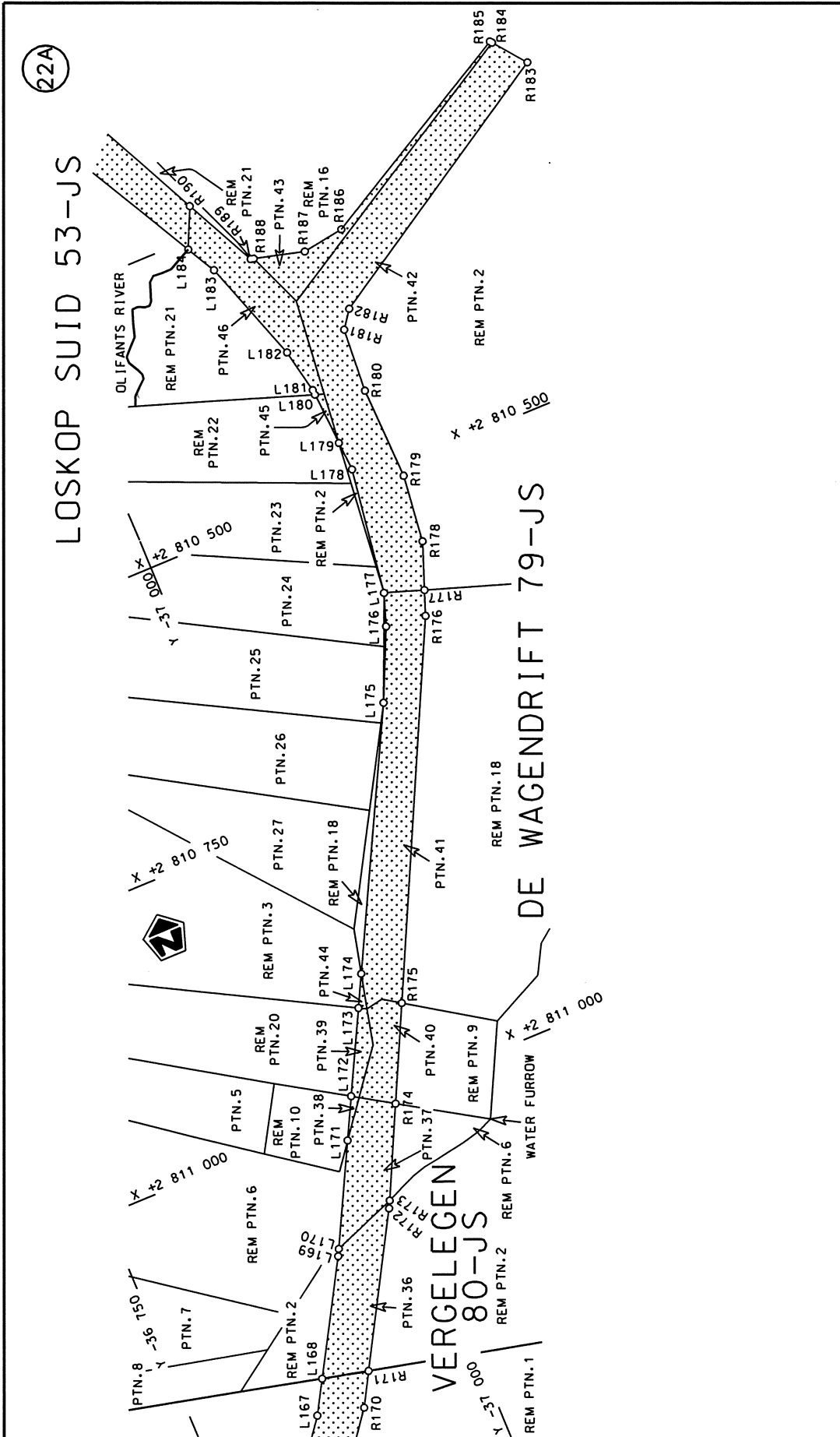

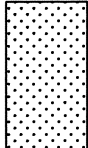
<p>Die Suid Afrikaanse Nasionale Padagentskap Beperk The South African National Roads Agency Limited</p>	<p>Die figuur getoon The figure shown</p> 	<p>steldie padreserwe voor van 'n gedeelte represents the road reserve of a portion van Nasionale Roete N11 of National Route</p> <p>Seksie 10 Section</p>	<p>Vel 9 van 20 Sheet of</p>
--	---	--	----------------------------------

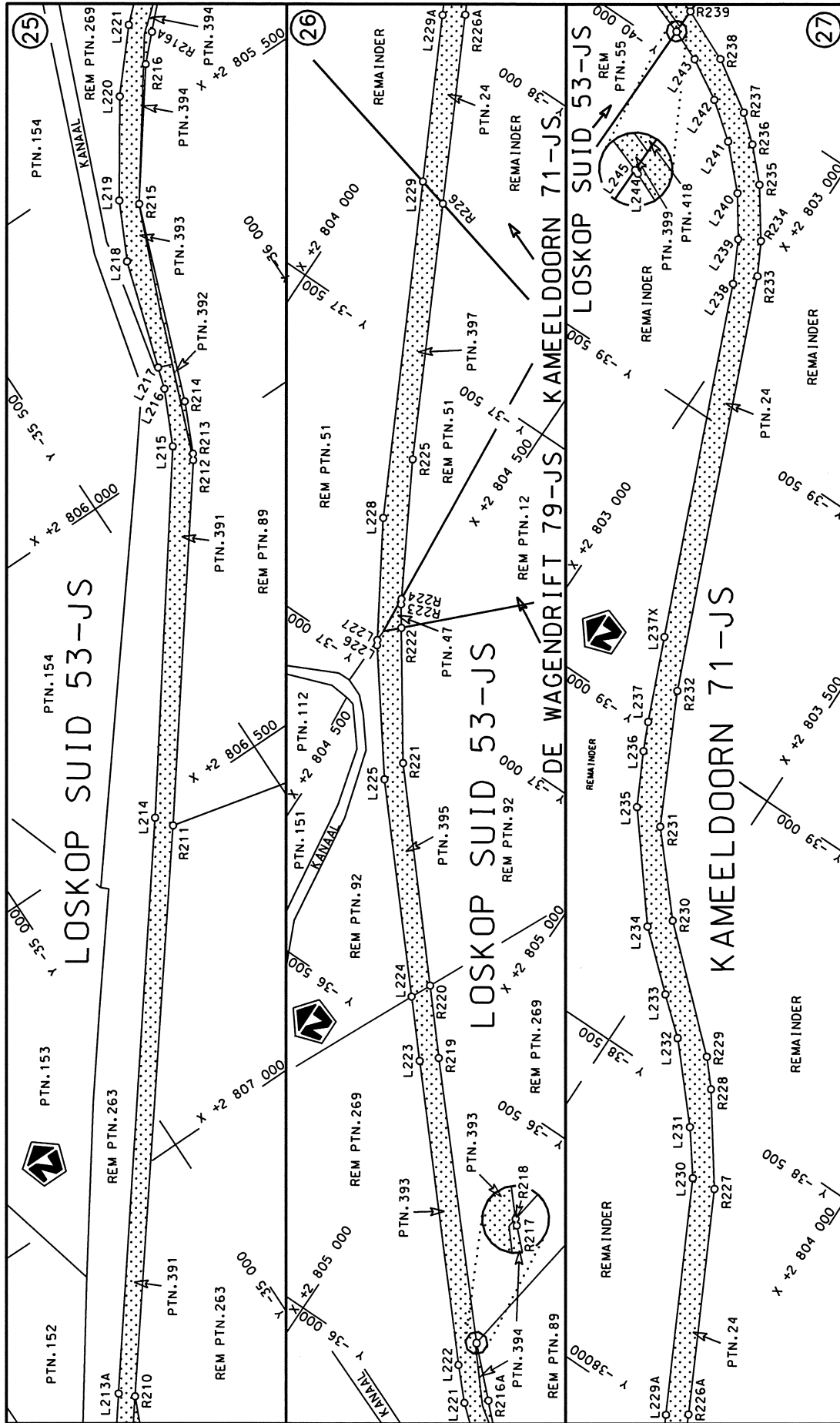

<p>Die Suid Afrikaanse Nasionale Padagentskap Beperk The South African National Roads Agency Limited</p>	<p>Die figuur getoon The figure shown</p>	<p>stel die padreserwe voor van 'n gedeelte represents the road reserve of a portion van Nasionale Roete N11 of National Route Section</p>
<p>Vel Sheet 10 of 20</p>	<p>10</p>	<p>Plan P712/08</p>

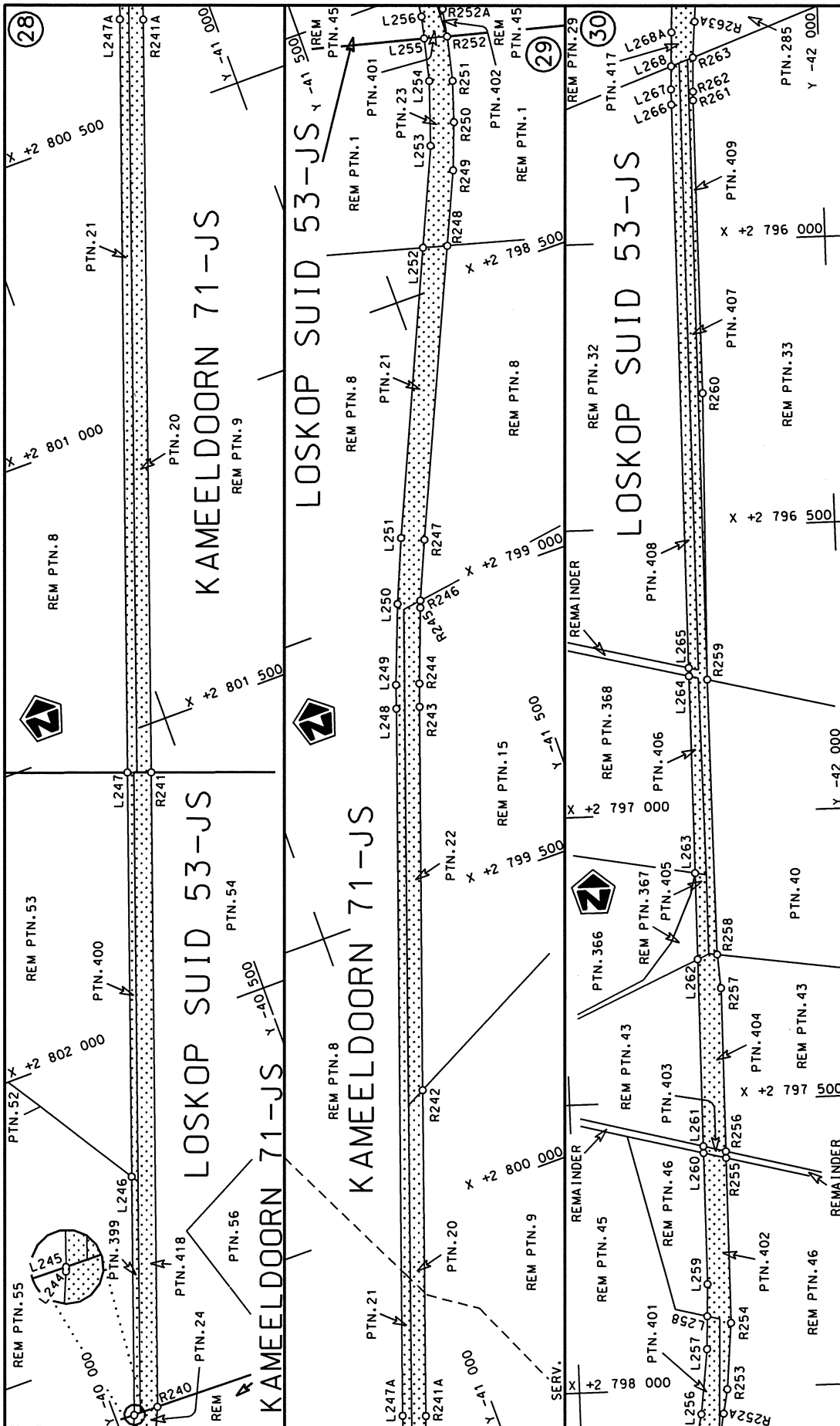

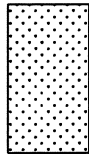
<p>Die Suid Afrikaanse Nasionale Padagentskap Beperk The South African National Roads Agency Limited</p>	<p>Die figuur getoon The figure shown</p> 	<p>steldie podreserwe voor van 'n gedeelte represents the road reserve of a portion van Nasionale Roete N11 of National Route Section</p>	<p>Vel Sheet 11 van of 20 Plan P712/08</p>
--	---	---	--

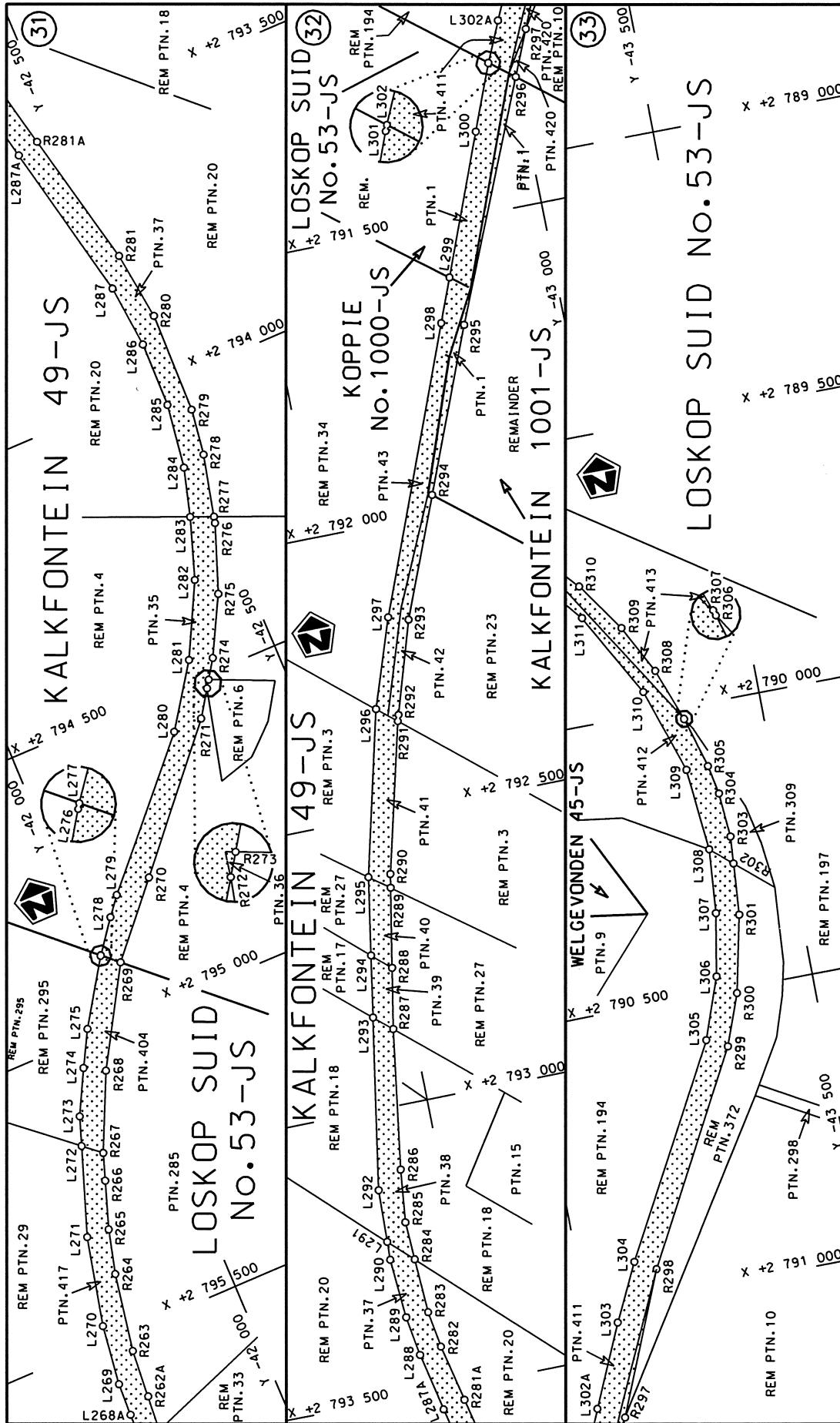

<p>Die Suid Afrikaanse Nasionale Padogentskap Beperk The South African National Roads Agency Limited</p>	<p>Die figuur getoon The figure shown</p>	<p>stel die padreserwe voor van 'n gedeelte represents the road reserve of a portion van Nasionale Roete N11 of National Route</p>
<p>Vel Sheet 12 of 20</p>	<p>Seksie Section 10</p>	<p>Plan P712/08</p>

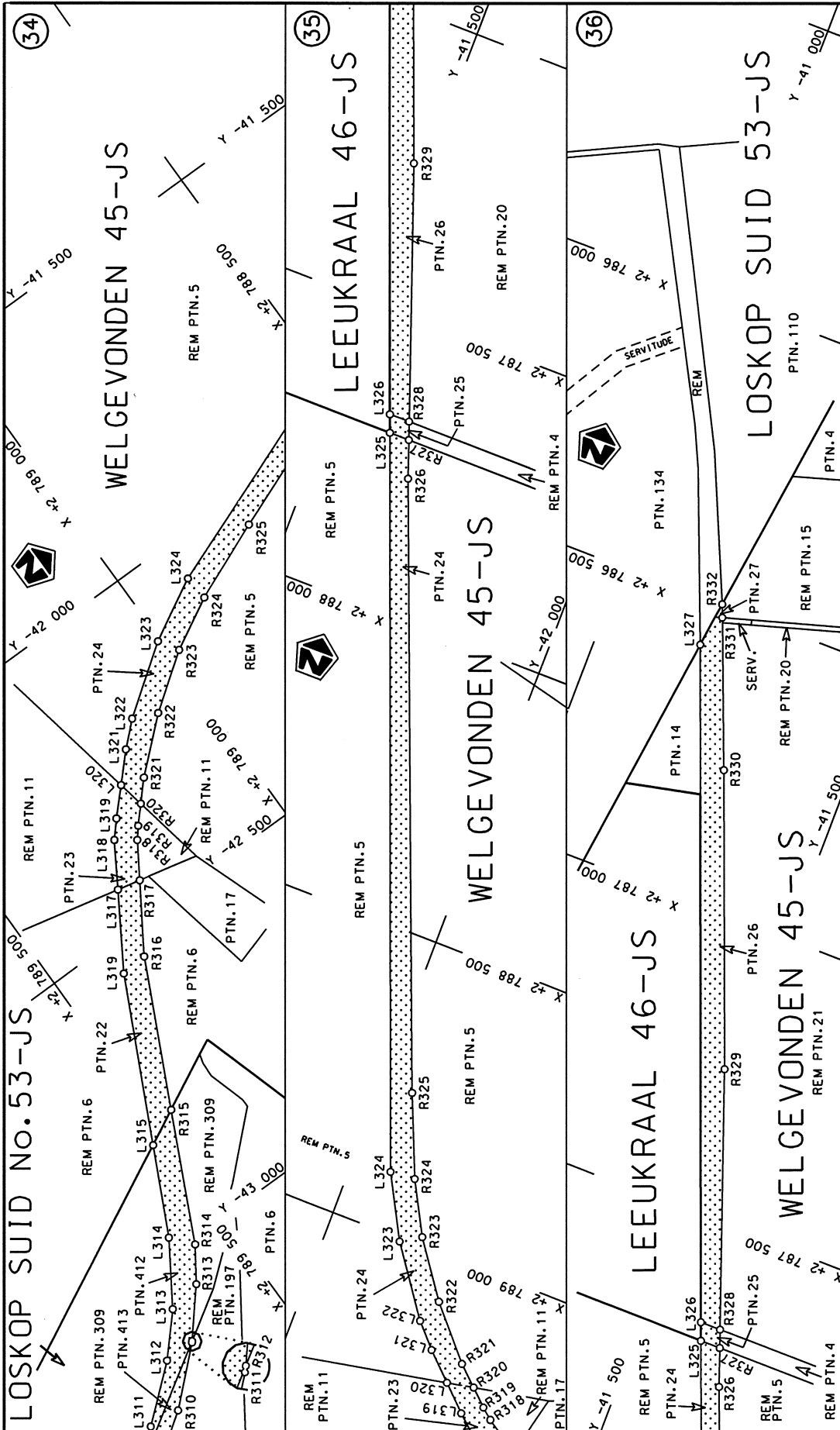

<p>Die Suid Afrikaanse Nasionale Padagentskap Beperk The South African National Roads Agency Limited</p>	<p>Die figuur getoon The figure shown</p> 	<p>steldie padreserwe voor van 'n gedeelte represents the road reserve of a portion van Nasionale Roete N11 of National Route</p>	<p>Vel Sheet 13 of 20 Plan P712/08</p>
--	---	---	--

10

PADRESERWE KOÖRDINATE / ROAD RESERVE CO-ORDINATES											
LINKERKANT/LEFT HAND SIDE					REGTERKANT/RIGHT HAND SIDE						
	Y		X	WG 29°		Y		X			
L1	-46	480.310	2	847	408.430	R1	-46	510.930	2	847	415.500
L2	-46	490.930	2	847	361.700	R2	-46	522.570	2	847	364.260
L3	-46	471.100	2	847	181.290	R3	-46	513.290	2	847	207.490
L4	-45	955.250	2	845	668.820	R4	-45	986.200	2	845	661.980
L5	-45	829.030	2	844	478.980	R5	-45	859.630	2	844	468.740
L6	-45	823.840	2	844	462.040	R6	-45	860.530	2	844	453.700
L7	-45	735.820	2	843	612.710	R7	-45	786.144	2	843	730.893
L8	-45	021.020	2	839	751.470	R8	-45	774.010	2	843	612.990
L9	-44	992.590	2	839	628.020	R9	-45	763.280	2	843	543.680
L10	-44	984.280	2	839	591.940	R10	-45	480.220	2	842	029.980
L11	-44	683.980	2	838	512.500	R11	-45	061.730	2	839	764.280
L12	-44	609.260	2	838	284.840	R12	-45	034.190	2	839	640.950
L13	-44	564.380	2	838	167.180	R13	-45	024.970	2	839	599.690
L14	-44	041.850	2	836	851.870	R14	-44	719.030	2	838	498.960
L14X	-43	891.170	2	836	472.570	R15	-44	653.150	2	838	295.810
L15	-43	891.070	2	836	472.240	R16	-44	599.890	2	838	153.670
L16	-43	872.050	2	836	403.860	R17	-44	077.720	2	836	857.260
L17	-43	856.850	2	836	318.050	R18	-43	926.630	2	836	471.130
L18	-43	843.390	2	836	087.740	R19	-43	898.610	2	836	360.620
L19	-43	818.020	2	835	653.720	R20	-43	890.110	2	836	304.060
L20	-43	802.720	2	835	392.040	R21	-43	876.980	2	836	084.110
L21	-43	812.890	2	835	271.300	R22	-43	851.070	2	835	649.560
L22	-43	819.850	2	835	246.590	R23	-43	840.610	2	835	390.030
L23	-43	848.160	2	835	146.120	R24	-43	850.340	2	835	276.450
L24	-43	929.610	2	834	970.960	R25	-43	858.980	2	835	246.540
L25	-44	783.850	2	833	088.350	R26	-43	880.960	2	835	165.060
L26	-45	121.700	2	832	344.730	R27	-43	950.500	2	835	008.900
L27	-45	714.300	2	831	040.390	R28	-44	817.260	2	833	103.610
L28	-45	744.480	2	830	973.960	R29	-45	150.650	2	832	370.750
L29	-45	952.900	2	830	515.230	R30	-45	728.970	2	831	099.500
L30	-46	057.160	2	830	309.960	R31	-45	777.080	2	830	993.740
L31	-46	218.340	2	830	044.980	R32	-45	969.030	2	830	571.780
L32	-46	827.370	2	829	043.650	R33	-46	098.680	2	830	316.560
L33	-47	407.210	2	828	090.310	R34	-46	285.310	2	830	006.550
L34	-47	605.640	2	827	758.700	R35	-46	604.540	2	829	485.010
L35	-47	612.960	2	827	739.220	R36	-46	831.760	2	829	113.770
L36	-47	638.200	2	827	682.940	R37	-47	029.090	2	828	783.520
L37	-47	664.970	2	827	580.520	R38	-47	232.830	2	828	448.630
L38	-47	685.410	2	827	455.410	R39	-47	439.940	2	828	106.990
L39	-47	728.480	2	827	191.860	R40	-47	625.650	2	827	800.650
L40	-47	740.160	2	827	120.290	R41	-47	645.420	2	827	755.760
L41	-47	792.230	2	826	801.010	R42	-47	677.310	2	827	683.350
L42	-47	842.030	2	826	495.730	R43	-47	722.210	2	827	465.140
L43	-47	907.950	2	826	091.550	R44	-47	766.680	2	827	191.390
L44	-47	956.080	2	825	796.510	R45	-47	776.580	2	827	129.920
L45	-48	019.500	2	825	407.660	R46	-47	828.050	2	826	810.490
L46	-48	019.780	2	825	388.520	R47	-47	877.270	2	826	505.050
L47	-48	022.630	2	825	192.910	R48	-47	942.430	2	826	100.670
L48	-47	995.490	2	825	065.170	R49	-47	991.180	2	825	798.130
L49	-47	661.630	2	824	128.690	R50	-48	063.660	2	825	348.300
L50	-47	486.970	2	823	654.450	R51	-48	063.960	2	825	346.440

Vel 14 Van 20
Sheet of

P712/08

PADRESERWE KOÖRDINATE / ROAD RESERVE CO-ORDINATES											
LINKERKANT/LEFT HAND SIDE					REGTERKANT/RIGHT HAND SIDE						
	Y		X	WG 29°		Y		X			
L51	-47	292.040	2	823	111.120	R52	-48	055.930	2	825	179.640
L52	-46	955.510	2	822	172.880	R53	-48	031.320	2	825	053.800
L53	-46	924.010	2	822	085.050	R54	-47	100.140	2	822	473.440
L54	-46	905.010	2	821	983.150	R55	-46	985.150	2	822	155.020
L55	-46	899.970	2	821	878.670	R56	-46	957.600	2	822	065.630
L56	-46	901.850	2	821	733.620	R57	-46	941.940	2	821	974.780
L57	-46	905.320	2	821	414.630	R58	-46	937.690	2	821	887.560
L58	-46	899.430	2	821	359.470	R59	-46	939.850	2	821	717.290
L59	-46	884.620	2	821	285.030	R60	-46	939.860	2	821	417.420
L60	-46	838.340	2	821	173.730	R61	-46	935.510	2	821	301.030
L61	-46	776.840	2	821	081.710	R62	-46	867.710	2	821	148.830
L62	-46	610.670	2	820	900.210	R63	-46	799.090	2	821	049.680
L63	-46	261.290	2	820	541.100	R64	-46	636.620	2	820	878.530
L64	-46	174.200	2	820	419.600	R65	-46	291.410	2	820	514.870
L65	-46	114.800	2	820	274.820	R66	-46	215.870	2	820	419.160
L66	-46	111.520	2	820	261.640	R67	-46	146.140	2	820	260.070
L67	-46	098.940	2	820	211.110	R68	-46	146.010	2	820	259.270
L68	-46	091.840	2	820	143.180	R69	-46	127.660	2	820	146.310
L69	-46	098.040	2	819	973.110	R70	-46	142.050	2	819	977.350
L70	-46	090.200	2	819	886.730	R71	-46	122.380	2	819	854.650
L71	-46	068.900	2	819	797.030	R72	-46	110.020	2	819	802.030
L72	-46	035.950	2	819	708.580	R73	-46	099.670	2	819	767.130
L73	-45	776.110	2	819	243.040	R74	-46	090.480	2	819	742.300
L74	-45	734.480	2	819	135.420	R75	-46	087.020	2	819	732.950
L75	-45	711.570	2	819	029.770	R76	-46	072.210	2	819	699.620
L76	-45	709.500	2	818	903.040	R77	-46	033.560	2	819	628.280
L77	-45	901.290	2	817	954.020	R78	-45	781.610	2	819	163.290
L78	-45	887.410	2	817	791.630	R79	-45	756.350	2	819	053.830
L79	-45	819.180	2	817	371.130	R80	-45	754.270	2	818	880.580
L80	-45	815.110	2	817	333.600	R81	-45	762.760	2	818	820.170
L81	-45	810.950	2	817	259.870	R82	-45	886.960	2	818	279.770
L82	-45	796.710	2	817	160.900	R83	-45	941.490	2	817	972.820
L83	-45	787.690	2	817	015.280	R84	-45	940.760	2	817	893.130
L84	-45	779.890	2	816	854.600	R85	-45	857.920	2	817	366.580
L85	-45	787.650	2	816	806.770	R86	-45	849.060	2	817	246.380
L86	-45	796.710	2	816	750.940	R87	-45	825.590	2	817	027.160
L87	-45	825.110	2	816	576.010	R88	-45	818.210	2	816	869.770
L88	-45	858.720	2	816	454.210	R89	-45	827.780	2	816	809.910
L89	-45	921.310	2	816	344.530	R90	-45	836.950	2	816	752.570
L90	-46	092.400	2	816	198.320	R91	-45	863.850	2	816	584.310
L91	-46	163.080	2	816	127.500	R92	-45	895.800	2	816	470.280
L92	-46	201.570	2	816	106.870	R93	-45	949.530	2	816	383.100
L93	-46	236.590	2	816	093.000	R94	-46	119.590	2	816	227.690
L94	-46	505.910	2	816	019.380	R95	-46	187.210	2	816	159.950
L95	-46	538.810	2	816	003.810	R96	-46	249.260	2	816	130.990
L96	-46	575.660	2	815	977.440	R97	-46	519.840	2	816	056.930
L97	-46	600.840	2	815	951.970	R98	-46	559.530	2	816	038.790
L98	-46	626.250	2	815	915.190	R99	-46	601.270	2	816	008.370
L99	-46	639.300	2	815	888.360	R100	-46	626.050	2	815	984.780
L100	-46	678.190	2	815	797.190	R101	-46	661.560	2	815	934.100
L101	-46	739.320	2	815	687.560	R102	-46	675.660	2	815	905.050

Vel	15	Van	20	P712/08
Sheet		of		

PADRESERWE KOÖRDINATE / ROAD RESERVE CO-ORDINATES											
LINKERKANT/LEFT HAND SIDE					REGTERKANT/RIGHT HAND SIDE						
	Y		X	WG 29°		Y		X			
L102	-46	771.960	2	815	645.910	R103	-46	714.090	2	815	814.740
L103	-46	795.060	2	815	628.520	R104	-46	772.530	2	815	709.560
L104	-46	901.790	2	815	582.320	R105	-46	800.200	2	815	674.650
L105	-46	942.780	2	815	553.510	R106	-46	815.380	2	815	663.210
L106	-46	974.060	2	815	516.190	R107	-46	921.680	2	815	618.190
L107	-47	032.010	2	815	419.440	R108	-46	965.610	2	815	588.450
L108	-47	058.120	2	815	368.250	R109	-47	006.710	2	815	539.560
L109	-47	070.930	2	815	324.390	R110	-47	012.830	2	815	529.350
L110	-47	073.640	2	815	258.330	R111	-47	040.930	2	815	482.420
L111	-47	069.950	2	815	220.350	R112	-47	067.030	2	815	438.820
L112	-47	045.990	2	815	147.770	R113	-47	090.930	2	815	386.700
L113	-47	021.240	2	815	103.890	R114	-47	107.170	2	815	324.420
L114	-46	984.100	2	815	066.360	R115	-47	111.200	2	815	256.630
L115	-46	941.290	2	815	033.480	R116	-47	105.590	2	815	212.090
L116	-46	909.800	2	815	016.450	R117	-47	098.050	2	815	181.530
L117	-46	876.520	2	815	003.100	R118	-47	076.260	2	815	126.500
L118	-46	263.300	2	814	843.080	R119	-47	048.480	2	815	080.530
L119	-46	183.130	2	814	833.660	R120	-46	998.910	2	815	028.790
L120	-44	724.220	2	814	857.730	R121	-46	971.260	2	815	007.770
L121	-44	366.410	2	814	860.510	R122	-46	922.900	2	814	980.440
L122	-44	270.690	2	814	854.820	R123	-46	905.710	2	814	973.420
L123	-43	812.980	2	814	777.740	R124	-46	275.660	2	814	809.680
L124	-43	095.360	2	814	653.880	R125	-46	166.350	2	814	798.150
L125	-42	922.730	2	814	622.990	R126	-44	733.540	2	814	817.460
L126	-42	468.900	2	814	544.870	R127	-44	327.760	2	814	822.930
L127	-41	970.800	2	814	459.100	R128	-44	304.560	2	814	823.240
L128	-41	894.400	2	814	436.830	R129	-44	276.690	2	814	818.440
L129	-41	829.860	2	814	403.100	R130	-43	816.300	2	814	739.220
L130	-41	780.450	2	814	369.830	R131	-42	940.460	2	814	588.510
L131	-41	714.250	2	814	302.910	R132	-42	000.510	2	814	425.790
L132	-41	679.660	2	814	261.030	R133	-41	933.720	2	814	408.710
L133	-41	676.550	2	814	257.250	R134	-41	869.790	2	814	381.040
L134	-41	640.640	2	814	191.430	R135	-41	811.000	2	814	343.560
L134X	-41	598.630	2	814	050.170	R136	-41	758.950	2	814	297.280
L135	-41	593.050	2	814	031.400	R137	-41	714.860	2	814	243.330
L136	-41	582.140	2	813	975.200	R138	-41	680.020	2	814	183.000
L137	-41	572.650	2	813	926.290	R139	-41	631.760	2	814	028.760
L138	-41	561.040	2	813	868.120	R140	-41	619.310	2	813	973.310
L139	-41	555.100	2	813	804.330	R141	-41	586.910	2	813	795.050
L140	-41	563.320	2	813	723.500	R142	-41	644.320	2	813	606.360
L141	-41	605.220	2	813	618.740	R143	-41	647.130	2	813	431.010
L142	-41	614.340	2	813	429.720	R144	-41	683.770	2	813	318.480
L143	-41	661.110	2	813	274.720	R145	-41	694.180	2	813	280.250
L144	-41	614.800	2	813	115.440	R146	-41	694.500	2	813	188.980
L145	-41	460.110	2	813	051.170	R147	-41	684.420	2	813	167.350
L146	-41	007.860	2	813	057.410	R148	-41	644.750	2	813	092.820
L147	-40	530.290	2	813	064.010	R149	-41	539.350	2	813	012.940
L148	-40	345.470	2	813	059.910	R150	-41	007.240	2	813	021.230
L149	-40	026.530	2	813	052.710	R151	-40	342.220	2	813	017.280
L150	-39	472.850	2	813	040.520	R152	-40	016.700	2	813	015.340
L151	-38	893.370	2	813	015.300	R153	-39	491.230	2	812	998.880

Vel	16	Van	20	P712/08
Sheet		of		

PADRESERWE KOÖRDINATE / ROAD RESERVE CO-ORDINATES											
LINKERKANT/LEFT HAND SIDE						REGTERKANT/RIGHT HAND SIDE					
	Y		X	WG 29°		Y		X			
L152	-38	308.640	2	812	941.910	R154	-38	875.300	2	812	974.250
L153	-38	043.010	2	812	928.590	R155	-38	312.510	2	812	901.640
L154	-37	927.900	2	812	909.100	R156	-38	046.950	2	812	888.630
L155	-37	305.620	2	812	696.680	R157	-37	938.360	2	812	870.470
L156	-37	197.240	2	812	681.040	R158	-37	314.760	2	812	657.740
L157	-37	008.180	2	812	682.880	R159	-37	200.150	2	812	641.790
L158	-36	937.910	2	812	683.560	R160	-37	021.120	2	812	639.620
L159	-36	794.790	2	812	653.940	R161	-36	944.490	2	812	629.200
L160	-36	500.180	2	812	504.080	R162	-36	825.700	2	812	603.620
L161	-36	387.310	2	812	414.150	R162X	-36	722.620	2	812	569.390
L162	-36	335.360	2	812	328.000	R162Y	-36	661.840	2	812	538.770
L163	-36	306.820	2	812	248.760	R163	-36	522.500	2	812	466.410
L164	-36	306.320	2	812	095.640	R164	-36	417.040	2	812	387.390
L165	-36	378.220	2	811	882.300	R165	-36	370.140	2	812	313.250
L166	-36	473.070	2	811	721.990	R166	-36	345.100	2	812	243.180
L167	-36	852.220	2	811	229.690	R167	-36	346.210	2	812	102.000
L168	-36	868.310	2	811	201.880	R168	-36	414.090	2	811	899.310
L169	-36	923.310	2	811	106.820	R169	-36	506.170	2	811	744.170
L170	-36	924.640	2	811	104.230	R170	-36	892.270	2	811	238.950
L171	-36	967.510	2	811	021.260	R171	-36	908.100	2	811	211.230
L172	-36	985.030	2	810	987.350	R172	-36	980.190	2	811	085.050
L173	-37	019.970	2	810	919.730	R173	-36	981.260	2	811	082.860
L174	-37	033.560	2	810	893.420	R174	-37	018.000	2	811	007.950
L175	-37	141.270	2	810	684.950	R175	-37	056.180	2	810	930.120
L176	-37	168.650	2	810	624.830	R176	-37	203.640	2	810	629.470
L177	-37	178.180	2	810	597.380	R177	-37	211.430	2	810	608.490
L178	-37	193.720	2	810	487.880	R178	-37	226.140	2	810	568.860
L179	-37	192.020	2	810	462.270	R179	-37	232.910	2	810	510.070
L180	-37	188.940	2	810	415.750	R180	-37	230.270	2	810	429.130
L181	-37	188.640	2	810	411.260	R181	-37	233.940	2	810	373.430
L182	-37	180.610	2	810	372.710	R182	-37	244.950	2	810	358.360
L183	-37	149.720	2	810	282.730	R183	-37	469.150	2	810	220.200
L184	-37	136.000	2	810	257.640	R184	-37	447.400	2	810	192.750
L185	-37	065.570	2	810	128.850	R185	-37	446.130	2	810	191.150
L186	-37	056.350	2	810	116.800	R186	-37	265.030	2	810	292.200
L187	-36	917.760	2	809	861.640	R187	-37	228.330	2	810	297.840
L188	-36	835.190	2	809	711.940	R188	-37	185.140	2	810	286.590
L189	-36	789.100	2	809	634.010	R189	-37	182.520	2	810	285.910
L190	-36	720.070	2	809	568.960	R190	-37	151.650	2	810	223.450
L191	-36	612.540	2	809	514.500	R191	-37	101.790	2	810	122.570
L192	-36	278.260	2	809	385.140	R192	-36	886.920	2	809	744.640
L193	-36	231.910	2	809	361.420	R193	-36	867.500	2	809	710.480
L194	-36	128.120	2	809	308.320	R194	-36	812.110	2	809	613.050
L195	-35	810.380	2	809	117.010	R195	-36	735.520	2	809	541.380
L196	-35	430.190	2	808	881.460	R196	-36	628.100	2	809	480.950
L197	-35	361.900	2	808	813.070	R197	-36	289.380	2	809	352.640
L198	-35	279.670	2	808	854.600	R198	-36	261.860	2	809	338.560
L199	-35	264.440	2	808	824.370	R199	-36	157.690	2	809	285.260
L200	-35	330.350	2	808	791.180	R200	-35	830.210	2	809	085.050
L201	-35	335.730	2	808	780.270	R201	-35	452.190	2	808	853.960
L202	-35	017.640	2	808	400.860	R202	-35	367.120	2	808	766.440

Vel	17	Van	20	P712/08
Sheet		of		

PADRESERWE KOÖRDINATE / ROAD RESERVE CO-ORDINATES											
LINKERKANT/LEFT HAND SIDE					REGTERKANT/RIGHT HAND SIDE						
	Y		X	WG 29°				X			
L203	-35	010.790	2	808	391.770	R203	-35	354.590	2	808	753.550
L204	-34	689.720	2	807	930.880	R204	-35	039.100	2	808	378.720
L205	-34	618.100	2	807	796.040	R205	-34	683.460	2	807	861.580
L206	-34	598.720	2	807	730.960	R206	-34	658.850	2	807	783.820
L207	-34	587.690	2	807	666.510	R207	-34	615.920	2	807	647.960
L208	-34	587.650	2	807	658.610	R208	-34	617.670	2	807	551.310
L209	-34	587.190	2	807	560.510	R209	-34	634.540	2	807	464.280
L210	-34	602.320	2	807	471.300	R210	-34	697.090	2	807	324.450
L211	-34	614.280	2	807	431.830	R211	-35	305.280	2	806	535.810
L212	-34	623.040	2	807	402.910	R212	-35	690.020	2	806	024.100
L213	-34	637.780	2	807	354.270	R213	-35	696.120	2	806	014.390
L214	-35	286.460	2	806	506.860	R214	-35	734.940	2	805	930.340
L215	-35	673.570	2	805	984.070	R215	-35	860.170	2	805	598.040
L216	-35	717.300	2	805	891.800	R216	-36	005.960	2	805	400.520
L217	-35	728.910	2	805	854.780	R217	-36	117.630	2	805	287.010
L218	-35	786.920	2	805	669.910	R218	-36	118.530	2	805	286.220
L219	-35	834.750	2	805	573.880	R219	-36	493.070	2	804	955.960
L220	-35	936.810	2	805	422.620	R220	-36	589.240	2	804	873.150
L221	-36	019.650	2	805	326.820	R221	-36	885.600	2	804	617.970
L222	-36	068.660	2	805	281.310	R222	-37	080.180	2	804	484.010
L223	-36	470.130	2	804	930.910	R223	-37	113.950	2	804	460.760
L224	-36	555.240	2	804	857.080	R224	-37	122.380	2	804	456.040
L225	-36	843.880	2	804	606.680	R225	-37	336.650	2	804	336.060
L226	-37	031.210	2	804	465.840	R226	-37	738.210	2	804	130.520
L227	-37	039.210	2	804	461.020	R227	-38	386.920	2	803	798.480
L228	-37	222.630	2	804	350.380	R228	-38	527.770	2	803	697.300
L229	-37	751.060	2	804	079.530	R229	-38	570.490	2	803	659.850
L230	-38	381.430	2	803	756.310	R230	-38	734.620	2	803	478.250
L231	-38	452.350	2	803	703.030	R231	-38	858.740	2	803	368.870
L232	-38	568.990	2	803	599.100	R232	-39	072.590	2	803	262.310
L233	-38	620.320	2	803	538.880	R233	-39	754.500	2	802	975.210
L234	-38	701.230	2	803	446.930	R234	-39	808.990	2	802	945.940
L235	-38	864.330	2	803	315.850	R235	-39	889.520	2	802	888.760
L236	-38	951.750	2	803	270.930	R236	-39	941.460	2	802	839.340
L237	-39	998.970	2	802	249.570	R237	-39	979.550	2	802	795.820
L237X	-39	138.130	2	803	190.850	R238	-40	034.990	2	802	709.670
L238	-39	719.710	2	802	947.000	R239	-40	075.080	2	802	619.290
L239	-39	789.380	2	802	911.140	R240	-40	444.670	2	801	580.160
L240	-39	855.900	2	802	865.200	R241	-41	072.570	2	799	805.890
L241	-39	922.110	2	802	801.290	R242	-41	296.190	2	799	177.430
L242	-39	969.640	2	802	740.710	R243	-41	309.860	2	799	139.150
L243	-40	009.530	2	802	672.020	R244	-41	356.700	2	799	015.230
L244	-40	031.970	2	802	619.190	R245	-41	361.060	2	799	003.400
L245	-40	032.240	2	802	618.430	R246	-41	404.060	2	798	905.920
L246	-40	170.710	2	802	228.160	R247	-41	617.390	2	798	436.210
L247	-40	405.660	2	801	565.950	R248	-41	672.080	2	798	315.800
L248	-41	256.930	2	799	166.690	R249	-41	702.220	2	798	237.100
L249	-41	270.660	2	799	127.440	R250	-41	724.790	2	798	168.140
L250	-41	321.500	2	798	995.640	R251	-41	742.270	2	798	091.740
L251	-41	366.900	2	798	889.080	R252	-41	759.120	2	798	001.980
L252	-41	576.400	2	798	424.900	R253	-41	769.730	2	797	887.000

Vel	18	Van	20	P712/08
Sheet		of		

PADRESERWE KOÖRDINATE / ROAD RESERVE CO-ORDINATES											
LINKERKANT/LEFT HAND SIDE					REGTERKANT/RIGHT HAND SIDE						
	Y		X	WG 29°			X				
L253	-41	649.910	2	798	262.040	R254	-41	771.200	2	797	600.340
L254	-41	686.510	2	798	154.540	R255	-41	771.260	2	797	588.900
L255	-41	703.470	2	798	081.610	R256	-41	772.720	2	797	305.810
L256	-41	712.220	2	798	043.940	R257	-41	767.940	2	797	247.090
L257	-41	726.190	2	797	931.230	R258	-41	767.310	2	796	767.810
L258	-41	728.620	2	797	873.820	R259	-41	776.580	2	796	266.630
L259	-41	730.980	2	797	818.250	R260	-41	777.140	2	795	754.280
L260	-41	732.010	2	797	590.520	R261	-41	777.560	2	795	738.990
L261	-41	732.060	2	797	578.890	R262	-41	779.330	2	795	679.280
L262	-41	733.530	2	797	254.260	R263	-41	790.640	2	795	533.120
L263	-41	734.210	2	797	103.740	R264	-41	814.990	2	795	397.860
L264	-41	735.450	2	796	760.820	R265	-41	834.780	2	795	322.110
L265	-41	735.510	2	796	746.240	R266	-41	862.360	2	795	241.840
L266	-41	739.080	2	795	760.360	R267	-41	878.160	2	795	196.190
L267	-41	739.290	2	795	733.860	R268	-41	938.400	2	795	066.360
L268	-41	740.950	2	795	693.410	R269	-42	035.680	2	794	902.950
L269	-41	745.710	2	795	577.200	R270	-42	139.430	2	794	786.360
L270	-41	759.730	2	795	473.240	R271	-42	332.310	2	794	566.880
L271	-41	794.840	2	795	319.600	R272	-42	362.180	2	794	522.310
L272	-41	847.630	2	795	170.310	R273	-42	370.900	2	794	509.300
L273	-41	864.840	2	795	121.630	R274	-42	392.270	2	794	477.370
L274	-41	903.930	2	795	046.870	R275	-42	445.020	2	794	377.850
L275	-41	936.870	2	794	987.120	R276	-42	488.290	2	794	261.400
L276	-42	008.070	2	794	879.110	R277	-42	490.930	2	794	250.500
L277	-42	008.640	2	794	878.360	R278	-42	516.930	2	794	143.170
L278	-42	050.220	2	794	823.530	R279	-42	528.660	2	794	062.450
L279	-42	075.460	2	794	792.200	R280	-42	531.810	2	793	885.400
L280	-42	280.160	2	794	569.690	R281	-42	516.540	2	793	764.920
L281	-42	352.830	2	794	464.490	R282	-42	440.010	2	793	425.940
L282	-42	416.880	2	794	339.560	R283	-42	429.680	2	793	362.520
L283	-42	452.720	2	794	234.460	R284	-42	424.650	2	793	267.840
L284	-42	476.530	2	794	150.890	R285	-42	421.140	2	793	201.710
L285	-42	492.820	2	794	038.380	R286	-42	430.820	2	793	110.190
L286	-42	494.310	2	793	923.940	R287	-42	465.760	2	792	868.170
L287	-42	483.710	2	793	812.980	R288	-42	484.350	2	792	763.260
L288	-42	401.390	2	793	433.060	R289	-42	509.470	2	792	623.270
L289	-42	390.290	2	793	364.100	R290	-42	513.280	2	792	602.050
L290	-42	382.540	2	793	260.290	R291	-42	577.820	2	792	342.740
L291	-42	383.490	2	793	228.710	R292	-42	578.310	2	792	340.740
L292	-42	386.210	2	793	137.960	R293	-42	630.900	2	792	172.270
L293	-42	434.920	2	792	841.640	R294	-42	713.450	2	791	965.820
L294	-42	452.470	2	792	734.930	R295	-42	826.020	2	791	684.310
L295	-42	475.060	2	792	597.540	R296	-42	998.920	2	791	275.120
L296	-42	544.620	2	792	314.910	R297	-43	032.320	2	791	196.080
L297	-42	596.680	2	792	161.580	R298	-43	135.230	2	790	952.530
L298	-42	787.400	2	791	673.490	R299	-43	331.100	2	790	596.090
L299	-42	817.090	2	791	597.610	R300	-43	364.150	2	790	507.780
L300	-42	911.580	2	791	356.120	R301	-43	393.680	2	790	370.830
L301	-42	956.310	2	791	242.360	R302	-43	400.630	2	790	284.830
L302	-42	956.720	2	791	241.440	R303	-43	404.020	2	790	237.450
L303	-43	049.850	2	791	033.070	R304	-43	398.100	2	790	159.840

Vel	19	Van	20	P712/08
Sheet		of		

PADRESERWE KOÖRDINATE / ROAD RESERVE CO-ORDINATES					
LINKERKANT/LEFT HAND SIDE			REGTERKANT/RIGHT HAND SIDE		
	Y	X	WG 29°	Y	X
L304	-43 099.450	2 790	931.980	R305	-43 388.110 2 790 109.260
L305	-43 295.320	2 790	578.170	R306	-43 362.260 2 790 021.100
L306	-43 333.740	2 790	472.530	R307	-43 361.960 2 790 020.100
L307	-43 353.370	2 790	363.840	R308	-43 327.820 2 789 928.550
L308	-43 363.030	2 790	252.460	R309	-43 283.480 2 789 843.940
L309	-43 349.560	2 790	108.670	R310	-43 224.270 2 789 758.520
L310	-43 300.310	2 789	960.870	R311	-43 143.300 2 789 669.920
L311	-43 218.830	2 789	813.850	R312	-43 141.390 2 789 668.310
L312	-43 143.240	2 789	723.560	R313	-43 065.930 2 789 604.500
L313	-43 077.020	2 789	662.910	R314	-43 009.240 2 789 565.800
L314	-42 972.960	2 789	595.940	R315	-42 796.800 2 789 462.870
L315	-42 827.450	2 789	524.360	R316	-42 554.700 2 789 345.580
L316	-42 557.590	2 789	391.620	R317	-42 443.070 2 789 274.190
L317	-42 433.890	2 789	314.570	R318	-42 384.080 2 789 236.460
L318	-42 360.500	2 789	268.870	R319	-42 365.030 2 789 220.770
L319	-42 332.560	2 789	244.090	R320	-42 336.790 2 789 194.680
L320	-42 290.470	2 789	203.700	R321	-42 303.240 2 789 163.670
L321	-42 245.220	2 789	160.280	R322	-42 227.280 2 789 077.580
L322	-42 208.460	2 789	120.330	R323	-42 160.170 2 788 983.720
L323	-42 126.180	2 789	004.950	R324	-42 112.010 2 788 894.700
L324	-42 068.490	2 788	898.330	R325	-42 054.600 2 788 757.600
L325	-41 608.060	2 787	701.690	R326	-41 666.150 2 787 765.040
L326	-41 596.520	2 787	671.630	R327	-41 643.170 2 787 701.730
L327	-41 183.240	2 786	522.680	R328	-41 632.260 2 787 671.680
				R329	-41 478.860 2 787 249.040
				R330	-41 292.300 2 786 765.660
				R331	-41 195.100 2 786 519.210
				R332	-41 186.620 2 786 497.700

Vel	20	Van	20	P712/08
Sheet		of		

Printed by and obtainable from the Government Printer, Bosman Street, Private Bag X85, Pretoria, 0001
Publications: Tel: (012) 334-4508, 334-4509, 334-4510
Advertisements: Tel: (012) 334-4673, 334-4674, 334-4504
Subscriptions: Tel: (012) 334-4735, 334-4736, 334-4737
Cape Town Branch: Tel: (021) 465-7531