



# Government Gazette Staatskoerant

REPUBLIC OF SOUTH AFRICA  
REPUBLIEK VAN SUID-AFRIKA

Vol. 574

Pretoria, 12 April 2013

No. 36365

*N.B. The Government Printing Works will not be held responsible for the quality of "Hard Copies" or "Electronic Files" submitted for publication purposes*



**AIDS HELPLINE: 0800-0123-22 Prevention is the cure**

**IMPORTANT NOTICE**

The Government Printing Works will not be held responsible for faxed documents not received due to errors on the fax machine or faxes received which are unclear or incomplete. Please be advised that an "OK" slip, received from a fax machine, will not be accepted as proof that documents were received by the GPW for printing. If documents are faxed to the GPW it will be the sender's responsibility to phone and confirm that the documents were received in good order.

Furthermore the Government Printing Works will also not be held responsible for cancellations and amendments which have not been done on original documents received from clients.

**CONTENTS****INHOUD**

<i>No.</i>	<i>Page No.</i>	<i>Gazette No.</i>	<i>No.</i>	<i>Bladsy No.</i>	<i>Koerant No.</i>
<b>GOVERNMENT NOTICE</b>			<b>GOEWERMENTSKENNISGEWING</b>		
<b>Transport, Department of</b>			<b>Vervoer, Departement van</b>		
<i>Government Notice</i>			<i>Goewermentskennisgewing</i>		
282			282		
South African National Roads Agency Limited and the National Roads Act (7/1998): Declaration amendment of National Road N14 Section 9 .....	3	36365	Wet op die Suid-Afrikaanse Nasionale Padagentskap Beperk en op Nasionale Paaie (7/1998): Verklaring wysiging van Nasionale Pad N14 Seksie 9 .....	4	36365

---

## GOVERNMENT NOTICE

---

### DEPARTMENT OF TRANSPORT

No. 282

12 April 2013

## THE SOUTH AFRICAN NATIONAL ROADS AGENCY SOC LIMITED

Registration No: 98/09584/06

---

### DECLARATION AMENDMENT OF NATIONAL ROAD N14 SECTION 9

AMENDMENT OF DECLARATION NO. 803 OF 2008

By virtue of Section 40(1)(b) of the South African National Roads Agency Limited and the National Roads Act, 1998 (Act No. 7 of 1998), I hereby amend Declaration No. 803 of 2008, by substituting sheets 1 to 22 of Plan No. P642/08, with the subjoined sheets 1 to 23 of Plan No. P810/12.

(National Road N14 Section 9: Vryburg – Delareyville)



\_\_\_\_\_  
MINISTER OF TRANSPORT

**GOEWERMENTSKENNISGEWING**

---

---

**DEPARTEMENT VAN VERVOER**

**No. 282**

**12 April 2013**

**DIE SUID-AFRIKAANSE NASIONALE  
PADAGENTSKAP MSB BEPERK**

Registrasie No: 98/09584/06

---

**VERKLARING WYSIGING VAN NASIONALE PAD N14 SEKSIE 9**

WYSIGING VAN VERKLARING NO. 803 VAN 2008

Kragtens Artikel 40(1)(b) van die Wet op die Suid-Afrikaanse Nasionale Padagentskap Beperk en op Nasionale Paaie, 1998 (Wet no. 7 van 1998), wysig ek hiermee Verklaring no. 803 van 2008, deur velle 1 tot 22 van Plan no. P642/08, te vervang met meegaande velle 1 tot 23 van Plan no. P810/12.

**(Nasionale Pad N14 Seksie 9: Vryburg – Delareyville)**



**MINISTER VAN VERVOER**

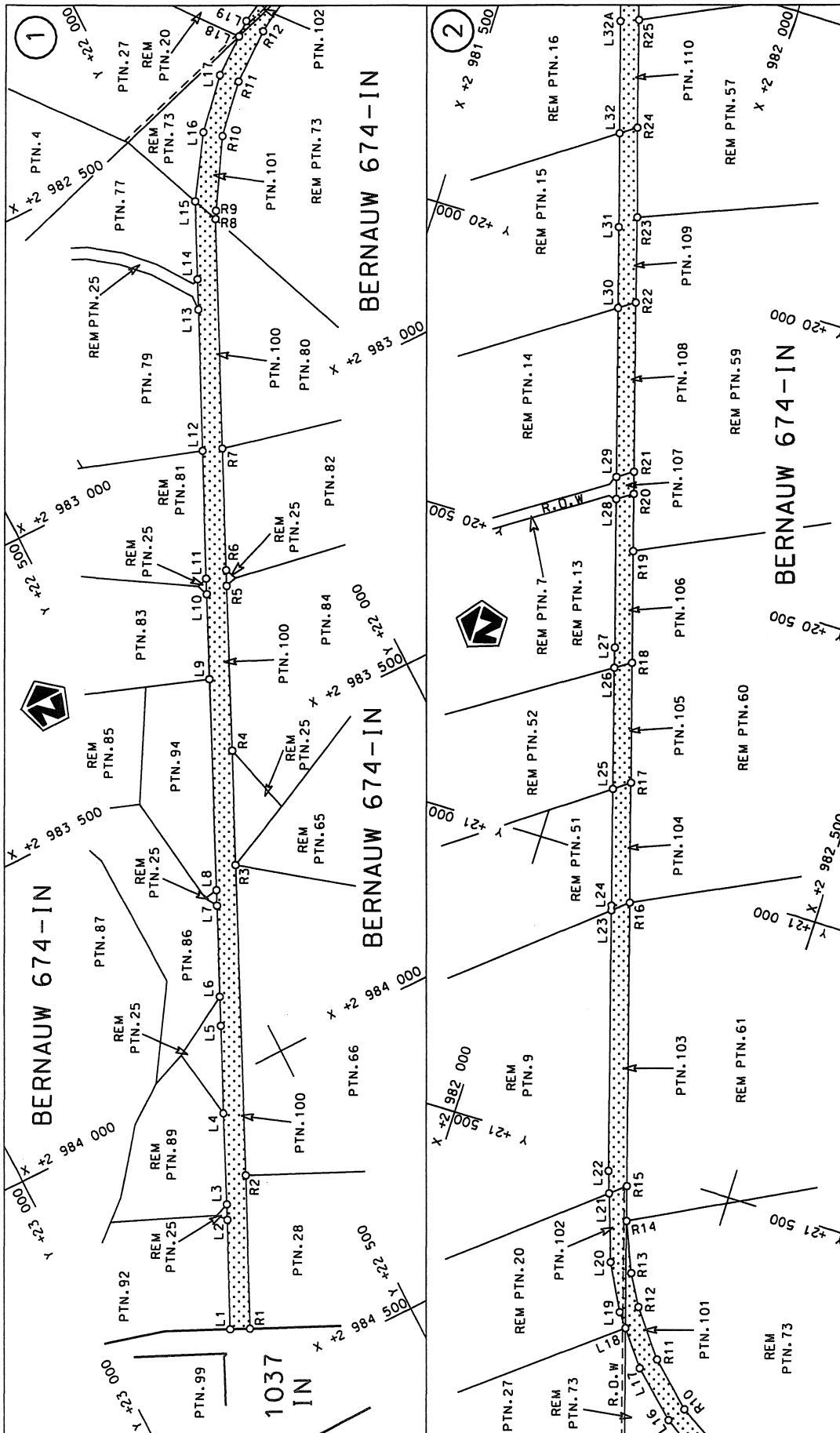

<p>Die Suid Afrikaanse Nasionale Padagentskap Beperk The South African National Roads Agency Limited</p>	<p>Die figuur getoon The figure shown</p>	<p>steldie padreserwe voor van 'n gedeelte represents the road reserve of a portion van Nasionale Roete N14 of National Route Seksie Section</p>	<p>9</p>	<p>Vel Sheet 1 of 23 Plan P810/12</p>
--------------------------------------------------------------------------------------------------------------	-----------------------------------------------	----------------------------------------------------------------------------------------------------------------------------------------------------------------------	----------	-------------------------------------------

D.O.9.A

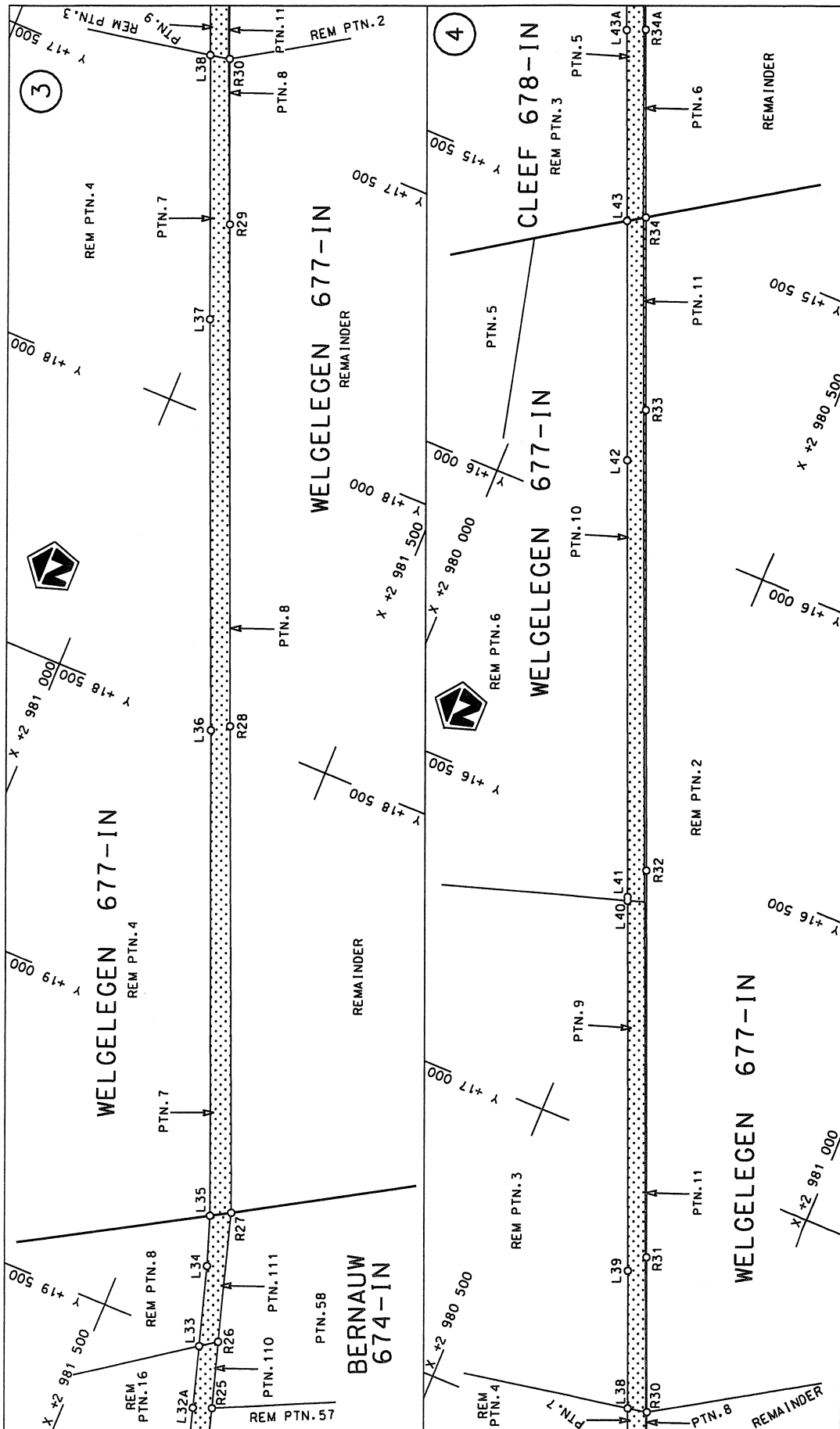

<p>Die Suid Afrikaanse Nasionale Padagentskap Beperk The South African National Roads Agency Limited</p>	<p>Die figuur getoon The figure shown</p>	<p>stel die podreserwe voor van 'n gedeelte represents the road reserve of a portion van Nasionale Roete N14 of National Route</p>	<p>Vel Sheet 2 of 23 Plan P810/12</p>
<p>9</p>			<p>D.O.9.A</p>

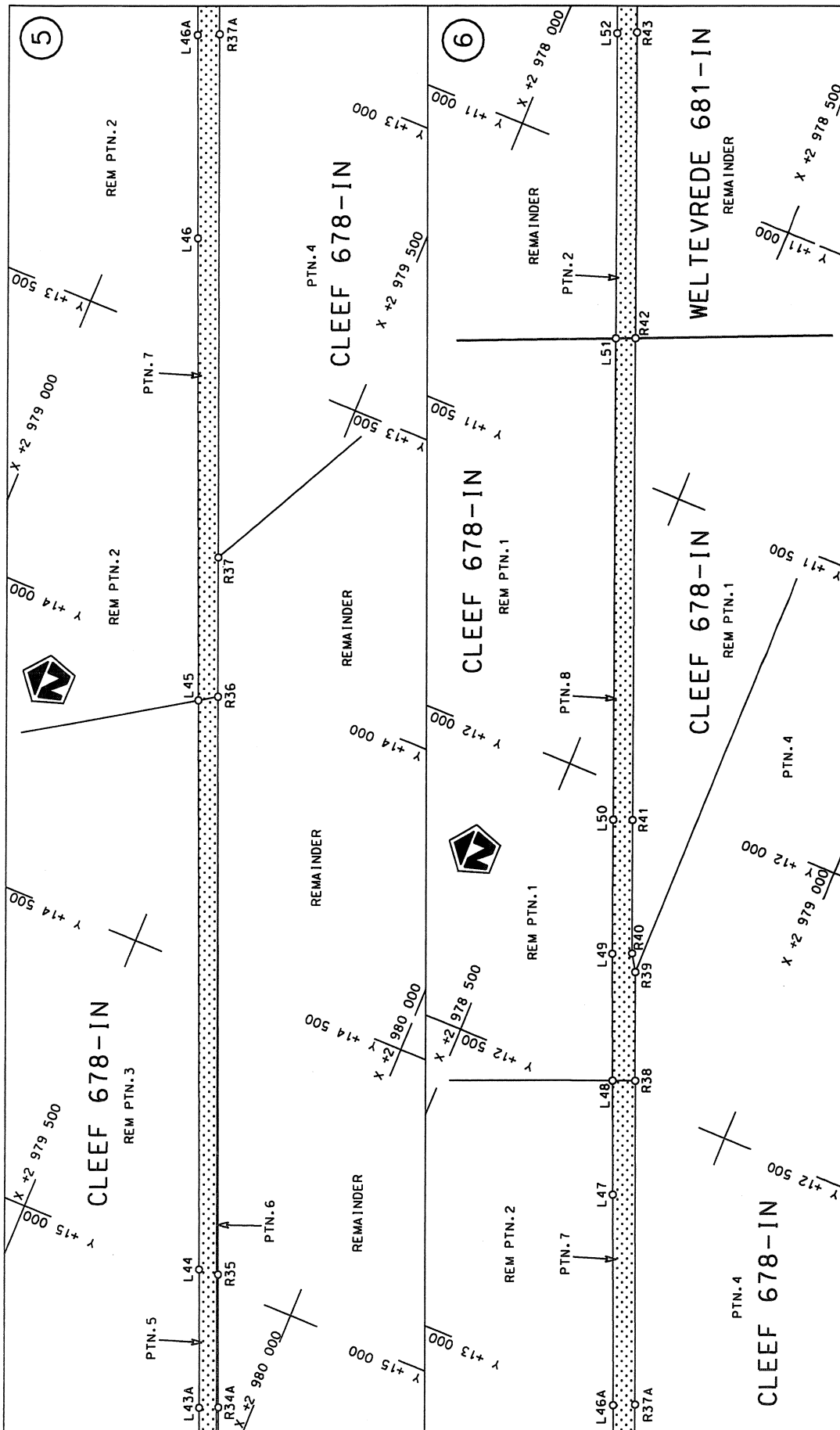

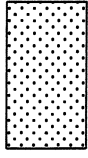
<p>Die Suid Afrikaanse Nasionale Padagentskap Beperk The South African National Roads Agency Limited</p>	<p>Die figuur getoon The figure shown</p>  <p>steldie padreserwe voor van 'n gedeelte represents the road reserve of a portion van Nasionale Roete N14 of National Route</p>	<p>Vel Sheet 3 of 23 Plan P810/12</p>
--------------------------------------------------------------------------------------------------------------	-----------------------------------------------------------------------------------------------------------------------------------------------------------------------------------------------------------------------------------------------------------------------------------	-------------------------------------------

D.O.9.A

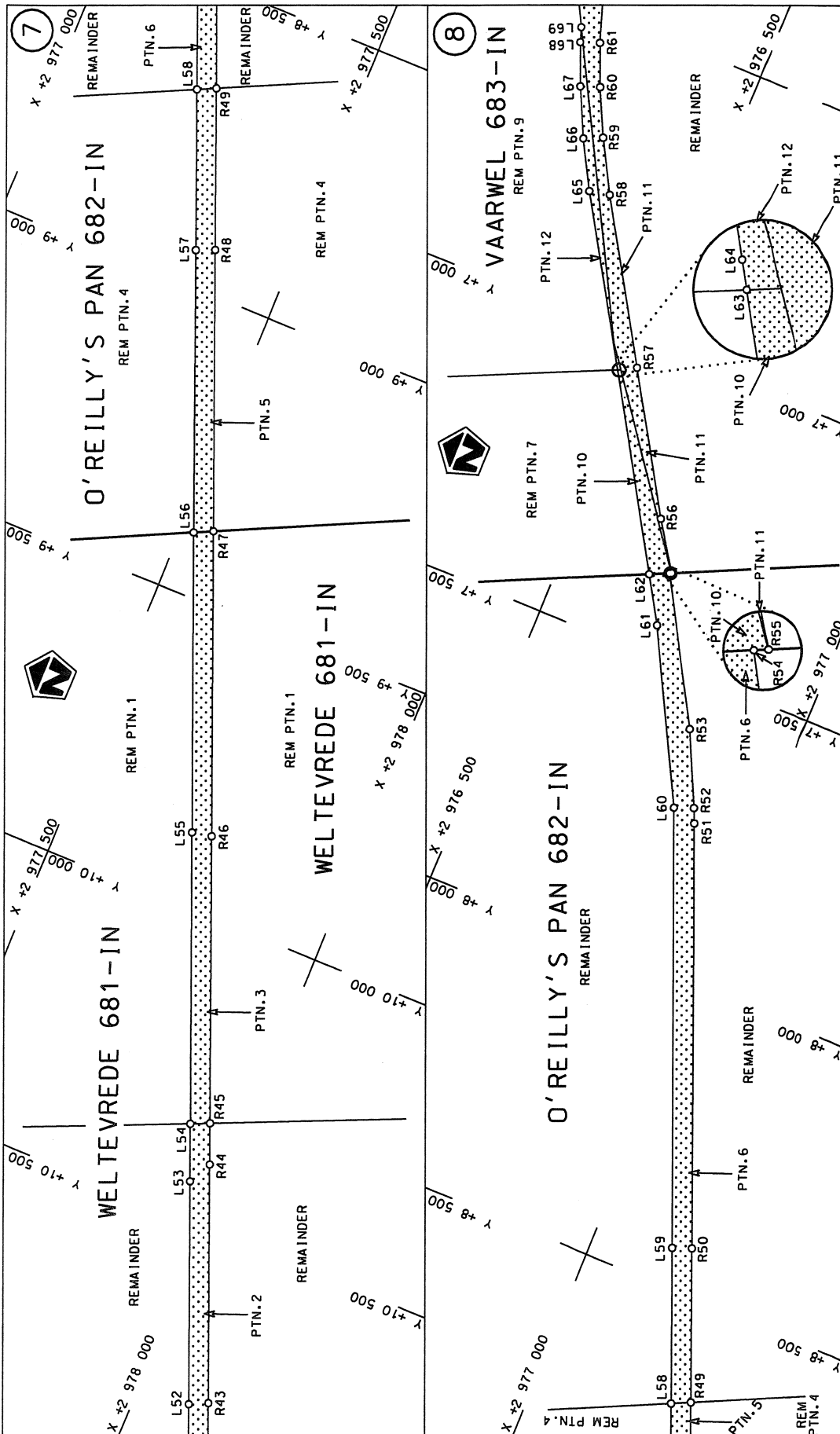

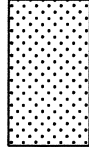
Die Suid Afrikaanse Nasionale Padagentskap Beperk The South African National Roads Agency Limited	Die figuur getoon The figure shown		steldie podreserwe voor 'n gedeelte represents the road reserve of a portion van Nasionale Roete N14 of National Route Section	Vel Sheet 4 of 23
				Plan P810/12

D.O.9.A



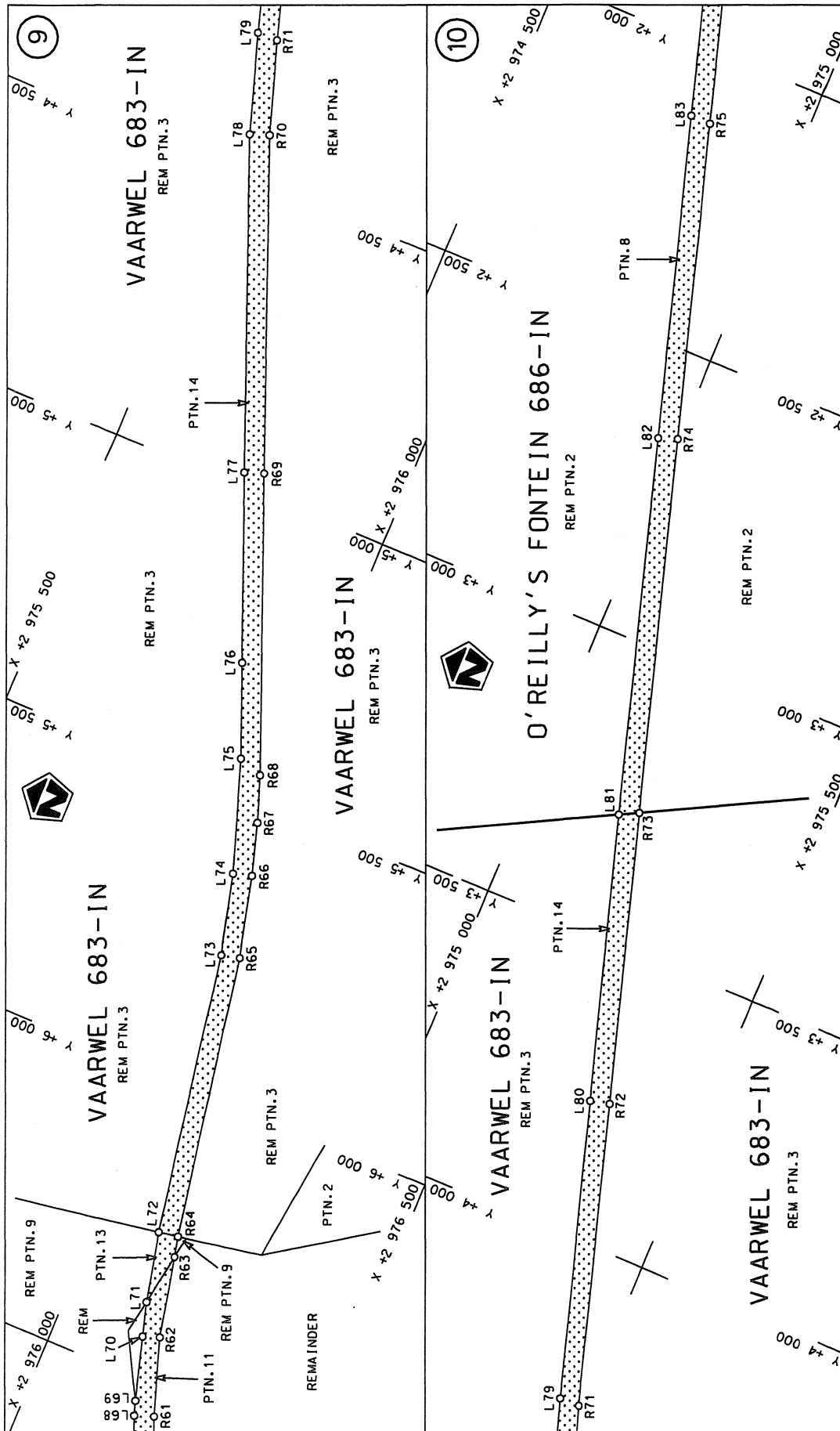

<p>Die Suid Afrikaanse Nasionale Padagentskap Beperk The South African National Roads Agency Limited</p>	<p>Die figuur getoon The figure shown</p>	<p>steldie padreserwe voor van 'n gedeelte represents the road reserve of a portion van Nasionale Roete N14 Sektie of National Route N14 Section</p>
<p>Vel Sheet</p> <p>5 of</p> <p>23</p>	<p>Plan</p> <p>P810/12</p>	<p>9</p>

D.O.9.A

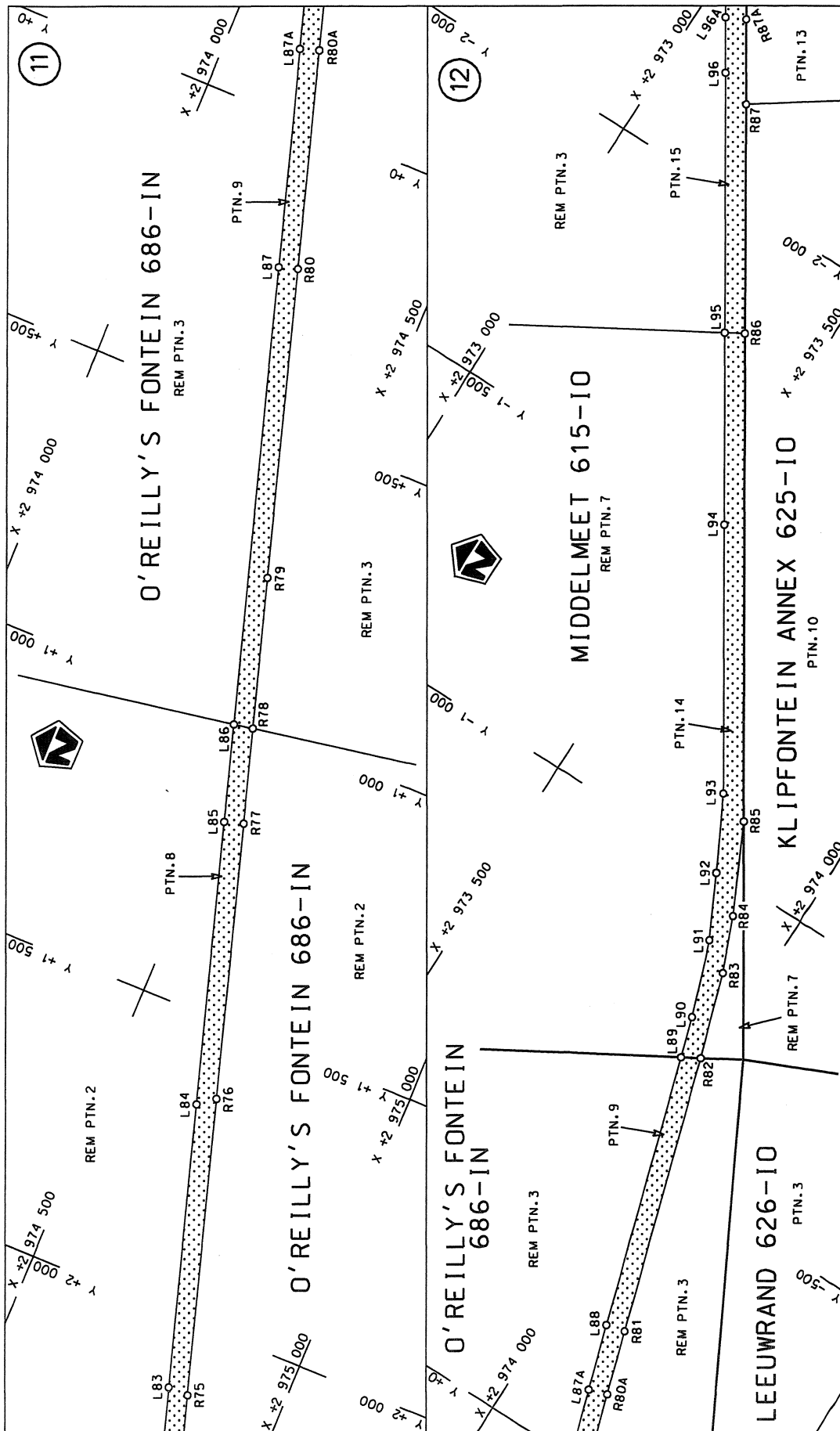

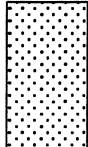
<p>Die Suid Afrikaanse Nasionale Padagentskap Beperk The South African National Roads Agency Limited</p>	<p>Die figuur getoon The figure shown</p> 	<p>stelt die padreserwe voor van 'n gedeelte represents the road reserve of a portion van Nasionale Roete N14 of National Route</p> <p style="text-align: right;">Seksie 9 Section</p>	<p>Vel Sheet 6 van of 23 Plan P810/12</p>
--------------------------------------------------------------------------------------------------------------	-------------------------------------------------------------------------------------------------------------------------------------	--------------------------------------------------------------------------------------------------------------------------------------------------------------------------------------------------------	-----------------------------------------------

D.O.9.A

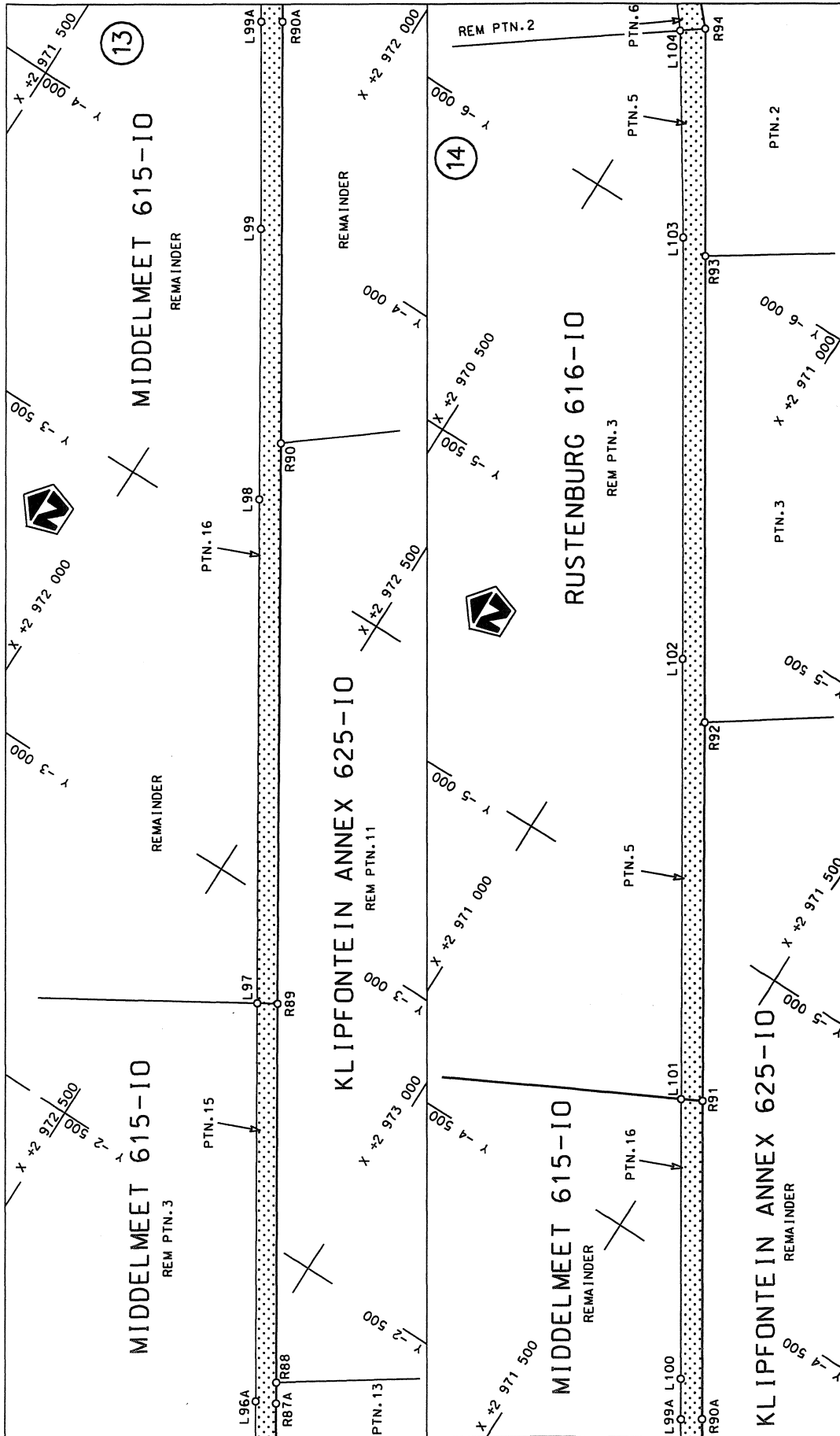

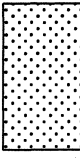
Die Suid Afrikaanse Nasionale Padagentskap Beperk The South African National Roads Agency Limited	Die figuur getoon The figure shown		steldie padreserwe voor van 'n gedeelte represents the road reserve of a portion van Nasionale Roete N14 of National Route Section	Vel Sheet 7 of 23
				Plan P810/12

D.O.9.A

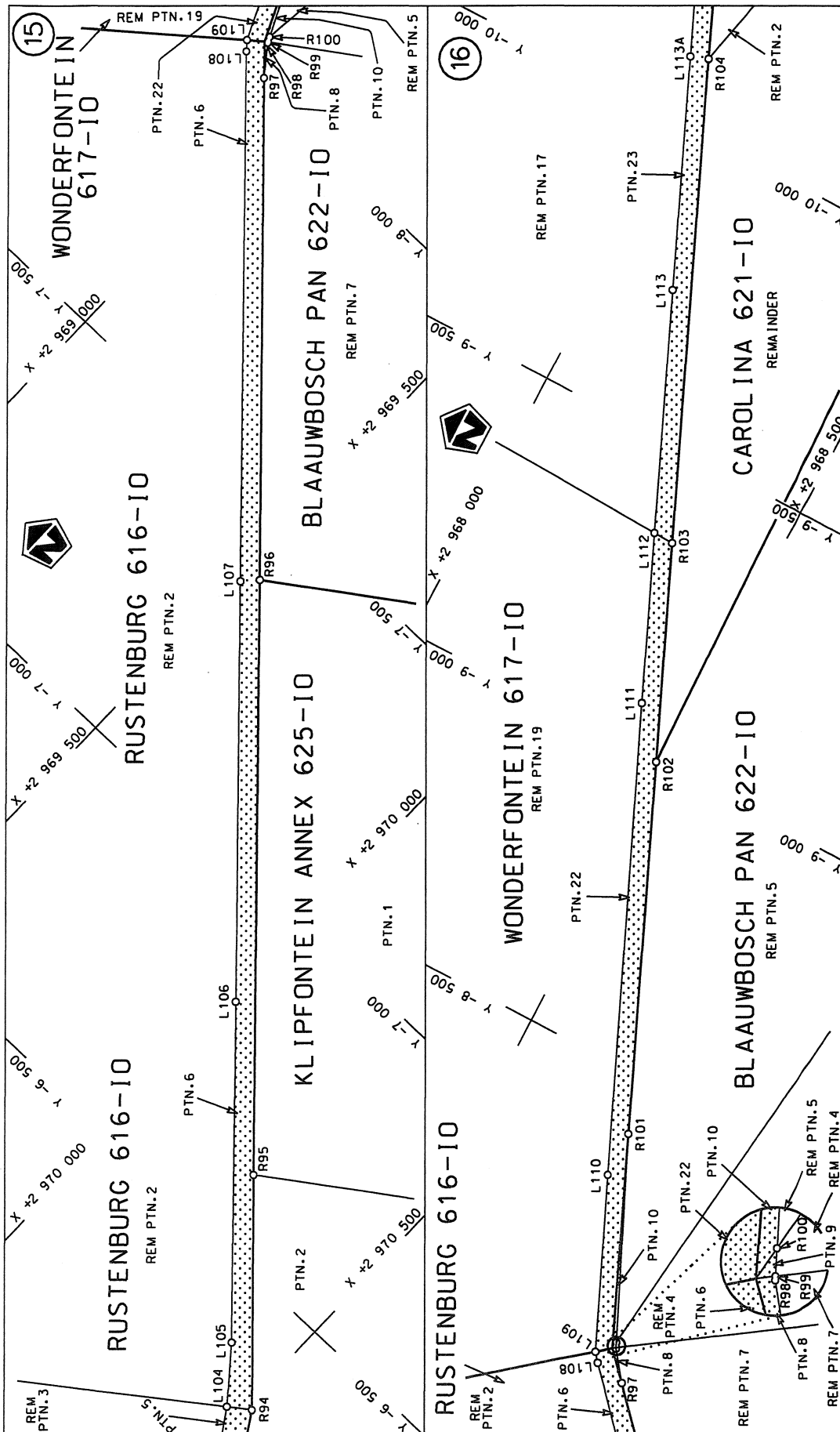

<p>Die Suid Afrikaanse Nasionale Padagentskap Beperk The South African National Roads Agency Limited</p>	<p>Die figuur getoon The figure shown</p>	<p>stel die padreserwe voor van 'n gedeelte represents the road reserve of a portion van Nasionale Roete N14 of National Route Section</p>	<p>Vel Sheet 8 of 23 Plan P810/12</p>
<p>9</p>		<p>D.O.9.A</p>	

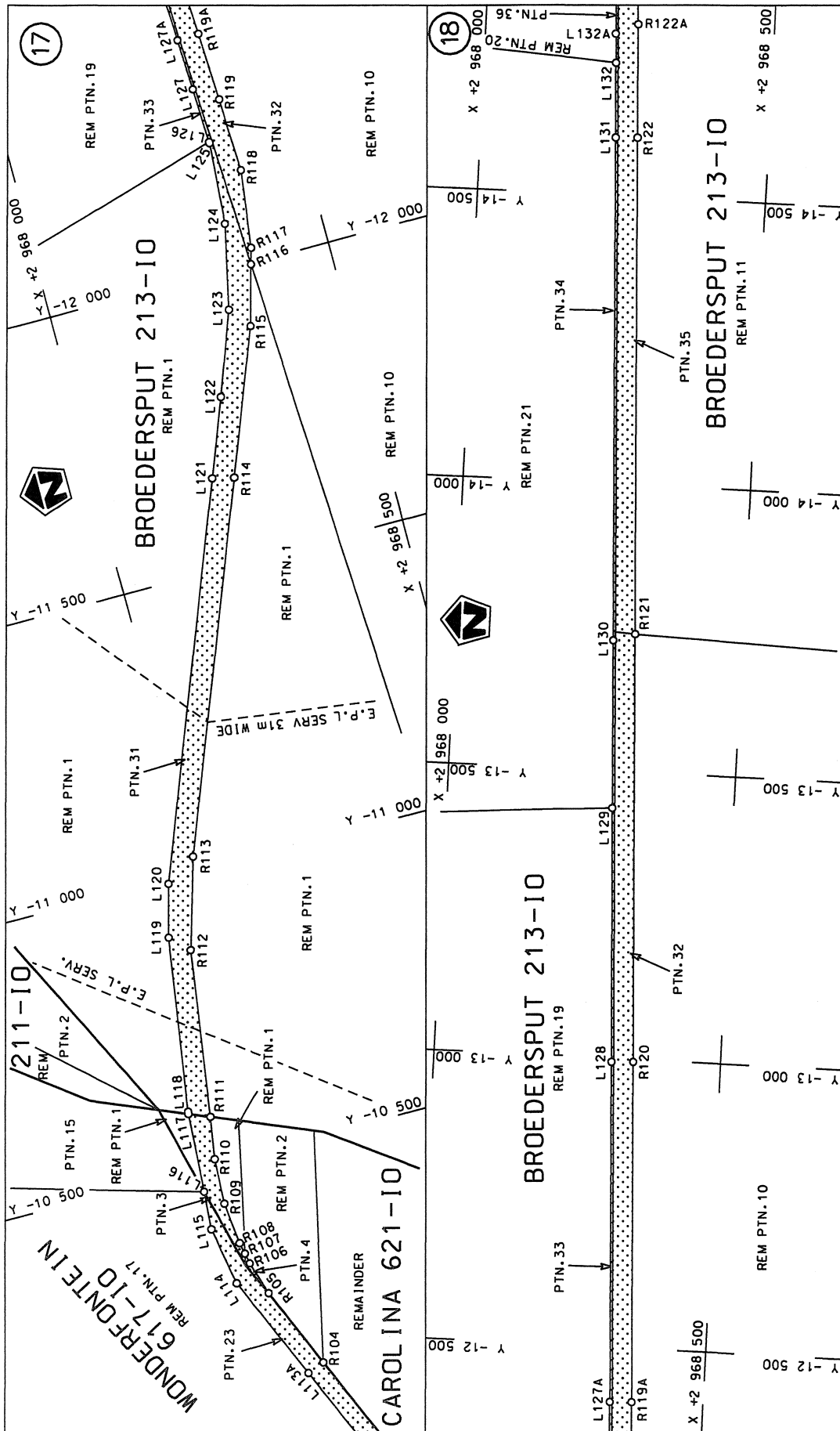

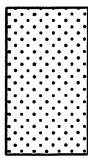
Die Suid Afrikaanse Nasionale Padagentskap Beperk The South African National Roads Agency Limited	Die figuur getoon The figure shown		stel die podreserwe voor van 'n gedeelte represents the road reserve of a portion	
			van Nasionale Roete N14 of National Route	Seksie 9 Section
		Vel Sheet 9 of	van 23	
		Plan P810/12		

D.O.9.A

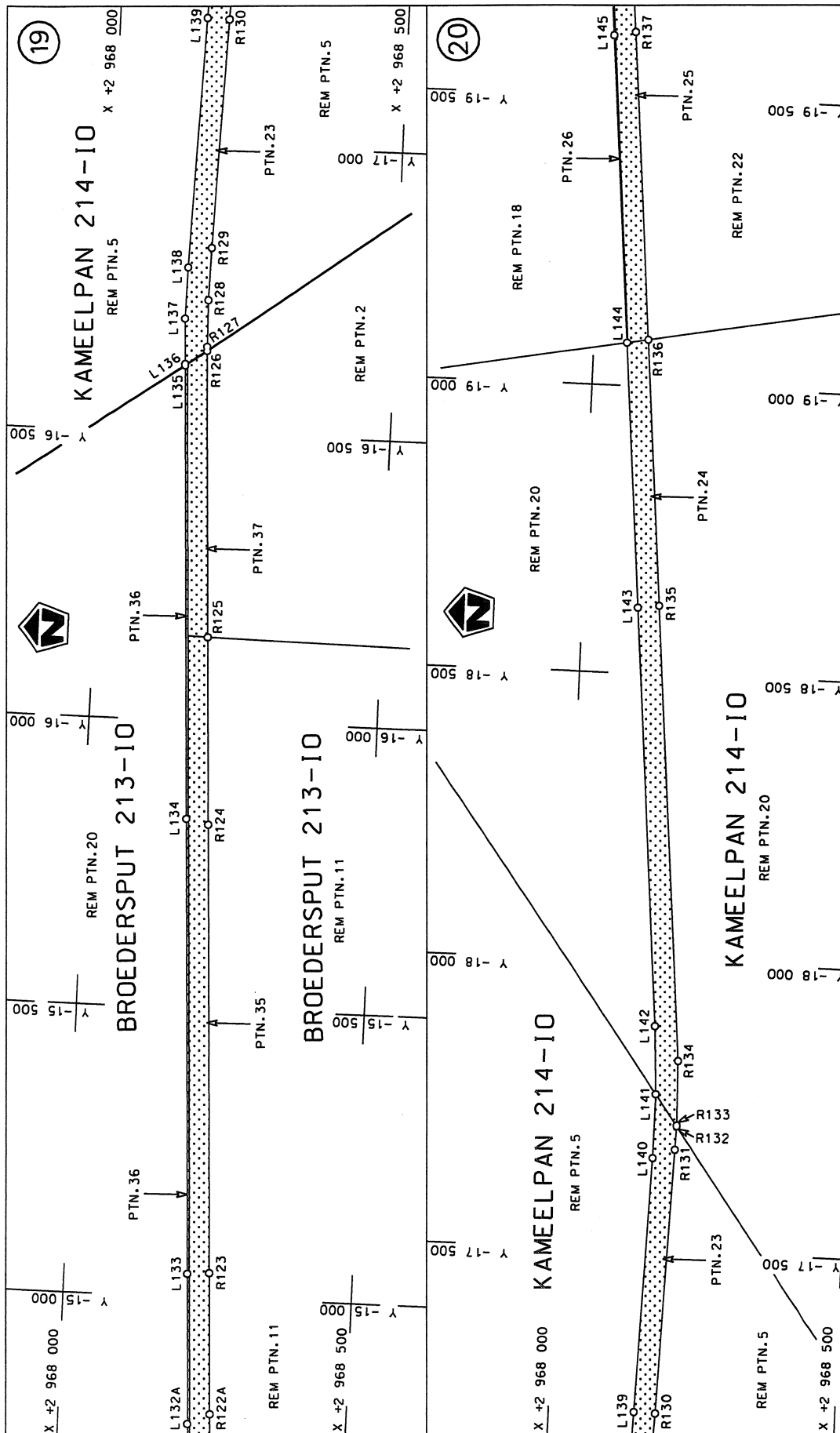

<p>Die Suid Afrikaanse Nasionale Podagentskap Beperk The South African National Roads Agency Limited</p>	<p>Die figuur getoon The figure shown</p>	<p>stel die podreserwe voor van 'n gedeelte represents the road reserve of a portion van Nasionale Roete N14 of National Route Seksie 9 Section</p>	<p>Vel Sheet 10 of 23 Plan P810/12</p>
--------------------------------------------------------------------------------------------------------------	-----------------------------------------------	-------------------------------------------------------------------------------------------------------------------------------------------------------------------------	--------------------------------------------

D.O.9.A

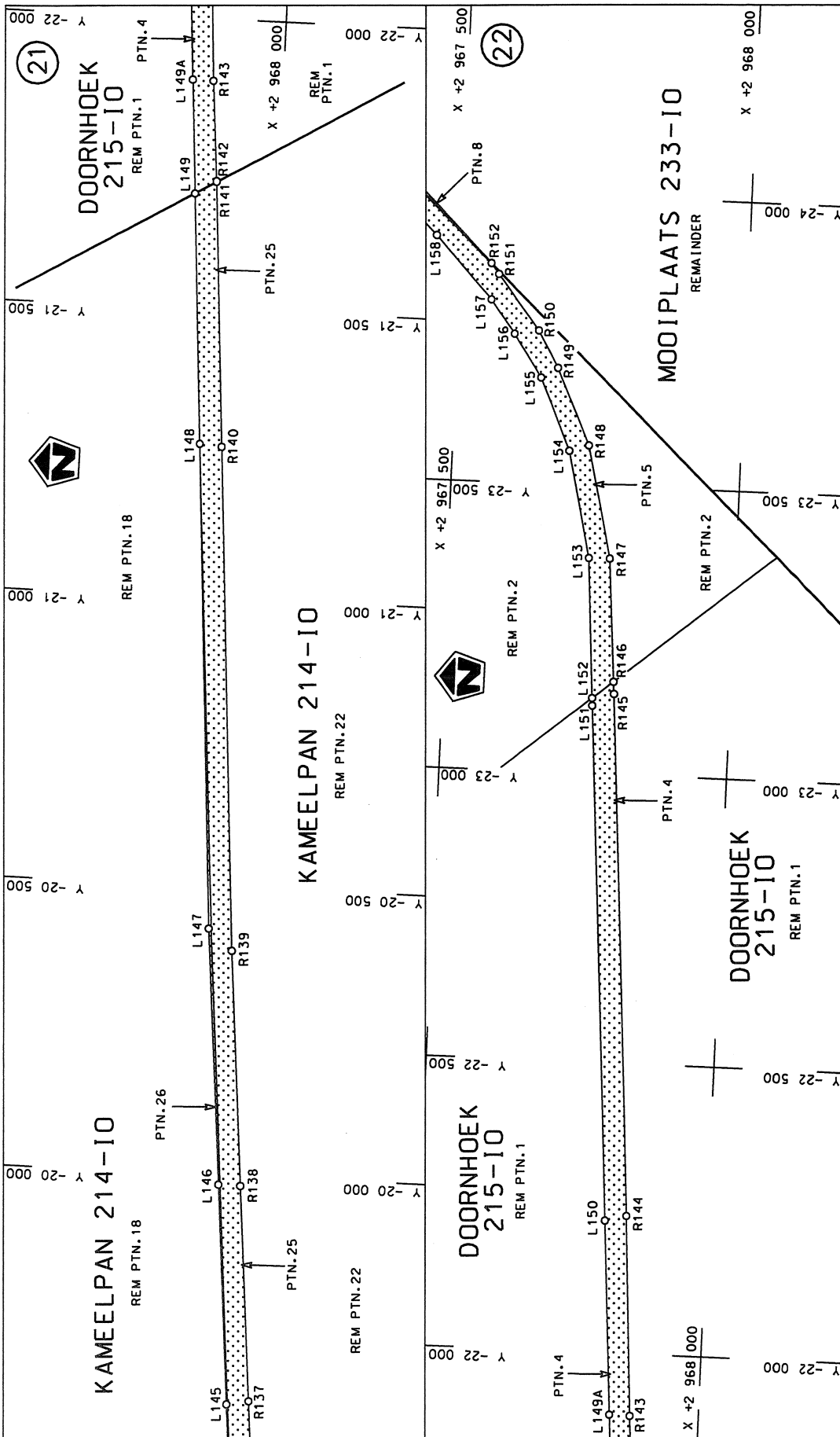

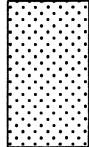
<p>Die Suid Afrikaanse Nasionale Padagentskap Beperk The South African National Roads Agency Limited</p>	<p>Die figuur getoon The figure shown</p>		<p>steldie padreserwe voor van 'n gedeelte represents the road reserve of a portion van Nasionale Roete N14 Seksie of National Route Section</p>	<p>Vel Sheet 11 van 23 Plan P810/12</p>
--------------------------------------------------------------------------------------------------------------	-----------------------------------------------	---------------------------------------------------------------------------------------	--------------------------------------------------------------------------------------------------------------------------------------------------------------	---------------------------------------------

D.O.9.A

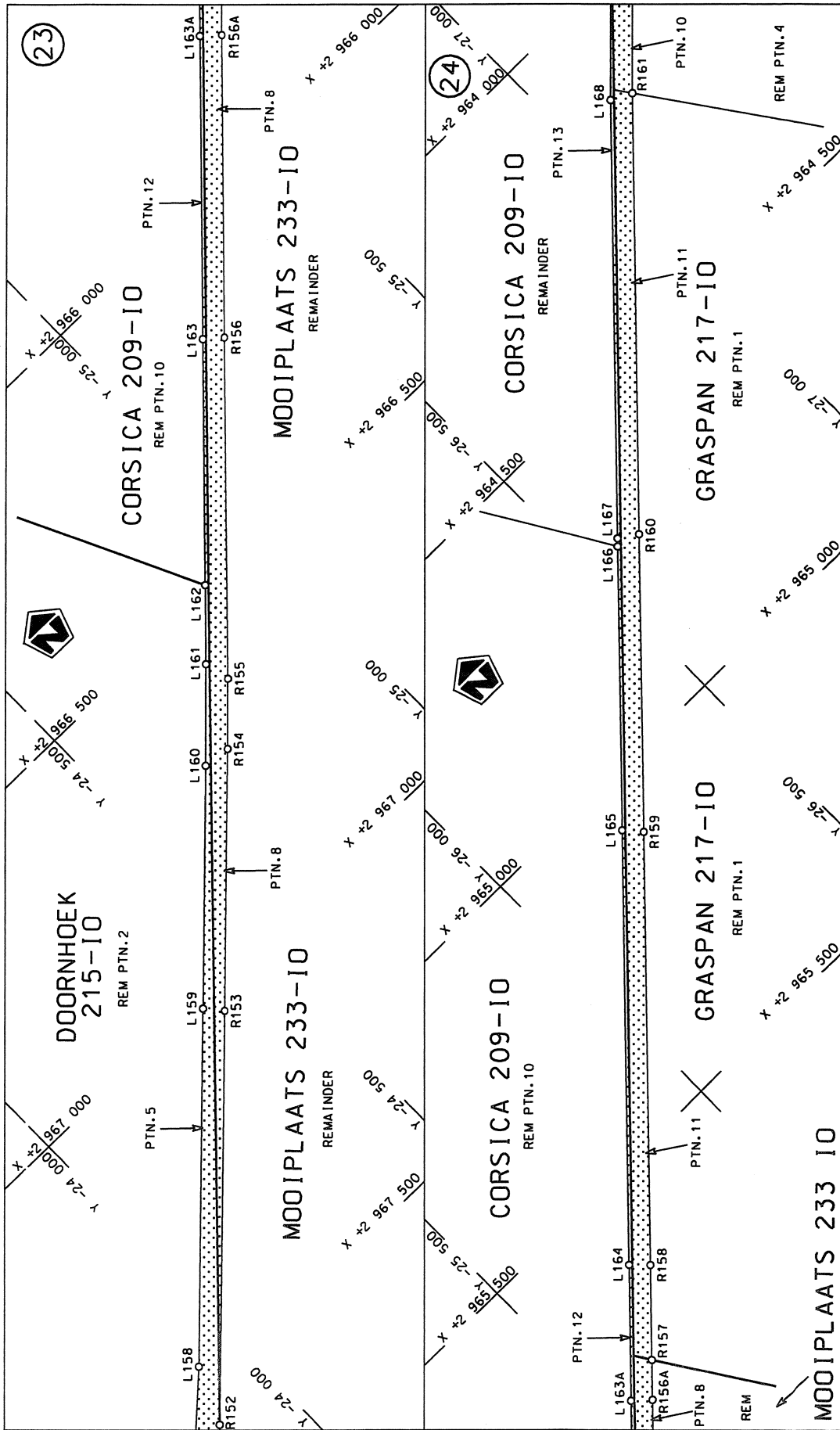

<p>Die Suid Afrikaanse Nasionale Padagentskap Beperk The South African National Roads Agency Limited</p>	<p>Die figuur getoon The figure shown</p> 	<p>stel die padreserwe voor van 'n gedeelte represents the road reserve of a portion van Nasionale Roete N14 of National Route N14 Seksie Section 9</p>	<p>Vel van Sheet 12 of 23 Plan P810/12</p>
--------------------------------------------------------------------------------------------------------------	-------------------------------------------------------------------------------------------------------------------------------------	-----------------------------------------------------------------------------------------------------------------------------------------------------------------------------	----------------------------------------------------

D.O.9.A



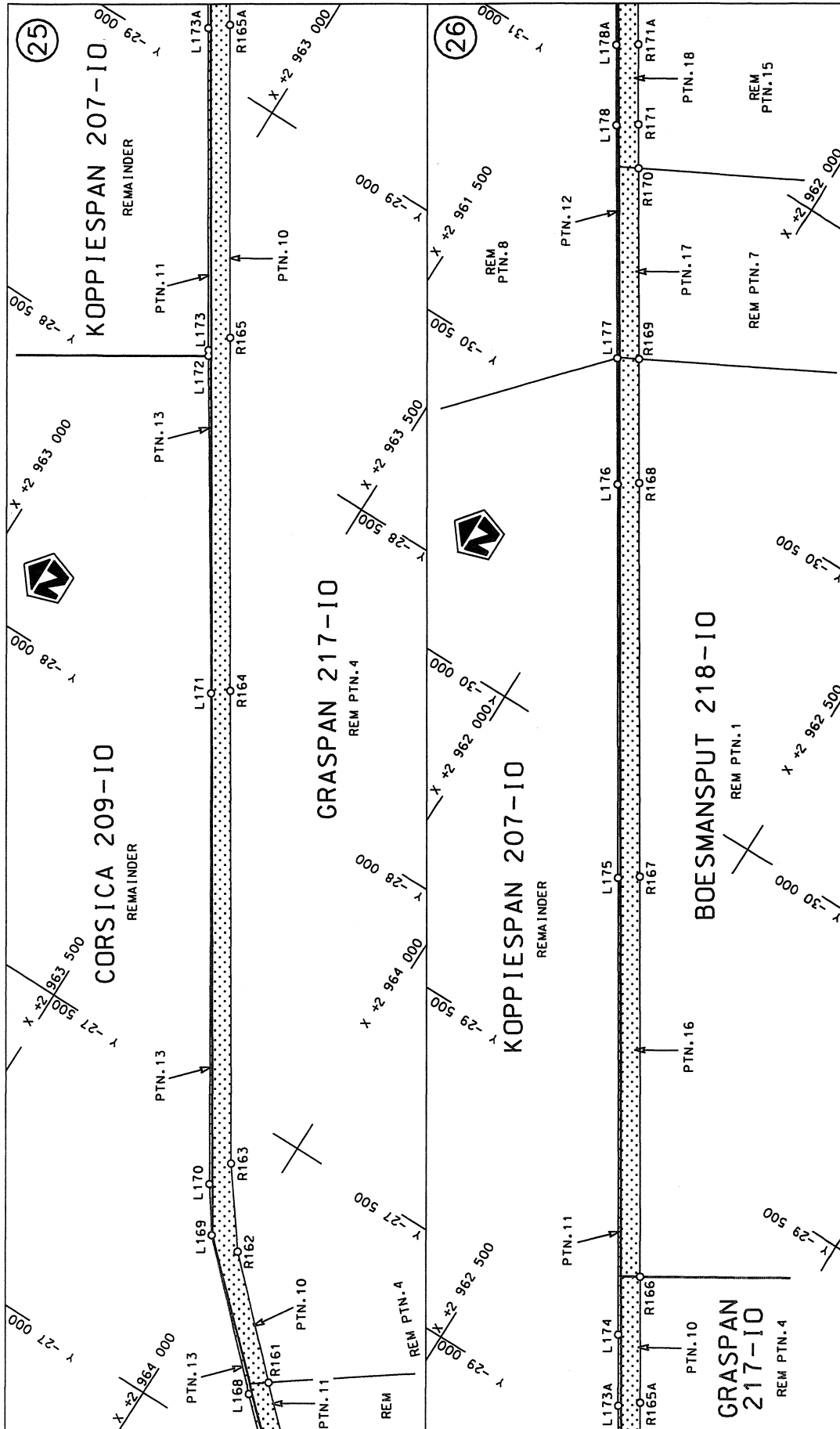

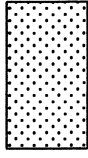
Die Suid Afrikaanse Nasionale Padagentskap Beperk The South African National Roads Agency Limited	Die figuur getoon The figure shown		steldie padreserve voor van 'n gedeelte represents the road reserve of a portion van Nasionale Roete of National Route	Vel Sheet	van 13 of	23
					Plan	P810/12

D.O.9.A

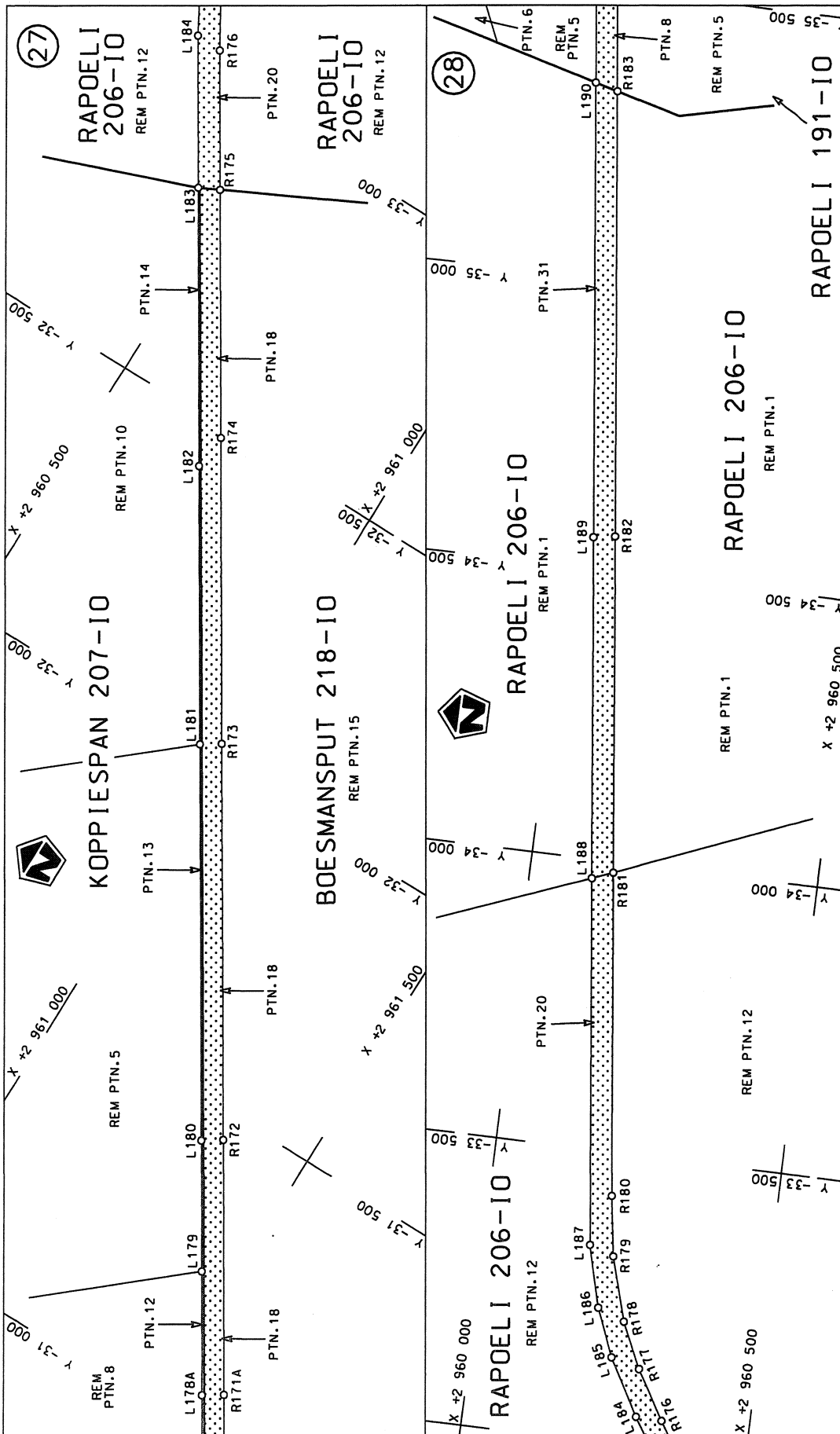

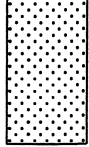
<p>Die Suid Afrikaanse Nasionale Padagentskap Beperk The South African National Roads Agency Limited</p>	<p>Die figuur getoon The figure shown</p> 	<p>steldie padreserwe voor van 'n gedeelte represents the road reserve of a portion van Nasionale Roete N14 Seksie 9 of National Route Section</p>	<p>Vel Sheet 14 of 23 Plan P810/12</p>
--------------------------------------------------------------------------------------------------------------	-------------------------------------------------------------------------------------------------------------------------------------	----------------------------------------------------------------------------------------------------------------------------------------------------------------	------------------------------------------------

D.O.9.A

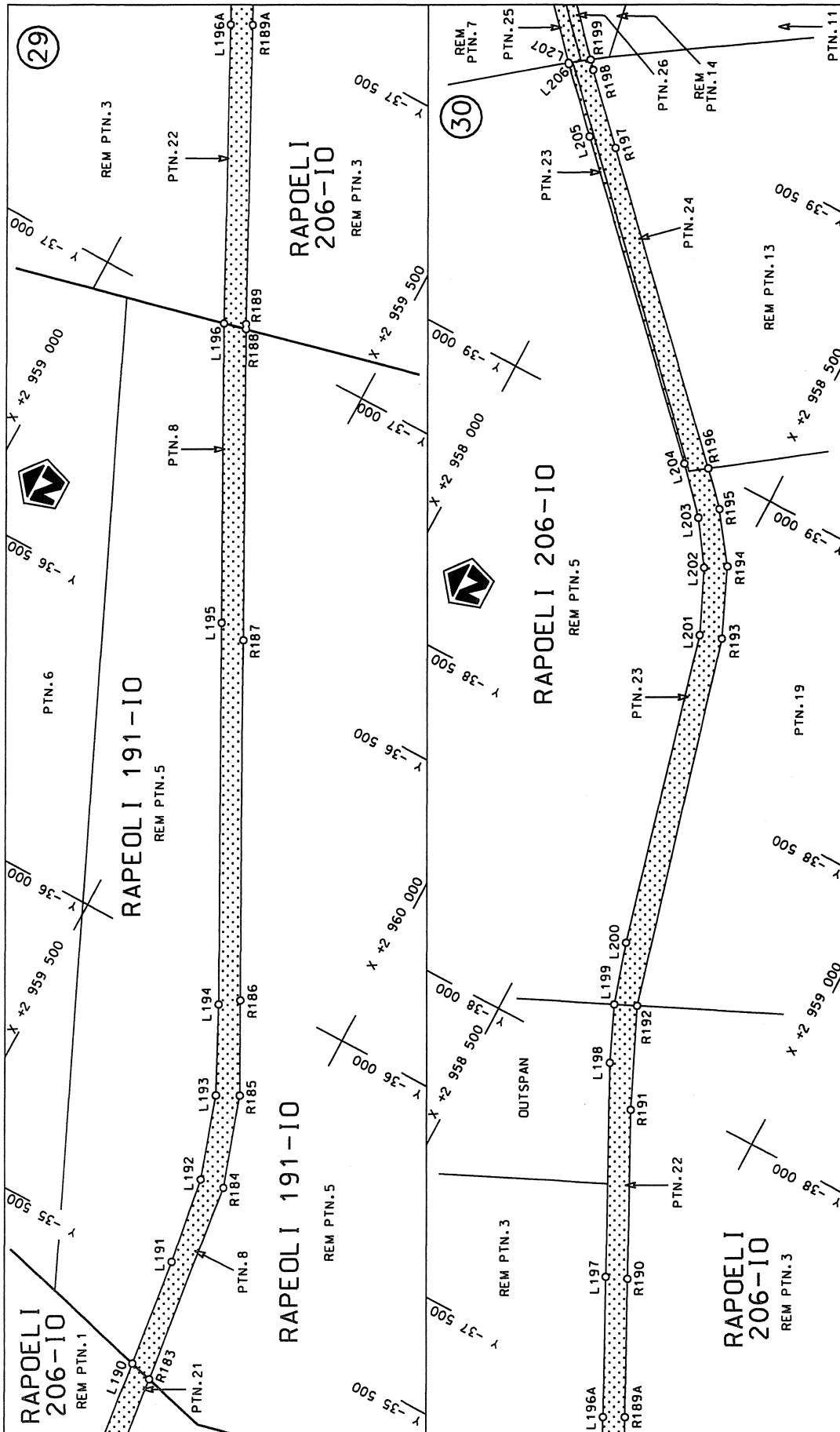

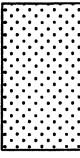
Die Suid Afrikaanse Nasionale Padogenskap Beperk The South African National Roads Agency Limited	Die figuur getoon The figure shown		stelde padreserwe voor van 'n gedeelte represents the road reserve of a portion van Nasionale Roete N14 of National Route Section	
			Vel Sheet 15 of 23	Plan P810/12

D.O.9.A

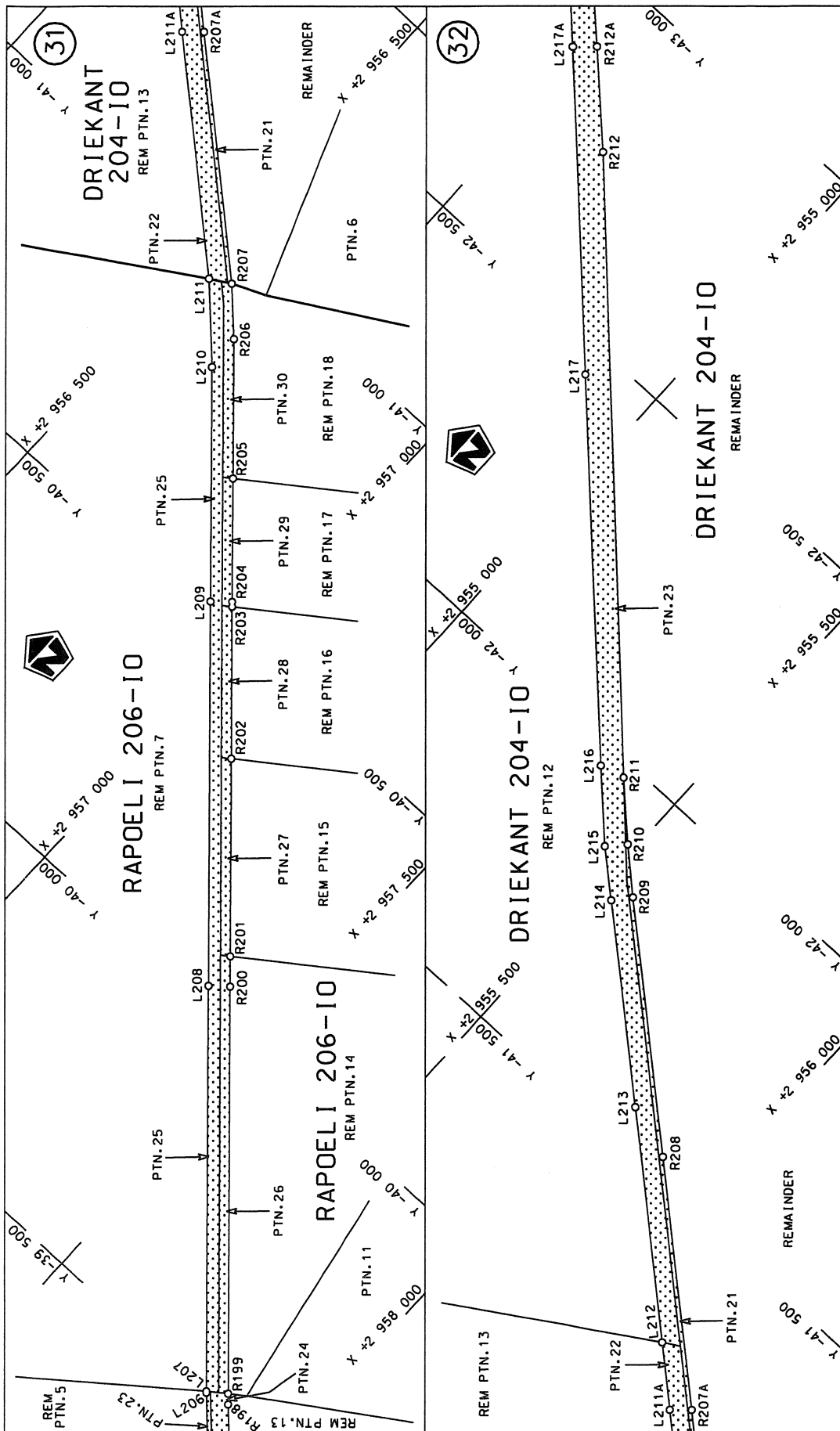

<p>Die Suid Afrikaanse Nasionale Padagentskap Beperk The South African National Roads Agency Limited</p>	<p>Die figuur getoon The figure shown</p>	<p>stel die padreserwe voor van 'n gedeelte represents the road reserve of a portion van Nasionale Roete N14 Sektie 9 of National Route</p>	<p>Vel Sheet 16 of 23 Plan P810/12</p>
--------------------------------------------------------------------------------------------------------------	-----------------------------------------------	---------------------------------------------------------------------------------------------------------------------------------------------------------	--------------------------------------------

D.O.9.A

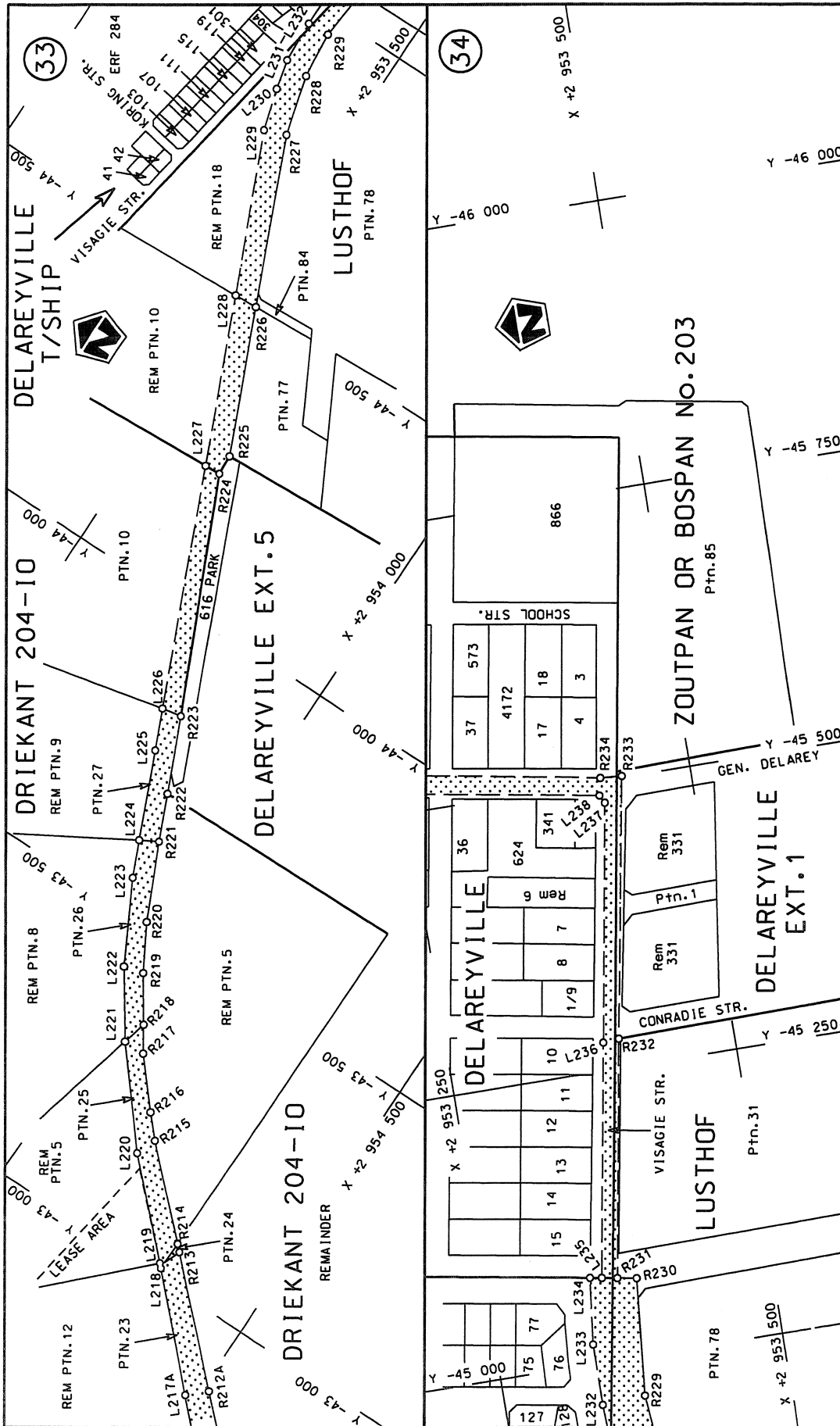

<p>Die Suid Afrikaanse Nasionale Padagentskap Beperk The South African National Roads Agency Limited</p>	<p>Die figuur getoon The figure shown</p>	<p>stel die padreserwe voor van 'n gedeelte represents the road reserve of a portion van Nasionale Roete N14 of National Route</p>	<p>Vel Sheet 17 of 23</p> <p>Plan P810/12</p>
<p>9</p>		<p>Section</p>	

D.O.9.A

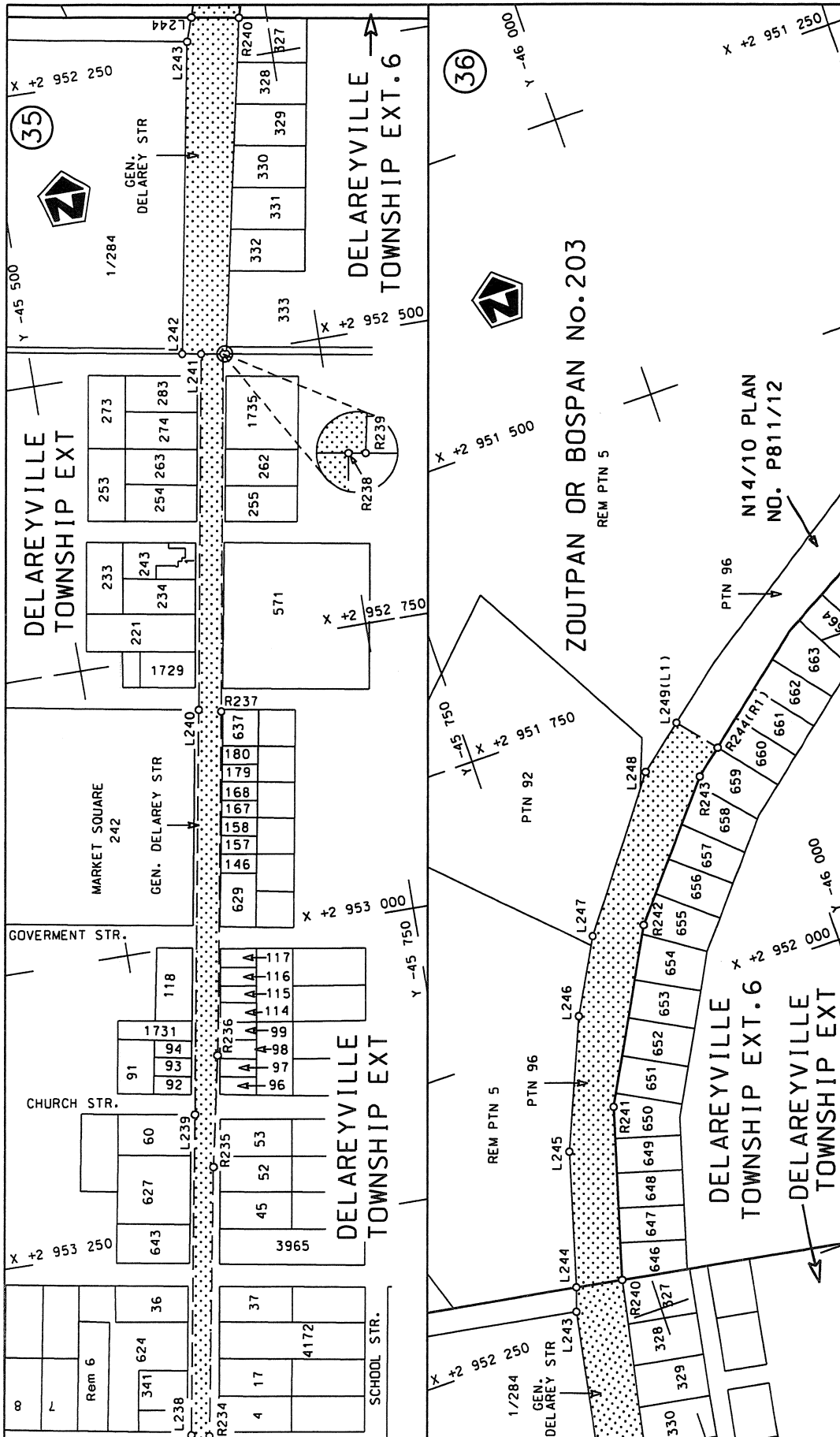

<p>Die Suid Afrikaanse Nasionale Padagentskap Beperk The South African National Roads Agency Limited</p>	<p>Die figuur getoon The figure shown</p>	<p>steldie podreserwe voor van 'n gedeelte represents the road reserve of a portion van Nasionale Roete N14 of National Route</p>	<p>Vel Sheet 18 of 23</p> <p>Plan P810/12</p>
--------------------------------------------------------------------------------------------------------------	-----------------------------------------------	-----------------------------------------------------------------------------------------------------------------------------------------------	---------------------------------------------------

D.O.9.A

PADRESERWE KOÖRDINATE / ROAD RESERVE CO-ORDINATES						
LINKERKANT/LEFT HAND SIDE				REGTERKANT/RIGHT HAND SIDE		
	Y	X	WG 25°		Y	X
L1	22 796.55	2 984 390.04		R1	22 765.77	2 984 404.50
L2	22 715.32	2 984 218.77		R2	22 652.24	2 984 164.62
L3	22 704.04	2 984 194.68		R3	22 424.49	2 983 676.67
L4	22 638.08	2 984 051.56		R4	22 339.40	2 983 496.25
L5	22 573.58	2 983 914.14		R5	22 218.02	2 983 235.91
L6	22 552.15	2 983 868.27		R6	22 206.38	2 983 211.12
L7	22 485.21	2 983 725.18		R7	22 116.53	2 983 019.17
L8	22 473.84	2 983 700.78		R8	21 947.89	2 982 659.21
L9	22 317.99	2 983 367.56		R9	21 940.88	2 982 646.70
L10	22 254.93	2 983 232.96		R10	21 872.12	2 982 536.61
L11	22 243.63	2 983 208.49		R11	21 804.61	2 982 465.07
L12	22 148.56	2 983 007.42		R12	21 727.26	2 982 406.63
L13	22 044.77	2 982 785.69		R13	21 674.66	2 982 377.26
L14	22 022.31	2 982 737.94		R14	21 591.46	2 982 342.46
L15	21 965.20	2 982 616.04		R15	21 533.75	2 982 325.09
L16	21 898.21	2 982 515.74		R16	21 063.19	2 982 183.50
L17	21 828.06	2 982 440.28		R17	20 863.22	2 982 123.21
L18	21 768.92	2 982 395.85		R18	20 663.14	2 982 062.89
L19	21 745.49	2 982 377.74		R19	20 477.21	2 982 006.84
L20	21 667.38	2 982 336.84		R20	20 381.65	2 981 978.03
L21	21 555.14	2 982 298.78		R21	20 344.72	2 981 966.89
L22	21 518.30	2 982 286.29		R22	20 063.93	2 981 882.24
L23	21 085.72	2 982 156.44		R23	19 922.52	2 981 840.58
L24	21 077.59	2 982 154.00		R24	19 774.09	2 981 794.86
L25	20 882.80	2 982 095.94		R25	19 595.17	2 981 741.96
L26	20 680.69	2 982 035.71		R26	19 484.54	2 981 707.57
L27	20 646.79	2 982 025.61		R27	19 268.89	2 981 642.55
L28	20 399.50	2 981 951.07		R28	18 487.55	2 981 315.91
L29	20 362.50	2 981 939.92		R29	17 680.02	2 980 979.78
L30	20 082.08	2 981 855.40		R30	17 415.04	2 980 869.39
L31	19 948.06	2 981 815.00		R31	17 166.88	2 980 766.01
L32	19 792.76	2 981 767.87		R32	16 546.31	2 980 507.68
L33	19 503.89	2 981 680.19		R33	15 804.38	2 980 198.47
L34	19 370.26	2 981 639.64		R34	15 495.17	2 980 069.71
L35	19 287.49	2 981 610.87		R35	14 981.84	2 979 855.95
L36	18 506.50	2 981 288.26		R36	14 052.57	2 979 470.16
L37	17 845.09	2 981 011.51		R37	13 827.38	2 979 377.26
L38	17 421.56	2 980 836.02		R38	12 467.04	2 978 816.08
L39	17 201.08	2 980 744.66		R39	12 292.41	2 978 744.04
L40	16 607.87	2 980 497.76		R40	12 264.31	2 978 726.49
L41	16 601.47	2 980 495.10		R41	12 049.00	2 978 638.46
L42	15 897.64	2 980 201.90		R42	11 270.29	2 978 322.66
L43	15 513.34	2 980 041.81		R43	10 778.06	2 978 122.61
L44	14 986.08	2 979 822.18		R44	10 395.96	2 977 967.31
L45	14 071.25	2 979 441.17		R45	10 330.21	2 977 940.60
L46	13 327.77	2 979 131.35		R46	9 868.76	2 977 753.16
L47	12 664.87	2 978 855.48		R47	9 377.60	2 977 553.67
L48	12 481.93	2 978 779.49		R48	8 926.16	2 977 370.30
L49	12 277.92	2 978 694.75		R49	8 667.00	2 977 265.26
L50	12 061.39	2 978 607.01		R50	8 420.69	2 977 165.44
L51	11 283.67	2 978 291.15		R51	7 738.92	2 976 887.89

Vel	19	Van	23	P810/12
Sheet		of		

PADRESERWE KOÖRDINATE / ROAD RESERVE CO-ORDINATES						
LINKERKANT/LEFT HAND SIDE				REGTERKANT/RIGHT HAND SIDE		
	Y	X	WG 25°		X	
L52	10 792.67	2 978 091.75	R52	7 714.35	2 976 877.04	
L53	10 435.77	2 977 946.71	R53	7 590.31	2 976 818.09	
L54	10 343.78	2 977 909.34	R54	7 353.65	2 976 682.57	
L55	9 875.42	2 977 719.06	R55	7 352.23	2 976 685.62	
L56	9 392.50	2 977 522.53	R56	7 271.49	2 976 632.39	
L57	8 939.07	2 977 338.89	R57	7 044.86	2 976 494.33	
L58	8 681.68	2 977 234.40	R58	6 786.51	2 976 337.07	
L59	8 433.11	2 977 133.48	R59	6 699.41	2 976 288.48	
L60	7 726.94	2 976 844.71	R60	6 621.02	2 976 250.81	
L61	7 445.37	2 976 697.24	R61	6 550.66	2 976 221.47	
L62	7 368.48	2 976 650.75	R62	6 419.97	2 976 177.65	
L63	7 061.11	2 976 464.90	R63	6 281.67	2 976 147.25	
L64	7 055.04	2 976 461.23	R64	6 246.72	2 976 139.57	
L65	6 793.79	2 976 302.28	R65	5 760.04	2 976 049.58	
L66	6 713.50	2 976 257.57	R66	5 620.12	2 976 013.49	
L67	6 632.71	2 976 218.77	R67	5 531.24	2 975 986.17	
L68	6 562.20	2 976 189.53	R68	5 453.41	2 975 958.79	
L69	6 537.60	2 976 181.33	R69	4 965.05	2 975 761.56	
L70	6 429.70	2 976 145.37	R70	4 420.14	2 975 542.48	
L71	6 372.35	2 976 132.47	R71	4 263.86	2 975 490.55	
L72	6 252.70	2 976 105.56	R72	3 761.03	2 975 337.91	
L73	5 767.54	2 976 018.83	R73	3 273.46	2 975 189.91	
L74	5 628.90	2 975 981.88	R74	2 646.34	2 974 999.26	
L75	5 438.74	2 975 917.29	R75	2 120.46	2 974 839.54	
L76	5 284.15	2 975 854.53	R76	1 626.20	2 974 689.34	
L77	4 976.22	2 975 729.44	R77	1 165.46	2 974 549.63	
L78	4 431.84	2 975 509.99	R78	1 005.96	2 974 501.27	
L79	4 264.68	2 975 455.14	R79	753.21	2 974 424.62	
L80	3 769.53	2 975 304.58	R80	236.68	2 974 267.78	
L81	3 290.32	2 975 157.71	R81	- 236.38	2 974 124.11	
L82	2 658.14	2 974 967.01	R82	- 706.73	2 973 981.27	
L83	2 120.19	2 974 804.01	R83	- 852.06	2 973 934.31	
L84	1 648.12	2 974 660.85	R84	- 945.18	2 973 896.43	
L85	1 175.51	2 974 517.29	R85	-1 094.03	2 973 823.36	
L86	1 011.64	2 974 467.69	R86	-1 812.56	2 973 368.76	
L87	246.61	2 974 236.08	R87	-2 149.39	2 973 156.77	
L88	- 228.47	2 974 091.47	R88	-2 303.69	2 973 059.21	
L89	- 689.46	2 973 951.48	R89	-2 856.17	2 972 708.49	
L90	- 758.65	2 973 930.48	R90	-3 679.32	2 972 189.43	
L91	- 888.18	2 973 883.91	R91	-4 757.98	2 971 505.26	
L92	- 993.31	2 973 831.16	R92	-5 313.38	2 971 156.33	
L93	-1 116.35	2 973 767.67	R93	-5 995.75	2 970 723.63	
L94	-1 513.05	2 973 516.94	R94	-6 326.87	2 970 513.61	
L95	-1 795.04	2 973 338.58	R95	-6 624.31	2 970 235.33	
L96	-2 176.27	2 973 097.45	R96	-7 382.79	2 969 530.51	
L97	-2 837.81	2 972 678.02	R97	-8 019.88	2 968 935.96	
L98	-3 576.82	2 972 209.65	R98	-8 068.27	2 968 898.99	
L99	-3 972.66	2 971 959.89	R99	-8 069.50	2 968 898.43	
L100	-4 332.68	2 971 730.61	R100	-8 077.99	2 968 894.52	
L101	-4 740.81	2 971 471.85	R101	-8 406.22	2 968 743.32	
L102	-5 386.02	2 971 064.82	R102	-9 000.08	2 968 482.40	

Vel 20 Van 23  
Sheet of

P810/12



PADRESERWE KOÖRDINATE / ROAD RESERVE CO-ORDINATES						
LINKERKANT/LEFT HAND SIDE				REGTERKANT/RIGHT HAND SIDE		
	Y	X	WG 25°			X
L103	-6 002.38	2 970	674.35	R103	- 9	349.34 2 968 328.23
L104	-6 300.73	2 970	478.26	R104	-10	120.12 2 967 988.99
L105	-6 387.17	2 970	407.53	R105	-10	260.50 2 967 928.49
L106	-6 820.89	2 970	006.19	R106	-10	318.74 2 967 910.43
L107	-7 357.56	2 969	507.69	R107	-10	337.24 2 967 906.41
L108	-8 031.15	2 968	881.88	R108	-10	357.19 2 967 902.08
L109	-8 046.29	2 968	869.29	R109	-10	429.93 2 967 894.69
L110	-8 326.68	2 968	744.66	R110	-10	508.71 2 967 898.43
L111	-9 078.97	2 968	412.23	R111	-10	581.49 2 967 910.69
L112	-9 350.53	2 968	292.71	R112	-10	870.77 2 967 952.61
L113	-9 738.70	2 968	121.87	R113	-11	026.98 2 967 998.49
L114	-10 291.02	2 967	879.43	R114	-11	647.01 2 968 236.77
L115	-10 392.92	2 967	861.79	R115	-11	894.62 2 968 331.93
L116	-10 458.80	2 967	866.61	R116	-11	998.01 2 968 360.55
L117	-10 596.13	2 967	875.53	R117	-12	025.53 2 968 368.17
L118	-10 600.25	2 967	875.88	R118	-12	160.05 2 968 384.85
L119	-10 901.86	2 967	920.82	R119	-12	288.05 2 968 380.90
L120	-10 992.43	2 967	944.86	R120	-12	995.80 2 968 347.25
L121	-11 655.42	2 968	200.06	R121	-13	740.05 2 968 312.36
L122	-11 789.04	2 968	251.22	R122	-14	601.95 2 968 271.77
L123	-11 931.58	2 968	303.30	R123	-15	042.97 2 968 250.99
L124	-12 077.42	2 968	335.19	R124	-15	819.88 2 968 214.23
L125	-12 218.90	2 968	345.27	R125	-16	146.33 2 968 198.89
L126	-12 221.30	2 968	345.18	R126	-16	643.33 2 968 175.53
L127	-12 316.87	2 968	341.63	R127	-16	650.76 2 968 175.19
L128	-12 994.07	2 968	309.74	R128	-16	732.01 2 968 173.59
L129	-13 435.60	2 968	288.83	R129	-16	822.85 2 968 175.43
L130	-13 727.30	2 968	275.02	R130	-17	218.97 2 968 188.00
L131	-14 600.31	2 968	234.15	R131	-17	675.98 2 968 202.56
L132	-14 729.73	2 968	228.05	R132	-17	716.82 2 968 203.96
L133	-15 040.32	2 968	213.42	R133	-17	718.21 2 968 204.01
L134	-15 828.59	2 968	176.22	R134	-17	829.79 2 968 201.46
L135	-16 616.84	2 968	138.73	R135	-18	619.76 2 968 134.15
L136	-16 619.27	2 968	138.62	R136	-19	080.62 2 968 095.17
L137	-16 698.32	2 968	134.92	R137	-19	612.57 2 968 050.17
L138	-16 787.59	2 968	136.41	R138	-19	982.93 2 968 018.34
L139	-17 219.89	2 968	150.35	R139	-20	389.25 2 967 984.29
L140	-17 659.87	2 968	164.39	R140	-21	262.50 2 967 925.04
L141	-17 770.83	2 968	164.76	R141	-21	719.08 2 967 894.16
L142	-17 888.30	2 968	158.34	R142	-21	720.68 2 967 894.05
L143	-18 615.06	2 968	096.80	R143	-21	892.99 2 967 880.22
L144	-19 074.02	2 968	057.96	R144	-22	236.88 2 967 859.23
L145	-19 605.43	2 968	012.98	R145	-23	139.70 2 967 798.28
L146	-19 983.24	2 967	980.69	R146	-23	160.85 2 967 796.71
L147	-20 425.94	2 967	942.96	R147	-23	374.06 2 967 780.97
L148	-21 265.95	2 967	887.28	R148	-23	569.29 2 967 736.49
L149	-21 697.84	2 967	857.99	R149	-23	700.86 2 967 677.55
L150	-22 227.33	2 967	822.21	R150	-23	764.37 2 967 641.88
L151	-23 117.90	2 967	761.74	R151	-23	859.56 2 967 568.42
L152	-23 131.01	2 967	760.87	R152	-23	877.84 2 967 554.31
L153	-23 373.63	2 967	744.67	R153	-24	385.07 2 967 044.75

Vel	21	Van	23	P810/12
Sheet		of		

PADRESERWE KOÖRDINATE / ROAD RESERVE CO-ORDINATES							
LINKERKANT/LEFT HAND SIDE				REGTERKANT/RIGHT HAND SIDE			
	Y	X	WG 25°			X	
L154	-23 558.54	2 967	703.15	R154	-24 706.66	2 966	721.08
L155	-23 683.13	2 967	649.18	R155	-24 792.78	2 966	633.52
L156	-23 757.16	2 967	600.02	R156	-25 202.53	2 966	202.04
L157	-23 815.07	2 967	557.01	R157	-25 611.94	2 965	771.44
L158	-23 922.28	2 967	456.70	R158	-25 725.30	2 965	652.21
L159	-24 360.97	2 967	015.62	R159	-26 244.58	2 965	106.38
L160	-24 658.95	2 966	715.35	R160	-26 602.36	2 964	729.86
L161	-24 783.01	2 966	588.39	R161	-27 130.51	2 964	174.69
L162	-24 878.19	2 966	488.43	R162	-27 293.70	2 964	008.25
L163	-25 173.79	2 966	178.00	R163	-27 416.79	2 963	916.71
L164	-25 698.69	2 965	625.91	R164	-28 111.91	2 963	476.06
L165	-26 219.51	2 965	077.94	R165	-28 631.49	2 963	146.93
L166	-26 560.63	2 964	719.02	R166	-29 273.80	2 962	739.81
L167	-26 570.40	2 964	708.75	R167	-29 860.58	2 962	367.73
L168	-27 095.23	2 964	156.79	R168	-30 440.18	2 962	000.62
L169	-27 293.79	2 963	954.63	R169	-30 622.38	2 961	885.08
L170	-27 366.78	2 963	903.61	R170	-30 901.93	2 961	707.82
L171	-28 090.43	2 963	449.84	R171	-30 966.01	2 961	667.19
L172	-28 584.82	2 963	131.68	R172	-31 455.02	2 961	357.51
L173	-28 593.18	2 963	126.30	R173	-32 036.01	2 960	989.20
L174	-29 169.17	2 962	761.27	R174	-32 484.74	2 960	705.13
L175	-29 838.86	2 962	337.01	R175	-32 847.40	2 960	475.25
L176	-30 418.58	2 961	970.25	R176	-33 050.50	2 960	346.51
L177	-30 603.73	2 961	852.61	R177	-33 134.30	2 960	295.87
L178	-30 944.82	2 961	635.91	R178	-33 212.22	2 960	259.25
L179	-31 242.76	2 961	447.25	R179	-33 321.84	2 960	226.97
L180	-31 434.00	2 961	326.15	R180	-33 425.10	2 960	211.23
L181	-32 015.31	2 960	957.80	R181	-33 981.62	2 960	144.60
L182	-32 423.43	2 960	699.19	R182	-34 561.49	2 960	075.59
L183	-32 830.55	2 960	441.35	R183	-35 325.91	2 959	983.94
L184	-33 052.20	2 960	300.97	R184	-35 678.75	2 959	940.65
L185	-33 148.75	2 960	245.52	R185	-35 833.00	2 959	889.63
L186	-33 230.83	2 960	211.82	R186	-35 978.61	2 959	812.48
L187	-33 336.42	2 960	184.07	R187	-36 532.65	2 959	519.81
L188	-33 967.22	2 960	108.52	R188	-37 011.32	2 959	267.09
L189	-34 555.47	2 960	038.36	R189	-37 019.22	2 959	262.92
L190	-35 336.16	2 959	945.05	R190	-37 693.18	2 958	918.97
L191	-35 523.74	2 959	922.67	R191	-37 953.83	2 958	786.05
L192	-35 672.92	2 959	899.18	R192	-38 117.90	2 958	710.98
L193	-35 813.89	2 959	853.12	R193	-38 750.18	2 958	539.74
L194	-35 954.76	2 959	782.68	R194	-38 865.91	2 958	489.01
L195	-36 541.61	2 959	472.37	R195	-38 947.32	2 958	429.42
L196	-37 002.18	2 959	228.83	R196	-39 000.47	2 958	379.40
L197	-37 678.46	2 958	884.02	R197	-39 414.19	2 957	975.35
L198	-38 008.42	2 958	715.51	R198	-39 514.93	2 957	877.67
L199	-38 101.26	2 958	674.80	R199	-39 528.76	2 957	865.09
L200	-38 205.57	2 958	641.93	R200	-40 051.16	2 957	389.81
L201	-38 737.27	2 958	502.96	R201	-40 090.00	2 957	354.50
L202	-38 844.62	2 958	454.30	R202	-40 345.28	2 957	122.39
L203	-38 916.91	2 958	404.48	R203	-40 541.44	2 956	944.04
L204	-38 988.38	2 958	338.82	R204	-40 547.90	2 956	938.16

Vel Sheet	22	Van of	23	P810/12
--------------	----	-----------	----	---------

PADRESERWE KOÖRDINATE / ROAD RESERVE CO-ORDINATES											
LINKERKANT/LEFT HAND SIDE					REGTERKANT/RIGHT HAND SIDE						
					WG 25°		X				
L205	-39	410.69	2	957	926.39	R205	-40	706.96	2	956	793.67
L206	-39	504.55	2	957	835.98	R206	-40	886.83	2	956	630.27
L207	-39	506.39	2	957	834.31	R207	-40	955.17	2	956	562.24
L208	-40	026.50	2	957	361.29	R208	-41	533.02	2	955	898.23
L209	-40	522.67	2	956	909.98	R209	-41	831.40	2	955	555.69
L210	-40	825.21	2	956	634.99	R210	-41	893.62	2	955	486.37
L211	-40	934.67	2	956	527.38	R211	-41	974.96	2	955	402.51
L212	-41	295.08	2	956	113.76	R212	-42	755.71	2	954	642.80
L213	-41	564.28	2	955	804.82	R213	-43	056.58	2	954	334.99
L214	-41	802.49	2	955	531.21	R214	-43	066.81	2	954	324.31
L215	-41	864.75	2	955	459.20	R215	-43	194.22	2	954	191.33
L216	-41	963.93	2	955	359.69	R216	-43	231.04	2	954	157.54
L217	-42	449.96	2	954	880.89	R217	-43	309.33	2	954	090.53
L218	-43	015.28	2	954	323.83	R218	-43	351.61	2	954	063.18
L219	-43	021.71	2	954	317.30	R219	-43	426.25	2	954	012.50
L220	-43	159.42	2	954	177.65	R220	-43	503.80	2	953	968.01
L221	-43	309.30	2	954	052.76	R221	-43	632.76	2	953	908.05
L222	-43	417.26	2	953	978.47	R222	-43	710.40	2	953	873.84
L223	-43	554.83	2	953	904.62	R223	-43	836.40	2	953	818.33
L224	-43	615.98	2	953	877.86	R224	-44	226.02	2	953	638.51
L225	-43	761.55	2	953	814.14	R225	-44	261.07	2	953	636.70
L226	-43	829.90	2	953	784.25	R226	-44	503.01	2	953	530.13
L227	-44	224.45	2	953	611.37	R227	-44	781.33	2	953	409.26
L228	-44	500.66	2	953	489.49	R228	-44	885.11	2	953	381.29
L229	-44	766.28	2	953	371.79	R229	-44	965.70	2	953	373.14
L230	-44	838.37	2	953	350.70	R230	-45	067.30	2	953	382.41
L231	-44	889.97	2	953	338.51	R231	-45	070.24	2	953	365.27
L232	-44	963.61	2	953	334.80	R232	-45	275.45	2	953	399.92
L233	-45	016.91	2	953	334.86	R233	-45	501.38	2	953	439.42
L234	-45	074.32	2	953	341.50	R234	-45	502.80	2	953	420.45
L235	-45	072.58	2	953	351.64	R235	-45	543.59	2	953	192.40
L236	-45	274.26	2	953	385.82	R236	-45	562.59	2	953	097.47
L237	-45	480.71	2	953	420.88	R237	-45	613.81	2	952	804.34
L238	-45	487.69	2	953	417.12	R238	-45	665.80	2	952	499.23
L239	-45	535.29	2	953	144.96	R239	-45	668.71	2	952	499.73
L240	-45	595.23	2	952	799.91	R240	-45	725.96	2	952	215.59
L241	-45	647.33	2	952	496.05	R241	-45	767.82	2	952	072.21
L242	-45	631.45	2	952	493.32	R242	-45	843.71	2	951	932.32
L243	-45	679.21	2	952	228.67	R243	-45	931.78	2	951	826.86
L244	-45	686.08	2	952	208.71	R244	-45	954.65	2	951	808.24
L245	-45	718.58	2	952	096.37						
L246	-45	764.85	2	951	988.43						
L247	-45	798.99	2	951	927.02						
L248	-45	888.65	2	951	807.68						
L249	-45	927.96	2	951	776.07						









Printed by and obtainable from the Government Printer, Bosman Street, Private Bag X85, Pretoria, 0001  
Publications: Tel: (012) 334-4508, 334-4509, 334-4510  
Advertisements: Tel: (012) 334-4673, 334-4674, 334-4504  
Subscriptions: Tel: (012) 334-4735, 334-4736, 334-4737  
Cape Town Branch: Tel: (021) 465-7531

Gedruk deur en verkrygbaar by die Staatsdrukker, Bosmanstraat, Privaatsak X85, Pretoria, 0001  
Publikasies: Tel: (012) 334-4508, 334-4509, 334-4510  
Advertensies: Tel: (012) 334-4673, 334-4674, 334-4504  
Subskripsies: Tel: (012) 334-4735, 334-4736, 334-4737  
Kaapstad-tak: Tel: (021) 465-7531